

FERNIE

87-671-16448

7/88



Province of British Columbia

Ministry of Energy, Mines and Petroleum Resources

ASSESSMENT REPORT
TITLE PAGE AND SUMMARY

TYPE OF REPORT/SURVEY(S)	TOTAL COST
DRILLING	\$13,883.00

AUTHOR(S) Alfred R. Allen SIGNATURE(S) *Alfred R. Allen*

DATE STATEMENT OF EXPLORATION AND DEVELOPMENT FILED July 22/87 YEAR OF WORK: 1987

PROPERTY NAME(S) ELDERBERRY

COMMODITIES PRESENT

B.C. MINERAL INVENTORY NUMBER(S), IF KNOWN

MINING DIVISION Fort Steele

NTS 82G/6E

LATITUDE 49°20'06" LONGITUDE 115°09'12"

NAMES and NUMBERS of all mineral tenures in good standing (when work was done) that form the property (Examples: TAX 1-4, FIRE 2 (12 units), PHOENIX (Lot 1706); Mineral Lease M 123; Mining or Certified Mining Lease ML 12 (claims involved)):

Elderberry 3, 4 (40 units)

OWNER(S)

(1) (2) Larry Becket

MAILING ADDRESS

P.O. Box 2
Galloway, B.C. V0B 1P0

OPERATOR(S) (that is, Company paying for the work)

(1) R.H. Stanfield (2)

MAILING ADDRESS

#350-4723 1st St., S.W.
CALGARY, ALBERTA
T2G 0A1

16,448

GEOLOGICAL BRANCH
ASSESSMENT REPORT

SUMMARY GEOLOGY (lithology, age, structure, alteration, mineralization, size, and attitude)

The Elderberry 3 and 4 claims are underlain by Upper Devonian limestone, argillaceous limestone and sandstone, and Mississippian limestone, limy siltstone and black shale. The well bedded strata strike north and dip 20 to 30 degrees west.

The Rimrock workings, exposing copper, silver and gold mineralization are located in the central east area of the Elderberry 4 claim.

REFERENCES TO PREVIOUS WORK

LOG NO: 1026	RD.
ACTION:	
FILE NO: 87-671 1648	

CONTENTS

TITLE PAGE AND SUMMARY 1 & 2

A. INTRODUCTION 3.

B. LOCATION 3.

C. PROPERTY 3.

D. PHYSIOGRAPHY 3.

E. GEOLOGY 4.

F. PREVIOUS WORK 4.

G. THEORY 4.

H. OBJECT OF THE DRILLING 5.

I. THE AIR ROTARY PERCUSSION DRILLING 5.

J. DRILLING RESULTS 5.

K. DISCUSSION 6.

L. SUMMARY 6.

REFERENCES 7.

COSTS STATEMENT

CERTIFICATE

- MAPS:
1. Location
 2. Topography, claims, Holes P-E-1-87, P-E-2-87
 3. Elderberry #4 claim, Holes P-E-1-87, P-E-2-87

* * * * *

SUB-RECORDER
RECEIVED

OCT 19 1987

M.R. # \$

VANCOUVER, B.C.

FILMED

A. INTRODUCTION

Two rotary holes were drilled near the northwest area of the Elderberry #4 claim to depths of 19.2 metres and 54.8 metres.

The drilling was contracted by R.H. Stanfield to Fort Steele Mineral Corporation.

The object of the drilling was to test the area for the possible extension of the Rimrock copper, silver, gold showings.

B. LOCATION

The property is located 2 kilometres north of Elko. Access to the drill sites is via secondary road from Elko 5 kilometres northwesterly,

C. PROPERTY

The Elderberry #4 group includes the Elderberry 3-(1484) July and Elderberry 4-(1485) July covering a 40 unit area.

D. PHYSIOGRAPHY

The property is located near the southern extremity of the Front Range of the Rocky Mountains.

The Elderberry #3 is located in rugged mountainous terrain from 1,220 metres to 2,290 metres above sea level.

The Elderberry #4 claim is located mostly in the Rocky Mountain Trench, about 900 metres elevation but extends easterly up to an elevation of 1,520 metres.

Drainage is by Callaghan and other south flowing creeks to the Elk River.

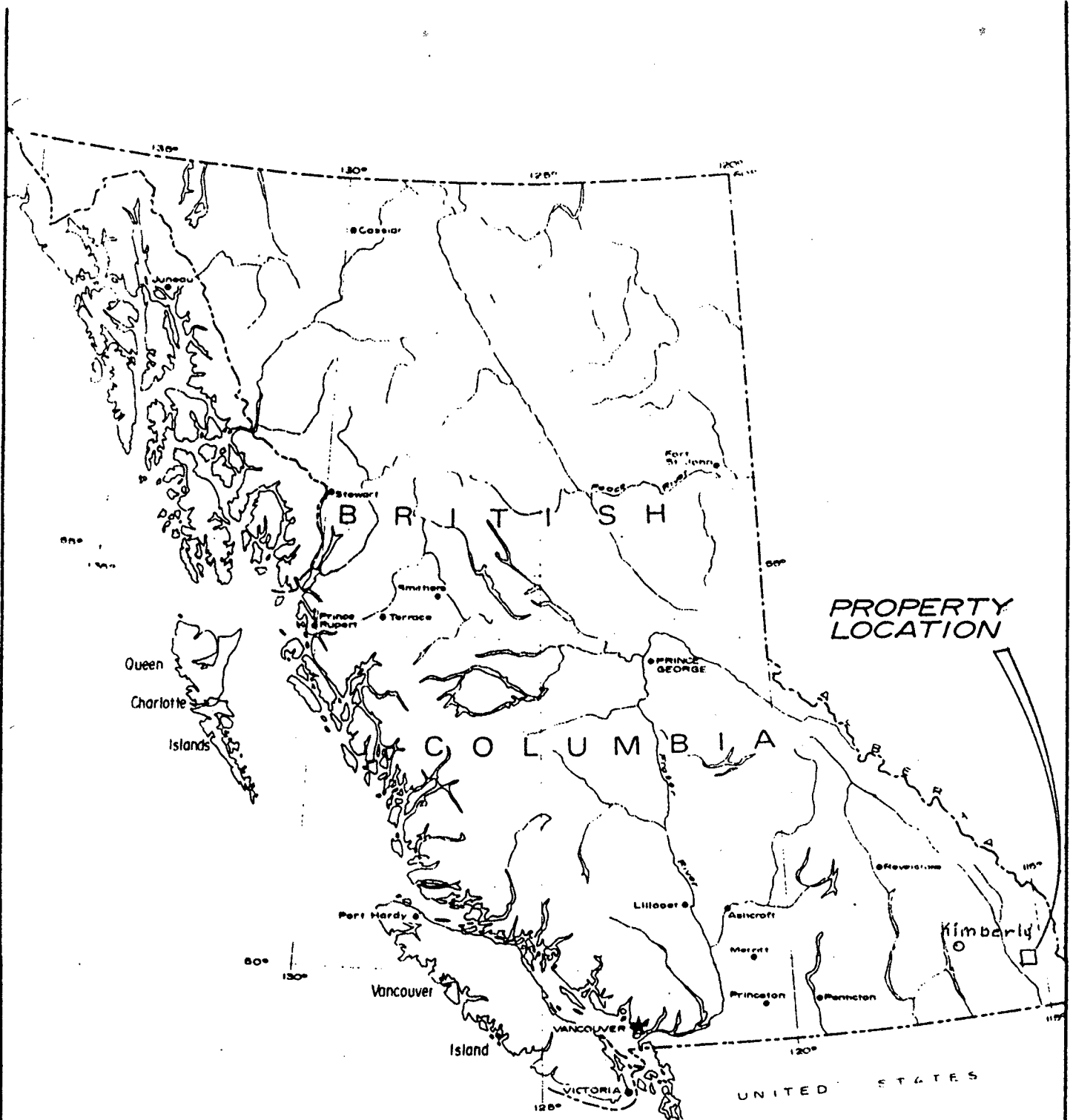

R.H. STANFIELD

LOCATION MAP

SCALE: 1" = 136 Mls.

Drawn by	Date	ALLEN GEOLOGICAL ENGINEERING LTD.
Checked by	Oct. / 87	
	Drq no. 1	

E. GEOLOGY

The Elderberry Group #4 claims are underlain by Upper Devonian Palliser and Alexo formations composed of massive grey limestone, thin bedded argillaceous limestone and sandstone.

This is overlain by the Mississippian Rundle group composed of grey limestone; the Banff formation composed of dark cherty limestone, grey limestone and limy siltstone; and the Exshaw formation of black shale and limestone.

The strata strike northerly and dip 20 to 30 degrees westerly.

Major and minor faulting has resulted on the above formation being underlain by Middle Cambrian Jubilee and Elko formations of dolomite, and Burton shale, limestone, sandstone and conglomerate; Precambrian Roosville argillite and siltstone; and Gateway grey-green argillite, siltstone and buff-weathering dolomite.

The Rimrock mineral showings, on the Elderberry #4 claim are composed of quartz-siderite veins containing copper, silver and gold values. Workings include 2 short adits and surface trenching. The host rock appears to be Gateway formation.

F. PREVIOUS WORK

The geology of the area was mapped by G.B. Leech of the G.S.C. and published - Paper 58-10.

No information is available regarding the Rimrock workings.

G. THEORY

Drilling on the Elderberry #4 claim was conducted to ascertain, if possible, the bedrock formation on the floor of the Rocky Mountain Trench, in order to correlate with the host rock of the Rimrock showings.

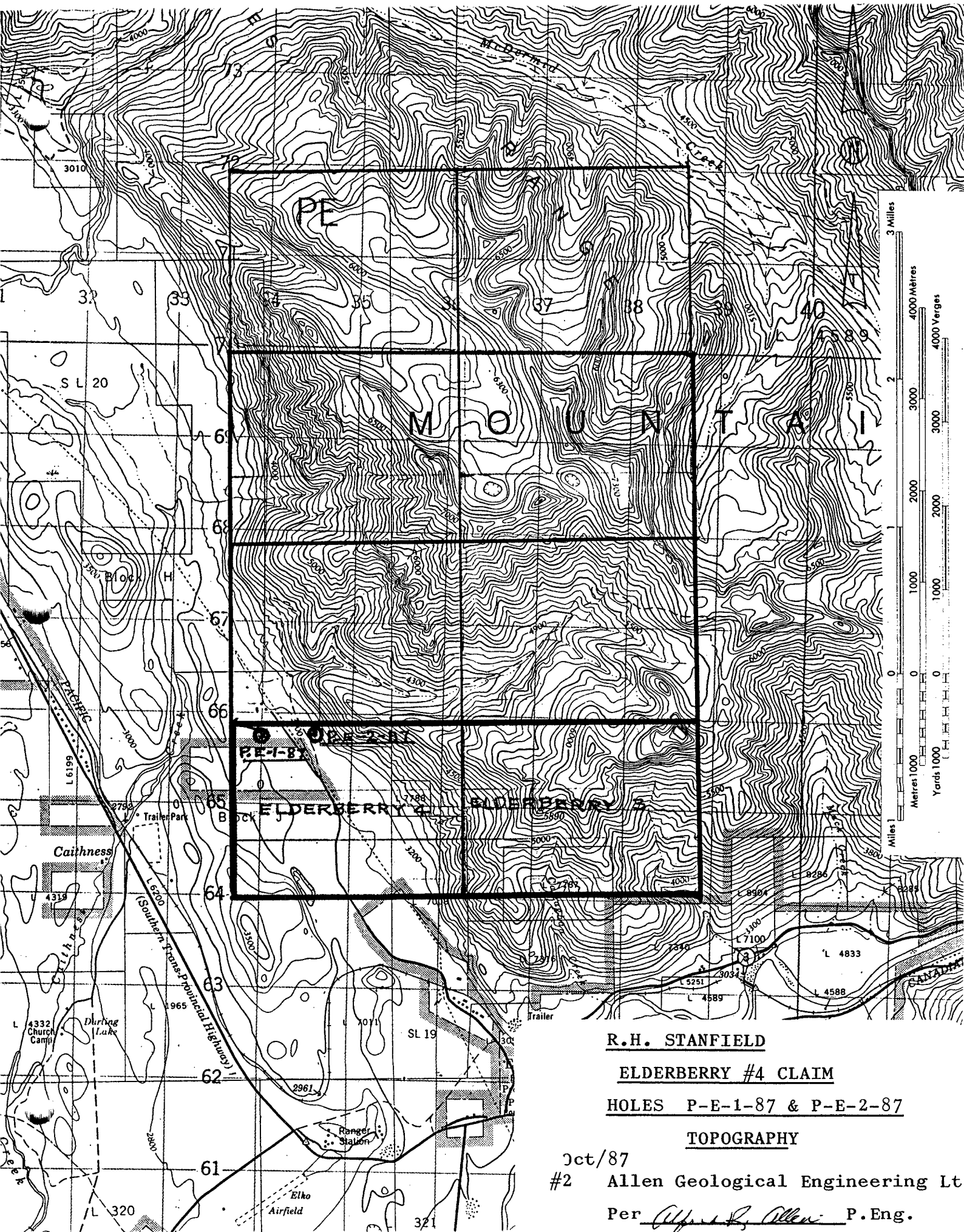

R.H. STANFIELD

ELDERBERRY #4 CLAIM

HOLES P-E-1-87 & P-E-2-87

TOPOGRAPHY

Oct/87

#2

Allen Geological Engineering Lt

Per Allen P. Eng. P. Eng.

H. OBJECT OF THE DRILLING

The percussion drilling on the Elderberry #4 claim was located in the Rocky Mountain Trench in order to check the geology in the floor of the Trench.

I. THE AIR ROTARY PERCUSSION DRILLING

The 2 drill holes on the Elderberry #4 claim were contracted with the following equipment and crew.

- 1 Ingersol Rand T H-60 rotary percussion rig with compressor and accessories
- 1 Drill stem trailer
- 1 Five ton water truck
- 1 Thirty-foot rod trailer and rods

Don Murray, driller, Strathmore, Alberta
Duane Bocek, driller, Strathmore, Alberta

Assisted by the following Stanfield crew

Ross Stanfield Jr. Coordinator
Brent Skene, foreman
2 Trucks, 4x4, 3/4 ton

J. DRILLING RESULTS

#1 hole was drilled 19.2 metres in overburden

#2 hole was drilled through 18 metres of overburden and 36.8 metres of light to dark grey banded argillite.

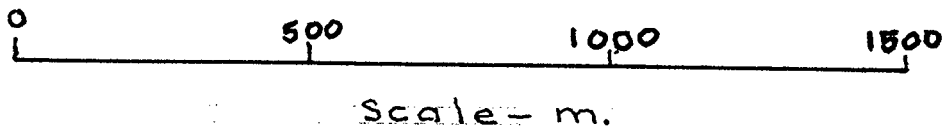
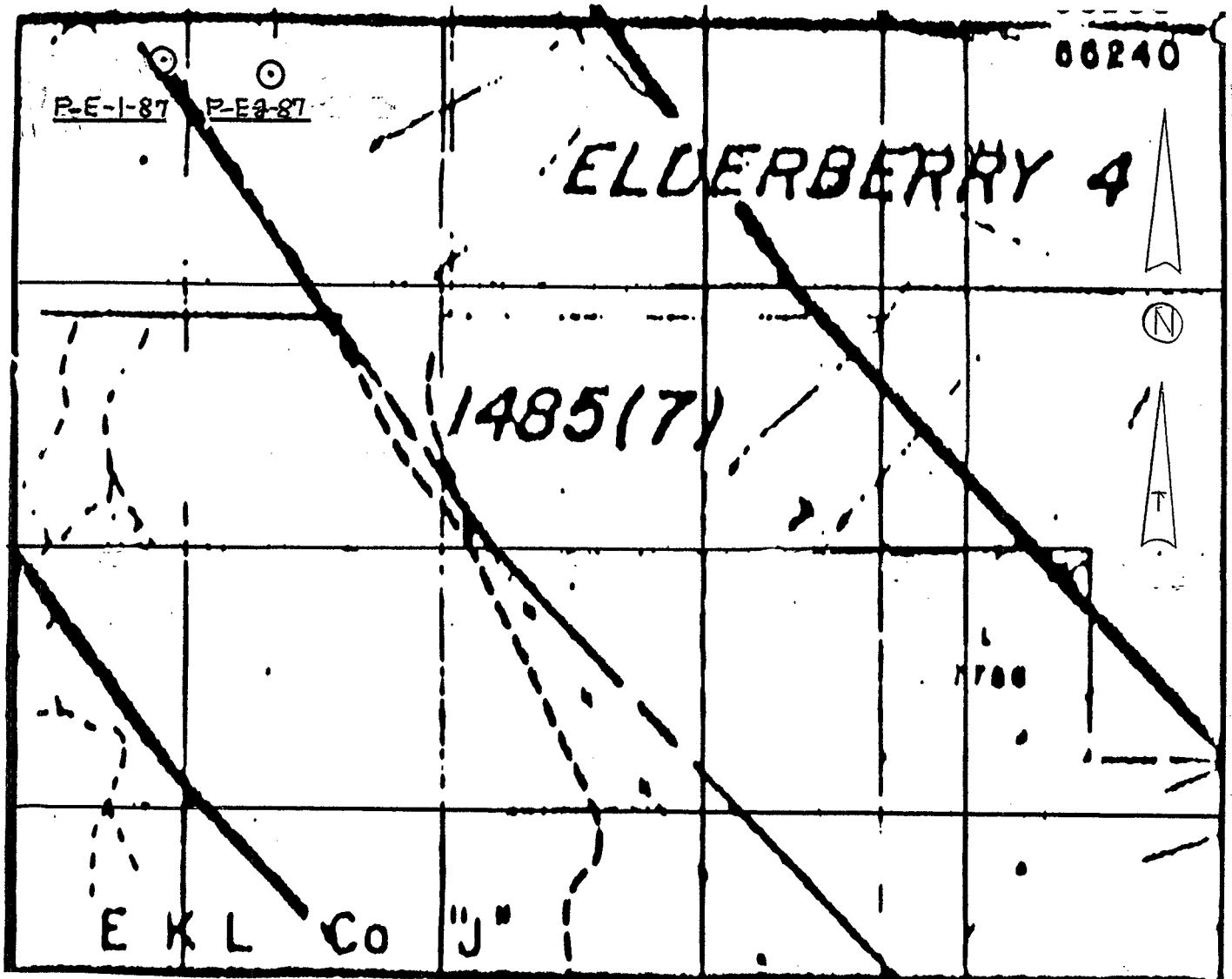

R.H. STANFIELD

ELDERBERRY #4 CLAIM

DRILL HOLES P-E-1-87 & P-E-2-87

Oct/87

#3 Allen Geological Engineering Ltd

Per Alfred J. Allen P.Eng.

K. DISCUSSION

The P-E-2-87 hole penetrated bedrock of light and dark grey argillite.

The cuttings provide insufficient information to determine stratigraphy or structure.

L. SUMMARY

The two vertical percussion holes drilled on the northwest boundary of the Elderberry #4 claim provided bedrock depth to be 18 metres and 36.8 metres of light and dark grey banded argillite.

The #2 hole did not provide sufficient information to classify the formation.

Submitted by:

Allen Geological Engineering Limited

Per Alfred R. Allen P.Eng.

October 1987.

REFERENCES

- Leech, G.B. G.S.C. Paper 58-10, Map 20, 1958
- Allen, A.R., Report on the Holdings of R.H. Stanfield
 Southeastern B.C. August 17, 1976.
- Chiang, M.C., Placid Oil Company, Reports, 1973-1976

* * * * *



FORT STEELE MINERAL CORPORATION LTD.

COSTS STATEMENT

ROTARY DRILLING REPORT

R.H. STANFIELD

<u>BY CONTRACT:-</u>	June 25 - July 3, 1987	
<u>LOCATION:-</u>	Elderberry #4 Claim, 945 m. A.S.L.	
<u>DIRECTION:-</u>	Vertical	
<u>LENGTH:-</u>	Hole #1, 19.2 m. Hole #2, 54.8 m.	
<u>COST:-</u>	740 m. @ \$147/m.	\$ 10,878.00
Accommodation & Meals:-	4 men, 2 days @ \$65/day	\$ 520.00
Coordinator:-	18 hours @ \$15/hr.	\$ 270.00
Foreman:-	18 hours @ \$15/hr.	\$ 270.00
Mobilization and Demobilization:-		\$ 1,000.00
Clean-up :-		\$ 155.00
Trucks:-	2, 4x4, 3/4 ton, 2 days @ \$50/day	\$ 200.00
A.R. Allen, Consulting and Reporting:-		\$ 590.00
		<hr/>
	To all inclusive:-	\$ 13,883.00

Drill Crew:- Don Murray, driller, Strathmore, Alberta.
Duane Bocek, driller, Strathmore, Alberta.
Ross Stanfield Jr. Coordinator, Galloway, B.C.
Brent Skene, Foreman, Galloway, B.C.

LILLIAN MORASH
Secretary

702 - 2025 Bellevue Avenue
West Vancouver, B.C.
V7V 1B9

CERTIFICATE

I, Alfred R. Allen, certify that:

I am a graduate of the University of British Columbia
and hold the following degrees therefrom:

BASc Geological Engineering 1939

MASc Geological Engineering 1941

I am a Life Member of the Association of Professional
Engineers of the Province of British Columbia.

I have practised my profession for the past forty years.

I hold no interest in the properties or securities of
R.H. Stanfield, or affiliates thereof, nor do I expect
to receive any directly or indirectly.

The report on the Air Rotary Percussion drilling on the
Elderberry #6 claim is based on examination of the area
drilled and inspection of the cuttings by the writer
August 4, 5, 6, 1987.

I consent to this report being filed with the British
Columbia Securities Commission.

Alfred R. Allen P.Eng.

Alfred R. Allen

October 1987.