

LOG NO: 0426	RD. 3
ACTION: Date received report back from amendments.	
FILE NO:	

LOG NO: 1126	RD.
ACTION:	
FILE NO: 87-801 16475	

GEOLOGICAL  
AND  
PHYSICAL REPORT  
ON THE  
VOLCANO GROUP  
GREENWOOD MINING DIVISION  
BRITISH COLUMBIA  
NTS 82E/7W  
LATITUDE 49° 27' <sup>06"</sup> N LONGITUDE 118° 58' <sup>48"</sup> W

Owners - Robert Hart  
Gordon Houllind

Operator: G. Houllind

Author of report  
J. Paul Stevenson

October 2, 1987

**GEOLOGICAL BRANCH  
ASSESSMENT REPORT**

**16,475**

<b>SUB-RECORDER RECEIVED</b>
NOV 19 1987
M.R. # ..... \$.....
VANCOUVER, B.C.

TABLE OF CONTENTS:

1. Introduction / Access / Geology/ Recommendations /	.... Page 1-2
2. Statement of Costs	.... Page 3
3. Claim Information	.... Page 4
4. Certificate of Assay	.... Page 5
5. Certification	.... Page 7

ILLUSTRATIONS

Location Map	at front
Claim Maps	at front
Trenches	... Page 6

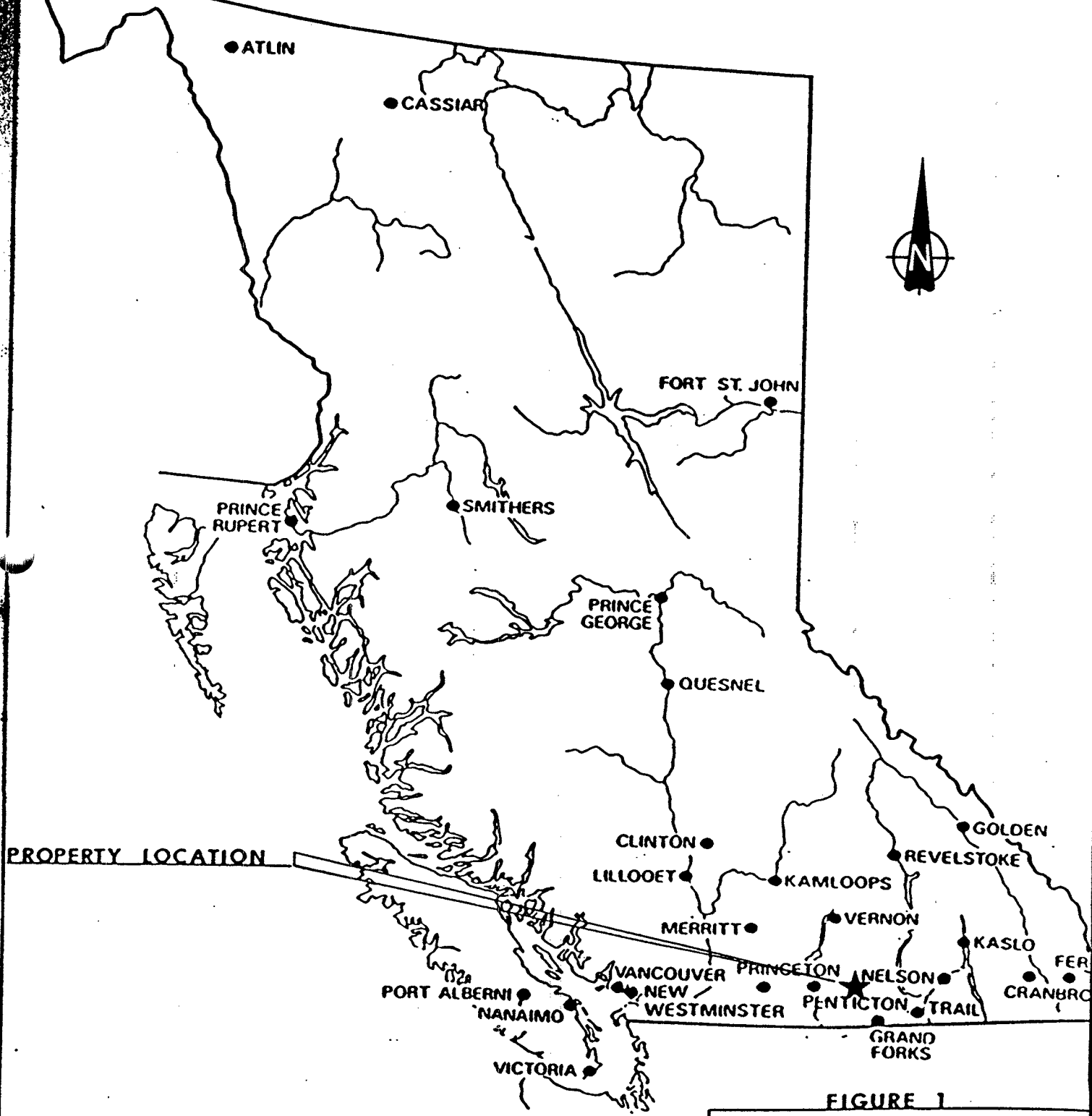

SCALE

1:8,000,000

FIGURE 1  
LOCATION MAP

VOLCANO GROUP

DATE 14-04-88

DRAWN BY af

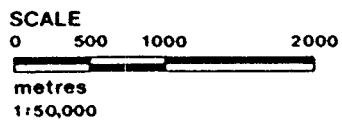
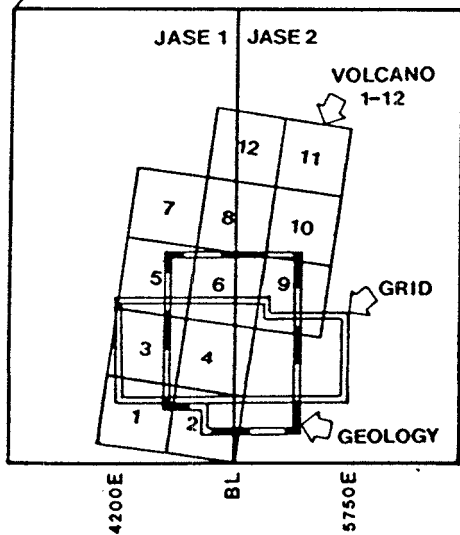
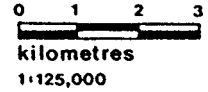
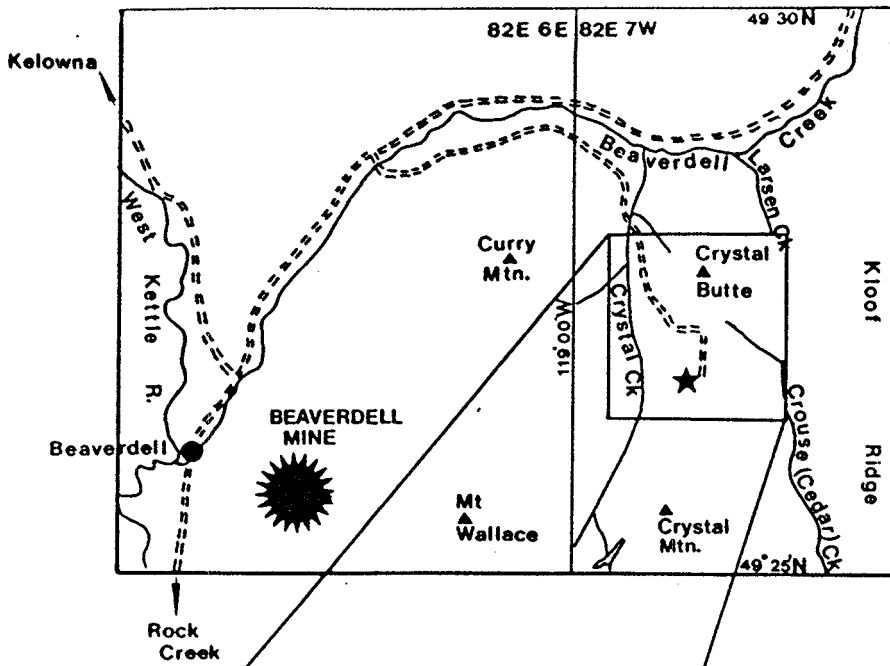

★ main workings

VOLCANO GROUP	
<b>CLAIM, GRID &amp; GEOLOGY</b>	
LOCATIONS	
FIGURE	NTS 82E 7W
DATE 16-04-88	

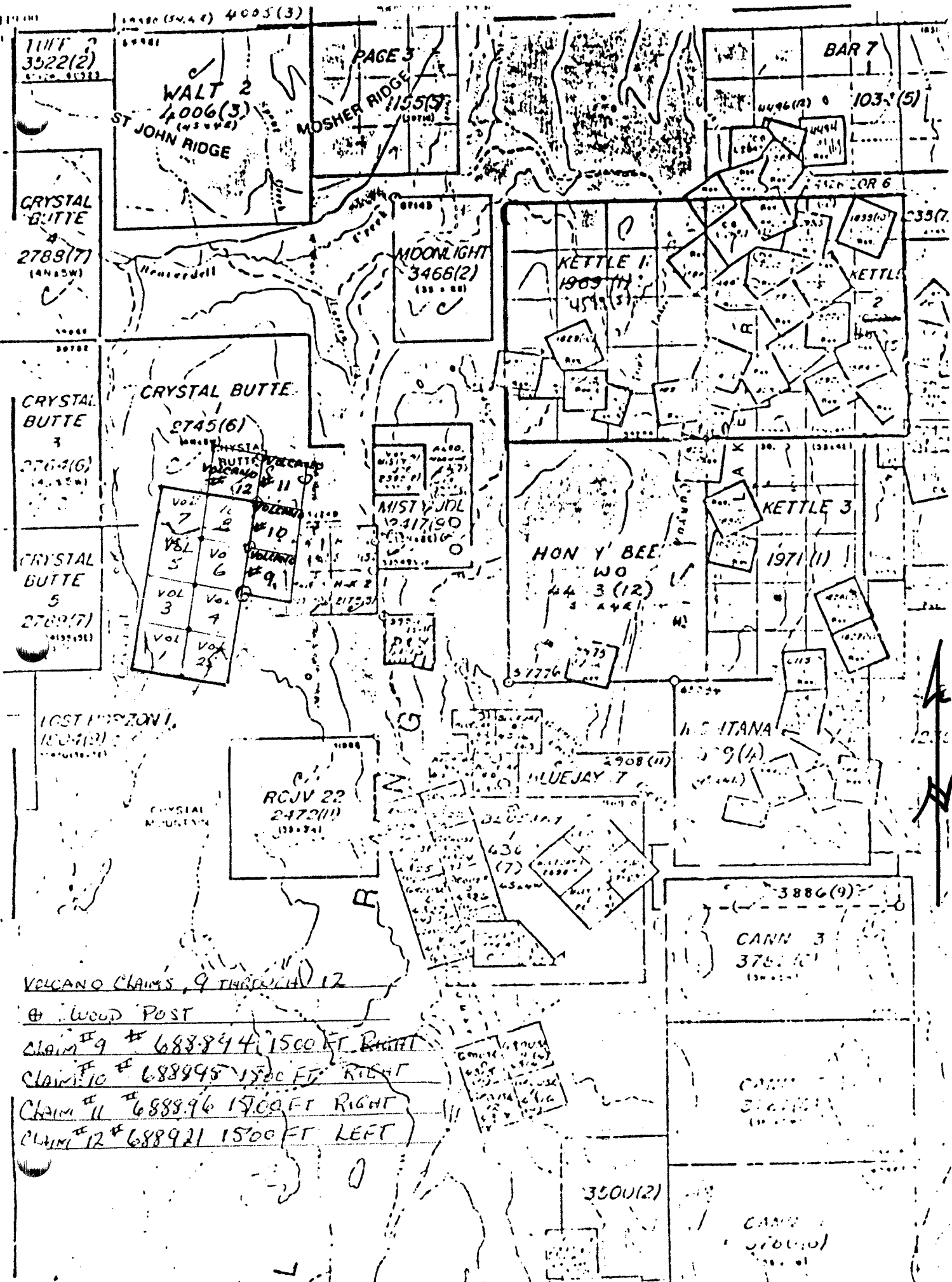

1000 (54.4) 4005 (3)

PAGE 3

WALT 2  
1006(3)  
ST JOHN RIDGE

MOSHER RIDGE  
1155(3)

BAR 7

103(5)

CRYSTAL BUTTE  
2789(7)

MOONLIGHT  
3468(2)

KETTLE 1  
1909(12)

KETTLE 2

CRYSTAL BUTTE  
3  
2764(6)

CRYSTAL BUTTE

2745(6)

MISTY JDL  
2417(90)

HON Y BEE  
WO  
44 3(12)

KETTLE 3

1971(11)

CRYSTAL BUTTE  
5  
2769(7)

VOL 7	11	VOLCANO #11
VBL 5	Vo 6	VOLCANO #9
VOL 3	Vol 4	
VOL 1	Vol 2	

1000 (54.4)

RCJV 22  
2472(11)

BLUEJAY 7  
2908(11)

MONTANA

3886(9)  
CANN 3  
375(10)

VOLCANO CLAIMS, 9 THROUGH 12

- WOOD POST
- CLAIM #9 # 688844 1500 FT RIGHT
- CLAIM #10 # 688945 1500 FT RIGHT
- CLAIM #11 # 688946 1500 FT RIGHT
- CLAIM #12 # 688921 1500 FT LEFT

3500(12)

CANN 3  
375(10)

## INTRODUCTION

A road to the property has been re-opened and some trenching has been completed at the north end of the claims. Limited mapping and sampling has been completed by the author with a geologist.

## ACCESS

The property can be reached by way of the Crystal Lake Road which leaves the Beaverdell Creek Forestry Road west of its junction with the Crouse Creek Forestry Road. The recently rehabilitated four wheel drive access road leaves the Crystal Lake Road just north of Crystal Lake and cuts the claims at the northern end where trenching was done.

## GEOLOGY

Regionally, this part of the Province is underlain by extensive bodies of the Nelson and Valhalla plutonic rocks of Cretaceous age, with inliers of older and younger meta-sediments and meta-volcanics.

The oldest rocks in the map area are the Anarchist (Wallace) Group of Paleozoic age. These rocks, which comprise the majority of outcroppings, include quartzites, limestones (locally marbleized and silicified), paragneiss, and minor greenstones that outcrop southwest of the claims.

Samples taken at the main adit were from Quartz lenses within shear zones. The country rock is a fractured and sheared quartzite. The lenses are mineralized with galena, sphalerite, chalcopyrite and silver. A sample taken at the Final Post of Volcano 1 and 2

was also primarily quartz vein material. The samples taken from the trench were primarily marbleized limestone, with hematite. The samples were taken from gossaned shears some skarn development was observed.

The trenches are at the Final Post of Volcano 5,6. Trench 1 bears 190° is 1.2 m deep, 42 m long and cuts meta-sediments. Trench 2 bears 315° is 2 m deep, 17 m long and has narrow quartz stringers in shears. There is abundant hematite. Trench 3 bears south is 45.3 m long and is 1.5 m deep. Marbling is found in the trench.

#### RECOMMENDATIONS

The property should be examined geochemically and geophysically. A grid should be established with consideration to locating both skarn and vein developments. A detailed geological map should be prepared.

STATEMENT OF COSTS

Road rehabilitation all inclusive with swamper

(D-8) 4 hours @ \$80.00 \$320.00

Trenching all inclusive with swamper

(D-8) 8 hours @ \$80.00 640.00

J. Paul Stevenson

2 days @ \$200.00 400.00

G. Nicholson BSc.

1 day @ \$200.00 200.00

TOTAL\$1,560.00



CLAIM INFORMATION

<u>CLAIM NAME:</u>	<u>RECORD NO.</u>	<u>RECORD DATE:</u>
Volcano 1	# 4652	Aug. 22, 1986
Volcano 2	# 4653	" " "
Volcano 3	# 4654	" " "
Volcano 4	# 4655	" " "
Volcano 5	# 4656	" " "
Volcano 6	# 4657	" " "
Volcano 7	# 4658	" " "
Volcano 8	# 4659	" " "
Volcano 9	# 4722	Sept. " 24 " 86
Volcano 10	# 4723	" " "
Volcano 11	# 4724	" " "
Volcano 12	# 4725	Sept. 24, 1986

MIN-EN LABORATORIES LTD.

Specialists in Mineral Environments

705 West 15th Street North Vancouver, B.C. Canada V7M 1T2

TELE: (604) 980-5814 DR (604) 988-4524

TELEX: VIA USA 7601067 UC

Certificate of ASSAY

Company: J.P. STEVENSON & ASSOC.

Project:

Attention: J.P. STEVENSON

File: 7-885/P1

Date: JULY 28/87

Type: ROCK ASSAY

We hereby certify the following results for samples submitted.

Sample Number	CU %	PB %	ZN %	AG G/TONNE	AG OZ/TON	AU G/TONNE	AU OZ/TON
3901	.004			.6	0.02	.01	0.001
7-11-3	.930			5.7	0.17	.64	0.019
7-11-4	1.090			7.4	0.22	3.20	0.093
15-7-1		1.02	11.10	99.0	2.89		
15-7-2		13.80	2.14	1360.0	39.67		
15-7-3		1.35	.18	40.0	1.17		
7-16-1		4.34	.02	84.7	2.47	<i>F.P. 1,2</i>	
7-16-2		17.50	2.27	194.0	5.66	<i>Adit</i>	
7-16-3		3.08	2.30	54.5	1.59	<i>Adit</i>	
7-16-4		.37	.62	10.2	0.30	<i>Adit</i>	
7-16-5		.02	.81	47.0	1.37	<i>trach</i>	
7-16-6		.54	1.07	113.0	3.30	<i>trach.</i>	
7-16-7		.03	3.72	32.3	0.94	<i>trach.</i>	

Certified by



MIN-EN LABORATORIES LTD.

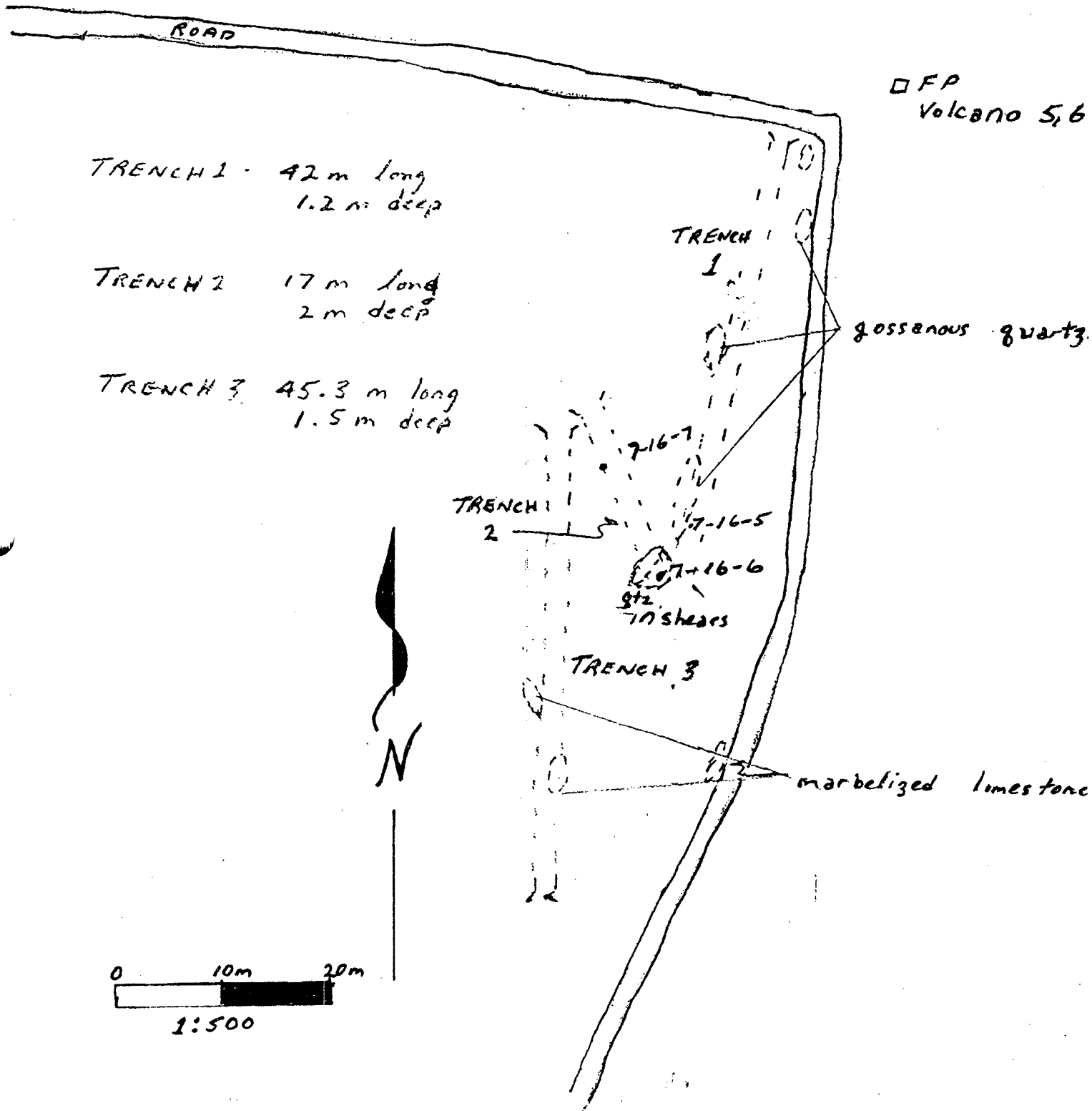

TRENCH 1 - 42 m long  
1.2 m deep

TRENCH 2 17 m long  
2 m deep

TRENCH 3 45.3 m long  
1.5 m deep

□ FP  
Volcano 5,6

TRENCH 1

gossensous quartz

TRENCH 2

7-16-7

7-16-5

7-16-6

qtz  
in shears

TRENCH 3

marbelized limestone



1:500

I, J. Paul Stevenson, having office at #618 - 475 Howe Street, Vancouver, B.C. V6C 2B3, do certify that;

- 1) I am a prospector, practicing my vocation since 1965 in British Columbia, The Yukon Territories, and Western U.S.A.;
- 2) I sampled and prospected inspected the trenches noted in this report;
- 3) I have managed numerous exploration and development projects.

Yours truly,

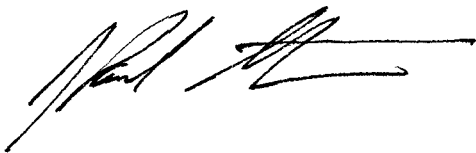
A handwritten signature in black ink, appearing to read 'J. Paul Stevenson', with a long horizontal flourish extending to the right.

J. Paul Stevenson