

Monashee Geological Consultants

GEOCHEMICAL AND GEOLOGICAL REPORT
ON THE
PATSY PROPERTY
NIS: 92H/8E

LOG NO: 1113	RD.
ACTION: 24pp.	
FILE NO: 87-741-16554	

SIMILKAMEEN MINING DIVISION

LATITUDE: $49^{\circ} 22' 12''$ N

LONGITUDE: $120^{\circ} 10' 09''$ W

for

FILMED

Owner/Operator: Mr. T.E. Kirk, President

Hedley-Sterling Explorations Inc.

210 - Burnes House

26 - Bastion Square

Victoria, B.C.

V8W 1H9

**GEOLOGICAL BRANCH
ASSESSMENT REPORT**

by

R.D. Kregosky, B.Sc., M.A.C.

16,554

September 15, 1987

Monashee Geological Consultants

TABLE OF CONTENTS

Introduction.....	Page 1
Location and Access	Page 1
Property Description.....	Page 1
Topography and Climate.....	Page 2
Regional Geology.....	Page 2
History.....	Page 2
Geochemical and Geological Surveys.....	Page 3
1. Central Zone.....	Page 4
2. Southern Zone.....	Page 4
Conclusion and Recommendations.....	Page 5
Cost Statement.....	Page 6
References.....	Page 7
Certificate.....	Page 8
Appendix: Assay Certificate.....	Page 9

Illustrations

1. Location Map.....	Fig. 1
2. Claim Location.....	Fig. 2
3. Survey Location.....	Fig. 3
4. Geochemical Survey: Central Zone.....	Fig. 4
5. Geological Survey: Central Zone.....	Fig. 5
6. Geochemical Survey: Southern Zone.....	Fig. 6
7. Geological Survey: Southern Zone.....	Fig. 7

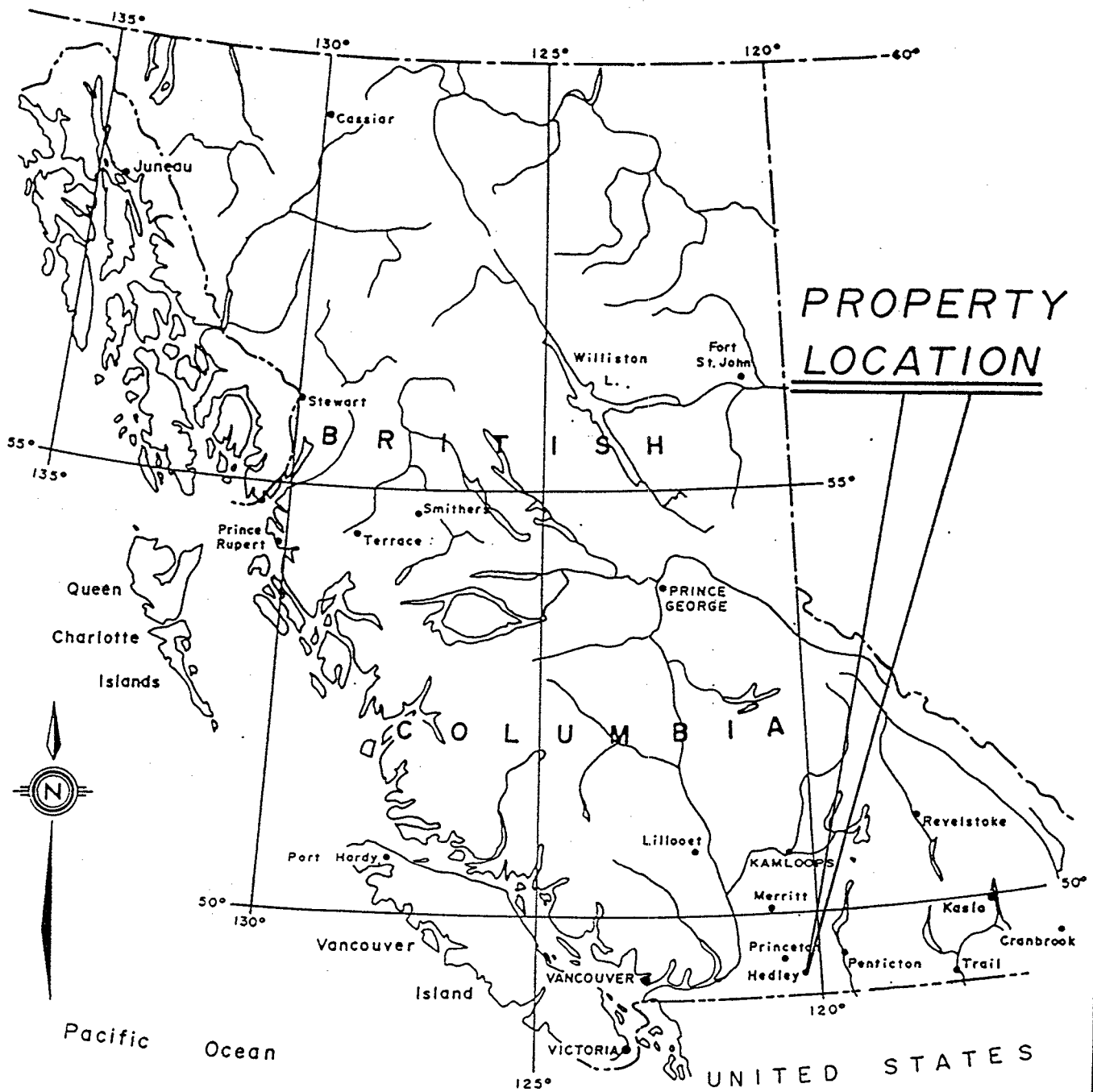

PROPERTY LOCATION

HEDLEY-STERLING EXPLORATIONS INC.		
PATSY PROPERTY		
HEDLEY, B.C. - SIMILKAMEEN M.D.		
PROPERTY LOCATION MAP		
MONASHEE GEOLOGICAL CONSULTANTS	NTS: 92H/8E SEPT.15/87	FIG. 1

Monashee Geological Consultants

INTRODUCTION

The author was retained by Hedley-Sterling Explorations to conduct a small scale exploration program over portions of the Patsy Property located near Hedley, B.C.

This report is based on field surveys made on the property during the period July 6 - July 11, 1987 as well as on the research of various published and unpublished accounts of the claims.

LOCATION AND ACCESS

The Patsy property (fig. 1) is situated approximately 7 km. west of Hedley, B.C. on the south side of the Similkameen River. This location is within the boundaries of the Similkameen Mining Division.

Access to the claims is by 1 km. of dirt road that joins B.C. Highway #3, 7.2 km. west of Hedley. A $\frac{1}{2}$ km. trail leads from the road to old workings in the northern portion of the property. Alternate access is available along the Sterling Creek Forestry Road which joins Highway #3, 7.8 km. west of Hedley. The property is situated immediately to the east of Sterling (Whistle) Creek.

PROPERTY DESCRIPTION

The Patsy property (fig. 2) consists of ten contiguous claims as outlined below:

<u>Claim</u>	<u>Lot/Record No.</u>	<u>Record Date</u>	<u>Expiry Date</u>	<u>Units</u>
Patsy	L3404s			1
Patsy 1	L3403s			1
Patsy 2	L3407s			1
Ivanhoe	(L3406s) 389	July 17/78	July 17/88	1
B.C.	(L3408s) 390	July 17/78	July 17/88	1
Grandview	(L3405s) 391	July 17/78	July 17/88	1
Gary	395	Aug. 4/78	Aug. 4/88	1
Gary 1	396	Aug. 4/78	Aug. 4/88	1
Gary 2	397	Aug. 4/78	Aug. 4/88	1
Gary 3	400	Aug. 4/78	Aug. 4/88	1

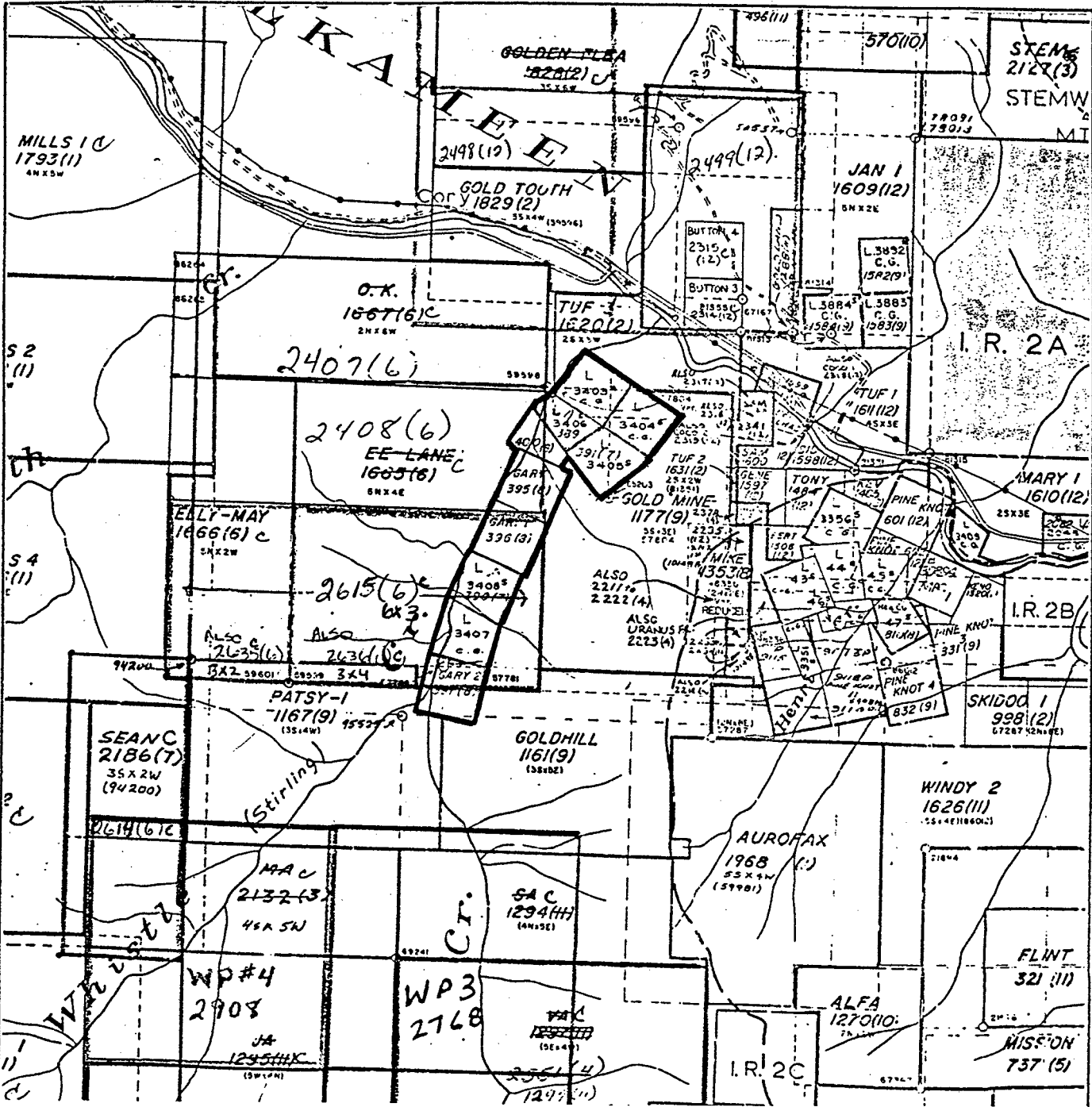

HEDLEY-STERLING EXPLORATIONS INC.

PATSY PROPERTY

CLAIM LOCATION

SIMILKAMEEN M.D.

MONASHEE GEOLOGICAL CONSULTANTS	NTS: 92 H/8 E SEPT. 15 / 87	Fig. no. 2
---------------------------------------	--------------------------------	------------

Monashee Geological Consultants

TOTAL UNITS

10

The Gary, Gary 1-3 two-post claims and the Ivanhoe, B.C. and Grandview reverted Crown grants have recently been acquired by Hedley-Sterling Explorations. The Patsy and Patsy 1 and 2 Crown Grants are owned by Mrs. L. Martin of Penticton and held under option.

TOPOGRAPHY AND CLIMATE

The Patsy claims are located on steep, moderately timbered slopes which have westerly exposures. Elevations range from 580m. in the west to more than 1000m. in the eastern portions. The main topographic feature on the claims is Sterling Creek which parallels the western claim boundary. This creek would provide adequate water resources for development purposes. Slopes are consistently steep except where broken by cliffs.

The property is located in the Interior Dry Belt and has low annual precipitation.

REGIONAL GEOLOGY

The Hedley region is underlain by Nicola Group rocks of late Triassic Age. These consist of interbedded to massive sequence of quartzites, argillites and limestones with a lesser amount of basic volcanic rocks. The Nicola Group have been intruded by small stocks, sills and dykes of gabbro and diorite. The Nicola rocks are bordered on the north and south by the Pennask and Similkameen granite batholiths of Jurassic Age.

HISTORY

The Hedley region is historically and currently recognized as a gold camp. The deposits are replacement bodies which are hosted by Nicola Group rocks. These gold deposits occur with arsenopyrite, pyrite, pyrrhotite, chalcopyrite and sphalerite in calc-silicate hornfels adjacent to intrusive rocks.

Elsewhere in the area, including Sterling Creek, gold mineralization

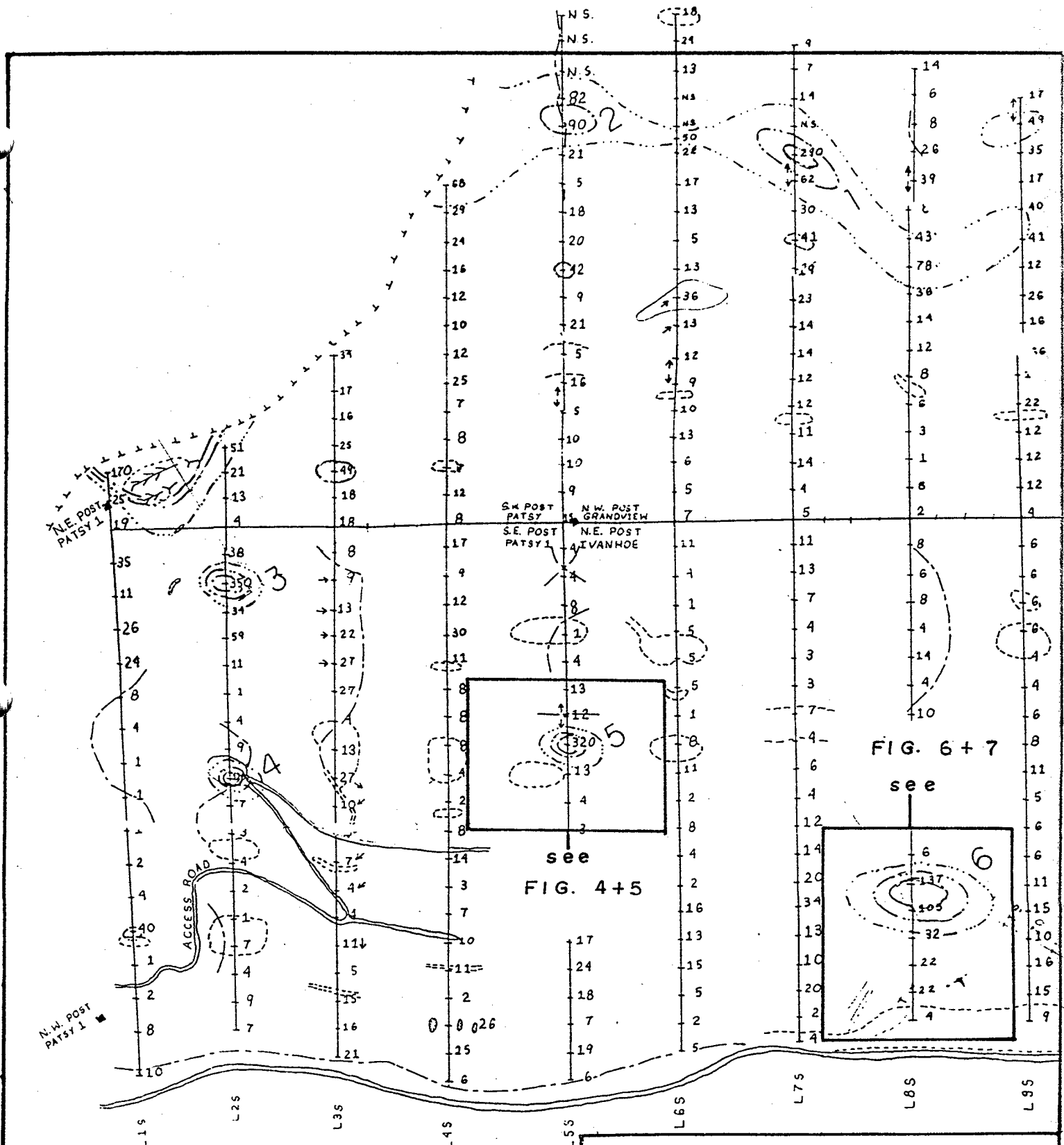

FIG. 6+7

see

see
FIG. 4+5

HEDLEY-STERLING
EXPLORATIONS INC.

PATSY CLAIMS
SURVEY LOCATION MAP
(after Smitheringale '83)

MONASHEE
GEOLOGICAL
CONSULTANTS

NTS: 92H/8E
SEPT. 15/87

Fig. 3

Monashee Geological Consultants

is associated with narrow quartz veins and shear zones in the argillites.

Gold mineralization on the Patsy claims was first explored in 1927. The property, acquired by Hedley-Sterling Gold Mines Ltd., was developed by a series of adits, shafts, open cuts and trenches in two different sectors, namely, the Patsy (L3404s) and the Patsy 2 (L3407s) claims. On the Patsy claim two adits were driven on narrow quartz/arsenopyrite veins located in argillites. "A sample taken from 6 inches of vein material in the upper tunnel assayed: Gold, 2 oz. to the ton; silver 0.40 oz to the ton" (B.C.M.M. 1928).

On the Patsy 2 claim a series of workings have exposed mineralization over a vertical distance of 200'. The main working, called Adit 0, is situated approximately 20 feet above Sterling Creek and consists of a 650 foot cross-cut with a number of north and south drifts. These drifts were driven on a series of "bedded shear zones" which vary in width from 4 to 10 feet and contains bands and segregations of quartz, pyrite, arsenopyrite and schisted country rock. A sample across 14 inches of vein material containing pyrite and arsenopyrite in the south drift, 15 feet in, assayed: Gold 0.12 oz./ton; silver 0.20 oz/ton (B.C.M.M. 1933). Assays up to 1.82 oz./ton gold have been reported from the Patsy 2 workings.

More recent work includes geochemical and geological surveys conducted by W.G. Smitheringale and Associated Ltd. in 1983.

GEOCHEMICAL AND GEOLOGICAL SURVEYS

A geochemical orientation survey in the vicinity of the Patsy and Patsy 2 mineralized zones was undertaken in May, 1983 by Smitheringale and Associates. This survey collected 75 soil samples which were analyzed for gold and arsenic. Results of the survey indicated that analysis for arsenic alone would be sufficient for additional geochemical surveys.

Subsequent soil sampling by Smitheringale in June of 1983 identified a number of areas with anomalous arsenic values on the Patsy property.

The purpose of this years program was to obtain detailed information from two of those areas (fig. 3) outlined during the 1983 survey. These areas are identified as the Central Zone (fig. 4 and 5) and the Southern Zone (fig. 6 and 7).

33-49 High background
 50-66 Anomalous
 ≥67 Highly Anomalous

Proposed Trenching

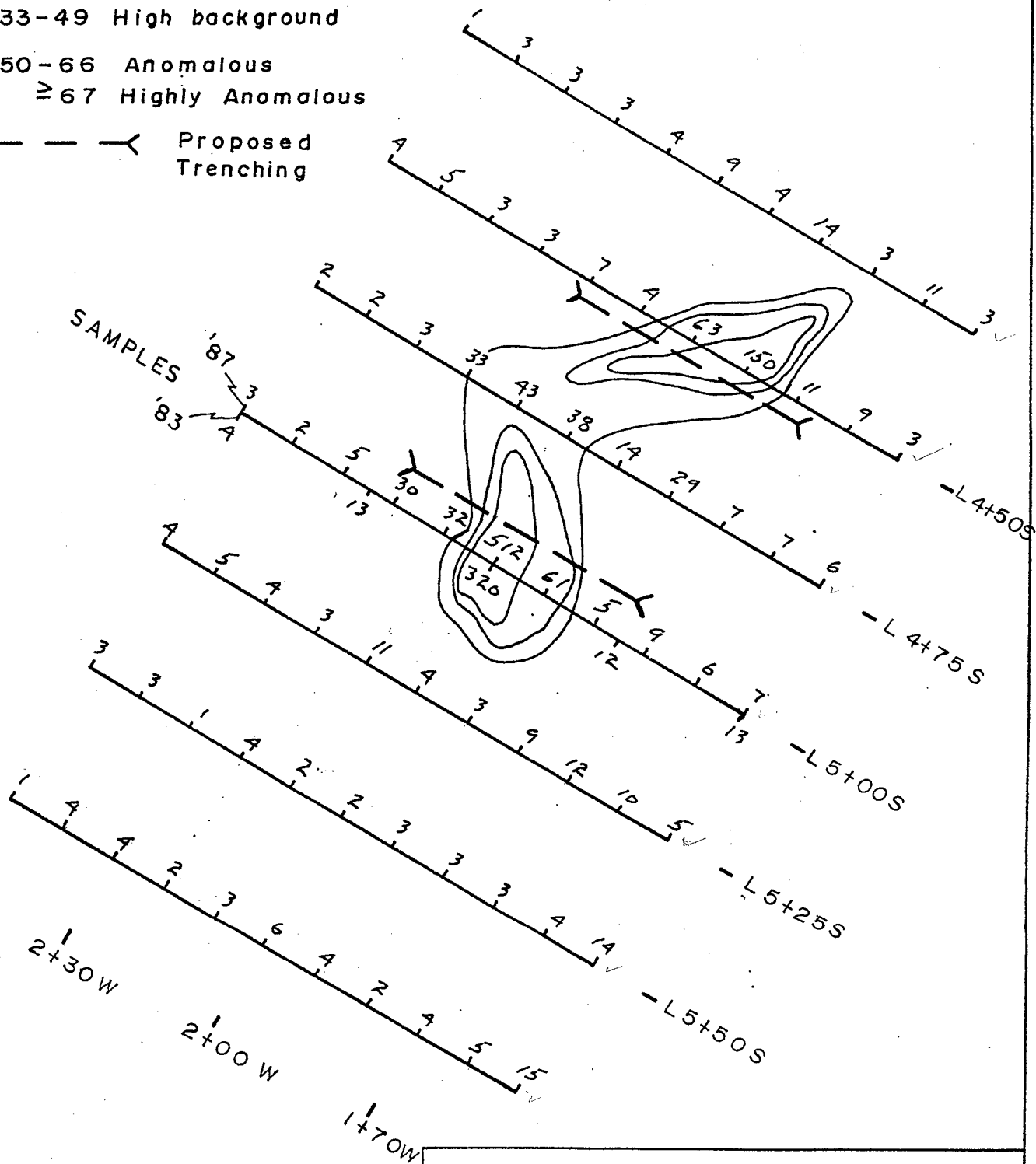

HEDLEY-STERLING
 EXPLORATIONS INC.

PATSY CLAIMS
 GEOCHEMICAL SURVEY
 (central zone)

MONASHEE
 GEOLOGICAL
 CONSULTANTS

NTS: 92H/8E
 SEPT.15/87

Fig. no. 4

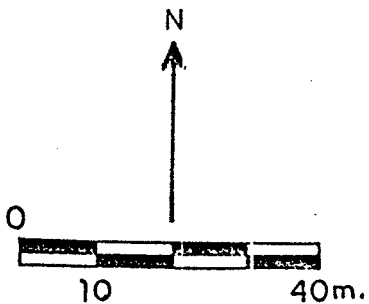
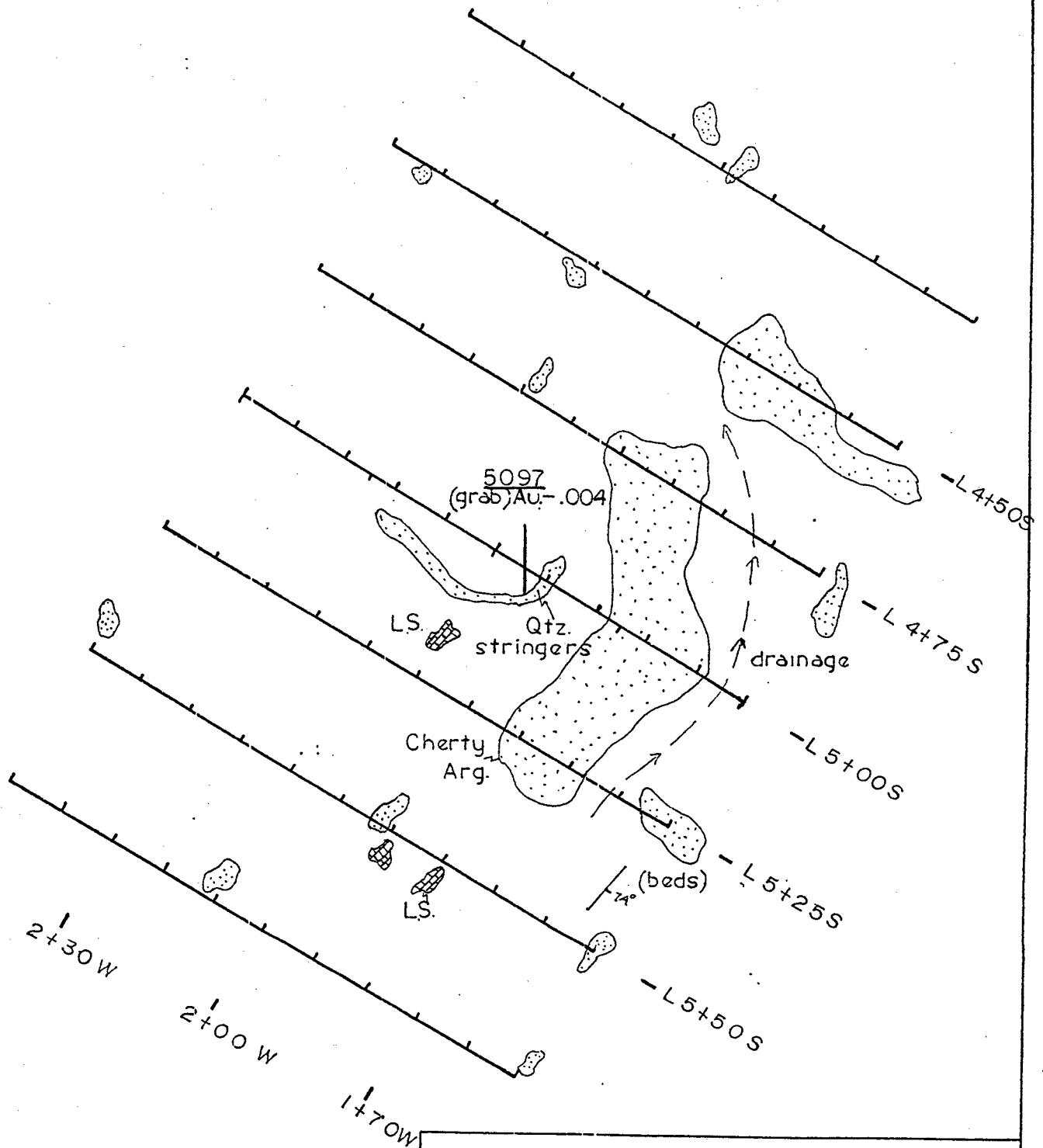

HEDLEY-STERLING
EXPLORATIONS INC.

PATSY CLAIMS

GEOLOGY
(Central Zone)

MONASHEE
GEOLOGICAL
CONSULTANTS

NTS: 92H/8E
SEPT.15/87

Fig. no. 5

Monashee Geological Consultants

The detailed programs were conducted on 25 meter line spacings and 10 meter station intervals. A total of 168 soil samples were collected over 1.54 line kilometers.

Samples were collected from the 'B' soil horizon and placed in pre-numbered Kraft paper envelopes. The samples were shipped to Chemex Labs Ltd. in North Vancouver, B.C. for analysis.

The geochemical results were treated by statistical analysis to obtain anomalous values. Geochemical results were assigned to three levels:

33-49 p.p.m. - High Background

50-66 p.p.m. - Anomalous

≥ 67 p.p.m. - Highly Anomalous

Geological mapping was also carried out over the two anomalous zones and five chip samples were collected for gold assay (appendix). The results are outlined below:

1. Central Zone

Detailed, follow-up soil sampling (fig. 4) in this area confirmed the presence of anomalous arsenic in the soils as originally outlined by the 1983 survey. Values of up to 512 p.p.m. arsenic were found. The 1983 anomaly was extended northward for 50 meters with a width of approximately 20 meters.

Geologically (fig. 5), the Central zone is known to be underlain by pyritic, black cherty argillites and thin beds of limestone. Beds strike northeasterly with steep (74°) dips to the east.

One outcrop on L5+00S 0+90W was observed to have undergone tensional fracturing with subsequent small scale (2-5 m.m.) quartz intrusion. A chip sample (5097) taken at this site assayed low gold content (0.004 oz/ton).

2. Southern Zone

Coincident geochemically anomalous arsenic values were outlined in this area during the 1983 and 1987 (fig. 6) surveys. The soil anomaly appears to be limited in extent with anomalous stations occurring mainly along L8+00S. A series of high background arsenic values forms a halo around the two main soil anomalies.

Here again, the Southern Zone is observed to be underlain by black cherty argillites and minor limestones of the Nicola Group (fig. 7).

**GEOLOGICAL BRANCH
ASSESSMENT REPORT**

16,554

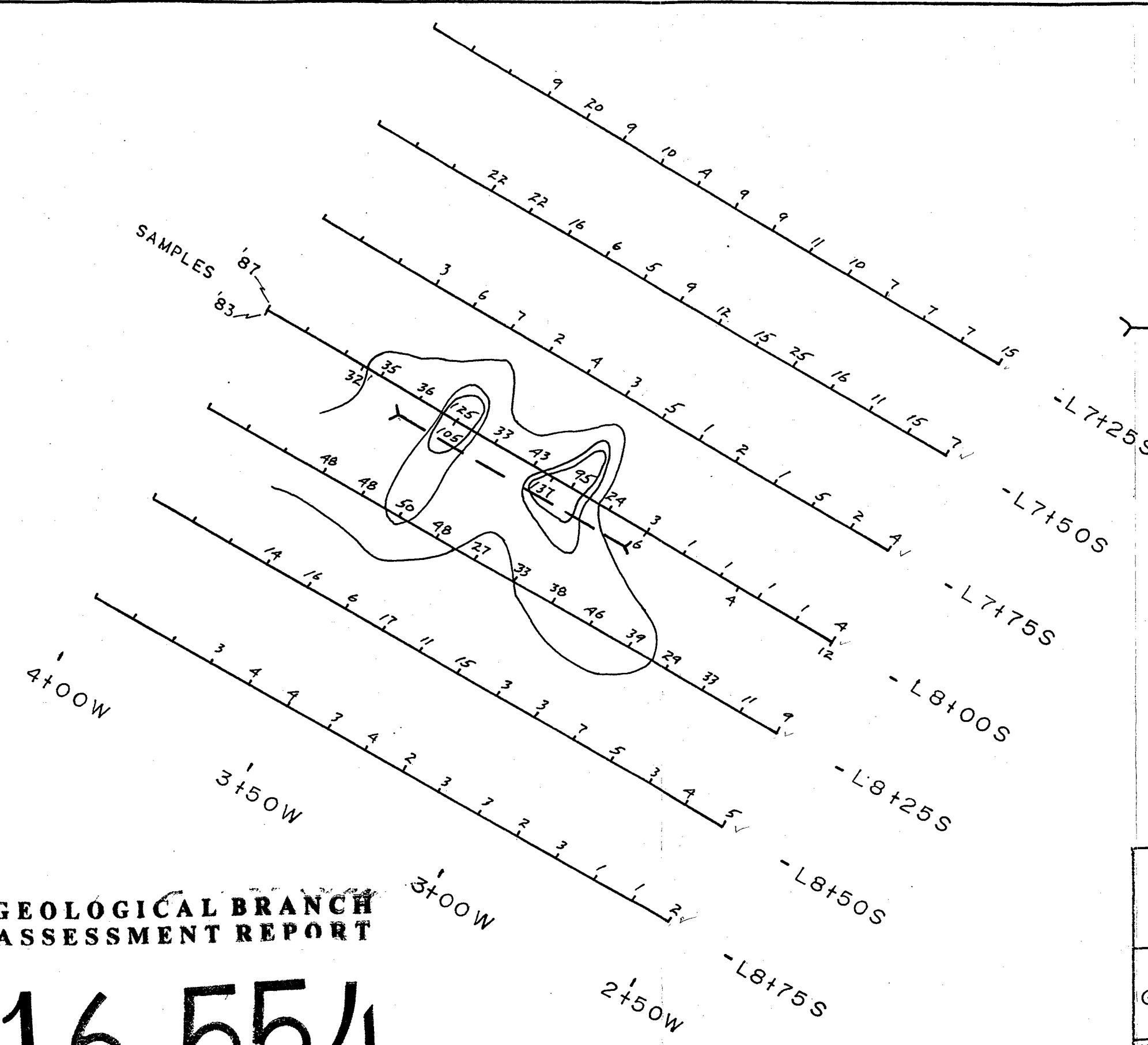

LEGEND
 33-49 High Background
 50-66 Anomalous
 ≥67 Highly Anomalous
 - - - Proposed Trenching

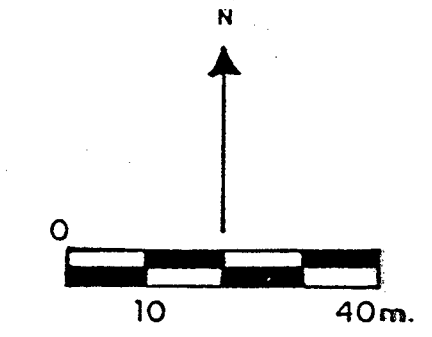

HEDLEY-STERLING EXPLORATIONS INC.		
PATSY CLAIMS GEOCHEMICAL SURVEY (Southern Zone)		
MONASHEE GEOLOGICAL CONSULTANTS	NTS:92H/8E SEPT.15/87	Fig. 6

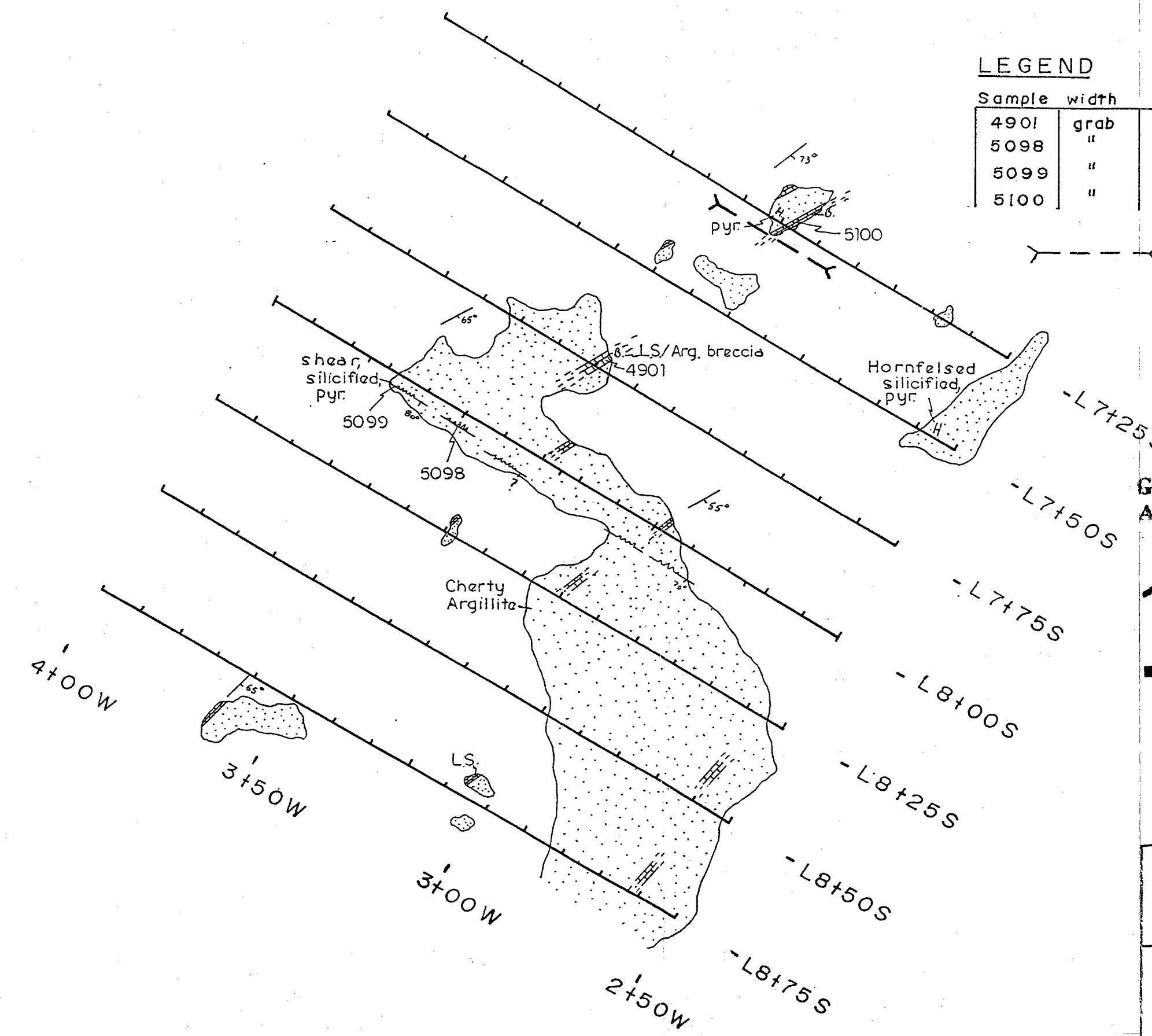

LEGEND

Sample	width	remarks	Au. oz./t.
4901	grab	l.s./Arg. breccia	0.002
5098	"	silicified sheared Arg.	0.002
5099	"	" " "	0.002
5100	"	pyr. Cherty Arg. - some brecc.	0.024

--- Proposed Trenching

**GEOLOGICAL BRANCH
ASSESSMENT REPORT**

16,554

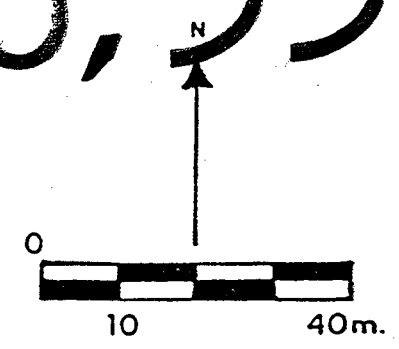

HEDLEY-STERLING
EXPLORATIONS INC.

PATSY CLAIMS
GEOLOGY
(Southern Zone)

MONASHEE GEOLOGICAL CONSULTANTS	NTS:92H/8E SEPT.15/87	Fig. 7
---------------------------------------	--------------------------	--------

Monashee Geological Consultants

Bedding is northeasterly with moderate to steep dips to the south-east.

This area was observed to have undergone a considerable degree of tectonic activity as evidenced by the degree of shearing and brecciation within the argillites and limestones. The argillites were also noted to be locally hornfelsed, silicified and pyritic. No dioritic intrusions are outcropping in the immediate area but the degree and nature of the alteration is consistent with this intrusive activity as recognized elsewhere on the property.

One shear zone is observed to be cross-cutting the bedding and strikes 130° with steep ($70-80^{\circ}$) dips to the southwest. Another breccia zone appears to be conformable to the bedding and is located along an argillite/limestone bedding plane.

Three chip samples (4901, 5098-99) collected from the shear/breccia zone assayed low gold (.002 oz/ton) content. Another sample (5100) assayed an encouraging gold content of 0.024 oz/ton.

Though the geochemical anomaly is of a localized nature, the geology, alteration, structural setting and one assay value indicates the need for additional work in this area.

CONCLUSION AND RECOMMENDATIONS

The Patsy property has a number of gold occurrences which are known to be associated with semi-massive to massive arsenopyrite mineralization. The mineralization is hosted by the Nicola Group sedimentary rocks which have been intruded by dioritic plutonic rocks. This is a similar geological setting that hosts the Mascot gold mine at Hedley, 7 km. to the east.

Limited, follow-up geochemical surveys conducted on two portions of the property have indicated two highly arsenical anomalies which could be associated with presently hidden mineralized features.

Based on these favourable factors it is recommended that the Central and Southern geochemical anomalies undergo a trenching program. As well, additional geochemical and geological surveys should be conducted over other areas of the property.

Monashee Geological Consultants

COST STATEMENT

1. R. Kregosky, Geologist: 5 days @ \$200.00/day.....	\$1,000.00
2. Soil Samples: 168 samples @ 3.95 ea.....	\$ 663.60
3. Assay: 5 samples @ 11.25 ea.....	\$ 56.25
4. Food and Accommodation: 5 days @ \$60.00/day.....	\$ 300.00
5. Transportation/travel @ 15%.....	\$ 303.00
6. Report preparation: 1 day @ \$200.00/day.....	<u>\$ 200.00</u>
TOTAL	\$2,522.85

Monashee Geological Consultants

REFERENCES

Rice, H.M.A. 1960

Geological Survey of Canada

Memoir 243

B.C.M.M.

Annual Reports, 1927, 1937

Smitheringale, W.G. and Associates

1980 - Geological Report on the Patsy Group Mineral

Claims near Hedley, B.C.

1983 - Geological and Geochemical Survey Maps

Monashee Geological Consultants

APPENDIX

Assay Certificates

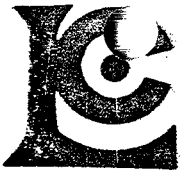

Chemex Labs Ltd.

Analytical Chemists • Geochemists • Registered Assayers

212 BROOKSBANK AVE., NORTH VANCOUVER,
BRITISH COLUMBIA, CANADA V7J-1C1

PHONE (604) 984-0221

To: HELEN Y STERLING EXPLORATION INC.

210 - 26 BASTION SQUARE
VICTORIA, BC
V8W 1H9

Project: PATSY

Comments: ATTN: TOM KIRK OC: MONASHEE GEOLOGICAL CONS.

Page No. :
Tot. Pages: 6
Date : 25-AUG-87
Invoice #: I-8720094
P.O. #: NONE

CERTIFICATE OF ANALYSIS A8720094

SAMPLE DESCRIPTION	PREP CODE		As ppm																	
L3S 2+60W	201	---																		
L3S 2+70W	201	---																		
L3S 2+80W	201	---																		
L3S 2+90W	201	---																		
L3S 3+00W	201	---																		
L4+25S 1+50W	201	---																		
L4+25S 1+60W	201	---																		
L4+25S 1+70W	201	---																		
L4+25S 1+80W	201	---																		
L4+25S 1+90W	201	---																		
L4+25S 2+00W	201	---																		
L4+25S 2+10W	201	---																		
L4+25S 2+20W	201	---																		
L4+25S 2+30W	201	---																		
L4+25S 2+40W	201	---																		
L4+25S 2+50W	201	---																		
L4+50S 1+50W	201	---																		
L4+50S 1+60W	201	---																		
L4+50S 1+70W	201	---																		
L4+50S 1+80W	201	---																		
L4+50S 1+90W	201	---																		
L4+50S 2+00W	201	---																		
L4+50S 2+10W	201	---																		
L4+50S 2+20W	201	---																		
L4+50S 2+30W	201	---																		
L4+50S 2+40W	201	---																		
L4+50S 2+50W	201	---																		
L4+75S 1+50W	201	---																		
L4+75S 1+60W	201	---																		
L4+75S 1+70W	201	---																		
L4+75S 1+80W	201	---																		
L4+75S 1+90W	201	---																		
L4+75S 2+00W	201	---																		
L4+75S 2+10W	201	---																		
L4+75S 2+20W	201	---																		
L4+75S 2+30W	201	---																		
L4+75S 2+40W	201	---																		
L4+75S 2+50W	201	---																		
L5S 1+50W	201	---																		
L5S 1+60W	201	---																		

CERTIFICATION :

Tom Kirk



Chemex Labs Ltd.

Analytical Chemists • Geochemists • Registered Assayers

212 BROOKSBANK AVE., NORTH VANCOUVER,
BRITISH COLUMBIA, CANADA V7J-1C1

PHONE (604) 984-0221

To: HEDLEY STERLING EXPLORATION INC.

2126 BASTION SQUARE
VICTORIA, BC
V8W 1H9

Project: PATSY

Comments: ATTN: TOM KIRK CC: MONASHEE GEOLOGICAL CONS.

*Page No. : 5

Tot. Pages: 1

Date : AUG-87

Invoice # : 1-8720094

P.O. # : NONE

CERTIFICATE OF ANALYSIS A8720094

SAMPLE DESCRIPTION	PREP CODE	As ppm																		
L5S 1+70W	201	---	9																	
L5S 1+80W	201	---	5																	
L5S 1+90W	201	---	61																	
L5S 2+00W	201	---	512																	
L5S 2+10W	201	---	32																	
L5S 2+20W	201	---	30																	
L5S 2+30W	201	---	5																	
L5S 2+40W	201	---	2																	
L5S 2+50W	201	---	3																	
L5+25S 1+50W	201	---	5																	
L5+25S 1+60W	201	---	10																	
L5+25S 1+70W	201	---	12																	
L5+25S 1+80W	201	---	9																	
L5+25S 1+90W	201	---	3																	
L5+25S 2+00W	201	---	4																	
L5+25S 2+10W	201	---	11																	
L5+25S 2+20W	201	---	3																	
L5+25S 2+30W	201	---	4																	
L5+25S 2+40W	201	---	5																	
L5+25S 2+50W	201	---	4																	
L5+50S 1+50W	201	---	14																	
L5+50S 1+60W	201	---	4																	
L5+50S 1+70W	201	---	3																	
L5+50S 1+80W	201	---	3																	
L5+50S 1+90W	201	---	3																	
L5+50S 2+00W	201	---	2																	
L5+50S 2+10W	201	---	2																	
L5+50S 2+20W	201	---	4																	
L5+50S 2+30W	201	---	1																	
L5+50S 2+40W	201	---	3																	
L5+50S 2+50W	201	---	3																	
L5+75S 1+50W	201	---	15																	
L5+75S 1+60W	201	---	5																	
L5+75S 1+70W	201	---	4																	
L5+75S 1+80W	201	---	2																	
L5+75S 1+90W	201	---	4																	
L5+75S 2+00W	201	---	6																	
L5+75S 2+10W	201	---	3																	
L5+75S 2+20W	201	---	2																	
L5+75S 2+30W	201	---	4																	

CERTIFICATION :

Scott Buchler



Chemex Labs Ltd.

Analytical Chemists • Geochemists • Registered Assayers

212 BROOKSBANK AVE., NORTH VANCOUVER,
BRITISH COLUMBIA, CANADA V7J-2C1

PHONE (604) 984-0221

MEDLEY STERLING EXPLORATION INC.

210 - 26 BASTION SQUARE
VICTORIA, BC
V8W 1H9

Project : PATSY

Comments: ATTN: TOM KIRK CC: MONASHEE GEOLOGICAL CONS.

Page: 0
Tot. Ass: 6
Date: 25-AUG-87
Invoice #: I-8720094
P.O. #: NONE

CERTIFICATE OF ANALYSIS A8720094

SAMPLE DESCRIPTION	PREP CODE	As ppm							
L5+75S 2+40W	201 ---	4							
L5+75S 2+50W	201 ---	1							
L7+25S 2+50W	201 ---	15							
L7+25S 2+60W	201 ---	7							
L7+25S 2+70W	201 ---	7							
L7+25S 2+80W	201 ---	7							
L7+25S 2+90W	201 ---	10							
L7+25S 3+00W	201 ---	11							
L7+25S 3+10W	201 ---	9							
L7+25S 3+20W	201 ---	9							
L7+25S 3+30W	201 ---	4							
L7+25S 3+40W	201 ---	10							
L7+25S 3+50W	201 ---	9							
L7+25S 3+60W	201 ---	20							
L7+25S 3+70W	201 ---	9							
L7+50S 2+50W	201 ---	7							
L7+50S 2+60W	201 ---	15							
L7+50S 2+70W	201 ---	11							
L7+50S 2+80W	201 ---	16							
L7+50S 2+90W	201 ---	25							
L7+50S 3+00W	201 ---	15							
L7+50S 3+10W	201 ---	12							
L7+50S 3+20W	201 ---	9							
L7+50S 3+30W	201 ---	5							
L7+50S 3+40W	201 ---	6							
L7+50S 3+50W	201 ---	16							
L7+50S 3+60W	201 ---	22							
L7+50S 3+70W	201 ---	22							

CERTIFICATION

John H. Becker

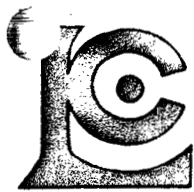

Chemex Labs Ltd.

Analytical Chemists * Geochemists * Registered Assayers

212 BROOKSBANK AVE., NORTH VANCOUVER,
BRITISH COLUMBIA, CANADA V7J-2C1

PHONE (604) 984-0221

To: HEDLEY STERLING EXPLORATION, INC.

210 - 26 BASTION SQUARE
VICTORIA, BC
V8W 1H9

Project: PATSY

Comments: ATTN: TOM KIRK CC: MONASHEE GEOLOGICAL CONS.

Page No. : 1
Tot. Pages: 2
Date : 25-AUG-87
Invoice # : I-8720095
P.O. # : NONE

CERTIFICATE OF ANALYSIS A8720095

SAMPLE DESCRIPTION	PREP CODE	As ppm						
L7+75S 2+50W	201 ---	4						
L7+75S 2+60W	201 ---	2						
L7+75S 2+70W	201 ---	5						
L7+75S 2+80W	201 ---	1						
L7+75S 2+90W	201 ---	2						
L7+75S 3+00W	201 ---	1						
L7+75S 3+10W	201 ---	5						
L7+75S 3+20W	201 ---	3						
L7+75S 3+30W	201 ---	4						
L7+75S 3+40W	201 ---	2						
L7+75S 3+50W	201 ---	7						
L7+75S 3+60W	201 ---	6						
L7+75S 3+70W	201 ---	3						
L8S 2+50W	201 ---	4						
L8S 2+60W	201 ---	1						
L8S 2+70W	201 ---	1						
L8S 2+80W	201 ---	1						
L8S 2+90W	201 ---	1						
L8S 3+00W	201 ---	3						
L8S 3+10W	201 ---	24						
L8S 3+20W	201 ---	95						
L8S 3+30W	201 ---	43						
L8S 3+40W	201 ---	33						
L8S 3+50W	201 ---	125						
L8S 3+60W	201 ---	36						
L8S 3+70W	201 ---	35						
L8+25S 2+50W	201 ---	9						
L8+25S 2+60W	201 ---	11						
L8+25S 2+70W	201 ---	33						
L8+25S 2+80W	201 ---	29						
L8+25S 2+90W	201 ---	39						
L8+25S 3+00W	201 ---	46						
L8+25S 3+10W	201 ---	38						
L8+25S 3+20W	201 ---	33						
L8+25S 3+30W	201 ---	27						
L8+25S 3+40W	201 ---	48						
L8+25S 3+50W	201 ---	50						
L8+25S 3+60W	201 ---	48						
L8+25S 3+70W	201 ---	48						
L8+50S 2+50W	201 ---	5						

CERTIFICATION : Hart Bickler

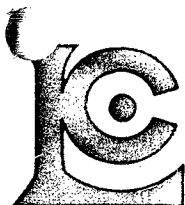

Chemex Labs Ltd.

Analytical Chemists * Geochemists * Registered Assayers

212 BROOKSBANK AVE., NORTH VANCOUVER,
BRITISH COLUMBIA, CANADA V7J-2C1

PHONE (604) 984-0221

o: HEDLEY STERLING EXPLORATION INC.

210 - 26 BASTION SQUARE
VICTORIA, BC
V8W 1H9

Project : PATSY

Comments: ATTN: TOM KIRK CC: MONASHEE GEOLOGICAL CONS.

*Page No. : 2
Tot. Pages: 2
Date : 25-AUG-87
Invoice # : I-8720095
P.O. # : NONE

CERTIFICATE OF ANALYSIS A8720095

SAMPLE DESCRIPTION	PREP CODE	As ppm																		
L8+50S 2+60W	201	---	4																	
L8+50S 2+70W	201	---	3																	
L8+50S 2+80W	201	---	5																	
L8+50S 2+90W	201	---	7																	
L8+50S 3+00W	201	---	3																	
L8+50S 3+10W	201	---	3																	
L8+50S 3+20W	201	---	15																	
L8+50S 3+30W	201	---	11																	
L8+50S 3+40W	201	---	17																	
L8+50S 3+50W	201	---	6																	
L8+50S 3+60W	201	---	16																	
L8+50S 3+70W	201	---	14																	
L8+75S 2+50W	201	---	2																	
L8+75S 2+60W	201	---	1																	
L8+75S 2+70W	201	---	1																	
L8+75S 2+80W	201	---	3																	
L8+75S 2+90W	201	---	2																	
L8+75S 3+00W	201	---	3																	
L8+75S 3+10W	201	---	3																	
L8+75S 3+20W	201	---	2																	
L8+75S 3+30W	201	---	4																	
L8+75S 3+40W	201	---	3																	
L8+75S 3+50W	201	---	4																	
L8+75S 3+60W	201	---	4																	
L8+75S 3+70W	201	---	3																	

CERTIFICATION :

Jan Bichler



Chemex Labs Ltd.

Analytical Chemists * Geochemists * Registered Assayers

212 BROOKSBANK AVE., NORTH VANCOUVER,
BRITISH COLUMBIA, CANADA V7J-2C1

PHONE (604) 984-0221

EDLEY STERLING EXPLORATION INC.

210 - 26 BASTION SQUARE
VICTORIA, BC
V8W 1H9

Project : PATSY

Comments: ATTN: TOM KIRK CC: MONASHEE GEOLOGICAL CONS. ✓

Page No : 1
Tot. Pages: 1
Date : 18-AUG-87
Invoice # : I-8720092
P.O. # : NONE

CERTIFICATE OF ANALYSIS A8720092

SAMPLE DESCRIPTION	PREP CODE	Au FA oz/T									
4901	207	--	< 0.002								
5097	207	---	0.004								
5098	207	---	0.002								
5099	207	---	0.002								
5100	207	---	0.024								

ALL ASSAY DETERMINATIONS ARE PERFORMED OR SUPERVISED BY B.C. CERTIFIED ASSAYERS

CERTIFICATION :

W. H. Amadio

Monashee Geological Consultants

CERTIFICATE

I Roy D. Kregosky of Vernon, British Columbia, do hereby certify that:

1. I am a Consulting Geologist with a business address at 3501 - 16th Street, Vernon, B.C., V1T 3X7.
2. I am a graduate of the University of Calgary where I obtained a B.Sc. degree in Geology in 1970.
3. I am a Fellow of the Geological Association of Canada.
4. I have practiced my profession for the past 17 years.
5. This report dated September 15, 1987 is based on personal field examinations of the Patsy Property as well as information gathered from available maps and published reports.
6. I have no interest, direct or indirect, in the securities or properties of Hedley-Sterling Explorations Inc.
7. Permission is hereby granted to submit this report in support of a prospectus or statement of Material Facts.

Dated at Vernon, British Columbia, this 15th day of September, 1987.

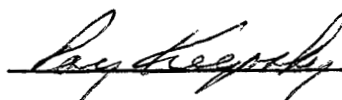

Roy D. Kregosky

B.Sc., F.G.A.C.