

DIAMOND DRILLING REPORT

ON

THE LAKEVIEW CLAIM GROUP

NANAIMO MINING DIVISION

FILMED

LAT. 49° 46'30"N

LONG. 125° 18'W

**GEOLOGICAL BRANCH  
ASSESSMENT REPORT**

N.T.S. 92F/11W & 92F/14W

FOR

**16,762**

BETTER RESOURCES LIMITED

BY

JAMES F. BRISTOW, P. ENG.

RICHMOND, B.C.

FEBRUARY, 1988

DIAMOND DRILLING REPORT  
ON  
LAKEVIEW CLAIM GROUP

T A B L E   O F   C O N T E N T S

|   | Page |
|---|------|
| INDEX MAP                               | 1    |
| SUMMARY AND CONCLUSION                  | 2    |
| INTRODUCTION                            | 2    |
| LOCATION, ACCESS AND FACILTIES          | 3    |
| PHYSIOGRAPHY AND CLIMATE                | 3    |
| LOCATION MAP                            | 4    |
| HISTORY                                 | 5    |
| PROPERTY DESCRIPTION                    | 7    |
| MINERAL CLAIM MAP                       | 8    |
| DISCUSSION                              | 9    |
| DRILL HOLE SUMMARY (See Appendix II)    |      |
| DIAMOND DRILL CORE LOG LEGEND           | 11   |
| COST STATEMENT                          | 14   |
| AUTHOR'S QUALIFICATIONS & CERTIFICATION | 16   |

APPENDIX I

- 1) Invoices

APPENDIX II (in pocket)

- 1) Drill Hole Summary - Table I
- 2) Diamond Drill Logs
- 3) Diamond Drill Hole Plans

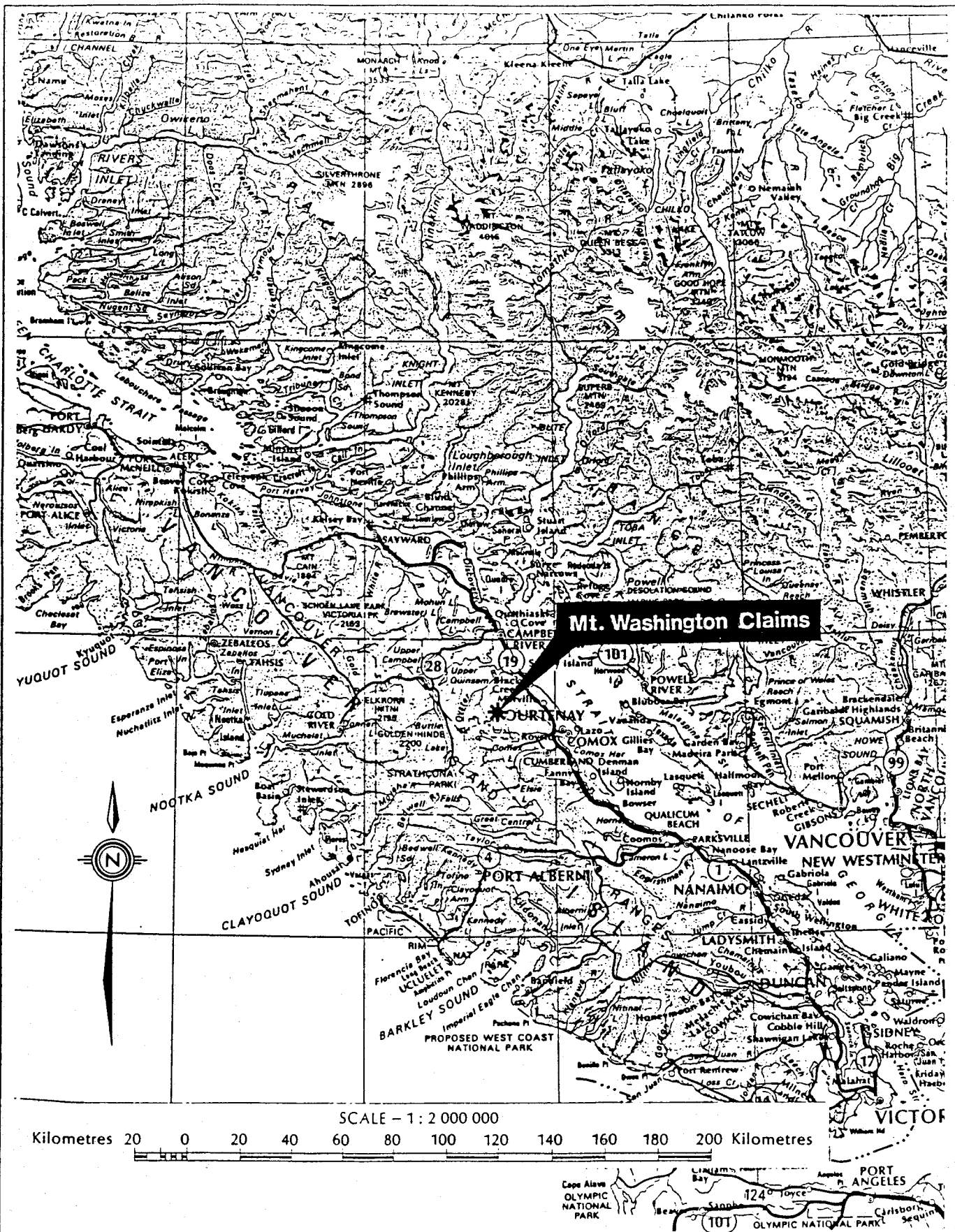

**Mt. Washington Claims**



SCALE - 1 : 2 000 000

Kilometres 20 0 20 40 60 80 100 120 140 160 180 200 Kilometres

Drawn By: D.P.B.  
 Checked By: J.F.B.  
 Date: February 1988

**BETTER RESOURCES**  
 LIMITED  
**INDEX MAP**

Scale: 1:2,000,000  
 Figure: 1

## SUMMARY AND CONCLUSION

Eighty four NQ wireline diamond drill holes totalling 5420 metres were drilled on the Lakeview Claim Group. The purpose of this drilling was to further delineate the extensive gently westerly dipping, auriferous alteration zone lying beneath the north spur of Mt. Washington. The programme expanded the 1986 ore inventory and confirmed that a mineralized alteration zone continues to the north as indicated by the previously established gold/arsenic soil geochemical anomalies.

Cost of the drilling programme was in excess of \$548,709.00

## INTRODUCTION

This report contains the results obtained from 5420 metres of NQ wireline diamond drilling conducted on the Lakeview Claim Group between June 6, 1987 and November 1, 1987 by Globe Drilling Ltd. and Quest Canada Drilling Ltd. of Vancouver, British Columbia. The drill core was split wherever mineralized and assayed for gold, silver and arsenic. Core logging and sampling was carried out by contract geologists and crew. Assaying was done by Kamloops Research and Assay Laboratory Ltd. in Kamloops, British Columbia.



This claim group is centred on Latitude 49° 46' 30" North, Longitude 125° 19' West within map sheet N.T.S. 92/F11W,92F/14W and the Nanaimo Mining Division. The claims are located approximately 22.5 kilometres northwest of Courtenay, British Columbia (see Figure 2). They straddle the north spur of Mt. Washington and a portion of the area to the North and West.

Access to the claims is by a network of well maintained paved and gravel mining and logging roads. Depending on snowfall and runoff conditions, access to within 1.0 kilometres of any point on the property is usually possible by four wheel drive vehicle between July and November. In most areas of the property year-round supply of drilling water is located within a radius of 400 metres. An electric power line has been extended to the top of Mt. Washington well within the claim boundaries. Well-appointed accommodations are available at the Mt. Washington Ski Resort during the summer months. Year-round accommodations are available in Courtenay. Construction supplies, services and labour are readily available in the Campbell River-Courtenay area.

#### PHYSIOGRAPHY AND CLIMATE

Mt. Washington is located along the eastern margin of the northwest trending Vancouver Island Ranges in the Insular Belt. The landscape is characterized by moderate to precipitous topography covered generally, by a thick mixed coniferous forest of hemlock, red and yellow cedar, douglas fir and balsam fir. Locally this forest has been extensively logged, however, in the area adjacent to Pyrrhotite lake and overlying the Oyster Breccia structure there remains a parklike stand of mature timber. A subalpine forest of heather and krum-

holtz is developed above 1500 metres. Property elevations range from 1590 metres to 670 metres. Evidence of recent glaciation is noted by cirque development, glacial striae and thin to moderate but pervasive glacial till development.

October to May is characterized by cold and wet weather with considerable snow accumulations. Depth may exceed 5 metres at higher levels where patches of snow may persist in sheltered areas well into the summer months. June through September are drier with temperatures ranging from near freezing to greater than 25°C.

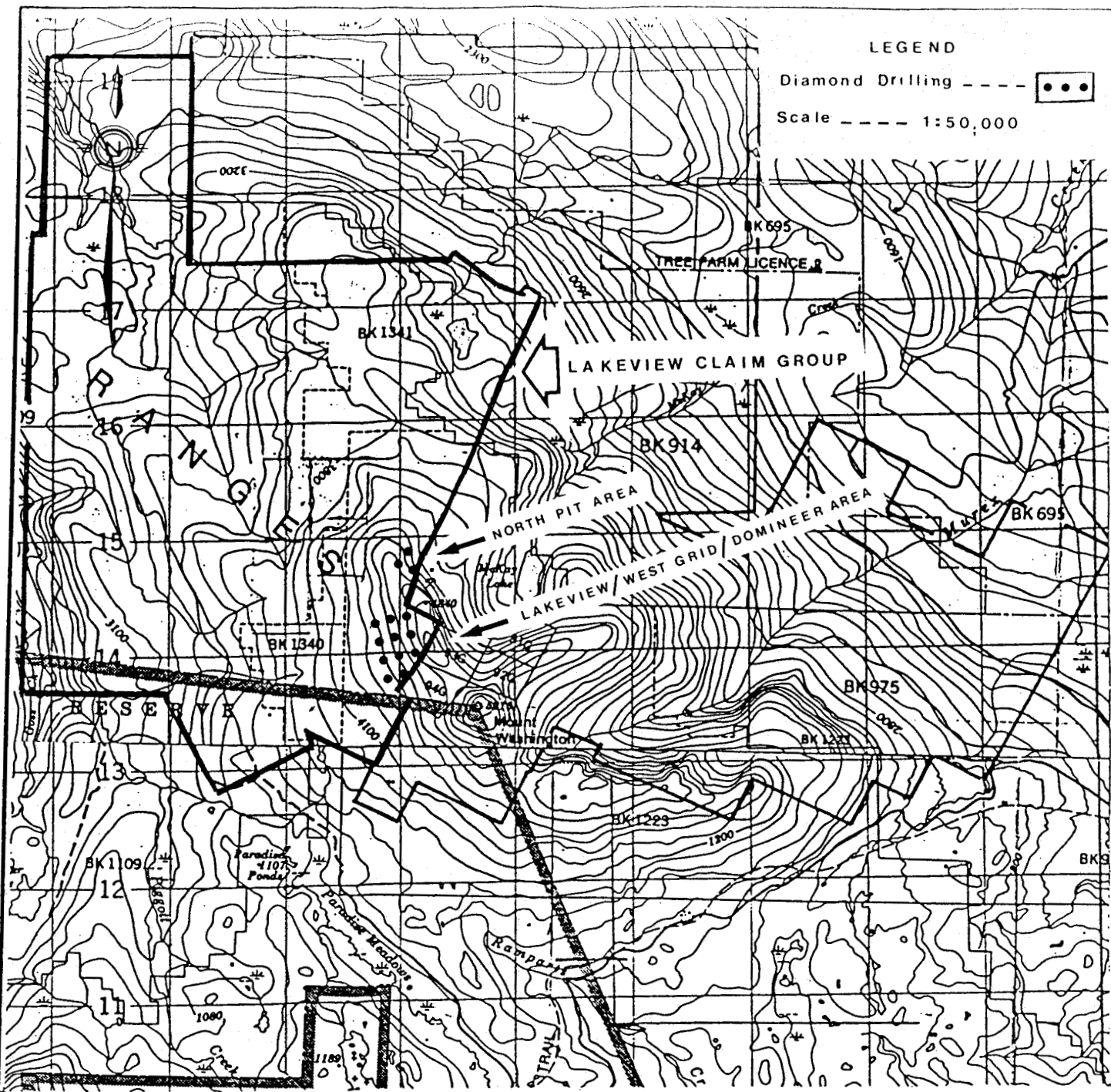

LEGEND

Diamond Drilling 

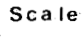
Scale  1:50,000

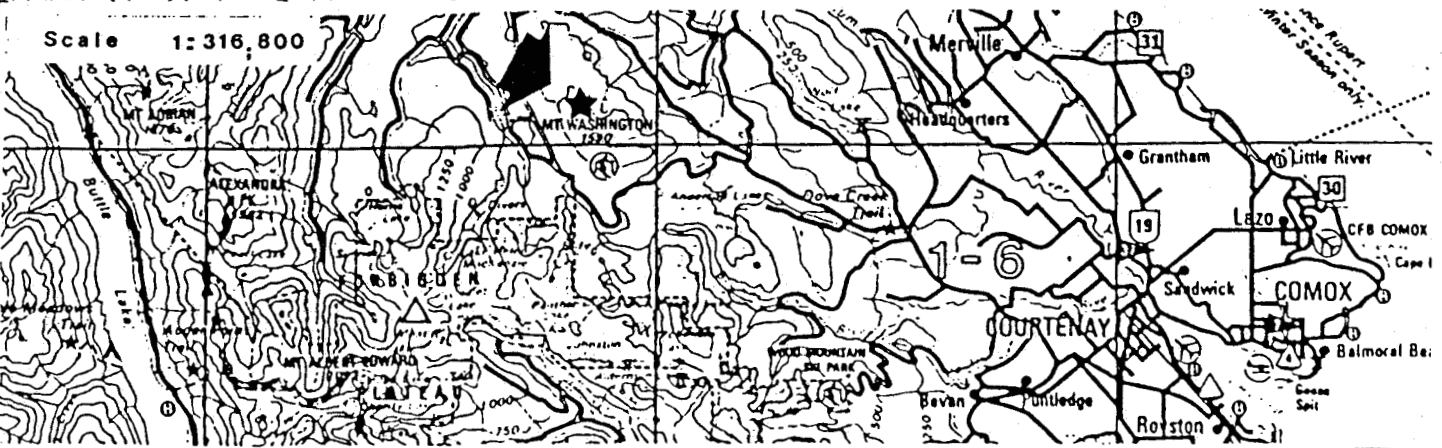

DRAWN BY J.F.B

BETTER RESOURCES LIMITED

DATE JANUARY 1988

LOCATION MAP MT. WASHINGTON AREA

FIGURE - 2

## HISTORY

Since 1940 the Mt. Washington area has been the focus of sporadic intensive exploration activity.

The following chronological summary of K.E. Northcote's report dated May 1983, covers the time span from discovery of gold mineralization in 1940 to 1982.

"Gold mineralization was discovered in place on Mt. Washington in May 1940 by J.M. McKay, a young mining engineer and prospector who systematically panned creeks up from the Oyster River to find coarse colours in a creek draining into McKay Lake. The gold bearing structures were prospected, trenched and sampled under the direction of Dr. D.F. Kidd in 1940-41. In 1944-45, Karl Springer financed adits on the copper bearing veins north of the area sampled for gold. Mt. Washington Copper Co. Ltd. was formed in 1956 by Gordon C. Murray and various joint agreements and options with Noranda and Cominco explored the property until 1964. From 1964 to 1966 Mt. Washington under revised agreement with Cominco and a joint venture with Cumberland Mining Co. mined and milled 392,173 tons of 1.16% Cu, 0.01 oz per ton Au and 0.5 oz per ton Ag. Upon exhaustion of economic open pit copper mineralization the mill was dismantled.

The property was optioned by Marietta Resources Ltd. in 1969, further explored by Mt. Washington in 1970-71 and then optioned to Imperial Oil from 1973 to 1982. During this latter period the exploration emphasis appears to have been directed towards a search for more extensive copper mineralization with little exploration for gold."

In May, 1983, Better Resources Limited acquired via Veerman Botel Limited, an option on a block of claims



previously controlled by Mt. Washington Copper Co. Ltd. By 1984, this land position was expanded to 130 units and a programme to assess the areas precious metal potential was initiated. By the spring of 1986 the land position was expanded to approximately 230 units.

Better Resources Limited drilled two short diamond drill holes on the Domineer zone and carried out a large soil sampling program for gold and arsenic in 1983. In 1984 the geochemical survey was extended and sixteen diamond core holes were drilled in the west grid area. The property was virtually inactive in 1985 when only one hole was drilled totalling 34 metres. In 1986 exploration efforts were concentrated in the Lakeview/West Grid area. Soil sampling coverage was expanded by 27 line kilometres and diamond drilling totalled 2418 metres.

The 1987 drilling programme was expanded to 114 drill holes totalling 8494 metres.

This report covers that portion of the diamond drilling conducted on the Lakeview Claim Group.

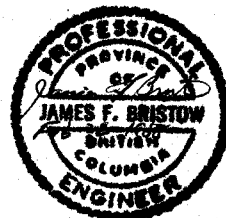

PROPERTY DESCRIPTION

Current Ministry of Energy, Mines and Petroleum Resources records show the Lakeview Claim Group owned by Better Resources Limited of Vancouver British Columbia to be composed of the following contiguous two post and metric mineral claims as shown in Figure 3.

| <u>NAME OF CLAIM</u> | <u>No. of<br/>Units</u> | <u>Record No.</u> | <u>Month<br/>of<br/>Record</u> |
|----------------------|-------------------------|-------------------|--------------------------------|
| B & T                | 9                       | 2447              | 7                              |
| Lager                | 16                      | 2441              | 7                              |
| Stout                | 16                      | 2443              | 7                              |
| Pil                  | 6                       | 2444              | 7                              |
| Ale                  | 16                      | 2442              | 7                              |
| Mouse 1              | 1                       | 1553              | 9                              |
| Mouse 2              | 1                       | 1554              | 9                              |
| Bill 1               | 1                       | 1556              | 9                              |
| Bill 2               | 1                       | 1567              | 9                              |
| Bill 3               | 1                       | 1568              | 9                              |
| Bill 4               | 1                       | 1569              | 9                              |
| Bill 5               | 1                       | 1570              | 9                              |
| DJV 1                | 1                       | 1261              | 10                             |
| DJV 2                | 1                       | 1262              | 10                             |
| DJV 3                | 1                       | 1263              | 10                             |
| DJV 4                | 1                       | 1264              | 10                             |
| DJV 5                | 1                       | 1265              | 10                             |
| MWC 201              | 1                       | 37257             | 9                              |
| MWC 202              | 1                       | 37258             | 9                              |
| MWC 203              | 1                       | 37259             | 9                              |
| MWC 204              | 1                       | 37260             | 9                              |
| MWC 206              | 1                       | 37262             | 9                              |
| MWC 211              | 1                       | 37267             | 9                              |
| MWC 212              | 1                       | 37268             | 9                              |
| MWC 222Fr            | 1                       | 37278             | 9                              |
| MWC 223              | 1                       | 37279             | 9                              |
| MWC 224              | 1                       | 37280             | 9                              |
| MWC 225              | 1                       | 37281             | 9                              |
| MWC 226              | 1                       | 37282             | 9                              |
| MWC 227              | 1                       | 37283             | 9                              |
| MWC 228              | 1                       | 37284             | 9                              |
| MWC 229              | 1                       | 37285             | 9                              |
| MWC 230              | 1                       | 37286             | 9                              |
|                      | <u>91</u>               |                   |                                |

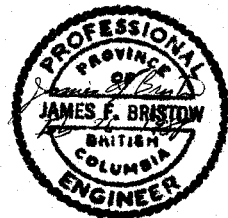

125° 15'

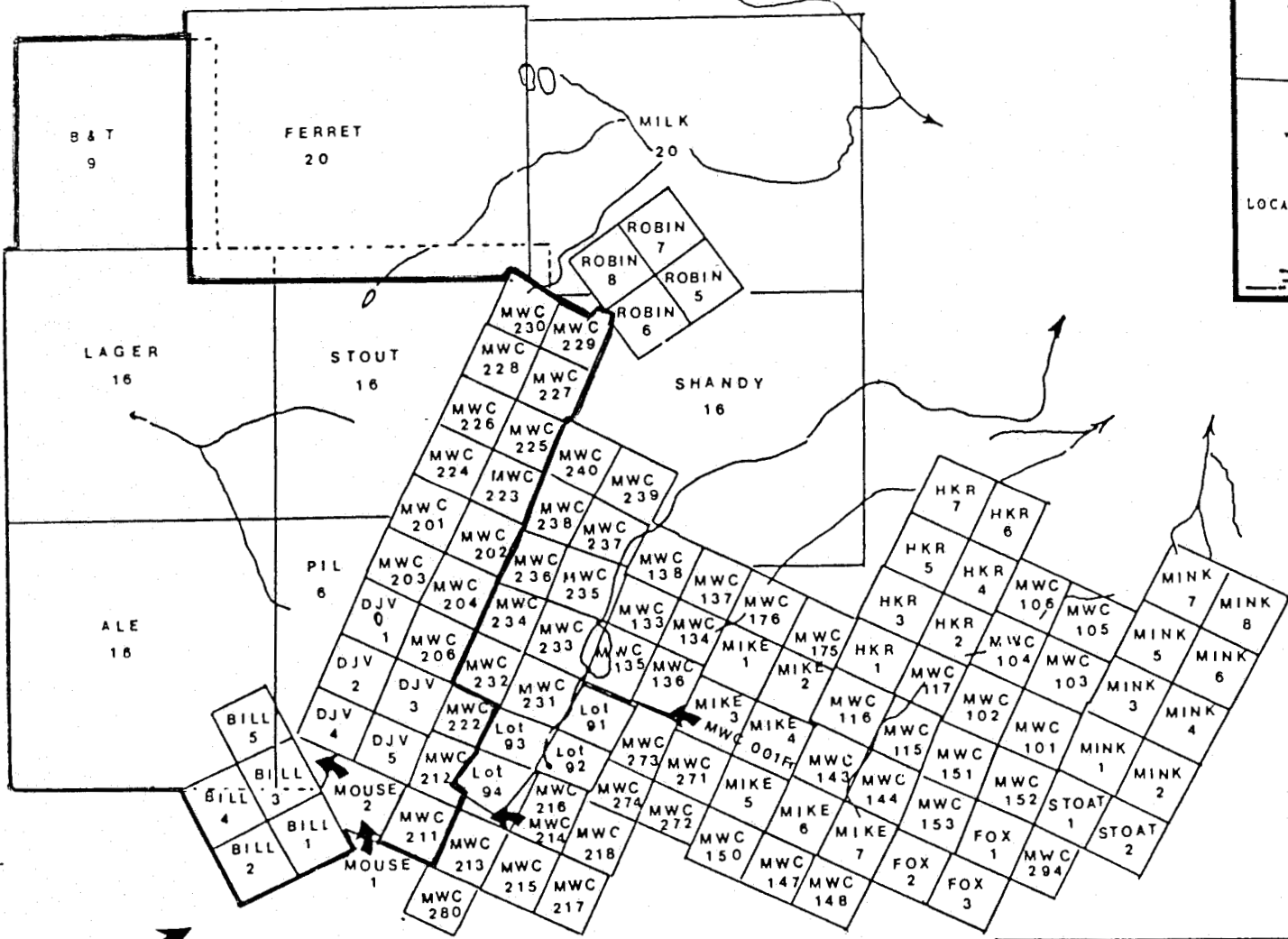
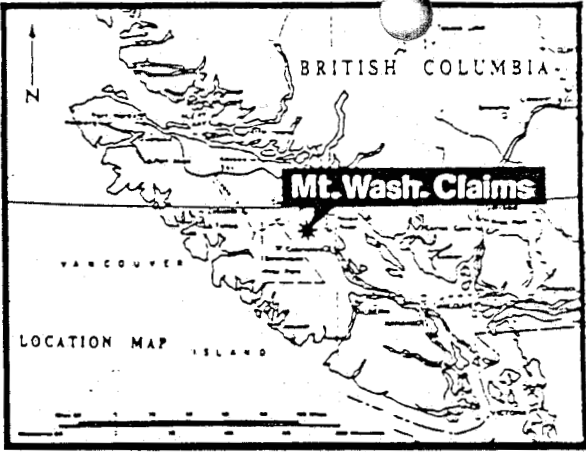

49° 45'



**LAKEVIEW  
CLAIM  
GROUP**

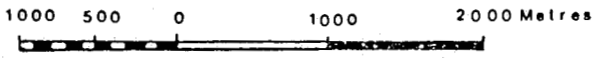

N.T.S. 92 F/11 & 14

**BETTER RESOURCES LIMITED**  
**CLAIM MAP**  
**MOUNT WASHINGTON AREA**  
**NANAIMO MINING DIVISION**

|                   |                |
|-------------------|----------------|
| DRAWN BY J.F.B    | SCALE 1:50,000 |
| DATE JANUARY 1988 | FIGURE 3       |

## DISCUSSION

The current diamond drilling programme was concentrated in the south-east corner of the Lakeview Claim group.

The purpose of the programme was two fold;

- 1) Seventy four NQ size wireline diamond drill holes were drilled in the Lakeview/West Grid/Domineer areas of the North spur of Mt. Washington to further delineate and expand the auriferous alteration zone indicated by previous work. (See Figure 4), and
- 2) Ten NQ size wireline diamond drill holes were drilled west of and adjacent to the north Mt. Washington open pit to test for the continuation of the gold bearing zone into this area. (See Figure 5).

A detail drill hole by drill hole evaluation of the results of this drilling programme is beyond the scope of this report. However, the results of the current drilling have not appreciably altered our general geological concept of the area which was previously stated as follows;

"The general geology of the Mt. Washington area depicts a thick sequence of Triassic Karmutsen Volcanics overlain by sediments of the Cretaceous Comox Formations. Both sequences are cut and intruded by feldspar porphyry and diorite dykes and sills of Tertiary age. All formations are in turn pierced by breccia systems of various composition, size, shape and possible of different ages. Breccia vary from those containing mainly monolithic intrusive clasts to those composed of predominantly rounded and milled heterolithic fragments.

The most extensive zones of mineralization identified to date are associated with gently west dipping continuous shear structures. These structures are semiconcordant with the bedding of the Comox formation, however, they cut all rock types including

most breccia pipes. They can be identified by their accompanying zone of kaolin alteration and silicification up to 30 metres in thickness.

Gold values are generally but not always associated with hanging wall zones of silicification. The best grade gold mineralization appears to be associated with open space quartz/massive sulphide veining (pyrite / arsenopyrite). Within the auriferous zone the principal sulphide minerals in order of abundance are pyrite, arsenopyrite, chalcopyrite covellite, realgar and orpiment."

The results from the drilling in the Lakeview/West Grid/Domineer areas have yielded sufficient detailed information to enable Better Resources staff to compile a drill indicated mineral inventory for this area totalling 1,527,300 tons grading 0.112 oz/T gold and 0.69 oz/T silver.

The eleven drill holes adjacent to the north Mt. Washington pit did not expand the ore zone previously exposed by the trenching of a gold/arsenic soil geochemical anomaly.

Most diamond drill holes were located by Ross Glover B.C.L.S.. Co-ordinates for all drill holes have been tabulated and are appended to this report. (Table I)

All mineralized core was split on site and samples were sent to Kamloops Research and Assay Laboratory for analysis for gold, silver and arsenic.

Drill core from the 1987 drilling is stored in permanent core sheds at Zebco Developments Lts., Piercy Road, Courtenay, British Columbia.

## DIAMOND DRILL CORE LOG LEGEND

Diamond Drill holes 87-42 to 87-45; 87-47 to 87-50 and 87-52 to 87-62 were logged on a 120 column coded format to allow recording as much detail as possible. The following key to this format.

| <u>Column No.</u> | <u>Code</u>       | <u>Description</u>           |
|-------------------|-------------------|------------------------------|
| 1 - 4             | <u>Depth</u>      | Depth as measured in feet    |
| 5 - 6             | <u>Formation</u>  |                              |
|                   | Bx                | Breccia                      |
|                   | I                 | Intrusive                    |
|                   | K                 | Karmutsen Formation          |
|                   | C                 | Comox Formation              |
| 7 - 8             | <u>Rock Types</u> |                              |
|                   | Mx                | Murex Breccia                |
|                   | My                | Murray Breccia               |
|                   | Wx                | Washington Breccia           |
|                   | Gx                | Glacier Breccia              |
|                   | Mp                | Porphyritic mafic volcanic   |
|                   | Di                | Diorite                      |
|                   | Df                | Diorite, fine grained        |
|                   | Ma                | Aphanitic mafic volcanic     |
|                   | Mv                | Mafic volcanic               |
|                   | Fs                | Feldspathic sandstone        |
|                   | Ar                | Argillite                    |
|                   | Hf                | Hornfels                     |
|                   | Di                | Diorite, leucocratic         |
|                   | Dp                | Diorite, porphyritic         |
|                   | St                | Siltstone                    |
| 1 - 10            | <u>Kaolinite</u>  | Content estimated in percent |
| 11                | <u>Habit</u>      |                              |
|                   | I                 | Irregular                    |
|                   | S                 | Stockwork                    |
|                   | V                 | Vein                         |
|                   | T                 | Veinlet                      |
|                   | P                 | Pervasive                    |
|                   | B                 | Banded                       |
|                   | D                 | Disseminated                 |
| 12 - 13           | <u>Chlorite</u>   | Content estimated in percent |



| <u>Column No.</u> | <u>Code</u>          | <u>Description</u>   |
|-------------------|----------------------|--|
| 14                | <u>Habit</u>         | (see Column #11)   |
| 15 - 16           | <u>Biotite</u>       | Content estimated in percent   |
| 17                | <u>Habit</u>         | (see Column #11)   |
| 18 - 19           | <u>Quartz</u>        | Content estimated in percent   |
| 20                | <u>Habit</u>         | (see Column #11)   |
| 21                | <u>Miscellaneous</u> |  |
|                   | Ak                   | Ankerite   |
|                   | C                    | Calcite  |
|                   | Ac                   | Actinolite   |
|                   | Sr                   | Sericite   |
| 22 - 23           |                      | Content estimated in percent   |
| 24                | <u>Habit</u>         | (see Column #11)   |
| 25 - 54           | <u>Comments</u>      | Written descriptions or general comments   |
| 55 - 56           | <u>Bedding</u>       | Maximum angle bedding makes to the core axis   |
| 57 - 58           | <u>Faulting</u>      | Maximum angle measurable faults have to the core axis (shaded portions indicated extent of faulting) |
|                   | G                    | Gouge zones  |
|                   | B                    | Broken core zones  |
| 59 - 60           | <u>&lt; to B</u>     | Angle between bedding and any vein, fault, banding or contact  |
| 61 - 62           | <u>Veining</u>       | Maximum angle at which a vein cuts the core axis   |
| 63 - 64           | <u>Pyrite</u>        | Content estimated in percent   |
| 65                | <u>Habit</u>         | (See Column #11)   |
| 66 - 67           | <u>Pyrrhotite</u>    | Content estimated in percent   |
| 68                | <u>Habit</u>         | (See Column #11)   |

| <u>Column No.</u> | <u>Code</u>          | <u>Description</u>                             |
|-------------------|----------------------|--|
| 69 - 70           | <u>Arsenopyrite</u>  | Content estimated in percent                   |
| 71                | <u>Habit</u>         | (See Column #11)                               |
| 72 - 73           | <u>Chalcopyrite</u>  | Content estimated in percent                   |
| 74                | <u>Habit</u>         | (See Column #11)                               |
| 75 - 76           | <u>Covellite</u>     | Content estimated in percent                   |
| 77                | <u>Habit</u>         | (See Column #11)                               |
| 78                | <u>Miscellaneous</u> |  |
|                   | Mg                   | Magnetite                                      |
|                   | Mo                   | Molybdenite                                    |
|                   | R                    | Realgar  |
|                   | Sp                   | Sphalerite                                     |
|                   | Sb                   | Stibnite                                       |
|                   | Gn                   | Galena   |
| 79 - 80           |                      | Content estimated in percent                   |
| 81                | <u>Habit</u>         | (See Column #11)                               |
| 82 - 86           | <u>Sample Number</u> | Assay tag number                               |
| 87 - 91           | <u>Depth</u>         | Depth in feet separating assay intervals       |
| 92 - 93           | <u>Interval</u>      | Interval of assay sample in feet               |
| 94 - 98           | <u>Au</u>            | Gold values in oz/ton                          |
| 99 - 102          | <u>Ag</u>            | Silver values in oz/ton                        |
| 103 - 106         | <u>Cu</u>            | Copper values in Wt percent                    |
| 107 - 110         | <u>As</u>            | Arsenic values in Wt percent                   |
| 111 - 114         |                      | Additional elements for assay                  |
| 115 - 118         |                      | Additional elements for assay                  |
| 119 - 120         | <u>Recovery</u>      | Recovery, intervals marked off by footage tags |



COST STATEMENTSLAKEVIEW CLAIM GROUP

Diamond Drilling (87-40 to 87-88, 87-91 to 87-99, 87-103 to 87-106, 87-109 to 87-110, 87-112 to 87-114, 87-119, 87-128 to 87-129, 87-132 to 87-136, 87-138 to 87-144 & 87-151 to 87-152.)

Supervision, Drillsite Preparation, Core logging,  
Splitting and Storage

James F. Bristow P. Eng.

June/87-10days, July/87-19 days, Aug/87-3 days, Sept/87

2 days, Oct/87-6 days Nov/87-1 day

41 days @ \$250.00/day \$10250.00

Brian Hall M.Sc.

June/87 - 9 days

9 days @ \$200.00/day 1800.00

Angie Stanta F.G.A.C.

July/87-4 days, Aug/87-22 days, Sept/87-16 days

Oct/87-16 days, Nov/87-2 days

60 days @ \$160.00/day 9600.00

Technical Services and Labour

P. MacEachern B. Sc.

July/87 - 10 days

10 days @ \$100.00/day 1000.00

S. Jut

June/87 - 12days

12 days @ \$132.00/day 1584.00

Tammy MacDonald

June/87-7 days, July/87-22days, Aug/87-19 days,

Sept/87-19 days Oct/87-16 days, Nov/87-2 days

85 days @ \$102.00/day 8670.00

Diamond Drilling (as per invoices)

Globe Drilling Ltd. & Quest Canada Drilling Ltd.

5420 metres @ \$82.46/metres 446,952.50

Drill Site Preparation

Dennis Phye Bulldozing Ltd.

(as per invoices) 6180.00

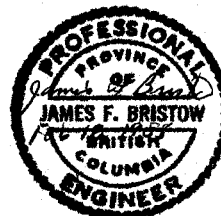

## Drill Core Storage

## Core Shack Construction

Lloyd Jones Carpentry  
(as per invoices) \$14,600.32

Core hauling Truck rentals  
(as per invoices) 1,997.07

## Labour

Barry Needham Sept/87-6days,  
Oct/87-3days, Nov/87-2days  
11 days @ \$168.00/day 1,848.00

Ron Biebrich Sept/87-6 days,  
Oct/87-3days  
9 days @ \$156.00/day 1,404.00

## Core Boxes

1013 boxes @ \$5.05/box 5,115.65 \$24,965.04

## Assaying Costs (gold, silver &amp; Arsenic)

1070 Samples @ \$22.25/sample 22,807.50

## Sample Freight to Kamloops B.C.

10700lbs. @ \$25.00/100 lbs. 2,675.00

## Transportation

120 days @ \$40.00 day 4,800.00

## Food and Accommodations

237 days @ \$25.00/day 5,925.00

Report Preparation (including drafting  
and typing) 1,500.00

TOTAL:

\$548,709.04

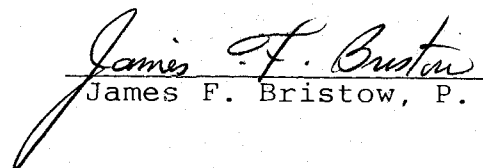
  
James F. Bristow, P. Eng.

QUALIFICATIONS AND CERTIFICATIONS

I, James F. Bristow, of 9620 Thomas Place, in the municipality of Richmond, Province of British Columbia, hereby certify as follows:

1. I am a graduate of the University of British Columbia with a B.A. Degree (Geology and Physics).
2. I am a member of the Canadian Institute of Mining and Metallurgy, the Geological Society of South Africa and the Association of Exploration Geochemists.
3. I am a Professional Engineer registered in the Province of British Columbia.
4. I have actively practiced my profession in mineral exploration and mining since my graduation in 1957.
5. That this report is based on data collected between June 6, 1987 and November 1, 1987 by myself or by other persons working under my direct supervision.
6. That I am a Director of Better Resources Limited and hold a direct interest in securities of this company.

Dated at Richmond, British Columbia this 23<sup>rd</sup> day of February 1988

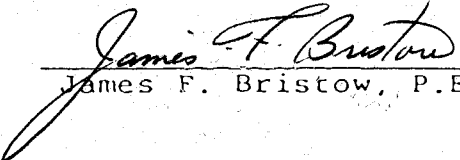
  
James F. Bristow, P.Eng.

A P P E N D I X I

INVOICES

|                    |             |
|--------------------|-------------|
| ORDER NUMBER       | 076667      |
| DATE               | July 2 1987 |
| CUSTOMER'S ORDER # | # 138       |
| SALESMAN           |             |
| TERMS              |             |
| F.O.B.             |             |

SOLD TO BETTER RES LTD.

SHIPPED TO \_\_\_\_\_

ADDRESS \_\_\_\_\_ VIA \_\_\_\_\_

INVOICE

|  |                             |  |             |  |
|--|-----------------------------|--|-------------|--|
|  |                             |  |             |  |
|  | DDH 40-61 inclusive         |  |             |  |
|  | 2642 feet NQ @ \$25.00/foot |  | \$60,766.00 |  |
|  | 122 feet NW @ \$23.00/foot  |  | \$2,806.00  |  |
|  | EXTRA CONTRACT CHARGES      |  | \$6,497.00  |  |
|  |                             |  | <hr/>       |  |
|  |                             |  | \$70,069.00 |  |
|  | Mike Rennie                 |  |             |  |
|  | GLOBE DRILLING (1981) LTD.  |  |             |  |
|  | Paid by cheque              |  |             |  |
|  | # 35277                     |  |             |  |

D32



076668

DATE July 15

CUSTOMER'S ORDER # 139

SALESMAN

TERMS

F.O.B.

SOLD TO BETTER RESOURCES LTD.

SHIPPED TO \_\_\_\_\_

ADDRESS \_\_\_\_\_ VIA \_\_\_\_\_

INVOICE

|   |                                  |  |                    |  |
|---|----------------------------------|--|--------------------|--|
|   | <u>D.D. # 63 TO 75</u>           |  |                    |  |
| ✓ | <u>1902' NQ @ \$23.00/foot</u>   |  | <u>\$43,746.00</u> |  |
| ✓ | <u>93' NW @ \$23.00/foot</u>     |  | <u>\$2,139.00</u>  |  |
|   |                                  |  |                    |  |
|   | <u>Paid by <i>Regue</i> #354</u> |  | <u>\$45,885.00</u> |  |
|   | <u>23 July/87</u>                |  |                    |  |
|   |                                  |  |                    |  |
|   |                                  |  |                    |  |
|   |                                  |  |                    |  |
|   |                                  |  |                    |  |
|   |                                  |  |                    |  |

D32



|                  |                |
|------------------|----------------|
| ORDER NUMBER     | 076670         |
| DATE             | AUGUST 14 1987 |
| CUSTOMER'S ORDER | #139           |
| SALESMAN         |                |
| TERMS            |                |
| F.O.B.           |                |

SOLD TO Better Resources Ltd.  
 SHIPPED TO \_\_\_\_\_  
 ADDRESS \_\_\_\_\_ VIA \_\_\_\_\_

INVOICE

|  |  |  |              |  |
|--|--|--|--------------|--|
|  | DDH 76 TO 89 inclusive                       |  |              |  |
|  | 62' FEET NW                                  |  | \$ 1 426.00  |  |
|  | 2 888 FEET NQ                                |  | \$ 66 424.00 |  |
|  | EXTRA CONTRACT charges<br>(EQUIPMENT RENTAL) |  | 5 244.00     |  |
|  | Paid by Cheque<br>#37114 Aug 18/87           |  |              |  |
|  |  |  | \$ 73 094.00 |  |

D32

LESS DDH 87-89 238' @ \$23.00/A \$ 5474.00

TOTAL \$ 67 620.00

2' NW  
238' @  
23.00/A

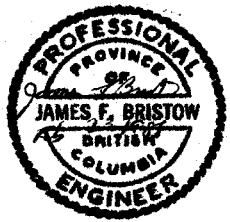

|                          |
|--------------------------|
| 076671                   |
| DATE<br>SEPT 1 '91       |
| CUSTOMER'S ORDER<br>#138 |
| SALESMAN<br>R19 #1       |
| TERMS                    |
| F.O.B.                   |

SOLD TO BETTER RESOURCES LTD.

SHIPPED TO \_\_\_\_\_

ADDRESS \_\_\_\_\_ VIA \_\_\_\_\_

INVOICE

|  |                                 |    |  |                     |
|--|---------------------------------|----|--|---------------------|
|  | DDH 90 TO 96 + 103 TO 107       |    |  |                     |
|  | 60 FEET NW @ \$23.00 PER FOOT   | 1  |  | 380.00              |
|  | 3080 FEET NW @ \$23.00 PER FOOT | 70 |  | 840.00              |
|  | EQUIPMENT RENTAL                | 6  |  | 149.00              |
|  |                                 |    |  | <del>78369.00</del> |
|  |                                 |    |  | 7958.00             |

*Paid by <sup>Telephone</sup> m 19 SEP 8*

032

LESS DDH 87-90

346' @ \$23.00/ft

\$ 7958.00

10 THAL

\$ 70,411.00

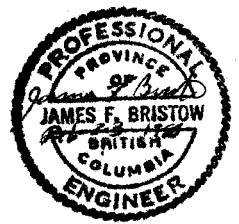



Hole 87-114 (Sept. 3)

Total depth 77 feet.  
77 feet of NQ core drilling @ \$21.50/ft. 1,655.50

Non-operating field costs chargeable for moving  
from hole that was not drilled to minimum hole  
depth.  
26 personnel hrs. @\$30.00/hr. 780.00  
13 drill rig hrs. @\$45.00/hr. 585.00

Miscellaneous  
4 core boxes @ \$6.00/box 24.00

Hole 87-113 (Sept. 4)

Total depth 77 feet.  
77 feet NQ core drilling @\$21.50/ft 1,655.50

Non-operating field costs chargeable for moving  
from hole that was not drilled to minimum depth.  
14 personnel hrs. @ \$30.00/hr 420.00  
7 drill rig hrs. @ \$45.00/hr. 315.00

Misc.  
4 core boxes @ \$6.00/box 24.00

Hole 87-112 (Sept. 4)

Total depth 75 feet  
75 feet of NQ core drilling @ \$21.50/ft. 1,612.50

Non-operating field costs chargeable for moving  
from hole that was not drilled to minimum depth.  
6 personnel hrs. @ \$30.00/hr. 180.00  
3 drill rig hrs. @ \$45.00/hr. 135.00

Miscellaneous  
4 NQ core boxes @ \$6.00/box 24.00

~~\$~~  
7410.50

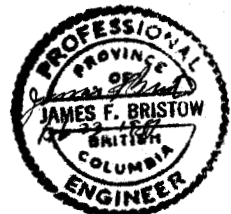

# QUEST CANADA DRILLING LTD

Hole 87-119 (Sept. 5-6) LAKEVIEW GROUP

Total depth 107 feet  
 107 feet of NQ core drilling @ \$21.50/ft 2,300.50

Non-operating field costs chargeable for moving  
 from hole that was not drilled to minimum depth.  
 4 personnel hrs @ \$30.00/hr 120.00  
 2 drill rig hrs @ \$45.00/hr 90.00

Hole 87-120 (Sept. 6) (DOMINFER GROUP)

Total depth 123 feet  
 123 feet of NQ core drilling @ \$21.50/ft. 2,644.50

Miscellaneous  
 7 NQ core boxes @ \$6.00/box 42.00

Mobilization LAKEVIEW GROUP

Cal Vic Trucking  
 Drill move and cat move, total charges  
 \$845.00 split 50% with Cactus West 422.50

Demobilization LAKEVIEW GROUP

Non-operating field costs chargeable for moving  
 from hole that was not drilled to minimum depth.  
 (Personnel hrs. only)  
 13.5 personnel hrs. for moving from last hole  
 site to truck loading point @ \$30.00/hr. 405.00

Cal Vic Trucking  
 Drill and cat to Courtenay \$880.00 880.00  
 Doman's trucking - Courtenay to Surrey 640.00  
 Crane Rental (off-loading from transport) 612.00  
 B.C. Ferry - 2 vehicles, 4 men 46.00

Demobilization (cont.)

D6 cat rental  
 Aug. 16 to Sept. 10; 26 days @ \$200/day (5,200.00)  
 9 Days LAKEVIEW @ \$200/day 1,800.00  
 17 Days DOMINFER  
 TOTAL DUE \$ 7316.00



|                  |              |
|------------------|--------------|
| OUR NUMBER       | 076672       |
| DATE             | SEPT 25 1987 |
| CUSTOMER'S ORDER | #138         |
| SALESMAN         |              |
| TERMS            |              |
| F.O.B.           |              |

SOLD TO BETTER RESOURCES LTD.

SHIPPED TO \_\_\_\_\_

ADDRESS \_\_\_\_\_ VIA \_\_\_\_\_

INVOICE

|   |              |
|---|--------------|
| RD. H. Hole # 97, 98, 99, 110, 115, 115B      |              |
| # 116, 117, 118, 119, 120, 121, 122           |              |
| # 123, 126, 127, 128, 130                     |              |
| <sup>21, 15</sup> 5079 NQ + NW @ \$23.00/foot | \$1176.45.00 |
| EXTRA contract charge                         | \$115,345.00 |
|   | \$11,847.00  |
|   | \$127,192.00 |
|   | \$129,492.00 |

Paid by Cheque  
# 389.26 Sept 26 1987

87-97 - 300'  
87-98 - 128'  
LAKEVIEW GROUP 87-99 - 402'  
87-110 350'  
87-128 500'

1680 @ \$23.00/ft = \$ 38,640.00

EXTRA CHARGES

EQUIPMENT RENTAL = \$ 2,050.00

10 @ \$6149.00  
30

28 Man Hours @ \$22.00/hr = 616.00

TOTAL LAKEVIEW CHARGES \$ 41,306.00



|                           |
|---------------------------|
| 076673                    |
| DATE<br>OCTOBER 2 '40     |
| CUSTOMER'S ORDER<br># 138 |
| SALESMAN                  |
| TERMS                     |
| F.O.B.                    |

SOLD TO PETER RESOURCES LTD.

SHIPPED TO \_\_\_\_\_

ADDRESS \_\_\_\_\_ VIA \_\_\_\_\_

INVOICE

|                                |  |             |  |
|--------------------------------|--|-------------|--|
| D.P.H. # 121, # 122, # 133     |  |             |  |
| # 129, # 134                   |  |             |  |
| 31' NW + 1757' NW @ \$23.00/ft |  | \$41,124.00 |  |
| Paid by #392<br>4/10/67        |  |             |  |

032

LESS DDH-87-131 340' @ 23.00/ft. 7820.00  
 33304.00

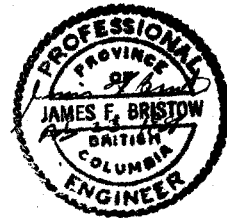

|                  |             |
|------------------|-------------|
| DATE             | OCT 15 1987 |
| CUSTOMER'S ORDER | #138        |
| SALESMAN         |             |
| TERMS            |             |
| F.O.B.           |             |

SOLD TO BETTER RESOURCES LTD

SHIPPED TO \_\_\_\_\_

ADDRESS \_\_\_\_\_ VIA \_\_\_\_\_

INVOICE

|   |  |  |             |  |
|---|--|--|-------------|--|
| DDH #136, 137, 138, 139, 142<br>+ #135        |  |  |             |  |
| 38' NW x 2138' NR @ \$23.00/ft                |  |  | \$50,048.00 |  |
| EXTRA contract charges<br>94 hrs @ \$22.00/hr |  |  | 2,068.00    |  |
|   |  |  | \$52,116.00 |  |
| Paid by cheque<br>#460 19/10/87 JFB           |  |  |             |  |

LESS DDH 87-137 361 @ \$23.00 8,303.00  
 \$ 43,813.00

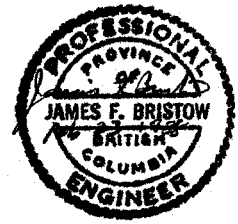

076675  
 DATE OCT 28  
 CUSTOMER'S ORDER # 139  
 SALESMAN  
 TERMS  
 F.O.B.

SOLD TO BETTER RES LTD  
 SHIPPED TO \_\_\_\_\_  
 ADDRESS \_\_\_\_\_ VIA \_\_\_\_\_

INVOICE

|  |   |       |        |  |
|--|---|-------|--------|--|
|  | D.R. H. #140, 141, 143, 144, 145<br>#146, 147 + 148 |       |        |  |
|  | 87 feet NW + 2798' NQ @ 23.00/ft                    | \$ 66 | 355.00 |  |
|  |   | \$ 6  | 964.00 |  |
|  |   | \$ 73 | 319.00 |  |

*Paid by #105  
 Cheque 2/11/87*

032

LESS 87-145 321'  
 87-146 408  
 87-147 245  
 87-148 324'  
1298'

@ \$23.00/ft.

29 854.00  
 43 465.00

TOTAL

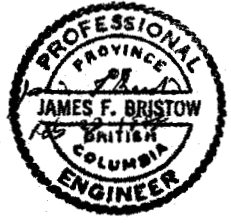

|                    |                 |
|--------------------|-----------------|
| OUR NUMBER         | 076676          |
| DATE               | November 6 1957 |
| CUSTOMER'S ORDER # | 138             |
| SALESMAN           |                 |
| TERMS              |                 |
| F.O.B.             |                 |

SOLD TO BETTER Resources LTD.

SHIPPED TO \_\_\_\_\_

ADDRESS \_\_\_\_\_ VIA \_\_\_\_\_

INVOICE

|  |  |  |             |  |  |
|--|--|--|-------------|--|--|
|  | D.D.H #149, 150, 151, 152              |  |             |  |  |
|  | 1227 feet NQ + 32 feet NW @ \$23.00    |  | \$28,865.00 |  |  |
|  | EXTRA CONTRACT charges                 |  | \$11,042.00 |  |  |
|  |  |  | \$39,907.00 |  |  |
|  | Less \$600.00 dollars rent lot #2 M.W. |  | - 600.00    |  |  |
|  |  |  | \$39,307.00 |  |  |
|  | paid by check #415                     |  |             |  |  |

032

DDH 87-151 286' @ \$23.00/H = 6578.00  
 87-152 306' @ \$23.00/H = 7038.00  
 13616.00

Applicable extra charges

2737.00

TOTAL \$16,353.00



STATEMENT

**Dennis Phye**

BULLDOZING LTD.

DOUBLE TILT BLADE  
Land Clearing • Approved Subdivision  
Complete Burning • Farm Land Clear

Free Estimates  
334-2825

4901 Topland Road  
Courtenay, B.C.  
V9N 6N1

DATE OCT. 31 19 87

Name BETTER RESOURCES

Address MT. WASHINGTON, B.C.

City \_\_\_\_\_ Telephone \_\_\_\_\_

Work done at pad site, drill roads.

|         |                           |          |           |
|---------|---------------------------|----------|-----------|
| Oct. 18 | 07-7 Excavator            |          |           |
|         | move, move plastic        | 3.0      |           |
| 19      | repair pad site, drill rd | 7.5      |           |
| 20      | drill road, pad site      | 7.5      |           |
| 22      | move 07-7 to lowbed       | - 1.5    |           |
|         |                           | 19.5 hr. |           |
|         | rate 82.00 per hr.        |          | 1599.00   |
| 22      | lowbed part of move       |          |           |
|         | 4.hr*75. 300.00 = 75.00   |          | 225.00    |
| 31      | invoice # 27938           |          |           |
|         | calvert pipe              |          | 161.93    |
|         |                           | TOTAL    | \$2060.93 |

*Thank You*  
*Dennis Phye*

*Paid By Cheque*  
*# 407 / 2/11/87*

TERMS: Net 30 days from date of invoice.  
2% per month on overdue accounts.  
24% per annum.

LAKE VIEW DRILL ROAD  
9 hrs @ 82.00/hr.  
LOW BED MOVE

738.00

225.00

\$ 963.00





STATEMENT

**Dennis Phye**  
BULLDOZING LTD.

DOZ • FULT BLADE  
Land Clearing • Approved Subdivision Rd.  
Complete Burning • Farm Land Clearing

Free Estimates  
334-2825

4901 Topland Road  
Courtenay, B.C.  
V9N 6N1

DATE August 5 19 87

Name Better Resources Ltd.

Address Mt. Washington

City \_\_\_\_\_ Telephone \_\_\_\_\_

Drill roads done at Mt. Washington site

|      |       |                               |  |                  |
|------|-------|-------------------------------|--|------------------|
| July | 19    | Lowbed move                   |  |                  |
|      |       | Topland Rd. to Mt. Washington |  |                  |
|      |       | 7.0 hr. * \$60.00             |  | 420.00           |
| July | 20-31 | Total 91.5 hr. * \$78.00      |  | 7137.00          |
|      |       | TOTAL                         |  | <u>\$7557.00</u> |
|      |       | Hitachi 07-5 Excavator        |  |                  |

*OK JFB  
Paid by # 377  
Aug 11/87*

*Thank you  
Dennis*

TERMS: Net 30 days from date of invoice.  
2% per month on overdue accounts.  
24% per annum.

DOMINIER DRILL ROAD  
30 hrs

LAKEVIEW DRILL ROAD  
61.5 hrs @ \$78.00/hr.  
LOWBED MOVE 7 hrs @ \$60.00/hr



4797.00  
420.00  
\$ 5217.00

A P P E N D I X    I I

(in pocket)

FAME GRANT 10962-EG9  
 BETTER RESOURCES LTD.

GEOLOGICAL BRANCH  
 ASSESSMENT REPORT

TABLE I  
 DRILL HOLE SUMMARY

| Claim Group | Drill hole No. | Azimuth | Dip | Ft  | Depth (Metres) | Coordinates |           | Elevation | Date     |         |           |            |            |
|-------------|----------------|---------|-----|-----|----------------|-------------|-----------|-----------|----------|---------|-----------|------------|------------|
|             |                |         |     |     |                | Northings   | Eastings  |           | Start    | Finish  |           |            |            |
| L*          | 87 - 40        | -       | -90 | 251 | (76.5)         | 4,563.0     | (1,390.8) | 2,057.0   | (-626.9) | 4,510.0 | (1,374.6) | June 6/87  | June 8/87  |
| L*          | 87 - 41        | -       | -90 | 173 | (52.7)         | 4,590.0     | (1,398.9) | 2,350.0   | (-716.2) | 4,502.0 | (1,372.2) | June 8/87  | June 9/87  |
| L           | 87 - 42        | -       | -90 | 51  | (15.5)         | 1,642.9     | (500.8)   | 2,271.2   | (-692.3) | 4,382.7 | (1,335.9) | June 10/87 | June 10/87 |
| L           | 87 - 43        | -       | -90 | 51  | (15.5)         | 1,546.3     | (471.3)   | 2,226.7   | (-678.7) | 4,381.1 | (1,335.4) | June 10/87 | June 10/87 |
| L           | 87 - 44        | -       | -90 | 67  | (20.4)         | 1,503.3     | (458.2)   | 2,199.8   | (-670.5) | 4,382.7 | (1,335.9) | June 11/87 | June 11/87 |
| L           | 87 - 45        | -       | -90 | 55  | (16.8)         | 1,740.4     | (530.5)   | 2,321.6   | (-707.6) | 4,386.1 | (1,336.8) | June 11/87 | June 11/87 |
| L           | 87 - 46        | -       | -90 | 55  | (16.8)         | 1,840.3     | (560.9)   | 2,361.0   | (-719.6) | 4,388.6 | (1,337.6) | June 11/87 | June 12/87 |
| L           | 87 - 47        | -       | -90 | 71  | (21.6)         | 1,935.4     | (589.9)   | 2,401.9   | (-732.1) | 4,386.9 | (1,337.1) | June 12/87 | June 12/87 |
| L           | 87 - 48        | -       | -90 | 55  | (16.8)         | 2,030.6     | (618.9)   | 2,444.2   | (-745.0) | 4,385.5 | (1,336.7) | June 12/87 | June 13/87 |
| L           | 87 - 49        | -       | -90 | 100 | (30.5)         | 1,612.8     | (491.6)   | 2,077.8   | (-633.3) | 4,437.9 | (1,352.7) | June 13/87 | June 13/87 |
| L           | 87 - 50        | 148     | -45 | 115 | (35.1)         | 1,603.6     | (488.8)   | 2,088.9   | (-636.7) | 4,437.9 | (1,352.7) | June 14/87 | June 14/87 |
| L           | 87 - 51        | 070     | -46 | 117 | (35.7)         | 1,599.9     | (487.7)   | 2,093.6   | (-638.1) | 4,437.9 | (1,352.8) | June 15/87 | June 15/87 |
| L           | 87 - 52        | 250     | -47 | 109 | (33.2)         | 1,599.9     | (487.7)   | 2,093.6   | (-638.1) | 4,437.9 | (1,352.7) | June 15/87 | June 16/87 |
| L           | 87 - 53        | 070     | -85 | 108 | (32.9)         | 1,696.7     | (517.2)   | 2,133.6   | (-650.3) | 4,444.7 | (1,354.8) | June 16/87 | June 18/87 |
| L           | 87 - 54        | 070     | -45 | 150 | (45.7)         | 1,696.7     | (517.2)   | 2,133.6   | (-650.3) | 4,444.7 | (1,354.8) | June 18/87 | June 19/87 |
| L           | 87 - 55        | 250     | -55 | 150 | (45.7)         | 1,696.7     | (517.2)   | 2,133.6   | (-650.3) | 4,444.7 | (1,354.8) | June 19/87 | June 20/87 |
| L           | 87 - 56        | -       | -90 | 337 | (102.7)        | 1,741.6     | (530.8)   | 2,134.3   | (-657.5) | 4,444.3 | (1,354.6) | June 20/87 | June 21/87 |
| L           | 87 - 57        | 070     | -45 | 170 | (51.8)         | 1,741.6     | (530.8)   | 2,134.3   | (-657.5) | 4,444.3 | (1,354.6) | June 22/87 | June 23/87 |
| L           | 87 - 58        | 250     | -55 | 145 | (44.2)         | 1,741.6     | (530.8)   | 2,134.3   | (-657.5) | 4,444.3 | (1,354.6) | June 23/87 | June 23/87 |
| L           | 87 - 59        | -       | -90 | 115 | (35.1)         | 1,785.1     | (544.1)   | 2,187.1   | (-666.6) | 4,446.1 | (1,355.2) | June 24/87 | June 24/87 |
| L           | 87 - 60        | 070     | -45 | 150 | (45.7)         | 1,785.8     | (544.3)   | 2,184.5   | (-665.8) | 4,446.1 | (1,355.2) | June 24/87 | June 25/87 |
| L           | 87 - 61        | 070     | -45 | 160 | (48.8)         | 1,821.5     | (555.2)   | 2,212.3   | (-674.3) | 4,446.7 | (1,354.7) | June 26/87 | June 26/87 |
| L           | 87 - 62        | 250     | -55 | 140 | (42.7)         | 1,821.5     | (555.2)   | 2,212.3   | (-674.3) | 4,446.7 | (1,354.7) | June 27/87 | June 27/87 |
| L           | 87 - 63        | -       | -90 | 124 | (37.8)         | 1,872.1     | (570.6)   | 2,224.5   | (-678.0) | 4,444.3 | (1,354.6) | July 02/87 | July 03/87 |
| L           | 87 - 64        | 070     | -45 | 185 | (56.4)         | 1,872.7     | (570.8)   | 2,222.3   | (-677.4) | 4,444.3 | (1,354.6) | July 3/87  | July 4/87  |
| L           | 87 - 65        | 250     | -55 | 143 | (43.6)         | 1,872.7     | (570.8)   | 2,222.3   | (-677.4) | 4,444.3 | (1,354.6) | July 04/87 | July 05/87 |
| L           | 87 - 66        | -       | -90 | 151 | (46.0)         | 1,919.6     | (585.1)   | 2,237.2   | (-681.9) | 4,442.5 | (1,354.1) | July 05/87 | July 06/87 |
| L           | 87 - 67        | 070     | -45 | 165 | (50.3)         | 1,920.8     | (585.5)   | 2,234.4   | (-681.1) | 4,442.5 | (1,354.1) | July 06/87 | July 08/87 |
| L           | 87 - 68        | 250     | -55 | 141 | (43.0)         | 1,918.5     | (584.8)   | 2,238.5   | (-682.3) | 4,442.5 | (1,354.1) | July 08/87 | July 08/87 |
| L           | 87 - 69        | -       | -90 | 106 | (32.3)         | 1,962.2     | (598.1)   | 2,258.2   | (-688.3) | 4,438.1 | (1,352.7) | July 09/87 | July 09/87 |
| L           | 87 - 70        | 070     | -45 | 134 | (40.8)         | 1,962.2     | (598.1)   | 2,258.2   | (-688.3) | 4,438.1 | (1,352.7) | July 09/87 | July 10/87 |
| L           | 87 - 71        | 250     | -55 | 125 | (38.1)         | 1,962.2     | (598.1)   | 2,258.2   | (-688.3) | 4,438.1 | (1,352.7) | July 10/87 | July 10/87 |
| L           | 87 - 72        | 070     | -45 | 220 | (67.1)         | 2,004.1     | (610.8)   | 2,281.5   | (-695.4) | 4,438.6 | (1,352.9) | July 11/87 | July 12/87 |
| L           | 87 - 73        | 250     | -55 | 135 | (41.1)         | 2,004.1     | (610.8)   | 2,281.5   | (-695.4) | 4,438.6 | (1,352.9) | July 12/87 | July 13/87 |
| L           | 87 - 74        | -       | -90 | 201 | (61.3)         | 2,056.1     | (626.7)   | 2,289.1   | (-697.7) | 4,438.6 | 1,352.9   | July 13/87 | July 14/87 |
| L           | 87 - 75        | 070     | -45 | 160 | (48.7)         | 2,057.1     | (627.0)   | 2,286.4   | (-696.9) | 4,438.6 | (1,352.9) | July 14/87 | July 15/87 |

16, 762

| Claim Group | Drill hole No. | Azimuth | Dip | Ft    | Depth (Metres) | Coordinates |           |         | Elevation | Date    |           |            |            |
|-------------|----------------|---------|-----|-------|----------------|-------------|-----------|---------|-----------|---------|-----------|------------|------------|
|             |                |         |     |       |                | Northings   | Eastings  |         |           | Start   | Finish    |            |            |
| L           | 87 - 76        | 070     | -45 | 230   | (70.1)         | 1,706.8     | (520.2)   | 1,967.7 | (-599.8)  | 4,512.5 | (1,375.4) | July 15/87 | July 17/87 |
| L           | 87 - 77        | -       | -90 | 181   | (55.2)         | 1,622.5     | (494.5)   | 1,910.3 | (-582.3)  | 4,509.7 | (1,374.6) | July 17/87 | July 19/87 |
| L           | 87 - 78        | 070     | -50 | 131   | (39.9)         | 1,623.2     | (494.8)   | 1,908.0 | (-581.6)  | 4,509.7 | (1,374.6) | July 19/87 | July 20/87 |
| L           | 87 - 79        | -       | -90 | 221   | (67.4)         | 1,544.0     | (470.6)   | 1,838.7 | (-560.4)  | 4,507.7 | (1,374.0) | July 21/87 | July 22/87 |
| L           | 87 - 80        | 070     | -48 | 161   | (49.1)         | 1,548.8     | (470.9)   | 1,836.8 | (-559.9)  | 4,507.7 | (1,374.0) | July 22/87 | July 23/87 |
| L           | 87 - 81        | -       | -90 | 181   | (55.2)         | 1,802.8     | (549.5)   | 2,014.4 | (-614.0)  | 4,520.7 | (1,377.9) | July 24/87 | July 25/87 |
| L           | 87 - 82        | 070     | -48 | 229   | (69.8)         | 1,802.8     | (549.5)   | 2,012.2 | (-613.3)  | 4,520.7 | (1,377.9) | July 25/87 | July 28/87 |
| L           | 87 - 83        | -       | -90 | 211   | (64.3)         | 1,969.4     | (600.3)   | 2,072.8 | (-631.8)  | 4,523.7 | (1,378.8) | July 29/87 | July 30/87 |
| L           | 87 - 84        | 070     | -48 | 255   | (77.7)         | 1,970.2     | (600.5)   | 2,071.0 | (-631.2)  | 4,523.7 | (1,378.8) | July 30/87 | Aug 01/87  |
| L           | 87 - 85        | -       | -90 | 210   | (64.0)         | 2,170.6     | (661.6)   | 2,139.2 | (-652.0)  | 4,518.9 | (1,377.4) | Aug 01/87  | Aug 02/87  |
| L           | 87 - 86        | 070     | -47 | 259   | (78.9)         | 2,171.5     | (661.9)   | 2,136.7 | (-651.3)  | 4,518.9 | (1,377.4) | Aug 02/87  | Aug 03/87  |
| L           | 87 - 87        | -       | -90 | 199   | (60.7)         | 2,250.0     | (685.8)   | 2,223.1 | (-677.6)  | 4,489.2 | (1,368.3) | Aug 04/87  | Aug 05/87  |
| L           | 87 - 88        | 070     | -50 | 240   | (73.2)         | 2,250.5     | (686.0)   | 2,221.5 | (-677.1)  | 4,489.2 | (1,368.3) | Aug 05/87  | Aug 06/87  |
| D           | 87 - 89        | -       | -90 | 238   | (72.5)         | 1,176.8     | (358.7)   | 1,745.1 | (-531.9)  | 4,446.6 | (1,355.3) | Aug 06/87  | Aug 08/87  |
| D           | 87 - 90        | -       | -90 | 346   | (105.5)        | 836.3       | (254.9)   | 1,527.4 | (-465.6)  | 4,465.1 | (1,361.0) | Aug 09/87  | Aug 10/87  |
| L           | 87 - 91        | -       | -90 | 71.9  | (21.9)         | 5,224.9     | (1,592.6) | 2,236.2 | (-681.6)  | 4,405.5 | (1,342.8) | Aug 12/87  | Aug 12/87  |
| L           | 87 - 92        | -       | -90 | 52    | (15.8)         | 5,211.9     | (1,588.6) | 2,289.2 | (-697.8)  | 4,401.6 | (1,341.6) | Aug 12/87  | Aug 12/87  |
| L           | 87 - 93        | -       | -90 | 39    | (11.9)         | 5,212.1     | (1,588.7) | 2,343.7 | (-714.4)  | 4,392.3 | (1,338.8) | Aug 12/87  | Aug 13/87  |
| L           | 87 - 94        | -       | -90 | 52    | (15.8)         | 5,219.3     | (1,590.9) | 2,395.2 | (-730.1)  | 4,382.8 | (1,335.9) | Aug 13/87  | Aug 13/87  |
| L           | 87 - 95        | -       | -90 | 337   | (102.7)        | 1,950.6     | (594.6)   | 1,862.4 | (-567.7)  | 4,633.8 | (1,412.4) | Aug 14/87  | Aug 16/87  |
| L           | 87 - 96        | 070     | -59 | 371   | (113.1)        | 1,950.6     | (594.6)   | 1,862.4 | (-567.7)  | 4,633.8 | (1,412.4) | Aug 17/87  | Aug 18/87  |
| L           | 87 - 97        | -       | -90 | 300   | (91.4)         | 1,787.5     | (544.8)   | 1,709.7 | (-521.1)  | 4,624.0 | (1,409.4) | Aug 16/87  | Aug 23/87  |
| L           | 87 - 98        | 070     | -67 | 128   | (39.0)         | 1,787.0     | (544.7)   | 1,708.9 | (-520.9)  | 4,624.0 | (1,409.4) | Aug 22/87  | Aug 25/87  |
| L           | 87 - 99        | 070     | -45 | 402   | (122.5)        | 1,787.5     | (544.8)   | 1,709.7 | (-521.1)  | 4,624.0 | (1,409.4) | Aug 27/87  | Sept 11/87 |
| D*          | 87 - 100       | 320     | -60 | 603.5 | (184.0)        | 1,699.0     | (518.0)   | 1,325.5 | (404.0)   | 4,826.0 | (1,471.0) | Aug 16/87  | Aug 20/87  |
| D*          | 87 - 101       | 310     | -52 | 546   | (166.4)        | 1,696.0     | (517.0)   | 1,318.9 | (402.0)   | 4,826.0 | (1,471.0) | Aug 20/87  | Aug 22/87  |
| D*          | 87 - 102       | 010     | -45 | 605   | (184.4)        | 1,558.0     | (475.0)   | 1,325.5 | (404.0)   | 4,829.5 | (1,472.0) | Aug 23/87  | Aug 25/87  |
| L           | 87 - 103       | 070     | -75 | 380   | (115.8)        | 2,134.1     | (650.5)   | 1,919.4 | (-585.0)  | 4,640.1 | (1,414.3) | Aug 19/87  | Aug 21/87  |
| L           | 87 - 104       | 070     | -55 | 390   | (118.9)        | 2,134.1     | (650.5)   | 1,917.3 | (-584.7)  | 4,640.1 | (1,414.3) | Aug 21/87  | Aug 23/87  |
| L           | 87 - 105       | -       | -90 | 381   | (116.1)        | 2,332.0     | (710.8)   | 1,940.1 | (-591.4)  | 4,643.5 | (1,415.4) | Aug 23/87  | Aug 25/87  |
| L           | 87 - 106       | 070     | -75 | 380   | (115.8)        | 2,332.0     | (710.8)   | 1,940.1 | (-591.4)  | 4,643.5 | (1,415.4) | Aug 25/87  | Aug 27/87  |
| D*          | 87 - 107       | 010     | -60 | 526   | (160.3)        | 1,558.5     | (475.0)   | 1,325.5 | (404.0)   | 4,829.5 | (1,472.0) | Aug 26/87  | Aug 28/87  |
| D*          | 87 - 108       | 270     | -45 | 465   | (141.7)        | 1,555.2     | (474.0)   | 1,351.7 | (412.0)   | 4,829.5 | (1,472.0) | Aug 28/87  | Aug 30/87  |
| L           | 87 - 109       | -       | -90 | 320   | (97.5)         | 2,587.9     | (788.8)   | 1,980.5 | (-603.6)  | 4,627.9 | (1,410.6) | Aug 28/87  | Aug 31/87  |
| L           | 87 - 110       | 070     | -58 | 350   | (106.7)        | 2,588.0     | (788.8)   | 1,979.0 | (-603.2)  | 4,627.9 | (1,410.6) | Aug 31/87  | Sept 2/87  |

| Claim Group | Drill hole No. | Azimuth   | Dip | Ft  | Depth (Metres) | Coordinates |                         |           |         | Elevation | Date    |           |            |            |
|-------------|----------------|-----------|-----|-----|----------------|-------------|-------------------------|-----------|---------|-----------|---------|-----------|------------|------------|
|             |                |           |     |     |                | Northings   | Eastings                |           |         |           | Start   | Finish    |            |            |
|             | D*             | 87 - 111  | 280 | -45 | 555            | (169.2)     | 1,804.5                 | (550.0)   | 636.5   | (194.0)   | 4,521.0 | (1,378.0) | Aug 31/87  | Sept 2/87  |
| L           |                | 87 - 112  | -   | -90 | 78             | (23.8)      | 4,953.8                 | (1,509.9) | 1,902.4 | (-579.8)  | 4,417.5 | (1,346.4) | Sept 4/87  | Sept 4/87  |
| L           |                | 87 - 113  | -   | -90 | 77             | (23.5)      | 5,162.2                 | (1,573.4) | 1,960.4 | (-597.5)  | 4,421.0 | (1,347.5) | Sept 4/87  | Sept 4/87  |
| L           |                | 87 - 114  | -   | -90 | 77             | (23.5)      | 5,239.2                 | (1,596.9) | 2,128.3 | (-648.7)  | 4,407.1 | (1,343.3) | Sept 3/87  | Sept 3/87  |
| R           |                | 87 - 115  | 017 | -67 | 168            | (51.2)      | Located with respect to |           |         |           | 3,812.0 | (1,162.0) | Sept 4/87  | Sept 5/87  |
| R           |                | 87 - 115A | 197 | -67 | 210            | (64.0)      | to Oyster Grid          |           |         |           | 3,812.0 | (1,162.0) | Sept 5/87  | Sept 7/87  |
| R           |                | 87 - 116  | 212 | -45 | 164            | (50.0)      |                         |           |         |           | 3,812.0 | (1,162.0) | Sept 5/87  | Sept 9/87  |
| D           |                | 87 - 117  | 070 | -76 | 490            | (149.4)     | 1,901.0                 | (579.4)   | 1,404.3 | (-428.0)  | 4,830.1 | (1,472.2) | Sept 11/87 | Sept 14/87 |
| D           |                | 87 - 118  | 070 | -55 | 590            | (179.8)     | 1,901.0                 | (579.4)   | 1,405.3 | (-428.4)  | 4,830.1 | (1,472.2) | Sept 14/87 | Sept 17/87 |
| L           |                | 87 - 119  | -   | -90 | 107            | (32.6)      | 4,792.2                 | (1,460.7) | 1,723.4 | (-525.3)  | 4,432.2 | (1,350.9) | Sept 5/87  | Sept 6/87  |
| D           |                | 87 - 120  | -   | -90 | 123            | (37.5)      | 4,541.8                 | (1,384.8) | 1,441.8 | (-439.4)  | 4,448.1 | (1,355.8) | Sept 6/87  | Sept 6/87  |
| R           |                | 87 - 121  | -   | -90 | 241            | (73.5)      |                         |           |         |           | 3,798.9 | (1,157.9) | Sept 12/87 | Sept 13/87 |
| R           |                | 87 - 122  | 197 | -45 | 115            | (35.1)      | Located with respect to |           |         |           | 3,798.9 | (1,157.9) | Sept 14/87 | Sept 15/87 |
| R           |                | 87 - 123  | 197 | -67 | 149            | (45.4)      | to Oyster Grid          |           |         |           | 3,798.9 | (1,157.9) | Sept 15/87 | Sept 17/87 |
| R           |                | 87 - 124  | 197 | -67 | 175            | (53.3)      |                         |           |         |           | 3,766.0 | (1,148.0) | Sept 9/87  | Sept 11/87 |
| R           |                | 87 - 125  | 197 | -45 | 165            | (50.3)      |                         |           |         |           | 3,766.0 | (1,148.0) | Sept 11/87 | Sept 12/87 |
| D           |                | 87 - 126  | -   | -90 | 326            | (99.4)      | 1,643.7                 | (501.0)   | 1,547.1 | (-471.6)  | 4,634.5 | (1,412.6) | Sept 18/87 | Sept 21/87 |
| D           |                | 87 - 127  | 070 | -45 | 335            | (102.1)     | 1,644.3                 | (501.2)   | 1,544.8 | (-470.9)  | 4,634.5 | (1,412.6) | Sept 21/87 | Sept 23/87 |
| L           |                | 87 - 128  | -   | -90 | 500            | (152.4)     | 2,082.6                 | (634.8)   | 1,524.2 | (-464.6)  | 4,842.2 | (1,475.9) | Sept 22/87 | Sept 24/87 |
| L           |                | 87 - 129  | 070 | -65 | 539            | (164.3)     | 2,082.6                 | (634.8)   | 1,524.2 | (-464.6)  | 4,842.2 | (1,475.9) | Sept 25/87 | Sept 28/87 |
| D           |                | 87 - 130  | -   | -90 | 286            | (87.2)      | 1,492.5                 | (454.9)   | 1,438.0 | (-438.3)  | 4,632.8 | (1,412.1) | Sept 23/87 | Sept 25/87 |
| D           |                | 87 - 131  | 070 | -50 | 340            | (103.6)     | 1,493.2                 | (455.1)   | 1,436.2 | (-437.7)  | 4,632.8 | (1,412.1) | Sept 25/87 | Sept 27/87 |
| L           |                | 87 - 132  | 070 | -82 | 167            | (50.9)      | 1,746.2                 | (532.2)   | 1,989.7 | (-606.5)  | 4,513.3 | (1,375.6) | Sept 28/87 | Sept 29/87 |
| L           |                | 87 - 133  | 070 | -45 | 214            | (65.2)      | 1,747.0                 | (532.5)   | 1,987.8 | (-605.9)  | 4,513.3 | (1,375.6) | Sept 29/87 | Oct 1/87   |
| L           |                | 87 - 134  | 070 | -80 | 515            | (157.0)     | 2,250.0                 | (685.8)   | 1,629.2 | (-496.6)  | 4,821.4 | (1,469.6) | Sept 29/87 | Oct 2/87   |
| L           |                | 87 - 135  | 070 | -61 | 545            | (166.1)     | 2,250.0                 | (685.8)   | 1,628.5 | (-496.6)  | 4,821.4 | (1,469.6) | Oct 2/87   | Oct 10/87  |
| L           |                | 87 - 136  | -   | -90 | 299            | (91.1)      | 1,710.7                 | (521.4)   | 1,628.6 | (-496.4)  | 4,626.4 | (1,410.1) | Oct 1/87   | Oct 3/87   |
| D           |                | 87 - 137  | 070 | -57 | 361            | (110.0)     | 1,711.5                 | (521.7)   | 1,627.4 | (-496.0)  | 4,626.4 | (1,410.1) | Oct 3/87   | Oct 4/87   |
| L           |                | 87 - 138  | -   | -90 | 301            | (91.8)      | 1,799.4                 | (548.5)   | 1,733.3 | (-528.3)  | 4,620.2 | (1,408.2) | Oct 5/87   | Oct 6/87   |
| L           |                | 87 - 139  | 070 | -70 | 341            | (103.9)     | 1,800.0                 | (548.6)   | 1,733.0 | (-528.2)  | 4,620.2 | (1,408.2) | Oct 7/87   | Oct 8/87   |
| L           |                | 87 - 140  | -   | -90 | 281            | (85.6)      | 2,702.0                 | (823.5)   | 1,972.0 | (-601.0)  | 4,631.9 | (1,411.8) | Oct 20/87  | Oct 23/87  |
| L           |                | 87 - 141  | 070 | -45 | 345            | (105.2)     | 2,702.0                 | (823.5)   | 1,969.0 | (-600.0)  | 4,631.9 | (1,411.8) | Oct 23/87  | Oct 26/87  |
| L           |                | 87 - 142  | 070 | -80 | 321            | (97.8)      | 1,855.8                 | (565.7)   | 1,815.2 | (-553.3)  | 4,613.6 | (1,406.2) | Oct 13/87  | Oct 14/87  |
| L           |                | 87 - 143  | 070 | -45 | 365            | (111.3)     | 1,856.2                 | (565.8)   | 1,813.5 | (-552.8)  | 4,613.6 | (1,406.2) | Oct 14/87  | Oct 16/87  |

| Claim Group | Drill hole No. | Azimuth | Dip | Ft  | Depth (Metres) | Coordinates |          |         |          | Elevation | Date      |           |           |
|-------------|----------------|---------|-----|-----|----------------|-------------|----------|---------|----------|-----------|-----------|-----------|-----------|
|             |                |         |     |     |                | Northings   | Eastings | Start   | Finish   |           |           |           |           |
| L           | 87 - 144       | 070     | -45 | 570 | (173.7)        | 2,083.8     | (635.2)  | 1,522.7 | (-464.1) | 4,842.2   | (1,475.9) | Oct 12/87 | Oct 18/87 |
| D*          | 87 - 145       | -       | -90 | 321 | (97.8)         | 1,732.0     | (527.9)  | 770.0   | (-234.7) | 4,754.1   | (1,449.0) | Oct 18/87 | Oct 20/87 |
| D*          | 87 - 146       | 250     | -50 | 408 | (124.4)        | 1,732.0     | (527.9)  | 772.0   | (-235.3) | 4,754.1   | (1,449.0) | Oct 21/87 | Oct 23/87 |
| D*          | 87 - 147       | -       | -90 | 245 | (74.7)         | 1,926.0     | (587.0)  | 817     | (-249.0) | 4,747.5   | (1,447.0) | Oct 23/87 | Oct 24/87 |
| D*          | 87 - 148       | 250     | -50 | 324 | (98.8)         | 1,926.0     | (587.0)  | 820.0   | (-249.9) | 4,747.5   | (1,447.0) | Oct 24/87 | Oct 26/87 |
| D*          | 87 - 149       | -       | -90 | 330 | (100.6)        | 1,568.0     | (477.9)  | 678.0   | (-206.7) | 4,773.8   | (1,455.0) | Oct 27/87 | Oct 28/87 |
| D*          | 87 - 150       | 250     | -50 | 336 | (102.4)        | 1,568.0     | (477.9)  | 680.0   | (-207.3) | 4,773.8   | (1,455.0) | Oct 29/87 | Oct 30/87 |
| L           | 87 - 151       | -       | -90 | 286 | (87.2)         | 2,896.0     | (882.7)  | 1,934.0 | (-589.5) | 4,659.7   | (1,420.0) | Oct 26/87 | Oct 28/87 |
| L           | 87 - 152       | -       | -90 | 306 | (93.3)         | 3,083.0     | (939.7)  | 1,868.0 | (-569.3) | 4,690.3   | (1,429.6) | Oct 28/87 | Oct 30/87 |
|             |                |         |     |     |                | 27,867.4    | 8,494.0  |         |          |           |           |           |           |

**CLAIM GROUP:**

Domineer D  
Lakeview L  
Rainbow R

\* approx. co-ordinates



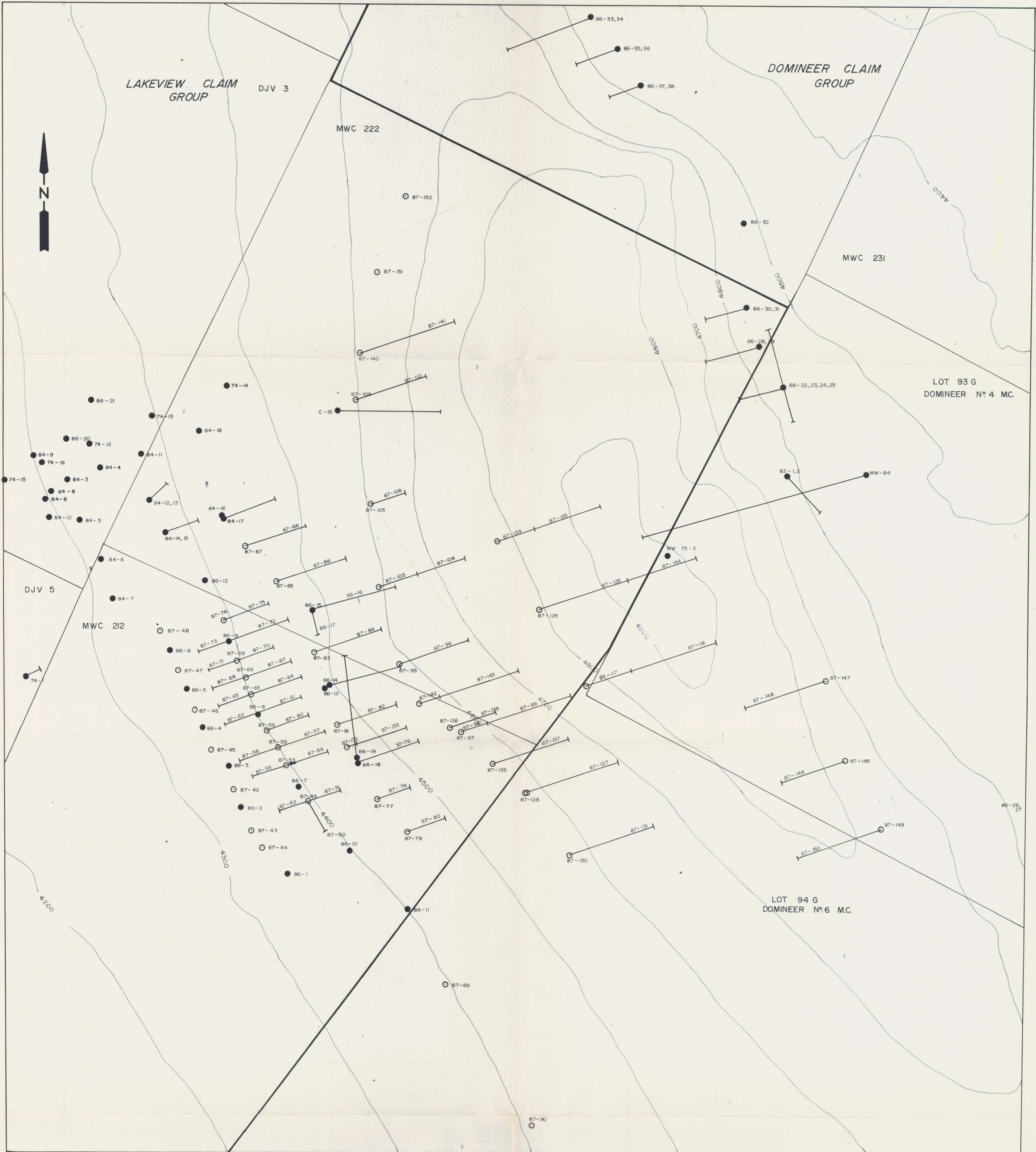

**LEGEND**

- Previous Diamond Drill Holes
- 1987 Diamond Drill Holes

NOTE: LOCATIONS BASED ON SURVEY BY  
McELHANNNEY ASSOCIATES - 1986  
AND ROSS N. GLOVER - 1987

CONTOURS IN FEET FROM 1968  
MT. WASHINGTON COPPER MINE  
DATUM.

GEOLOGICAL BRANCH  
ASSESSMENT REPORT  
**16,762**

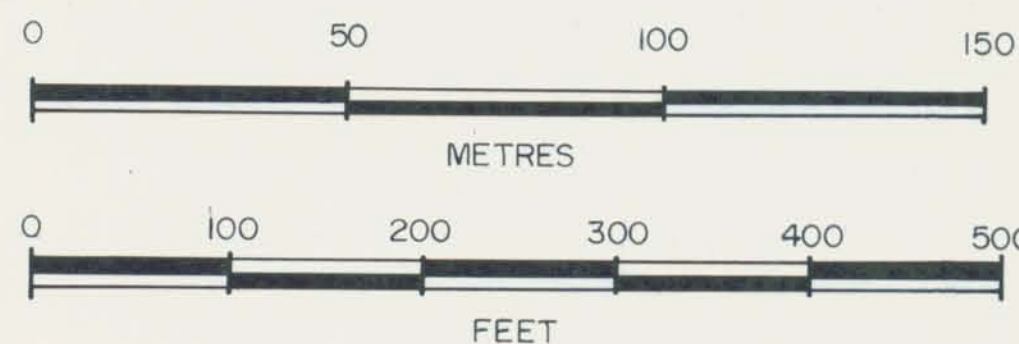

*James S. Burt*  
Feb 23 1988

|  |           |                |
|--|-----------|----------------|
| BETTER RESOURCES LTD.                              |           |                |
| MT. WASHINGTON PROPERTY<br>DRILL HOLE LOCATION MAP |           |                |
| SCALE 1:100  | REVISIONS | DRN BY: J.F.B. |
| DATE: FEB 1988                                     |           | FIGURE 4       |



