

LOG NO: 0405	RD.
ACTION:	
FILE NO:	

PAGE 1

REPORT OF EXPLORATION AND DEVELOPMENT

on the

Gordon (20 units), Gail 2 Post Staking (⁶ units) CHRIS 2-POST- (8 UNITS)
Chris FR, Joe FR, Gordon FR.

Greenwood Mining Division, B.C.

Map 82E 3E

North Lat. 49

West Long 119

January

1988

Author:

Andy Dupras

FILMED

Prospector

GEOLOGICAL BRANCH
ASSESSMENT REPORT

17,236

ARIS SUMMARY SHEET

District Geologist, Nelson

Off Confidential: 89.01.28

ASSESSMENT REPORT 17236

MINING DIVISION: Greenwood

PROPERTY: Gordon (Chris)
LOCATION: LAT 49 08 20 LONG 119 09 53
UTM 11 5444932 342107
NTS 082E03E

CLAIM(S): Chris 3-8
OPERATOR(S): Craney, J. Whatley, G.

AUTHOR(S): Dupras, A.
REPORT YEAR: 1988, 12 Pages

COMMODITIES

SEARCHED FOR: Gold, Copper, Silver, Lead, Zinc

GEOLOGICAL

SUMMARY: Interbedded and locally banded and folded quartzite and greenstone belonging to the Permian Anarchist Group are intruded by plutonic rocks belonging to the Osoyoos Batholith of Cretaceous age.

WORK

DONE: Prospecting, Physical
LINE 1.5 km
PROS 50.0 ha
ROAD 0.1 km
TREN 60.0 m 7 trench(es)

Table of Contents

Introduction: Property Location and Physiography
Technical Data and Interpretation
Itemized Cost Statement
Qualification

Maps

Figure 1 - Location = 1 = 50,000
Figure 2 - Claim Map
Figure 3 - Field Work-Map 1 = 10,000

* * * * *

Introduction

The purpose of this report is for assessment work credit; and also to review the current and previous work done on the claims, to assess the potential of the property.

It includes Information collected from field Survey, Examination and prospecting on several occasions during this past summer on the Gordon, Gail, Chris, Chris FR, Joe FR, and Gordon FR.

A program of mineral Exploration and a Geophysical Survey is recommended.

Claims

The Claims are located in the Greenwood Mining Division, in the N.T.S. area 82E-3E.

Information on file with the British Columbia Ministry of Energy, Mines and Petroleum Resources at Grand Forks, B.C. is as follows:

<u>Claim Name</u>	<u>Record No.</u>		<u>Expiry Date</u>
Gordon (20 units)	4796	Joe	Jan. 5 - 88
Gail (2 Post (6 units)	4984-4989	Joe	July 10 - 88
Chris (2 Post (8 units)	4849-4856	Gordon	Feb. 13 - 88
Chris FR	4847		Feb. 13,-88
Joe FR	4846	G-	Feb. 13 - 88
Gordon FR	4848	G-	Feb. 13 - 88

(Total = 37 Units)

PROPERTY LOCATION ACCESS

AND

PHYSIOGRAPHY

The Chris - 1 - 8 - 2 post mineral claims are situated about = 1½ miles N.E. of old Camp McKinney. They are bounded to the E and W by the Inkameep = claims and the Kettle to the south = they are reached by a bush (4 x 4) road from the Southern Provincial Highway at Rock Creek Canyon Bridge: for 5 miles this road is followed - then Jolly Creek Trail is followed for approximately 2½ miles and Chris 7 - 8 are just north of the power line (approximately 500 m) Rock Creek runs right through the full length of the claims from N-to-S- Rock Creek crosses Chris 2-4-6-8= The topography is very good; shallow rolling hills. The road runs through the full length of the claims. Elevation is approximately 4000 to 5000 feet above sea level.

The Gordon Claim & Chris FR

are Situated approx. 7.2 km from Rock Creek Canyon Bridge on Camp McKinney Road accessible by car; runs through the whole property from S.E. corder to N.W. corner which is approx. 650 m. west of Camp McKinney (Now ARK Energy) Mine Shaft and mine Camp.

Gail Claims

are accessible by 4 x 4 or pick up truck; they are Situated between the Gordon and the Chris Claims -- the Gail No. 1 & 2 -- No. 1 Post is situated approximately 350 m. north of Jolly Lake - Elevation 3900 to 4200 feet above Sea Level.

Technical Data & Interpretation

Main Showing is on the Chris 3 & 4 - 5 & 6. Blasted and cleaned 3 old trenches (circa 1900) opened new Showing (Shear zone) with 555 cat. with 6 way Blade and Back hoe on the Road and made cat Road from Road to old trench west Side of Road. Good Shear zone 20' wide mineralized few inches wide with abundant Galena, Chalco, Pyrite and sparce Zinc. We surveyed a traverse connecting all trenches and pits and old Shaft in the area -- took numerous Rock Samples, Prospected 2 men - 10 Days.

4 - Good Showings on the Gail No. 5 & 6 and 1 & 2 consisting of very old workings, but had no time this year to further Prospect the property. Will do a Geophysic Survey next summer. Plus back hoe and cat work.

We did back hoe work on the Gordon Claim Intersected a calcite vein 3 to 6' wide and a Graphite vein 12" wide approximately 350 feet west of the calcite Vein. found some very old workings on the S.W. corner of the Property 1 claim North of the E.W. South Boundary. This claim is situated in the immediate Vicinity of Camp McKinney and warrant a lot more exploration which we will carry on in 1988 in Geophysic, EM and MAG and Soil Sampling. The location is very favourable for Gold and Silver.

See map for Surveyed traverse and Location of trenches and Shafts and Pits. Also included are assay Reports from Vancouver.

Itemized Cost of Project

July 5 - 6	550 cat 14 hrs. @ 30.00 per hr.	420.00
July 5 - 6	2 men on Power Saw - Cleaning behind cat & on road side	200.00
July 5 - 6	Cat Operator	200.00
July 5 - 6	Land Rover & Gas	60.00
August 24-30-31- Sept. 1 to 18	Prospecting 2 men @ 75.00 per man	1050.00
Aug. - Sept.	Gas & Deisel	150.60
Aug. - Sept.	13 days = Land Rover @ 20.00 per day	260.00
Aug. - Sept.	Back hoe - move to Worksite and back to O.K. Falls. 200.00 each way (Low Boy)	400.00
Aug. - Sept.	Back hoe work 7 days = 40 hr @ 30.00 per hour (Operator included)	1200.00
Sept. 5 & 18	Professional Geologist on property (2 of them consultant)	400.00
Sept. 5 & 18	Gas	30.00
Sept. 5 & 18	Land Rover	40.00
Sept. 5 & 18	Driver	100.00
Aug. - Sept.	Groceries 3 men 11 days	240.00
Aug. 24	2 men surveyed traverse measurement between pits & trenches	100.00
Trench # 1 =	Chris claim # 3 approx. 7 cu. yds. removed	30.00
Trench # 2	Chris Claim #4 approx. 15 " " "	70.00
Trench #3	Chris claim #3 approx. 10 " " "	50.00
Trench #4	Chris Claim #3 approx. 10 " " "	50.00
Trench #5	Chris Claim # 3 approx. 5 " " "	25.00

..../cont'd.

Itemized Cost of Project, continued.

Trench # 6	Chris Claim #8 Approx. 5 yds.	25.00
Trench # 7	Chris Claim #7 approx. 5 yds.	25.00
Trench # 1	Gordon Claim approx. 20 yeds.	100.00
Pit # 1	Gordon Claim approx. 7 yds.	30.00

Total Expenses \$5255.60

MR. ANDY DUPRAS - Has been prospecting for the last 25 years.

I have learned in the field in the company of geologist, geophysicist and mineralogist. I was employed as a prospector for Keevil Inc. of Toronto for two years. I have prospected for Getty Mines Ltd., for 2 years also for Sumac Mines, Canadian Occidental Petroleum, Rio Tinto (in Alaska). I have worked in mining explorations in N.W.T., Yukon Territories, Quebec, Ontario, Manitoba and Saskatchewan. I have owned several mining claims -- I still do. Would agree in any Prospecting Examination required. Prospected last summer in Arctic for Abermin Corp. Ltd. and Donegal Dev. Ltd.

ANDY DUPRAS

MR. GORDON WHATLEY -

Resident of Okanagan Falls for 16 years. Has been involved in mining for the last 14 years. Mr. Whatley owns 1/3 interest in the claims involved in this report.

GORDON WHATLEY

MR. JOE CRANEY -

Resident of Okanagan Falls for 30 years. Involved in mining for the past 12 years. Mr. Craney is 1/3 owner in the claims involved in this report, Mr. Craney owns several other claims in B.C.

JOE CRANEY

CHRIS 2

CHRIS-1

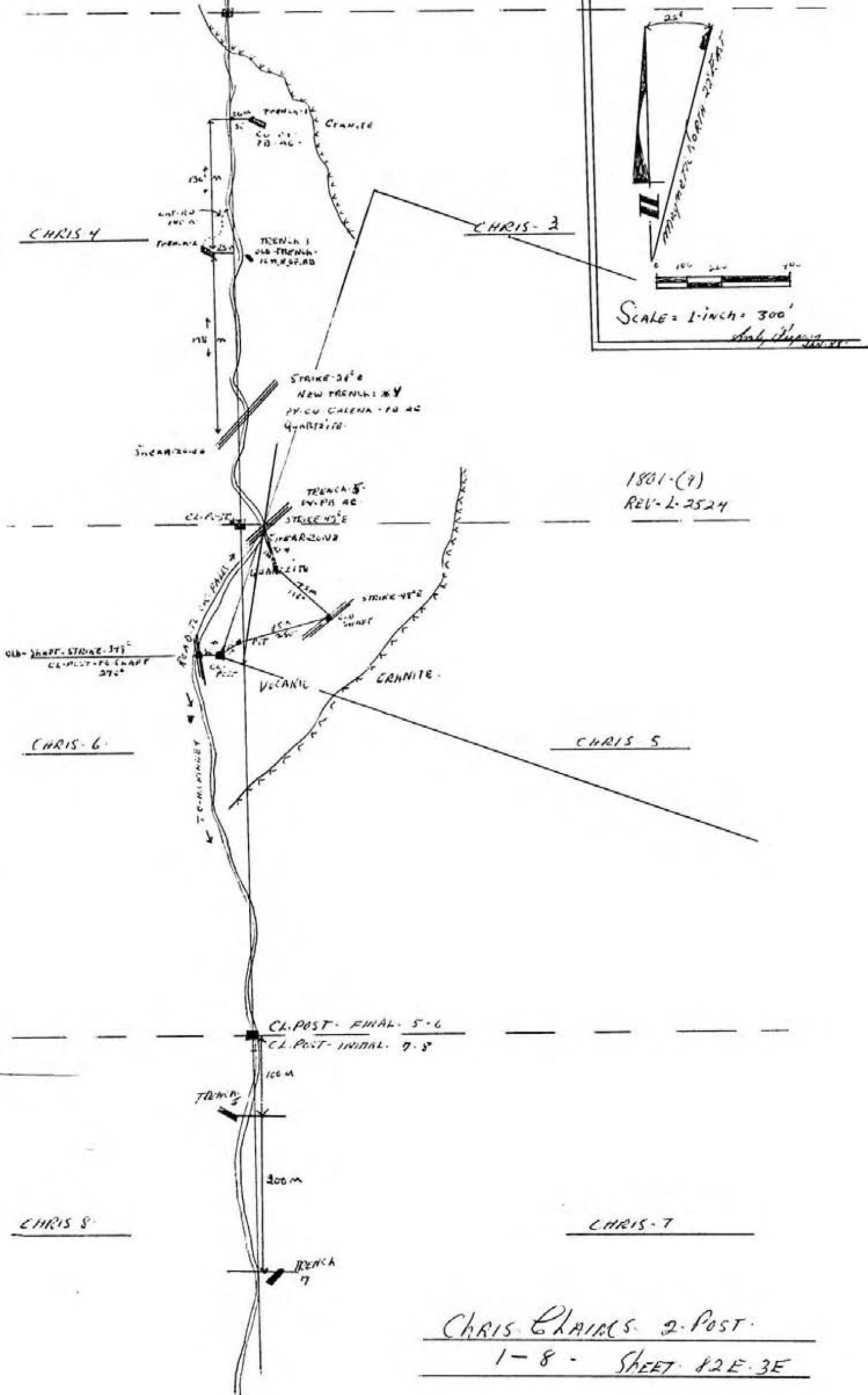

SCALE = 1 INCH = 300'

1861-(9)
REV. 2-25-24

CHRIS CLAIMS 2-POST.

1-8 - SHEET 82E.3E



Chemex Labs Ltd.

Analytical Chemists • Geochemists • Registered Assayers

212 Brooksbank Ave.
North Vancouver, B.C.
Canada V7J 2C1
Telephone: (604) 984-0221
Telex: 043-52597

CERTIFICATE OF ASSAY

TO : CRANEY, J.

RET. BOX 188
OKANAGAN FALLS, B.C.
VOH 1R0

** CERT. # : A8514063-001-A
INVOICE # : 18514063
DATE : 29-JUL-86
P.O. # : NONE →

sample description	Prep. code	Au. F.A. oz/1					
1-S-S	207	0.004	--	--	--	--	--
2-W-S	207	0.008	--	--	--	--	--
3-B-S	207	0.210	--	--	--	--	--

GORDON CLAIM

25

ACME ANALYTICAL LABORATORIES LTD.

PHONE: 253-3158

852 East Hastings St., Vancouver, B.C. V6A 1R6

File: B7-1960

Date: JULY 1 1987

WAPITI EXPLORATION INC.
405 - 535 W. GEORGIA ST.
VANCOUVER B.C.
V6B 1Z6

TERMS:
NET TWO WEEKS -
1% PER MONTH CHARGED ON
OVERDUE ACCOUNTS.

NUMBER	ASSAY	PRICE	AMOUNT
1	AG & AU ASSAY @	9.75	9.75
1	ROCK SAMPLE PREPARATION @	3.00	3.00
TOTAL			12.75

GAIL CLAIM

ACME ANALYTICAL LABORATORIES LTD.
852 E. HASTINGS ST. VANCOUVER B.C. V6A 1R6
PHONE 253-3158 TELEX 04-53124

DATE RECEIVED: DEC 18 1984

DATE REPORT MAILED: *Dec 21/84*

ASSAY CERTIFICATE

SAMPLE TYPE: ROCK CHIPS AU# 10 GRAM REGULAR ASSAY

ASSAYER: *D. Toye* DEAN TOYE, CERTIFIED B.C. ASSAYER

GOLDWEST RESOURCES

FILE # 84-3596

PAGE

SAMPLE#	Ag oz/t	Au oz/t
TAM 5 NO. B	.07	.001
TAM 4 NO. C	.11	.001
TAM 8 NO. D	.04	.001
AU 3 (NO NUMBER)	6.72	.001

*CROSS CLAIMS
1984-*

ACME ANALYTICAL LABORATORIES LTD.
852 E. HASTINGS, VANCOUVER B.C.
PH: (604)253-3158 COMPUTER LINE: 251-1011

DATE RECEIVED JUNE 24 1987

DATE REPORTS MAILED *June 30/87*

ASSAY CERTIFICATE

SAMPLE TYPE: ROCK - CRUSHED AND PULVERIZED TO -100 MESH.

ASSAYER: *D. Toye* DEAN TOYE, CERTIFIED B.C. ASSAYER

WAPITI EXPLORATION FILE# 87-1960

PAGE# 1

SAMPLE	Ag oz/t	Au oz/t
5008	.68	.070

*GAIL
CLAIM*