

## ARIS SUMMARY SHEET

District Geologist, Nelson

Off Confidential: 89.03.24

ASSESSMENT REPORT 17573

MINING DIVISION: Fort Steele

PROPERTY: Swenson  
LOCATION: LAT 49 25 00 LONG 116 14 00  
UTM 11 5473839 555608  
NTS 082F08E  
CLAIM(S): Realthing, Call Back, Viking  
OPERATOR(S): Trans-Arctic Ex.  
AUTHOR(S): Sywulsky, C.  
REPORT YEAR: 1988, 11 Pages

## COMMODITIES

SEARCHED FOR: Gold, Copper, Silver

## GEOLOGICAL

## SUMMARY:

The property is underlain by sediments of the middle and upper Proterozoic Creston and Kitchener Formations. The Middle Creston is composed of green, grey and purple argillaceous quartzite. The Upper Creston is composed mainly of grey weathering argillites. The Kitchener Formation consists of vari-coloured argillites and dolomitic argillites weathering buff to brown. The rocks strike generally 020 to 40 degrees and dip vertical to 75 degrees east, and host quartz lenses and veins. Trenching and shafts with tunnel work, done at the turn of the century, were located on the property.

## WORK

## DONE:

Prospecting  
PROS 100.0 ha

LOG NO: 0711 RD.

ACTION:

FILE NO:

PROSPECTING REPORT

FOR

THE SWENSON CLAIM GROUP

FORT STEELE MINING DIVISION

BRITISH COLUMBIA

49° 25' North Latitude - 116° 14' West Longitude

NTS 82F/8

SUB-RECORDER  
RECEIVED  
JUL - 6 1988  
M.R. # ..... \$.....  
VANCOUVER, B.C.

PREPARED FOR

TRANS-ARCTIC EXPLORATIONS LTD.

815-850 West Hastings Street

Vancouver, B.C., V6C 1E2

FILMED

PREPARED BY

C.P.S. EXPLORATIONS

Perry Creek, B.C.

GEOLOGICAL BRANCH  
ASSESSMENT REPORT

March 1988

17,573

TABLE OF CONTENTS

|                                      |   |
|--------------------------------------|---|
| SUMMARY .....                        | 1 |
| ACCESS .....                         | 2 |
| GROUND COVER .....                   | 2 |
| PROPERTY AND OWNERSHIP .....         | 2 |
| GEOLOGY:                             |   |
| A. Regional .....                    | 3 |
| B. Property .....                    | 3 |
| RESULTS AND INTERPRETATION .....     | 4 |
| CONCLUSIONS AND RECOMENDATIONS ..... | 5 |
| STATEMENT OF QUALIFICATIONS .....    | 6 |
| COST BREAKDOWN AND PERSONNEL .....   | 7 |
| ASSAY RESULTS .....                  | 8 |

LIST OF ILLUSTRATIONS

|          |                                       |
|----------|---------------------------------------|
| Map 1    | Location Map, Provincial              |
| Map 2    | Location Map, Swenson Claim Group     |
| Figure 1 | Traverse Map, Swenson Group East Half |

**C.P.S. EXPLORATIONS****EXPLORATION/  
NTS 82F/8****TRAVERSE PROSPECTING  
ON THE SWENSON CLAIM GROUP  
PERRY CREEK AREA  
FORT STEELE MINING DIVISION, B.C.****SUMMARY**

A traverse prospecting program was carried out on the eastern half of the Swenson claim group during the 1987 field season. The work consisted of traversing the southern height of land in the immediate vicinity of Gold Run Lake. Samples were collected from mineralized zones encountered. One sample collected from the remains of an old adit showed anomalous values in Au. In March of 1988, 300 metres of base line was surveyed on the claim group and will be continued after snow breakup in preparation for a VLF-EM survey.

Results show an anomalous zone in relation to an old an old adit in Au, as well as another mineralized zone that until now has been unexplored.

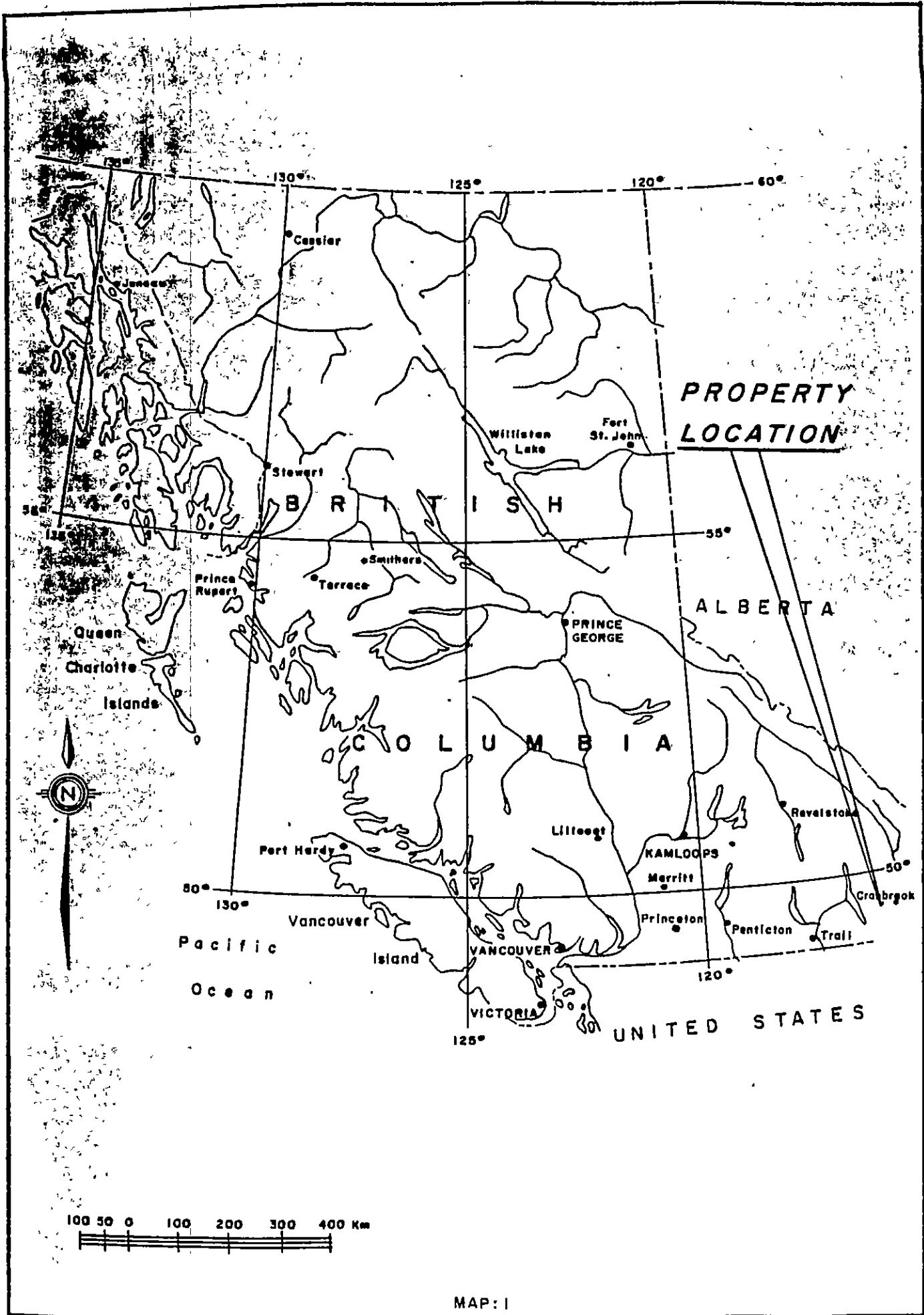

MAP: I



FLETT  
2048(1)  
15 x 5W

MT. FLEET

CND 5  
2269(9)  
5N x 4E

Hawk #  
2283(9)  
(65 x 4W)

# N.T.S. 82F/8E

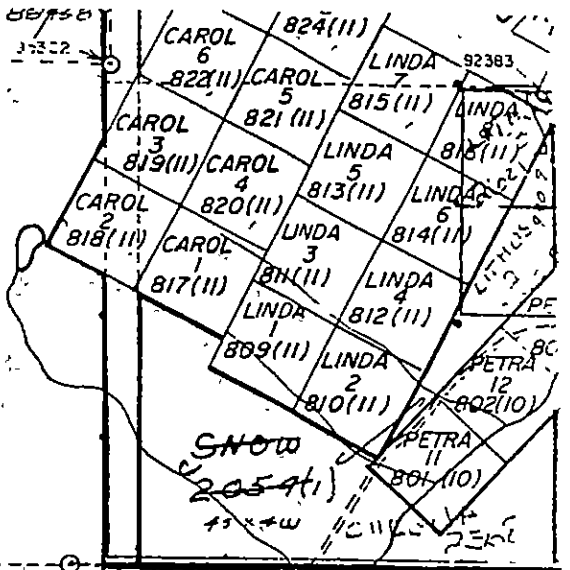

66583

66605 66604

2386(5)  
L  
14284  
C.G.

2387  
L(5)  
14285  
C.G.

CND 4  
2268(9)  
4W x 5S

CND 3  
2267(9)  
4E x 5S

CND 2  
2266(9)  
(55 x 4W)

~~CND 1~~  
~~2265(9)~~  
(55 x 4E)

G.D. Smith  
RN 262B

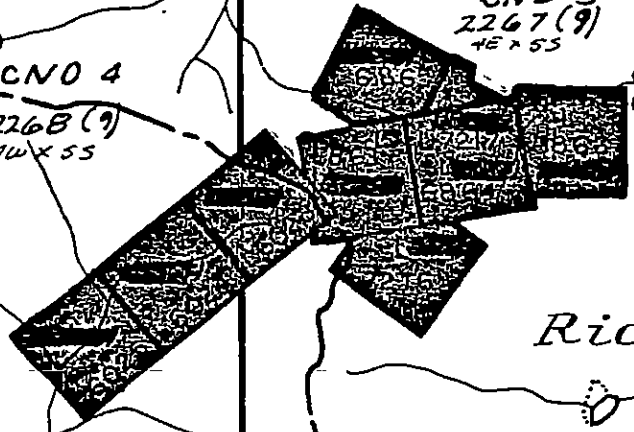

Richmond L.

2388  
L(5)  
14286  
C.G.

2389  
L(5)  
14287  
C.G.

1860 C

1851 C

1839(7)  
2E 5S

1840 C

CND  
2321(11)  
5N x 4W

125265

|                    |     |        |
|--------------------|-----|--------|
| SWENSON GROUP      |     |        |
| CLAIM LOCATION MAP |     |        |
| SCALE              | MAP | DATE   |
| 1 : 50,000         | 4   | ONE/88 |
| BDS/JRB            |     |        |

ACCESS

The Swenson group is reached via the Perry Creek main haul road to its southern terminus, approximately 60 km south of Kimberley, B.C. From this point a pack trail is followed westerly for approximately 2 km until Gold Run Lake is reached. The claim group extends south and west from this point.

GROUND COVER

The Swenson group covers an area from 5,300 feet (1,615 m) to 7,300 feet (2,225 m) elevation. Vegetation is mainly alpine, with some forested areas on the most southerly claims. Outcrop is extensive with numerous slides, bluffs and cliffs.

PROPERTY AND OWNERSHIP

The Swenson group comprises nine reverted crown grant on the divide between Perry, Hellroaring, North Moyie, and Kamma Creeks. NTS 82F/8

| <u>Claim Name</u> | <u>Record Number</u> | <u>Lot Number</u> | <u>Anniversary Date</u> |
|-------------------|----------------------|-------------------|-------------------------|
| Surething         | 2865                 | 6023              | Mar. 24, 1990           |
| Northern Light    | 2866                 | 6024              | Mar. 24, 1990           |
| Roaring King      | 2871                 | 6025              | Mar. 24, 1990           |
| Call Back         | 2867                 | 6863              | Mar. 24, 1990           |
| Real Thing &      | 2868                 | 6864              | Mar. 24, 1990           |
| Canby fraction    | 2868                 | 7217              | Mar. 24, 1990           |
| Gold Cure         | 2869                 | 6865              | Mar. 24, 1990           |
| Viking            | 2870                 | 6866              | Mar. 24, 1990           |
| Lady Grace        | 2872                 | 7216              | Mar. 24, 1990           |

The anniversary date shown takes into account the surveys under discussion as being accepted for assessment credits.

The property is registered in the name of the author, Chris Sywulsky of Kimberley, B.C.

## GEOLOGY

### A. Regional

The claim group is an area underlain by sedimentary rocks of Proterozoic age. Mapping by the GSC indicates an east-west trending sequence of the Creston formation overlain by the Kitchener formation to the west.

### B. Property Geology

As noted during traverse, the property consists of grey to purple colored quartzite and argillite. The strike of the country rock trends from N20°E to N40°E. The dips vary from vertical to 75° east. Quartz is abundant, occurring as small stringers/veins conforming to the general strike of the country rock, to quartz veins/lenses that lie horizontally and cross cut the bedding plane of the country rock. It is in the latter that the best mineralization was noted. Faulting and shearing is evident, the largest displacement found being 20 feet (6 m) horizontally east to west on Lot 6866. The sediments in the uppermost elevations appear in places to have been crushed and reorganized, this possibly the result of glacial movement and natural weathering.



## RESULTS AND INTERPRETATION

Traverse #1 uncovered two old adits, probably dating to the turn of the century. Adit #1 located on Lot 6864 is driven on a quartz vein varying from two to eight inches (5 to 20 cm) in width conforming with the strike of the country rock at N20°E. The adit is approximately 75 feet (22 m) in length but does not show any apparent mineralization. Adit #2 is driven on a quartz lens that strikes westerly and dips to the south, thus cross-cutting the bedding plane of the host rock. It is approximately one foot (30 cm) wide at the portal and pinches a few inches at the face some 50 feet (15 m) in. At its widest point it is well mineralized with pyrite, chalcopyrite, native copper and traces of malachite. Gold is visible to the eye, occurring as small flakes the size of a head of a pin and associated with the native copper.

Traverse #2 uncovered a mineralized quartz vein on Lot 6866. It strikes N25°E and dips at 80° to the east. It is approximately 1.5 feet (46 cm) wide where exposed and is heavily mineralized with pyrite. It was traced for approximately 200 feet (60 m) to the south where it was obscured by overburden. Through its traced length it retained its average width of 1.5 feet (46 cm).

Traverse #3 was a modified version of #1. Both adits were chip sampled at the portal, halfway, and at the face, these samples were saved for future assay. Both of the adits are in excellent condition, the walls and roof being very competent with very little water evident. Air in both adits passes the candle test.

A trip was made in early 1988 to begin work on a VLF-EM grid, and 300 metres of baseline was completed. It is believed

that once this survey is completed, it will afford a better picture of the structure in place, in relation to the mineralized area that are exposed, and their extension into areas that are obscured by overburden.

CONCLUSIONS AND RECOMMENDATIONS.

A program of traverse prospecting on the eastern half of the Swenson claim group has indicated small highly anomalous zones for gold. Determination of the significance of these values requires further work.

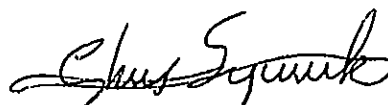

Chris P. Sywulsky  
Prospector

STATEMENT OF QUALIFICATIONS

I Christopher P. Sywulsky have been employed in the mining exploration industry full time as an independent or contract prospector working almost entirely in the Cranbrook, Perry Creek area since September, 1982.

  
CHRIS P. Sywulsky

Reference:

Richard S. Simpson  
Trans-Arctic Explorations Ltd.  
815-850 West Hastings Street  
Vancouver, B.C., V6C 1E2  
(604) 683-5246

COST BREAKDOWN AND PERSONNEL

C. Sywulsky, Prospector, Kimberley, B.C.  
Total 7 man days

Dates worked: April 6, Aug. 15, Sept 24 & 25, 1987, March 10 to  
March 12, 1988 inclusive.

D. Pearson, Assistant, Kimberley N.C.  
Total 3 man days

Costs:

|  |                 |
|--|-----------------|
| C. Sywulsky, 7 days @ \$125/day  | \$ 875          |
| D. Pearson, 3 days @ \$100/day   | 300             |
| One 4X4 3/4 ton truck, 7 days @ \$75/day<br>(includes gas and mileage) | 525             |
| Supplies   | 75              |
| Room and board, total 10 man days @ \$35/day                           | 350             |
|  | <u>\$ 2,125</u> |

Report:

|                          |               |
|--------------------------|---------------|
| Preparation, compilation | \$ 175        |
| Drafting                 | 120           |
|                          | <u>\$ 295</u> |

Grand Total \$ 2,420

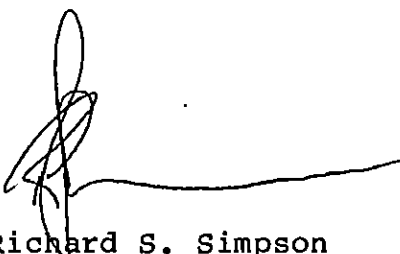

Richard S. Simpson

**Trans-Arctic Explorations Ltd.**  
815 - 850 West Hastings Street  
Vancouver, B.C. V6C 1E2  
Phone 683-5246

GOLD RUN LAKE

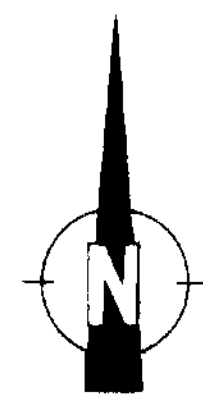

BASE LINE

000S

100S

200S

300S

6100

6200

6300

6500

6400

6600

6700

6800

6900

7000

7100

7300

7200

Traverse 1

Traverse 2

Traverse 3

L6864

L7217

L6865

L6863

Adit No. 1  
SAMPLE 42479E  
Gold - 3.938 Oz. Per Ton.  
Silver - 2.25 Oz. Per Ton.

Adit No. 2

GEOLOGICAL BRANCH  
ASSESSMENT REPORT

17,573

TRANS-ARCTIC EXPLORATIONS LTD.

SWENSON CLAIM GROUP  
(9 Reverted Crown Grants)  
Perry Creek Area  
FORT STEELE M.D. B.C.

PROSPECTING MAP

LEGEND  
Adit  
Traverse  
Station  
Quartz Vein

|                      |                   |               |              |                          |
|----------------------|-------------------|---------------|--------------|--------------------------|
| SCALE:<br>1 cm = 20M | DATE:<br>MAY 1988 | NTS:<br>82F/8 | FIGURE:<br>1 | DRAFTED BY:<br>GOS / JRB |
|----------------------|-------------------|---------------|--------------|--------------------------|

L7216