

PROSPECTING REPORT  
ON THE  
CEDAR 7 - 18 CLAIMS  
RECORD NUMBERS 7433 - 7444  
KAMLOOPS MINING DIVISION  
NTS 92P/8W

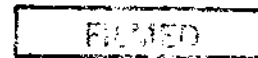

Latitude 51° 29' 30"

Longitude 120° 17'

OWNER:

E.A. DeBOCK

OPERATOR:

COMOX RESOURCES LTD.

REPORT BY:

C. SAYER, M.Sc., P. Geol  
J.C. Stephen Explorations Ltd.

Report Submitted

August, 1988

GEOLOGICAL BRANCH  
ASSESSMENT REPORT

17,709

## TABLE OF CONTENTS

|                                 |     |
|---------------------------------|-----|
| INTRODUCTION                    | 1   |
| LOCATION AND ACCESS             | 2   |
| CLAIM STATUS                    | 2   |
| HISTORY                         | 5   |
| GEOLOGY                         | 6   |
| -Regional Geology               | 6   |
| -Property Geology               | 6   |
| -Mineralization and Alteration  | 6-7 |
| ROCK SAMPLING                   | 8   |
| CONCLUSIONS AND RECOMMENDATIONS | 9   |
| REFERENCES                      | 10  |
| STATEMENT OF COSTS              | 11  |
| STATEMENT OF QUALIFICATIONS     | 12  |
| APPENDIX I ASSAY CERTIFICATES   |     |

## LIST OF FIGURES

|          |  |   |
|----------|--|---|
| Figure 1 | Location Map                             | 4 |
| Figure 2 | Claim Map                                | 5 |
| Map 1    | Geology and Sample Locations (in pocket) |   |

### LOCATION AND ACCESS

The Cedar claims are located about 9 km. northwest of the town of Little Fort B.C. (Figure 1) They can be reached by good road on the new highway 24 from Little Fort. The highway transects the claim group.

### CLAIM STATUS

A total of 12 two-post claims Cedar 7 - 18 are staked on approximately N-S lines (Figure 2). The following table details pertinent information on each claim.

| <u>Claim</u> | <u>Record<br/>Number</u> | <u>Expiry<br/>Date</u> | <u>Owner</u> |
|--------------|--------------------------|------------------------|--------------|
| Cedar #7     | 7433                     | Jan. 12/89             | E.A. DeBock  |
| Cedar #8     | 7434                     | Jan. 12/89             | E.A. DeBock  |
| Cedar #9     | 7435                     | Jan. 12/89             | E.A. DeBock  |
| Cedar #10    | 7436                     | Jan. 12/89             | E.A. DeBock  |
| Cedar #11    | 7437                     | Jan. 12/89             | E.A. DeBock  |
| Cedar #12    | 7438                     | Jan. 12/89             | E.A. DeBock  |
| Cedar #13    | 7439                     | Jan. 12/89             | E.A. DeBock  |
| Cedar #14    | 7440                     | Jan. 12/89             | E.A. DeBock  |
| Cedar #15    | 7441                     | Jan. 12/89             | E.A. DeBock  |
| Cedar #16    | 7442                     | Jan. 12/89             | E.A. DeBock  |
| Cedar #17    | 7443                     | Jan. 12/89             | E.A. DeBock  |
| Cedar #18    | 7444                     | Jan. 12/89             | E.A. DeBock  |

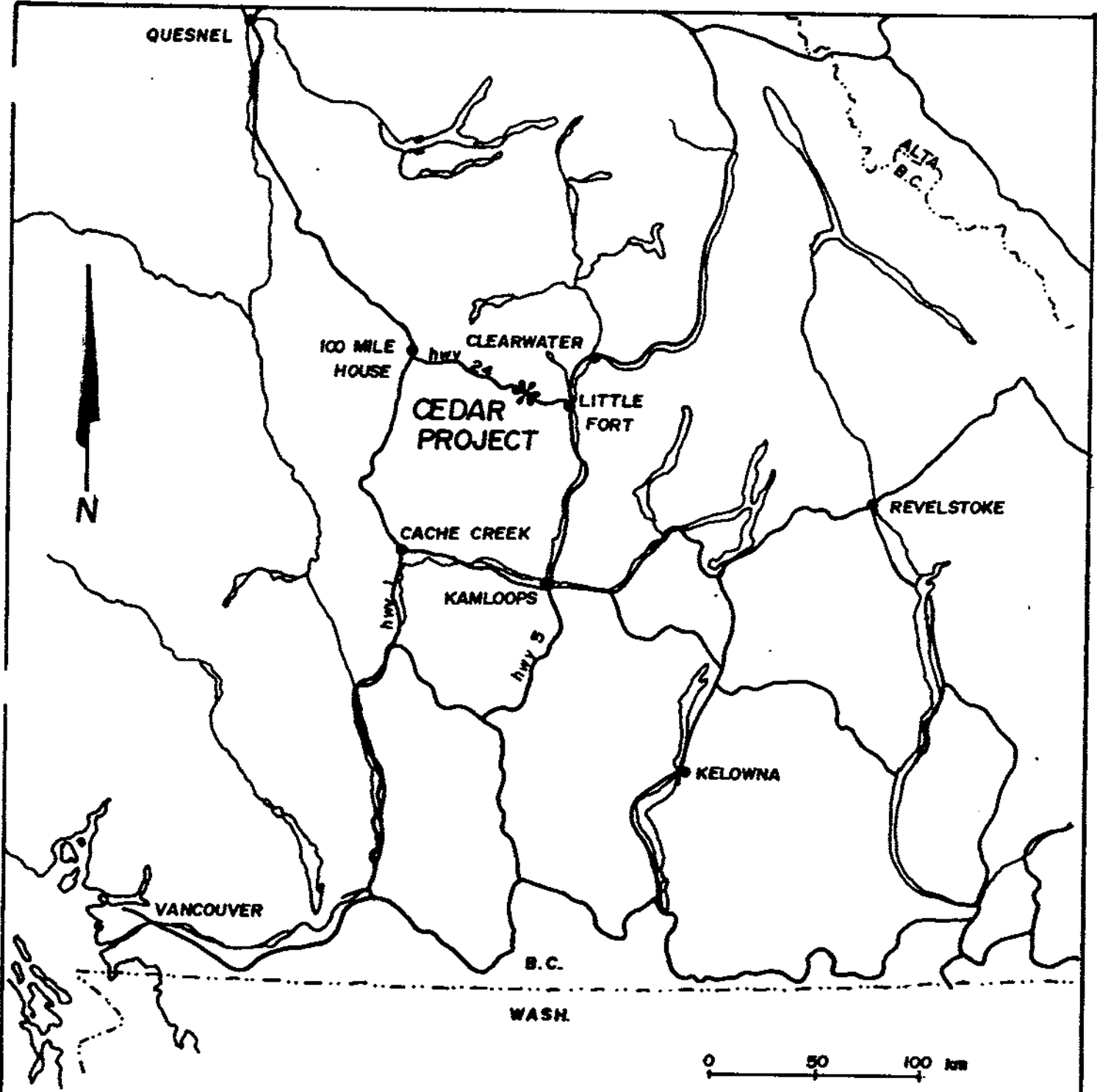

J.C. STEPHEN EXPLORATION LTD.

COMOX RESOURCES LTD.  
CEDAR PROPERTY  
LOCATION MAP

FIGURE 1

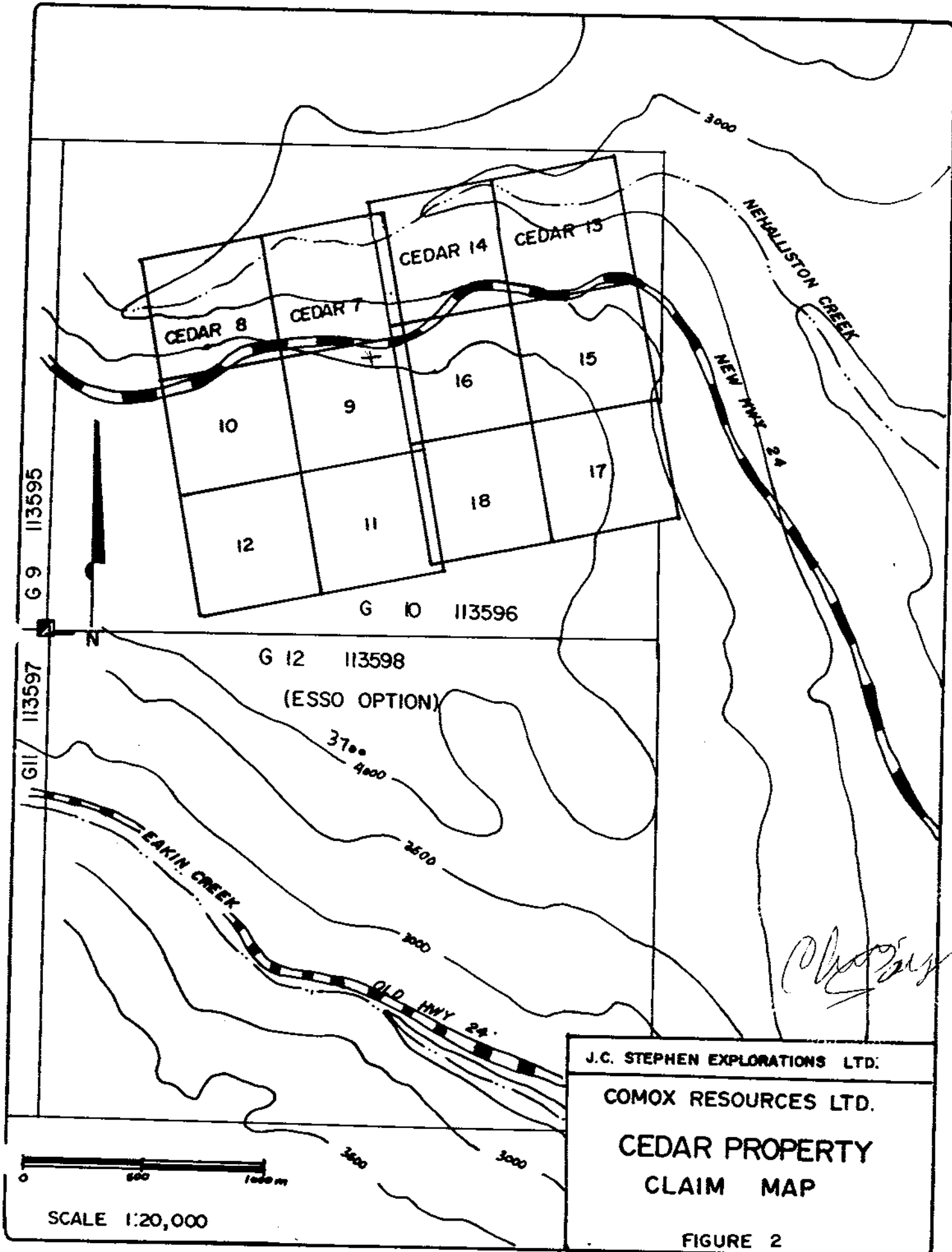

G 9 113595

G 11 113597

G 10 113596

G 12 113598

(ESSO OPTION)

CEDAR 8

CEDAR 7

CEDAR 14

CEDAR 13

10

9

16

15

12

11

18

17

3000

NEW HALLISTON CREEK

NEW HWY 24

3700  
4000

3500

3000

OLD HWY 24

3500

3000

*Handwritten signature*



SCALE 1:20,000

## HISTORY

The earliest recorded work done in the area of the Cedar claims was placer exploration in the 1920's. Placer gold deposits were discovered in Lemieux Creek and its tributary Eakin creek which is just south of the Cedar claims. Efforts to find the lode source of the gold led to the discovery of the Lakeview property 9 miles due west of Mt. Olie. The Lakeview showings are characterised by massive sulphide replacements in fracture zones cutting a belt of limestone. A massive specimen of arsenopyrite was reported to contain 12.3 oz/ton gold (B.C.D.M. 1930).

In the late 1960's and early 1970's the area around the Cedar claims was examined for its porphyry copper potential with limited success.

In 1984 the area of the present Cedar 7-18 claims as well as ground to the South was staked by E.A. DeBock and also called the Cedar claims. This ground was optioned by Craven Resources Ltd. and a first phase exploration program was conducted on it. The road showing was geologically mapped and sampled in great detail. A long (4.4 km) narrow (600 m wide) grid was established parallel to the mineralization. Soil geochemical and VLF-EM surveys were conducted on the grid.

A few widely spread gold geochemical anomalies were reported as well as quite strong VLF-EM conductors. The conductors run parallel with the known mineralization.

Results of Craven Resources' work is filed with the B.C.D.M. as assessment work.

## GEOLOGY

### Regional Geology

The Cedar claims are located on map 92-P which was mapped by R.B. Campbell and N.W. Tipper of the Geological Survey of Canada in 1964. This work is presented in Geological Survey of Canada Memoir 363.

According to Campbell and Tipper the claim area is near the northeast margin of the Late Triassic-Early Jurassic Thuya Batholith. The claims are underlain by a belt of northwest trending andesites, tuffs, argillites and limestone of the Triassic Nicola group in fault contact with Permian Eagle Bay sediments and volcanics.

This area is separated from Paleozoic terrain to the east by a major N-S fault paralleling the Thompson River valley. Splay faults off the main fault branch to the northwest; one of which passed by the eastern margin of the claims.

### Property Geology

Exposure on the property is concentrated mainly on the road cuts and in the Nehalliston Creek valley at the northern boundary. West of the main showing rocks are dominated by volcanics probably of the Nicola group. East of the showing the rocks are layered argillite and andesite of the Eagle Bay formation. At the showing itself is where previous workers have suggested the fault contact between the two exists. In general the contact is suggested to be between a more or less massive volcanic and dioritic package which is assumed to be Nicola and a variable package of chert, argillite, limestone and volcanic which is assumed to be Eagle Bay.

### Mineralization and Alteration

The most significant zone of mineralization on the Cedar claim group occurs in a road cut on the new highway 24. Two sulphide zones each about 1m wide occur in a silicified andesite in the footwall of a large fault. Sulphides may comprise up to 35% of the rock. Pyrite and pyrrhotite are dominant but traces of chalcopyrite occur. Quartz veinlets containing chalcopyrite and galena occur within the fault zone.

A second less obvious showing occurs approximately 75-100m west of the western claim line on the highway. Here a 8-10m wide skarn zone occurs within the Nicola volcanics. The skarn material is an epidote-actinolite-chlorite rich rock with 10-35% sulphide which is mainly pyrite. Small carbonate veinlets also occur often containing brecciated bits of skarn.

In other areas of the property smaller shear zones occur where the rock is quite sericitised and finely veined, mainly with carbonate. Pervasive chloritic alteration exists throughout.



## ROCK SAMPLING

A total of 14 rock samples was taken on the Cedar claims. Sampling was concentrated where previous sampling by Craven Resources Ltd. indicated gold enrichment. Map 1 shows the locations of the samples and the following table lists sample numbers and descriptions.

| Sample No. | Location                                | Rock type                                     | Width  | Au<br>(ppb) | Ag<br>(ppm) | Cu<br>(ppm) |
|------------|---|---|--------|-------------|-------------|-------------|
| 348301     | N. side<br>Nehalliston Crk.             | Carb veins in<br>chloritic volc.              | grab   | <5          | <0.2        | 80          |
| 348302     | 35 m. south of<br>Nehalliston crk.      | sheared sericitic<br>chloritic volc.          | grab   | <5          | <0.2        | 61          |
| 348303     | 35 m. south of<br>Nehalliston crk.      | sheared quartz<br>vein in volc.               | grab   | <5          | <0.2        | 129         |
| 348304     | 25 m. south of<br>Nehalliston crk.      | Epidotised diorite (?)<br>carb veins 3-4% py  | grab   | 10          | <0.2        | 142         |
| 348305     | 25 m. south of<br>Nehalliston crk.      | carb & quartz veins<br>in rusty volc. 1-3% py | grab   | 20          | <0.2        | 43          |
| 348306     | 15 m. north of<br>Nehalliston crk.      | epidote altered<br>volc                       | grab   | 20          | <0.2        | 90          |
| 348307     | 300 m. west of W.<br>claim line on Hwy. | carb veins in volc<br>up to 5% py.            | grab   | 425         | <0.2        | 112         |
| 348308     | 6275 m w of w<br>claim line on Hwy.     | carb in volc with<br>py up to 5%              | grab   | 240         | <0.2        | 50          |
| 348309     | 6250 m. w of w<br>claim line on Hwy.    | sheared carb and<br>chlorite in fault 5-8% py | grab   | 50          | <0.2        | 24          |
| 348310     | 100 m w of w claim<br>line on Hwy.      | skarn up to<br>15-20% py + cpy                | grab   | <5          | <0.2        | 371         |
| 348311     | Just above main<br>showing on Hwy       | Highly sil. volc traces<br>of malachite stain | grab   | <5          | <0.2        | 14          |
| 348312     | Just above main<br>showing on Hwy       | massive sulphide<br>rusted py, cpy, epidote   | 30 cm. | 100         | 20.4        | 0.95%       |
| 348313     | 15 m. nw of<br>31+100 nw 2+00NE         | 9B/carb veins in<br>bleached volc.            | grab   | <5          | <0.2        | 18          |
| 348314     | adjacent to 348310                      | more skarn                                    | grab   | 10          | <0.2        | 315         |

## CONCLUSIONS AND RECOMMENDATIONS

The rock sampling done during this recent study continues to produce interesting gold values such as 240 and 425 ppb. These occur west of the main showing near a previously unsampled skarn. Samples from the new skarn itself do not return particularly high gold values but they are only grab samples and do not test the potential of the skarn accurately. Samples 348302-304 and 348306 are located at Craven Resource Ltd. sample sites which returned greater than 100 ppb Au. The anomalous gold values were not confirmed by the recent sampling but it was not possible to determine exactly what material had been sampled by Craven Resources.

The Cedar property is located in a geologically interesting area from which anomalous gold samples have been and continue to be found but little comprehensive exploration work has been conducted. An initial exploration program can be recommended which would include re-establishment of the Craven Resources Ltd. grid which runs parallel to the known mineralization. The cross lines which exist should be extended to cover the entire property and additional lines should be established at 50 m intervals between the existing lines. The entire grid area should be geologically mapped and prospected in detail. Soil geochemical and magnetometer surveys should be conducted to more clearly outline the strong mineralized structure and any potential skarn zones.

Contingent upon results from the initial survey an induced polarization survey with follow up trenching and/or drilling could be recommended.

REFERENCES

B.C. Minister of Mines Report 1930, pp. A191-A192.

Campbell R.B., and Tipper N.W. 1971, Geology of Bonaparte Lake Map-Area, British Columbia. Geological Survey of Canada Memoir 363, pp. 100.

Caulfield D.A., and Ikona C.K. 1986, Assessment Report on the Cedar I, Vi, VII-XVII, XIX, XX Mineral Claims. Craven Resources Inc.

Ikona C.K. 1984, Progress Report on Cedar Claims NTS 92-P-8. Internal report, Craven Resources Inc.

Yorston R., and Ikona C.K. 1985, Geological Report on the Cedar I to VI Mineral Claims Internal report, Craven Resources Inc.

## STATEMENT OF COSTS

|  |            |
|--|------------|
| C. Sayer, Geologist April 19, August 2-4<br>4 days @ \$ 200/day    | \$ 800.00  |
| S. Allen, Assistant Aug. 3, 4<br>2 days @ \$ 125/day               | 250.00     |
| Rivermount Motel August 2-4 meals and<br>accomodation              | 176.52     |
| Vehicle Rental August 2-5, 5 days<br>\$40/day + 1100 km. @ .10/km. | 310.00     |
| Fuel   | 50.45      |
| Rock Samples 14 samples @ \$ 16.00/sample                          | 224.00     |
|  | =====      |
| TOTAL  | \$ 1810.97 |

Respectfully Submitted  
J.C.STEPHEN EXPLORATION LTD

  
Christina J. Sayer, P. Geol.

STATEMENT OF QUALIFICATIONS

I, Christina J. Sayer of Vancouver, B.C. state that:

- 1) I have obtained BSc (Honours) and MSc. degrees in geology from the University of Alberta 1984 and 1986 respectively.
- 2) I have practiced geology as a geological asistant from 1981-1985 and as a geologist from 1986 till the present.
- 3) This report is based on examination of reports by Craven Resources Inc. and my personal examination of the property on April 19 and August 2-4, 1988.
- 4) I have no interest in the Cedar property or in Comox Resources.

Dated at Vancouver, British Columbia this 24 day of Aug 1988.

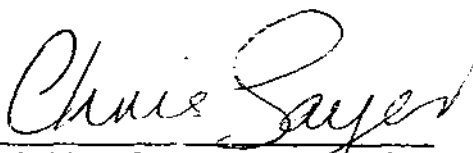
  
Christina J. Sayer, P. Geol.

APPENDIX I  
ASSAY CERTIFICATES



# Chemex Labs Ltd.

Analytical Chemists • Geochemists • Registered Assayers  
212 BROOKSBANK AVE., NORTH VANCOUVER,  
BRITISH COLUMBIA, CANADA V7J-2C1  
PHONE (604) 984-0221

T. STEPHEN, J.C. EXPLORATION LIMITED

746 REGAL CRESCENT  
NORTH VANCOUVER, B.C.  
V7K 2X8

Project: COMOX-CEDAR  
Comments:

Page No. 1-A  
Tot. Pages: 1  
Date: 15-AUG-88  
Invoice #: I-8820537  
P.O. #: NONE

## CERTIFICATE OF ANALYSIS A8820537

| SAMPLE DESCRIPTION | PREP CODE |     | Au ppb | Cu   | Al   | Ag   | As  | Ba   | Be    | Bi  | Ca    | Cd  | Co  | Cr  | Cu   | Fe    | Ga   | Hg  | K    | La   | Mg   |
|--------------------|-----------|-----|--------|------|------|------|-----|------|-------|-----|-------|-----|-----|-----|------|-------|------|-----|------|------|------|
|                    |           |     | FA+AA  | %    | %    | ppm  | ppm | ppm  | ppm   | ppm | ppm   | %   | ppm | ppm | ppm  | ppm   | %    | ppm | ppm  | %    | ppm  |
| 348312             | 208       | 238 | 100    | 0.95 | 0.34 | 20.4 | 690 | < 10 | < 0.5 | 4   | 14.85 | 1.5 | 239 | 42  | 9180 | 12.65 | < 10 | < 1 | 0.01 | < 10 | 0.06 |

ALL ASSAY DETERMINATIONS ARE PERFORMED OR SUPERVISED BY B.C. CERTIFIED ASSAYERS

CERTIFICATION :



# Chemex Labs Ltd.

Analytical Chemists • Geochemists • Registered Assayers  
212 BROOKSBANK AVE., NORTH VANCOUVER,  
BRITISH COLUMBIA, CANADA V7J-2C1  
PHONE (604) 984-0221

THE STEPHEN, J.C. EXPLORATION LIMITED

746 REGAL CRESCENT  
NORTH VANCOUVER, B.C.  
V7K 2X8

Project : COMOX-CEDAR  
Comments :

Page No. : 1-B  
Tot. Pages : 1  
Date : 15-AUG-88  
Invoice # : I-8820537  
P.O. # : NONE

## CERTIFICATE OF ANALYSIS A8820537

| SAMPLE DESCRIPTION | PREP CODE |     | Mn   | Mo  | Na     | Ni  | P   | Pb  | Sb  | Sc  | Sr  | Ti     | Tl | U    | V   | W   | Zn  |
|--------------------|-----------|-----|------|-----|--------|-----|-----|-----|-----|-----|-----|--------|----|------|-----|-----|-----|
|                    |           |     | ppm  | ppm | %      | ppm | ppm | ppm | ppm | ppm | ppm | ppm    | %  | ppm  | ppm | ppm | ppm |
| 348312             | 208       | 238 | 1205 | < 1 | < 0.01 | 6   | 40  | 322 | < 5 | 2   | 24  | < 0.01 | 10 | < 10 | 10  | < 5 | 305 |

ALL ASSAY DETERMINATIONS ARE PERFORMED OR SUPERVISED BY BC CERTIFIED ASSAYERS

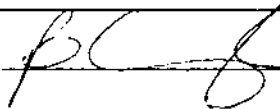
CERTIFICATION : 





# Chemex Labs Ltd.

Analytical Chemists \* Geochemists \* Registered Assayers

212 BROOKSBANK AVE. NORTH VANCOUVER,  
BRITISH COLUMBIA, CANADA V7J-2C1

PHONE (604) 984-0221

THE STEPHEN, J.C. EXPLORATION LIMITED

746 REGAL CRESCENT  
NORTH VANCOUVER, B.C.  
V7K 2X8

Project : COMOX-CEDAR

Comments :

Page No. 1-A  
Tot. Pages: 1  
Date : 17-AUG-88  
Invoice # : 1-8820536  
P.O. # : NONE

## CERTIFICATE OF ANALYSIS A8820536

| SAMPLE DESCRIPTION | PREP CODE | Au ppb<br>FA+AA | Al % | Ag ppm | As ppm | Ba ppm | Be ppm | Bi ppm | Ca %  | Cd ppm | Co ppm | Cr ppm | Cu ppm | Fe % | Ga ppm | Hg ppm | K %  | La ppm | Mg % | Mn ppm |
|--------------------|-----------|-----------------|------|--------|--------|--------|--------|--------|-------|--------|--------|--------|--------|------|--------|--------|------|--------|------|--------|
| 348301             | 205 238   | < 5             | 1.76 | < 0.2  | < 5    | 20     | < 0.5  | < 2    | 12.55 | < 0.5  | 14     | 39     | 80     | 3.18 | < 10   | < 1    | 0.07 | < 10   | 1.73 | 1165   |
| 348302             | 205 238   | < 5             | 3.83 | < 0.2  | 20     | 50     | < 0.5  | < 2    | 5.96  | < 0.5  | 28     | 18     | 61     | 6.70 | < 10   | < 1    | 0.20 | < 10   | 3.30 | 1350   |
| 348303             | 205 238   | < 5             | 2.81 | < 0.2  | 20     | 10     | < 0.5  | < 2    | 4.54  | < 0.5  | 29     | 13     | 129    | 5.48 | < 10   | < 1    | 0.02 | < 10   | 2.79 | 1105   |
| 348304             | 205 238   | 10              | 2.25 | < 0.2  | < 5    | 10     | < 0.5  | < 2    | 5.12  | < 0.5  | 27     | 18     | 142    | 3.70 | < 10   | < 1    | 0.04 | < 10   | 2.37 | 847    |
| 348305             | 205 238   | 20              | 2.22 | < 0.2  | 10     | 40     | < 0.5  | < 2    | 2.88  | < 0.5  | 30     | 6      | 43     | 5.54 | < 10   | < 1    | 0.16 | 10     | 2.13 | 690    |
| 348306             | 205 238   | 20              | 2.76 | < 0.2  | 25     | 50     | < 0.5  | < 2    | 1.74  | < 0.5  | 23     | 2      | 90     | 4.61 | < 10   | < 1    | 0.13 | 20     | 2.23 | 819    |
| 348307             | 205 238   | 425             | 1.85 | < 0.2  | < 5    | 40     | < 0.5  | < 2    | 6.58  | < 0.5  | 18     | 11     | 112    | 3.90 | < 10   | < 1    | 0.23 | < 10   | 1.59 | 1110   |
| 348308             | 205 238   | 240             | 1.25 | < 0.2  | 35     | 40     | < 0.5  | < 2    | 5.47  | < 0.5  | 22     | 24     | 50     | 3.51 | < 10   | < 1    | 0.19 | < 10   | 1.06 | 753    |
| 348309             | 205 238   | 50              | 2.30 | < 0.2  | < 5    | 30     | < 0.5  | < 2    | 5.28  | < 0.5  | 14     | 16     | 24     | 5.05 | 10     | < 1    | 0.63 | < 10   | 2.39 | 1150   |
| 348310             | 205 238   | < 5             | 1.96 | < 0.2  | 5      | 50     | < 0.5  | < 2    | 1.16  | < 0.5  | 26     | 8      | 371    | 4.61 | < 10   | < 1    | 0.27 | 10     | 1.84 | 626    |
| 348311             | 205 238   | < 5             | 0.39 | < 0.2  | 5      | < 10   | < 0.5  | < 2    | 7.29  | < 0.5  | 4      | 62     | 14     | 0.31 | < 10   | < 1    | 0.01 | < 10   | 0.10 | 295    |
| 348313             | 205 238   | < 5             | 1.66 | < 0.2  | 15     | 10     | < 0.5  | < 2    | 3.40  | < 0.5  | 9      | 33     | 18     | 3.20 | < 10   | 1      | 0.04 | < 10   | 1.15 | 958    |
| 348314             | 205 238   | 10              | 1.87 | < 0.2  | 5      | 40     | < 0.5  | < 2    | 0.82  | < 0.5  | 26     | 2      | 315    | 4.49 | < 10   | < 1    | 0.13 | 10     | 1.83 | 602    |

CERTIFICATION :

*BC*



# Chemex Labs Ltd.

Analytical Chemists • Geochemists • Registered Assayers

112 BROOKSBANK AVE., NORTH VANCOUVER,  
BRITISH COLUMBIA, CANADA V7J-1C1

PHONE (604) 984-0111

For STEPHEN J.C. EXPLORATION LIMITED

746 REGAL CRESCENT  
NORTH VANCOUVER, B.C.  
V7K 2X8

Project : COMOX-CEDAR

Comments :

Page No. -B  
Tot. Pages. 1  
Date : 17-AUG-88  
Invoice # : I-8820536  
P.O. # : NONE

## CERTIFICATE OF ANALYSIS A8820536

| SAMPLE DESCRIPTION | PREP CODE | Mb<br>ppm | Na<br>% | Ni<br>ppm | P<br>ppm | Pb<br>ppm | Sb<br>ppm | Sc<br>ppm | Sr<br>ppm | Ti<br>% | Tl<br>ppm | U<br>ppm | V<br>ppm | W<br>ppm | Zn<br>ppm |
|--------------------|-----------|-----------|---------|-----------|----------|-----------|-----------|-----------|-----------|---------|-----------|----------|----------|----------|-----------|
| 348301             | 205 238   | < 1       | 0.01    | 9         | 460      | < 2       | < 5       | 8         | 223       | 0.17    | < 10      | < 10     | 96       | 5        | 36        |
| 348302             | 205 238   | < 1       | 0.02    | 15        | 1980     | < 2       | < 5       | 11        | 185       | 0.19    | < 10      | < 10     | 178      | 10       | 79        |
| 348303             | 205 238   | < 1       | 0.01    | 12        | 2010     | < 2       | < 5       | 6         | 171       | 0.13    | < 10      | < 10     | 123      | < 5      | 62        |
| 348304             | 205 238   | < 1       | 0.02    | 10        | 1580     | 4         | < 5       | 4         | 133       | 0.16    | < 10      | < 10     | 102      | < 5      | 38        |
| 348305             | 205 238   | 2         | 0.03    | 6         | 790      | < 2       | < 5       | 8         | 88        | 0.32    | < 10      | < 10     | 135      | 5        | 41        |
| 348306             | 205 238   | < 1       | 0.04    | < 1       | 1850     | 2         | < 5       | 6         | 158       | 0.35    | < 10      | < 10     | 130      | < 5      | 64        |
| 348307             | 205 238   | < 1       | 0.01    | < 1       | 1590     | < 2       | < 5       | 2         | 204       | 0.19    | < 10      | < 10     | 59       | 10       | 39        |
| 348308             | 205 238   | < 1       | 0.02    | 1         | 1400     | < 2       | < 5       | 1         | 230       | 0.11    | < 10      | < 10     | 39       | < 5      | 25        |
| 348309             | 205 238   | < 1       | 0.02    | 7         | 1290     | 10        | < 5       | 13        | 159       | 0.12    | < 10      | < 10     | 172      | < 5      | 48        |
| 348310             | 205 238   | < 1       | 0.04    | < 1       | 1640     | < 2       | < 5       | 4         | 61        | 0.29    | < 10      | < 10     | 109      | 5        | 42        |
| 348311             | 205 238   | < 1       | 0.01    | < 1       | 370      | 2         | < 5       | < 1       | 48        | 0.03    | < 10      | < 10     | 8        | < 5      | 88        |
| 348313             | 205 238   | < 1       | 0.01    | 5         | 850      | 6         | < 5       | 3         | 56        | 0.16    | < 10      | < 10     | 70       | 10       | 31        |
| 348314             | 205 238   | < 1       | 0.02    | 1         | 1490     | 6         | < 5       | 5         | 44        | 0.23    | < 10      | < 10     | 98       | < 5      | 43        |

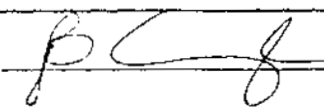
CERTIFICATION : 



# Chemex Labs Ltd.

Analytical Chemists • Geoscientists • Registered Assayers

212 BROOKSBANK AVE., NORTH VANCOUVER,  
BRITISH COLUMBIA, CANADA V7J-2C1

PHONE (604) 284-0221

To: EPIHEN, J.C. EXPLORATION LIMITED

746 REGAL CRESCENT  
NORTH VANCOUVER, B.C.  
V7K 2X8

Project: COMOX-CEDAR

Comments:

Page No. A  
Tot. Pages: 1  
Date: 17-AUG-88  
Invoice #: I-8820536  
P.O. #: NONE

## CERTIFICATE OF ANALYSIS A8820536

| SAMPLE DESCRIPTION | PREP CODE |     | Au           | Al   | Ag    | As  | Ba   | Be    | Bi  | Ca    | Cd    | Co  | Cr  | Cu  | Fe   | Ga   | Hg  | K    | La   | Mg   | Mn   |
|--------------------|-----------|-----|--------------|------|-------|-----|------|-------|-----|-------|-------|-----|-----|-----|------|------|-----|------|------|------|------|
|                    |           |     | ppb<br>FA+AA | %    | ppm   | ppm | ppm  | ppm   | ppm | ppm   | %     | ppm | ppm | ppm | ppm  | %    | ppm | ppm  | %    | ppm  | %    |
| 348301             | 205       | 238 | < 5          | 1.76 | < 0.2 | < 5 | 20   | < 0.5 | < 2 | 12.55 | < 0.5 | 14  | 39  | 80  | 3.18 | < 10 | < 1 | 0.07 | < 10 | 1.73 | 1163 |
| 348302             | 205       | 238 | < 5          | 3.83 | < 0.2 | 20  | 50   | < 0.5 | < 2 | 5.96  | < 0.5 | 28  | 18  | 61  | 6.70 | < 10 | < 1 | 0.20 | < 10 | 3.30 | 1390 |
| 348303             | 205       | 238 | < 5          | 2.81 | < 0.2 | 20  | 10   | < 0.5 | < 2 | 4.54  | < 0.5 | 29  | 13  | 129 | 5.48 | < 10 | < 1 | 0.02 | < 10 | 2.79 | 1105 |
| 348304             | 205       | 238 | 10           | 2.25 | < 0.2 | < 5 | 10   | < 0.5 | < 2 | 5.12  | < 0.5 | 27  | 18  | 142 | 3.70 | < 10 | < 1 | 0.04 | < 10 | 2.37 | 847  |
| 348305             | 205       | 238 | 20           | 2.22 | < 0.2 | 10  | 40   | < 0.5 | < 2 | 2.88  | < 0.5 | 30  | 6   | 43  | 5.54 | < 10 | < 1 | 0.16 | 10   | 2.13 | 690  |
| 348306             | 205       | 238 | 20           | 2.76 | < 0.2 | 25  | 50   | < 0.5 | < 2 | 1.74  | < 0.5 | 23  | 2   | 90  | 4.61 | < 10 | < 1 | 0.13 | 20   | 2.23 | 819  |
| 348307             | 205       | 238 | 425          | 1.85 | < 0.2 | < 5 | 40   | < 0.5 | < 2 | 6.58  | < 0.5 | 18  | 11  | 112 | 3.90 | < 10 | < 1 | 0.23 | < 10 | 1.59 | 1110 |
| 348308             | 205       | 238 | 240          | 1.25 | < 0.2 | 35  | 40   | < 0.5 | < 2 | 5.47  | < 0.5 | 22  | 24  | 50  | 3.51 | < 10 | < 1 | 0.19 | < 10 | 1.06 | 753  |
| 348309             | 205       | 238 | 50           | 2.30 | < 0.2 | < 5 | 30   | < 0.5 | < 2 | 5.28  | < 0.5 | 14  | 16  | 24  | 5.05 | 10   | < 1 | 0.63 | < 10 | 2.39 | 1150 |
| 348310             | 205       | 238 | < 5          | 1.96 | < 0.2 | 5   | 50   | < 0.5 | < 2 | 1.16  | < 0.5 | 26  | 8   | 371 | 4.61 | < 10 | < 1 | 0.27 | 10   | 1.84 | 626  |
| 348311             | 205       | 238 | < 5          | 0.39 | < 0.2 | 5   | < 10 | < 0.5 | < 2 | 7.29  | < 0.5 | 4   | 62  | 14  | 0.31 | < 10 | < 1 | 0.01 | < 10 | 0.10 | 295  |
| 348313             | 205       | 238 | < 5          | 1.66 | < 0.2 | 15  | 10   | < 0.5 | < 2 | 3.40  | < 0.5 | 9   | 33  | 18  | 3.20 | < 10 | 1   | 0.04 | < 10 | 1.15 | 958  |
| 348314             | 205       | 238 | 10           | 1.87 | < 0.2 | 5   | 40   | < 0.5 | < 2 | 0.82  | < 0.5 | 26  | 2   | 315 | 4.49 | < 10 | < 1 | 0.13 | 10   | 1.83 | 602  |

CERTIFICATION:



# Chemex Labs Ltd.

Analytical Chemists • Geochemists • Registered Assayers  
 212 BROOKSBANK AVE. NORTH VANCOUVER,  
 BRITISH COLUMBIA, CANADA V7J-2C1  
 PHONE (604) 984-0111

To: EPHEN, J.C. EXPLORATION LIMITED

746 REGAL CRESCENT  
 NORTH VANCOUVER, B.C.  
 V7K 2X8

Project: COMOX-CRDAR  
 Comments:

Page No. : B  
 Tot. Pages: 1  
 Date : 17-AUG-88  
 Invoice #: I-8820536  
 P.O. #: NONE

## CERTIFICATE OF ANALYSIS A8820536

| SAMPLE DESCRIPTION | PREP CODE | Mb<br>ppm | Na<br>% | Ni<br>ppm | P<br>ppm | Pb<br>ppm | Sb<br>ppm | Sc<br>ppm | Sr<br>ppm | Ti<br>% | Ti<br>ppm | U<br>ppm | V<br>ppm | W<br>ppm | Zn<br>ppm |
|--------------------|-----------|-----------|---------|-----------|----------|-----------|-----------|-----------|-----------|---------|-----------|----------|----------|----------|-----------|
| 348301             | 205 238   | < 1       | 0.01    | 9         | 460      | < 2       | < 5       | 8         | 223       | 0.17    | < 10      | < 10     | 96       | 5        | 36        |
| 348302             | 205 238   | < 1       | 0.02    | 15        | 1980     | < 2       | < 5       | 11        | 185       | 0.19    | < 10      | < 10     | 178      | 10       | 79        |
| 348303             | 205 238   | < 1       | 0.01    | 12        | 2010     | < 2       | < 5       | 6         | 171       | 0.13    | < 10      | < 10     | 123      | < 5      | 62        |
| 348304             | 205 238   | < 1       | 0.02    | 10        | 1580     | 4         | < 5       | 4         | 133       | 0.16    | < 10      | < 10     | 102      | < 5      | 38        |
| 348305             | 205 238   | 2         | 0.03    | 6         | 790      | < 2       | < 5       | 8         | 88        | 0.32    | < 10      | < 10     | 135      | 5        | 41        |
| 348306             | 205 238   | < 1       | 0.04    | < 1       | 1850     | 2         | < 5       | 6         | 158       | 0.35    | < 10      | < 10     | 130      | < 5      | 64        |
| 348307             | 205 238   | < 1       | 0.01    | < 1       | 1590     | < 2       | < 5       | 2         | 204       | 0.19    | < 10      | < 10     | 59       | 10       | 39        |
| 348308             | 205 238   | < 1       | 0.02    | 1         | 1400     | < 2       | < 5       | 1         | 230       | 0.11    | < 10      | < 10     | 39       | < 5      | 25        |
| 348309             | 205 238   | < 1       | 0.02    | 7         | 1290     | 10        | < 5       | 13        | 159       | 0.32    | < 10      | < 10     | 172      | < 5      | 48        |
| 348310             | 205 238   | < 1       | 0.04    | < 1       | 1640     | < 2       | < 5       | 4         | 61        | 0.29    | < 10      | < 10     | 109      | 5        | 42        |
| 348311             | 205 238   | < 1       | 0.01    | < 1       | 370      | 2         | < 5       | < 1       | 48        | 0.03    | < 10      | < 10     | 8        | < 5      | 88        |
| 348313             | 205 238   | < 1       | 0.01    | 5         | 850      | 6         | < 5       | 3         | 56        | 0.16    | < 10      | < 10     | 70       | 10       | 31        |
| 348314             | 205 238   | < 1       | 0.02    | 1         | 1490     | 6         | < 5       | 5         | 44        | 0.23    | < 10      | < 10     | 98       | < 5      | 43        |

CERTIFICATION :





LEGEND

- 4 DIORITE
- 3 NICOLA volcanics and minor sediments (TRIASSIC)
- 2 SKARN epidote-actinolite
- 1 EAGLE BAY volcanics and sediments (PERMIAN)

- outcrop outline
- geologic contact / inferred
- rock sample
- fault
- shearing
- road
- creek
- claim post
- original grid

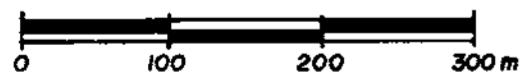

J.C. STEPHEN EXPLORATIONS LTD.

COMOX RESOURCES LTD.

CEDAR PROPERTY

KAMLOOPS M.D.  
NTS 92 P/8

GEOLOGY and ROCK SAMPLES  
MAP 1

*Oliver's*  
*Page*

SCALE 1:5000

AUGUST 1988

GEOLOGICAL BRANCH  
ASSESSMENT REPORT

17,709

\*NOTE: a second grid has been superimposed on the original grid. all the numbering is the same but the new grid is offset 40m south

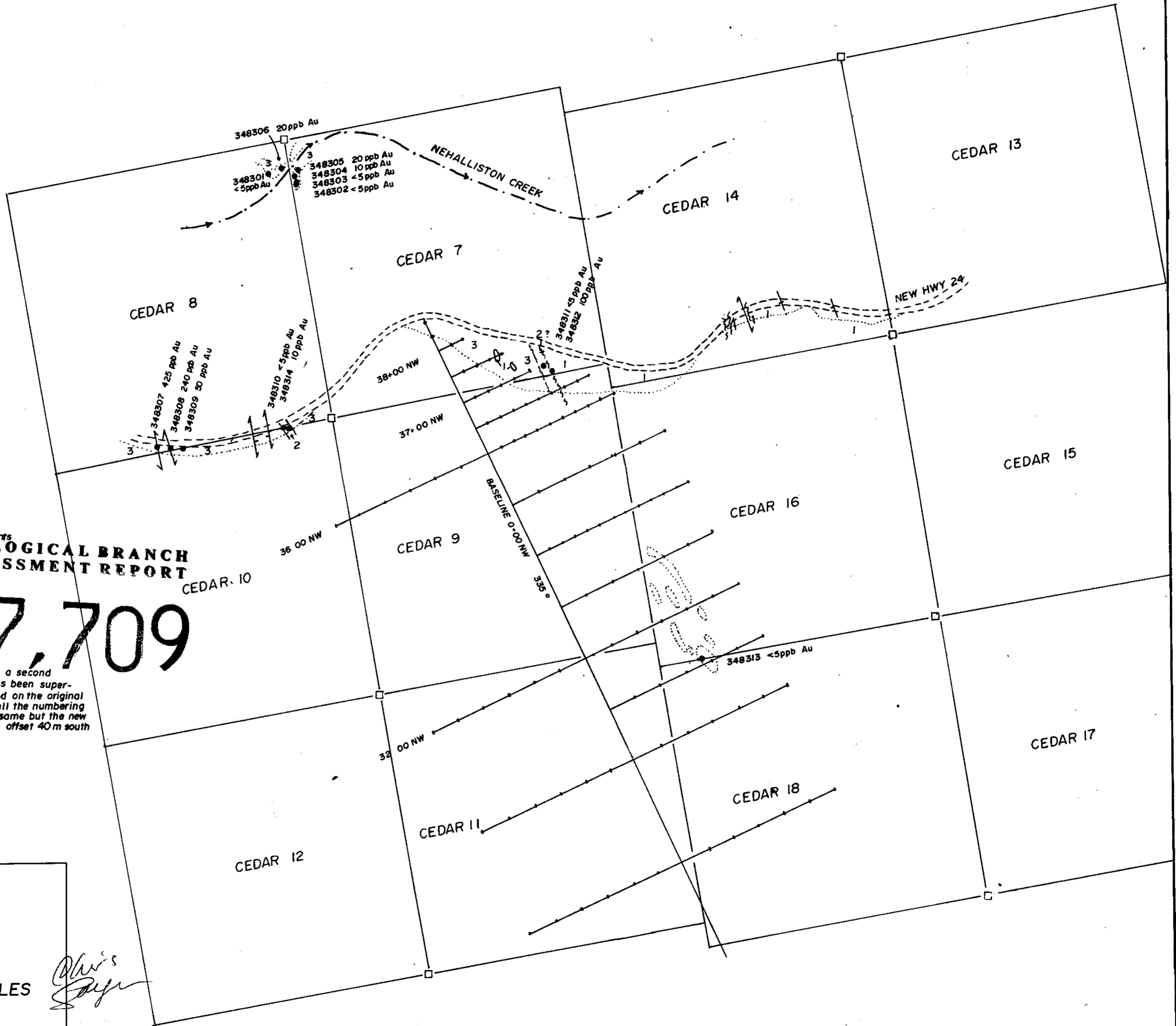

348306 20ppb Au  
348305 20 ppb Au  
348304 10 ppb Au  
348303 <5 ppb Au  
348302 <5ppb Au

348307 425 ppb Au  
348308 240 ppb Au  
348309 30 ppb Au

348310 <5ppb Au  
348314 10ppb Au

348311 <5ppb Au  
348312 100 ppb Au

348313 <5ppb Au

38+00 NW  
37+00 NW  
36 00 NW

32 00 NW

BASELINE 0-00 NW  
335°