

ARIS SUMMARY SHEET

District Geologist, Victoria

Off Confidential: 89.03.10

ASSESSMENT REPORT 17755

MINING DIVISION: Nanaimo

PROPERTY: Dave
LOCATION: LAT 50 15 00 LONG 126 01 00
UTM 09 5570467 712685
NTS 092L01E

CLAIM(S): Dave
OPERATOR(S): Welcome North Mines
AUTHOR(S): Roberts, W.J.
REPORT YEAR: 1988, 15 Pages

GEOLOGICAL SUMMARY: The claims are underlain by an east to northeast trending, south dipping sequence of Upper Triassic volcanic and sedimentary rocks of the Vancouver Group. The oldest rocks are basaltic to andesitic lavas, breccias and tuffs of the Karmutsen Formation which is overlain by massive limestone of the Quatsino Formation.

WORK DONE: Prospecting
PROS 1000.0 ha

RELATED REPORTS: 17449

PROSPECTING AND
GEOLOGICAL REPORT

ON THE
DAVE CLAIMS

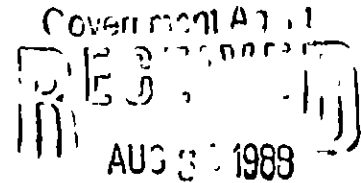

N.T.S. 9
82 L/1

NANAIMO, B.C.

NANAIMO MINING DIVISION

LOG NO: 0926	RD.
ACTION:	
FILE NO:	

LONGITUDE: 126°05'W
LATITUDE: 50°00'N

FOR



WELCOME NORTH MINES LTD.
1500 - 675 W. Hastings Street
Vancouver, B.C.

V6B 1N2

GEOLOGICAL BRANCH
ASSESSMENT REPORT

Prepared By

W.J. ROBERTS

17,755

Work done during the period
January 1 to February 29, 1988

PROSPECTING AND
GEOLOGICAL REPORT
ON THE
DAVE CLAIMS

N.T.S. 92 L/1, 8

NANAIMO MINING DIVISION

LONGITUDE: 126°05'W
LATITUDE: 50°00'N

FOR

WELCOME NORTH MINES LTD.
1500 - 675 W. Hastings Street
Vancouver, B.C.
V6B 1N2

Prepared By

W.J. ROBERTS

Work done during the period
January 1 to February 29, 1988

TABLE OF CONTENTS

	<u>Page</u>
INTRODUCTION	1
LOCATION AND ACCESS	2
CLAIMS	2
HISTORY	4
REGIONAL GEOLOGY	5
MINERALIZATION	5
PROSPECTING PROGRAM	9
CONCLUSIONS AND RECOMMENDATIONS	10
SUMMARY OF 1988 EXPENDITURES	11

FIGURES

FIGURE

1	PROPERTY LOCATION, CLAIM MAP.....	3
2	GEOLOGY MAP, DAVE CLAIMS	7
3	CROSS SECTION, LUCKY JIM SHOWING	8

APPENDIX I

LIST OF ASSAYS - DAVE PROSPECTING PROGRAM

INTRODUCTION

The Dave claims were staked to cover strike extensions of the gold bearing sulphide mineralization on the Lucky Jim claim. The Dave 1 and 2 mineral claims of 20 units each were staked on March 10, 1987 by John McClintock and later transferred to Welcome North Mines Ltd.

The geological setting of the DAVE claims is similar to that hosting gold mineralization on the adjacent Lucky Jim property. The Dave claims are largely overburden covered. Prospecting and sampling on the Dave claims did not locate any significant potential economic mineralization.

Further work is recommended.

LOCATION AND ACCESS

The claims straddle the Upper Adams River, 15 kilometres south of Kelsey Bay on Vancouver Island. Access to the claims is via a network of logging roads from Highway 19. The coordinates for the claim group are longitude 126°05'W and latitude 50°00'N on N.T.S. map 92L/1, 8.

CLAIMS

<u>Claim</u>	<u>Record No.</u>	<u>Recording Date</u>	<u>Units</u>
DAVE #1	2582	March 12, 1987	20
DAVE #2	2583	March 12, 1987	20

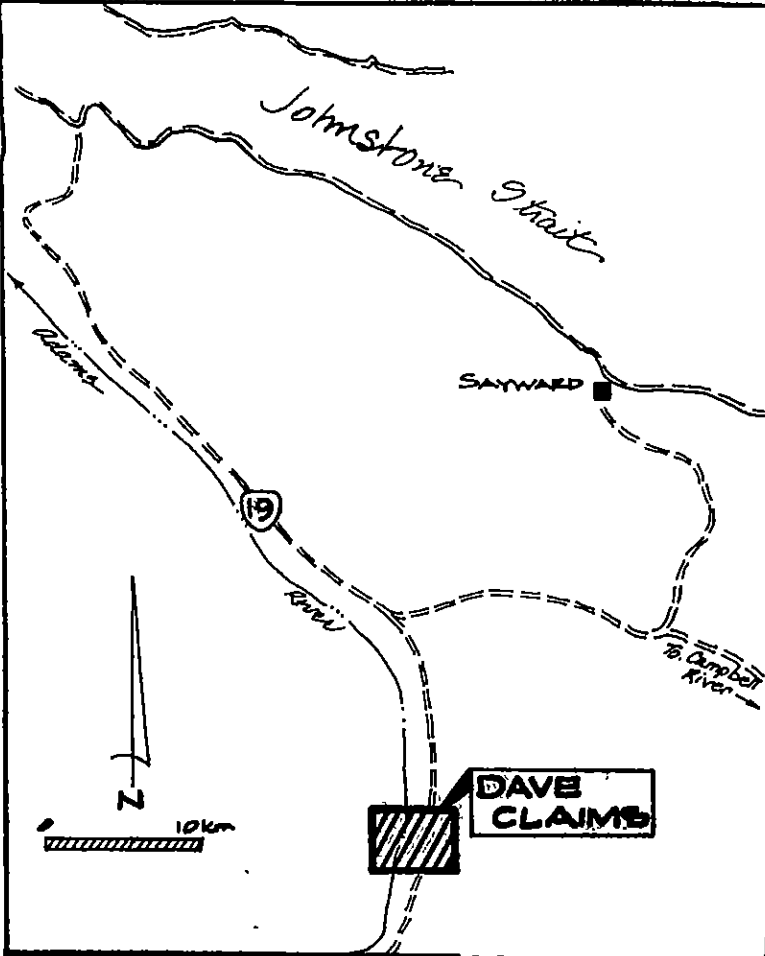
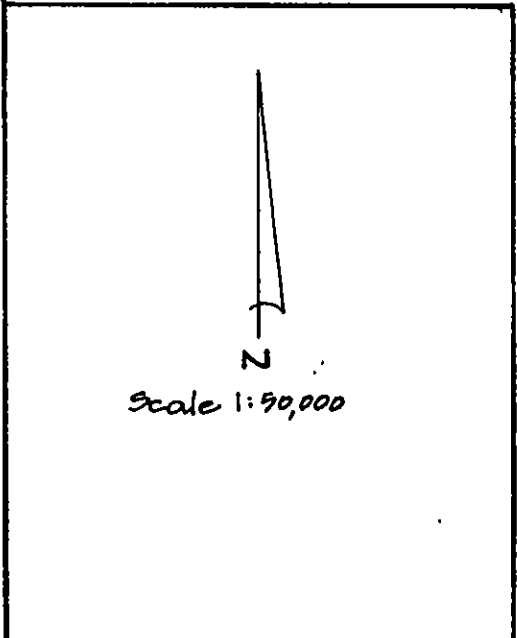

VICINITY MAP

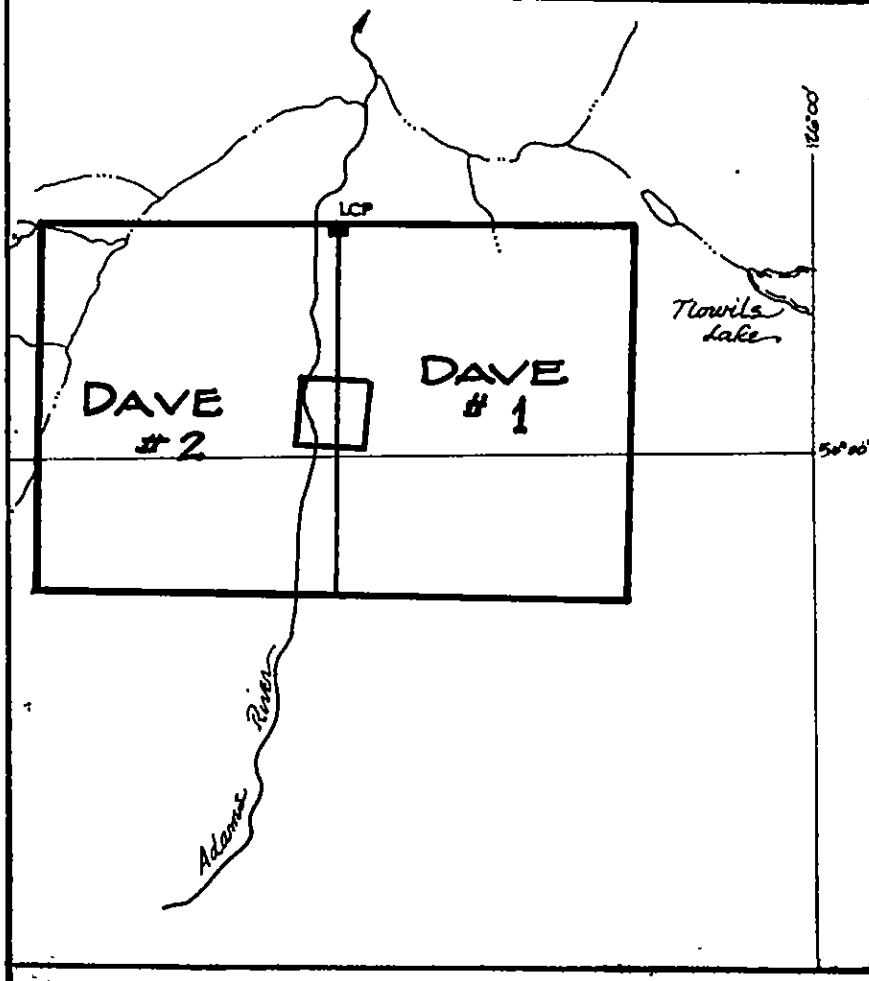

WELCOME NORTH MINES LTD.	
CLAIM MAP	
DAVE CLAIMS	
NTS: 02-L-1 02	FIGURE 1

HISTORY

Much of the previous work in the area was conducted on the adjoining Lucky Jim claim which covers the most significant showings found to date.

In 1919, surface trenching and 21 metres of drifting was conducted by Cominco. They also drilled 6 holes from 1926 to 1927. In 1966 to 1968, the property was trenched and drilled by the Adams River Syndicate. From 1979 to 1983, Five M Mining carried out soil sampling, geological mapping and diamond drilled 5 holes.

Although the showings have been drilled on several occasions, most of the holes were drilled down dip of the zone and stopped short of the zone. Holes that did penetrate the zone assayed to 0.22 oz/ton gold over 20 feet.

No records exist of prior work on the DAVE claims.

REGIONAL GEOLOGY

The claims are underlain by an easterly to northeasterly trending, southerly dipping sequence of Upper Triassic volcanic and sedimentary rocks of the Vancouver Group. The oldest rocks are basaltic to andesitic lavas, breccias and tuffs of the Karmutsen Formation. The Karmutsen Formation is overlain by massive limestone of the Quatsino Formation, which in turn is overlain by calcareous siltstone, shale, limestone and greywacke of the Parson Bay formation on the northern boundary of the claims, the Vancouver Group rocks are intruded by a quartz diorite batholith. Dykes of dacitic feldspar porphyry also cut the sedimentary and volcanic rocks.

MINERALIZATION

Gold and copper mineralization has been discovered at several sites on the adjacent LUCKY JIM claim. These showings are the Main, West Main, Dyke, North, and Lois Creek. The main showing occurs in the centre of the Lucky Jim claim on the east bank of the Adams River and has been the focus of most of the past exploration effort. Mineralization consists of a skarn-like siliceous replacement of limestone adjacent to the contact with a pyritic dacitic feldspar porphyry dyke. Mineralization consists of pyrite, pyrrhotite, chalcopyrite, lesser sphalerite and rare galena occurring in massive pods, and a stockwork-like network of fracture

fillings and disseminations. On surface, the zone has a variable width from 1 metre to 4 metres and can be traced continuously along strike for 50 metres. The zone is exposed on a cliff face over a vertical distance of 15 metres. The zone, which is replacement/skarn type mineralization localized along the contact between limestone and pyritic feldspar porphyry, strikes N10°W and dips 70 to 80° to the west.

Extensive surface sampling of the zone by numerous people, including personnel of Welcome North Mines has yielded an average grade of the exposed zone of 0.22 oz/ton Au, 2% Cu and 1.0 oz/ton Ag across an average width of 2.1 metres. The high-grade zone has been previously tested to depth with a 70 foot adit and eight drill holes. Six of the holes tested a 15 metre length of drill holes. Of these, four penetrated the zone down dip.

Previous workers have interpreted the mineralization to be stratabound to the Karmutsen limestone.

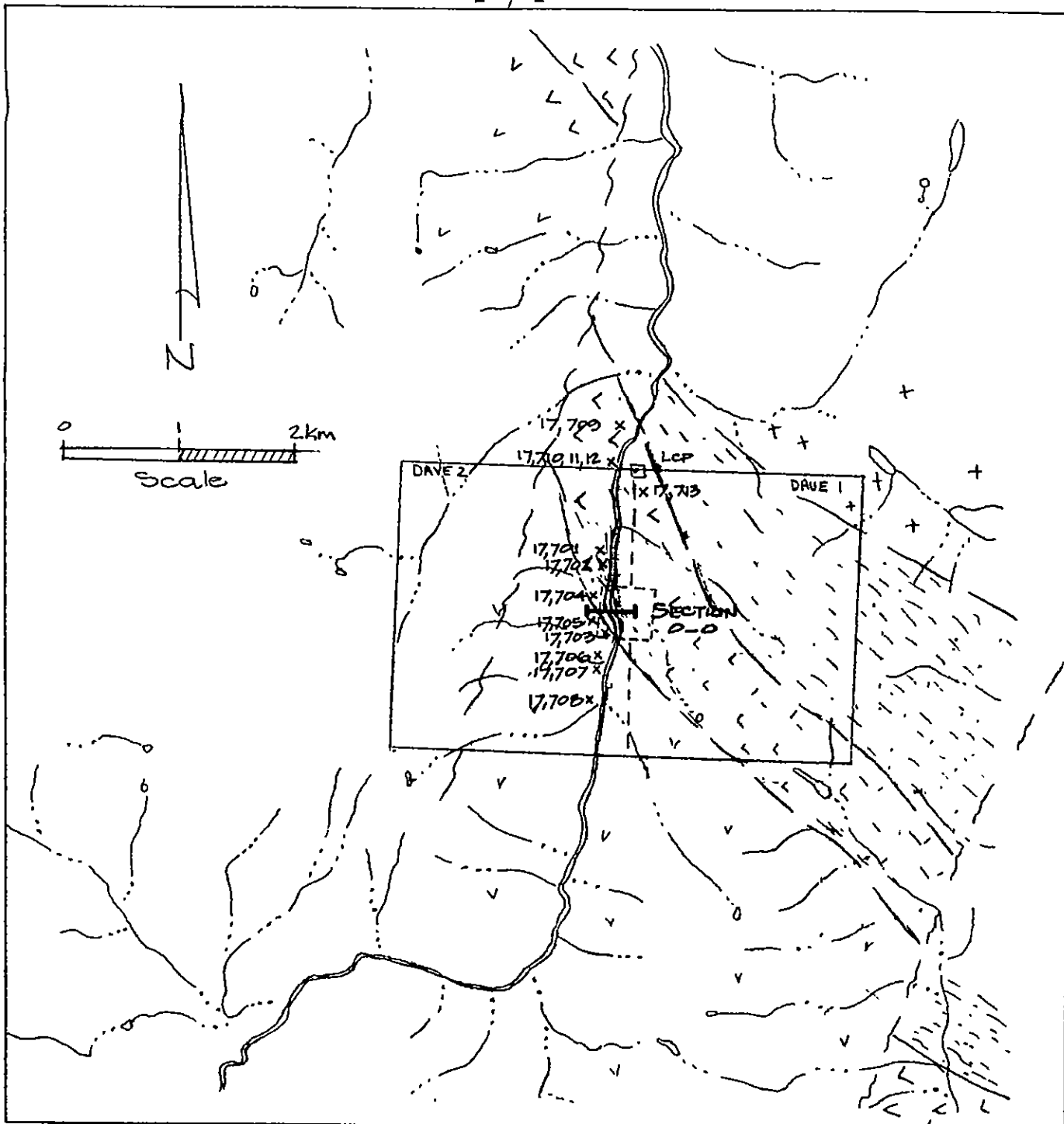

LEGEND

- Granodiorite
- Parson Bay argillites, siltstone
minor limestone
- Quatsino Limestone
- Karmutsen Volcanics, andesite - basalt
- Geological Contact
- Claim Outline
- Fault
- Strike - Dip bedding

WELCOME NORTH MINES LTD

GEOLOGY MAP

DAVE CLAIMS

NTS 8236:1

FIGURE 2

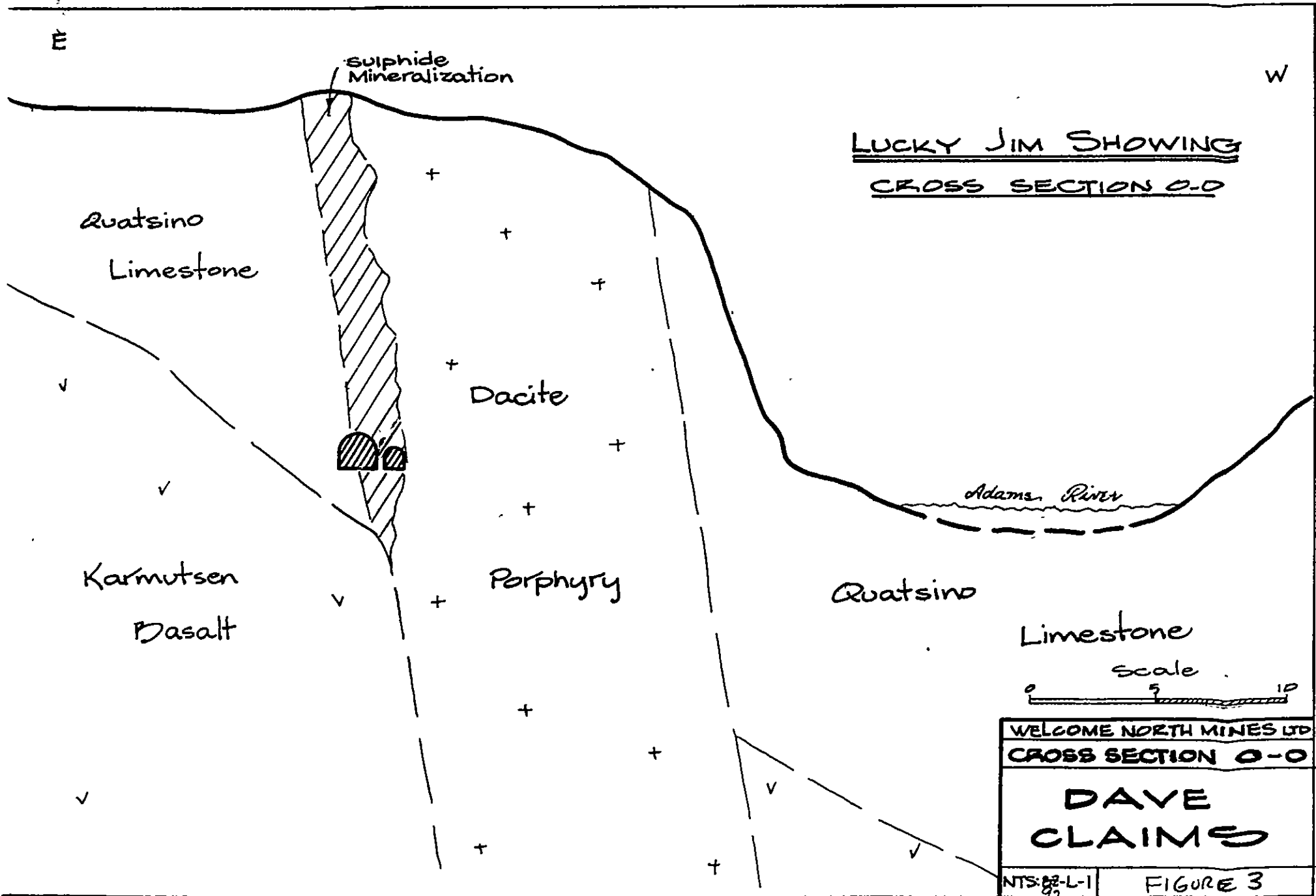

PROSPECTING PROGRAM

Prospector, Dave Heino, prospected the northwest trending belt of Quatsino limestone from the Lucky Jim on to the DAVE claims. His sample locations are shown on the geology map and resulting assays listed in Appendix I. Mineralization consisted of pyrite-chalcopyrite fracture fillings in altered limestone. No massive sulphide mineralization was discovered. All gold and silver assays are low. Several showings of fracture controlled pyrite-chalcopyrite mineralization were also discovered on the west side of the Adams River within the Karmutsen volcanics. Again, this mineralization did not have significant silver-gold assays.

CONCLUSIONS AND RECOMMENDATIONS

Sulphide mineralization located along the contact of a dacite porphyry with limestone has attractive gold and silver grades. The DAVE 1 and 2 claims cover the potential strike extension of this mineralization.

Preliminary prospecting and mapping of the DAVE 1 and 2 claims led to the discovery of sulphide mineralization with attractive copper grades, but low precious metal content.

The DAVE 1 and 2 claims hold potential for gold bearing sulphide mineralization along trend from the Lucky Jim property.

Due to extensive timber cover and poor exposure, a follow-up targeting program of grid soil sampling and VLF geophysical surveys is recommended.

Respectfully submitted,

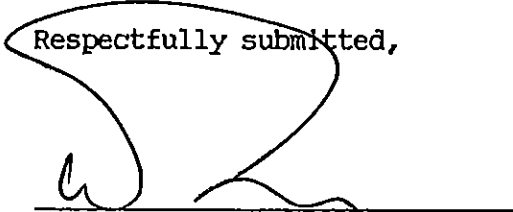

W.J. Roberts
Exploration Manager
WELCOME NORTH MINES LTD.

SUMMARY OF EXPENDITURES

PROSPECTING PROGRAM

Expenditure
\$

Assays - 13 samples @ \$19.35/sample	251.50
Camp Maintenance (actual cost)	243.30
Field Equipment - bags, flagging, etc. (actual cost)	99.79
Salaries - Prospector - 12 days @ \$168.25/day	2025.00
Transportation - Vehicle (fuel)	<u>24.00</u>
Sub Total:	2643.59

GEOLOGICAL MAPPING

Camp Maintenance (actual cost)	243.29
Consulting Geological - 1 day @ \$270/day	270.00
Maps, Prints, Drafting - 13 hrs. @ \$15/hr.	195.00
Salaries - Geologist - 2 days @ \$270/day	540.00
Transportation - Vehicle (fuel)	<u>24.00</u>
Sub Total:	<u>1272.29</u>

Total Expenditures:	<u><u>3915.88</u></u>
---------------------	-----------------------

MIN-EN LABORATORIES LTD.

Specialists in Mineral Environments

705 West 15th Street North Vancouver, B.C. Canada V7M 1T2

PHONE: (604)980-5814 OR (604)988-4524

TELEX: VIA USA 7601067 UC

Certificate of ASSAY

Company: WELCOME NORTH MINES
Project: WLN-OEX (DAVE CLAIMS)
Attention: D. HEINO

File: 8-234/P1
Date: FEB 26/88
Type: ROCK ASSAY

We hereby certify the following results for samples submitted.

Sample Number	CU %	AG G/TONNE	AG OZ/TON	AU G/TONNE	AU OZ/TON
17 701	.010	1.7	0.05	.02	0.001
17 702	.068	2.1	0.06	.21	0.006
17 703	.232	4.8	0.14	.18	0.005
17 704	.660	13.7	0.40	2.16	0.063
17 705	.542	11.5	0.34	.19	0.006
17 706	.038	2.2	0.06	.33	0.010
17 707	.204	5.9	0.17	.52	0.015
17 708	.012	1.6	0.05	.01	0.001
17 709		1.7	0.05	.06	0.002
17 710				.01	0.001
17 711				.03	0.001
17 712				.02	0.001
17 713				.01	0.001

Certified by

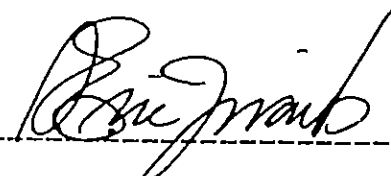
MIN-EN LABORATORIES LTD.