

ARIS SUMMARY SHEET

District Geologist, Nelson

Off Confidential: 89.06.16

ASSESSMENT REPORT 17757

MINING DIVISION: Fort Steele

PROPERTY: Cedar
 LOCATION: LAT 49 24 29 LONG 115 13 49
 UTM 11 5474105 628382
 NTS 082G06E

CLAIM(S): Cedar 3
 OPERATOR(S): Stanfield, R.H.
 AUTHOR(S): Allen, A.R.
 REPORT YEAR: 1988, 11 Pages

COMMODITIES
 SEARCHED FOR: Copper

GEOLOGICAL

SUMMARY: The major Bull River fault bisects the Cedar 1A group. It strikes northwest and dips southwest below the Rocky Mountain Trench. Proterozoic Aldridge Formation strata are exposed on the north boundary of the Cedar 5 claim and in a series of outcrops along the east boundary of the group. There are no outcrops on the remainder of the Cedar 1A group, however, 2.5 kilometres to the northwest Devonian and Mississippian limestone strata are exposed across the full width of the Rocky Mountain Trench.

WORK

DONE: Drilling, Physical
 ROAD 5.0 km
 ROTD 246.2 m 2 hole(s)

LOG NO: 0928

RD.

ACTION:

FILE NO:

CONTENTS

	<u>Page</u>
TITLE PAGE AND SUMMARY	1 & 2
A. INTRODUCTION	2
B. PROPERTY	2
C. LOCATION AND ACCESSIBILITY	2
D. PHYSIOGRAPHY	2
E. PREVIOUS WORK	3
F. GEOLOGY	3
G. THEORY	3
H. OBJECT OF THE DRILLING	4
I. CYCLONE ROTARY AIR-MUD DRILL PROGRAM	4
J. DRILLING RESULTS	4
K. DISCUSSION	4
L. SUMMARY AND CONCLUSIONS	4
M. DRILLING REPORT AND COSTS STATEMENT	5
N. ROAD WORK AND EROSION CONTROL AND COSTS STATEMENT REFERENCES	5 & 6

FILMED

CERTIFICATE

- MAPS:
1. Location
 2. Claims, Topography, Drill Holes & Roads
 3. Cedar #3 Claim & Drilling Locations

**GEOLOGICAL BRANCH
ASSESSMENT REPORT**

17,757

**REPORT ON
THE CEDAR #1a GROUP
FORT STEELE M.D.B.C.**

A. INTRODUCTION

Field work was conducted intermittently over the Cedar 1, 3 & 5 mineral claims from June 18, 1987 to June 15, 1988.

Two vertical holes were drilled near the northeast corner of the Cedar #3 claim. In addition road work and erosion control was conducted over the Cedar 1A Group. The claims area is almost completely covered with overburden, but exposure of Aldridge quartzite and argillite contain copper, silver and gold, on the Cedar #3 claim.

B. PROPERTY

The Cedar #1-A Group includes the following adjoining located mineral claims:

<u>Claim</u>	<u>Record Number</u>	<u>Area</u>	<u>Expiration Date</u>
Cedar 1	205	20 units	17-6-91
Cedar 2	206	20 units	17-6-91
Cedar 3	207	20 units	17-6-91
Cedar 4	715	20 units	17-6-91
Cedar 5	209	20 units	17-6-91

C. LOCATION AND ACCESSIBILITY

The Cedar #1A Group is located in southeastern British Columbia, in the Fort Steele Mining Division. Galloway is located at the southeast corner of the Cedar #1 claim on highway #3. Cranbrook is located 27 kilometres northwest and Fernie 25 kilometres to the east.

D. PHYSIOGRAPHY

The northeast corner of the Cedar #5 claim is located on the precipitous southwest slope of the Lizard Range, at an elevation of 1,650 metres above sea level. The remainder of the property lies within the Rocky Mountain Trench 880-920 metres above sea level.

Sand Creek flows southwesterly across the southeast area of the Cedar #1 claim, and Little Sand Creek flows southerly through the westerly area of the Cedar #4 claim. Rosen Lake is located on the Cedar #3 and #4 claims at elevation 860 metres above sea level.

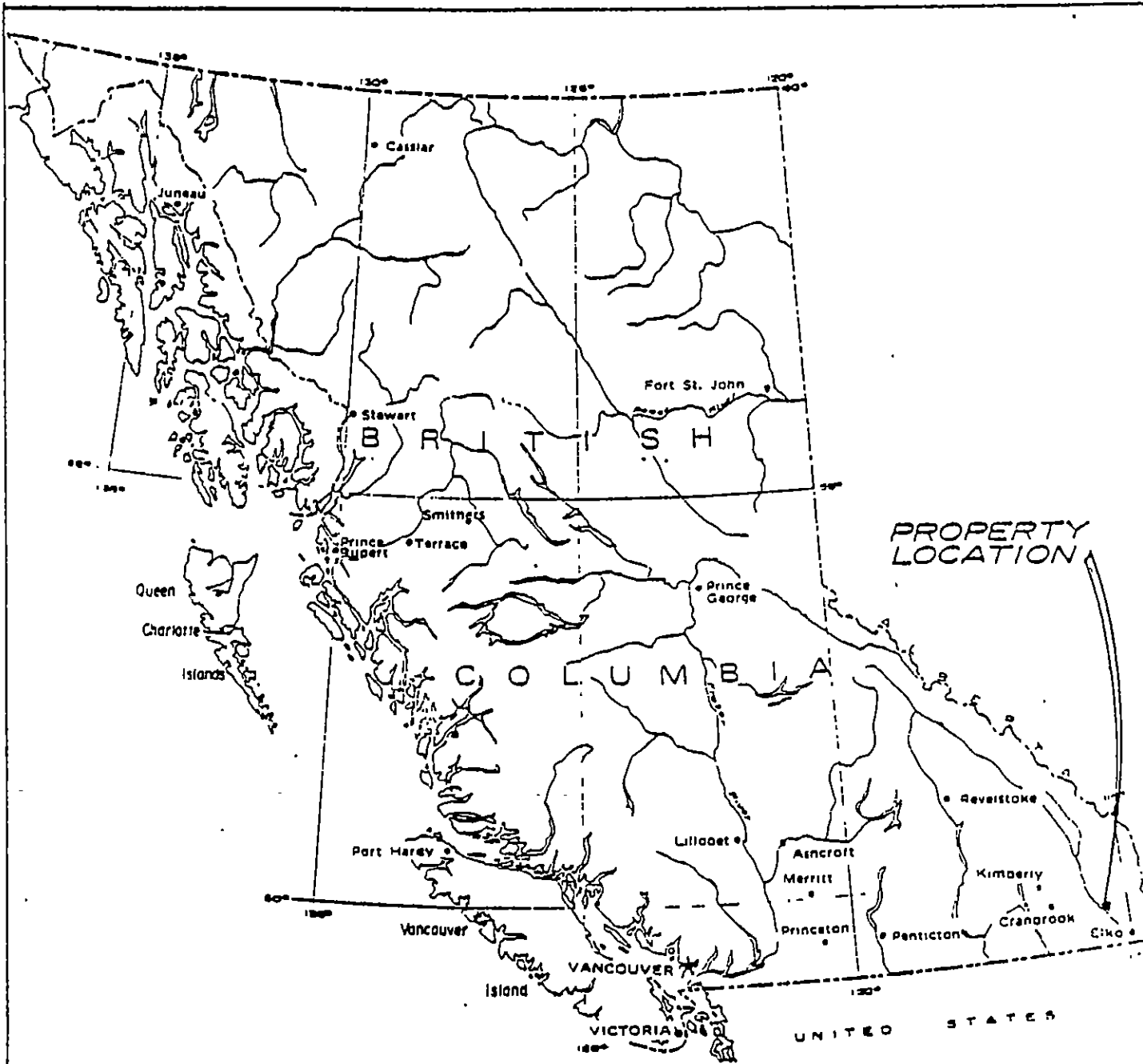

R.H. STANFIELD HOLDINGS

LOCATION MAP

SCALE: 1" = 136 Mts.

Drawn by Date 28/8/88

Checked by Jorg no. u.k.d.

ALLEN GEOLOGICAL
ENGINEERING LTD

E. PREVIOUS WORK

G.B. Leach and R.L. Langenhein Jr. of the G.S.C. Paper 58-10.

A.R. Allen, Stanfield Property Reports 1968-1986

International Geological Congress, Field Excursion Reports A15-C15, 1972

F. GEOLOGY

Outcrops of the Precambrian Aldridge formation occur on the north boundary of the Cedar #5 claim, the central east and northeast areas of the Cedar #3 claim, and just east of the southeast corner of the Cedar #1 claim. Bedded quartzite and argillaceous quartzite strike north to northwest and dip 5 degrees west to 25 degrees northeast.

A major fault, probably the southeast projection of the Bull River fault, trends southeast across the Cedar 1 and 3 claims.

The Rex mineralized vein is located in the northeast area of the Cedar #3 claim. Several trenches and a 7.6 metre shaft exposed a mineralized quartz vein 1.5 metres wide. It is composed of quartz, siderite and calcite, chalcopyrite and pyrite. Samples from 2 to 5.8% copper, 0.7 to 3.0 ounces silver and 0.01 to 0.5 ounces gold per ton. (B.C. Macdonald, P. Eng. April 1966).

The Dean showings in Aldridge argillaceous quartzite are located in the central east area of the Cedar #3 claim. One shaft and an adit tunnel were completed by early prospectors on two quartz veins.

Samples were reported to be 3.3% copper, 1.6 ounces of silver per ton and 0.25 ounces per ton.

G. THEORY

The C3-1-87 and C3-2-87 holes were drilled in the northeast area of the Cedar #3 claim, at elevation 900 metres above sea level. Outcrops to the northwest and southeast indicate that the trench at this location may be underlain by the Precambrian Aldridge formation. The precise location of the major contract fault between the Aldridge and younger Devonian and Mississippian formations has not been established because of the irregular overburden cover in the trench. Hole C 3-1-87 has established another location for the Aldridge formation near the east boundary of the trench.

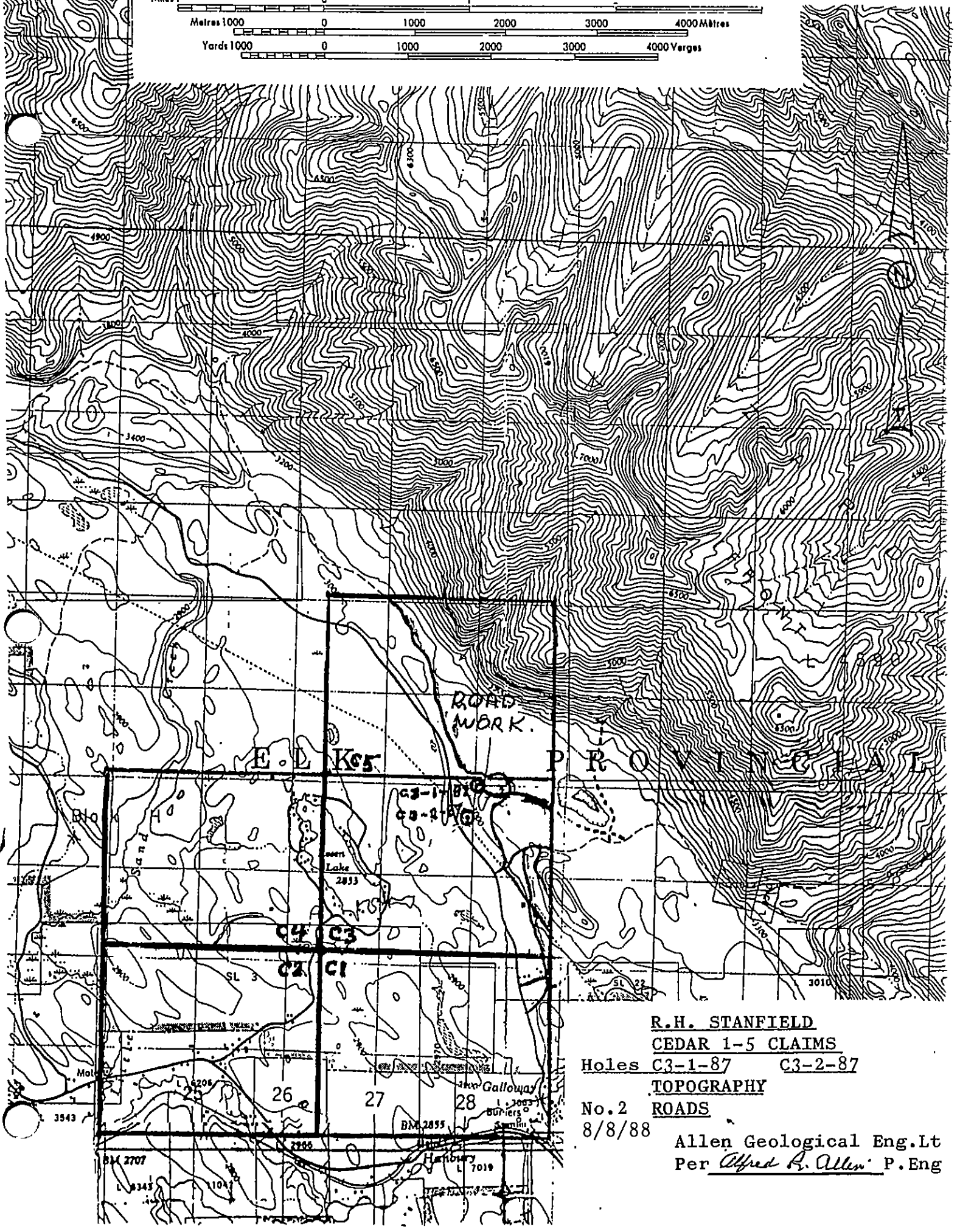
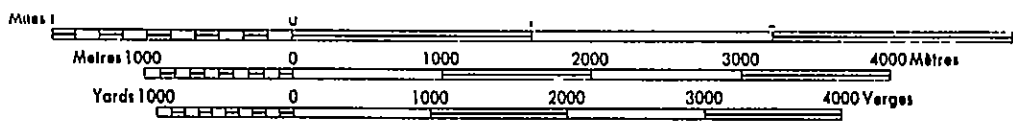

R.H. STANFIELD
CEDAR 1-5 CLAIMS
 Holes **C3-1-87** **C3-2-87**
TOPOGRAPHY
 No. 2 **ROADS**
 8/8/88
 Allen Geological Eng. Lt
 Per Alfred R. Allen P. Eng

H. OBJECT OF THE DRILLING

Mineralized quartz-sidorite veins are exposed within the Trench and on the Strathcona-Empire Crown Granted claims, to the southeast of holes C3-1-87 and C 3-2-87. The object of drilling the two holes was two-fold - first to check bedrock - and second to prospect for vein mineralization similar to the Rex, Dean and Strathcona-Empire vein systems to the southeast.

I. CYCLONE ROTARY AIR-MUD DRILL PROGRAM

Two vertical holes were located in the northeast area of the Cedar #3 claim. They are collared at the 900 metre level of the Rocky Mountain Trench. Hole C3-1-87 was drilled 122.8 metres through dark grey argillaceous quartzite of the Aldridge formation. Hole C3-2-87 was drilled 123.4 metres through overburden.

Ingersol Rand T-H-60 cyclone air-mud drilling equipment was used and cuttings were collected in plastic bags and stored in the core house at the Stanfield camp.

J. DRILLING RESULTS

Hole C3-1-87 penetrated typical Aldridge dark grey argillaceous quartzite. Minor quartz-siderite-calcite stringers were noted along with pyrite and pyrrhotite in fracture zones. Hole C3-2-87 was drilled through overburden and abandoned before reaching bedrock.

K. DISCUSSION

Drill hole C3-1-87 penetrated Aldridge argillaceous quartzite bedrock to a depth of 122.8 metres, thereby establishing another location of Precambrian strata near the east boundary of the Rocky Mountain Trench. Drill hole C3-2-87, located about 500 metres farther southwest may have penetrated all overburden, or strongly sheared and fractured ground near the major fault.

L. SUMMARY AND CONCLUSIONS

The two rotary holes, near the northeast corner of the Cedar 3 claim provided stratigraphic data from the bottom of the Rocky Mountain Trench.

It is concluded that detailed geophysical surveys may be advisable to test the possibility of a favourable mineralized zone, extending from the Strathcona-Empire showings northwesterly to the Dean and Rex deposits.

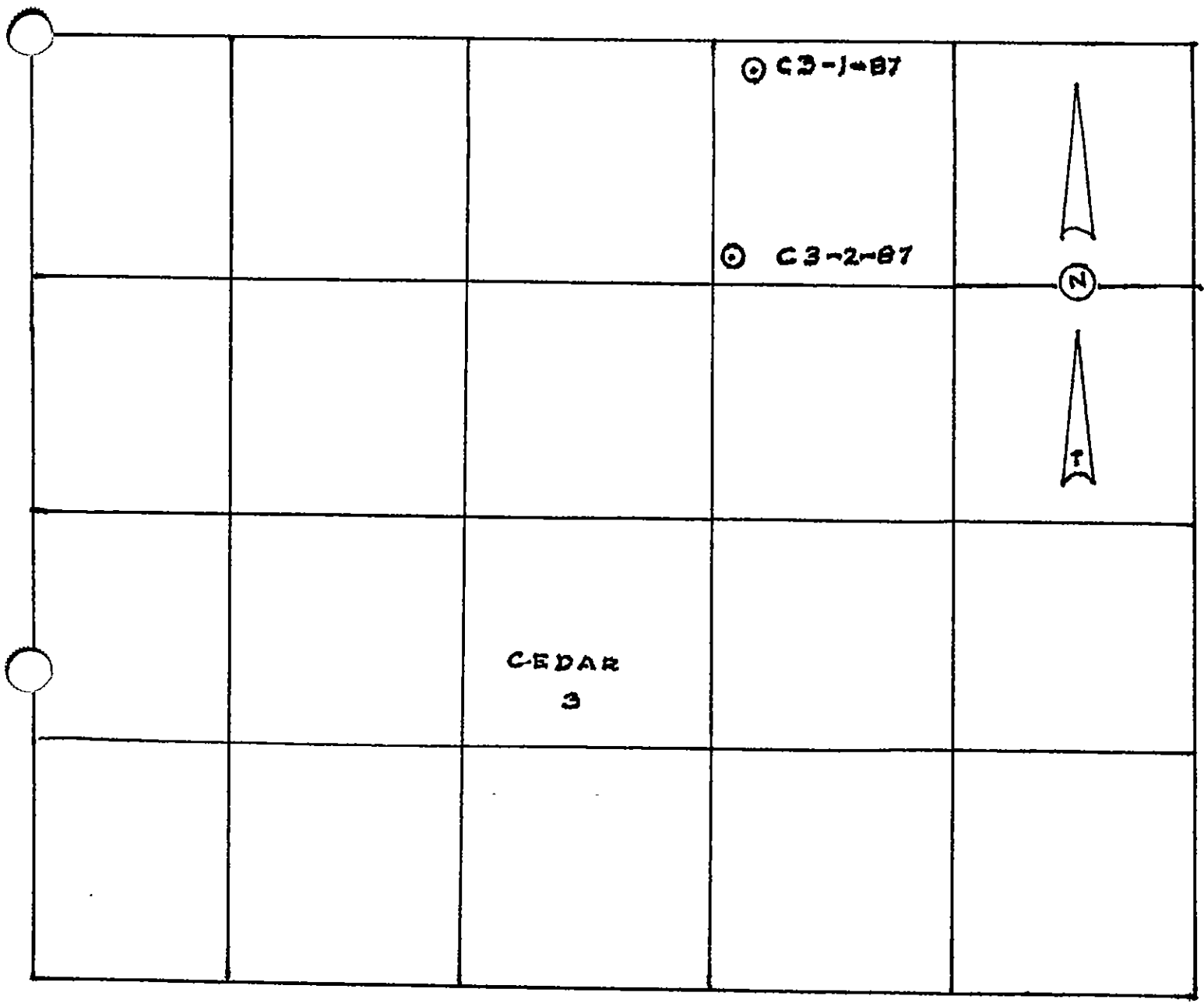

scale — m

R.H. STANFIELD
CEDAR #3 CLAIM
DRILL HOLES

No. 3
 8/8/88 C3-1-87 C3-2-87

Allen Geological Eng. :Ltd.
 Per Alfred B. Allen P.Eng.

M. FORT STEELE MINERAL CORPORATION LTD.**COSTS STATEMENTS****ROTARY DRILLING REPORTS****R.H. STANFIELD**
BY CONTRACT**ROTARY DRILLING** Cedar #3 Claim August 20 - 24, 1987

Vertical Holes: C3-1-87 122.8 metres
C3-2-87 123.4 metres

DRILL I.R.T.H.-60 Cyclone Rotary Air-Mud drill and equipment.

PERSONNEL Don Murray, driller, Strathmore, Alberta
Duane Bocek, driller, Strathmore, Alberta
Ross Stanfield Jr., Co-ordinator, Galloway, B.C.
Brent Skene, Foreman, Galloway, B.C.

Drilling Costs Statements

C3-1-87 122.8 m @ \$147/m	\$18,051.60
C3-2-87 123.4 m @ \$147/m	18,139.80
Meals & Accommodations:	
4 men @ \$65 day, 3 days	780.00
Co-Ordinator, 25 hrs. @ \$15/hr.	375.00
Foreman, 25 hrs. @ \$15/hr.	375.00
Mobilization and Demobilization	1,000.00
Clean Up	310.00
Trucks 2, 4 x 4, 3 days @ \$50/day	300.00
Total Drilling Costs	\$39,331.40
Consulting & Reports, A.R.Allen, P. Eng.	560.00
to all inclusive	\$39,891.40

N. ROADWORK AND EROSION CONTROL

Roads were repaired from the northeast area of the Cedar #1 through Cedar #3 and #5 claims, a distance of 13 km, and maintained at widths of 5 to 6 metres.

Ditches, water bars and culverts were cleared and repaired or replaced where necessary.

N. ROADWORK AND EROSION CONTROL, Cont'd...

Costs Statement

Stanfield Crew 3 men 9 days @ \$65/day	\$1,755.00
George Clayton and helper, Equipment Operator, Ross Stanfield Jr., Foreman, 68 hrs. @ \$15/hr.	1,020.00
D9 H Bulldozer with ripper, 8 hrs. @ \$182/hr.	1,456.00
740 Champion grader 36 hrs. @ \$55/hr.	1,680.00
Truck 4 x 4 3/4 ton 9 days @ \$50/day	450.00
Power Saw 9 days @ \$18/day	<u>162.00</u>
Total Costs	\$8,503.00

Submitted By:

ALLEN GEOLOGICAL ENGINEERING LTD.

Per Alfred R. Allen P. Eng.
Alfred R. Allen

August 9, 1988

REFERENCES

- Leech G.B., Paper 58-10 Maje #20 1958
- Leech G.B., International Geological Congress
24th Session Canada 1972
Field Excursions
- Allen A.R. Allemint Exploration Co. Report 1967
- Allen A.R. Stanfield Holdings Report 1973
- Allen A.R. Geology, One Potential Stanfield Holdings 1976
- Chiang G.B. Placid Oil Company Reports 1973-1976

CERTIFICATES

CONSENT

MAPS

1. Location
2. Mineral Claims, Holes C31-87, C32-87

702 - 2025 Bellevue Avenue
West Vancouver, B.C.

(604) 926-4785

V7V 1B9

CERTIFICATE

September, 1988

I am a graduate of the University of British Columbia and hold the following degrees therefrom:

BASc Geological Engineering 1939

MASc Geological Engineering 1941

I am a Life Member of the Association of Professional Engineers of the Province of British Columbia.

I have practised my profession for the past forty years.

I hold no interest in the properties or securities of R.H. Stanfield, or affiliates thereof, nor do I expect to receive any, directly or indirectly.

The report on the Cedar 1A Group, Cedar 1, 2, 3, 4 and 5 is based on an examination of the property August 4, 5, 6, 1987.

Alfred R. Allen, P.Eng.

Alfred R. Allen