

ARIS SUMMARY SHEET

District Geologist, Victoria

Off Confidential: 90.02.17

ASSESSMENT REPORT 18561

MINING DIVISION: Victoria

PROPERTY: Cassey
LOCATION: LAT 48 50 00 LONG 123 57 00
UTM 10 5409144 430281
NTS 092B13W

CAMP: 024 Sicker Belt

CLAIM(S): Cassey
OPERATOR(S): Rajala, D.F.
AUTHOR(S): Rajala, D.F.
REPORT YEAR: 1989, 12 Pages
KEYWORDS: Granodiorite

WORK

DONE: Prospecting, Geophysical, Physical
EMGR 2.0 km; MAX
Map(s) - 1; Scale(s) - 1:2500
LINE 4.8 km
MAGG 4.8 km
Map(s) - 1; Scale(s) - 1:2500

LOG NO: 0317	RD.
ACTION:	
FILE NO:	

1988 Assessment Report on the

Casey#1 Claim

FILMED

by

Douglas F. Rajala

Victoria Mining District, British Columbia
Latitude 48°51' Longitude 123°66'
NTS 92B/13W

GEOLOGICAL BRANCH
ASSESSMENT REPORT

10,561

Owner/Operator:

Douglas F. Rajala
190 Dukes Rd.,
RR#1, Fulford Harbour,
B.C. V0S 1C0

Feb/1989

CONTENTS

INTRODUCTION	1
DISCUSSION OF WORK DONE	1
CLAIM MAP.....	2
MAXMIN II SURVEY RESULTS(PLATE#1)	SEE MAP POCKET
MAGNETOMETER SURVEY RESULTS(PLATE#2).....	SEE MAP POCKET

APPENDICES

APPENDIX A DAILY OPERATIONS REPORTS

APPENDIX B ASSAY RESULTS

APPENDIX C SUMMARY OF COSTS

APPENDIX D STATEMENT OF QUALIFICATIONS

INTRODUCTION

The Casey #1 Claim consists of 20 units, 4W and 5S. The legal claim post is located 1500 meters south of the Chemainus River on the Hill 60 forestry road. The southern units of the claim border the Cowichan Lake Highway, the southwest post adjacent to the Skutz Falls turnoff (see attached map). The claims are owned and operated by Douglas Rajala of Salt Spring Island. As of February, 1989 application was made to reduce the size of the claim to 16 units by releasing the 4 southernmost units along Highway #18.

The claims are located in typical Vancouver Island second growth forest of cedar, hemlock and fir. The underbrush is largely salal, in some parts with heavy undergrowth, in other parts with larger trees and more open brush. The terrain is for the most part steep. This season the work began on the upper section which, though steep in part, was much easier to access than the southern portion will be. The southern units drop off very steeply to Highway #18 but hopefully there will good exposure along the cliff.

DISCUSSION OF WORK DONE

I went to the claims and followed the old mine road to the L126 & L130 claims to assess the outcrop on the road for potential mineralization. (These claims being no longer active but at one time producing rhodonite). There was no exposed mineralization however there was considerable outcrop which I hope to have a geologist map in the 1989 season. I took a number of samples at the base of the road where it junctions with the Hill 60 road. Five of these were sent for analysis and the results are attached.

I ran two Maxmin Survey lines at the junction of the old mine road and the Hill 60 road in order to make a quick assessment and to determine if a 50m cable length or a 100m cable length would prove more useful. The lines showed nothing of interest (see attached plots). I decided to have a geophysicist come to the property and recommend a grid and survey.

It was decided to continue work on the Casey claims by cutting lines in order to run a Magnetometer Survey. This survey would delineate areas to concentrate further effort.

Lines were cut to begin an assesment of the north sector of the claim. The lines are plotted on the accompanying map. Two east west lines and one north south line are not sufficient for assessment but they do show some interesting features (see attached plots). From these lines further infill lines are planned for 1989 to resolve the change from magnetically variable terrain in the north to a magnetically flat area in the south. It is hoped to also continue into the very steep terrain toward Highway #18.

A number of outcrops were noted on the north line (L0000). They were all granodiorite associated with the major intrusive to the north. I expect that the contact between the intrusive and the Paleozoic Sicker rocks will be in the north sector of the claim and that the magnetometer survey will help to pinpoint it. This seems evident from the definite change in character of the magnetic readings on the south line (L08005).

CHEMAINUS RIVER

MAGNETOMETER L00+00
L2000.00 W
L800.00 S.

MAX MIN L1
L2

① MAPPED OUTCROPS.
9 GRANADIORITE: GRAY,
MASSIVE CRYSTALLINE
EQUANT, 40% QUARTZ
40% FELDSPAR,
15% BIOTITE
5% HORNBIENDE.

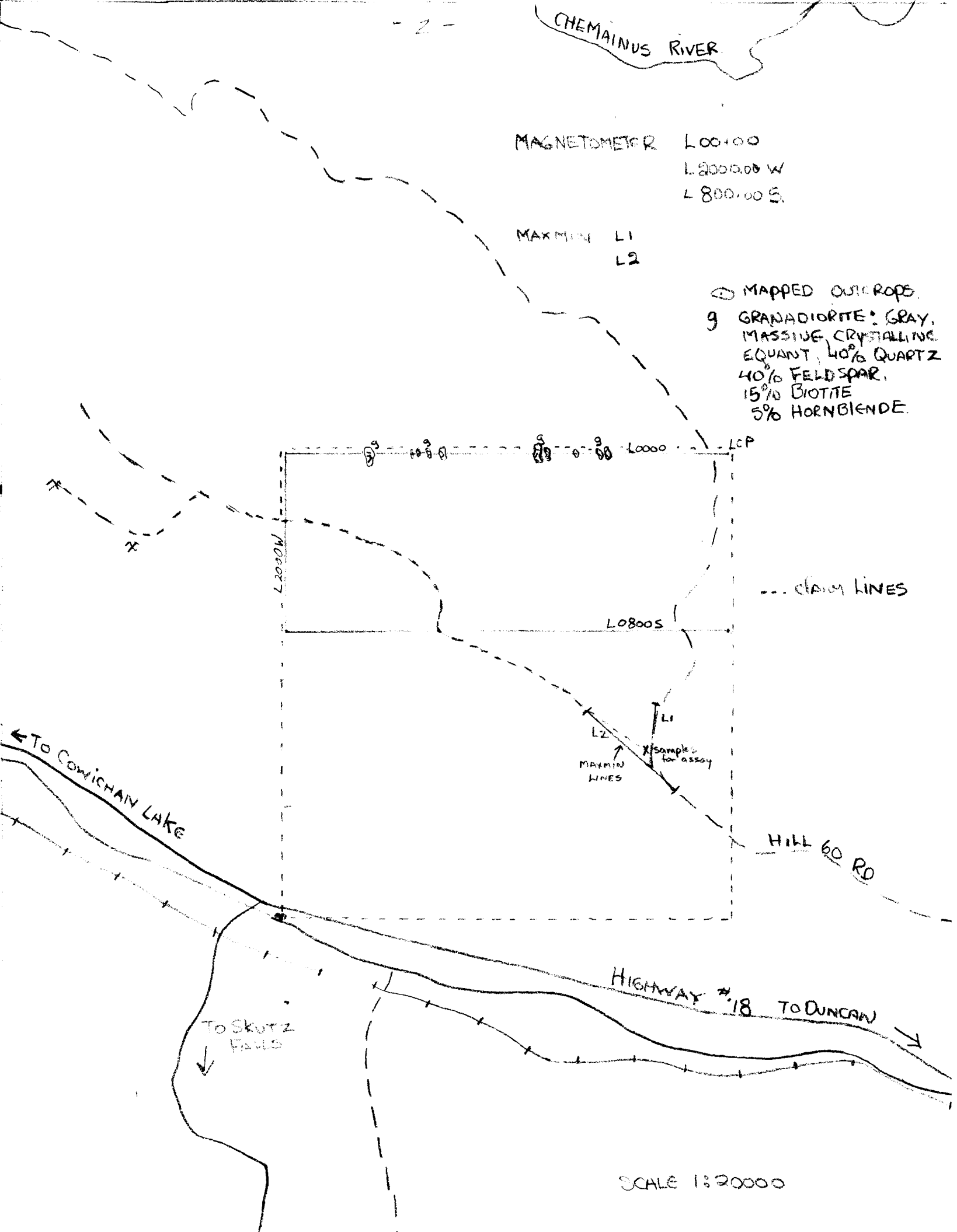

APPENDICES

APPENDIX A

Daily Operations Report

Feb. 24/88 - Day 1

- took float samples from junction of the Hill 60 forestry road and the mine road to L12 & L13 claims
- ran Maxmin II survey on roads at junction to determine suitability of cable length and potential of survey - total 2 km

Expenses

Two men @ \$100/day	200.00
Travelling gas	14.50
ferries	12.00
meals	40.00
Equipment Rental 1 day @ \$90/day	90.00
Total	356.50

March 21/88 - Day 2

- went to claims with Geophysicist to determine best survey and position of grid

Expenses

One man @ \$100/day	100.00
Oneman @ \$250/day	250.00
Travelling gas	14.50
ferries	12.00
meals	40.00
Total	416.50

April 14/88 - Day 3

- chained and flagged line L0000 and L2000W to south L0800S - total 2.8 km

Expenses

Two men @ \$100/day	200.00
Travelling gas	14.50
ferries	12.00
meals	40.00
Total	266.50

April 15/88 - Day 4

- chained and flagged L0800S - total 1.9 km

Expenses

Two men @ \$100/day	200.00
Travelling gas	14.50
ferries	12.00
meals	40.00
Total	266.50

August 25/88 - Day 5

- ran Magnetometer survey on lines L0000 and L2000W - total 2.8 km
- prospected up L0000

Expenses

Two men @\$100/day	200.00
Travelling gas	14.50
ferries	12.00
meals	40.00
Equipment Rental @40/day	40.00
Total	306.50

September 30/88 - Day 6

-ran magnetometer survey on L0800S - 1.9 km

Expenses

One man @\$100/day	100.00
Travelling gas	14.50
ferries	10.00
meals	20.00
Equipment Rental @40/day	40.00
Total	184.50

Feb 14/89 - Day 7

- prepare report, draft lines and maps

Expenses

One man @\$100/day	100.00
Total	100.00

APPENDIX B

MIN-EN LABORATORIES LTD.

Specialists in Mineral Environments

705 West 15th Street North Vancouver, B.C. Canada V7M 1T2

PHONE: (604) 980-5814 DF (604) 988-4524

TELEX: VIA USA 7601067 UC

Certificate of ASSAY

Company: D. RAJALA
Project:
Attention: D. RAJALA

File: B-283/P1
Date: MAR 9/88
Type: ROCK ASSAY

We hereby certify the following results for samples submitted.

Sample Number	AU G/TONNE	AU OZ/TON	AG G/TONNE	AG OZ/TON	NI %	CU %	PE %
05001	.18	0.005	2.1	0.06	.010	.119	.01
01002	.03	0.001	1.8	0.05	.004	.003	.01
01003	.10	0.003	3.0	0.09	.003	.084	.02
01004	.04	0.001	2.1	0.06	.010	.058	.01
01005	.01	0.001	1.8	0.05	.006	.019	.02

Certified by:

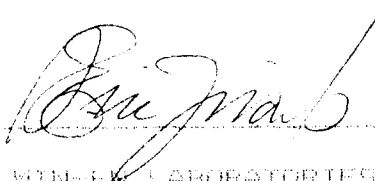

MIN-EN LABORATORIES LTD.

MIN-EN LABORATORIES LTD.

Specialists in Mineral Environments

705 West 15th Street North Vancouver, B.C. Canada V7M 1T2

PHONE: (604) 980-5814 OR (604) 998-4524

TELEX: VIA USA 7601067 UC

Certificate of Assay

Company: D. RAJALA
Project:
Attention: D. RAJALA

File: 8-283/P2
Date: MAR 9/88
Type: ROCK ASSAY

We hereby certify the following results for samples submitted.

Sample Number	ZN %	MM %	AS %
05001	.01	.12	.01
01002	.01	.89	.02
01003	.01	.42	.01
01004	.01	.72	.01
01005	.01	10.80	.01

Certified by

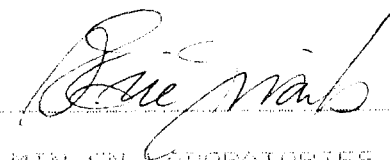

MIN-EN LABORATORIES LTD.

APPENDIX C

SUMMARY OF COSTS

I Wages

February/88 to September/88

D. Rajala	6 days @ \$100/d	\$600.
P. Wheadon	4 days @ \$100/d	\$400.
V. Toews	1 day @ \$100/d	\$100.
A. Wynne	1 day @ \$250/d	\$250.
		<hr/>
TOTAL		\$1350.

II Transportation

Gas	6 days @ \$14.50	\$87.
Ferries	5 days @ \$12.00	\$60.
	1 days @ \$10.00	\$10.
		<hr/>
TOTAL		\$157.

III Food

5 days @ \$40/d	\$200.
1 days @ \$20/d	\$20.
	<hr/>
	\$220.

IV Equipment Rentals

Magnetometer	2 days @ \$40/d	\$80.
MaxMin	1 day @ \$90/d	\$90.
		<hr/>
		\$170.

V Sample Analysis

Min-En Laboratories Ltd.	5 samples @ \$60.50/s	\$302.
for Au, Ag, Cu, Pb, Zn, Ni, Mn, As		

VI Report Preparation

D. Rajala	1 day @ \$100/d	\$100.
		<hr/>
TOTAL		\$2199.

APPENDIX D

STATEMENT OF QUALIFICATIONS

I, Douglas Rajala, have worked in the mining industry for 16 years. In the past 5 years I have been managing the operation of and operating electromagnetic and magnetic surveys for MWH Geophysics of Sidney, B.C.

Date:

FEB 14 1999

Signature:

Douglas Rajala

13,561

MAXMIN II SURVEY CASEY I. SCALE 1:2500

0 25 50

L2E 1777HZ



100M SEPERATION

L2E 444 HZ



100 M SEPERATION

L2E 1777HZ



50M SEPERATION

L2E 444HZ



50M SEPERATION

L1E 1777 HZ



100M SEPERATION

L1E 444 HZ



100M SEPERATION

L1E 1777HZ



50M SEPERATION

L1E 444HZ



+10%

- 0

-10%

50M SEPERATION

0100

1100

2100

3100

4100

5100

