

**LEGEND**

- Multiphase Intrusive:**
- 3 coarse hornblende diorite with minor gabbroic felsic and fine grained intrusive phases.
- Thuya Batholith:**
- 2 hornblende-biotite quartz diorite and granodiorite, minor hornblende diorite.
- Nicola Formation**
- 1C Mixed Volcanics and Sediments: Well bedded to poorly bedded, lapilli tufts, crystal lithic tufts and crystal tufts with bedded argillite and minor sandstone and siltstone.
  - 1B Limestone: Pale green semi-massive, cherty, and recrystallized in some areas.
  - 1A Bedded argillite with minor bedded crystal and lapilli tufts

- Dike
- Vein
- Jointing
- Bedding

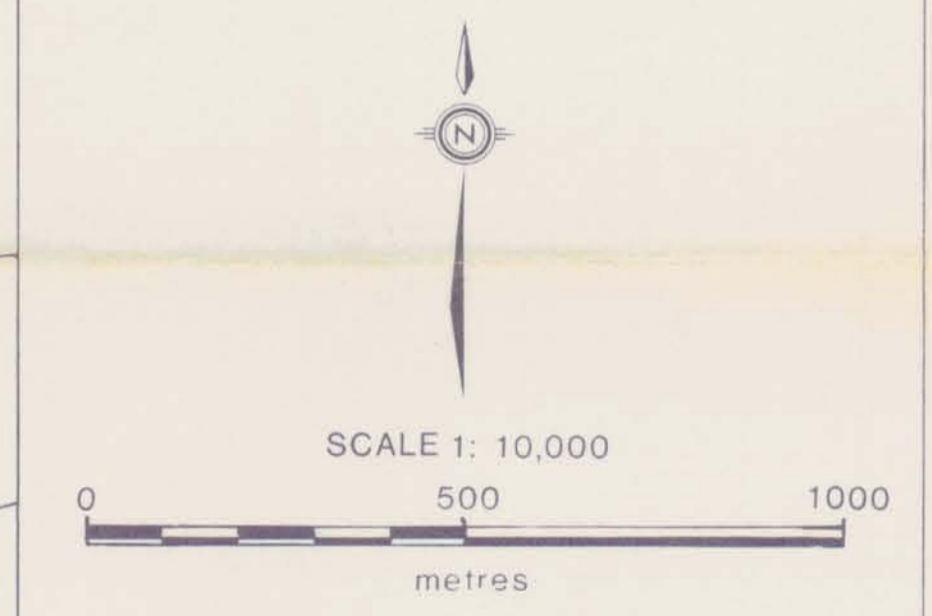

REVISIONS

By	Date	Appov. By

**ESSO MINERALS CANADA**  
G CLAIMS  
**GEOLOGY MAP**

To accompany a report by K. Dom

Project No: 132/135	Report No: M32.C.902
Mining Div: Kamloops	NTS 92P/8,9
Survey By: K.D.	Drafted By: K.D.
Date: JUNE 1988	Map No: 1

GEOLOGICAL BRANCH  
ASSESSMENT REPORT  
**18,597**  
 Part 2 of 2

LEGEND

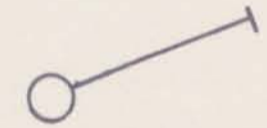

Proposed Drill Hole

RESULTS

Au, Ag, Pb, Zn, Cu, As /metre  
All values in ppm except Au, in ppb.

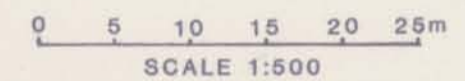

ESSO MINERALS CANADA

G CLAIMS

CHIP SAMPLING  
DISCOVERY SHOWING

To accompany a report by: K. DOM

Project No: #132	Report No: MA32.C.902
Mining Div: KAMLOOPS	NTS: 92 P/8
Survey By: K.D.	Drafted By: W.F.
Date: DEC./1988	Map No: 3

GEOLOGICAL BRANCH  
ASSESSMENT REPORT  
**18,597**  
Part 2 of 2

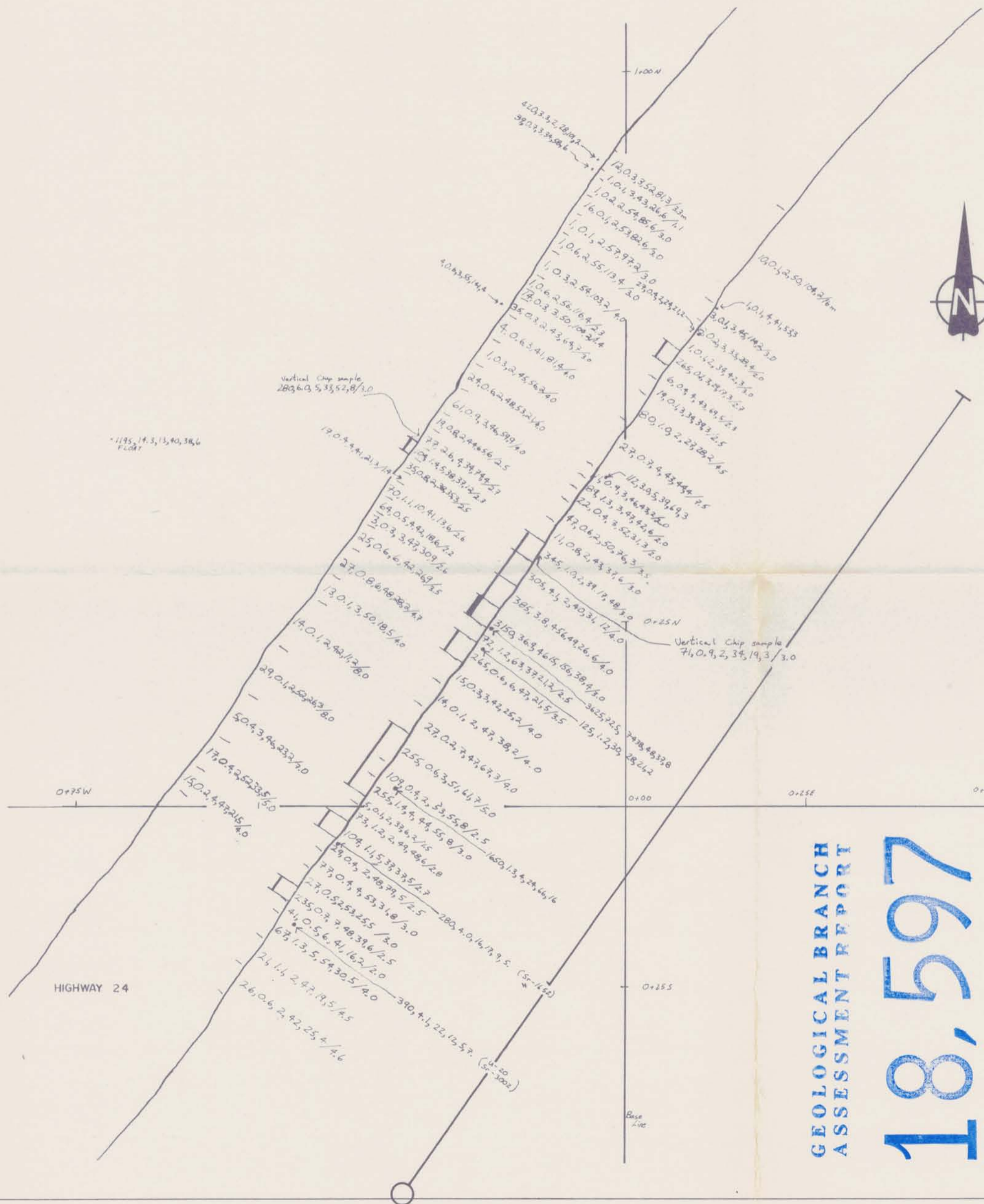

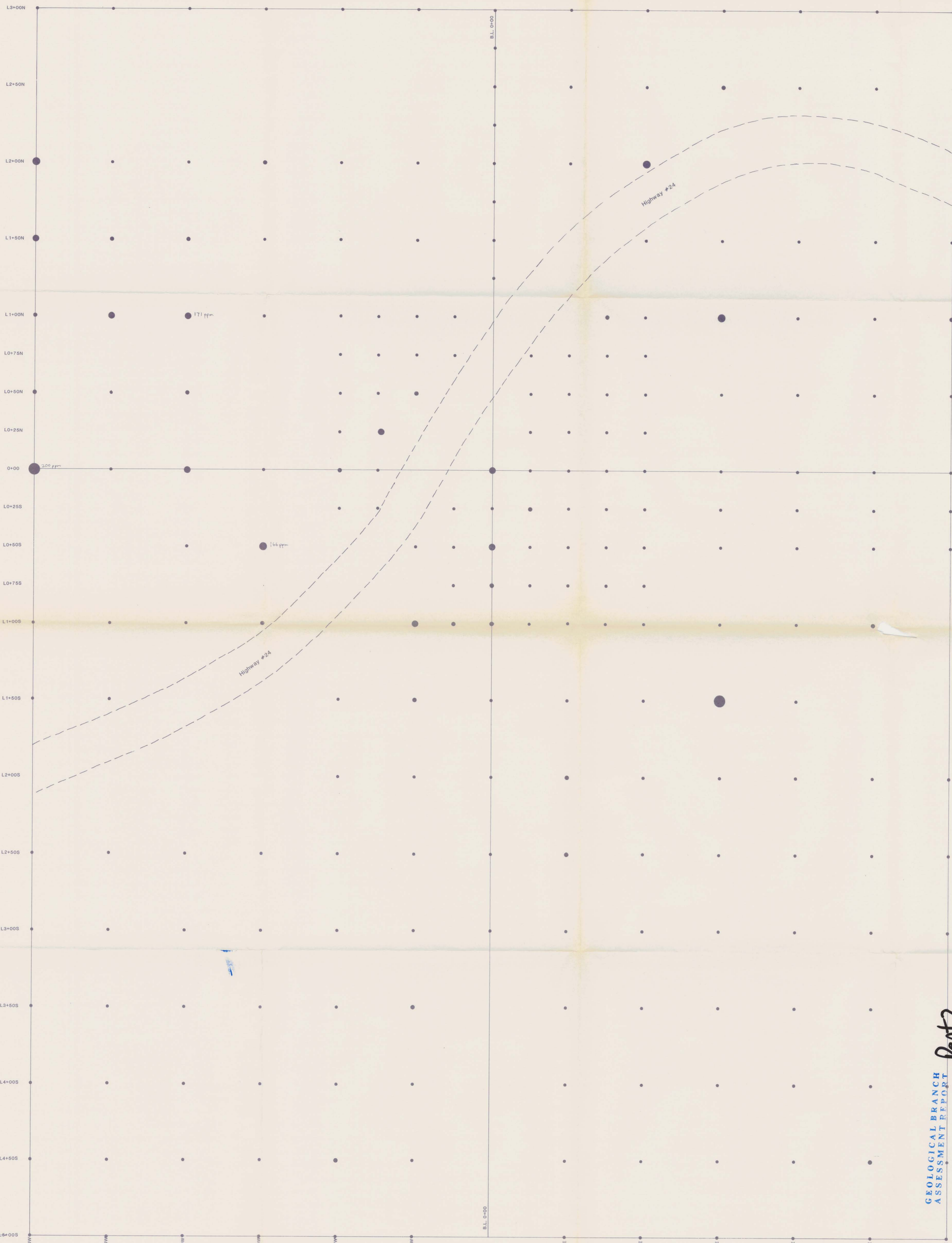

- < 100 ppm Zn
- > 100 ppm Zn
- > 125 ppm Zn
- > 150 ppm Zn
- > 175 ppm Zn

0 10 20 30 50m  
SCALE 1:1000

By	Date	Approv. By

**ESSO MINERALS CANADA**  
**G CLAIM**  
**DISCOVERY SHOWING SOIL GRID**  
**GEOCHEMICAL RESULTS**

Zn ppm

GEOLOGICAL BRANCH  
 ASSESSMENT REPORT  
 Part 2 of 2  
 18,597

To accompany a report by

Project No: #312	Report No: MA32.C.902
Mining Div: KAMLOOPS	NTS: 92 P/8
Survey By: K.D.	Drafted By: W.F.
Date: DEC/1988	Map No: 6

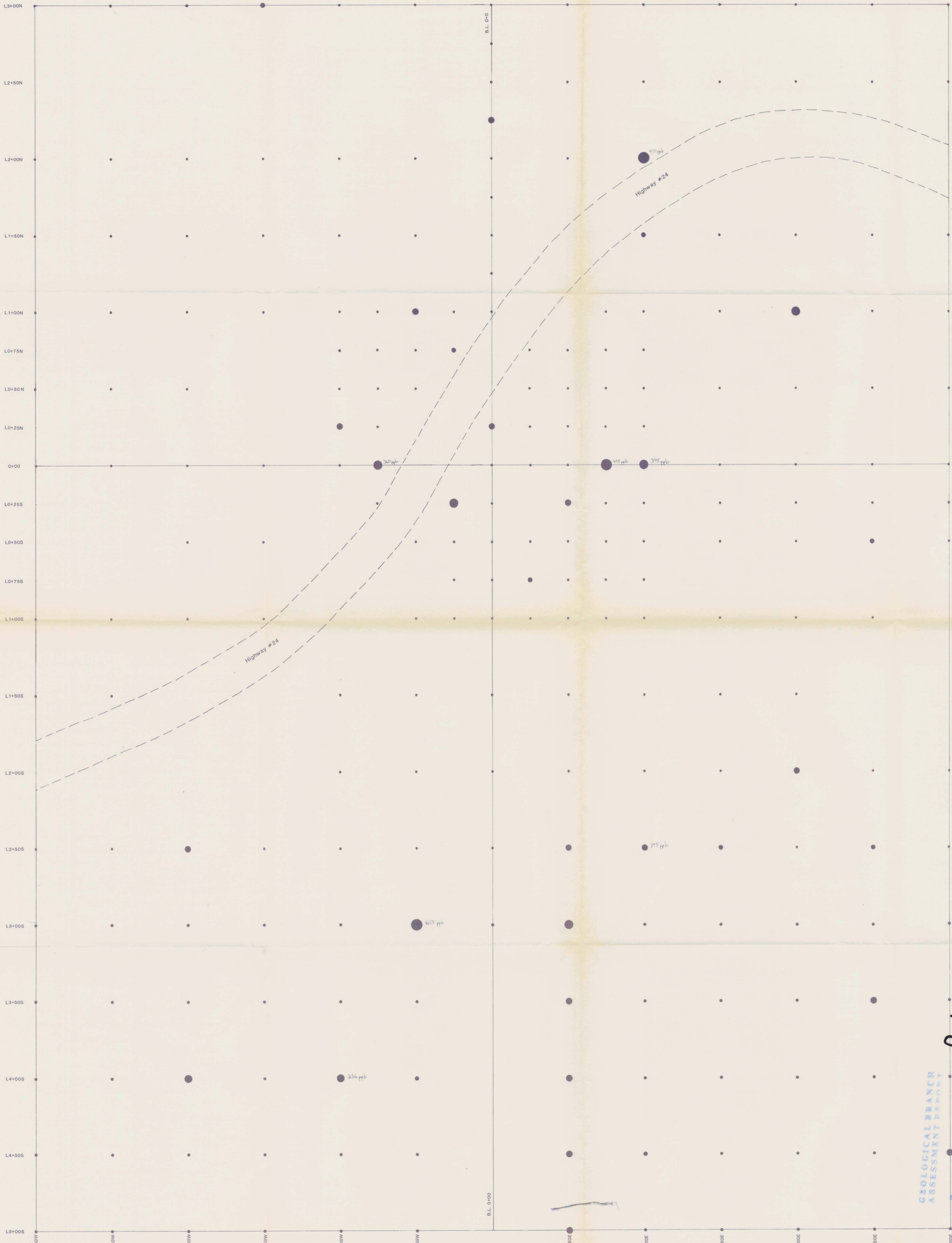

- < 80 ppb Au
- > 80 ppb Au
- > 120 ppb Au
- > 250 ppb Au
- > 400 ppb Au

0 10 20 30 50m  
SCALE 1:1000

By	Date	Approv. By

**ESSO MINERALS CANADA**  
**G CLAIM**  
**DISCOVERY SHOWING SOIL GRID**  
**GEOCHEMICAL RESULTS**  
**Au ppb**

To accompany a report by	
Project No: #312	Report No: MA32.C.902
Mining Div: KAMLOOPS	NTS: 92 P/8
Survey By: K.D.	Drafted By: W.F.
Date: DEC./1988	Map No: 4

GEOLOGICAL BRANCH  
 ASSESSMENT REPORT  
 18,597  
 Part 2  
 of 2

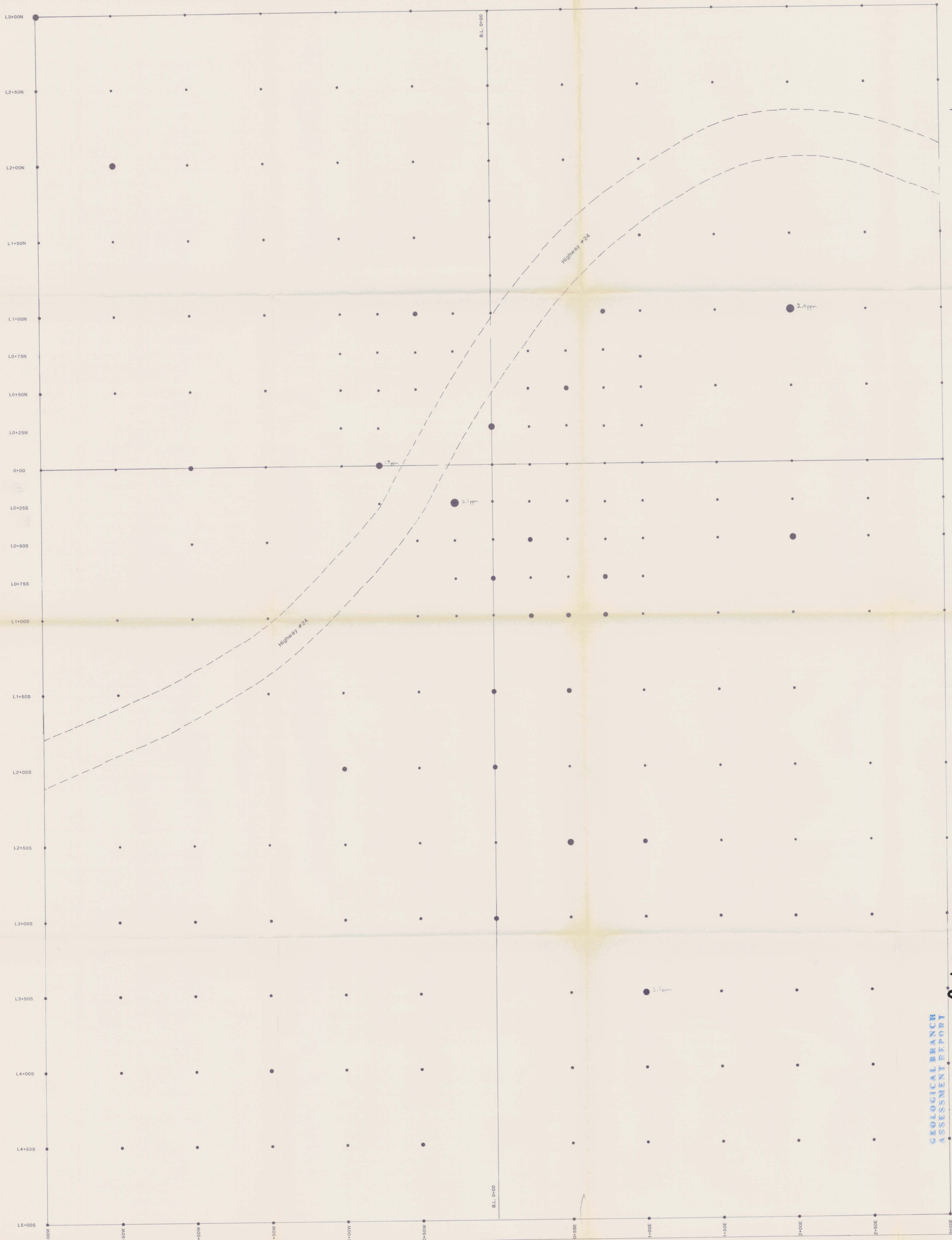

- < 1.0 ppm Ag
- > 1.0 ppm Ag
- > 1.5 ppm Ag
- > 2.0 ppm Ag

0 10 20 30 50m  
SCALE 1:1000

By	Date	Approv. By

ESSO MINERALS CANADA

G CLAIM  
DISCOVERY SHOWING SOIL GRID  
GEOCHEMICAL RESULTS  
Ag ppm

To accompany a report by	
Project No: #312	Report No: MA32.C.902
Mining Div: KAMLOOPS	NTS: 92 P/8
Survey By: K.D.	Drafted By: w.f.
Date: DEC./1988	Map No: 5

GEOLOGICAL BRANCH  
ASSESSMENT REPORT  
**18,597**  
Part 2  
of 2

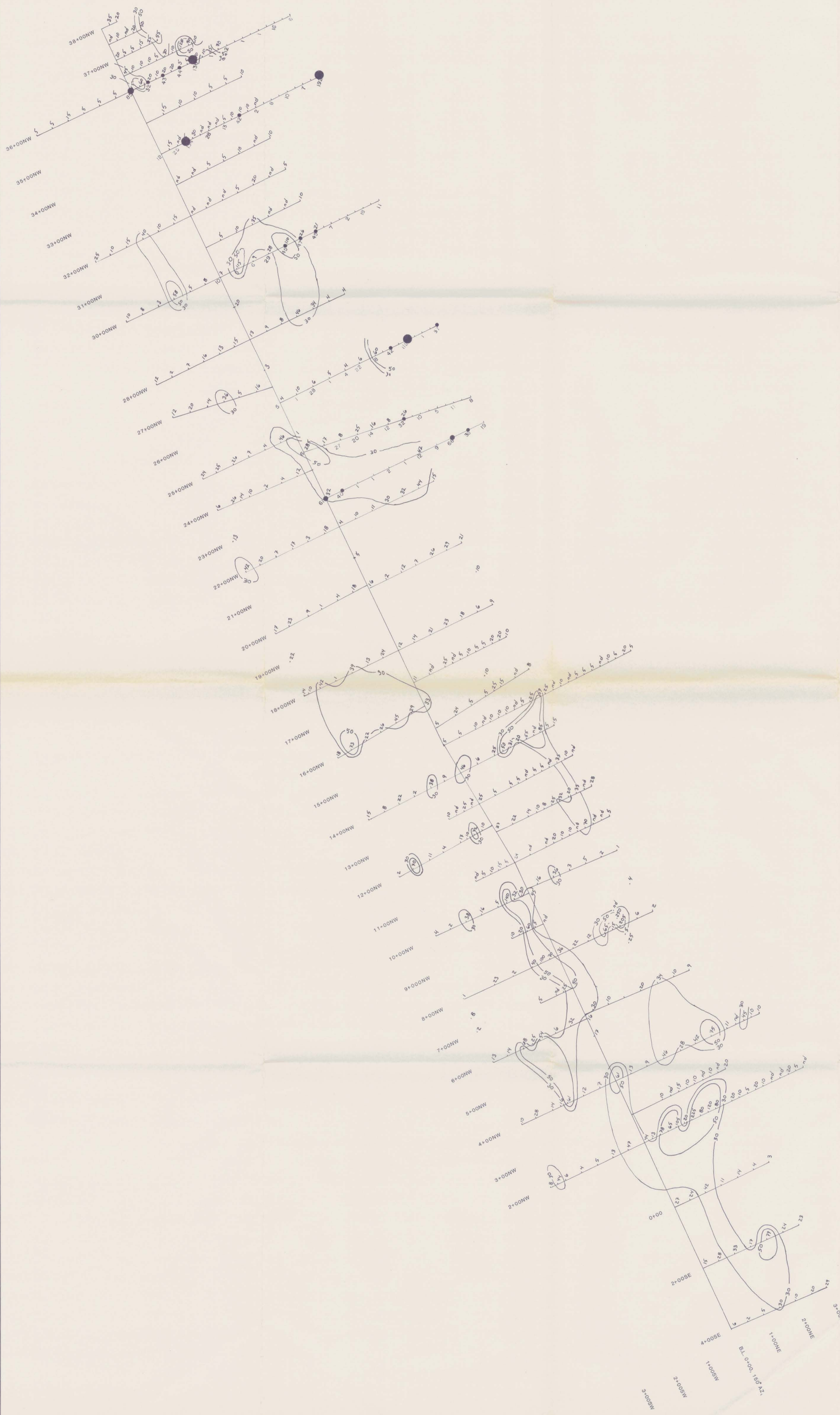

- > 30 ppb
- > 50 ppb
- > 75 ppb
- > 100 ppb

CRAVEN (1985)  
ESSO (1988)

VALUES QUOTED IN ppb.

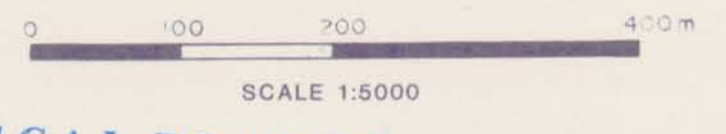

SCALE 1:5000

GEOLOGICAL BRANCH  
ASSESSMENT REVISIONS

18,597 Part 2 of 2

ESSO MINERALS CANADA	
G CLAIMS SOIL GEOCHEMISTRY Au	
EXTENSION OF CRAVEN RESOURCES GRID	
To accompany a report by	
Project No: #132	Report No: MA32.C.902
Mining Div: KAMLOOPS	NTS: 92 P/B
Survey By: K.D.	Drafted By: w.f.
Date: DEC/1988	Map No: 7

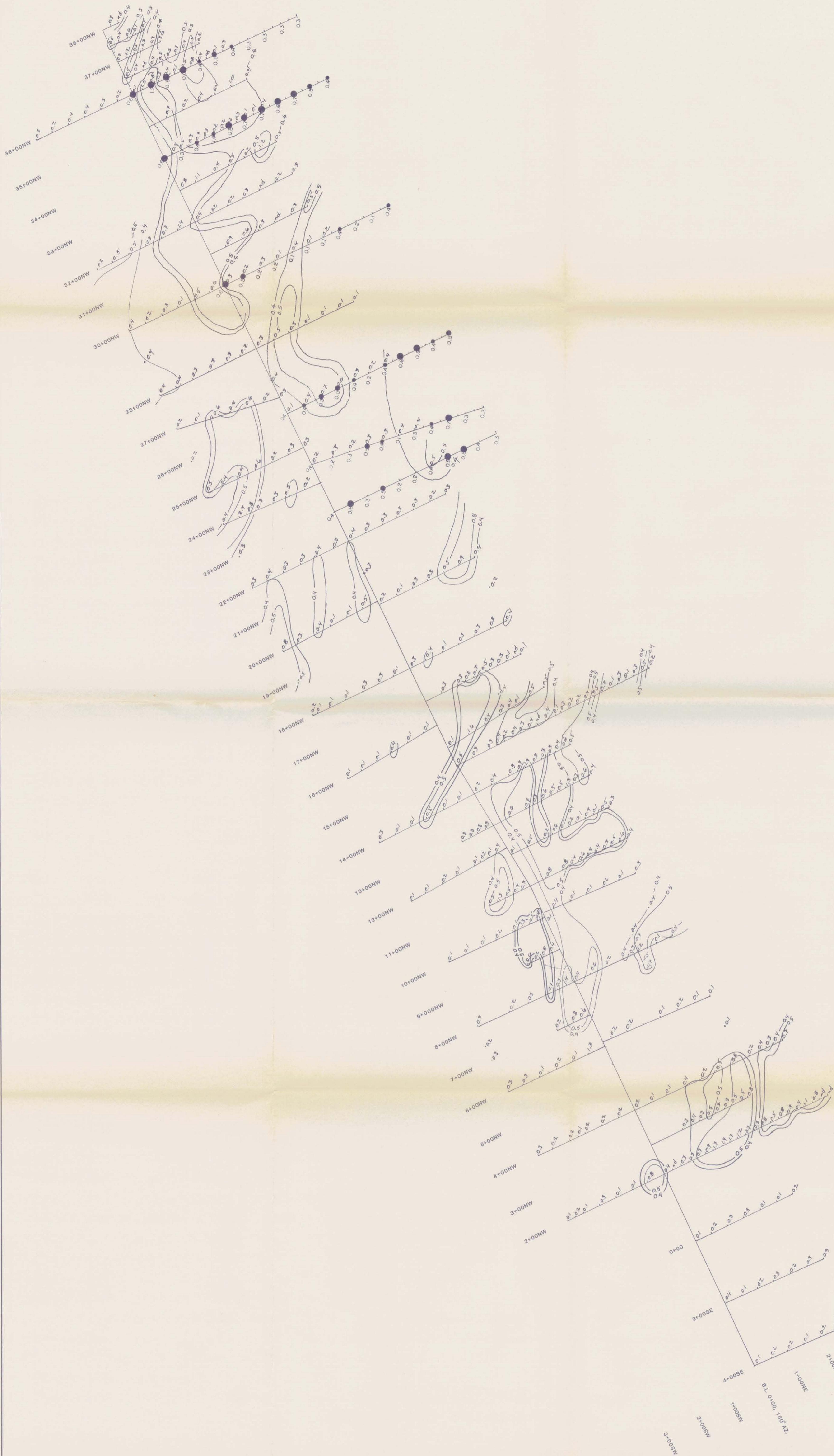

- 0.4 ppm
- 0.5 ppm
- > 0.5 ppm

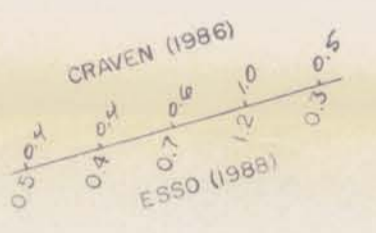

VALUES QUOTED IN ppm.

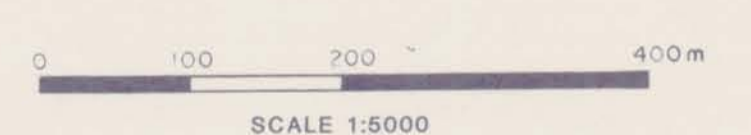

SCALE 1:5000

GEOLOGICAL BRANCH  
ASSESSMENT REVISIONS

18,597 Part 2 of 2

ESSO MINERALS CANADA

G CLAIMS  
SOIL GEOCHEMISTRY  
Ag  
EXTENSION  
OF  
CRAVEN RESOURCES GRID

To accompany a report by

Project No: #132	Report No: MA32.C.902
Mining Div: KAMLOOPS	NTS: 92 P/8
Survey By: K.D.	Drafted By: W.F.
Date: DEC.1988	Map No: 8

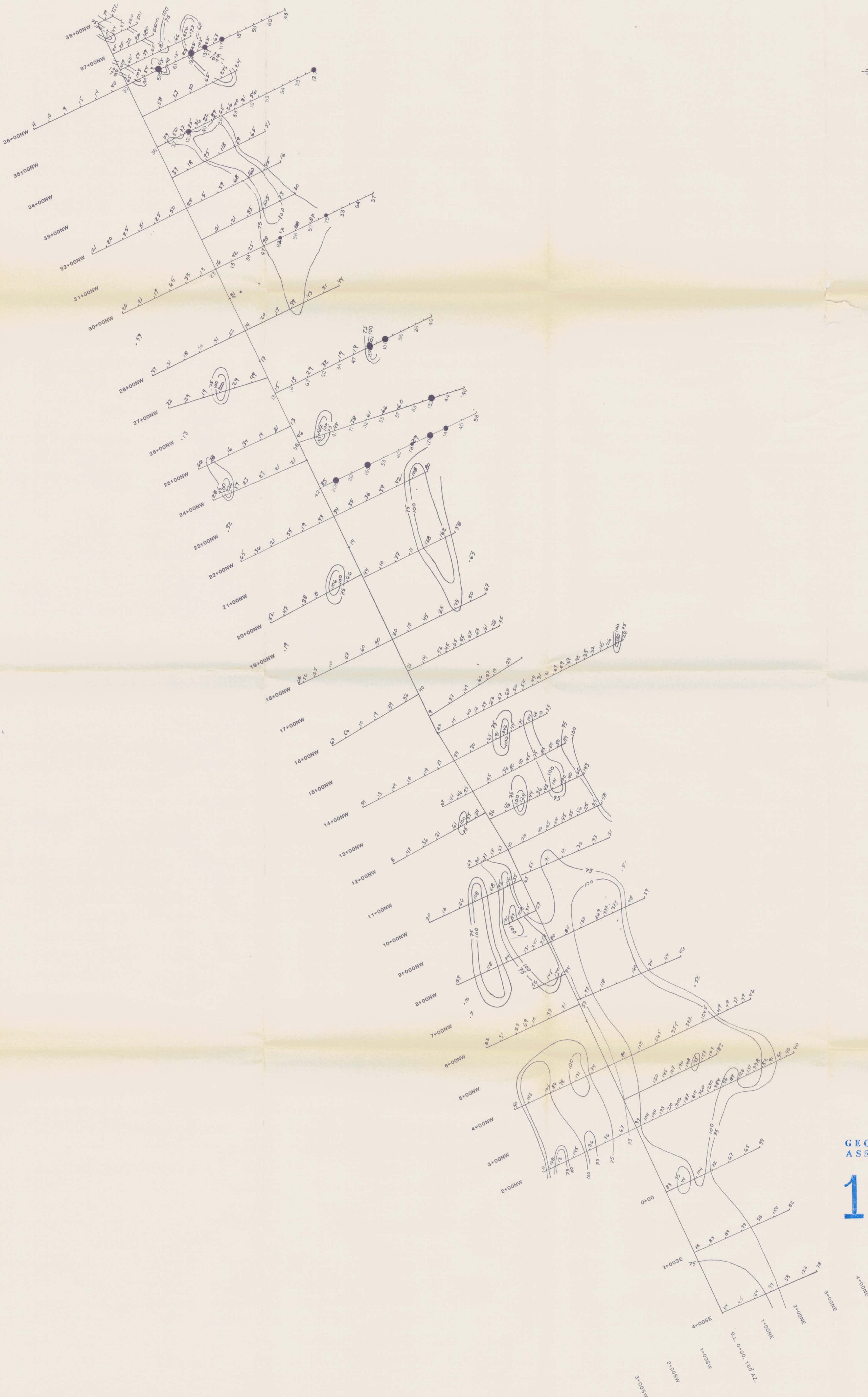

- > 75 ppm
- > 100 ppm
- > 150 ppm

CRAVEN (198E)  
76 70 65 60 55 50 45 40 35 30 25 20 15 10 5 0  
ESSO (198B)  
89 75 60 45 30 15 0

VALUES QUOTED IN ppm.

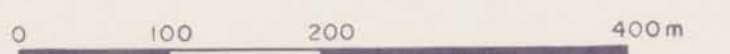

SCALE 1:5000  
**GEOLOGICAL BRANCH**  
**ASSESSMENT REPORT**  
REVISIONS

By	Date	Apprv. By
18,597		

*Part 2 of 2*

**ESSO MINERALS CANADA**

G CLAIMS  
SOIL GEOCHEMISTRY  
Cu  
EXTENSION  
OF  
CRAVEN RESOURCES GRID

To accompany a report by

Project No: #132	Report No: MA32.C.902
Mining Div: KAMLOOPS	NTS: 92 P/8
Survey By: K.D.	Drafted By: W.F.
Date: DEC./1988	Map No: 9



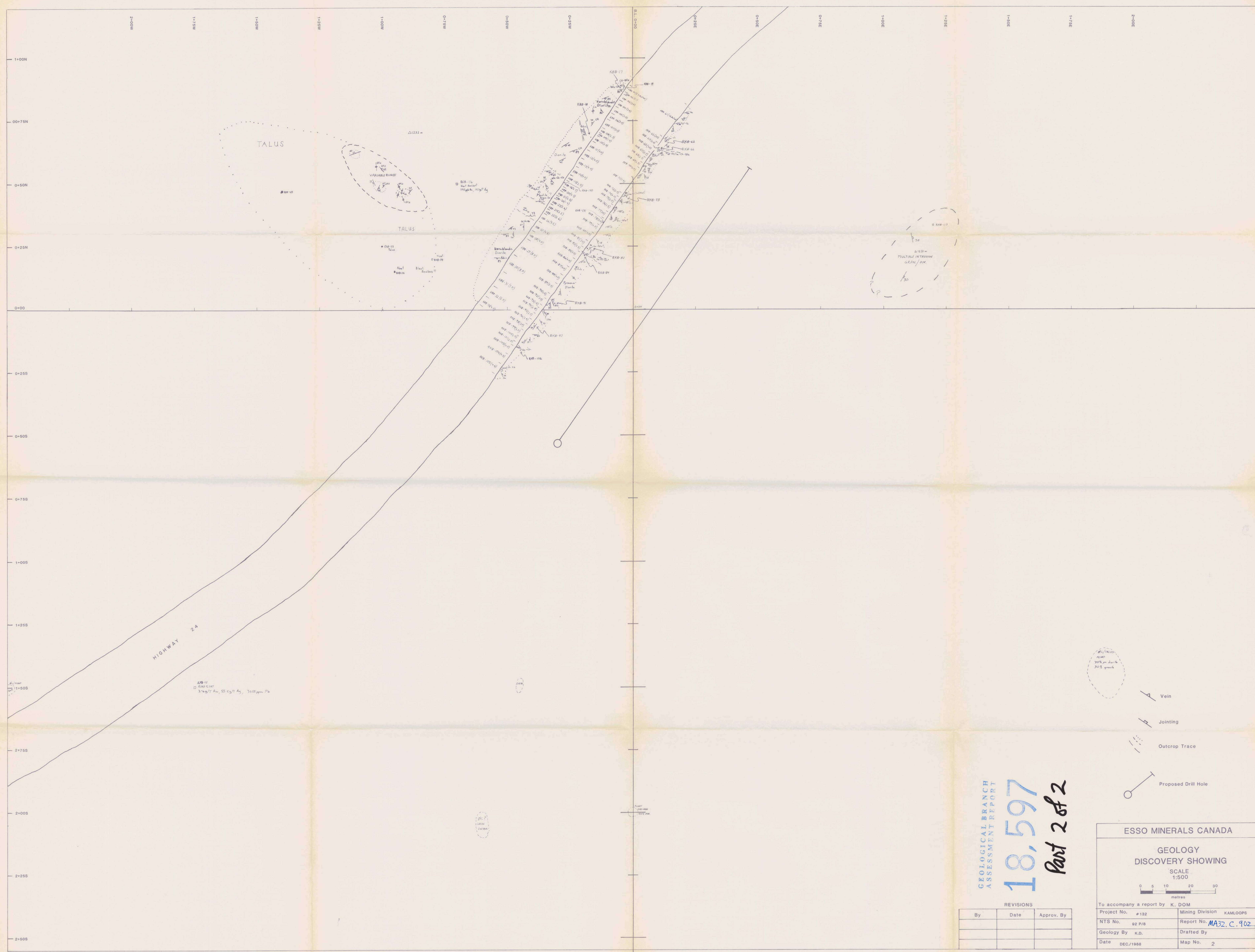

HIGHWAY 24

AMS-III  
 □ RMP 72147  
 3-10-87/14, SS 53/17 Ag, 3005 ppm Pb

GEOLOGICAL BRANCH  
 ASSESSMENT REPORT  
**18,597**  
*Part 2 of 2*

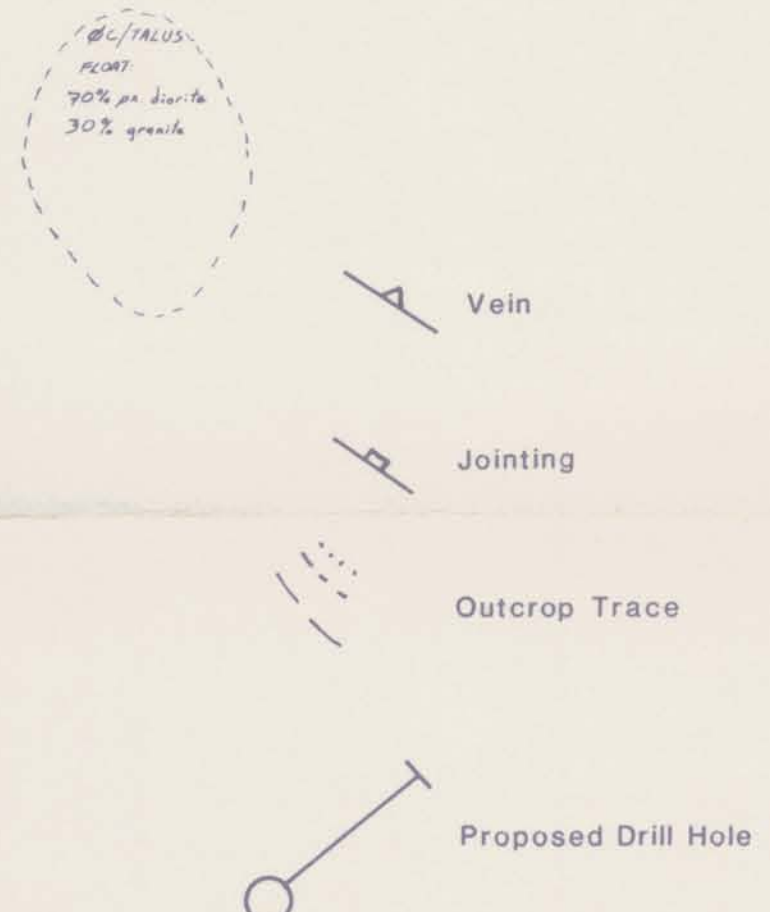

ESSO MINERALS CANADA

GEOLOGY  
 DISCOVERY SHOWING

SCALE  
 1:500

0 5 10 20 30  
 metres

To accompany a report by K. DOM

Project No.	#132	Mining Division	KAMLOOPS
NTS No.	92 P/R	Report No.	MA32.C.902
Geology By	K.D.	Drafted By	
Date	DEC/1988	Map No.	2

REVISIONS

By	Date	Apprv. By