

LOG NO: 0907
ACTION: Date received report
back from amendments.
FILE NO:

LOG NO: 0621 RD.
ACTION:
FILE NO:

PRELIMINARY GEOLOGICAL REPORT

INCLUDING

GEO - CHEM SURVEY RESULTS

AND

TRENCHING RESULTS.

FILM

THE VAD CLAIM.

GOLDEN MINING DIVISION, B.C.

NTS Map: M82K/15W

Lat. 50° 55'

Long. 116° 55'

16 1989

FOR

James S. Adamson, (Operator)-paid for all work done.

James S. Adamson,

Calgary, Alberta **GEOLOGICAL BRANCH**

ASSESSMENT REPORT

Report prepared by- Bruce H. van der Lee, P. Eng.

June 12th, 1989.

18,849

TABLE OF CONTENTS

<u>PROPERTY</u>	1
<u>LOCATION AND ACCESS</u>	1
<u>ECONOMIC GEOLOGY</u>	1
<u>GEOLOGY</u>	1
<u>EXPLORATORY GEO-CHEM LINES</u>	2
<u>TRENCHING AND RESULTANT OBSERVATIONS</u> ..	3
<u>CONCLUSIONS AND RECOMMENDATIONS</u>	4

INCLUSIONS

STATEMENT OF COSTS

INDEX MAP

TRENCHING MAP

GEO-CHEM MAP

CLAIM LOCATION MAP

ASSAY REPORTS

SUMMARY OF WORK DONE (page 7)

PROPERTY

The property consists of one unpatented mineral claim containing 20 units.

It is known as the VAD Mineral Claim.

The above claim is owned by James S. Adamson of Calgary, Alberta.

LOCATION AND ACCESS

The claim is located between Crystalline and Conrad Creeks, approximately 1500 meters south from the junction of Conrad Creek with Vowell Creek.

The claim area is 56km from Parsons, B.C., and is accessible by an all-weather road. Parsons is served by the CPR, and highway 95. The property lies on the west slope of the Vowell Creek valley at an elevation of 1300 to 2000 meters. Much of the property can be reached by 4 wheel drive vehicles over existing logging trails.

Although much of the valley is heavily timbered about a third of the claim area has been logged. Due heavy overburden there is little or no rock exposure in the claim area being investigated at present time.

ECONOMIC GEOLOGY

The VAD Mineral Claim is an interesting prospect as it appears to be on strike with the Columbia River Mines property to the north-west. Columbia River Mines was active in the late 1970's, shipping a lead silver concentrate to the smelter.

GEOLOGY

The claim area is in the Purcel Range and was mapped by J. E. Reesor

(G.S.C.) Map 12, 1957, (Lardeau Half).

The claims are underlain by rock of the Horsethief Creek Series, which consist of quartzite, argillite, pebble conglomerate, and limestone of the late Precambrian age. Mineralization appears to have come from the southeast where there is a large stock of granodiorite of the Mesozoic age. There are a number of folds in the area with dips of approximately 25 degrees. The Columbia River Mines ore body occurs in such a synclinal fold within a limestone band.

The VAD property has few outcroppings, making detailed geology of the claim next to impossible.

EXPLORATORY GEO-CHEM LINES

The location line runs north and south and is located on unit O 1S 1E as shown on map 3. Laterals running east and west from this location line are sampled at 25' intervals or as required as shown on map 5. Three trips had to be made to obtain soil samples and run shallow trenches along the shoulders of the logging trails in order to determine the actual location and direction of strike of the ore zone. This was necessary due to the leaching of the minerals in the gossans that lie beneath the overburden. Strong soil samples are not the rule and some hand trenching is necessary to get a true indication of values.

All samples were taken from the B zone at a depth of 8 to 12". Samples from swampy areas were taken from the clays and gravels at the base of the peat. All samples were assayed at Loring Laboratories Ltd. located in Calgary, Alberta. An 80 mesh was used with all samples.

The analysis was done by hot acid digestion and atomic absorption spectroscopy. The sampling was done by James Adamson, Nick Dobni and William van der Lee. Standard geo-chem bags were used as supplied by Loring Laboratories. All bags were marked and tied at the sample location. All samples were paid for by James Adamson.

The sampling was done on June 19 - 20, Aug. 7 - 8, and Sept. 2 - 3, of 1988.

TRENCHING AND RESULTANT OBSERVATIONS

About 300' of shallow hand trenching was necessary to remove weathered material from the shoulders of the old logging trails to expose the gossans.

On Oct. 27 a D7 'Cat' was used to trench the areas at 1200S-100W, 1200S-200W and 1300S-100W. as shown on map 4. Gossan 20' wide was exposed at 1200S-100W which assayed values to 1.12 in lead. This eroded vein material dips to the east at 69° and the strike is S - 35°E. At the 1300S-100W location the the 10' shoulder exposed a gossan 1' wide at the top and widening to 6' at the bottom of the cut.

The geo-chem survey appears to extend the main vein through the 1300S line at the 25W (100ppm lead) and the 35W (100ppm lead) intervals, and then carry it though to the 1450S-125E interval (548ppm lead). Other veins seem to be indicated by the soil sample readings at the following intervals: 1200S-200W, 1250S-105W and 1300S-100W.

It is interesting to note that two rock samples containing galena which were picked up on the eastern portion of the 800S and 900S laterals assayed 8% lead - 13.48 oz silver per ton and 59.69% lead and 45.37 oz silver per ton; - and gold at .036 per ton.

CONCLUSIONS AND RECOMMENDATIONS

The gossans at 1200S-100W and at the 1300S-100W locations were located by geo-chem assay results of 630ppm and 573ppm respectively, and were relatively narrow at their surface exposures. Trenching to 10' in depth has raised the values of lead to as high as 1.12% and shows these gossans widening significantly with depth.

The presence of geo-chem highs to the south east of the gossan exposure at 1200S-100W seems to indicate the continuity of a strong vein system.

Trenching to expose the main vein at 1300S-25W and 1450S-125E is necessary to show the vein width and the lead values at depth.

Widening the existing logging trails to cut into the bank and expose gossans or veins on the following lines would be advantageous:

1200S	-	Between	-	250E and 250W.
1300S	-	Between	-	300E and 200W
1000S	-	Between	-	400E and 500W

Some additional geo-chem should be done at 10' intervals where the strike of the main veins appears to cross the lines:- 1000S, -1600S, 1800S, 2000S, and also between 200W and 600W on the 800S line.

After trenching has been completed at 1450S-125E a decision can then be made to diamond drill to intersect this vein material at depth. I would recommend drilling to intersect this vein at approximately 75' at both the 1450S-125E and the 1200S-100W locations.

C E R T I F I C A T E

This is to certify that I, Bruce H. van der Lee,

1. Am a resident of Calgary, Alberta, and live @ #1100, 1122 - 4th. Street, S.W. T2R 1M1.
2. Am a graduate of the University of Alberta, B. Sc. in Mining Eng. (1979)
3. Am a member of APEGGA.
4. Have no interest direct or indirect in the properties known as The VAD Claim.
5. Have authorized this report after examination of the field data and the G.S.C. reports pertaining to the area.

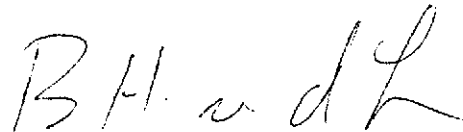

Bruce H. van der Lee, P.Eng.

STATEMENT OF COSTS FOR THE VAD CLAIM, (20 UNITS) FOR 1988 - 89.

Claim VAD - 20 Units

Map No. 82K/15W

Mi. Rec. 057706S

Rec. No. 1893

The above Claim recorded at Golden, B.C., the 6th day of July, 1988.

Geo-chem & Rock Assays	566.00
Labor:- Geo-chem & Hand Trenching:- 3 men for 5 days @ 8.00 hr	960.00
Labor to assist with 'Cat' D7 Trenching:- 2 men for one day ..	128.00
Trenching with D7 'Cat' 5 hrs @ 78.00 hr	390.00
Geologist one day @ 250.00 day	250.00
Preparing Report and recording geo-chem	250.00
Board:- @ 15.00 per man per day- 19 man days	285.00
Geo-chem bags and supplies-	35.00
4X4 - @ 35.00 per day- 19 days	245.00
Chain Saw - @ 8.00 day for 5 days	40.00
Travel in B.C. - 40.00 per trip - 4 trips	160.00
Total Costs	<u>3309.00</u>

SUMMARY OF WORK DONE ON VAD 1 MINERAL CLAIM FOR 1988 - 1989.

Geo-Chemical Survey was done on portions of units O 1S 1E and 1E 1S 2E. The survey covered approximately 54 hectares.

130 soil samples were collected.

15 rock samples were collected and assayed.

100 meters of hand trenching was done along existing logging trails.

3 trenches, each 10 meters long by 4 meters wide to expose a side wall of approximately 3 meters high in the ore zone, was excavated by a D7 'Cat'.

117°00'

GEOLOGICAL MAP # I 45'

5000m

VAD CLAIM

30'

51°00'

45'

E



M82K/15W

(FCR PLACER SEE P 82K/15W)

82K/14E

1M 3 52 (11)

1000 M

MAP # 2



117.00'
5760'

M82K/15W

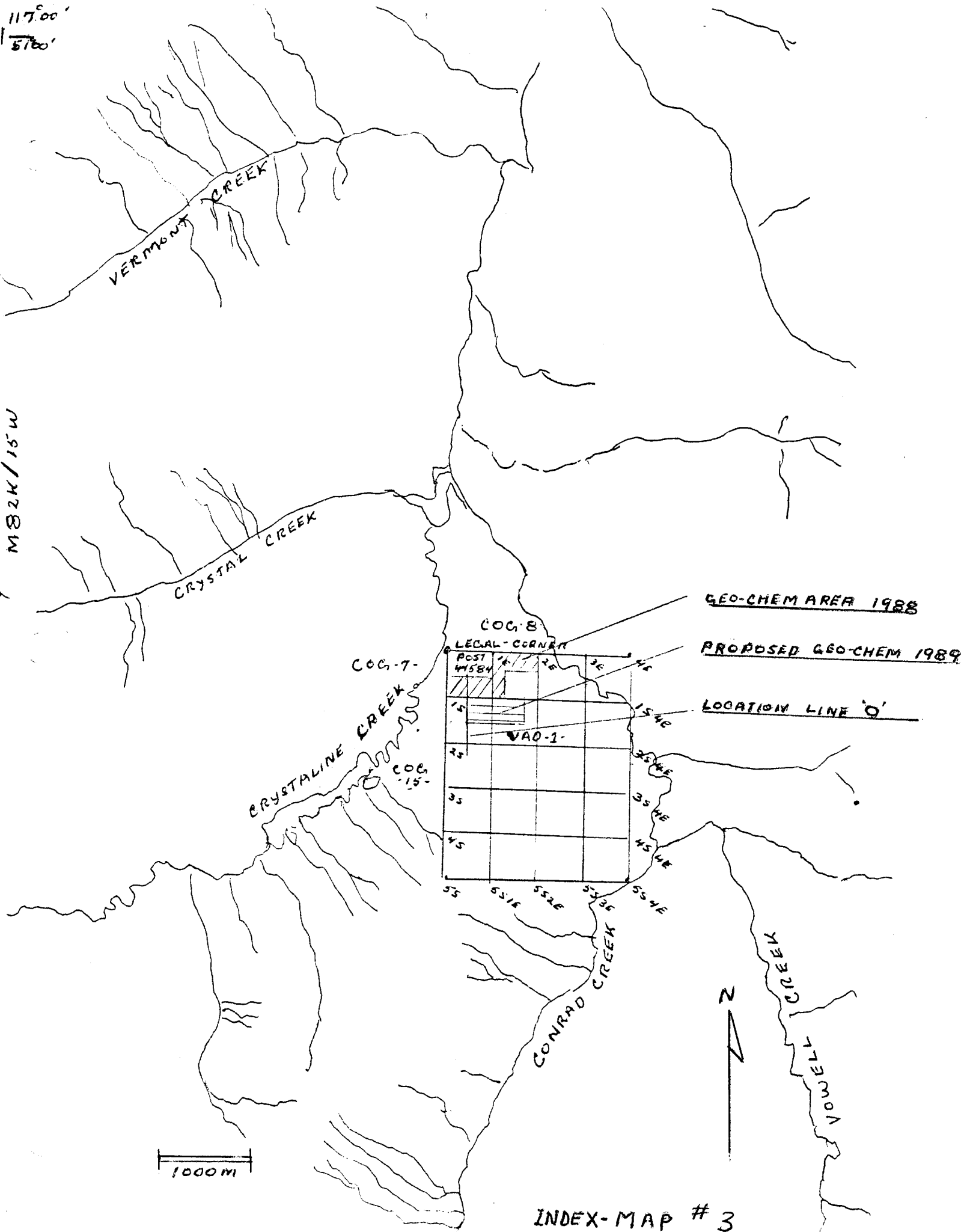

GEO-CHEM AREA 1988

PROPOSED GEO-CHEM 1989

LOCATION LINE 'O'

INDEX-MAP # 3

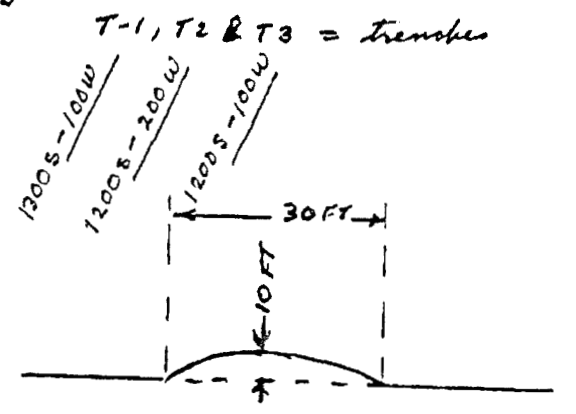
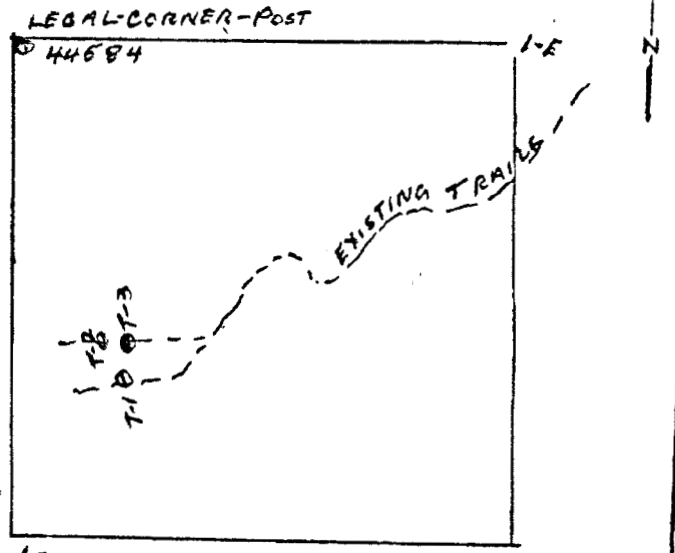
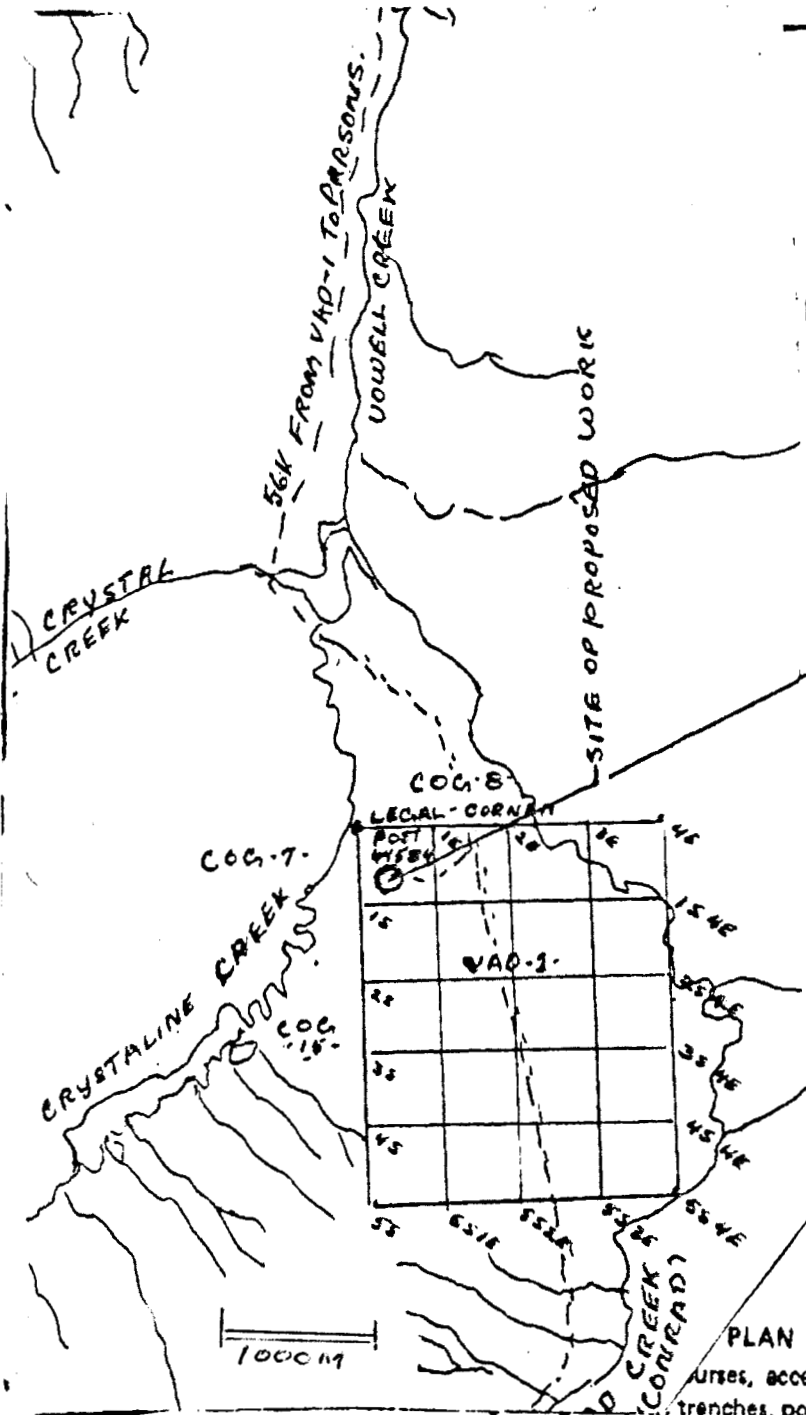

PROPOSED TRENCH AT EACH LOCATION (T1; T2 & T3).

courses, access road and distance to nearest town, proposed trenches, portals, drill sites, and camp sites.

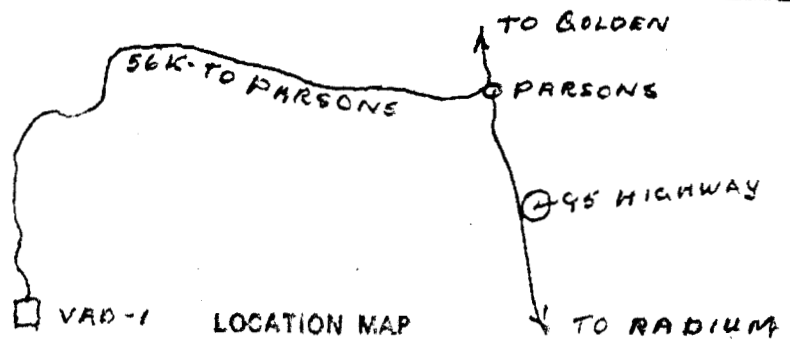

Show nearest town and access road.

MAP #4

To: JAYSION INVESTMENTS LTD.,
 539 - 47th Avenue S.W.,
 Calgary, Alberta T2J 1C5

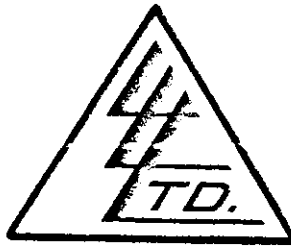

File No. 31446
 Date July 12, 1988
 Samples Soil

ATTN: Jim Adamson

Certificate of
ASSAY of
LORING LABORATORIES LTD.

Page # 1

SAMPLE No.	PPM Pb
<u>"Soil Samples"</u>	
Geochemical Analysis	
1-HR	83
2	182
3	107
4	51
5	123
6	57
7	64
8	45
9	63
10	77
11	51
12	41
1-LR	84
2	55
3	53
4	59
5	66
6	41
7	28
8	39
9	61
10	25

I Hereby Certify THAT THE ABOVE RESULTS ARE THOSE
 ASSAYS MADE BY ME UPON THE HEREIN DESCRIBED SAMPLES

Rejects Retained one month.
 Pulps Retained one month
 unless specific arrangements
 made in advance.

James Loring

To: JAYSION INVESTMENTS LTD.,
 539 - 47th Avenue S.W.,
 Calgary, Alberta T2J 1C5

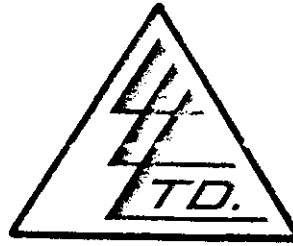

File No. 31446
 Date July 12, 1988
 Samples Rock

ATTN: Jim Adamson

Certificate of
ASSAY OF
LORING LABORATORIES LTD.

Page # 2

SAMPLE No.	OZ./TON GOLD	OZ./TON SILVER	% Pb
"Rock Samples" "Assay Analysis"			
Below White Rock	.012	-	.06
Large Sample No.	-	13.48	8.00
.			
<p>I Hereby Certify THAT THE ABOVE RESULTS ARE THOSE ASSAYS MADE BY ME UPON THE HEREIN DESCRIBED SAMPLES</p>			

Rejects Retained one month.
 Pulps Retained one month
 unless specific arrangements
 made in advance.

To: JAYSION INVESTMENT LTD.
 539 - 47 Avenue S.W.,
 Calgary, Alberta
 T2J 1C5
 Attn: Jim Adamson

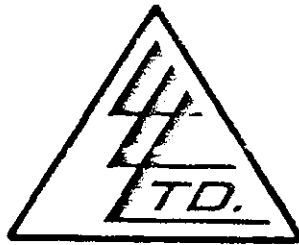

File No. 31446 - 1
 Date August 8, 1988
 Samples Rock

Certificate of
ASSAY OF
LORING LABORATORIES LTD.

SAMPLE No.	<i>Gold</i>	OZ./TON Silver	% Lead
"Assay Analysis" NICK - 1	036	45.37	59.69

I Herby Certify THAT THE ABOVE RESULTS ARE THOSE
 ASSAYS MADE BY ME UPON THE HEREIN DESCRIBED SAMPLES

Rejects Retained one month.
 Pulps Retained one month
 unless specific arrangements
 made in advance.

David L...

To: JAYSION INVESTMENTS LTD.,

539 - 47th Avenue S.W.,

Calgary, Alberta T2J 1G5

File No. 31636

Date August 25, 1988

Samples Soil



ATTN: J.S. Adamson

Certificate of Assay LORING LABORATORIES LTD.

Page # 1

SAMPLE NO.

PPM
Pb

Soil Samples

Geochemical Analysis

0S- 800E	41
100S- 800E	44
200S- 800E	33
100N- 800E	24
200N- 800E	38
300N- 800E	22
400S- 0	19
400S- 100E	67
400S- 200E	51
400S- 300E	26
400S- 400E	30
400S- 500E	11
400S- 600E	33
400S- 700E	29
400S- 800E	26
400N- 800E	24
400N- 900E	36
400N-1000E	40
400N-1100E	44
400N-1200E	48
400N-1300E	62
400N-1400E	21
400N-1500E	26
400N-1600E	31
400N-1700E	51
400N-1800E	14
400N-1900E	26
775S- 75W	28
775S- 100W	37
775S- 125W	27
775S- 150W	16

I Hereby Certify that the above results are those assays made by me upon the herein described samples....

Rejects retained one month.
Pulps retained one month
Unless specific arrangements
are made in advance.

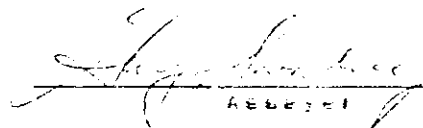
J.S. Adamson

To: JAYSION INVESTMENTS LTD.,
539 - 47th Avenue S.W.,
Calgary, Alberta T2J 1C5

File No. 31636
Date August 25, 1988
Samples Soil



ATTN: J.S. Adamson

Certificate of Assay LORING LABORATORIES LTD.

Page # 2

SAMPLE NO.	PPM Pb
800S- 0	52
800S- 50W	72
800S-100W	22
800S-200W	26
800S-300W	31
800S-400W	73
800S-500W	40
800S-600W	38
800S-700W	19
1200S- 50E	64
1200S-100E	40
1200S-150E	64
1200S-200E	61
1200S-250E	68
1200S-300E	22
1200S-100W	630
1200S-150W	31
1200S-200W	22
1200S-225W	50

I Hereby Certify that the above results are those
assays made by me upon the herein described samples....

Rejects retained one month.
Pulps retained one month
unless specific arrangements
are made in advance.

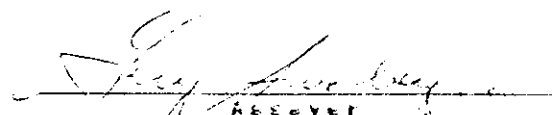

Assayer

To: MR. J.S. ADAMSON,
539 - 47th Avenue S.W.,
Calgary, Alberta
2J 1C5

File No. 31919

Date October 31, 1988

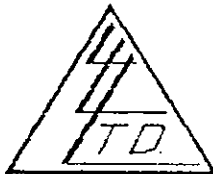
Samples Rock



Certificate of Assay LORING LABORATORIES LTD.

Page # 1

SAMPLE NO.

OZ./TON
GOLD

%
Pb

"Rock Samples"
"Assay Analysis"

1300S + 100W	.008	-
1200S + 100W	-	.14
1200S + 110W	-	.88

I Hereby Certify that the above results are those
assays made by me upon the herein described samples....

Rejects retained one month.
Ips retained one month
less specific arrangements
are made in advance.

Assayer

To: MR. J.S. ADAMSON,
539 - 47th Avenue S.W.,
Calgary, Alberta
2J 1C5

File No. 31919
Date October 31, 1988
Samples Soil



Certificate of Assay LORING LABORATORIES LTD.

Page # 2

SAMPLE NO.	PPM Pb
<u>"Soil Samples"</u>	
<u>Geochemical Analysis</u>	
1200S + 85W	38
90W	41
100W	+1000
110W	+1000
115W	163
120W	39
150W	17
200W	547
1250S + 80W	56
90W	59
95W	41
100W	44
105W	471
110W	31
120W	27
130W	19
140W	46
1300S + 50W	30
75W	123
90W	47
95W	45
100W	573
105W	60
110W	38
115W	65
120W	34
125W	22
130W	68
150W	36
1350S + 0W	143

I Hereby Certify that the above results are those
assays made by me upon the herein described samples....

Subjects retained one month.
Specimens retained one month
unless specific arrangements
are made in advance.



ASSAYER

To: MR. J.S. ADAMSON,
 539 - 47th Avenue S.W.,
 Calgary, Alberta
 T2J 1C5

File No. 31919
 Date October 31, 1988
 Samples Soil

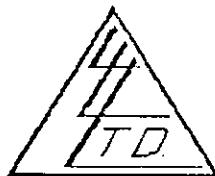

Certificate of Assay LORING LABORATORIES LTD.

Page # 3

SAMPLE NO.	PPM Pb
1350S + 10W	33
20W	106
30W	66
40W	52
50W	52
60W	34
70W	34
80W	8
90W	27
100W	32
110W	25
120W	28
130W	38
140W	46
150W	28
1450S + 0W	165
25W	32
50W	32
75W	49
100W	32
125W	37
150W	67
1450S + 25E	45
50E	32
75E	23
100E	30
125E	548
150E	35

I Hereby Certify that the above results are those assays made by me upon the herein described samples....

jects retained one month.
 ips retained one month
 unless specific arrangements
 are made in advance.

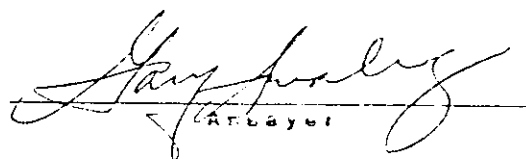

 Gary Pauling
 Assayer

To: MR. J.S. ADAMSON,
539 - 47th Avenue S.W.,
Calgary, Alberta
J-105

File No. 31995

Date November 22, 1988

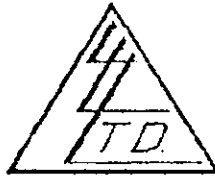
Samples Soil



Certificate of Assay LORING LABORATORIES LTD.

SAMPLE NO.

%
Pb

"Assay Analysis"

1200S-110W 1 Ft from West Side of Nick's Vein	.18
5 Ft from West Side of Nick's Vein	1.12
Ft from West Side of Nick's Vein	.07
(Ft from West Side of Nick's Vein	.07
12 Ft from West Side of Nick's Vein	.03
21 Ft from West Side of Nick's Vein	.02
1300S-25W (A) Extension of Nick's Vein	.01
1300S-25W (B) Extension of Nick's Vein	.01

I Hereby Certify that the above results are those
assays made by me upon the herein described samples....

Objects retained one month.
Slips retained one month
Unless specific arrangements
are made in advance.

Assayer

To: JAYSION INVESTMENTS LTD.,
539 - 47th Avenue S.W.,
Calgary, Alberta T2J 1C5

File No. 32064
Date December 21, 1999
Samples Rock



Attn: J.S. Adamson

Certificate of Assay LORING LABORATORIES LTD.

SAMPLE NO.

OZ./TON
GOLD

"Assay Analysis"

1 ROCK

.036

SAMPLE FROM 13005 - 100W

I Hereby Certify that the above results are those
assays made by me upon the herein described samples....

Results retained one month.
Results retained one month
or as specific arrangements
are made in advance.

Assayer

3 TRENCHES WITH D7 'CAT'

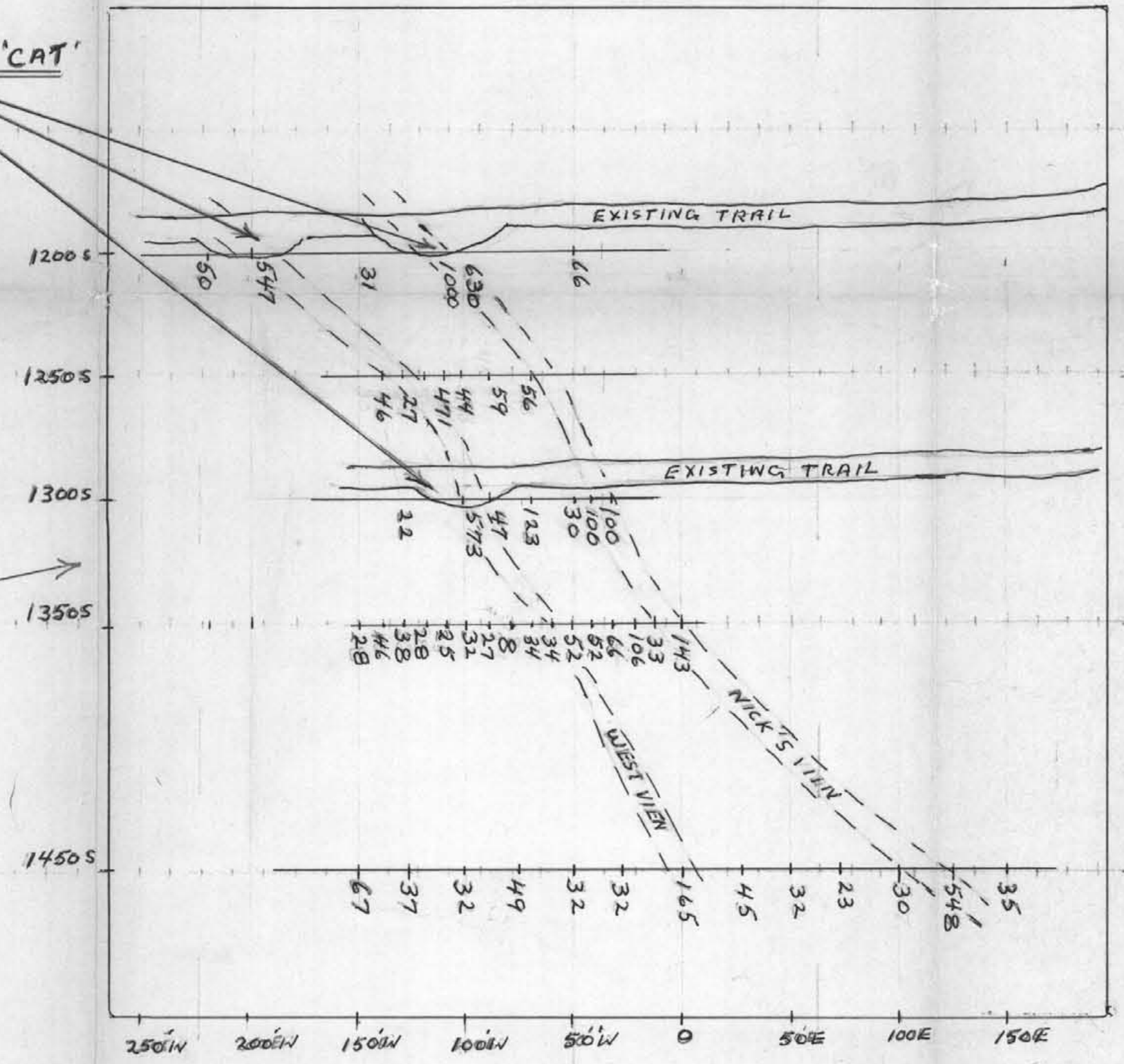

DETAIL OF AREA (A) TO SHOW VEIN SYSTEM AND TRENCHES

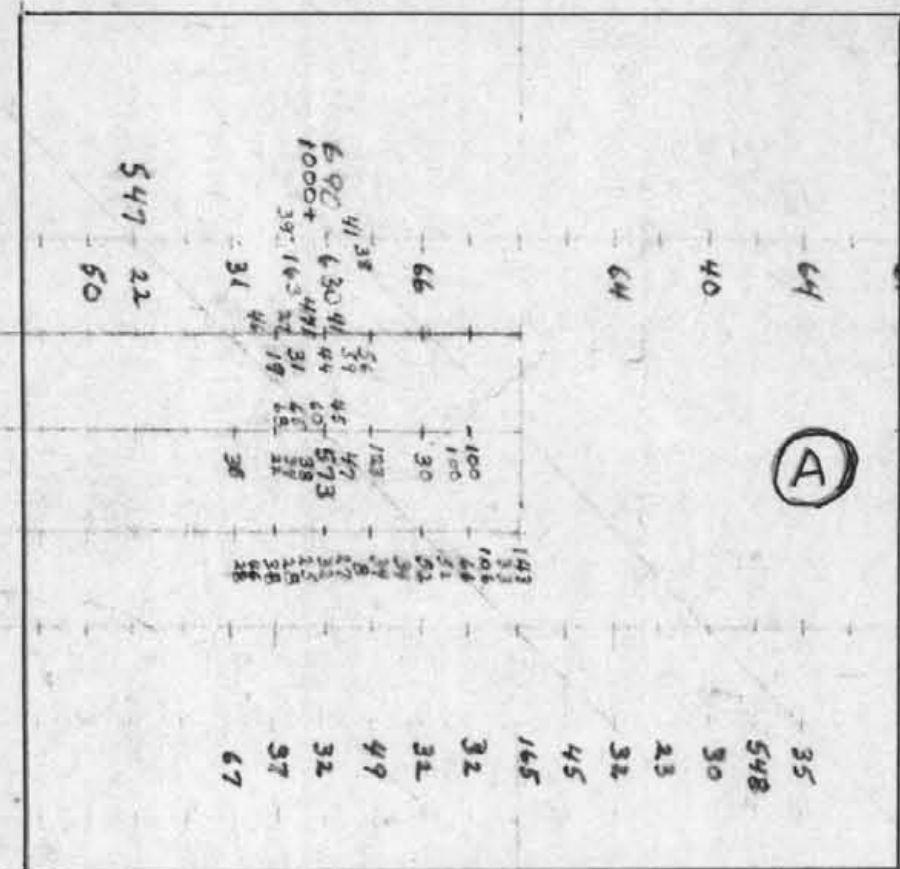

GEOLOGICAL BRANCH
ASSESSMENT REPORT

13,849

NORTH EXTENSION OF GEO-CHEM (A)

'VAD' CLAIM - GEO-CHEM SURVEY

MAP # 5 SEE INDEX MAP # 3

ALL READINGS - LEAD ppm

AVERAGE NORM Pb under 70ppm = 39ppm

