

SPRINGGLEN
RECEIVED

AUG 11 1989

M.D. J. S.
VANCOUVER, B.C.

VOLUME II

MAPS

ASSESSMENT REPORT FOR 1988 GEOLOGICAL, GEOCHEMICAL, GEOPHYSICAL WORK

T E N N CLAIMS
LOUISE LAKE
OMINECA M.D.

FILMED

OWNERS: L.B. Warren
P.O. Box 662
Smithers, B.C.
VOJ 2N0

and

Eric A. Shaede
R.R. #1,
Sicamous, B.C.
VOE 2V0

Part 3 of 3

GEOLOGICAL BRANCH
ASSESSMENT REPORT

OPERATOR: CORONA CORPORATION
1440 - 800 W. Pender Street
Vancouver, B.C.
V6C 2V6

18,971

N.T.S. 93-L/13E
54°51'N/127°41'E

R.W. KLASSEN
March 1989

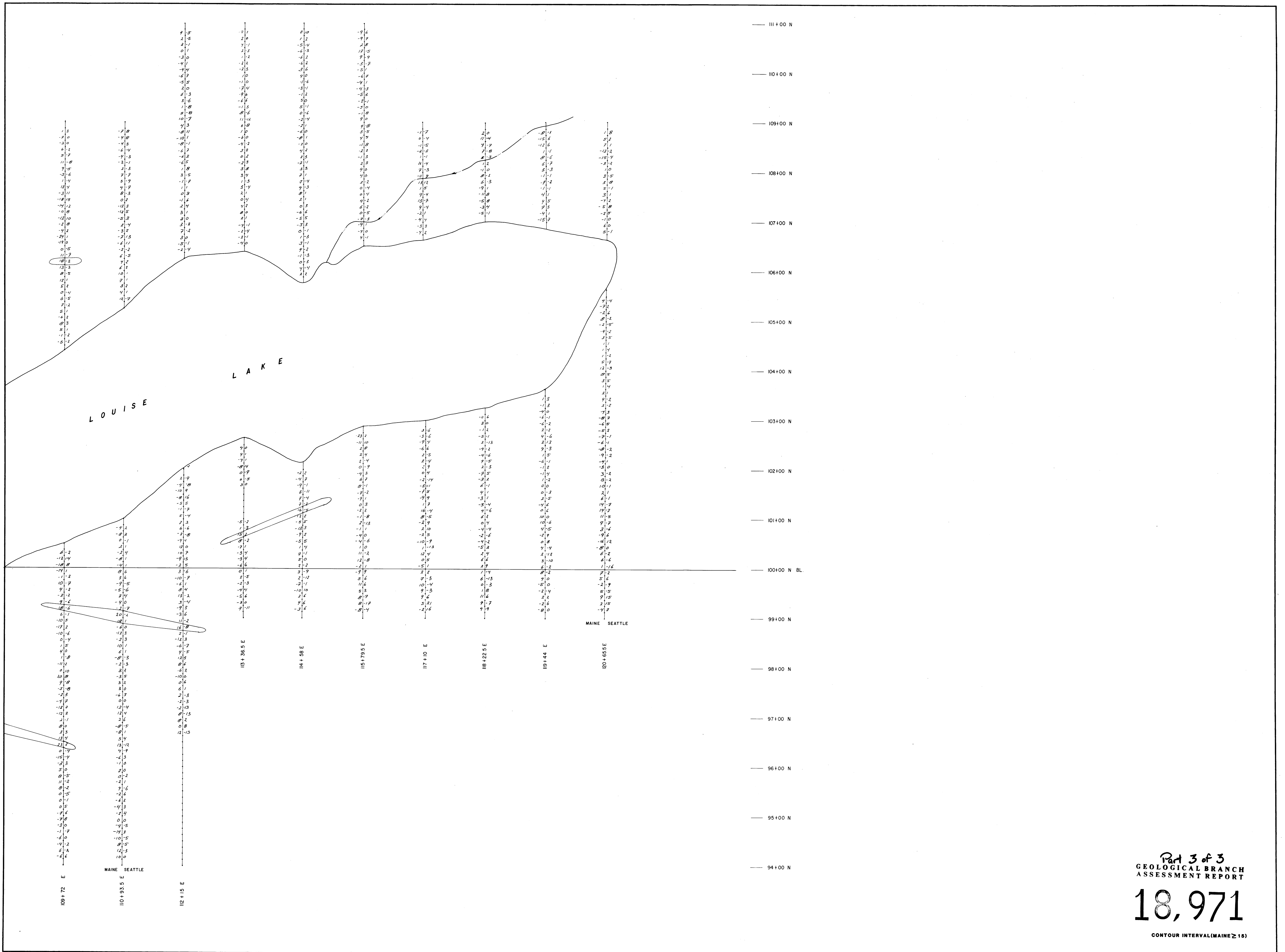

Part 3 of 3
 GEOLOGICAL BRANCH
 ASSESSMENT REPORT
18,971
 CONTOUR INTERVAL (MAINE ≥ 15)

<p>MAP SCALE</p> <p>NTS: 93L / 13E</p>	<table border="1" style="width: 100%; border-collapse: collapse;"> <thead> <tr> <th>No.</th> <th>Date</th> <th>MADE BY</th> <th>DESCRIPTION</th> </tr> </thead> <tbody> <tr><td>1</td><td></td><td></td><td></td></tr> <tr><td>2</td><td></td><td></td><td></td></tr> <tr><td>3</td><td></td><td></td><td></td></tr> <tr><td>4</td><td></td><td></td><td></td></tr> <tr><td>5</td><td></td><td></td><td></td></tr> </tbody> </table>	No.	Date	MADE BY	DESCRIPTION	1				2				3				4				5				<table border="1" style="width: 100%; border-collapse: collapse;"> <thead> <tr> <th>DATE</th> <th>DRAWN BY</th> <th>CHECKED</th> <th>APPROVED</th> </tr> </thead> <tbody> <tr> <td>Oct. 1988</td> <td>J v v</td> <td></td> <td></td> </tr> </tbody> </table>	DATE	DRAWN BY	CHECKED	APPROVED	Oct. 1988	J v v			<p>CORONA CORPORATION</p>	<p style="text-align: center;">LOUISE LAKE PROJECT FRASER FILTER</p> <table border="1" style="width: 100%; border-collapse: collapse;"> <tr> <th>OFFICE</th> <th>DEPARTMENT</th> <th>MAP INDEX NUMBER</th> <th>SCALE</th> <th>DRAWING NUMBER</th> </tr> <tr> <td></td> <td></td> <td></td> <td>1: 2,500</td> <td>105</td> </tr> </table>	OFFICE	DEPARTMENT	MAP INDEX NUMBER	SCALE	DRAWING NUMBER				1: 2,500	105
No.	Date	MADE BY	DESCRIPTION																																											
1																																														
2																																														
3																																														
4																																														
5																																														
DATE	DRAWN BY	CHECKED	APPROVED																																											
Oct. 1988	J v v																																													
OFFICE	DEPARTMENT	MAP INDEX NUMBER	SCALE	DRAWING NUMBER																																										
			1: 2,500	105																																										

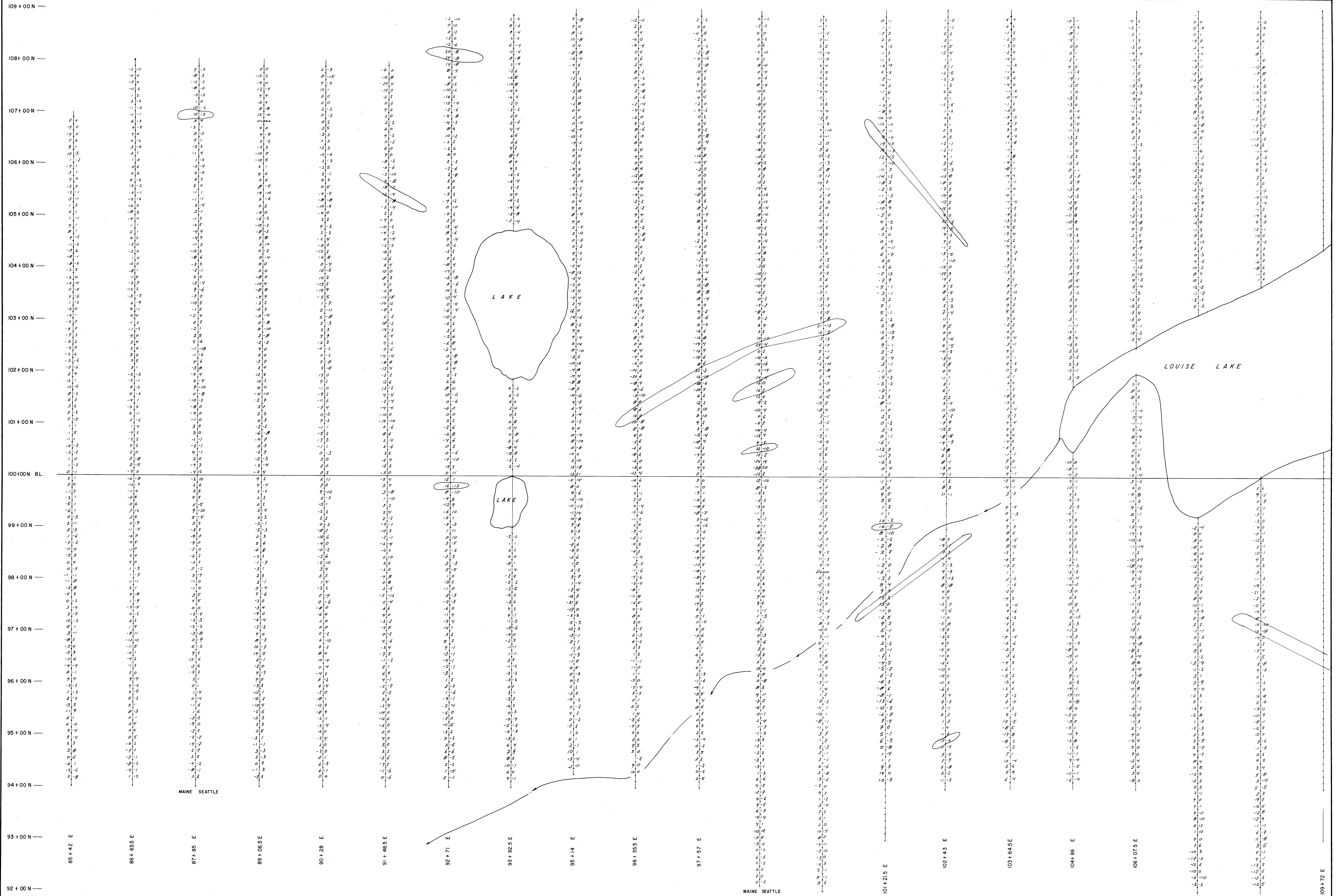

Part 3 of 3
 GEOLOGICAL BRANCH
 ASSESSMENT REPORT
 18,971

CONTOUR INTERVAL (MAINE ≥ 15)

No.	Date	MADE BY	DESCRIPTION
1			
2			
3			
4			
5			

DATE	DRAWN BY	CHECKED	APPROVED
Oct 1988	Jv V		

CORONA CORPORATION

LOUISE LAKE PROJECT
FRASER FILTER

OFFICE	DEPARTMENT	MAP INDEX NUMBER	SCALE	DRAWING NUMBER
			1:2,500	10 d

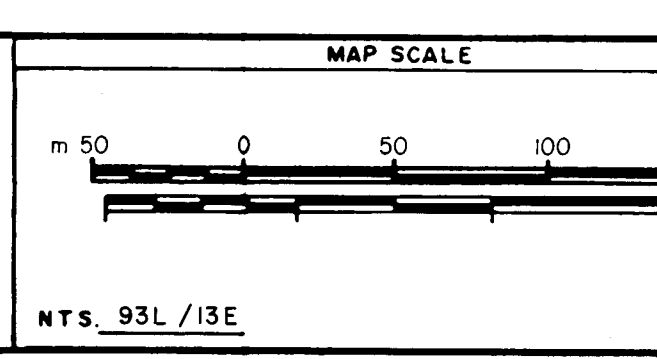

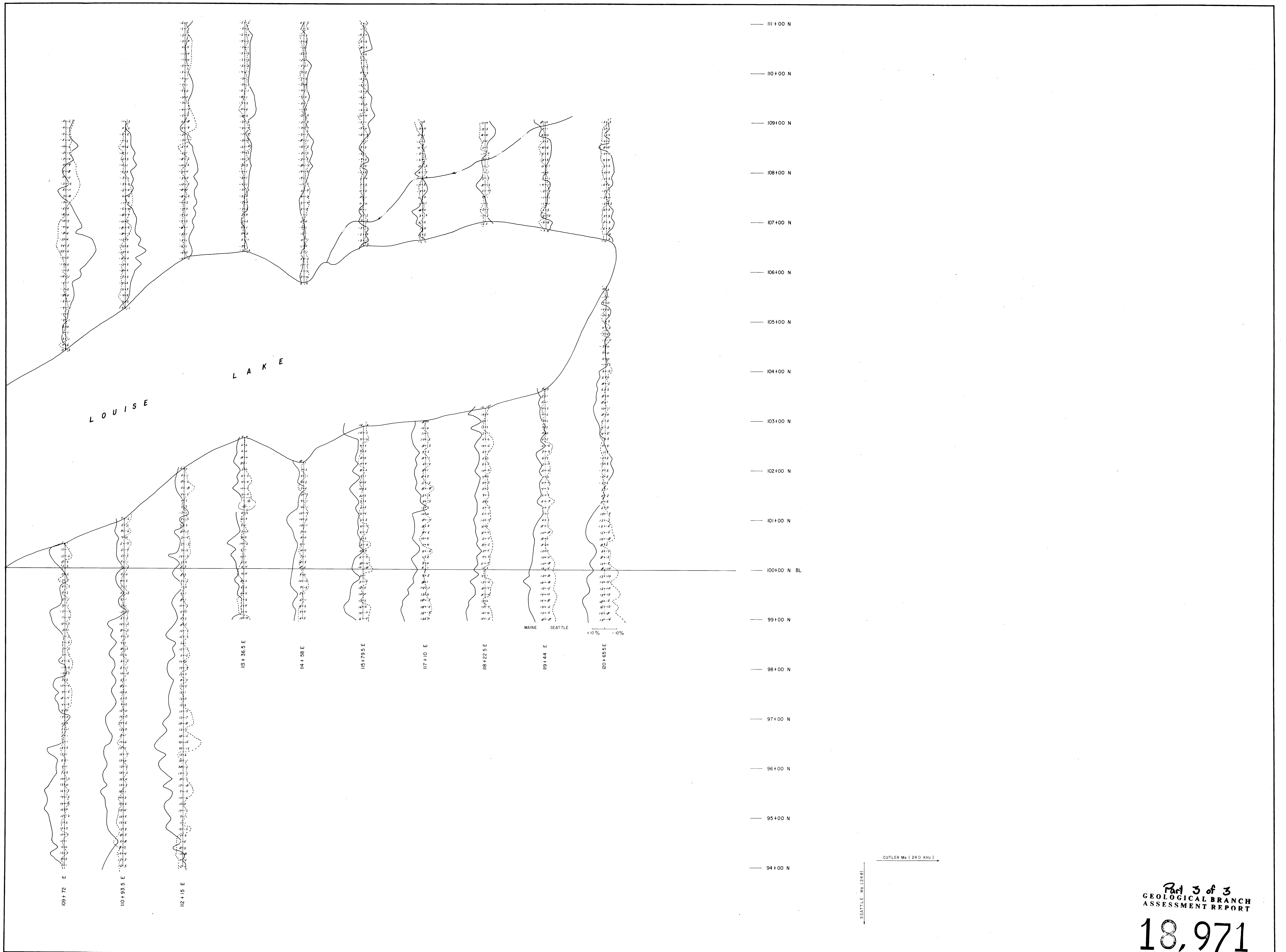

Part 3 of 3
 GEOLOGICAL BRANCH
 ASSESSMENT REPORT

18,971

MAP SCALE 0 50 100 150 m 1 cm = 10% NTS	No. 1 DATE Oct 1988	Dwn. J. v. V.	MADE BY CHECKED APPROVED	DESCRIPTION OFFICE DEPARTMENT	CORONA CORPORATION	LOUISE LAKE PROJECT VLF - EM SURVEY DIP ANGLE - EAST HALF	MAP INDEX NUMBER SCALE 1:2,500	DRAWING NUMBER 9b
	ENCLOSURES 1 2 3 4 5							

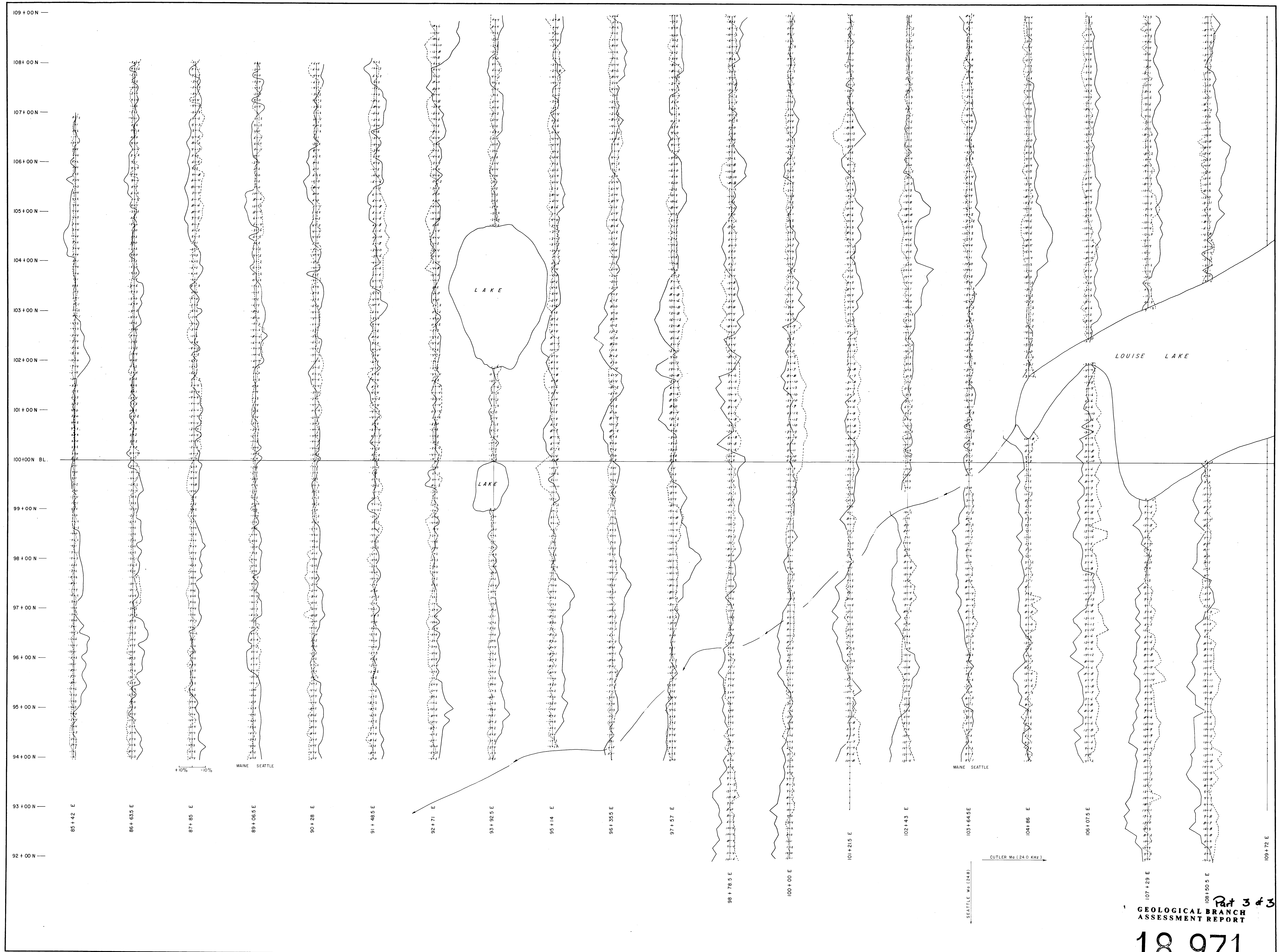

Part 3 of 3
GEOLOGICAL BRANCH
ASSESSMENT REPORT
18,971

<p>MAP SCALE</p> <p>1 cm = 10%</p> <p>Measurements made with phoenix 500 VLF-EM Receiver</p>	<table border="1" style="width: 100%; border-collapse: collapse;"> <tr> <th>No</th> <th>Date</th> <th>MADE BY</th> <th>DESCRIPTION</th> </tr> <tr> <td>1</td> <td></td> <td></td> <td></td> </tr> <tr> <td>2</td> <td></td> <td></td> <td></td> </tr> <tr> <td>3</td> <td></td> <td></td> <td></td> </tr> <tr> <td>4</td> <td></td> <td></td> <td></td> </tr> <tr> <td>5</td> <td></td> <td></td> <td></td> </tr> </table>	No	Date	MADE BY	DESCRIPTION	1				2				3				4				5				<p style="text-align: center;">CORONA CORPORATION</p> <p>OFFICE: _____ DEPARTMENT: _____</p>	<table border="1" style="width: 100%; border-collapse: collapse;"> <tr> <td>DATE: Oct 1988</td> <td>DRAWN BY: J v V</td> <td>CHECKED: _____</td> <td>APPROVED: _____</td> </tr> <tr> <td>MAP INDEX NUMBER</td> <td>SCALE: 1:2,500</td> <td colspan="2">DRAWING NUMBER: 9a</td> </tr> </table>	DATE: Oct 1988	DRAWN BY: J v V	CHECKED: _____	APPROVED: _____	MAP INDEX NUMBER	SCALE: 1:2,500	DRAWING NUMBER: 9a	
No	Date	MADE BY	DESCRIPTION																																
1																																			
2																																			
3																																			
4																																			
5																																			
DATE: Oct 1988	DRAWN BY: J v V	CHECKED: _____	APPROVED: _____																																
MAP INDEX NUMBER	SCALE: 1:2,500	DRAWING NUMBER: 9a																																	

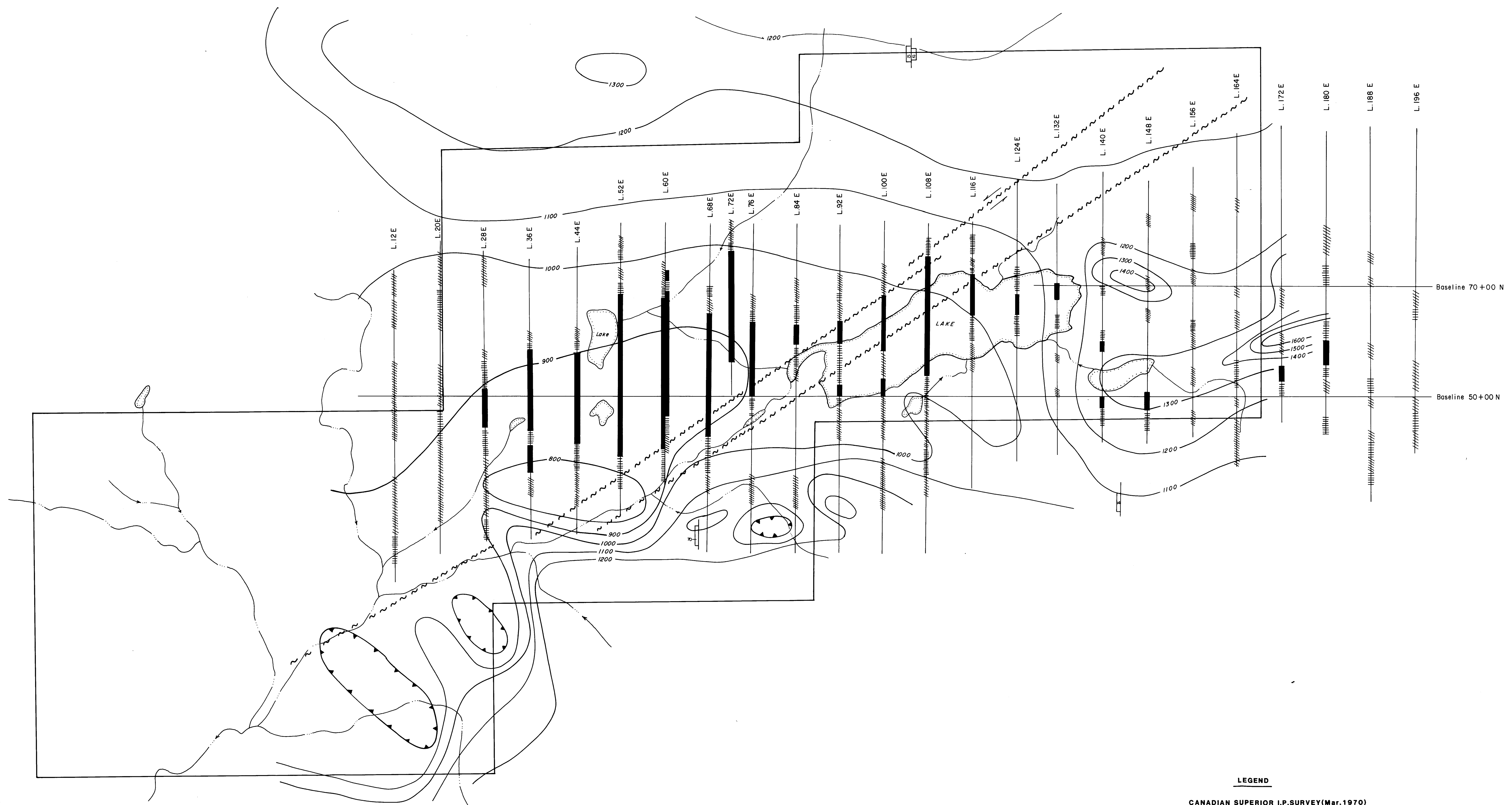
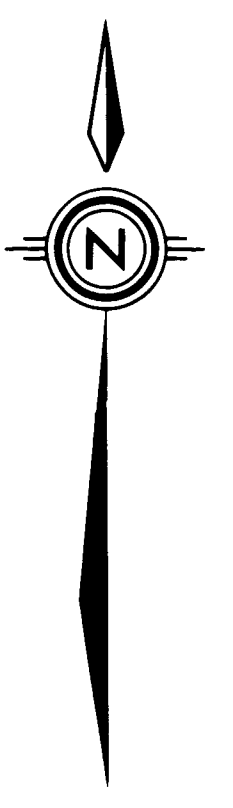

LEGEND

CANADIAN SUPERIOR I.P. SURVEY (Mar. 1970)

■ STRONG ANOMALY

▨ MODERATE ANOMALY

▧ WEAK ANOMALY

NOTE: PLOTTED USING ORIGINAL IMPERIAL GRID NOTATION.

NORANDA AIRBORNE GEOPHYSICS (Jan. 1981)

— 900 — AIRBORNE MAGNETIC SURVEY (Contour Interval 100 nT)

▲ AIRBORNE VLF ANOMALY SHOWING % F.S. INCREASE

ANNAPOLIS, MD SEATTLE, WA.

Part 3 of 3
GEOLOGICAL BRANCH
ASSESSMENT REPORT

18,971

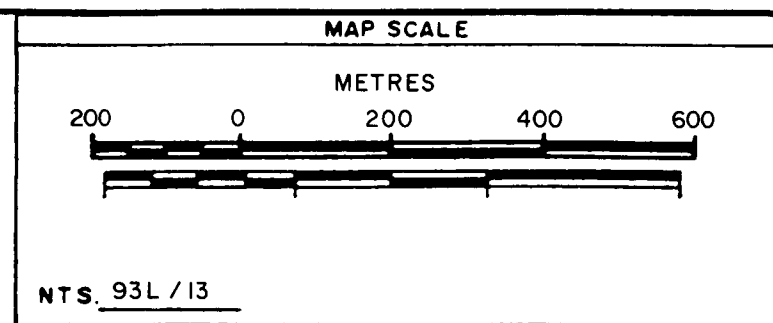

REVISIONS	No	Date	MADE BY	DESCRIPTION
1				
2				
3				
4				
5				

DATE	DRAWN BY	CHECKED	APPROVED
MAR. / 1989	m.k.		

CORONA CORPORATION

OFFICE: _____ DEPARTMENT: _____

LOUISE LAKE PROJECT		
GEOPHYSICAL COMPILATION MAP		
MAP INDEX NUMBER	SCALE	DRAWING NUMBER
	1:10,000	8

MAG. 8724



109 + 00 N
 108 + 00 N
 107 + 00 N
 106 + 00 N
 105 + 00 N
 104 + 00 N
 103 + 00 N
 102 + 00 N
 101 + 00 N
 BL 100 + 00 N
 99 + 00 N
 98 + 00 N
 97 + 00 N
 96 + 00 N
 95 + 00 N
 94 + 00 N

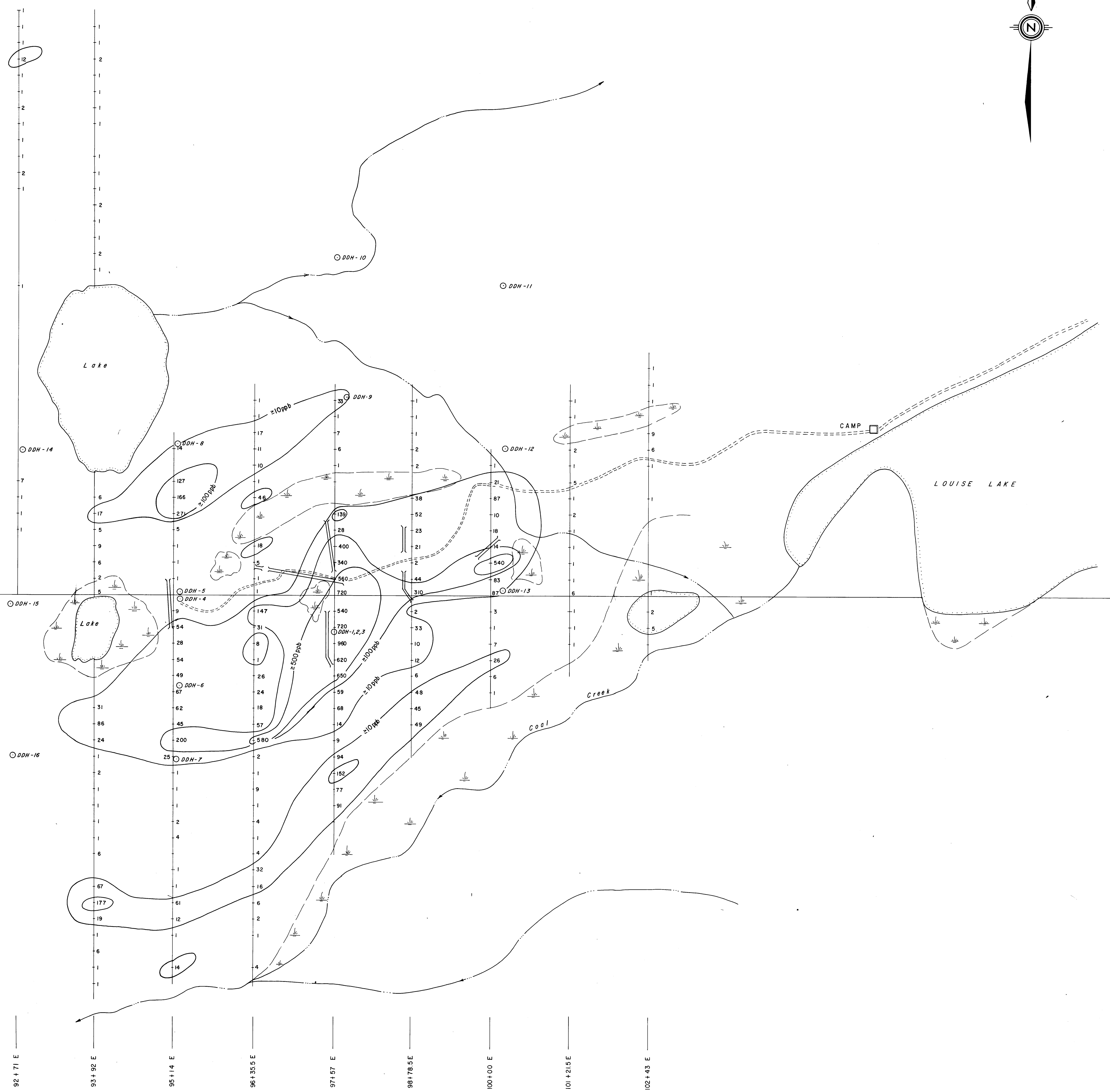

- LEGEND**
- TRENCH (CORONA 1988)
 - DDH-2 DRILL HOLE (CANADIAN SUPERIOR 1971)
 - CREEK
 - + 87 SOIL SAMPLE Au PPB (CORONA 1988)
 - - - - CAT ROAD
 - ~ SWAMP

Part 3 of 3
 GEOLOGICAL BRANCH
 ASSESSMENT REPORT

18,971

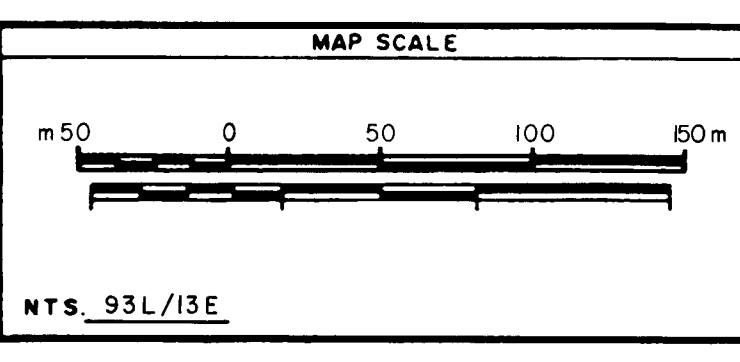

NO	DATE	BY	DESCRIPTION
1			
2			
3			
4			
5			

CORONA CORPORATION

LOUISE LAKE PROJECT	
SOIL GRID	
MAP INDEX NUMBER	DRAWING NUMBER
	7

NTS_33L/13E

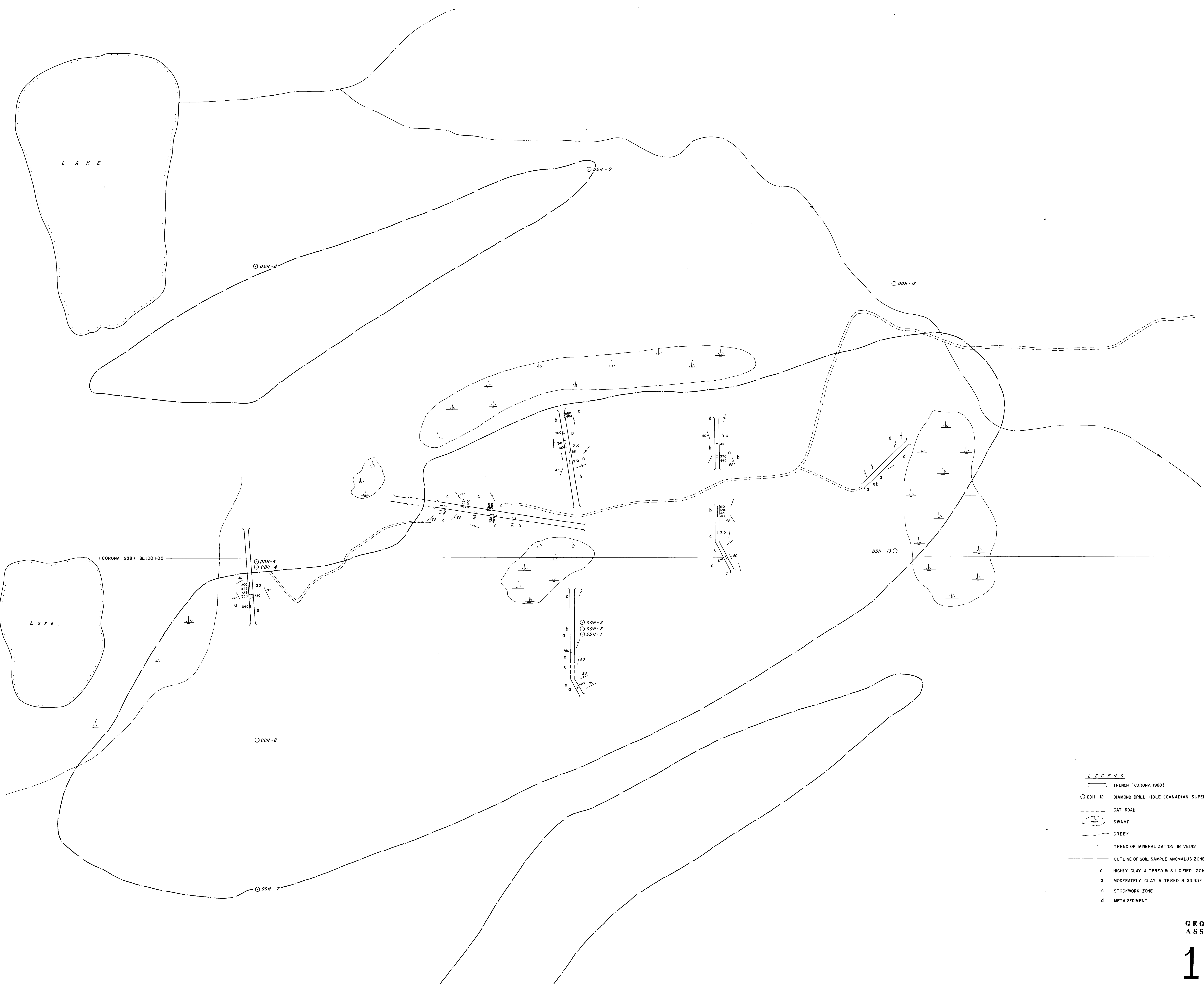

- LEGEND**
- TRENCH (CORONA 1988)
 - DDH - 12 DIAMOND DRILL HOLE (CANADIAN SUPERIOR 1971)
 - - - - CAT ROAD
 - ⊞ SWAMP
 - ~ CREEK
 - + TRENDS OF MINERALIZATION IN VEINS
 - - - - OUTLINE OF SOIL SAMPLE ANOMALOUS ZONES (CORONA 1988)
 - a HIGHLY CLAY ALTERED & SILICIFIED ZONE
 - b MODERATELY CLAY ALTERED & SILICIFIED ZONE
 - c STOCKWORK ZONE
 - d META SEDIMENT

Part 3 of 3
 GEOLOGICAL BRANCH
 ASSESSMENT REPORT
18,971

<p>MAP SCALE</p> <p>NTS 33L/13E</p>	<table border="1" style="width: 100%; border-collapse: collapse;"> <thead> <tr> <th>REV.</th> <th>DATE</th> <th>BY</th> <th>DESCRIPTION</th> </tr> </thead> <tbody> <tr><td>1</td><td></td><td></td><td></td></tr> <tr><td>2</td><td></td><td></td><td></td></tr> <tr><td>3</td><td></td><td></td><td></td></tr> <tr><td>4</td><td></td><td></td><td></td></tr> <tr><td>5</td><td></td><td></td><td></td></tr> </tbody> </table>	REV.	DATE	BY	DESCRIPTION	1				2				3				4				5				<table border="1" style="width: 100%; border-collapse: collapse;"> <thead> <tr> <th>DATE</th> <th>DRAWN BY</th> <th>CHECKED</th> <th>APPROVED</th> </tr> </thead> <tbody> <tr> <td>Nov. 1988</td> <td>J. v. V.</td> <td></td> <td></td> </tr> </tbody> </table>	DATE	DRAWN BY	CHECKED	APPROVED	Nov. 1988	J. v. V.				<p>LOUISE LAKE PROJECT COMPILATION TRENCH MAP</p> <table border="1" style="width: 100%; border-collapse: collapse;"> <tr> <td>OFFICE</td> <td>DEPARTMENT</td> <td>MAP INDEX NUMBER</td> <td>SCALE</td> <td>DRAWING NUMBER</td> </tr> <tr> <td></td> <td></td> <td></td> <td>1:1000</td> <td>6</td> </tr> </table>	OFFICE	DEPARTMENT	MAP INDEX NUMBER	SCALE	DRAWING NUMBER				1:1000	6
REV.	DATE	BY	DESCRIPTION																																											
1																																														
2																																														
3																																														
4																																														
5																																														
DATE	DRAWN BY	CHECKED	APPROVED																																											
Nov. 1988	J. v. V.																																													
OFFICE	DEPARTMENT	MAP INDEX NUMBER	SCALE	DRAWING NUMBER																																										
			1:1000	6																																										

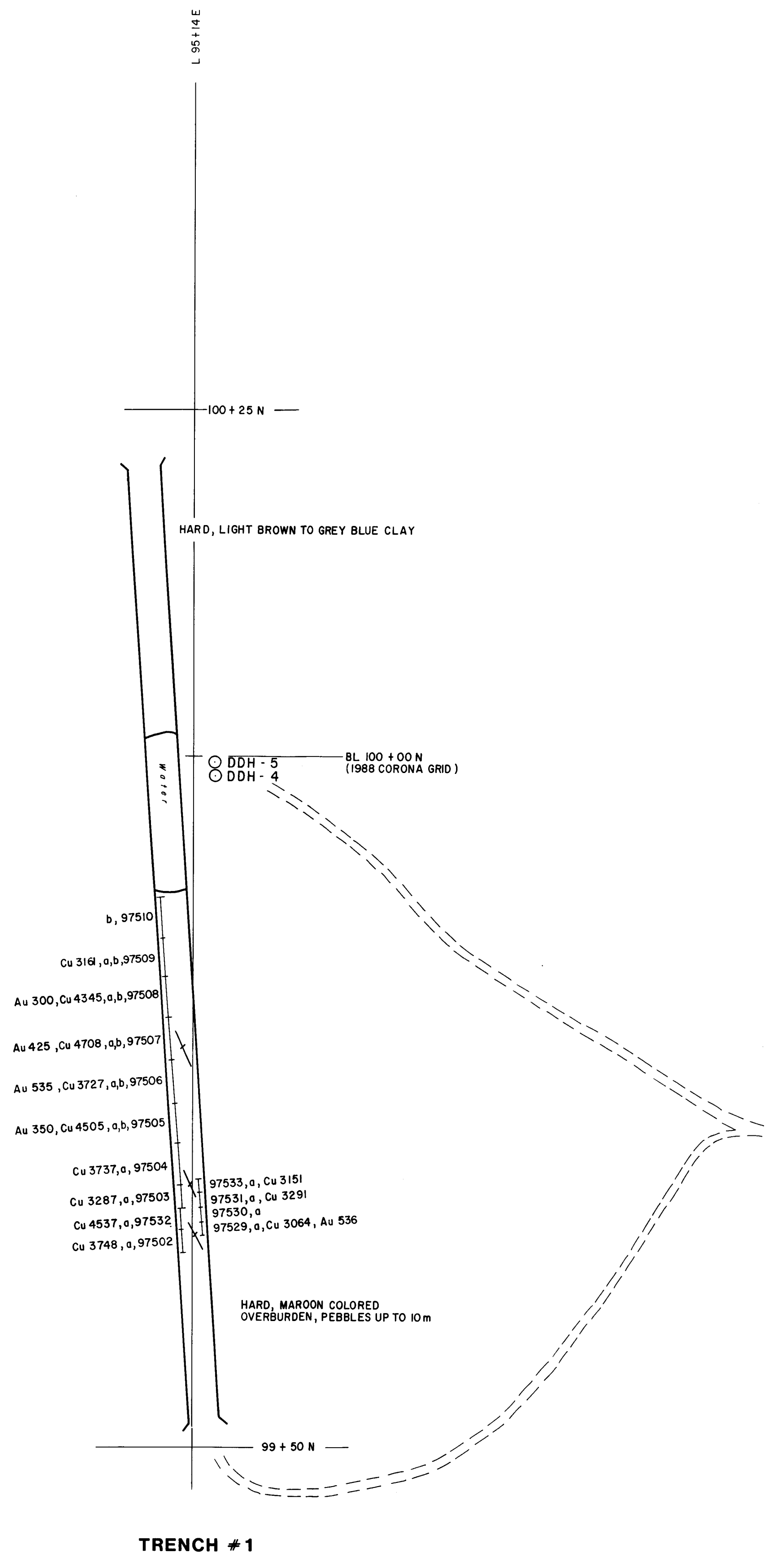
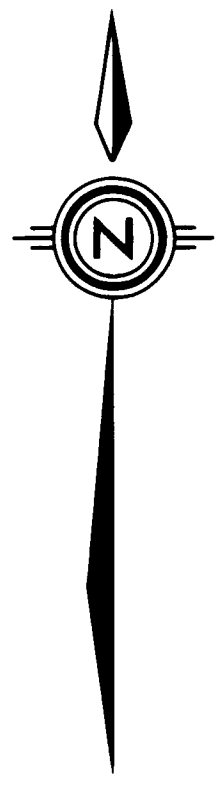

TRENCH #1

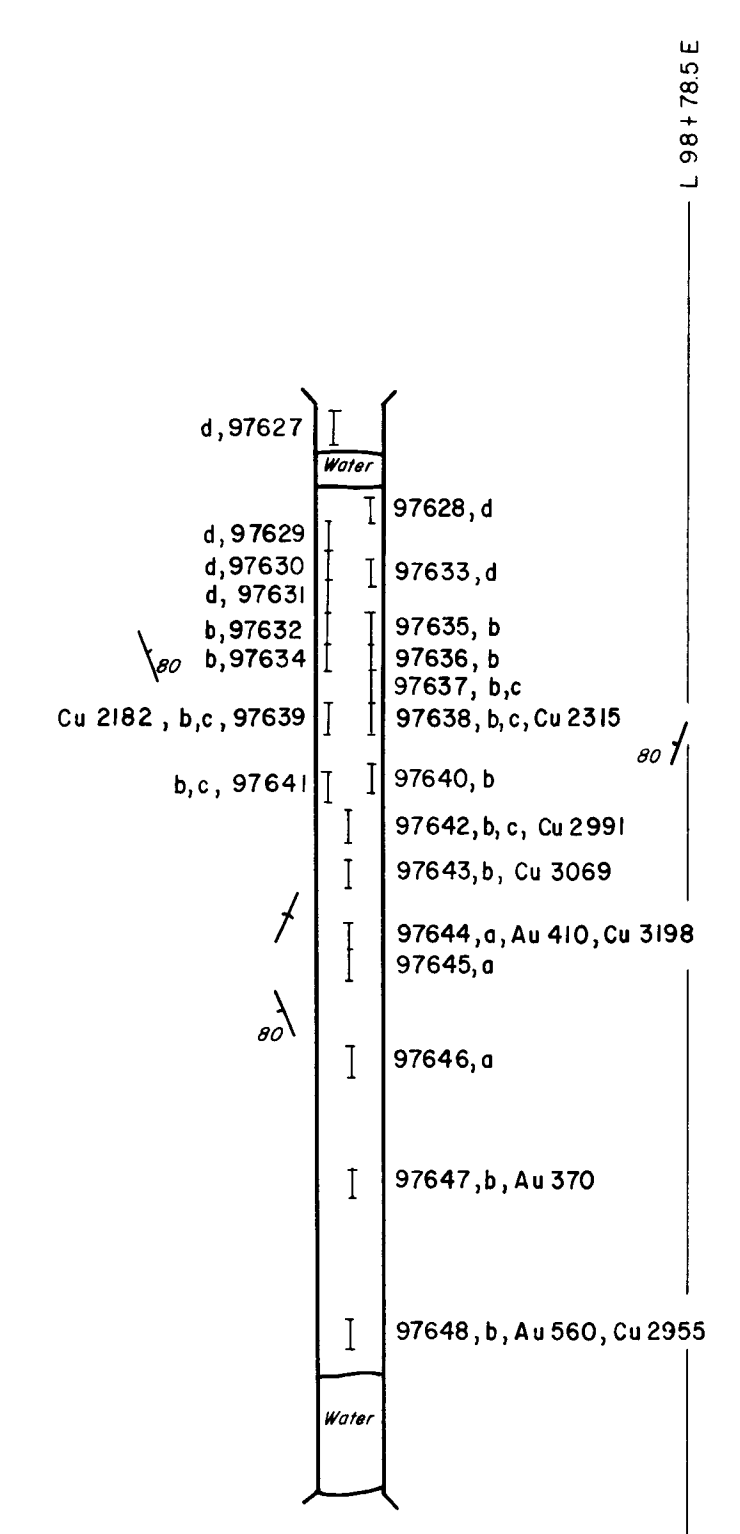

TRENCH #6

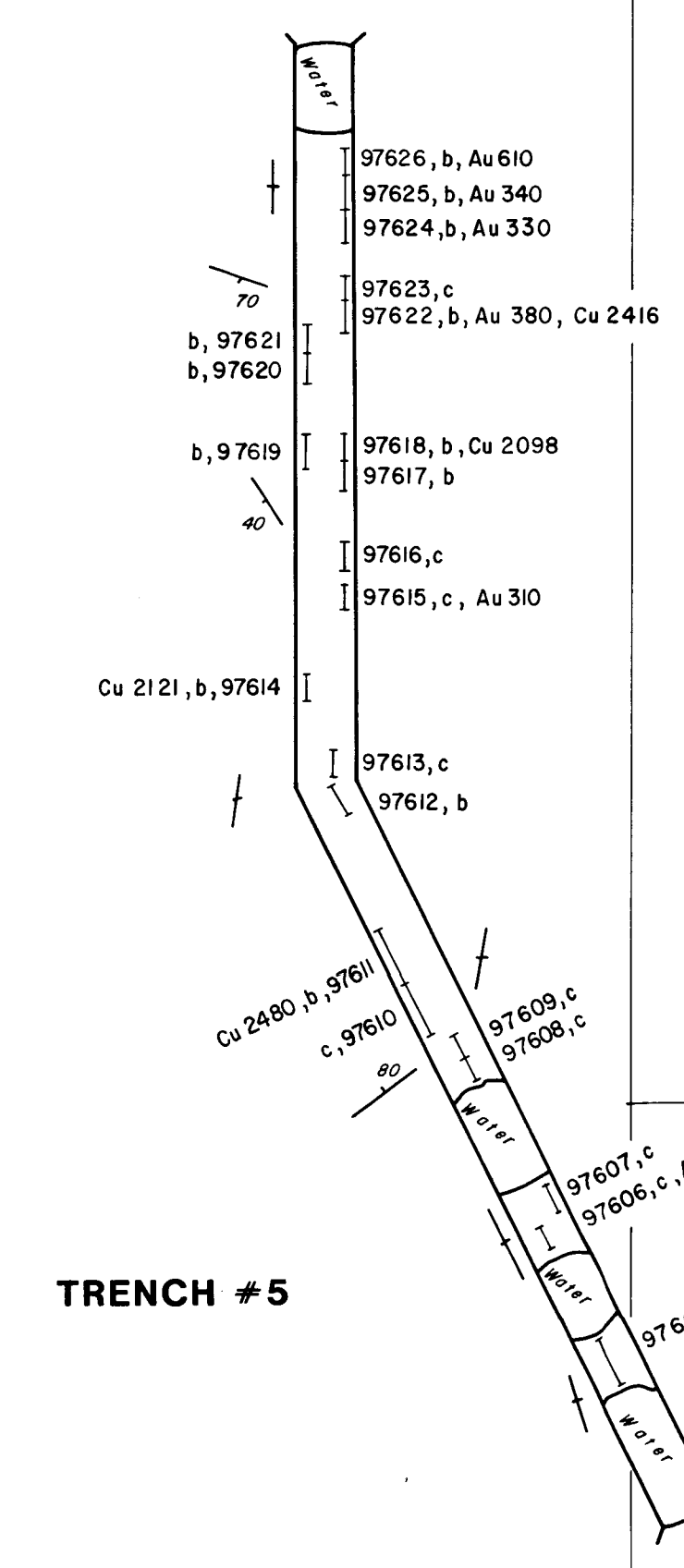

TRENCH #5

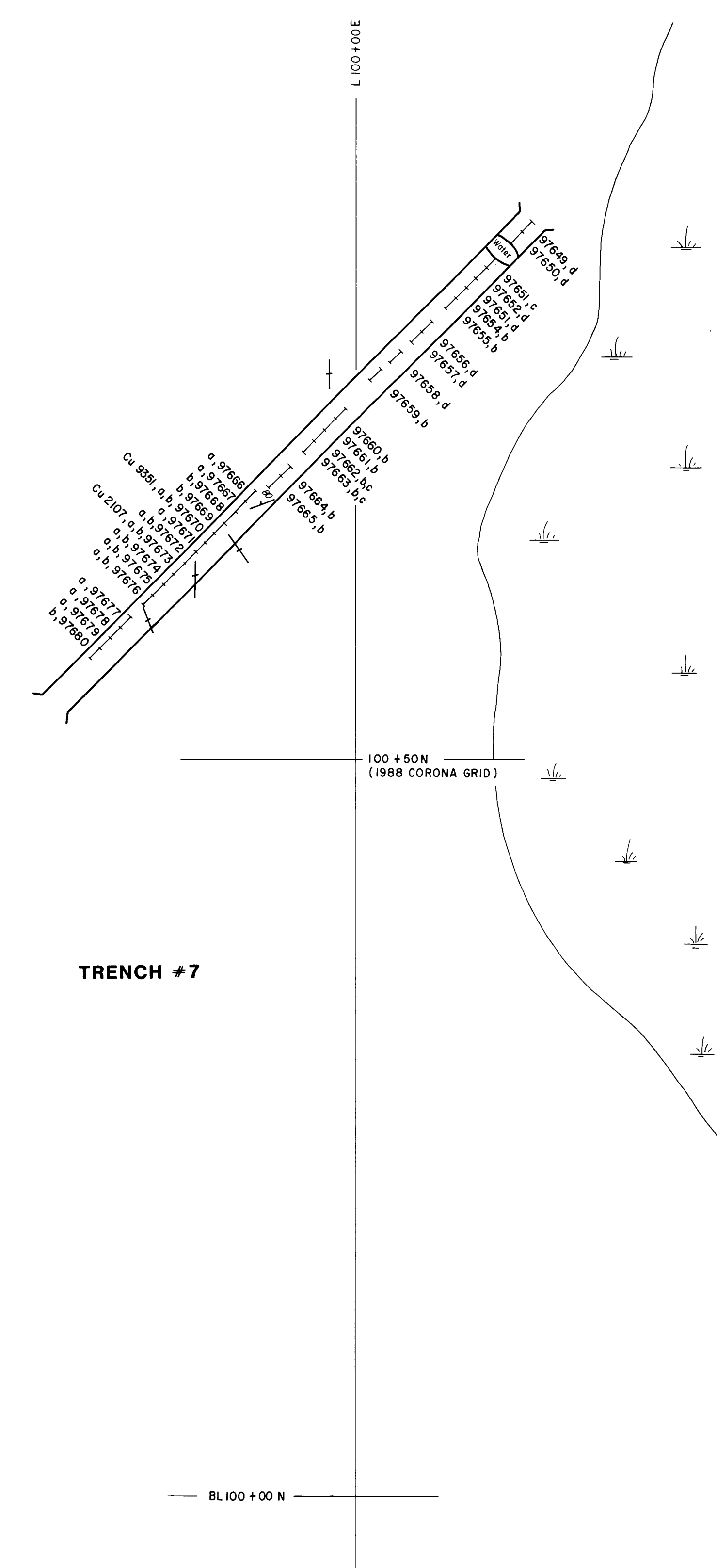

TRENCH #7

- LEGEND**
- 97659 / CHIP SAMPLE
 - c / HIGHLY CLAY ALTERED ZONE
 - b / MODERATELY CLAY ALTERED & SILICIFIED ZONE
 - c / STOCKWORK ZONE
 - d / METASEDIMENT
 - - - - / TREND OF MINERALIZED VEINS
 - ≡ / SWAMP
 - == / ROAD
 - VALUES ≥ 2000 PPM Cu PLOTTED
 - VALUES ≥ 300 PPB Au PLOTTED

Part 3 of 3
GEOLOGICAL BRANCH
ASSESSMENT REPORT

18,971

<p>MAP SCALE 0 5 10 15m</p>	<table border="1" style="width: 100%; border-collapse: collapse;"> <tr> <th>No</th> <th>Date</th> <th>MADE BY</th> <th>DESCRIPTION</th> </tr> <tr> <td>1</td> <td></td> <td></td> <td></td> </tr> <tr> <td>2</td> <td></td> <td></td> <td></td> </tr> <tr> <td>3</td> <td></td> <td></td> <td></td> </tr> <tr> <td>4</td> <td></td> <td></td> <td></td> </tr> <tr> <td>5</td> <td></td> <td></td> <td></td> </tr> </table>	No	Date	MADE BY	DESCRIPTION	1				2				3				4				5				<table border="1" style="width: 100%; border-collapse: collapse;"> <tr> <th>DATE</th> <th>DRAWN BY</th> <th>CHECKED</th> <th>APPROVED</th> </tr> <tr> <td>Nov 1988</td> <td>J.V.V.</td> <td></td> <td></td> </tr> </table>	DATE	DRAWN BY	CHECKED	APPROVED	Nov 1988	J.V.V.			<p>CORONA CORPORATION</p>	<p>LOUISE LAKE PROJECT TRENCHES 1, 5, 6, 7</p>
No	Date	MADE BY	DESCRIPTION																																	
1																																				
2																																				
3																																				
4																																				
5																																				
DATE	DRAWN BY	CHECKED	APPROVED																																	
Nov 1988	J.V.V.																																			
			OFFICE	DEPARTMENT	MAP INDEX NUMBER	SCALE	DRAWING NUMBER																													
						1:250	50																													

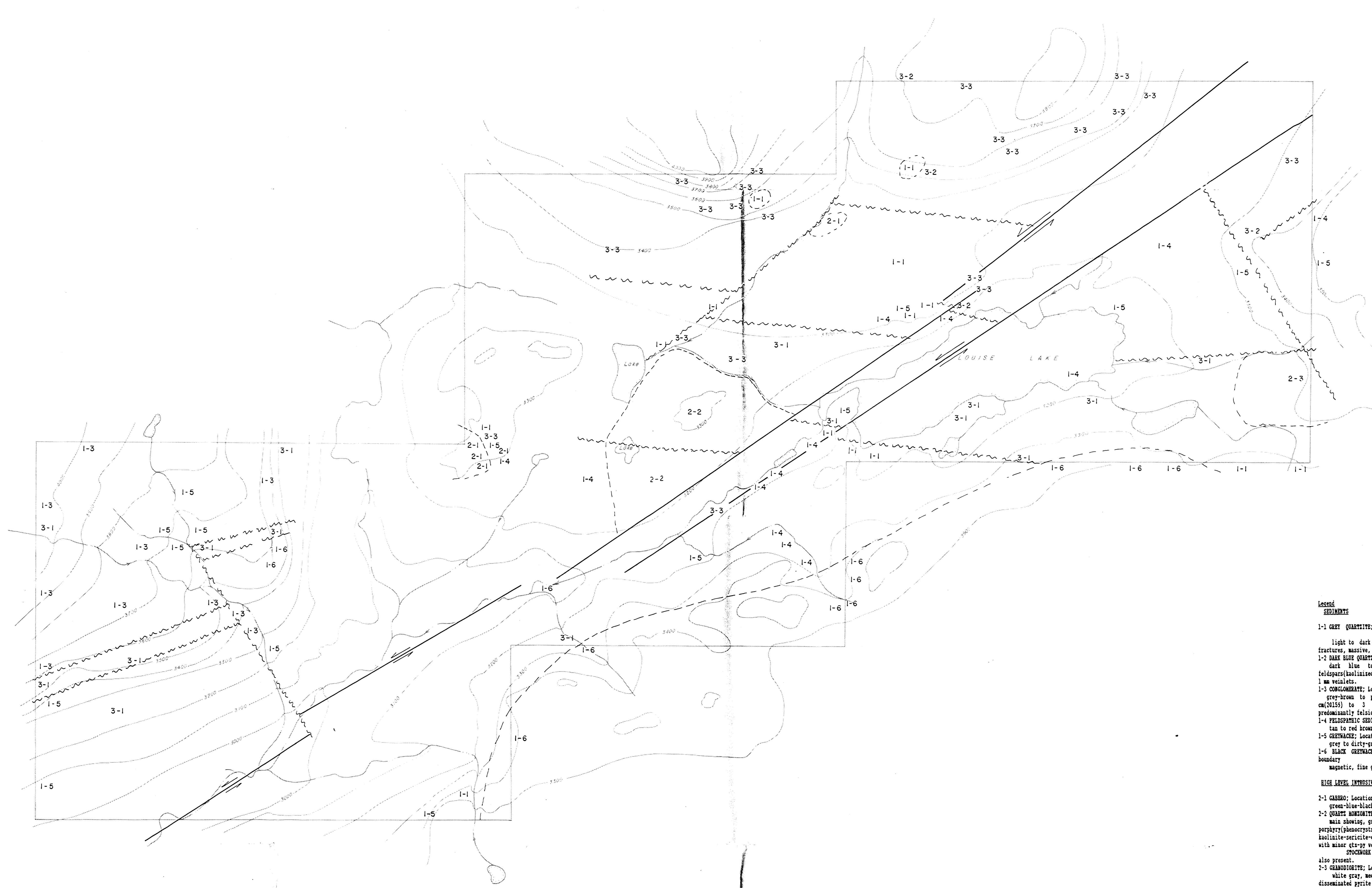

- Legend**
- SEDIMENTS**
- 1-1 **GREY QUARTZITE**; Location: North Shore of Louise Lake
light to dark grey, fine disseminated pyrite (14), conchoidal fractures, massive, occasional trace of carbonization;
 - 1-2 **DARK BLUE QUARTZITE**; Location: 400m West of Louise Lake
dark blue to purple green, conchoidal fracturing, feldspars (kaolinitized), barren to trace pyrite as disseminated and 1 mm veinlets.
 - 1-3 **CONGLOMERATE**; Location: West claim boundary
grey-brown to purple, barren, clasts range in size from 1 cm (1/16) to 1 cm (3/16), ground mass medium grained - predominantly felsic.
 - 1-4 **FELSIPATHIC SEDIMENTS (ARGOSE)**; Location: East claim boundary
tan to red brown to purple, predominantly fine grained
 - 1-5 **GREYWACKS**; Location: West claim boundary
grey to dirty-grey, medium grained, barren
 - 1-6 **BLACK GREYWACKS** intrusives; Location: South Central claim boundary
magnetic, fine grained, carb/sil sweetenets, clasts 1.5 cm
- HIGH LEVEL INTRUSIVE**
- 2-1 **GABBRO**; Location: 2 km west of Louise Lake
green-blue-black, medium grained
 - 2-2 **QUARTZ MONZONITE**; Location: 500m west of Louise Lake
main showing, grey to blue, fine to medium grained, feldspar porphyry/phenocrysts to 3mm diam., pervasive moderate to high kaolinite-sericite-quartz alteration, disseminated py up to 5% with minor qtz-py veinlets (1mm-1cm).
STOCKWORK ZONE with a high density of qtz-py veinlets also present.
 - 2-3 **GRANODIORITE**; Location: east claim boundary
white grey, medium grained, feldspar phenocrysts, biotite, disseminated pyrite up to 5%, 140 shear zones with pyrite up to 10%, weak carbonate and kaolinite alteration.
- VOLCANICS**
- 3-1 **ANDESITE**; Location: NW of Louise Lake
purple-black intermediate-mafic volcanic
 - 3-2 **BIOTITE VOLCANIC**; Location: North shore of Louise Lake
pink-tan brown with up to 5mm biotite crystals and books, weathers blue-purple
 - 3-3 **POPHYRYTIC VOLCANIC**; Location: North claim boundary
green-purple weathers pink, fine to medium grained, occasional conchoidal fractures, feldspar phenocrysts 3-4mm. Trace pyrite.
- 1-6 **ROCK TYPE** (See descriptions)
- **CREEK**
- **CONTOUR INTERVAL 100'**
- **REGIONAL FAULT**
- **FAULT**
- **CONTACT (inferred)**

18,971
 Geological Branch
 Assessment Report
 Part 3 of 3

MAP SCALE NTS_93L/ISE	<table border="1" style="width: 100%; border-collapse: collapse;"> <thead> <tr> <th>No.</th> <th>Date</th> <th>Made By</th> <th>Description</th> </tr> </thead> <tbody> <tr><td> </td><td> </td><td> </td><td> </td></tr> <tr><td> </td><td> </td><td> </td><td> </td></tr> <tr><td> </td><td> </td><td> </td><td> </td></tr> <tr><td> </td><td> </td><td> </td><td> </td></tr> </tbody> </table>	No.	Date	Made By	Description																	<table border="1" style="width: 100%; border-collapse: collapse;"> <thead> <tr> <th>Date</th> <th>Drawn By</th> <th>Checked</th> <th>Approved</th> </tr> </thead> <tbody> <tr> <td>JAN. 1989</td> <td>Jan</td> <td> </td> <td> </td> </tr> </tbody> </table>	Date	Drawn By	Checked	Approved	JAN. 1989	Jan			 CORONA CORPORATION	LOUISE LAKE PROJECT 1988 MAPPING GEOLOGY	<table border="1" style="width: 100%; border-collapse: collapse;"> <tr> <td>OFFICE</td> <td>DEPARTMENT</td> <td>MAP INDEX NUMBER</td> <td>SCALE</td> <td>DRAWING NUMBER</td> </tr> <tr> <td> </td> <td> </td> <td> </td> <td>1:40,000</td> <td>4</td> </tr> </table>	OFFICE	DEPARTMENT	MAP INDEX NUMBER	SCALE	DRAWING NUMBER				1:40,000	4
No.	Date	Made By	Description																																								
Date	Drawn By	Checked	Approved																																								
JAN. 1989	Jan																																										
OFFICE	DEPARTMENT	MAP INDEX NUMBER	SCALE	DRAWING NUMBER																																							
			1:40,000	4																																							

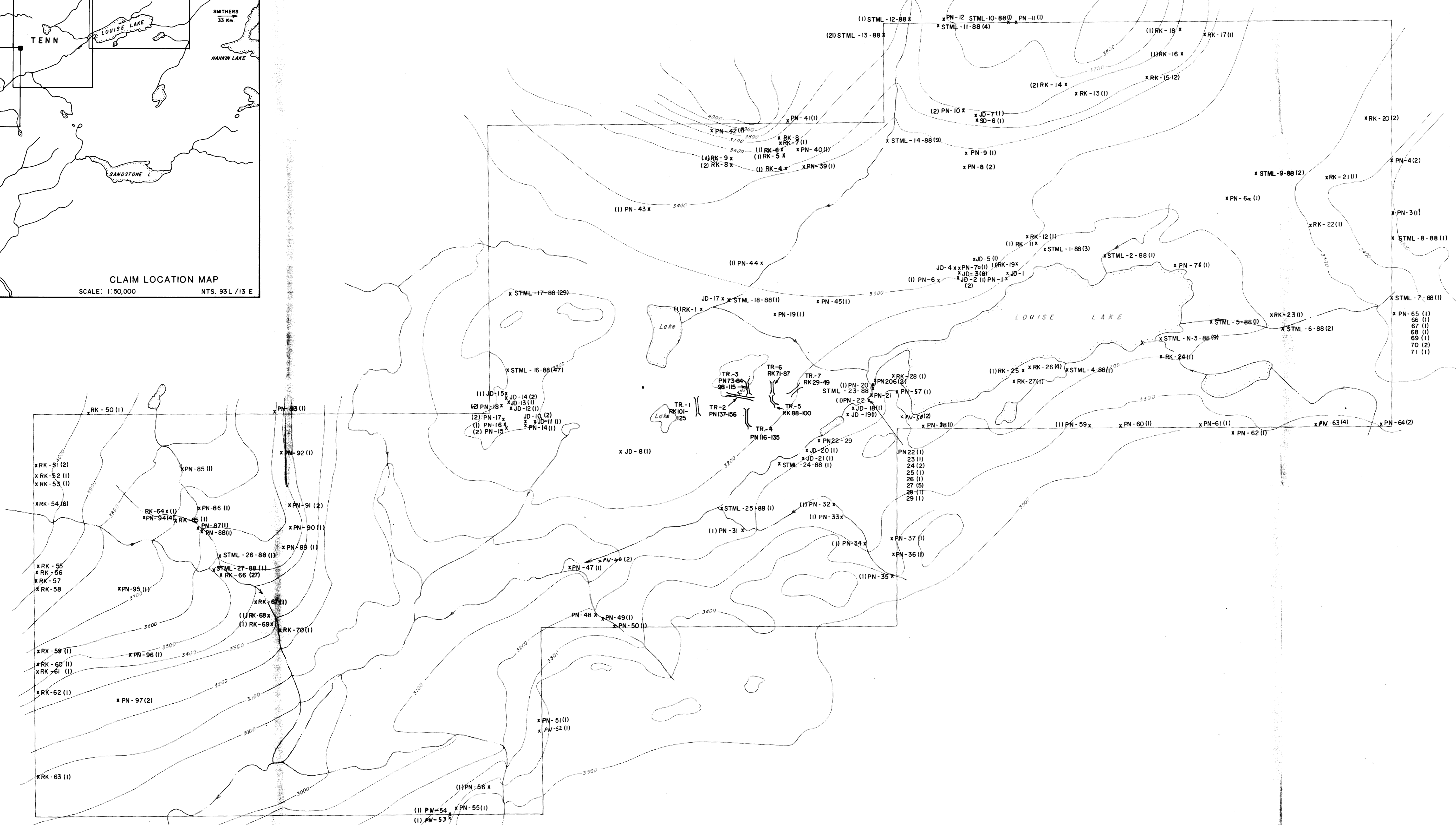
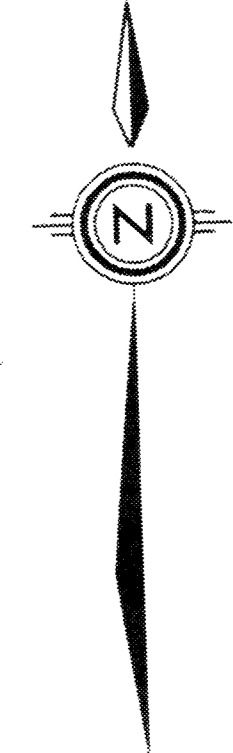
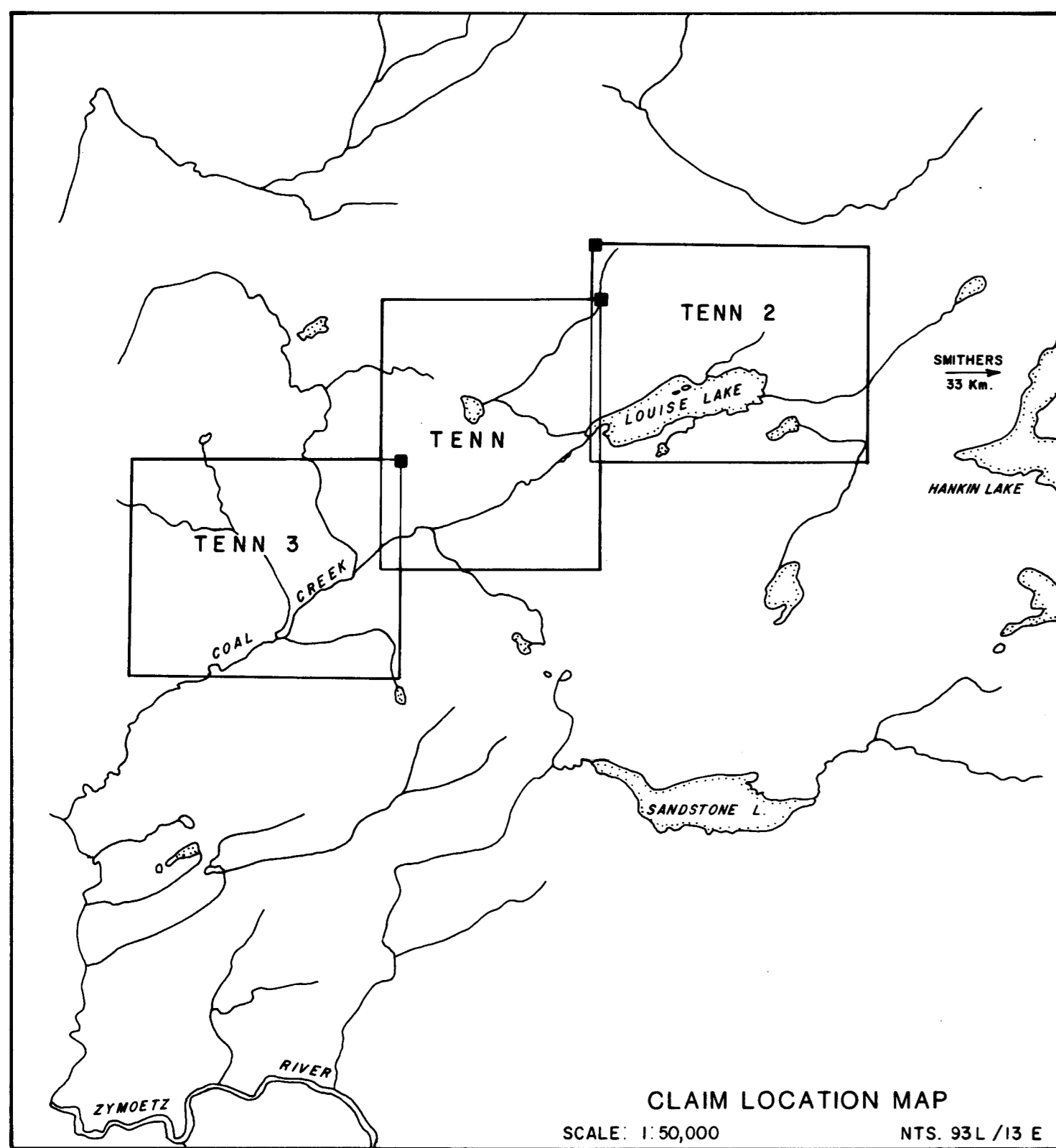

LEGEND

- TR-3 TRENCH
- xSTML-27-88 (2) 1988 SILT SAMPLE (Au-ppb)
- xPN-59 (2) 1988 ROCK SAMPLE (Au-ppb)

Part 3 of 3
**GEOLOGICAL BRANCH
 ASSESSMENT REPORT**

18,971

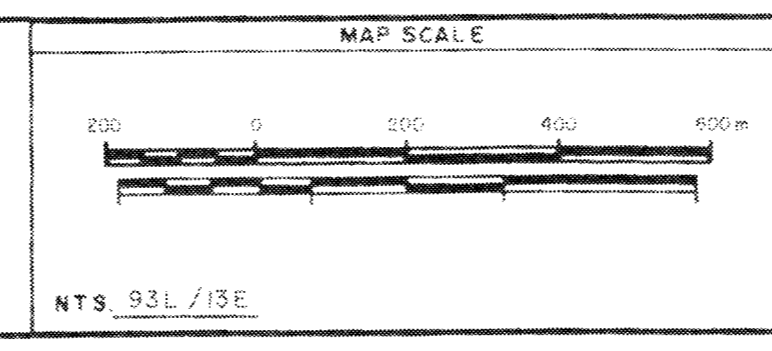

REV.	DATE	BY	DESCRIPTION
1			
2			
3			
4			
5			



LOUISE LAKE PROJECT		
1988 MAPPING		
SAMPLE LOCATIONS		
MAP INDEX NUMBER	SCALE	DRAWING NUMBER
	1:10,000	3

UNCL. 93L/13E

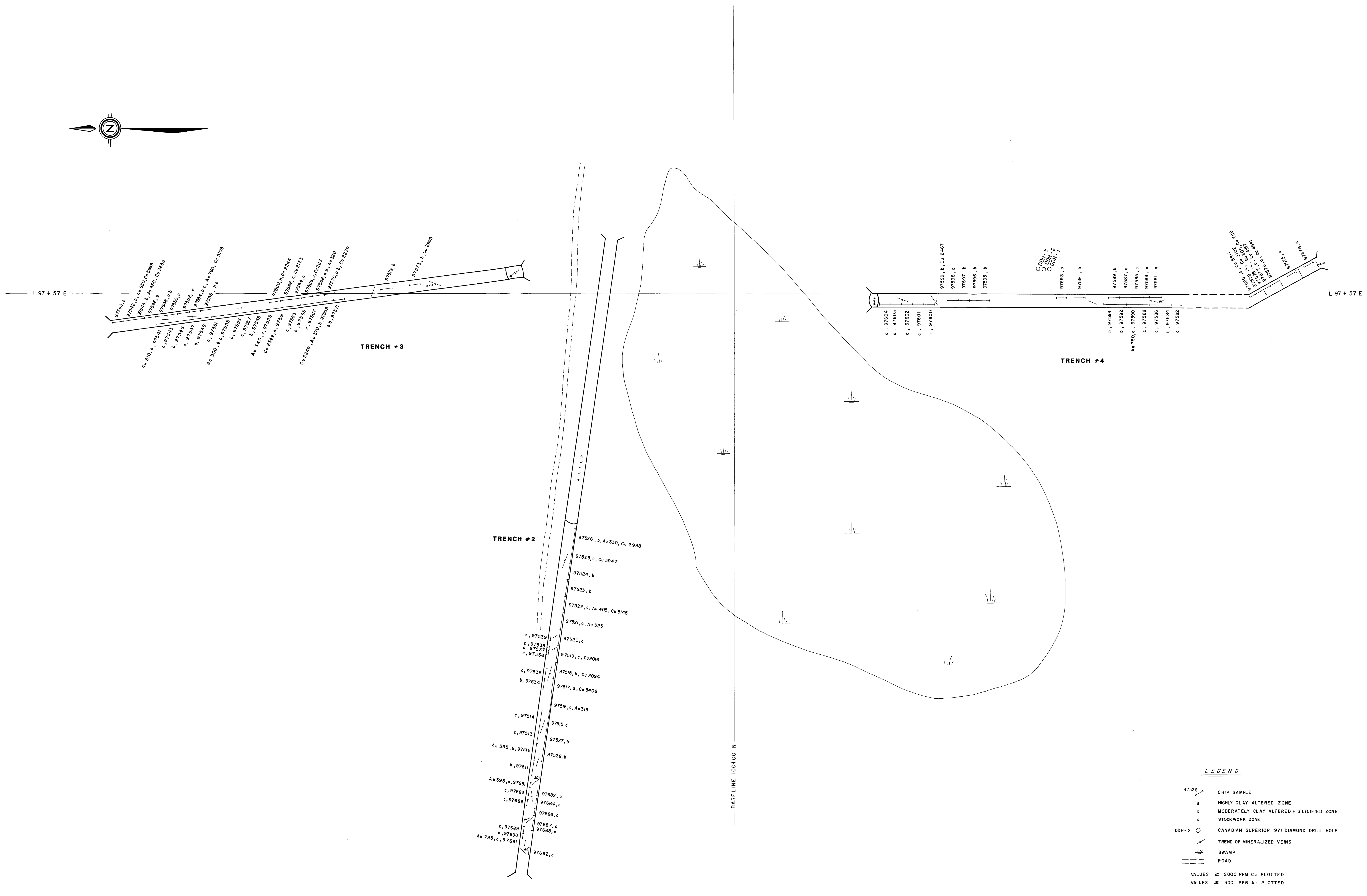
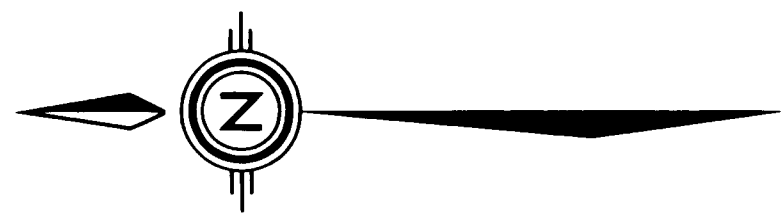

- LEGEND**
- 97526 / CHIP SAMPLE
 - o / HIGHLY CLAY ALTERED ZONE
 - o / MODERATELY CLAY ALTERED + SILICIFIED ZONE
 - o / STOCKWORK ZONE
 - DDH-2 / CANADIAN SUPERIOR 1971 DIAMOND DRILL HOLE
 - o / TREND OF MINERALIZED VEINS
 - o / SWAMP
 - / ROAD
- VALUES ≥ 2000 PPM Cu PLOTTED
VALUES ≥ 300 PPB Au PLOTTED

Part 3 of 3
**GEOLOGICAL BRANCH
 ASSESSMENT REPORT**
 18,971

MAP SCALE 	NO. / DATE / MADE BY / DESCRIPTION 1 / Nov 1988 / J. V. V. /	LOUISE LAKE PROJECT TRENCHES 2, 3, 4
	CORONA CORPORATION OFFICE / DEPARTMENT / MAP INDEX NUMBER / SCALE / DRAWING NUMBER Nov 1988 / J. V. V. / 5b	