

LOG NO: 0914	89
ACTION:	
FILE NO:	

DRILLING REPORT
ON
CEDAR 1A, CEDAR 3A, DOGWOOD 1A, DOGWOOD 4 GROUPS

PREPARED FOR
R.H. STANFIELD

FILMED

BY:
ALFRED R. ALLEN, P.ENG.
ALLEN GEOLOGICAL ENGINEERING
827 WEST PENDER STREET
VANCOUVER, B.C.
V6C 3G8

DATED AUGUST 24, 1989

GEOLOGICAL BRANCH
ASSESSMENT REPORT

19,034

CONTENTS

TITLE PAGE AND SUMMARY

A.	INTRODUCTION	3
B.	PROPERTY	3
C.	LOCATION	3
D.	PHYSIOGRAPHY	4
E.	PREVIOUS WORK	4
F.	GEOLOGY	4
G.	THEORY	5
H.	OBJECT OF THE DRILLING PROGRAM	5
I.	CYCLONE ROTARY AIR-MUD DRILLING	5
J.	DRILLING RESULTS	6
K.	ROAD WORK AND EROSION CONTROL	6
L.	SUMMARY	7
	REFERENCES	8
	COSTS STATEMENT #1	9
	COSTS STATEMENT #1 DETAILED	10
	COSTS STATEMENT #2	11

MAPS:	1. LOCATION	
	2. CLAIMS, DRILLHOLES, MINERAL WORKINGS AND SHOWINGS	
	3. ROAD WORK AND	
	4. CEDAR 3 CLAIM	
	5. CEDAR 8 CLAIM	
	6. DOGWOOD 10 CLAIM	
	7. DOGWOOD 12 CLAIM	

A. INTRODUCTION

The Cedar 1A claims group includes the Cedar 1, 2, 3, 4, 5. A vertical Rotary hole was drilled on the Cedar 3 claim, December 12-14, 1988. Road work and erosion control was also completed over the Cedar 1, 3 and 5 claims area. A hole was drilled on the Cedar 8 claim of the Cedar 3A group June 18-19, 1988.

Four Rotary holes were drilled on the Dogwood 12 claim of the Dogwood 1A Group. Road work and erosion control was completed over the Dogwood 9 and 11 claims June 18, 1988 - June 15, 1989. Drilling was conducted June 22-23, 1988 and Nov 10-22, 1988.

The Dogwood #4 group includes the Dogwood 8 and 10 claims. Four holes were drilled on the Dogwood 10 claim November 23-28 and December 7-11, 1988. Road work and erosion control was conducted June 18, 1988 - June 15, 1989.

B. PROPERTY

<u>Group</u>	<u>Claim</u>	<u>Record No.</u>	<u>Area</u>	<u>Expiration Dates</u>
1-A	Cedar 1	205	20	17-06-92
	Cedar 2	206	20	17-06-92
	Cedar 3	207	20	17-06-92
	Cedar 4	715	20	24-07-92
	Cedar 5	209	20	17-06-92
3-A	Cedar 6	485	20	17-06-93
	Cedar 7	211	20	17-06-93
	Cedar 8	212	20	17-06-93
	Cedar 9	213	20	17-06-93
	Cedar 11	234	20	17-06-93

C. LOCATION

The R.H. Stanfield property is located in the East Kootenay area of British Columbia, in the Fort Steele Mining Division. Cranbrook is 30 Kilometres West, and Fernie is 35 Kilometres northeast via Highway #3. The area is serviced by Canadian Pacific Railway, and Air service is available from Vancouver to Cranbrook. The Stanfield camp is located on the northeast area of the Cedar #1 claim.

<u>Group</u>	<u>Claim</u>	<u>Record No.</u>	<u>Area</u>	<u>Expiration Dates</u>
Dogwood 1A	9	226	20	17-06-92
	11	228	20	17-06-92
	12	229	20	17-06-92
	14	230	20	17-06-92
Dogwood #4	8	225	20	17-06-95
	10	227	20	17-06-95

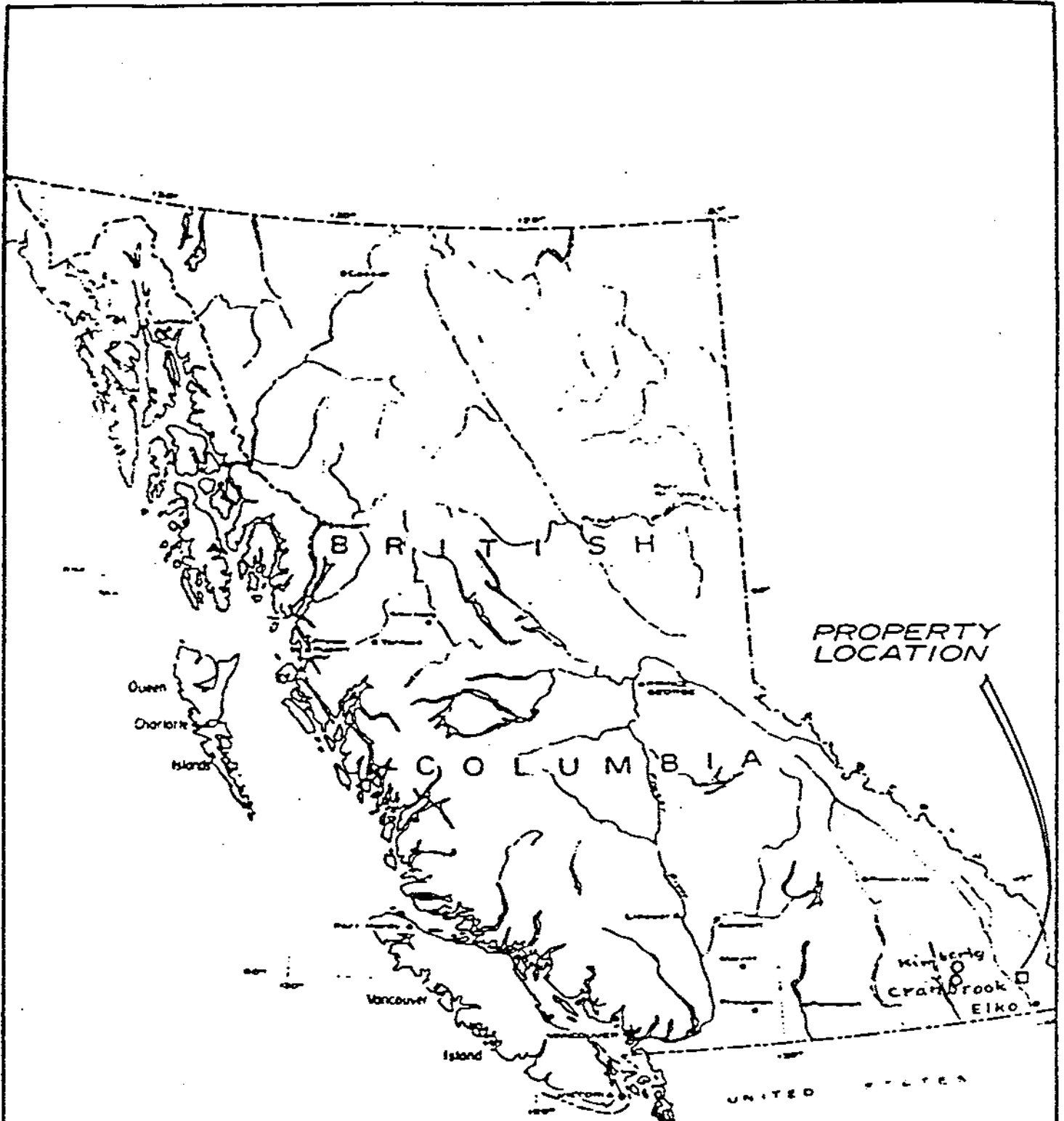

R.H. STANFIELD PROPERTY

LOCATION MAP

SCALE: 1" = 136 MILES

Drawn by	Dsf-8/2/88	ALLEN GEOLOGICAL
Checked by	DRS-1	ENGINEERING LTD.

D. PHYSIOGRAPHY

Cedar 1-4, 6, and all but the northeast corner of the Cedar 8 are located within the Rocky Mountain Trench. Within the Trench, but extending up the steep westerly slopes of the Lizard Range are the Cedar 5, 7, 8 and 10, and Dogwood 9, 10 and 12 claims. The Cedar 9 and 11, and Dogwood 9, 11 and 14 are within the Rocky Mountains.

Elevations range from 884 metres in the Trench to 2,134 metres of the peaks to the east.

Sand creek flows southwest across the Dogwood 7, 8 and 9 claims and south to the Kootenay River. Little Sand Creek flows across the Cedar 2, 4, 6 and 8 claims south to Sand Creek.

Rosen Lake is located on the Cedar 3 and 4 claims at 863 metres above sea level.

E. PREVIOUS WORK

Leech G.B. Fernie Map Area, West Half
G.S.C. Paper 58-10, Map 20, 1958
Leech G.B. Southern Rocky Mountain Trench
C.I.M.M. Vol LXII pp 154-174, 1972
Allen A.R. Drillhole C-1-85 Road Work and Erosion Control
Allen A.R. Rotary Drilling Report Cedar 3 Group, Cedar 6, 9, 11
Allen A.R. Stanfield Reports 1969-1988

F. GEOLOGY

The Cedar 2, 4 and 6, and Dogwood 8 claims are located within the Rocky Mountain Trench where bedrock exposures are minimal.

The Aldridge formation is exposed on the Cedar 1, 3, 5, 7, 9 and 11 and on the Dogwood 12 and 14 claims.

Upper Devonian and Mississippian formations outcrop on the Dogwood 10 and 11 claims. The Aldridge beds strike south to southwest and dip 5 to 45 degrees northeast.

Fault zones are evident striking southeast from the northwest Cedar 8 to the southeast corner of the Cedar 1, and from the northwest area of the Dogwood 11 to the southeast corner of the Cedar 1 claim.

Mineral showings are partly exposed on the following claims:

Cedar 3 - Rex and Dean - Cu, Au, Ag: Cedar 8-G-zone: Ag, P6:
Cedar 10 - Great Western - Au, Ag, P6
Dogwood - 9 & 10 Strathcona Empire - Cu, Ag, Au: Dogwood 9 - Burt - Ag,
Pb, Zn: Dogwood II-OK-Ag, P6, Zn, Dogwood-8-Treasure A, Ag, Au

G. THEORY

Rotary drill hole G-3-88 between the Rex and Dean copper, silver, gold showings, and 3 Kilometres west of the Strathcona - Empire workings and Burt silver, lead, zinc showings.

This area is underlain by the Aldridge formation, as evidenced by several exposures.

The hole is located between two major faults. Theoretically it is prime location for mineral deposition, similar to the above noted copper, gold silver, and silver, lead, zinc showings.

H. OBJECT OF THE DRILLING

The C8 G-1-88 hole was located to check the area on the north side of the G silver lead-zinc zone. The D10-1-88 and D10-P1 and D10-P2 holes were drilled to check the area west of the Strathcona-Empire copper, gold, silver workings, and the D1-88, D2-88, D12-1 and D12-2 holes were drilled to check the area northwest of Strathcona - Empire workings, and Rex copper, silver-gold showings.

I. CYCLONE ROTARY AIR-MUD DRILLING

The C3-88 vertical hole was drilled in the central east area of the Cedar 3 claim. December 12-14, 1988 between the Rex and Dean showings of copper, silver, gold mineralization.

The C8 G1-88 vertical hole was drilled at the northeast corner of the Cedar 8 claim, on the northwest side of the high grade silver, lead G zone.

The D10 1-88, D10 2-88 and D10 PP-1, D10 PP-2 vertical holes were drilled in the northwest quarter of the Dogwood 10 claim, November 23-28 and December 7-11, 1988 on the northwest side of the Strathcona-Empire copper, gold, silver workings.

The D12-1-88, D12-2-88, D1-88, D2-88 vertical holes were drilled in the southwest area of the Dogwood 12 claim November 10-22, 1988 and June 22-23, 1988, north of the Rex and Dean, copper, silver, gold showings.

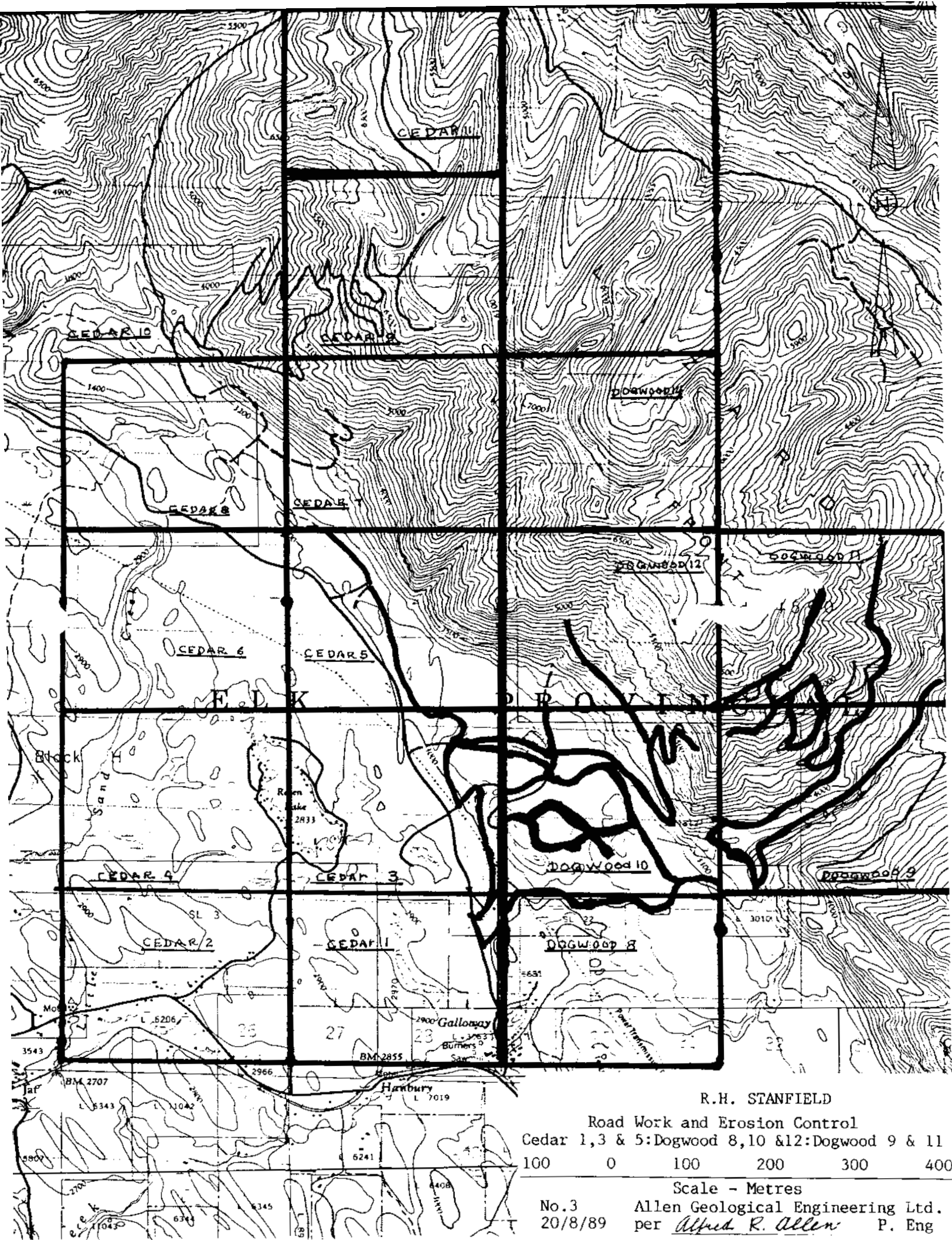

R.H. STANFIELD

Road Work and Erosion Control
 Cedar 1,3 & 5: Dogwood 8,10 &12: Dogwood 9 & 11
 100 0 100 200 300 400

Scale - Metres

No.3
 20/8/89

Allen Geological Engineering Ltd.
 per *Alfred R. Allen* P. Eng

J. DRILLING RESULTS

<u>Group</u>	<u>Claim</u>	<u>Hole Number</u>	<u>Depth</u>	<u>Log</u>
1A	Cedar 3	C3-88	71.6M	Overburden
3A	Cedar 8	C8-G-1-88	141.1M	Black Argillite-Aldridge
1A	Dogwood 12	D1-1-88	25.9	Overburden
		D2-2-88	71.6	Overburden
		D1-88	12.1	Overburden
		D2-88	18.2	Overburden
4	Dogwood	D10-1	41.1	Overburden
		D10-2	40.2	Overburden
		D10-PP1	31.0	Overburden
		D10-PP2	92.0	Overburden
			544.8M	

K. ROADWORK - EROSION CONTROL AND SITE PREPARATION**Cedar 1-5**

Road clearing, grading and widening was completed from the northeast corners of Cedar 1 claim to the northwest area of Cedar 5 claim. A total length of 7.5 Kilometres and width of 6 Metres. Culverts were cleared and repaired and water bars cleared. Erosion control was maintained.

Dogwood 8-10

Road clearing, grading, and widening was completed on the Dogwood 8 and 10 claims over a length of 18 Kilometres and width of 6 Metres. Culverts were cleared and repaired and water bars cleared. Erosion control was maintained.

Dogwood 9-11-12

Road clearing, grading and widening was completed on the Dogwood 9, 11 and 12 claims, and erosion control maintained.

REFERENCES

- Leech G.B., Fernie Map Area, West Half,
G.S.C. Paper 58-10, Map 20, 1958
- Leech G.B., International Geological Congress
Twenty-fourth Session, Canada 1972
Field Excursion A03 - Co3 pp 21-26
- Leech G.B., T CIMM V LX 11 pp 154-174
Southern Rocky Mountain Trench
- Allen, A.R., The Bull River Copper-Silver-Gold Mine,
June 7, 1976
- Chiang, M.C., Placid Oil Company, Reports, 1973-1976
- Allen, A.R., R.H. Stanfield, Rotary Drilling, Bull River
Property, March 1985

**COSTS STATEMENT #1
CYCLONE ROTARY AIR-MUD
DRILLING**

R. H. STANFIELD
BY CONTRACT

Location: Cedar Groups 1A and 3A, Dogwood Groups 1A and 4

Dates: Dec. 12-14, 1988, June 18-19, 1988, June 22-23, 1988, Nov 10-22, 1988

Crew: Don Murray, Driller Strathmore, Alberta
Randy Miller, Helper Strathmore, Alberta
Jason Raber, Helper Strathmore, Alberta
R. Stanfield Jr, Co-Ordinator Galloway, B.C.
R.H. Stanfield, Foreman Calgary, Alberta

Don Murray, Driller
Lewis Waklem, Driller
R. Stanfield Jr., Co-Ordinator
R.H. Stanfield, Foreman

Equipment: C.C.C. Truck with TH60 I.R. Drill and accessories
1 Mac Tandem water truck
1 Ford 750 casing truck
1 Toyota crew truck
Stanfield Ford 250 3/4 ton truck

Total Drilling
Costs: \$103,108.34

L. SUMMARY

Rotary hole C3-88 was drilled in the central eastern area of the Cedar #3 claim to a depth of 71.6M, between the Rex and Dean copper, silver, gold showings.

Rotary hole C8 G-1-88 on the northeast area of Cedar 8 claim to a depth of 141.1M. It is collared 250 Metres northwest of the highgrade silver, lead G Zone. The hole penetrated black argillite of the Aldridge formation.

Rotary holes D1-01-88, D1-02-88 and D10-P1 and P-2 were drilled in the northwest quarter of the Dogwood 10 claim, 1500 Metres northwest of the Strathcona Empire workings. The four holes were drilled to depths of 41.1, 40.2 and 92 Metres. The holes are 3 Metres apart.

Rotary holes 12-1 and 12-2-88 and D-1-88 and D-2-88 are collared on the southwest quarter of the Dogwood 12 claim, 2500 Metres northwest from the Strathcona Empire copper, gold workings. The holes are spaced 3 Metres apart and drilled to 25.9, 71.6, 12.1 and 18.2 Metres depth. Holes C3-88, and those on Dogwood 10 and 12 claims did not penetrate bedrock.

Respectfully submitted

ALLEN GEOLOGICAL ENGINEERING LTD.

Per Alfred R. Allen, P.Eng.
Alfred R. Allen

August, 1989

Detailed
Costs Statement #1
Cyclone Rotary Air-Mud Drilling

Mob 8 Demob.	Group	Accommodation and Meals	Truck & Coordinator	Site Prep. & Clean up	Consulting	Drilling	Total Costs
1,000	Cedar 1A	180	440	155	800	13,360.20	14,160.20
1,000	Cedar 3A	520	340	155	805	20,741.70	24,019.44
1,000	Dogwood 4	2,600	1,700	155	830	30,032.10	37,517.10
1,000	Dogwood 1A	3,120	2,000	155	870	18,786.60	27,411.60
4,000		7,020	4,480	620	3,305	82,920.60	\$103,108.34

Alfred R. Allen

**COSTS STATEMENT #2
ROAD WORK EROSION CONTROL AND SITE PREPARATION**

R.H. STANFIELD

Location: Cedar 1-5 Cedar 1A Group

Length: 7.5 Kilometres

Crew, Accommodation and Meals - 3 Men @ \$65/day x 7 days	\$1,365.00
Foreman - \$15/hour - 56 hours	840.00
D9H Bulldozer and ripper	3,094.00
HD16 A.C. 11 - \$70/hour x 24 hours	1,680.00
Champion \$740 Grader - \$55/hour x 32 hours	1,760.00
Truck 3/4 ton 4X4 - \$50/day x 7 days	350.00
Power Saw - \$18/day x 7 days	<u>126.00</u>
	\$9,215.00

R.H. STANFIELD

Location: Dogwood 8 & 10, Dogwood 4 Group

Length: 10.6 Kilometres

Crew, Accommodation and Board - 3 Men @ \$65/day x 11 days	\$ 2,145.00
Foreman - \$15/hour x 90 hours	1,350.00
HD16 AC Bulldozer - \$70/hour x 88 hours	6,160.00
Champion 740 Grader - \$55/hour x 24 hours	1,320.00
Truck 3/4 Ton 4X4 - \$50/day x 11 days	550.00
Power Saw - \$18/day x 11 days	<u>198.00</u>
	\$11,723.00

Alfred R. Allen

COSTS STATEMENT #2 CONT'D

R.H. STANFIELD

Location: Dogwood 9, 11, 12 Dogwood 1A Group

Length: 16 Kilometres

Crew, Accommodation and Meals - 3 Men @ \$65/day x 17 days	\$ 3,315.00
Foreman - \$15/hour x 130 hours	1,950.00
HD16AC Bulldozer - \$70/hour x 136 hours	9,520.00
Champion \$740 Grader - \$55/hour x 32 hours	1,760.00
Truck 3/4 Ton 4X4 - \$50/day x 17 days	850.00
Power Saw - \$18/day x 17 days	<u>306.00</u>
	\$17,701.00
Total Costs	\$38,639.00

Alfred B. Allen

2-730 West 7th Avenue
Vancouver, B.C.

(604)874-5517

CERTIFICATE

August 17, 1989

I am a graduate of the University of British Columbia and hold the following degrees therefrom:

BA Sc Geological Engineering 1939
MA Sc Geological Engineering 1941

I am a life member of the Association of Professional Engineers of the Province of British Columbia.

I have practised my profession forty eight years.

I hold no interest in the properties or securities of R.H. Stanfield or affiliates thereof, nor do I expect to receive any, directly or indirectly.

The report of the Cedar 1A, 3A, Dogwood 1A and 4 is based on examination on the property as consultant January 27-30, 1989.

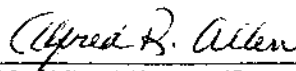

Alfred R. Allen, P.Eng.

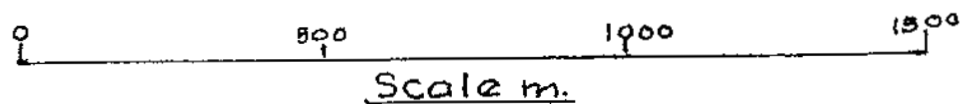
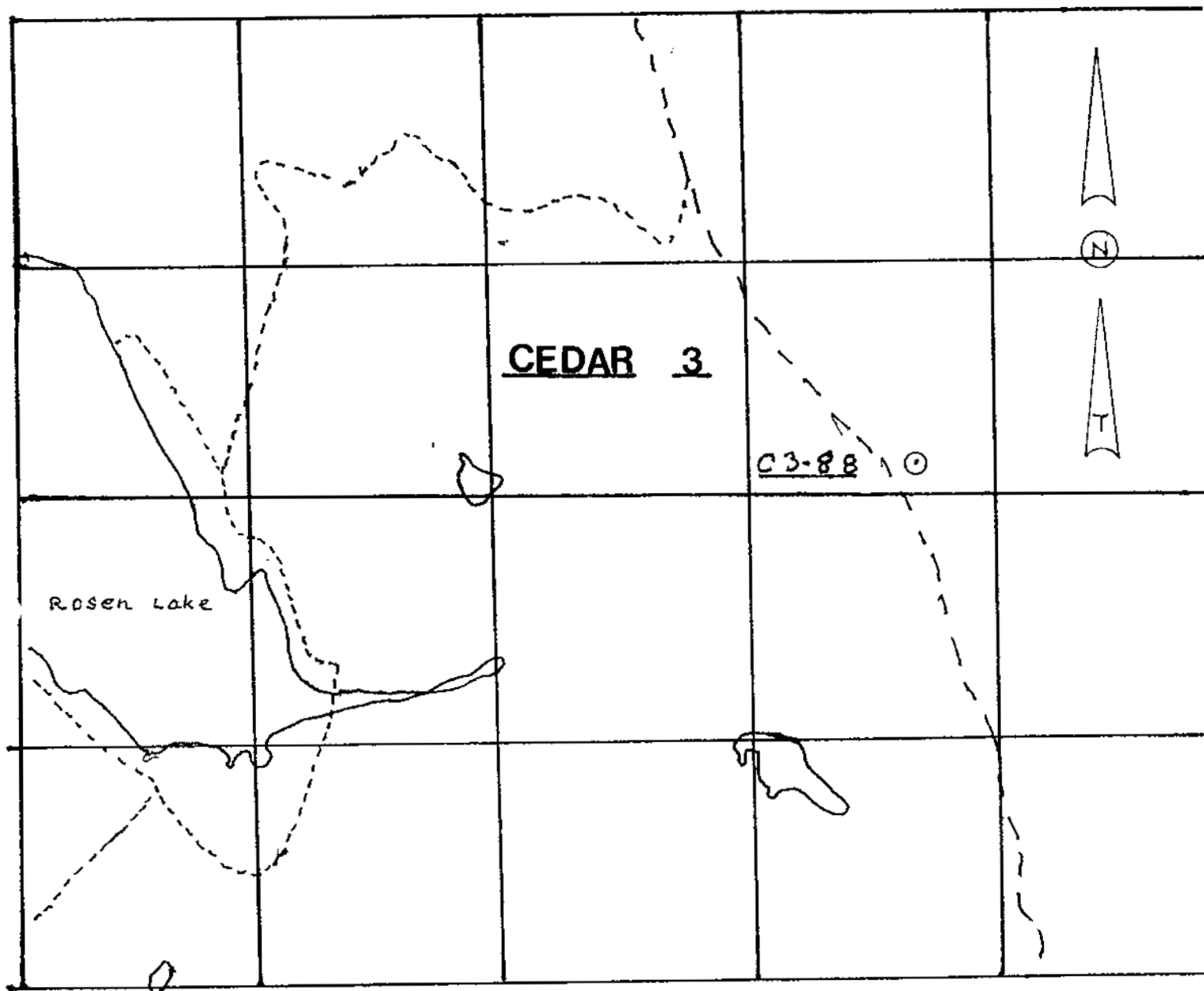

R.H. STANFIELD
 CEDAR #3 CLAIM
 ROTARY HOLE C 3-88

No.4 Allen Geological Engineering Ltd.
 08/89 per Alfred R. Allen P.Eng.
 Alfred R. Allen

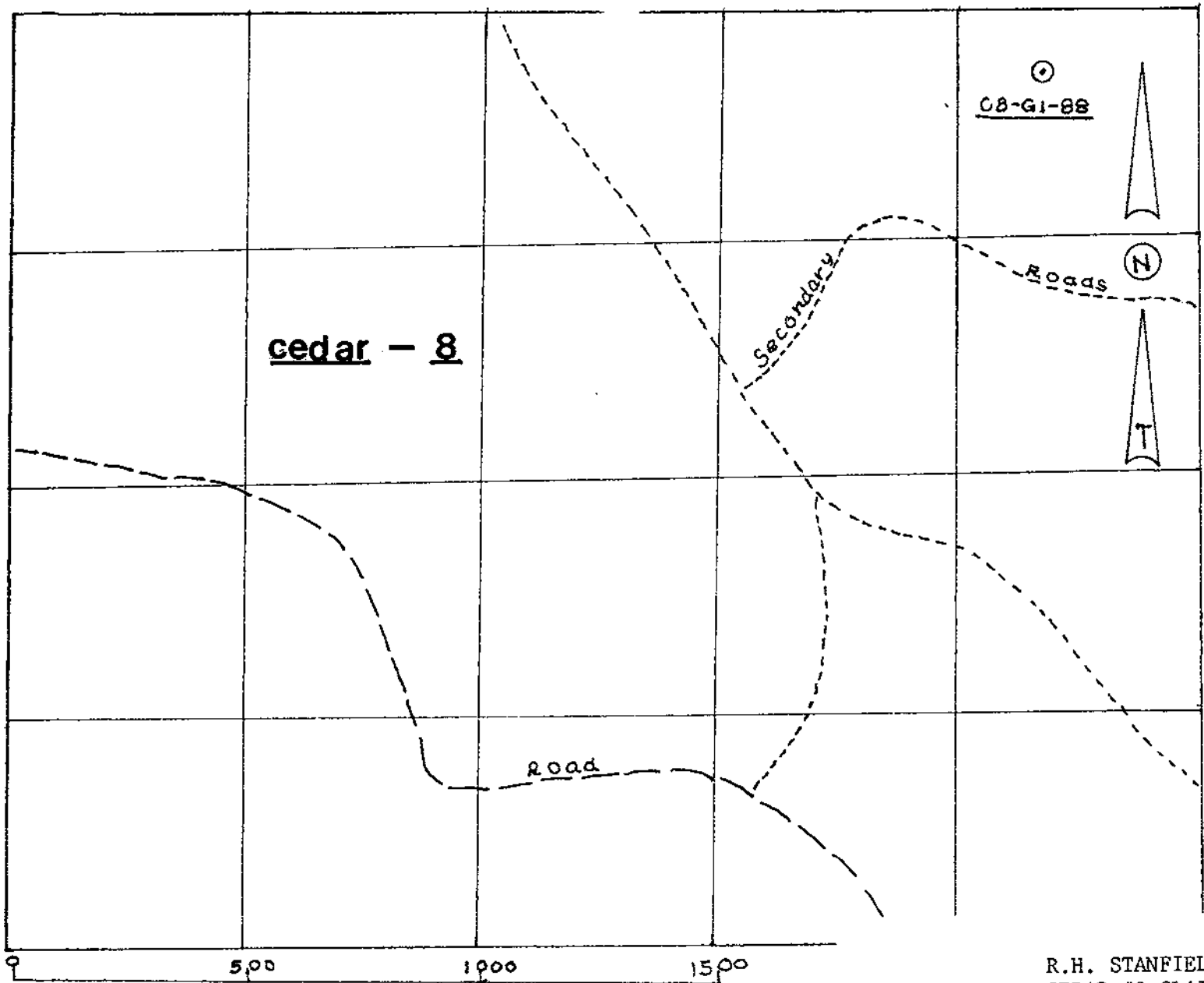

cedar - 8

Secondary

C8-G1-88

N

Roads

T

Road

0 500 1000 1500

Scale - m.

R.H. STANFIELD
 CEDAR #8 CLAIM
 ROTARY HOLE C 8-G1-88

No.5 Allen Geological Engineering Ltd.

per Alfred R. Allen P.Eng.

Alfred R. Allen

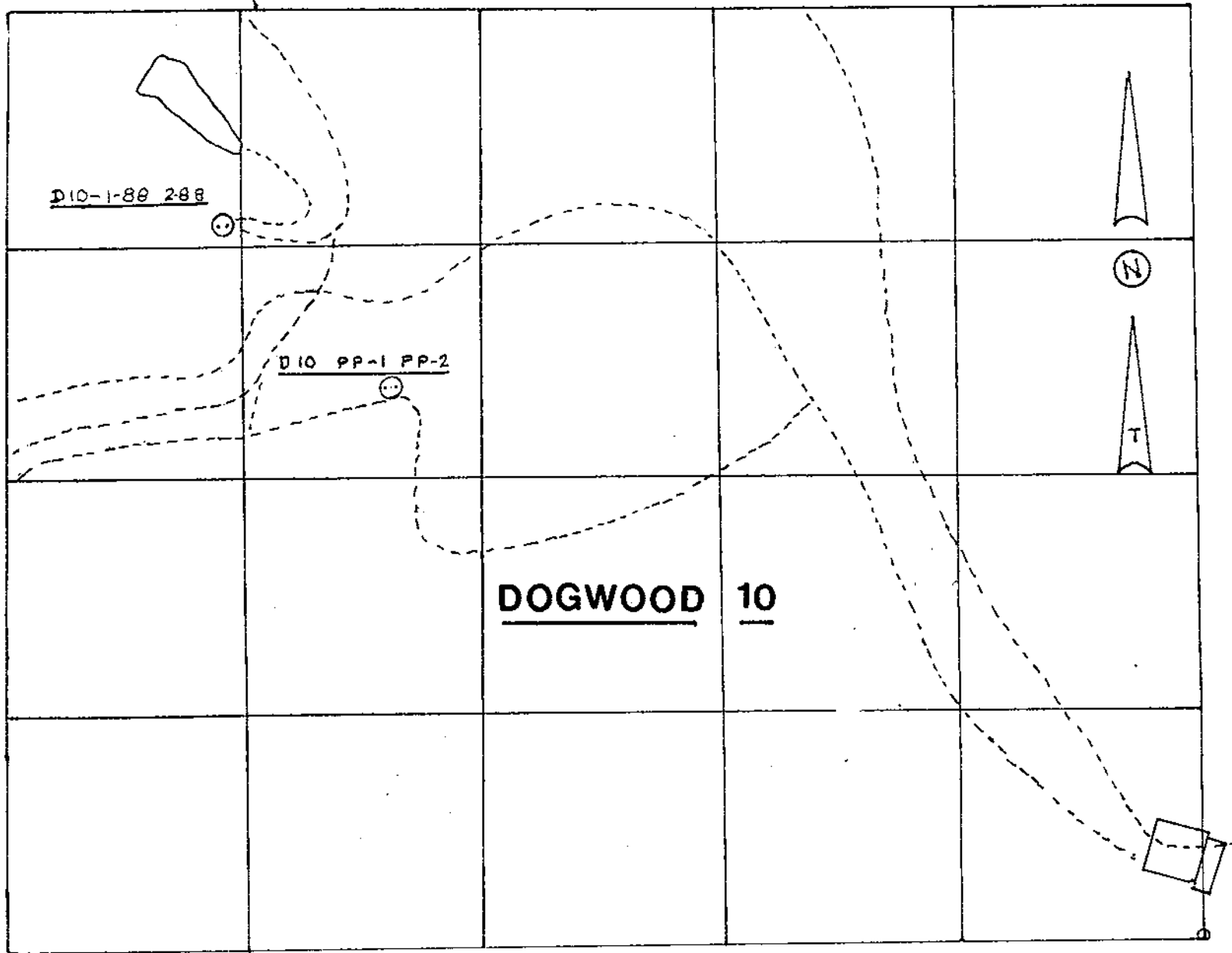

R.H. STANFIELD
 DOGWOOD 10 CLAIM
 ROTARY HOLES D10-10-8, 2-88
 D10, PP-1, PP-2, 88

No.6 Allen Geological Engineering Ltd.

08/89 per Alfred R. Allen P.Eng.

Alfred R. Allen

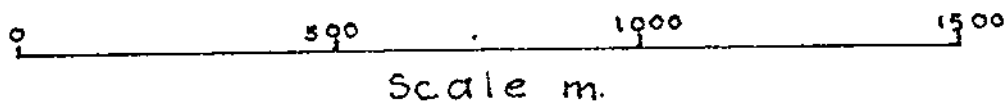
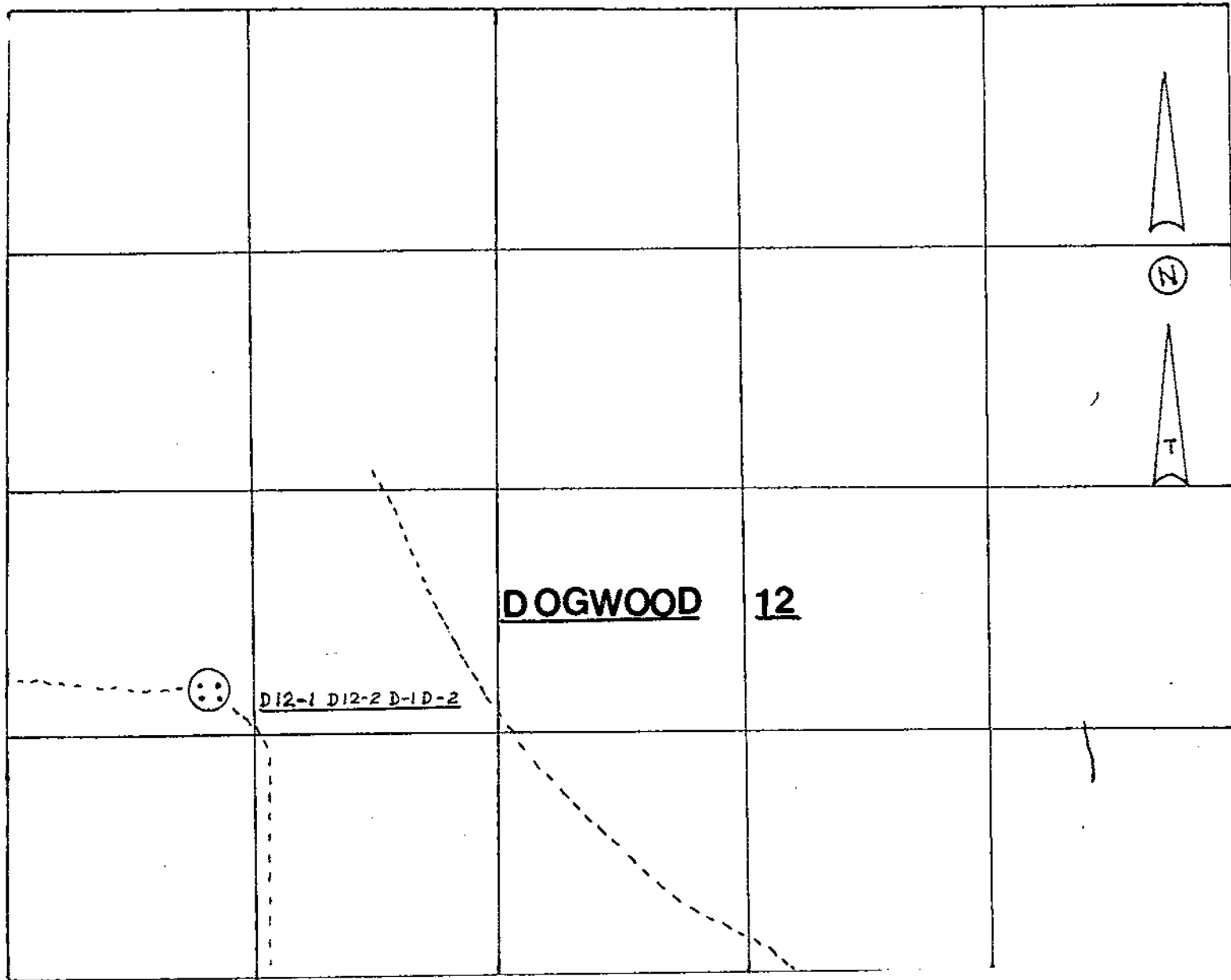

R.H. STANFIELD
 DOGWOOD 12 CLAIM
 ROTARY HOLES D12-1, D12-2, D-1, D-2

No.7 Allen Geological Engineering Ltd.
 08/89 per Alfred R. Allen P.Eng.

Alfred R. Allen