

1988 YEAR END REPORT

on the

DOVE PROJECT

VOLUME II A

FILMED

GLA Plans COMPLIANCE
ASSESSMENT REPORT

19,081

Part 2 of 5

LIST OF PLANS

- 1) Geology of the Dove Property, 1:10,000 scale, Revised
 - a) South Sheet
 - b) Central Sheet
 - c) North Sheet
- 2) Soil Geochemistry on Ideal Claims, 1:10,000 scale, Revised
 - a) Au
 - b) As
- 3) Soil Geochemistry on Harmony Claims, 1:10,000 scale, Revised
 - a) Au
 - b) As
- 4) Geology, NS Grid, 1:2500 scale
- 5) Geology, Main/Murex Grids, 1:5000 scale
- 6) Geology, McKay Grid, 1:2500 scale
- 7) Geology, Regan Grid, 1:2500 scale
- 8) Soil Geochemistry, NS Grid, 1:2500 scale
 - a) Au/Ag
 - b) As/Sb
 - c) Pb/Zn
 - d) Cu/Mo

LEGEND FOR GEOLOGY PLANS

Tqd Tertiary Quartz Diorite - grey equigranular and porphyritic intrusions.

Tdp Tertiary Dacite Porphyry - grey hornblende porphyritic subvolcanic intrusions.

KN Cretaceous Nanaimo Group - sandstone, siltstone, shale, coal, conglomerate.

——— Unconformity ———

TK Triassic Karmutsen Fm. - basalt/andesite massive flows, pillow lavas, breccias, hyaloclastite.



Fault

↑ high

↓ low/minor

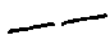

Geological contact.

x float (F)

Abbreviations:

congl. = conglomerate

ss = sandstone

sst = siltstone

sh = shale

ss (m) = metasandstone

B = basalt

a = amygdaloidal

h = hyaloclastic

m = massive

p = porphyritic

Ank = Ankerite

Bo = Bornite

Ca = Calcite

Cp = Chalcopyrite

I = Intrusive

Lm = Limonite

Mn = Manganese

Po = Pyrrhotite

Py = Pyrite

Qtz = Quartz

v = vein

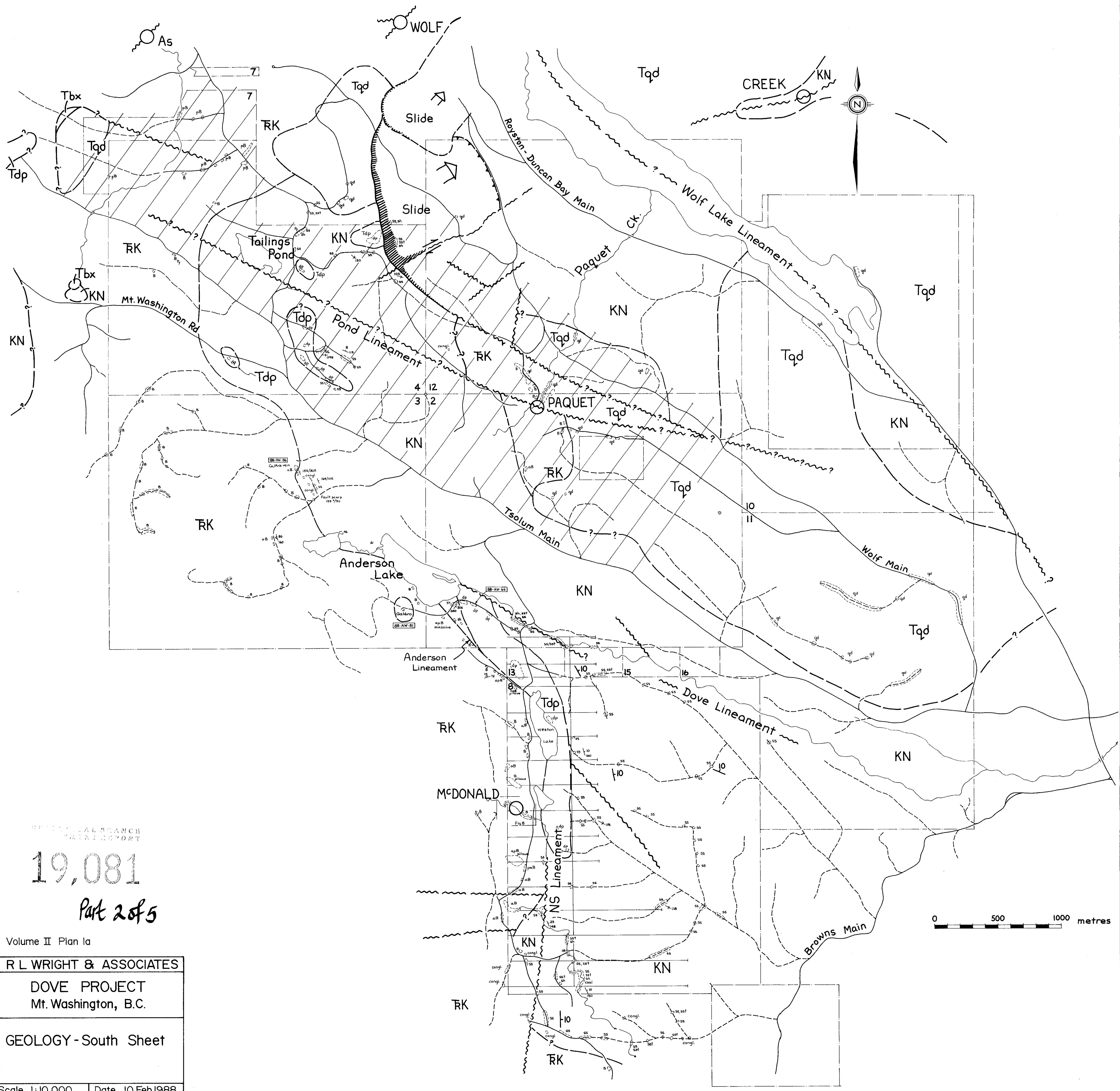

PROSPECT BRANCH
MONTICFORT

19,081

Part 2 of 5

Volume II Plan Ia

R L WRIGHT & ASSOCIATES

DOVE PROJECT
Mt. Washington, B.C.

GEOLOGY - South Sheet

Scale 1:10,000 | Date 10 Feb 1988

19,081

Part 2 of 5

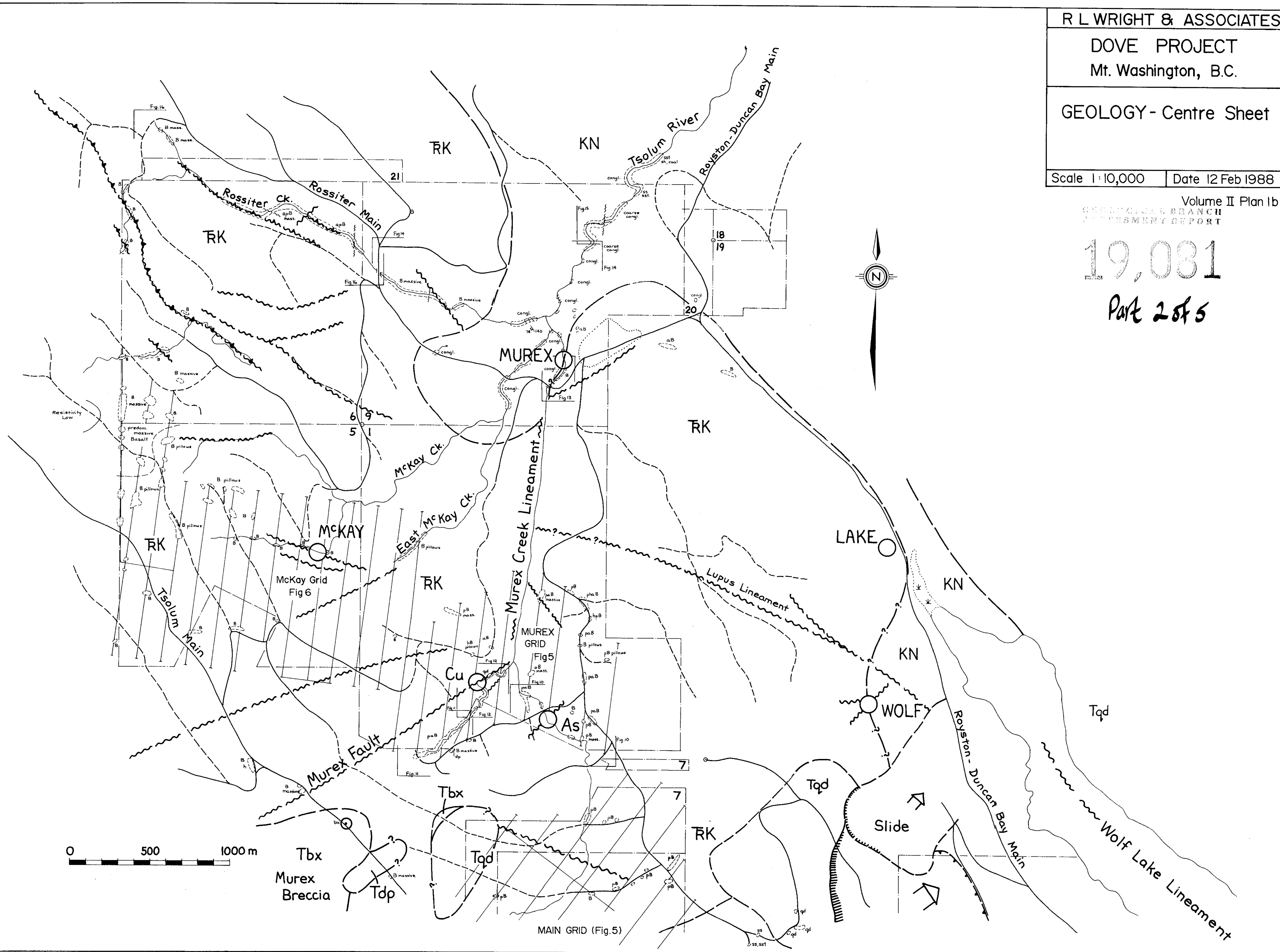

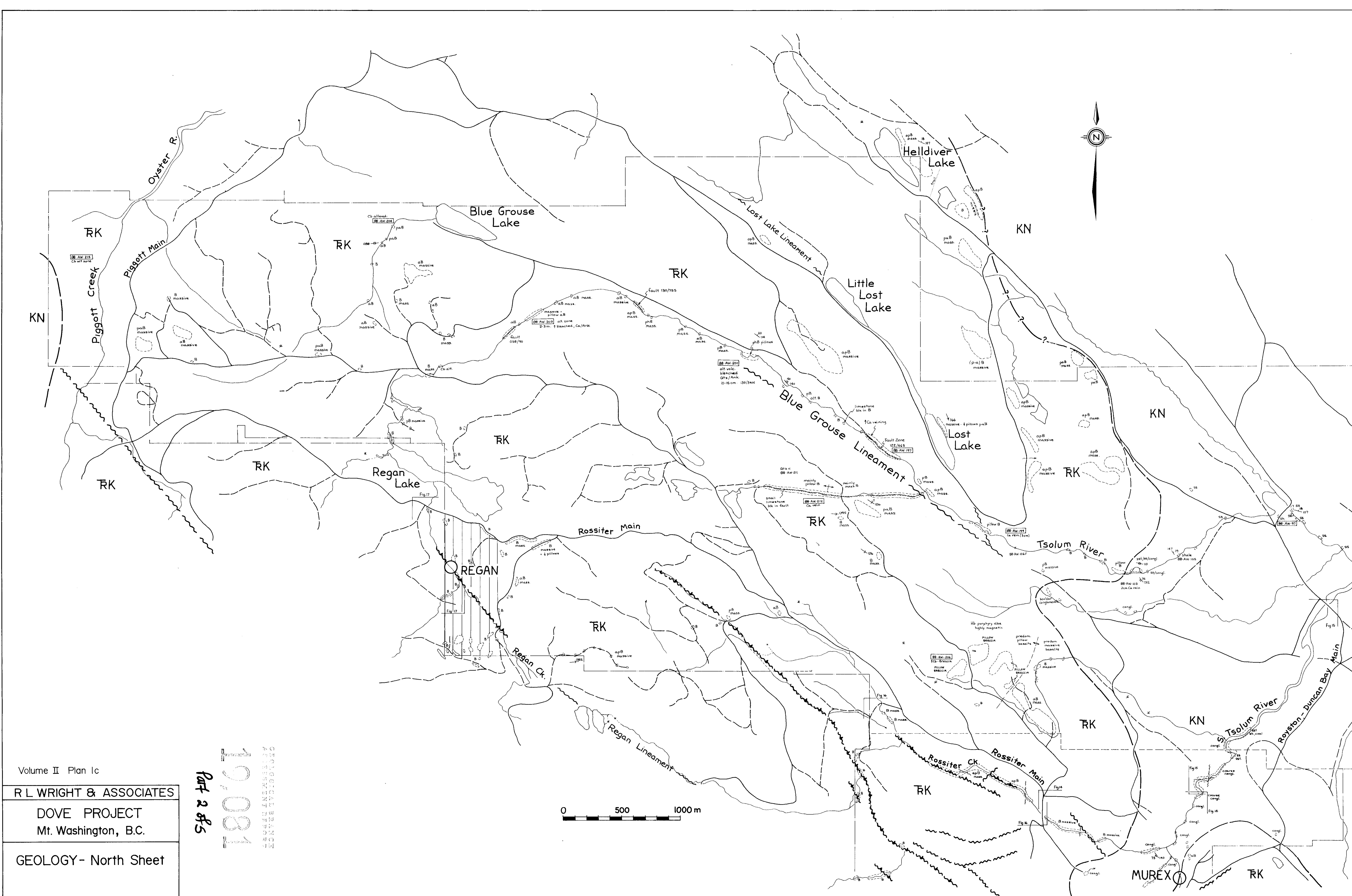

Volume II Plan 1c

R L WRIGHT & ASSOCIATES

DOVE PROJECT
Mt. Washington, B.C.

GEOLOGY - North Sheet

Scale 1:10,000 | Date 14 Feb 1988

19,081
 285
 285

Revised Nov 1988

MUREX

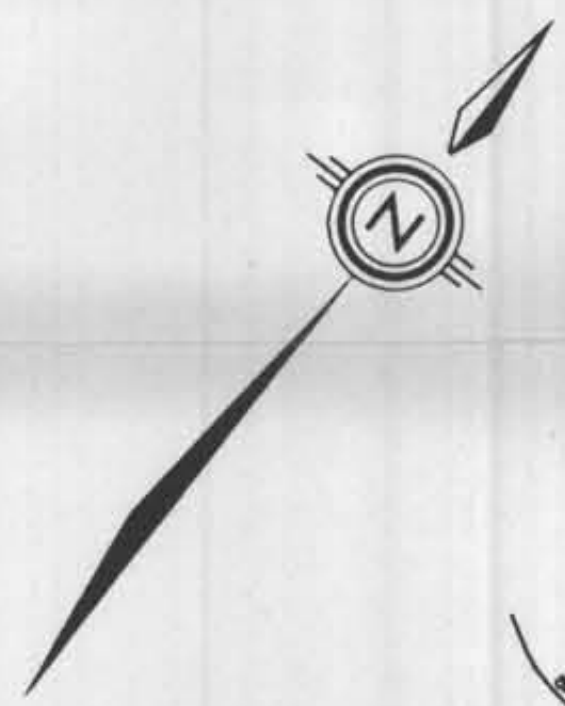

0 500 1000 1500 metres

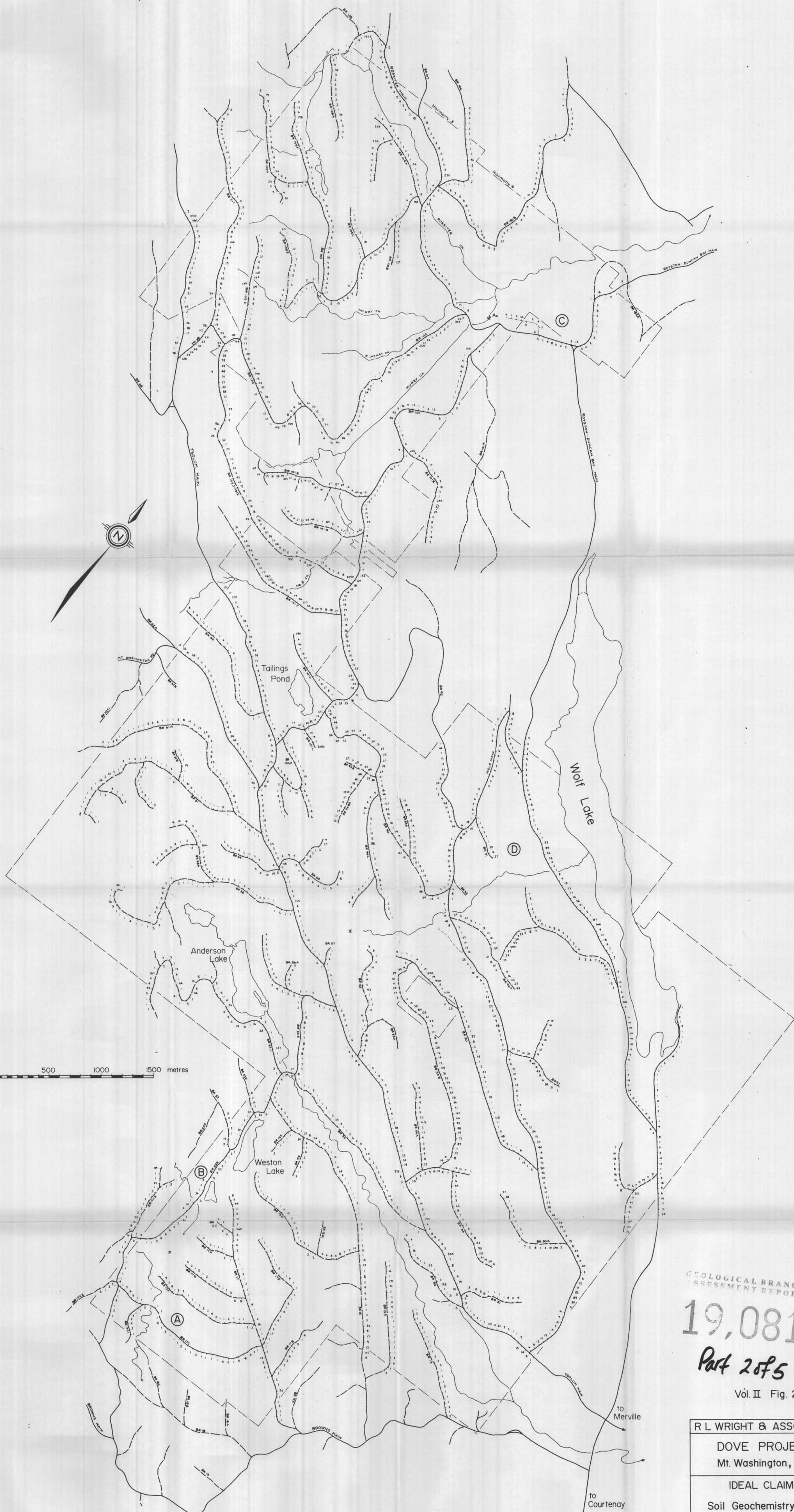

GEOLOGICAL BRANCH
ASSESSMENT REPORT

19,081

Part 2 of 5

Vol. II Fig. 2a

R L WRIGHT & ASSOCIATES

DOVE PROJECT
Mt. Washington, B.C.

IDEAL CLAIMS
Soil Geochemistry - Au

Scale 1:10,000 Date 26 July 1988

to Merville

to Courtenay

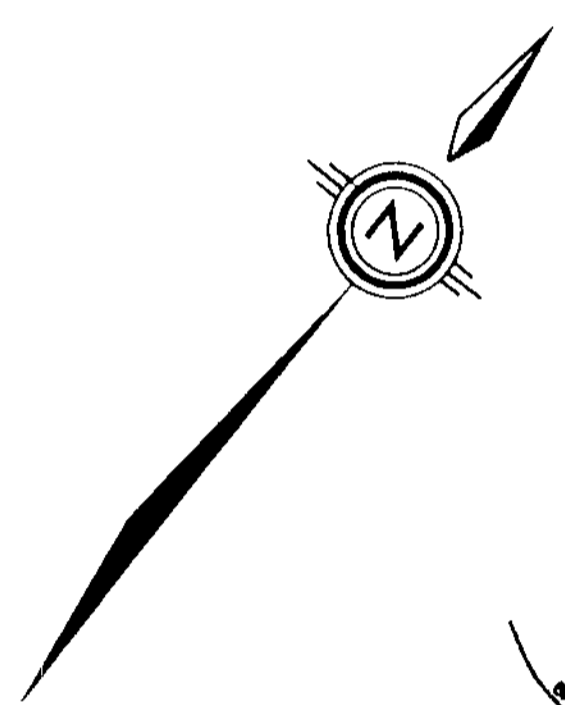

0 500 1000 1500 metres

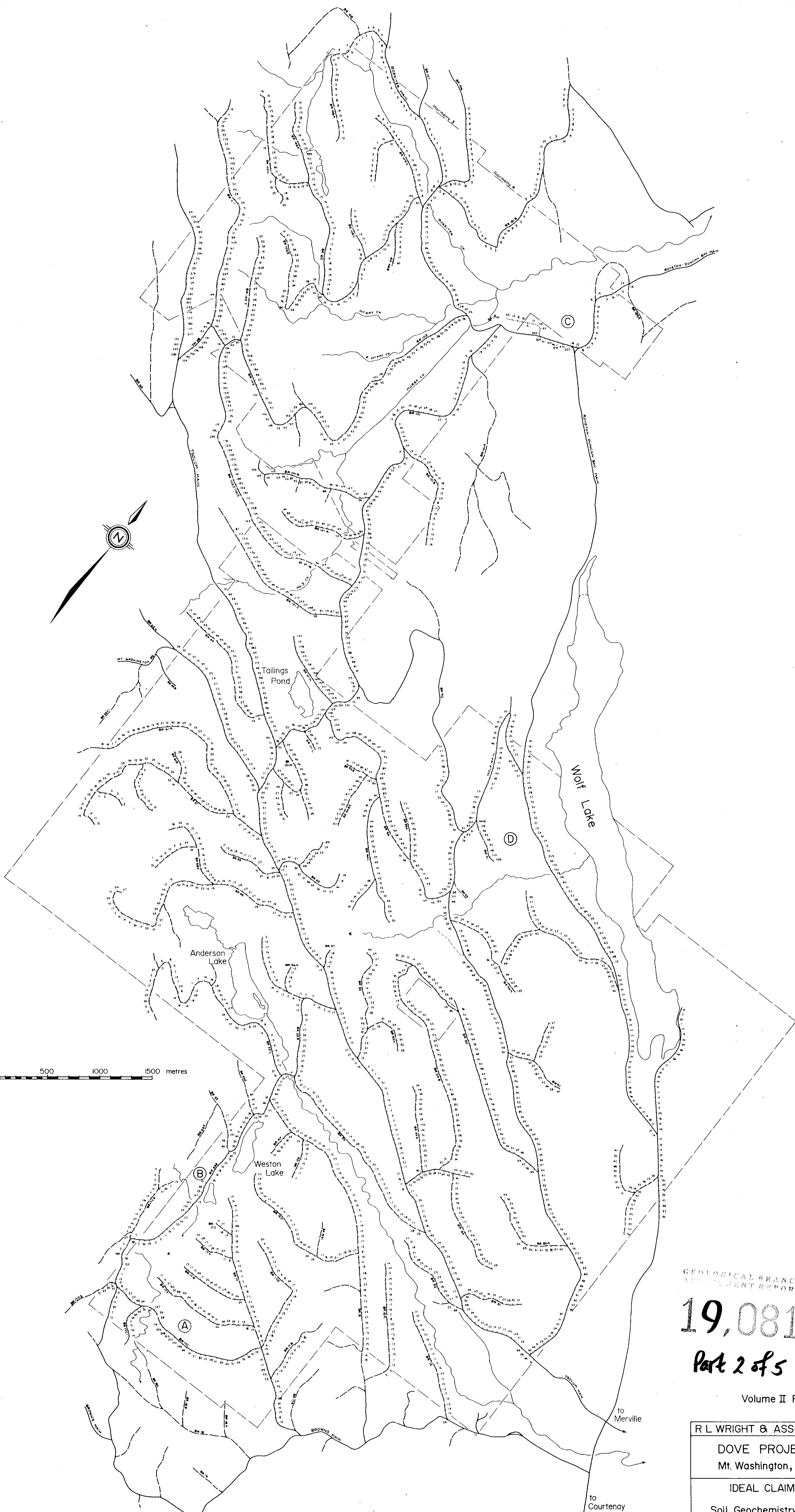

GEOLOGICAL BRANCH
APPENDIX REPORT

19,081

Part 2 of 5

Volume II Fig. 2b

R L WRIGHT & ASSOCIATES

DOVE PROJECT
Mt. Washington, B.C.

IDEAL CLAIMS
Soil Geochemistry - As

Scale 1:10,000 Date 26 July 1988

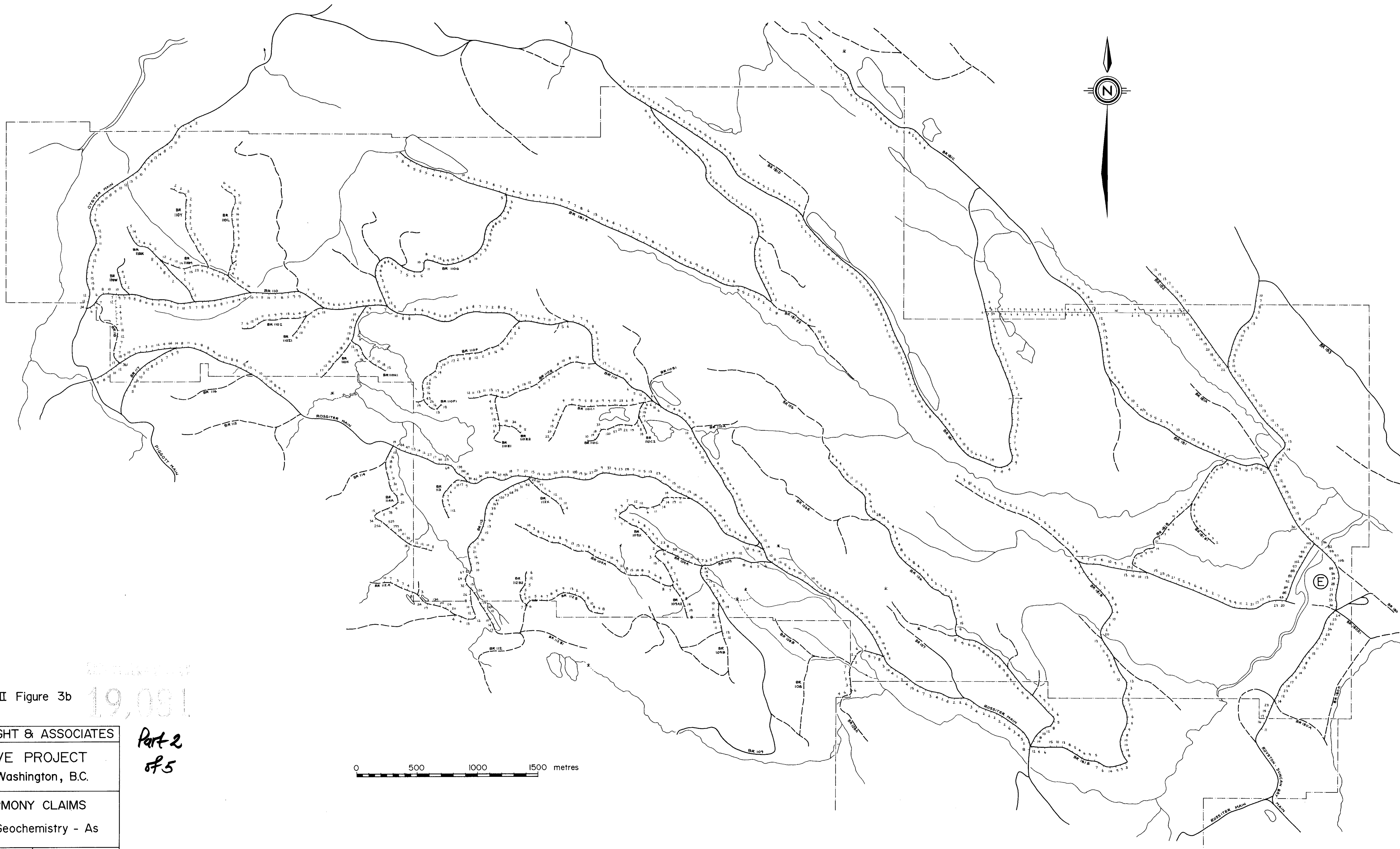

Vol. II Figure 3b

19,081

Part 2
of 5

R L WRIGHT & ASSOCIATES

DOVE PROJECT
Mt. Washington, B.C.

HARMONY CLAIMS
Soil Geochemistry - As

0 500 1000 1500 metres

19,081

Part 2 of 5

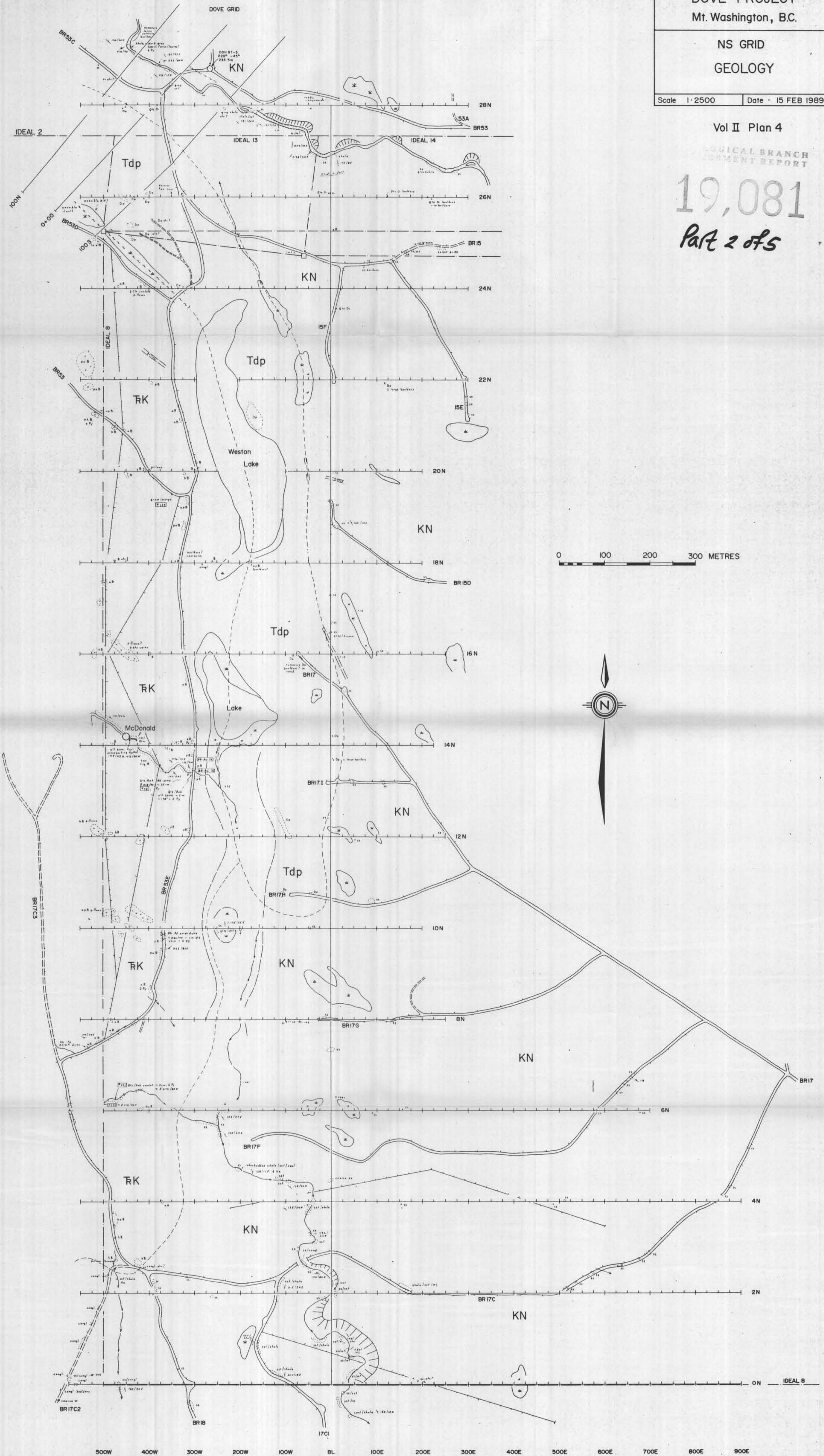

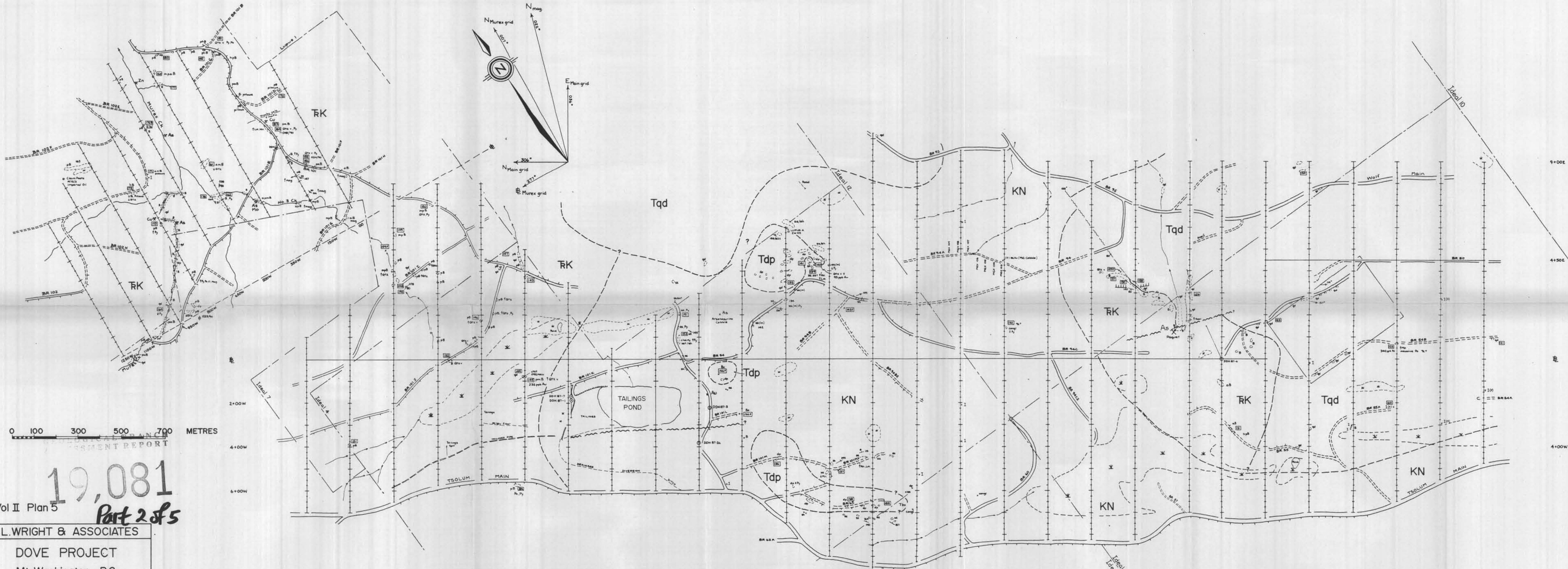

0 100 300 500 700 METRES

19,081

Vol II Plan 5 Part 2 of 5

R.L. WRIGHT & ASSOCIATES
 DOVE PROJECT
 Mt. Washington, B.C.
 MAIN and MUREX GRIDS
 GEOLOGY

Scale: 1:5000 Date: 15 NOV 1988

44+00N 42+00N 40+00N 38+00N 36+00N 34+00N 32+00N 30+00N 28+00N 26+00N 24+00N 22+00N 20+00N 18+00N 16+00N 14+00N 12+00N 10+00N 8+00N 6+00N 3+50N 2+00N 0N 2+00S 4+00S 6+00S 8+00S 10+00S

Vol II Plan 6
 19,081 Part 2 of 5

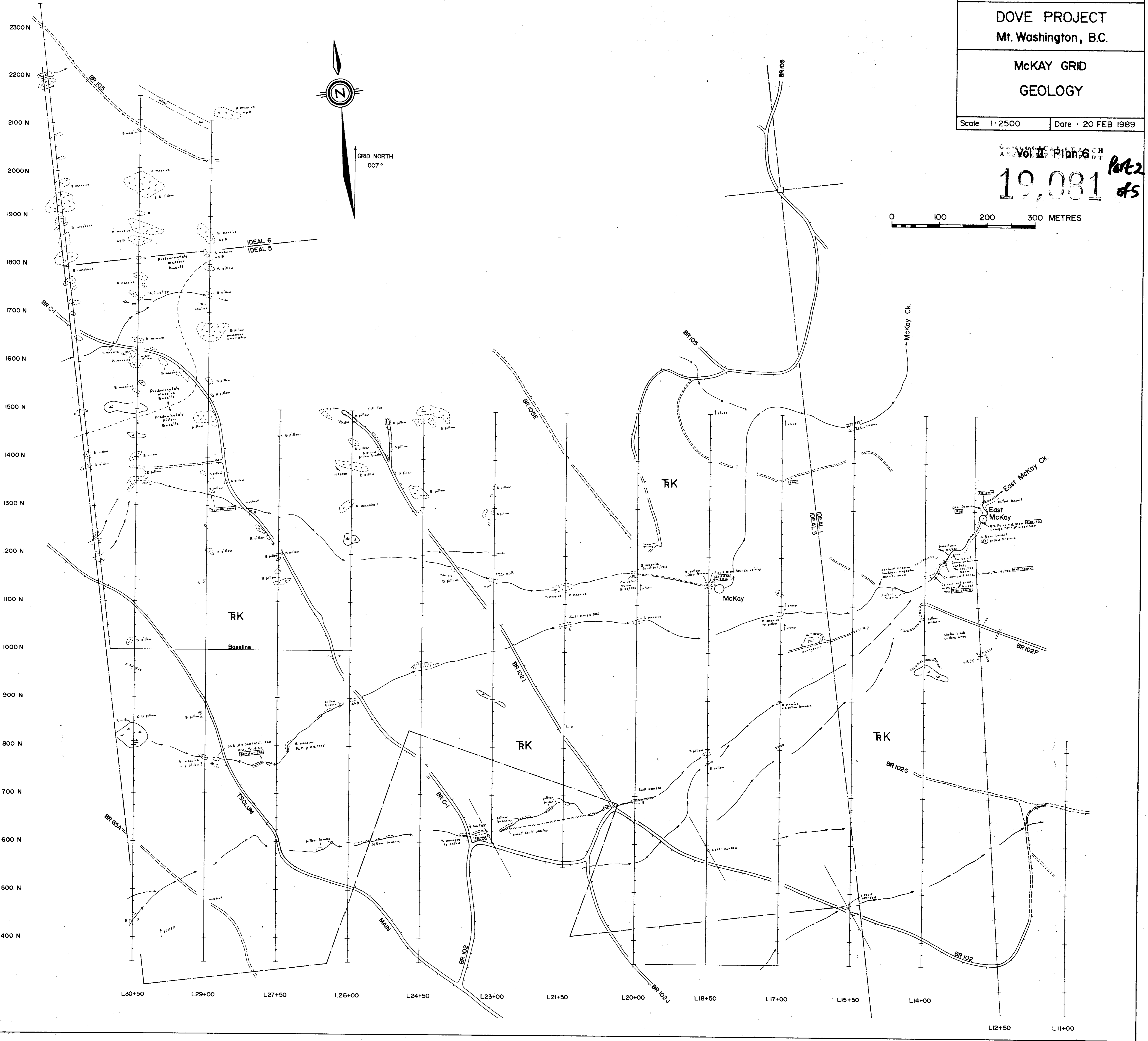

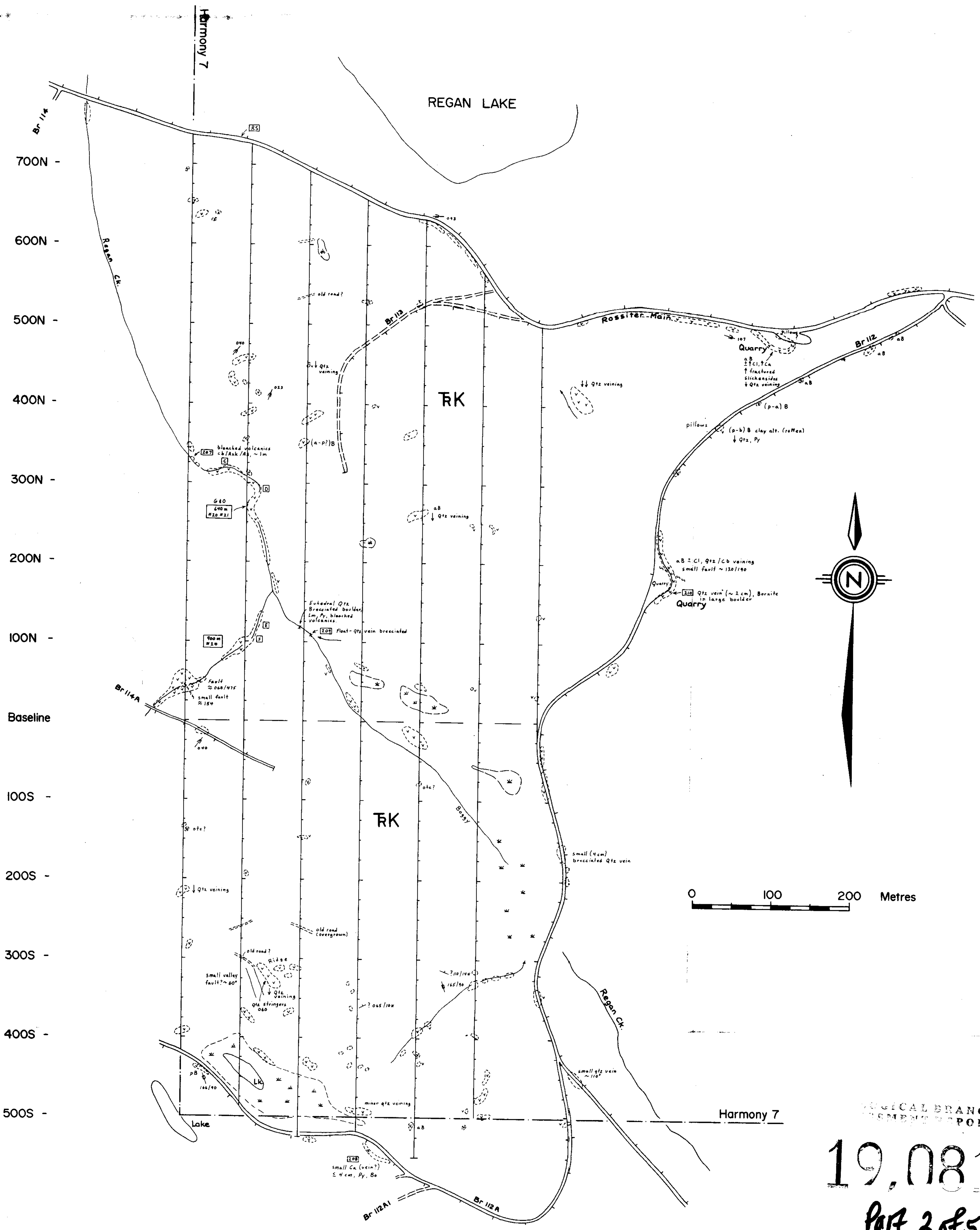

GEOLOGICAL BRANCH
 REPORT

19,081

Part 2 of 5

Vol II Plan 7

R.L. WRIGHT & ASSOCIATES	
DOVE PROJECT Mt. Washington, B.C.	
REGAN GRID GEOLOGY	
Scale 1:2500	Date: 15 NOV 1988

L0+00E - L0+75E - L1+50E - L2+25E - L3+00E - L3+75E - L4+50E -

19,081
LEGEND Part 2 of 5

- Au (ppb) / Ag (ppm)
- Au (ppb) / Ag (ppm)
- Au (ppb) / Ag (ppm)
- No sample

0 100 200 300 METRES

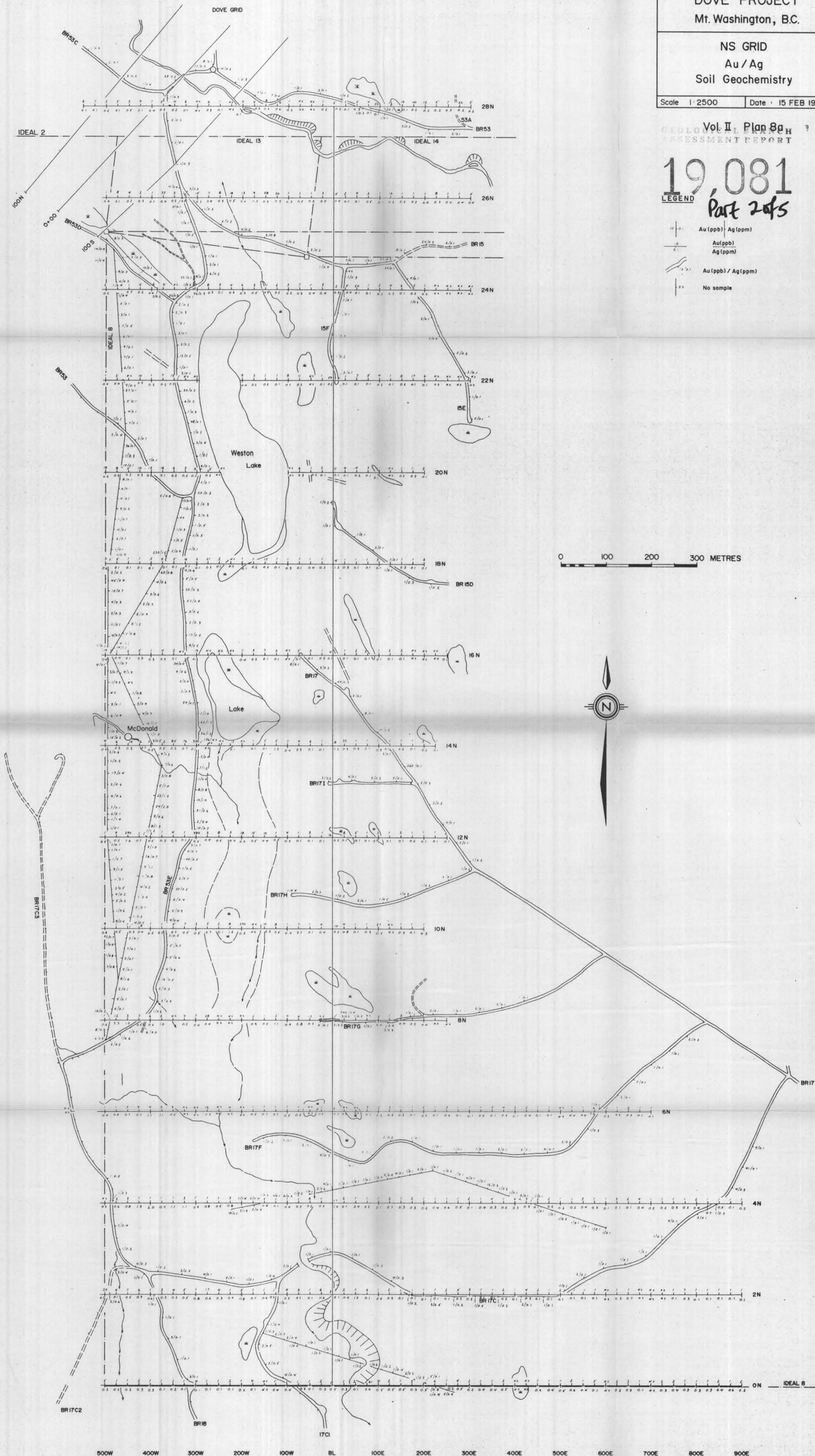

19,081

LEGEND Part 2 of 5

- Pb (ppm) Zn (ppm)
- Pb (ppm) Zn (ppm)
- Pb (ppm) Zn (ppm)
- No sample

0 100 200 300 METRES

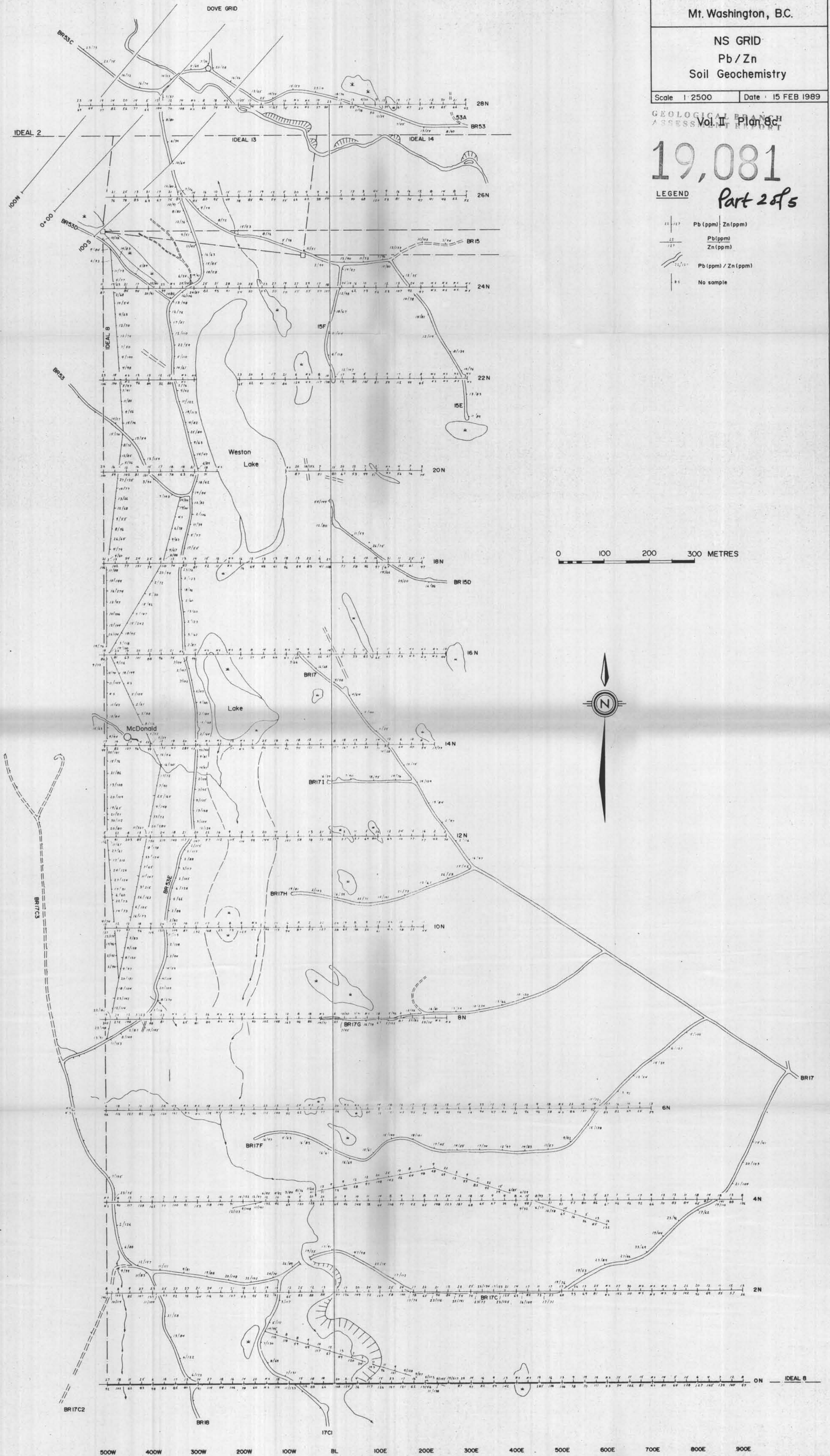

19,081

Part 2 of 5

LEGEND

- Cu (ppm) Mo (ppm)
- Cu (ppm) Mo (ppm)
- Cu (ppm) Mo (ppm)
- No sample

0 100 200 300 METRES

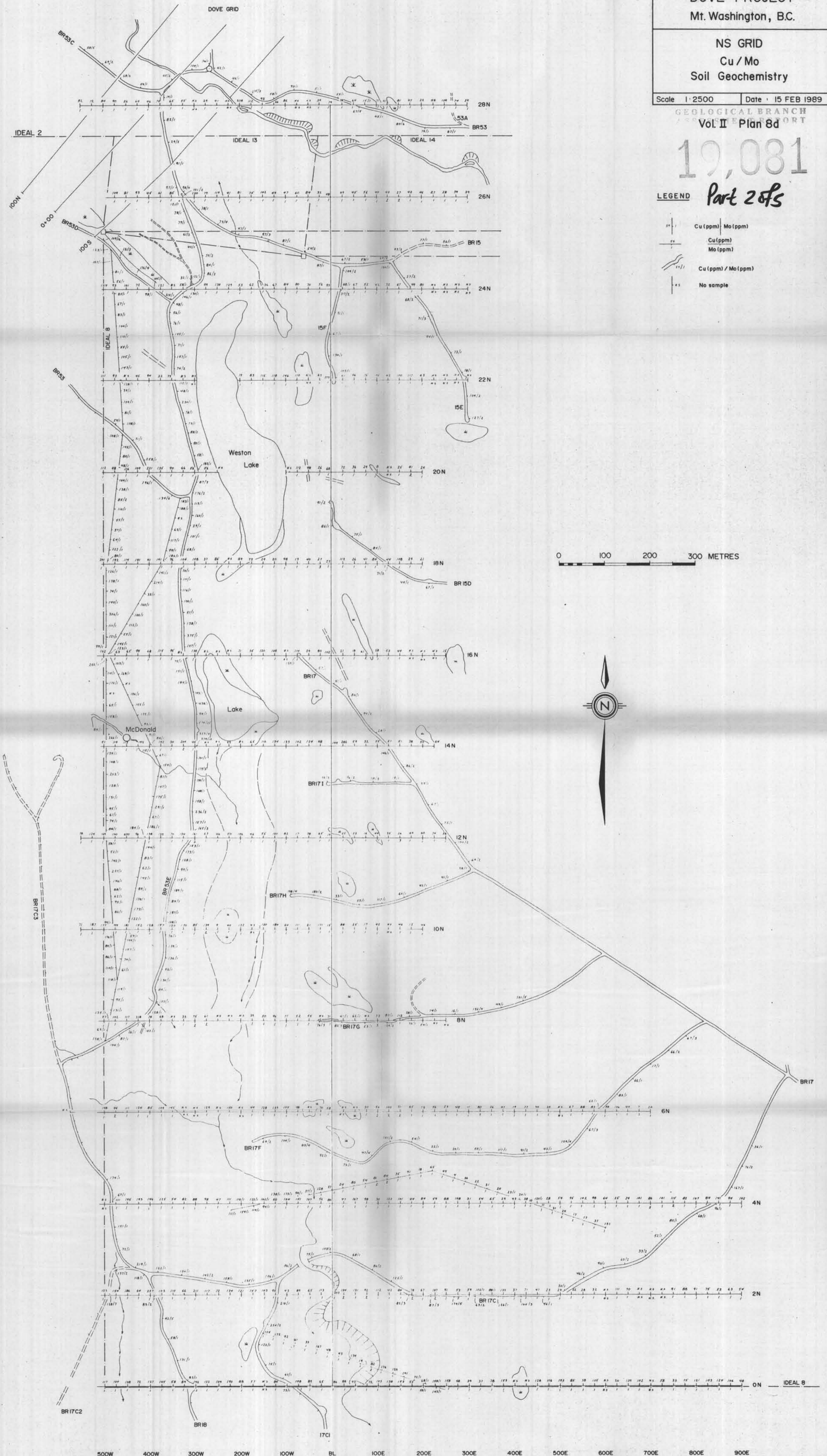

500W 400W 300W 200W 100W BL 100E 200E 300E 400E 500E 600E 700E 800E 900E