

LOG NO: 0116	RD.
ACTION:	
FILE NO:	

GEOCHEMICAL REPORT

JOE CLAIM GROUP

KAMLOOPS MINING DIVISION

LAT. 51 DEGREES 19.5'N LONG 119 DEGREES 58.5'W

NTS 82M/5

OCTOBER 1989

GEOLOGICAL BRANCH
ASSESSMENT REPORT

19,546

GEOCHEMICAL REPORT

JOE CLAIM GROUP

KAMLOOPS MINING DIVISION

LATITUDE 51 DEGREES 19.5'N NTS 82M/5 LONGITUDE 119 DEGREES 58.5'W

By

LARRY OVINGTON

For

LARRY OVINGTON - OWNER

PLACER DOME INC. - OPERATOR

RECORD NUMBERS 6400(10), 6702(7),
6703(7), 6707(7), 6709(7)

KAMLOOPS - October 15, 1989

TABLE OF CONTENTS

TABLE OF CONTENTS	I
LIST OF ILLUSTRATIONS	I
LIST OF REFERENCES	II
	<u>Page</u>
1.0 INTRODUCTION	1
2.0 LOCATION AND ACCESS	1
3.0 OWNERSHIP AND CLAIM STATUS	2
4.0 HISTORY AND PREVIOUS WORK	2 & 3
5.0 SUMMARY OF WORK PERFORMED IN 1989	3 & 4
6.0 GEOLOGY	5
7.0 RESULTS	5 & 6
8.0 CONCLUSIONS AND RECOMMENDATIONS	6
STATEMENT OF COSTS	7 & 8
STATEMENT OF QUALIFICATIONS	9
"APPENDIX A" - ASSAY CERTIFICATES OF SOIL SAMPLING	After page 9
- ASSAY CERTIFICATES OF ROCK ASSAYS	
- ROCK DESCRIPTIONS	

LIST OF ILLUSTRATIONS

PLATE 1	LOCATION MAP	After Page 1
PLATE 2	INDEX MAP	After Plate 1
PLATE 3	CHECK SOIL SAMPLES & ROCK SAMPLES	- In Pocket
PLATE 4	GEOCHEMICAL MAP - Au VALUES	- In Pocket
PLATE 5	GEOCHEMICAL MAP - Ag VALUES	- In Pocket
PLATE 6	GEOCHEMICAL MAP - Pb VALUES	- In Pocket
PLATE 7	GEOCHEMICAL MAP - Zn VALUES	- In Pocket
PLATE 8	GEOCHEMICAL MAP - Cu VALUES	- In Pocket
PLATE 9	GEOCHEMICAL MAP - As VALUES	- In Pocket

LIST OF REFERENCES

- Woodcock, J. Geochem Report (Assessment Report 3333) 1971
- Vollo, Nels Geochem Geophysical Report, B.C. Group
(Assessment Report 3716)
- Vollo, Nels Geochem, Geology Report B.C. Group
(Assessment Report 4136) 1973
- Woodjack, P. Geochem, Geology Report, Bet Claims
(Assessment Report 6202) 1977
- Ministry of Mines Preliminary Map No. 56
Geology of the Adams Plateau-Clearwater Area
1984
- Schiarrizza, P. Geology of the Eagle Bay Formation between
the Raft and Baldy Batholiths. 1985
- Moraal, Dirk Prospectors Report for Larry Ovington
September 15, 1986
- Larry Ovington
& Bryan Elliott Geochemical Report
October 1987 Assessment Report #16884

1.0 INTRODUCTION

The Joe Claim (20 unit) was first staked in October 1985 and then abandoned and restaked in October 1986. The 4 (2 Post Claims) adjoining to the west were staked in July 1986. The claims were staked in order to prospect the favourable geological environment for massive sulphides. That is the contact between the Eagle Bay sediments and the Fennel Volcanics. This contact runs the entire length of the claim group, which is about 2,500 meters. Reference (Preliminary Map No. 56). Geology of the Adams Plateau-Clearwater area. Massive sulphide in place and float were found on the property in 1986 which encouraged further exploration.

2.0 LOCATION AND ACCESS

The Joe Claim is located at the head of Slate Creek. Access is from the town of Barriere approximately 18 km to the northeast. Access from Barriere is along a paved road to the North Barriere Lake turnoff and then via good gravel logging road to the Birk Creek turnoff. From there a logging road can be followed to the head of Slate Creek which joins the Barriere River about 4 km below the outlet of North Barriere Lake.

The Joe Claim is on an easterly facing slope which has been extensively logged in past years. Heavy growth of buck brush and willows cover patches of spruce, balsam and cedar. Elevations vary from 1345m at the southeast corner to 1735m along the western boundary.

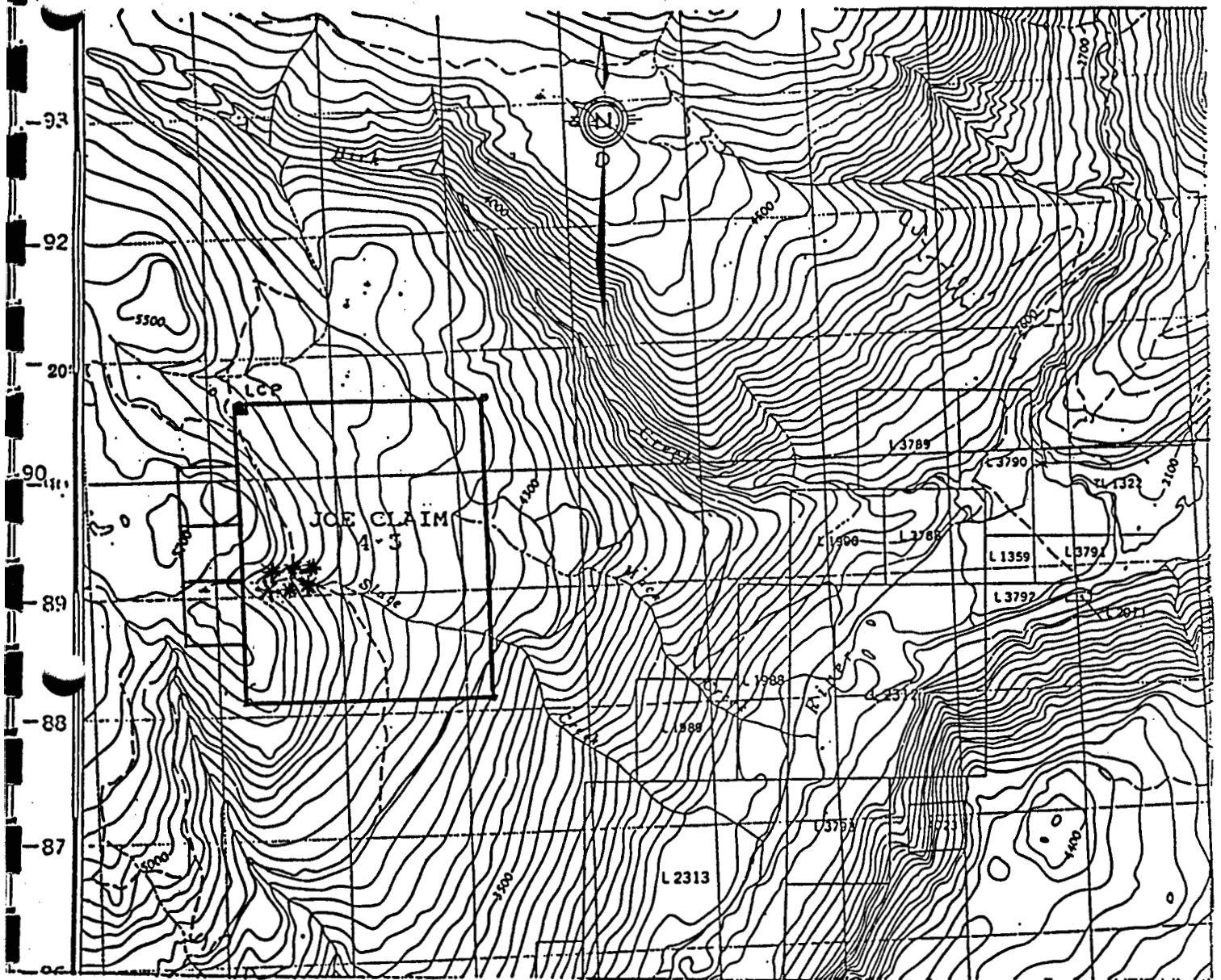

* AREA OF INTEREST

INDEX MAP
Joe Mineral Claim Group
Kamloops Mining Division
NTS 82M/5
Scale 1:50000

Plate 2

3.0 OWNERSHIP AND CLAIM STATUS

The claim group is owned 100% by Larry Ovington of Kamloops, B.C. The Joe Group consists of one 20 unit block group staked under the modified grid system. The L.C.P. is located at UTM coordinates 229250m E and 5683650m N. Record Number is 6400(10). The Metal Tag No. is 106880. Four 2 post claims adjoin the Joe Claim on the west boundary. They are Flint #1, Flint #2, Pete #3, and Pete #5. The Record Numbers are 6702(7), 6703(7), 6707(7), 6709(7) respectively. The Tag Numbers are 534957M, 534958M, 534159M, 534962M. The work described herein covers assessment work until October 21, 1991 on the Joe Claim and July 29, 1991 on the 2 post claims. These claims were grouped on October 16, 1987.

4.0 HISTORY AND PREVIOUS WORK

No assessment reports could be found at the Court House on this specific ground except the Prospectors Report by Dirk Moraal for Larry Ovington, September 1986. There have been numerous reports and drilling done on properties in the general area since 1951. Assessment reports dealing with results are noted in "List of References" II (See Table of Contents). There may be more results of work done on these properties which were never filed for assessment. The September 1986 Prospecting Report covered geological mapping and a massive sulphide occurrence found on the Joe Claim. The Geochemical Survey in 1987 outlined a broad area

4.0 HISTORY AND PREVIOUS WORK Con't

of multi-element responses with Au, Ag, As being the most dominant.
(Assessment Report #16884)

5.0 SUMMARY OF WORK PERFORMED IN 1989

Based on the favourable results of the 1987 geochemical results, Placer Dome Inc. undertook to fill in and expand in all directions the 1987 grid. The 1989 grid was ran east/west off a north/south baseline. The baseline runs along the west boundary of the Joe Mineral Claim. Line 10000N is at the 3S I.D. Post of the Joe Mineral Claim. Crosslines are 50 meters apart. Crossline L9950N to L10150N were soil sampled every 20 meters. All the crosslines were run from the baseline 600 meters to the east except for L10000N which was also ran 600 meters west. The soils were taken by Placer Dome personnel using hand augers. The soils were taken at a depth of 8 - 12 inches in most cases getting a representative B Zone. Where a reasonable soil could not be obtained due to glacial overburden or organic material the station was flagged N/A (not available). A preliminary countercheck in the area of some of the soil Au highs obtained from 1987 grid were taken prior to the establishment and soiling of the 1989 grid. A few rock samples were also taken where outcrop was available and these were assayed for Au, Cu, Pb, Zn, Ag.

5.0 SUMMARY OF WORK PERFORMED IN 1989 Con't

The soil samples were gathered in brown kraft envelopes and sent to Eco-Tech Laboratories Ltd. Kamloops, B.C., to be assayed for Au, Ag, Cu, Pb, Zn, and As. The method of assay used for soils and rocks was Au - 10 gram sample fire assay, atomic absorption finish. Ag, Cu, Pb, Zn - 1/2 gram sample, aqua regia digestion, atomic absorption finish. As - 1/2 gram sample aqua regia digestion, hydride/atomic absorption finish. The grid was established by hip chain and compass. The stations were put in with wooden pegs, flagged and station numbers marked on water-proof tyvex tags. The location of the 14 rock samples and 17 check soil stations are marked and numbered on ribbon flagging and location shown on Plate 3. Also, on Plate 3, the 1987 grid was mapped in with the 1987 Au soil values plotted. The 1989 grid is displayed on Plate 4 to Plate 9 with individual soil assays plotted for Au, Pb, Zn, Cu, and As respectively. A total of 178 soil samples were assayed for Au, Ag, Pb, Zn, Cu, and As on this grid. All assay results are included behind "Appendix A" which also includes a description of the rock types assayed on Plate 3, Au values in soils of <5 were plotted as 2.5.

6.0 GEOLOGY

The western claim line of the Joe Mineral Claim in the area of I.D. Post 3S is basically on the contact of the Eagle Bay and Fennel formations. Diorite can be found in the area of Post 3S to the south 100 meters, and to the northwest about 125 meters. From Post 3S about 500 meters west and also to the southwest about 500 meters light to medium grey rhyolite, sometimes porphyritic can be found. To the east of Post 3S about 150 meters, blackshales argillites, phyllites are found in place. This group of rocks is cut by numerous quartz veins, some milk white and barren of mineral and others rusty and packing sulphides giving good values in Au, Ag, Pb, and Zn. White most of these have been stringers, a lot of the areas where good Au, Ag, Pb, and Zn values in soils have been obtained, over burden prevents a look at the rock in place. The geology as mapped by V.A. Petro on Preliminary Map No. 56 "Geology of the Adams Plateau-Clearwater Area" complies very closely to what I found on the property so far.

7.0 RESULTS

The results of the 1989 program are as follows. The preliminary countercheck on some of the high soils taken by myself in 1987 proved the results to be valid. The 1989 grid soil results show the area of interest to extend to the north, south, and east.

7.0 RESULTS Con't

The soil anomalies are still open in these three directions. While the anomalies are basically multi-element Au stands out as being the most dominant, followed by Ag.

8.0 RECOMMENDATIONS AND CONCLUSIONS

The conclusions are that more work is required on the property and the following steps would be in order. More prospecting is required as much of the claim group area has not been looked over. Thick brush, heavy moss, and overburden make this job more difficult than one would like. The 1989 grid should be extended to the north, south, and east since the soil anomalies are still open in these directions. The highest Au soil value locations should be back hoed or trenched to get a look at the rock in place. A VLF/EM and magnetometer survey over the area would be helpful to see if the rock structure and conductors, if any, correlate with the soil anomalies.

STATEMENT OF COSTS

PERSONNEL

Lorne Warner, Geologist, 5 days @ \$250.00/day	
June 5, 28, 29, 30, July 26, 1989	\$1,250.00
Arne Toma Jr., Geologist, 2 days @ \$175.00/day	
June 29, 30, 1989	\$ 350.00
Arnt Burgert, Linecutting, 3 days @ \$150.00 per day	
June 28, 29, 30, 1989	\$ 450.00
Scott Knight, Soil Sampling, 3 days \$150.00/day	
June 28, 29, 30, 1989	<u>\$ 450.00</u>
	\$2,500.00

CAMP OPERATIONS

Meals and Accommodations for 3 days	\$ 165.00
-------------------------------------	-----------

TRANSPORTATION AND FREIGHT

3/4 Ton 4 x 4 Ford Pickup	\$ 150.00	
Fuel and Oil	<u>\$ 180.00</u>	
		\$ 330.00

GEOCHEMISTRY

178 Soil Samples for Cu, Pb, Zn, Ap, Au, and As @ \$16.75/soil	\$2,981.50	
17 Soil Samples for Cu, Pb, Zn, Ap, and Au @ \$12.75/soil	\$ 216.75	
14 Rock Samples for Cu, Pb, Zn, Ap, and Au @ \$15.25/rock	<u>\$ 213.50</u>	
		\$3,411.75

MISCELLANEOUS

i.e. Truck Repairs, Stationary & Supplies	\$ 500.00
---	-----------

STATEMENT OF COSTS Con't

REPORT PREPARATION

Compilation and Writing, L. Ovington		
3 days @ \$150.00/day	\$ 450.00	
Drafting, Typing, and Photocopying	<u>\$ 550.00</u>	
		<u>\$1,000.00</u>
SUB TOTAL		\$7,906.75
15% CONTINGENCIES		<u>1,186.01</u>
TOTAL COSTS		\$9,092.76
		=====

STATEMENT OF QUALIFICATIONS

I, Larry Ovington, of the City of Kamloops, in British Columbia, hereby state that:

1. I am a prospector and earn my living from the exploration and optioning of Mining Properties.
2. I have worked on various Mining Properties from 1958 to present both for myself and for other Mining Companies.
3. I have optioned at least 13 properties to Junior and Major Mining Companies.
4. I have worked on large exploration programmes for Dr. Norman Keevil, Sherwin Kelly, P. Eng., Bill Pentland, (Craigmont) and Morris Mathieu (Torwest Resources).
5. I am the sole owner and President of Whopper Holdings Ltd., a B.C. Incorporated company engaged in mineral exploration.
6. I am the Vice-President of Iota Explorations Ltd., a company exploring for precious metals in British Columbia.
7. This report is based on information gathered during the 1989 field season by Placer Dome Inc. The work was done to comply with assessment requirements and to enhance the sale of the property.
8. I am the sole owner of the Joe Group of Mineral Claims.



Larry Ovington

October 15, 1989

APPENDIX "A"

ASSAY CERTIFICATES

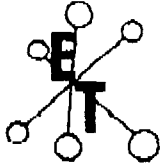
**ECO-TECH LABORATORIES LTD.**

ASSAYING - ENVIRONMENTAL TESTING

10041 East Trans Canada Hwy., Kamloops, B.C. V2C 2J3 (604) 573-5700 Fax 573-4557

JULY 18, 1989

CERTIFICATE OF ANALYSIS ETK 89-401
=====

Placer Dome Inc.
401, 1450 Pearson Place
KAMLOOPS, B.C.
V1S 1J9

=====

DATE RECEIVED:	JULY 4, 1989	REJECTS:	N/A
PROJECT:	GENERAL 1E - JC	PULPS:	STORE
NUMBER SAMPLES:	178		
TYPE SAMPLES:	SOILS	NOTE:	< = LESS THAN

=====

ET#	Description	Au (ppb)	Ag (ppm)	Cu (ppm)	Pb (ppm)	Zn (µm)
401 - 1	L 9950 N JG 10000 E	<5	.3	44	14	88
401 - 2	L 9950 N JG 10020 E	15	.4	54	12	92
401 - 3	L 9950 N JG 10040 E	<5	.3	49	12	139
401 - 4	L 9950 N JG 10060 E	10	1.6	52	13	136
401 - 5	L 9950 N JG 10080 E	10	.4	47	15	129
401 - 6	L 9950 N JG 10100 E	5	.7	92	14	101
401 - 7	L 9950 N JG 10120 E	<5	.2	21	11	50
401 - 8	L 9950 N JG 10140 E	<5	.2	19	12	66
401 - 9	L 9950 N JG 10160 E	5	1.3	69	15	111
401 - 10	L 9950 N JG 10180 E	5	.7	33	12	48
401 - 11	L 9950 N JG 10200 E	15	.3	54	10	183
401 - 12	L 9950 N JG 10220 E	30	4.7	158	48	164
401 - 13	L 9950 N JG 10240 E	20	2.5	72	19	279
401 - 14	L 9950 N JG 10260 E	5	1.8	159	30	163
401 - 15	L 9950 N JG 10280 E	15	.7	69	18	352
401 - 16	L 9950 N JG 10300 E	20	.6	52	20	226
401 - 17	L 9950 N JG 10320 E	15	.8	82	28	307
401 - 18	L 9950 N JG 10340 E	35	2.8	76	30	171
401 - 19	L 9950 N JG 10380 E	30	1.2	54	99	135
401 - 20	L 9950 N JG 10400 E	60	2.1	47	92	128
401 - 21	L 9950 N JG 10420 E	5	1.2	27	21	111
401 - 22	L 9950 N JG 10440 E	55	.6	21	21	83
401 - 23	L 9950 N JG 10460 E	45	1.1	44	24	135
401 - 24	L 9950 N JG 10480 E	85	2.5	74	37	138
401 - 25	L 9950 N JG 10500 E	45	3.5	64	22	116
401 - 26	L 9950 N JG 10520 E	65	.4	45	25	56
401 - 27	L 9950 N JG 10540 E	70	4.3	123	32	102
401 - 28	L 9950 N JG 10560 E	30	.1	9	16	29
401 - 29	L 9950 N JG 10580 E	15	<.1	7	16	20
401 - 30	L 9950 N JG 10600 E	25	.3	10	20	42

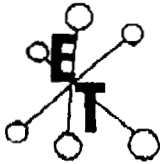

ECO-TECH LABORATORIES LTD.

ASSAYING - ENVIRONMENTAL TESTING

10041 East Trans Canada Hwy., Kamloops, B.C. V2C 2J3 (804) 573-6700 Fax 573-4557

Placer Dome Inc.

JULY 18, 1989

ET#	Description	Au (ppb)	Ag (ppm)	Cu (ppm)	Pb (ppm)	Zn (ppm)
401 - 31	L 10000 N JG 9400 E	10	.3	20	14	59
401 - 32	L 10000 N JG 9420 E	10	<.1	24	16	64
401 - 33	L 10000 N JG 9440 E	10	.3	32	16	65
401 - 34	L 10000 N JG 9460 E	20	.5	38	15	68
401 - 35	L 10000 N JG 9480 E	5	.2	21	18	49
401 - 36	L 10000 N JG 9500 E	10	.2	14	14	34
401 - 37	L 10000 N JG 9520 E	5	.4	15	12	37
401 - 38	L 10000 N JG 9540 E	15	.1	19	15	29
401 - 39	L 10000 N JG 9560 E	5	.2	16	14	31
401 - 40	L 10000 N JG 9580 E	15	.1	15	14	27
401 - 41	L 10000 N JG 9600 E	5	<.1	10	13	19
401 - 42	L 10000 N JG 9620 E	10	.1	16	10	32
401 - 43	L 10000 N JG 9640 E	10	.2	26	11	47
401 - 44	L 10000 N JG 9660 E	10	1	62	11	63
401 - 45	L 10000 N JG 9680 E	5	.1	17	13	30
401 - 46	L 10000 N JG 9700 E	20	.3	32	11	56
401 - 47	L 10000 N JG 9720 E	5	.1	15	12	19
401 - 48	L 10000 N JG 9740 E	10	.4	9	11	25
401 - 49	L 10000 N JG 9760 E	10	.1	53	15	40
401 - 50	L 10000 N JG 9780 E	10	.7	30	13	36
401 - 51	L 10000 N JG 9800 E	5	.3	19	18	41
401 - 52	L 10000 N JG 9820 E	5	.2	20	15	47
401 - 53	L 10000 N JG 9840 E	10	.6	58	16	72
401 - 54	L 10000 N JG 9860 E	5	.9	82	16	126
401 - 55	L 10000 N JG 9880 E	10	<.1	17	19	65
401 - 56	L 10000 N JG 9900 E	10	<.1	21	18	66
401 - 57	L 10000 N JG 9920 E	30	.1	25	19	63
401 - 58	L 10000 N JG 9940 E	10	.8	30	16	99
401 - 59	L 10000 N JG 9960 E	15	.3	43	18	188
401 - 60	L 10000 N JG 9980 E	15	.6	31	17	88
401 - 61	L 10000 N JG 10000 E	10	.2	35	19	83
401 - 62	L 10000 N JG 10020 E	10	.2	24	16	72
401 - 63	L 10000 N JG 10040 E	5	.7	40	15	69
401 - 64	L 10000 N JG 10060 E	5	.6	49	19	73
401 - 65	L 10000 N JG 10080 E	15	.8	82	17	89
401 - 66	L 10000 N JG 10100 E	20	.9	50	17	82
401 - 67	L 10000 N JG 10120 E	5	.3	34	19	58
401 - 68	L 10000 N JG 10140 E	10	.2	33	14	40
401 - 69	L 10000 N JG 10160 E	10	.6	34	20	57
401 - 70	L 10000 N JG 10180 E	10	.8	33	18	89
401 - 71	L 10000 N JG 10200 E	5	.2	23	20	82
401 - 72	L 10000 N JG 10220 E	15	.2	52	17	140
401 - 73	L 10000 N JG 10240 E	10	2.4	126	132	420
401 - 74	L 10000 N JG 10260 E	10	1.3	87	77	398
401 - 75	L 10000 N JG 10280 E	5	.2	29	26	143

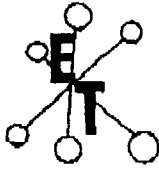

ECO-TECH LABORATORIES LTD.

ASSAYING - ENVIRONMENTAL TESTING

10041 East Trans Canada Hwy., Kamloops, B.C. V2G 2J3 (804) 573-5700 Fax 573-4557

Placer Dome Inc.

JULY 18, 1989

ET#	Description	Au (ppb)	Ag (ppm)	Cu (ppm)	Pb (ppm)	Zn (ppm)
401 - 76	L 10000 N JG 10300 E	60	.9	26	47	144
401 - 77	L 10000 N JG 10320 E	5	.9	24	23	102
401 - 78	L 10000 N JG 10340 E	5	1.1	26	24	71
401 - 79	L 10000 N JG 10360 E	20	1	30	24	127
401 - 80	L 10000 N JG 10380 E	30	1.2	18	21	86
401 - 81	L 10000 N JG 10400 E	5	.4	21	18	94
401 - 82	L 10000 N JG 10420 E	15	.9	38	22	96
401 - 83	L 10000 N JG 10440 E	10	.6	31	15	81
401 - 84	L 10000 N JG 10460 E	15	2.2	72	23	158
401 - 85	L 10000 N JG 10480 E	5	.6	22	37	90
401 - 86	L 10000 N JG 10500 E	30	.7	31	27	72
401 - 87	L 10000 N JG 10520 E	230	.4	19	14	32
401 - 88	L 10000 N JG 10540 E	45	.7	16	27	40
401 - 89	L 10000 N JG 10560 E	45	.6	23	20	52
401 - 90	L 10000 N JG 10580 E	10	.5	14	19	25
401 - 91	L 10000 N JG 10600 E	70	.6	24	23	55
401 - 92	L 10000 N JG 10000 E	5	1.6	136	15	151
401 - 93	L 10050 N JG 10020 E	10	.3	56	13	115
401 - 94	L 10050 N JG 10040 E	5	.7	54	15	99
401 - 95	L 10050 N JG 10060 E	10	.3	38	9	90
401 - 96	L 10050 N JG 10080 E	5	.4	44	16	91
401 - 97	L 10050 N JG 10100 E	10	.2	45	13	83
401 - 98	L 10050 N JG 10120 E	5	.2	46	15	120
401 - 99	L 10050 N JG 10140 E	10	<.1	23	19	47
401 - 100	L 10050 N JG 10160 E	15	.2	53	12	61
401 - 101	L 10050 N JG 10180 E	55	.9	55	38	168
401 - 102	L 10050 N JG 10200 E	<5	.4	29	15	76
401 - 103	L 10050 N JG 10220 E	65	1.1	52	39	117
401 - 104	L 10050 N JG 10240 E	5	.3	49	17	112
401 - 105	L 10050 N JG 10260 E	55	1.6	121	70	167
401 - 106	L 10050 N JG 10280 E	20	.2	51	105	195
401 - 107	L 10050 N JG 10300 E	15	.3	56	37	126
401 - 108	L 10050 N JG 10320 E	410	5.8	82	>1000	772
401 - 109	L 10050 N JG 10340 E	40	1.7	35	34	206
401 - 110	L 10050 N JG 10360 E	10	.7	41	21	90
401 - 111	L 10050 N JG 10380 E	10	.5	25	19	74
401 - 112	L 10050 N JG 10400 E	25	1.2	48	25	135
401 - 113	L 10050 N JG 10420 E	10	.1	31	53	110
401 - 114	L 10050 N JG 10440 E	15	.5	47	16	84
401 - 115	L 10050 N JG 10460 E	25	.8	65	16	83
401 - 116	L 10050 N JG 10500 E	205	2.5	106	34	161
401 - 117	L 10050 N JG 10520 E	35	1.3	55	29	111
401 - 118	L 10050 N JG 10540 E	65	<.1	26	18	73
401 - 119	L 10050 N JG 10560 E	5	<.1	15	12	17
401 - 120	L 10050 N JG 10580 E	10	<.1	10	19	26

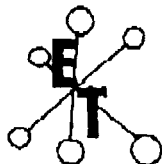

ECO-TECH LABORATORIES LTD.

ASSAYING - ENVIRONMENTAL TESTING

10041 East Trans Canada Hwy., Kamloops, B.C. V2C 2J3 (604) 573-5700 Fax 573-4557

Placer Dome Inc.

JULY 18, 1989

ET#	Description	Au (ppb)	Ag (ppm)	Cu (ppm)	Pb (ppm)	Zn (ppm)
401 - 121	L 10050 N JG 10600 E	75	.2	34	29	79
401 - 122	L 10050 N JG 10000 E	20	1.4	124	21	200
401 - 123	L 10100 N JG 10020 E	5	1.1	107	20	168
401 - 124	L 10100 N JG 10040 E	15	.8	49	18	78
401 - 125	L 10100 N JG 10060 E	<5	.2	61	17	68
401 - 126	L 10100 N JG 10080 E	<5	.7	76	36	180
401 - 127	L 10100 N JG 10100 E	<5	.3	40	19	59
401 - 128	L 10100 N JG 10120 E	<5	<.1	25	14	50
401 - 129	L 10100 N JG 10140 E	<5	.9	89	16	84
401 - 130	L 10100 N JG 10160 E	<5	.2	42	14	63
401 - 131	L 10100 N JG 10180 E	<5	.1	24	16	62
401 - 132	L 10100 N JG 10200 E	<5	<.1	17	16	56
401 - 133	L 10100 N JG 10220 E	<5	<.1	68	15	81
401 - 134	L 10100 N JG 10240 E	<5	.3	29	16	46
401 - 135	L 10100 N JG 10260 E	<5	.7	73	19	66
401 - 136	L 10100 N JG 10280 E	<5	.2	45	14	53
401 - 137	L 10100 N JG 10320 E	<5	.4	36	21	77
401 - 138	L 10100 N JG 10340 E	<5	.4	41	20	102
401 - 139	L 10100 N JG 10360 E	<5	.4	50	16	68
401 - 140	L 10100 N JG 10380 E	<5	.2	39	14	64
401 - 141	L 10100 N JG 10400 E	<5	<.1	25	13	40
401 - 142	L 10100 N JG 10420 E	20	1.9	92	183	240
401 - 143	L 10100 N JG 10440 E	40	<.1	34	80	110
401 - 144	L 10100 N JG 10460 E	<5	<.1	26	33	86
401 - 145	L 10100 N JG 10480 E	<5	<.1	44	24	65
401 - 146	L 10100 N JG 10500 E	5	<.1	49	24	90
401 - 147	L 10100 N JG 10540 E	10	1.3	76	25	68
401 - 148	L 10100 N JG 10560 E	30	1	102	23	72
401 - 149	L 10100 N JG 10580 E	<5	.9	88	24	69
401 - 150	L 10100 N JG 10600 E	20	<.1	52	27	50
401 - 151	L 10100 N JG 10000 E	5	.2	56	15	67
401 - 152	L 10150 N JG 10020 E	<5	<.1	47	22	64
401 - 153	L 10150 N JG 10040 E	<5	.6	67	18	72
401 - 154	L 10150 N JG 10060 E	<5	.4	69	20	109
401 - 155	L 10150 N JG 10100 E	<5	.6	51	16	84
401 - 156	L 10150 N JG 10140 E	<5	.2	61	9	62
401 - 157	L 10150 N JG 10160 E	5	.3	28	10	80
401 - 158	L 10150 N JG 10180 E	<5	.3	27	9	59
401 - 159	L 10150 N JG 10200 E	<5	.2	59	11	73
401 - 160	L 10150 N JG 10220 E	<5	.4	39	18	109
401 - 161	L 10150 N JG 10240 E	<5	.4	23	7	94
401 - 162	L 10150 N JG 10260 E	<5	.3	45	11	80
401 - 163	L 10150 N JG 10280 E	15	1.8	213	22	136
401 - 164	L 10150 N JG 10300 E	10	.9	90	17	87
401 - 165	L 10150 N JG 10320 E	10	1.2	97	18	112

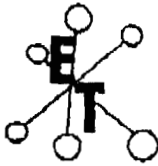
**ECO-TECH LABORATORIES LTD.**

ASSAYING - ENVIRONMENTAL TESTING

10041 East Trans Canada Hwy., Kamloops, B.C. V2C 2J3 (804) 573-5700 Fax 573-4557

Placer Dome Inc.

JULY 18, 1989

ET#	Description	AU (ppb)	Ag (ppm)	Cu (ppm)	Pb (ppm)	Zn (ppm)
401 - 166	L 10150 N JG 10340 E	5	.6	40	12	64
401 - 167	L 10150 N JG 10360 E	50	.4	25	9	59
401 - 168	L 10150 N JG 10380 E	60	.5	33	14	58
401 - 169	L 10150 N JG 10400 E	10	.6	24	18	90
401 - 170	L 10150 N JG 10420 E	30	.4	28	12	64
401 - 171	L 10150 N JG 10440 E	75	2	129	22	64
401 - 172	L 10150 N JG 10460 E	15	.8	45	17	35
401 - 173	L 10150 N JG 10480 E	20	.5	84	16	54
401 - 174	L 10150 N JG 10500 E	20	2.3	142	21	82
401 - 175	L 10150 N JG 10540 E	60	.5	15	14	54
401 - 176	L 10150 N JG 10560 E	30	.4	40	20	105
401 - 177	L 10150 N JG 10580 E	15	.7	20	18	48
401 - 178	L 10150 N JG 10600 E	65	.2	14	10	40

Doug Howard
 ECO-TECH LABORATORIES LTD.
 DOUG HOWARD
 B.C. CERTIFIED ASSAYER

CC: LORNE WARNER
 FAX
 SC89/PLACER2

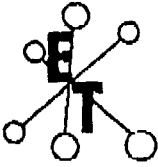
**ECO-TECH LABORATORIES LTD.**

ASSAYING - ENVIRONMENTAL TESTING

10041 East Trans Canada Hwy., Kamloops, B.C. V2C 2J3 (604) 573-5700 Fax 573-4557

AUGUST 2, 1989

CERTIFICATE OF ANALYSIS ETK 89-401B
 =====

 Placer Dome Inc.
 401, 1450 Pearson Place
 KAMLOOPS, B.C.
 V1S 1J9

 =====
 DATE RECEIVED: JULY 4, 1989 REJECTS: N/A
 PROJECT: GENERAL 1E - JC PULPS: STORE
 NUMBER SAMPLES: 178
 TYPE SAMPLES: SOILS
 =====

ET#	Description	As (ppm)
401 - 1	L 9950 N JG 10000 E	17
401 - 2	L 9950 N JG 10020 E	20
401 - 3	L 9950 N JG 10040 E	15
401 - 4	L 9950 N JG 10060 E	18
401 - 5	L 9950 N JG 10080 E	21
401 - 6	L 9950 N JG 10100 E	21
401 - 7	L 9950 N JG 10120 E	10
401 - 8	L 9950 N JG 10140 E	6
401 - 9	L 9950 N JG 10160 E	39
401 - 10	L 9950 N JG 10180 E	17
401 - 11	L 9950 N JG 10200 E	18
401 - 12	L 9950 N JG 10220 E	22
401 - 13	L 9950 N JG 10240 E	25
401 - 14	L 9950 N JG 10260 E	13
401 - 15	L 9950 N JG 10280 E	10
401 - 16	L 9950 N JG 10300 E	16
401 - 17	L 9950 N JG 10320 E	20
401 - 18	L 9950 N JG 10340 E	30
401 - 19	L 9950 N JG 10380 E	35
401 - 20	L 9950 N JG 10400 E	38
401 - 21	L 9950 N JG 10420 E	13
401 - 22	L 9950 N JG 10440 E	36
401 - 23	L 9950 N JG 10460 E	42
401 - 24	L 9950 N JG 10480 E	34
401 - 25	L 9950 N JG 10500 E	40
401 - 26	L 9950 N JG 10520 E	40
401 - 27	L 9950 N JG 10540 E	50
401 - 28	L 9950 N JG 10560 E	29
401 - 29	L 9950 N JG 10580 E	15
401 - 30	L 9950 N JG 10600 E	30

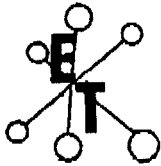

ECO-TECH LABORATORIES LTD.

ASSAYING - ENVIRONMENTAL TESTING

10041 East Trans Canada Hwy., Kamloops, B.C. V2C 2J3 (904) 573-5700 Fax 573-4557

Placer Dome Inc.

ET#	Description	As (ppm)
401 - 31	L 10000 N JG 9400 E	10
401 - 32	L 10000 N JG 9420 E	7
401 - 33	L 10000 N JG 9440 E	6
401 - 34	L 10000 N JG 9460 E	10
401 - 35	L 10000 N JG 9480 E	5
401 - 36	L 10000 N JG 9500 E	3
401 - 37	L 10000 N JG 9520 E	7
401 - 38	L 10000 N JG 9540 E	5
401 - 39	L 10000 N JG 9560 E	11
401 - 40	L 10000 N JG 9580 E	9
401 - 41	L 10000 N JG 9600 E	6
401 - 42	L 10000 N JG 9620 E	14
401 - 43	L 10000 N JG 9640 E	15
401 - 44	L 10000 N JG 9660 E	22
401 - 45	L 10000 N JG 9680 E	10
401 - 46	L 10000 N JG 9700 E	16
401 - 47	L 10000 N JG 9720 E	6
401 - 48	L 10000 N JG 9740 E	9
401 - 49	L 10000 N JG 9760 E	17
401 - 50	L 10000 N JG 9780 E	17
401 - 51	L 10000 N JG 9800 E	15
401 - 52	L 10000 N JG 9820 E	13
401 - 53	L 10000 N JG 9840 E	47
401 - 54	L 10000 N JG 9860 E	47
401 - 55	L 10000 N JG 9880 E	13
401 - 56	L 10000 N JG 9900 E	17
401 - 57	L 10000 N JG 9920 E	14
401 - 58	L 10000 N JG 9940 E	31
401 - 59	L 10000 N JG 9960 E	32
401 - 60	L 10000 N JG 9980 E	21
401 - 61	L 10000 N JG 10000 E	18
401 - 62	L 10000 N JG 10020 E	15
401 - 63	L 10000 N JG 10040 E	19
401 - 64	L 10000 N JG 10060 E	17
401 - 65	L 10000 N JG 10080 E	17
401 - 66	L 10000 N JG 10100 E	28
401 - 67	L 10000 N JG 10120 E	21
401 - 68	L 10000 N JG 10140 E	16
401 - 69	L 10000 N JG 10160 E	22
401 - 70	L 10000 N JG 10180 E	24
401 - 71	L 10000 N JG 10200 E	23
401 - 72	L 10000 N JG 10220 E	34
401 - 73	L 10000 N JG 10240 E	35
401 - 74	L 10000 N JG 10260 E	53
401 - 75	L 10000 N JG 10280 E	31

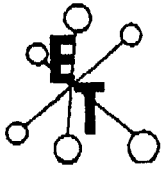

ECO-TECH LABORATORIES LTD.

ASSAYING - ENVIRONMENTAL TESTING

10041 East Trans Canada Hwy., Kamloops, B.C. V2C 2J3 (604) 573-6700 Fax 573-4557

Placer Dome Inc.

ET#	Description	As (ppm)
401 - 76	L 10000 N JG 10300 E	51
401 - 77	L 10000 N JG 10320 E	47
401 - 78	L 10000 N JG 10340 E	30
401 - 79	L 10000 N JG 10360 E	28
401 - 80	L 10000 N JG 10380 E	23
401 - 81	L 10000 N JG 10400 E	25
401 - 82	L 10000 N JG 10420 E	34
401 - 83	L 10000 N JG 10440 E	24
401 - 84	L 10000 N JG 10460 E	22
401 - 85	L 10000 N JG 10480 E	98
401 - 86	L 10000 N JG 10500 E	56
401 - 87	L 10000 N JG 10520 E	24
401 - 88	L 10000 N JG 10540 E	32
401 - 89	L 10000 N JG 10560 E	11
401 - 90	L 10000 N JG 10580 E	22
401 - 91	L 10000 N JG 10600 E	21
401 - 92	L 10000 N JG 10000 E	49
401 - 93	L 10050 N JG 10020 E	23
401 - 94	L 10050 N JG 10040 E	21
401 - 95	L 10050 N JG 10060 E	32
401 - 96	L 10050 N JG 10080 E	23
401 - 97	L 10050 N JG 10100 E	21
401 - 98	L 10050 N JG 10120 E	19
401 - 99	L 10050 N JG 10140 E	22
401 - 100	L 10050 N JG 10160 E	20
401 - 101	L 10050 N JG 10180 E	25
401 - 102	L 10050 N JG 10200 E	40
401 - 103	L 10050 N JG 10220 E	42
401 - 104	L 10050 N JG 10240 E	48
401 - 105	L 10050 N JG 10260 E	32
401 - 106	L 10050 N JG 10280 E	24
401 - 107	L 10050 N JG 10300 E	31
401 - 108	L 10050 N JG 10320 E	20
401 - 109	L 10050 N JG 10340 E	19
401 - 110	L 10050 N JG 10360 E	21
401 - 111	L 10050 N JG 10380 E	18
401 - 112	L 10050 N JG 10400 E	23
401 - 113	L 10050 N JG 10420 E	21
401 - 114	L 10050 N JG 10440 E	20
401 - 115	L 10050 N JG 10460 E	3
401 - 116	L 10050 N JG 10500 E	18
401 - 117	L 10050 N JG 10520 E	12
401 - 118	L 10050 N JG 10540 E	15
401 - 119	L 10050 N JG 10560 E	2
401 - 120	L 10050 N JG 10580 E	7

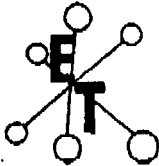

ECO-TECH LABORATORIES LTD.

ASSAYING - ENVIRONMENTAL TESTING

10041 East Trans Canada Hwy., Kamloops, B.C. V2C 2J3 (804) 573-5700 Fax 573-4567

Placer Dome Inc.

ET#	Description	As (ppm)
401 - 121	L 10050 N JG 10600 E	20
401 - 122	L 10050 N JG 10000 E	4
401 - 123	L 10100 N JG 10020 E	4
401 - 124	L 10100 N JG 10040 E	3
401 - 125	L 10100 N JG 10060 E	2
401 - 126	L 10100 N JG 10080 E	3
401 - 127	L 10100 N JG 10100 E	3
401 - 128	L 10100 N JG 10120 E	2
401 - 129	L 10100 N JG 10140 E	5
401 - 130	L 10100 N JG 10160 E	7
401 - 131	L 10100 N JG 10180 E	5
401 - 132	L 10100 N JG 10200 E	7
401 - 133	L 10100 N JG 10220 E	4
401 - 134	L 10100 N JG 10240 E	5
401 - 135	L 10100 N JG 10260 E	5
401 - 136	L 10100 N JG 10280 E	2
401 - 137	L 10100 N JG 10320 E	2
401 - 138	L 10100 N JG 10340 E	4
401 - 139	L 10100 N JG 10360 E	5
401 - 140	L 10100 N JG 10380 E	6
401 - 141	L 10100 N JG 10400 E	4
401 - 142	L 10100 N JG 10420 E	9
401 - 143	L 10100 N JG 10440 E	6
401 - 144	L 10100 N JG 10460 E	5
401 - 145	L 10100 N JG 10480 E	5
401 - 146	L 10100 N JG 10500 E	2
401 - 147	L 10100 N JG 10540 E	9
401 - 148	L 10100 N JG 10560 E	10
401 - 149	L 10100 N JG 10580 E	10
401 - 150	L 10100 N JG 10600 E	12
401 - 151	L 10100 N JG 10000 E	11
401 - 152	L 10150 N JG 10020 E	2
401 - 153	L 10150 N JG 10040 E	26
401 - 154	L 10150 N JG 10060 E	28
401 - 155	L 10150 N JG 10100 E	28
401 - 156	L 10150 N JG 10140 E	25
401 - 157	L 10150 N JG 10160 E	22
401 - 158	L 10150 N JG 10180 E	23
401 - 159	L 10150 N JG 10200 E	20
401 - 160	L 10150 N JG 10220 E	24
401 - 161	L 10150 N JG 10240 E	20
401 - 162	L 10150 N JG 10260 E	27
401 - 163	L 10150 N JG 10280 E	31
401 - 164	L 10150 N JG 10300 E	27
401 - 165	L 10150 N JG 10320 E	25

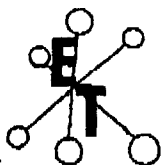

ECO-TECH LABORATORIES LTD.

ASSAYING - ENVIRONMENTAL TESTING

10041 East Trans Canada Hwy., Kamloops, B.C. V2C 2J3 (804) 573-5700 Fax 573-4567

Placer Dome Inc.

ET#	Description	As (ppm)
401 - 166	L 10150 N JG 10340 E	18
401 - 167	L 10150 N JG 10360 E	19
401 - 168	L 10150 N JG 10380 E	17
401 - 169	L 10150 N JG 10400 E	19
401 - 170	L 10150 N JG 10420 E	22
401 - 171	L 10150 N JG 10440 E	41
401 - 172	L 10150 N JG 10460 E	34
401 - 173	L 10150 N JG 10480 E	60
401 - 174	L 10150 N JG 10500 E	37
401 - 175	L 10150 N JG 10540 E	49
401 - 176	L 10150 N JG 10560 E	46
401 - 177	L 10150 N JG 10580 E	44
401 - 178	L 10150 N JG 10600 E	30

Doug Howard
 ECO-TECH LABORATORIES LTD.
 DOUG HOWARD
 B.C. CERTIFIED ASSAYER

CC: LORNE WARNER
 FAX
 SC89/PLACER2

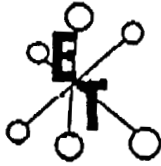

ECO-TECH LABORATORIES LTD.

ASSAYING - ENVIRONMENTAL TESTING
 10041 East Trans Canada Hwy., Kamloops, B.C. V2C 2J3 (804) 573-5700 Fax 573-4667

JUNE 16, 1989

CERTIFICATE OF ANALYSIS ETK 89-286

Placer Dome Inc.
 401, 1450 Pearson Place
 KAMLOOPS, B.C.
 V1S 1J9

=====

DATE RECEIVED: JUNE 9, 1989 REJECTS: STORE
 PROJECT: GENERAL - 1E PULPS: STORE
 NUMBER SAMPLES: 17
 TYPE SAMPLES: SOILS NOTE: < = LESS THAN

=====

ET#	Description	Au (ppb)	Ag (ppm)	Cu (ppm)	Pb (ppm)	Zn (ppm)
286 - 1	JOE CLAIM 1000N 900E B2	15	.3	51	11	163
286 - 2	JOE CLAIM 1000N 920E B2	10	.2	47	37	258
286 - 3	JOE CLAIM 1000N 940E B2 SOILORG	45	1.1	146	38	237
286 - 4	JOE CLAIM 1000N 950E B2	<5	.6	92	43	219
286 - 5	JOE CLAIM 1000N 960E B2	10	.7	97	152	502
286 - 6	JOE CLAIM 1000N 980E B2	195	3.1	111	67	522
286 - 7	JOE CLAIM 1000N 990E B2	45	1.6	107	44	198
286 - 8	JOE CLAIM 10+00N 10+00E B2 FE/QTS	155	21.3	212	>1000	>1000
286 - 9	JOE CLAIM 1000N 900E X6	5	<.1	67	11	145
286 - 10	JOE CLAIM 1000N 910E X6	150	3.1	234	245	783
286 - 11	JOE CLAIM 1000N 920E X6	25	1	63	29	304
286 - 12	JOE CLAIM 1000N 930E X6 QTS	>1000	4.2	142	165	587
286 - 13	JOE CLAIM 1000N 950E X6	20	.1	53	10	141
286 - 14	JOE CLAIM 1000N 960E X6	25	.9	88	97	303
286 - 15	JOE SOILS 1000N 970E X6	115	1.1	99	40	299
286 - 16	JOE SOILS 1000N 990E X6	175	.7	267	72	850
286 - 17	JOE SOILS 1000N 1000E X6	>1000	6.5	211	>1000	>1000

Doug Howard
 ECO-TECH LABORATORIES LTD.
 DOUG HOWARD
 B.C. Certified Assayer

F A X
 SCB9/PLACER1
 CC: LORNE WARNER

CHECK SOIL SAMPLES - PLATE 3 (POCKET)
 B2 - B-HORIZON
 X6 - BELOW B HORIZON

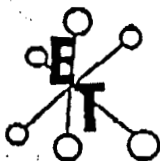

ECO-TECH LABORATORIES LTD.

ASSAYING - ENVIRONMENTAL TESTING
 10041 East Trans Canada Hwy., Kamloops, B.C. V2C 2J3 (604) 673-5700 Fax 573-4557

JUNE 15, 1989

CERTIFICATE OF ANALYSIS ETK 89-285

Placer Dome Inc.
 401, 1450 Pearson Place
 KAMLOOPS, B.C.
 V1S 1J9

DATE RECEIVED: JUNE 9, 1989
 PROJECT: GENERAL - 1E
 NUMBER SAMPLES: 6
 TYPE SAMPLES: ROCKS

REJECTS: STORE
 PULPS: STORE

NOTE: < = LESS THAN

ET#	Description	AU (ppb)	AU (g/t)	AU (oz/t)	Ag (ppm)	Ag (g/t)	Cu (ppm)	Pb (ppm)	Pb (%)	Cu (%)	Zn (ppm)	Z (%)
285 - 1	42758	15			<.1		16	4			46	
285 - 2	42759	10			<.1		46	8			69	
285 - 3	42760	>1000	3.22	.094	>30.0	164.2	208	>1000	6.3		484	
285 - 4	42761	30			2.7		36	406			140	
285 - 5	42762	170			1.0		281	108			376	
285 - 6	42763	35			<.1		130	27			>1000	

Douglas Howard
 ECO-TECH LABORATORIES LTD.
 DOUG HOWARD
 B.C. Certified Assayer

FAX
 SC89/PLACER1
 CC: LORNE WARNER

Rock Samples - PLATE 3 (Pocket)

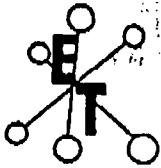

ECO-TECH LABORATORIES LTD.

ASSAYING - ENVIRONMENTAL TESTING

10041 East Trans Canada Hwy., Kamloops, B.C. V2C 2J3 (604) 573-5700 Fax 573-4657

AUGUST 23, 1989

CERTIFICATE OF ANALYSIS ETK 89-623

Placer Dome Inc.
401, 1450 Pearson Place
KAMLOOPS, B.C.
V1S 1J9

DATE RECEIVED: AUGUST 17, 1989
PROJECT: GENERAL 1E
NUMBER SAMPLES: 10
TYPE SAMPLES: ROCK

REJECTS: STORE
PULPS: STORE

NOTE: > = MORE THAN

ET#	Description	Au (ppb)	Au (g/t)	Au (oz/t)	Ag (ppm)	Ag (g/t)	Ag (oz/t)	Cu (ppm)	Cu (%)	Pb (ppm)	Pb (%)	Zn (ppm)	Zn (%)
623 - 1	52701	155			3.9			65		>1000	.14	532	
623 - 2	52702	40			.2			176		57		183	
623 - 3	52703	70			.4			22		39		81	
623 - 4	52704	25			.3			46		51		133	
623 - 5	52705	45			<.1			40		59		159	
623 - 6	52706	40			<.1			16		33		43	
623 - 7	52707	140			.2			10		36		26	
623 - 8	52708	200			>30.	38.9	1.134	44		>1000	1.96	>1000	.79
623 - 9	52709	>1000	2.50	.074	>30.	134.0	0.400	511		>1000	1.72	>1000	.75
623 - 10	52710	>1000	6.49	.189	>30.	8420.0	245.553	>1000	.26	>1000	05.7	>1000	6.20

Douglas Howard
ECO-TECH LABORATORIES LTD.
DOUG HOWARD
B.C. Certified Assayer

Rock Samples
PLATE 3 (POCKET)

F A X - LORNE WARNER
SC89/PLACER6

ROCK ASSAYS - DESCRIPTION

<u>ASSAY #</u>	<u>DESCRIPTION</u>
42758	Brecciated Chert
42759	Brecciated Chert
42760	Quartz Float with visible Galena
42761	Quartz Float with no visible Galena
42762	Pyritic Grey Phyllite, fractured, minor Quartz infilling
42763	Ferricrete Zone - Highly Oxidized
52701	Quartz Stringers
52702	Grey Phyllite - Slightly Pyritic
52703	Quartz Breccia
52704	Grey Phyllite, - Slightly Pyritic
52705	Altered Phyllite
52706	Quartz Breccia
52707	Brecciated Phyllite - 10 - 15% Quartz
52708	Bleached Phyllite - 10 - 15% Quartz (subcrop)

(SEE PLATE 3 - IN POCKET - FOR SAMPLE LOCATIONS)

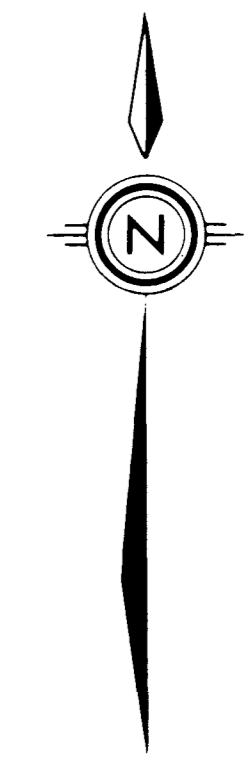

LEGEND

- ROAD
- ~ CREEK
- - - CLAIM BOUNDARY
- GRID LINE WITH SOIL GEOCHEMICAL GOLD VALUE (ppb) (1987 GRID) OVERLAY
- 25 SOIL SAMPLE LOCATION AND GOLD VALUE (ppb) (1987)
- ▨ CHERT, BRECCIATED, SILICA FLOODED
- ▨ BLACK PHYLLITE — FINE GRAIN TUFF
- ▨ DIORITE
- 40°/15° STRIKE AND DIP OF BEDDING
- * 10/55 PDI, 1989 SOIL SAMPLE FIRST NUMBER GIVES Au ASSAY IN ppb OF B2 SOIL HORIZON. SECOND NUMBER GIVES Au ASSAY IN ppb OF XG SOIL HORIZON.
- L10050N PDI, 1989 GRID LINE
- ▲ 52701-52708 42758-42763 ROCK SAMPLES (1989)

**GEOLOGICAL BRANCH
ASSESSMENT REPORT**

19,546

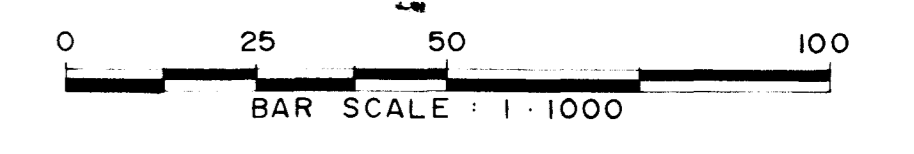

PLACER DOME INC.	
JOE CLAIMS	
<i>Geological Plan</i>	
TECHNICAL WORK BY: L. WARNER	DATE: AUG. / 1989
DRAWN BY: D. B. MIRTLE	SCALE: 1:1000
NTS 82M/5W	FIGURE NO. PLATE 3

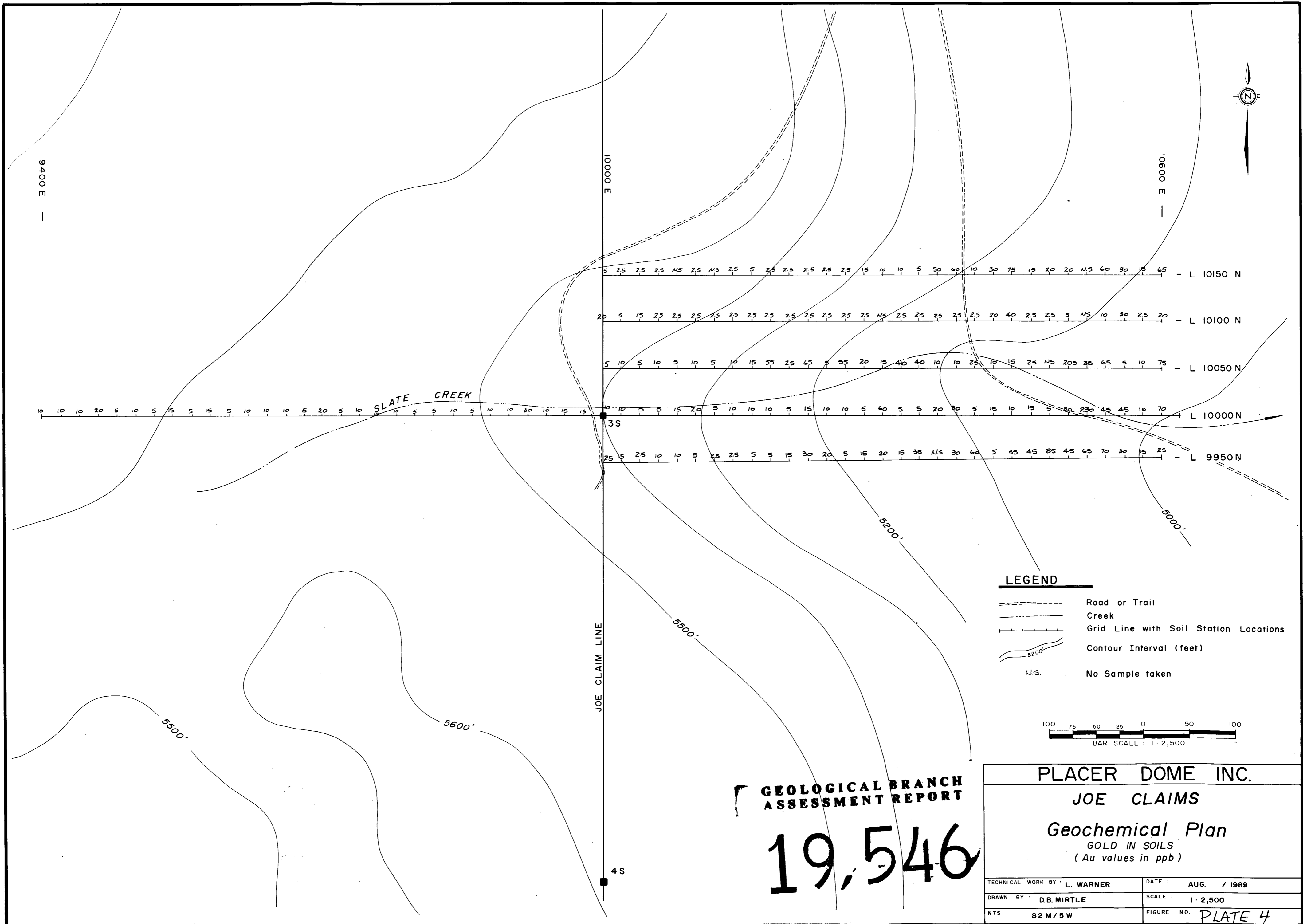

LEGEND

- Road or Trail
- Creek
- Grid Line with Soil Station Locations
- Contour Interval (feet)
- No Sample taken



**GEOLOGICAL BRANCH
ASSESSMENT REPORT**

19,546

PLACER DOME INC.

JOE CLAIMS

Geochemical Plan

GOLD IN SOILS
(Au values in ppb)

TECHNICAL WORK BY: L. WARNER	DATE: AUG. / 1989
DRAWN BY: D.B. MIRTLE	SCALE: 1:2,500
NTS 82 M / 5 W	FIGURE NO. PLATE 4

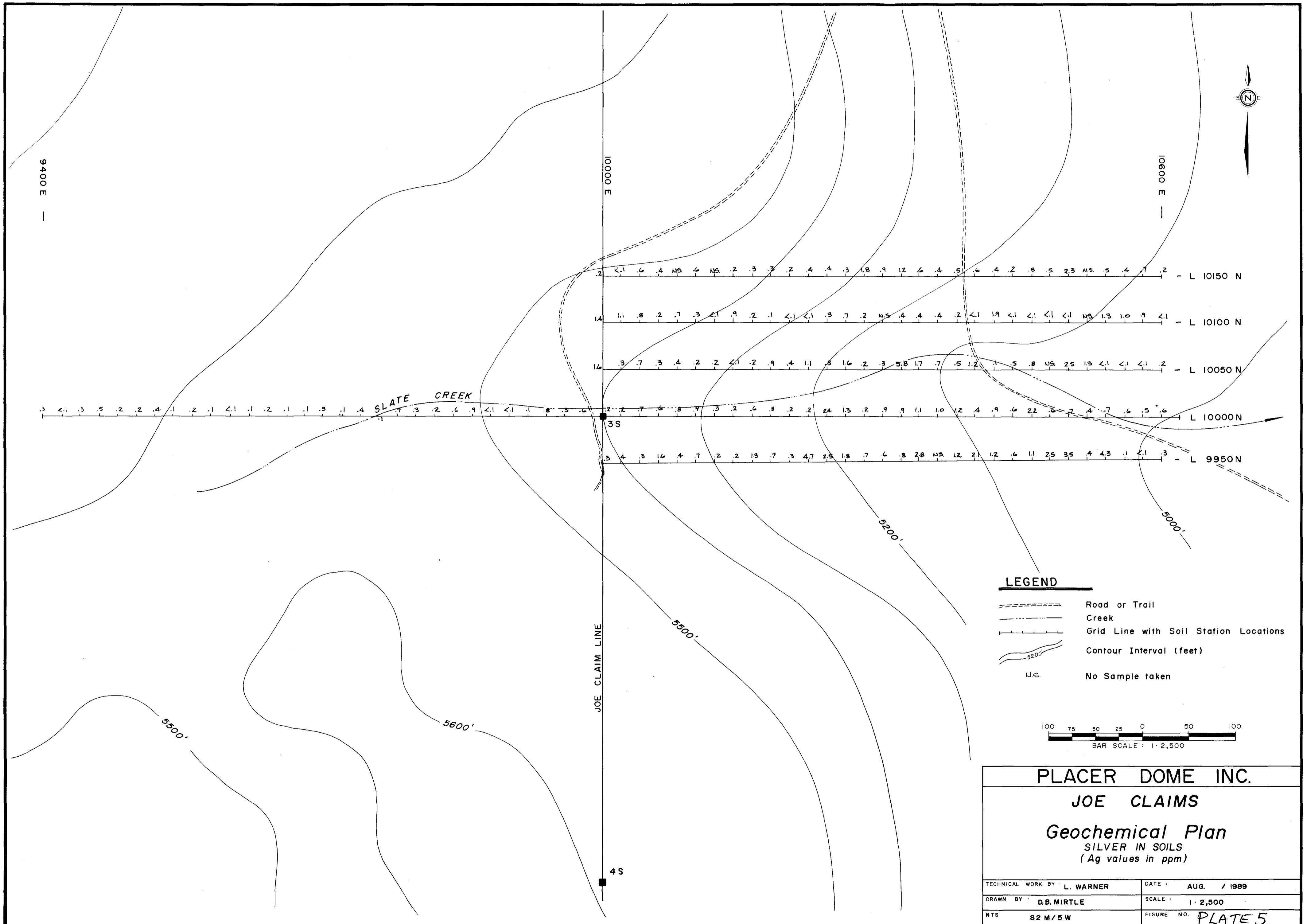

LEGEND

- Road or Trail
- Creek
- Grid Line with Soil Station Locations
- Contour Interval (feet)
- No Sample taken

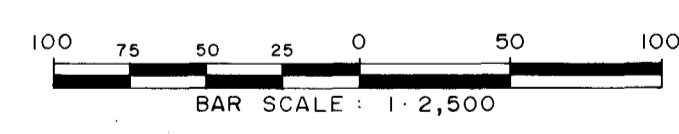

PLACER DOME INC.	
JOE CLAIMS	
Geochemical Plan	
SILVER IN SOILS (Ag values in ppm)	
TECHNICAL WORK BY: L. WARNER	DATE: AUG. / 1989
DRAWN BY: D.B. MIRTLE	SCALE: 1:2,500
NTS 82 M/5 W	FIGURE NO. PLATE 5

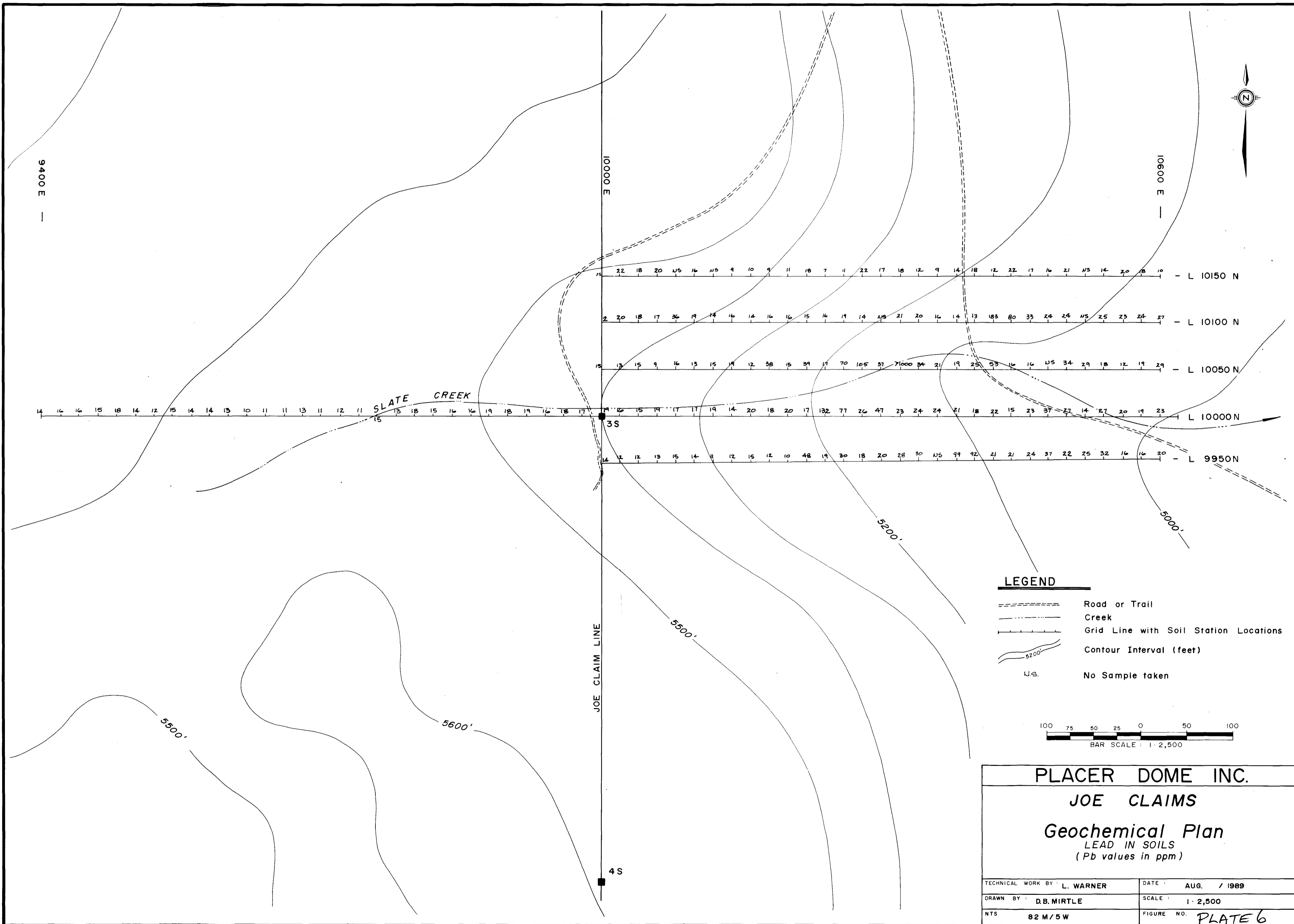

LEGEND

- Road or Trail
- Creek
- Grid Line with Soil Station Locations
- Contour Interval (feet)
- N.S. No Sample taken

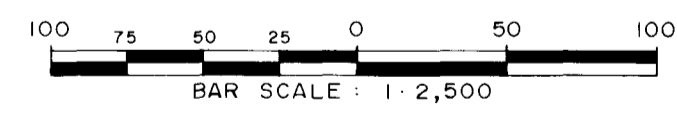



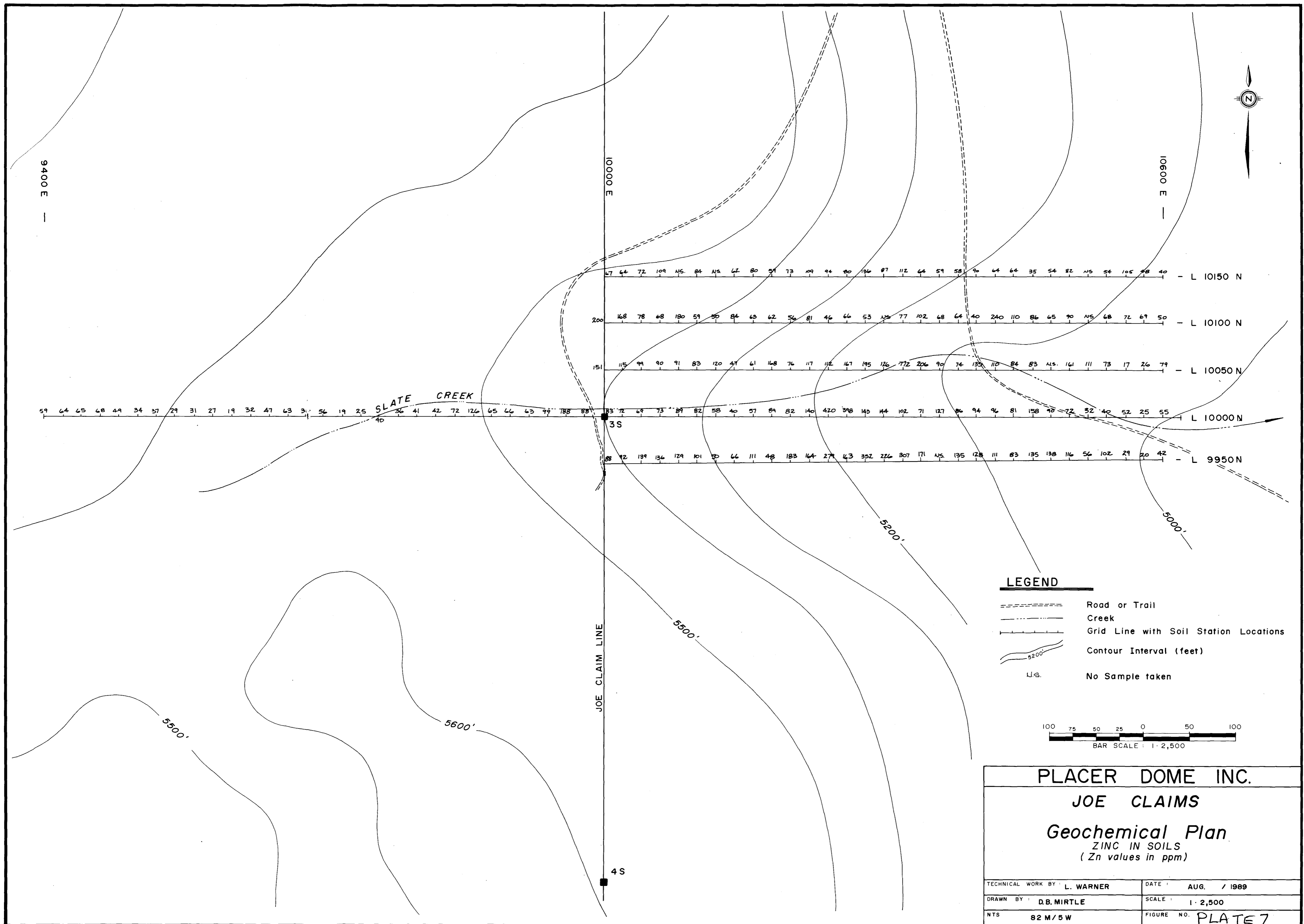

PLACER DOME INC.
JOE CLAIMS
Geochemical Plan
 LEAD IN SOILS
 (Pb values in ppm)

TECHNICAL WORK BY: L. WARNER	DATE: AUG. / 1989
DRAWN BY: D.B. MIRTLE	SCALE: 1:2,500
NTS 82 M/5 W	FIGURE NO. PLATE 6

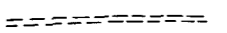

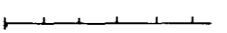
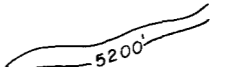
LEGEND

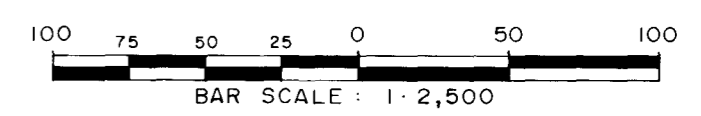

-  Road or Trail
-  Creek
-  Grid Line with Soil Station Locations
-  Contour Interval (feet)
-  N.S. No Sample taken

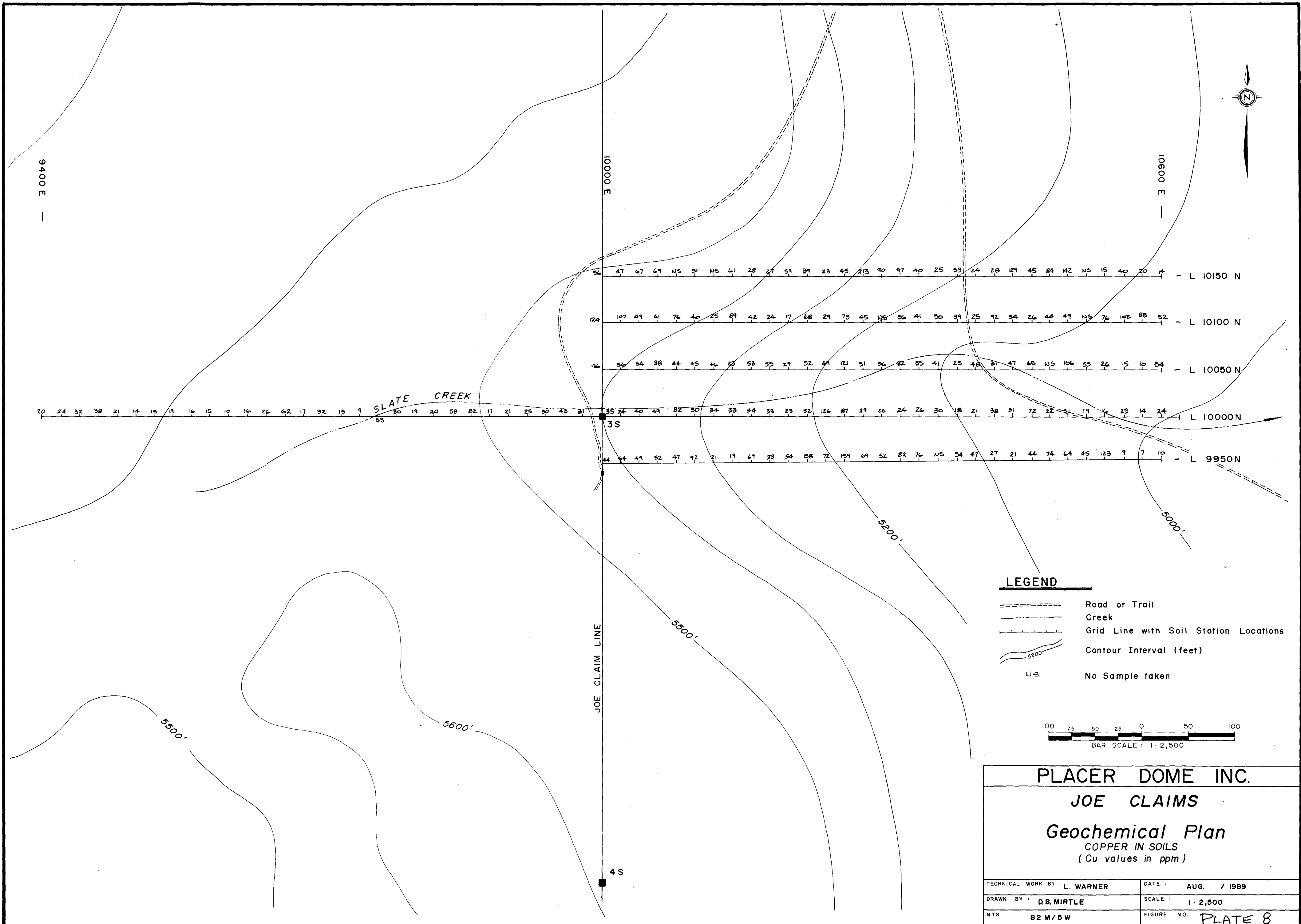

PLACER DOME INC.	
JOE CLAIMS	
Geochemical Plan	
ZINC IN SOILS (Zn values in ppm)	
TECHNICAL WORK BY: L. WARNER	DATE: AUG. / 1989
DRAWN BY: D.B. MIRTLE	SCALE: 1:2,500
NTS 82 M/5 W	FIGURE NO. PLATE 7

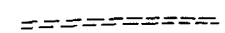
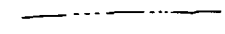
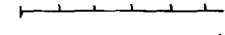
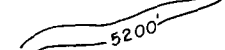

LEGEND

-  Road or Trail
-  Creek
-  Grid Line with Soil Station Locations
-  Contour Interval (feet)
-  N.S. No Sample taken

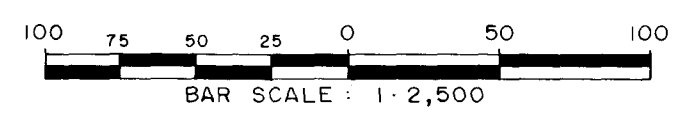

PLACER DOME INC.	
JOE CLAIMS	
Geochemical Plan	
COPPER IN SOILS (Cu values in ppm)	
TECHNICAL WORK BY: L. WARNER	DATE: AUG. / 1989
DRAWN BY: D.B. MIRTLE	SCALE: 1:2,500
NTS 82 M/5 W	FIGURE NO. PLATE 8

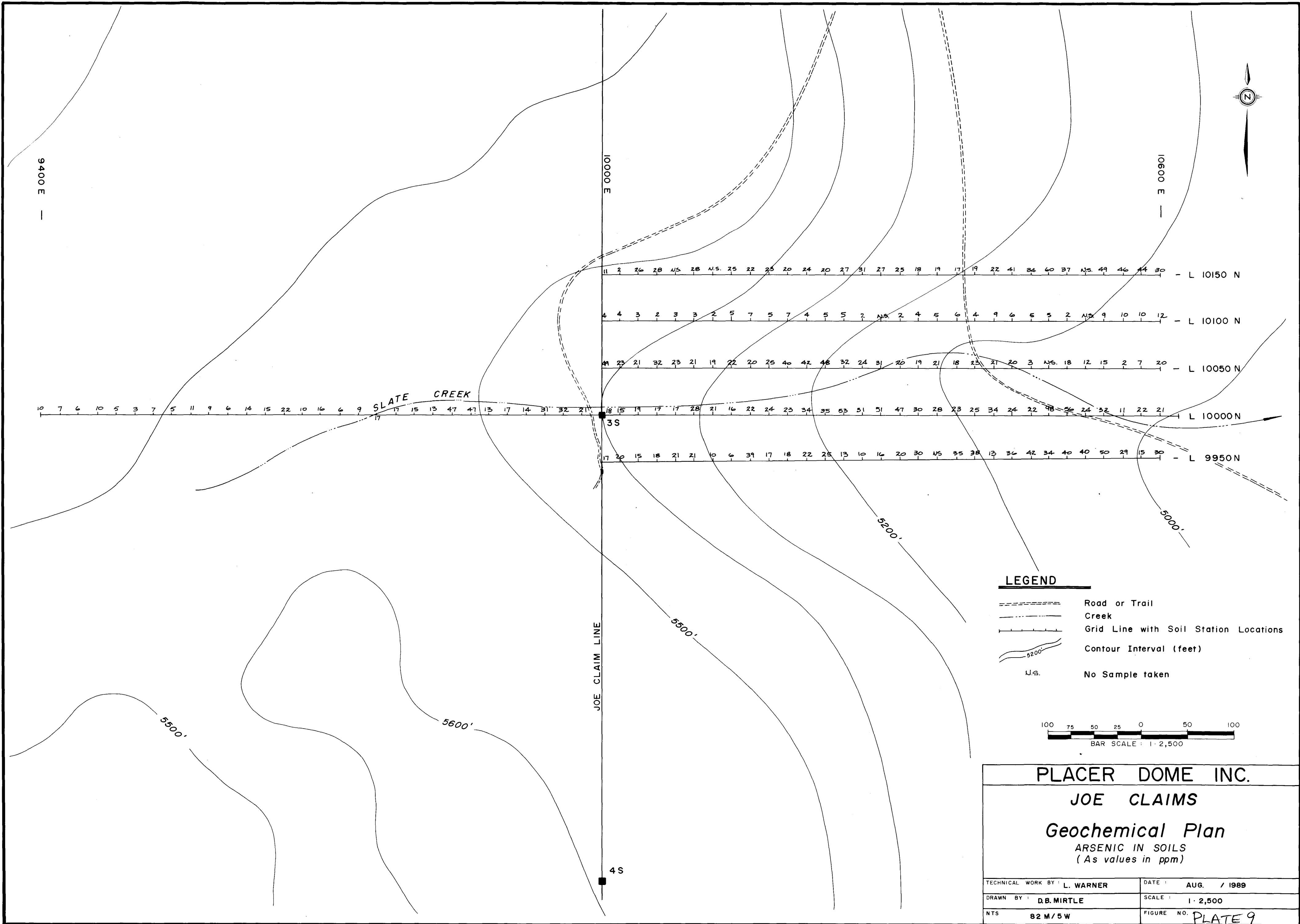

LEGEND

- Road or Trail
- Creek
- Grid Line with Soil Station Locations
- Contour Interval (feet)
- N.S. No Sample taken

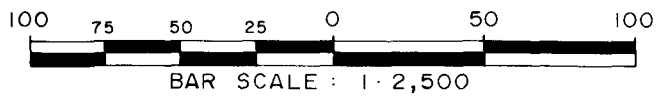

PLACER DOME INC.	
JOE CLAIMS	
Geochemical Plan	
ARSENIC IN SOILS (As values in ppm)	
TECHNICAL WORK BY: L. WARNER	DATE: AUG. / 1989
DRAWN BY: D.B. MIRTLE	SCALE: 1:2,500
NTS 82 M/5 W	FIGURE NO. PLATE 9