

VOLUME II OF II

GEOLOGICAL, GEOCHEMICAL AND
GEOPHYSICAL REPORT
ON THE
GNAT PASS PROPERTY
LIARD MINING DIVISION
BRITISH COLUMBIA

NTS 104I/4W

58°08'N, 129°50'E

FOR

EQUITY SILVER MINES LIMITED
#13 - 1155 Melville Street
Vancouver, British Columbia
V6E 4C4

PREPARED BY

STETSON RESOURCE MANAGEMENT CORP
#13 - 1155 Melville Street
Vancouver, British Columbia
V6E 4C4

LOG NO: 0417
ACTION:
FILE NO:

GEOLOGICAL BRANCH
ASSESSMENT REPORT

19,885
Part 2 of 2

January 25, 1990

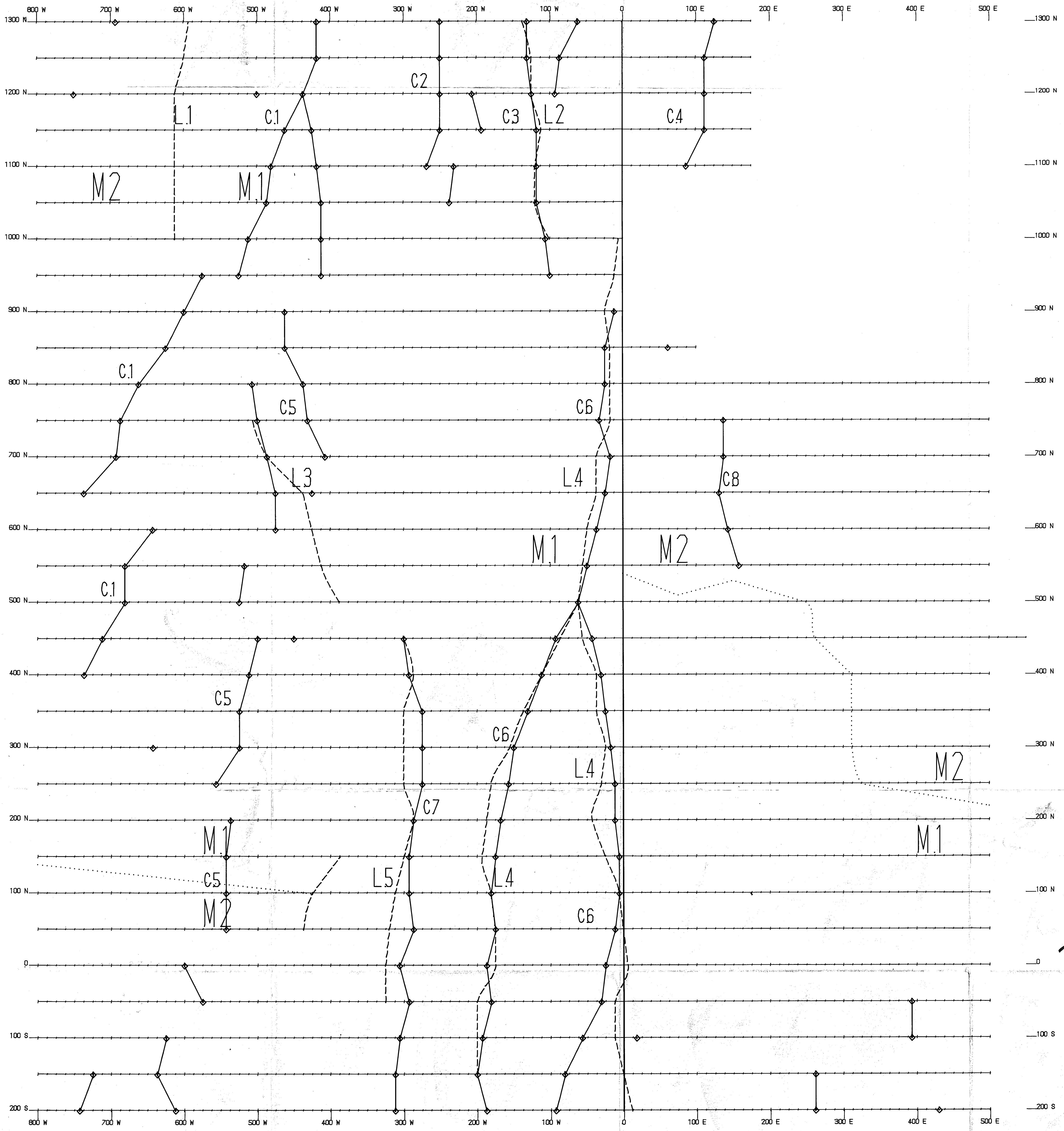

Scale 1:2500
 25 0 25 50 75 100 125
 (metres)

**GEOLOGICAL BRANCH
 ASSESSMENT REPORT**

19,885

Part 2 of 2 LEGEND.

- ◊—◊ VLF-EM Conductor
- Magnetic Lineament
- Magnetic Unit Boundary
- M1
- M2

EQUITY SILVER MINES LIMITED

Geophysical Interpretation Map

Gnat Pass Grid
 Liard Mining Division
 NTS: 104 1/4W Figure G-4
 Surveyed by Stetson Resource Management Corp.

Interpretex Resources Ltd.

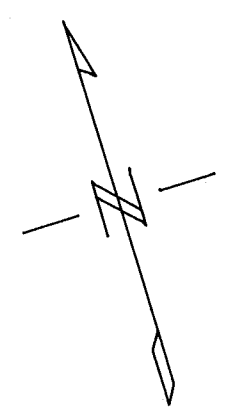
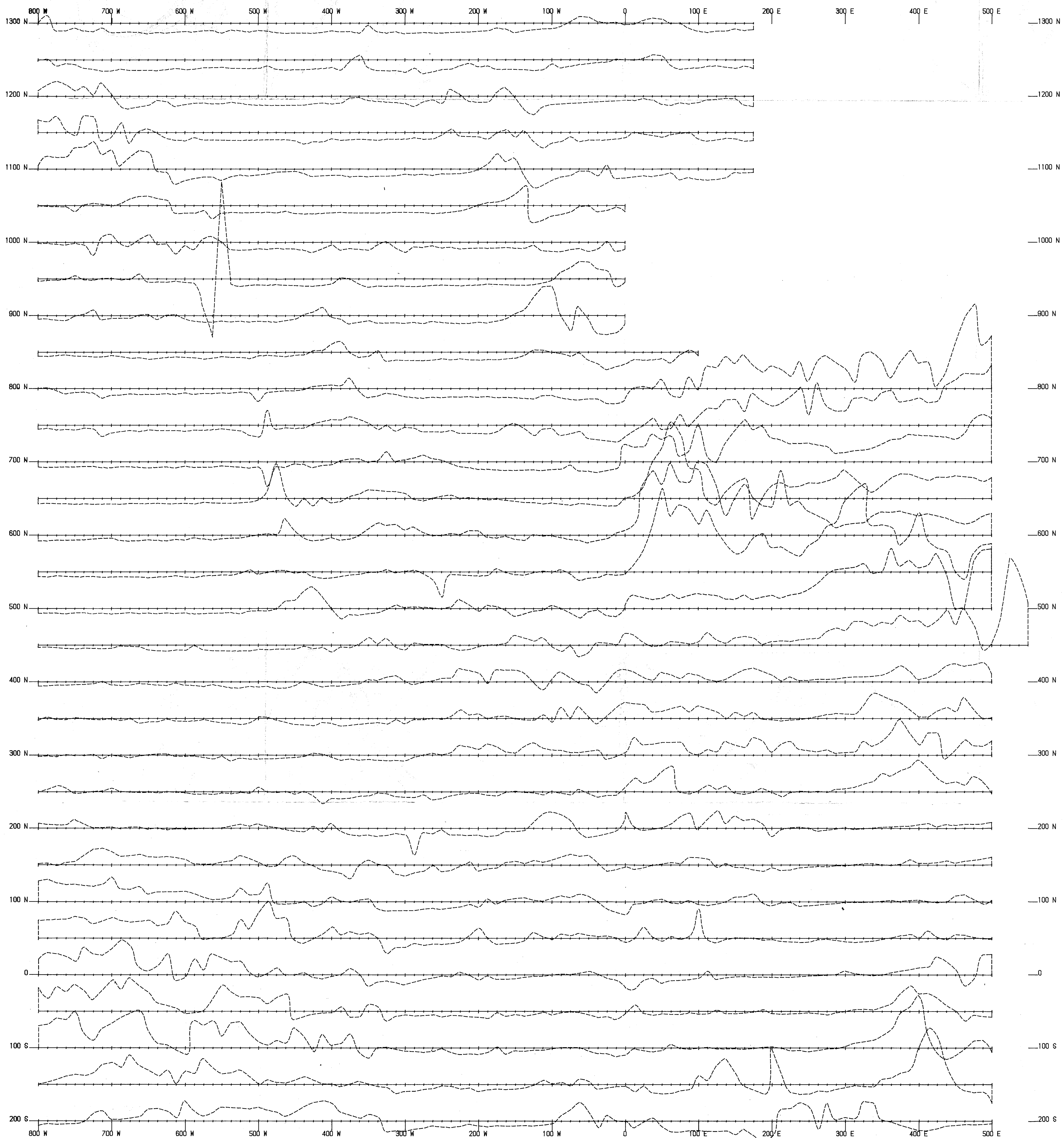

Scale 1:2500
 25 0 25 50 75 100 125
 (metres)

LEGEND

----- Total Magnetic Field Strength
 1 cm. = 1000 nT
 Total Magnetic Field Datum Value = 58600 nT

**GEOLOGICAL BRANCH
 ASSESSMENT REPORT**

19,885 *Part 2 of 2*

EQUITY SILVER MINES LIMITED

Total Field Magnetic Profiles

Gnat Pass Grid
 Liard Mining Division
 NTS: 104 1/4W Figure # G-2
 Surveyed by Stetson Resource Management Corp.

Interpretex Resources Ltd.

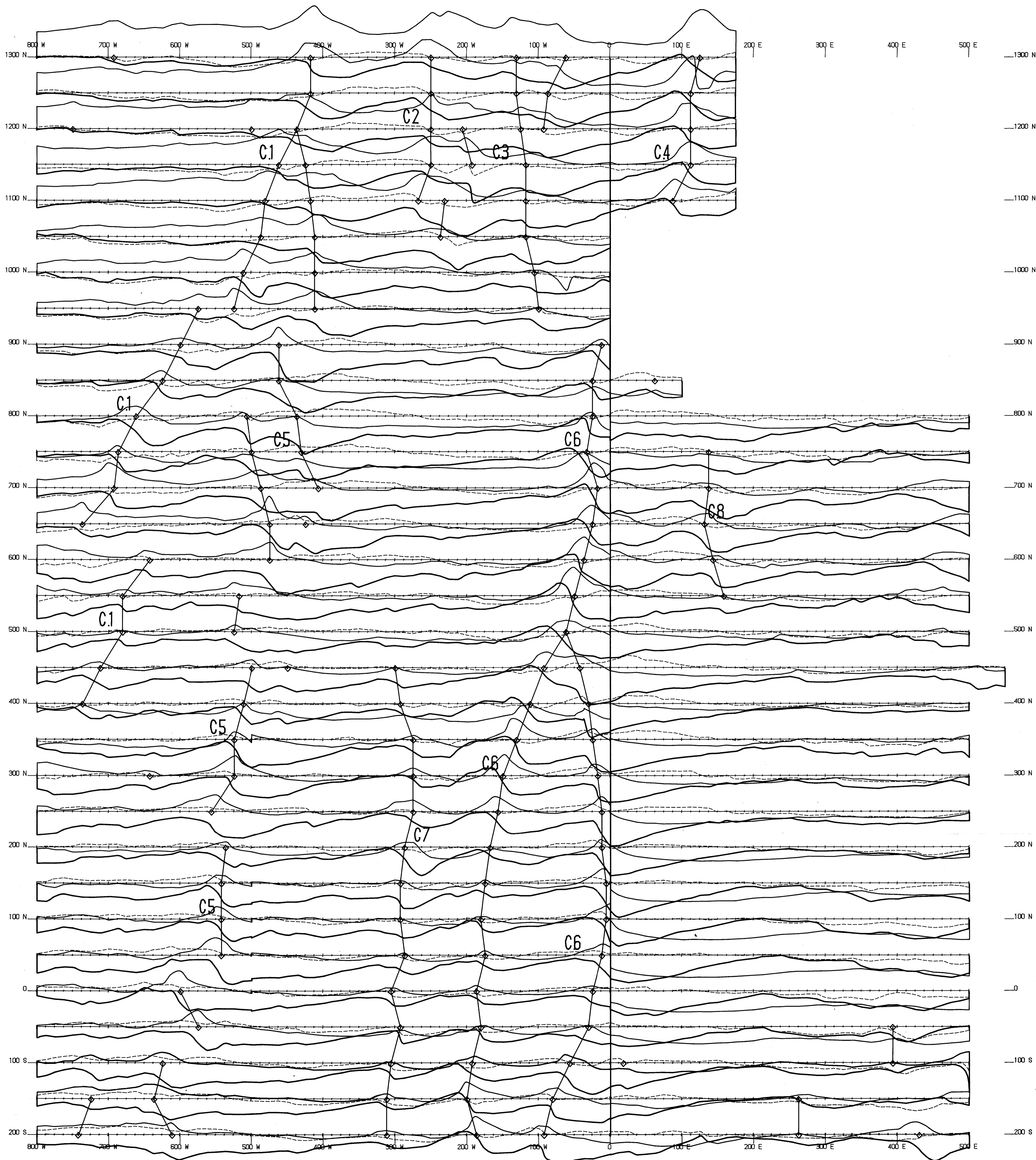

GEOLOGICAL BRANCH
ASSESSMENT REPORT

19,885

Part 2
of 2

Scale 1:2500
0 25 50 75 100 125
(metres)

LEGEND

- Anomalous Inflection (In-Phase)
- In-Phase 1 cm. = 30 %
- Quadrature
- Field Strength 1 cm. = 5 units
- VLF-EM Conductor

EQUITY SILVER MINES LIMITED

VLF-EM Profiles
NPM, Lualaba, Hw.

Gnat Pass Grid

Liard Mining Division
NTS: 104 1/4W Figure # G-2
Surveyed by Stetson Resource Management Corp.

Interpretex Resources Ltd.

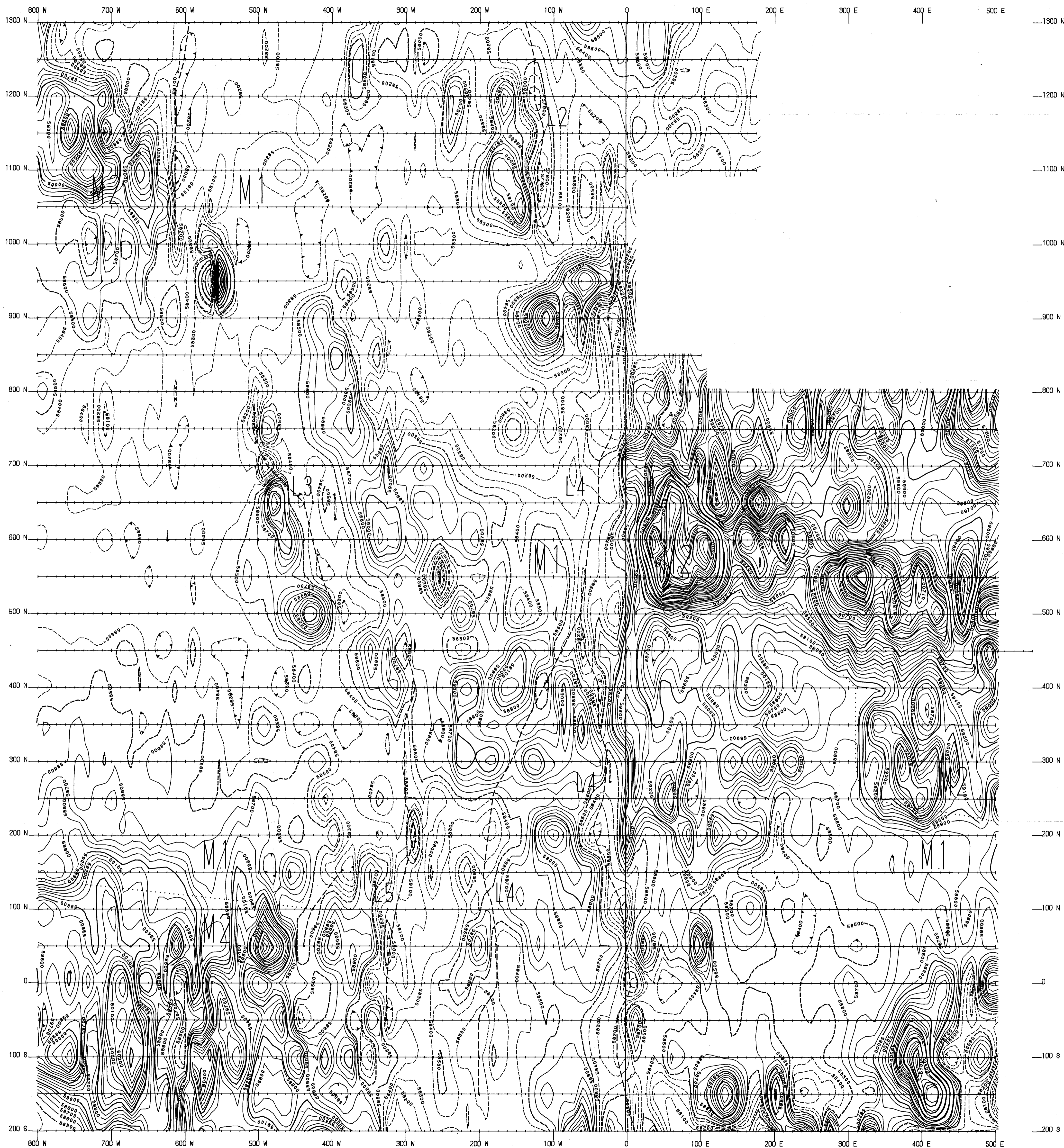

GEOLOGICAL BRANCH
ASSESSMENT REPORT

19,885
Part 2 of 2

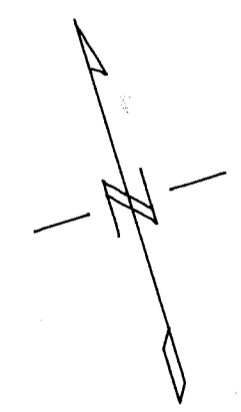

Scale 1:2500
0 25 50 75 100 125
(metres)

LEGEND

- Contour Interval
- < 58600 nT > 58600 nT
- 100 nT
- 500 nT
- Magnetic Lineament
- M1 Magnetic Unit Boundary
- M2

EQUITY SILVER MINES LIMITED

Total Field Magnetic Contours

Gnat Pass Grid
Liard Mining Division
NTS: 104 1/4W Figure # 6-2
Surveyed by Stetson Resource Management Corp.

Interpretex Resources Ltd.

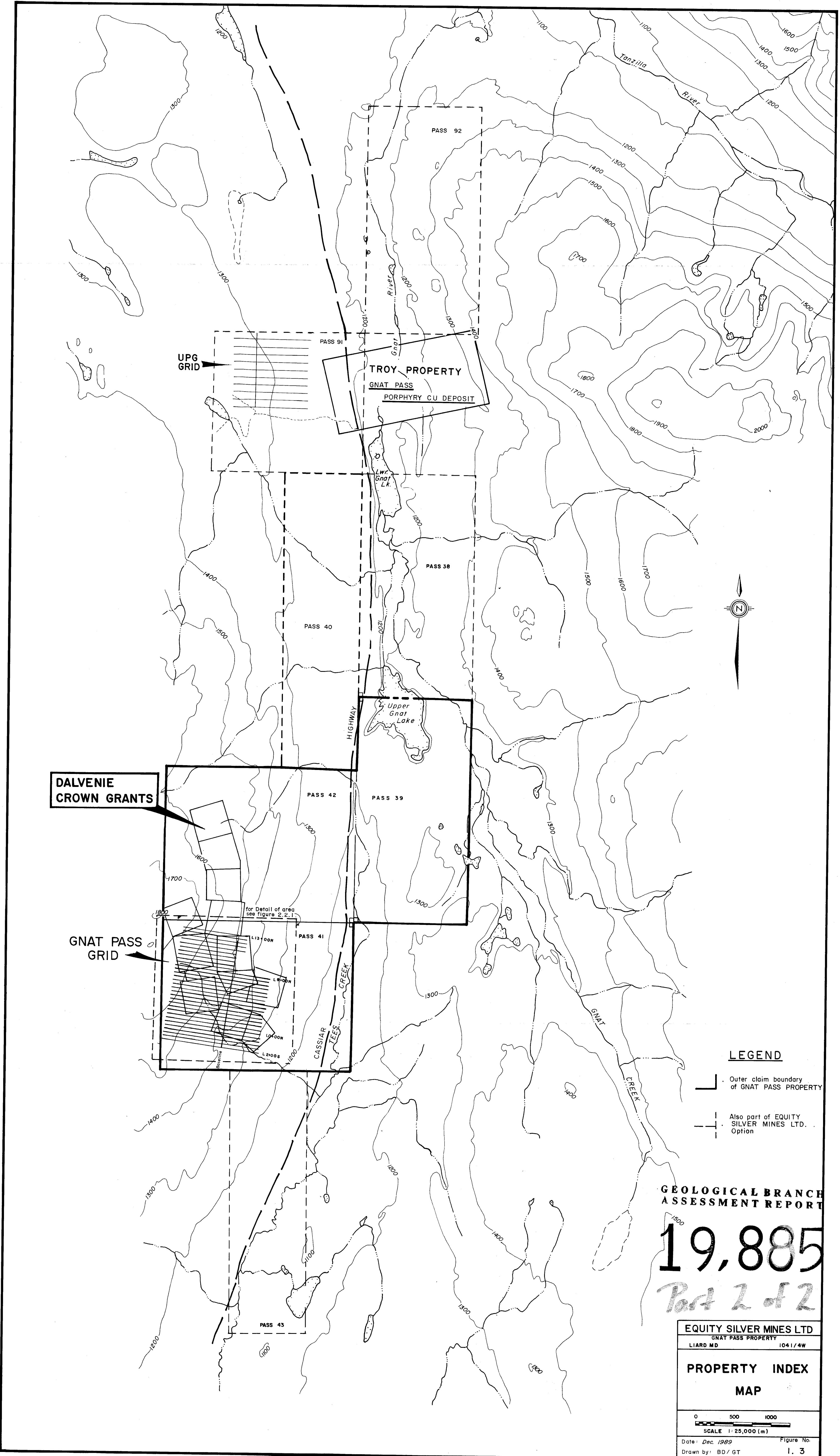

**DALVENIE
CROWN GRANTS**

**GNAT PASS
GRID**

**TROY PROPERTY
GNAT PASS
PORPHYRY CU DEPOSIT**

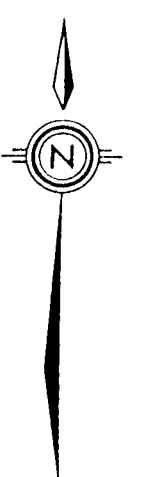

LEGEND

- Outer claim boundary of GNAT PASS PROPERTY
- - - Also part of EQUITY SILVER MINES LTD. Option

**GEOLOGICAL BRANCH
ASSESSMENT REPORT**

19,885
Part 2 of 2

EQUITY SILVER MINES LTD	
GNAT PASS PROPERTY	
LIARD MD	1041/4W
PROPERTY INDEX MAP	
SCALE 1:25,000 (m)	
Date: Dec. 1989	Figure No.
Drawn by: BD/GT	1. 3

LEGEND

LITHOLOGIES -

AGE UNKNOWN (Cuts all lithologies)

- 4 Dykes
- 4a Andesite
- 4b Diabase
- 4c Rhy-dacite

MIDDLE JURASSIC

- 3 Biotite hornblende diorite (Three Sisters)
- 3-2 Intrusive margin breccia, agmatite

LATE TRIASSIC

- 2 Hornblende clinopyroxenite (Ultramafic)
- 1s Cherts, argillites - tuffites
- 1va Augit porphyritic basalts
- 1vp Andesites (Locally feldspar porphyritic)

SYMBOLS -

- Limit of outcrop
- Contact; assumed, inferred
- Open cut
- ~ Fault; downthrown side
- Vein
- ↗ Shear, slickenside
- ▲ Subcrop sample; number
- Outcrop sample; number
- Old Drill Hole

ABBREVIATIONS -

- ank - ankerite
- asp - arsenopyrite
- bxwk - boxwork
- c.g. - coarse grained
- cpy - chalcopyrite
- Ep - epidote
- G - gossanous
- Lmo - limonite
- Mnr - minor
- Msv - massive
- Py - pyrite
- Qz - quartz
- Su - sulfides

SYMBOLS -

- Dyke with dip
- Schistosity

ROCK SAMPLE GEOCHEM

Sample	Au (ppb)	Cu (ppm)	Width
No.211224	8	806	
228	7194	>2000	
229	5210	11242	
416251	691	11761	
252	34	3091	
253	3	14908	
254	1033	4689	
255	1551	18517	
256	615	>2000	
257	13	3750	
258	129	752	
259	< 5	116	
260	2977	14	
261	12	211	
262	128	125	
263	282	2761	
264	37	1866	
265	11	212	
266	75	>2000	
267	27	9093	
268	< 5	1428	
269	17	10241	
270	< 5	1830	
271	< 5	507	
272	34	881	
273	< 5	369	
274	< 5	240	
275	< 5	10	
276	< 5	95	
277	< 5	54	
312	< 5	18	
313	< 5	311	
335	18	373	
336	560	108	
337	235	489	
211237	297	6352	
238	112	484	
241	3.4	142	
242	3.9	115	
250	2083	3502	
22884	0.10opt	0.03%	
887	0.14opt	0.02%	
416323	154	213	
324	133	477	

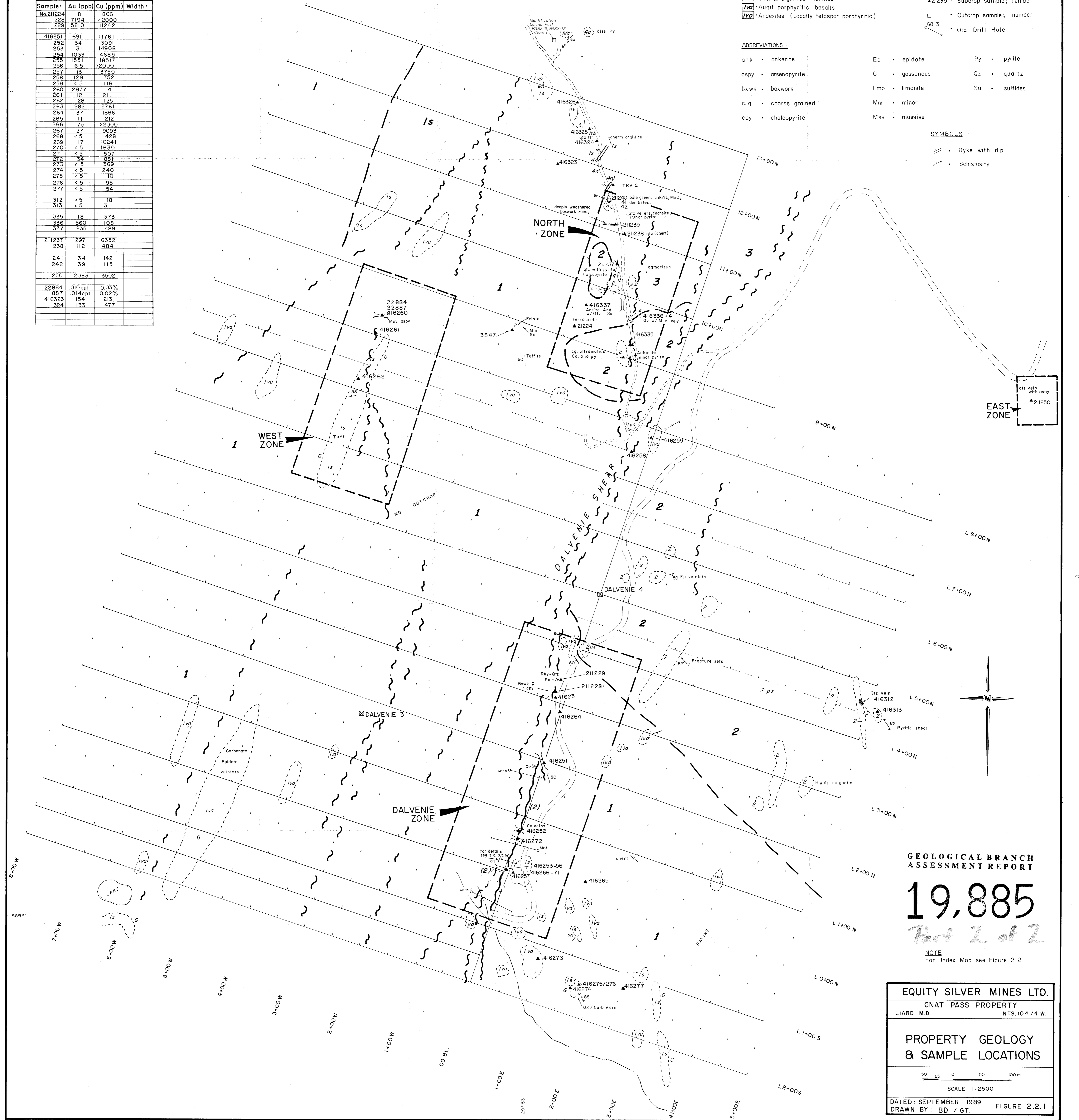

GEOLOGICAL BRANCH ASSESSMENT REPORT

19,885
Part 2 of 2

NOTE - For Index Map see Figure 2.2

EQUITY SILVER MINES LTD.	
GNAT PASS PROPERTY	NTS.104 / 4 W.
LIARD M.D.	
PROPERTY GEOLOGY & SAMPLE LOCATIONS	
SCALE 1:2500	
DATED: SEPTEMBER 1989	FIGURE 2.2.1
DRAWN BY: BD / GT.	

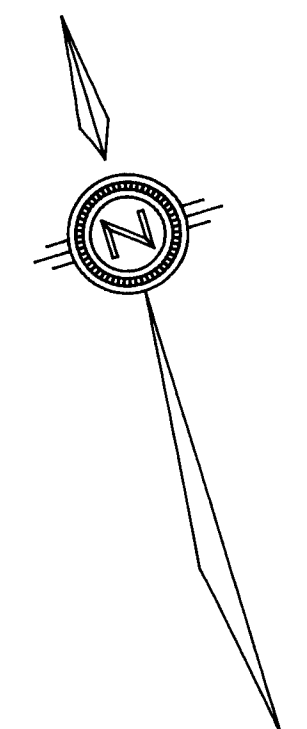
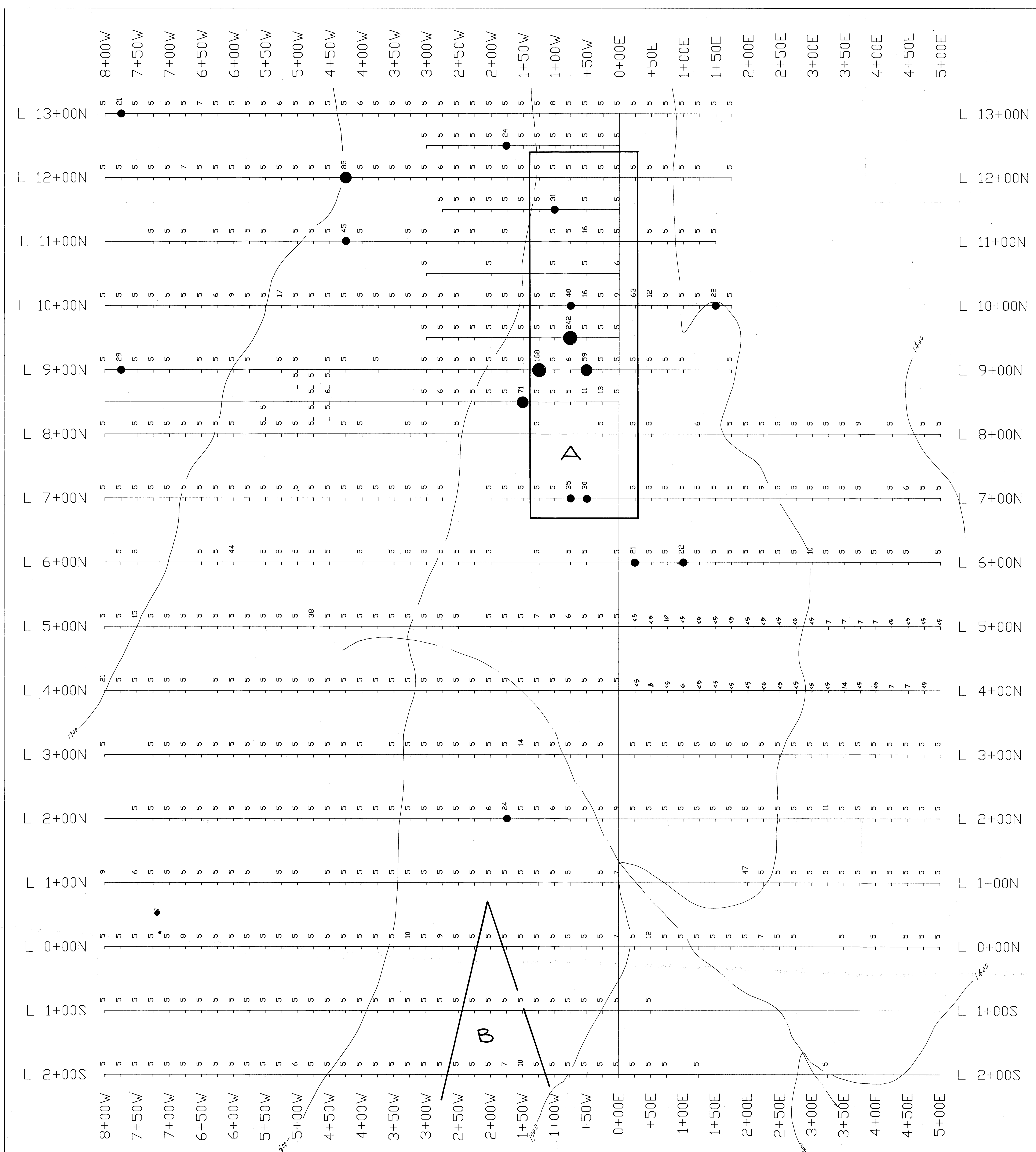

LEGEND ~

- 5 42 5 Gold (ppb)
- < 100 ppb Au
- < 50 ppb Au
- < 20 ppb Au

Contours in meters.

△ Anomaly Outline
(For Details see Section 9.2.2)

**GEOLOGICAL BRANCH
ASSESSMENT REPORT**

19,885 Part 2
of 2
GOLD GEOCHEMISTRY

EQUITY SILVER MINES LTD	
GNAT PASS PROJECT	
LIARD MINING DISTRICT	NTS 104/
PALVENIE GRID	
SOIL GEOCHEMISTRY	
Scale ~ 1:2000 metres	
Date: January 1990	Figure No.
Drawn by: JW/vh	9.2.2a
Prepared by STETSON RESOURCE MANAGEMENT CORPORATION	

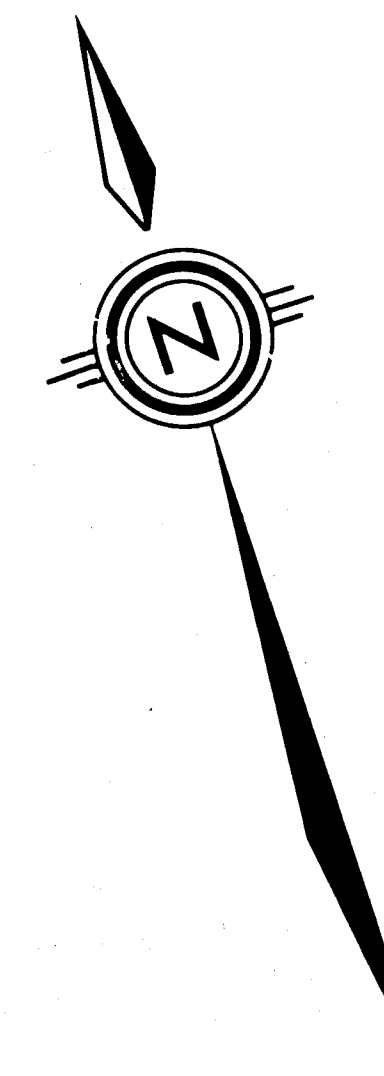
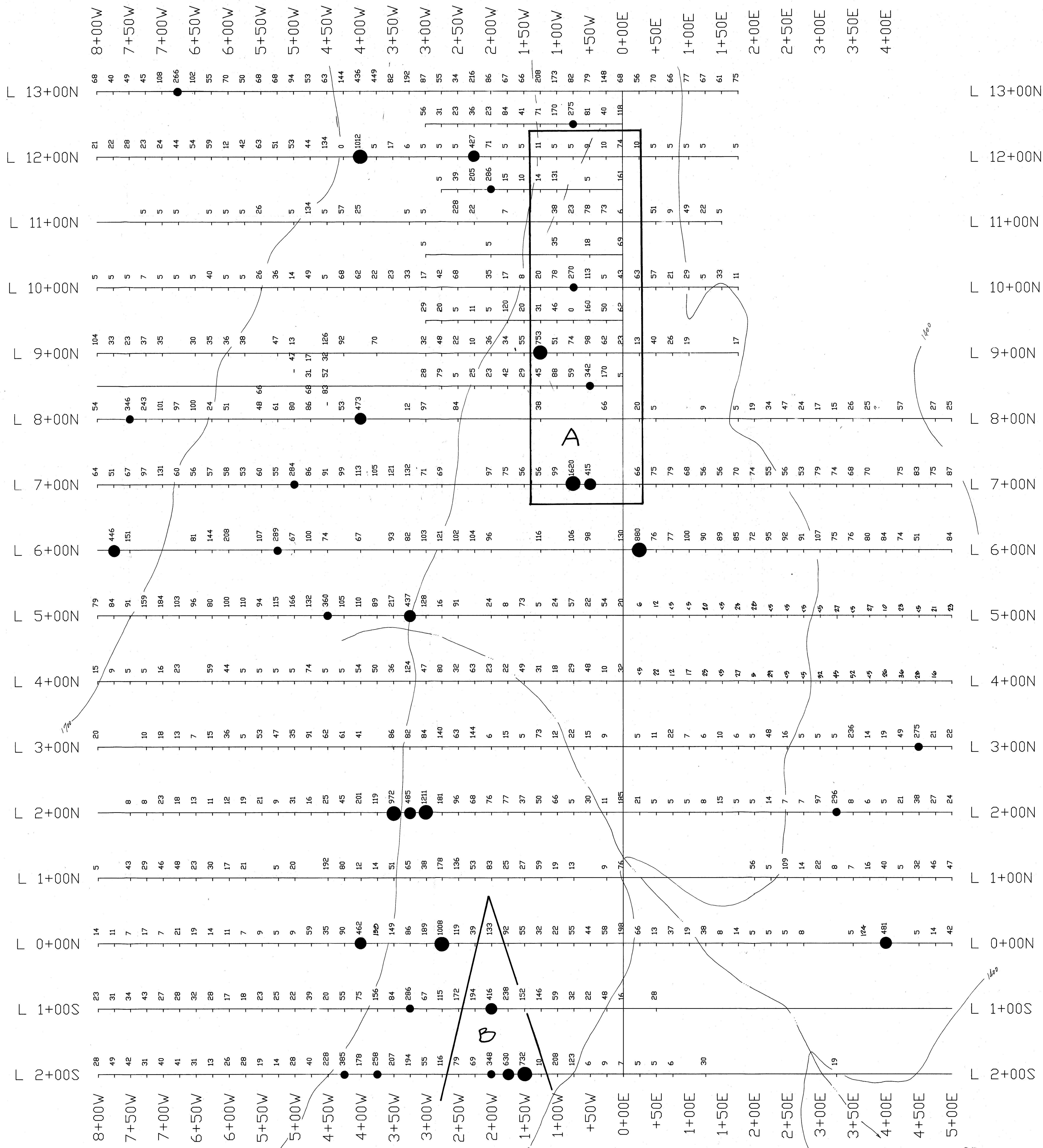

LEGEND ~

- (Large) > 621 ppm As
- (Medium) > 392 ppm As
- (Small) > 253 ppm As

Contours in metres
 ▲ Anomaly Outline
 (For Details see SECTION 3.2.2.)

ARSENIC GEOCHEMISTRY

EQUITY SILVER MINES LTD.	
GNAT PASS PROJECT	
LIARD MINING DISTRICT	NTS 104 /
DALVENIE GRID	
SOIL GEOCHEMISTRY	
Scale = 1:2500 metres	
Date: January 1990	FIGURE No.
Drawn by: JW/vh	9.2.2b
Prepared by: STETSON RESOURCE MANAGEMENT CORPORATION	

GEOLOGICAL BRANCH
 ASSESSMENT REPORT
19,885
 Part 2 of 2

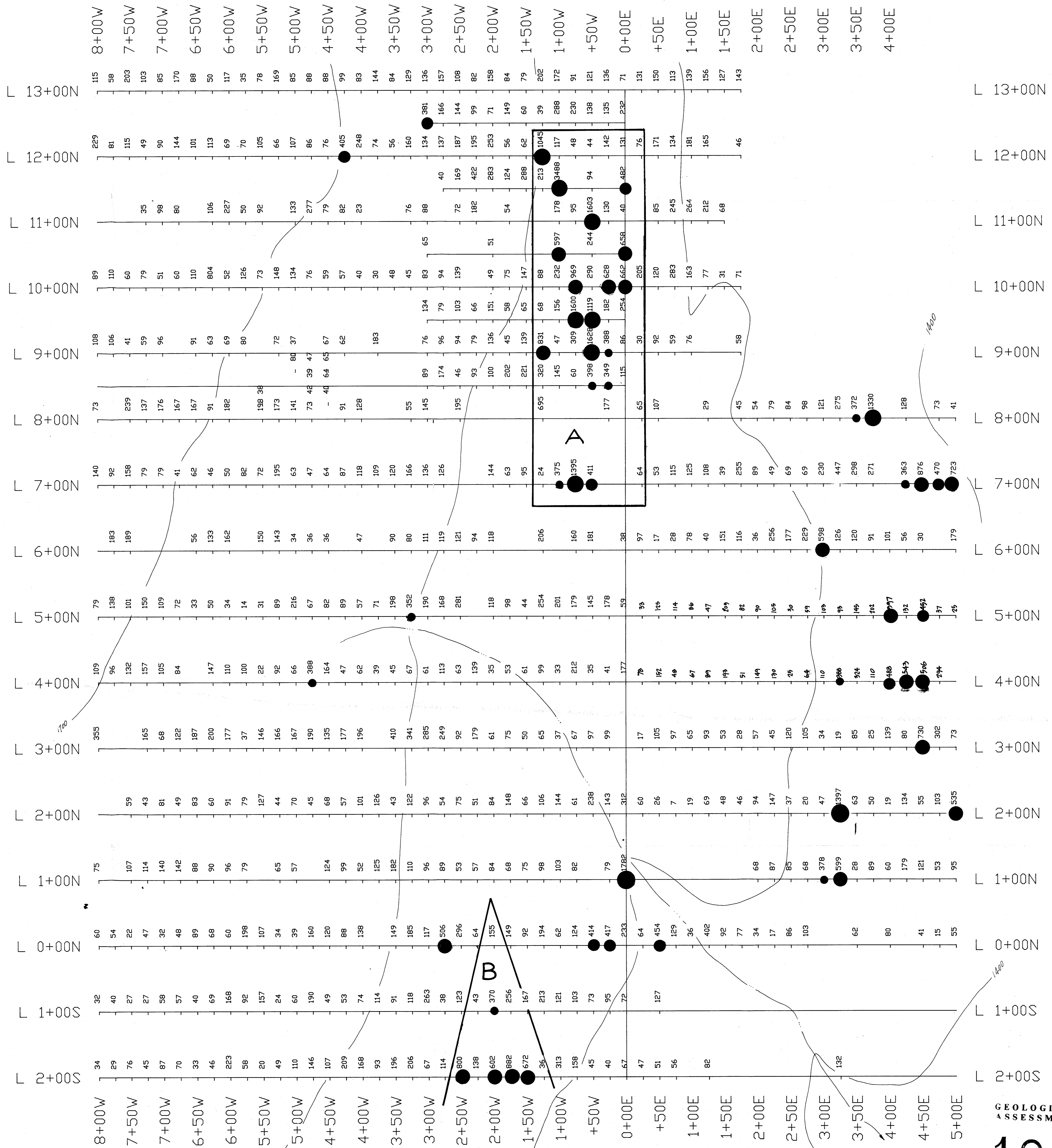

LEGEND ~



- Very Highly anomalous ● > 1000 ppm Cu
- Highly anomalous ● 900 ppm Cu - 1000 ppm Cu
- Very anomalous ● 400 ppm Cu - 900 ppm Cu
- Anomalous ● 330 ppm Cu - 400 ppm Cu

Contours in metres

▲ Anomaly Outline
(For Details see SECTION 3.2.2)

COPPER GEOCHEMISTRY

EQUITY SILVER MINES, LTD
GNAT PASS PROJECT
LIAZO MINING DISTRICT NTS 104/1

DALVENIE GRID

SOIL GEOCHEMISTRY

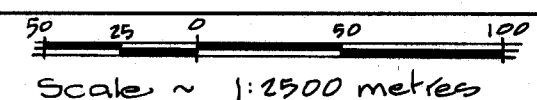

Date: January 1990
Drawn by: JW/vh
FIGURE NO. 3.2.2c

Prepared by: STETSON RESOURCE MANAGEMENT CORP.

**GEOLOGICAL BRANCH
ASSESSMENT REPORT**
19,385
Part 2 of 2

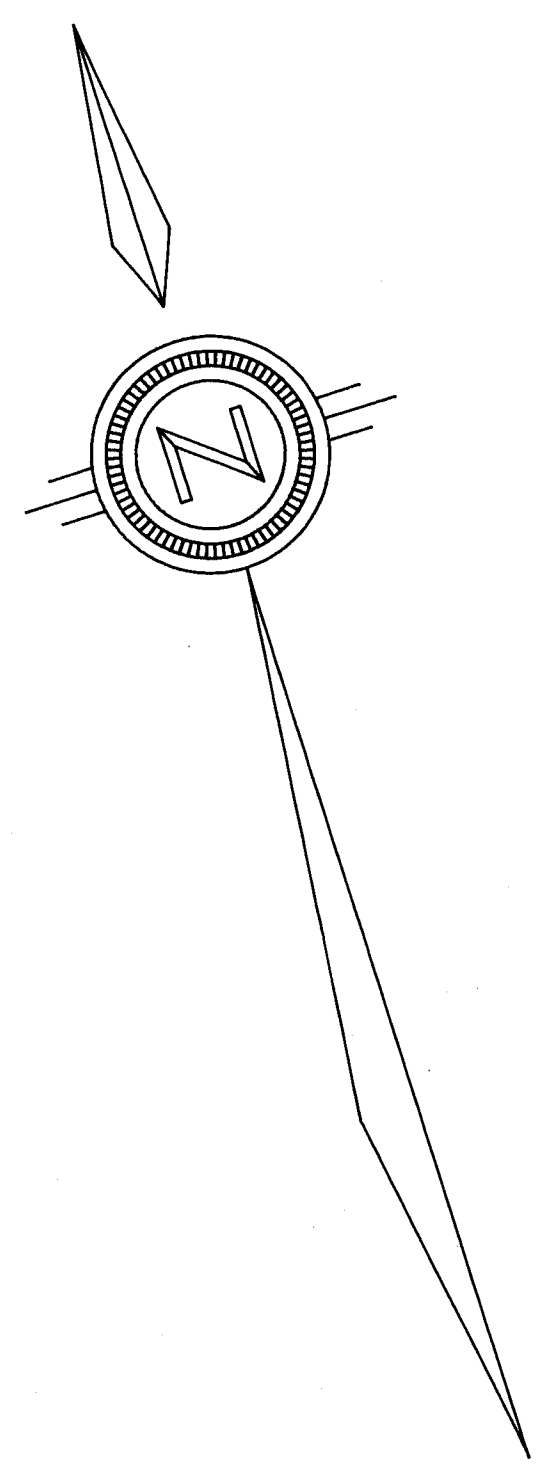
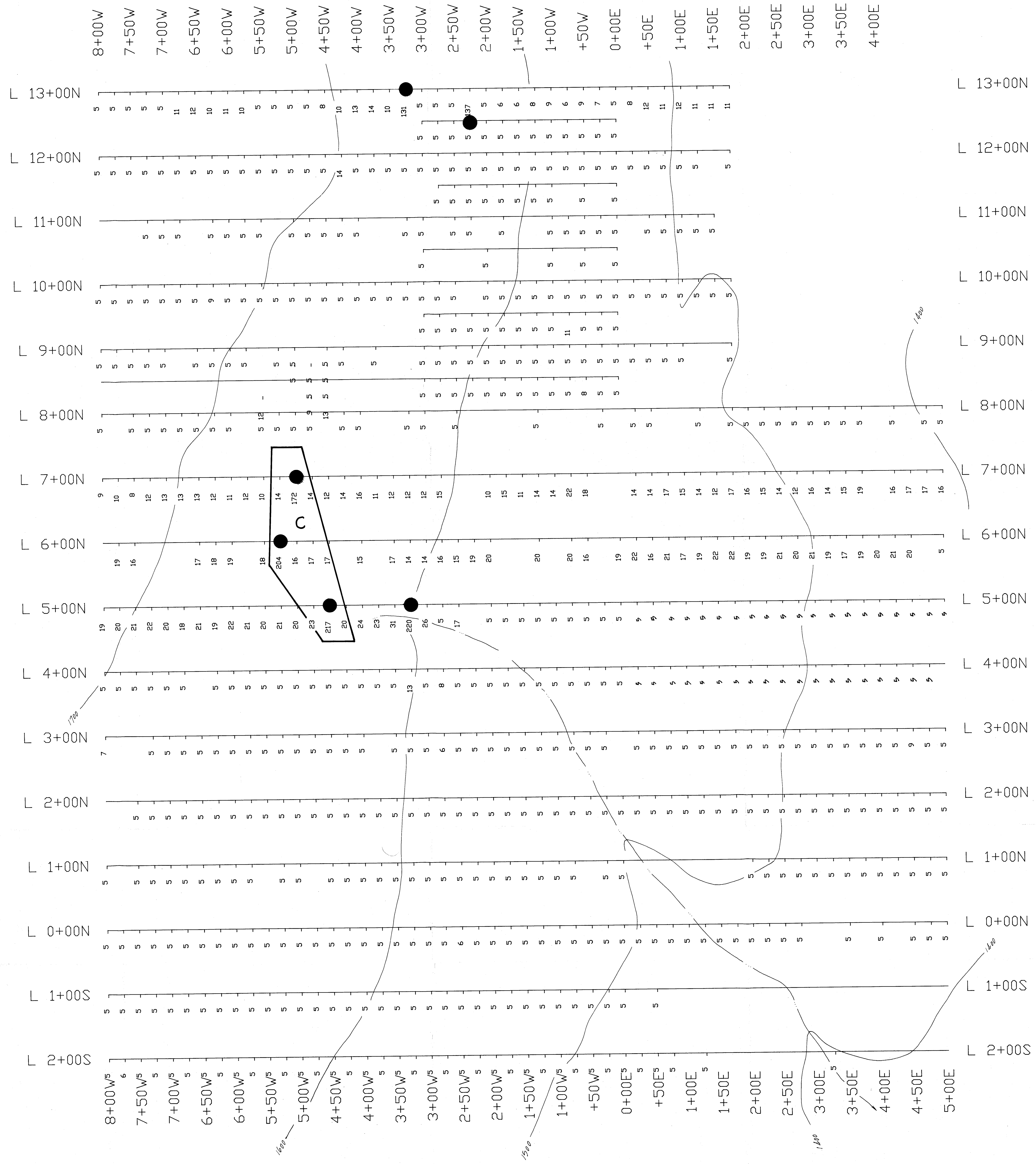

LEGEND ~

- Antimony (ppm)
- >100 ppm
- Contours in meters

Anomaly Outline
 (For Details see SECTION 3.2.2)
GEOLOGICAL BRANCH
ASSESSMENT REPORT
19,885 Part 2 of 2
ANTIMONY GEOCHEMISTRY

EQUITY SILVER MINES LTD	
GNAT PASS PROJECT	
LIAED MINING DISTRICT	NTS 104/
DALVENIE GRID	
SOIL GEOCHEMISTRY	
Scale ~ 1:2500 metres	
Date: January 1990	FIGURE NO
Drawn by: JW/vh	7.2.2d
Prepared by: STETSON RESOURCE MANAGEMENT CORPORATION	

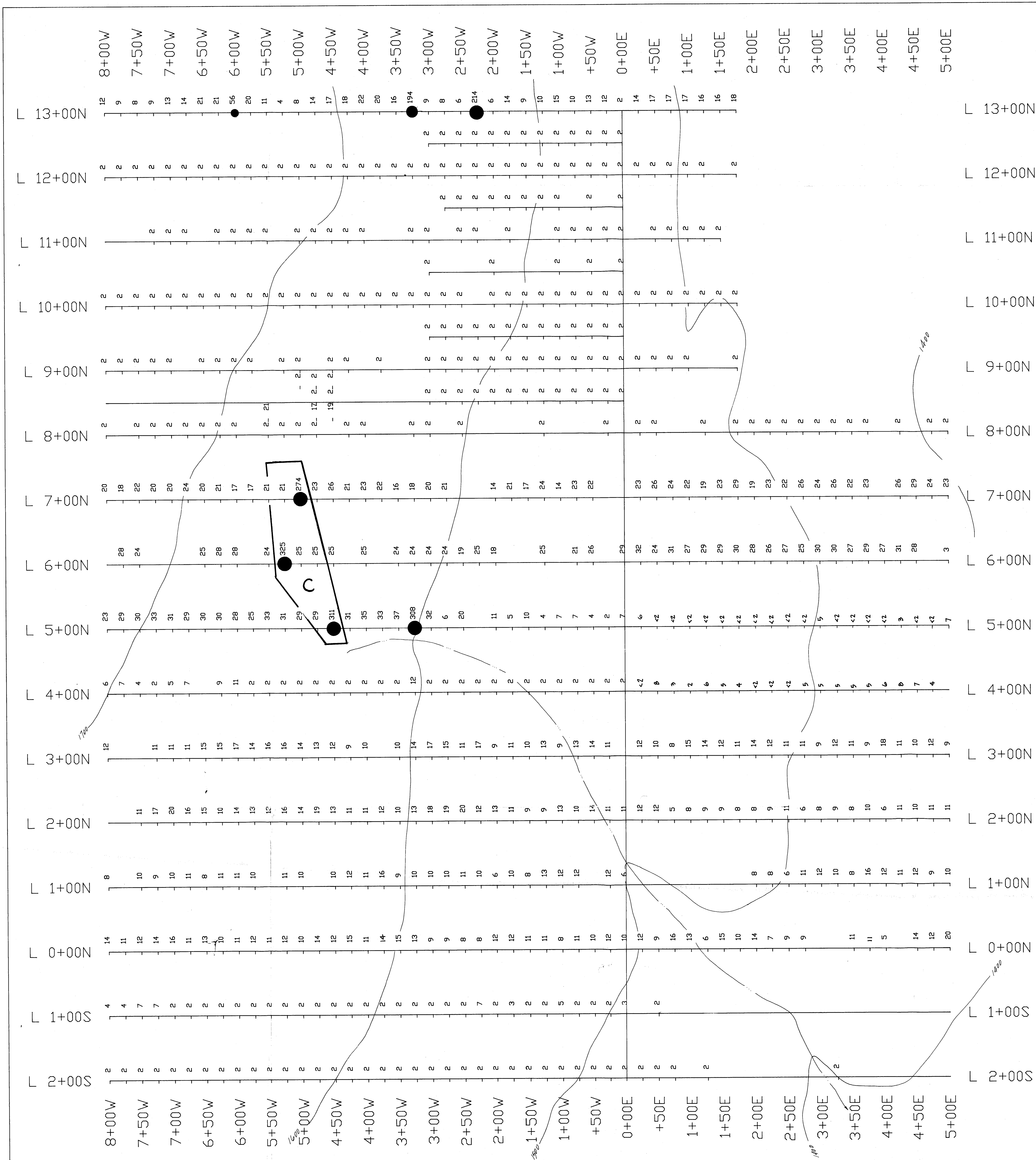

LEAD VALUES
ppm

LEGEND ~

- Lead (ppm)
- >111 ppm - Highly anomalous
- >75 ppm - Very anomalous
- >51 ppm - Anomalous
- Contours in metres
- Anomaly Outline (For Details see SECTION 2.2.2)

GEOLOGICAL BRANCH
ASSESSMENT REPORT

19,885
Part 2 of 2

LEAD GEOCHEMISTRY

EQUITY SILVER MINES LTD.	
GNAT PASS PROJECT	
LIARD MINING DISTRICT NT# 104 /	
DALVENIE GRID	
SOIL GEOCHEMISTRY	
Scale ~ 1:2500 metres	
Date: January 1990	FIGURE No. 2.2.2f
Drawn by: JW/vh	
Prepared by: STETSON RESOURCE MANAGEMENT CORPORATION	

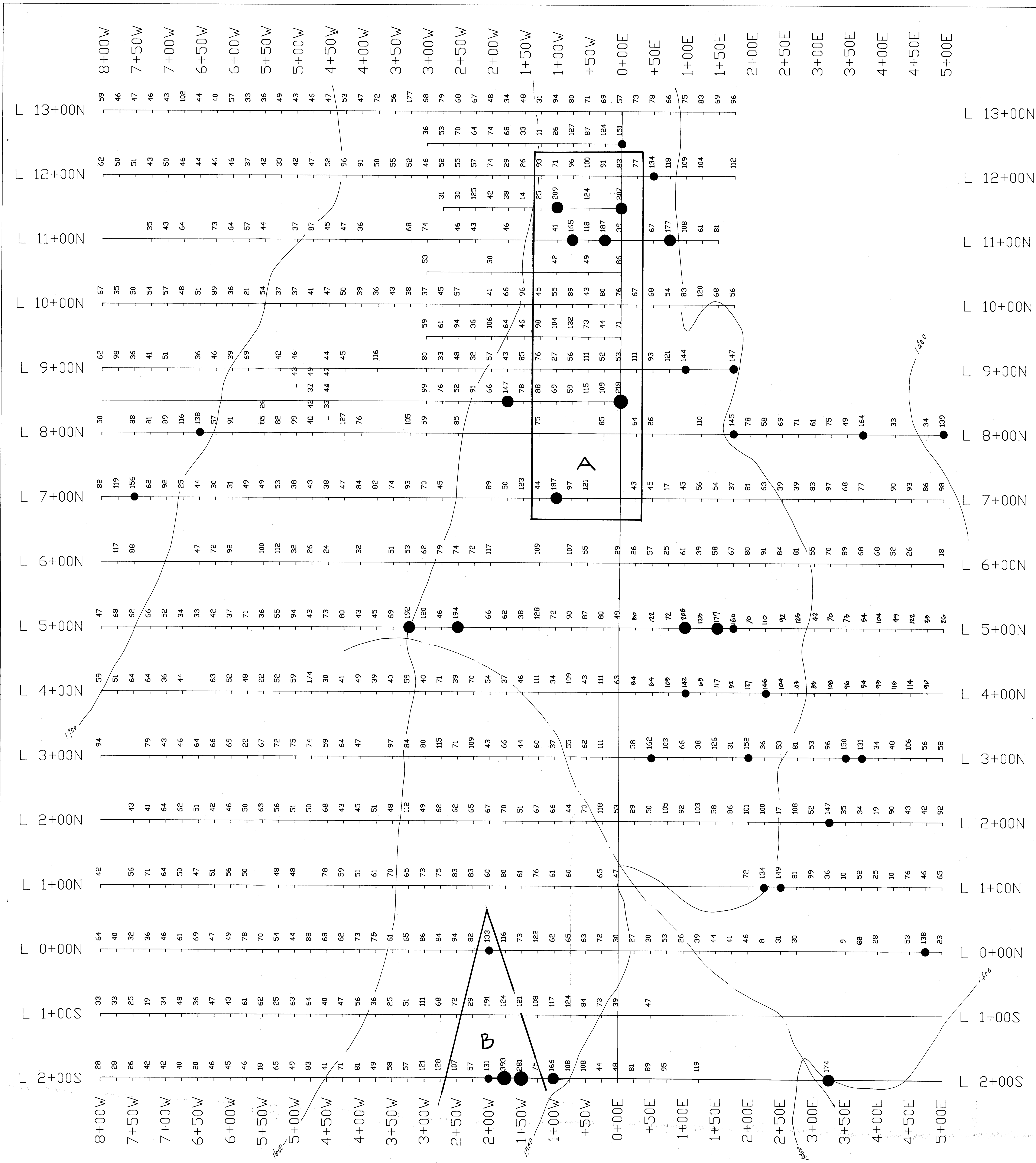

NICKEL VALUES
ppm

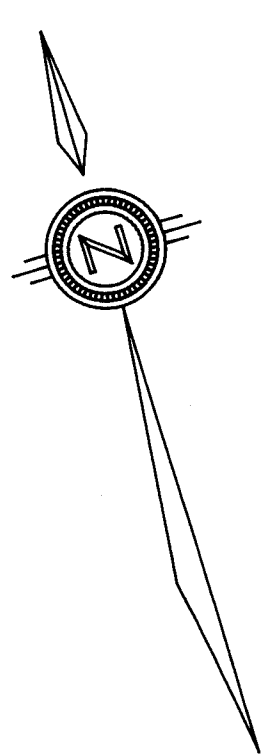

LEGEND ~

- Nickel (ppm)
- < 210 ppm Ni
- < 165 ppm Ni
- < 130 ppm Ni

Contours in metres

△ Anomaly Outline
(For Details see SECTION 3.2.2)

GEOLOGICAL BRANCH
ASSESSMENT REPORT

19,885
NICKEL GEOCHEMISTRY
Part 2 of 2

EQUITY SILVER MINES LTD.
GNAT PASS PROJECT
LIARD MINING DISTRICT NTS 104/
DALVENIE GRID
**SOIL
GEOCHEMISTRY**

Scale ~ 1:2500 metres
Date: January 1999
Drawn by: JW/ta
FIGURE No. 3.2.2e
Prepared by: STETSON RESOURCE MANAGEMENT CORPORATION