

|              |     |
|--------------|-----|
| LOG NO: 0612 | RD. |
| ACTION:      |     |
| FILE NO:     |     |

PROSPECTING REPORT

on the

ROMA #3, ROMA #4 & ROMA #5  
MINERAL CLAIMS

RECORD NO'S 6070, 6071, 6072

LIARD MINING DIVISION  
BRITISH COLUMBIA

LATITUDE: 57°03'N  
LONGITUDE: 131°21'W

N.T.S. MAP # 104G/3W

Prepared for:

PACIFIC RIM MINING CORP: OWNER/OPERATOR  
722-510 WEST HASTINGS STREET  
VANCOUVER, B.C. V6B 1L8

Prepared by: John Mirko  
April 21, 1990

GEOLOGICAL BRANCH  
ASSESSMENT REPORT

20,046

## TABLE OF CONTENTS

|                              | <u>Page</u> |
|------------------------------|-------------|
| Introduction                 | 1           |
| Claims, Location and Access  | 1           |
| History                      | 2           |
| Sample Descriptions          | 4           |
| Observations and Conclusions | 6           |
| Itemized Cost Statement      | 7           |
| Statement of Qualifications  | 8           |

## LIST OF APPENDICES

|              |  |    |
|--------------|--|----|
| Appendix 'A' | Bibliography                           | 9  |
| Appendix 'B' | Assay Results and Analytical Procedure | 10 |

## LIST OF FIGURES

|              |   |   |
|--------------|---|---|
| Figure 1     | Location Map                                    | 2 |
| Figure 2     | Claim Map                                       | 3 |
| Figure 3,4,5 | Prospecting, Outcrop and Sample<br>Location Map | 5 |

### Introduction

The Roma #3 to #5 claims, owned by Pacific Rim Mining Corp., were prospected and sampled by the author and D. Cosgrove (Prospector) between September 14, 1989 and September 20, 1989 and by the author and D. Caufield (Geologist) on October 16, 1989.

Approximately 4km of prospecting traverse was carried out over accessible portions of all claims. A total of 7 samples were taken (4 rock and 3 stream sediment) on the ROMA #5 claim.

### Claims, Location and Access

The Roma #3 to #5 claims cover a total of 42 claim units and are owned by Pacific Rim Mining Corp. The record dates are April 28, 1989.

The claims are located in the Coast Range Mountains approximately 111km south of Telegraph Creek and next to Sphaler Creek in northwestern British Columbia, in the Liard Mining Division. Access to the Roma #3 to #5 claims is by helicopter from the Bronson Creek airstrip or the Galore Creek airstrip from which fixed wing aircraft connect various other airports. The nearest road is the Stewart-Cassiar Hwy. which is located about 85km to the east.

The claims span four unnamed peaks on the northern side of Sphaler Creek covering extremely rugged mountainous and glaciated terrain (most of which is snow, ice or talus covered) typical of the Galore Creek area. Elevations range from about 915 metres on the south to over 2375 metres further north on an unnamed peak on the ROMA #4 claim.

### History

No work has been recorded on ground covered by the claims.



**PROPERTY  
LOCATION**

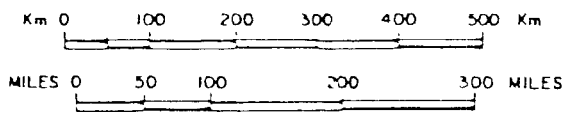

|   |                           |               |  |
|---|---------------------------|---------------|--|
| <p><b>PACIFIC RIM MINING CORP.</b></p> <p><b>ROMA #1-#5 CLAIMS</b></p> <p><b>LOCATION MAP</b></p> <p>BRITISH COLUMBIA</p> |                           |               |  |
| <p>EQUITY ENGINEERING LTD.</p>  |                           |               |  |
| <p>DRAWN: J.E.</p>  | <p>MINING DIV.: LIARD</p> | <p>FIGURE</p> |  |
| <p>NTS.: 104G/3W</p>  | <p>SCALE: AS SHOWN</p>    | <p>1</p>      |  |
| <p>DATE: APRIL, 1990</p>  | <p>REVISED</p>            |               |  |

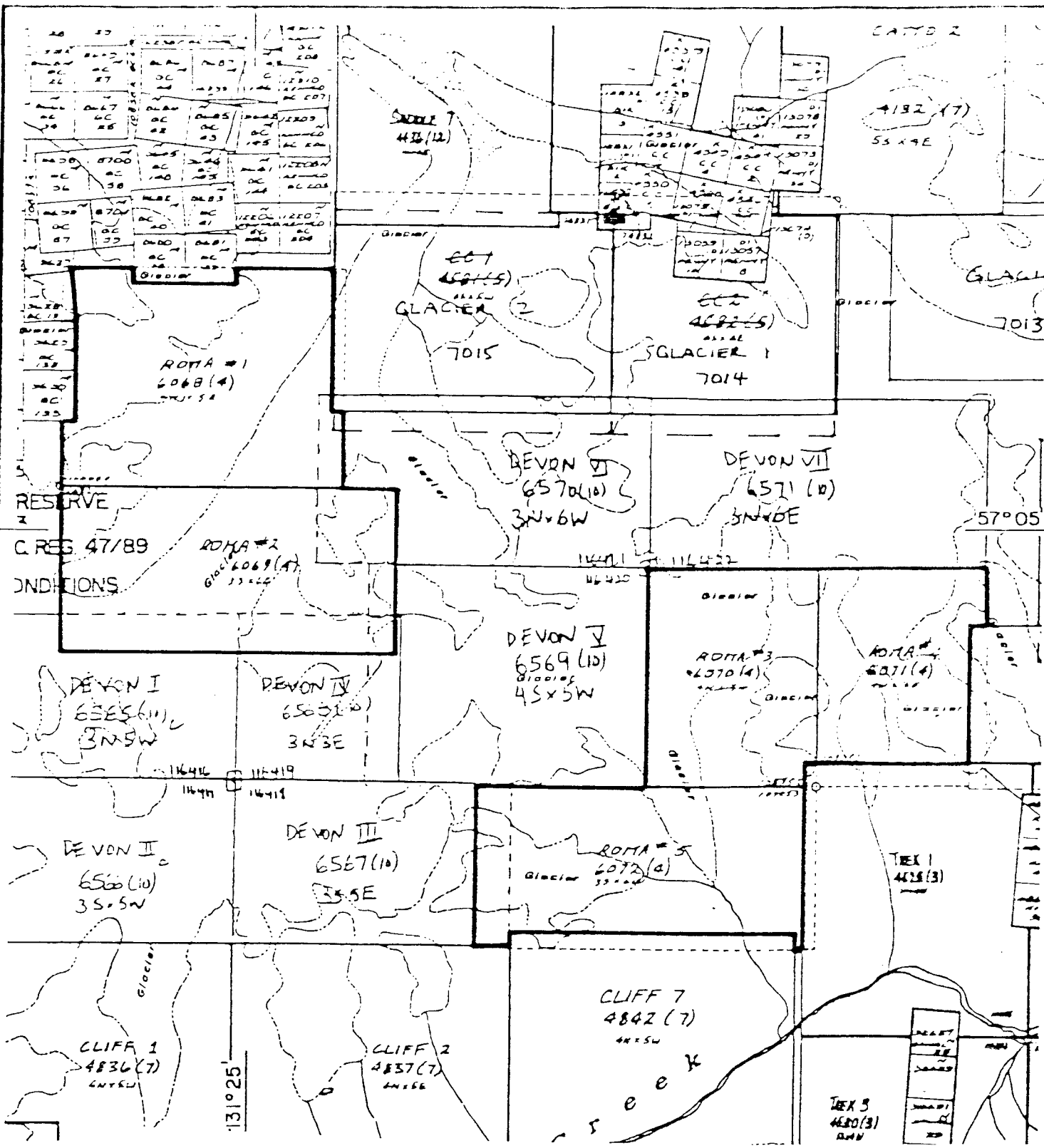

|                          |                    |        |
|--------------------------|--------------------|--------|
| PACIFIC RIM MINING CORP. |                    |        |
| ROMA #1-#5 CLAIMS        |                    |        |
| CLAIM MAP                |                    |        |
| BRITISH COLUMBIA         |                    |        |
| EQUITY ENGINEERING LTD.  |                    |        |
| DRAWN: J.J.E.            | MINING DIV.: LIARD | FIGURE |
| N.T.S.: 104 6/3W         | SCALE: 1:50000     | 2      |
| DATE: APRIL, 1990        | REVISED:           |        |

## SAMPLE DESCRIPTIONS

| <u>Sample #</u> | <u>Type &amp; Width</u> | <u>Rock, Type, Alteration and Observations</u> |
|-----------------|-------------------------|--|
| CRM34R          | ROCK/GRAB/FLOAT         | VOLC, SILIC, QTZ RICH. RUSTY. SHEARED, <3% PY  |
| CRM35R          | ROCK/GRAB/1M            | AND, PROP, QTZ VNLTs 6CM, <1% PY, MINOR MAL    |
| CRM36R          | ROCK/GRAB               | BR, GRY, AND QTZ VNLTs 1CM, MINOR EPI, <1% PM  |
| CRM37X          | STREAM SED.             | LIGHT GRY BR SAND, COARSE FRAGS                |
| CRM38X          | STREAM SED.             | LIGHT GRY BR SAND, COARSE FRAGS                |
| CRM39R          | ROCK/GRAB/FLOAT         | AND, GRY, SILIC, PROPY, RUSTY, <3% PY          |
| CRM40X          | STREAM SED.             | LIGHT GRY, BR SAND, COARSE FRAGS               |

\* R = Rock  
X = Silt

### Legend for Sample Descriptions etc.

|       |              |       |             |
|-------|--------------|-------|-------------|
| AGG   | AGGLOMERATE  | HEM   | HEMITITE    |
| AND   | ANDESITE     | MAG   | MAGNETITE   |
| AUG   | AUGITE       | MAL   | MALACHITE   |
| BIO   | BIOTITE      | O/C   | OUTCROP     |
| BX    | BRECCIATION  | OX    | OXIDE(S)    |
| CARB  | CARBONATE    | PORP  | PORPHYRITIC |
| CHLOR | CHLORITE     | PROP  | PROPYLITIC  |
| CPY   | CHALCOPYRITE | PY    | PYRITE      |
| DK    | DARK         | QTZ   | QUARTZ      |
| EPID  | EPIDOTE      | SERIC | SERICITE    |
| FRAC  | FRACTURE     | SILIC | SILICIFIED  |
| FRAG  | FRAGMENT     | VN    | VEIN(S)     |
| GR    | GREEN        | VNLTs | VEINLETS    |
| GRY   | GREY         |       |             |

Observations and Conclusions

The prospecting done on the claims found that they are mostly underlain by the Upper Triassic Stuhini Group volcanic package, which shows up as propylitically altered mafic volcanics (andesites) with some siltstone, sandstone and limestone boulders noted in some glacial and creek drainages.

One minor copper (malachite on fractures) showing of very limited size was found on the ROMA #5 claim with an assay of a grab sample giving 1520 parts per million (p.p.m.) copper. No other significant values were returned from the limited sampling done (the stream sediment samples appear insignificant) on the claims.

The claims are underlain by the Stuhini Group volcanics which are known to host significant gold occurrences in the area.

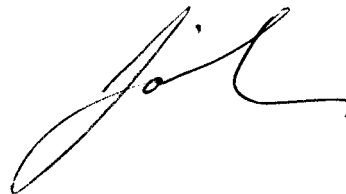
A handwritten signature in black ink, appearing to be 'J. L.', located in the lower right quadrant of the page.

## Itemized Cost Statement

|  |  |           |                 |
|--|--|-----------|-----------------|
| Labour                                       | J.Mirko, Field, 2 days @ \$200                   | \$        | 400.00          |
|  | D.Cosgrove, Field, 3 days @ \$150                |           | 450.00          |
|  | D. Caufield, Field, 1 day @ \$375                |           | 375.00          |
| Mobilization                                 | - Vanc to Smithers to Galore Creek Camp<br>1 man |           | 380.00          |
| De Mobilization                              | - Galore Creek Camp to Smithers to Vanc<br>1 man |           | 380.00          |
| Accommodation and board at Galore Creek Camp |  |           |                 |
|  | 1 man x 3 days @ \$130/day                       |           | 390.00          |
|  | 1 man x 2 days @ \$130/day                       |           | 260.00          |
|  | 1 man x 1 day @ \$130/day                        |           | 130.00          |
| Helicopter (500D)                            | 1.0 hrs @ \$789/hr                               |           | 1,420.20        |
| Expediting                                   |  |           | 55.70           |
| Supplies, radios and equipment               |  |           | 25.00           |
| Freight                                      |  |           | 15.20           |
| Assays                                       | 7 samples @ \$11.50                              |           | 80.50           |
| Report                                       | 1 man x 1 day @ 200/day & typing, etc            |           | 350.00          |
|  |  |           | 4,711.60        |
|  | <b>ROMA #3 to #5 Total Expenditures</b>          | <b>\$</b> | <b>4,711.60</b> |





## QUALIFICATIONS

John M. Mirko  
811 Prospect Avenue  
North Vancouver, B.C.  
V7R 2M2  
Phone: 986-4821

### Previously Employed by:

|                                   |                |
|-----------------------------------|----------------|
| Manex Mining Ltd.                 | 1972           |
| Sumitomo Metal Mining Canada Ltd. | 1972 - 1973    |
| Kerr Addison Mines Ltd.           | 1974 - 1975    |
| Newconex Ltd.                     | 1976           |
| Consulting                        | 1977 - Present |

### Experience in:

Total property evaluations, consulting, etc.  
Mine development, contracting  
Supervision  
Construction  
All phases of exploration

### Duties included:

Line cutting, claim staking, blasting, first aid, surveying, percussion and diamond drilling, camp management, geochemical and geophysical surveys, prospecting, geological mapping, bedding and structure interpretation, core logging, grade and tonnage calculations, drill management, underground rehabilitation and development, road construction, bridge construction, geotechnical surveys for water storage dams, tailings dams and mill sites, property acquisitions, property sales.

### Type of Deposits

Skarns - Au, Ag, Pb, Zn, WO, U O, Fe, Sn  
Veins - all minerals  
Strataform Replacement - Pb, Zn, Cu, Ag, Ba  
Volcanic Bedded Massive Sulphide - Pb, Zn, Cu, Au, Ag  
Disseminated - Au, Ag, U<sub>2</sub>O<sub>3</sub>, Fe  
Porphyry - Cu, Mo, Ag, Au, WO<sub>3</sub>  
Industrial - Ba, Lime, MgCo<sub>3</sub>, CaF<sub>2</sub>.

## APPENDIX 'A'

Allen, D.G., Panteleyev, A., and Armstrong, A.T. (1976): Galore Creek, in CIM Special Volume 15; p. 402-414.

Grant, G.W. (1965): Geological Report - PH Group; British Columbia Ministry of Energy, Mines and Petroleum Resources Assessment Report #620.

Logan, J.M., and Koyanagi, J.M. (1989 @): Geology and Mineral Deposits of the Galore Creek Area, N.W. B.C., 104G/3,4,1N, Geological Fieldwork 1988; British Columbia Ministry of Energy, Mines and Petroleum Resources, Geological Survey Branch, Paper 1989-1, p. 269-284.

A P P E N D I X    B

ACME ANALYTICAL LABORATORIES LTD.  
 852 E. HASTINGS ST. VANCOUVER B.C. V6A 1R6  
 PHONE(604)253-3158 FAX(604)253-1716

DATE RECEIVED: SEP 19 1989

DATE REPORT MAILED: *Sept. 26/89.*

GEOCHEMICAL ANALYSIS CERTIFICATE

ICP - .500 GRAM SAMPLE IS DIGESTED WITH 3ML 3-1-2 HCL-HNO3-H2O AT 95 DEG. C FOR ONE HOUR AND IS DILUTED TO 10 ML WITH WATER. THIS LEACH IS PARTIAL FOR MN PB SR CA P LA CR MG BA TI B W AND LIMITED FOR NA K AND AL. AU DETECTION LIMIT BY ICP IS 3 PPM. - SAMPLE TYPE: P1 ROCK P2 SILT AU\* ANALYSIS BY ACID LEACH/AA FROM 10 GM SAMPLE.

SIGNED BY... *C. Leong* D. TOYE, C. LEONG, J. WANG: CERTIFIED B.C. ASSAYERS

Pacific Rim Mining Corp PROJECT ROMA-GACORE CK. FILE = 89-3756 Page 1

| SAMPLE#    | Cu PPM | Pb PPM | Zn PPM | Ag PPM | Bi PPM | Au* PPB |
|------------|--------|--------|--------|--------|--------|---------|
| CRM-01R    | 11438✓ | 26     | 87     | 11.4   | 6      | 77      |
| CRM-02R    | 700    | 37     | 95     | .9     | 2      | 13      |
| CRM-03R    | 18493✓ | 34     | 195    | 7.7    | 2      | 860     |
| CRM-04R    | 3591   | 46     | 32     | 48.0✓  | 6      | 260     |
| CRM-05R    | 244    | 13     | 78     | .2     | 2      | 5       |
| CRM-06R    | 1195   | 13     | 63     | 1.8    | 4      | 2       |
| CRM-07R    | 19     | 4      | 27     | .2     | 2      | 4       |
| CRM-08R    | 13     | 254    | 107    | .2     | 3      | 8       |
| CRM-09R    | 45     | 92     | 23     | 1.0    | 2      | 10      |
| CRM-10R    | 142    | 17     | 43     | .7     | 2      | 6       |
| CRM-11R    | 31     | 37     | 28     | .4     | 2      | 4       |
| CRM-12R    | 47     | 194    | 102    | .3     | 2      | 1       |
| CRM-14R    | 128    | 43     | 132    | .5     | 2      | 9       |
| CRM-15R    | 3      | 24     | 13     | .1     | 2      | 2       |
| CRM-16R    | 2536   | 5      | 101    | 15.9   | 10     | 125     |
| CRM-17R    | 104    | 6      | 92     | .5     | 2      | 1       |
| CRM-18R    | 1395   | 8      | 10     | 3.9    | 2      | 1       |
| CRM-19R    | 20     | 5      | 63     | .2     | 2      | 1       |
| CRM-20R    | 14     | 3      | 47     | .1     | 2      | 1       |
| CRM-21R    | 3093   | 12     | 204    | 7.3    | 2      | 3       |
| CRM-22R    | 2830   | 8      | 54     | 6.9    | 3      | 7       |
| CRM-23R    | 403    | 6      | 7      | .4     | 2      | 1       |
| CRM-24R    | 1500   | 11     | 233    | 4.4    | 2      | 5       |
| CRM-25R    | 67     | 4      | 14     | .2     | 2      | 4       |
| CRM-26R    | 239    | 60     | 126    | 1.3    | 2      | 60      |
| CRM-27R    | 12     | 4      | 15     | .2     | 2      | 1       |
| CRM-28R    | 24     | 32     | 15     | .2     | 2      | 1       |
| CRM-29R    | 19419✓ | 34     | 115    | 87.0✓  | 2      | 510     |
| CRM-33R    | 5061   | 27     | 216    | 9.9    | 3      | 81      |
| CRM-34R    | 343    | 50     | 278    | 5.0    | 2      | 28      |
| CRM-35R    | 1520   | 2      | 41     | .8     | 2      | 31      |
| CRM-36R    | 13     | 3      | 105    | .3     | 2      | 3       |
| CRM-39R    | 126    | 2      | 106    | .1     | 2      | 4       |
| STD C/AU-R | 58     | 41     | 133    | 6.6    | 17     | 505     |

*ROMA #1 + 2*

*ROMA #4, 5, 6*

- ASSAY REQUIRED FOR CORRECT RESULT -

*[Signature]*

| SAMPLE#    | Cu<br>PPM | Pb<br>PPM | Zn<br>PPM | Ag<br>PPM | Bi<br>PPM | Au*<br>PPB |
|------------|-----------|-----------|-----------|-----------|-----------|------------|
| CRM-13X    | 280       | 54        | 103       | .4        | 2         | 20         |
| CRM-30X    | 112       | 10        | 63        | .4        | 2         | 21         |
| CRM-31X    | 154       | 7         | 71        | .3        | 3         | 16         |
| CRM-32X    | 178       | 25        | 79        | .7        | 2         | 130        |
| CRM-37X    | 110       | 12        | 70        | .8        | 2         | 9          |
| CRM-38X    | 106       | 8         | 78        | .3        | 2         | 2          |
| CRM-40X    | 91        | 8         | 58        | .4        | 2         | 3          |
| STD C/AU-S | 63        | 39        | 132       | 6.8       | 22        | 51         |

ROMA  
172  
ROMA  
34, 5

*[Handwritten signature]*

PROSPECTING OUTCROP/SAMPLE MAP

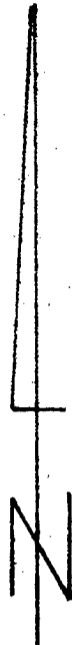

FOR  
 PACIFIC RIM MINING CORP.  
 ASSESSMENT REPORT  
 APRIL, 1990  
 ROMA # 3 TO # 5  
 CLAIMS  
 GALORE CREEK, LIARD M.D., B.C.  
 NTS 1046/3W

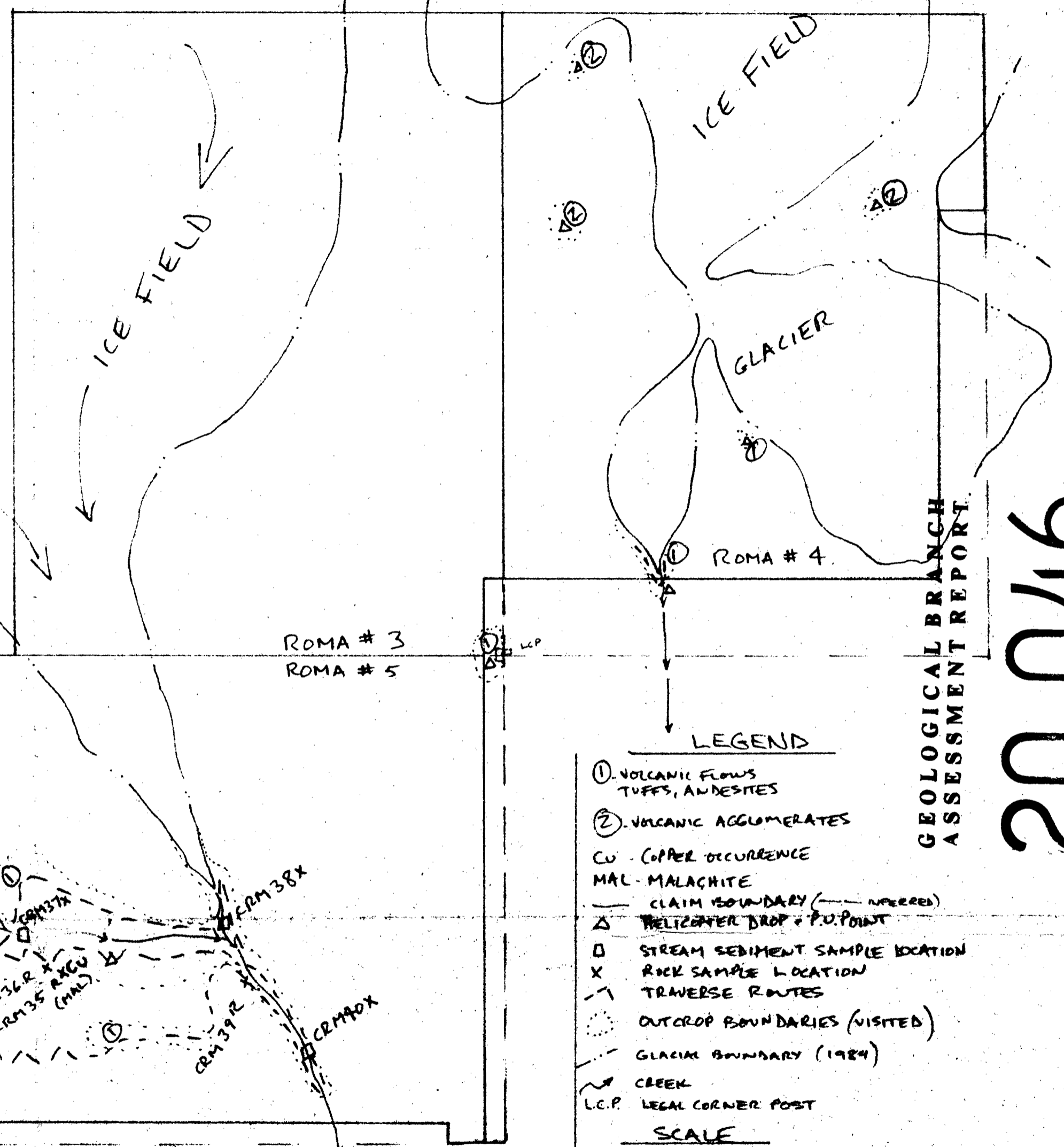

- LEGEND
- ① VOLCANIC FLOWS  
TUFFS, ANDESITES
  - ② VOLCANIC AGGUMERATES
  - CU - COPPER OCCURRENCE
  - MAL - MALACHITE
  - CLAIM BOUNDARY (--- UNPERED)
  - △ HELICOPTER DROP & P.O. POINT
  - STREAM SEDIMENT SAMPLE LOCATION
  - X ROCK SAMPLE LOCATION
  - - - TRAVERSE ROUTES
  - OUTCROP BOUNDARIES (VISITED)
  - GLACIAL BOUNDARY (1984)
  - ~ CREEK
  - L.C.P. LEGAL CORNER POST

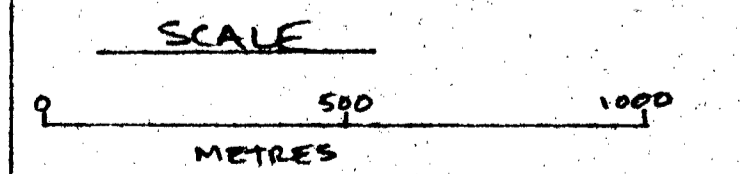

J.M. (SEE APPENDIX 'B' FOR ASSAY RESULTS.) FIG. 3

GEOLOGICAL BRANCH  
ASSESSMENT REPORT

20,046