

MINING LEASE No.34

584.7 ha (1444.77 acres)

LAWYERS No.3
Rec. No. 8596
(6 units)

LAWYERS No.4
Rec. No. 8597
(3 units)

LAWYERS No.6
Rec. No. 8599
(16 units)

LAWYERS No.1
Rec. No. 8594
(8 units)

LAWYERS No.7
Rec. No. 8600
(2 units)

LAWYERS No.9
Rec. No. 8602 (4 units)

LEGEND

LITHOLOGIES

TOCODOGONE GROUP VOLCANICS (LOWER TO MIDDLE JURASSIC)

2 FELDSPAR PORPHYRY ANDESITE CRYSTAL AND CRYSTAL LAGUNA TUFF - Typically 15 to 25 subhedral feldspar phenocrysts (1 to 5ml) and 5 to 20 quartz eyes. Occasional lappill and bomb sized pyroclasts.

1 FELDSPAR MEGACRYSTAL ANDESITE CRYSTAL TUFF - similar to Feldspar Porphyry Andesite Crystal tuff but with increased K-feldspar content. Dark green coloured. Contains 1 - 25 large subhedral feldspar megacrysts to 1cm x 5cm.

STRUCTURAL UNITS

CHALCEDONY BRACCOIA - >20% angular to rounded chalcedony fragments and minor wallrock fragments within a chalcedony and/or basaltic matrix.

Limit of Chalcedony Braccia Zone

Limit of Argillic Alteration Zone

Fault - definite

Fault - assumed

Geological Contact

NADIR MAPPING CORPORATION,
310 WATER STREET, VANCOUVER,
Telephone (604) 683-3282

COMPILED JUNE 1985
PHOTO SCALE 1:24000

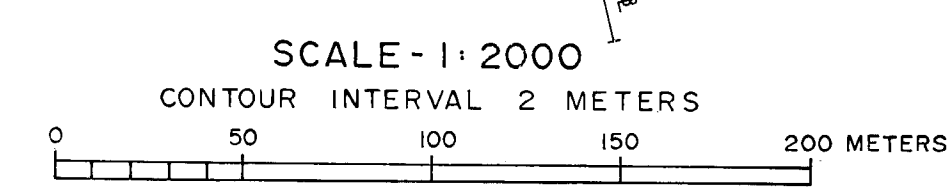

CHENI GOLD MINES INC.
LAWYERS PROJECT

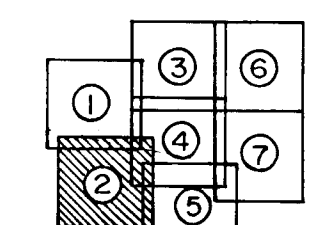

PLAN MAP
GEOLOGY and DRILL HOLE LOCATIONS

20405

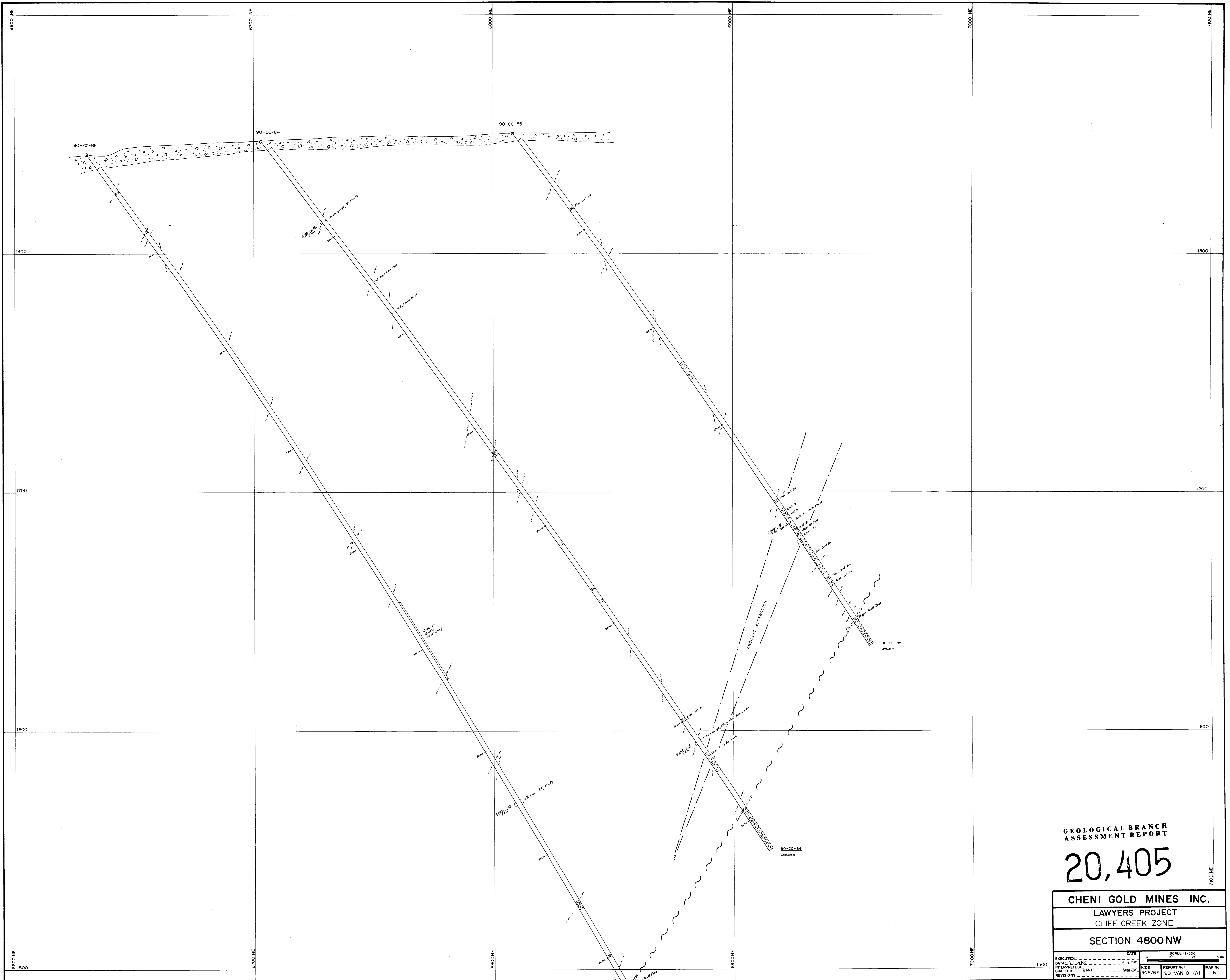

GEOLOGICAL BRANCH
ASSESSMENT REPORT

20,405

CHENI GOLD MINES INC.
LAWYERS PROJECT
CLIFF CREEK ZONE
SECTION 4800 NW

EXECUTED:	DATE	SCALE	1/500	30m
INTERPRETED:	DATE	SCALE	1/500	30m
DRAFTED:	DATE	SCALE	1/500	30m
REVISIONS:	DATE	SCALE	1/500	30m

90-CC-86
End of core @ 426.08m
in megacrystic andesitic crystal tuff

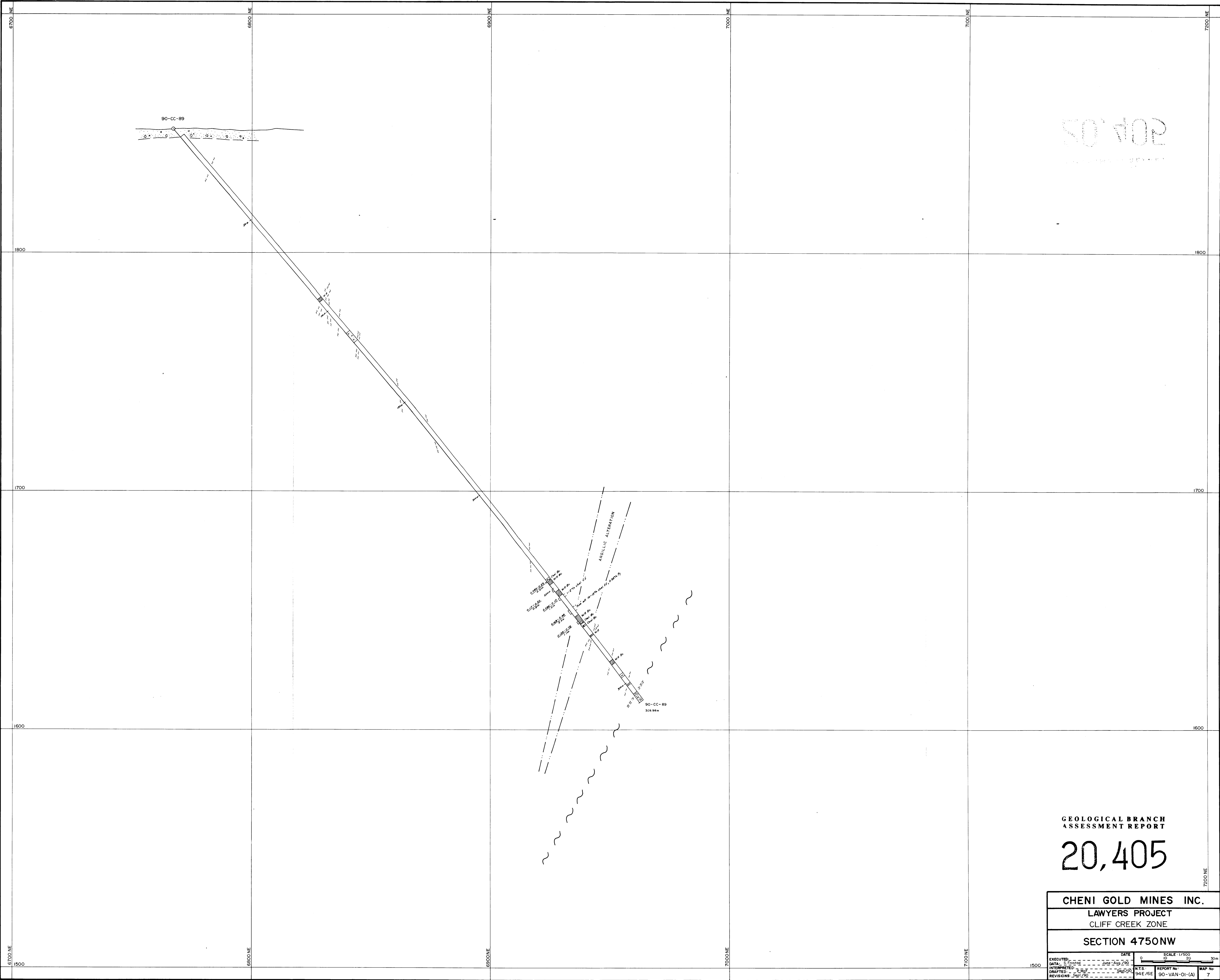

20,405

GEOLOGICAL BRANCH
ASSESSMENT REPORT

20,405

CHENI GOLD MINES INC.
LAWYERS PROJECT
CLIFF CREEK ZONE
SECTION 4750NW

EXECUTED: _____	DATE: _____	SCALE: 1/500
DATA: S. 1/2/95	DATE: 2/19/95	0 10 20 30m
INTERPRETED: _____	DATE: _____	NTS
DRAFTED: _____	DATE: _____	REPORT No: 94E/5E
REVISIONS: _____	DATE: _____	90-VAN-01-(A)
		MAP No: 7

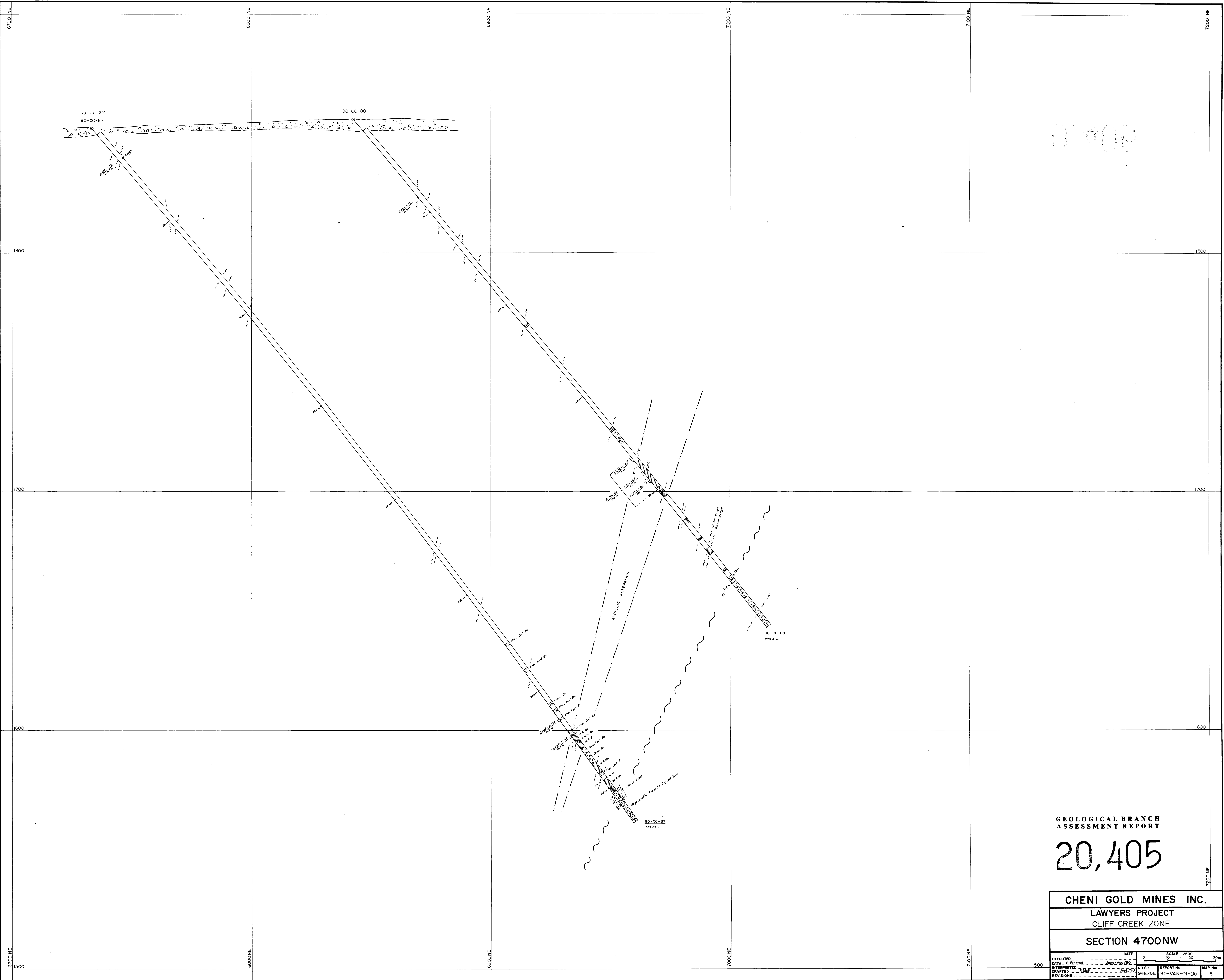

01709

GEOLOGICAL BRANCH
ASSESSMENT REPORT

20,405

CHENI GOLD MINES INC.			
LAWYERS PROJECT			
CLIFF CREEK ZONE			
SECTION 4700NW			
EXECUTED	DATE	SCALE	1:500
DRAWN	DATE	0	10 20 30m
INTERPRETED	DATE	N.T.S.	REPORT No.
DRAFTED	DATE	94E/6E	90-VAN-01-(A)
REVISIONS			MAP No. 8

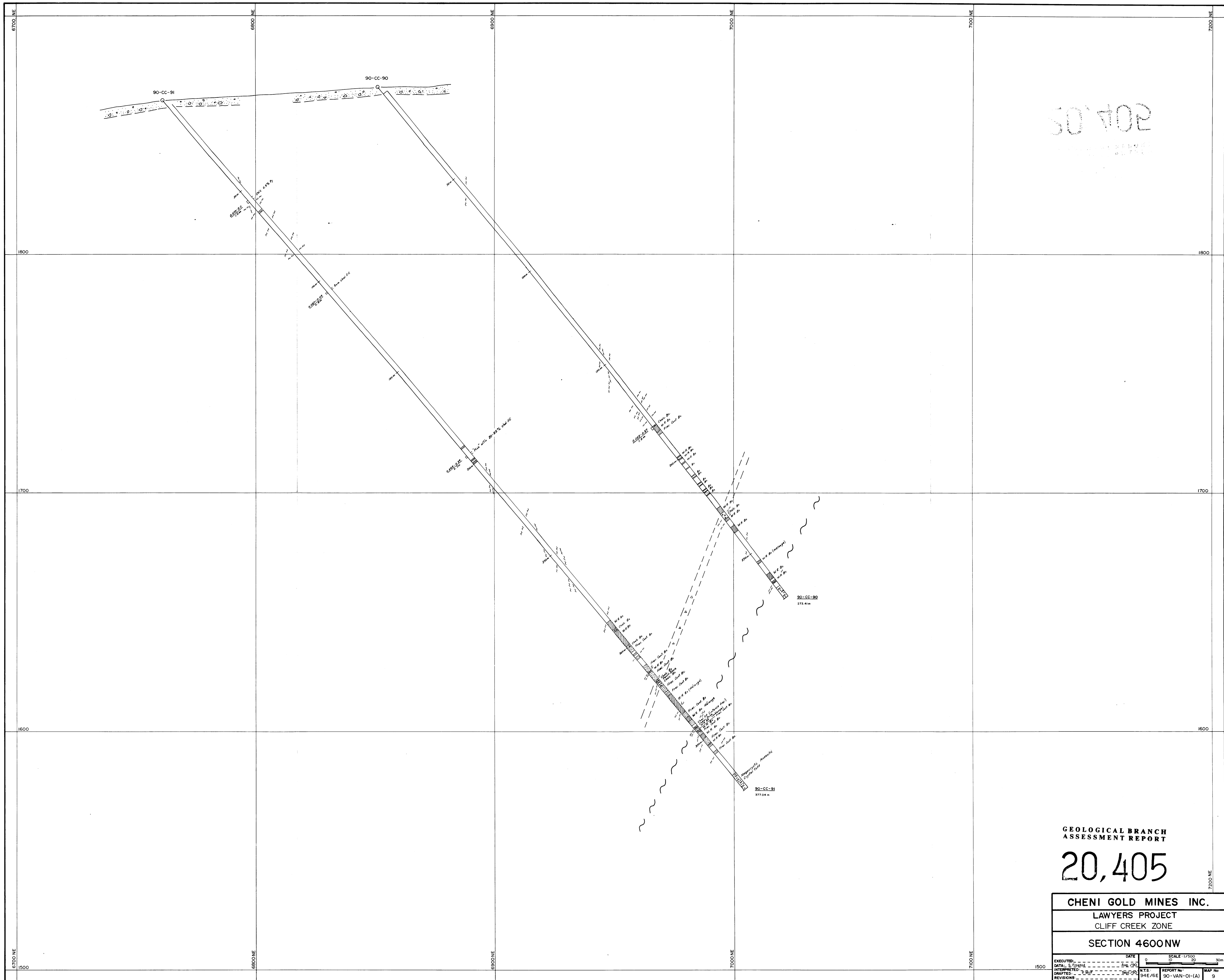

50702

**GEOLOGICAL BRANCH
ASSESSMENT REPORT**

20,405

**CHENI GOLD MINES INC.
LAWYERS PROJECT
CLIFF CREEK ZONE
SECTION 4600NW**

EXECUTED	DATE	SCALE	1:500
DATA	3/20/90	0	10 20 30m
INTERPRETED			
DRAFTED	S.B.F.	NTS	REPORT No. 90-VAN-01-(A)
REVISIONS		34E/6E	MAP No. 9

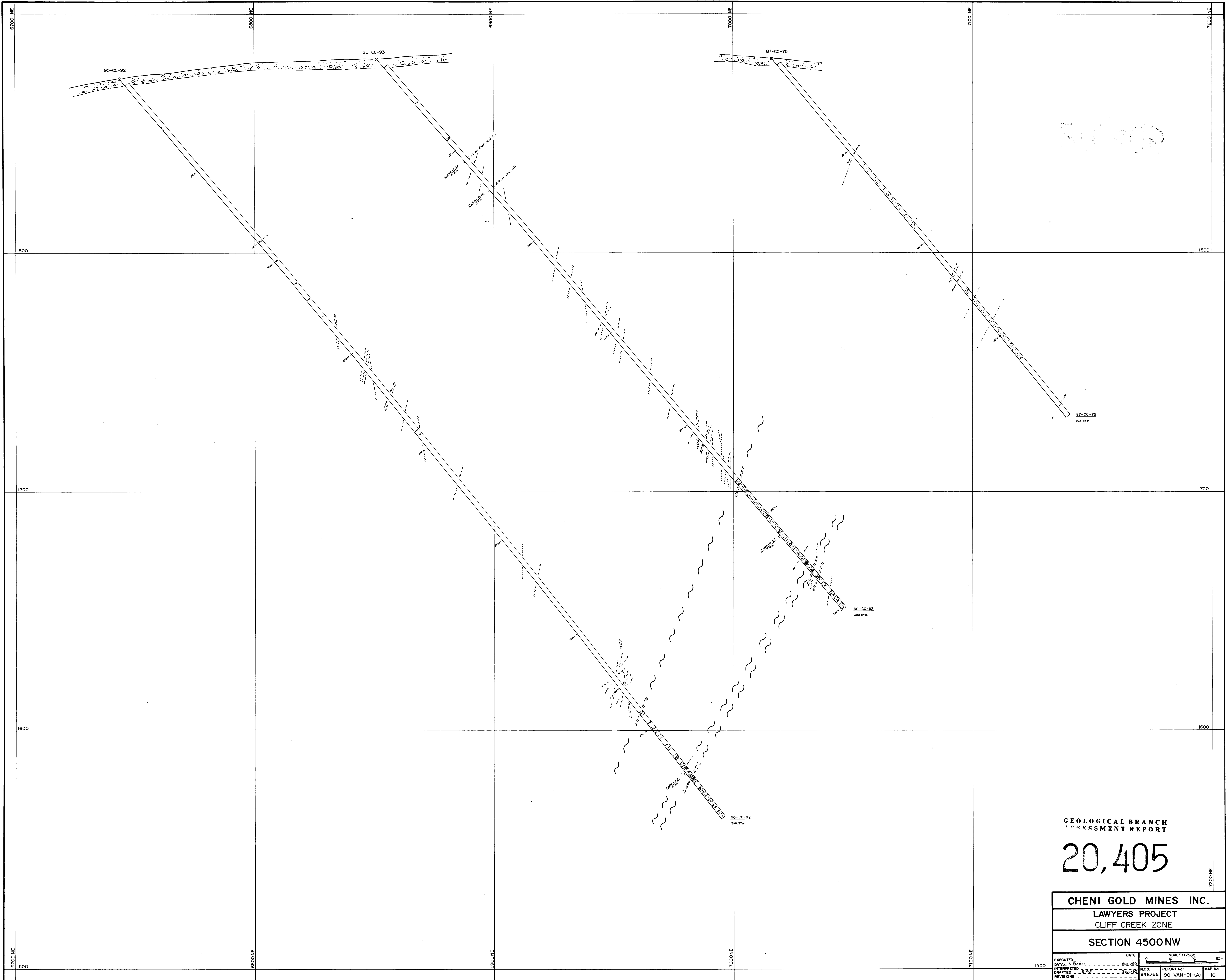

20,405

GEOLOGICAL BRANCH
ASSESSMENT REPORT

20,405

CHENI GOLD MINES INC.
LAWYERS PROJECT
CLIFF CREEK ZONE
SECTION 4500 NW

EXECUTED: _____	DATE: _____	SCALE: 1/7500
DATA: S. F. 1998	INT. BY: S. F. 1998	0 10 20 30m
DRAFTED: S. F. 1998	NTS	REPORT No: 90-VAN-01-(A)
REVISIONS: _____	94E/SE	MAP No: 10

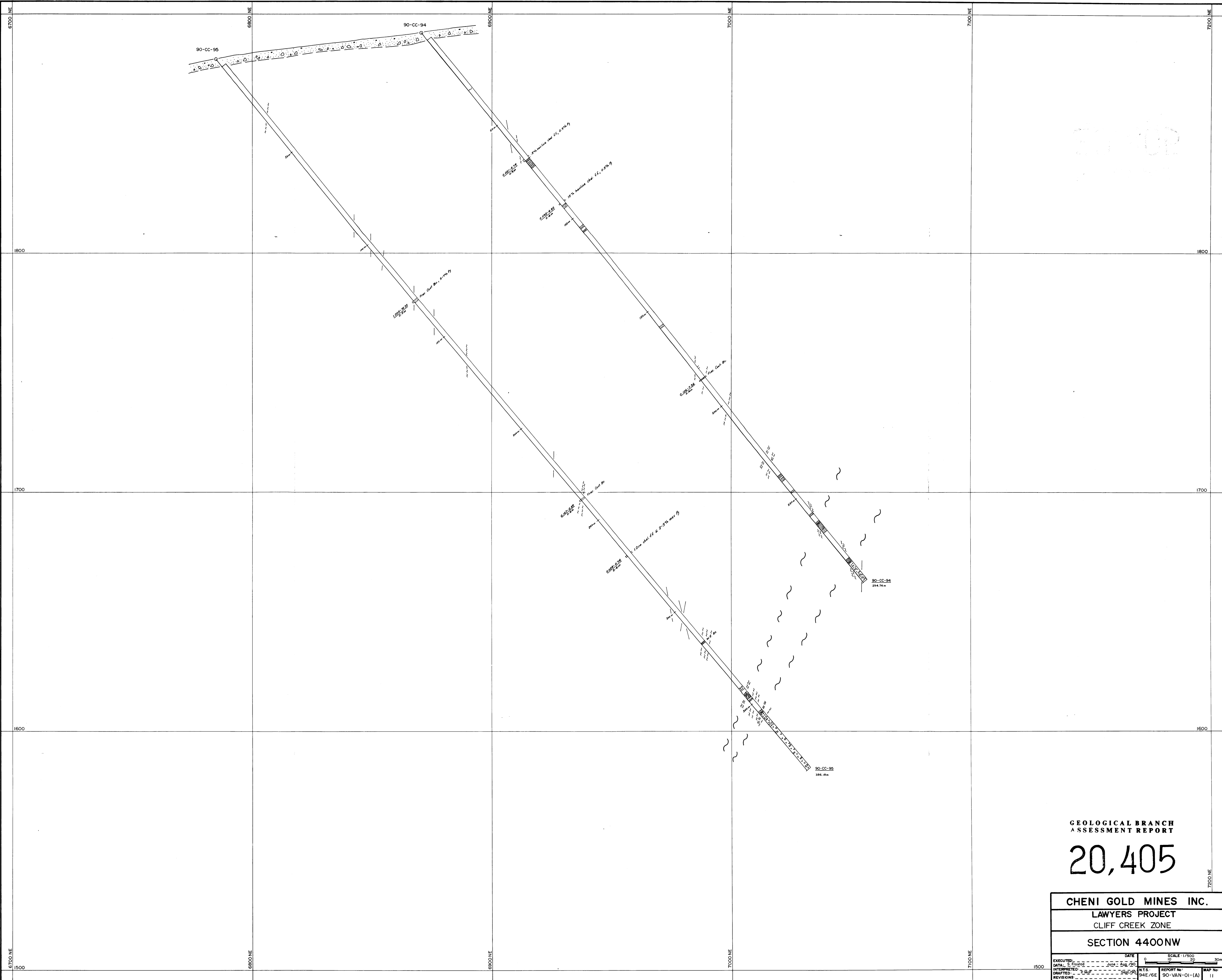

20,405

**GEOLOGICAL BRANCH
ASSESSMENT REPORT**

20,405

**CHENI GOLD MINES INC.
LAWYERS PROJECT
CLIFF CREEK ZONE
SECTION 4400NW**

EXECUTED: _____	DATE: _____	SCALE: 1/500
DATA: 3 Frostad	DATE: 2 Aug 2010	0 10 20 30m
INTERPRETED: T.M.J.	DATE: _____	
DRAFTED: T.M.J.	DATE: _____	
REVISIONS: _____	DATE/EE: _____	REPORT NO: 90-VAN-01-(A)
		MAP NO: 11

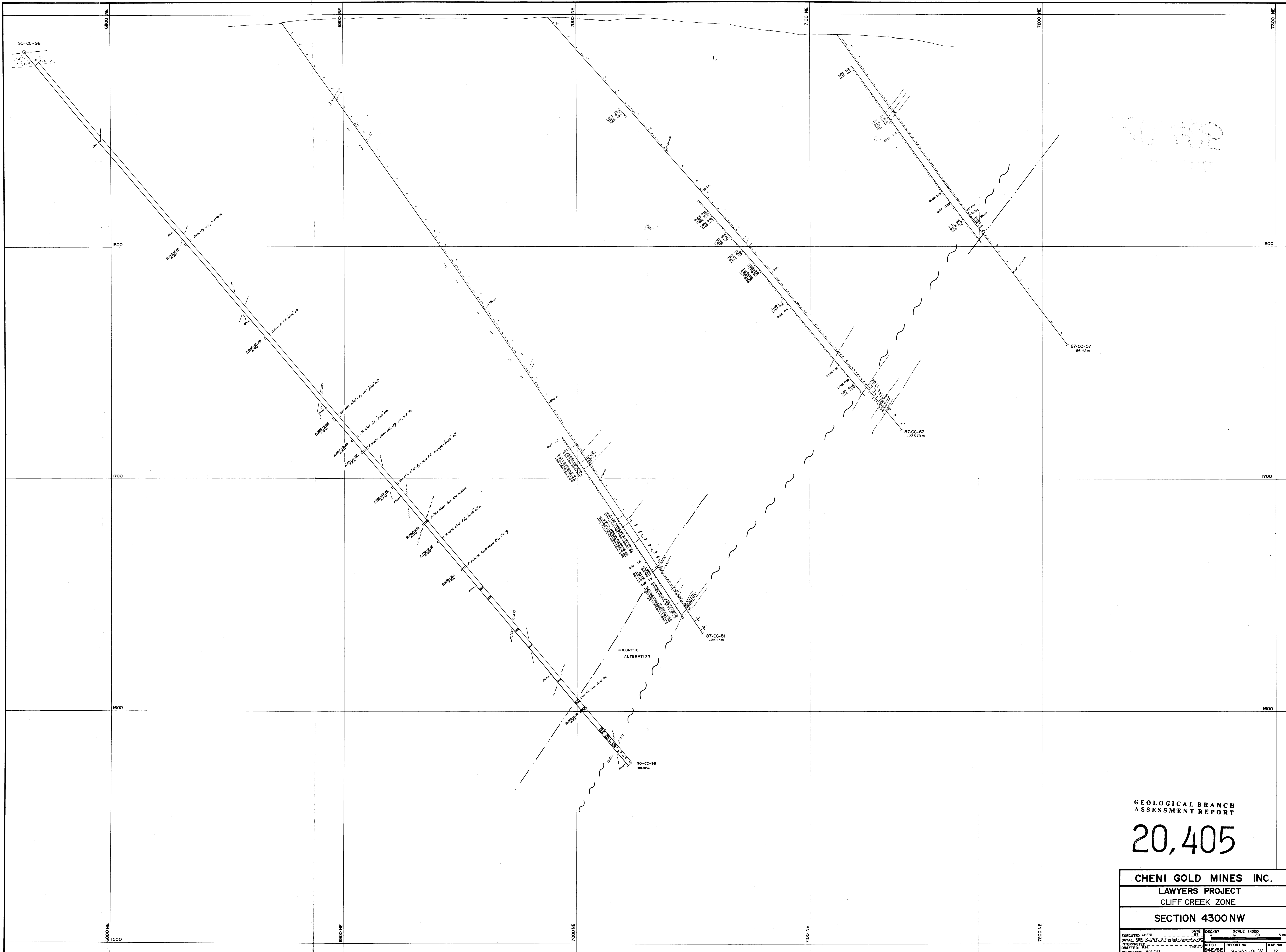

GEOLOGICAL BRANCH
 ASSESSMENT REPORT
20,405

CHENI GOLD MINES INC.			
LAWYERS PROJECT			
CLIFF CREEK ZONE			
SECTION 4300NW			
EXECUTED: CHENI	DATE: 8/7	SCALE: 1:800	30m
DRAWN: JAS	DATE: 8/7	SCALE: 1:800	30m
INTERPRETED: JAS	DATE: 8/7	SCALE: 1:800	30m
REVISED: JAS	DATE: 8/7	SCALE: 1:800	30m
DATE: 8/7	SCALE: 1:800	30m	
REPORT No:	9-VAN-01(A)	MAP No:	12

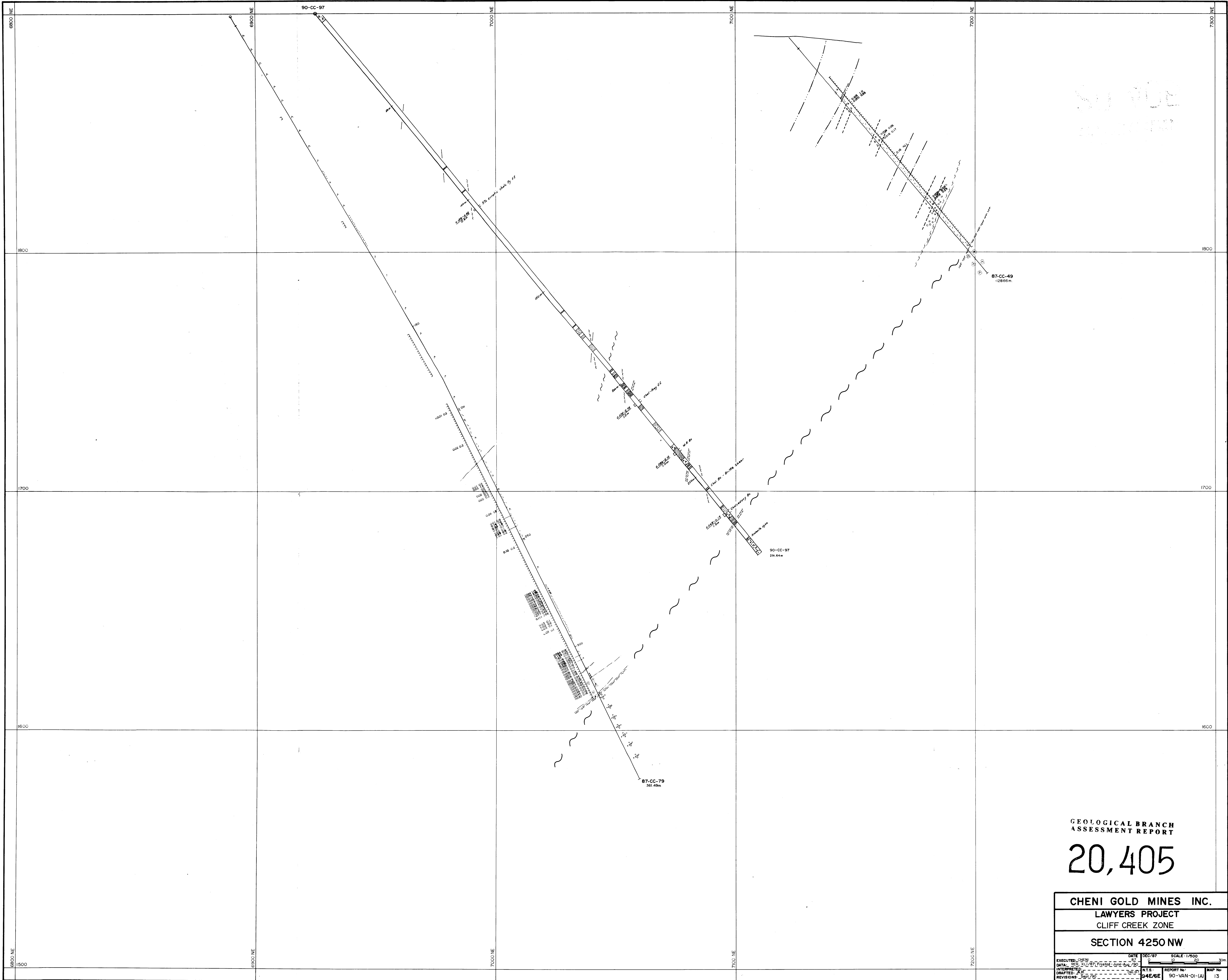

GEOLOGICAL BRANCH
ASSESSMENT REPORT

20,405

CHENI GOLD MINES INC.
LAWYERS PROJECT
CLIFF CREEK ZONE
SECTION 4250 NW

EXECUTED	DATE	SCALE
DATE	12/07	1:200
INTERPRETED	REPORT No.	MAP No.
DRAFTED	94E/BE	90-VAN-OI-(A)
REVISIONS	13	

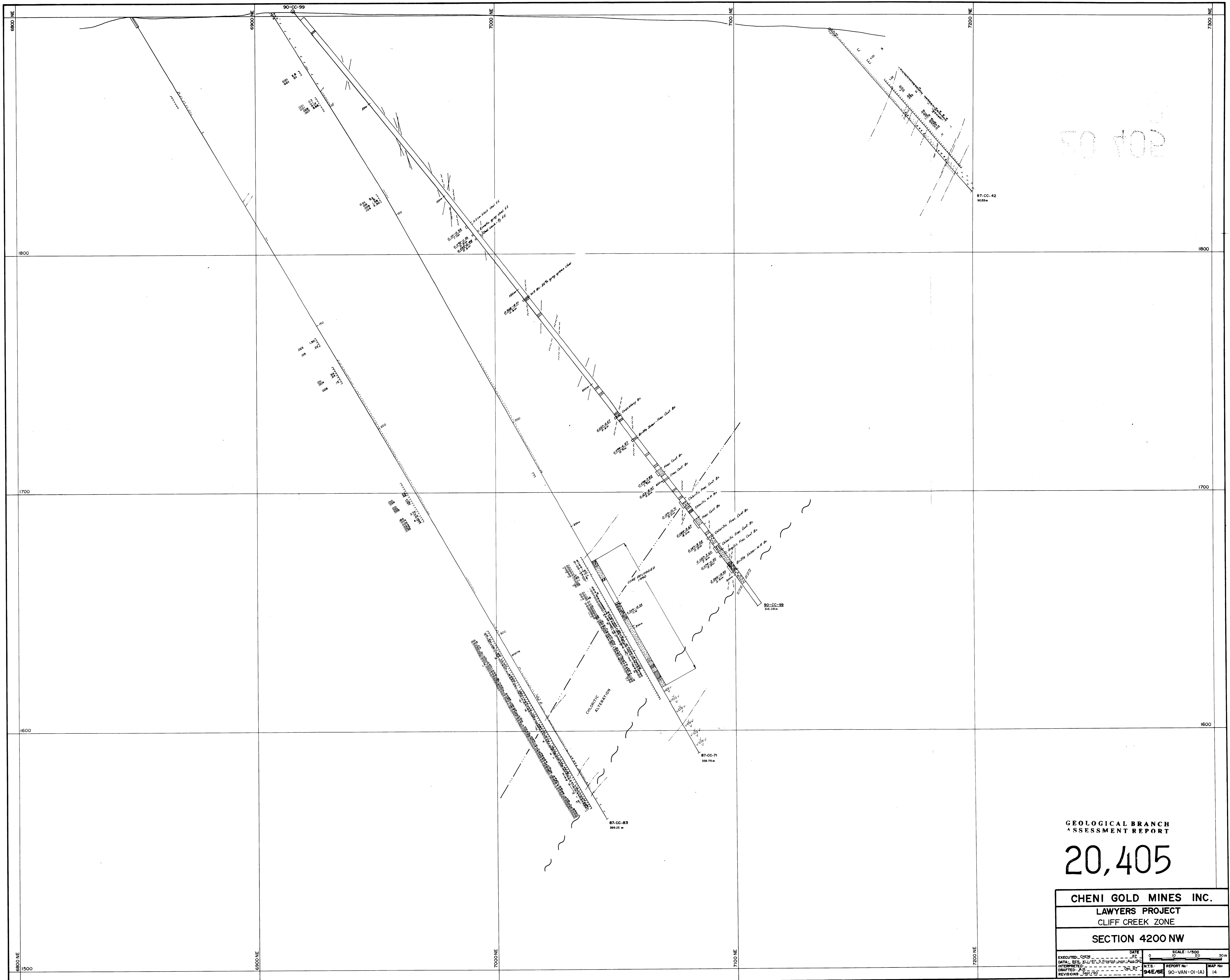

20,405

GEOLOGICAL BRANCH
ASSESSMENT REPORT

20,405

CHENI GOLD MINES INC.
LAWYERS PROJECT
CLIFF CREEK ZONE
SECTION 4200 NW

EXECUTED: CHEN	DATE: 07	SCALE: 1/500
DATA: 87-CC-83, 87-CC-71, 87-CC-82, 87-CC-42	0	10 20 30m
INTERPRETED: JLS	N.T.S.	REPORT No: 90-VAN-01-(A)
DRAFTED: JLS	94E/88	MAP No: 14
REVISIONS: 01/17/92		

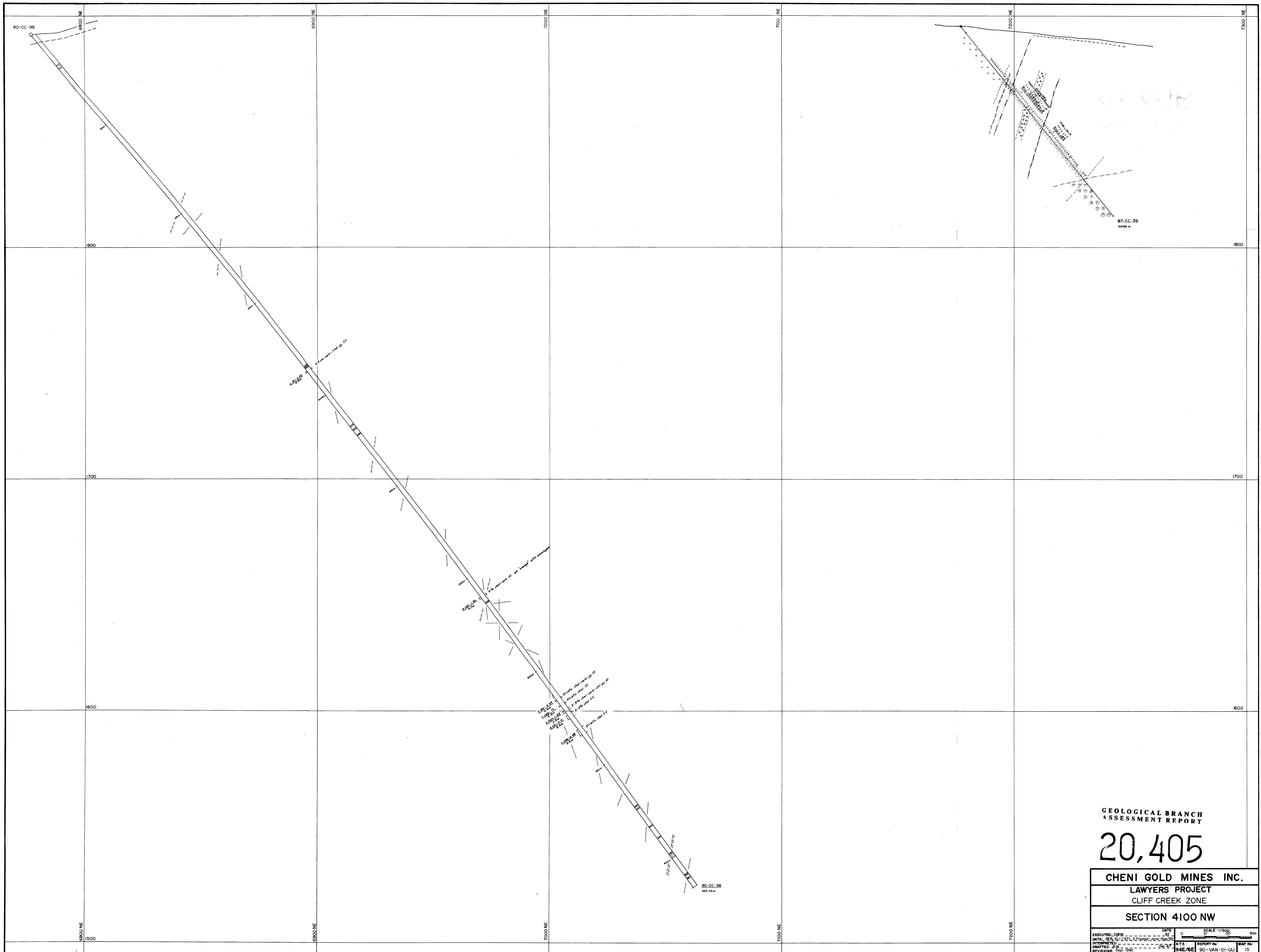

GEOLOGICAL BRANCH
ASSESSMENT REPORT

20,405

CHENI GOLD MINES INC.
LAWYERS' PROJECT
CLIFF CREEK ZONE
SECTION 4100 NW

EXECUTED: CHM	DATE: 01/01/00	SCALE: 1/5000	MAP NO:
DATA: SFL, KJ, LK, S, T, R, G, C, M, A, H, S, P, O	BY: JAE	0 10 20 30m	15
INTERPRETED: JAE	DATE: 01/01/00	REPORT NO:	90-VAN-01-(A)
DRAFTED: JAE	DATE: 01/01/00	BY: JAE/BE	
REVISIONS: SFL, 1/20/00			