

INSTRUMENT : IGS - 2
 Azimuth to Station : Az218

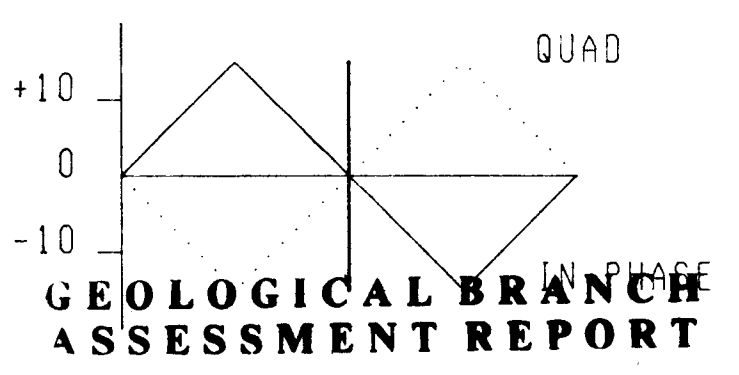
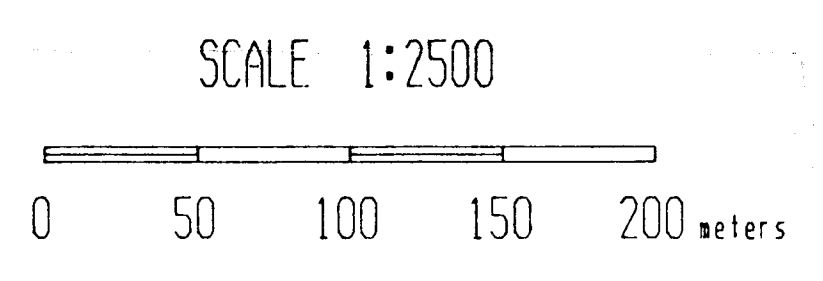

20,536
 Part 2 of 2
 REVISIONS

By	Date	Apprv. By

MINNOVA INC.
 MIDWAY PROPERTY

HAWAII VLF-EM
 PROFILE MAP

In accompany a report by

Project No:	Report No:
Drawing No:	E.L.S.:
Date: 07/04/90	Fig No: 21

QUEST CANADA EXPLORATION SERVICES INC.

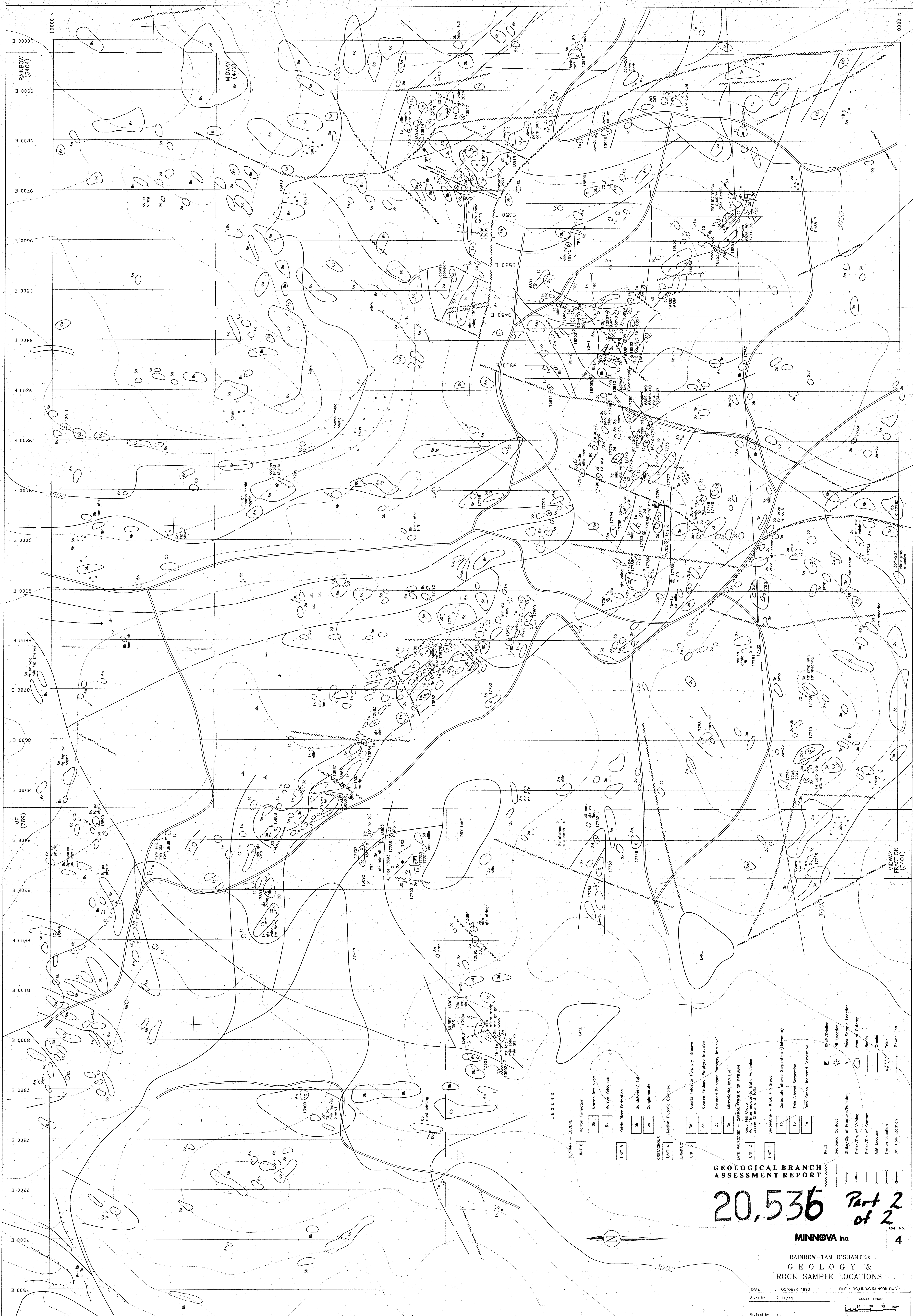

LEGEND

- | | | | |
|---------------|--|----------------------------------|--|
| UNIT 6 | Warron Formation | UNIT 3 | Quartz Feldspar Porphyry Intrusive |
| 6a | Warron Intrusive | 3a | Coarse Feldspar Porphyry Intrusive |
| 6b | Warron Volcanics | 3b | Coarse Feldspar Porphyry Intrusive |
| UNIT 5 | Kettle River Formation | 3c | Microdiorite Intrusive |
| 5a | Sandstone / Turf | UNIT 2 | LATE PALEOZOIC - ONDREPOUS OR REINMAN |
| 5b | Conglomerate | 2a | Knob Hill Group |
| UNIT 4 | Medford Plutonic Complex | 2b | Ureter Chert and Muff |
| 4a | Medford Plutonic Complex | UNIT 1 | Serpentine - Knob Hill Group |
| UNIT 3 | UJASSZC | 1a | Composites altered Serpentine (Uthmaniyah) |
| 3a | Quartz Feldspar Porphyry Intrusive | 1b | Dark Green Unaltered Serpentine |
| 3b | Coarse Feldspar Porphyry Intrusive | 1c | Dark Green Unaltered Serpentine |
| 3c | Coarse Feldspar Porphyry Intrusive | FAULT | Shear/Deformed |
| 3d | Microdiorite Intrusive | Geological Contact | Fracture/Foliation |
| UNIT 2 | LATE PALEOZOIC - ONDREPOUS OR REINMAN | Shear/Zone of Fracture/Foliation | Rock Sample Location |
| 2a | Knob Hill Group | Shear/Zone of Folding | Area of Outcrop |
| 2b | Ureter Chert and Muff | Shear/Zone of Contact | Roads |
| 2c | Serpentine - Knob Hill Group | Art Location | Contours |
| 2d | Composites altered Serpentine (Uthmaniyah) | Trench Location | Power Line |
| 2e | Dark Green Unaltered Serpentine | Drill Hole Location | |

GEOLOGICAL BRANCH ASSESSMENT REPORT

20,536 Part 2 of 2

MINNOVA Inc.		MAP No.	4
RAINBOW-TAM O'SHANTER GEOLOGY & ROCK SAMPLE LOCATIONS			
DATE	OCTOBER 1990	FILE	D:\LINDA\RAINSOL.WG
Drew by	LL/sg	SCALE	1:2500
Revised by			

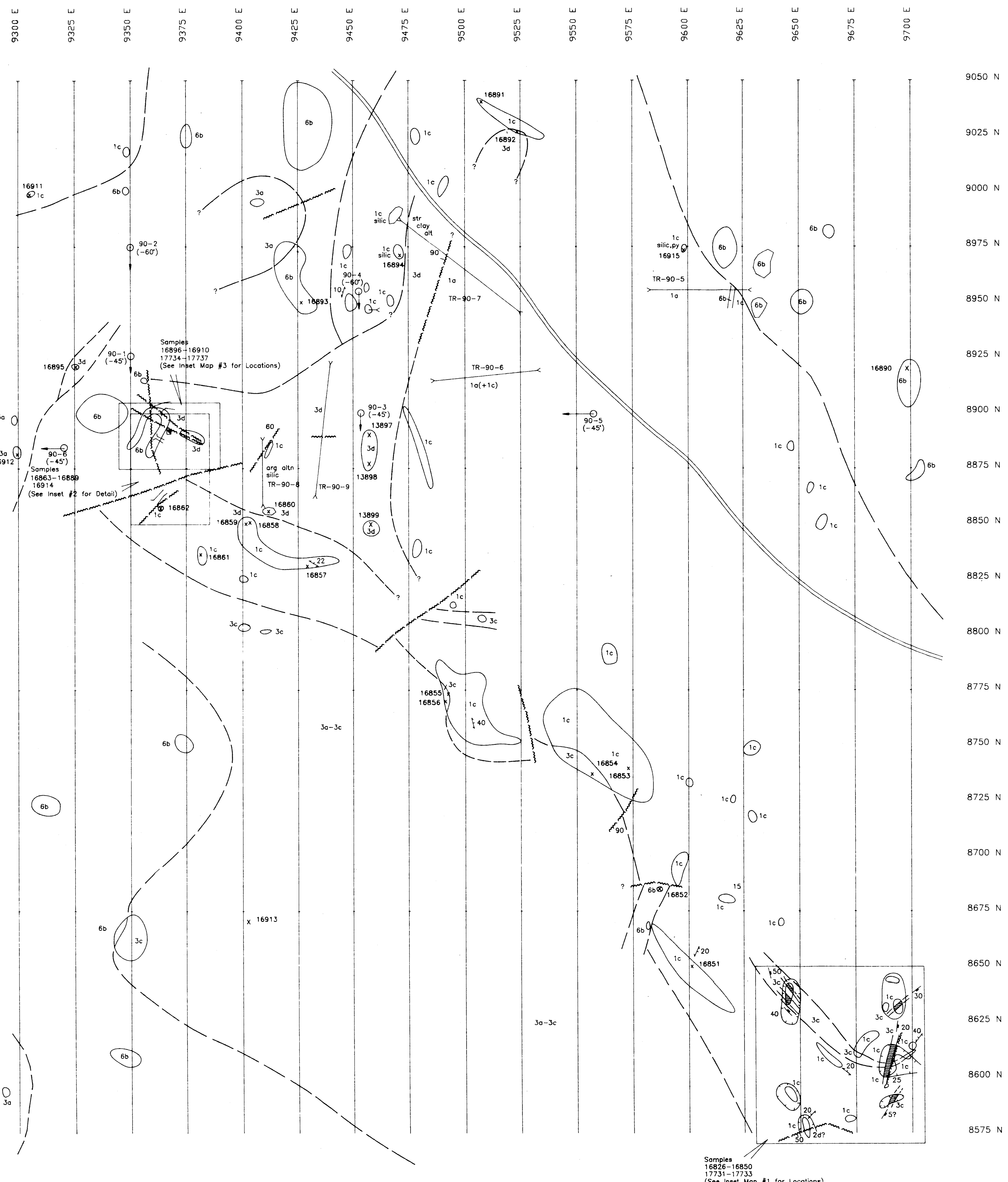

LEGEND

- TERTIARY - EOCENE
 - UNIT 6 Marron Formation
 - 6b Marron Intrusives
 - 6a Marron Volcanics
 - UNIT 5 Kettle River Formation
 - 5b Sandstone / Tuff
 - 5a Conglomerate
 - CRETACEOUS
 - UNIT 4 Nelson Plutonic Complex
 - JURASSIC
 - UNIT 3
 - 3d Quartz Feldspar Porphyry Intrusive
 - 3c Coarse Feldspar Porphyry Intrusive
 - 3b Crowded Feldspar Porphyry Intrusive
 - 3a Microdiorite Intrusive
 - LATE PALEOZOIC - CARBONIFEROUS OR PERMAN
 - UNIT 2
 - Knob Hill Group
 - Many Intermediate to Mafic Volcanics
 - Lesser Cherts and Tuffs
 - UNIT 1
 - Serpentine - Knob Hill Group
 - 1c Carbonate altered Serpentine (Listwanite)
 - 1b Talc Altered Serpentine
 - 1a Dark Green Unaltered Serpentine
- Fault
 - Geological Contact
 - Strike/Dip of Fracture/Foliation
 - Strike/Dip of Veining
 - Strike/Dip of Contact
 - Adit Location
 - Trench Location
 - Drill Hole Location
 - Shaft/Decline
 - ✱ Pit Location
 - x Rock Sample Location
 - Area of Outcrop
 - == Roads
 - Creeks
 - x x x x x Talus
 - Power Line

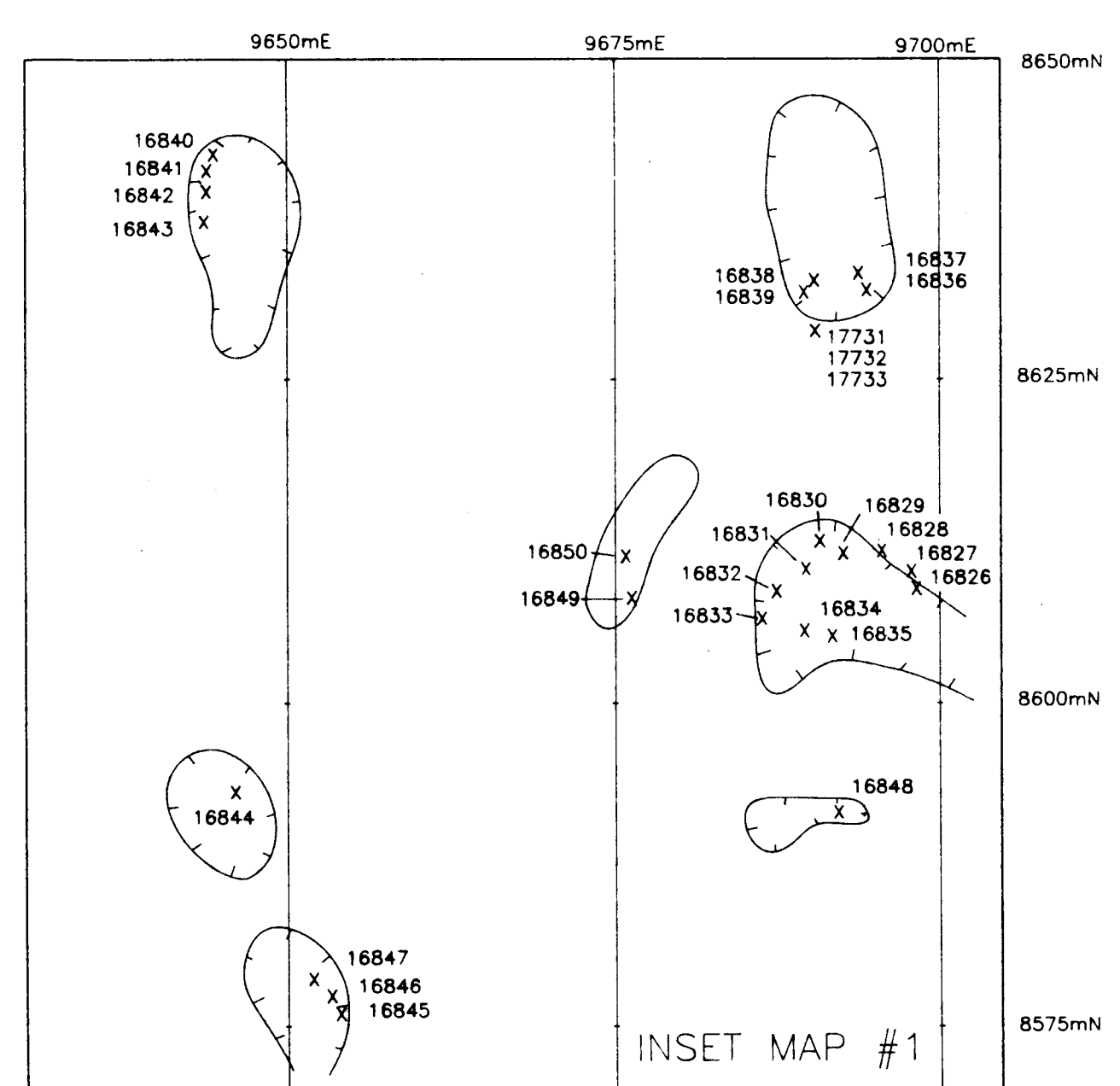
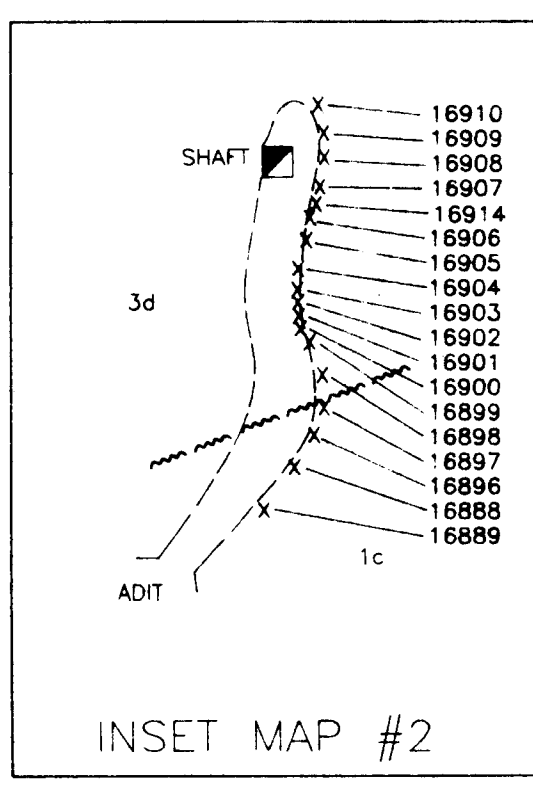
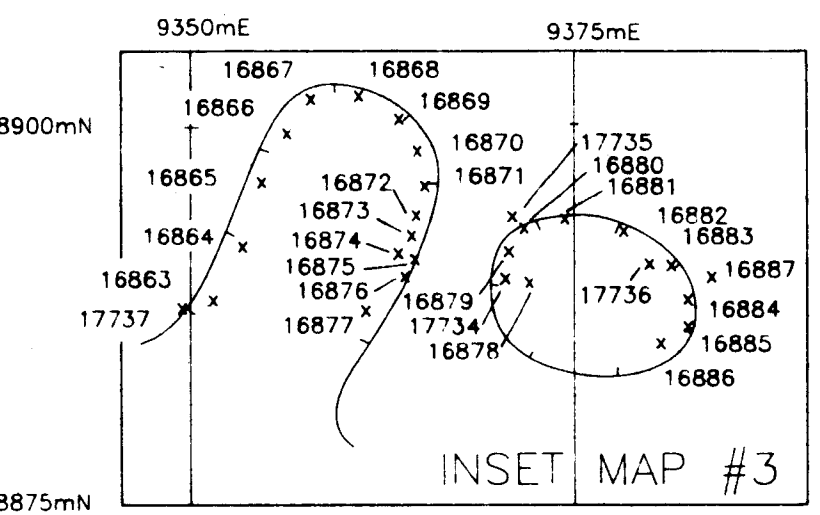

**GEOLOGICAL BRANCH
ASSESSMENT REPORT**

20,536 *Part 2
of 2*

MINNOVA Inc.		MAP No. 5
RAINBOW DETAILED GRID GEOLOGY & ROCK SAMPLE LOCATIONS		
Date: NOVEMBER 1990	FILE: MINNOG.DWG	
Drawn by: LL/sj	Scale: 1 : 1000 (metres)	
Revised by:		

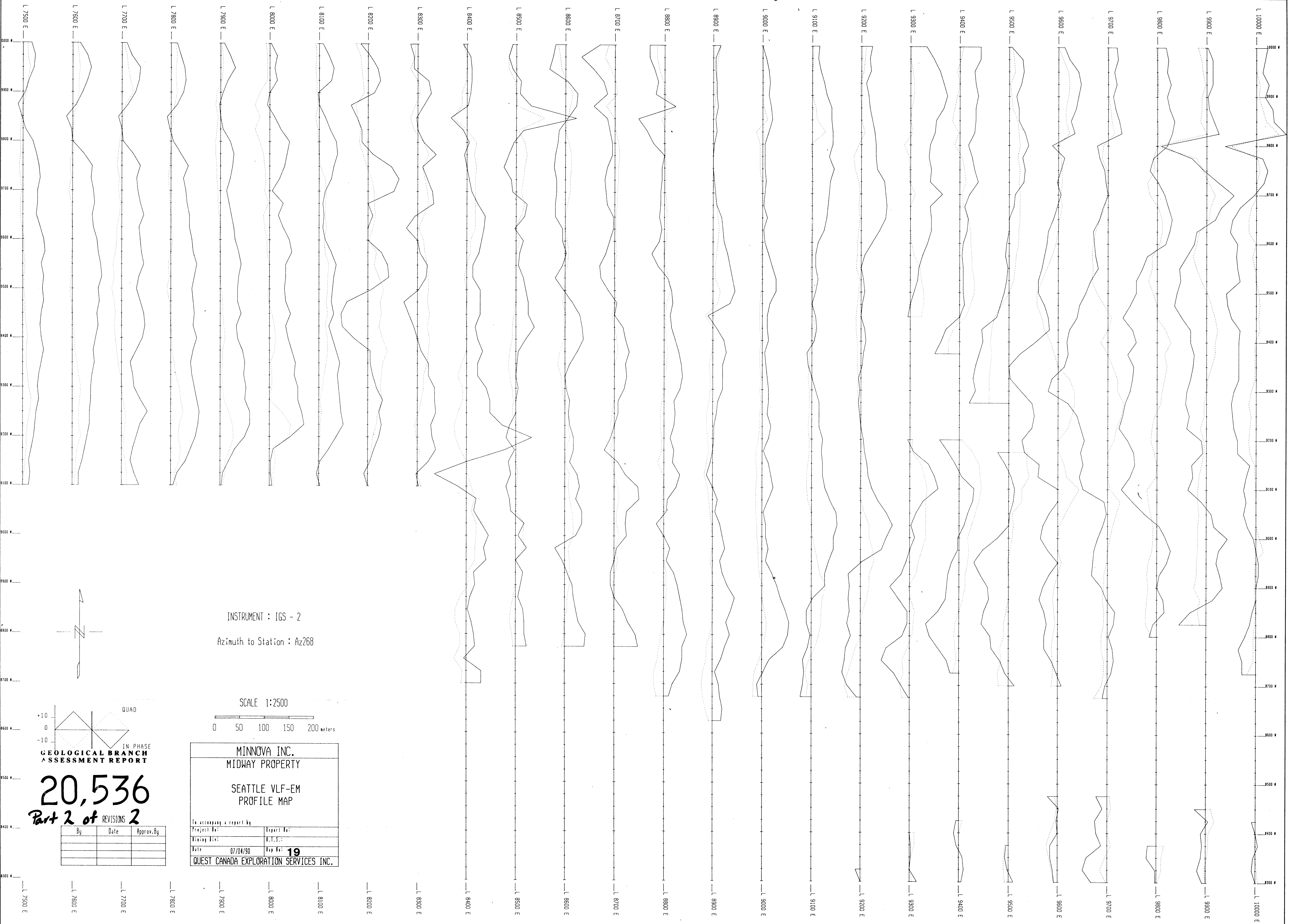

INSTRUMENT : IGS - 2
 Azimuth to Station : Az268

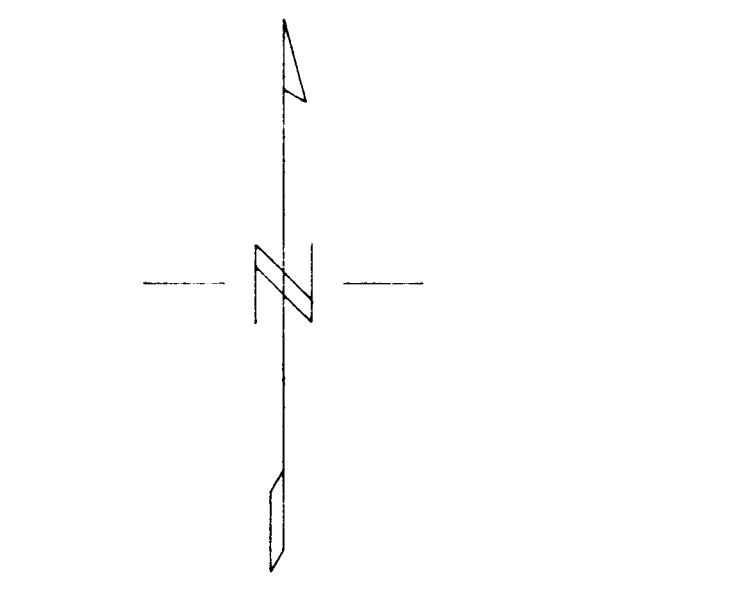
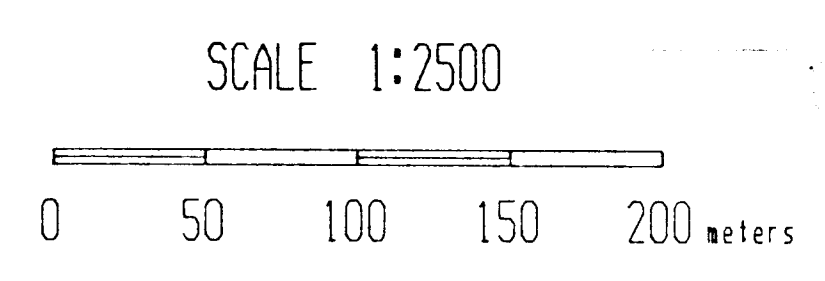

QUAD
 IN PHASE
 GEOLOGICAL BRANCH
 ASSESSMENT REPORT

20,536
 Part 2 of REVISIONS 2

By	Date	Approv. By

MINNOVA INC. MIDWAY PROPERTY	
SEATTLE VLF-EM PROFILE MAP	
In accompany a report by	
Project No:	Report No:
Drawing No:	T.C.S.:
Date: 07/04/90	Map No: 19
QUEST CANADA EXPLORATION SERVICES INC.	

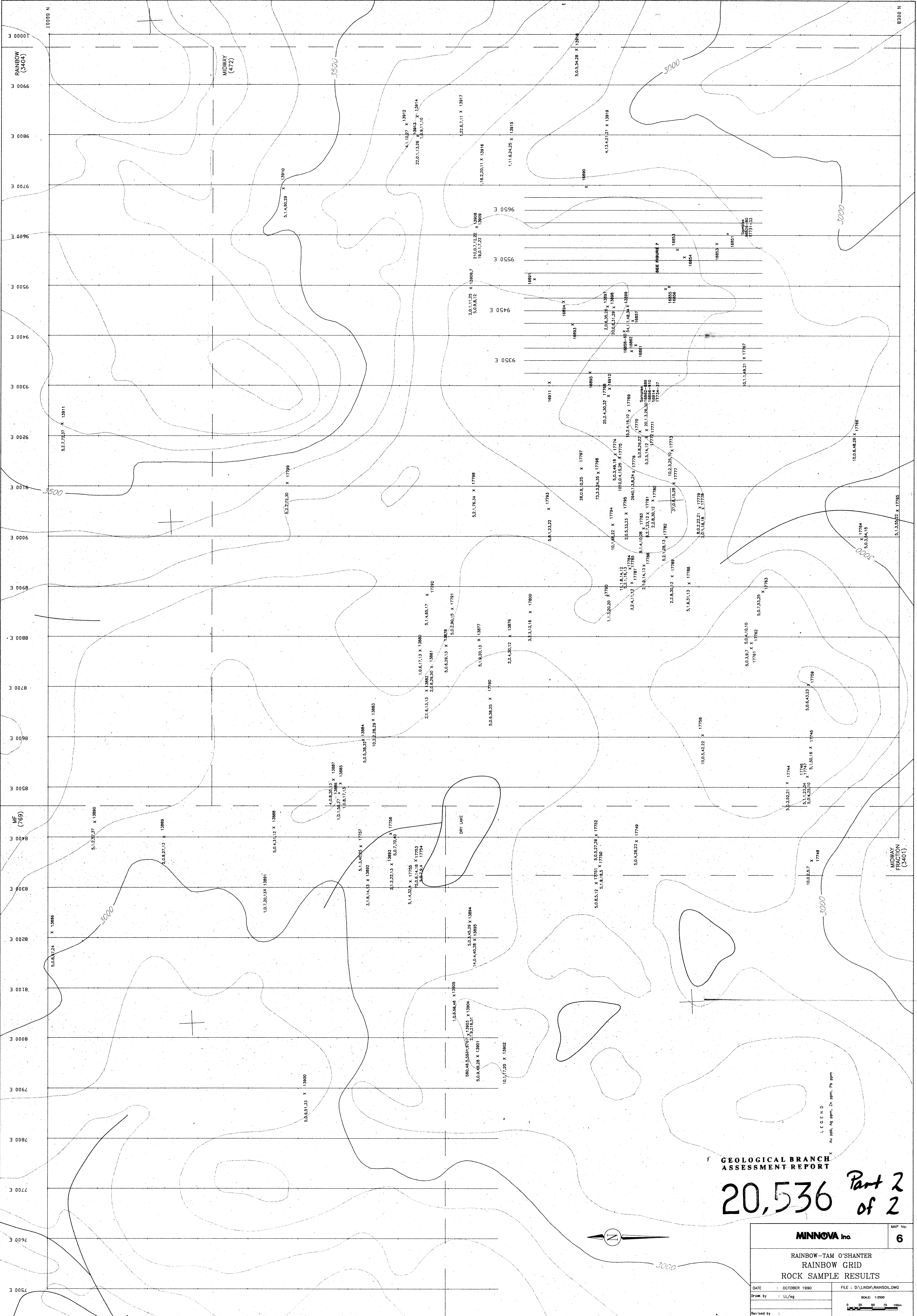

GEOLOGICAL BRANCH
ASSESSMENT REPORT

20,536 *Part 2 of 2*

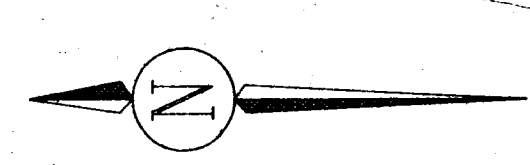

LEGEND
Au ppm, Ag ppm, Zn ppm, Pb ppm

MINNOVA Inc.		MAP No.
		6
RAINBOW-TAM O'SHANTER RAINBOW GRID ROCK SAMPLE RESULTS		
DATE :	OCTOBER 1990	FILE : D:\LINDA\RAINSOILDWG
Drawn by :	LL/sq	SCALE: 1:2500
Revised by :		0 25 50 75 100m

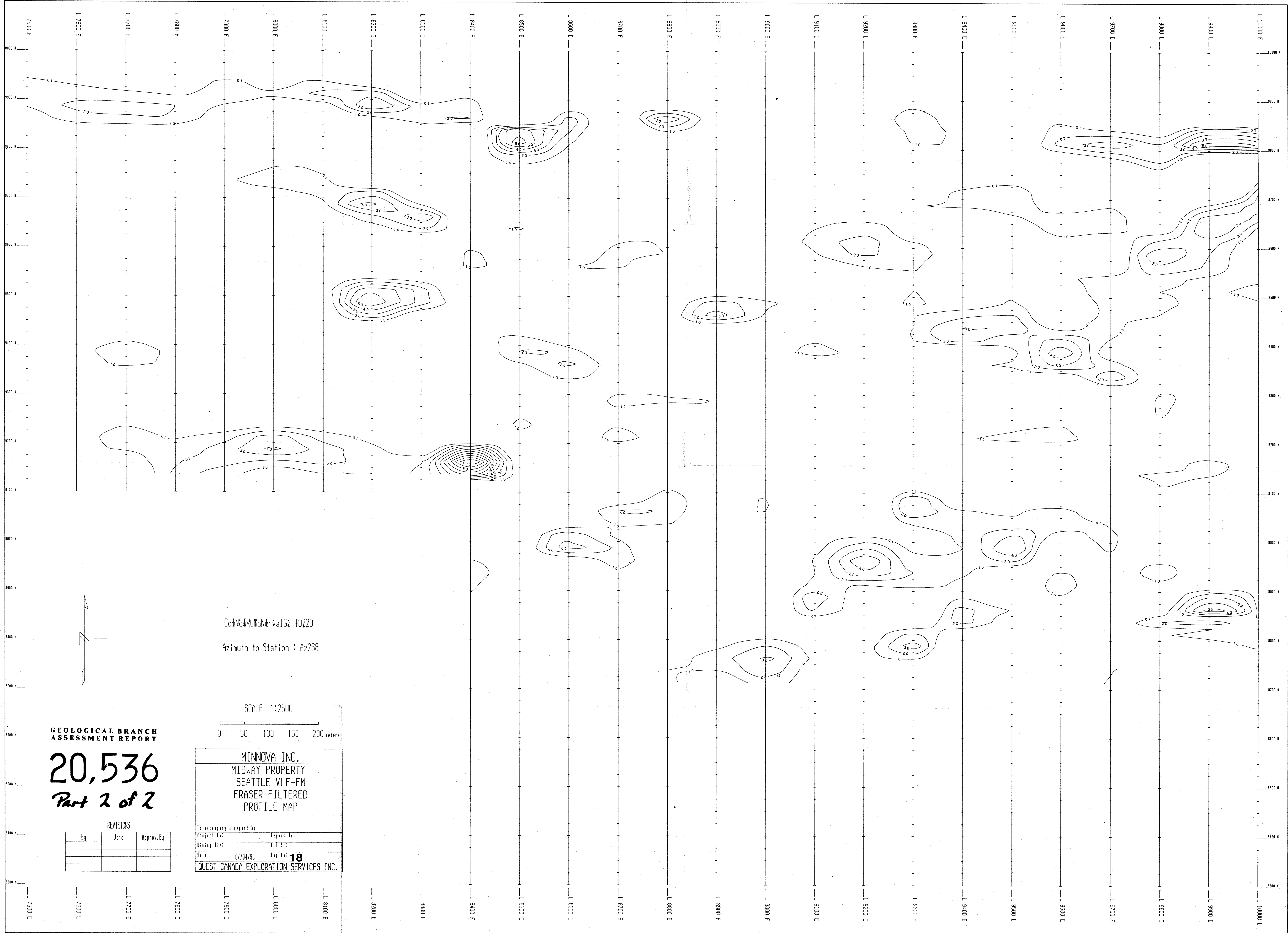

COORDINATES IN UTM 10220

Azimuth to Station : Az268

SCALE 1:2500

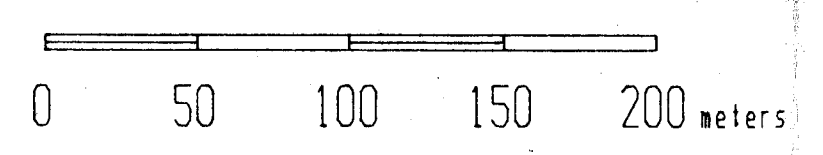

**GEOLOGICAL BRANCH
ASSESSMENT REPORT**

20,536
Part 2 of 2

REVISIONS

By	Date	Apprv. By

MINNOVA INC. MIDWAY PROPERTY SEATTLE VLF-EM FRASER FILTERED PROFILE MAP	
To accompany a report by	
Project No:	Report No:
Drawing No.:	M.P.S.:
Date: 07/04/90	Map No: 18
QUEST CANADA EXPLORATION SERVICES INC.	

SAMPLE No.	Au ppb	Ag ppm	Zn ppm	Pb ppm
BCS 18863	5	1.1	60	17
BCS 18864	4	1.5	65	25
BCS 18865	18	1.4	63	26
BCS 18866	357	2.7	150	150
BCS 18867	213	7.3	335	144
BCS 18868	83	3.7	207	88
BCS 18869	388	10.4	922	243
BCS 18870	380	6.4	156	128
BCS 18871	6800	320.4	3760	858
BCS 18872	375	6.7	262	85
BCS 18873	405	6.6	406	110
BCS 18874	308	24.1	1178	130
BCS 18875	199	10.5	219	200
BCS 18876	1550	16.8	2547	355
BCS 18877	336	8.8	103	119
BCS 18878	2650	169.0	6270	1792
BCS 18879	111	4.7	223	76
BCS 18880	2850	285.1	2584	1698
BCS 18881	103	11.5	149	182
BCS 18882	25	3.9	72	52
BCS 18883	37	11.0	501	186
BCS 18884	4200	342.2	5384	2946
BCS 18885	1680	118.4	1650	2919
BCS 18886	195	6.7	258	183
BCS 18887	5	1.8	58	30
BCS 17734	7000	499.7	21383	11858
BCS 17735	285	32.6	528	260
BCS 17736	40	6.1	118	104
BCS 17737	5	1.4	64	28

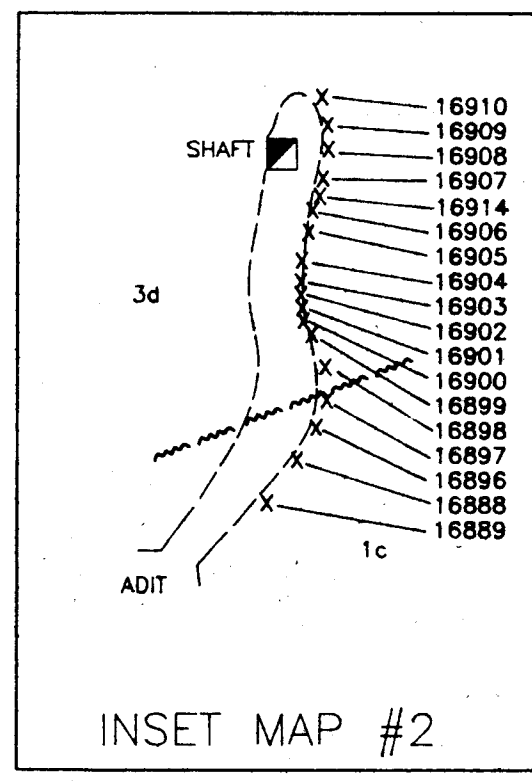
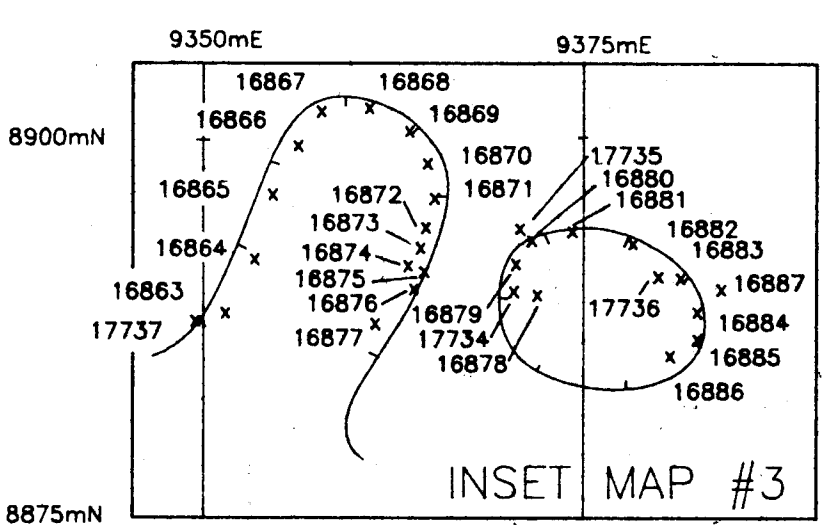

SAMPLE No.	Au ppb	Ag ppm	Zn ppm	Pb ppm
BCS 18888	2	3.8	41	14
BCS 18889	1	2.2	18	14
BCS 18890	6	2.2	20	11
BCS 18891	1900	17.1	1752	886
BCS 18892	59	1.4	38	40
BCS 18893	250	434.8	4087	5843
BCS 18894	580	6.1	101	108
BCS 18901	393	7.1	254	187
BCS 18902	148	2.3	78	37
BCS 18903	680	5.8	126	71
BCS 18904	21	1.7	66	27
BCS 18905	218	1.5	71	30
BCS 18906	518	13.5	515	172
BCS 18907	446	2.3	92	43
BCS 18908	708	11.8	402	320
BCS 18909	303	10.7	192	151
BCS 18910	37	1.8	35	33
BCS 18914	1	2.4	132	11

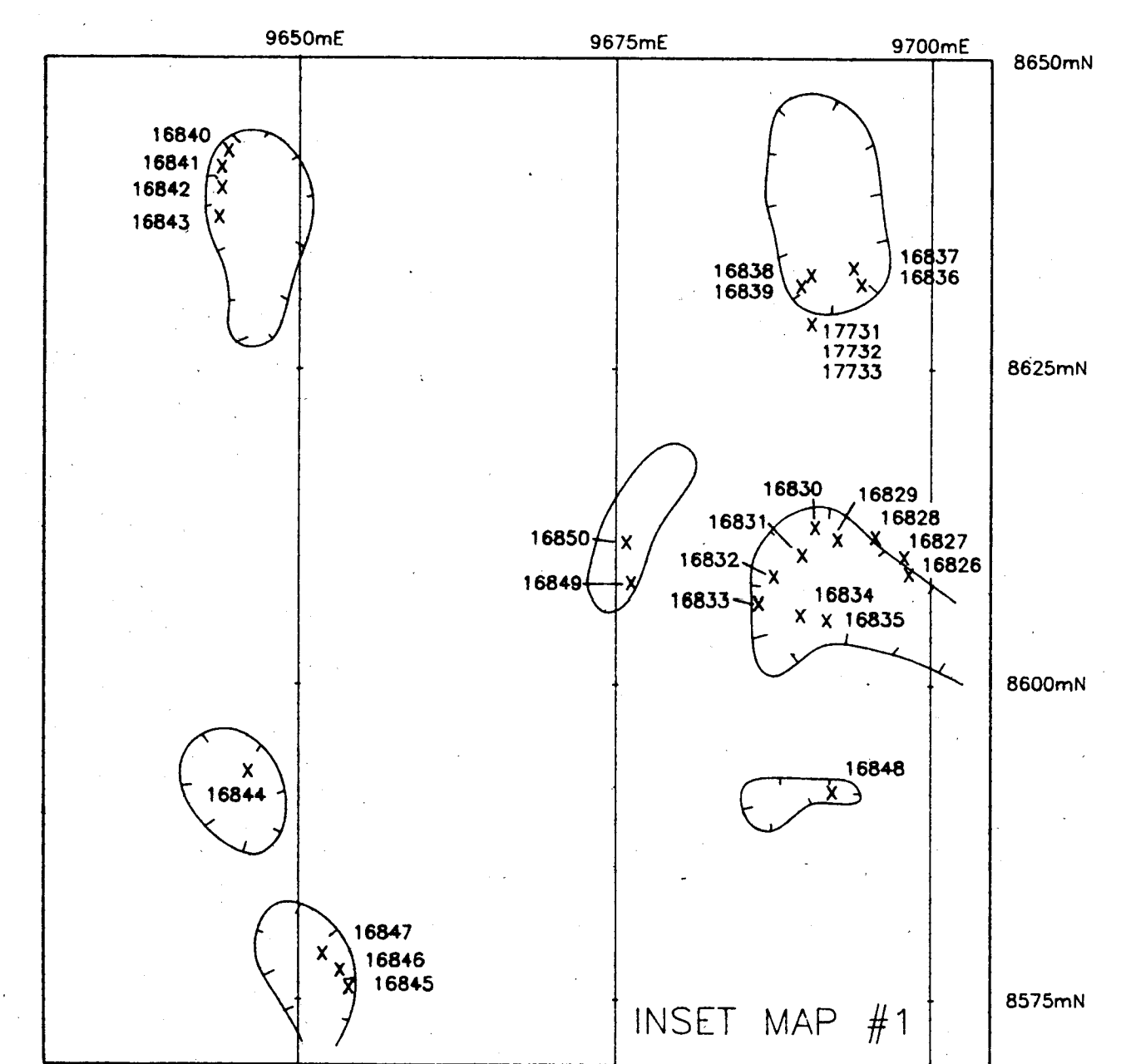
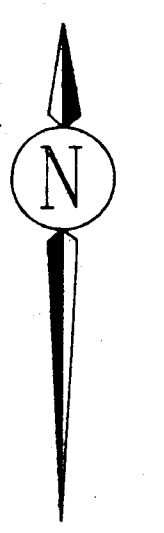
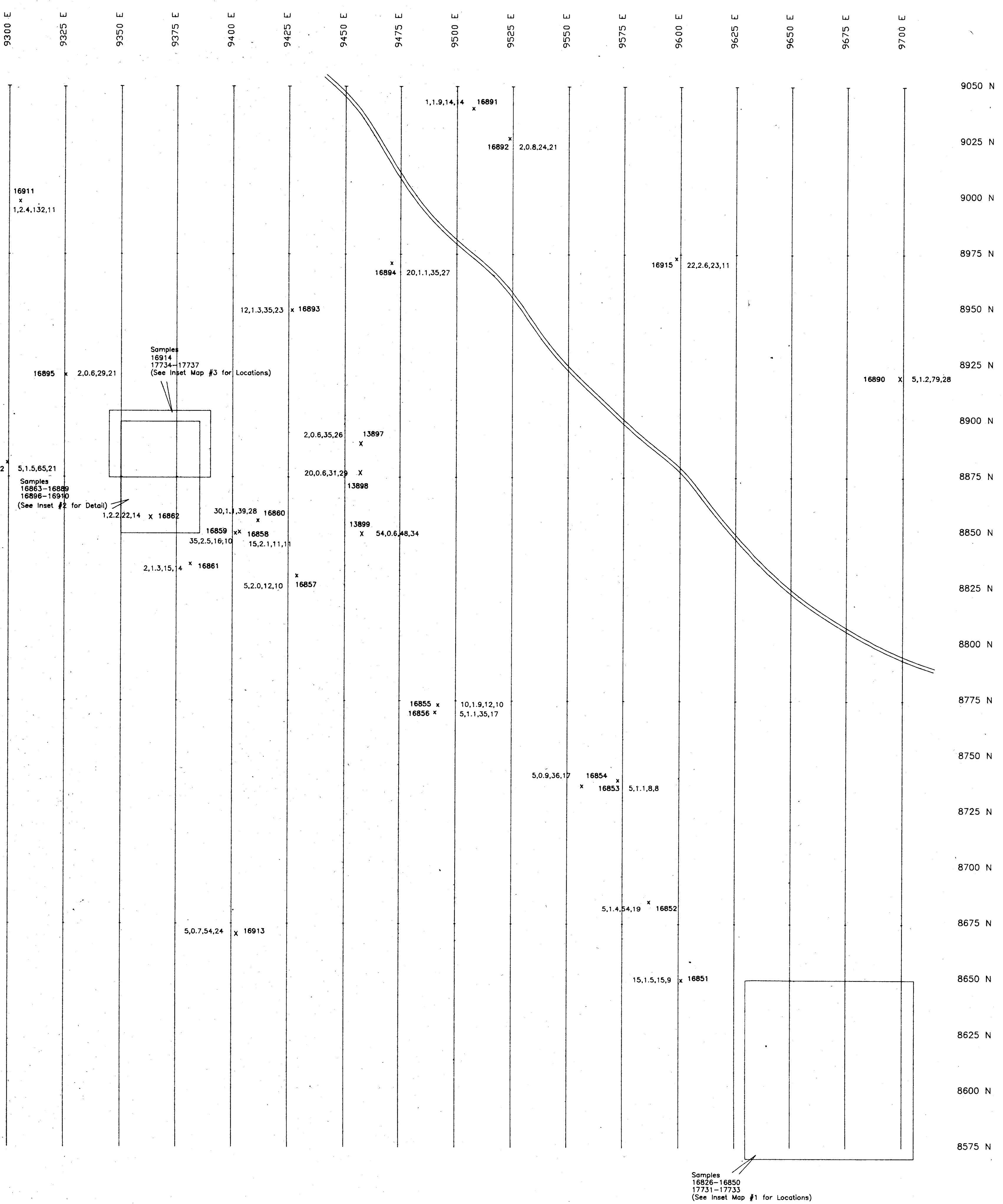

SAMPLE No.	Au ppb	Ag ppm	Zn ppm	Pb ppm
BCS 18856	5	1.6	38	10
BCS 18857	10	1.9	26	20
BCS 18858	5	1.7	50	10
BCS 18859	205	1.6	18	20
BCS 18860	120	0.9	3	15
BCS 18861	580	0.7	2	14
BCS 18862	55	1.9	15	10
BCS 18863	10	1.4	20	20
BCS 18864	15	1.5	16	14
BCS 18865	5	2.1	15	10
BCS 18866	5	2.6	34	9
BCS 18867	5	1.9	13	11
BCS 18868	5	1.8	13	11
BCS 18869	15	1.2	32	26
BCS 18870	30	1.2	45	28
BCS 18871	5	0.9	34	15
BCS 18872	405	1.3	8	10
BCS 18873	20	2.1	8	21
BCS 18874	5	2.0	73	9
BCS 18875	10	2.5	72	23
BCS 18876	10	2.2	60	84
BCS 18877	40	0.3	2	13
BCS 18878	185	1.2	46	21
BCS 18879	49	2.5	9	10
BCS 11731	726	0.1	5	8
BCS 11732	56	0.1	5	6
BCS 11733	4	1.3	5	15

SAMPLE No. X Au ppb, Ag ppm, Zn ppm, Pb ppm

GEOLOGICAL BRANCH
ASSESSMENT REPORT

20,536 Part 2
of 2

MINNOVA Inc.		MAP No.
RAINBOW DETAILED GRID		7
ROCK SAMPLE LOCATIONS & RESULTS		
(Au ppb, Ag ppm, Zn ppm, Pb ppm)		
Date: NOVEMBER 1990	FILE: MINNOVA.DWG	
Drawn by: LL/ag	Scale: 1 : 1000 (metres)	
Revised by:		

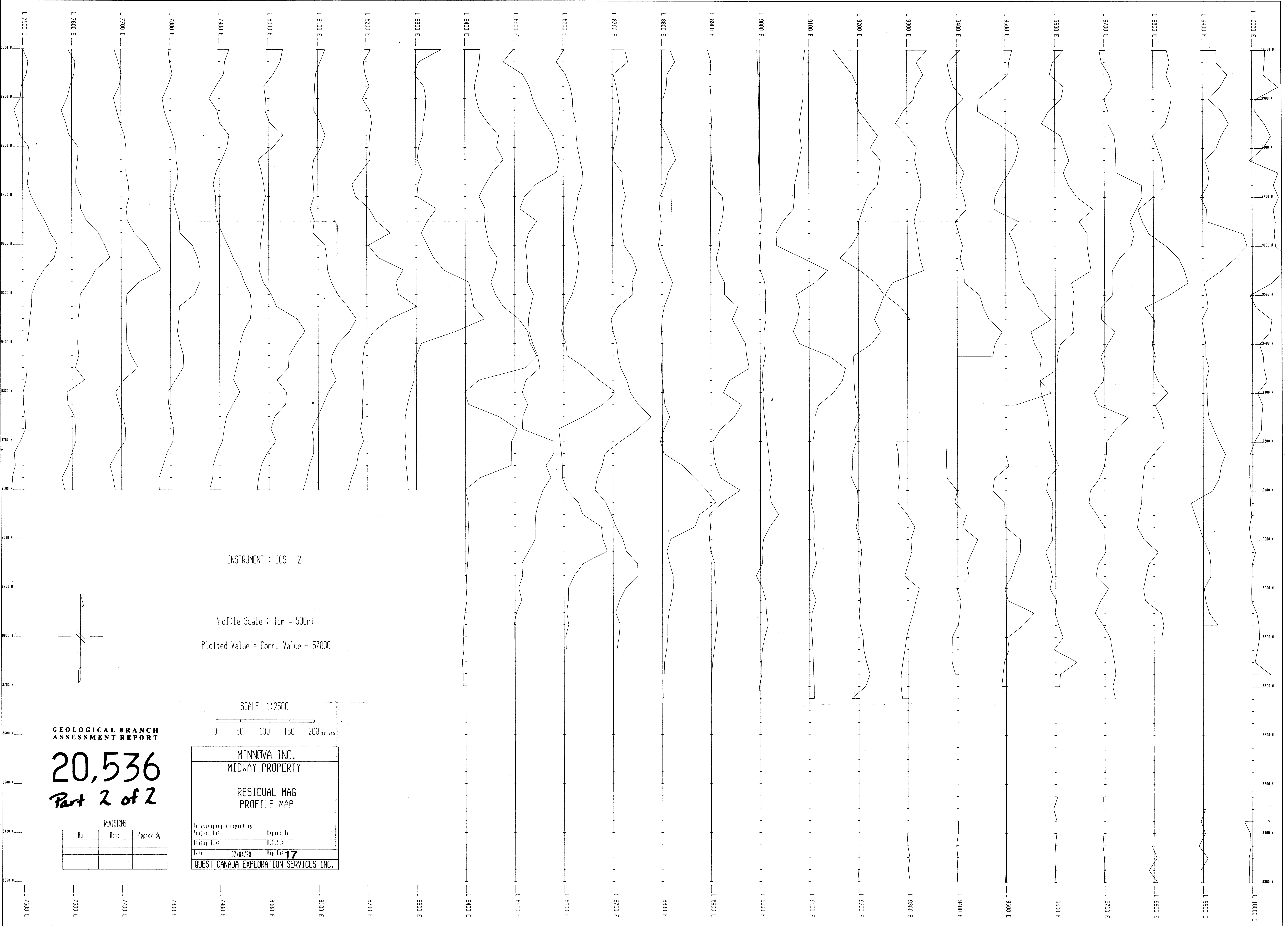

INSTRUMENT : IGS - 2

Profile Scale : 1cm = 500nt

Plotted Value = Corr. Value - 57000

SCALE 1:2500

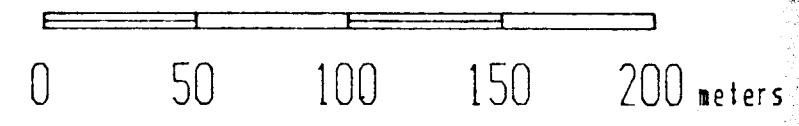

GEOLOGICAL BRANCH
ASSESSMENT REPORT

20,536
Part 2 of 2

REVISIONS

By	Date	Approv. By

MINNOVA INC. MIDWAY PROPERTY	
RESIDUAL MAG PROFILE MAP	
In accompany a report by	
Project No:	Report No:
Working No:	N.T.S.:
Date: 07/04/90	Map No: 17
QUEST CANADA EXPLORATION SERVICES INC.	

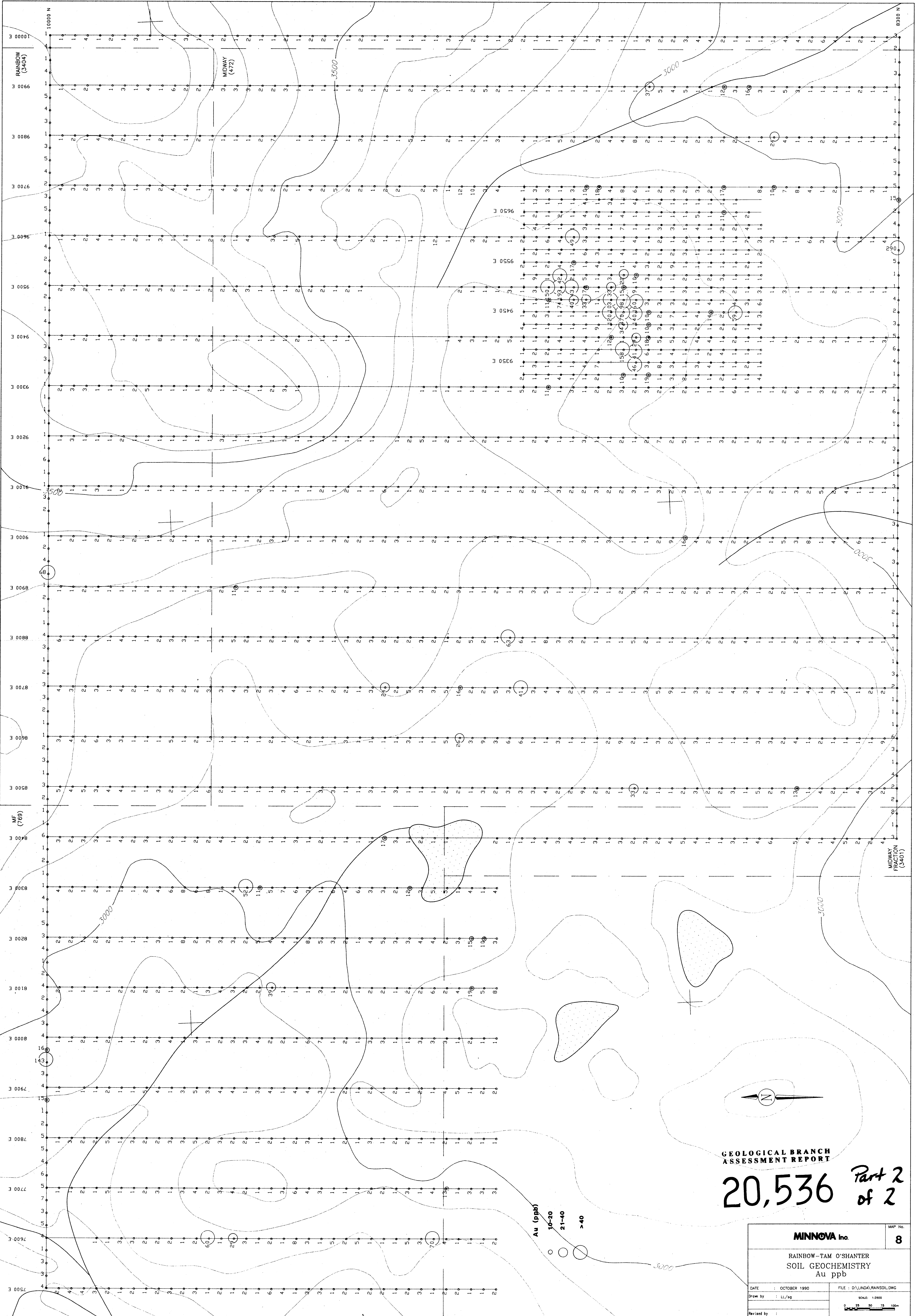

MINNOVA Inc.

RAINBOW-TAM O'SHANTER
SOIL GEOCHEMISTRY
Au ppb

20,536 Part 2 of 2

DATE : OCTOBER 1990	FILE : D:\LINDA\RAINSOIL.DWG
Drawn by : LL/sq	SCALE : 1:2500
Revised by :	0 25 50 75 100m

MAP No.
8

MIDWAY FRACTION (3401)

MF (769)

RAINBOW (3404)

MIDWAY (472)

Au (ppb)
10-20
21-40
>40



INSTRUMENT : IGS - 2

Contour Interval : 500nT

Plotted Value = Corr. Value - 57000

SCALE 1:2500

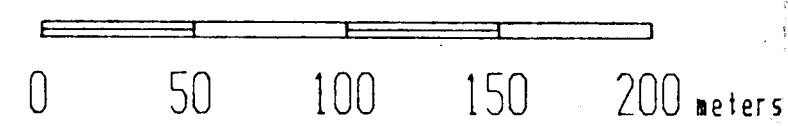

GEOLOGICAL BRANCH
ASSESSMENT REPORT

20,536
Part 2 of 2

REVISIONS

By	Date	Apprv. By

MINNOVA INC. MIDWAY PROPERTY	
RESIDUAL MAG CONTOUR MAP	
To accompany a report by	
Project No:	Report No:
Drawing No:	C.T.S.:
Date: 07/04/90	Map No: 16
QUEST CANADA EXPLORATION SERVICES INC.	

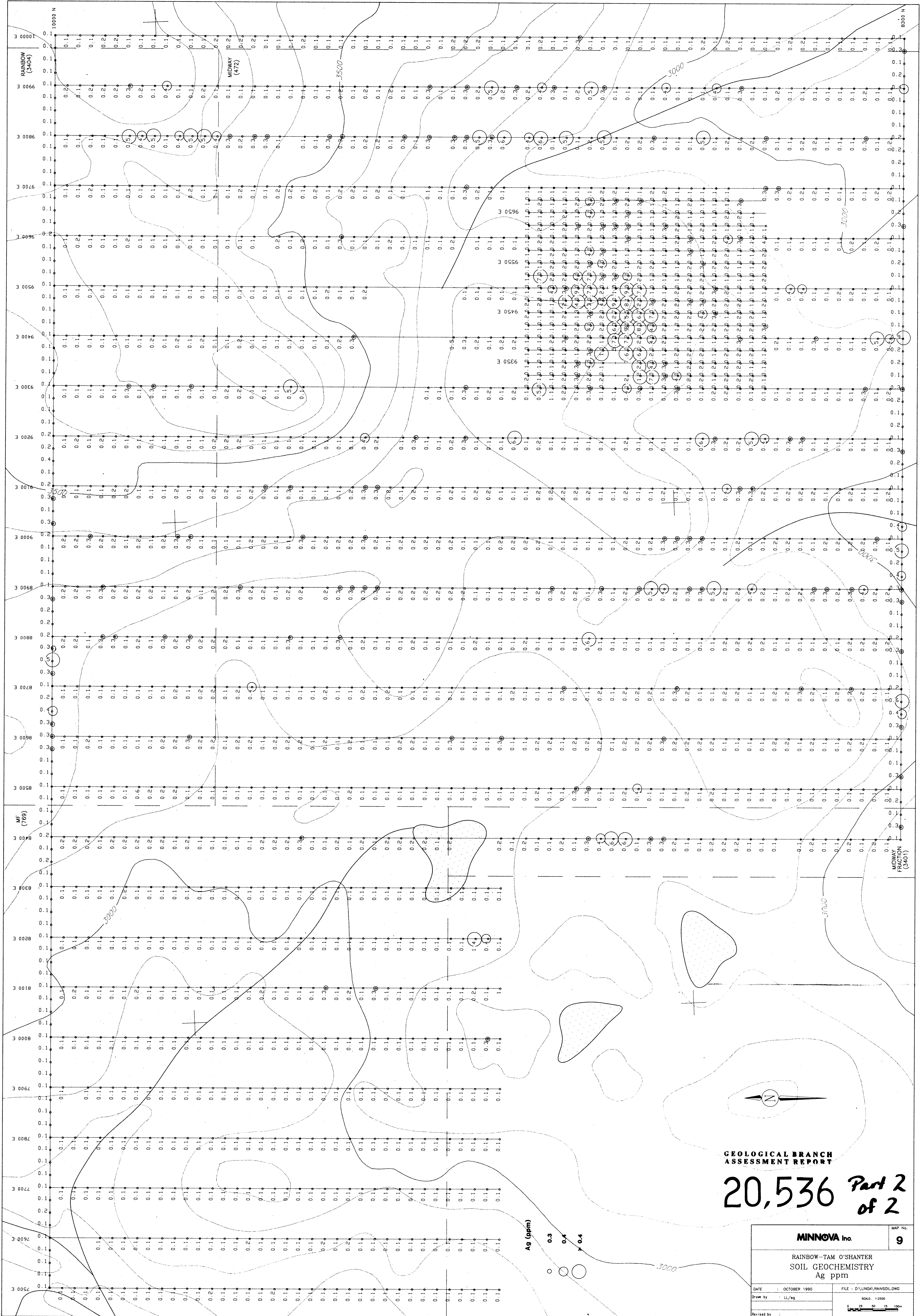

GEOLOGICAL BRANCH
ASSESSMENT REPORT

20,536 Part 2
of 2

MINNOVA Inc.		MAP No.
		9
RAINBOW-TAM O'SHANTER SOIL GEOCHEMISTRY Ag ppm		
DATE	OCTOBER 1990	
Drawn by	LL/sg	
Revised by		
SCALE: 1:2500		

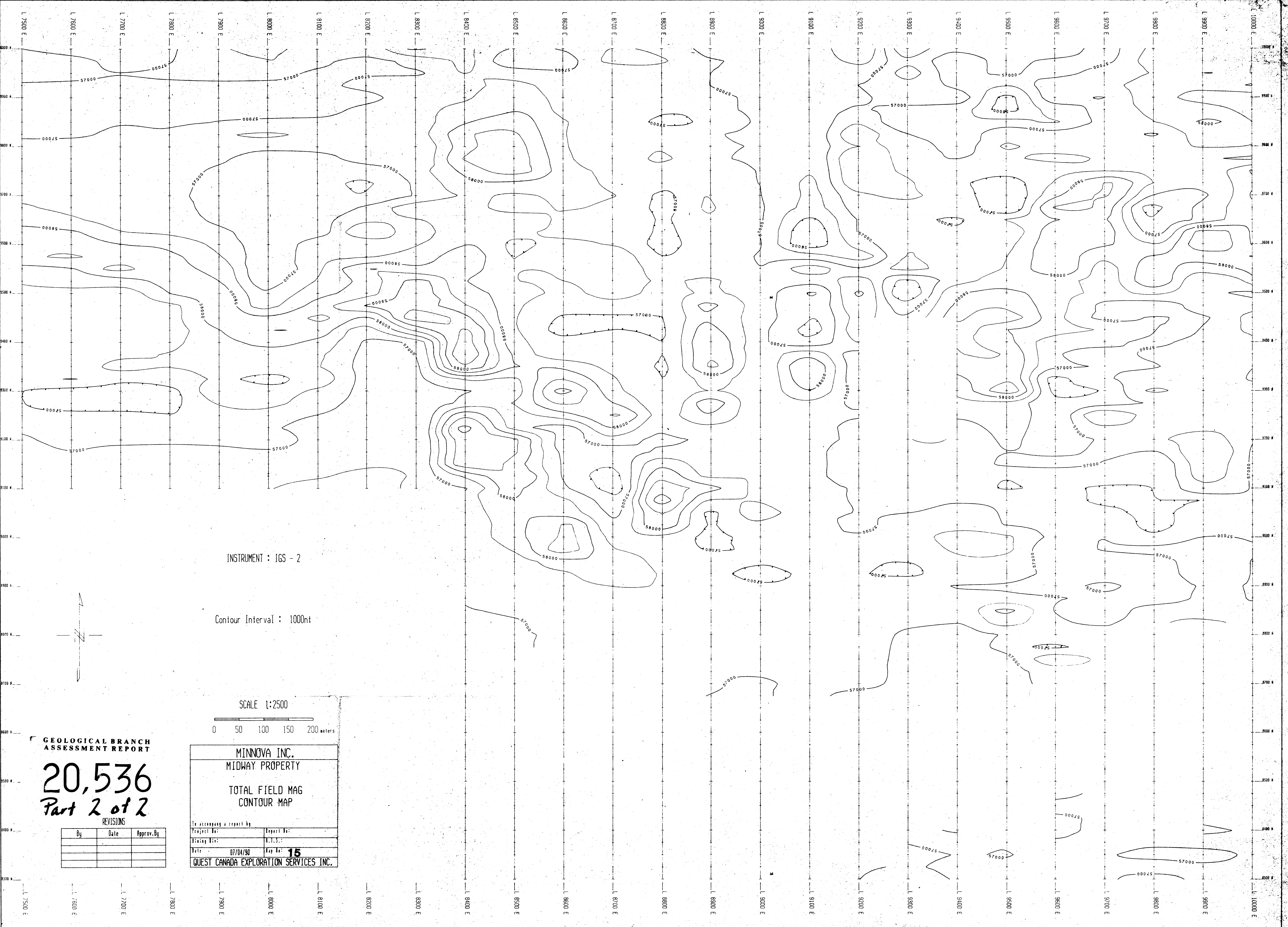

INSTRUMENT : IGS - 2

Contour Interval : 1000ft

SCALE 1:2500

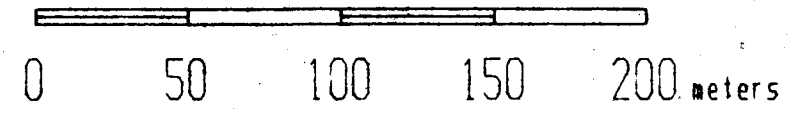

GEOLOGICAL BRANCH
ASSESSMENT REPORT

20,536
Part 2 of 2

REVISIONS

By	Date	Approv. By

MINNOVA INC. MIDWAY PROPERTY	
TOTAL FIELD MAG CONTOUR MAP	
In accompany a report by	
Project No:	Report No:
Drawing No:	D.S.S.:
Date: 07/04/90	Map No: 15
QUEST CANADA EXPLORATION SERVICES INC.	

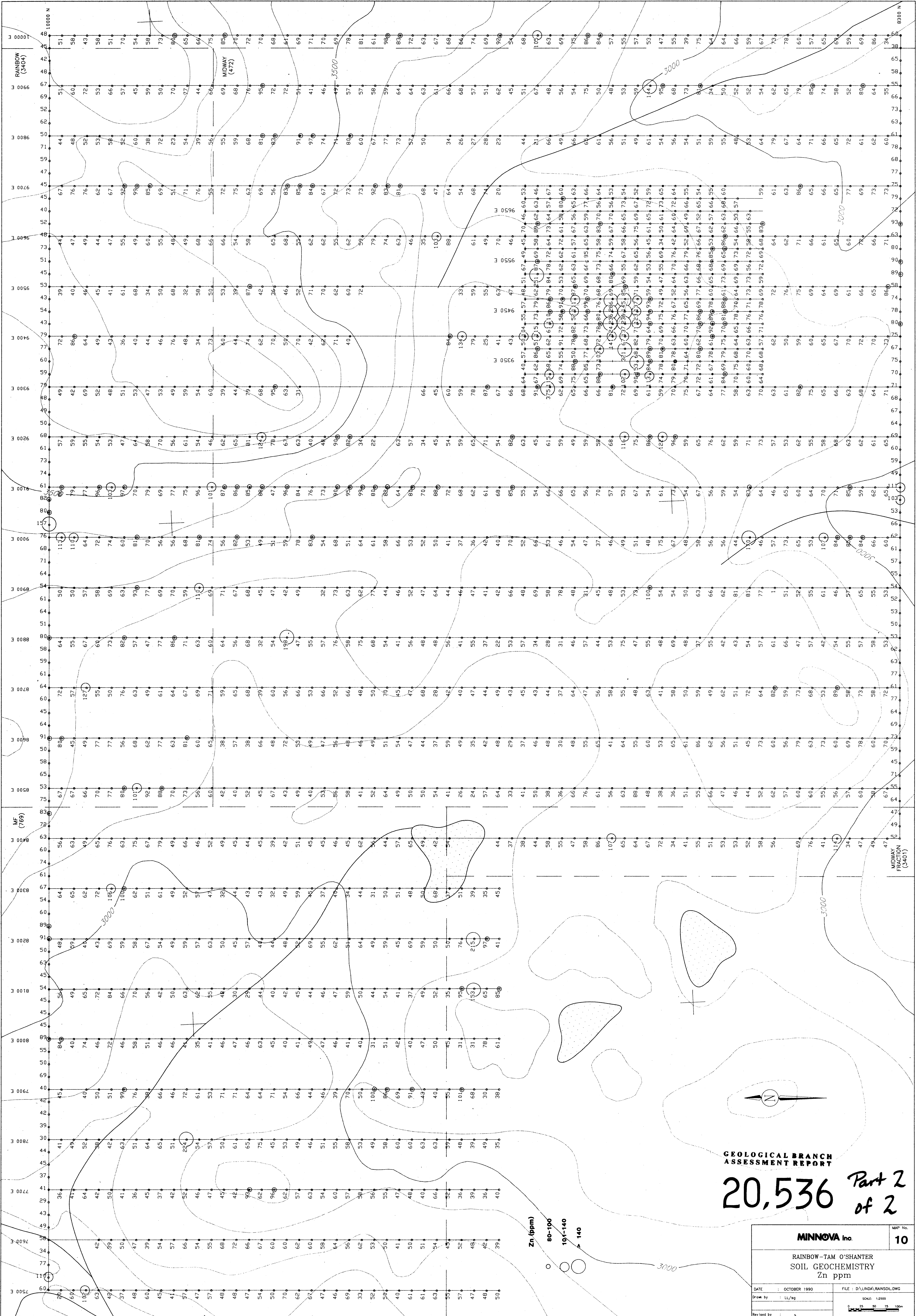

GEOLOGICAL BRANCH
ASSESSMENT REPORT

20,536 Part 2
of 2

Zn (ppm)
80-100
101-140
140

MINNOVA Inc.		MAP No.
RAINBOW-TAM O'SHANTER SOIL GEOCHEMISTRY Zn ppm		10
DATE	OCTOBER 1990	FILE : D:\LINDA\RAINSOIL.DWG
Drawn by	LL/sg	SCALE: 1:2500
Revised by		0 20 40 60 80 100

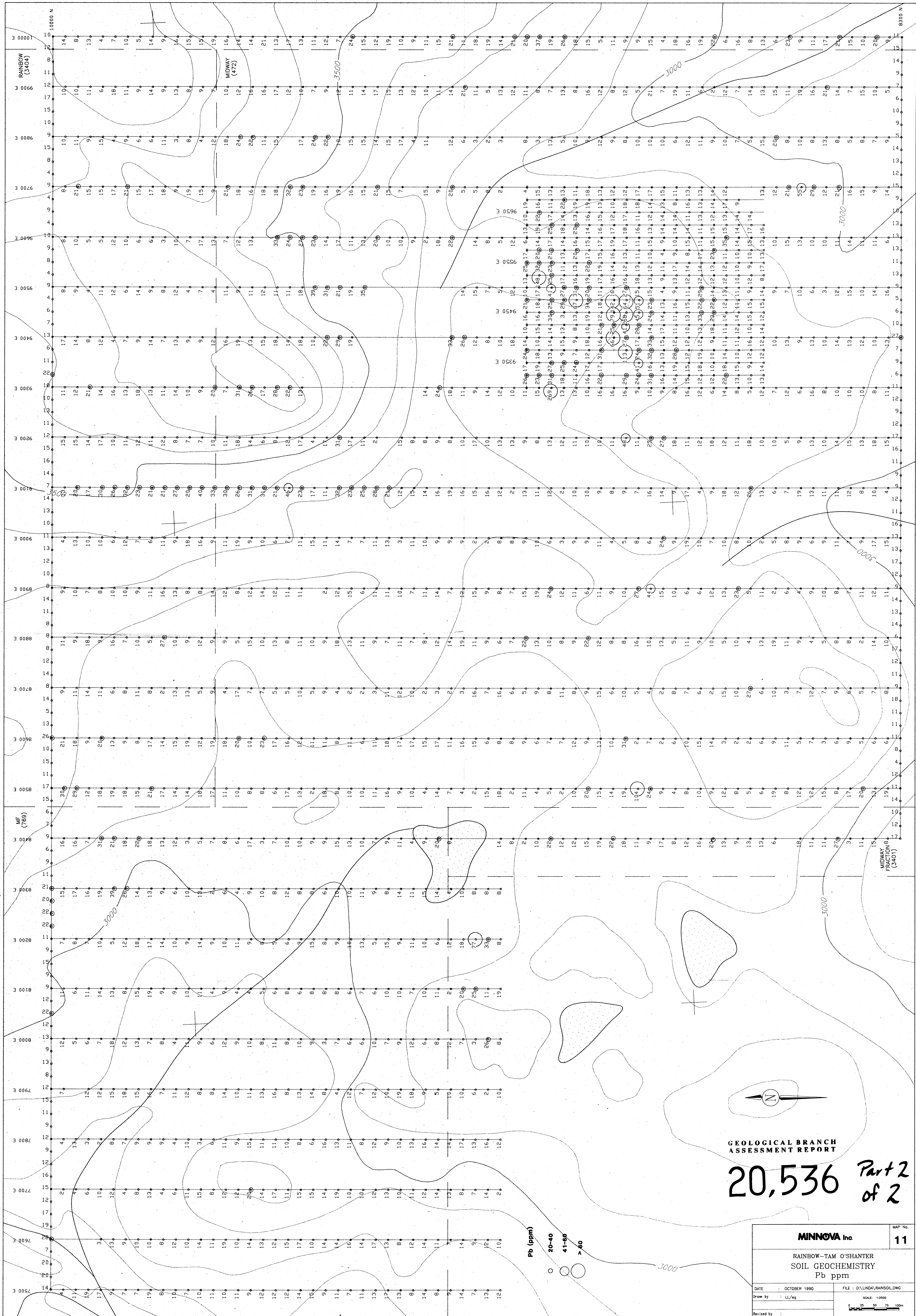

GEOLOGICAL BRANCH
ASSESSMENT REPORT

20,536 Part 2
of 2

Pb (ppm)
○ 20-40
○ 41-60
○ > 60

MINNOVA Inc.		MAP No.
RAINBOW-TAM O'SHANTER SOIL GEOCHEMISTRY Pb ppm		11
DATE : OCTOBER 1990	FILE : D:\LINDA\RAINBOW.DWG	
Drawn by : LL/ag	SCALE: 1:2000	
Revised by :		

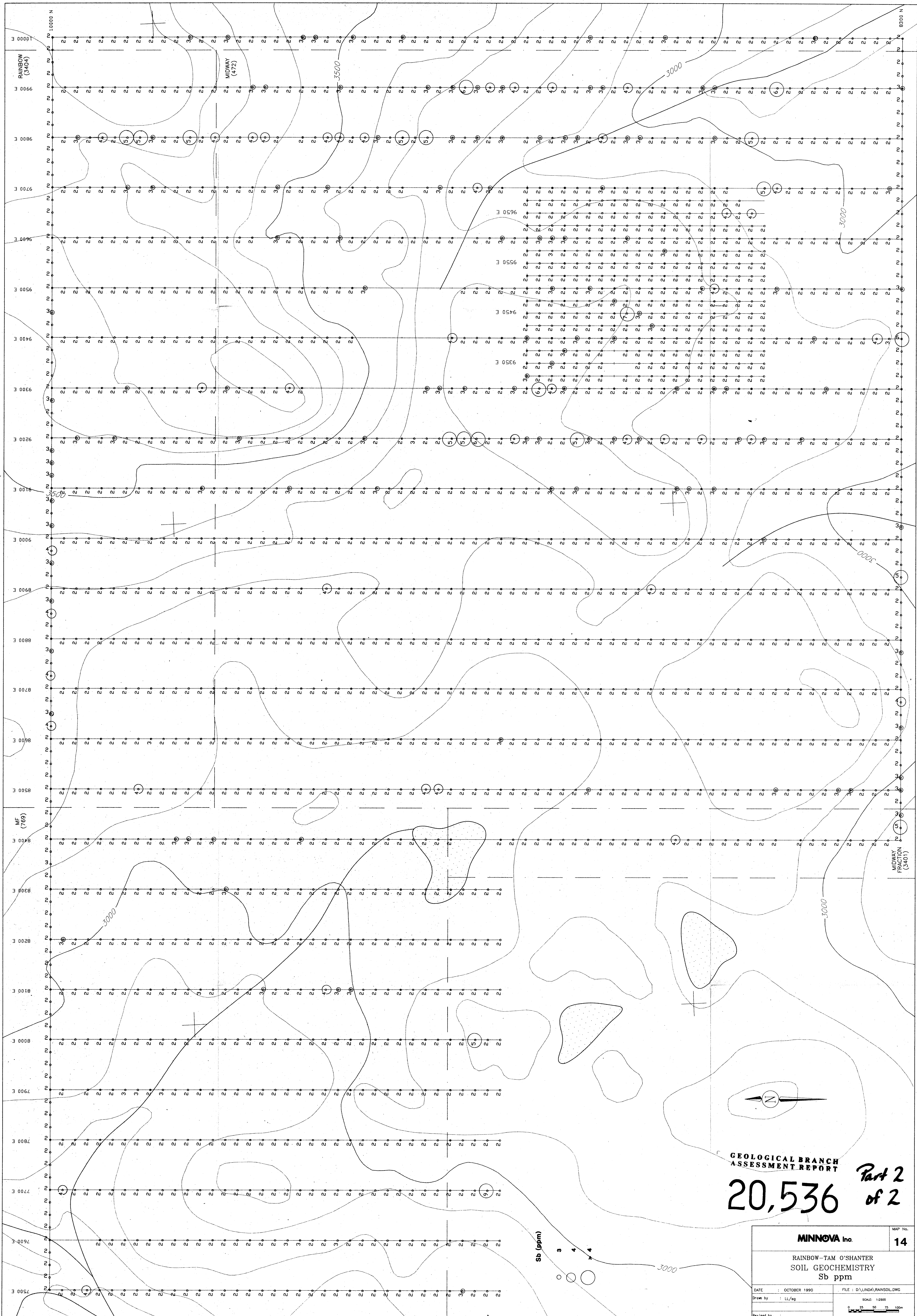

GEOLOGICAL BRANCH
ASSESSMENT REPORT

20,536 Part 2
of 2

MINNOVA Inc.		MAP No.
RAINBOW-TAM O'SHANTER SOIL GEOCHEMISTRY Sb ppm		14
DATE : OCTOBER 1990	FILE : D:\LINDA\RAINBOW.DWG	
Drawn by : LL/sg	SCALE : 1:2500	
Revised by :		

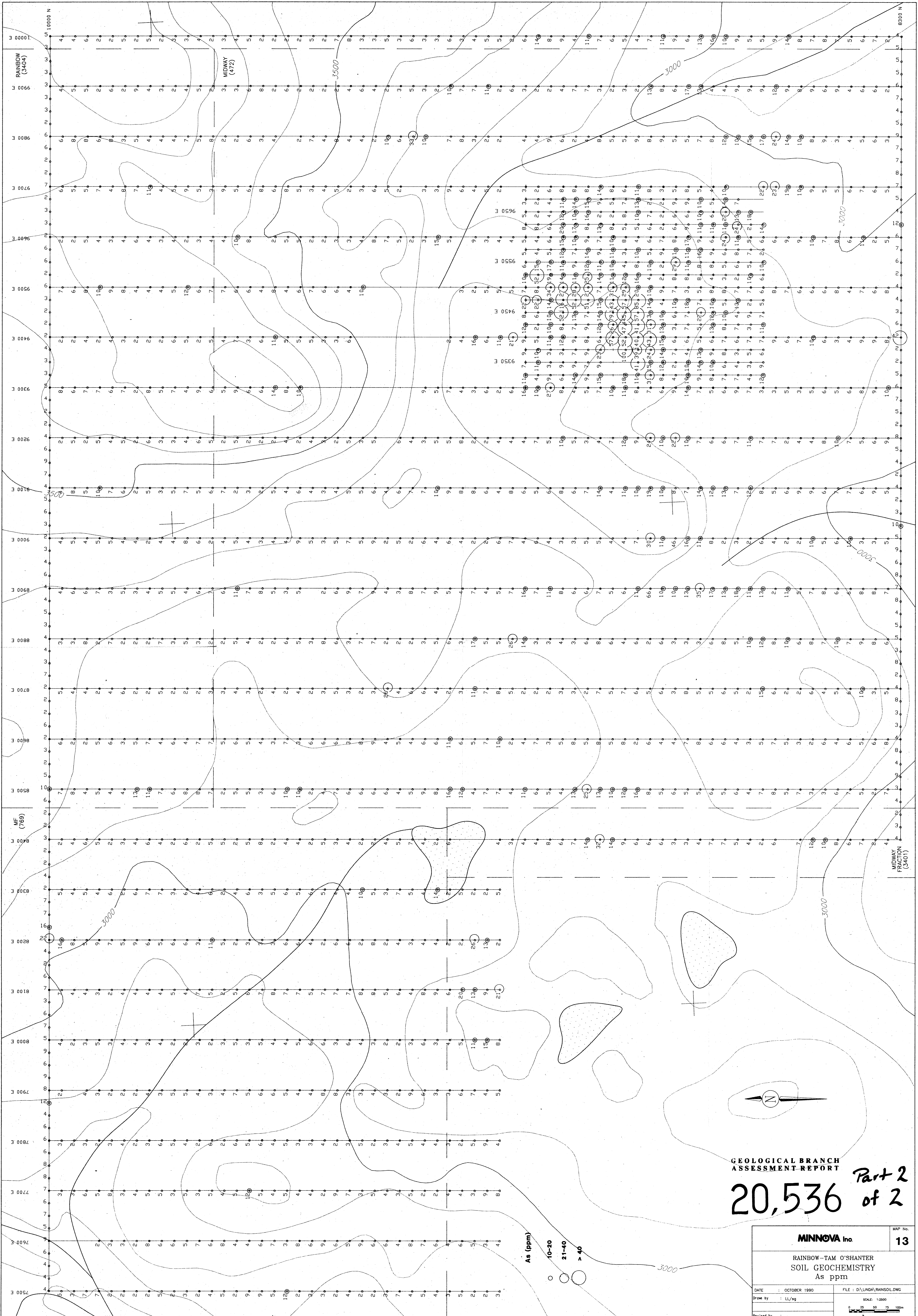

GEOLOGICAL BRANCH
ASSESSMENT REPORT

20,536 Part 2
of 2

As (ppm)

○ 10-20
○ 21-40
○ > 40

MINNOVA Inc.		MAP No.
		13
RAINBOW-TAM O'SHANTER SOIL GEOCHEMISTRY As ppm		
DATE : OCTOBER 1990	FILE : D:\LINDA\RAINSOL.DWG	
Drawn by : LL/sg	SCALE: 1:2500	
Revised by :		

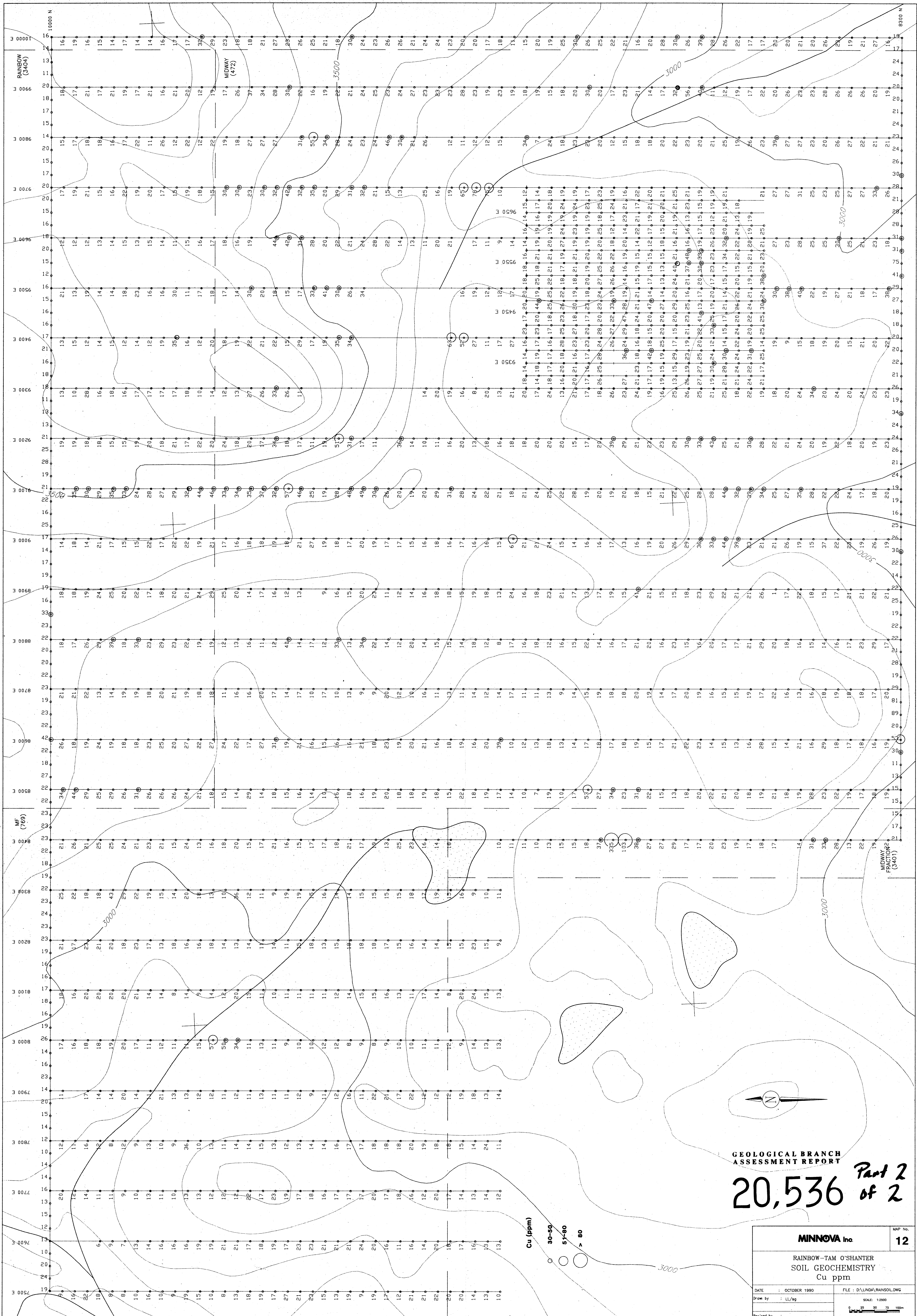

GEOLOGICAL BRANCH
ASSESSMENT REPORT

20,536 *Part 2*
of 2

MINNOVA Inc		MAP No.
RAINBOW-TAM O'SHANTER SOIL GEOCHEMISTRY Cu ppm		12
DATE : OCTOBER 1990	FILE : D:\LINDA\RAINSOL.DWG	
Drawn by : LL/sg	SCALE: 1:2500	
Revised by :	0 25 50 75 100m	