

LOG NO: 12-04	RD.
ACTION:	
FILE NO:	

NTS 82E/6E
 Lat 49°20'N
 Long 119°03'W

GEOLOGICAL REPORT
 on the
CASCADE CORAL PROPERTY
 Greenwood Mining Division, B.C.

SR-RECORDER
 RECEIVED
 NOV 28 1990
 M.R. # _____
 VANCOUVER, B.C.

for
1885 Holdings Ltd
 1030 - 885 W. Pender St
 Vancouver, B.C. V6C 2V6
 Tel: (604) 688-4850 Fax: 688-5175
GEOLOGICAL BRANCH
ASSESSMENT REPORT

20,569
 by

Roger Kidlark, B.Sc., F.G.A.C.

RELIANCE GEOLOGICAL SERVICES INC.
 241 East 1st Street
 North Vancouver, B.C. V7L 1B4
 Tel: (604) 984-3663
 Fax: (604) 988-4653

22 November 1990

1. INTRODUCTION

This report was prepared at the request of 1885 Holdings Ltd to describe and evaluate the results of a geological mapping program carried out by Reliance Geological Services Inc on September 21, 22, and 28, 1989 on the Cascade Coral Property in south-central British Columbia.

2. LOCATION, ACCESS and PHYSIOGRAPHY

The Cascade Coral Property is situated in the Greenwood Mining Division, approximately 14 kilometers south of Beaverdell and 52 kilometers north of Rock Creek, B.C. (Fig. 1)

The claims are located on Map Sheet NTS 82E/6E at latitude 49°20'North and 119°03'West. UTM limits are UTM 546600 m and 5468500 m north and UTM 352000 and 350000 m east.

Two wheel drive vehicles can access the property by using paved Highway 33 which crosses the southeastern corner of the property.

Elevations range from 2390 ft (729 m) along Highway 33 to 3900 ft (1190 m) at the northern claim boundary. Slopes are moderate to steep and stepped up towards the northwest.

1885 HOLDINGS LTD.
 CASCADE CORAL PROPERTY
 Greenwood Mining Division
LOCATION MAP
 British Columbia
 NTS: 82 E/6E
 OCTOBER 1990 FIGURE: 1
 RELIANCE GEOLOGICAL SERVICES INC.

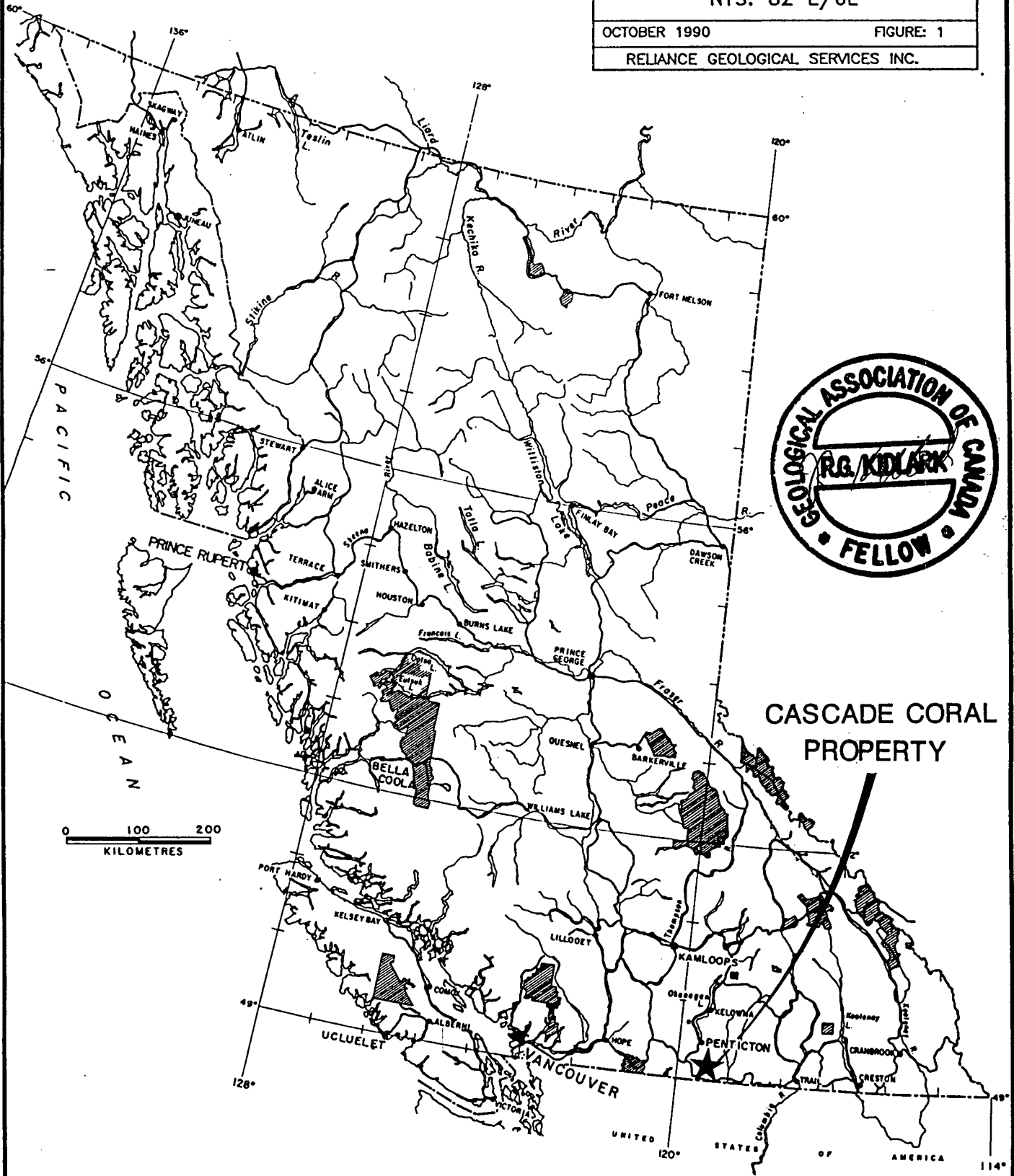

CASCADE CORAL PROPERTY

3. PROPERTY STATUS

The property consists of nine contiguous two-post mineral claims (Fig.2) in the Greenwood Mining Division. The claims are 100% owned by 1885 Holdings Ltd, 1030 - 800 W. Pender St, Vancouver, B.C.

Details of the claims are as follows:

<u>Claim</u>	<u>Record #</u>	<u>Units</u>	<u>Record Date</u>	<u>Expiry Date</u>
Hawk 1	5582	1	19 Sep 1989	19 Sep 1993
Hawk 2	5583	1	19 Sep 1989	19 Sep 1993
Hawk 3	5584	1	20 Sep 1989	19 Sep 1993
Hawk 4	5585	1	20 Sep 1989	20 Sep 1993
Bear	5579	1	17 Sep 1989	17 Sep 1993
Elk 1	5580	1	18 Sep 1989	18 Sep 1993
Elk 2	5581	1	18 Sep 1989	18 Sep 1993
Moose	5578	1	16 Sep 1989	16 Sep 1993
Beaver	5557	1	1 Sep 1989	1 Sep 1993

The total area covered by the claims is 213 hectares, or 526 acres, after correcting for overlap.

4. PROPERTY HISTORY

The Beaverdell Granite Quarry was operated in the 1960's by Continental Granite and Marble Ltd (Smith, 1965). It is reported that granite from the quarry was crushed, sized, and transported to Vancouver for use as facing material in building blocks.

During 1985/1986, the Geotechnical and Materials Branch of the B.C. Ministry of Transportation and Highways carried out a physical dimension test on the abandoned quarry face. Their results are reported as follows:

Specific Gravity	2.61
Density - lb/ft ³	162.63
- kg/m ³	2605
Absorption by weight (%)	0.50
Compressive Strength - PSI	8110 - 9543
- MPa	55.92 - 65.80
Traverse Strength - PSI	1151 - 1460
(Modulus of Rupture) - MPa	7.94 - 10.07

In September of 1989, the property was staked for 1885 Holdings Ltd.



119° 05'

119° 01'

49° 22'

CASCADE CORAL PROPERTY

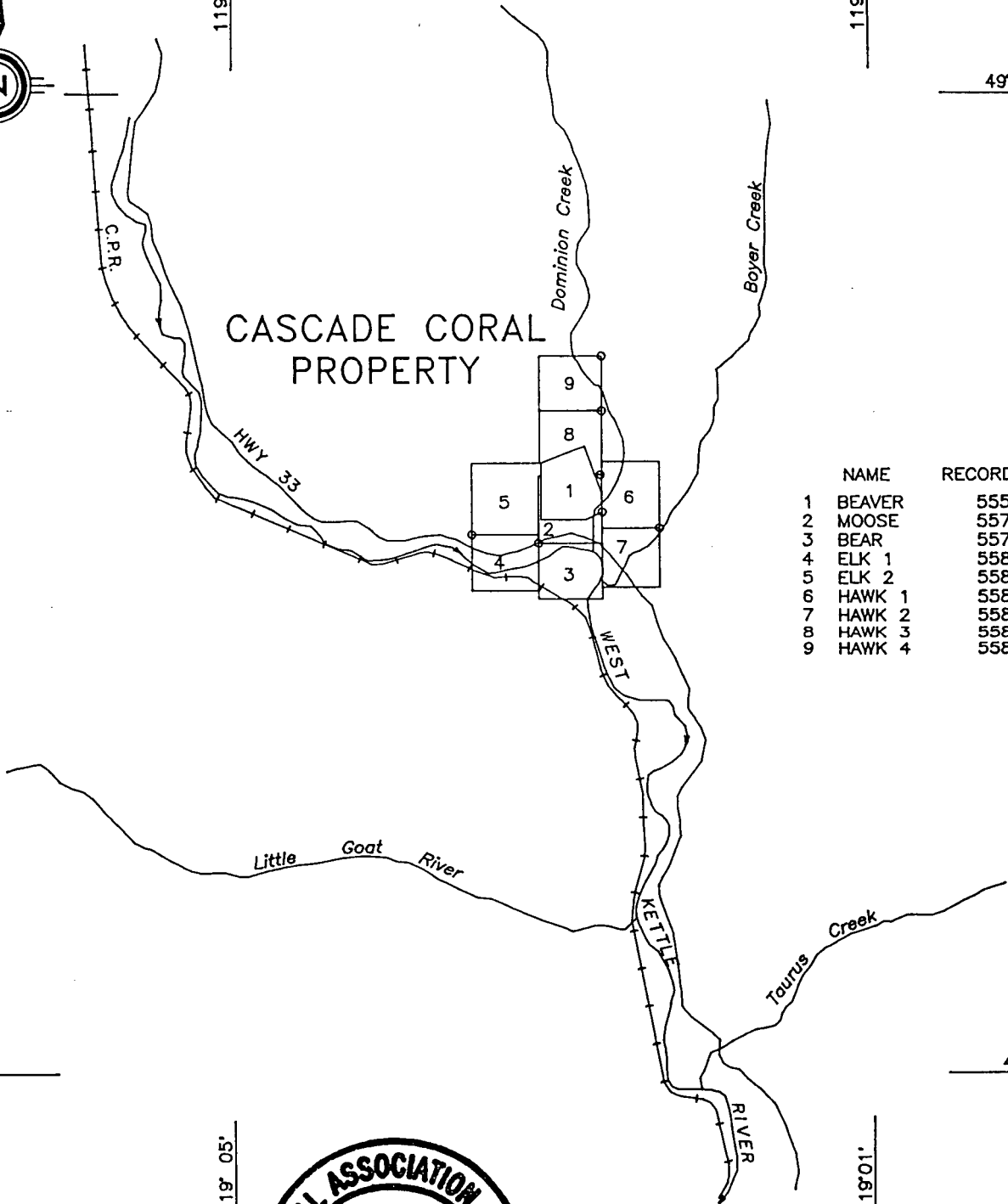

NAME	RECORD No.
1 BEAVER	5557
2 MOOSE	5578
3 BEAR	5579
4 ELK 1	5580
5 ELK 2	5581
6 HAWK 1	5582
7 HAWK 2	5583
8 HAWK 3	5584
9 HAWK 4	5585

49°18'

49°18'

119° 05'

119° 01'

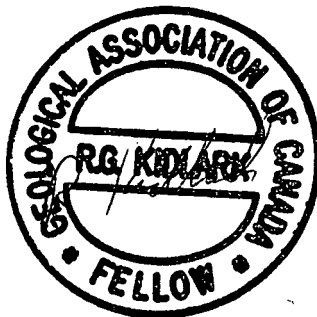

1885 HOLDINGS LTD.	
CASCADE CORAL PROPERTY Greenwood Mining Division	
CLAIM MAP British Columbia NTS: 82 E/6E	
OCTOBER 1990	FIGURE: 2
RELIANCE GEOLOGICAL SERVICES INC.	

5.0 1990 PROGRAM

5.1 Scope and Purpose

During September 1989, two geologists completed a program of geological mapping, grid layout and slope determination on the south central area of the subject property.

The purpose of the program was to geologically map the lithology and structure in order to evaluate the granite quarry potential.

5.2 Methods and Procedures

Using a compass and hipchain, a flagged grid was laid out over the southern portion of the Beaver claim. The entire gridded area was geologically mapped. Line intervals were at 30 meter spacings, with a total of 1.75 line kilometers being laid out. A clinometer was used to note slope changes along lines.

6. RESULTS

The property is underlain by the granite member of the Mesozoic Valhalla intrusive complex.

The granite has a speckled appearance, a porphyritic texture, and is coarse-grained. Rectangular phenocrysts of pink orthoclase feldspar measure up to 3.5 cm by 6 cm. Other mineral constituents include plagioclase, quartz, biotite, and minor hornblende.

Along the southern side of the property, the granite is crosscut by a northeast striking biotite-feldspar porphyry dyke ranging from 5 to 10 meters in width.

Three sets of joints are well developed:

J1 joints are horizontal, strike north, and dip 25° to 50° east;

J2 joints strike from 25° to 40°, and dip 50° to 75° northwest;

J3 joints strike from 110° to 150°, and dip steeply to vertically northwest.

Based on texture and joint density, the granite has been subdivided into three units:

a) NQ unit: (non-quarriable)

Covers approximately 50% of the gridded area.

Joint density is irregular, variable, and averages 1 per 30 cm. The granite has a bleached appearance. A crude foliation is locally developed.

b) PQ unit: (possibly quarriable)

Covers approximately 25% of the gridded area.

Joint density averages 1 per 1.5 meters. Locally, joints are irregularly spaced.

c) QR unit: (Cascade Coral Unit - quarriable)

Covers approximately 25% of the gridded area.

Joint spacing is regular, with joint density averaging 1 per 2.0 meters. The porphyritic granite is a light pink color, and has a fresh appearance. The average modal composition is:

Quartz	15%
Orthoclase	55%
Plagioclase	20%
Biotite plus Hornblende	10%

7. CONCLUSIONS

As there is good access (paved highway) to the property,
and
as joint density in the PQ and QR units can be classified as
favorable (using a minimum standard of 1 joint per 1.5 meters),
and
as the texture of the porphyritic granite in the QR unit and some
of the PQ unit can be classified as acceptable,
and
as the rock classified as PQ and QR covered approximately 50% of
the area studied,

the author concludes that the Cascade Coral Property has
granistone quarry potential.

CERTIFICATE

I, ROGER G. KIDLARK, of 303 - 9110 Halston Court, Burnaby, B.C., do hereby certify that:

1. I am a graduate of the University of Toronto with a Bachelor of Science Degree in Geology, 1974.
2. I am a Fellow in good standing with the Geological Association of Canada.
3. I have practised my profession as a geologist for fourteen years in British Columbia, Ontario, Nova Scotia, the Yukon and Northwest Territories, and Montana.
4. The information, opinions and recommendations in this report are based on fieldwork carried out under my direction and on published and unpublished literature. I was present on the subject property during 1990.
5. I have no interest, direct or indirect, in the subject claims or the securities of 1885 Holdings Ltd.
6. I consent to the use of this report in a Prospectus or Statement of Material Facts for the purpose of private or public financing.

RELIANCE GEOLOGICAL SERVICES INC.

Roger G. KIDLARK, F.G.A.C.

Dated at North Vancouver, this 22nd day of November 1990.



REFERENCES

- White, G.V. (1986):
Dimension Stone Quarries in B.C.
B.C. Ministry of Energy, Mines, and Petroleum Resources,
Exploration in B.C. 1985, Part B.
- White, G.V. (1987):
Dimension Stone Quarries in B.C.
B.C. Ministry of Energy, Mines, and Petroleum Resources,
Geological Fieldwork, 1986, Paper 1987 - 1.

ITEMIZED COST STATEMENT

CASCADE CORAL PROPERTY

Project preparation		\$	50.
Mobilization and demobilization (includes freight, transportation, wages)		\$	650.
Field Crew:			
Project Geologist \$325/day x 2 days (R. Kidlark - Sep 21, 22/89)	\$ 650.		
Project Geologist \$400/day x 1 day (D. Innes - Sep 28/89)	\$ <u>400.</u>	\$	1,050.
Field Costs:			
Food & Accommodation \$ 70/day x 3 mandays	\$ 210.		
Supplies	\$ 50.		
Vehicles \$110/day x 3 days	\$ <u>330.</u>	\$	590.
Report:			
Drafting and map preparation	\$ 250.		
Report writing and editing	\$ 650.		
Word processing, copying, binding	\$ <u>150.</u>	\$	<u>1,050.</u>
Sub-total		\$	3,390.
Administration, incl overhead and profit		\$	<u>339.</u>
TOTAL		\$	<u>3,729.</u>



GEOLOGICAL BRANCH
ASSESSMENT REPORT

20,569

MOOSE #1 POST BEAR #1 POST BEAVER #1 POST
HAWK #1 POST HAWK #2 #1 POST

LEGEND:

- PORPHYRITIC MAFIC DYKE
- PORPHYRITIC GRANITE
- NQ HIGHLY QUARRIABLE ROCK
HIGHLY FRACTURED AND LIMITED
- PQ POSSIBLE TO GET SOME QUARRIABLE ROCK
FRACTURED AND LIMITED AT 1-1.5 METRE INTERVALS
- QR SOME QUARRY ROCK - CASCADE LOCAL UNIT
- CLAIM POST
- STRIKE AND DIP OF FAULTS (INCLINED, VERTICAL)
- ROCK BLUFF WITH HEIGHT
- FELDSPAR PORPHYRY DYKE
- (1:2.0) FAULT TENDENCY NUMBER
- HOVB HEAVY OVERBURDEN (>2.4m)
- MOVB MODERATE OVERBURDEN (1.0 to 2.4m)
- LOVB LIGHT OVERBURDEN (<1.0m)

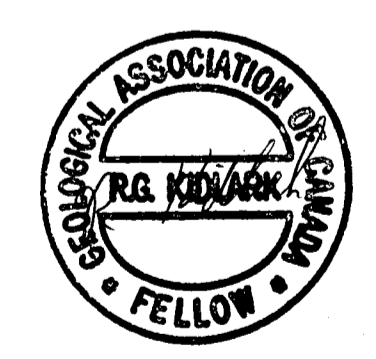

1885 HOLDINGS LTD.
CASCADE CORAL PROPERTY
GREENWICH MINING DIVISION LTD. NO. 82 E.P.R.

GEOLOGY OF QUARRY SITE

SCALE 1:1000

DATE: OCTOBER, 1990 FIGURE NO. 2

RELIANCE GEOLOGICAL SERVICES LTD.

