

NOTE: ALL HOLES PROJECTED TO LEVEL 2000m.

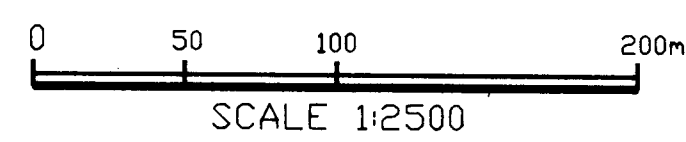

BOND GOLD CANADA INC
RED MOUNTAIN PROJECT - B.C.
MARC ZONE
DRILL HOLE LOCATION
PLAN MAP
DECEMBER 06, 1990. 1:2500

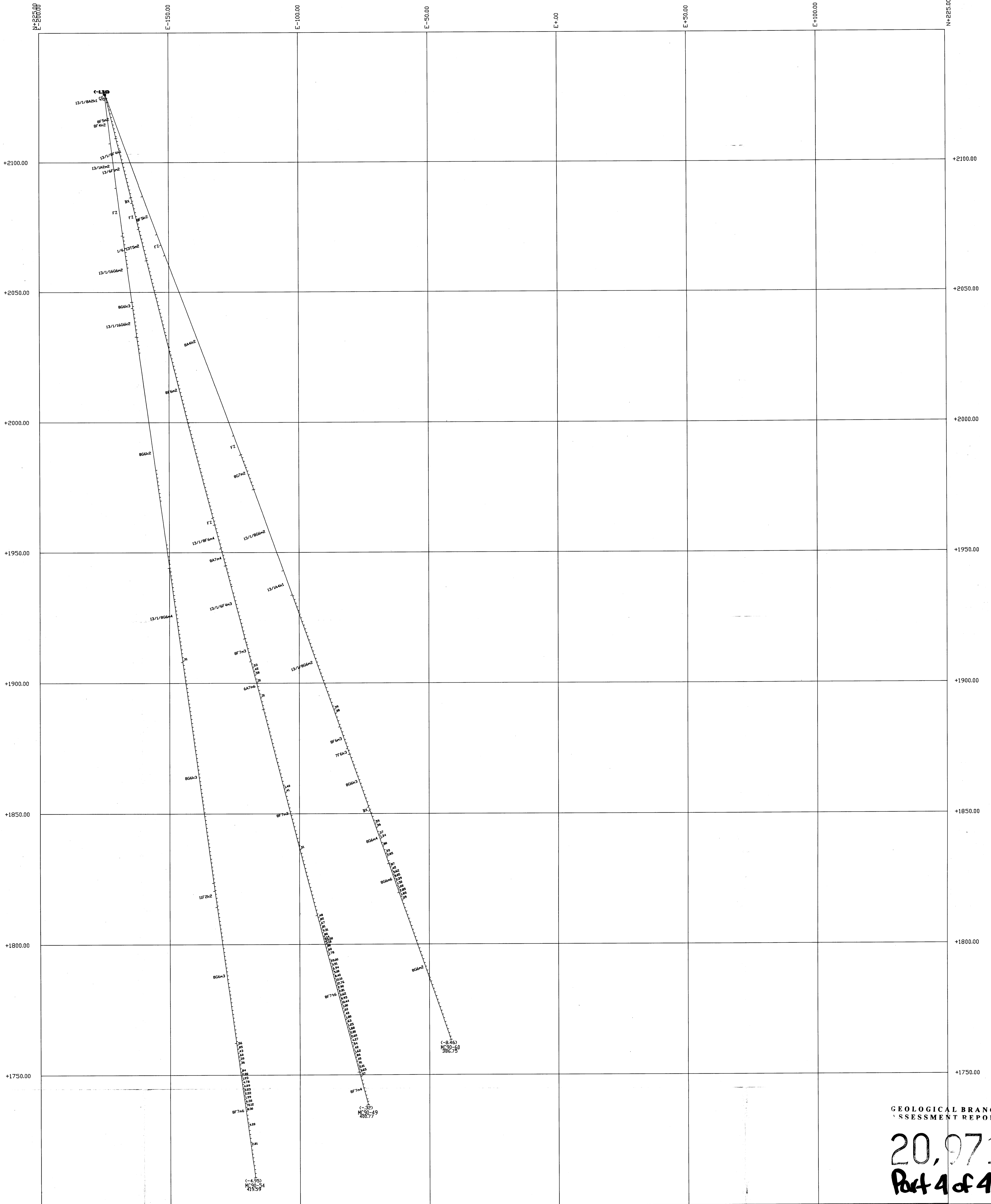

SECTION VIEW

GEOLOGICAL BRANCH
ASSESSMENT REPORT

20,971
Part 4 of 4

| | | | |
|-----------|------------|----------|---|
| | DRAWN BY | DATE | BOND GOLD CANADA INC. RED MOUNTAIN PROJECT MARC ZONE SECTION 225 N |
| | G.S.M. | 02/15/91 | |
| | REVISED BY | DATE | |
| | | | |
| | Scale - | 1:500 | |
| FIGURE 07 | | | |

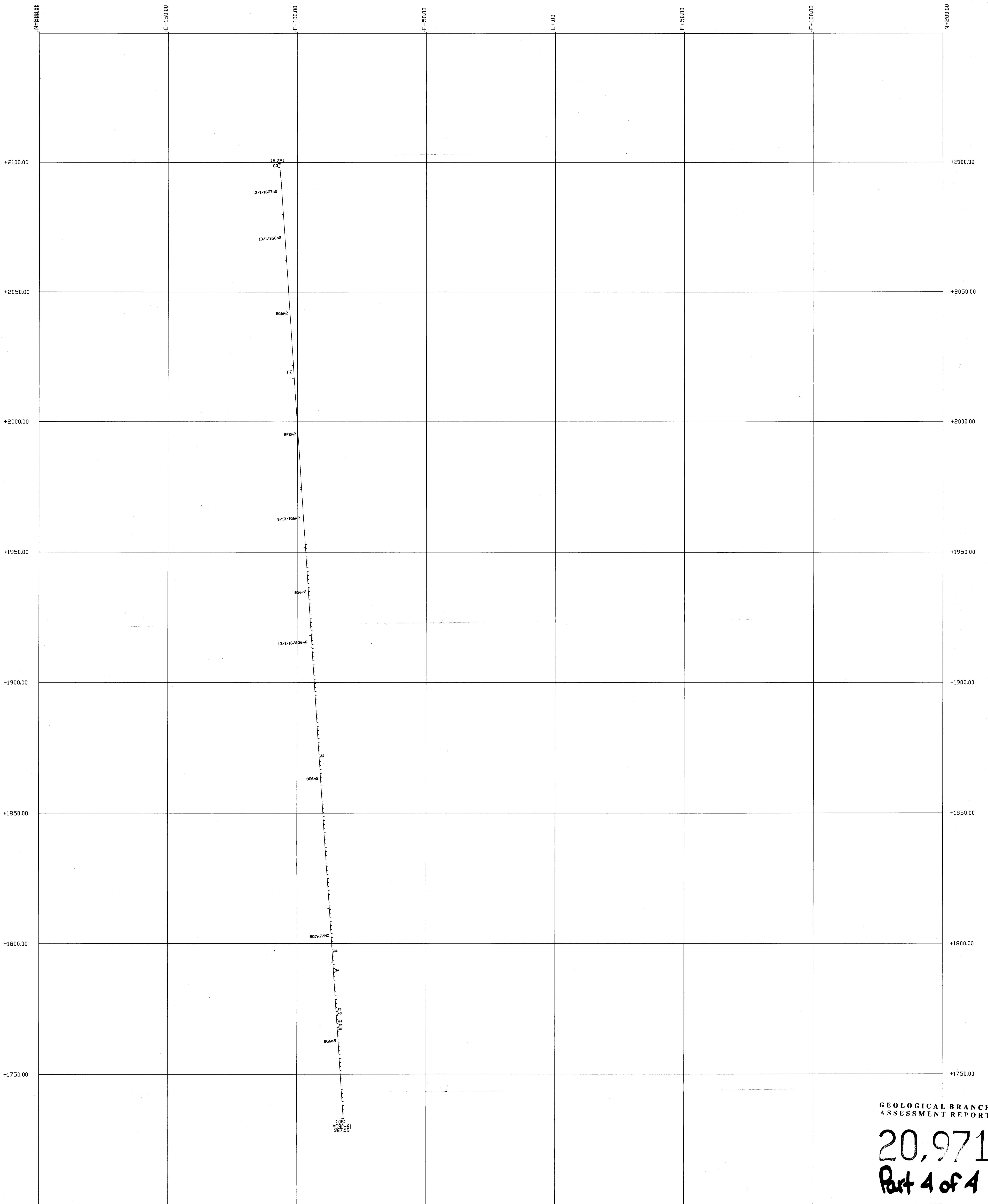

GEOLOGICAL BRANCH
ASSESSMENT REPORT

20,971
Part 4 of 4

SECTION VIEW

| | | | |
|---------------|------------|-----------|---|
| | DRAWN BY | DATE | BOND GOLD CANADA INC. RED MOUNTAIN PROJECT MARC ZONE SECTION 200 N |
| | C.S.M. | 02/15/91 | |
| | REVISED BY | DATE | |
| Scale - 1:500 | | FIGURE 08 | |

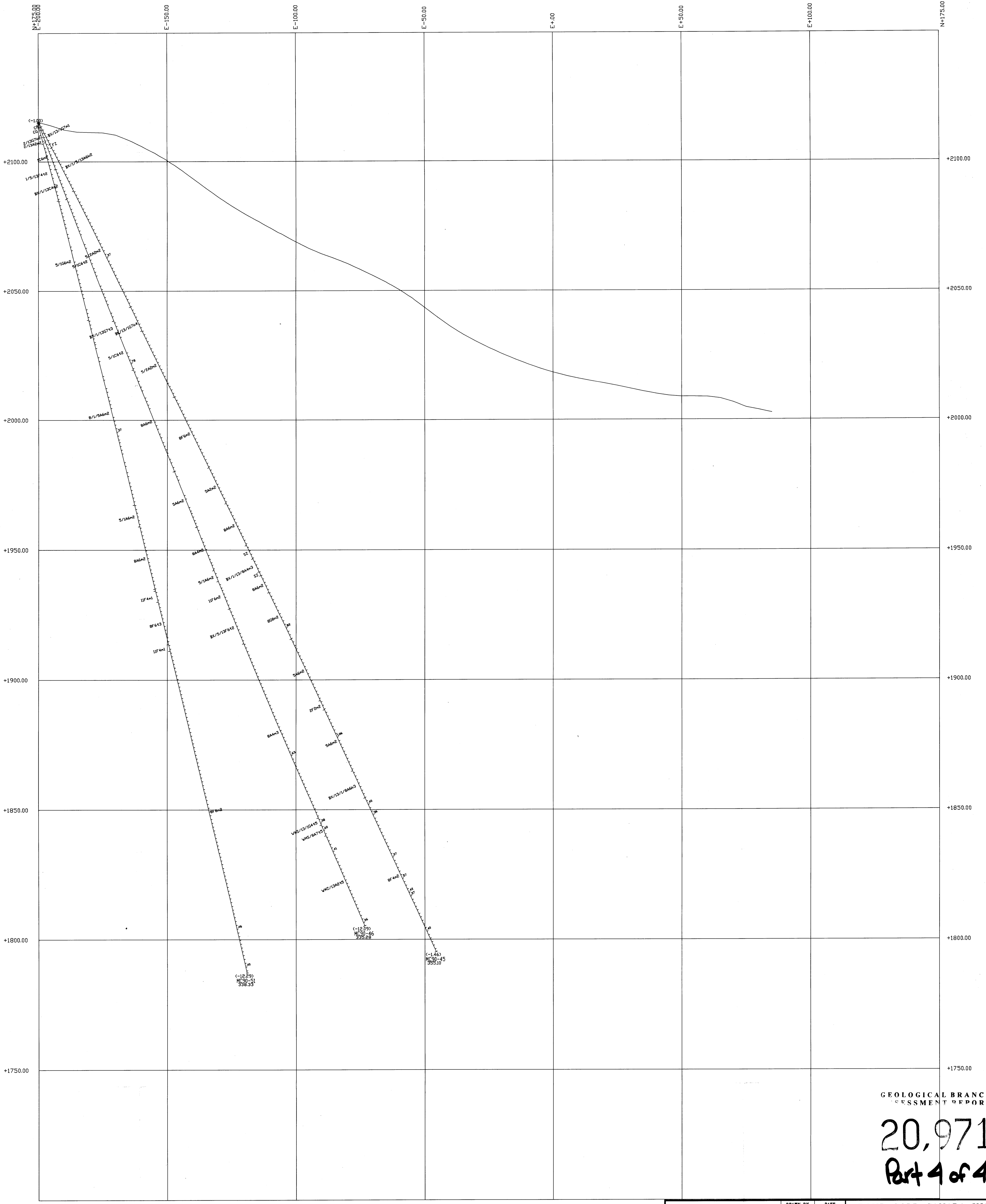

GEOLOGICAL BRANCH
ASSESSMENT REPORT
20,971
Part 4 of 4

SECTION VIEW

| | <table border="1"> <tr> <th>DRAWN BY</th> <th>DATE</th> </tr> <tr> <td>G.S.M.</td> <td>02/15/91</td> </tr> <tr> <th>REVISED BY</th> <th>DATE</th> </tr> <tr> <td></td> <td></td> </tr> </table> | DRAWN BY | DATE | G.S.M. | 02/15/91 | REVISED BY | DATE | | | BOND GOLD CANADA INC. RED MOUNTAIN PROJECT |
|--|---|----------|------|--------|----------|------------|------|--|--|---|
| | DRAWN BY | DATE | | | | | | | | |
| G.S.M. | 02/15/91 | | | | | | | | | |
| REVISED BY | DATE | | | | | | | | | |
| | | | | | | | | | | |
| Scale - 1:500 FIGURE 09 | MARC ZONE SECTION 175 N | | | | | | | | | |

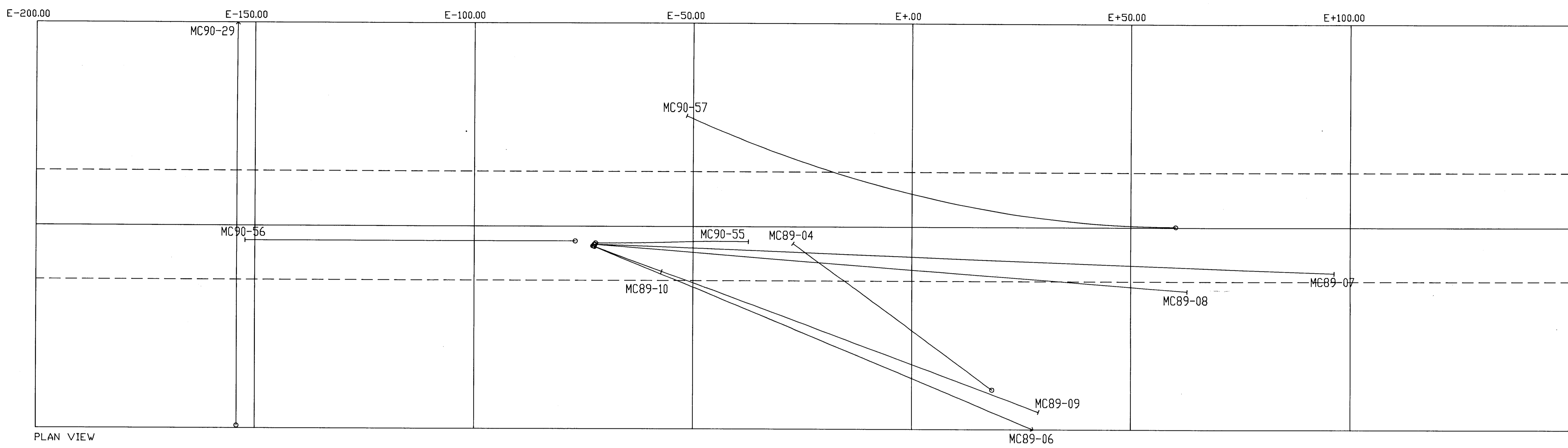

PLAN VIEW

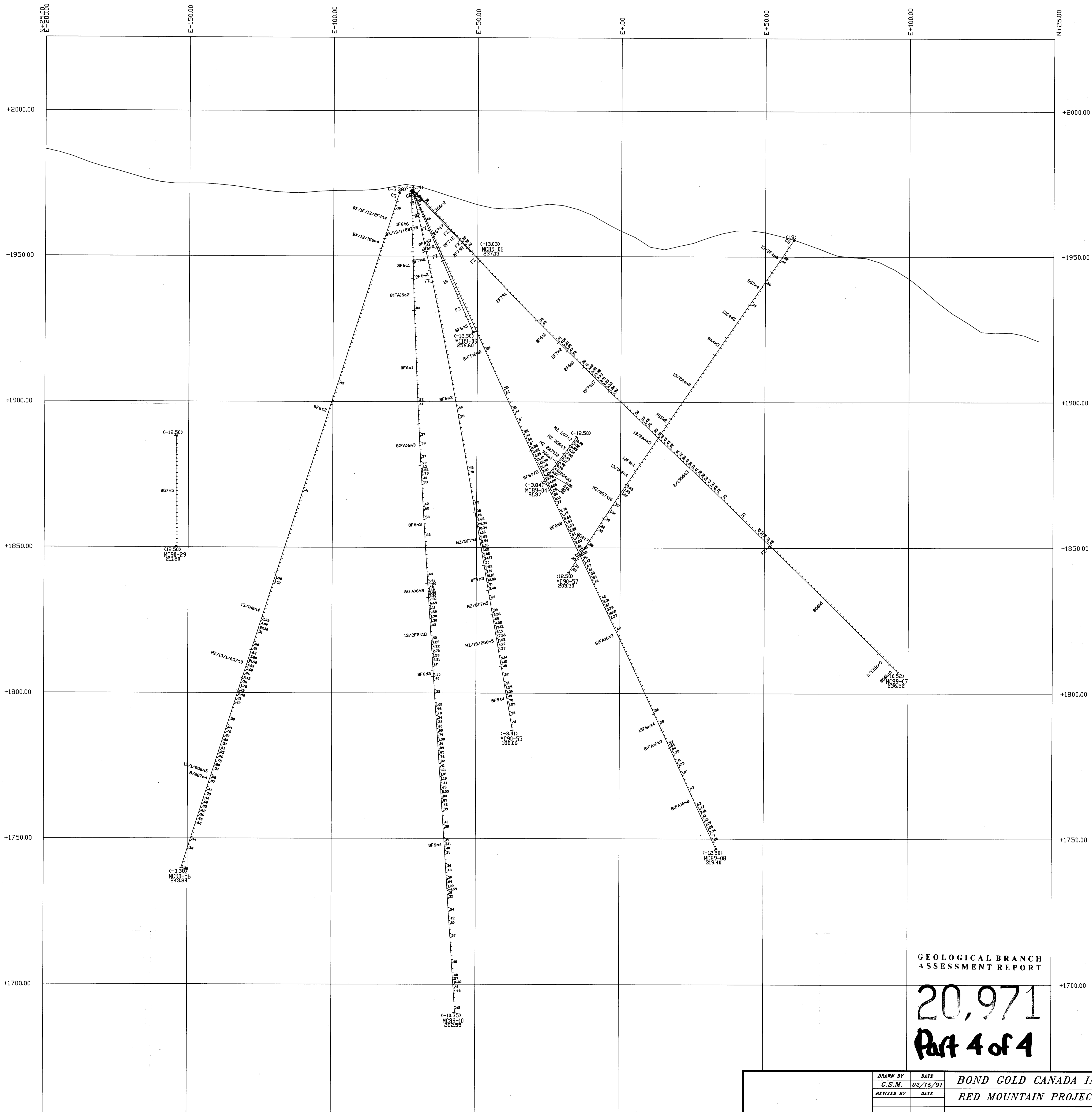

GEOLOGICAL BRANCH
ASSESSMENT REPORT

20,971
Part 4 of 4

| | | |
|---------------|----------|----------------------------|
| DRAWN BY | DATE | BOND GOLD CANADA INC. |
| | 02/15/91 | |
| REVISOR | DATE | MARC ZONE SECTION 025 N |
| | | |
| Scale - 1:500 | | FIGURE 15 |
| | | |

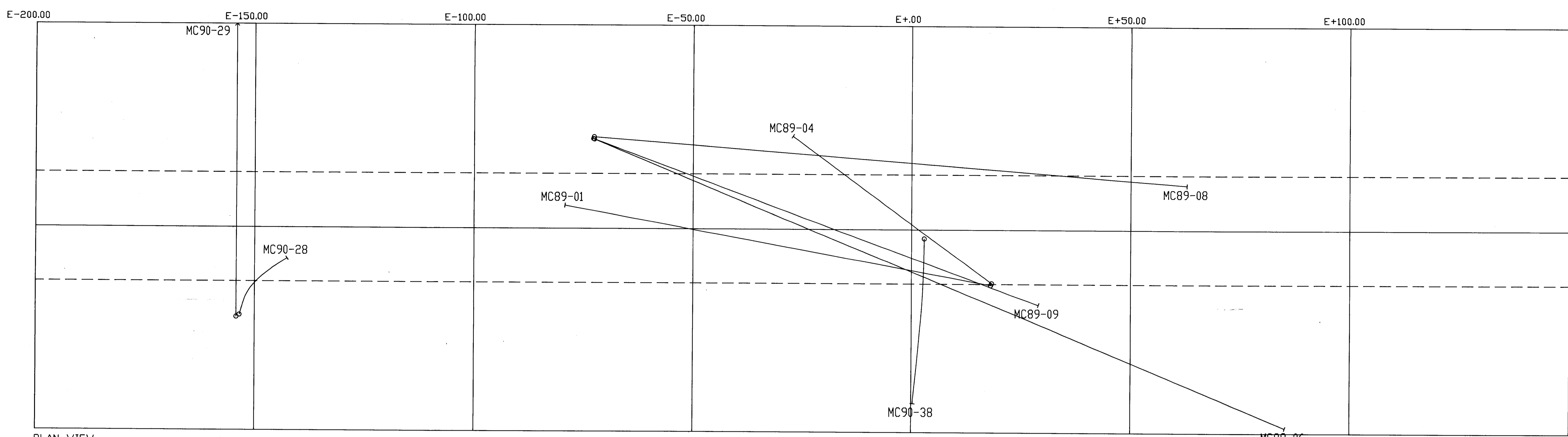

PLAN VIEW

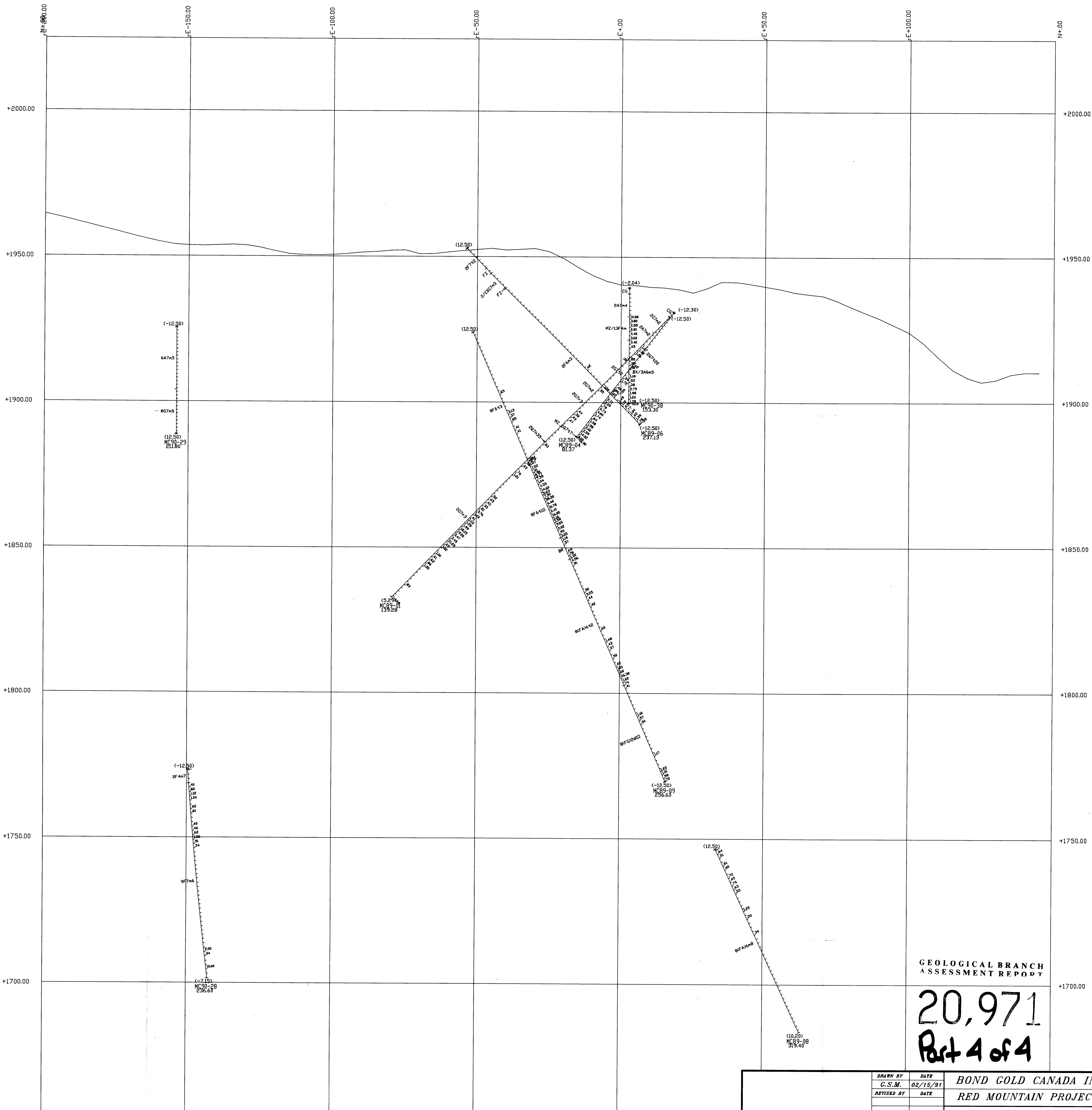

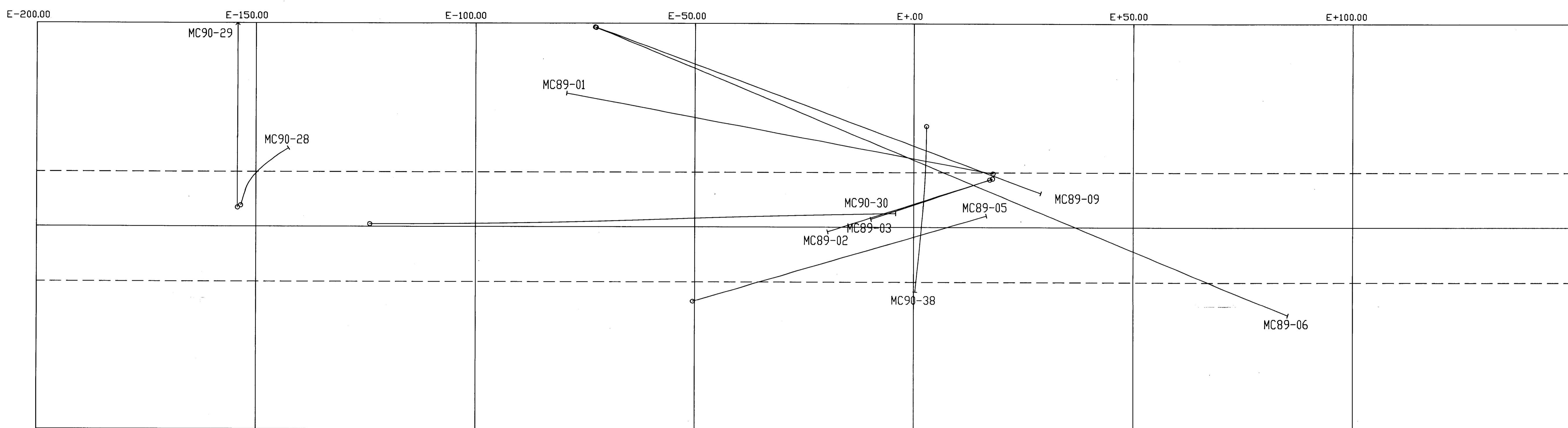

PLAN VIEW

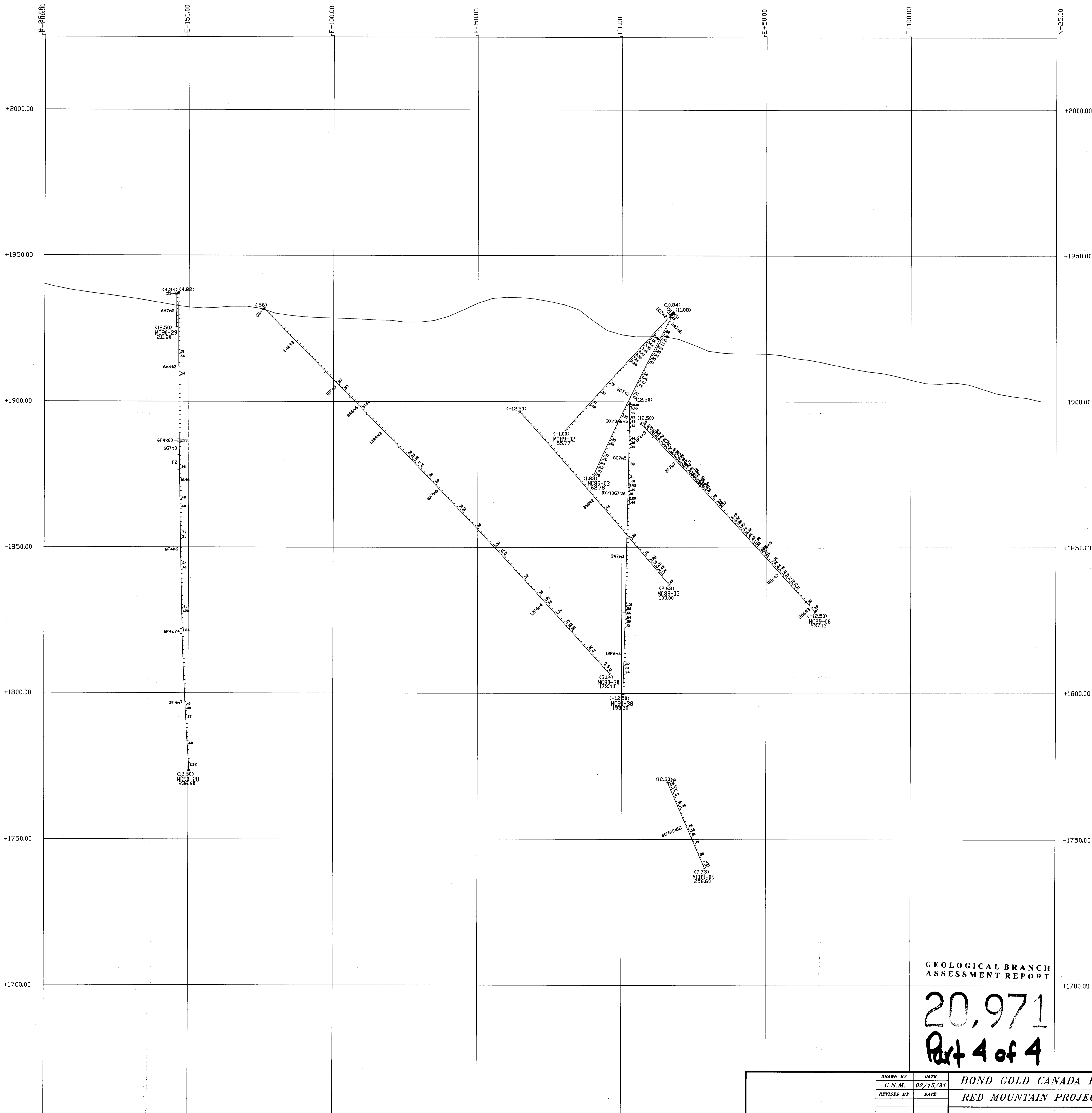

SECTION VIEW

GEOLOGICAL BRANCH
ASSESSMENT REPORT

20,971
Part 4 of 4

| | | |
|---------------|----------|-----------------------|
| DRAWN BY | DATE | BOND GOLD CANADA INC. |
| G.S.M. | 02/15/91 | |
| REVISED BY | DATE | RED MOUNTAIN PROJECT |
| Scale - 1:500 | | MARC ZONE |
| FIGURE 17 | | SECTION 025 S |

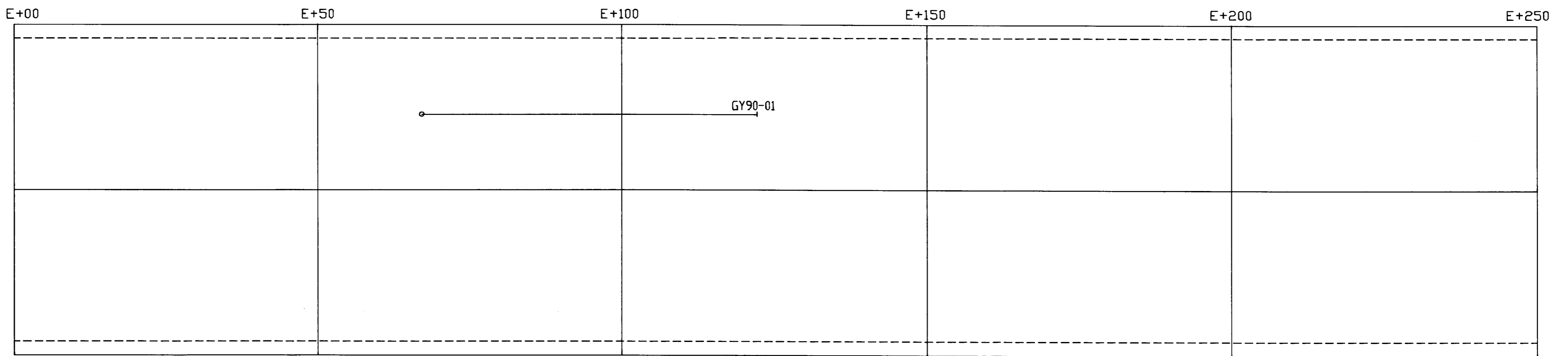

PLAN VIEW

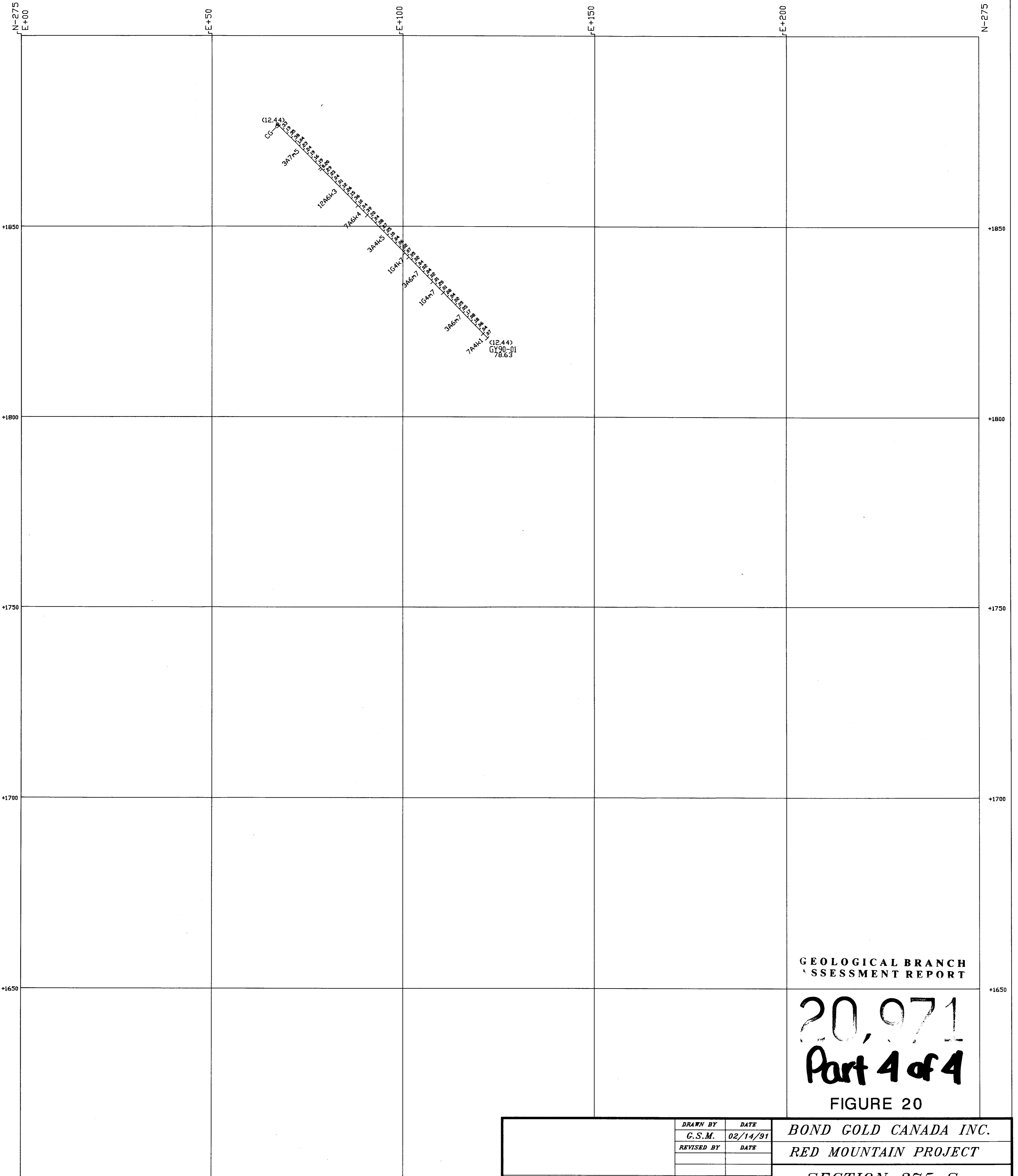

SECTION VIEW

GEOLOGICAL BRANCH
ASSESSMENT REPORT

20,971
Part 4 of 4

FIGURE 20

| | |
|------------|----------|
| DRAWN BY | DATE |
| G.S.M. | 02/14/91 |
| REVISED BY | DATE |
| | |

BOND GOLD CANADA INC.
RED MOUNTAIN PROJECT

Scale - 1:500

SECTION 275 S
GY90-01



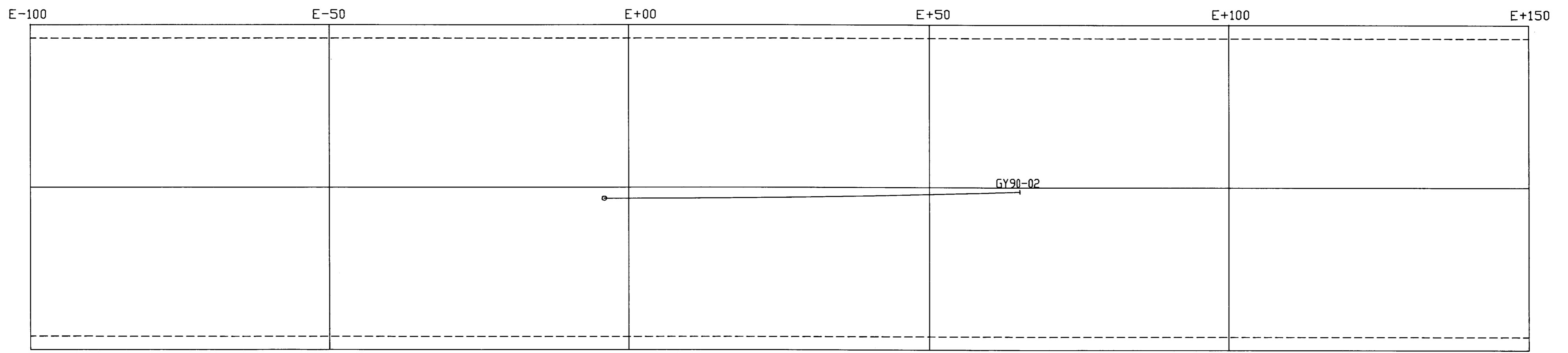

PLAN VIEW

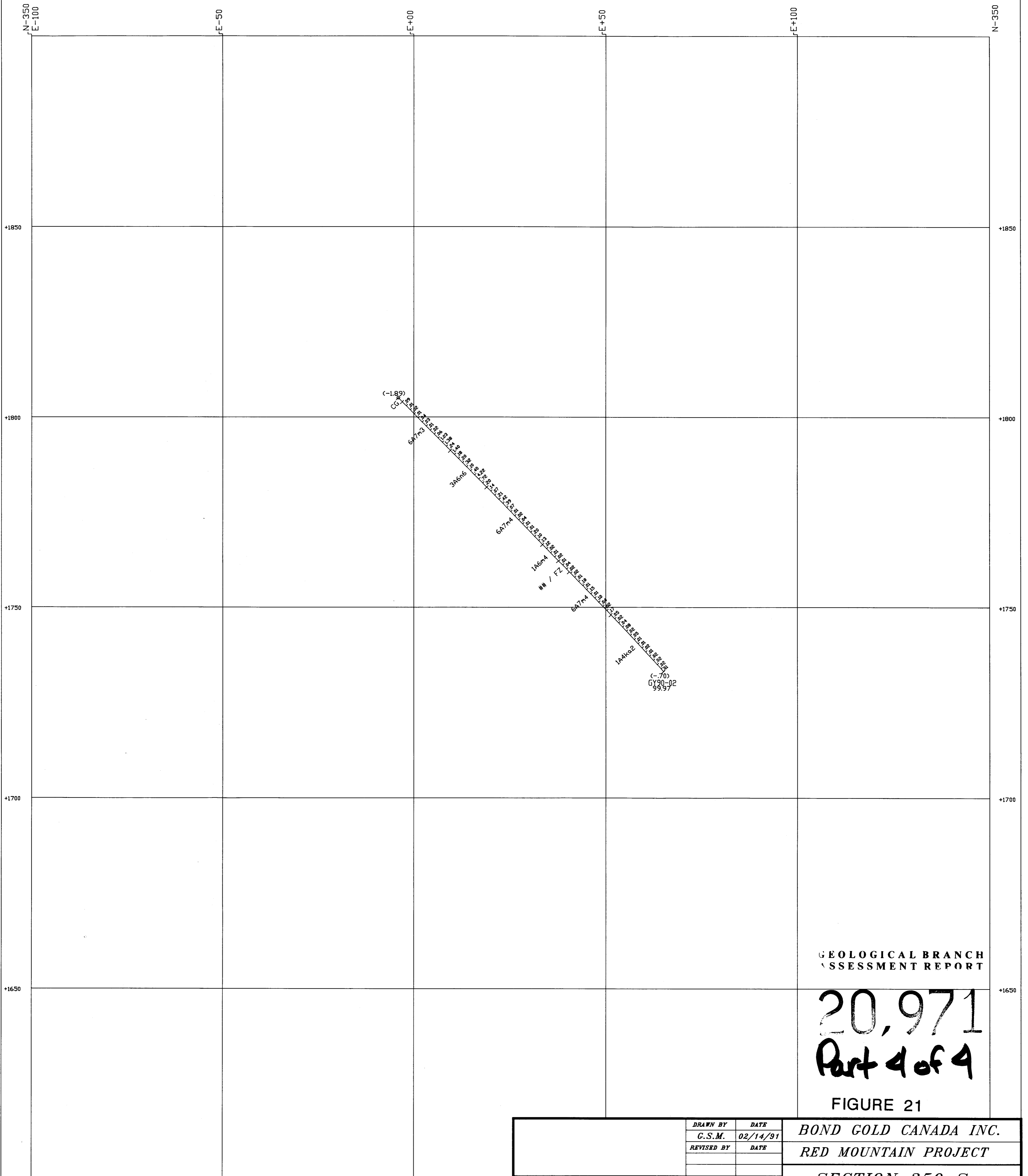

SECTION VIEW

GEOLOGICAL BRANCH
ASSESSMENT REPORT

20,971
Part 4 of 4

FIGURE 21

| | |
|--------------|----------|
| DRAWN BY | DATE |
| G.S.M. | 02/14/91 |
| REVISED BY | DATE |
| | |
| Scale- 1:500 | |

BOND GOLD CANADA INC.

RED MOUNTAIN PROJECT

SECTION 350 S
GY90-02

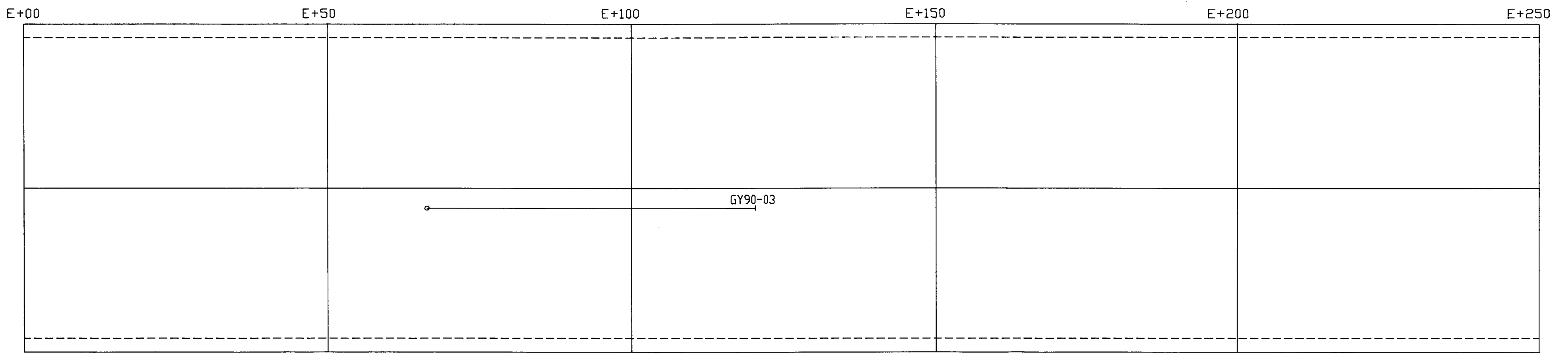

PLAN VIEW

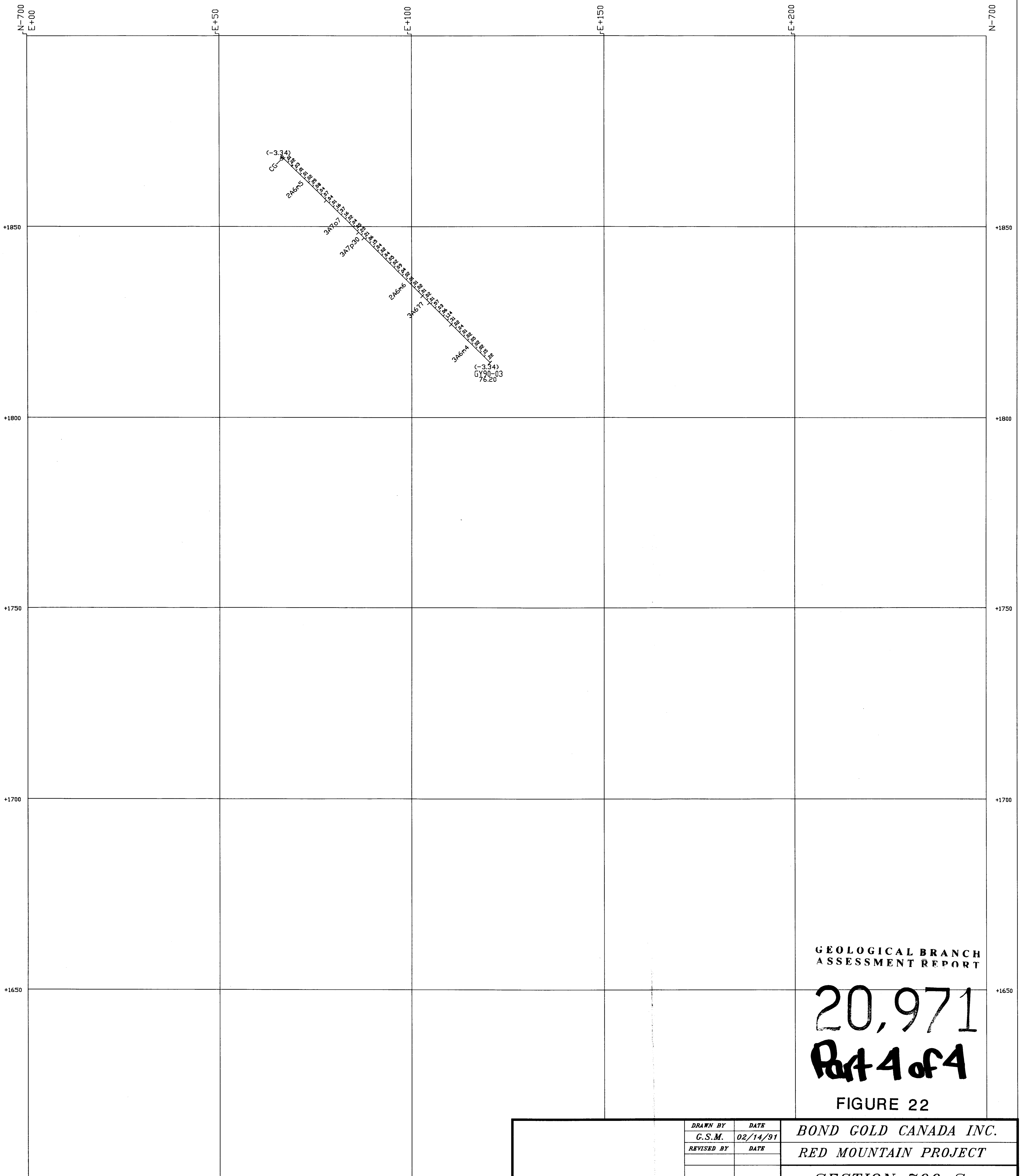

SECTION VIEW

GEOLOGICAL BRANCH
ASSESSMENT REPORT

20,971
Part 4 of 4

FIGURE 22

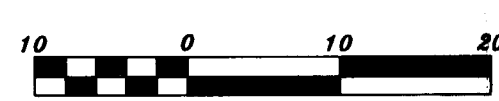

| | |
|------------|----------|
| DRAWN BY | DATE |
| G.S.M. | 02/14/91 |
| REVISED BY | DATE |
| | |

Scale - 1:500

BOND GOLD CANADA INC.
RED MOUNTAIN PROJECT

SECTION 700 S
GY90-03

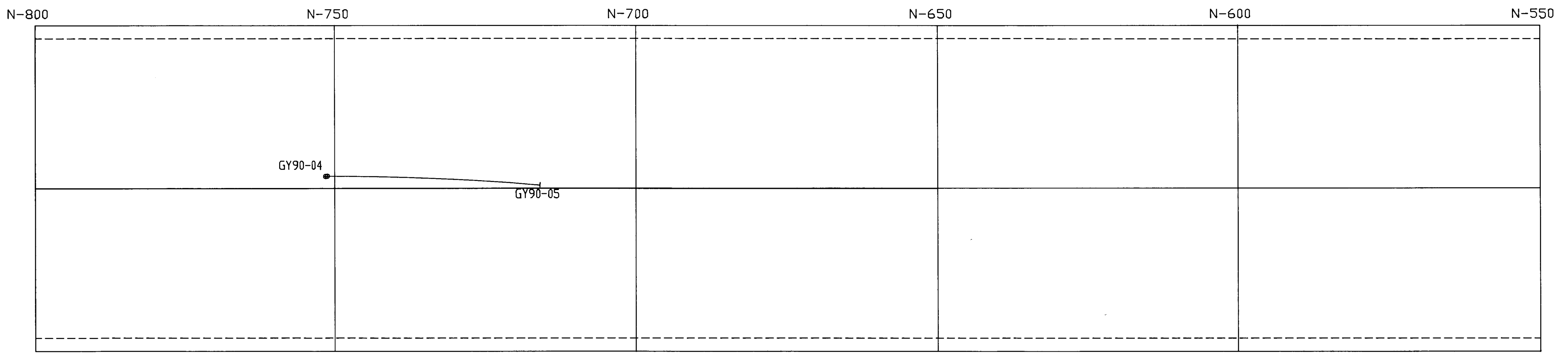

PLAN VIEW



SECTION VIEW

GEOLOGICAL BRANCH
ASSESSMENT REPORT

20,971
Part 4 of 4

FIGURE 23

| | |
|------------|----------|
| DRAWN BY | DATE |
| G.S.M. | 02/14/91 |
| REVISED BY | DATE |
| | |

BOND GOLD CANADA INC.
RED MOUNTAIN PROJECT

Scale- 1:500

SECTION 150 E
GY90-04 GY90-05



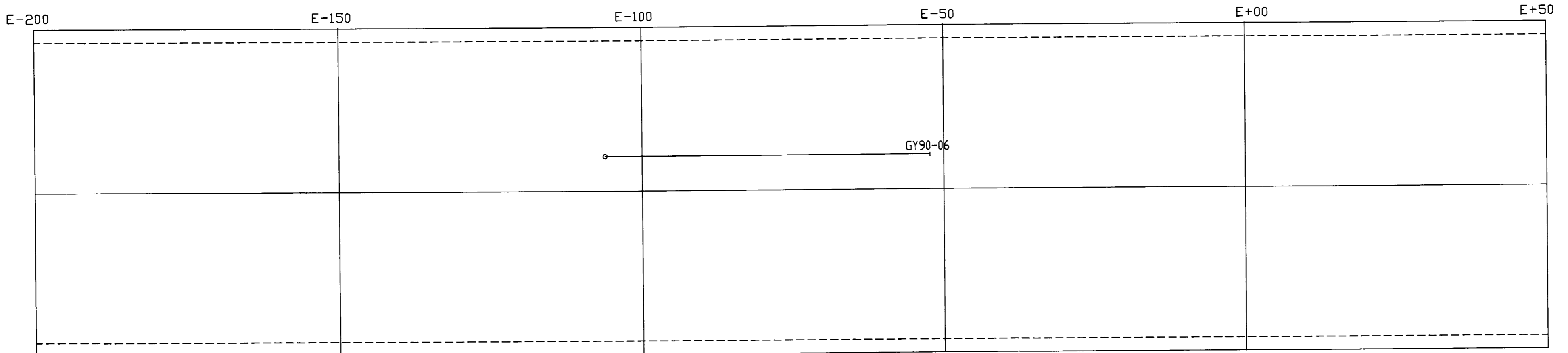

PLAN VIEW

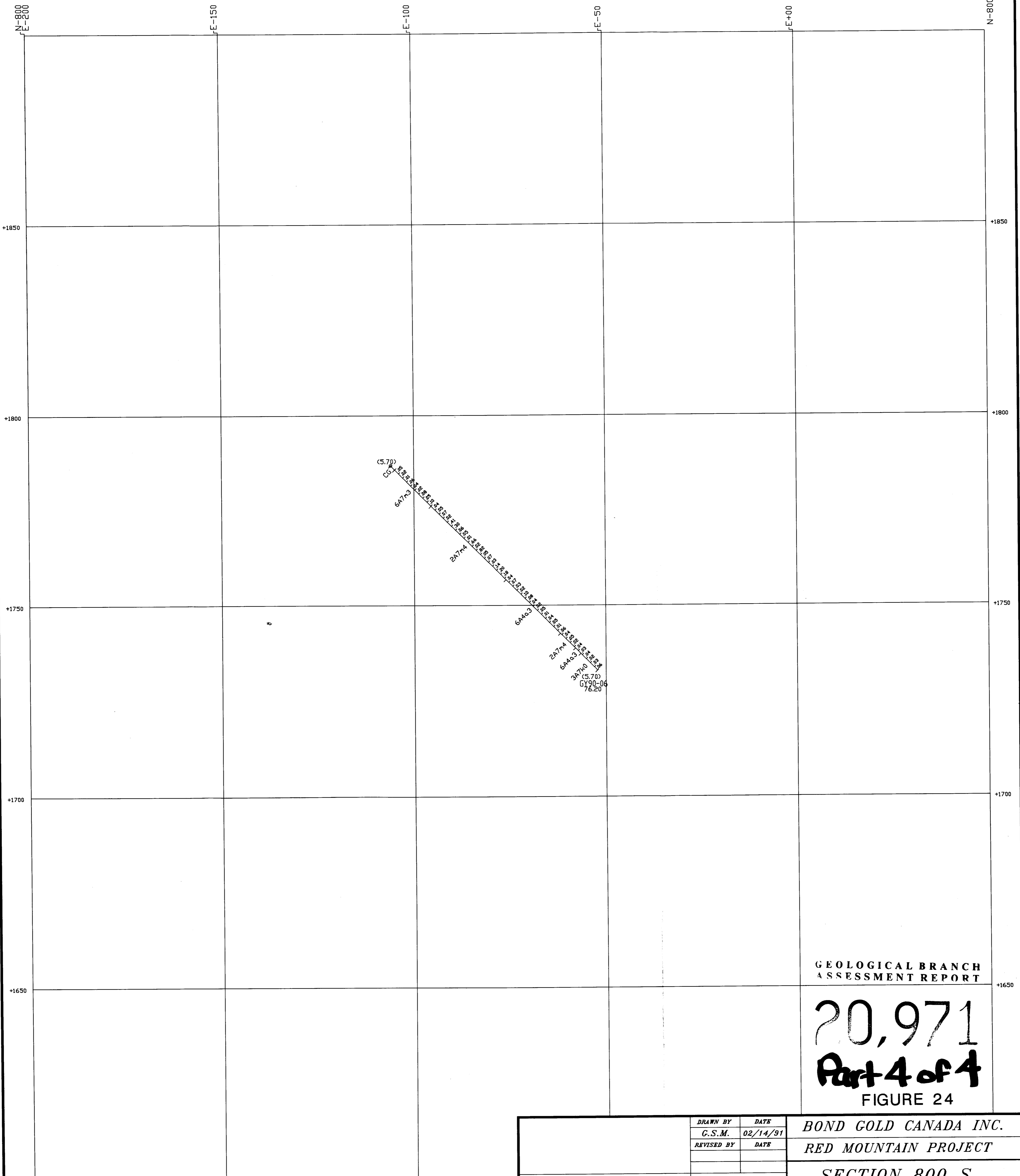

SECTION VIEW

GEOLOGICAL BRANCH
ASSESSMENT REPORT

20,971
Part 4 of 4
FIGURE 24



| | |
|--------------|----------|
| DRAWN BY | DATE |
| G.S.M. | 02/14/91 |
| REVISED BY | DATE |
| | |
| Scale- 1:500 | |

BOND GOLD CANADA INC.
RED MOUNTAIN PROJECT
SECTION 800 S
GY90-06

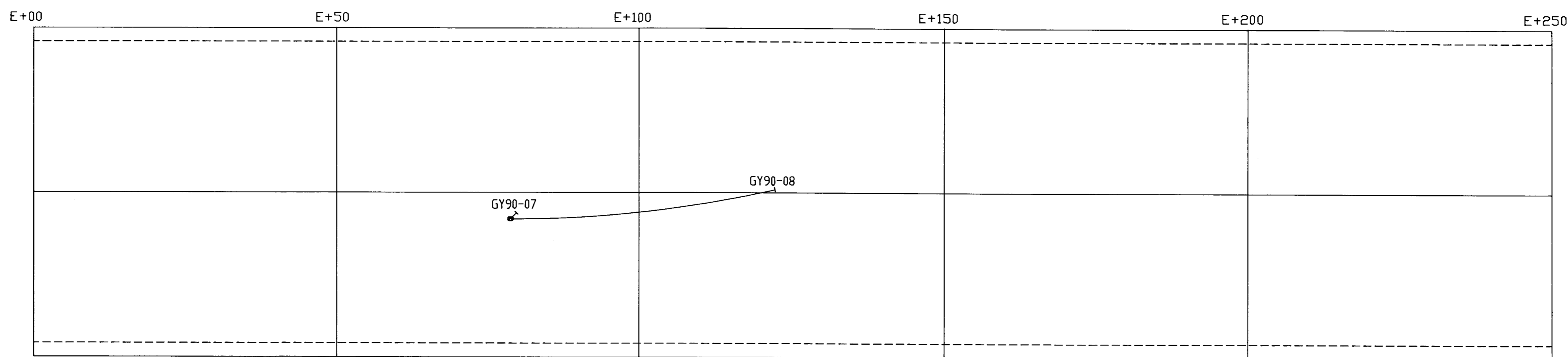

PLAN VIEW

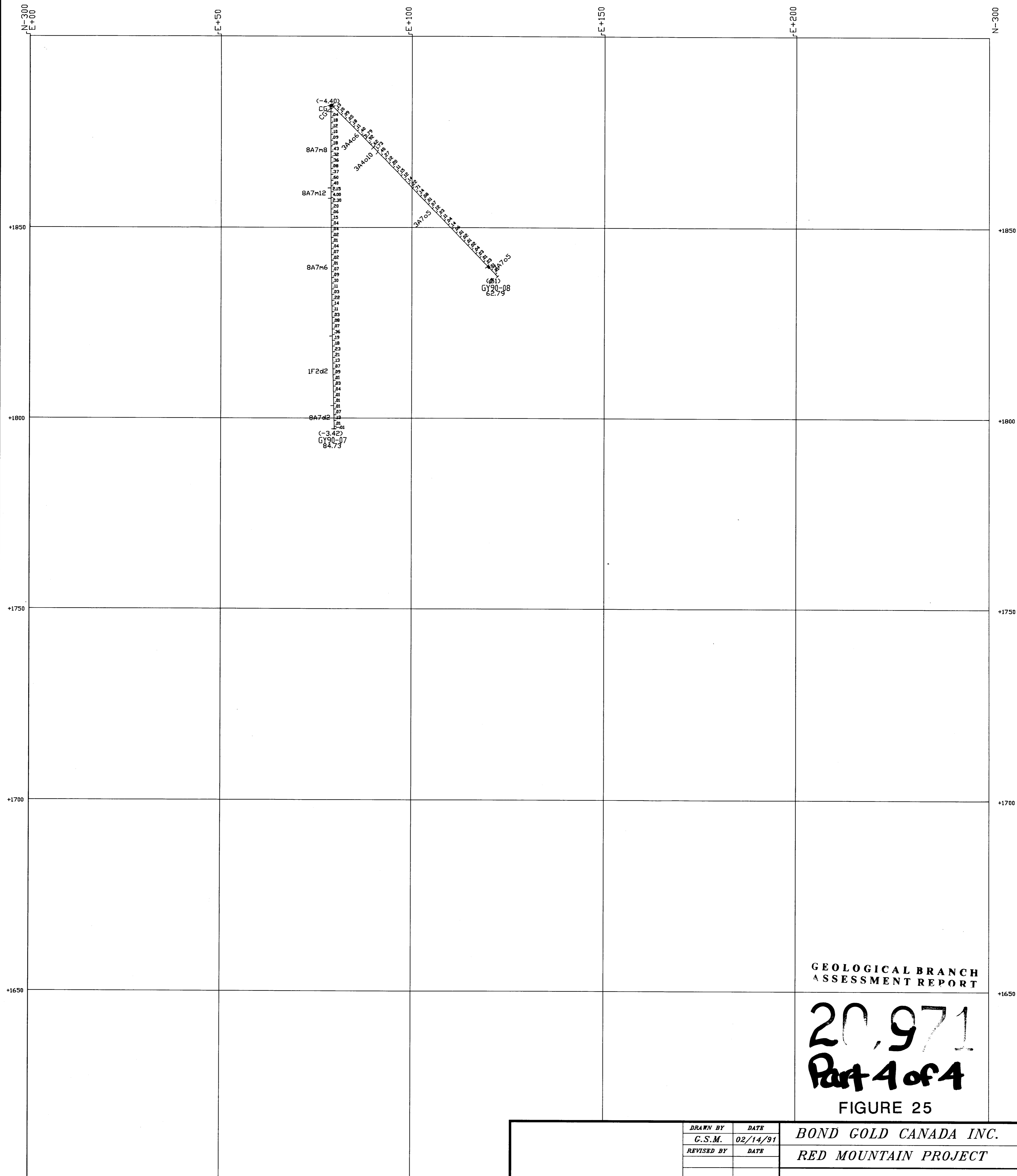

SECTION VIEW

GEOLOGICAL BRANCH
ASSESSMENT REPORT

20,971
Part 4 of 4
FIGURE 25



| | |
|------------|----------|
| DRAWN BY | DATE |
| C.S.M. | 02/14/91 |
| REVISED BY | DATE |
| | |

BOND GOLD CANADA INC.
RED MOUNTAIN PROJECT

SECTION 300 S
GY90-07 GY90-08

Scale - 1:500

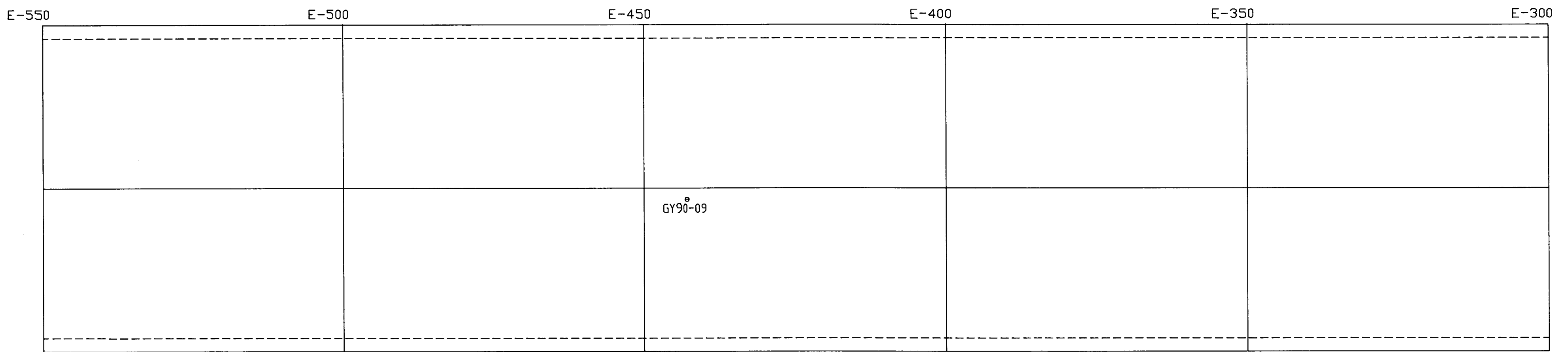

PLAN VIEW



SECTION VIEW

GEOLOGICAL BRANCH
ASSESSMENT REPORT

20,971

Part 4 of 4

FIGURE 26

| | |
|------------|----------|
| DRAWN BY | DATE |
| G.S.M. | 02/14/91 |
| REVISED BY | DATE |
| | |

BOND GOLD CANADA INC.
RED MOUNTAIN PROJECT

Scale- 1:500

SECTION 1025 S
GY90-09



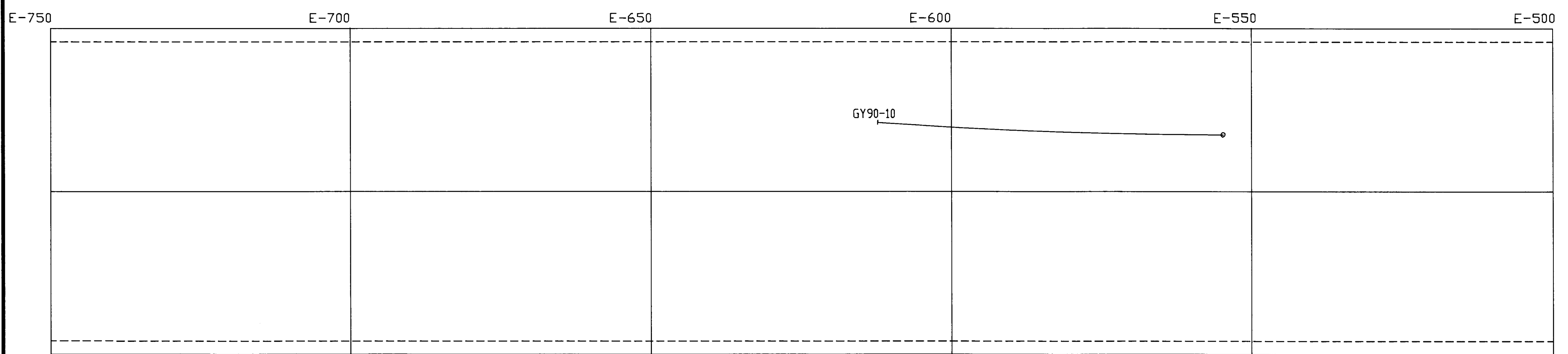

PLAN VIEW



SECTION VIEW

GEOLOGICAL BRANCH
ASSESSMENT REPORT

20,971

Part 4 of 4

FIGURE 27



| | |
|-------------------|-------------|
| <i>DRAWN BY</i> | <i>DATE</i> |
| G.S.M. | 02/14/91 |
| <i>REVISED BY</i> | <i>DATE</i> |
| | |
| Scale - 1:500 | |

BOND GOLD CANADA INC.
RED MOUNTAIN PROJECT
SECTION 750 S
GY90-10

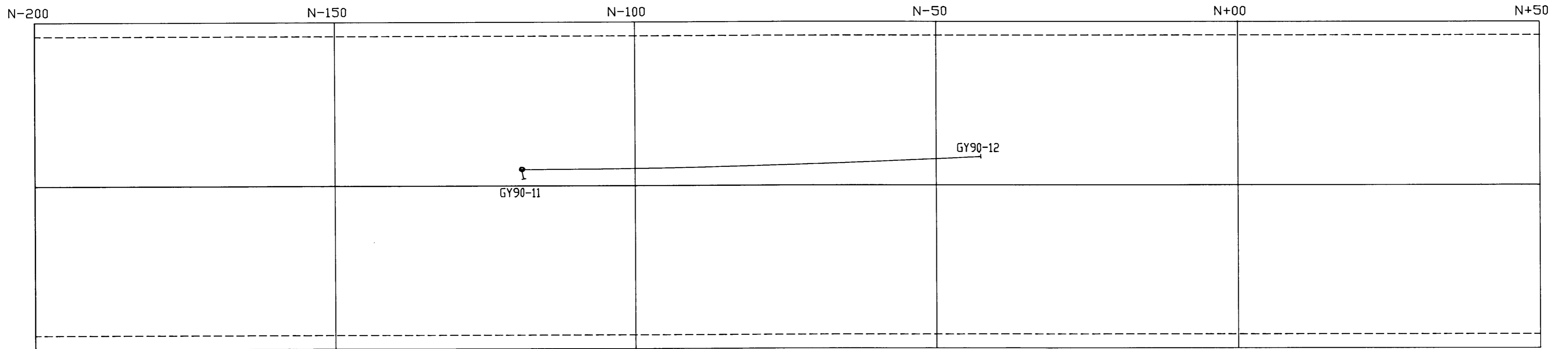

PLAN VIEW

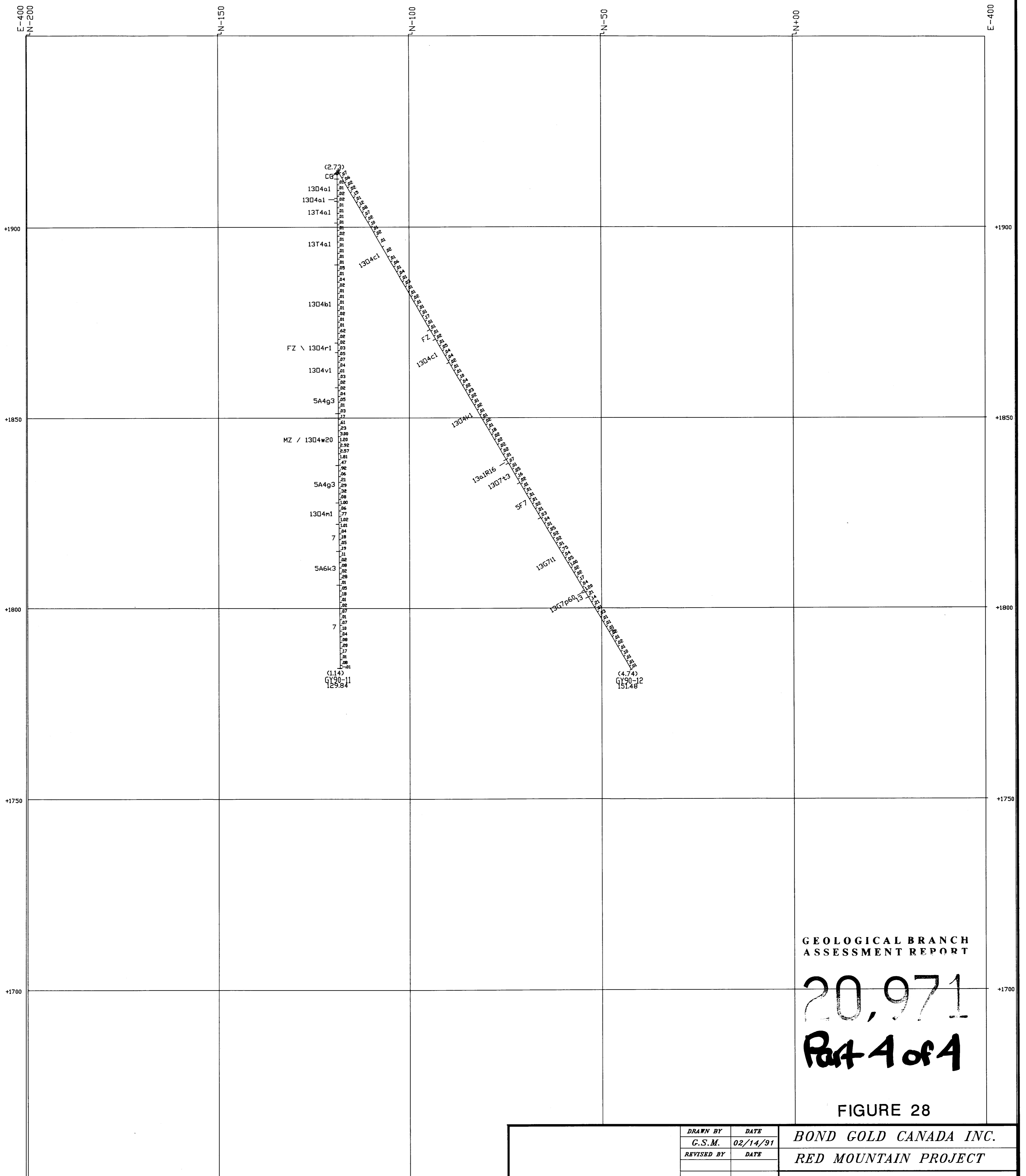

GEOLOGICAL BRANCH
ASSESSMENT REPORT

20,971
Part 4 of 4

FIGURE 28

| | | |
|--------------------|------------------|---|
| DRAWN BY G.S.M. | DATE 02/14/91 | BOND GOLD CANADA INC. RED MOUNTAIN PROJECT |
| | REVISED BY | |
| Scale - 1:500 | | SECTION 400 W GY90-11 GY90-12 |



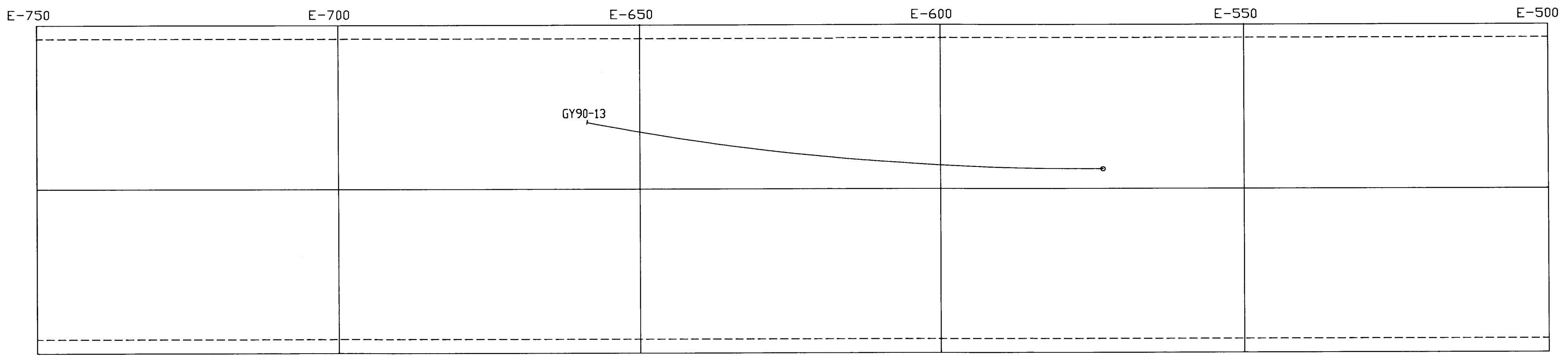

PLAN VIEW

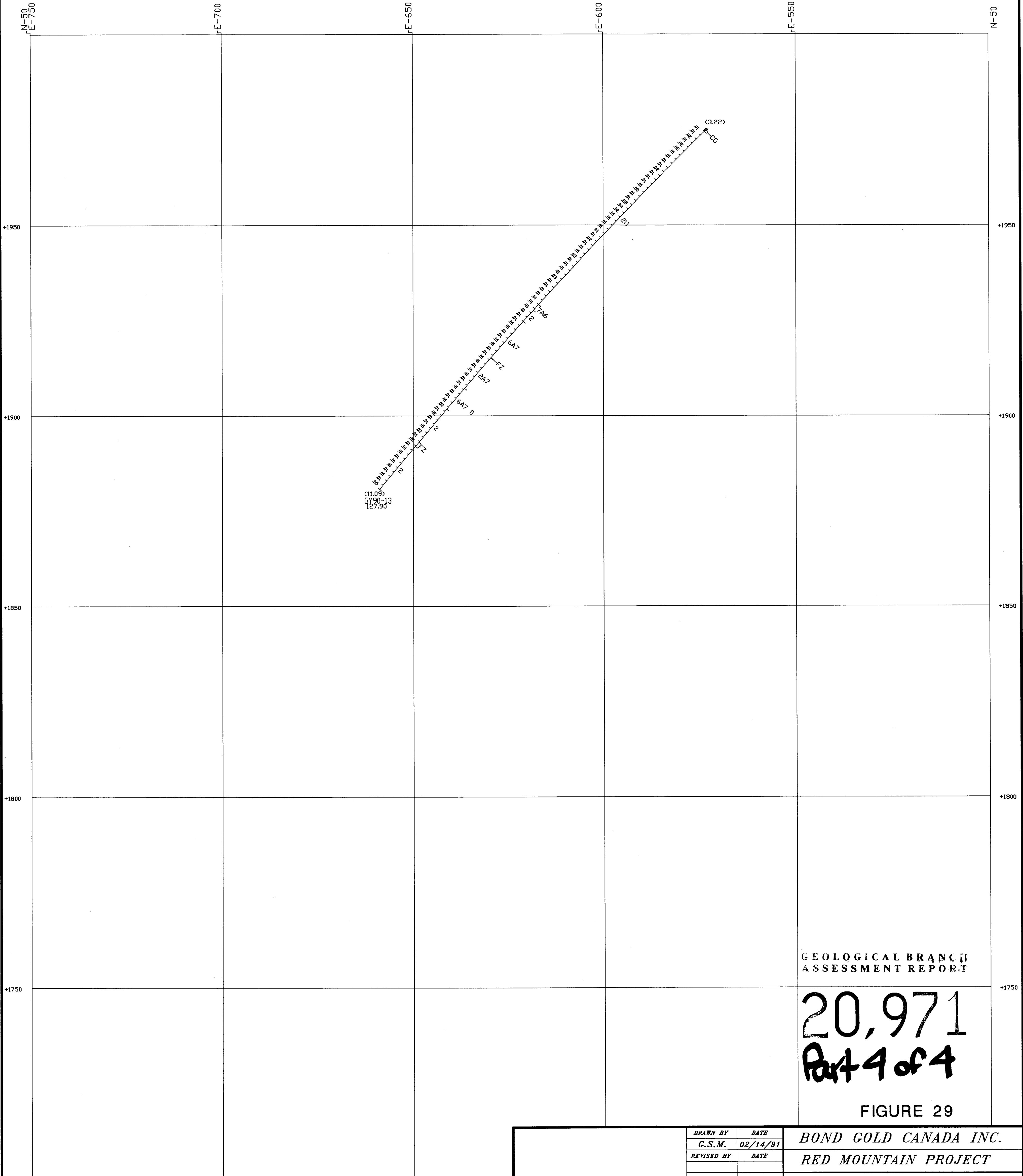

SECTION VIEW

GEOLOGICAL BRANCH
ASSESSMENT REPORT

20,971
Part 4 of 4

FIGURE 29

| | | | | |
|--------------|--|----------|--|---|
| DRAWN BY | | DATE | | BOND GOLD CANADA INC. RED MOUNTAIN PROJECT |
| G.S.M. | | 02/14/91 | | |
| REVISED BY | | DATE | | |
| | | | | SECTION 050 S GY90-13 |
| Scale- 1:500 | | | | |

