

ARIS SUMMARY SHEET

District Geologist, Victoria

Off Confidential: 92.03.22

ASSESSMENT REPORT 21136

MINING DIVISION: Alberni

PROPERTY: General James M.

LOCATION: LAT 49 14 00 LONG 125 38 00
UTM 10 5456513 308296
NTS 092F04E

CAMP: 025 Tofino - Kennedy River Area

CLAIM(S): Hope (L.453), Princess (L.390), Duchess (L.388), Condor (L.327)
Count of Monte Cristo (L.326)

OPERATOR(S): Hicks, K.E.

AUTHOR(S): Tribe, N.

REPORT YEAR: 1991, 21 Pages

COMMODITIES

SEARCHED FOR: Copper, Silver

KEYWORDS: Paleozoic, Sicker Group, Andesites, Limestones, Diorites, Skarns

WORK

DONE: Prospecting

PROS 200.0 ha

RELATED

REPORTS: 14331, 16354

MINFILE: 092F 152

LOG NO: <i>March 26/91</i> RD.
ACTION:
FILE NO:

ASSESSMENT REPORT
ON THE
GENERAL JAMES M. GROUP,
OF
REVERTED CROWN GRANTS,
ALBERNI MINING DIVISION,
BRITISH COLUMBIA.

LATITUDE: 49 DEGREES 14 MINUTES NORTH
LONGITUDE: 125 DEGREES 37 MINUTES WEST
NTS 92F/4E, 92F/5E,

FOR
KENNETH E. HICKS
115 - 1741 W. 10TH. AVE.
VANCOUVER, B.C. V6J 2A5
TEL. (604) 734-4551 Vancouver, B.C.

SUB-RECORDER
RECEIVED
MAR 22 1991
M.R. # _____ \$ _____
VANCOUVER, B.C.

**GEOLOGICAL BRANCH
ASSESSMENT REPORT**

21,136

ASSESSMENT REPORT
ON THE
GENERAL JAMES M. GROUP,
OF
REVERTED CROWN GRANTS,
ALBERNI MINING DIVISION,

TABLE OF CONTENTS

SUMMARY	.1.
INTRODUCTION	.3.
LOCATION, ACCESS AND TOPOGRAPHY	.3.
PROPERTY	.5.
HISTORY	.5.
GEOLOGY	.6.
KNOWN SHOWINGS AND DOCUMENTED MINERALIZATION	.6.
1991 WORK PROGRAM	.10.
STATEMENT OF COSTS	.13.
RESUME OF AUTHOR	.14.

LIST OF ILLUSTRATIONS

		Page
Figure #1	LOCATION MAP	.2.
Figure #2	INDEX AND CLAIM MAP	.4.
Figure #3	PROPERTY MAP	.8.
Figure #4	GEOLOGY & ASSAY MAP HOPE, PRINCESS, DUCHESS, COUNTESS	.10.
Figure #5	GEOLOGY & ASSAY MAP CONDOR COUNT OF MONTE CRISTO	.11.

APPENDICES

APPENDIX I ASSAY CERTIFICATES

ASSESSMENT REPORT
ON THE
GENERAL JAMES M.
GROUP OF REVERTED
CROWN GRANTS

SUMMARY

The property consists of 14 Reverted Crown Grants located 20 km. north of Tofino, B.C. Access is by highway and logging road.

The deposits are copper silver skarns at the contact of quartz-diorite and Sicker Group volcanics and sedimentary rocks. There are numerous skarny areas on the property with three known sulphide skarn bodies. The central one has two adits driven in the 1930's. Copper values average around 2.0% in the skarns with some values as high as 4.32% over 1.00 m.

The Pandora gold mine is located about 500 m. to the north of the property along the same contact and a strong gold anomaly from stream sediments was identified on adjacent R.C.G. "B.C. Wonder" claim in the central portion of the property. This stream sediment sample was taken from Elsul Creek which has a steep profile draining the "Duchess" and "Countess" R.C.G.s.

The possibility of further gold skarn occurrences along this contact has not been sufficiently tested and therefore makes an attractive target. .1.

YUKON TERRITORY



WHITEHORSE

WATSON LAKE

BRITISH

PRINCE RUPERT

PRINCE GEORGE

COLUMBIA

BELLA COOLA

KAMLOOPS

VANCOUVER

PENTICTON

CRANBROOK

VICTORIA

UNITED STATES

GENERAL JAMES M.
GROUP OF REVERTED
CROWN GRANTS

SHT RESOURCE SYNDICATE
GENERAL JAMES M. GROUP
OF REVERTED CROWN GRANTS
LOCATION MAP

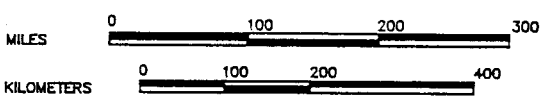

Scale : 1:50,000 Drawn by: N.L.T.
Date: MAY, 1990 FILE:- GENJLOC.DWG Figure Number 1
N.TRIBE & ASSOC. LTD.

INTRODUCTION

This report is based on information collected during the 1991 work program in which prospecting and mapping traverses were carried out over the claims.

LOCATION ACCESS AND TOPOGRAPHY

The property is located at the head of Tofino Inlet, about 20 km NE of Tofino. Geographic location is 49 degrees 14 minutes north and 125 degrees 37 minutes west on map sheets 92F/4E and 92F/5E in west-central Vancouver Island, British Columbia, in the Alberni Mining Division.

Access to the property is by road from the Alberni Tofino highway just west of Kennedy Lake by MacMillan Bloedel's West Main logging road, to the head of Deer Bay thence along the logging road north and west to the property. Access about the property is mainly on foot with logging roads providing some local access. The Elsul Creek branch logging road from Rankin Inlet, reaches onto the Hope R.C.G. but this road is washed out in several places and is no longer passable to vehicular traffic. The main showings are not accessible by road.

The claims lie across the divide between the Tranquil Creek Drainage and the Tofino Creek Drainage and the terrain is rugged with temperate rain forest vegetation. Elevations on the property range from 90 m. to 1,100 m. The climate is mild with an abundance of rain and little snow. Outcrop

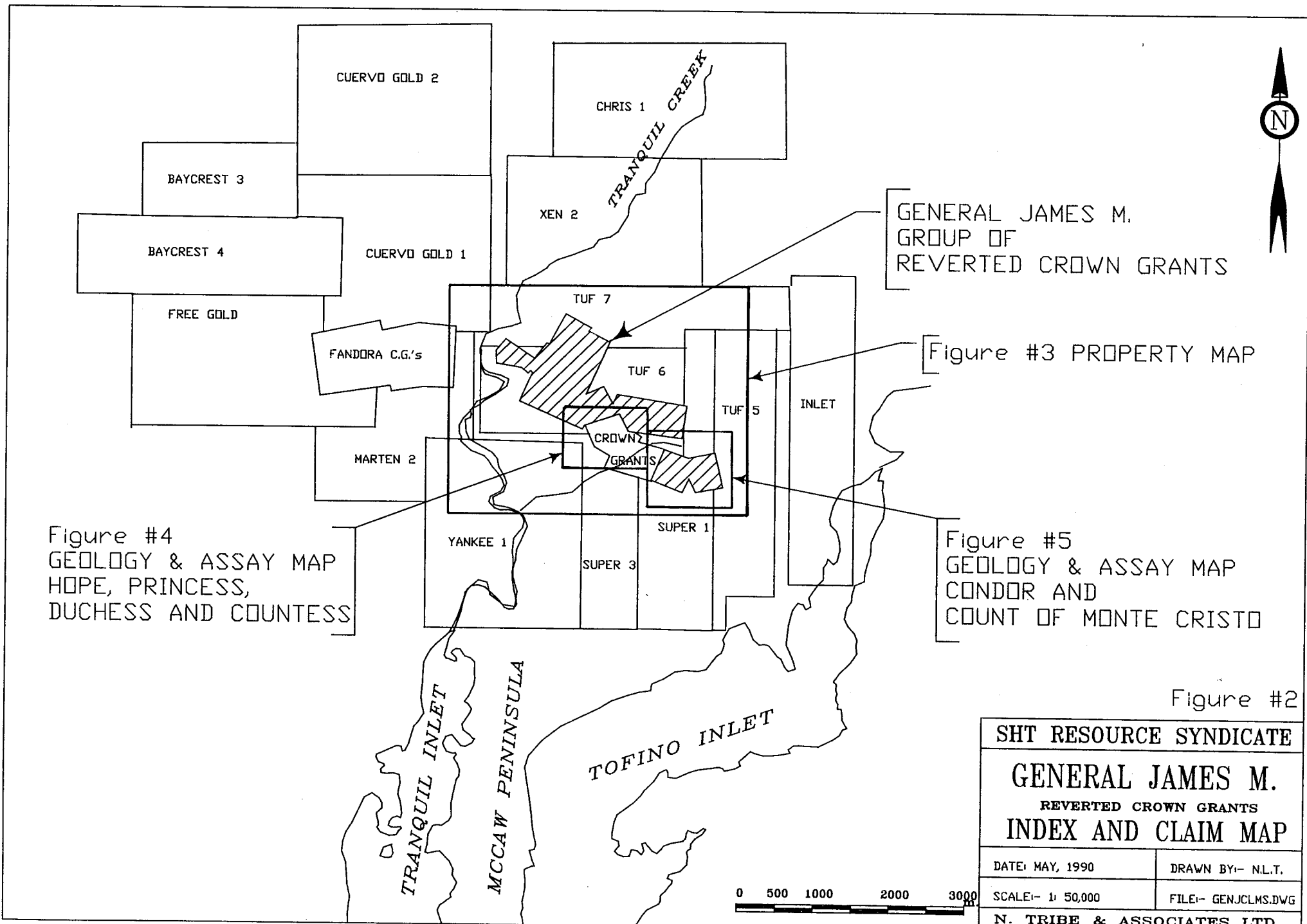

Figure #4
GEOLOGY & ASSAY MAP
HOPE, PRINCESS,
DUCHESS AND COUNTESS

GENERAL JAMES M.
GROUP OF
REVERTED CROWN GRANTS

Figure #3 PROPERTY MAP

Figure #5
GEOLOGY & ASSAY MAP
CONDOR AND
COUNT OF MONTE CRISTO

Figure #2

SHT RESOURCE SYNDICATE	
GENERAL JAMES M. REVERTED CROWN GRANTS INDEX AND CLAIM MAP	
DATE: MAY, 1990	DRAWN BY:- N.L.T.
SCALE:- 1: 50,000	FILE:- GENJCLMS.DWG
N. TRIBE & ASSOCIATES LTD.	

exposures are estimated to be in the order of 25% of the surface. The forest is open mature cedar, hemlock and fir but much has been clear cut.

PROPERTY

The General James M. property consists of 14 Reverted Crown Grants comprising 205.89 hectares all within the Alberni Mining Division. The following is a list of the claims:

Claim	Lot No.	Size ha.
General James M.	318	14.79
Lady Francis	319	20.90
Superb	320	13.40
Success	321	19.58
Leviathan	322	8.86
Leviathan No. 2	323	3.60
Count of Monte Cristo	326	20.90
Condor	327	17.00
Duchess	388	17.04
Countess	389	20.90
Princess	390	18.13
Leviathan Fr.	391	0.88
Hope	453	12.79
Faith	454	17.12

		205.89

HISTORY

Gold and copper mineralization was first discovered on the area in the 1890's and the development work on the property, consisting of the adits and drifting, was started in the 1930's. The main gold producer in the area was the Fandora Mine, which is on strike about 500 m. north of the Leviathan R.C.G. on the west side of Tranquil Creek. The Fandora produced during the 1940's and again during the 1960's.

Two adits are reported on the General James M. R.C.G., the longest is 30 m. and is driven on a copper skarn associated with the contact between the intrusive and the limestone. The assays reported from this early work are recorded on the attached property map, and listed in TABLE I.

GEOLOGY

The property is about half underlain by Sicker Group volcanics and sediments of Devonian age, and half by the Tofino Inlet Pluton, Jurassic in age and quartz-dioritic in composition. At the contact a skarn has formed which varies in composition but is generally a garnet-epidote-sulphide-skarn, with magnetite, chalcopyrite, pyrite and pyrrhotite, after limestone or porphyritic andesite. Grades average around 2% copper and about 0.5 opt silver with minor amounts of zinc, lead and a trace of gold.

KNOWN SHOWINGS AND DOCUMENTED MINERALIZATION

The Assessment Reports by West-Mar Resources Ltd. define three mineralized zones. The largest of these is a 35 m. wide zone of skarn containing a 3.5 m. vertical quartz vein striking Az. 110 degrees with some smaller associated veins and stringers. This showing is located near the boundary of the Leviathan R.C.G. and Leviathan No. 2 R.C.G. (lot 323 and lot 322) just above the logging road. The best results from samples tested in this zone gave 0.30% copper and 2.7 ppm silver.

The best of the tested mineralization is on the General James M. R.C.G. at the site of the two adits. .6.

In the immediate area of the adits three steeply dipping east-west trending subparallel copper-magnetite bearing skarn systems are exposed. Each of these areas was sampled and the results are given in Table I. A short description is as follows:

Sample number 8 was taken from the main adit workings, and gave results of 4.32% copper and 1.2 opt silver over 1.00 m. in width. Sample number 9 was taken 10 m. north and still in magnetite skarn in a 2.0 m. wide breccia zone.

Sample numbers 5, 6 and 7, are taken from the collapsed adit about 30 m. to the north of the main adit. The skarn at this location is 2.5 m. wide and can be traced up the cliff face for a distance of 10 m. The best result from these samples is 1.83% copper, 0.43 opt silver over 25 cm.

Sample number 4 is a chip sample over 40 cm. taken from a vein 20 meters east of the collapsed adit above. This is thought to be a separate vein from the veins in the adits. The results from this sampling are 3.38% copper and 1.27 opt silver.

Heavy metal concentrates analyses were done on three samples from Elsul Creek. Sample number 1 gave results of 2897 ppb gold in the heavy fraction. This is considered to be a significant anomaly indicating an occurrence of gold mineralization in the Elsul Creek drainage. This mineralization may be on the B.C. Wonder R.C.G. which is not held by this owner or they may be further up the drainage on the Princess, Countess, or Duchess R.C.G.'s or even over on

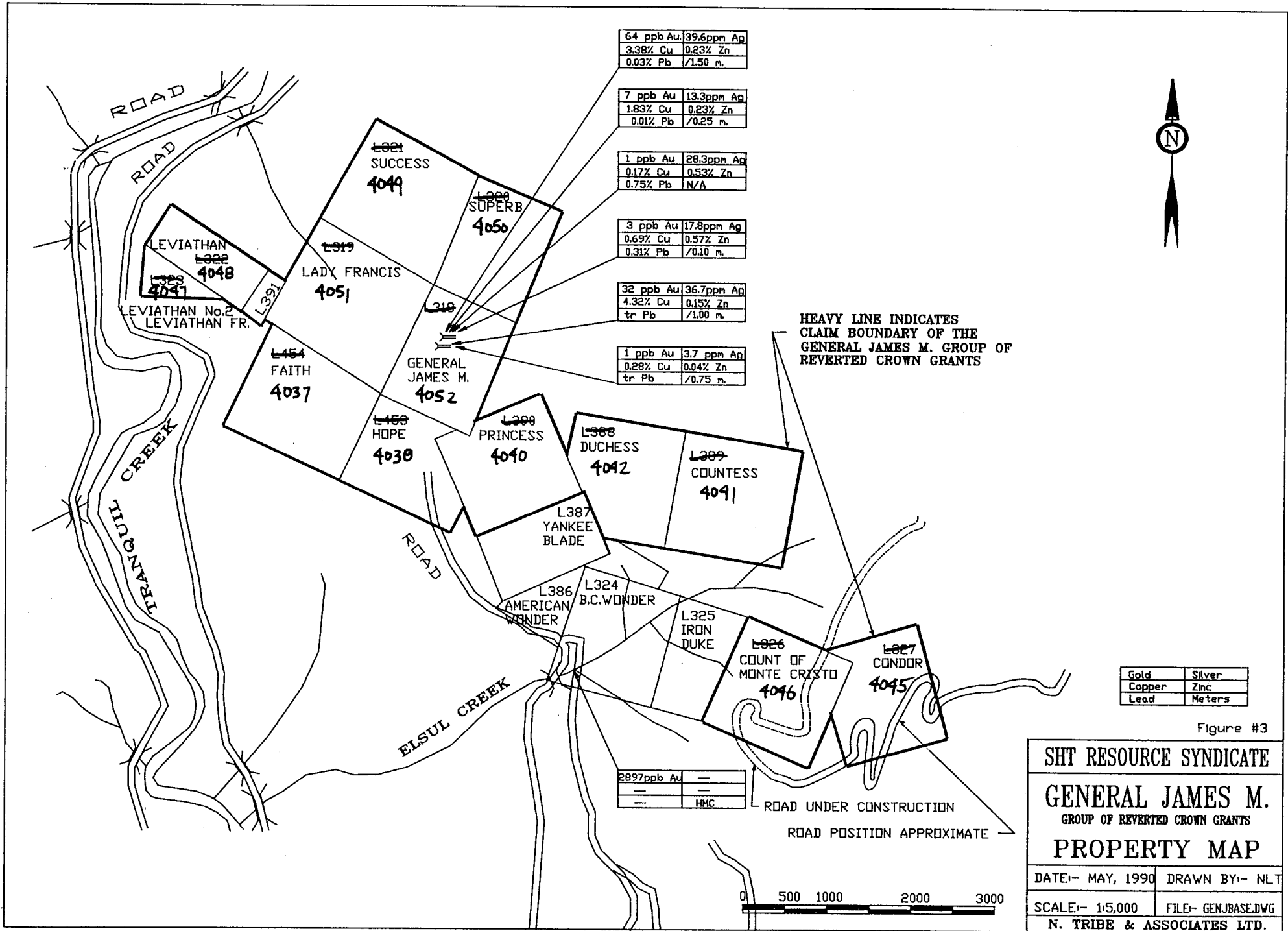

64 ppb Au	39.6ppm Ag
3.38% Cu	0.23% Zn
0.03% Pb	/1.50 m.

7 ppb Au	13.3ppm Ag
1.83% Cu	0.23% Zn
0.01% Pb	/0.25 m.

1 ppb Au	28.3ppm Ag
0.17% Cu	0.53% Zn
0.75% Pb	N/A

3 ppb Au	17.8ppm Ag
0.69% Cu	0.57% Zn
0.31% Pb	/0.10 m.

32 ppb Au	36.7ppm Ag
4.32% Cu	0.15% Zn
tr Pb	/1.00 m.

1 ppb Au	3.7 ppm Ag
0.28% Cu	0.04% Zn
tr Pb	/0.75 m.

HEAVY LINE INDICATES CLAIM BOUNDARY OF THE GENERAL JAMES M. GROUP OF REVERTED CROWN GRANTS

Gold	Silver
Copper	Zinc
Lead	Meters

2897ppb Au	---
---	---
---	HMC

ROAD UNDER CONSTRUCTION
ROAD POSITION APPROXIMATE



Figure #3

SHT RESOURCE SYNDICATE

GENERAL JAMES M. GROUP OF REVERTED CROWN GRANTS

PROPERTY MAP

DATE:- MAY, 1990 DRAWN BY:- NLT

SCALE:- 1:5,000 FILE:- GENJBASE.DWG

N. TRIBE & ASSOCIATES LTD.

the Count of Monte Cristo R.C.G. or Condor R.C.G. all owned by Mr. Hicks.

The significance of this anomaly could easily be overlooked. The important indication is that two areas of gold mineralization are demonstrated along this series of skarns, these being the Pandora Mine and this second occurrence on Elsul Creek. The possibility for still more undiscovered gold mineralization, exists along the 9000 feet of skarnified contact yet to be carefully explored.

Very careful prospecting and plenty of sampling is required to locate the extremely variable and high grade pockets in the typical gold bearing skarn.

TABLE I SAMPLE FROM 1987 WORK

Sample no.	width cm.	Au.(ppb)	Ag.(ppm)	Cu %	Zn %	Pb %
87-1	hmc	2897				
87-2	hmc	n/d				
87-3	hmc	n/c				
87-4	150	64	39.6	3.38	0.23	0.03
87-5	25	7	13.3	1.83	0.39	0.01
87-6	n/a	1	28.3	0.17	0.53	0.75
87-7	10	3	17.8	0.69	0.57	0.31
87-8	100	32	36.7	4.32	0.15	0.00
89-9	75	1	3.7	0.28	0.04	0.00

Note: hmc - heavy mineral concentrate
n/d - non detected
n/a - not applicable

THE 1991 PROGRAM

The 1991 program consisted mainly of reconnaissance, locating the known showings, sampling the numerous less mineralize skarns in the area, mapping and prospecting.

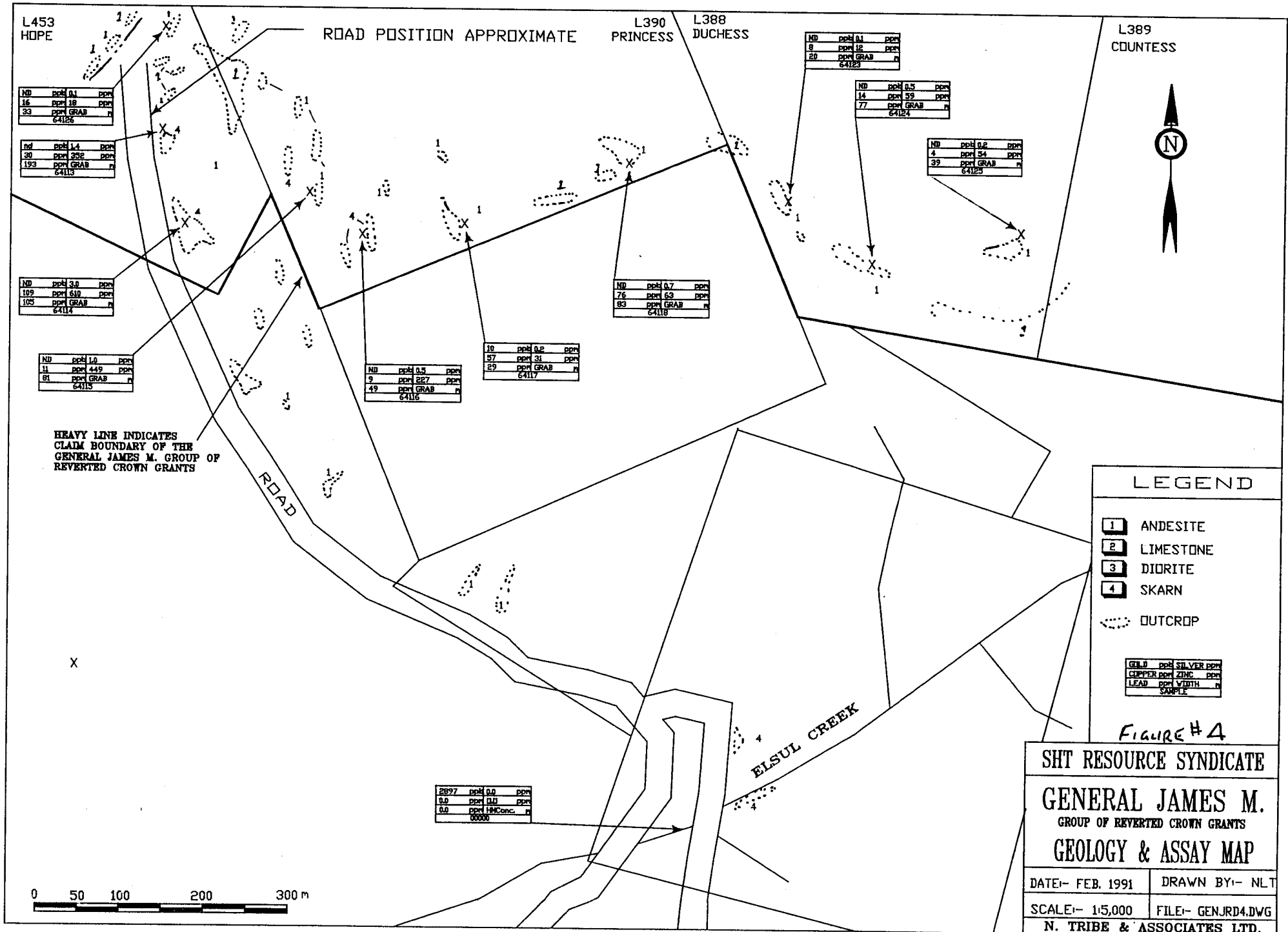
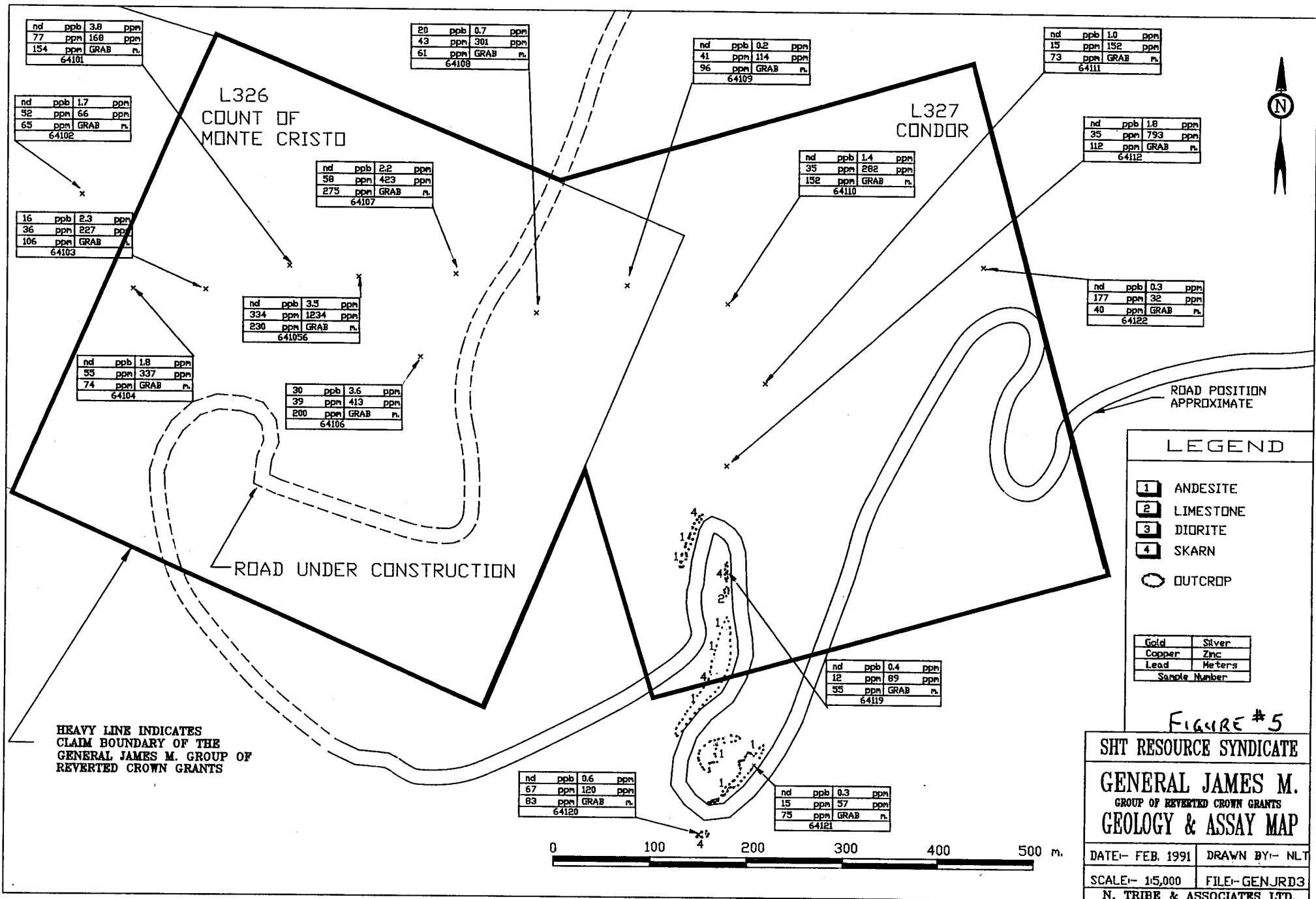

FIGURE #4

SHT RESOURCE SYNDICATE
GENERAL JAMES M.
 GROUP OF REVERTED CROWN GRANTS
GEOLOGY & ASSAY MAP

DATE:- FEB. 1991 DRAWN BY:- NLT
 SCALE:- 1:5,000 FILE:- GENJRD4.DWG
 N. TRIBE & ASSOCIATES LTD.





In all 26 samples were collected and send to Vangeochem for ICP assays and gold geochem assays. The results are included in Appendix I.

The area along the new road presently being built by Macmillan Bloedel was mapped and several samples taken. The rocks varied from andesite, limey sediments, to limestone, which occasionally was altered to skarns of varying intensity. Traces of copper staining was found in some of the road cuts.

Respectfully Submitted

A handwritten signature in cursive script, appearing to be 'M. E. ...', written below the phrase 'Respectfully Submitted'.

STATEMENT OF COSTS

Travel

Feb. 22	Vehicle	Coquihalla toll	10.00
		gas Clearbrook	39.46
		ferry	24.00
Feb. 23		gas Alberni	36.24
Feb. 24		gas Uclulet	30.40
Feb. 26		gas Alberni	24.88
		ferry	24.00
		Coquihalla toll	10.00
		gas Clearbrook	24.00
		gas Kelowna	42.00
		Mileage 1973 km. @ .35	690.55

Accommodation and Meals

Feb. 22		Tyee Motel Alberni	48.30
		meal Clearbrook	11.00
		meal Naniamo	16.37
Feb. 23		Tyee Motel Alberni	48.30
		meal Alberni	11.55
		supplies Alberni	18.32
		meal Alberni	24.00
Feb. 24		Thornton Motel Uclulet	48.30
		meal Alberni	12.50
		meal Uclulet	23.95
Feb. 25		meal Uclulet	7.50
		Tyee Motel Alberni	48.30
		meal Alberni	15.50
Feb. 26		meal Alberni	11.00
		meal Vancouver	12.30
		meal Chilliwack	15.50

Supplies

Feb. 26		B.C. Govt. Maps	31.86
March 18		Copying	12.50
		Mylar 5 sheets	10.00
		Assays	472.94

Total \$1,855.52

Consulting Fees

N. Tribe P. Eng. (\$400/day	Helper C. Tribe (\$80/day)	
February 22, travel		1 day
February 23, reconnaissance field work		1 day
February 24, field work, mapping		1 day
February 25, field work mapping		1 day
prospecting		1 day
February 26, travel		1 day
March 15, reporting		1 day
March 18, reporting		1 day

Total 7 days at \$480/day \$3,360.00

TOTAL COSTS \$5,215.52
.13.

RESUME OF AUTHOR
NORMAN L. TRIBE P.ENG.

- Graduated from the University of British Columbia in 1964 with a B.A.Sc. in Geological Engineering.
- Registered Professional Engineer in the Province of British Columbia.
- President and principal of N. Tribe & Assoc Ltd. a geological contracting company serving the industry for 20 years.
- A total of 26 years experience in most phases of my profession including underground grade control, pit grade control, mine development, mine evaluation, property evaluation, project management, project consultant, exploration management, exploration geology and reporting to the various governments and/or stock exchanges.
- Wide ranging experience throughout the world including postings in the Cordillera, the Canadian Shield (Ontario, Saskatchewan, Manitoba and the N.W.T.), Australia and the Pacific Islands, (Fiji, Misima, P.N.G., Etc.), the Australian Shield, the Guiana Shield, Mexico and Western U.S.A.
- Experience in various mines including Craigmont (Merritt), Eldorado (Beaverlodge), Highland Bell (Beaverdell), Argo (Zortman), Pegasus (Landusky), Lupin (Contwoyto Lake), Scottie Gold (Stewart), Newhawk (Brucejack Lake) Esperanza Gold (Burton) and Edjudina (Australia).
- Spent six months with the Ministry of Energy Mines and Petroleum Resources of British Columbia as Mines Inspector in Kamloops B.C.
- Holder of the following industry related certificates:
 - Underground Shift Boss, U.G. 2029
 - Open Pit Shift Boss, O.P. 811
 - General Blasting Ticket B.C. 37431
 - Blasters Permit, Yukon Territories, 2037
 - Industrial First Aid Ticket, 703669465 (expired)
 - Underground Mine Rescue Ticket, 6642
 - Surface Mine Rescue Ticket, 03969
 - British Columbia Class 5 Drivers Licence 3146483
 - International Drivers Licence
 - Valid Current Canadian Passport

RESUME OF HELPER

C. Tribe

Field assistant with approximately 2 years experience, as soil sampler and geological assistant. Also has approximately 0.5 years in computer drafting.

APPENDIX I

ASSAY CERTIFICATES

ICAP GEOCHEMICAL ANALYSIS

A .5 gram sample is digested with 5 ml of 3:1:2 HCL to HNO₃ to H₂O at 95 °C for 90 minutes and is diluted to 10 ml with water.
 This leach is partial for Al, Ba, Ca, Cr, Fe, K, Mg, Mn, Na, P, Sn, Sr and W.

ANALYST: *Rydell*

REPORT #: 910029 PA N. TRIBE & ASSOCIATES LTD. PROJECT: None Given DATE IN: FEB 27 1991 DATE OUT: MAR 6 1991 ATTENTION: MR. NORM TRIBE PAGE 1 OF 2

Sample Name	Ag	Al	As	Ba	Bi	Ca	Cd	Co	Cr	Cu	Fe	K	Mg	Mn	Mo	Na	Ni	P	Pb	Sb	Sn	Sr	U	W	Zn
	ppm	%	ppm	ppm	ppm	%	ppm	ppm	ppm	ppm	%	%	%	ppm	ppm	%	ppm	%	ppm	ppm	ppm	ppm	ppm	ppm	ppm
64088	0.4	1.75	121	121	15	0.21	5.3	14	18	18	3.75	0.30	0.21	816	9	0.03	26	0.01	66	4	16	6	<5	<3	176
64089	0.3	1.53	95	95	<3	0.21	4.7	10	17	14	3.26	0.37	0.16	763	7	0.03	23	0.01	90	<2	6	6	<5	<3	134
64090	0.7	2.99	129	77	87	0.35	13.8	21	17	41	5.05	0.32	0.40	2069	12	0.02	39	0.01	154	25	74	8	<5	<3	952
64091	1.3	1.41	85	97	<3	0.55	11.1	10	11	15	3.98	0.39	0.16	627	9	0.03	23	0.01	75	<2	6	8	<5	<3	805
64092	0.7	1.24	77	113	<3	0.68	5.0	11	18	11	3.47	0.37	0.12	913	7	0.02	25	0.01	76	<2	<2	12	<5	<3	177
64093	1.6	2.66	139	150	62	0.38	9.6	19	24	110	4.77	0.36	0.32	1831	11	0.02	37	0.01	315	22	56	7	<5	<3	660
64094	0.4	2.02	90	97	43	0.53	7.0	13	12	23	4.51	0.28	0.26	961	9	0.04	27	0.01	83	11	31	12	<5	<3	158
64095	0.7	1.19	49	167	<3	0.11	4.3	7	13	21	2.86	0.37	0.10	1104	8	0.02	18	0.01	127	<2	<2	4	<5	<3	175
64096	9.8	0.82	25	78	<3	0.06	18.3	5	19	931	3.56	0.32	0.03	1645	11	0.01	18	<0.01	1208	<2	<2	2	<5	<3	1787
64097	1.3	1.94	70	102	21	0.06	6.2	14	24	138	3.82	0.38	0.23	2191	9	0.02	26	0.01	527	7	20	3	<5	<3	337
64098	>50.0	0.39	<3	<1	679	1.81	897.2	<1	<1	>20000	>10.00	0.03	0.30	9876	13	<0.01	75	<0.01	16255	455	842	6	<5	<3	>20000
64099	>50.0	1.80	49	144	18	0.11	26.1	6	16	1366	3.66	0.35	0.20	1184	8	0.03	23	<0.01	1217	19	45	6	<5	<3	2305
64100	3.1	1.80	65	133	5	0.28	11.4	8	11	106	3.98	0.44	0.15	841	9	0.06	23	<0.01	255	3	13	19	<5	<3	908
64101	3.8	0.90	53	107	<3	0.02	4.2	2	31	77	3.41	0.46	0.02	125	10	0.02	17	<0.01	154	<2	<2	3	<5	<3	168
64102	1.7	1.01	31	63	<3	0.14	4.2	8	5	52	3.80	0.53	0.04	119	7	0.01	19	0.01	65	<2	<2	4	<5	<3	66
64103	2.3	1.59	77	152	<3	0.10	6.0	7	9	36	3.82	0.44	0.16	1195	8	0.03	20	0.01	106	<2	7	4	<5	<3	227
64104	1.8	1.71	56	159	11	0.22	6.3	13	8	55	3.90	0.39	0.18	2143	10	0.02	21	0.01	74	3	12	10	<5	<3	337
64105	3.5	1.31	48	163	<3	0.16	13.6	10	9	334	3.89	0.53	0.09	1426	11	0.01	19	0.01	230	<2	<2	7	<5	<3	1234
64106	3.6	0.62	47	11	44	0.02	10.6	9	14	39	7.56	0.40	<0.01	19	6	0.02	37	<0.01	200	<2	4	4	<5	<3	413
64107	2.2	1.35	49	64	6	0.08	6.8	12	16	58	4.40	0.41	0.12	640	7	0.02	33	<0.01	275	<2	5	4	<5	<3	423
64108	0.7	0.78	24	114	<3	0.02	4.4	4	14	43	2.56	0.39	0.04	78	6	0.02	18	<0.01	61	<2	<2	3	<5	<3	301
64109	0.2	1.24	38	99	<3	0.05	4.5	6	6	41	3.45	0.41	0.13	329	7	0.03	20	0.01	96	<2	<2	11	<5	<3	114
64110	1.4	0.89	30	93	<3	0.03	3.9	4	12	35	1.99	0.42	0.06	284	6	0.02	12	<0.01	152	19	<2	3	<5	<3	282
64111	1.0	1.01	29	107	<3	0.02	2.9	4	12	15	1.89	0.46	0.07	264	8	0.02	13	<0.01	73	<2	<2	4	<5	<3	152
64112	1.6	0.94	26	79	<3	0.28	10.4	5	20	35	2.63	0.43	0.06	322	16	0.02	17	<0.01	112	<2	<2	4	<5	<3	793
64113	1.4	0.88	28	66	<3	0.12	5.2	5	13	30	2.97	0.43	0.06	280	6	0.02	14	<0.01	193	<2	<2	3	<5	<3	352
64114	3.0	0.95	83	100	<3	0.11	9.4	8	10	109	3.40	0.43	0.02	1203	5	0.02	25	<0.01	105	<2	<2	5	<5	<3	610
64115	1.0	0.85	37	93	<3	4.23	7.3	4	35	11	2.03	0.37	0.07	1616	6	0.01	19	<0.01	81	<2	<2	79	<5	<3	449
64116	0.5	0.99	56	160	<3	0.47	7.0	9	22	9	2.34	0.42	0.05	1135	5	0.02	23	<0.01	49	<2	<2	9	<5	<3	227
64117	0.2	0.77	12	15	<3	0.64	2.2	12	39	57	2.10	0.08	0.06	420	5	0.10	17	<0.01	29	<2	<2	14	<5	<3	31
64118	0.7	3.22	45	40	73	0.75	4.4	15	13	76	5.48	0.34	0.26	830	20	0.14	29	<0.01	83	24	94	13	<5	<3	63
64119	0.4	1.68	32	18	44	0.46	4.9	13	30	12	3.55	0.10	0.33	924	9	0.09	19	<0.01	55	8	44	5	<5	<3	89
64120	0.6	2.87	105	11	110	0.52	6.5	25	3	67	5.84	0.06	0.40	1265	11	0.08	32	<0.01	83	30	97	7	<5	<3	120
64121	0.3	2.94	43	19	28	1.73	2.5	13	16	15	3.09	0.16	0.28	824	10	0.06	19	0.01	75	18	58	11	<5	<3	57
64122	0.3	1.36	32	225	<3	0.49	2.8	12	48	177	1.42	0.05	0.25	170	11	0.08	35	<0.01	40	<2	<2	6	<5	<3	32
64123	0.1	0.60	9	53	<3	0.17	0.8	3	45	8	0.69	0.16	0.04	293	3	0.08	7	<0.01	20	<2	<2	18	<5	<3	12
64124	0.5	3.00	40	29	6	2.56	1.8	13	15	14	3.03	0.09	0.20	672	10	0.11	17	0.01	77	16	60	67	<5	<3	59
64125	0.2	1.41	28	54	<3	0.07	2.3	4	46	4	1.34	0.20	0.23	508	7	0.06	12	<0.01	39	<2	<2	3	<5	<3	54
64126	0.1	1.21	16	54	<3	0.70	0.8	4	38	16	0.89	0.17	0.08	329	6	0.10	9	0.01	33	<2	<2	6	<5	<3	18

Minimum Detection 0.1 0.01 3 1 3 0.01 0.1 1 1 1 1 0.01 0.01 0.01 1 1 0.01 1 0.01 2 2 2 1 5 3 1
 Maximum Detection 50.0 10.00 2000 1000 1000 10.00 1000.0 20000 1000 20000 10.00 10.00 10.00 20000 1000 10.00 20000 10.00 20000 2000 2000 1000 10000 100 1000 20000
 < - Less Than Minimum > - Greater Than Maximum is - Insufficient Sample ns - No Sample ANOMALOUS RESULTS - Further Analyses By Alternate Methods Suggested.

REPORT NUMBER: 910029 GA

JOB NUMBER: 910029

N. TRIBE & ASSOCIATES LTD.

PAGE 1 OF 2

SAMPLE #	Au
	ppb
64088	nd
64089	nd
64090	nd
64091	50
64092	nd
64093	nd
64094	nd
64095	nd
64096	10
64097	nd
64098	1500
64099	130
64100	nd
64101	nd
64102	nd
64103	10
64104	nd
64105	nd
64106	30
64107	nd
64108	20
64109	nd
64110	nd
64111	nd
64112	nd
64113	nd
64114	nd
64115	nd
64116	nd
64117	10
64118	nd
64119	nd
64120	nd
64121	nd
64122	nd
64123	nd
64124	nd
64125	nd
64126	nd

DETECTION LIMIT

5

nd = none detected

-- = not analysed

is = insufficient sample