

ARIS SUMMARY SHEET

District Geologist, Victoria

Off Confidential: 91.12.19

ASSESSMENT REPORT 21137

MINING DIVISION: New Westminster

PROPERTY: Margie  
LOCATION: LAT 49 25 00 LONG 121 26 00  
UTM 10 5474737 613632  
NTS 092H06W  
CLAIM(S): Margie  
OPERATOR(S): Manex Cons.  
AUTHOR(S): Amendolagine, E.  
REPORT YEAR: 1991, 19 Pages  
KEYWORDS: Paleozoic, Hozameen Group, Greenstone, Cretaceous-Tertiary, Intrusions  
Eocene, Conglomerate  
WORK  
DONE: Prospecting  
PROS 250.0 ha  
RELATED  
REPORTS: 08827, 10039, 13190, 14349, 17196, 18607

LOG NO: SEP 27 1991	RD. A
ACTION: <del>WASH FROM</del> <del>MANUAL</del>	
FILE NO:	

LOG NO: March 26/91	RD.
ACTION:	
FILE NO:	

GEOLOGICAL AND AIR PHOTO STUDY

ON THE

MARGIE (12) REC. NO. 752

IN THE

SCHKAM LAKE AREA

NEW WESTMINSTER MINING DIV.

OF

BRITISH COLUMBIA

DURING PERIOD OF

MAY - DECEMBER 1990

49° 25' NORTH LATITUDE

121° 26' WEST LONGITUDE

NTS 92H/6W

SUB-RECORDER RECEIVED	
SEP 13 1991	
M.R. #	\$
VANCOUVER, B.C.	

SUB-RECORDER RECEIVED	
MAR 21 1991	
M.R. #	\$
VANCOUVER, B.C.	

GEOLOGICAL BRANCH  
ASSESSMENT REPORT

21,137

March 19, 1991

MANEX CONSULTANTS LTD.  
by: EMANUEL AMENDOLAGINE, P.Eng.

## TABLE OF CONTENTS

	<u>PAGE</u>
<b>INTRODUCTION</b>	1 /
Property	2 /
Location and Access	2 /
<b>GEOLOGY</b>	6 /
<b>GEOLOGICAL MAPPING AND STUDY PROGRAM</b>	6 /
Eocene Conglomerate	6 /
Cretaceous - Yale Intrusive	12 /
Paleozoic-Hozameen Group	12 /
<b>CONCLUSION</b>	15 /
<b>CERTIFICATE</b>	16 /
<b>COST BREAKDOWN</b>	17 /
<b>MAPS &amp; PHOTOGRAPHS</b>	
Claim Map	3 /
Topographic Claim Map	4 /
Airphoto Map	5 /
Geology Map	8 /
Eocene Conglomerate on side Road E of Initial Post (Photo)	9 /
Eocene Conglomerate on Side Road E of Initial Post (Photo)	10 /
Eocene Conglomerate of Road N of Initial Post (Photo)	11 /
Two Intrusives into Paleozoic-Hozameen (Photo)	13 /
Garbage Dump Road Two Intrusives Upper Left (Photo)	13 /
Lower Intrusive into Hozameen (Photo)	14 /
Upper Intrusive into Hozameen N 80°E 85°S (Photo)	14 /

## INTRODUCTION

During the period of May to December 1990 the program on the Margie claim was to map the locations of the Eocene conglomerate, the Yale intrusive formation and to study the aerial photographs for geological information.

The controls for the program were the blown-up aerial photographs, the line grid and the maze of roads and trails.

These were used as controls for the traverses.

### Property

The Margie Claim 752 (12) consisting of 12 units is located in the NEW WESTMINSTER Mining Division of British Columbia (NTS, 92H/6W). The anniversary date of the Margie claim is 21 December 1979.

### Location and Access

The legal corner post is located at the southwestern corner of the property, 1.5 km due north of Hope, B.C. on a side road off Highway #1. See Geology Map.

The claim is west of the Fraser river.

The geographical coordinates are  $49^{\circ} 25'$  north latitude,  $121^{\circ} 26'$  west longitude.

Access is gained by traveling 2.5 km north of Hope, B.C. on Highway #1. The highway runs north easterly through the northwestern portion of the claim.

Gravel roads and trails give some access to the rest of the property.

The Hope garbage dump is on the north eastern unit of the claim.

The claim map and road map are enclosed.

The following maps are:

1. Claim Map M92 H/6 W
2. Topographic Claim Map
3. Airphoto Map
4. Geology
5. Line Grid
6. Five Photographs

121° 30'

49° 30'

M 92 H/6 W

(FOR PLACER SEE P. 92H/6W)

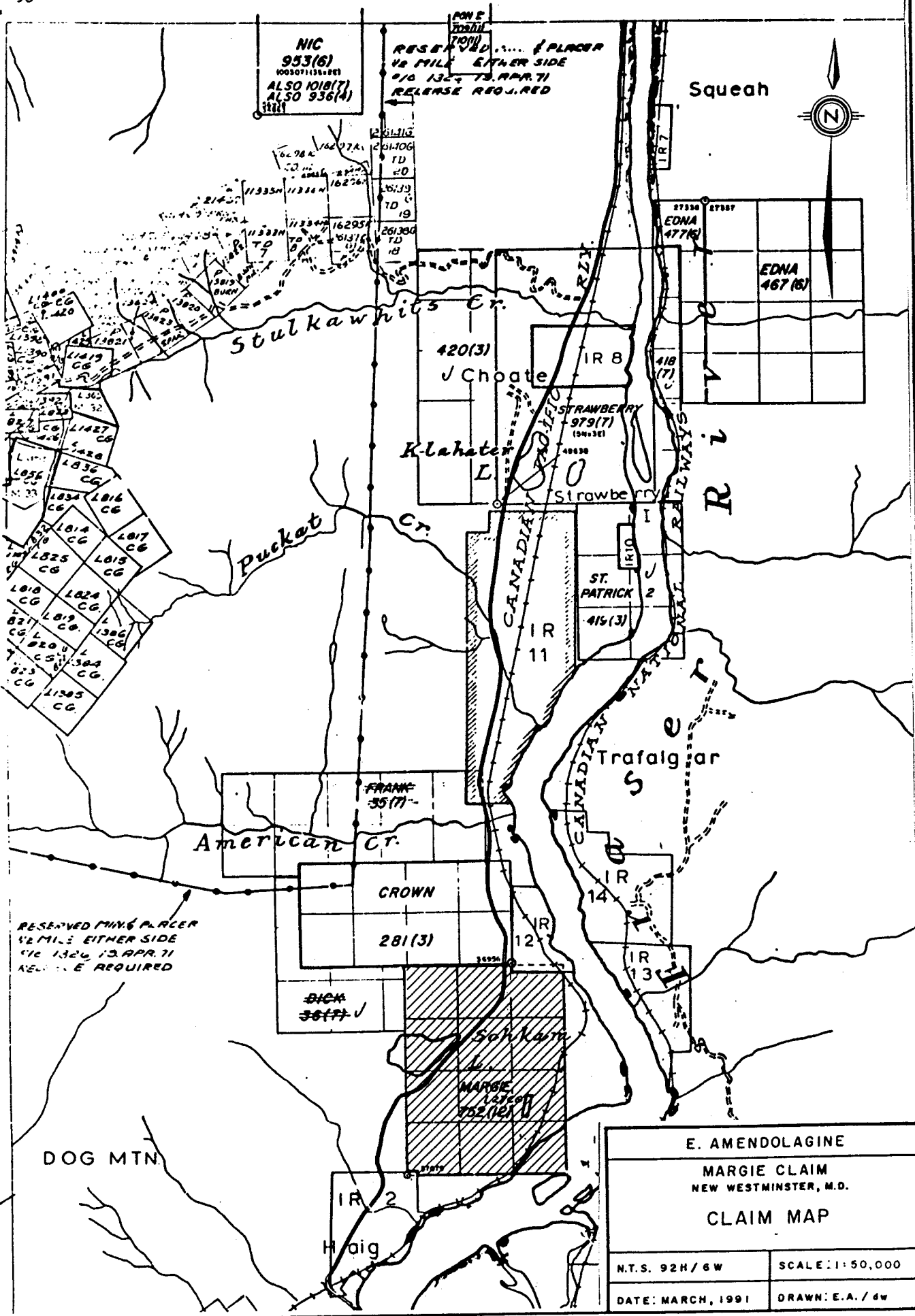

NIC  
933(6)  
1003071(5) (20)  
ALSO 1018(7)  
ALSO 936(4)  
10224

RESERVED MINING PLACER  
1/2 MILE EITHER SIDE  
P/O 1326 13 APR 71  
RELEASE REQUIRED

Squeah



RESERVED MINING PLACER  
1/2 MILE EITHER SIDE  
P/O 1326 13 APR 71  
RELEASE REQUIRED



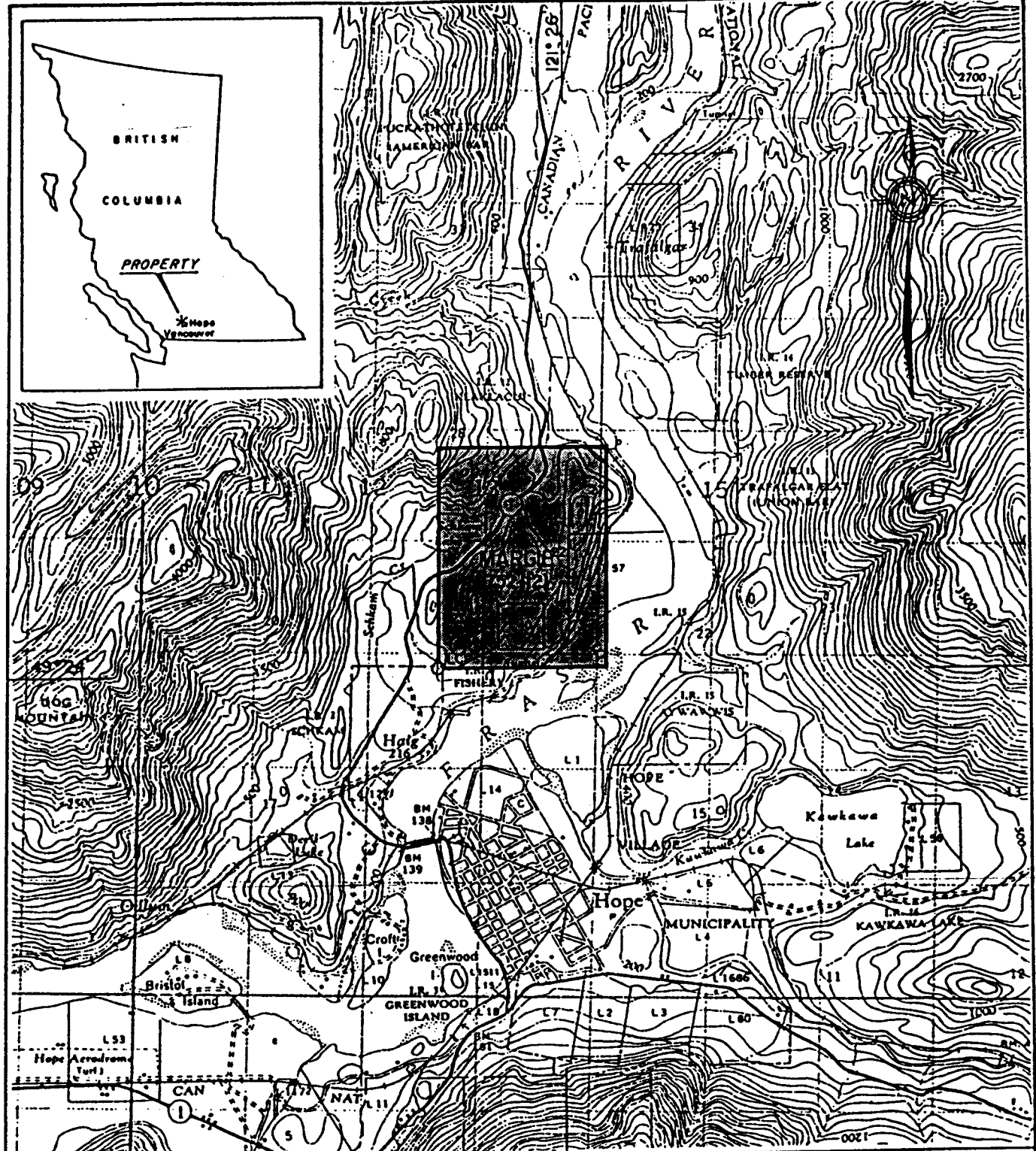

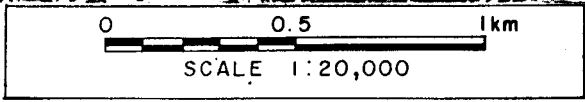

E. AMENDOLAGINE	
MARGIE CLAIM NEW WESTMINSTER, M.D.	
CLAIM MAP	
N.T.S. 92H/6W	SCALE: 1:50,000
DATE: MARCH, 1991	DRAWN: E.A./dw



E. AMENDOLAGINE				
MARGIE CLAIM				
NEW WESTMINSTER M.D.				
<b>TOPOGRAPHIC CLAIM MAP</b>				
DATE:	SCALE:	DRAWN BY:	JOB No.:	MAP No.
MAR. 1991	1:50,000	K. K.	84-59	1



LEGEND

-  FLIGHT LINES
-  5 SECOND INTERVALS
-  CLAIM BOUNDARIES
-  LEGAL CLAIM POST
-  TOTAL MAGNETIC FIELD INTENSITY CONTOURS - gammas
-  HIGH SPATIAL FREQUENCY MAGNETIC RESPONSES - amplitude
-  ULF-EM ANOMALIES - % change

INSTRUMENTS

- SABRE AIRBORNE MAGNETOMETER
- SABRE AIRBORNE ULF-EM ECTF MAGNETOMETER
- 100 M CREEK, WASHINGTON 95 KHz
- 11 ANNAPOLIS, MARYLAND 2.4 KHz

E. AMENDOLAGINE	
MARGIE CLAIM NEW WESTMINSTER, M.D.	
AIRPHOTO MAP	
N.T.S. 92H/6W	SCALE: 1:20,000
DATE: MARCH, 1991	DRAWN: E.A./dw



## GEOLOGY

The claim area is underlain mainly by highly schistose sedimentary and volcanic rocks of the Chilliwack Group of Carboniferous Age. The sediments have been altered to quartz-biotite or quartz hornblende schists. The volcanics have been altered to hornblende or chlorite-carbonite schists. Ref. G.S.C. Cairnes (Map 737 A).

The Paleozoic schists display well developed quartz gneiss.

The Paleozoic schists to the north of the property are intruded by plutonic coarse grained quartz diorite to gneisses. In places these are highly sheared and altered.

## GEOLOGICAL MAPPING AND STUDY PROGRAM

The purpose of this program was to outline the Eocene conglomerate formation and the Cretaceous Yale intrusive. A total of ten man days was spent on the property.

The geological legend of the claim areas is:

<u>Eocene</u>	Conglomerate, sandstone argillite (Allenby formation of Princeton Group). These could include Hozameen and Yale intrusive group.
<u>Cretaceous</u>	Yale intrusion early Tertiary intrusions of granodiorite and intermediate composition.
<u>Late Paleozoic</u>	Hozameen group of green stone, chert-argillite.

The geological mapping consisted of traverses across the property mainly in an east west direction.

The control used was the blow up aerial photograph, the existing survey grid lines and the trails (shown as roads in the photograph) and forestry map. Most of the trails or roads have heavy growth and overburden. The property area is covered with light to heavy overburden. Traverses were also made on the periphery of the claim along the southern boundary and along the railroad track to the east of the claim.

### Eocene Conglomerate

There is a narrow strip along the western boundary of the Margie claim that is a Eocene age conglomerate. This is composed of materials derived from the older formations.

This conglomerate can be seen along the road some 600m to the north some 150m to the south and some 100m to east of the initial claim post.

There is no visible contact either on the east or west part of the conglomerate formation. The conglomerate can be seen mainly on the road. Traverses eastward from the road indicated the conglomerate being present some 100 meters along the south boundary of the claim. This belt strikes north-north westerly across the road some 600 meters north of the initial claim post.

No visible contacts were observed of the conglomerate either east, west, north or south.

The conglomerate is visible mainly in road cuts. Over burden coverage generally obscures the conglomerate and contact. Generally the round pebbles and boulders in the over burden indicates the presence of the conglomerate.



This is the only area of conglomerate on the property below Schkam lake.

The following is the geologic map and three colored pages of conglomerate formation taken north and east of the initial post.

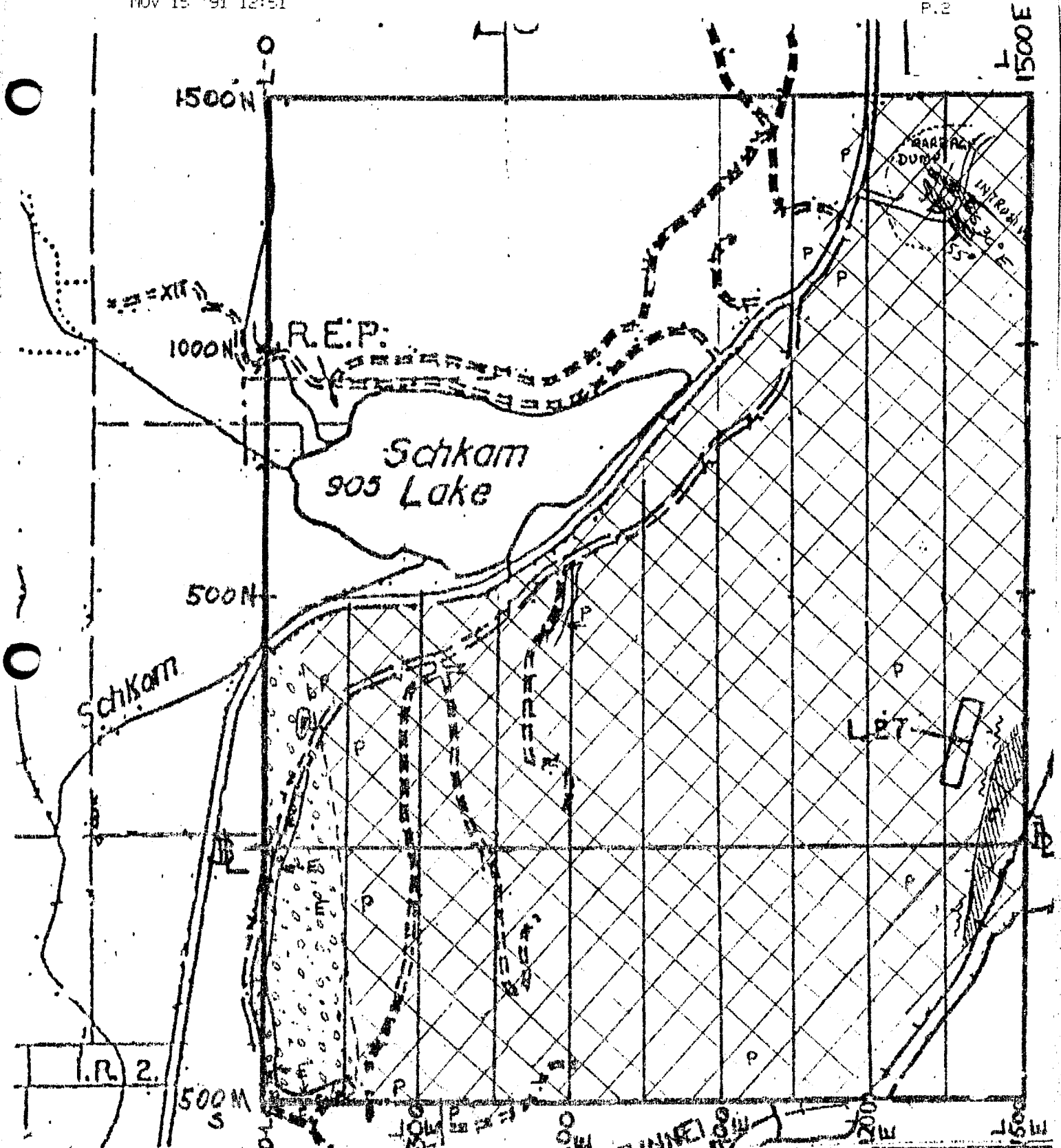
A plan of the line grid is also enclosed.



LEGEND

- EOCENE  Conglomerate, Sandstone
- CRETACEOUS  Yala Intrusive
- PALEOZOIC  Hexamen Group

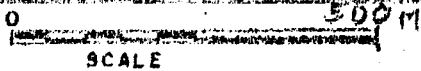

E. AMENDOLAGINE

MARGIE CLAIM  
NEW WESTMINSTER, N.D.

GEOLOGY MAP  
LINE GRID

N.T.S. 32K/8W	SCALE: 1"
DATE: MARCH, 1991	DRAWN: S.A./G.W.

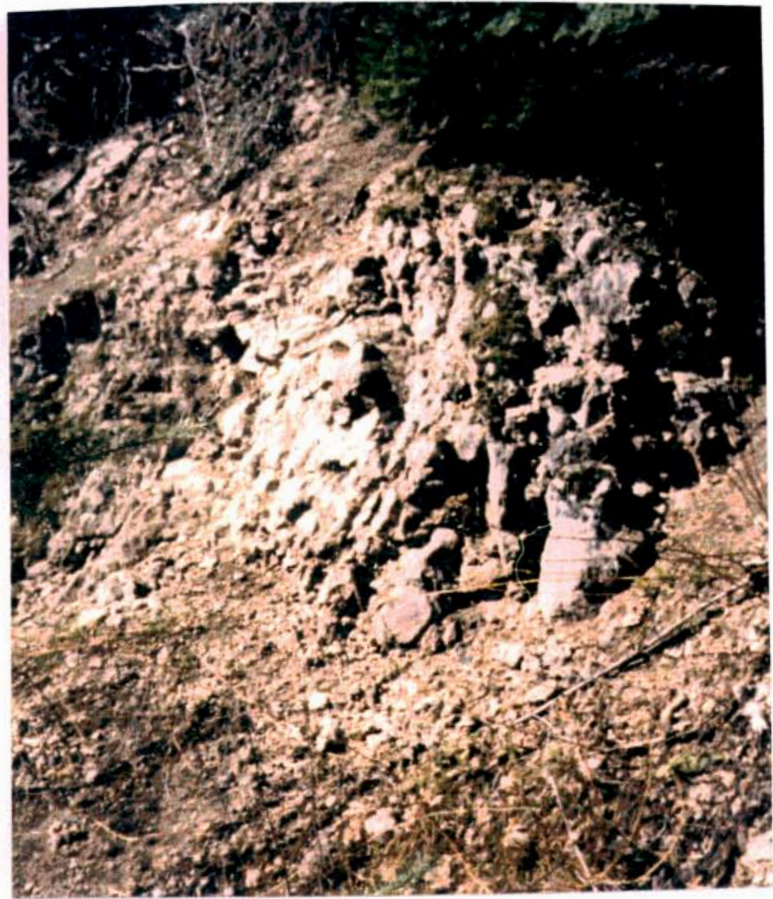
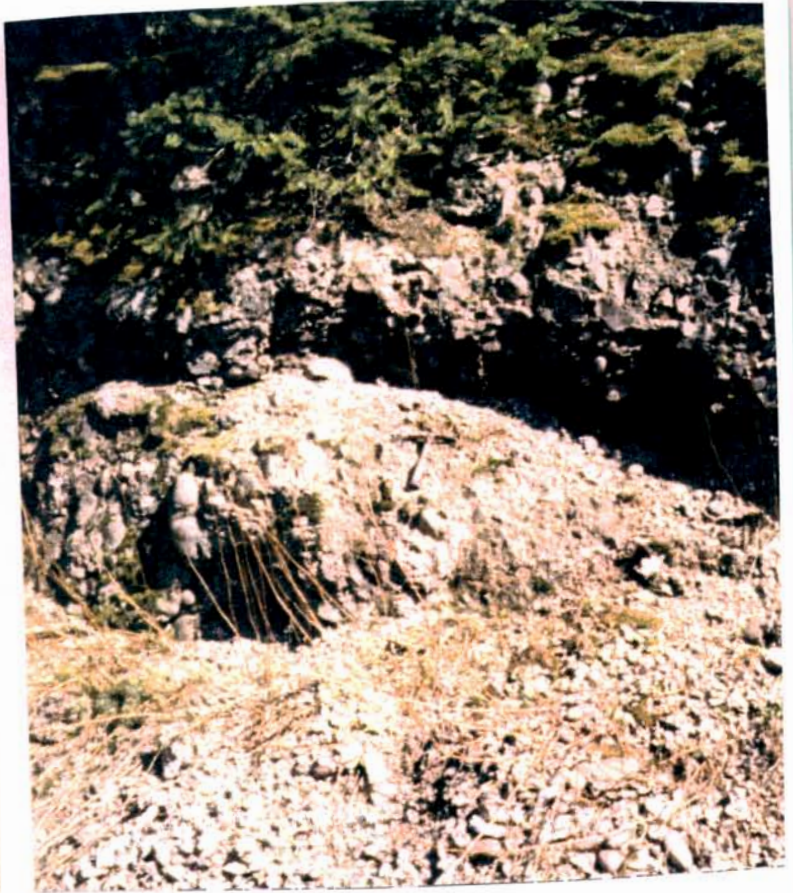

EOCENE CONGLOMERATE  
ON SIDE ROAD E OF INITIAL POST

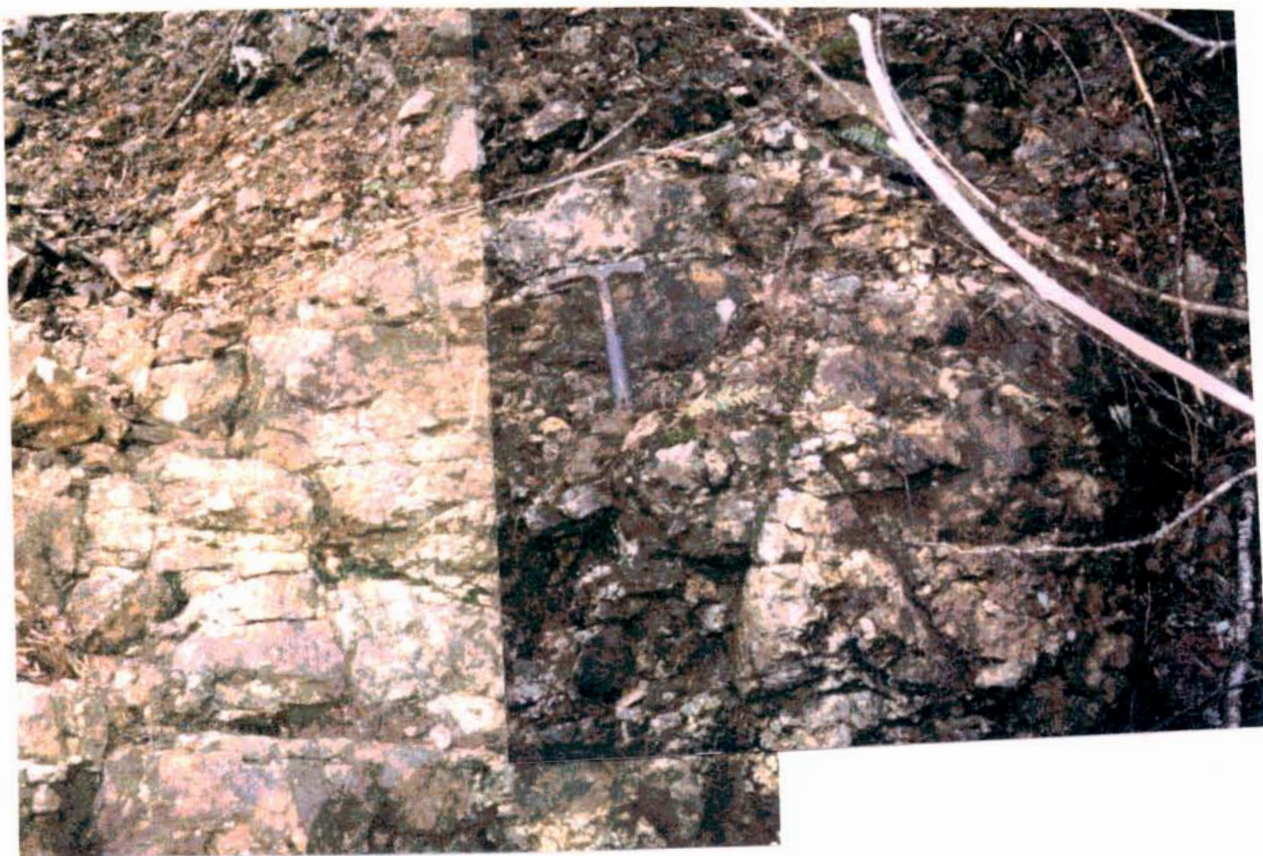

EOCENE CONGLOMERATE  
ON SIDE ROAD E OF INITIAL POST



EOCENE CONGLOMERATE  
OF ROAD N OF INITIAL POST

### Cretaceous - Yale Intrusive

The Yale intrusive-cretaceous age is present on the east boundary of the claim.

It is exposed from line 14+50E to approximately line 15+00E from 1+50S to 1+50N.

This is a limited formation cut off by a steep embankment of some 100 meters drop to the railroad on the east and by north easterly fault on its west boundary.

This Yale intrusive measures some 50 meters in width and can be followed for some 300 meters in a northerly strike.

### Paleozoic-Hozameen Group

The Hozameen group of rocks covers the major portion of the Margie claim. This geologic study will be another project.

During this current study some intrusives were observed in the southern portion of the claim and at the garbage dump in the north eastern part of the claim. The two colored pages show the intrusive. Both pictures are looking east.

The one picture shows the road leading to the intrusives in the upper left hand corner. The top picture with the truck in it show the two intrusives. One is at the truck tail gate and the other is some 10m to the right. The second picture which is all blue shows the upper intrusive which is the one at the truck tail gate and the lower intrusive is the one 10m behind the truck. They strike N80°E and dip 85°S.



TWO INTRUSIVES INTO PALEOZOIC - HOZAMEEN



GARBAGE DUMP ROAD TWO INTRUSIVES UPPER LEFT



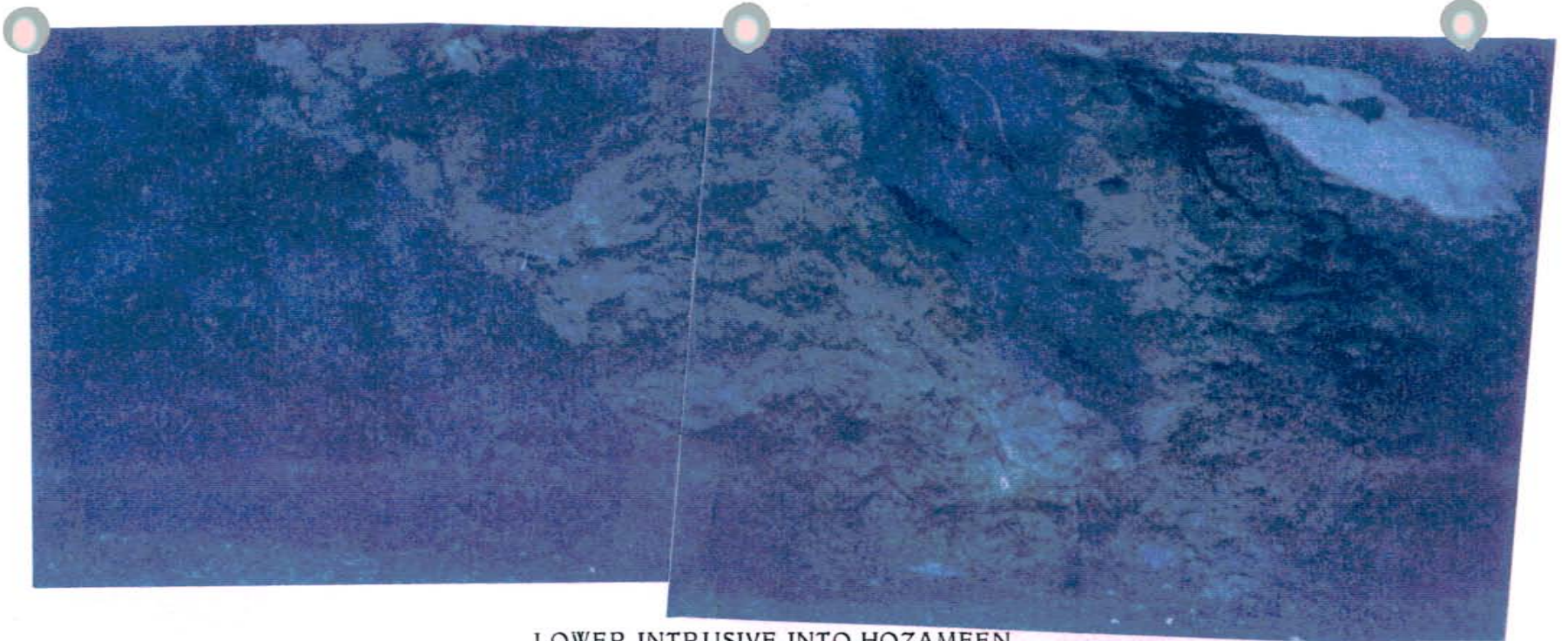

LOWER INTRUSIVE INTO HOZAMEEN

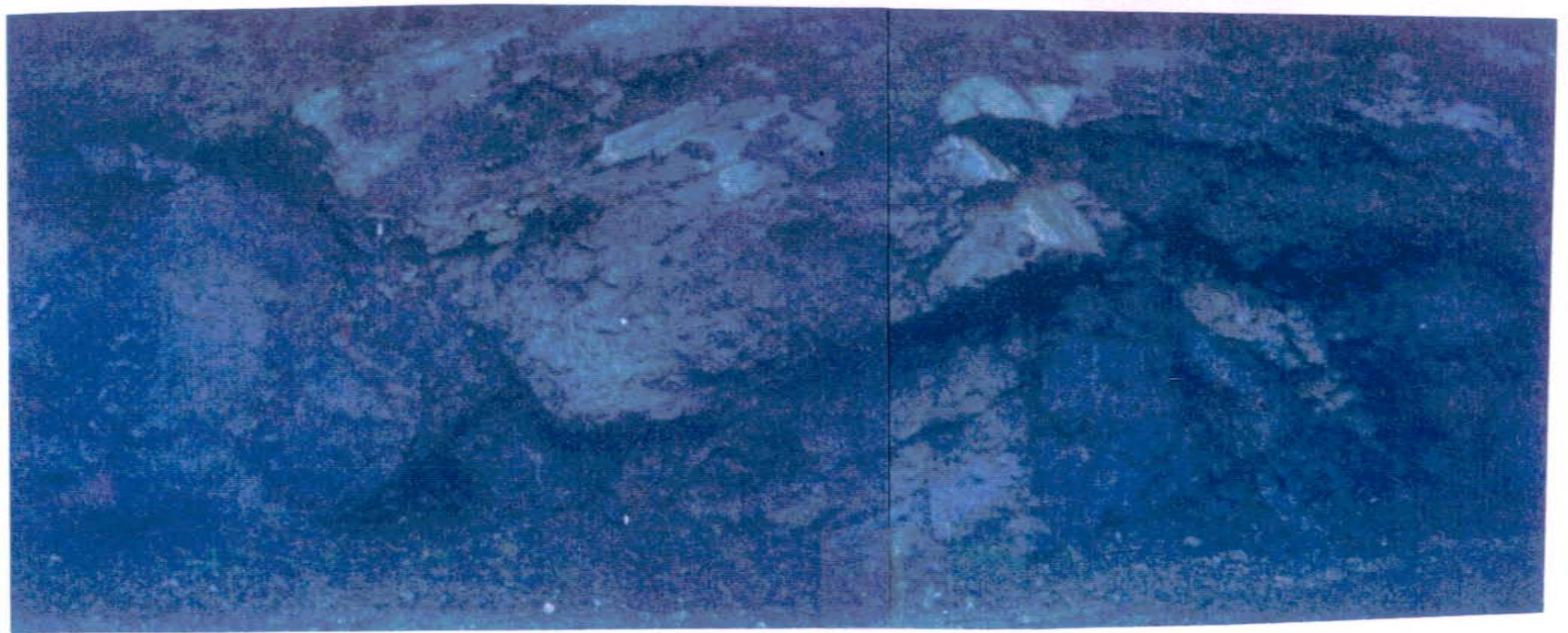

UPPER INTRUSIVE INTO HOZAMEEN N 80°E 85°S

**CONCLUSION**

The property area is covered mostly with heavy bush and over burden making it difficult to map.

The major portion of the claim is underlain by the Hozameen Group of rocks.

A tight detail geological survey has to be carried out to map the Hozameen Group.

Respectfully submitted,

**MANEX CONSULTANTS LTD.**

March 19, 1991

  
Emanuel Amendolagine, P.Eng.

**CERTIFICATE**

I, Emanuel Amendolagine, of the City of Vancouver, province of British Columbia, hereby certify:

1. That I am a geologist and reside in Vancouver, British Columbia.
2. That I am a graduate of Hunter College, City of New York, and Columbia University, with a B.A. and M.A., respectively, and that I have been practising my profession as a geologist for 35 years.
3. That I am a Professional Engineer in the Province of British Columbia.

**DATED AT VANCOUVER, BRITISH COLUMBIA** this 15 day of March 19, 1991.

  
\_\_\_\_\_  
E. Amendolagine, P.Eng.

**COST BREAKDOWN**

<b>Personnel</b>	<b>Dates</b>	<b>Rate</b>	
Manny Amendolagine, Geol.	May 27, Sept. 30 Nov. 15, Dec. 10-11	5/D @ \$400	\$ 2,000.00
D. Olson, Geol.	Sept. 30, Dec. 10-11	3/D @ \$200	600.00
I. Coulter, Fld. Ass.	May 27	1/D @ \$150	150.00
Ken Edwards, Prospector	Nov. 15	1/D @ \$200	200.00
Room & Board			550.00
Supplies			475.00
Trans. 4			600.00
Report			<u>800.00</u>
		Total	<u><u>\$ 5,375.00</u></u>