

KAM CLAIM
Wood Group
Kamloops M.D.

21608

ASSESSMENT REPORT
on
LINE CUTTING
IN PREPARATION FOR AN I.P. SURVEY

CONDUCTED IN THE
WOOD GROUP
NTS
92I/10E & 92I/9W
Lat $50^{\circ} 36' N$ Long $120^{\circ} 43' W$

Owned and Operated
by
Charles Boitard

Author:
Charles Boitard
August 12, 1991
Vancouver, B.C.

LOG NO: AUG 29 1991	RD.
ACTION:	
FILE NO:	Page

TABLE OF CONTENTS

INTRODUCTION

(i)	General geographic and physiographic position and access to claims	1,2
(ii)	Property definition, current owner and operator	2
(iii)	Claims on which assessment work was performed	2
	SUMMARY	3
	STATEMENT OF COSTS	4

ILLUSTRATIONS

Figure 1	Location Map	
Figure 2	Claim Map	
Figure 3	Grid Location	
Figure 4	Access Sketch	
Figure 5	Line Cutting Map	1:10,000

GEOLOGICAL BRANCH
ASSESSMENT REPORT

21,608

INTRODUCTION

(i) The Wood Group is owned by Charles Boitard.

The property is situated at a latitude of $50^{\circ} 36'$ and longitude of $120^{\circ} 32'$, 6 kilometers south of Afton Mine in the Kamloops area.

The property is drained by Cherry Creek and Alkali Creek (fig 1 & 2).

Access to the claim group is gained by the Trans-Canada Highway (Kamloops-Cache Creek) then turning off via Greenstone Mtn. Road 16 km. from Kamloops, then turning left from Greenstone Mtn. Road to an old logging road 6 km. from the junction of the Trans-Canada Highway and Greenstone Mtn. Road, then driving on the old logging road for 1.5 km. before entering the claim group. The property is also accessible from the Coquihalla Highway by using the Inks Lake exit 12 km. from Kamloops, then driving west on old logging roads for another 7 km. to the east side of Wood #5 (see attached sketch, fig. 4).

The area was logged 30 to 40 years ago and is covered by a network of old roads and skid trails giving access to all parts of the property. The vegetation is partly grassland and forest, groves of pine and fir trees occur throughout the property with some poplar and a considerable amount of underbrush. The topography is low to moderate with elevation ranging from 910 meters to 1310 meters.

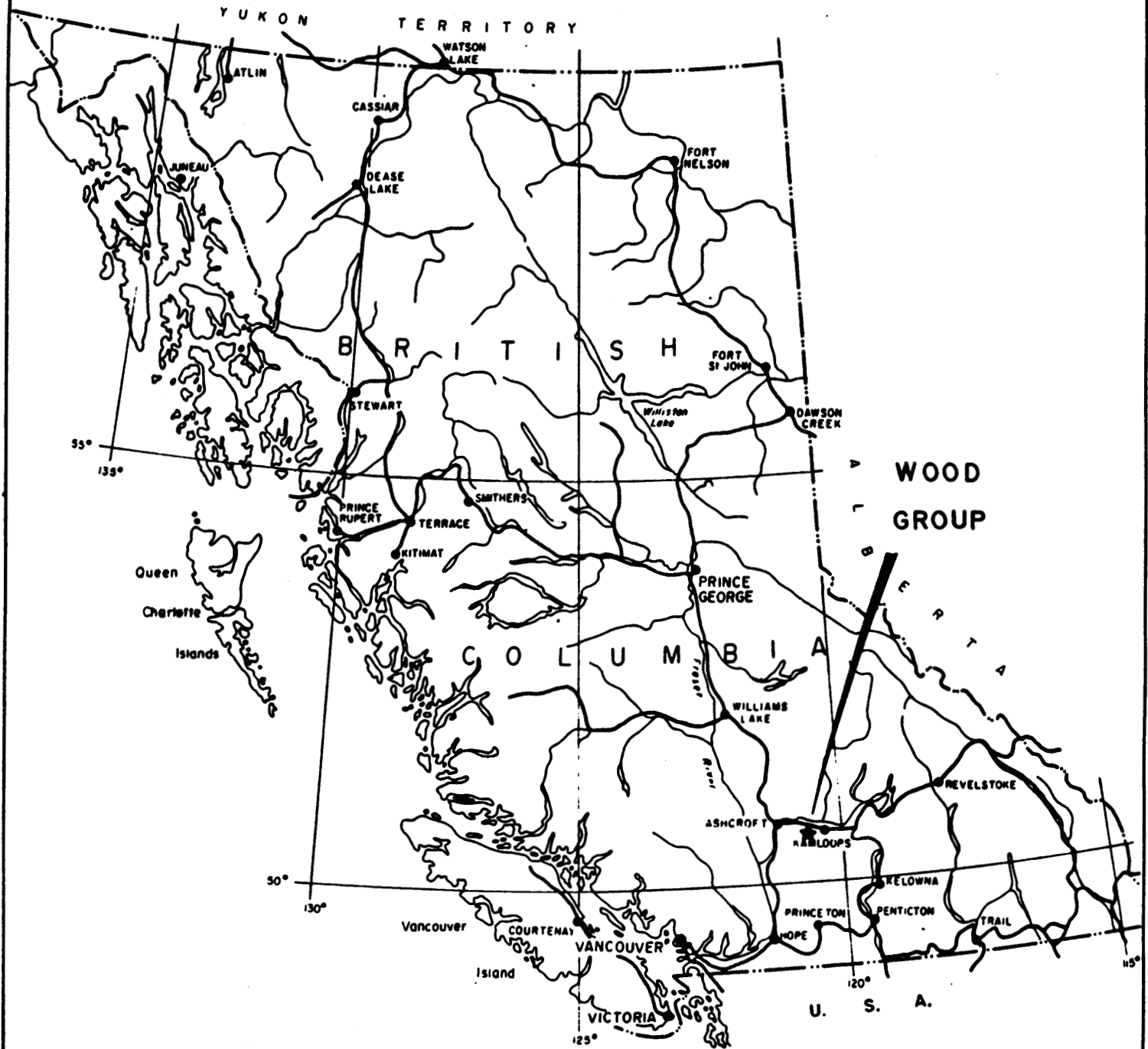

WOOD GROUP

LOCATION MAP

Fig 1

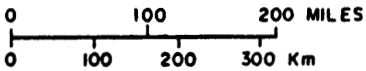

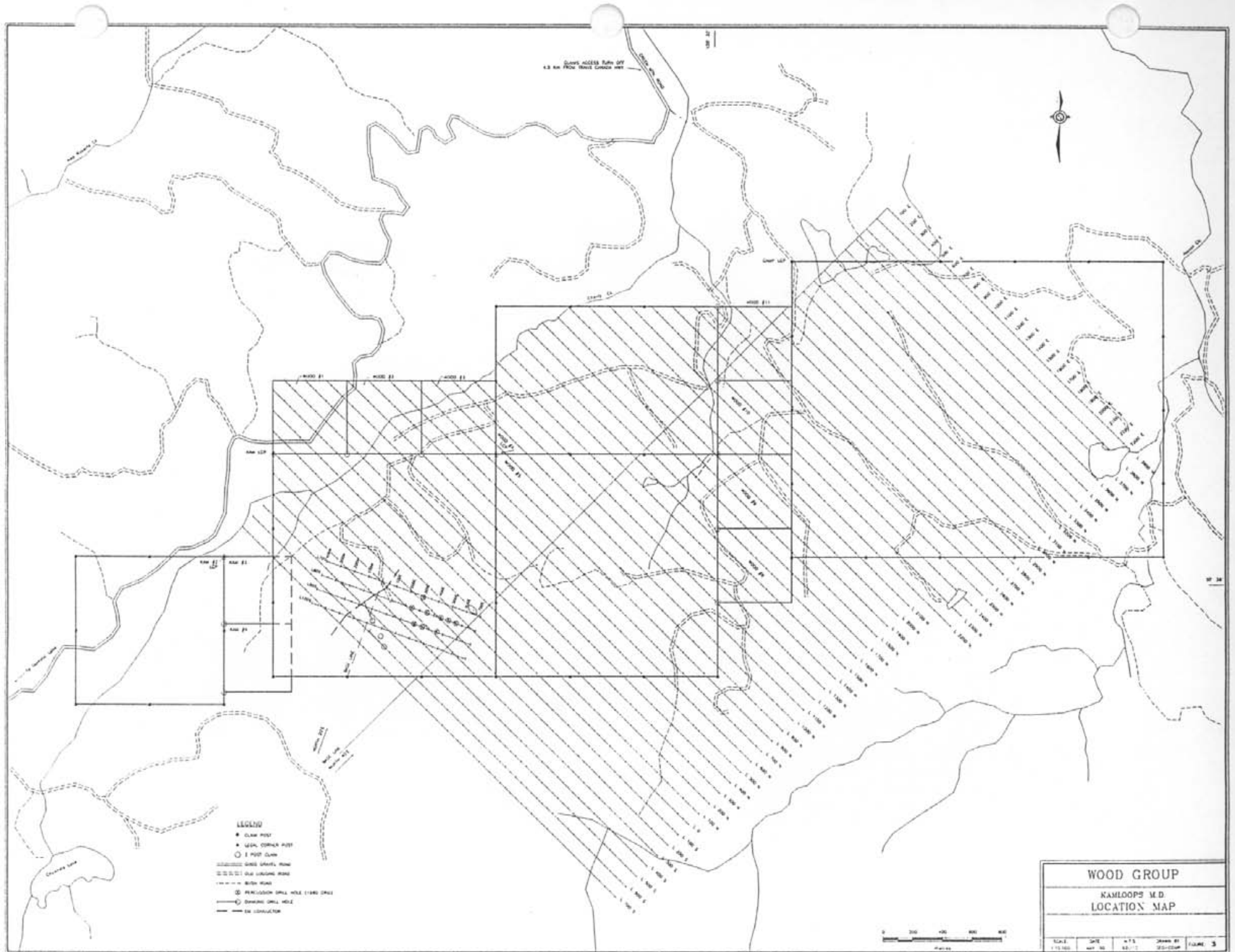

ACCESS ROAD
WOOD GROUP

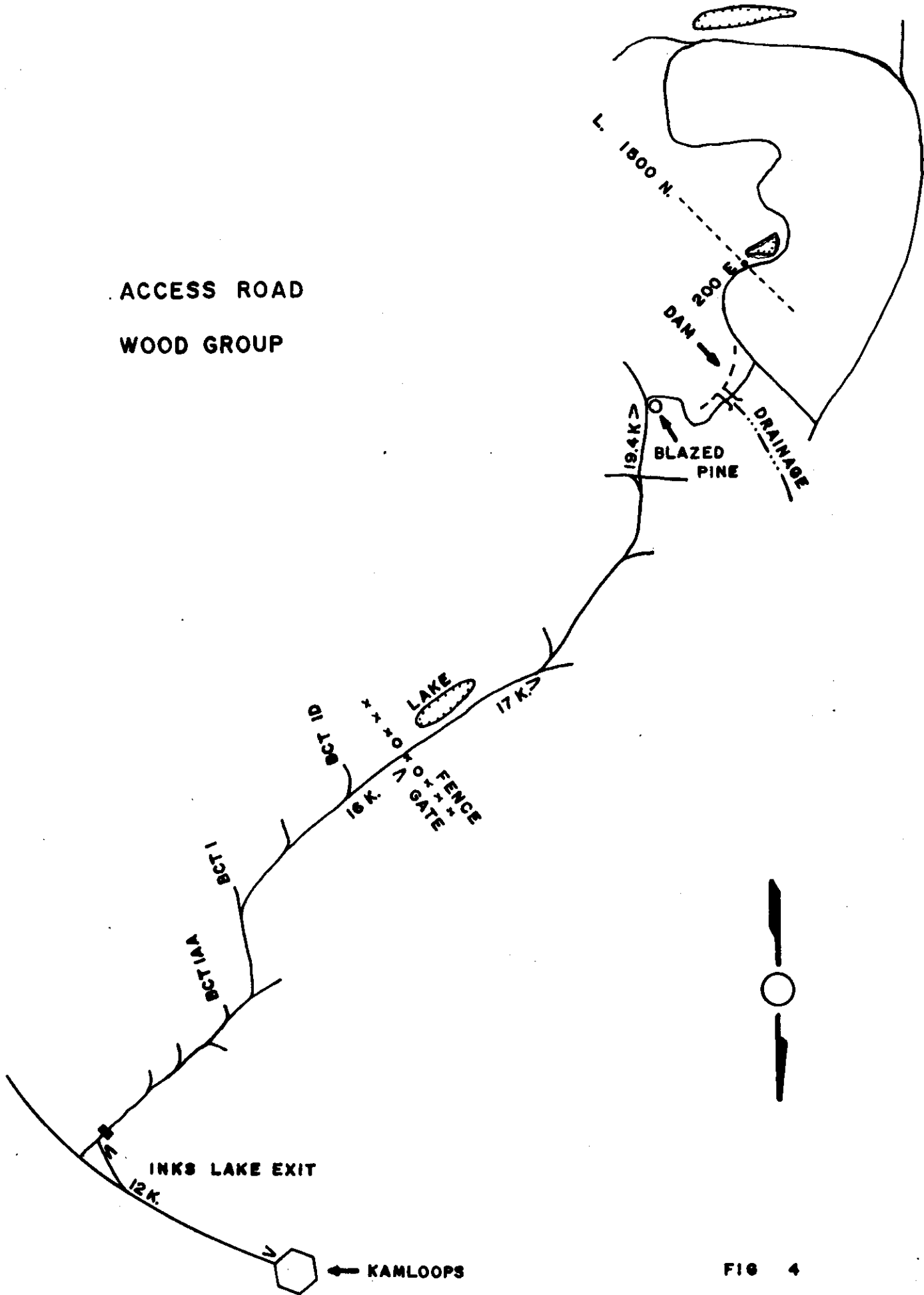

FIG 4

The climate is semi-arid with an annual precipitation of approximately 25 cm. The temperature varies from an extreme high in the summer of +30^o to a low in the winter of -30^o.

(ii) The Wood Group is owned and operated by Charles Boitard.

	<u>Units</u>	<u>Record #</u>	<u>Expiry Date</u>
Camp	20	8656	13/5/92
Wood #1	1	8430	4/4/92
Wood #2	1	8431	4/4/92
Wood #3	1	8432	4/4/92
Wood #4	6	8433	4/4/92
Wood #5	9	8434	5/4/92
Wood #8	1	8439	16/4/92
Wood #9	1	8440	16/4/92
Wood #10	1	8441	16/4/92
Wood #11	1	8442	16/4/92
Kam	9	1917	15/6/93
Kam #2	4	2901	26/8/92
Kam #3	1	3062	10/11/92
Kam #4	1	3063	10/11/92

(iii) Work for assessment purposes was carried out on the Wood #3, Wood #4, Wood #5, Wood #8, Wood #9 and the Kam Claims, during the month of August 1990.

SUMMARY

Preparation for an I.P. Survey

The survey lines were established with a compass and hip chain at 90° to the base line, the base line is in the north 45° , north 125° .

The survey lines are at 100 meter intervals, the direction from the base line is north 135° , north 315° . The survey stations are flagged at 50 meter intervals.

The survey was established in this direction because Cherry Creek flows through the claim in the northeast direction, possibly indicating the direction of a major fault.

The area was partly logged by selective method 30 to 40 years ago, and is covered by new growth and windfalls.

The lines were cut with an axe and a chainsaw. To facilitate the I.P. survey the lines have been cut on the following lines as shown on the map in the pocket (fig. 5).

Line 800N	1400m
Line 900N	1400m
Line 1000N	1400m
Line 1100N	1400m
Line 1200N	1400m
Line 1400N	1950m
Line 1600N	1950m
Line 1700N	1950m
Line 1800N	<u>1200m</u>
	14050m

STATEMENT OF COSTS

Statement of cost and expenses incurred on the Wood Group.

Line cutting in preparation for I.P. Survey

14 km. at \$375.00 per km.	\$5,250.00
----------------------------	------------

Respectfully submitted,

A handwritten signature in cursive script, appearing to read "Charles Boitard", with a large, sweeping flourish at the end.

Charles Boitard

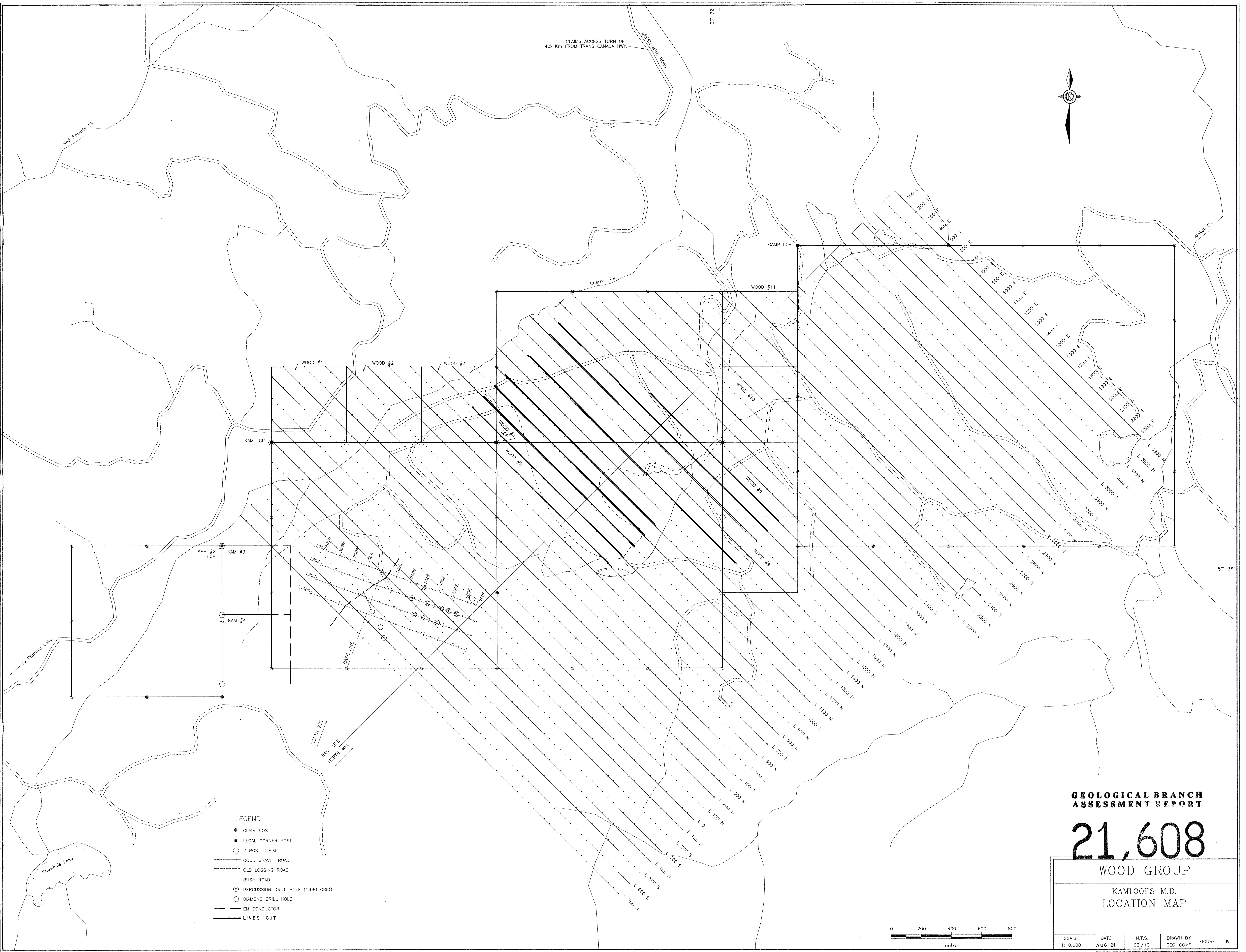

- LEGEND**
- CLAIM POST
 - LEGAL CORNER POST
 - 2 POST CLAIM
 - ==== GOOD GRAVEL ROAD
 - OLD LOGGING ROAD
 - BUSH ROAD
 - ⊗ PERCUSSION DRILL HOLE (1980 GRID)
 - DIAMOND DRILL HOLE
 - EM CONDUCTOR
 - LINES CUT

**GEOLOGICAL BRANCH
ASSESSMENT REPORT**

21,608

WOOD GROUP

KAMLOOPS M.D.
LOCATION MAP

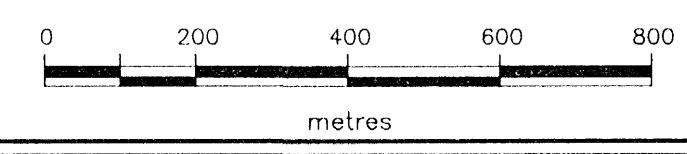

SCALE: 1:10,000	DATE: AUG 91	N.T.S. 92/10	DRAWN BY GEO-COMP	FIGURE: 5
--------------------	-----------------	-----------------	----------------------	--------------