

LOG NO:	91115	K
ACTION:		
FILE NO:		

SURE BET & PUP CLAIMS
 PROSPECTING AND ROCK SAMPLING
 SLOCAN MINING DIVISION
 N.T.S. 82F/10W
 LATITUDE 117 50 LONGITUDE 49 38

LOG NO:	FEB 20 1992	RD.
ACTION:	<i>[Handwritten signature]</i>	
FILE NO:		

BY
 BRUCE A. DOYLE PROSPECTOR

PAID
 GOVERNMENT AGENT

NOV 8 1991

NELSON

TRANS. \$.....

OCT. 25, 1991

**GEOLOGICAL BRANCH
 ASSESSMENT REPORT**

21,793

BRUCE DOYLE 312 INNES ST. NELSON B.C.

21793



Province of British Columbia

Ministry of Energy, Mines and Petroleum Resources

ASSESSMENT REPORT TITLE PAGE AND SUMMARY

TYPE OF REPORT/SURVEY(S)	TOTAL COST
--------------------------	------------

AUTHOR(S) BRUCE DOYLE SIGNATURE(S) Bruce Doyle

DATE STATEMENT OF EXPLORATION AND DEVELOPMENT FILED OCT. 28/ YEAR OF WORK 91

PROPERTY NAME(S) SURE BET. & PUP CLAIMS

COMMODITIES PRESENT ZINC LEAD SILVER COPPER

B.C. MINERAL INVENTORY NUMBER(S), IF KNOWN

MINING DIVISION SLOLAN NTS 120980

LATITUDE 117° 50' LONGITUDE 49° 38'

NAMES and NUMBERS of all mineral tenures in good standing (when work was done) that form the property (Examples: TAX 1-4, FIRE 2 (12 units); PHOENIX (Lot 1706); Mineral Lease M 123; Mining or Certified Mining Lease ML 12 (claims involved)):

SURE BET. (12 units) pup. (4 units)

OWNER(S)
(1) BRUCE DOYLE (2)

MAILING ADDRESS
312 JONES ST. NELSON B.C.
V1L5E5

OPERATOR(S) (that is, Company paying for the work)
(1) (2)

MAILING ADDRESS

SUMMARY GEOLOGY (lithology, age, structure, alteration, mineralization, size, and attitude):
THE SURE BET. & PUP CLAIMS are underlain by the
HAMILTON, BADSTIEK and LARDEAU formations of
PRECAMBRIAN and CAMBRIAN age. STRIKES NORTH,
NORTHEAST and dips moderately to the west.
MINERALIZATION consists of ZINC, LEAD, SILVER,
COPPER.

REFERENCES TO PREVIOUS WORK COMINCO 1977

TABLE OF CONTENTS

	PAGE
SUMMARY	2
CONCLUSION	3
INTRODUCTION	3
GEOLOGY	3
HISTORY	4
SAMPLE RESULTS	4
ROCK SAMPLE DESCRIPTIONS	5-7

MAPS

FIGURE 1 LOCATION MAP	1
FIGURE 2 CLAIM MAP	2
FIGURE 3 GEOLOGICAL MAP, TRAVERSES & SAMPLE LOCATIONS	

APPENDICES

APPENDIX 1 COST STATEMENT	
APPENDIX 2 AUTHORS QUALIFICATIONS	
APPENDIX 3 ASSAY REPORTS	

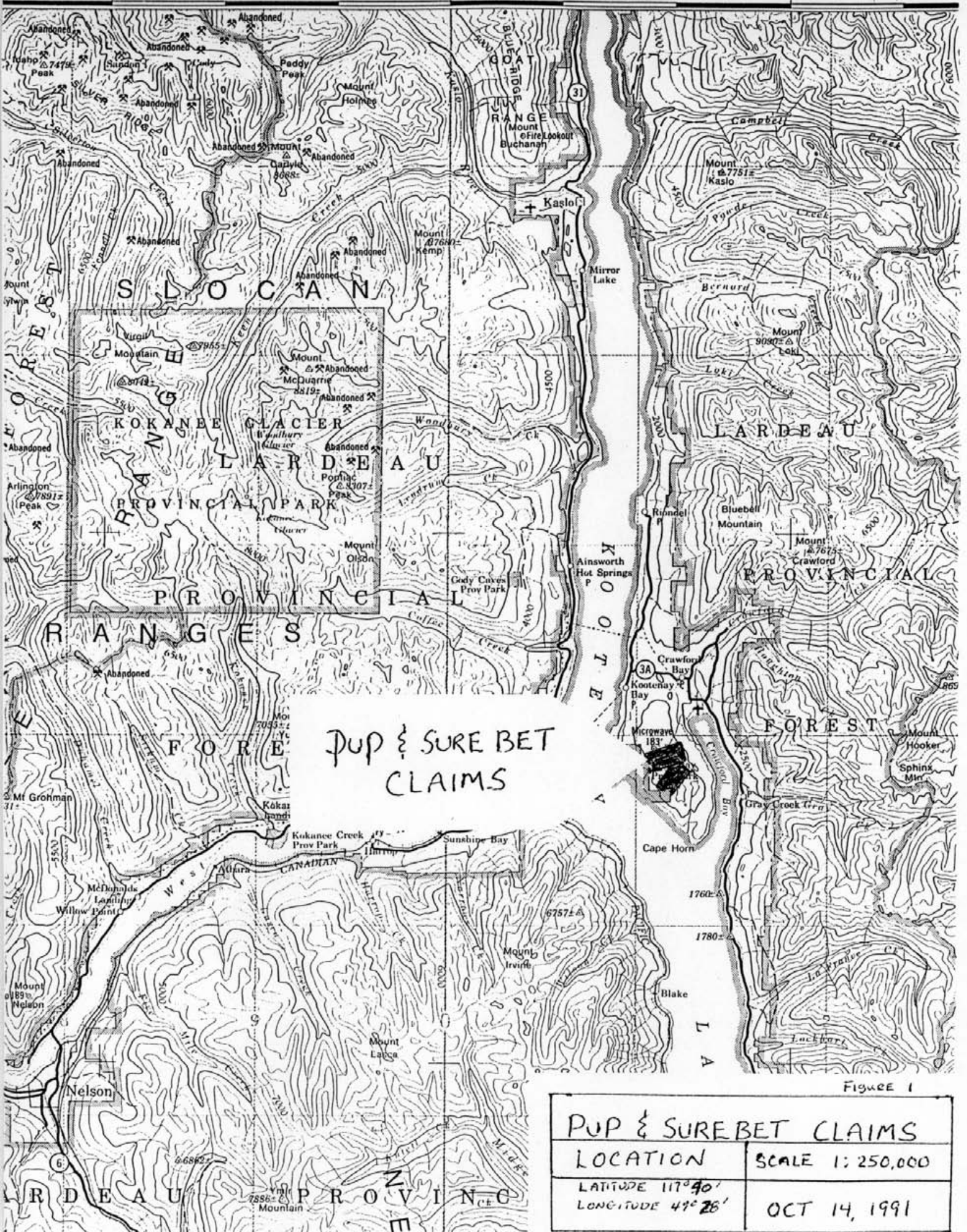

PUP & SURE BET
CLAIMS

FIGURE 1

PUP & SURE BET CLAIMS	
LOCATION	SCALE 1:250,000
LATITUDE 117°40'	OCT 14, 1991
LONGITUDE 49°26'	

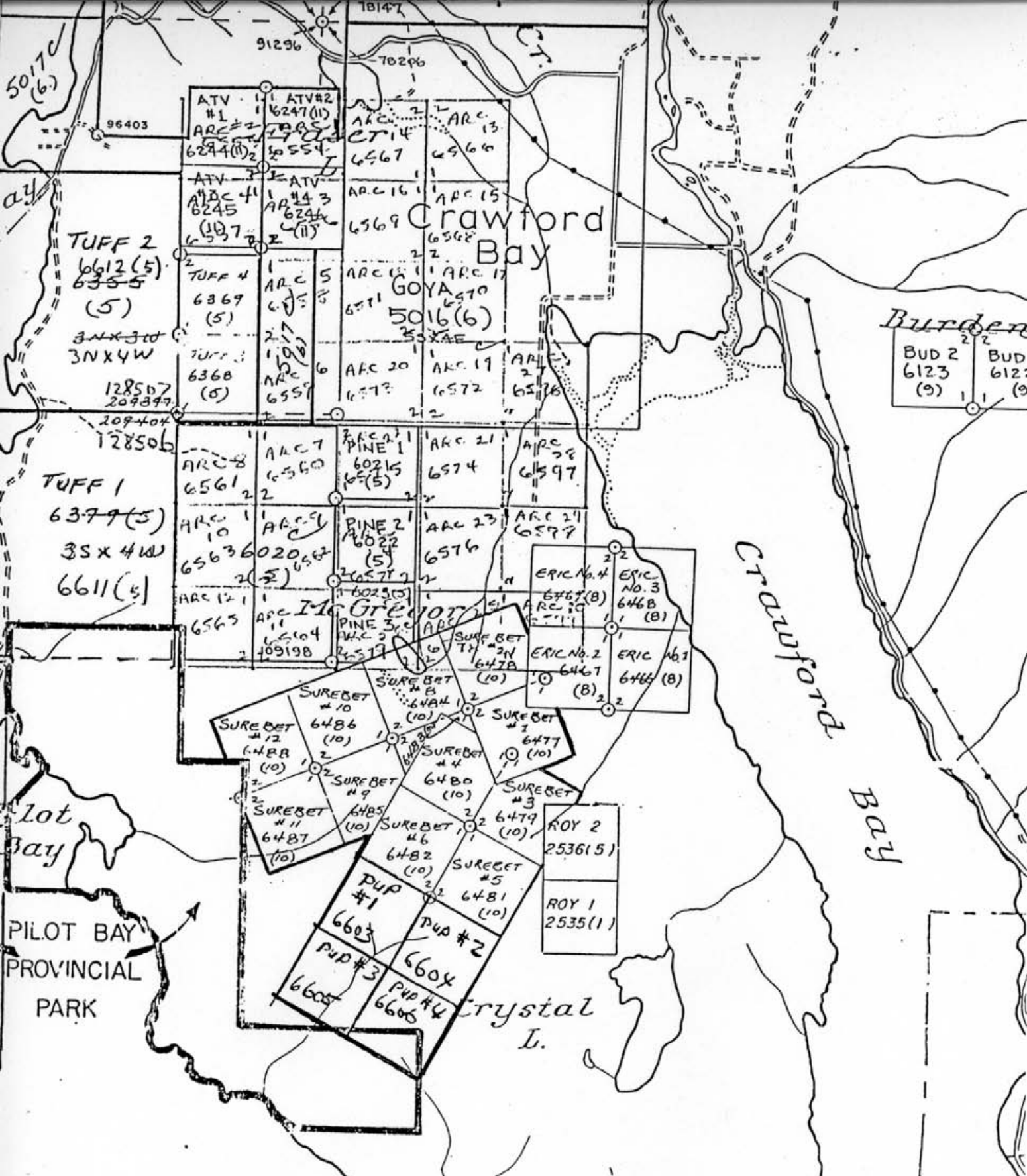

CLAIM MAP Figure 2

PUP & SUREBET	SCALE 1:31,650
NTS 82 F/10 W	OCT 14, 1991

SUMMARY

During the period from Nov. 1990 to Aug. 1991 the Sure Bet & Pup claims were prospected and sampled. A total of 20 rock samples were collected and analyzed for elements. The samples were taken from float boulders and from outcrop. The purpose of this was to see if there was any similarities between the float boulders and the underlying geology that they were found on. The rock samples taken from the black siltstones, argillites and quartzite schists show very few geochemical similarities to those of the float boulders. The samples taken from the areas of recrystallized limestone match fairly closely geochemically to those of the samples from the float boulders.

CONCLUSION

The float boulders that were found and sampled most likely have come from an outcrop of recrystalline limestone rather than from black siltstones, argillites and quartzite schists.

INTRODUCTION

The Sure Bet & Pup Claims are located in Southeast British Columbia, on the Crawford Bay Peninsula. The group is 8 miles south of Riondel and is approximately 25 miles Northeast of Nelson, B.C. The Group consists of 16 claims, which were staked over a known mineralized boulder occurrence.

GEOLOGY

The Sure Bet & Pup claims are underlain by the Hamill, Badshot, and Lardeau formations of Precambrian and Cambrian age. The formation strikes North, Northeast and dips moderately to the west. The Hamill formation in the area consists of pink quartzite and quartz mica schists, the Badshot is a white generally recrystallized limestone about 200 feet thick in places. Index information in the area consists of black siltstones and argillites.

HISTORY

In 1977 Cominco Ltd. explored for the source of a number of mineralized boulders containing Galena, Sphalerite and Pyrrhotite in the area of the Sure Bet claims. Geochemical, Geophysical, and a total of 330 meters of drilling were carried out but failed to locate the source of the sulphide mineralization.

SAMPLE RESULTS

Two types of samples were taken, one was from mineralized float boulders, the other from material in place. The samples from the float boulders were high in silver, lead, zinc and some copper values. The samples taken from in place were anomalous for silver lead zinc but values were much lower.

Jan 23/91

NEW PAGE*

Bondar - Clegg Report V90-02924.0

Sample designations

(a) R2 CB1 to 12 Bruce Doyle's claims - Crawford Bay

Crawford Bay :

- CB # 1 In place sample-- Fe (pyrite) rich zone on new logging road about 1.5 km. south of micro-wave tower turn-off.
- CB # 2 In place sample-- Limonite rich zone on new logging road about 200 m. south of micro-wave tower turn-off. Might be the weathered section of a vein or it could be the edge of a fault. Structure 193/ 74 W
- CB # 3 In place sample-- Fe (pyrite) rich zone on top of ridge near the micro-wave tower.
- CB # 4 Boulder -- Fe (pyrite) rich boulder about 100 m. west of the I.P. for claims 7 & 8
- CB # 5 Boulder -- Thick coating of limonite v.f.g. metallic present (probably pyrite). Located about 200 m. north of the I.P. for 7 & 8.
- CB # 6 Boulder -- Black sphalerite, galena, chalcopryrite and some carbonate gangue. Located about 220 m. north of the I.P. for 7 & 8.
- CB # 7 Boulder -- Pyrrhotite, black sphalerite, galena, chalcopryrite. Located at gate below micro-wave tower.
- CB # 8 Boulder -- Black sphalerite, pyrrhotite, galena, chalcoptrite, and minor carbonate gangue. Located about 50 m. south of sample no. 7.
- CB # 9 In place (?) -- On main road about 50 m. south of intersection with road to micro-wave tower (or about 200 m. north-easterly of sample no.2) Black graphitic-looking, with no obvious mineralization--white incrustations might be hydro-zincite.
- CB # 10 Boulder -- Located on main road about 75 m. south of intersection with tower road. Sample similar in appearance to sample no. 8

- CB # 11 In place sample-- Sample taken from old test pit dump site. Contains 10 to 20 per cent pyrite but no other mineral was definitely recognized.
- CB # 12 In place sample-- Sample taken from exposure on upper side of main road about 150 m. south of the the intersection with the tower road. Contains pyrite and a trace of chalcopyrite.

The samples have been taken from a roughly rectangular area about 0.75 km. by 1.5 km. The area in which the boulders have been found is roughly a unit to a unit and a half square; on the northern end of the rectangle. The area containing the boulders is within an active logging area and it will be grubbed and burned once the logs have been removed.

SAMPLE DESIGNATIONS
PUP & SUREBET CLAIMS

SAMPLE NO. 32001 Oxidized galena and sphalerite, pyrite
in marble. Taken 1.7 km on the main
Pilot Point Road on the Sure Bet #3.

SAMPLE NO. 32002 Banded limestone with calcite veining
containing pyrite, galena, sphalerite.
Taken 1.7 km on the main Pilot Point
Road on the Sure Bet #3.

SAMPLE NO. 32003 Silicious green altered limestone with
galena, sphalerite and pyrite. Taken
1.7 km on the main Pilot Point Road on
the Sure Bet #3.

SAMPLE NO. 32004 Breccia of marble, limestone and calcite
containing pyrite, sphalerite and
galena. Sample taken approx. 4.5 km on
the Pilot Point Road on the Pup #1.

SAMPLE NO. 32005 Crystalline marble, with some dolomite,
fine grained galena taken from Pup #1.

SAMPLE NO. 32006 Course marble with disseminated
sphalerite. Taken 1.7km on the main
Pilot Point Road on the Sure Bet #3.

SAMPLE NO. 32007 Altered limestone, breccia with calcite
veining, galena and sphalerite. Taken
on the main Pilot Point Road on the
Sure Bet #3.

SAMPLE NO. 32008 Breccia with calcite marble and
limestone containing galena, sphalerite
and pyrite. Taken approx. 4.5 km on the
edge of the road on the Pup #1.

APPENDICES

APPENDIX 1

COST STATEMENT

4X4 truck	\$50 per day	10 days	\$ 500
Prospector/Sampler	\$180 per day	10 days	\$1800
Assay Costs			\$ 255.96
		TOTAL =	<hr/> \$2055.96

AUTHORS QUALIFICATIONS

1980 - Physical geology 164 Selkirk College, Castlegar, B.C.

1983 - Basic prospecting course Nelson, B.C.

1990 - Successfully completed the ministrys advanced prospecting course. Vancouver Island

1981- 1992 - Employed by Minequest, Lacana, Boundary Drilling (Foremosa Resources) Noramco Corp.

A. Ismay & Associates

my experience cover geochemical, geophysical, and geological work.

353-2458

REPORT: V90-02924.0

DATE PRINTED: 10-JAN-91

PROJECT: NONE GIVEN

PAGE 1A

Bruce

SAMPLE NUMBER	ELEMENT UNITS	Au 10g PPB	Ag PPM	Cu PPM	Pb PPM	Zn PPM	Mo PPM	Ni PPM	Co PPM	Cr PPM	Bi PPM	As PPM	Sb PPM
R2 CB1	J. 2 Km	<5	3.7	433	28	1188	36	294	21	5	<5	<5	<5
R2 CB2		<5	0.5	156	22	126	8	62	13	<1	<5	<5	<5
R2 CB3	Top of Ridge	7	3.7	232	42	277	9	88	11	<1	<5	23	<5
R2 CB4		8	3.0	349	49	514	21	165	14	<1	<5	9	<5
R2 CB5		8	1.7	332	51	365	27	210	14	<1	<5	<5	<5
R2 CB6		77	>50.0	1762	3014	10910	13	4	86	44	<5	1868	<5
R2 CB7		7	>50.0	6456	>10000	>20000	85	4	25	793	<5	59	63
R2 CB8		<5	>50.0	3412	>10000	>20000	60	<1	31	492	<5	52	61
R2 CB9		7	5.2	444	2082	1776	33	177	16	5	<5	9	<5
R2 CB10		82	28.8	2169	>10000	>20000	32	3	276	291	<5	>2000	53
R2 CB11		9	2.8	388	99	563	37	279	18	<1	<5	25	<5
R2 CB12		<5	4.1	468	630	1673	39	302	23	5	<5	63	<5

REPORT: V90-02924.0

DATE PRINTED: 10-JAN-91

PROJECT: NONE GIVEN

PAGE 1B

SAMPLE NUMBER	ELEMENT UNITS	Fe PCT	Mn PCT	Te PPM	Ba PPM	Cr PPM	V PPM	Sn PPM	V PPM	Li PPM	Ga PPM	La PPM	Ta PPM
R2 CB1		>10.00	0.35	<10	148	257	487	<20	<10	<1	<2	8	<1
R2 CB2		6.92	0.75	<10	675	164	139	<20	<10	16	8	26	<1
R2 CB3		>10.00	1.86	<10	332	233	256	<20	<10	3	3	27	<1
R2 CB4		>10.00	0.24	<10	97	260	700	<20	<10	35	<2	13	<1
R2 CB5		>10.00	0.50	16	243	340	571	<20	<10	2	<2	14	16
R2 CB6		>10.00	0.09	12	13	96	19	28	<10	7	<2	<1	14
R2 CB7		>10.00	0.08	58	10	128	7	<20	<10	6	<2	<1	<1
R2 CB8		>10.00	0.06	57	9	40	6	110	<10	1	<2	<1	<1
R2 CB9		>10.00	0.51	<10	233	423	682	<20	<10	<1	2	15	25
R2 CB10		>10.00	0.09	41	36	92	<1	<20	<10	4	<2	<1	50
R2 CB11		>10.00	0.06	<10	62	300	741	<20	<10	29	<2	14	<1
R2 CB12		>10.00	0.27	<10	178	246	602	<20	<10	9	<2	10	<1

DATE PRINTED: 10-JAN-91

PROJECT: NONE GIVEN

PAGE 10

REPORT: 79C-02924.0

SAMPLE NUMBER	ELEMENT UNITS	Ti PCT	Al PCT	Mg PCT	Ca PCT	Na PCT	K PCT	Nb PPM	Sr PPM	Y PPM	Zr PPM
R2 CB1		0.09	1.12	0.40	0.99	0.05	0.72	5	122	19	<1
R2 CB2		0.18	3.57	1.45	2.06	0.31	0.63	14	208	42	<1
R2 CB3		0.13	1.88	1.93	3.80	0.09	0.28	11	144	50	<1
R2 CB4		0.12	1.65	0.75	0.85	0.06	0.23	6	21	27	<1
R2 CB5		0.12	1.49	1.21	2.69	0.10	0.44	8	133	37	<1
R2 CB6		<0.05	0.29	0.12	0.13	0.08	<0.05	27	2	3	<1
R2 CB7		<0.05	0.16	<0.05	0.06	<0.05	<0.05	13	4	4	<1
R2 CB8		<0.05	0.13	<0.05	0.05	0.05	<0.05	15	2	3	<1
R2 CB9		0.12	1.54	1.18	0.08	0.09	0.47	5	189	54	<1
R2 CB10		<0.05	0.13	<0.05	0.08	0.12	<0.05	26	6	6	<1
R2 CB11		0.13	1.42	0.60	0.60	<0.05	0.25	6	11	28	<1
R2 CB12		0.10	1.27	0.37	1.04	0.08	0.67	9	98	25	<1



GEOCHEMICAL ANALYSIS CERTIFICATE



Bruce Doyle File # 91-1501
312 Innes St., Nelson BC V1L 5E5

SAMPLE#	Mo ppm	Cu ppm	Pb ppm	Zn ppm	Ag ppm	Ni ppm	Co ppm	Mn ppm	Fe %	As ppm	U ppm	Au ppm	Th ppm	Sr ppm	Cd ppm	Sb ppm	Bi ppm	V ppm	Ca %	P %	La ppm	Cr ppm	Mg %	Ba ppm	Ti %	B ppm	Al %	Na %	K %	W ppm
B 32001	1	14	68	936	.9	5	2	329	.90	21	5	ND	1	95	17.3	3	2	3	.97	.006	2	4	.06	16	.01	2	.14	.01	.06	3
B 32002	1	46	2409	4144	3.8	15	9	398	3.69	662	5	ND	10	168	25.8	7	2	5	6.24	.048	12	13	1.34	22	.01	2	.35	.01	.24	21
B 32003	1	71	875	4617	4.2	66	29	713	5.48	572	5	ND	1	195	24.8	14	2	38	9.58	.052	5	52	2.43	31	.01	2	.35	.01	.25	22
B 32004	1	107	1689	11167	4.7	19	9	745	6.02	614	5	ND	1	203	74.1	12	2	13	14.05	.035	7	12	1.96	41	.01	2	.32	.01	.17	1

ICP - .500 GRAM SAMPLE IS DIGESTED WITH 3ML 3-1-2 HCL-HNO3-H2O AT 95 DEG. C FOR ONE HOUR AND IS DILUTED TO 10 ML WITH WATER.
THIS LEACH IS PARTIAL FOR MN FE SR CA P LA CR MG BA TI B W AND LIMITED FOR NA K AND AL. AU DETECTION LIMIT BY ICP IS 3 PPM.
- SAMPLE TYPE: ROCK

DATE RECEIVED: MAY 30 1991 DATE REPORT MAILED: *June 3/91.* SIGNED BY: *C. Leong* D. TOYE, C. LEONG, J. WANG; CERTIFIED B.C. ASSAYERS

GEOCHEMICAL ANALYSIS CERTIFICATE

Bruce Doyle File # 91-2102
312 Innes St., Nelson BC V1L 5E5



SAMPLE#	Mo ppm	Cu ppm	Pb ppm	Zn ppm	Ag ppm	Ni ppm	Co ppm	Mn ppm	Fe %	As ppm	U ppm	Au ppm	Th ppm	Sr ppm	Cd ppm	Sb ppm	Bi ppm	V ppm	Ca %	P %	La ppm	Cr ppm	Mg %	Ba ppm	Ti %	B ppm	Al %	Na %	K %	W ppm
B 32005	1	6	1135	63	.3	3	1	217	.42	2	5	ND	1	158	.4	2	2	2	16.03	.018	2	3	7.62	12	.01	2	.06	.01	.01	1
B 32006	1	200	63	25279	3.4	5	3	782	3.46	6	5	2	1	296	145.1	4	2	2	19.17	.016	2	50	2.62	18	.01	2	.08	.01	.04	2
B 32007	1	60	535	5320	3.8	29	15	880	4.68	187	9	2	2	306	31.1	4	2	15	10.99	.052	2	36	2.71	21	.01	2	.27	.01	.20	1
B 32008	1	51	1755	8559	2.0	16	7	482	4.56	52	8	2	3	188	51.8	4	2	3	14.63	.036	8	33	3.24	25	.01	2	.15	.01	.10	2

ICP - .500 GRAM SAMPLE IS DIGESTED WITH 3ML 3-1-2 HCL-HNO3-H2O AT 95 DEG. C FOR ONE HOUR AND IS DILUTED TO 10 ML WITH WATER.
THIS LEACH IS PARTIAL FOR MN FE SR CA P LA CR MG BA TI B W AND LIMITED FOR NA K AND AL. AU DETECTION LIMIT BY ICP IS 3 PPM.
- SAMPLE TYPE: ROCK

DATE RECEIVED: JUN 27 1991 DATE REPORT MAILED: *July 2/91.* SIGNED BY: *Chung* D. TOYE, C. LEONG, J. WANG; CERTIFIED B.C. ASSAYERS

/ ASSAY RECOMMENDED

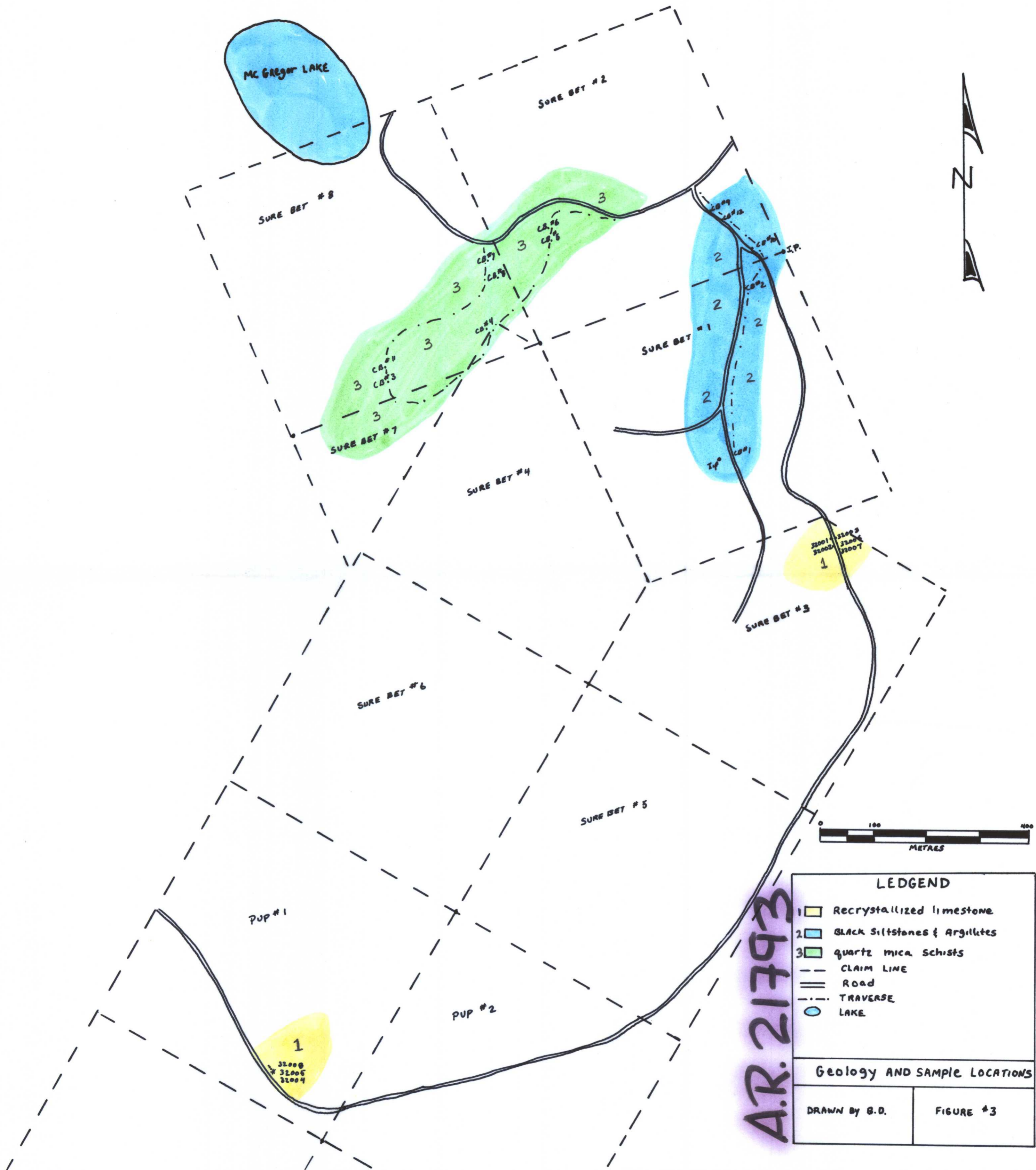

A.R. 21793

LEGEND	
1	Recrystallized limestone
2	Black Siltstones & Argillites
3	quartz mica Schists
- - -	CLAIM LINE
==	ROAD
- . - .	TRAVERSE
○	LAKE

Geology AND SAMPLE LOCATIONS	
DRAWN BY G.D.	FIGURE #3