

ARIS SUMMARY SHEET

District Geologist, Kamloops

Off Confidential: 92.08.21

ASSESSMENT REPORT 21921

MINING DIVISION: Similkameen

PROPERTY: WH  
LOCATION: LAT 49 44 00 LONG 120 10 00  
UTM 10 5512616 704170  
NTS 092H09E  
CLAIM(S): WH 9-12  
OPERATOR(S): Fairfield Min.  
AUTHOR(S): Rowe, J.  
REPORT YEAR: 1991, 26 Pages  
COMMODITIES  
SEARCHED FOR: Gold  
KEYWORDS: Jurassic, Osprey Lake Batholith, Granites, Quartz-feldspar porphyry  
WORK  
DONE: Geochemical  
SOIL 843 sample(s) ;AU  
Map(s) - 1; Scale(s) - 1:10 000  
RELATED  
REPORTS: 20883

LOG NO: DEC 18 1991 RD.
ACTION:
FILE NO:

1991  
GEOCHEMICAL REPORT

On the WH #1-12 MINERAL CLAIMS  
Similkameen Mining Division, B.C.  
NTS: 92H/9E,16E; Lat 49 Deg.46'N; Long 120 Deg.11'W

DECEMBER 1991. (BC '91 ASSESSMENT)

REPORT DISTRIBUTION

- Mining Recorder:	2	
- Fairfield Minerals Ltd.	1	
- Field	1	
- Cordilleran Engineering Ltd.	1	(Original)
Total:	5	

GEOLOGICAL BRANCH  
ASSESSMENT REPORT

21,921

**1991 GEOCHEMICAL REPORT**  
**ON THE WH #1-12 MINERAL CLAIMS**

Similkameen Mining Division, B.C.  
Latitude 49 degrees 46'N; Longitude 120 degrees 11'W  
NTS: 92H/9E, 16E

For

**FAIRFIELD MINERALS LTD.**  
Vancouver, British Columbia

By

J. D. Rowe, B.Sc.  
Geologist

**CORDILLERAN ENGINEERING LTD.**  
1980-1055 W. Hastings St.  
Vancouver, B.C. V6E 2E9

Date Submitted: December, 1991  
Field Period: June 18 to August 11, 1991

**TABLE OF CONTENTS**

		Page
1.0	SUMMARY AND CONCLUSIONS .....	1 ✓
2.0	RECOMMENDATIONS .....	2 ✓
3.0	INTRODUCTION .....	3 ✓
3.1	Location and Physiography .....	3 ✓
3.2	Claim Data .....	3 ✓
3.3	History .....	6 ✓
3.4	1991 Exploration Program .....	7 ✓
4.0	GEOLOGY .....	8 ✓
4.1	Regional Geology .....	8 ✓
4.2	Property Geology and Mineralization .....	8 ✓
5.0	GEOCHEMISTRY .....	11 ✓
5.1	Sampling Procedure .....	11 ✓
5.2	Results .....	11 ✓
6.0	PERSONNEL .....	13 ✓
7.0	STATEMENT OF EXPENDITURES .....	14 ✓
8.0	REFERENCES .....	15 ✓
9.0	STATEMENT OF QUALIFICATIONS .....	16 ✓
10.0	ANALYTICAL RESULTS	

**FIGURES**

<u>Figure 1</u>	Location Map .....	4 ✓
<u>Figure 2</u>	Claim and Grid Locations .....	5 ✓
<u>Figure 3</u>	Regional Geology .....	9 ✓

**TABLE**

<u>Table 1</u>	Claim Status as at November 1991 .....	6 ✓
----------------	--	-----

**PLATE**  
(in pocket)

<u>Plate 1</u>	Au Soil Geochemistry .....	<u>Scale</u> 1:10,000 ✓
----------------	----------------------------	----------------------------

The WH property comprises 12 claims (181 units) in the Similkameen Mining Division, located 57 kilometres southeast of Merritt, B.C. The claims, staked during 1988, 1989 and 1990, are owned 100 percent by Fairfield Minerals Ltd. The exploration target was a structurally controlled lode gold deposit. Work was managed by Cordilleran Engineering Ltd. of Vancouver, B.C.

Logging roads provide excellent access to all parts of the property. The claims cover rolling forested hills and scattered clear cut logged areas.

Previous exploration by others near the property has included mapping, soil sampling, geophysical surveys, trenching, diamond drilling, limited underground drifting and small scale placer mining. A drill intercept of five feet grading 0.43 oz/ton gold, 5.67 oz/ton silver and 0.23% copper was reported from a showing 1.0 km east of the WH claims. Seven kilometres to the northwest, on the Elk property, a high-grade vein system contains drill indicated reserves in excess of 200,000 ounces of gold with an average grade of 0.647 oz/ton Au using 6.6 feet true width. Within the WH property area a narrow quartz vein/alteration zone yielded 15,900 ppb (0.46 oz/ton) gold and 1100.9 ppm (32.1 oz/ton) silver across 10 cm.

During 1988-89 the WH 1-8 claims were soil sampled and minor trenching was conducted. In 1990, work included detailed follow-up soil sampling, minor trenching and staking of sixty claim units on the south side of the property.

The property is underlain by coarse granite of the Coast Intrusions injected by a stock and abundant dykes of porphyritic granite of the Otter Intrusions. Clay alteration, with local disseminated pyrite, occurs along some shears. Sericite, chlorite, carbonate and silica alteration are also developed locally. Major lineaments, as well as fractures and shears exhibit predominant northeast and northwest trends. Narrow quartz veins have been observed locally with minor pyrite, occasional chalcopyrite or galena and some gold and silver values.

The 1991 program consisted of wide-spaced (400m x 50m) grid soil sampling to evaluate new claims on the south side of the property. These 653 samples were analyzed for gold, whereupon fill-in sampling (50m x 50m) was conducted around those sites which yielded values greater than 20 ppb Au, adding another 156 samples. In addition, 34 sites were resampled on one line due to contamination of the original samples.

Scattered anomalous gold values were returned from the initial soil sampling, however, follow-up failed to confirm or extend most of these and overall the gold geochemical values were low.

Small, spotty, weak gold anomalies were indicated by this program of wide-spaced soil sampling. Narrow, high grade gold veins could have been missed between the 400 metre-spaced soil lines, however, this possibility is considered slight. No further work is warranted on the claims which were subject to this exploration program.

\*\*\*\*

2.0

#### RECOMMENDATIONS

Based upon the lack of significant gold values from this program of soil sampling on the WH 9-12 claims it is recommended that these claims be allowed to lapse and future exploration focus on the remainder of the property where greater gold potential exists.

Respectfully submitted

CORDILLERAN ENGINEERING LTD.



J. D. Rowe, B.Sc.  
Geologist

JDR/z  
December, 1991

\*\*\*\*

3.0

**I N T R O D U C T I O N**

3.1 **LOCATION AND PHYSIOGRAPHY** (Figures 1 and 2)

The WH property is located 32 kilometres west of Peachland and 57 kilometres southeast of Merritt in south-central British Columbia (Figure 1). The property is centered on latitude 49 degrees 46'N and longitude 120 degrees 11'W within NTS map areas 92H/9E + 16E. Good gravel roads extend to the area from Peachland and from the Princeton-Merritt highway. Several logging roads traverse the claims providing excellent access.

The claims cover an area of approximately 45 square kilometres in rolling, hilly terrain on a broad uplands plateau. Elevations range from 1150m to 1550m above sea level. The east side of the property drops down steeply to Trout Creek, a two to four metre wide stream flowing to the south. Spring Creek follows a northeast-trending depression across the central part of the property and North Trout Creek cuts south and east across the northern claims. Whitehead Lake, measuring 800 metres by 400 metres lies on the plateau in the east-central part of the claim group. A dam on the lake has caused a tributary creek to back up forming a long swampy zone to the southwest. Outcrop exposures are scarce with till depth ranging from less than one metre to greater than four metres. Mature stands of spruce, balsam, fir and pine have been logged from several scattered plots. Annual temperatures range from -20 to 30 degrees C and precipitation is low to moderate. The area is basically snow-free from late June through October.

3.2 **CLAIM DATA** (Figure 2)

The current status of the WH claims is indicated in Table 1, and their locations are shown on Figure 2. The claims, located in the Similkameen Mining Division, were staked in September and October 1988, May and July 1989 and August 1990 and are 100 percent owned by Fairfield Minerals Ltd. The WH 9, 10, 11 and 12 claims were allowed to lapse on their anniversary dates in August, 1991.

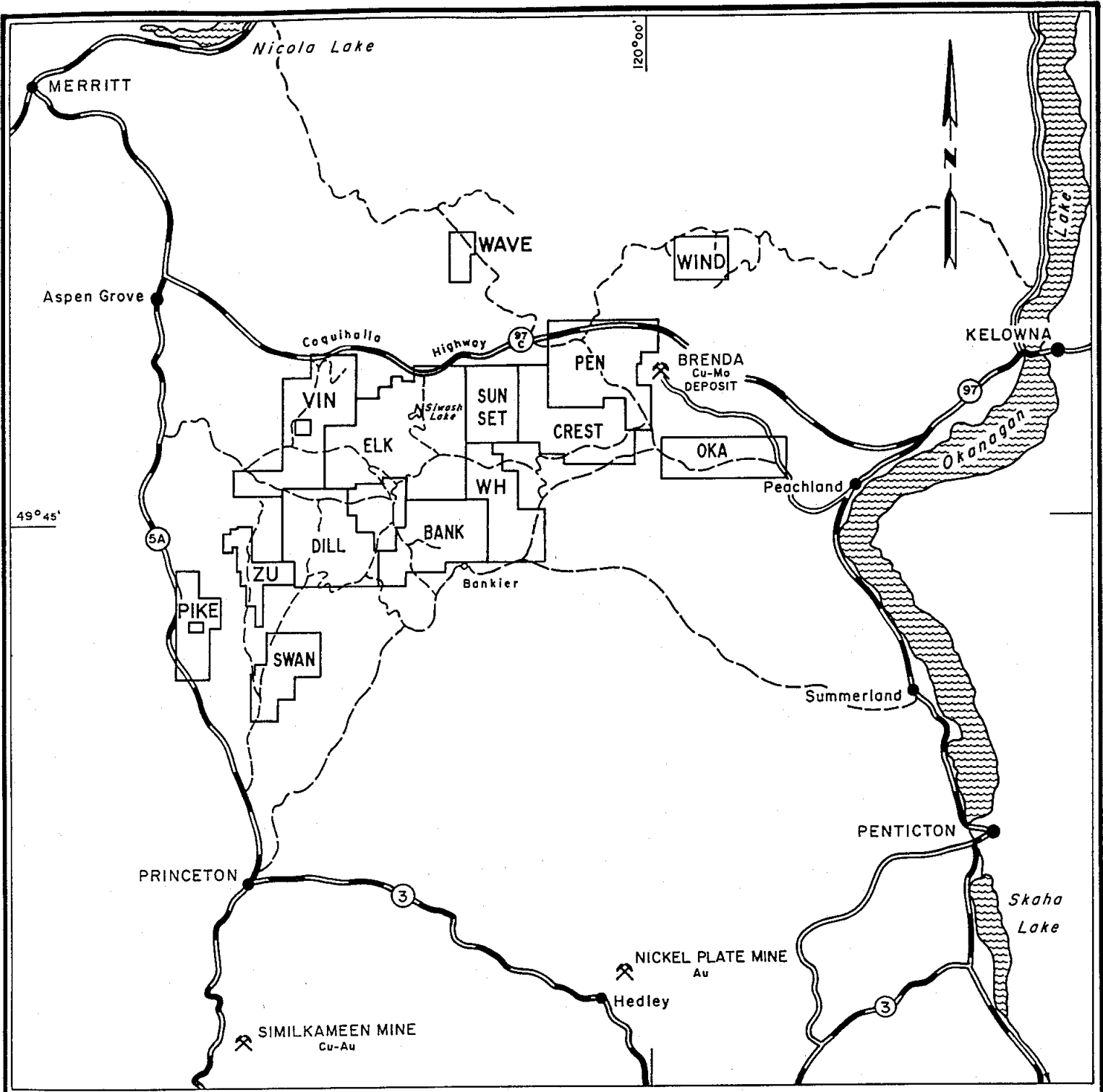

FAIRFIELD MINERALS LTD.  
**PROPERTY LOCATION MAP**  
 SOUTHERN BRITISH COLUMBIA  
 OKANAGAN AREA, NTS 82E/92H

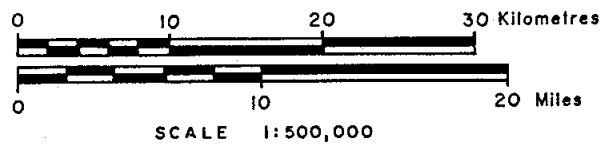

CORDILLERAN ENGINEERING LTD.  
 1980-1055 W. HASTINGS STREET  
 VANCOUVER, B.C. V6E 2E9

NOVEMBER 1991

FIGURE 1

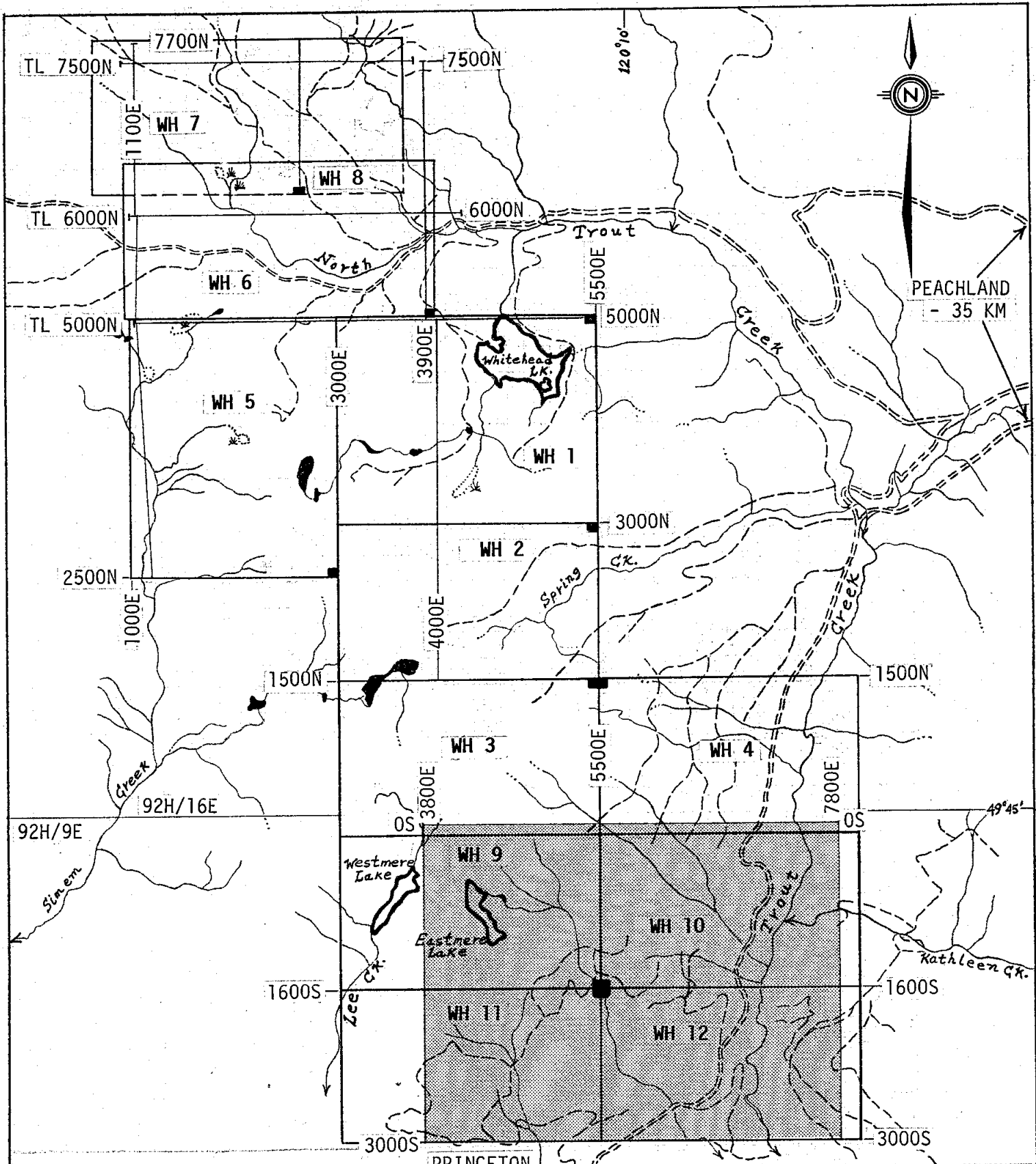

PEACHLAND  
- 35 KM

PRINCETON  
- 45 KM

**LEGEND**

- — Legal Corner Post of 4-Post Mineral Claim(s)
- 3800E — Grid Line Number
- - - - Access Roads, Trails
- — 1991 Soil Geochemical Survey

**FAIRFIELD MINERALS LTD.  
WH PROPERTY**

**CLAIM AND GRID LOCATION MAP**

Similkameen Mining Division  
92H/9E & 16E, B.C.  
Scale - 1:50,000



November 1991

**Figure 2**

Table 1 CLAIM STATUS AS AT NOVEMBER, 1991

<u>CLAIM</u>	<u>UNITS</u>	<u>RECORD NO.</u>	<u>EXPIRY DATE</u>
WH 1	20	3186	2 SEPT 1995
WH 2	15	3201	16 SEPT 1995
WH 3	15	3213	10 OCT 1996
WH 4	15	3214	11 OCT 1996
WH 5	20	3339	6 MAY 1994
WH 6	18	3340	7 MAY 1994
WH 7	12	3437	9 JULY 1994
WH 8	6	3438	13 JULY 1994
WH 9	15	3750	27 AUG 1991 cancelled
WH 10	15	3751	27 AUG 1991 cancelled
WH 11	15	3752	27 AUG 1991 cancelled
<u>WH 12</u>	<u>15</u>	<u>3753</u>	<u>27 AUG 1991 cancelled</u>
12 Claims	181 Units		

3.3

HISTORY

Areas to the east and west of the WH claims have been previously explored. In the Spring Creek area, from 1972 to 1985 various companies conducted mapping, soil sampling, a magnetometer survey, trenching and limited diamond drilling in search of copper, molybdenum, lead, zinc and silver, with little success. Along North Trout Creek, a small, intermittent placer mining operation has recovered minor amounts of gold. From 1986 to 1991 large areas east and west of WH were explored for gold by soil sampling, magnetometer and VLF-EM surveys, mapping, prospecting, trenching and drilling.

Directly southeast of the WH 4 claim a gold, silver, copper showing has been explored by diamond drilling, trenching, a magnetometer survey and soil sampling between 1973 and 1987. A 64 metre adit is reported to have been excavated in 1898. The best drill intercept was 5 feet of 0.43 oz/ton gold, 5.67 oz/ton silver and 0.23% copper within a 15 foot section averaging 0.30 oz/ton gold.

Seven kilometres to the northwest, high grade gold vein systems have been explored from 1986 to present on the adjoining Elk property. Geochemical and geophysical surveys, trenching and diamond drilling at Elk have revealed several gold-bearing structures, one of which contains drill indicated reserves in excess of 200,000 ounces of gold with an average grade of 0.647 oz/ton Au over 6.6 feet true width.

Prospecting of the area near Whitehead Lake in 1988 by Fairfield Minerals Ltd. located a narrow quartz vein/alteration zone in granite which yielded 15,900 ppb (0.46 oz/ton) gold, 1100.9 ppm (32.1 oz/ton) silver across 10 cm. This initiated the staking of the WH claims.

During 1988, 1989 and 1990 the WH 1-8 claims were soil sampled on 200m by 50m spaced grid lines. Fill-in samples were collected around some of the anomalous stations. Three short trenches and six pits were excavated in the Spring Creek area and on the northern claims (WH 6, 8) but failed to expose any significant gold mineralization.

**3.4 1991 EXPLORATION PROGRAM**

The 1991 program consisted of wide-spaced (400m x 50m) grid soil sampling to cover the southern part of the property comprised of WH 9, 10, 11 and 12 claims. Follow-up soil sampling (50m x 50m) was undertaken around a few sites which returned anomalous gold values.

A total of 28 mandays were expended between June 18 and August 11, 1991 to establish grid lines and collect 843 soil samples.

No significant gold trends were indicated by this sampling program and the WH 9-12 claims were allowed to lapse.

\*\*\*\*

4.0

G E O L O G Y

4.1 REGIONAL GEOLOGY (Figure 3)

The WH regional geology is shown on the northeast part of GSC Map 41-1989, Hope, by J.W.H.Monger, 1989 which is condensed on Figure 3. The area is underlain by an Early Tertiary stock of porphyritic granite in contact with Late Jurassic Coast intrusive granitic rocks to the west, north and south.

4.2 PROPERTY GEOLOGY AND MINERALIZATION

Outcrop is sparse on the property, confined predominantly to creek banks, ridges and road cuts.

The central and eastern portions of the property are underlain by a stock of quartz-feldspar porphyry of Early Tertiary age. Quartz eyes are common, up to 1.5 centimetres in diameter and feldspar phenocrysts are up to 4 centimetres in length. The composition is generally granite to monzonite with local diorite sections, often near contact zones. Dykes and small stocks of similar rock were observed on the northernmost claims. Clay alteration of matrix minerals to chalky white material is common, with local weathered pyrite imparting a rusty yellow colour.

Coarse, equigranular, pink granite of the Jurassic batholithic unit dominates on the northern and southern claims. Contacts with the porphyry stock are irregular.

Pendants of gneissic rock of possible Paleozoic age are present in both porphyry and granite as rafted inclusions. These were observed on WH 3, 4 and 9-12 claims. The gneiss is fine grained, dark grey to black and weakly to moderately foliated.

In a few exposures fine-grained andesitic dykes have been noted cutting both the granite and quartz-feldspar porphyry units. These dykes may be late stage members of the porphyry intrusions of Tertiary age.

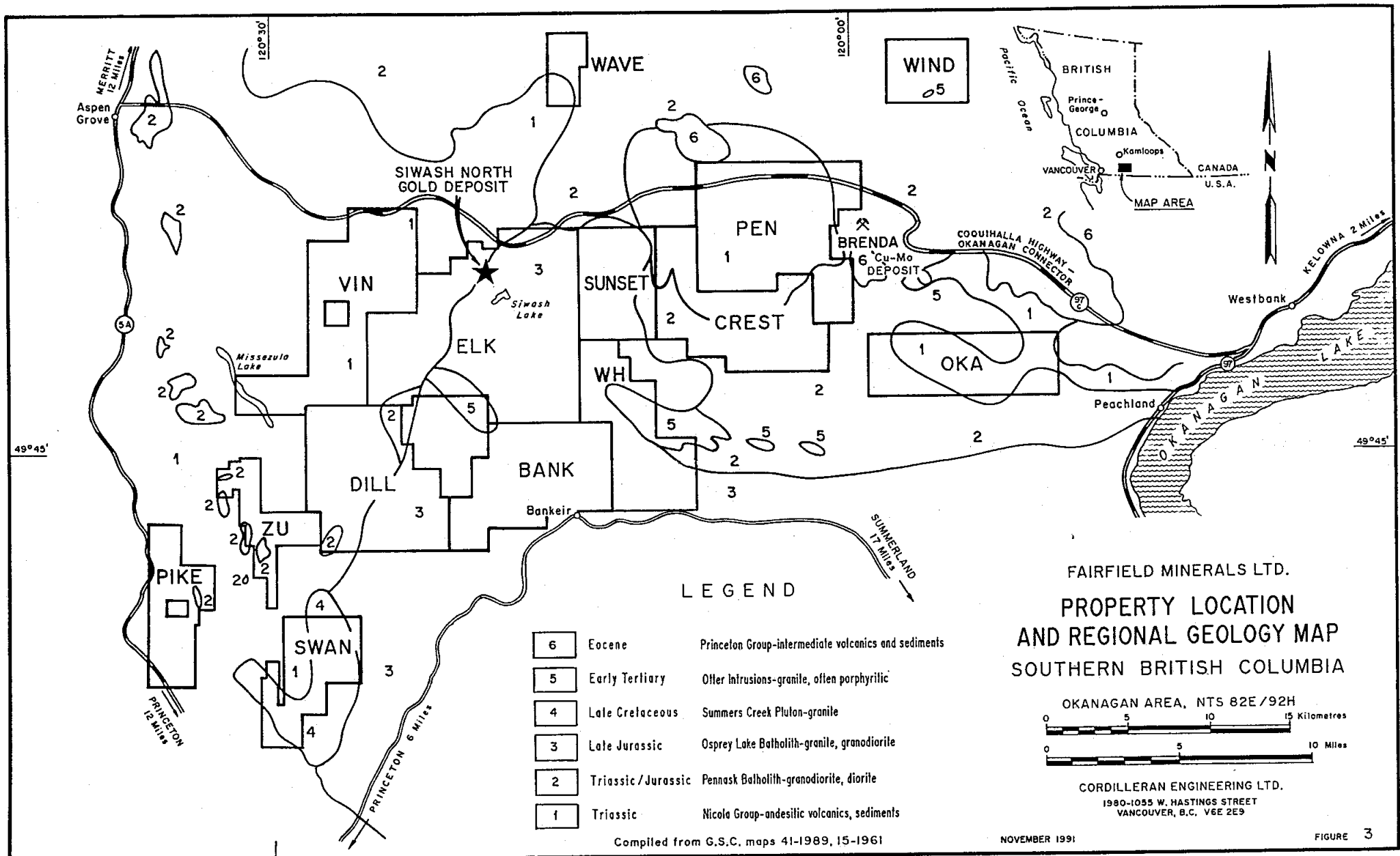

Major lineaments on the property, which probably reflect large fault structures, trend dominantly 070 and 150 degrees. Local fracturing and shearing also exhibit similar trends.

Intense clay alteration is locally developed in some shear zones, usually less than one metre in width. Sericite alteration is prevalent in the granite and quartz-feldspar porphyry units. Low levels of silicification, chloritization and carbonatization are also locally evident.

Disseminated pyrite has been noted in quartz veinlets and in some argillically altered or silicified zones. Locally, minor chalcopyrite or galena accompany the pyrite and some anomalous gold and silver values have been returned. A 10 cm chip sample collected in 1988 from a quartz veinlet cutting altered granite on WH 1 claim returned 15,900 ppb (0.46 oz/ton) gold and 1100.9 ppm (32.1 oz/ton) silver. A 1.5 m chip sample collected in 1989 from silicified quartz diorite in a trench exposure on WH 2 claim yielded 33.5 ppm (0.98 oz/ton) silver and 30 ppb gold. The two 1990 trenches failed to reveal any significant mineralization and sample results were all low.

\*\*\*\*

5.0

**G E O C H E M I S T R Y**

5.1

**SAMPLING PROCEDURE**

A total of 843 soil samples were collected from the WH 9-12 claims in 1991. Initial (400m x 50m) grid sampling yielded 653 soils and fill-in sampling (50m x 50m) surrounding selected anomalous sample sites produced an additional 190. East-west claim lines served as baselines, spaced 1500 metres apart. They were measured with a hip chain, marked with pink flagging and, at 50m stations, marked with grid-numbered, waterproof Tyvek tags plus pink and blue flagging. North-south soil lines were established using hip chain and compass and soil stations at 50m intervals were similarly identified with tags plus orange and blue flagging. Subsequent fill-in line locations were determined from existing initial grid stations. Samples were collected from the "B" horizon with mattocks and placed in Kraft paper bags marked with the appropriate grid coordinates. The samples were sent to Acme Analytical Laboratories Ltd. in Vancouver where they were dried, sieved and the -80 mesh fraction used for gold analysis. Each sample was tested for gold by atomic absorption following aqua regia digestion and MIBK extraction from a 10 gram sample.

The wide-spaced grid sampling of this portion of the property was adopted to economically explore the largest extent reasonable, at the risk of missing narrow, high grade gold veins which may lie between 400 metre-spaced lines. It was hoped that this "first pass" sampling would identify sites with anomalous levels of gold which, with more detailed fill-in sampling, could outline gold trends which would warrant further exploration.

5.2

**RESULTS** (Plate 1)

The 1991 gold soil geochemical results are plotted on Plate 1. The location of the geochemical grid is keyed on Figure 2. All 1991 soil sample analytical certificates are contained in Section 10.0

Increasing symbol sizes on Plate 1 correspond to values  $\leq 10$ , 11-20, 21-50, 51-100, >100 ppb Au. Only results greater than 5 ppb Au are plotted on the map. Values of 1 to 4 ppb are considered to be background and those greater than 20 ppb are significant anomalies which warrant follow-up sampling.

Contamination affected most of the 34 soils from the northern half of line 5800E (00S to 1650 SA) giving spurious gold values, several greater than 1000 ppb. A number of sample pulps from this line, as well as from lines to the east and west, were analyzed for 30 elements by ICP to try and determine the source of the contamination. The reanalyses confirmed most of the high gold values and also showed enrichment in silver. However, all other elements gave low results. It is expected in this geological environment that higher Cu, Pb, Zn and Fe values would be associated with high grade gold-silver mineralization. Therefore, it is concluded that the gold and silver in the pulps may have been introduced during sample preparation. It is possible that native gold particles from high grade samples processed prior to line 5800E were caught in the screen and shaken into the pulps during sieving.

Resampling was undertaken at all of the sites of suspect samples and gold analyzed by the same MIBK/AA method. The gold values were much lower, being predominantly background, with the exception of 86 ppb at 5800E, 1600S which had originally returned 3 ppb Au. The results of the resamples are shown on Plate 1. The gold values from the original samples, as well as the 30 element ICP analyses are included in the analytical reports (Section 10.0).

The "first pass" sampling returned ten values greater than 20 ppb Au, to a high of 86 ppb, dispersed widely across the grid. Fill-in sampling around these sites confirmed the existence of anomalous gold in two of the areas. A small cluster of weakly anomalous values near the north end of line 5000E extends southeasterly for 150m and a weak anomaly at 7000E, 2100S may continue easterly for 150m.

In the middle section of lines 5400E and 5800E weakly to moderately anomalous gold values were not extended by fill-in results. Near the south ends of the same lines fill-in around scattered spot high values also failed to show any continuity.

The lack of confirmation or extension of most of the gold anomalies and the overall low order of anomalous values indicate very limited potential for discovery of a significant gold deposit in this area.

\*\*\*\*

6.0

PERSONNEL

Days Worked - 1991:

E.A.Balon, Prospector North Vancouver, BC	Jun 18,19; Aug 11	3 days sampling.
R.Champoux, Sampler Vancouver, BC	Jun 18-20, 27-30 July 1, Aug 11	9 days sampling
R. Harwood, Sampler Nelson, BC	Jun 20, 27-30 July 1, Aug 11	7 days sampling
M.Steiner, Sampler Coquitlam, BC	Jun 18-20, 27-30 July 1, Aug 11	9 days sampling
J.D.Rowe, Geologist North Vancouver, BC		3 days report preparation

\*\*\*\*

7.0

STATEMENT OF EXPENDITURES

WH PROPERTY

PROFESSIONAL, TECHNICAL & GEOLOGICAL SERVICES .....	\$2,675
SALARIES & BENEFITS .....	3,079
GEOCHEM ANALYSIS .....	4,552
VEHICLE RENTAL .....	604
EQUIPMENT, & RADIO RENTALS .....	166
PRINTING, TELEPHONE, INSURANCE .....	67
FREIGHT .....	246
TRAVEL & ACCOMMODATION .....	2,091
FIELD SUPPLIES .....	510
VEHICLE EXPENSE (FUEL) .....	<u>160</u>
<b>TOTAL EXPENDITURES</b>	<b><u>\$14,150</u></b>

\*\*\*\*

8.0

REFERENCES

DESCHENES, M., LETIENT, H. and PEASE, R.:

1989: Property and Assessment Report for the 1989 Work Program on the WH Property. BC Assessment Report.

JAKUBOWSKI, W.J.:

1991: 1990 Drilling, Trenching, Geochemical and Geophysical (Assessment) Report on the Elk Property

1991: Personal Communication.

KRUECKL, G.P.:

1984: Report on the Disko 2 & 3 Claims for De La Mothe Exploration Services. Private Report.

LIVGARD, E.:

1986: Report on the Kathleen Mountain Mineral Property for Transglobe Resources Ltd. Private Report.

MONGER, J.W.H.:

1989: Geol. Surv. of Canada Map 41-1989, Geology, Hope, B.C. Scale 1:250,000

RICE, H.M.A.:

1947: Geol. Surv. of Canada Memoir 243, Geology and Mineral Deposits of Princeton Map-Area, British Columbia

ROWE, J.D.:

1989: 1988 Geochemical Report on the WH #1-4 Mineral Claims, BC Assessment Report.

1991: 1991 Geochemical and Trenching Report on the WH #1-8 Mineral Claims, B.C. Assessment Report.

THOMAS, P.:

1984: Geological Report on Disko 2 & Disko 3, Kathleen Mountain. Assessment Report 12790.

WEYMARK, W.J.:

1985: Diamond Drilling Assessment Report 14556, Kathleen Mineral Claims Group.

\*\*\*\*

9.0 STATEMENT OF QUALIFICATIONS

I, Jeffrey D. Rowe, of North Vancouver, British Columbia hereby certify that:

1. I am a geologist residing at 2596 Carnation Street, and employed by Cordilleran Engineering Ltd, of 1980 - 1055 West Hastings Street, Vancouver, British Columbia V6E 2E9.
2. I have received a B.Sc. degree in Honours Geology from the University of British Columbia, Vancouver, B.C. in 1975.
3. I have practiced my profession for eighteen years in British Columbia, Yukon and Quebec.
4. I am the author of this report and supervisor of the field work conducted on the WH claims during the period June 18 to August 11, 1991.

CORDILLERAN ENGINEERING LTD.



Jeffrey D. Rowe, B.Sc.,  
Geologist

JDR/z  
December, 1991  
Vancouver, B.C.

10.0

**ANALYTICAL RESULTS**

By:

**ACME ANALYTICAL LABORATORIES LTD.  
852 E. Hastings Street  
Vancouver, BC V6A 1R6**

## GEOCHEMICAL ANALYSIS CERTIFICATE

Cordilleran Engineering Ltd. PROJECT WH #2 FILE # 91-2367 Page 1

1980 - 1055 W. Hastings St., Vancouver BC V6E 2E9 Attn: MARK STEINER

SAMPLE#	AU* ppb	SAMPLE#	AU* ppb	SAMPLE#	AU* ppb	SAMPLE#	AU* ppb	SAMPLE#	AU* ppb	SAMPLE#	AU* ppb
3800E 50S	4	3800E 2050S	5	4200E 1400S	1	4300E 850S	3	4600E 1600S	2	5000E 350S	23
3800E 100S	4	3800E 2100S	2	4200E 1450S	3	4300E 900S	1	4600E 1650S	1	5000E 400S	20
3800E 150S	3	3800E 2150S	3	4200E 1500S	17	4400E 900S	2	4600E 1700S	1	5000E 450S	7
3800E 200S	4	3800E 2200S	5	4200E 1550S	2	4400E 950S	1	4600E 1750S	1	5000E 500S	2
3800E 250S	10	3800E 2250S	1	4200E 1600S	2	4400E 1000S	1	4600E 1800S	2	5000E 550S	6
3800E 400S	1	3800E 2300S	1	4200E 1700S	1	4400E 1050S	3	4600E 1850S	1	5000E 600S	4
3800E 500S	1	3800E 2350S	1	4200E 1750S	1	4400E 1100S	14	4600E 1900S	1	5000E 650S	2
3800E 550S	1	3800E 2400S	5	4200E 1800S	2	4600E 50S	1	4600E 1950S	1	5000E 700S	2
3800E 600S	1	3800E 2450S	2	4200E 1850S	2	4600E 100S	2	4600E 2000S	2	5000E 750S	4
3800E 650S	1	3800E 2500S	1	4200E 1900S	1	4600E 150S	1	4600E 2050S	1	5000E 800S	4
3800E 700S	4	3800E 2550S	2	4200E 1950S	1	4600E 200S	3	4600E 2100S	2	5000E 900S	4
3800E 750S	2	3800E 2600S	1	4200E 2000S	1	4600E 250S	1	4600E 2150S	1	5000E 950S	1
3800E 800S	1	3800E 2650S	1	4200E 2050S	4	4600E 300S	5	4600E 2200S	1	5000E 1000S	1
3800E 850S	3	3800E 2700S	4	4200E 2100S	2	4600E 350S	1	4600E 2250S	1	5000E 1050S	1
3800E 900S	1	3800E 2750S	2	4200E 2150S	1	4600E 400S	1	4600E 2300S	2	5000E 1100S	3
3800E 950S	1	3800E 2800S	1	4200E 2200S	2	4600E 450S	1	4600E 2350S	1	5000E 1150S	1
3800E 1000S	1	3800E 2850S	1	4200E 2250S	1	4600E 500S	4	4600E 2400S	2	5000E 1200S	1
3800E 1050S	1	3800E 2900S	1	4200E 2300S	1	4600E 550S	3	4600E 2450S	1	5000E 1250S	4
3800E 1100S	4	3800E 2950S	4	4200E 2350S	1	4600E 600S	1	4600E 2500S	1	5000E 1300S	5
3800E 1150S	2	3800E 2975S	2	4200E 2400S	3	4600E 650S	1	4600E 2550S	1	5000E 1350S	3
3800E 1200S	3	4200E 100S	2	4200E 2450S	1	4600E 700S	1	4600E 2600S	1	5000E 1400S	2
3800E 1250S	3	4200E 150S	1	4200E 2500S	1	4600E 750S	1	4600E 2650S	1	5000E 1450S	2
3800E 1300S	1	4200E 200S	4	4200E 2550S	4	4600E 800S	1	4600E 2700S	1	5000E 1500S	1
3800E 1350S	1	4200E 250S	2	4200E 2600S	2	4600E 850S	1	4600E 2750S	1	5000E 1550S	1
3800E 1400S	2	4200E 300S	6	4200E 2650S	2	4600E 900S	1	4600E 2800S	1	5000E 1600S	2
3800E 1450S	1	4200E 350S	3	4200E 2700S	3	4600E 950S	2	4600E 2850S	1	5000E 1650S	3
3800E 1500S	2	4200E 400S	2	4200E 2750S	3	4600E 1000S	2	4600E 2900S	1	5000E 1700S	1
3800E 1550S	1	4200E 450S	2	4200E 2800S	2	4600E 1100S	3	4600E 2950S	1	5000E 1750S	1
3800E 1600S	1	4200E 500S	1	4200E 2850S	1	4600E 1150S	1	4600E 2975S	1	5000E 1800S	2
3800E 1650S	1	4200E 550S	2	4200E 2900S	1	4600E 1200S	1	5000E 00S	2	5000E 1850S	2
3800E 1700S	3	4200E 1100S	3	4300E 550S	1	4600E 1250S	1	5000E 50S	1	5000E 1900S	1
3800E 1750S	1	4200E 1150S	1	4300E 600S	1	4600E 1300S	1	5000E 100S	1	5000E 1950S	4
3800E 1800S	4	4200E 1200S	1	4300E 650S	1	4600E 1400S	1	5000E 150S	1	5000E 2050S	1
3800E 1850S	1	4200E 1250S	12	4300E 700S	2	4600E 1450S	1	5000E 200S	2	5000E 2100S	4
3800E 1950S	1	4200E 1300S	8	4300E 750S	1	4600E 1500S	1	5000E 250S	1	5000E 2150S	2
3800E 2000S	1	4200E 1350S	2	4300E 800S	1	4600E 1550S	10	5000E 300S	2	5000E 2200S	5
STANDARD AU-S	49	STANDARD AU-S	48	STANDARD AU-S	45	STANDARD AU-S	46	STANDARD AU-S	49	STANDARD AU-S	47

- SAMPLE TYPE: SOIL AU\* ANALYSIS BY ACID LEACH/AA FROM 10 GN SAMPLE.

DATE RECEIVED: JUL 8 1991

DATE REPORT MAILED: July 15/91

RECEIVED  
JUL 16 1991SIGNED BY: *C. Leong* D. TOYE, C. LEONG, J. WANG; CERTIFIED B.C. ASSAYERS

SAMPLE#	AU* ppb	SAMPLE#	AU* ppb
5000E 2250S	13	5400E 1150S	3
5000E 2300S	1	5400E 1200S	1
5000E 2350S	1	5400E 1250S	1
5000E 2400S	1	5400E 1300S	2
5000E 2450S	35	5400E 1350S	2
5000E 2500S	2	5400E 1400S	1
5000E 2550S	1	5400E 1500S	2
5000E 2600S	1	5400E 1550S	2
5000E 2650S	1	5400E 1600S	2
5000E 2700S	1	5400E 1650S	28
5000E 2750S	2	5400E 1700S	24
5000E 2800S	1	5400E 1750S	3
5000E 2850S	5	5400E 1800S	1
5000E 2900S	4	5400E 1850S	1
5000E 2950S	2	5400E 1900S	5
5000E 3000S	1	5400E 1950S	1
5000E 3050S	1	5400E 2000S	2
5400E 200S	2	5400E 2050S	1
5400E 250S	1	5400E 2100S	1
5400E 300S	1	5400E 2150S	1
5400E 350S	1	5400E 2200S	4
5400E 400S	1	5400E 2250S	1
5400E 450S	3	5400E 2300S	1
5400E 500S	14	5400E 2350S	1
5400E 550S	1	5400E 2400S	1
5400E 600S	5	5400E 2450S	2
5400E 650S	4	5400E 2500S	1
5400E 700S	1	5400E 2550S	3
5400E 750S	1	5400E 2600S	1
5400E 800S	2	5400E 2650S	3
5400E 850S	1	5400E 2700S	1
5400E 900S	1	5400E 2750S	1
5400E 950S	1	5400E 2800S	1
5400E 1000S	9	5400E 2850S	3
5400E 1050S	2	5400E 2900S	1
5400E 1100S	1	5400E 2950S	1
STANDARD AU-S	48	STANDARD AU-S	51

SAMPLE#	Mo ppm	Cu ppm	Pb ppm	Zn ppm	Ag ppm	Ni ppm	Co ppm	Mn ppm	Fe %	As ppm	U ppm	Au ppm	Th ppm	Sr ppm	Cd ppm	Sb ppm	Bi ppm	V ppm	Ca %	P %	La ppm	Cr ppm	Mg %	Ba ppm	Ti %	B ppm	Al %	Na %	K %	M ppm
5400E 1150S	1	13	6	96	.4	17	8	416	2.79	2	5	ND	4	24	1.2	2	2	53	.28	.143	6	20	.55	100	.21	2	2.25	.03	.11	1
5400E 1200S	1	14	12	97	.2	10	6	350	2.43	2	5	ND	2	20	.8	2	2	49	.22	.070	12	14	.24	141	.12	2	2.14	.02	.09	1
5400E 1250S	1	12	8	96	.5	10	7	875	3.21	2	5	ND	2	32	1.3	2	2	70	.33	.072	18	11	.38	159	.21	2	1.86	.03	.11	1
5400E 1300S	1	11	10	108	.3	10	6	697	2.67	2	5	ND	1	25	.9	2	2	54	.31	.099	9	15	.35	123	.16	2	1.76	.03	.10	1
5400E 1350S	1	13	5	88	.4	25	11	358	3.11	2	5	ND	3	40	1.1	2	2	59	.48	.209	8	31	.69	299	.24	2	1.85	.03	.41	1
5400E 1400S	1	9	9	93	.4	14	9	375	3.38	2	5	ND	3	37	1.0	2	2	68	.52	.130	8	20	.55	146	.22	2	1.48	.03	.33	1
5400E 1500S	1	9	13	80	.3	10	5	395	2.17	2	5	ND	3	29	.9	2	2	42	.34	.090	12	17	.26	119	.10	2	1.03	.02	.12	1
5400E 1550S	1	11	9	203	.5	10	6	535	2.37	3	5	ND	3	45	.7	2	2	46	.50	.157	10	16	.25	235	.13	4	1.35	.03	.15	1
5400E 1600S	2	14	12	115	.5	9	4	543	1.46	2	9	ND	1	172	.9	2	2	29	1.92	.069	10	13	.25	261	.06	6	.82	.02	.12	1
5400E 1650S	1	21	12	132	.7	13	9	575	3.48	2	5	ND	4	68	1.1	2	2	67	.65	.109	21	16	.64	260	.19	2	1.82	.02	.30	1
5400E 1700S	1	11	9	146	.4	8	6	1176	2.76	2	5	ND	2	54	1.0	2	2	55	.53	.181	9	14	.32	314	.11	2	1.16	.02	.13	1
5400E 1750S	1	11	8	76	.4	9	6	248	2.58	3	5	ND	3	31	.4	2	2	56	.28	.048	11	14	.37	129	.13	2	1.15	.02	.17	1
5400E 1800S	1	4	8	123	.4	10	4	597	1.90	4	5	ND	3	15	.2	2	2	36	.16	.071	4	13	.14	125	.11	2	1.13	.02	.05	1
5400E 1850S	1	17	12	148	.5	16	6	269	2.80	2	5	ND	4	17	.6	2	3	53	.22	.099	8	23	.32	146	.15	2	2.30	.03	.08	1
5400E 1900S	1	8	9	179	.4	8	5	711	2.33	2	5	ND	4	14	.5	2	2	45	.17	.135	7	12	.12	99	.11	2	1.42	.02	.07	1
5400E 1950S	1	7	12	127	.3	7	4	355	2.13	2	5	ND	2	19	.3	2	2	41	.20	.072	7	11	.13	105	.09	2	1.27	.02	.08	1
5400E 2000S	1	6	7	112	.4	7	4	419	2.15	2	6	ND	1	18	.3	2	2	44	.17	.059	6	12	.12	141	.09	2	.97	.02	.09	1
5400E 2050S	1	8	13	193	.4	8	7	1456	3.08	2	6	ND	7	31	.7	2	7	50	.32	.104	21	11	.55	274	.13	2	2.00	.02	.29	1
5400E 2100S	1	8	8	156	.4	9	5	825	2.29	2	5	ND	4	32	.5	2	2	43	.28	.082	9	14	.16	218	.09	2	1.23	.03	.11	1
5400E 2150S	1	8	15	94	.4	7	6	653	2.64	2	9	ND	6	39	.3	2	2	50	.37	.067	18	14	.38	152	.11	2	1.10	.02	.25	1
5400E 2200S	1	12	8	196	.3	8	5	861	2.34	2	5	ND	6	55	.9	2	2	42	.40	.239	11	11	.16	309	.13	3	1.63	.04	.13	1
5400E 2250S	1	4	6	84	.3	6	3	153	1.55	2	5	ND	3	26	.4	2	2	29	.16	.069	8	10	.07	108	.06	2	.80	.02	.07	1
5400E 2300S	1	8	6	124	.5	8	4	280	2.15	2	5	ND	2	21	.4	2	2	45	.19	.086	6	13	.11	159	.11	2	1.13	.03	.06	1
5400E 2350S	1	12	13	177	.4	11	5	455	2.23	3	5	ND	4	24	1.4	2	2	42	.24	.110	7	13	.18	181	.13	2	1.74	.03	.08	1
5400E 2400S	1	16	10	154	.4	14	6	668	2.63	2	5	ND	5	23	.5	3	4	48	.24	.142	13	21	.20	175	.15	2	2.33	.03	.09	1
5400E 2450S	1	9	7	191	.5	9	5	541	2.60	2	5	ND	4	31	.5	2	2	51	.25	.072	7	13	.20	148	.14	2	1.52	.03	.11	1
5400E 2500S	1	9	6	188	.4	8	5	587	2.56	2	5	ND	6	33	1.4	2	2	51	.26	.062	4	13	.19	160	.14	2	1.37	.03	.09	1
5400E 2550S	1	11	9	175	.5	9	6	568	2.80	2	5	ND	4	27	.4	2	2	52	.32	.064	7	14	.32	143	.13	2	1.60	.03	.11	1
5400E 2600S	1	14	12	176	.4	10	6	682	2.64	2	5	ND	4	33	1.1	2	2	50	.37	.094	8	13	.31	203	.14	2	1.88	.03	.10	1
5400E 2650S	1	13	11	144	.6	10	6	496	3.03	2	5	ND	8	29	.2	2	8	52	.31	.081	11	15	.38	161	.15	3	1.83	.02	.15	1
5400E 2700S	1	13	8	180	.4	12	6	997	2.80	2	8	ND	6	39	1.3	2	5	49	.38	.046	10	19	.38	228	.17	4	2.09	.03	.27	1
5400E 2750S	1	9	5	98	.4	9	5	374	2.99	2	5	ND	6	26	.6	2	3	58	.25	.034	10	20	.25	96	.14	2	1.13	.02	.14	1
5400E 2800S	1	7	5	130	.5	8	5	591	2.61	2	5	ND	4	26	1.2	2	2	51	.25	.035	6	13	.17	146	.15	3	1.27	.03	.14	1
5400E 2850S	1	13	10	173	.6	13	6	594	3.05	2	6	ND	7	42	.6	2	8	59	.40	.139	8	20	.36	185	.16	4	1.65	.03	.17	1
5400E 2900S	1	11	6	69	.5	5	4	267	2.28	2	5	ND	3	45	.2	2	2	40	.34	.012	16	12	.14	74	.13	2	1.38	.04	.08	1
5400E 2950S	1	23	7	107	.7	8	5	648	2.80	2	6	ND	11	64	.6	2	7	49	.50	.019	39	14	.20	102	.15	3	1.75	.03	.15	1
STANDARD C	19	60	35	132	7.5	70	31	1047	3.96	43	25	7	40	52	17.1	15	21	57	.48	.089	37	59	.88	176	.09	32	1.88	.06	.14	11

SAMPLE#	AU* ppb	SAMPLE#	AU* ppb
5400E 3000S	43	5800E 1700S	3
5800E 00S	11800	5800E 1750S	4
5800E 50S	63500	5800E 1800S	8
5800E 100S	14000	5800E 1850S	3
5800E 150S	6800	5800E 1900S	3
5800E 200S	690	5800E 1950S	2
5800E 250S	1820	5800E 2000S	2
5800E 300S	1120	5800E 2050S	1
5800E 350S	5000	5800E 2100S	3
5800E 400S	2220	5800E 2150S	2
5800E 450S	1270	5800E 2200S	1
5800E 500S	120	5800E 2250S	1
5800E 550S	390	5800E 2300S	4
5800E 600S	1600	5800E 2350S	3
5800E 650S	110	5800E 2400S	1
5800E 700S	150	5800E 2450S	7
5800E 750S	740	5800E 2500S	3
5800E 800S	1550	5800E 2550S	4
5800E 850S	430	5800E 2600S	3
5800E 900S	120	5800E 2650S	6
5800E 950S	72	5800E 2700S	36
5800E 1000S	1290	5800E 2750S	4
5800E 1050S	1780	5800E 2800S	1
5800E 1100S	600	5800E 2850S	5
5800E 1150S	160	5800E 2900S	2
5800E 1200S	61	5800E 2975S	50
5800E 1250S	1230	6200E 100S	2
5800E 1300S	580	6200E 150S	2
5800E 1350S	24	6200E 200S	2
5800E 1400S	6000	6200E 250S	2
5800E 1450S	100	6200E 300S	2
5800E 1500S	99	6200E 350S	4
5800E 1550S	6	6200E 400S	2
5800E 1600S	3	6200E 450S	15
5800E 1650S	120	6200E 500S	2
5800E 1650SA	270	6200E 550S	7
STANDARD AU-S	51	STANDARD AU-S	48

SAMPLE#	Mo ppm	Cu ppm	Pb ppm	Zn ppm	Ag ppm	Ni ppm	Co ppm	Mn ppm	Fe %	As ppm	U ppm	Au ppm	Th ppm	Sr ppm	Cd ppm	Sb ppm	Bi ppm	V ppm	Ca %	P %	La ppm	Cr ppm	Mg %	Ba ppm	Ti %	B ppm	Al %	Na %	K %	V ppm
5400E 3000S	1	7	4	134	.1	5	4	601	1.57	2	5	ND	1	31	.2	2	2	28	.24	.072	11	7	.17	159	.09	2	1.33	.02	.08	1
5800E 00S	1	4	13	75	.6	4	4	239	1.53	2	5	3	2	37	.2	2	2	30	.19	.013	16	4	.11	213	.04	2	1.05	.02	.04	1
5800E 50S	1	7	17	119	6.3	7	4	402	1.94	2	5	43	3	12	.2	2	2	36	.10	.044	14	7	.11	146	.07	2	1.87	.02	.04	1
5800E 100S	2	7	8	114	1.0	5	4	374	1.63	2	5	9	3	14	.2	2	2	29	.13	.058	11	6	.10	166	.06	2	1.76	.02	.04	1
5800E 150S	1	6	9	117	1.3	4	4	461	1.60	2	5	7	6	12	.2	2	2	29	.10	.078	10	7	.10	100	.07	2	1.50	.02	.04	1
5800E 200S	1	3	8	96	.1	5	3	290	1.54	2	5	ND	3	26	.2	2	2	31	.17	.014	13	8	.15	126	.07	2	1.17	.02	.04	1
5800E 250S	1	4	5	57	.6	4	3	113	1.47	2	5	6	1	55	.2	2	2	29	.24	.006	11	6	.13	212	.08	2	1.21	.03	.04	1
5800E 300S	1	6	10	90	1.9	6	3	143	1.45	2	5	12	1	39	.2	2	2	29	.26	.009	12	8	.18	208	.09	2	1.41	.03	.04	1
5800E 350S	1	6	12	123	.2	4	4	852	1.50	2	5	ND	2	22	.2	2	2	29	.18	.068	12	5	.09	178	.06	2	1.30	.02	.04	1
5800E 400S	1	9	12	157	.1	7	5	669	1.94	2	5	ND	4	15	.2	2	2	33	.13	.069	13	5	.13	212	.08	2	2.10	.02	.06	1
STANDARD C	18	57	39	132	6.9	69	32	1041	3.95	42	20	6	38	52	18.5	15	19	54	.48	.090	38	58	.88	176	.09	32	1.88	.06	.15	11

SAMPLE#	Mo ppm	Cu ppm	Pb ppm	Zn ppm	Ag ppm	Ni ppm	Co ppm	Mn ppm	Fe %	As ppm	U ppm	Au ppm	Th ppm	Sr ppm	Cd ppm	Sb ppm	Bi ppm	V ppm	Ca %	P %	La ppm	Cr ppm	Mg %	Ba ppm	Ti %	B ppm	Al %	Na %	K %	V ppm
5800E 1700S	1	13	12	145	.4	12	5	229	2.22	2	15	ND	5	22	.2	2	6	39	.26	.113	12	12	.23	157	.11	2	1.74	.04	.11	1
5800E 1750S	1	9	7	131	.5	9	5	385	2.08	3	12	ND	3	28	.2	2	4	37	.32	.177	9	12	.19	178	.09	2	1.13	.03	.09	1
5800E 1800S	1	8	6	147	.3	11	6	401	2.23	2	11	ND	3	21	.2	3	6	41	.22	.068	8	11	.22	121	.12	3	1.53	.04	.08	1
5800E 1850S	1	7	9	172	.3	11	5	347	2.22	2	6	ND	3	16	.2	2	7	40	.17	.126	8	10	.15	150	.10	3	1.55	.03	.06	1
5800E 1900S	1	6	8	177	.5	10	5	535	1.72	2	21	ND	3	16	.2	2	8	32	.16	.155	6	8	.12	117	.10	2	1.34	.03	.07	1
5800E 1950S	1	8	9	121	.3	9	5	251	1.94	2	5	ND	2	22	.3	2	4	37	.23	.088	9	11	.17	107	.10	2	1.20	.04	.06	1
5800E 2000S	1	10	7	176	.6	14	5	536	2.03	2	13	ND	3	21	.4	3	6	35	.18	.172	9	9	.17	189	.12	2	1.82	.04	.09	1
5800E 2050S	1	8	6	123	.3	11	5	348	2.37	2	14	ND	3	23	.2	2	5	44	.24	.092	10	13	.22	182	.12	2	1.31	.04	.10	1
5800E 2100S	1	9	6	136	.3	12	6	383	2.48	2	13	ND	2	27	.2	2	8	45	.26	.082	10	11	.25	189	.13	2	1.67	.04	.11	1
5800E 2150S	1	9	7	118	.4	11	5	398	2.20	2	17	ND	3	28	.2	2	3	42	.26	.041	10	13	.21	142	.12	2	1.29	.03	.12	1
5800E 2200S	1	8	4	135	.2	11	7	350	2.94	2	11	ND	3	24	.2	2	2	55	.26	.085	9	13	.30	196	.16	2	1.90	.04	.11	1
5800E 2250S	1	8	6	179	.3	10	6	456	2.65	2	13	ND	4	23	.2	2	2	50	.23	.070	7	10	.24	169	.14	2	1.58	.04	.12	1
5800E 2300S	1	9	7	166	.3	8	5	450	2.26	2	12	ND	3	27	.3	2	5	41	.24	.076	7	8	.22	171	.12	3	1.47	.04	.13	1
5800E 2350S	1	9	6	209	.2	10	7	1366	3.05	2	7	ND	5	35	.2	2	2	52	.31	.078	10	11	.37	301	.17	3	1.87	.04	.31	1
5800E 2400S	1	11	2	202	.3	8	6	1174	2.33	2	11	ND	9	35	.7	3	2	40	.33	.087	9	9	.37	280	.14	4	1.03	.03	.29	1
5800E 2450S	1	8	8	85	.2	9	7	590	3.19	2	15	ND	17	27	.2	2	2	54	.33	.066	14	14	.42	147	.15	3	1.12	.03	.26	1
5800E 2500S	1	11	9	206	.2	12	7	360	3.05	2	9	ND	10	35	.3	2	2	47	.30	.197	13	15	.44	330	.14	2	1.90	.03	.15	1
5800E 2550S	1	10	7	245	.1	11	7	1188	2.63	2	5	ND	3	27	.2	2	2	44	.30	.086	11	10	.38	351	.15	4	2.10	.04	.16	1
5800E 2600S	1	4	6	198	.3	9	5	603	2.10	2	12	ND	4	25	.3	2	2	44	.26	.095	5	9	.15	178	.14	3	1.11	.06	.11	1
5800E 2650S	1	9	6	253	.3	9	6	1110	2.22	2	12	ND	2	32	.2	2	5	43	.34	.074	8	7	.27	284	.15	3	1.20	.04	.14	1
5800E 2700S	1	14	6	200	.3	11	7	488	2.56	2	9	ND	3	31	.2	2	2	46	.34	.144	10	10	.37	196	.16	3	1.93	.04	.13	1
5800E 2750S	1	6	5	281	.2	8	6	709	2.41	2	9	ND	7	23	.2	2	2	48	.22	.078	5	8	.22	203	.16	2	1.00	.03	.10	1
5800E 2800S	1	12	9	240	.2	15	10	1133	3.55	2	10	ND	5	30	.2	2	2	61	.39	.105	16	19	.69	208	.18	2	1.95	.03	.20	1
5800E 2850S	1	5	8	141	.2	8	4	656	1.93	2	5	ND	1	29	.2	2	3	39	.20	.025	5	9	.17	144	.11	2	1.18	.03	.10	1
5800E 2900S	1	11	5	169	.3	9	6	331	2.46	2	10	ND	3	38	.2	2	2	49	.34	.111	7	10	.25	254	.17	3	1.39	.05	.13	1
5800E 2975S	1	10	7	153	.2	8	5	401	1.94	3	7	ND	2	22	.2	2	2	40	.19	.064	4	8	.18	184	.13	2	1.53	.04	.06	2
6200E 100S	1	10	22	130	.6	7	5	235	1.96	4	18	ND	7	24	.2	3	2	41	.24	.063	18	11	.16	134	.08	2	1.22	.03	.08	1
6200E 150S	2	7	26	191	.5	10	6	598	2.08	2	14	ND	4	25	.2	4	3	43	.22	.110	10	10	.18	141	.10	3	1.90	.03	.07	96
6200E 200S	1	13	19	157	.9	13	5	179	2.03	5	18	ND	4	30	.2	2	5	38	.21	.062	15	16	.17	209	.11	2	2.58	.03	.07	1
6200E 250S	1	12	16	199	.6	11	6	323	2.08	3	6	ND	3	31	.2	2	2	41	.21	.067	12	13	.19	165	.12	2	2.09	.03	.05	1
6200E 300S	1	9	17	143	.4	9	4	301	1.76	3	6	ND	3	37	.2	2	3	36	.22	.065	10	15	.13	121	.09	2	1.19	.03	.05	1
6200E 350S	2	6	20	174	.4	6	5	176	1.82	2	5	ND	2	85	.2	2	2	30	.37	.039	9	10	.17	227						

SAMPLE#	AU* ppb	SAMPLE#	AU* ppb	SAMPLE#	AU* ppb	SAMPLE#	AU* ppb	SAMPLE#	AU* ppb	SAMPLE#	AU* ppb
6200E 600S	6	6200E 2400S	13	6600E 1200S	5	7000E 100S	2	7000E 1950S	4	7400E 700S	3
6200E 650S	5	6200E 2450S	4	6600E 1250S	3	7000E 150S	1	7000E 2000S	1	7400E 750S	1
6200E 700S	4	6200E 2500S	3	6600E 1300S	1	7000E 200S	7	7000E 2050S	1	7400E 800S	4
6200E 750S	1	6200E 2550S	2	6600E 1350S	2	7000E 250S	2	7000E 2100S	25	7400E 850S	3
6200E 800S	1	6200E 2600S	2	6600E 1400S	1	7000E 300S	1	7000E 2150S	1	7400E 900S	1
6200E 850S	8	6200E 2650S	2	6600E 1450S	2	7000E 350S	1	7000E 2200S	3	7400E 950S	1
6200E 900S	3	6200E 2700S	2	6600E 1500S	1	7000E 400S	1	7000E 2250S	2	7400E 1000S	3
6200E 950S	1	6200E 2750S	2	6600E 1650S	1	7000E 450S	2	7000E 2300S	3	7400E 1050S	3
6200E 1000S	5	6200E 2800S	3	6600E 1700S	1	7000E 500S	3	7000E 2350S	4	7400E 1100S	3
6200E 1050S	1	6200E 2850S	2	6600E 1750S	2	7000E 550S	1	7000E 2400S	2	7400E 1150S	3
6200E 1100S	1	6200E 2900S	2	6600E 1800S	1	7000E 600S	1	7000E 2450S	2	7400E 1200S	1
6200E 1150S	1	6200E 2925S	3	6600E 1850S	1	7000E 650S	3	7000E 2500S	1	7400E 1250S	1
6200E 1200S	3	6600E 00S	2	6600E 1900S	1	7000E 700S	1	7000E 2550S	3	7400E 1300S	1
6200E 1250S	1	6600E 50S	4	6600E 1950S	5	7000E 750S	1	7000E 2600S	6	7400E 1350S	2
6200E 1300S	5	6600E 100S	3	6600E 2000S	1	7000E 800S	1	7000E 2650S	2	7400E 1400S	1
6200E 1350S	4	6600E 150S	3	6600E 2050S	2	7000E 850S	1	7000E 2700S	1	7400E 1450S	1
6200E 1400S	2	6600E 200S	2	6600E 2100S	1	7000E 900S	2	7000E 2750S	1	7400E 1500S	3
6200E 1450S	1	6600E 250S	1	6600E 2150S	1	7000E 950S	3	7000E 2800S	2	7400E 1550S	2
6200E 1500S	1	6600E 300S	1	6600E 2200S	1	7000E 1050S	4	7000E 2850S	3	7400E 1600S	1
6200E 1650S	1	6600E 350S	2	6600E 2250S	1	7000E 1100S	1	7000E 2900S	1	7400E 1660S	2
6200E 1675S	2	6600E 400S	2	6600E 2300S	5	7000E 1150S	1	7000E 2910S	4	7400E 1665S	2
6200E 1680S	1	6600E 450S	2	6600E 2350S	1	7000E 1200S	2	7000E 2915S	2	7400E 1675S	1
6200E 1700S	1	6600E 500S	2	6600E 2400S	4	7000E 1250S	1	7000E 2925S	2	7400E 1700S	4
6200E 1750S	1	6600E 550S	3	6600E 2450S	3	7000E 1300S	1	7400E 50S	5	7400E 1750S	1
6200E 1800S	1	6600E 600S	2	6600E 2500S	1	7000E 1350S	2	7400E 100S	1	7400E 1800S	1
6200E 1850S	1	6600E 650S	1	6600E 2550S	1	7000E 1400S	1	7400E 150S	2	7400E 1850S	1
6200E 1900S	2	6600E 700S	4	6600E 2600S	1	7000E 1450S	6	7400E 200S	2	7400E 1900S	2
6200E 1950S	1	6600E 750S	4	6600E 2650S	2	7000E 1500S	1	7400E 250S	2	7400E 1950S	2
6200E 2000S	4	6600E 800S	1	6600E 2700S	2	7000E 1550S	2	7400E 300S	3	7400E 2000S	1
6200E 2050S	5	6600E 850S	2	6600E 2750S	1	7000E 1600S	2	7400E 350S	4	7400E 2050S	1
6200E 2100S	1	6600E 900S	3	6600E 2800S	1	7000E 1650S	2	7400E 400S	3	7400E 2100S	11
6200E 2150S	1	6600E 950S	2	6600E 2850S	1	7000E 1700S	1	7400E 450S	1	7400E 2150S	2
6200E 2200S	2	6600E 1000S	2	6600E 2900S	1	7000E 1750S	1	7400E 500S	4	7400E 2200S	1
6200E 2250S	1	6600E 1050S	1	6600E 2910S	1	7000E 1800S	2	7400E 550S	5	7400E 2250S	1
6200E 2300S	1	6600E 1100S	1	6600E 2925S	1	7000E 1850S	1	7400E 600S	1	7400E 2300S	1
6200E 2350S	3	6600E 1150S	1	7000E 50S	2	7000E 1900S	1	7400E 650S	1	7400E 2350S	1
STANDARD AU-S	47	STANDARD AU-S	46	STANDARD AU-S	47	STANDARD AU-S	45	STANDARD AU-S	47	STANDARD AU-S	48

SAMPLE#	AU* ppb	SAMPLE#	AU* ppb
7400E 2400S	21	7800E 1200S	2
7400E 2450S	6	7800E 1250S	4
7400E 2500S	12	7800E 1300S	2
7400E 2550S	7	7800E 1350S	2
7400E 2600S	1	7800E 1400S	2
7400E 2650S	1	7800E 1450S	2
7400E 2700S	5	7800E 1500S	1
7400E 2750S	1	7800E 1550S	2
7400E 2800S	1	7800E 1600S	2
7400E 2850S	1	7800E 1650S	4
7400E 2900S	4	7800E 1700S	2
7400E 2925S	8	7800E 1750S	2
7800E 00S	2	7800E 1800S	1
7800E 50S	1	7800E 1850S	5
7800E 100S	1	7800E 1900S	1
7800E 150S	3	7800E 1950S	2
7800E 200S	1	7800E 2000S	3
7800E 250S	1	7800E 2050S	1
7800E 300S	1	7800E 2100S	2
7800E 350S	2	7800E 2150S	2
7800E 400S	1	7800E 2200S	2
7800E 450S	2	7800E 2250S	1
7800E 500S	1	7800E 2300S	3
7800E 550S	1	7800E 2350S	1
7800E 600S	1	7800E 2400S	2
7800E 650S	1	7800E 2450S	3
7800E 700S	1	7800E 2500S	3
7800E 750S	2	7800E 2550S	2
7800E 800S	4	7800E 2600S	3
7800E 850S	1	7800E 2650S	2
7800E 900S	3	7800E 2700S	2
7800E 950S	6	7800E 2750S	3
7800E 1000S	11	7800E 2800S	1
7800E 1050S	1	7800E 2850S	1
7800E 1100S	2	7800E 2900S	2
7800E 1150S	19	7800E 2910S	3
STANDARD AU-S	45	STANDARD AU-S	49

SAMPLE#	AU* ppb
7800E 2915S	2
7800E 2920S	15
7800E 2925S	2
7800E 2950S	3
7800E 2975S	2

**GEOCHEMICAL ANALYSIS CERTIFICATE**

Gordilleran Engineering Ltd. PROJECT WH. FILL IN #9 FILE # 91-3489 Page 1  
 1980 - 1055 W. Hastings St. Vancouver BC V6E 2E9 Attn: MARK STEINER

SAMPLE#	AU* ppb	SAMPLE#	AU* ppb	SAMPLE#	AU* ppb	SAMPLE#	AU* ppb	SAMPLE#	AU* ppb	SAMPLE#	AU* ppb
4850E 300S	4.6	5150E 350S	4.3	5500E 1700S	1.3	5800E 300S	3.3	5900E 2750S	1.6	7350E 2450S	1.1
4850E 350S	2.3	5150E 400S	4.6	5500E 1750S	1.2	5800E 350S	1.9	5900E 2875S	2.0	7450E 2350S	.7
4850E 400S	2.1	5150E 450S	.8	5500E 2950S	.8	5800E 400S	1.3	5900E 2925S	.8	7450E 2400S	2.6
4850E 450S	1.4	RE 5250E 1610S	2.4	5500E 3000S	.2	5800E 450S	17.5	5900E 2975S	3.5	7450E 2450S	1.1
4850E 2400S	.2	5150E 2400S	1.0	5500E 3050S	2.2	5800E 500S	1.9	5950E 2650S	4.3	7500E 2350S	1.3
4850E 2450S	8.4	5150E 2450S	.8	5550E 1600S	1.4	5800E 550S	1.2	5950E 2700S	.9	7500E 2400S	.7
4850E 2500S	1.6	5150E 2500S	4.6	5550E 1650S	1.3	5800E 600S	4.1	5950E 2750S	1.4	7500E 2450S	.2
4900E 300S	1.7	5250E 1610S	1.6	5550E 1700S	.8	5800E 650S	.4	5950E 2875S	.8	7550E 2350S	.9
4900E 350S	1.4	5250E 1650S	.6	5550E 1750S	1.0	5800E 700S	.3	5950E 2925S	2.4	7550E 2400S	.9
4900E 400S	1.2	5250E 1700S	2.2	5550E 2950S	2.0	5800E 750S	.9	5950E 2975S	1.8	7550E 2450S	1.1
4900E 450S	1.8	5250E 1750S	1.1	5550E 3000S	.8	5800E 800S	1.3	6850E 2050S	.5		
4900E 2400S	.5	5250E 2950S	2.2	5550E 3050S	1.4	5800E 850S	1.4	6850E 2100S	1.4		
4900E 2450S	.7	5250E 3000S	2.0	5650E 2650S	1.1	5800E 900S	1.9	6850E 2150S	1.9		
4900E 2500S	.4	5250E 3050S	1.9	5650E 2700S	8.1	5800E 950S	4.1	6900E 2050S	1.9		
4950E 300S	.2	5300E 1600S	1.8	5650E 2750S	.8	5800E 1000S	.6	6900E 2100S	1.4		
4950E 350S	3.3	5300E 1650S	2.3	5650E 2875S	.8	5800E 1050S	1.0	6900E 2150S	.9		
4950E 400S	1.2	5300E 1700S	.6	5650E 2925S	2.3	5800E 1100S	1.5	6950E 2050S	2.4		
4950E 450S	2.2	5300E 1750S	1.5	5650E 2975S	.6	5800E 1150S	1.4	6950E 2100S	.8		
4950E 2400S	1.1	5300E 2950S	1.5	5700E 2650S	2.3	5800E 1200S	1.8	6950E 2150S	4.2		
4950E 2450S	1.1	5300E 3000S	1.2	5700E 2700S	1.3	5800E 1250S	.5	7050E 2050S	5.8		
4950E 2500S	2.3	5300E 3050S	.2	5700E 2750S	.5	5800E 1300S	3.2	7050E 2100S	1.4		
5050E 300S	.8	5350E 1610S	.2	5700E 2875S	.7	5800E 1350S	.6	7050E 2150S	2.1		
5050E 350S	6.6	5350E 1650S	.6	5700E 2925S	1.1	5800E 1400S	1.3	7100E 2050S	1.4		
5050E 400S	2.5	5350E 1700S	.7	5700E 2975S	.3	5800E 1450S	1.0	7100E 2100S	1.3		
5050E 450S	5.1	5350E 1750S	3.4	5750E 2650S	.5	5800E 1500S	1.3	7100E 2150S	1.1		
5050E 2400S	2.1	5350E 2950S	.2	5750E 2700S	.6	5800E 1550S	9.3	7150E 2050S	4.3		
5050E 2450S	1.6	5350E 3000S	.7	5750E 2750S	.8	5800E 1600S	85.5	7150E 2100S	12.7		
5050E 2500S	2.1	5350E 3050S	1.3	5750E 2875S	3.0	5800E 1650S	2.8	7150E 2150S	1.7		
5100E 300S	1.4	5450E 1600S	10.4	5750E 2925S	.2	5850E 2650S	1.6	7250E 2350S	2.2		
5100E 350S	2.8	5450E 1650S	1.5	5750E 2975S	.6	5850E 2700S	.7	7250E 2400S	2.9		
5100E 400S	1.2	5450E 1700S	3.8	5800E 000S	.9	5850E 2750S	.2	7250E 2450S	2.0		
5100E 450S	34.4	5450E 1750S	7.1	5800E 050S	1.8	5850E 2875S	.9	RE 7150E 2100S	38.5		
5100E 2400S	3.1	5450E 2950S	9.9	RE 5750E 2875S	1.5	RE 5850E 2650S	.6	7300E 2350S	2.2		
5100E 2450S	3.5	5450E 3000S	3.1	5800E 100S	1.8	5850E 2925S	1.2	7300E 2400S	1.8		
RE 5100E 350S	2.1	5450E 3050S	1.8	5800E 150S	1.6	5850E 2975S	5.6	7300E 2450S	15.8		
5100E 2500S	1.0	5500E 1600S	1.0	5800E 200S	2.0	5900E 2650S	.3	7350E 2350S	3.8		
5150E 300S	2.4	5500E 1650S	.7	5800E 250S	.8	5900E 2700S	1.0	7350E 2400S	1.9		
STANDARD AU-S	45.8	STANDARD AU-S	45.8	STANDARD AU-S	47.2	STANDARD AU-S	47.8	STANDARD AU-S	45.5		

- SAMPLE TYPE: SOIL AU\* ANALYSIS BY ACID LEACH/AA FROM 10 GM SAMPLE.  
 Samples beginning 'RE' are duplicate samples.

DATE RECEIVED: AUG 14 1991 DATE REPORT MAILED: Aug 21/91  
 SIGNED BY: *C. King* D. TOYE, C. LEONG, J. WANG; CERTIFIED B.C. ASSAYERS AUG 22 1991

Samples beginning 'RE' are duplicate samples.

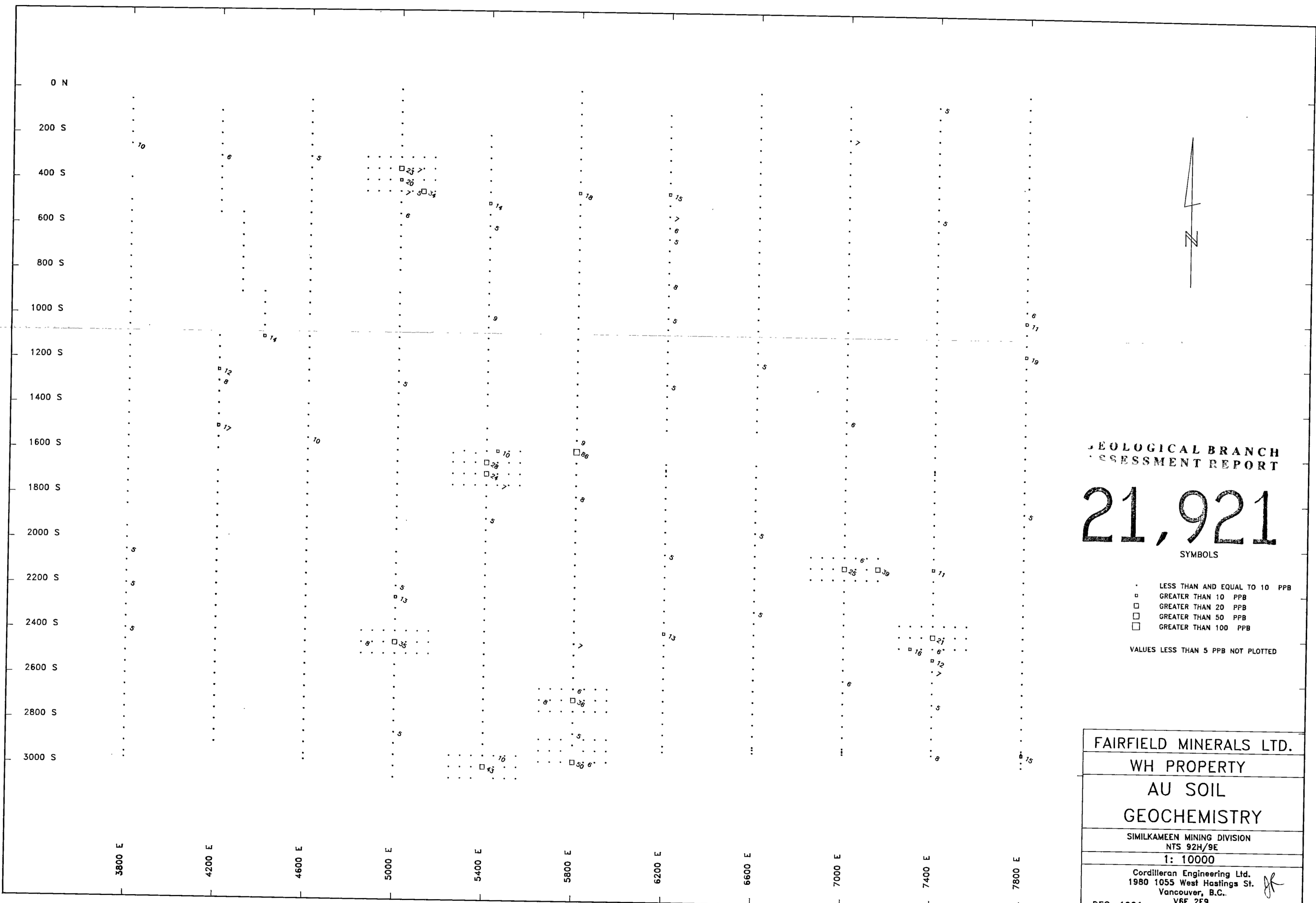

GEOLOGICAL BRANCH  
ASSESSMENT REPORT

21,921

SYMBOLS

- LESS THAN AND EQUAL TO 10 PPB
- ◻ GREATER THAN 10 PPB
- ◻ GREATER THAN 20 PPB
- ◻ GREATER THAN 50 PPB
- ◻ GREATER THAN 100 PPB

VALUES LESS THAN 5 PPB NOT PLOTTED

FAIRFIELD MINERALS LTD.
WH PROPERTY
AU SOIL
GEOCHEMISTRY
SIMILKAMEEN MINING DIVISION NTS 92H/9E
1: 10000
Cordilleran Engineering Ltd. 1980 1055 West Hastings St. Vancouver, B.C. V6E 2E9
DEC. 1991