

LOG NO: JAN 17	RD.
ACTION:	
FILE NO:	

STREAM MOSS MAT SAMPLES

and

GEOCHEMICAL ASSESSMENT REPORT

on the

PADDY-MAC GOLD PROPERTY
Omineca Mining Division
Carpenter Creek Area, Terrace, B.C.

Claims: PADDY MAC GOLD (7352) 20 units
J.M. (8137) 14 units
D.A. 305740 3 units

Latitude: 54 46' North
Longitude: 128 22' West
NTS: 103I/16W and 103I/9W

by

R.A. Neill

**GEOLOGICAL BRANCH
ASSESSMENT REPORT**

22,050

TABLE OF CONTENTS

1.0	INTRODUCTION	/
2.0	SUMMARY & CONCLUSIONS	/
3.0	LOCATION & ACCESS	✓
4.0	CLAIM INFORMATION	✓
5.0	PROPERTY HISTORY	✓
6.0	GEOLOGY	✓
	6.10 REGIONAL GEOLOGY	✓
	6.20 LOCAL GEOLOGY	✓
	6.210 MINERALIZATION	✓
	6.220 WORK DONE	✓
7.0	RECOMMENDATION	✓
8.0	COST STATEMENT	✓

LIST OF FIGURES

Fig.

- 3-1 Location Map ✓
- 4-1 Claim Map ✓
- 6-1 Regional Geology Mapping ✓
- 6-2 Grid Map ✓
- 6-3 Grid Location Map ✓
- ~~6-4 Creek Sample Location Map~~ sec 6-3

APPENDICES

- I - Laboratory Assay Sheets ✓
- II - References ✓
- III - Statement of Costs ✓

1.0 INTRODUCTION

This Report, written on behalf of the recorded owners R.A. Neill and D.A. Smithson field work carried out.

1. Describes field work carried out on the Paddy Mac Gold Group. During the period of October 23, 1991 to October 27, 1991.
2. Assay reports on Stream Sediment and Soil Samples taken from a grid.
3. Cost Statement.

2.0 SUMMARY & CONCLUSIONS

The Paddy-Mac Gold Group consists of a total of 37 units between the headwaters of Carpenter Creek and Sand Creek area North east of Terrace, B.C. Access to the Property is by Helicopter from Terrace or by NW Forestry Bridge over the Skeena River which is located 30 KM North East of Terrace. Then proceed on the logging road to the trial.

The Claim area was sampled by several Companies in the past with Assays of up to 10.8 oz/ton Au and 9.82 oz/ton Ag were obtained from the Quartz Vains. The surrounding area of the Claims is largely unmapped, due to its rugged Nature.

During the 1991 Field Work Program, a grid has been put in place on the South side of the mountain. The Vain is exposed on the North Side and dips into the mountain at 15 to 30 degrees. The South side is covered with overburden and forest. This Grid and Sampling is the start of a program to determine if the Vain continues from the North to South side of the mountain.

Some Mineralized Quarts was observed in an unnamed Creek. Which headwaters flow from the Property, that indicate the Vain may "expose" on the South side of the mountain.

Further work will be required to determine this.

3.0 LOCATION & ACCESS

The Paddy-Mac Gold Group is located approximately 30km North Northeast of Terrace, B.C., between the Headwaters of Carpenter and Sand Creeks, Southeasterly flowing tributaries of the Skeena River.

Elevations on the Property, ranges from 800m to 1700m. Location information is shown on Figures 3-1, 4-1, 4-11 and 5-1. The Claim area is typically rugged.

Access to the Property is by Helicopter from Terrace, B.C. or by trail up Carpenter Creek, which enters the Property from the Northeast side, with difficult climbing. Weather conditions should be taken in consideration when planning any exploration.

A new Forestry bridge across the Skeena River, along with bridges across Carpenter and Sand Creeks, has made access to the South side of the Property easier, by following the trail. Future logging road plans take roads onto the Property.

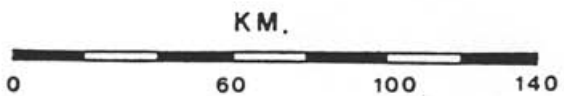
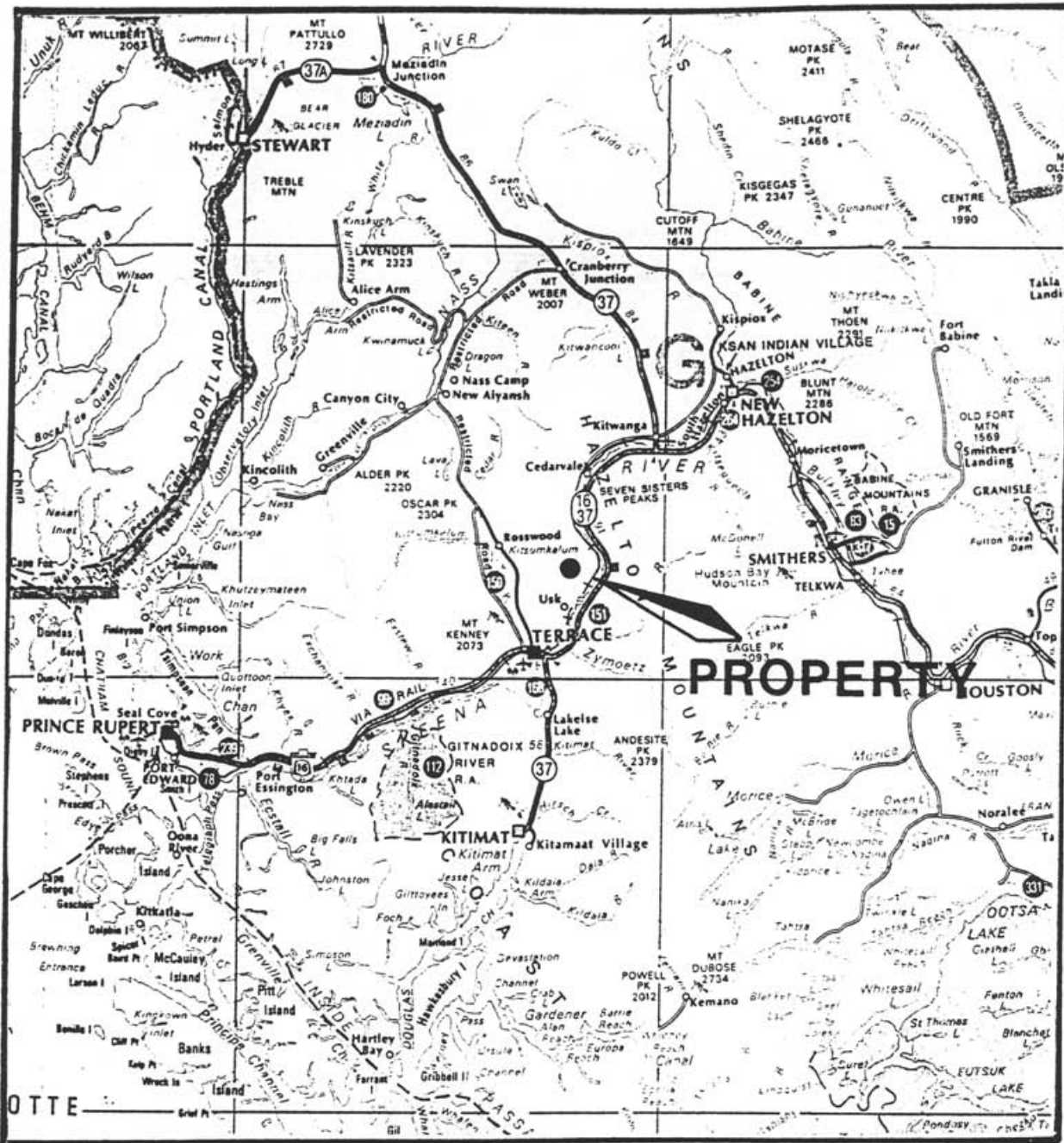

Paddy-Mac Cls.

Location Map

FIG. 3-1

4.0 CLAIM INFORMATION

The Paddy-Mac Gold Group Property consists of 3 Modified Grid Claims totally 37 units, in the Ominica Mining Division. Claim information is summarized as follows:

<u>CLAIM NAME</u>	<u>RECORD #</u>	<u>UNITS</u>	<u>EXPIRE DATE</u>
J.M.	8137	14	05 FEB. 1993
PADDY-MAC GOLD	7352	20	04 NOV. 1992
D.A.	305740	3	23 OCT. 1993

Expire Dates pending acceptance of this report.

MAP NO. 103 I/16W

4-1

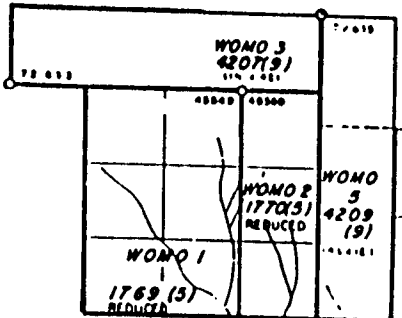

AATTARI MZ
9759(8)
SN x 4E

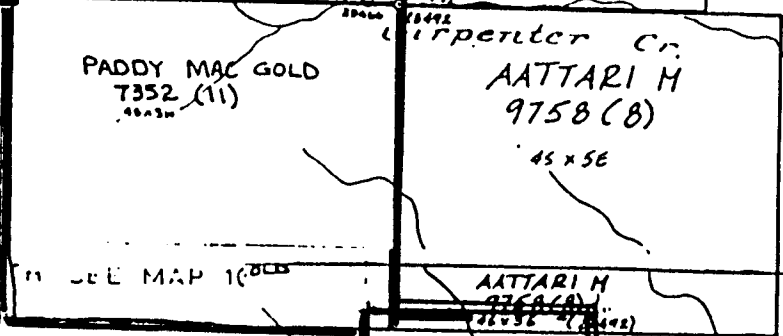
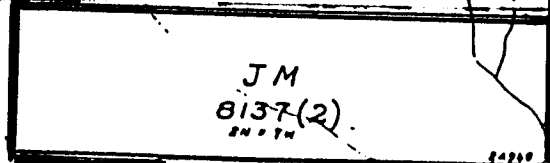

MINES DIVISION

TO SOUTH SEE MAP 103 I/16W

DEPARTMENT OF MINES AND
VICTORIA



L.C.P. FAC NO 222566

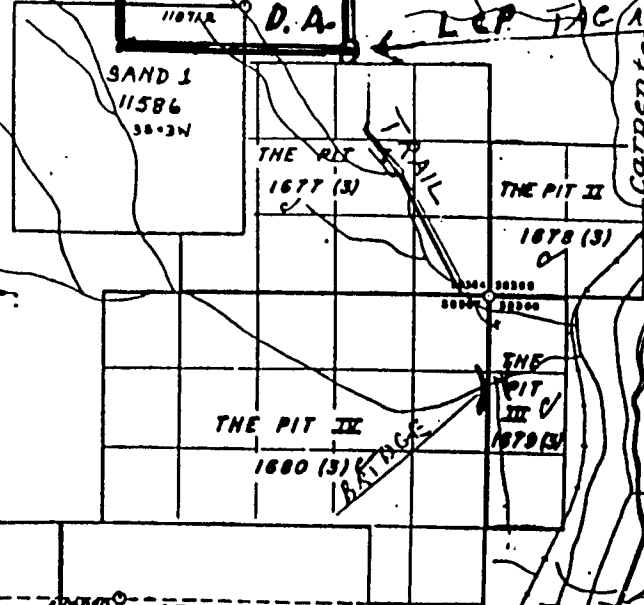

NEW BRIDGE

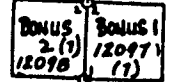

103 I/9W.

CLAIM MAP

Fig. 4-1

5.0 PROPERTY HISTORY

Old workings on the Paddy-Mac gold property include two short adits.

The Property was examined and sampled by Holt Engineering in 1980, also examined and sampled by Canamax Ltd. in 1986.

A description of these samplings are in the (Geological Assessment Report), by Burton Consulting. Submitted on Paddy-Mac Gold Property in 1990

Holt Engineering Ltd 1980 and Burton Consulting Inc. 1990 recommended further work.

6.0 GEOLOGY

6.10 REGIONAL GEOLOGY

The Geology of the Terrace Map area has been compiled most recently by Woodworth (1985). The pertinent portion of this compilation is shown on Fig. 6-1.

The West side of the Skeena River in the Carpenter Creek area is shown as an unmapped territory. The area to the North-West of the Paddy-Mac Gold Property is underlain by intrusive rocks ranging from Tertiary to late Cretaceous in Age.

6.20 LOCAL GEOLOGY

Taken from Burton Consulting Inc. Report 1990.

The most Prominent rocks are dark gray - black often rusty argillaceous sediments. These sediments are cut by a series of lamprophyre and felsitic dykes that strike Northeast with vertical dips that offset the veins.

Prominent light coloured dykes cut all other rock types and also cut the Quartz Vains. They strike Northwest and are steeply dipping.

Quartz Veins vary in thickness from a few centimeters to a Metre or more. They strike 30 degrees and dip at about 20 to 30 degrees South. The general surface trace is nearly East-West as the trace crosses from the base of the cliff in the east and rises in elevation as the trace moves westwards and upward.

The South side of the mountain is covered with overburden and Forested with old grothe. This area needs to be soil sampled to determine if Vains show up on the South side of the mountain.

6.210 MINERALIZATION

Economic Mineralization within and immediately surrounding the Quartz veins consists of visible galena and chalcopyrite with erratic Gold and Silver values detected by assaying. Gold assays of up to 10.8 oz/ton have been obtained.

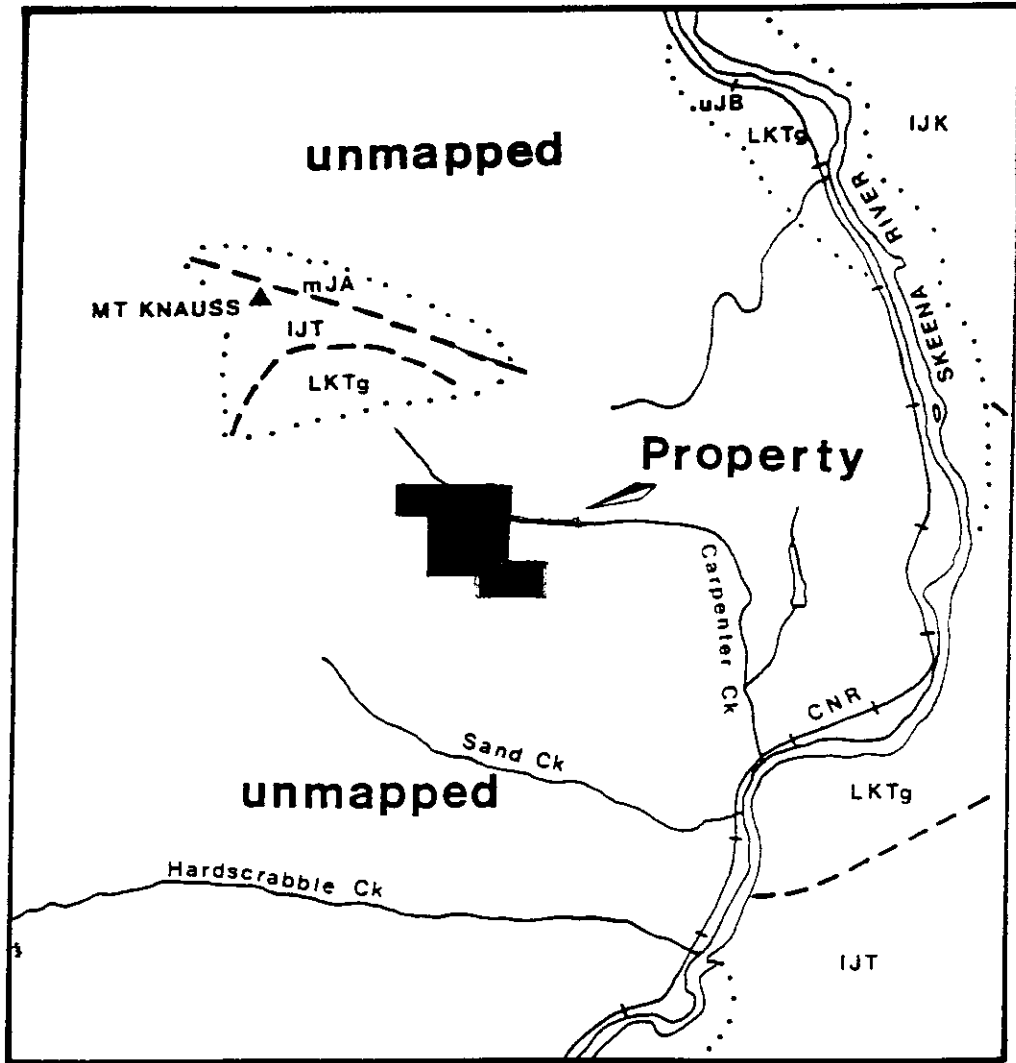

NTS 103 I - 9,16

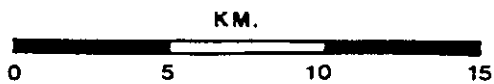

Paddy-Mac Cls.
<i>Regional Geology</i> After Woodsworth, 1985
FIG. 6-1

LEGEND

(TO ACCOMPANY FIGURE 6-1)

JB Middle and Upper Jurassic Bowser Lake Group; and Non Marine
U sandstone, siltstone, shale.

J
m a Middle and Upper Jurassic Ashman Formation; Thin-bedded
siltstone, shale, graywacke, conglomerate

J
I T Upper Triassic and Lower Jurassic Telkwa Formation (Kiselas
Volcanics; rhyolitic flows, tuffs, briccias.

KTg
L Late Cretaceous; post-tectonic quartz diorite, diorite,
granodiorite.

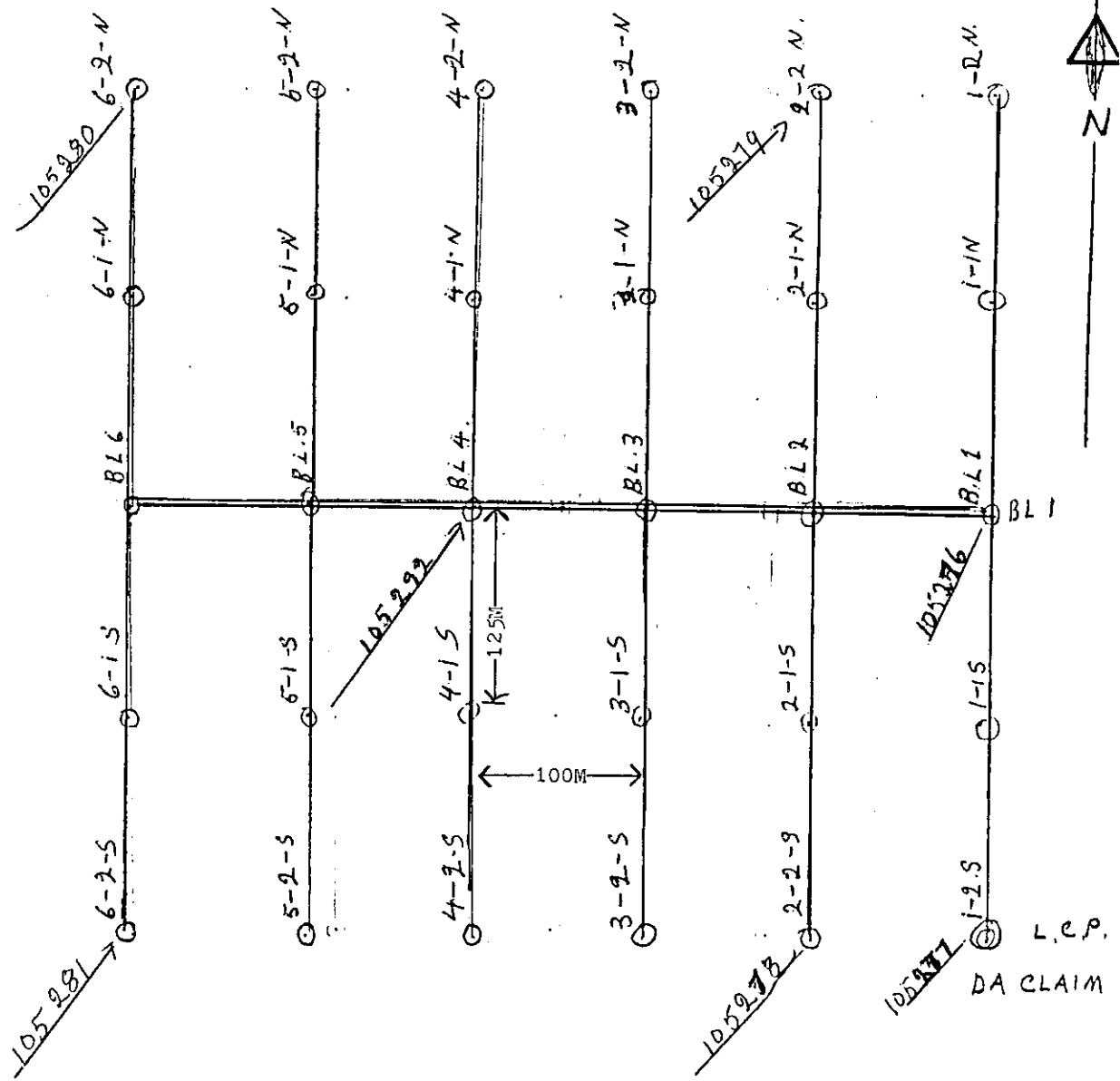

GRID COVERS 500M X 500M
30 STATIONS 30 SAMPLES

FIG. 6 --2

FIG 6-2

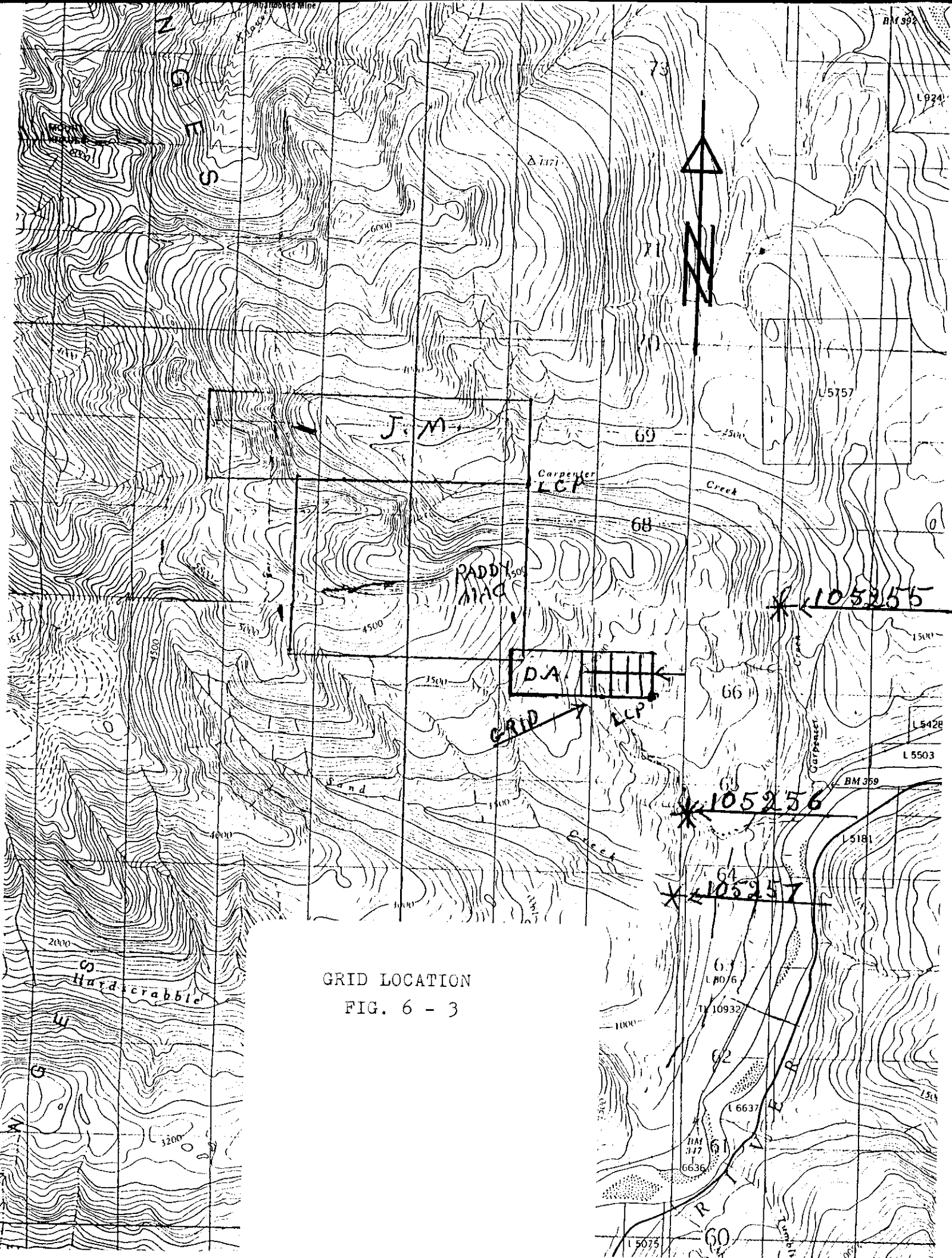

GRID LOCATION
FIG. 6 - 3

6.220 WORK DONE

During the period of October 23, 1991 to October 27, 1991 a grid was blazed and marked on the D.A. Claim. A base line running from East to West 500m with cross lines every 100m running 250m North and 250m South from 100m stations on a base line. These 6 lines are sampled at stations 125m apart.

Survey Control for grid and sampling was achieved using compass and hip chain.

The results of this work is shown on "Drawing of Grid) on figure 6-2.

A total of 30 soil samples were taken, a moss matt sample from Carpenter Creek, unnamed Creek and Sand Creek were taken. Locations of these three samples are marked on Fig. 6-3.

7.0 RECOMMENDATION

Further work is recommended on the Paddy-Mac Gold Property including:

- a surveying program (transit & Electronic Distance Meter) to establish a sufficient number of reference points to enable accurate drilling and sampling.
- further geological mapping and sampling to fill in and potentially extend knowledge of the vein structures.
- a diamond drilling program (large core) to test the extent of mineralized zones ("ore shoots").

APPENDIX 1

(LABRATORY ASSAY SHEETS)

Bondar Clegg & Company Ltd.
130 Pemberton Ave.
North Vancouver, B.C.
V7P 2R5
(604) 985-0681 Telex 04-352667



Certificate of Analysis

A DIVISION OF INCHCAPE INSPECTION & TESTING SERVICES

DATE PRINTED: 22-NOV-91

REPORT: V91-111746.4 (COMPLETE)

PROJECT: NONI GTUIN

PAGE 1

SAMPLE NUMBER	ELEMENT UNITS	Au OPT	Ag OPT	Cu PCT	Pb PCT	Zn PCT
X2 105255		0.081	0.13	<0.01	<0.01	<0.01
X2 105256		<0.0002	0.05	<0.01	<0.01	<0.01
X2 105257		<0.002	<0.02	<0.01	<0.01	<0.01

A DIVISION OF INCHCAPE INSPECTION & TESTING SERVICES

REPORT: V91-01747.0 (COMPLETE)

DATE PRINTED: 21-NOV-91

PROJECT: NONE GIVEN

PAGE 1A

SAMPLE NUMBER	ELEMENT UNITS	Ag PPM	Cu PPM	Pb PPM	Zn PPM	Mo PPM	Ni PPM	Co PPM	Cd PPM	Bi PPM	As PPM	Sb PPM
X1 105276		<0.2	20	10	42	3	9	4	<1.0	<5	<5	<5
X1 105277		<0.2	6	4	21	<1	3	1	<1.0	<5	<5	<5
X1 105278		<0.2	4	3	20	<1	2	1	<1.0	<5	<5	<5
X1 105279		<0.2	12	12	42	32	6	4	<1.0	<5	<5	<5
X1 105280		<0.2	51	10	59	4	12	5	<1.0	<5	10	<5
X1 105281		<0.2	8	12	45	7	7	4	<1.0	<5	<5	<5
X1 105292		<0.2	75	14	82	9	26	12	<1.0	<5	6	<5

REPORT: V91-01747.0 (COMPLETE)

DATE PRINTED: 21-NOV-91

PROJECT: NONE GIVEN

PAGE 1B

SAMPLE NUMBER	ELEMENT UNITS	Fe PCT	Mn PCT	Te PPM	Ba PPM	Cr PPM	V PPM	Sn PPM	N PPM	La PPM	Al PCT	Mg PCT
X1 105276		7.22	0.02	<10	39	29	88	<20	<20	2	1.89	0.22
X1 105277		4.78	0.02	<10	30	11	55	<20	<20	2	0.45	0.07
X1 105278		4.57	0.02	<10	30	11	54	<20	<20	1	0.50	0.10
X1 105279		8.19	0.03	<10	44	32	90	<20	<20	3	2.09	0.22
X1 105280		4.90	0.02	<10	52	20	55	<20	<20	6	2.63	0.30
X1 105281		7.06	0.02	<10	31	34	99	<20	<20	3	2.06	0.26
X1 105292		4.43	0.03	<10	138	30	60	<20	<20	6	2.94	0.62

A DIVISION OF INCHCAPE INSPECTION & TESTING SERVICES

REPORT: V91-01747.0 (COMPLETE)

DATE PRINTED: 21-NOV-91

PROJECT: NONE GIVEN

PAGE 1C

SAMPLE NUMBER	ELEMENT UNITS	Ca PCT	Na PCT	K PCT	Sr PPM	Y PPM
X1 105276		0.04	0.01	0.03	9	2
X1 105277		0.11	0.01	0.01	16	3
X1 105278		0.11	<0.01	0.02	17	3
X1 105279		0.06	<0.01	0.02	8	2
X1 105280		0.14	0.01	0.03	10	5
X1 105281		0.04	0.01	0.03	6	1
X1 105292		0.06	0.01	0.05	9	3

APPENDIX 11

REFERENCE

REFERENCE

Geological Assessment Report

The Paddy Mac Gold Property

by

D.A. Symonds B.S.E. F.G.A.C.

Burton Consulting Inc. Nov. 9, 1990

APPENDIX 111

STATEMENT OF COSTS

8.0 COST STATEMENT

Personnel: Reg Neill

- Oct. 23 to Oct. 27, 1991 (incl)
Field Work - 5 days at \$220.00 = \$1100.00

Robert Neill

- Oct. 23 to Oct. 27, 1991 (incl)
Field Work - 5 days at \$180.00 = \$900.00

James Neill

- Oct. 23 to Oct. 27, 1991 (incl)
Field Work - 5 days at \$180.00 = \$900.00

Ken Neill

- Oct. 23 to Oct. 27, 1991 (incl)
Field Work - 5 days at \$180.00 = \$900.00

TOTAL PERSONNEL: \$3800.00

ACCOMMODATION:

<u>Travel Trailer Rental:</u>	From Aug. 18 to Aug. 29, 1991 11 days at \$50.00 per day	\$550.00
Motel:	October 25, 1991	<u>60.00</u>
TOTAL ACCOMMODATION:		\$610.00

Food and Meals:

-	Oct. 18 meals on trip - (4 men)	\$62.30
-	Oct. 19 meals on trip - (4 men)	69.71
-	Oct. 28 meals on returned trip	54.35
-	Oct. 29 meals on returned trip	36.42
-	Oct. 23 to Oct 27, 1991 - 4 men 5 days in field at \$40.00 per day.	<u>\$800.00</u>
TOTAL FOOD AND MEALS:		\$1022.78

Supplies:

-	Oct. 14	maps	\$12.00
-	Oct. 15	flagging tape	32.50
-	Oct. 15	string for hip chain	12.32
-	Oct. 19 to 27	power saw rental	40.00
-	Oct. 25	camera & film	<u>21.63</u>
TOTAL SUPPLIES:			\$119.45

Transportation:

-	Oct. 19	truck & trailer - Ferry	\$ 56.50
-	Oct. 21	Victoria to Terrace 1400km at .40	560.00
-	Oct. 25	Ferry Back	56.50
-	Oct. 29	Terrace to Victoria 1400km at .40	<u>560.50</u>
		TOTAL TRANSPORTATION:	\$1233.00

Analytical Costs:

-	Nov.	Bondar - Clegg Lab.	
		Creek Moss Mat Analysis V087606	\$101.12
		7 soil samples - invoice no. V087561	<u>93.63</u>
			TOTAL: \$194.75

Miscellaneous:

-	Oct. 24	long distance call	\$2.45
-	Oct. 26	long distance call	1.50
-	Oct. 27	long distance call	<u>2.60</u>
		TOTAL MISCELLANEOUS:	\$6.55

Drafting and Report Preparation **TOTAL: \$186.00**

TOTAL EXPENSES: \$7,172.53



Province of British Columbia
 Ministry of Energy, Mines and Petroleum Resources
 MINERAL RESOURCES DIVISION - TITLES BRANCH

DOCUMENT No. 3009243
 OFFICE USE ONLY

Mineral Tenure Act
 SECTION 28

NOTICE TO GROUP

INDICATE TYPE OF TITLE MINERAL
 (Mineral or Placer)*

Sub Recorder
 RECEIVED
 T 29 1992
 M.R. = 14 355
 VICTORIA B.C.
 RECORDING STAMP

1. R.A. NEILL
 (Name)
568 LANGHOLME DRIVE
 (Address)
VICTORIA B.C.
4781807 V9C1K8
 (Telephone) (Postal Code)

Agent for SELF AND D.A. SMITHSON
 (Name)
 (Address)
 (Telephone) (Postal Code)

Valid subsisting FMC No. 302902 119455 Valid subsisting FMC No. 124983

FMC Code NEILRA. FMC Code

request that the following mineral titles be grouped under group name PADDY MAC GOLD

Mining Division OMINECA Map No. 103-I/9W-103I/16W.

Name of Claim	No. of Units	Title Number
<u>D.A.</u>	<u>3</u>	<u>305740</u>
<u>PADDY MAC 239039</u>	<u>20</u>	<u>7352</u>
<u>J.M. 239380</u>	<u>14</u>	<u>8137</u>

Name of Claim	No. of Units	Title Number

R.A. Neill has many years of prospecting experience and prospecting wide
 T.K.

R.A. Neill
 (Signature of Applicant)

*Note: Mineral claim(s) and lease(s) cannot be grouped with placer claims and leases