

**SUB-RECORDER  
RECEIVED**  
APR 23 1992  
M.R. #.....\$.....  
VANCOUVER, B.C.

LOG NO:	APR 27 1992	RD.
ACTION:		
FILE NO:		

**ASSESSMENT REPORT**  
  
**ON THE**  
**1991 DIAMOND DRILLING PROGRAM**  
  
**(PACIFIC TALC J&J PROJECT)**

**NEW WESTMINSTER MINING DIVISION**  
North Bend, British Columbia

Location:

NTS : 92 H/13 E, 92 I/4 E  
Latitude : 50° 0'48" N  
Longitude : 121° 34' 30" W

**GEOLOGICAL BRANCH  
ASSESSMENT REPORT**

Claims:

J&J 1 to 10  
Phantom

**22,260**

Owned By:  
Pacific Talc Ltd.  
408 - 1755 West Broadway  
Vancouver, BC  
V6J 4S5

Work Managed By:  
A. Ismay Associates, Inc.  
538 - 999 Canada Place  
Vancouver, BC  
V6C 3E1

Prepared By:  
NEIL V. FROC, P.Eng.

March 1992

## TABLE OF CONTENTS

	<u>Page No.</u>
1.0 INTRODUCTION .....	<del>3</del> 4
2.0 LOCATION .....	<del>3</del> 4
3.0 ACCESS .....	<del>3</del> 4
4.0 TOPOGRAPHY AND VEGETATION .....	4
5.0 CLAIM STATUS .....	6
6.0 HISTORY .....	7
7.0 WORK PROGRAM .....	8
8.0 GEOLOGY	
8.1 Regional Geology .....	8
8.2 Property Geology .....	9
9.0 DIAMOND DRILLING .....	13
10.0 CONCLUSIONS AND RECOMMENDATIONS .....	14

## FIGURES

Figure 1	Property Location
Figure 2	Claim Map
Figure 3	Regional Geology
Figure 4	Property Geology and Borehole Location Plan
Figure 5	Lithology Section

## APPENDICES

Appendix I	Drill Logs
Appendix II	Statement of Qualifications
Appendix III	Statement of Costs

## 1.0 INTRODUCTION

A thirteen hole diamond drilling program was carried out in two phases from June 17, 1991 to October 16, 1991 on the J&J 1 to 10 and Phantom claims for the purpose of defining the J&J talc deposit. The holes were collared within the J&J 1 and J&J 8 claim boundaries.

The "NQ" size core was collected, logged and shipped to Sardis, BC under the direction of the author.

## 2.0 LOCATION

The J&J 1 to 10 and the Phantom claims are situated approximately 150 km northeast of Vancouver, BC in the Nahatlatch River Valley approximately 20 km northwest of North Bend (see Figure 1).

The mineral claims are located within the New Westminster Mining Division on NTS map sheets 92 H/13 E and 92 I/4 E centred on geographic coordinates  $50^{\circ} 0' 48''$  N latitude and  $121^{\circ} 34' 30''$  W longitude (see Figure 2).

## 3.0 ACCESS

Access to the property is gained from North Bend via 13.5 km of well maintained gravel logging road northward, 2.0 km of moderately maintained gravel road westward and 2.5 km of poorly maintained one-lane gravel road westward ("Lower Road"). The property is situated near the old Nahatlatch River Bridge, which has recently been destroyed. Four-wheel drive access is recommended for travel on the last 2.5 km of the access road to the claims.

North Bend can be reached by way of the Trans Canada Highway No. 1 to Boston Bar and then westward 1.0 km across a new bridge spanning the Fraser River. Vehicle travel time from Vancouver to North Bend is approximately three hours.

## 4.0 TOPOGRAPHY AND VEGETATION

The terrain in the claim area is gently rolling near the Nahatlatch River Valley to rugged away from the valley, ranging in elevation from 150 m to 2300 m above seal level. Slopes are steep and locally precipitous in the vicinity of the J&J deposit.

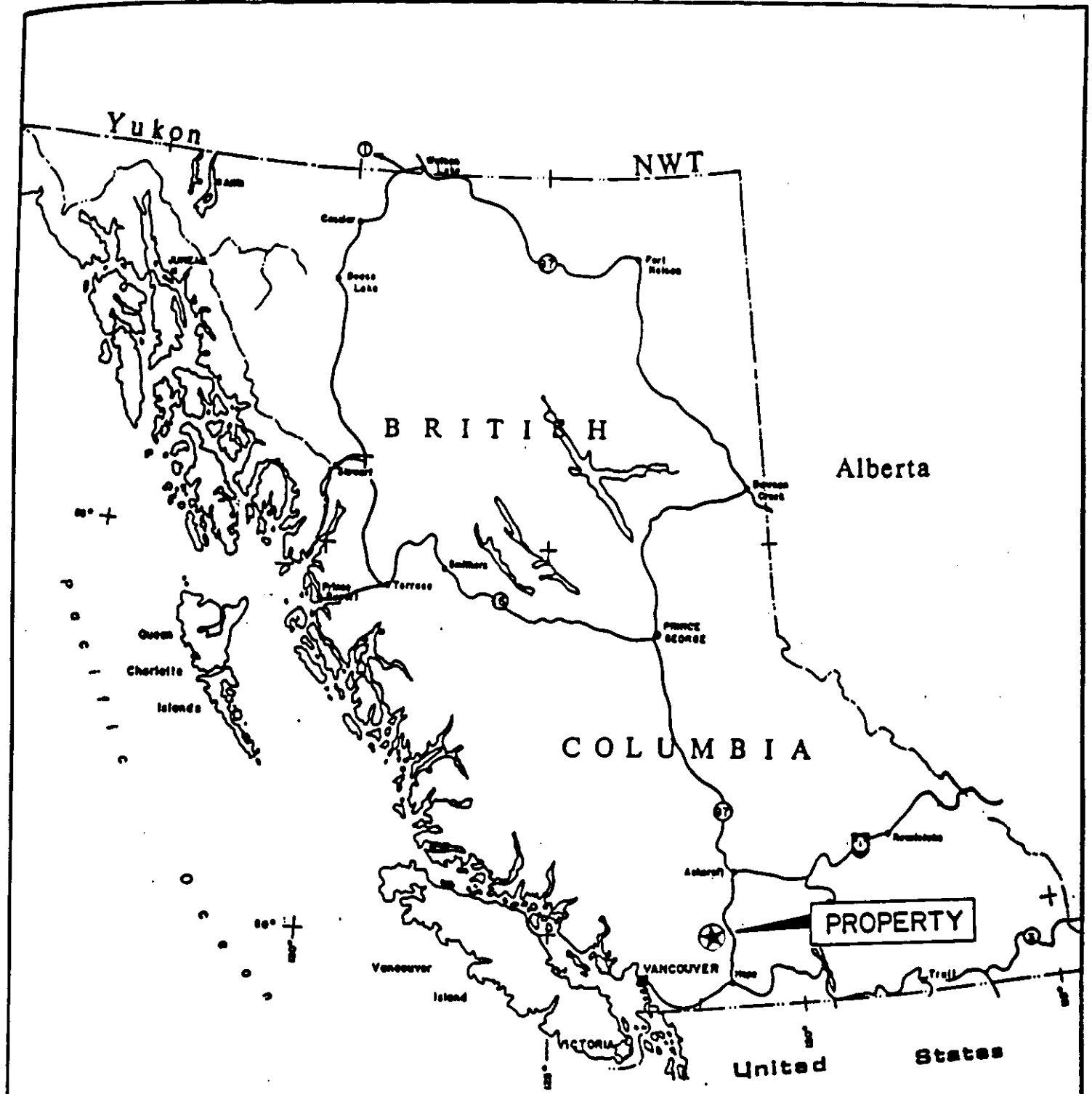

PACIFIC TALC PROJECT

**PROPERTY  
LOCATION MAP**

A ISMAY ASSOCIATES Inc

date: Nov 1991

Fig. No

NTS 92I/92H W

1

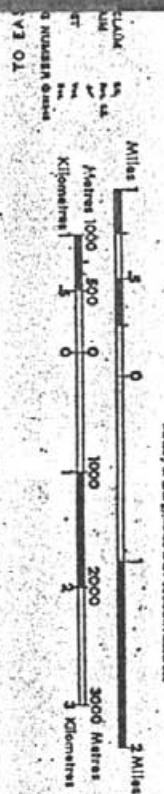

Ministry of British Columbia  
Library of Geology, Mines and Petroleum Resources

UNLESS VERIFIED ON SURVEY, THE LEGAL POSITION OF A LEGAL CORNER POST IS BASED ON THE LATEST AVAILABLE INFORMATION, SUBJECT TO THE OFFICE OF THE MINING DIVISION CONCERNED.  
DATE OF MICROFILM: 87-12-05

M921/4E

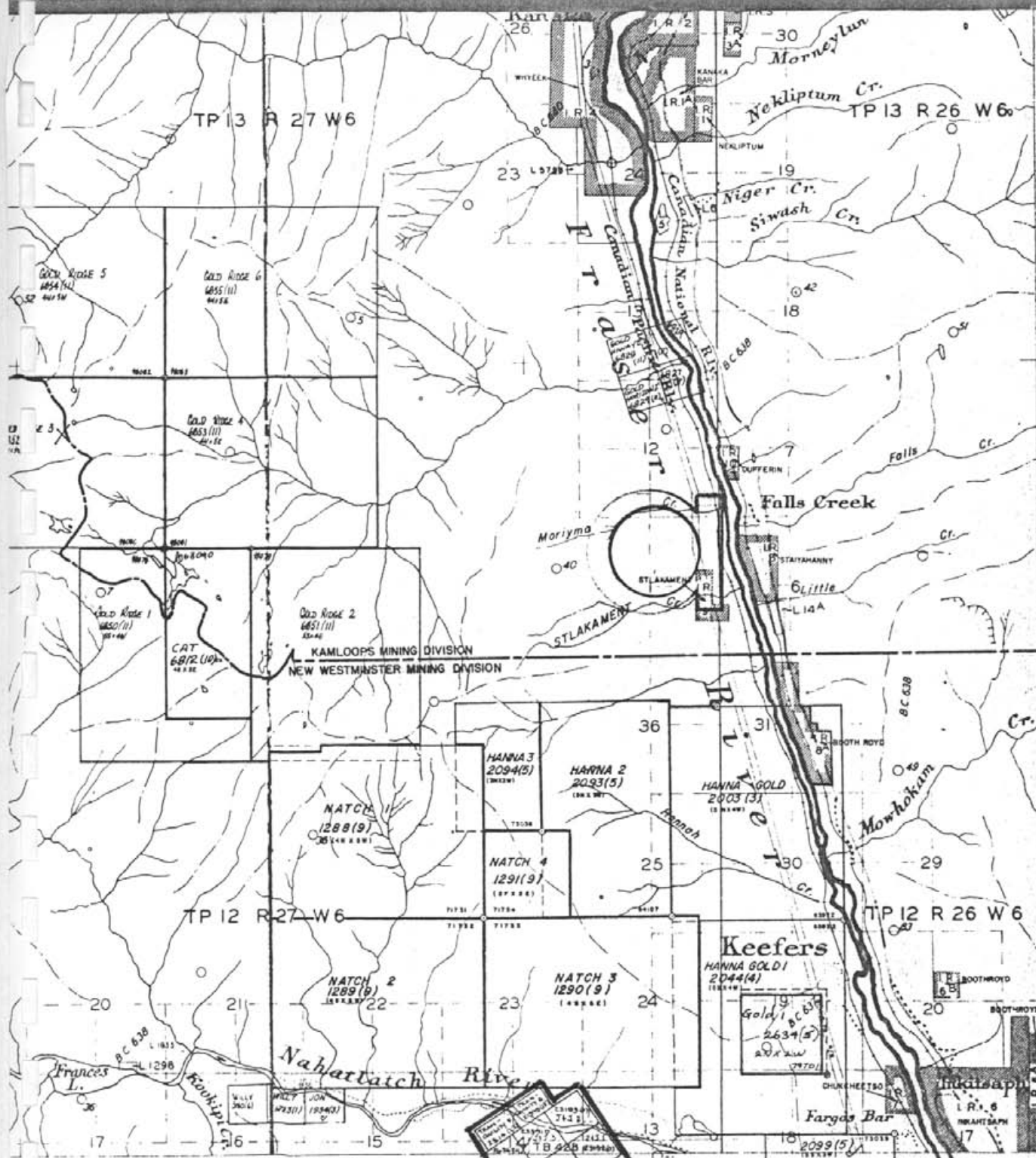

### MINERAL TITLES REFERENCE MAP 921/4E

DEPARTMENT OF MINES AND PETROLEUM RESOURCES VICTORIA, B.C.  
This map is prepared as a guide only to the location of mineral claims that have not been surveyed. Where the geographic position of a legal corner post has been verified it is indicated with the symbol, Ver. Additional information with respect to the claims may be obtained at the Mining Division concerned.

Legend:  
Claim  
Ver.  
PIPELINE

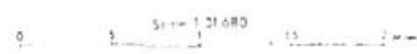

T.K.

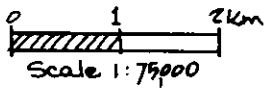
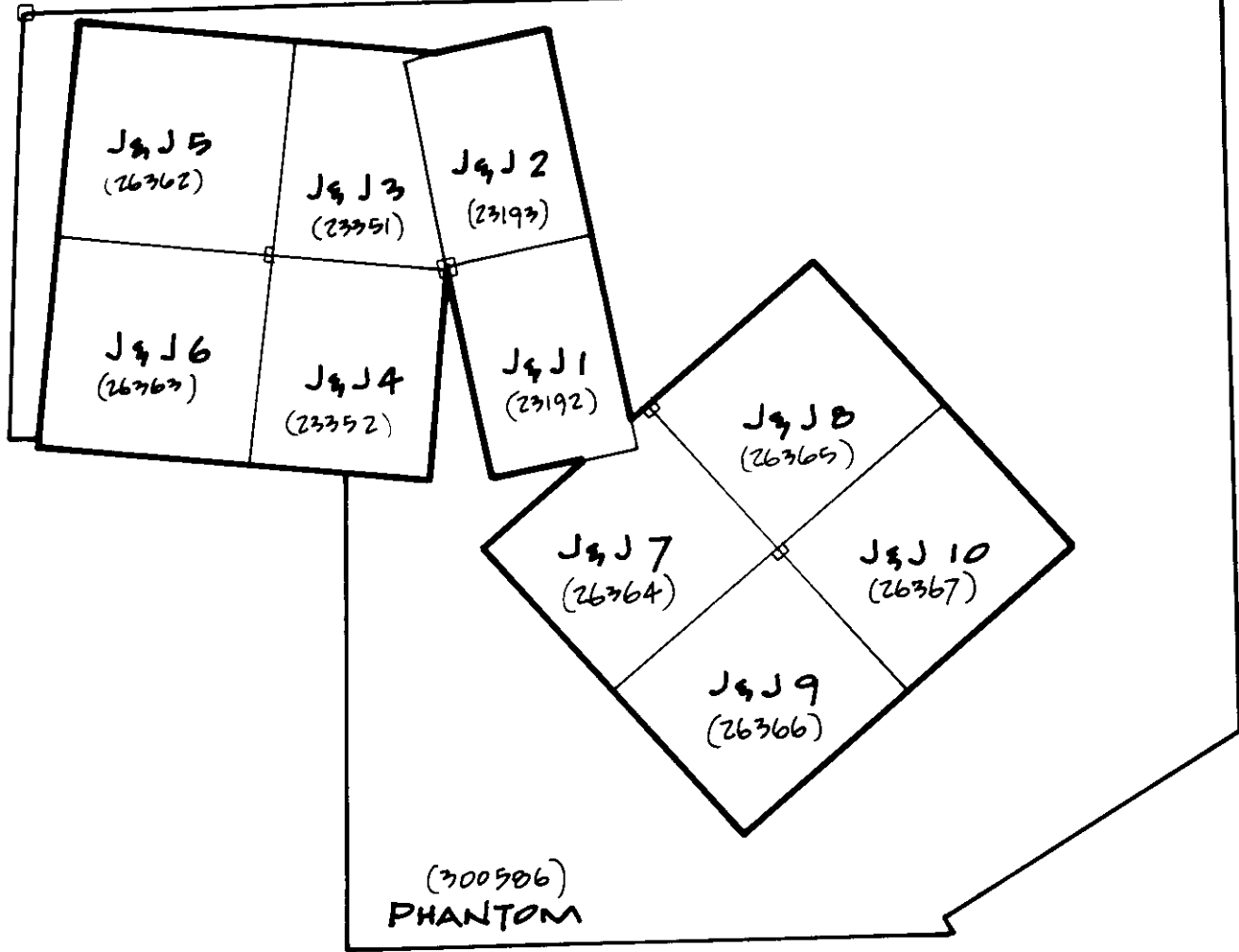

PACIFIC TALC PROJECT	
CLAIM MAP	
A ISMAY ASSOCIATES INC	
Date: Mar. 1992	Fig. No
NTD. 92I/92H W	2

Although the region is dominated by a dry interior climate, the influence of a moist coastal flow is strongly evident. The northern one-third of the claims cross the bottom of the Nahatlatch River Valley which occurs as a broad level bench vegetated by mainly pine and fir with some sparse ground cover. The remaining portion of the claims are marked by steep slopes vegetated by hemlock, fir and cedar with moderate undergrowth.

Numerous small creeks traverse the property, including Gold Dust Creek, situated on the western edge of the talc showing. With the dry climate in the region, the flow in these creeks could be seasonal or intermittent.

## 5.0 CLAIM STATUS

The property consists of 30 contiguous mineral claims within the New Westminster Mining Division in the Nahatlatch River Valley approximately 20 km northwest of North Bend on NTS sheets 92 H/13 E and 92 I/4 E. They are 100% owned by Pacific Talc Ltd. of 408 - 1755 West Broadway, Vancouver, BC. The J&J 1 to 10 claims lie within the boundary of the Phantom claim.

Pertinent claim data is summarized as follows:

<u>Claim Name</u>	<u>Units</u>	<u>Record No.</u>	<u>Expiry Dates</u>
Phantom	20	300586	19/06/92
J&J 1	1	23192	03/03/97
J&J 2	1	23193	03/03/97
J&J 3	1	23351	10/04/96
J&J 4	1	23352	10/04/96
J&J 5	1	26362	16/07/96
J&J 6	1	26363	16/07/96
J&J 7	1	26364	16/07/96
J&J 8	1	26365	16/07/96
J&J 9	1	26366	16/07/96
J&J 10	1	26367	16/07/96

Assessment credit is applied for under this report.

## 6.0 HISTORY

Talc occurrences in the lower Nahatlatch Valley were recognized since before 1900. The Gisby claims located just south of the confluence of the Nahatlatch with the Fraser River, were staked as a gold prospect and cover a number of silica and talc showings. Although no mention of gold production is made, small amounts of both talc and silica were mined from the group in the 1920's (MM&PR, 1965). Little to no activity on these claims has been reported since.

The J&J claims were staked in 1970 and 1971, and cover a talc showing exposed for approximately 40 m along the old Nahatlatch River road. Preliminary work involved surface trenching and open cuts designed to investigate the extent of the talc body. Samples collected from these workings were sent to Lakefield Research of Canada Ltd. and to the Mineral Processing Division, Mines Branch of the Department of Energy, Mines and Resources of Canada for analysis (Lakefield, 1972; Wyman, 1973). A series of bulk samples were removed by Pacific Talc Ltd. from the site during the mid-1970's, including one sold to an Inuit Art co-operative as carving stone.

In late 1977, the claims were optioned to Mountain Minerals Co. Ltd. of Lethbridge, Alberta who conducted an extensive surface and subsurface investigation of the deposit. Seven AQ diamond drill holes totalling 470 m were sited along the strike of the talc showing during late 1978 and 1979. Additionally, a 6 ton bulk sample was removed from the "main pit area" in the fall of 1979 and transported to Mountain Minerals' Lethbridge Mill facility for grinding tests (Perston, 1979b). Mountain Minerals relinquished their option on the property in the early 1980's.

In 1984, the existing data on the property was compiled in a detailed report by Joseph Sullivan, P.Eng. The report includes reserve calculations and in an appended report by J. M. Currie, P.Eng., flowsheets and a capital cost estimate for a production facility.

In 1987, Stuart A. S. Croft, P.Eng., of Nevin Sadler-Brown Goodbrand Ltd. conducted an engineering evaluation of the deposit and recommended continued development of the property.

In 1988, several bulk samples of the talc from surface were shipped to the Ontario Research Foundation in Mississauga, Ontario, and flotation testwork completed. It was concluded that a marketable talc product could technically be produced from the J&J deposit.

Continued metallurgical testwork was carried out in 1989 by Bacon, Donaldson and Associates in Richmond, BC, to refine the flotation process.



A test pit program was completed in 1989 under the direction of Steffen, Robertson and Kirsten of Vancouver, BC, to confirm or refine the assumed extent of the talc body on surface over the southeastern half of the deposit.

The technical and economic feasibility of mining the deposit and processing the ore in a plant in the Fraser Valley near Vancouver was investigated by Pacific Talc Ltd. in 1990 and a complete feasibility study is presently underway.

The diamond drilling summarized in this report is part of the above feasibility study program to increase and define proven reserves of the J&J deposit.

## **7.0 WORK PROGRAM**

Thirteen diamond drill holes, JJ 91-01 to JJ 91-13 were drilled by Blackhawk Diamond Drilling Inc. for Pacific Talc Ltd. under the direction of A. Ismay Associates, Inc.

A total of 1131.3 m of NQ core drilling was done. The core was photographed, geologically and geotechnically logged and stored at 45170 Redwood Ave., Sardis, BC. Intervals for XRD analysis have also been selected.

## **8.0 GEOLOGY**

### **8.1 Regional Geology**

The Boston Bar-Lytton area comprise two distinct geological and physiographic provinces, the Intermontane Belt to the east, and the Coast and Cascade belts to the west, with the boundary delineated by the north northwest trending Pasayten and Fraser Faults. The Intermontane Belt is a region of relatively low topographic and structural relief, with mainly subgreenschist metamorphic grade rocks exposed across its entire width. By contrast, the Coast and Cascade belts have high topographic and structural relief; a tract of amphibolite grade rocks, exposed between Harrison Lake and Fraser River, is flanked by greenschist and lower grade rocks on east and west. The boundary between Coast and Cascade belts is placed at the Fraser River, with the Coast belt to the north and west of it, and the Cascade belt to the east and south (Monger, 1989).

The J&J deposit is hosted within the Methow-Tyauhton terrane of the Coast-Cascade belt (see Figure 3). The Methow-Tyauhton terrane comprises a basal ophiolite of probable Triassic age, which is overlain by the predominantly fine-grained clastic Lower and Middle Jurassic Ladner Group, with its volcanic-rich facies, the Dewdney Creek Formation. Above this in the south, is a thin Late Jurassic succession ("Thunder Lake sequence"), but in the north partly coeval strata form the thicker, Upper Jurassic-Lower Cretaceous Relay Mountain Group. Uppermost are thick Upper Lower Cretaceous-Lower Upper Cretaceous fine to coarse clastics of the partly coeval Jackass Mountain and Pasayten Groups. The latter contain detritus from, respectively, Quesnellion and Bridge River rocks, thus linking these terranes together about mid-Cretaceous time.

## 8.2 Property Geology

The region of the Phantom and J&J claims is underlain by strongly schistose chloritic, graphitic, and quartzose phyllite correlative to some sequences of the Middle and Early Jurassic Ladner group. A number of discontinuous elongate Jurassic intrusives comprising hornblende diorite, quartz diorite and amphibolite are mapped in the northern sections of the phyllite sequence and immediately southwest of North Bend. Though none are mapped near the J&J deposit, the general trend of these mafic intrusives cross the deposit. Granodiorite of the Tertiary Scuzzy Pluton borders the phyllite unit on the southwest and intrudes it at several locations.

The J&J talc deposit is a tabular elongate body of sheared talc-magnesite-chlorite-dolomite rock hosted by a medium to dark grey-green phyllite striking roughly  $135^{\circ}$  with a vertical to subvertical northeastward dip (see Figures 4 and 5). The talc mineralization appears conformable to the phyllitic host.

The talc is platy and light to dark greyish green, weathering buff to brown. It is associated with carbonates (magnesite and some dolomite), chlorite, serpentine, limonite and magnetite. Up to five percent pyrite is visible mainly along fractures and also disseminated throughout the rock.

The mineralized body ranges in true width from 10 m to 70 m, averaging 45 m, and has been identified along strike for 600 m. The limits of the body remain "open", or to be defined, at depth and to the southeast. Diamond drilling has confirmed depths of the talc body to at least 110 m.

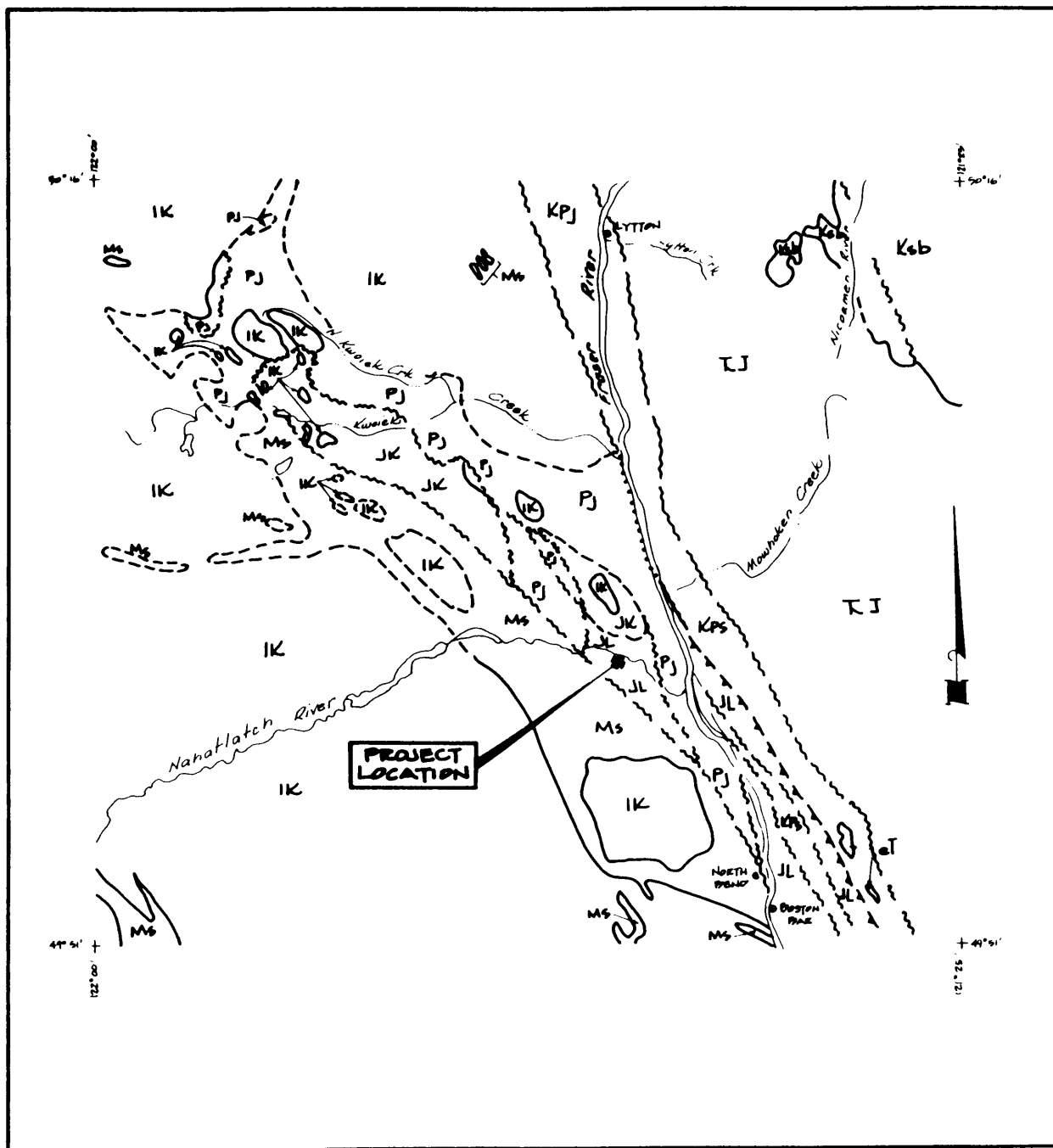

## EXPLANATION

### EARLY TERTIARY

**eT** Intrusions of intermediate composition

### CRETACEOUS and/or TERTIARY

**Ms** Garnet-biotite, Kyanite and Sillimanite schist, local amphibolite

### LATE CRETACEOUS

**IK** Granodiorite, quartz monzonite

### MIDDLE and LATE CRETACEOUS

**Ksb** SPENCES RIDGE GROUP - Intermediate, locally felsic and mafic flows and pyroclastics; sandstone, shale conglomerate

### EARLY and MIDDLE CRETACEOUS

**KPj** PASAYTEN and JACKASS MOUNTAIN GROUPS - Sandstone, argillite, conglomerate and minor shale

### JURASSIC and CRETACEOUS

**JK** RELAY MOUNTAIN GROUP - Argillite, siltstone, sandstone, local conglomerate

### MIDDLE and EARLY JURASSIC

**JL** LADNER GROUP - Argillite, slate, phyllite, tuff

### TRIASSIC and/or JURASSIC

**TJ** MOUNT LYTTON COMPLEX - Diorite, granodiorite, quartz monzonite, amphibolite and mylonite

### PERMIAN TO JURASSIC

**PJ** BRIDGE RIVER COMPLEX - Radiolarian chert, argillite, basalt, pillow basalt, local carbonate, gabbro and serpentinite, phyllite, siliceous and chlorite schist

METHOW-TYLAUGHTON TERRANE

- Geologic boundary (defined, approximate, assumed)
- ~ ~ ~ Fault (defined, approximate, assumed)
- ◄ ◄ ◄ Thrust Fault (teeth on upper plate)

<b>PACIFIC TALC PROJECT</b>	
<b>GEOLOGY</b> of the <b>BOSTON BAR - LYTTON</b> <b>AREA</b>	
A. ISMAY ASSOCIATES INC.	
Date November 1991	Figure No
NTS 92I/92H W	<b>3</b>

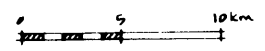

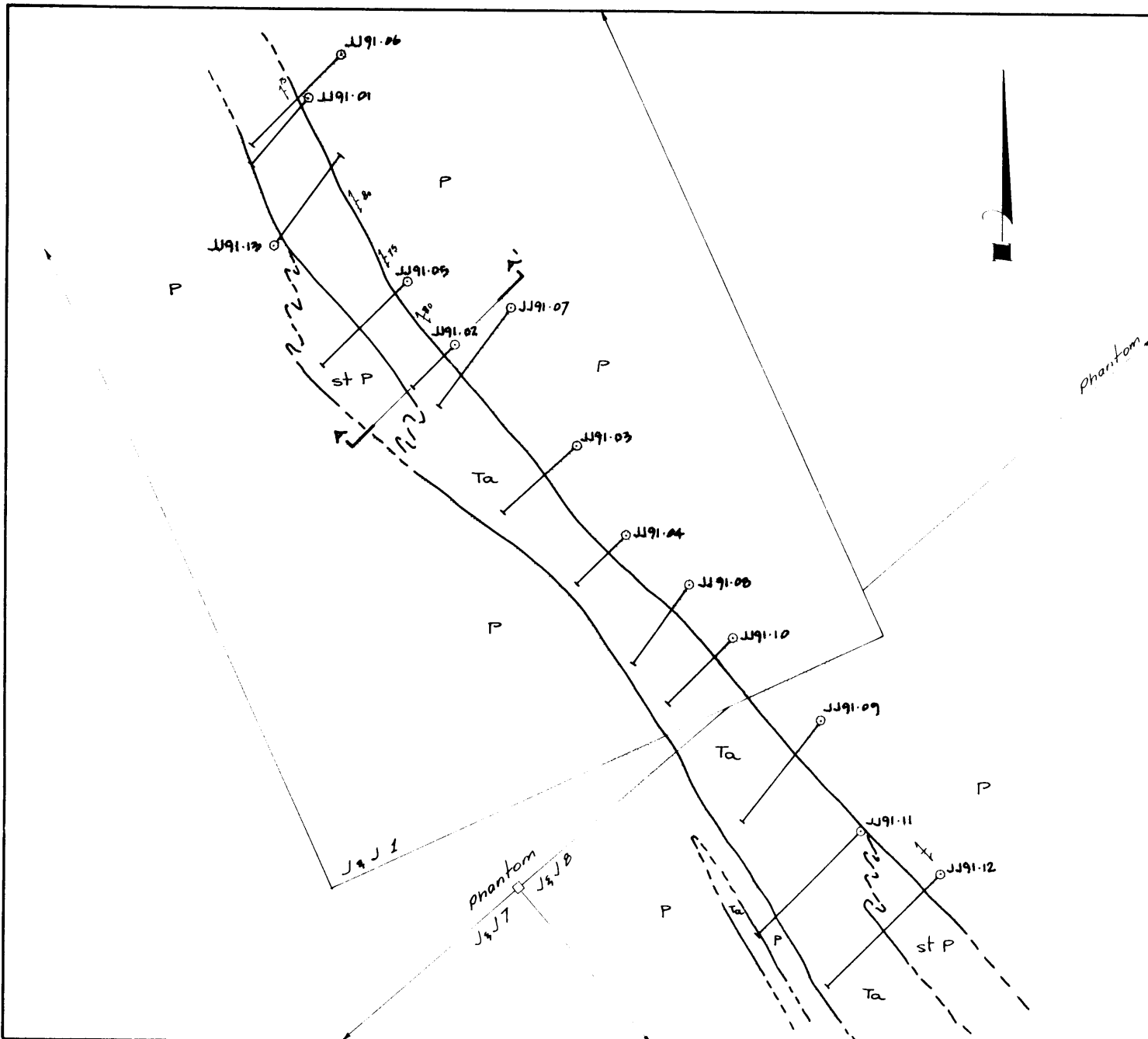

**~ EXPLANATION ~**  
**MIDDLE AND EARLY JURASSIC**

**LADNER GROUP**

- P PHYLLITE: strongly schistose chloritic phyllite and graphitic to quartzose phyllite
- st P PHYLLITE: weak to moderately steatized phyllite and phyllite
- Ta TALC: light to dark greyish green, weathered buff to brown talc with associated magnesite and chlorite
- Schistosity
- 1991 Diamond Drill Hole
- Geologic boundary, (defined)
- Geologic boundary, (approximate)
- Claim post with claim boundary
- Claim name
- Cross section location (looking northwest)

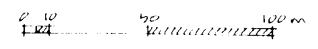

<b>PACIFIC TALC PROJECT</b>	
PROPERTY GEOLOGY and BOREHOLE LOCATION	
A. ISMAY ASSOCIATES, INC.	
200 N. CENTRAL BLVD. SUITE 321, DENVER, CO	
4	

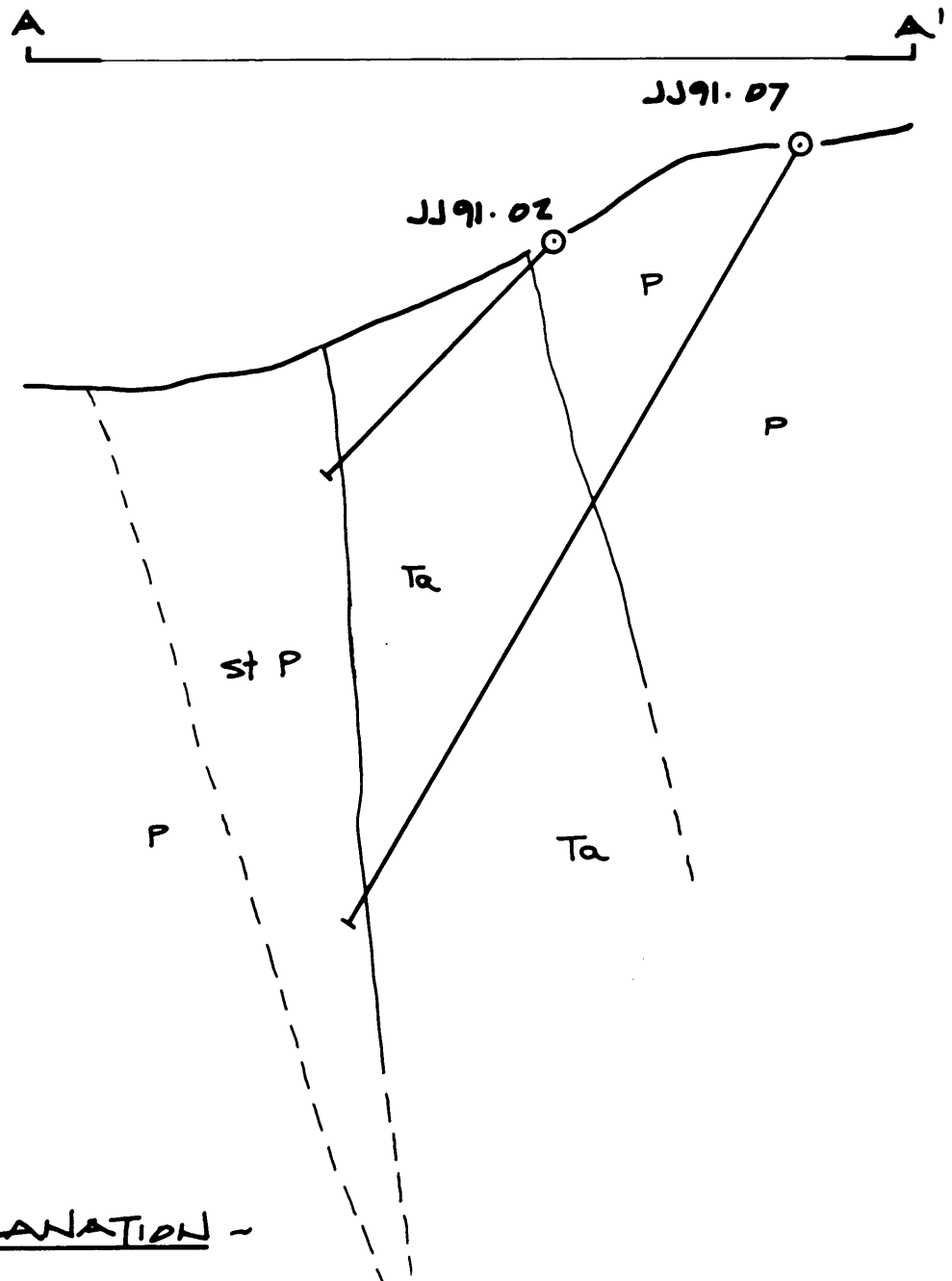

~ EXPLANATION ~

MIDDLE AND EARLY JURASSIC

Ladner Group

- P . PHYLITE · strongly schistose chloritic phyllite and graphitic to quartzose phyllite
- st P . PHYLITE · weak to moderately steatized phyllite and phyllite
- Ta . TALC · light to dark greyish green, weathered buff to brown talc with associated magnesite and chlorite

○ · 1991 Diamond Drill Hole

— · Geologic boundary, defined

- - - · Geologic boundary, approximate

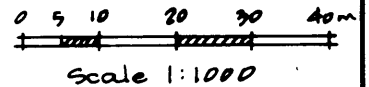

PACIFIC TALC PROJECT	
LITHOLOGY	
SECTION A - A'	
A. ISMAY ASSOCIATES, INC.	
Date: November 1991	Pg. No.
NTS: 92E/92H W	5

## 9.0 DIAMOND DRILLING

Thirteen diamond drill holes, JJ 91-01 to 91-13 (see Figure 4) were drilled by Blackhawk Diamond Drilling Inc., Site 11, Camp 138, RR3, Kamloops, BC, V2C 5K1, for Pacific Talc Ltd., 408 - 1755 West Broadway, Vancouver, BC, V6J 4S5.

A total of 1131.3 m of NQ core were drilled within the claim units J&J 1 and J&J 8. The drilling was completed in two separate field programs; June 17 to June 26, 1991 and September 18 to October 16, 1991, using a Longyear 44 drilling rig under the supervision of the author (A. Ismay Associates, Inc., 538 - 999 Canada Place, Vancouver, BC, V6C 3E1).

The core was photographed, geologically and geotechnically logged, and shipped to 45170 Redwood Ave., Sardis, BC, for cutting and sampling under the supervision of the author. Samples selected for XRD analysis were shipped to Bacon, Donaldson and Associates Ltd., 12271 Horseshoe Way, Richmond, BC, V7A 4Z1, by the author. The drill core which was not used for testing, remains stored at 45170 Redwood Ave., Sardis and XRD sample rejects at Bacon, Donaldson and Associates, Richmond. Drill logs for the thirteen holes have been included in Appendix I.

The following is a description list of diamond drill holes completed during the two field programs.

### 1st Program (June 17 to 26, 1991)

<u>Hole No.</u>	<u>Azimuth (°)</u>	<u>Inclination(°)</u>	<u>Depth (m)</u>
JJ 91-01	221	50.5	71.0
-02	225	45	44.2
-03	227.5	50	79.9
-04	225	50	56.0
-05	225	50	<u>96.6</u>
		TOTAL	<u>347.7</u>

2nd Program (September 18 to October 16, 1991)

<u>Hole No.</u>	<u>Azimuth (°)</u>	<u>Inclination(°)</u>	<u>Depth (m)</u>
JJ 91-06	225	45	105.5
-07	217	60	124.0
-08	215.5	48	75.0
-09	218	45	92.1
-10	225	60	96.6
-11	225	45	104.2
-12	225	45	114.6
-13	36	36	<u>71.6</u>
		TOTAL	<u>783.6</u>

\* NOTE - downhole directions were surveyed using a sperry-sun single shot instrument by Blackhawk Diamond Drilling Inc. and surface locations of drill holes were surveyed by Turnbridge & Turnbridge, 45710 Hocking Ave., Chilliwack, BC, V2P 1B3, under the supervision of the author.

## 10.0 CONCLUSIONS AND RECOMMENDATIONS

The thirteen holes provided the required definition of the J&J deposit needed to complete the present feasibility study.

Further trenching and diamond drilling could be conducted if additional reserves are required for future production.

**APPENDIX I**  
**DRILL LOGS**



**DIAMOND DRILL LOG  
GENERAL**

Hole No. JJ-99-01

Page 1 of 1

COMPANY: Pacific Talc Limited

PROPERTY: J & J Claims

HOLE NUMBER: JJ-91-01

CLAIM GROUP: \_\_\_\_\_

NTS: \_\_\_\_\_

ZONE/SECTION: \_\_\_\_\_

Easting: \_\_\_\_\_

Northing: \_\_\_\_\_

Elevation: \_\_\_\_\_

Azimuth/Dip: \_\_\_\_\_

DRILLED BY: Blackhawk Diamond Drilling Ltd., Kamloops

Core Size: \_\_\_\_\_ Interval 0 - 71.0

\_\_\_\_\_ Interval \_\_\_\_\_ - \_\_\_\_\_

Started: June 18, 1991

Finished: June 19, 1991

Casing Left: None

LOGGED BY: Neil Froc, P.Eng.

Started: July 3, 1991

Finished: July 3, 1991

Purpose/Comment: To test the continuity of the talc grade across its width near the northern extent of the mineralized body (also serves as a comparison hole for holes 79-1 and 79-2).

Measure:

Feet

Metres

DOWNHOLE SURVEY				
Metreage	Dip	AZIMUTH		
		Observed	Corrected	Comment
0	50.5	NS	221°	NS
71.0	50.5	S 19.5° W	221°	SS

\* NS - Not Surveyed, SS - Sperry Sun Single Shot

Assay For: XRD (Bacon, Donaldson and Associates Ltd.) for talc %, magnesite %, chlorite % and siderite/ankerite %.

Assay By: \_\_\_\_\_

**DIAMOND DRILL LOG  
LITHOLOGY**

NEIL FROC  
JULY 3, 1991

COMPANY: PACIFIC TALC LTD.

Hole No. JJ-91-01

PROPERTY: J & J CLAIMS

Page 1 of 3

INTERVAL FROM TO		CODE LITHOLOGY	DESCRIPTION (Lithology, Color, Comments, etc.)
0	6.4	OVB	OVER BURDEN - tan/brown sandy clay
6.4	14.7	2	TALC/CARBONATE - dark grey/smoky white, mod. irregular foliation, minor oxid. along fractures to 7.2m, minor quartz @ 9.0m, minor chlorite, minor sulphides (pyrite) along foliation (<0.5%), minor blue/green "soapy" talc, chloritic zone 6.5 - 7.8 m. - foliation to core axis 51 ; 52 ; 59 ; 54 ; 52 . - petrographic sample @ 14.1 m.
14.7	26.4	1	TALC - white/grey, mod. foliation, minor talc/carbonate @ 18.0m, black specs(?), mottled texture, minor blue/green "soapy" talc veinlets (1.0-10.0mm in width), trace sulphides along foliations, shear zone(?) 33 - to core axis @ 18.2m. - foliation to core axis 54 ; 60 ; 59 ; 66 ; 51 . -petrographic sample @ 21.5m.
26.4	36.7	2	TALC/CARBONATE - dark grey/smoky white, minor light brown intermixed mottled and mod. foliated texture, minor chlorite, chloritic zone @ 33.6 - 34.0m, sulphides along foliations (0.5%). - foliations to core axis 50 ; 67 ; 32 ; 48 ; 53 . - gradational upper contact, sharp lower contact.

**DIAMOND DRILL LOG  
LITHOLOGY**

NEIL FROC  
JULY 3, 1991

COMPANY: PACIFIC TALC LTD.

Hole No. JJ-91-01

PROPERTY: J & J CLAIMS

Page 2 of 3

<u>INTERVAL</u> FROM TO		<u>CODE</u> <u>LITHOLOGY</u>	<u>DESCRIPTION</u> (Lithology, Color, Comments, etc.)
36.7	37.6	C	CHLORITE - dark olivine green, minor carbonate veinlets, strong foliation. - foliation to core axis 47 ; 74 .
37.6	40.2	2	TALC/CARBONATE - as above, 5-10% blue/green soapy talc, minor mottled light brown color. - foliation to core axis 65 ; 72 ; 64 .
40.2	41.2	1	TALC - grey and white, mod. foliation - narrow (5mm) white talc veinlet @ 10 . to core axis @ 40.5m. - minor chlorite, sulphides (pyrite) along foliations. - foliation to core axis 50 .
41.2	47.9	2	TALC/CARBONATE - greys/smoky white/white, mod. to strong foliation, minor chlorite, mottled texture, talc veining (1mm-10mm), minor blue/green soapy talc, minor pyrite along foliation, increased talc content @ 42.6 - 43.5. - foliation to core axis 58 ; 68 ; 65 ; 50 ; 50 . - talc veinlets to core axis 05 . @ 43.0 m.



**DIAMOND DRILL LOG  
A S S A Y**

July 3, 1991  
Neil Froc

Hole No. JJ-91-01  
Page 1 of 3

COMPANY: PACIFIC TALC LTD.  
PROPERTY: J & J CLAIMS

INTERVAL				SAMPLE NUMBER	A S S A Y S			
FROM	TO	CORE WIDTH	CORE REC. %		% Talc	% Magnesite	% Chlorite	% Side/Anker
0	6.4			Not Sampled (OVB)				
6.4	8.0	1.4	88	235751 H				
8.0	10.0	1.3	65	235752 H				
10.0	12.0	1.4	70	235753 H				
12.0	14.0	1.8	90	235754 H				
14.0	14.7	0.6	86	235755 H				
14.7	16.0	1.1	85	235756 H				
16.0	18.0	1.5	75	235757 H				
18.0	20.0	1.7	85	235758 H				
20.0	22.0	1.9	95	235759 H				
22.0	24.0	1.9	95	235760 H				
24.0	26.0	1.7	85	235761 H				
26.0	26.4	0.4	100	235762 H				
26.4	28.0	1.3	81	235763 H				

**DIAMOND DRILL LOG  
A S S A Y**

July 3, 1991  
Neil Froc

Hole No. JJ-91-01  
Page 2 of 3

COMPANY: PACIFIC TALC LTD.  
PROPERTY: J & J CLAIMS

INTERVAL				SAMPLE NUMBER	A S S A Y S			
FROM	TO	CORE WIDTH	CORE REC. %		% Talc	% Magnesite	% Chlorite	% Side/Anker
28.0	30.0	1.7	85	235764 H				
30.0	32.0	1.5	75	235765 H				
32.0	33.6	1.4	100	235766 H				
33.6	34.0	0.3	75	235767 H				
34.0	36.0	1.9	95	235768 H				
36.0	36.7	0.6	86	235769 H				
36.7	37.6	0.8	89	235770 H				
37.6	38.0	0.3	75	235771 H				
38.0	40.0	1.7	85	235772 H				
40.0	40.2	0.2	100	235773 H				
40.2	41.2	0.9	90	235774 H				
41.2	42.0	0.7	88	235775 H				
42.0	44.0	1.6	80	235776 H				
44.0	46.0	1.6	80	235777 H				

**DIAMOND DRILL LOG  
ASSAY**

July 3, 1991  
Neil Froc

Hole No. JJ-91-01  
Page 3 of 3

COMPANY: PACIFIC TALC LTD.  
PROPERTY: J & J CLAIMS

INTERVAL				SAMPLE NUMBER	ASSAYS			
FROM	TO	CORE WIDTH	CORE REC. %		% Talc	% Magnesite	% Chlorite	% Side/Anker
46.0	48.0	1.5	75	235778 H				
48.0	49.2	0.9	75	235779 H				
49.2	50.0	0.8	100	235780 H				
50.0	52.0	1.8	90	235781 H				
52.0	54.0	1.9	95	235782 H				
54.0	56.0	1.9	95	235783 H				
56.0	58.0	1.5	75	235784 H				
58.0	60.0	1.4	70	235785 H				
60.0	62.0	1.9	95	235786 H				
62.0	64.0	1.4	70	235787 H				
64.0	65.5	1.4	93	235788 H				
65.5	66.0	0.5	100	235789 H				
66.0	68.0	1.9	95	235790 H				
No more samples. EOH @ 71.02 m								

**DIAMOND DRILL LOG  
R Q D**

COMPANY: PACIFIC TALC LTD.  
PROPERTY: J & J CLAIMS

Page 1 of 1  
Hole No. JJ-91-01

FROM	TO	TOTAL LENGTH	MEAS.	% RQD	FROM	TO	TOTAL LENGTH	MEAS.	%
6.40	7.62	1.22	0.20	16	64.92	67.97	3.05	2.58	85
7.62	10.67	3.05	0.92	30	67.97	71.02	3.05	3.14	100
10.67	13.72	3.05	1.86	61		EOH			
13.72	16.76	3.04	1.93	63					
16.76	19.81	3.05	2.30	75					
19.81	22.86	3.05	2.72	89					
22.86	25.91	3.05	2.55	84					
25.91	28.96	3.05	2.13	70					
28.96	32.00	3.04	1.75	58					
32.00	35.05	3.05	2.76	90					
35.05	38.10	3.05	2.27	74					
38.10	41.15	3.05	1.90	62					
41.15	44.20	3.05	1.60	52					
44.20	47.24	3.04	1.70	56					
47.24	50.29	3.05	1.78	58					
50.29	53.34	3.05	2.60	85					
53.34	56.39	3.05	2.80	92					
56.39	59.44	3.05	1.70	56					
59.44	62.48	3.04	2.40	79					
62.48	64.92	3.04	0.70	23					



**DIAMOND DRILL LOG  
GENERAL**

Hole No. JJ-91-02  
Page 1 of 1

COMPANY: Pacific Talc Limited  
PROPERTY: J & J Claims

Measure:  Feet  Metres

HOLE NUMBER: JJ-91-02  
CLAIM GROUP: \_\_\_\_\_  
NTS: \_\_\_\_\_  
ZONE/SECTION: \_\_\_\_\_  
Easting: \_\_\_\_\_  
Northing: \_\_\_\_\_  
Elevation: \_\_\_\_\_  
Azimuth/Dip: \_\_\_\_\_

DOWNHOLE SURVEY				
Metreage	Dip	AZIMUTH		
		Observed	Corrected	Comment
0	45	Not Surveyed	225°	NS
44.2	45	Not Surveyed	225°	NS

DRILLED BY: Blackhawk Diamond Drilling Ltd., Kamloops  
Core Size: \_\_\_\_\_ Interval 0 - 44.2  
Interval \_\_\_\_\_ - \_\_\_\_\_  
Started: June 20, 1991  
Finished: June 20, 1991  
Casing Left: None

NS - Not Surveyed SS - Sperry Sun Single Shot

LOGGED BY: Neil Froc, P.Eng.  
Started: July 4, 1991  
Finished: July 4, 1991

Assay For: XRD (Bacon Donaldson and Associates) for talc %, magnestie %, chlorite % and siderite/ankerite %.  
\_\_\_\_\_  
\_\_\_\_\_  
\_\_\_\_\_

Purpose/Comment: To test the continuity of the talc grade across its width near the zone of "apparent pinching". Downhole survey did not work.  
\_\_\_\_\_  
\_\_\_\_\_  
\_\_\_\_\_

Assay By: \_\_\_\_\_

**DIAMOND DRILL LOG  
LITHOLOGY**

NEIL FROC  
JULY 4, 1991

COMPANY: PACIFIC TALC LTD.

Hole No. JJ-91-02

PROPERTY: J & J CLAIMS

Page 1 of 3

INTERVAL FROM TO		CODE LITHOLOGY	DESCRIPTION (Lithology, Color, Comments, etc.)
0	3.8	OVB	OVERBURDEN (triconed to 3.8m)
3.8	16.6	2	TALC/CARBONATE - dark grey/grey/smoky white, mottled appearance numerous blue/green "soapy" talc veinlets, chlorite from 7.2 - 7.8m and 12.2 to 12.6m, carbonate oxidized from 6.0 to 7.2m (weak) and 10.2 to 10.4m (weak) and, 13.2 to 13.3m (weak), and 13.9 to 15.5m (strong). - broken friable zone @ 14.3 to 15.4m, oxid. along fractures (weak) from 3.8 to 15.6m. - talc @ 4.9 to 5.1m, and @ 16.0 to 16.6m (blue/green). - mod. to strong foliation to core axis 45°, 60°, 55°, 55°. - minor calcite veining pyrite along foliation (<1.0%).
16.6	18.0	C	CHLORITE - dark green, mod foliation (to core axis 47°, 62°), pyrite along foliations, talc & chlorite mixed from 17.7 to 18.0m.
18.0	26.0	2 (3)	TALC/CARBONATE - dark grey/grey/smoky white, mod. to weak foliation, mottled texture, pyrite along foliation (trace to <.05%), blue/green "soapy" talc, noticeable black specs (?), chlorite 22.5 to 22.9m, foliation to core axis 40°, 60°, 55°, 70°.

**DIAMOND DRILL LOG  
LITHOLOGY**

NEIL FROC  
JULY 4, 1991

COMPANY: PACIFIC TALC LTD.

Hole No. JJ-91-02

PROPERTY: J & J CLAIMS

Page 2 of 3

INTERVAL FROM TO		CODE LITHOLOGY	DESCRIPTION (Lithology, Color, Comments, etc.)
26.0	28.8	3 (2)	CARBONATE/TALC - dark grey/green/white, intense foliation, oxidized (1%) carbonate, sulfides <1.0%. - foliation to core axis 56°, 56°, 73°.
28.8	36.0	2 (C)	TALC/CARBONATE/CHLORITE - olive green/smoky white/grey, mod. foliation, mottled texture 33.0 to 36.0m, petrographic sample @ 35.1m (white xtals with black specs in center?) - grey calcite veining @ 33.7m 10° to core axis 8mm wide. @ 32.8m 45° to core axis 20mm wide. - foliation to core axis 40°, 49°, 65°.
36.0	39.5	2	TALC/CARBONATE - grey/smoky white, weak foliation (to core axis 65°, 65°) mod. mottled texture, blue/green "soapy talc" mixed from 38.1 to 39.5m, sulphide, along foliations (<.05%), minor calcite veining 15° to core axis (1mm wide), sharp lower contact.
39.5	40.6	C	CHLORITE - dark olive green, strong foliation, minor talc @ 40.1m, foliation to core axis 45°, 55°. - sharp lower contact.



**DIAMOND DRILL LOG  
ASSAY**

July 4, 1991  
Neil Froc

Hole No. JJ-91-02  
Page 1 of 2

COMPANY: PACIFIC TALC LTD.  
PROPERTY: J & J CLAIMS

INTERVAL				SAMPLE NUMBER	ASSAYS			
FROM	TO	CORE WIDTH	CORE REC. %		% Talc	% Magnesite	% Chlorite	% Side/Anker
4.0	6.0	1.6	80	235791 H				
6.0	8.0	1.6	80	235792 H				
8.0	10.0	1.9	95	235793 H				
10.0	12.0	2.	100	235794 H				
12.0	14.0	1.9	95	235795 H				
14.0	16.0	1.3	65	235796 H				
16.0	16.6	0.6	100	235797 H				
16.6	18.0	1.3	65	235798 H				
18.0	20.0	1.9	95	235799 H				
20.0	22.0	1.8	90	235800 H				
22.0	24.0	1.8	90	235851 H				
24.0	26.0	1.6	80	235852 H				
26.0	28.0	1.7	85	235853 H				
28.0	28.8	0.7	88	235854 H				





**DIAMOND DRILL LOG  
GENERAL**

Hole No. JJ-91-03

Page 1 of 1

COMPANY: Pacific Talc Limited

PROPERTY: J & J Claims

HOLE NUMBER: JJ-91-03

CLAIM GROUP: \_\_\_\_\_

NTS: \_\_\_\_\_

ZONE/SECTION: \_\_\_\_\_

Easting: \_\_\_\_\_

Northing: \_\_\_\_\_

Elevation: \_\_\_\_\_

Azimuth/Dip: \_\_\_\_\_

DRILLED BY: Blackhawk Diamond Drilling Ltd., Kamloops

Core Size: \_\_\_\_\_ Interval 0 - 79.9

Interval \_\_\_\_\_ - \_\_\_\_\_

Started: June 21, 1991

Finished: June 22, 1991

Casing Left: None

LOGGED BY: Neil Froc, P. Eng.

Started: July 5, 1991

Finished: July 5, 1991

Purpose/Comment: To test the continuity of the talc grade across its width and along strike between trench #5 and ddh JJ-91-02.

Measure:

Feet

Metres

DOWNHOLE SURVEY				
Metreage	Dip	AZIMUTH		
		Observed	Corrected	Comment
0	50	NS	227.5	NS
76.2	50	S 26°W	227.5	SS
79.9	50	NS	227.5	NS

NS - Not Surveyed SS - Sperry Sun Single Shot

Assay For: XRD (Bacon Donaldson and Associates Ltd.) for talc %, magnesite %, chlorite %, and siderite/ankerite %

Assay By: \_\_\_\_\_



**DIAMOND DRILL LOG**  
**LITHOLOGY**

NEIL FROC  
JULY 5, 1991

COMPANY: PACIFIC TALC LTD.

Hole No. JJ-91-03

PROPERTY: J & J CLAIMS

Page 1 of 2

INTERVAL FROM TO		CODE LITHOLOGY	DESCRIPTION (Lithology, Color, Comments, etc.)
0	7.3	OVB	OVERBURDEN - (tricone to 6.10m)
7.3	32.8	P	PHYLLITE - grey/white, intense, well-defined foliation (to core axis 52°, 52°, 59°, 48°, 60°), minor gneissic texture, quartz vein @ 17.1m 30° to core.
32.8	42.6	2 (C)	TALC/CHLORITE (chlorite) - dark green/grey/smoky white, mod. foliation & slickensides (?). - very broken up from 36.4 to 42.0m, blue/green soapy talc, talc from 40.0 - 42.0m, carbonate content higher from 34.0 to 36.4m minor sulphide <0.5%, sharp lower contact.
42.6	44.0	P	PHYLLITE - grey/black, strongly foliated, minor talc @ 43.2m, biotite rich, foliation at 52° to core axis.
44.0	47.2	1	TALC - grey/white, intense foliation, minor chlorite @ 45.0m, blue/green soapy talc, minor carbonate, talc vein (blue/green) @ 47.0 m, 5 to 10° to core axis (10mm wide), trace sulphide, sharp upper and lower contacts.



**DIAMOND DRILL LOG  
A S S A Y**

July 5, 1991  
Neil Froc

Hole No. JJ-91-03  
Page 1 of 2

COMPANY: PACIFIC TALC LTD.  
PROPERTY: J & J CLAIMS

INTERVAL				SAMPLE NUMBER	A S S A Y S			
FROM	TO	CORE WIDTH	CORE REC. %		% Talc	% Magnesite	% Chlorite	% Side/Anker
32.8	34.0	0.6	60	235863 H				
34.0	36.0	1.8	90	235864 H				
36.0	38.0	1.5	75	235865 H				
38.0	40.0	1.0	50	235866 H				
40.0	42.0	1.1	55	235867 H				
42.0	42.6	0.4	67	235868 H				
42.6	44.0	1.4	100	235869 H				
44.0	46.0	2.0	100	235870 H				
46.0	47.2	1.2	100	235871 H				
47.2	48.0	0.7	88	235872 H				
48.0	50.0	2.0	100	235873 H				
50.0	52.0	2.0	100	235874 H				
52.0	54.0	2.0	100	235875 H				
54.0	56.0	1.9	100	235876 H				



**DIAMOND DRILL LOG  
R Q D**

COMPANY: PACIFIC TALC LIMITED

Page 1 of 1

PROPERTY: J & J CLAIMS

Hole No. JJ-91-03

FROM	TO	TOTAL	MEAS.	%	FROM	TO	TOTAL	MEAS.	%
7.3	8.2	0.9	0.12	13	65.53	68.58	3.05	2.73	90
8.2	10.66	2.46	0.75	30	68.58	71.62	3.04	2.17	71
10.66	13.72	3.06	1.32	43	71.62	74.67	3.05	2.40	79
13.72	16.76	3.06	1.88	61	74.67	76.81	2.14	1.00	47
16.76	19.81	3.05	1.34	44	76.81	79.85	3.04	2.43	79
19.81	22.86	3.05	1.37	45		EOH			
22.86	25.91	3.05	1.35	44					
25.91	28.96	3.05	2.13	70					
28.96	32.00	3.04	0.62	20					
32.00	35.05	3.05	0.27	9					
35.05	38.10	3.05	0.72	24					
38.10	40.84	2.74	0	0					
40.84	44.20	3.36	1.10	33					
44.20	47.24	3.04	2.30	76					
47.24	50.29	3.05	2.95	97					
50.29	53.34	3.05	2.63	86					
53.34	56.38	3.04	2.87	94					
56.38	59.44	3.06	2.74	90					
59.44	62.48	3.04	2.77	91					
62.48	65.53	3.05	2.73	90					

**DIAMOND DRILL LOG  
GENERAL**

Hole No. JJ-91-04  
Page 1 of 1

COMPANY: Pacific Talc Limited  
PROPERTY: J & J Claims

Measure:  Feet  Metres

HOLE NUMBER: JJ-91-04  
CLAIM GROUP: \_\_\_\_\_  
NTS: \_\_\_\_\_

ZONE/SECTION: \_\_\_\_\_  
Easting: \_\_\_\_\_  
Northing: \_\_\_\_\_  
Elevation: \_\_\_\_\_  
Azimuth/Dip: \_\_\_\_\_

DRILLED BY: Blackhawk Diamond Drilling Ltd., Kamloops  
Core Size: \_\_\_\_\_ Interval 0 - 56.0  
Interval \_\_\_\_\_ - \_\_\_\_\_  
Started: June 23, 1991  
Finished: June 23, 1991  
Casing Left: \_\_\_\_\_

LOGGED BY: Neil Froc, P. Eng.  
Started: July 6, 1991  
Finished: July 6, 1991

Purpose/Comment: To test the continuity of the talc grade across its width and along strike within the zone of "apparent pinching".

DOWNHOLE SURVEY				
Metreage	Dip	AZIMUTH		Comment
		Observed	Corrected	
0	50	NS	225	NS
54.9	50	S 23.5 W	225	SS
56.0	50	NS	225	NS

NS - Not Surveyed    SS - Sperry Sun Single Shot

Assay For: XRD (Bacon Donaldson and Associates Ltd.) for talc %, magnesite %, chlorite % and siderite/ankerite %

Assay By: \_\_\_\_\_

**DIAMOND DRILL LOG  
LITHOLOGY**

NEIL FROC  
JULY 5, 1991

COMPANY: PACIFIC TALC LTD.

Hole No. JJ-91-04

PROPERTY: J & J CLAIMS

Page 1 of 2

<u>INTERVAL</u> FROM TO		<u>CODE</u> <u>LITHOLOGY</u>	<u>DESCRIPTION</u> (Lithology, Color, Comments, etc.)
0	4.6	OVB	OVERBURDEN (triconed to 4.9m - no core)
4.6	16.7	P	PHYLLITE - grey/white, strong foliation (gneissic texture), trace oxidation, foliation to core axis 58°, 56°, 52°, 57°
16.7	22.9	2 (C)	TALC/CARBONATE/CHLORITE - olive green/ grey/white, weak foliation, mottled, minor blue/green "soapy" talc, oxidized 17.7 to 17.8m and 19.7 to 20.1 m, high tremolite content from 16.7 to 17.1 m, broken up from 17.7 to 18.1 m, and 19.5 to 19.8 m, trace sulphide.
22.9	40.0	2	TALC/CARBONATE - grey/smoky white/white, moderate foliation, mottled, variable talc content, blue/green "soapy" talc, trace sulphide, chlorite @ 33.7 - 34.0 m, minor calcite veining, minor sulphides.
40.0	41.1	1	TALC - dark grey, minor carbonate, minor sulphide
41.1	45.5	T	TREMOLITE - apple green, very fibrous, minor talc (?), 42.6 - 43.4 m phyllite, minor talc, weak foliation petrographic sample @ 43.9 m, talc content increase 44.0 to 45.5 m.





**DIAMOND DRILL LOG  
A S S A Y**

July 5, 1991  
Neil Froc

Hole No. JJ-91-04  
Page 1 of 2

COMPANY: PACIFIC TALC LTD.  
PROPERTY: J & J CLAIMS

INTERVAL				SAMPLE NUMBER	A S S A Y S			
FROM	TO	CORE WIDTH	CORE REC. %		% Talc	% Magnesite	% Chlorite	% Side/Anker
16.7	18.0	1.8	138	235887 H				
18.0	20.0	1.9	95	235888 H				
20.0	22.0	1.8	90	235889 H				
22.0	22.9	0.7	78	235890 H				
22.9	24.0	1.0	91	235891 H				
24.0	26.0	1.6	80	235892 H				
26.0	28.0	2.0	100	235893 H				
28.0	30.0	1.9	95	235894 H				
30.0	32.0	2.0	100	235895 H				
32.0	34.0	1.6	80	235896 H				
34.0	36.0	1.9	95	235897 H				
36.0	38.0	1.9	95	235898 H				
38.0	40.0	1.7	65	235899 H				
40.0	41.1	1.1	100	235900 H				



NEIL FROC  
JULY, 1991

DIAMOND DRILL LOG  
R Q D

COMPANY: PACIFIC TALC LIMITED

Page 1 of 1

PROPERTY: J & J CLAIMS

Hole No. JJ-91-04

FROM	TO	TOTAL	MEAS.	%	FROM	TO	TOTAL	MEAS.	%
4.9	7.62	2.72	0.66	24	53.03	56.08	3.05	2.97	97
7.62	10.36	2.74	0.66	24		EOH			
10.36	11.89	1.53	0.10	7					
11.89	13.71	1.82	0.57	31					
13.71	16.30	2.59	0.13	5					
16.30	17.80	1.5	0.33	22					
17.80	19.81	2.01	0.10	5					
19.81	22.86	3.05	1.84	60					
22.86	24.68	1.82	0.62	34					
24.68	25.90	1.22	0.85	70					
25.90	28.95	3.05	1.38	45					
28.95	32.00	3.05	1.08	35					
32.00	35.05	3.05	1.57	51					
35.05	37.94	2.89	1.29	45					
37.94	39.92	1.98	0.44	22					
39.92	42.97	3.05	2.50	82					
42.97	46.02	3.05	2.30	75					
46.02	47.24	1.22	1.35	111					
47.24	50.29	3.05	2.30	75					
50.29	53.03	2.74	2.20	80					

**DIAMOND DRILL LOG  
GENERAL**

Hole No. JJ-91-05

Page 1 of 1

COMPANY: Pacific Talc Limited  
PROPERTY: J & J Claims

Measure:  Feet  Metres

HOLE NUMBER: JJ-91-05

CLAIM GROUP: \_\_\_\_\_

NTS: \_\_\_\_\_

ZONE/SECTION: \_\_\_\_\_

Easting: \_\_\_\_\_

Northing: \_\_\_\_\_

Elevation: \_\_\_\_\_

Azimuth/Dip: \_\_\_\_\_

DRILLED BY: Blackhawk Diamond Drilling Ltd., Kamloops

Core Size: \_\_\_\_\_ Interval 0 - 96.6

\_\_\_\_\_ Interval \_\_\_\_\_ - \_\_\_\_\_

Started: June 24, 1991

Finished: June 25, 1991

Casing Left: \_\_\_\_\_

LOGGED BY: Neil Froc, P. Eng.

Started: July 7, 1991

Finished: July 7, 1991

Purpose/Comment: To test the continuity of the talc grade across its width and along strike between JJ-91-01 and JJ-91-02. Downhole Survey did not work? Hole drilled at 50°.

DOWNHOLE SURVEY				
Metreage	Dip	AZIMUTH		Comment
		Observed	Corrected	
0	50	NS	225	
96.6	50	NS	225	

NS - Not Surveyed SS - Sperry Sun Single Shot

Assay For: XRD (Bacon Donaldson and Associates Ltd.) for talc %, magnesite %, chlorite % and siderite/ankerite %

Assay By: \_\_\_\_\_

**DIAMOND DRILL LOG**  
**L I T H O L O G Y**

NEIL FROC  
JULY 6, 1991

COMPANY: PACIFIC TALC LTD.

Hole No. JJ-91-05

PROPERTY: J & J CLAIMS

Page 1 of 3

INTERVAL FROM TO		CODE LITHOLOGY	DESCRIPTION (Lithology, Color, Comments, etc.)
0	6.1	OVB	OVERBURDEN (tricone to 6.7m)
6.1	13.6	2 (C)	TALC/CARBONATE/CHLORITE - grey/smoky white/green, mottled, mod. foliation, oxidized to 13.0 m, (carbonate oxidized), minor chlorite (chlorite content increasing to end of interval), sulphides along foliation <0.5 %
13.6	17.4	C	CHLORITE - dark olive green, mod. foliation, minor talc, sulphides along contact.
17.4	42.5	2	TALC/CARBONATE - grey/smoky white, moderate to strong foliation, minor oxidation to 23 m (oxidation of carbonates along fractures), carbonates coarser near start of interval, blue/green "soapy" talc, mottled, poor recovery @ 25.5 m, trace sulphides, chlorite content increases 38.5 to 42.5 m, foliation to core axis; 60°, 27°, 35°
42.5	44.0	C	CHLORITE - dark green, strong foliation (35° to core axis)
44.0	46.6	1	TALC - grey/green, strong foliation, minor tremolite @ 46.0 - 46.6 m, minor sulphide.
46.6	47.8	C	CHLORITE - dark green, minor calcite veining, strong foliation (to core axis 45°)

**DIAMOND DRILL LOG  
LITHOLOGY**

NEIL FROC  
JULY 6, 1991

COMPANY: PACIFIC TALC LTD.

Hole No. JJ-91-05

PROPERTY: J & J CLAIMS

Page 2 of 3

<u>INTERVAL</u> FROM TO		<u>CODE</u> <u>LITHOLOGY</u>	<u>DESCRIPTION</u> (Lithology, Color, Comments, etc.)
47.8	54.0	2	TALC/CARBONATE - grey/smoky white, strong foliation (62°, 65° to core axis), blue/green "soapy" talc, sulphides along foliation <1.0 %, coarse carbonate.
54.0	58.0	C	CHLORITE - dark green/olive green, strong foliation, weaker chloritic alteration at end of interval minor mica @ 57.0 m, minor carbonate veining minor sulphides
58.0	58.8	2	TALC/CARBONATE - grey/green, strong foliation (to core axis 35°) coarse carbonate, minor tremolite (?) at end of interval.
58.8	63.1	2 (C)	TALC/CARBONATE/CHLORITE - green/grey, strong foliation, high chlorite content, minor sulphide, tremolite (?) common.
63.1	70.0	C (2)	CHLORITE/TALC/CARBONATE - dark green & green/grey, intermixed chlorite and talc/carbonate, abundant tremolite (?) Petrographic sample @ 66.4 m.
70.0	87.5	2 (C)	TALC/CARBONATE - as above 58.8 - 63.1 m, increased chlorite content, calcite veining 83.0 to 84.0 m.



**DIAMOND DRILL LOG  
A S S A Y**

July, 1991  
Neil Froc

Hole No. JJ-91-05  
Page 1 of 4

COMPANY: PACIFIC TALC LTD.  
PROPERTY: J & J CLAIMS

INTERVAL				SAMPLE NUMBER	A S S A Y S			
FROM	TO	CORE WIDTH	CORE REC. %		% Talc	% Magnesite	% Chlorite	% Side/Anker
6.7	8.0	0.5	38	235958 H				
8.0	10.0	1.0	50	235959 H				
10.0	12.0	1.8	90	235960 H				
12.0	14.0	2.0	100	235961 H				
14.0	16.0	1.9	95	235962 H				
16.0	18.0	2.0	100	235963 H				
18.0	20.0	2.0	100	235964 H				
20.0	22.0	2.0	100	235965 H				
22.0	24.0	2.0	100	235966 H				
24.0	26.0	1.2	60	235967 H				
26.0	28.0	1.5	75	235968 H				
28.0	30.0	1.8	90	235969 H				
30.0	32.0	2.0	100	235970 H				
32.0	34.0	2.0	100	235971 H				



**DIAMOND DRILL LOG  
A S S A Y**

July 6, 1991  
Neil Froc

Hole No. JJ-91-05  
Page 2 of 4

COMPANY: PACIFIC TALC LTD.  
PROPERTY: J & J CLAIMS

INTERVAL				SAMPLE NUMBER	A S S A Y S			
FROM	TO	CORE WIDTH	CORE REC. %		% Talc	% Magnesite	% Chlorite	% Side/Anker
34.0	36.0	2.0	100	235972 H				
36.0	38.0	1.9	95	235973 H				
38.0	40.0	2.0	100	235974 H				
40.0	42.0	2.0	100	235975 H				
42.0	42.5	0.5	100	235976 H				
42.5	44.0	1.1	73	235977 H				
44.0	46.0	1.9	95	235978 H				
46.0	46.6	0.6	100	235979 H				
46.6	48.0	1.4	100	235980 H				
48.0	50.0	2.0	100	235981 H				
50.0	52.0	2.0	100	235982 H				
52.0	54.0	2.0	100	235983 H				
54.0	56.0	2.0	100	235984 H				
56.0	58.0	2.0	100	235985 H				

**DIAMOND DRILL LOG  
A S S A Y**

July 6, 1991  
Neil Froc

Hole No. JJ-91-05  
Page 3 of 4

COMPANY: PACIFIC TALC LTD.  
PROPERTY: J & J CLAIMS

INTERVAL				SAMPLE NUMBER	A S S A Y S			
FROM	TO	CORE WIDTH	CORE REC. %		% Talc	% Magnesite	% Chlorite	% Side/Anker
58.0	58.8	0.8	100	235986 H				
58.8	60.0	1.2	100	235987 H				
60.0	62.0	2.0	100	235988 H				
62.0	64.0	2.0	100	235989 H				
64.0	66.0	1.9	95	235990 H				
66.0	68.0	2.0	100	235991 H				
68.0	70.0	2.0	100	235992 H				
70.0	72.0	2.0	100	235993 H				
72.0	74.0	2.0	100	235994 H				
74.0	76.0	2.0	100	235995 H				
76.0	78.0	2.0	100	235996 H				
78.0	80.0	2.0	100	235997 H				
80.0	82.0	2.0	100	235998 H				
82.0	84.0	2.0	100	235999 H				



**DIAMOND DRILL LOG  
R Q D**

COMPANY: PACIFIC TALC LIMITED

Page 1 of 1

PROPERTY: J & J CLAIMS

Hole No. JJ-91-05

FROM	TO	TOTAL	MEAS.	%	FROM	TO	TOTAL	MEAS.	%
6.7	8.22	1.52	0.28	18	66.14	69.18	3.04	2.00	66
8.22	11.28	3.06	0.37	12	69.18	72.24	3.06	2.64	86
11.28	14.32	3.04	1.46	48	72.24	75.29	3.05	2.90	95
14.32	17.37	3.05	0.76	25	75.29	78.33	3.04	2.70	89
17.37	20.42	3.05	2.30	75	78.33	81.38	3.05	2.30	75
20.42	23.46	3.04	2.80	92	81.38	84.43	3.05	2.94	96
23.46	25.90	2.44	0.0	0	84.43	87.48	3.05	1.65	54
25.90	29.26	3.36	2.00	59	87.48	90.53	3.05	2.45	80
29.26	32.61	3.35	3.30	99	90.53	93.57	3.04	1.84	61
32.61	35.66	3.05	2.32	76	93.57	96.62	3.05	2.44	80
35.66	38.70	3.04	2.66	88		EOH			
38.70	41.75	3.05	2.27	74					
41.75	44.80	3.05	1.06	35					
44.80	47.85	3.05	2.64	87					
47.85	50.90	3.05	2.75	90					
50.90	53.94	3.04	3.05	100					
53.94	57.00	3.06	2.73	89					
57.00	60.05	3.05	1.77	58					
60.05	63.09	3.04	2.80	92					
63.09	66.14	3.05	1.95	64					

**DIAMOND DRILL LOG  
GENERAL**

Hole No. JJ-91-06  
Page 1 of 1

COMPANY: Pacific Talc Limited  
PROPERTY: J & J Claims

Measure:  Feet  Metres

HOLE NUMBER: JJ-91-06  
CLAIM GROUP: J & J  
NTS: \_\_\_\_\_

ZONE/SECTION: \_\_\_\_\_  
Easting: \_\_\_\_\_  
Northing: \_\_\_\_\_  
Elevation: \_\_\_\_\_  
Azimuth/Dip: \_\_\_\_\_

DRILLED BY: Blackhawk Diamond Drilling Ltd., Kamloops  
Core Size: NQ Interval 0 - 105.5  
Interval \_\_\_\_\_ - \_\_\_\_\_  
Started: Sept 19, 1991  
Finished: Sept 21, 1991  
Casing Left: None

LOGGED BY: Chris Baldys  
Started: Oct 11, 1991  
Finished: Oct 11, 1991

Purpose/Comment: To change geologic reserves on surface from probable to proven category. Sperry Sun Survey did not work!  
\_\_\_\_\_  
\_\_\_\_\_  
\_\_\_\_\_

DOWNHOLE SURVEY				
Metreage	Dip	AZIMUTH		
		Observed	Corrected	Comment
0	45	-	225°	NS
105.5	45	-	225	NS

NS - Not Surveyed SS - Sperry Sun Single Shot

Assay For: XRD (Bacon Donaldson & Associates Ltd.) for talc %, magnesite %, chlorite %.  
\_\_\_\_\_  
\_\_\_\_\_  
\_\_\_\_\_

Assay By: \_\_\_\_\_

**DIAMOND DRILL LOG  
LITHOLOGY**

CHRIS BALDYS  
OCTOBER, 1991

COMPANY: PACIFIC TALC LTD.

Hole No. JJ-91-06

PROPERTY: J & J CLAIMS

Page 1 of 3

INTERVAL FROM TO		CODE LITHOLOGY	DESCRIPTION (Lithology, Color, Comments, etc.)
0.0	4.6	OVB	OVERBURDEN
4.6	38.7	P	PHYLLITE - typical, well-foliated, moderately broken, locally poddy, quartz veins up to 5 cm wide.
38.7	39.1	DY ?	DYKE - porphyritic grey-greenish, massive @ 45° to C/A.
39.1	39.8	P	PHYLLITE - sheared fishscale zone, shearing @ 45° to C/A, black chlorite as fishscale zone grading to fractured phyllite in upper part.
39.8	44.5	3	TALC/CARBONATE - patchy, mosaical carbonate-talc, competent zone, light to dark grey with minor 5 cm thick chlorite sections @ 40.6 and 43.3 m.
44.5	49.7	2	TALC/CARBONATE - light grey zone, starting with sheared talc @ 44.5 - 44.8 m, mainly "granular" appearance grading to patchy speckled look down the hole near chlorite contact.
49.7	50.8	C	CHLORITE - dark green, moderately broken zone, slickensides @ 30° to C/A.

DIAMOND DRILL LOG  
L I T H O L O G Y

CHRIS BALDYS  
OCTOBER, 1991

COMPANY: PACIFIC TALC LTD.

Hole No. JJ-91-06

PROPERTY: J & J CLAIMS

Page 2 of 3

INTERVAL FROM TO		CODE LITHOLOGY	DESCRIPTION (Lithology, Color, Comments, etc.)
50.8	54.7	2	TALC-CARBONATE - light grey, patchy to "granular" texture, competent zone, minor light green soapstone veins along fractures.
54.7	59.0	3 (C)	TALC-CARBONATE-CHLORITE - light grey-green zone of fine-grained relatively harder rock (due to CaCO <sub>3</sub> ), very competent core.
59.0	60.8	2	TALC-CARBONATE - as (2) above, competent core.
60.8	61.6	C	CHLORITE - pale green, roughly laminated zone, intermixed?? with talc at lower part.
61.6	86.3	2	TALC-CARBONATE - uniformly textured zone of patchy to roughly layered fabric in unit 2 locally 3 material, narrow chlorite zones @ 73.6 - 73.8, 79.7 - 79.9, generally competent to moderately broken zone with shears at 71.9 - 72.0 (fishscale texture), 83.4 - 84.0 (fracture zone + minor gouge), 84.5 - 85.0 (fracture zone + ground-up core). - some tremolite intermixed with patchy calcite.





**DIAMOND DRILL LOG  
ASSAY**

CHRIS BALDYS  
OCTOBER, 1991

Hole No. JJ-91-06  
Page 1 of 2

COMPANY: PACIFIC TALC LTD.  
PROPERTY: J & J CLAIMS

INTERVAL				SAMPLE NUMBER	ASSAYS			
FROM	TO	CORE WIDTH	CORE REC. %		% Talc	% Magnesite	% Chlorite	% Side/Anker
39.8	42.0	2.1	95	332251 H				
42.0	44.5	2.4	96	332252 H				
44.5	46.0	1.3	87	332253 H				
46.0	49.7	2.5	68	332254 H				
49.7	50.0	0.3	100	332255 H				
50.0	50.8	0.8	100	332256 H				
50.8	54.0	3.2	100	332257 H				
54.0	54.7	0.7	100	332258 H				
54.7	58.0	3.3	100	332259 H				
58.0	59.0	1.0	100	332260 H				
59.0	60.8	1.8	100	332261 H				
60.8	61.6	0.8	100	332262 H				
61.6	62.0	0.4	100	332263 H				
62.0	66.0	4.0	100	332264 H				



CHRIS BALDYS  
OCTOBER, 1991

DIAMOND DRILL LOG  
R Q D

COMPANY: PACIFIC TALC LIMITED

Page 1 of 1

PROPERTY: J & J CLAIMS

Hole No. JJ-91-06

FROM	TO	TOTAL	MEAS.	%	FROM	TO	TOTAL	MEAS.	%
4.60	7.62	0.80	0	0	47.50	50.30	2.60	2.25	87
7.62	11.00	2.80	0.75	27	50.30	53.40	3.10	1.45	47
11.00	12.80	1.80	0	0	53.40	56.50	3.10	2.80	90
12.80	14.20	1.25	0.35	28	56.50	59.70	3.00	2.80	93
14.20	15.50	1.30	0.45	35	59.70	62.80	3.00	2.30	77
15.50	16.90	1.00	0.45	45	62.80	65.80	3.00	1.10	37
16.90	18.10	1.20	0.50	42	65.80	68.90	2.90	2.00	69
18.10	20.10	1.90	0.30	16	68.90	71.90	3.00	1.90	63
20.10	21.20	1.05	0.30	29	71.90	75.00	2.80	1.50	54
21.20	24.40	3.10	1.30	42	75.00	78.00	3.00	2.00	67
24.40	25.90	1.35	0.35	26	78.00	81.10	2.90	1.90	66
25.90	29.30	3.20	3.20	100	81.10	84.10	3.00	0.90	30
29.30	30.80	1.50	0.60	40	84.10	87.20	3.00	1.45	48
30.80	32.60	1.60	0.75	47	87.20	90.20	2.90	2.60	90
32.60	33.70	1.40	0.30	21	90.20	93.30	2.80	1.30	46
33.70	36.70	3.00	2.35	78	93.30	96.20	2.90	2.40	83
36.70	39.80	2.65	1.75	66	96.20	99.20	3.00	2.50	83
39.80	43.30	3.30	2.40	73	99.20	102.40	3.00	2.30	77
43.30	44.50	1.00	0.25	25	102.40	105.50	3.00	1.80	60
44.50	47.60	2.85	2.05	72	EOH				

**DIAMOND DRILL LOG  
GENERAL**

Hole No. JJ-91-07  
Page 1 of 1

COMPANY: Pacific Talc Ltd.

PROPERTY: J & J Claims

HOLE NUMBER: JJ-91-07

CLAIM GROUP: J & J

NTS: \_\_\_\_\_

ZONE/SECTION: \_\_\_\_\_

Easting: \_\_\_\_\_

Northing: \_\_\_\_\_

Elevation: \_\_\_\_\_

Azimuth/Dip: \_\_\_\_\_

DRILLED BY: Blackhawk Diamond Drilling Ltd., Kamloops

Core Size: NQ Interval 0 - 124.0

Interval \_\_\_\_\_ - \_\_\_\_\_

Started: Sept 23, 1991

Finished: Sept 26, 1991

Casing Left: 3 m

LOGGED BY: Chris Baldys

Started: Oct 13, 1991

Finished: \_\_\_\_\_

Purpose/Comment: To change geologic reserves on surface from probable to proven category.

Measure:  Feet  Metres

DOWNHOLE SURVEY				
Metreage	Dip	AZIMUTH		Comment
		Observed	Corrected	
0	60°	-	217	NS
124.0	60°	S 16° W	217	SS

NS - Not Surveyed SS - Sperry Sun Single Shot

Assay For: talc %, magnesite %, chlorite % by XRD

Assay By: Bacon Donaldson & Associates (Richmond, BC)

**DIAMOND DRILL LOG  
LITHOLOGY**

CHRIS BALDYS  
OCTOBER, 1991

COMPANY: PACIFIC TALC LTD.

Hole No. JJ-91-07

PROPERTY: J & J CLAIMS

Page 1 of 3

INTERVAL FROM TO		CODE LITHOLOGY	DESCRIPTION (Lithology, Color, Comments, etc.)
0.0	3.05	OVB	OVERBURDEN - (casing)
3.05	59.1	P	PHYLLITE - typical dark grey, well-foliated @ 50 - 60° to C/A, siliceous with abundant quartz as poddy veins and stringers up to 10 cm thick and silica layers as laminae, some combination of folding and diagenetic deformation producing characteristic textures in foliation - bedding shears @ 42.4 - 44.0 (broken + s. siding), 53.6 - 53.8 (broken-graphitic) minor shear.
59.1	67.7	C	CHLORITE - chloritized and locally silicified phyllite, grey-greenish to grey zone with strong shearing associated with talc @ 59.1 - 61.5 (highly broken, talcose loc. silicified), 63.0 - 67.6 (strong shearing with gouge/fishscale zones @ 80 - 70° to C/A??)
67.7	86.0	2	TALC-CARBONATE - light grey to dark grey zone of patchy mosaical textured, dark green to light soapy talc intermixed with irregular poddy carbonate frequently broken, locally s. sided or intensely sheared @ 67.7 - 69.2 (highly broken + gouge [40%]), 70.2 - 71.9 (broken, s. sided), 75.4 - 76.7 (broken, s. sided), v. minor chlorite, i.e., 10 cm zone @ 81.8, talc generally grey to greenish grey, massive, intermixed with patchy to smeared carbonate, locally grading to (1).

DIAMOND DRILL LOG  
LITHOLOGY

CHRIS BALDYS  
OCTOBER, 1991

COMPANY: PACIFIC TALC LTD.

Hole No. JJ-91-07

PROPERTY: J & J CLAIMS

Page 2 of 3

INTERVAL FROM TO		CODE LITHOLOGY	DESCRIPTION (Lithology, Color, Comments, etc.)
86.0	88.7	C	CHLORITE - dark green, massive, weakly talcose with narrow zones of talc or talc-carbonate healing fracture/breccia zones @ 87.0 - 87.1, 87.7 - 87.9.
88.7	90.5	2 (C)	TALC-CARBONATE-CHLORITE - grey to dark green zone of transition to underlying (2) grade zone starts with 0.2 m calcite healed breccia in chlorite material, grades to (2) material in the centre and 2(C) at lower limit.
90.5	96.6	2	TALC-CARBONATE - dark grey to light grey zone of typical patchy textured talc-carbonate with blurred roughly marked "foliation", minor amounts of light greenish, soapy talc present with pods? of calcite, all core competent.
96.6	98.0	C	CHLORITE - dark to pale green talcose chlorite zone with talc increasing downwards along with development of "fishscale" fractures @ 97.5 - 98.0, shear zone @ 45° to C/A.
98.0	104.4	2	TALC-CARBONATE - continuation of previous grade (2) zone of dark to light grey patchy - speckled talc-carbonate, massive, competent core.
104.4	106.0	C	CHLORITE - dark green, massive, low talc zone, locally broken/fractured @ 104.4 - 104.6 m.

DIAMOND DRILL LOG  
LITHOLOGY

CHRIS BALDYS  
OCTOBER, 1991

COMPANY: PACIFIC TALC LTD.

Hole No. JJ-91-07

PROPERTY: J & J CLAIMS

Page 3 of 3

INTERVAL FROM TO		CODE LITHOLOGY	DESCRIPTION (Lithology, Color, Comments, etc.)
106.0	109.6	2	TALC-CARBONATE - dark grey to light grey-greenish slightly chloritic, typical talc-carbonate with patchy to blurred texture, talc cemented fault breccia @ 108.0 - 108.5.
109.6	111.6	C	CHLORITE - dark green to greenish-grey zone within a shear of same width of strongly fractured, locally brecciated talcose material.
111.6	120.6	2	TALC-CARBONATE - grey to light grey massive zone of typical talc-carbonate in competent core.
120.6	121.8	1	TALC - soapy, massive, light grey to pale greenish talc with polished s. siding @ 45° to C/A, fairly competent core.
121.8	122.4	C	CHLORITE - pale greenish-grey, chlorite zone at phyllite contact.
122.4	124.0	P	PHYLLITE - dark grey to black foliated phyllite in competent core.
		EOH	End of Hole

**DIAMOND DRILL LOG  
ASSAY**

CHRIS BALDYS  
OCTOBER, 1991

Hole No. JJ-91-07  
Page 1 of 2

COMPANY: PACIFIC TALC LTD.  
PROPERTY: J & J CLAIMS

INTERVAL				SAMPLE NUMBER	ASSAYS			
FROM	TO	CORE WIDTH	CORE REC. %		% Talc	% Magnesite	% Chlorite	% Side/Anker
59.1	62.0	2.6	84	332479 H				
62.0	66.0	3.9	98	332480 H				
66.0	67.7	1.4	82	332481 H				
67.7	70.0	1.8	78	332482 H				
70.0	74.0	4.0	100	332483 H				
74.0	78.0	4.0	100	332484 H				
78.0	82.0	4.0	100	332485 H				
82.0	86.0	3.9	98	332486 H				
86.0	88.7	2.6	96	332487 H				
88.7	90.0	1.2	92	332488 H				
90.0	90.5	0.5	100	332489 H				
90.5	94.0	3.5	100	332490 H				
94.0	96.6	2.3	88	332491 H				
96.6	98.0	1.4	100	332492 H				





CHRIS BALDYS  
OCTOBER, 1991

DIAMOND DRILL LOG  
R Q D

COMPANY: PACIFIC TALC LIMITED

Page 1 of 2

PROPERTY: J & J CLAIMS

Hole No. JJ-91-07

FROM	TO	TOTAL	MEAS.	%	FROM	TO	TOTAL	MEAS.	%
3.05	5.2	1.80	1.45	81	58.5	59.3	0.8	0.4	50
5.2	8.2	3.0	2.3	77	59.3	60.7	1.2	0.3	25
8.2	11.3	2.9	1.6	55	60.7	62.8	1.1	0.8	73
11.3	14.3	2.9	2.6	90	62.8	63.9	0.6	0.35	58
14.3	17.4	2.9	2.6	90	63.9	64.6	0.7	0	0
17.4	20.4	3.0	3.0	100	64.6	66.1	1.4	0.3	21
20.4	23.5	3.0	3.0	100	66.1	67.7	1.4	0.15	11
23.5	26.5	3.0	2.3	77	67.7	68.3	0.6	0	0
26.5	29.6	3.0	2.6	87	68.3	69.2	0.4	0	0
29.6	32.6	2.9	2.9	100	69.2	72.2	2.8	1.1	39
32.6	35.7	2.9	2.3	79	72.2	75.3	2.9	1.1	38
35.7	38.7	2.8	1.1	39	75.3	76.8	1.5	0.1	7
38.7	41.8	3.0	1.9	63	76.8	78.3	1.5	1.3	87
41.8	42.4	0.6	0.5	83	78.3	81.4	3.0	2.1	70
42.4	44.5	1.4	0.2	14	81.4	84.4	3.0	2.1	70
44.5	47.6	2.7	1.6	59	84.4	87.5	3.0	1.8	60
47.6	50.6	3.1	1.9	61	87.5	90.5	3.0	1.1	37
50.6	53.6	3.0	1.7	57	90.5	93.6	3.0	2.2	73
53.6	56.7	2.6	1.8	69	93.6	96.6	3.0	2.4	80
56.7	58.5	1.7	0.8	47	96.6	99.7	3.0	1.3	43



**DIAMOND DRILL LOG  
GENERAL**

Hole No. JJ-91-08  
Page 1 of 1

COMPANY: PACIFIC TALC LIMITED  
PROPERTY: J & J CLAIMS

Measure:  Feet  Metres

HOLE NUMBER: JJ-91-08  
CLAIM GROUP: J & J  
NTS: \_\_\_\_\_

ZONE/SECTION: \_\_\_\_\_  
Easting: \_\_\_\_\_  
Northing: \_\_\_\_\_  
Elevation: \_\_\_\_\_  
Azimuth/Dip: \_\_\_\_\_

DRILLED BY: Blackhawk Diamond Drilling Ltd., Kamloops  
Core Size: NQ Interval 6.10 - 75.0  
Interval \_\_\_\_\_ - \_\_\_\_\_  
Started: Sept 27, 1991  
Finished: Sept 28, 1991  
Casing Left: \_\_\_\_\_

LOGGED BY: Neil Froc/Chris Baldys  
Started: Oct 8, 1991  
Finished: Oct 9, 1991

Purpose/Comment: To change geologic reserves on surface from probable to proven category.

DOWNHOLE SURVEY				
Metreage	Dip	AZIMUTH		
		Observed	Corrected	Comment
0	48°	-	215.5	NS
75.0	42°	S 14.5 W	215.5	SS

NS - Not Surveyed SS - Sperry Sun Single Shot

Assay For: talca %, magnesite %, chlorite % by XRD.  
\_\_\_\_\_  
\_\_\_\_\_  
\_\_\_\_\_  
\_\_\_\_\_

Assay By: Bacon Donaldson & Associates (Richmond, BC)

**DIAMOND DRILL LOG  
L I T H O L O G Y**

NEIL FROC/CHRIS BALDYS  
OCTOBER, 1991

COMPANY: PACIFIC TALC LTD.

Hole No. JJ-91-08

PROPERTY: J & J CLAIMS

Page 1 of 2

INTERVAL FROM TO		CODE LITHOLOGY	DESCRIPTION (Lithology, Color, Comments, etc.)
0	6.10	OVB	OVERBURDEN - (actual contact between OVB and Phyllite = 5.8).
6.10	22.3	P	PHYLLITE - grey/black, well-foliated, oxidized along fractures and foliations, minor quartz veining parallel to foliations (30 mm), minor veinlets (1 mm) crosscutting laminations @ 20.1 m, sharp upper contact.
22.3	39.4	3	TALC/CARBONATE - grey/white, very weak foliation, well-defined carbonate crystals (white & tan carbonate), weak oxidation along widely spaced fractures, highly broken core from 22.3 to 24.69 m (areas of intense foliation), chlorite from 24.1 to 24.5 m, oxidized carbonate crystals, trace sulphides, minor blue/green "soapy" talc zones, high grade talc at upper contact.
39.4	39.9	C	CHLORITE - dark green, minor sulphides (trace).
39.9	57.2	3	TALC/CARBONATE (as above) - trace to 1% sulphides, weak oxidation from 45.5 m to 47.0 along fractures and carbonates near fractures, increased blue/green "soapy" talc from 47.4 to 49.1 m, minor blue/green "soapy" talc across complete interval, chlorite along fracture along lower contact.

DIAMOND DRILL LOG  
LITHOLOGY

NEIL FROC/CHRIS BALDYS  
OCTOBER, 1991

COMPANY: PACIFIC TALC LTD.

Hole No. JJ-91-08

PROPERTY: J & J CLAIMS

Page 2 of 2

INTERVAL FROM TO		CODE LITHOLOGY	DESCRIPTION (Lithology, Color, Comments, etc.)
57.2	57.7	C	CHLORITE - green, waxy, trace sulphides
57.7	64.4	3	TALC/CARBONATE - grey/white, moderate foliation evident from 60.0 to 64.4 m, trace to 1% sulphide blue/green "soapy" talc intervals mixed throughout.
64.4	68.3	1 (C)	TALC (chloritic) - light green to dark green, strong foliation to intense foliation, graphitic (?) at 66.30, minor sulphide, minor brecciation (?) @ 64.5, dark green chloritic zone 65.0 to 66.3 m.
68.3	69.2	1	TALC - grey/white/blue-green, intense foliation, less chloritic than intervals above and below, trace sulphide.
69.2	70.7	1 (C)	TALC (chloritic) - as above, gradational lower contact with phyllite, no dark green chloritic zone.
70.7	75.0	P	PHYLLITE - grey/black, minor talc at upper contact, 30% quartz from 70.7 to 71.5, minor to 5% biotite moderately to intense foliation, minor gneissic intervals.

**DIAMOND DRILL LOG  
A S S A Y**

NEIL FROC/CHRIS BALDYS  
OCTOBER, 1991

COMPANY: PACIFIC TALC LTD.

PROPERTY: J & J CLAIMS

Hole No. JJ-91-08

Page 1 of 2

INTERVAL				SAMPLE NUMBER	A S S A Y S			
FROM	TO	CORE WIDTH	CORE REC. %		% Talc	% Magnesite	% Chlorite	% Side/Anker
22.3	26.0	2.95	80	332351 H				
26.0	30.0	3.95	99	332352 H				
30.0	34.0	4.00	100	332353 H				
34.0	38.0	4.00	100	332354 H				
38.0	39.4	1.40	100	332355 H				
39.4	39.9	0.50	100	332356 H				
39.9	42.0	1.96	93	332357 H				
42.0	46.0	3.90	98	332358 H				
46.0	50.0	4.00	100	332359 H				
50.0	54.0	3.90	98	332360 H				
54.0	57.2	3.20	100	332361 H				
57.2	57.7	0.50	100	332362 H				
57.7	58.0	0.25	83	332363 H				
58.0	62.0	3.95	99	332364 H				





NEIL FROC/CHRIS BALDYS  
OCTOBER, 1991

**DIAMOND DRILL LOG  
R Q D**

COMPANY: PACIFIC TALC LIMITED

Page 1 of 1

PROPERTY: J & J CLAIMS

Hole No. JJ-91-08

FROM	TO	TOTAL	MEAS.	%	FROM	TO	TOTAL	MEAS.	%
6.1	7.62	0.68	0.20	29	47.55	50.60	3.08	3.00	97
7.62	9.45	1.00	0.20	20	50.60	53.64	2.95	2.81	95
9.45	10.97	0.60	0	0	53.64	56.69	3.07	2.87	93
10.97	13.41	2.35	0.10	4	56.69	59.74	3.12	2.57	82
13.41	15.54	1.85	1.07	58	59.74	62.79	2.83	1.10	29
15.54	17.07	1.30	0.50	38	62.79	66.44	1.90	1.04	55
17.07	18.29	1.15	0	0	66.44	68.88	2.08	0.60	29
18.29	19.20	1.45	0.20	14	68.88	71.93	2.95	0.86	29
19.20	20.57	1.20	0.34	28	71.93	74.98	3.00	2.70	90
20.57	22.56	1.70	0.40	24		EOH			
22.56	23.16	0.50	0	0					
23.16	24.69	1.45	0.15	10					
24.69	26.21	1.30	1.1	85					
26.21	29.26	3.00	2.80	93					
29.26	32.31	3.10	2.95	95					
32.31	35.36	3.05	2.90	95					
35.36	38.40	3.10	2.95	95					
38.40	41.45	3.00	2.73	91					
41.45	44.50	3.04	2.95	97					
44.50	47.55	3.05	2.75	90					

**DIAMOND DRILL LOG  
GENERAL**

Hole No. JJ-91-09  
Page 1 of 1

COMPANY: PACIFIC TALC LIMITED  
PROPERTY: J & J CLAIMS

Measure:  Feet  Metres

HOLE NUMBER: JJ-91-09  
CLAIM GROUP: J & J  
NTS: \_\_\_\_\_

ZONE/SECTION: \_\_\_\_\_  
Easting: \_\_\_\_\_  
Northing: \_\_\_\_\_  
Elevation: \_\_\_\_\_  
Azimuth/Dip: \_\_\_\_\_

DRILLED BY: Blackhawk Diamond Drilling Ltd., Kamloops  
Core Size: NQ Interval 3.05 - 92.05  
Interval \_\_\_\_\_ - \_\_\_\_\_  
Started: Sept 29, 1991  
Finished: Oct 1, 1991  
Casing Left: \_\_\_\_\_

LOGGED BY: Chris Baldys  
Started: Oct 10, 1991  
Finished: \_\_\_\_\_

Purpose/Comment: To change geologic reserves from probable to proven category.

DOWNHOLE SURVEY				
Metreage	Dip	AZIMUTH		
		Observed	Corrected	Comment
1	45°	-	218°	NS
92.1	48°	S 17° W	218°	SS

NS - Not Surveyed SS - Sperry Sun Single Shot

Assay For: % talc, magnesite, chlorite by XRD.  
\_\_\_\_\_  
\_\_\_\_\_  
\_\_\_\_\_  
\_\_\_\_\_

Assay By: Bacon Donaldson & Associates

**DIAMOND DRILL LOG**  
**LITHOLOGY**

CHRIS BALDYS  
OCTOBER, 1991

COMPANY: PACIFIC TALC LTD.

PROPERTY: J & J CLAIMS

Hole No. JJ-91-09

Page 1 of 3

INTERVAL FROM TO		CODE LITHOLOGY	DESCRIPTION (Lithology, Color, Comments, etc.)
0.0	3.1	OVB	OVERBURDEN
3.1	22.2	P	PHYLLITE - well-foliated and broken core down to @ 16.00 m and grading to more competent chlorite or chlorite carbonate schists downhole from @ 16.00 - 22.15. Locally limonite stained in quartz-pod sections.
22.2	28.5	2(C)	TALC-CHLORITE-CARBONATE - locally chlorite prevailing (>50 %), locally faulted (gouge) @ 22.5 - 23.0 and @ 27.5 - 28.45 - fishscale chlorite zone foliation well marked in chlorite-rich zones.
28.5	41.0	3	TALC-CARBONATE - massive zone with competent core of dark grey to grey talc with some evenly distributed chlorite, no foliation, some s. siding with serpentine of fractures??.
41.0	50.6	OX-3	OXIDIZED-TALC-CARBONATE - intense limonite staining (after ankerite?), locally badly broken with fault zones (fishscale) @ 44.0 - 44.5, 45.0 - 45.6, 46.3 - 46.6, 48.5 - 49.1 (gouge + breccia).
50.6	52.0	C	CHLORITE - moderately broken, s. sided at upper contact, dark green.

DIAMOND DRILL LOG  
LITHOLOGY

CHRIS BALDYS  
OCTOBER, 1991

COMPANY: PACIFIC TALC LTD.

PROPERTY: J & J CLAIMS

Hole No. JJ-91-09

Page 2 of 3

INTERVAL FROM TO		CODE LITHOLOGY	DESCRIPTION (Lithology, Color, Comments, etc.)
52.0	55.7	3	TALC-CARBONATE - grey zone, broken in upper part @ 52.0 - 53.0 with some dark chlorite grading to competent light grey zone downhole.
55.7	58.6	OX-3	OXIDIZED-TALC-CARBONATE - intense iron staining due to ankerite-rich zones, possibly healing shear fractures (low angle to C/A).
58.6	67.5	3	TALC-CARBONATE - competent core of light grey talc-carbonate locally grade 2?, occasionaly iron stained poddy zones.
67.5	68.6	C	CHLORITE - dark green, roughly foliated at right angle to C/A.
68.6	81.0	OX-3	OXIDIZED-TALC-CARBONATE - iron stained, highly broken zone with competent unstained section @ 74.7 - 76.2.
81.0	83.3	1	TALC - light soapy talc in competent core, greasy-translucent green on fractures.
83.3	89.8	2(C)	TALC-CHLORITE - dark green, locally light soapy zone, badly broken throughout with common gouge - fishscale sections marking faulting at high angle to C/A @ 83.3, 84.0 - 84.9, 85.2 - 86.9, 87.8 - 89.5.



**DIAMOND DRILL LOG  
A S S A Y**

CHRIS BALDYS  
OCTOBER, 1991

COMPANY: PACIFIC TALC LTD.

PROPERTY: J & J CLAIMS

Hole No. JJ-91-09

Page 1 of 2

INTERVAL				SAMPLE NUMBER	A S S A Y S			
FROM	TO	CORE WIDTH	CORE REC. %		% Talc	% Magnesite	% Chlorite	% Side/Anker
22.2	26.0	3.8	100	332372 H				
26.0	28.5	2.1	84	332373 H				
28.5	30.0	1.5	100	332374 H				
30.0	34.0	4.0	100	332375 H				
34.0	38.0	3.8	95	332376 H				
38.0	41.0	3.0	100	332377 H				
41.0	42.0	1.0	100	332378 H				
42.0	46.0	3.4	85	332379 H				
46.0	50.0	3.4	85	332380 H				
50.0	50.6	0.4	67	332381 H				
50.6	52.0	1.1	79	332382 H				
52.0	54.0	2.0	100	332383 H				
54.0	55.7	1.7	100	332384 H				
55.7	58.0	2.3	100	332385 H				

**DIAMOND DRILL LOG  
A S S A Y**

CHRIS BALDYS  
OCTOBER, 1991

COMPANY: PACIFIC TALC LTD.

PROPERTY: J & J CLAIMS

Hole No. JJ-91-09

Page 2 of 2

INTERVAL				SAMPLE NUMBER	A S S A Y S			
FROM	TO	CORE WIDTH	CORE REC. %		% Talc	% Magnesite	% Chlorite	% Side/Anker
58.0	58.6	0.5	83	332386 H				
58.6	62.0	3.3	97	332387 H				
62.0	66.0	4.0	100	332388 H				
66.0	67.5	1.5	100	332389 H				
67.5	68.6	1.0	91	332390 H				
68.6	70.0	1.3	93	332391 H				
70.0	74.0	3.2	80	332392 H				
74.0	78.0	3.6	90	332393 H				
78.0	81.0	2.9	97	332394 H				
81.0	82.0	1.0	100	332395 H				
82.0	83.3	1.3	100	332396 H				
83.3	86.0	2.3	85	332397 H				
86.0	89.8	3.4	89	332398 H				
	EOH							

CHRIS BALDYS  
OCTOBER, 1991

**DIAMOND DRILL LOG  
R Q D**

COMPANY: PACIFIC TALC LIMITED

Page 1 of 1

PROPERTY: J & J CLAIMS

Hole No. JJ-91-09

FROM	TO	TOTAL	MEAS.	%	FROM	TO	TOTAL	MEAS.	%
3.05	4.57	0.55	0	0	50.60	53.64	2.95	1.27	43
4.57	9.14	4.40	1.80	41	53.64	56.69	2.90	2.25	78
9.14	10.97	1.70	0.84	49	56.69	59.74	3.15	2.27	72
10.97	12.50	1.40	0.33	24	59.74	62.78	3.00	2.90	97
12.50	14.17	1.50	0.55	37	62.78	65.83	3.05	2.58	85
14.17	16.00	1.75	0.56	32	65.83	68.88	3.05	2.00	66
16.00	18.13	2.25	1.15	51	68.88	71.93	2.60	1.05	40
18.13	19.81	2.02	1.32	65	71.93	74.98	2.90	0.40	14
19.81	22.25	2.43	1.64	67	74.98	77.21	2.28	1.60	70
22.25	24.38	2.35	0.93	40	77.21	78.79	1.25	0.62	50
24.38	26.21	1.70	0.84	49	78.79	81.53	2.75	1.78	65
26.21	29.26	3.05	1.25	41	81.53	83.82	2.42	1.55	64
29.26	32.30	3.04	2.67	88	83.82	86.86	2.35	0.40	17
32.30	35.36	3.05	2.95	97	86.86	88.24	1.10	0.10	10
35.36	38.40	3.00	2.86	95	88.24	89.31	0.90	0	0
38.40	42.20	3.80	3.07	81	89.31	92.05	2.75	1.50	55
42.20	44.50	1.45	0.95	66		EOH			
44.50	46.63	2.10	0.55	26					
46.63	47.54	0.65	0.65	100					
47.54	50.60	2.75	1.28	47					



**DIAMOND DRILL LOG  
GENERAL**

Hole No. JJ-91-10  
Page 1 of 1

COMPANY: PACIFIC TALC LTD.  
PROPERTY: J & J CLAIMS

Measure:  Feet  Metres

HOLE NUMBER: JJ-91-10  
CLAIM GROUP: J & J  
NTS: \_\_\_\_\_

ZONE/SECTION: \_\_\_\_\_  
Easting: \_\_\_\_\_  
Northing: \_\_\_\_\_  
Elevation: \_\_\_\_\_  
Azimuth/Dip: \_\_\_\_\_

DRILLED BY: Blackhawk Diamond Drilling Ltd., Kamloops  
Core Size: NQ Interval 0 - 96.6  
Interval \_\_\_\_\_ - \_\_\_\_\_  
Started: Oct 2, 1991  
Finished: Oct 4, 1991  
Casing Left: None

LOGGED BY: Chris Baldys  
Started: Oct 12, 1991  
Finished: \_\_\_\_\_

Purpose/Comment: To change geologic reserves on surface from probable to proven category.

DOWNHOLE SURVEY				
Metreage	Dip	AZIMUTH		
		Observed	Corrected	Comment
0	60°	-	225	NS
96.6	60	S 24° W	225	SS

NS - Not Surveyed SS - Sperry Sun Single Shot

Assay For: % talc, magnesite, chlorite by XRD.  
\_\_\_\_\_  
\_\_\_\_\_  
\_\_\_\_\_  
\_\_\_\_\_

Assay By: Bacon Donaldson & Associates

**DIAMOND DRILL LOG  
LITHOLOGY**

CHRIS BALDYS  
OCTOBER, 1991

COMPANY: PACIFIC TALC LTD.

Hole No. JJ-91-10

PROPERTY: J & J CLAIMS

Page 1 of 4

<u>INTERVAL</u> FROM TO		<u>CODE</u> <u>LITHOLOGY</u>	<u>DESCRIPTION</u> (Lithology, Color, Comments, etc.)
0.0	18.3	OVB	OVERBURDEN - various lithologies as boulders up to 0.4 m diameter mixed with clay.
18.3	20.5	P	PHYLLITE - dark-brown weathered out, well-foliated, more siliceous at bottom contact.
20.5	21.5	C	CHLORITE - zone of chlorite replacement of phyllite in part, dark green talcose and broken.
21.5	24.5	1	TALC - light greenish grading to brownish-light locally strongly brown at lower part, occasionally minor dark chlorite, roughly foliated in upper part and highly broken @ 22.5 - 24.5, shears @ 22.5 - 22.8, 24.0 - 24.5.
24.5	25.3	C	CHLORITE - dark green talcose, dyke replacement zone.
25.3	30.8	2	TALC-CARBONATE - light to locally dark grey, often greenish zone of "speckled" texture, generally good white lumpy + greenish translucent soapy + massive greyish varieties of talc intermixed with poddy calcite (brownish-grey).

DIAMOND DRILL LOG  
LITHOLOGY

CHRIS BALDYS  
OCTOBER, 1991

COMPANY: PACIFIC TALC LTD.

Hole No. JJ-91-10

PROPERTY: J & J CLAIMS

Page 2 of 4

INTERVAL FROM TO		CODE LITHOLOGY	DESCRIPTION (Lithology, Color, Comments, etc.)
30.8	31.4	C	CHLORITE - replacing narrow dyke dipping @ 5 - 10° to C/A followed by narrow talc-gouge filled fracture (1 cm) at footwall.
31.4	37.7	2	TALC-CARBONATE - continuation of the above (2) zone, light grey-greenish, quite massive zone, minor massive chlorite @ 36.5 - 36.7 m.
37.7	38.7	C	CHLORITE - grey-greenish zone, partly broken, comprising the upper part of major mafic dyke, weakly talcose.
38.7	42.7	P	PHYLLITE - dark grey "porphyritic", dyke-like massive zone, rough foliation, locally, dark chlorite, siliceous throughout except for lower contact zone 0.6 m of chlorite-muscovite including shear @ 42.5 - 42.7.
42.7	46.4	3 (T)	TALC-TREMOLITE-CARBONATE - pale greenish zone, highly competent, massive homogenous texture, relatively hard consisting of greenish soapy talc intermixed with bright green radiating tremolite + some calcite, gradual contact with (2).

DIAMOND DRILL LOG  
LITHOLOGY

CHRIS BALDYS  
OCTOBER, 1991

COMPANY: PACIFIC TALC LTD.

PROPERTY: J & J CLAIMS

Hole No. JJ-91-10

Page 3 of 4

INTERVAL FROM TO		CODE LITHOLOGY	DESCRIPTION (Lithology, Color, Comments, etc.)
46.4	48.6	2	TALC-CARBONATE - grey to grey-greenish zone of typical talc-carbonate patchy to blurred texture.
48.6	50.0	C	CHLORITE - weakly chloritized, talcose mafic dyke or inclusion of phyllite.
50.0	51.9	2	TALC-CARBONATE - light greenish to dark grey, typical patchy blurred texture with abundant soapy pods accounting for grade (1) locally.
51.9	52.5	C	CHLORITE - massive dark green chlorite (replacing a dyke?)
52.5	67.5	2	TALC-CARBONATE - light grey to grey patchy but speckled texture due to big calcite pods, often grading to (3), very competent zone with uniform texture.
67.5	69.9	C	CHLORITE - dark green, massive chloritic dyke at low angle to CIA (5 - 10°?).



**DIAMOND DRILL LOG  
A S S A Y**

CHRIS BALDYS  
OCTOBER, 1991

COMPANY: PACIFIC TALC LTD.

PROPERTY: J & J CLAIMS

Hole No. JJ-91-10

Page 1 of 3

INTERVAL				SAMPLE NUMBER	A S S A Y S			
FROM	TO	CORE WIDTH	CORE REC. %		% Talc	% Magnesite	% Chlorite	% Side/Anker
20.5	21.5	0.8	80	332273 H				
21.5	24.0	2.5	100	332274 H				
24.0	24.5	0.2	40	332275 H				
24.5	25.3	0.6	75	332276 H				
25.3	28.0	2.7	100	332277 H				
28.0	30.8	2.8	100	332278 H				
30.8	31.4	0.5	83	332279 H				
31.4	32.0	0.6	100	332280 H				
32.0	36.0	4.0	100	332281 H				
36.0	37.7	1.7	100	332282 H				
37.7	38.7	1.0	100	332283 H				
38.7	40.0	1.3	100	332284 H				
40.0	42.7	2.6	96	332285 H				
42.7	44.0	1.3	100	332286 H				

**DIAMOND DRILL LOG  
ASSAY**

CHRIS BALDYS  
OCTOBER, 1991

COMPANY: PACIFIC TALC LTD.

PROPERTY: J & J CLAIMS

Hole No. JJ-91-10

Page 2 of 3

INTERVAL				SAMPLE NUMBER	ASSAYS			
FROM	TO	CORE WIDTH	CORE REC. %		% Talc	% Magnesite	% Chlorite	% Side/Anker
44.0	46.4	2.2	92	332287 H				
46.4	48.0	1.6	100	332288 H				
48.0	48.6	0.6	100	332289 H				
48.6	50.0	1.3	93	332290 H				
50.0	51.9	1.6	84	332291 H				
51.9	52.0	0.1	100	332292 H				
52.0	52.5	0.5	100	332293 H				
52.5	56.0	3.5	100	332294 H				
56.0	60.0	4.0	100	332295 H				
60.0	64.0	3.9	98	332296 H				
64.0	67.5	3.3	94	332297 H				
67.5	68.0	0.5	100	332298 H				
68.0	69.9	1.7	89	332299 H				
69.9	72.0	2.1	100	332300 H				





CHRIS BALDYS  
OCTOBER, 1991

**DIAMOND DRILL LOG  
R Q D**

COMPANY: PACIFIC TALC LIMITED

Page 1 of 1

PROPERTY: J & J CLAIMS

Hole No. JJ-91-10

FROM	TO	TOTAL	MEAS.	%	FROM	TO	TOTAL	MEAS.	%
18.30	20.40	1.40	0.55	39	78.30	81.40	3.00	2.60	87
20.40	23.50	2.80	0.80	29	81.40	84.40	3.00	2.80	93
23.50	25.30	1.70	0.40	24	84.40	87.50	3.00	1.60	53
25.30	28.40	2.95	2.30	78	87.50	90.50	2.70	1.20	44
28.40	32.60	3.00	2.75	92	90.50	93.60	2.80	1.25	45
32.60	35.70	2.95	2.75	93	93.60	96.60	3.00	2.15	72
35.70	38.70	2.90	1.30	45					
38.70	41.80	3.10	2.90	94					
41.80	44.80	3.10	2.20	71					
44.80	47.90	3.10	2.80	90					
47.90	50.90	3.00	2.45	82					
50.90	54.00	3.00	2.40	80					
54.00	57.00	3.00	2.00	67					
57.00	60.05	3.00	2.35	78					
60.05	63.10	3.00	2.20	73					
63.10	66.10	3.00	3.00	100					
66.10	69.20	3.00	2.30	77					
69.20	72.20	3.00	2.65	88					
72.20	75.30	3.00	2.10	70					
75.30	78.30	2.60	2.50	96					

**DIAMOND DRILL LOG  
GENERAL**

Hole No. JJ-91-11  
Page 1 of 1

COMPANY: Pacific Talc Limited  
PROPERTY: J & J Claims

HOLE NUMBER: JJ-91-11  
CLAIM GROUP: J & J  
NTS: \_\_\_\_\_

ZONE/SECTION: \_\_\_\_\_  
Easting: \_\_\_\_\_  
Northing: \_\_\_\_\_  
Elevation: \_\_\_\_\_  
Azimuth/Dip: \_\_\_\_\_

DRILLED BY: Blackhawk Diamond Drilling Ltd., Kamloops  
Core Size: NQ Interval 0 - 104.2  
Interval \_\_\_\_\_ - \_\_\_\_\_  
Started: Oct 5, 1991  
Finished: Oct 6, 1991  
Casing Left: None

LOGGED BY: Chris Baldys  
Started: Oct 17, 1991  
Finished: \_\_\_\_\_

Purpose/Comment: To change geologic reserves on surface from probable to proven category.  
\_\_\_\_\_  
\_\_\_\_\_  
\_\_\_\_\_

Measure:  Feet  Metres

DOWNHOLE SURVEY				
Metreage	Dip	AZIMUTH		Comment
		Observed	Corrected	
0	45°	-	225	NS
104.2	44°	S 23° W	224	SS

NS - Not Surveyed SS - Sperry Sun Single Shot

Assay For: % talc, magnesite, chlorite by XRD.  
\_\_\_\_\_  
\_\_\_\_\_  
\_\_\_\_\_  
\_\_\_\_\_

Assay By: Bacon Donaldson & Associates

**DIAMOND DRILL LOG**  
**LITHOLOGY**

CHRIS BALDYS  
OCTOBER, 1991

COMPANY: PACIFIC TALC LTD.

Hole No. JJ-91-11

PROPERTY: J & J CLAIMS

Page 1 of 4

<u>INTERVAL</u> FROM TO		<u>CODE</u> <u>LITHOLOGY</u>	<u>DESCRIPTION</u> (Lithology, Color, Comments, etc.)
0.0	7.0	OVB	OVERBURDEN (casing + broken talc core)
7.0	22.7	2	TALC-CARBONATE - light grey, slightly brown-yellowish zone of weakly oxidized talc-carbonate with patchy mosaical to roughly foliated texture, locally narrow fault breccias @ 13.2 - 13.3, 16.2 - 16.3.
22.7	24.2	C	CHLORITE - dark green massive to brown crumbly zone; starts as faulted off, oxidized to crumbly zone @ 22.7 - 23.2, inclusion of talc-carbonate @ 23.2 - 23.5 (contacts low angle?? to C/A - 0-5°), and massive @ 23.5 - 24.2
24.2	35.4	3	CARBONATE-TALC - grey to light grey zone of irregularly textured talc-carbonate (mosaical to roughly foliated often blurred stockwork-like [worm stringers] of calcite, locally poddy calcite up to 5 cm thick), competent core (35.4 m subjective contact marked by brown stain starting locally oxidized higher?? grade talc).
35.4	64.2	2	TALC-CARBONATE - light grey, greenish to grey-brownish zone of talc-carbonate with distinct brown iron stain zones coincident with fracturing, locally pure pale-greenish soapstone, minor chlorite throughout with narrow chlorite section @ 50.8 - 51.0, generally mosaical texture with grey-greenish talc prevailing, brown fracture zones @ 35.4 - 35.7, 41.5 - 41.7, 41.9 - 42.1, 45.7 - 46.0, 50.1 - 50.4.

DIAMOND DRILL LOG  
LITHOLOGY

CHRIS BALDYS  
OCTOBER, 1991

COMPANY: PACIFIC TALC LTD.

PROPERTY: I & J CLAIMS

Hole No. JJ-91-11

Page 2 of 4

<u>INTERVAL</u> FROM TO		<u>CODE</u> <u>LITHOLOGY</u>	<u>DESCRIPTION</u> (Lithology, Color, Comments, etc.)
64.2	65.0	C	CHLORITE - dark green, massive chlorite, weakly talcose, locally fractured zone.
65.0	67.6	2	TALC-CARBONATE - continuation of talc grade and texture as the zone overlying chlorite.
67.6	72.0	2(C)	TALC-CARBONATE-CHLORITE - dark grey-greenish zone with narrow massive chlorite sections @ 67.9 - 68.0, 68.5 - 68.7, 69.0 - 69.3, 69.5 - 69.7, 71.8 - 72.0, moderately broken s. sided core @ 45° to C/A.
72.0	77.5	1	TALC - light grey to pale green zone of soapy soft talc to locally carbonate mixed (2) grade shearing @ 72.0 - 73.9 talc gouge + broken soapstone, 74.3 - 74.8 talc gouge + broken soapstone, 76.2 - 77.5 broken + "fishscale" soapstone, lower contact with phyllite unusually sharp.
77.5	82.8	P	PHYLLITE - dark grey, well-foliated with minor poddy silica veins concordant to foliation and one 10 cm thick milky quartz vein normal to foliation @ 80.2 m, fairly competent core.
82.8	84.0	1(P,T)	TALC-PHYLLITE-TREMOLITE - weakly chloritic zone of intermittent pale-greyish talc, pale green tremolite and unaltered phyllite sections with gradual changes between them.

DIAMOND DRILL LOG  
LITHOLOGY

CHRIS BALDYS  
OCTOBER, 1991

COMPANY: PACIFIC TALC LTD.

PROPERTY: J & J CLAIMS

Hole No. JJ-91-11

Page 3 of 4

<u>INTERVAL</u> FROM TO		<u>CODE</u> <u>LITHOLOGY</u>	<u>DESCRIPTION</u> (Lithology, Color, Comments, etc.)
84.0	85.0	P	PHYLLITE - typical phyllite in competent core.
85.0	85.6	1(T)	TALC-TREMOLITE - two zones @ 85.0 - 85.3, grey to light grey talcose phyllite; 85.3 - 85.6, pale green tremolite.
85.6	87.8	P	PHYLLITE - dark grey to black graphitic phyllite highly broken (lost core) at lower contact.
87.8	88.3	C	CHLORITE - highly broken + fishscale sheared zone (lost core, rec. 10%).
88.3	92.6	1	TALC - grey greenish, soapy, soft with 60% of the material sheared to talc, shear zone @ 88.7 - 90.8 m, talc gouge @ 91.1 - 92.5, broken + minor gouge and fishscale soapstone, 10 - 20° to CIA???
92.6	97.5	2	TALC-CARBONATE - grey to light grey locally roughly foliated zone of typical talc-carbonate.
97.5	98.1	C	CHLORITE - dark green zone, highly broken (shear zone) + weakly talcose gouge.



**DIAMOND DRILL LOG  
ASSAY**

CHRIS BALDYS  
OCTOBER, 1991

COMPANY: PACIFIC TALC LTD.

PROPERTY: J & J CLAIMS

Hole No. JJ-91-11

Page 1 of 3

INTERVAL				SAMPLE NUMBER	ASSAYS			
FROM	TO	CORE WIDTH	CORE REC. %		% Talc	% Magnesite	% Chlorite	% Side/Anker
7.0	10.0	2.7	90	332109 H				
10.0	14.0	4.0	100	332110 H				
14.0	18.0	4.0	100	332111 H				
18.0	22.0	2.0	100	332112 H				
22.0	22.7	0.7	100	332113 H				
22.7	24.2	1.5	100	332114 H				
24.2	26.0	1.8	100	332115 H				
26.0	30.0	4.0	100	332116 H				
30.0	34.0	4.0	100	332117 H				
34.0	35.4	1.4	100	332118 H				
35.4	38.0	2.2	85	332119 H				
38.0	42.0	3.0	75	332120 H				
42.0	46.0	4.0	100	332121 H				
46.0	50.0	4.0	100	332122 H				

**DIAMOND DRILL LOG  
A S S A Y**

CHRIS BALDYS  
OCTOBER, 1991

COMPANY: PACIFIC TALC LTD.

PROPERTY: J & J CLAIMS

Hole No. JJ-91-11

Page 2 of 3

INTERVAL				SAMPLE NUMBER	A S S A Y S			
FROM	TO	CORE WIDTH	CORE REC. %		% Talc	% Magnesite	% Chlorite	% Side/Anker
50.0	54.0	4.0	100	332123 H				
54.0	58.0	4.0	100	332124 H				
58.0	62.0	4.0	100	332125 H				
62.0	64.2	2.2	100	332126 H				
64.2	65.0	0.8	100	332127 H				
65.0	66.0	1.0	100	332128 H				
66.0	67.6	1.6	100	332129 H				
67.6	70.0	2.4	100	332130 H				
70.00	72.0	2.0	100	332131 H				
72.0	74.0	1.5	75	332132 H				
74.0	77.5	3.2	91	332133 H				
77.5	78.0	0.5	100	332134 H				
78.0	82.0	3.9	98	332135 H				
82.0	82.8	0.8	100	332136 H				





CHRIS BALDYS  
OCTOBER, 1991

DIAMOND DRILL LOG  
R Q D

COMPANY: PACIFIC TALC LIMITED

Page 1 of 1

PROPERTY: J & J CLAIMS

Hole No. JJ-91-11

FROM	TO	TOTAL	MEAS.	%	FROM	TO	TOTAL	MEAS.	%
7.0	7.3	0.1	0	0	62.8	65.8	3.0	2.1	70
7.3	10.4	3.0	1.6	53	65.8	68.9	3.0	2.2	73
10.4	13.4	3.0	1.8	60	68.9	71.6	2.2	1.2	55
13.4	16.4	3.0	1.6	53	71.6	74.7	2.7	0.5	19
16.4	17.1	0.4	0.1	25	74.7	80.2	2.9	2.0	69
17.1	20.1	3.0	2.1	70	80.2	84.1	3.9	2.3	59
20.1	23.2	2.5	1.9	76	84.1	88.7	3.8	1.5	34
23.2	25.9	2.7	2.0	74	88.7	90.2	1.5	0	0
25.9	29.0	3.0	2.7	90	90.2	96.3	4.0	2.6	65
29.0	32.0	3.0	3.0	100	96.3	99.1	3.0	1.4	47
32.0	35.7	3.7	3.4	92	99.1	102.1	2.4	1.4	58
35.7	38.4	2.5	1.8	72	102.1	102.7	0.6	0.2	33
38.4	41.1	2.5	1.7	68	102.7	103.7	1.5	1.2	80
41.1	44.2	3.0	2.9	97					
44.2	47.2	3.0	2.2	73					
47.2	50.4	3.0	2.2	73					
50.4	53.5	3.0	2.7	90					
53.5	56.7	3.1	2.8	90					
56.7	59.7	3.0	2.9	97					
59.7	62.8	3.0	2.6	87					

**DIAMOND DRILL LOG  
GENERAL**

Hole No. JJ-91-13  
Page 1 of 1

COMPANY: PACIFIC TALC LIMITED  
PROPERTY: J & J CLAIMS

Measure:  Feet  Metres

HOLE NUMBER: JJ-91-13  
CLAIM GROUP: J & J  
NTS: \_\_\_\_\_

ZONE/SECTION: \_\_\_\_\_  
Easting: \_\_\_\_\_  
Northing: \_\_\_\_\_  
Elevation: \_\_\_\_\_  
Azimuth/Dip: \_\_\_\_\_

DRILLED BY: Blackhawk Diamond Drilling Ltd., Kamloops  
Core Size: NQ Interval 0 - 71.6  
Interval \_\_\_\_\_ - \_\_\_\_\_  
Started: Oct 11, 1991  
Finished: Oct 13, 1991  
Casing Left: 3 m

LOGGED BY: Chris Baldys  
Started: Oct 14, 1991  
Finished: \_\_\_\_\_

Purpose/Comment: To change geologic reserves on surface from probable to proven category.

DOWNHOLE SURVEY				
Metreage	Dip	AZIMUTH		
		Observed	Corrected	Comment
0	36°	-	36°	NS
71.6	53.5	N 15° E	36	SS

NS - Not Surveyed SS - Sperry Sun Single Shot

Assay For: % talc, magnestie, chlorite by XRD  
\_\_\_\_\_  
\_\_\_\_\_  
\_\_\_\_\_  
\_\_\_\_\_

Assay By: Bacon, Donaldson and Associates

**DIAMOND DRILL LOG  
LITHOLOGY**

CHRIS BALDYS  
OCTOBER, 1991

COMPANY: PACIFIC TALC LTD.

Hole No. JJ-91-13

PROPERTY: J & J CLAIMS

Page 1 of 2

INTERVAL FROM TO		CODE LITHOLOGY	DESCRIPTION (Lithology, Color, Comments, etc.)
0.0	6.1	OVB	OVERBURDEN (casing)
6.1	7.3	C	CHLORITE - highly chloritized foliated Phyllite with ≈ 30% biotite, no talc.
7.3	12.9	2(C)	TALC-CARBONATE-CHLORITE - grey to locally dark green zone of patchy, mosaical talc carbonate locally grading to (1) with narrow chloritic zones of massive dark green talcose chlorite: @ 7.6 - 8.0 m, 12.6 - 12.9 m.
12.9	25.1	2	TALC-CARBONATE - grey to light grey talc-carbonate with patchy-mosaical texture and rough foliation-bedding locally poddy calcite veins up to 5 cm thick @ 19.3 m and @ 20.7 m, generally competent core with s. siding @ 19.2 m.
25.1	27.6	C	CHLORITE - dark green zone of massive chlorite with a calcite podd @ 26.5, competent core.
27.6	69.0	2	TALC-CARBONATE - grey to light grey zone, uniformly textured, paichy-mosaical to locally "granular" talc-carbonate, some distinct layered-like fabric at 5 - 20° to CIA in the upper part @ 27.6 - 34.4 often coincidental with s. siding/fracturing shearing common throughout, @ 19.0 - 19.5 (gouge + lost core), 31.7 - 32.9 (fracture zone + s. siding @ 10 - 20° to CIA); 51.1 - 51.6, ground up rock - fault breccia; 52.5 - 53.0, ground up rock - fault breccia; 57.7 - 58.9, fracture zone; 61.2 - 61.7,



**DIAMOND DRILL LOG  
ASSAY**

CHRIS BALDYS  
OCTOBER, 1991

COMPANY: PACIFIC TALC LTD.

PROPERTY: J & J CLAIMS

Hole No. JJ-91-13

Page 1 of 2

INTERVAL				SAMPLE NUMBER	ASSAYS			
FROM	TO	CORE WIDTH	CORE REC. %		% Talc	% Magnesite	% Chlorite	% Side/Anker
6.1	7.3			332459 H				
7.3	10.0			332460 H				
10.0	12.9			332461 H				
12.9	14.0			332462 H				
14.0	18.0			332463 H				
18.0	22.0			332464 H				
22.0	25.1			332465 H				
25.1	26.0			332466 H				
26.0	27.6			332467 H				
27.6	30.0			332468 H				
30.0	34.0			332469 H				
34.0	38.0			332470 H				
38.0	42.0			332471 H				
42.0	46.0			332472 H				



CHRIS BALDYS  
OCTOBER, 1991

**DIAMOND DRILL LOG  
R Q D**

COMPANY: PACIFIC TALC LIMITED  
PROPERTY: J & J CLAIMS

Page 1 of 1  
Hole No. JJ-91-13

FROM	TO	TOTAL	MEAS.	%	FROM	TO	TOTAL	MEAS.	%
6.1	7.6	0.9	0.2	22	62.2	65.3	3.0	2.0	67
7.6	10.7	2.8	1.6	57	65.3	68.6	3.0	1.2	40
10.7	13.7	3.0	2.5	83	68.6	71.6	3.0	2.6	87
13.7	16.8	3.0	2.8	93					
16.8	19.4	2.0	1.4	70					
19.4	22.4	3.0	2.5	83					
22.4	25.5	3.0	2.9	97					
25.5	28.6	3.0	2.9	97					
28.6	31.7	3.0	2.6	87					
31.7	33.2	2.4	0.5	21					
33.2	35.4	1.8	1.4	78					
35.4	38.1	2.9	2.3	79					
38.1	41.2	2.9	2.6	90					
41.2	44.2	3.0	3.0	100					
44.2	47.2	3.0	2.9	97					
47.2	50.3	3.0	2.9	97					
50.3	53.0	2.2	0.9	41					
53.0	56.1	3.0	2.1	70					
56.1	59.4	3.0	1.3	43					
59.4	62.2	2.8	1.6	57					



**DIAMOND DRILL LOG  
GENERAL**

Hole No. JJ-91-12  
Page 1 of 1

COMPANY: PACIFIC TALC LIMITED  
PROPERTY: J & J CLAIMS

Measure:  Feet  Metres

HOLE NUMBER: JJ-91-06  
CLAIM GROUP: J & J  
NTS: \_\_\_\_\_

ZONE/SECTION: \_\_\_\_\_  
Easting: \_\_\_\_\_  
Northing: \_\_\_\_\_  
Elevation: \_\_\_\_\_  
Azimuth/Dip: \_\_\_\_\_

DRILLED BY: Blackhawk Diamond Drilling Ltd., Kamloops  
Core Size: NQ Interval 0 - 114.6  
Interval \_\_\_\_\_ - \_\_\_\_\_  
Started: Oct 7, 1991  
Finished: Oct 9, 1991  
Casing Left: None

LOGGED BY: Chris Baldys  
Started: Oct 19, 1991  
Finished: Oct 19, 1991

Purpose/Comment: To change geologic reserves on surface from probable to proven category.

DOWNHOLE SURVEY				
Metreage	Dip	AZIMUTH		Comment
		Observed	Corrected	
0	45°	-	225°	NS
114.6	45	?	225	?

NS - Not Surveyed SS - Sperry Sun Single Shot

Assay For: % talc, magnesite, chlorite by XRD.  
\_\_\_\_\_  
\_\_\_\_\_  
\_\_\_\_\_  
\_\_\_\_\_

Assay By: Bacon, Donaldson and Associates

**DIAMOND DRILL LOG  
LITHOLOGY**

**CHRIS BALDYS  
OCTOBER, 1991**

**COMPANY: PACIFIC TALC LTD.**

**PROPERTY: J & J CLAIMS**

**Hole No. JJ-91-12**

**Page 1 of 3**

<i>INTERVAL FROM TO</i>		<i>CODE LITHOLOGY</i>	<i>DESCRIPTION (Lithology, Color, Comments, etc.)</i>
0.0	4.3	OVB	OVERBURDEN
4.3	46.6	P	PHYLLITE - unusual, highly altered varieties: @ 4.3 - 10.8, dark to black foliated, chloritized at lower section. 2(C) @ 10.8 - 14.8, pale-greenish, extremely altered talc + chlorite (approx. 40% talc); @ 14.8 - 20.3, brown to dark green, strongly biotitized with chlorite increasing downhole. (C) @ 20.3 - 23.0, pale green to dark green ± brown, strongly chloritized + some biotite a. talc; @ 23.0 - 31.2, dark grey to dark green/brown, strongly biotitized and graphitic locally in @ 25.7 - 27.5 zone; @ 31.2 - 36.4, typical dark grey strongly folded; @ 36.4 - 39.1, brown extremely biotitized, crumbly; @ 39.1 - 44.8, dark grey to dark green locally biotitized or chloritized; @ 44.8 - 46.6, brown to dark greenish, strongly biotitized, some chlorite at lower part; shear zones @ 11.8 - 13.4, strongly broken talcose zone and @ 20.3 - 22.0, shear with gouge sections.
46.6	48.2	C	CHLORITE - contact + alteration zone between phyllite and talc, dark green broken zone = 10 - 20% talc.
48.2	50.6	I	TALC - pale greenish to brownish @ 49.5 - 49.9 (gouge) soapy to compact talcy clay in shear zone? section.

**DIAMOND DRILL LOG  
LITHOLOGY**

CHRIS BALDYS  
OCTOBER, 1991

COMPANY: PACIFIC TALC LTD.

Hole No. JJ-91-12

PROPERTY: J & J CLAIMS

Page 2 of 3

<u>INTERVAL</u> FROM TO		<u>CORE</u> LITHOLOGY	<u>DESCRIPTION</u> (Lithology, Color, Comments, etc.)
50.6	55.2	C	CHLORITE - dark greenish massive zone in competent core weakly talcose 5 - 10%?, foliation texture "wiped out", fissility along polished s. side planes.
55.2	89.5	2	TALC-CARBONATE - uniform grade + texture in light grey to grey locally brown stained zone of (2) or 2(C) material?, common dark green chlorite intermixed with talc at lower contact, brown stain possibly due to minor sulphides (pyrrhothite?) locally coating s. side planes and being oxidized at fracture zones deeply penetrating the talc zone, dominating texture: roughly foliated with direction marked by stringers and smeared patches of carbonates, minor weak shears @ 71.1 - 71.3, 75.4 - 75.9; brown stained fracture zones.
89.5	90.0	C	CHLORITE - 2(C) intermixed with some dark green massive chlorite.
90.0	92.0	1(C)	TALC - pale greenish, soapy zone, fairly broken with minor chlorite.
92.0	98.4	C	CHLORITE - variable dark green to dark grey (locally pale green, soapy) zone of chloritized to unaltered phyllite with a narrow talc zone @ 89.9 - 90.1 coincident with strong fracturing.

DIAMOND DRILL LOG  
LITHOLOGY

CHRIS BALDYS  
OCTOBER, 1991

COMPANY: PACIFIC TALC LTD.

PROPERTY: J & J CLAIMS

Hole No. JJ-91-12

Page 3 of 3

INTERVAL FROM TO		CODE LITHOLOGY	DESCRIPTION (Lithology, Color, Comments, etc.)
98.4	104.5	P	PHYLLITE - dark grey, locally chloritic - greenish and pale greenish (talcy), but generally typical foliated with shear zone @ 104.0 - 104.3, talc gouge in slip zone.
104.5	106.0	T(1)	TREMOLITE-TALC - pale to apple green zone with approximately 15 - 20% talc.
106.0	107.7	P	PHYLLITE - dark grey to black with strong fracturing in narrow lower contact zone 107.5 - 107.7.
107.7	108.9	T(1)	TREMOLITE-TALC - pale to apple green zone with approximately 15 - 20% talc.
108.9	114.6	P	PHYLLITE - dark grey to black foliated @ 45° to CIA in competent core.
		EOH	

**DIAMOND DRILL LOG  
A S S A Y**

CHRIS BALDYS  
OCTOBER, 1991

COMPANY: PACIFIC TALC LTD.

PROPERTY: J & J CLAIMS

Hole No. JJ-91-12

Page 1 of 2

INTERVAL				SAMPLE NUMBER	A S S A Y S			
FROM	TO	CORE WIDTH	CORE REC. %		% Talc	% Magnesite	% Chlorite	% Side/Anker
46.6	48.2	1.6	100	332401 H				
48.2	50.0	1.6	89	332402 H				
50.0	50.6	0.5	83	332403 H				
50.6	54.0	3.3	97	332404 H				
54.0	55.2	1.2	100	332405 H				
55.2	58.0	2.6	93	332406 H				
58.0	62.0	4.0	100	332407 H				
62.0	66.0	4.0	100	332408 H				
66.0	70.0	4.0	100	332409 H				
70.0	74.0	4.0	100	332410 H				
74.0	78.0	4.0	100	332411 H				
78.0	82.0	4.0	100	332412 H				
82.0	86.0	4.0	100	332413 H				
86.0	89.5	3.5	100	332414 H				



CHRIS BALDYS  
OCTOBER, 1991

<b>DIAMOND DRILL LOG</b> <b>R Q D</b>
--

COMPANY: PACIFIC TALC LIMITED

PROPERTY: J & J CLAIMS

Page 1 of 1

Hole No. JJ-91-12

FROM	TO	TOTAL	MEAS.	%	FROM	TO	TOTAL	MEAS.	%
4.3	7.9	0.7	0	0	56.7	59.7	3.0	2.9	97
7.9	10.4	1.1	0.3	27	59.7	62.8	3.0	2.8	93
10.4	13.4	1.2	0.3	25	62.8	65.8	2.8	2.5	89
13.4	14.9	1.2	0.35	29	65.8	68.9	3.0	2.3	77
14.9	17.1	1.9	0.55	29	68.9	71.9	3.0	2.4	80
17.1	20.1	2.5	0.95	38	71.9	75.0	3.0	2.3	77
20.1	23.2	2.5	0.6	24	75.0	78.0	3.0	2.2	73
23.2	25.3	2.1	1.1	52	78.0	81.1	3.0	2.7	90
25.3	28.4	3.1	1.6	52	81.1	84.1	2.9	2.7	93
28.4	31.2	2.7	1.1	41	84.1	87.2	2.8	2.6	93
31.2	34.3	3.1	2.6	84	87.2	90.2	3.0	1.8	60
34.3	37.3	3.0	3.0	100	90.2	93.3	2.7	0.7	26
37.3	38.4	1.1	0	0	93.3	99.4	3.0	1.4	47
38.4	41.5	3.1	1.4	45	99.4	102.4	3.0	1.9	63
41.5	43.6	1.8	0.9	50	102.4	105.5	2.7	1.6	59
43.6	45.1	1.4	0.9	64	105.5	108.5	2.6	2.1	81
45.1	47.2	1.9	0.7	37	108.5	111.6	3.0	2.8	93
47.2	50.6	2.9	1.6	55	111.6	114.6	3.0	2.9	97
50.6	53.6	3.0	1.7	57					
53.6	56.7	2.9	1.8	62					

**APPENDIX II**  
**STATEMENT OF QUALIFICATIONS**



## STATEMENT OF QUALIFICATIONS

I, NEIL VICTOR FROC, of 45170 Redwood Avenue, Sardis, British Columbia, do hereby certify that:

I am a graduate of the University of Saskatchewan with a Bachelor of Engineering Degree in Geology, 1986.

I am a graduate of the Northern Alberta Institute of Technology, Edmonton, Alberta with a diploma in Mineral Resources, 1981.

Prior to 1986, I was actively employed in mineral exploration in British Columbia, Saskatchewan and Arizona. One year was not spent in mineral exploration as employment was as a senior engineering technician (geotechnical).

Since 1986 I have been actively employed in mineral exploration and mine evaluation in British Columbia.

I am a Professional Engineer registered in the Province of British Columbia (APEBC).

I am a Geological Engineer.

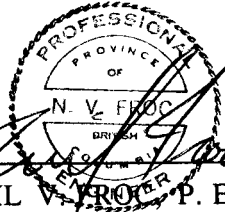

The seal is circular with a double-line border. The outer ring contains the text "PROFESSIONAL ENGINEER" at the top and "PROVINCE OF BRITISH COLUMBIA" at the bottom. The center of the seal contains the name "N. V. FROC" and the title "P. Eng." below it. A handwritten signature in black ink is written across the seal, overlapping the text.

NEIL V. FROC P. Eng.

**APPENDIX III**  
**STATEMENT OF COSTS**

## STATEMENT OF COSTS

### 1.0 FIRST PROGRAM (June 17 - 26, 1991)

#### Salaries:

N. Froc (Geological Engineer)	235 hrs @ \$65.50/hr	\$15,392.50
Secretarial	15 hrs @ \$25.00/hr	375.00

#### Drilling

Blackhawk Diamond Drilling Inc. As per invoice (3 man crew)		31,698.16
--	--	-----------

Transportation/Accommodation/Meals		1,245.60
------------------------------------	--	----------

Misc. Expenses		<u>48.00</u>
----------------	--	--------------

<b>FIRST PROGRAM TOTAL</b>		<b><u>\$48,759.26</u></b>
----------------------------	--	---------------------------

### 2.0 SECOND PROGRAM (Sep 18 - Oct 16, 1991)

#### Salaries:

N. Froc (Geological Engineer)	281 hrs @ \$65.50/hr	\$18,405.50
C. Baldys (Senior Geologist)	88 hrs @ \$55.00/hr	4,840.00
Secretarial	29 hrs @ \$25.00/hr	725.00

#### Drilling

Blackhawk Diamond Drilling Inc. As per invoice (3 man crew)		63,792.46
--	--	-----------

#### Surveying

Turnbridge & Turnbridge		1,364.25
-------------------------	--	----------

Transportation/Accommodation/Meals		2,904.81
------------------------------------	--	----------

Misc. Expenses		<u>135.33</u>
----------------	--	---------------

<b>SECOND PROGRAM TOTAL</b>		<b><u>\$92,167.35</u></b>
-----------------------------	--	---------------------------

3.0 REPORT PREPARATION \$1,500.00

SUMMARY

FIRST PROGRAM TOTAL	\$48,759.26
SECOND PROGRAM TOTAL	92,167.35
REPORT PREPARATION	<u>1,500.00</u>
<b>TOTAL COST</b>	<b><u>\$142,426.61</u></b>