

LOG NO:	SEP 30 1992	RD.
ACTION:		
FILE NO:		

1991 - 92 ASSESSMENT REPORT

Including

1991 GEO-CHEM RESULTS and

TRENCHING RESULTS

THE AB MINERAL GROUP CLAIMS

THE GOLDEN MINING DIVISION, GOLDEN, B.C.

NTS MAP: M82K/15W

Lat. 50 Deg. 55 Min.

Long. 116 Deg. 55 Min.

for

James S. Adamson, and Sodi Berar, (Operators)

James S. Adamson, and Sodi Berar, of Calgary,
Alberta, owners of the AB Group.

Report prepared by-

Bruce H. van der Lee, P. Eng. Sept. 12, 1991.

**GEOLOGICAL BRANCH
ASSESSMENT REPORT**

22,525

TABLE OF CONTENTS

<u>PROPERTY</u>	<u>1</u>
<u>LOCATION AND ACCESS</u>	<u>1</u>
<u>ECONOMIC GEOLOGY</u>	<u>1</u>
<u>GEOLOGY</u>	<u>2</u>
<u>INTRODUCTION</u>	<u>2</u>
<u>GEO-CHEMICAL REPORT</u>	<u>3</u>
<u>TRENCHING REPORT</u>	<u>3</u>
<u>CONCLUSIONS AND RECOMMENDATIONS</u>	<u>4</u>
<u>SUMMARY</u>	<u>6</u>
<u>CERTIFICATE</u>	<u>7</u>
<u>STATEMENT OF COSTS</u>	<u>8</u>

INCLUSIONS :

INDEX MAP, ASSAY REPORTS, CLAIM LOCATION MAP, GEO-CHEM AND TRENCHING MAP, AND GEOLOGICAL MAP.

PROPERTY

The property consists of one unpatented mineral claim of 8 units, and 5 one unit claims, for a total of 13 units.

It is known as the AB Mineral Group.

The AB Mineral Group is owned by James S. Adamson of Calgary, and Sodi Berar of Calgary.

LOCATION AND ACCESS

The AB Mineral Group is located on both sides of Crystalline Creek, south of the junction of Crystalline and Vowell Creeks.

The claim area is 56km south west of Parsons, B.C., and can be reached by a forestry road.

The property lies in the valley of Vowell Creek, and on the west slope of the valley at elevations from 1300m to 1800m. Most of the units are accessible by four wheel drive vehicles over existing logging trails. Some of the claim area has been logged, and new road construction on the claims suggests further logging in the near future.

ECONOMIC GEOLOGY

Recent road construction has exposed mineralization which appears to establish the continuity of mineralization with that of the Columbia River mines property to the NW which produced and shipped lead-silver concentrates during the 1970's.

GEOLOGY

The Claim Group is in the Purcel Range, which was mapped by J.E. Reesor, (G.S.C.) Map 12, 1957, (Lardeau Half).

The area is underlain by rock of the Horsethief Creek Series, which consist of argillite, quartzite, pebble conglomerate, and limestone of the late precambrian age. The mineralization appears to have come from a large stock of granodiorite of the mesozoic age which lies to the southeast. There are several folds in the area which dip at approximately 25 degrees. Columbia River Mines occurs in such a synclinal fold within a limestone band.

The AB claims have few outcroppings because the heavy overburden near the valley floor makes detailed surface geology of the claims very difficult.

INTRODUCTION

The work done this season was a follow up of last years work to determine the widths of the exposed mineral zones and to sample across each of them for their mineral content. The erosion of the (new) road banks (which in some places are 5 to 9m high) is considerable and much hand trenching was necessary to expose the extent of some of the showings. Geo-Chem lines were also run above some of the mineral exposures to see if the zones are following the established NW to SE trend.

GEO-CHEM REPORT

A Selective Geo-chem survey was carried out on July 29 and July 30, 1992, to acquire more information as to the mineral content and the widths of each zone that was located last season. Samples were taken across various zones and above the exposures as shown on Map # AB-4-92.

All samples were taken from the -B- zone, and were placed in Geo-Chem bags, which were marked and tied at the sample location. The samples were taken at 10 or 20 meter intervals on claim location lines measured from the I.P.

All samples were assayed by Loring Laboratories Ltd., Calgary, Alberta. A 80 mesh was used with all samples, and the analysis was done by hot acid digestion and atomic absorption spectroscopy. The sampling was done by Jim Adamson, and Jamie Van der Lee, both of Calgary. All samples were paid for by James Adamson and Sodi Berar.

All the samples were assayed for Cu, Pb, and Zn. Some were further assayed for Mn.

TRENCHING

A new road was constructed over the winter (1990 - 91) by the forestry on the AB Group Claims. The road banks are 5 to 9m high in some locations and are still quite unstable. Sections of rubble have slipped down to cover some of the newly exposed gossans and mineralized rock. A considerable amount of hand trenching was necessary to expose these gossans which are indicated on Map # AB-4-92. Mineralization was exposed at a

number of locations, and samples were assayed for Cu, Pb, Zn, and Mn. The results are included in the assay section of this report.

CONCLUSIONS AND RECOMMENDATIONS

The 1991-92 season was a more detailed examination of the mineral locations found in 1990-91. A study was made of a geo-chem survey done by previous owners of most properties in the area and it became evident that a manganese marker extends from the Columbia River Mines property on a SE trend, through the Mine Quest property, the AB property, and then the VAD property to the SE, over a distance of 8 km. To the west of this marker commercial mineralization has been found on the Columbia River Mines property. Good mineralization to the west of this marker has also been found on the Mine Quest property, and the VAD property to the SE. However on the AB property the mineral zones seem to be occurring to the east of this marker. This could indicate that another anomaly may be found to the west above the present mineralization.

An effort was made to find the Mn marker to the SE of the 510 exposure at the north end of the AB property. 450m to the SE we found another exposure of Mn at sample locations Cor 141 to 144. It is interesting to note the strong zinc values that are in evidence from the B 508 to the 513 sample location as well as at the B 178 location.

An attempt to locate mineralization to the west of the

Mn showings on the AB claims should be made as this would considerably broaden the present mineral trend. Some fill-in Geo-Chem between the two Mn showings and beyond to the north end of the property may find even better mineral occurrences for future drill targets.

SUMMARY

A more detailed study of the mineralized areas found during the 1990-91 season was carried out on July 29 - 30, 1992. Three men took samples and trenched through rubble where necessary along the high unstable road banks to expose the mineralization. Geo-Chem lines above the road were run at some gossen locations to determine whether the mineral zone was following the established SE trend. Carefull inspection and some trenching helped to locate an extension of the Mn marker (found at the 508 sample location), southeasterly 450m, to the - Cor 141m -144m locations on the lower road as shown on Map AB #4-92.

C E R T I F I C A T E

This is to certify that I, Bruce H. van der Lee :

1. Am a resident of Calgary, Alberta, and live at #1100, 1122 - 4th Street, S.W., Calgary, Alberta. T2R 1M1
2. Am a graduate of the University of Alberta, B. Sc. in Mining Eng. (1979)
3. Have no interest direct or indirect in the properties known as the AB Mineral Group Claims.
4. Have authorized this report after examination of the field data and the G.S.C. reports pertaining to the area.

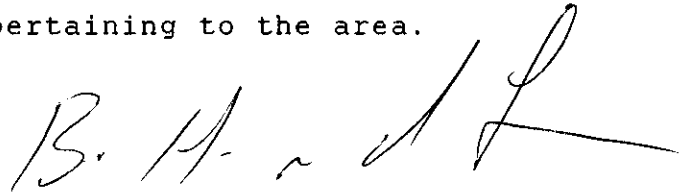
A handwritten signature in black ink, appearing to read 'B. H. van der Lee', with a long horizontal stroke extending to the right.

Bruce H. van der Lee, P. Eng.

STATEMENT OF COSTS

Geo-Chem and rock assays	455.00
Labor: Geo-chem & hand trenching- 3 men - 2 days @ 80.00 per day	480.00
Board: @ 110.00 - 6 man days	110.00
Geo-chem bags and supplies-	50.00
4x4 - @ 40.00 per day - 2 days	80.00
Chain Saw @ 8.00 per day - 3 days	24.00
Travel in B.C. - 60.00	60.00
Preparing Report and maps	300.00
	<hr/>
Total Costs.....	1559.00

M82K 15W

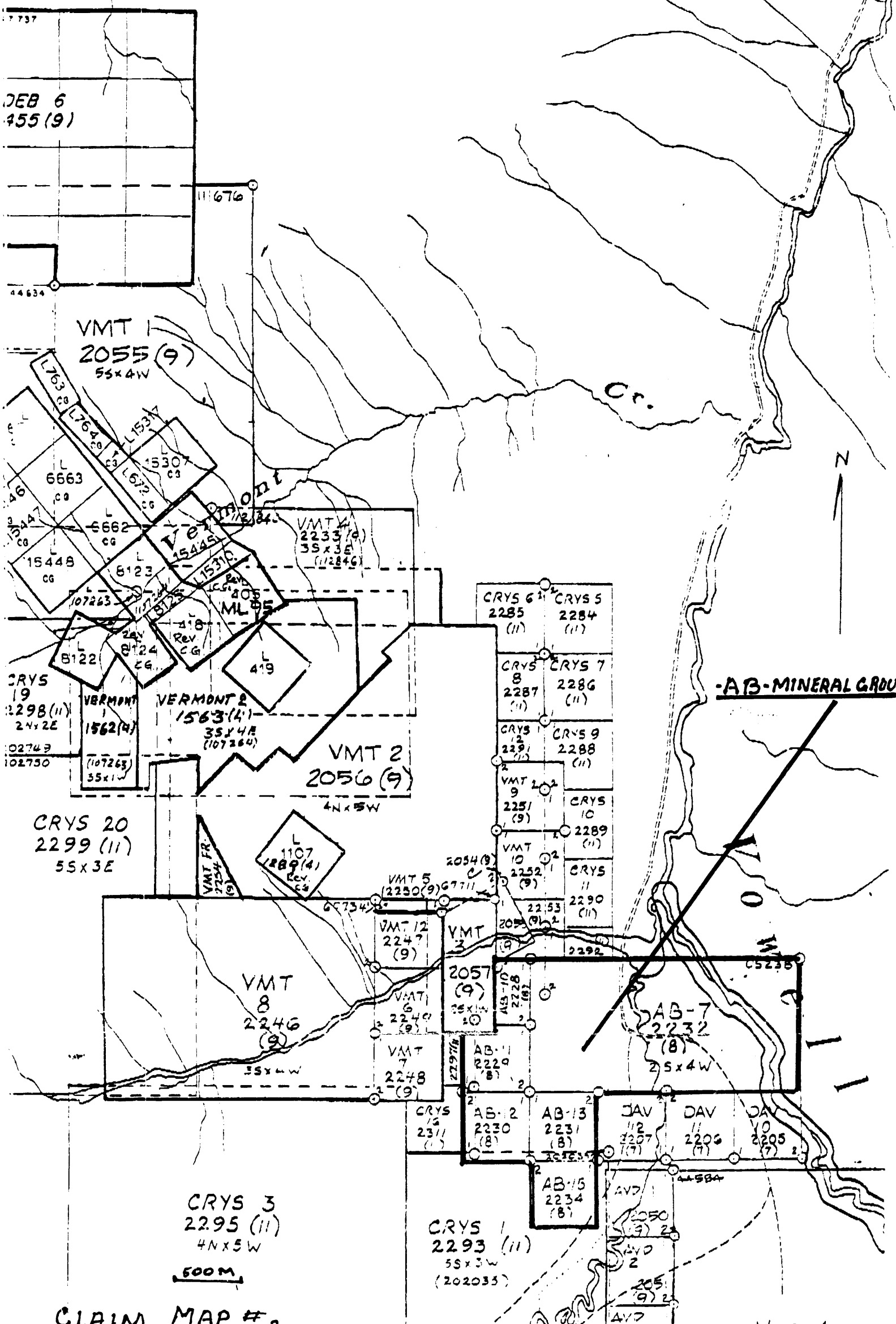

-AB-MINERAL GROU

CLAIM MAP # 2

VA2-1

117°00'
51°00'

MB2K/15W

MB2K/151

VERMONT CREEK

54 KM TO PARSONS B.C.

YOWELL CREEK

==== NEW FORESTRY ROAD

CRYSTAL CREEK

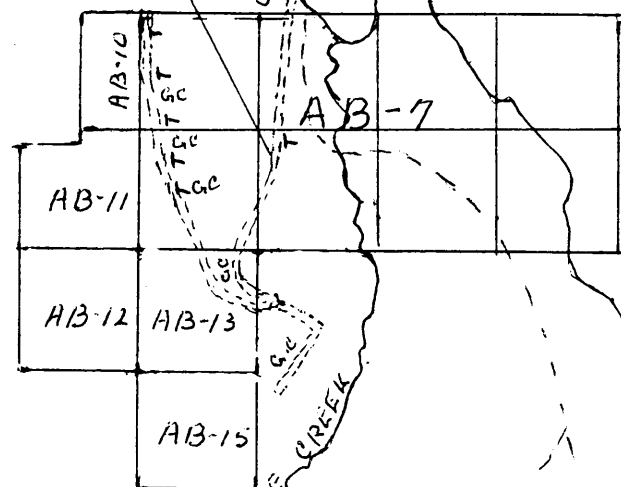

CRYSTALLINE CREEK

1991-92
INDEX MAP # 1
AB CLIMIX
Geo-chem = G.C
TRENCH = T

500 M

117°00'

GEOLOGICAL MAP # 3 45'

4000M

AB GROUP CLAIMS

1°00'



To: A & B RESOURCES,
539 - 47th Avenue S.W.,
Calgary, Alberta T2J 1C5

 ATTN: Jim Adamson

File No. 35292
 Date August 12, 1992
 Samples Soil



Certificate of Assay LORING LABORATORIES LTD.

Page # 1

SAMPLE NO.	PPM Cu	PPM Pb	PPM Zn	PPM Mn
Geochemical Analysis				
S 0 Above Road	17	31	56	-
S 10 Above Road	28	32	69	-
S 20 Above Road	20	23	83	-
S 30 Above Road	18	33	97	-
S 40 Above Road	19	27	36	-
S 50 Above Road	23	26	69	-
S 60 Above Road	26	22	53	-
S 70 Above Road	28	24	75	-
S 80 Above Road	22	25	83	-
S 90 Above Road	21	34	51	-
S 100 Above Road	18	26	58	-
B 480 Above Road	57	61	209	553
B 490 Above Road	59	123	640	9160
B 500 Above Road	29	110	78	215
B 510 Above Road	32	124	84	182
B 515 Above Road	44	27	75	253
B 520 Above Road	41	49	78	214
B 525 Above Road	36	62	81	236
B 530 Above Road	41	27	82	260
B 535 Above Road	31	31	71	234
B 540 Above Road	52	44	87	286

I Hereby Certify that the above results are those
 assays made by me upon the herein described samples....

Subjects retained one month.
 Samples retained one month
 unless specific arrangements
 are made in advance.



 Assayer

To: A & B RESOURCES,
539 - 47th Avenue S.W.,
Calgary, Alberta T2J 1C5

 ATTN: Jim Adamson

File No. 35292
 Date August 12, 1992
 Samples Rock



Certificate of Assay LORING LABORATORIES LTD.

Page # 2

SAMPLE NO.	PPM Cu	PPM Pb	PPM Zn	PPM Mn
Geochemical Analysis				
B 154 Base	56	31	63	-
B 158 Base	49	30	67	-
B 162 Base	41	72	166	-
B 166 Base	52	49	129	-
B 168 Base	41	85	141	-
B 170 Base	31	114	27	-
B 174 Base	60	59	119	-
B 178 Base	47	72	165	-
B 182 Base	49	157	234	-
B 182 Base	41	56	134	-
B 186 Base	64	294	419	-
B 186 Base	38	20	140	-
B 190 Base	45	36	164	-
B 150 Base	29	27	34	-
B 154 Base	47	84	129	-
B 158 Base	50	69	203	-
B 162 Base	49	86	205	-
B 166 Base	49	26	61	-
B 170 Base	48	51	132	-
B 174 Base	49	72	165	-
B 328 Base	89	19	45	-
B 504 Base	36	45	115	-
B 508 Base	795	4780	2020	-
B 510 Base	27	133	1260	-
B 513 Base Black	18	103	2780	-
A 23M Bank	55	431	190	-
A 28 M Bank	59	136	216	-
A 32 M Bank	21	46	111	-
A 36 M Bank	212	+10000	345	-
A 40 M Bank	38	70	313	-

I Hereby Certify that the above results are those
 assays made by me upon the herein described samples....

Reagents retained one month.
 Samples retained one month
 unless specific arrangements
 are made in advance.



 Assayer

To: A & B RESOURCES,

539 - 47th Avenue S.W.,

Calgary, Alberta T2J 1C5

ATTN: Jim Adamson

File No. 35292

Date August 12, 1992

Samples Rock



Certificate of Assay LORING LABORATORIES LTD.

Page # 3

SAMPLE NO.	PPM Cu	PPM Pb	PPM Zn	PPM Mn
A 44 M Bank	33	92	143	-
A 48 M Bank	42	56	131	-
A 52 M Bank	41	121	168	-
Cor 141 Bank (A)	25	56	28	1136
Cor 141 Bank (B)	18	107	26	845
Cor 142 Bank	127	115	77	9280
Cor 143 Bank	59	58	69	+10000
Cor 144 Bank	69	73	63	758
75 M.N. Main Quartz & Y in Road	52	+10000	31	-

I Hereby Certify that the above results are those
assays made by me upon the herein described samples....

Rejects retained one month.
Slips retained one month
unless specific arrangements
are made in advance.

Assayer

To: A & B RESOURCES,
539 - 47th Avenue S.W.,
Calgary, Alberta T2J 1C5

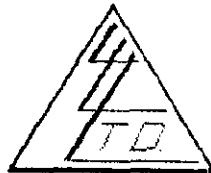

File No. 35292-1
Date September 22, 1992
Samples Pulp

ATTN: Jim Adamson

Certificate of Assay LORING LABORATORIES LTD.

SAMPLE NO.

PPM
Mn

Geochemical Analysis

B-178	665
B-182	2875
B-186	320
B-504	1750
B-508	5275
B-513	90000
B-510 Soil	185

I Hereby Certify that the above results are those assays made by me upon the herein described samples....

Rejects retained one month.
Copies retained one month
Unless specific arrangements
are made in advance.

Assayer

AB-10

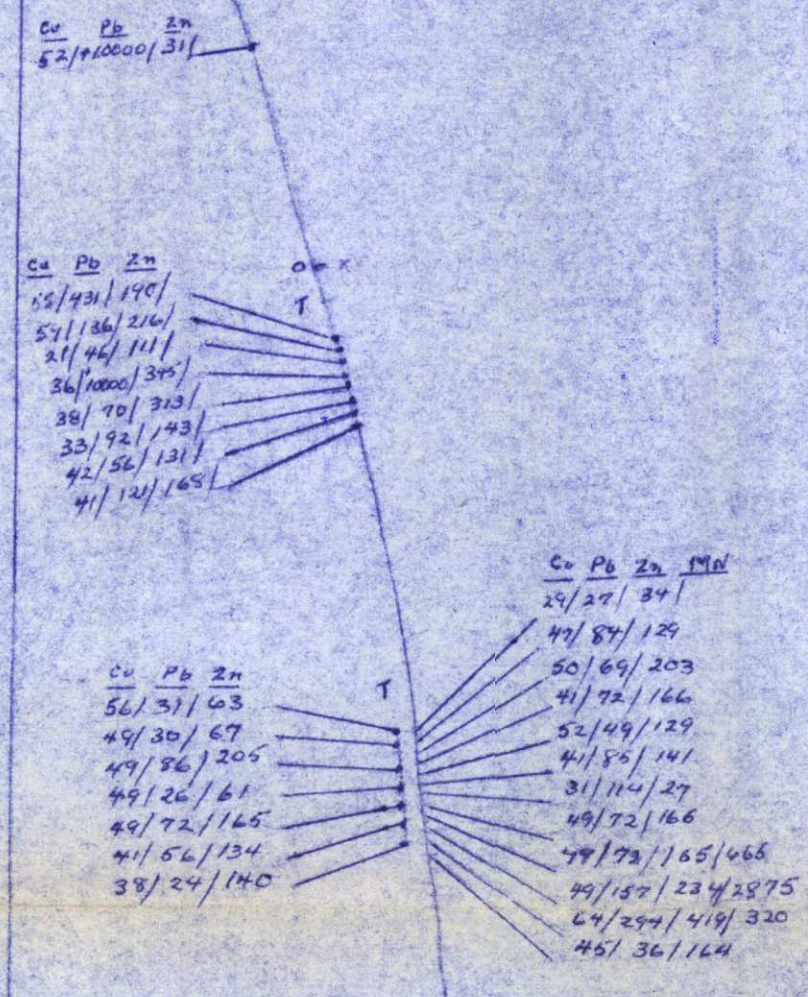

AB-7

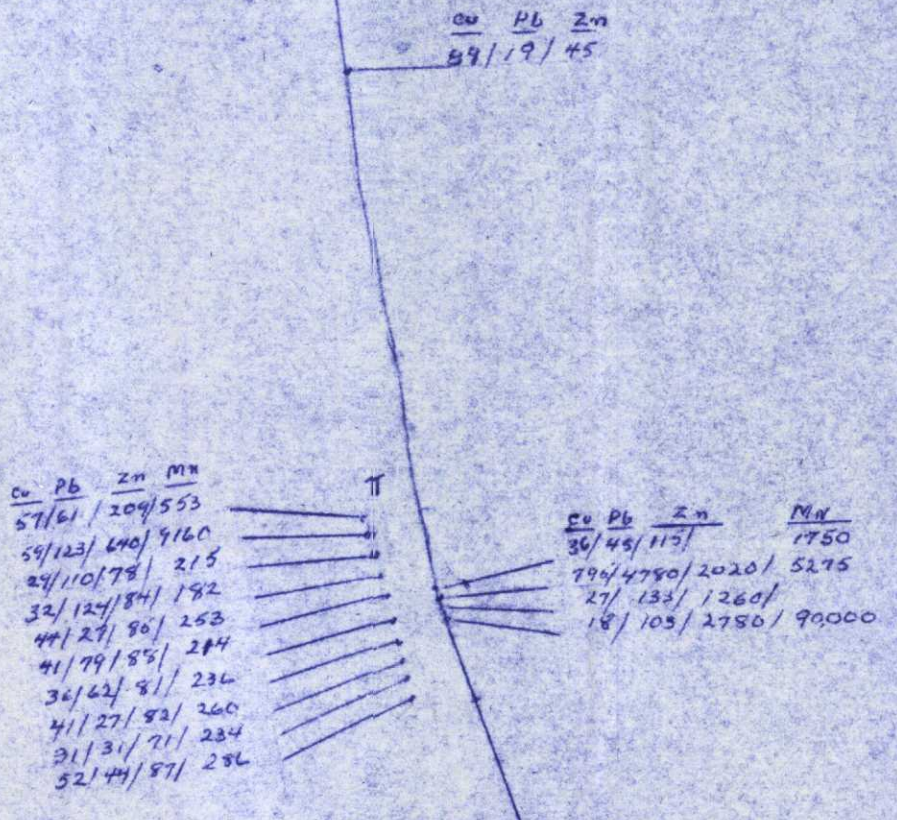

AB-11

AB-12

AB-13

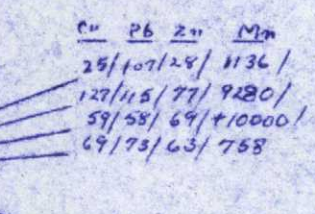

GEOLOGICAL BRANCH ASSESSMENT REPORT

22,526
5

100m



1971-72 GEO-CHEM EXPLORATION SURVEY
 AB-MINERAL GROUP CLAIMS
 HAND-TRENCHING = T. READINGS - Cu-Pb-Zn
 Map No. - AB-4-92