

22840

NIZI

GEOLOGICAL MAPS

DIAMOND DRILL SECTIONS

GOLD FIELDS CANADIAN MINING
LIMITED

March, 1993

LEGEND

JURASSIC and/or CRETACEOUS

- 10 Ultra Mafic Intrusives
 - 10 Unsubdivided
 - 10a Peridotite
 - 10b Pyroxenite
 - 10c Serpentinite
 - 10d Listwanite (calc-silicate alteration)
- 9 Felsic Intrusives
 - 9 Unsubdivided
 - 9a Granodiorite
 - 9b Leucocratic granodiorite / quartz monzonite
 - 9c Granodiorite / quartz diorite / diorite
 - 9d Porphyritic granodiorite
 - 9e Very fine grained leucocratic felsite
- 8 Mafic Intrusives
 - 8 Unsubdivided
 - 8a Diorite
 - 8b Diorite / Gabbro
 - 8c Porphyritic diorite / gabbro
 - 8d Gabbro dike
- 7 Porphyritic Subvolcanic Rocks
 - 7 Unsubdivided
 - 7a Massive "Pristine" Quartz-Feldspar Porphyry
 - 7b Massive Feldspar Porphyry

DEVONIAN and MISSISSIPPIAN

- 4 Metasediments
 - 4 Unsubdivided
 - 4a Massive Wacke / Sandstone
 - 4b Bedded Wacke / Sandstone +/- siltstone
 - 4c Bedded Wacke / Sandstone +/- siltstone + chert layers
 - 4d Calc-silicate bands (Amphibolitic)
 - 4e Quartz Sweets (3-5% of rock)
 - 4f Carbonate
 - 4g Muscovite + Biotite Wacke
- 3 Felsic Volcanics / Subvolcanics
 - 3 Unsubdivided
 - 3a Massive rhyolite silicified
 - 3b Massive < weak brittle fracturing / brecciation
 - 3c Massive < mod-strong brittle fracturing
 - 3d Intensely silicified / quartz vein
 - 3e Massive, mod-strong brittle fracturing, > 3-5% pyrite
 - 3f Prominent shear fractures (major scale)
 - 3g Felsic Breccia / sulphide rich matrix
 - 3h Highly sericitic
 - 3i spotted rhyolite
- 2 Intermediate - Felsic Volcanic
 - 2 Unsubdivided
 - 2a Massive flow / tuff
 - 2b Felsic - intermediate
 - 2c Massive flow / tuff weakly / moderately fractured (brittle, local scale)
 - 2d Weakly - moderately silicified
 - 2e Prominent fracturing / shear fracturing (Major scale eg: H. Zone)
 - 2f Porphyritic flow / subvolcanic
 - 2x Feldspar crystal and / or felsic fragments, Brecciated / Fractured
- 1 Mafic Intermediate Volcanic
 - 1 Unsubdivided
 - 1a Massive flow
 - 1b Porphyritic Flow
 - 1c Mafic Volcaniclastic
 - 1d Mafic pnesiose volcanic
 - 1x Brecciated / Fractured

SYMBOLS

- Foliation
- Shear Foliation (near H Zone)
- Fractures/joint
- Shear (actual H. zone)
- Bedding with dip
- Vein Orientation
- Contact (assumed, known)
- Fault Zone with limit approximated
- Steep Cliff
- Grab sample Sample No. 49000 to 50700 #'s from present sampling program (all have SP prefix)
- Float Sample (ppb Au) or (oz/ton Au) values < 100ppb not plotted 4371 to 4400 #'s all have GP prefix
- Carbonate zone
- Snow cover
- Outcrop
- Claim Line
- Claim Post
- Creek or Stream

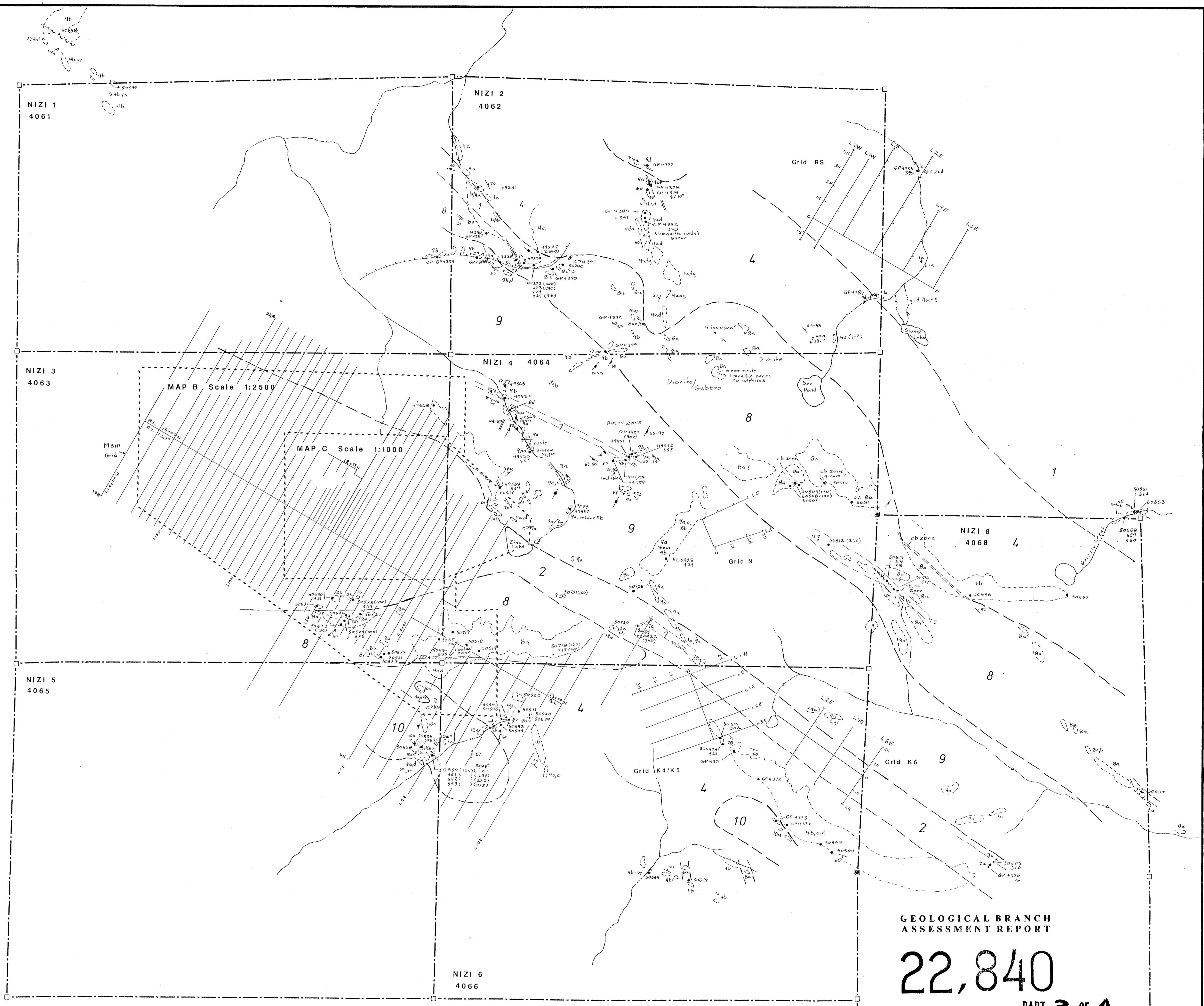

GEOLOGICAL BRANCH
ASSESSMENT REPORT

22,840

PART 2 OF 4

| | | | |
|-----------------|---|----------------------|--|
| Revision | GOLD FIELDS CANADIAN MINING, LTD. | | |
| | NIZI PROJECT RECON. GEOLOGY and SAMPLE LOCATIONS Liard Mining Division British Columbia | | |
| SCALE: 1:10,000 | MAP No. | MAP A | |
| DATE: July 1992 | MAPPED: Dunlop / McIntosh | DRAWN: I.C.D., R.Mc. | |
| | | N.T.S. | |

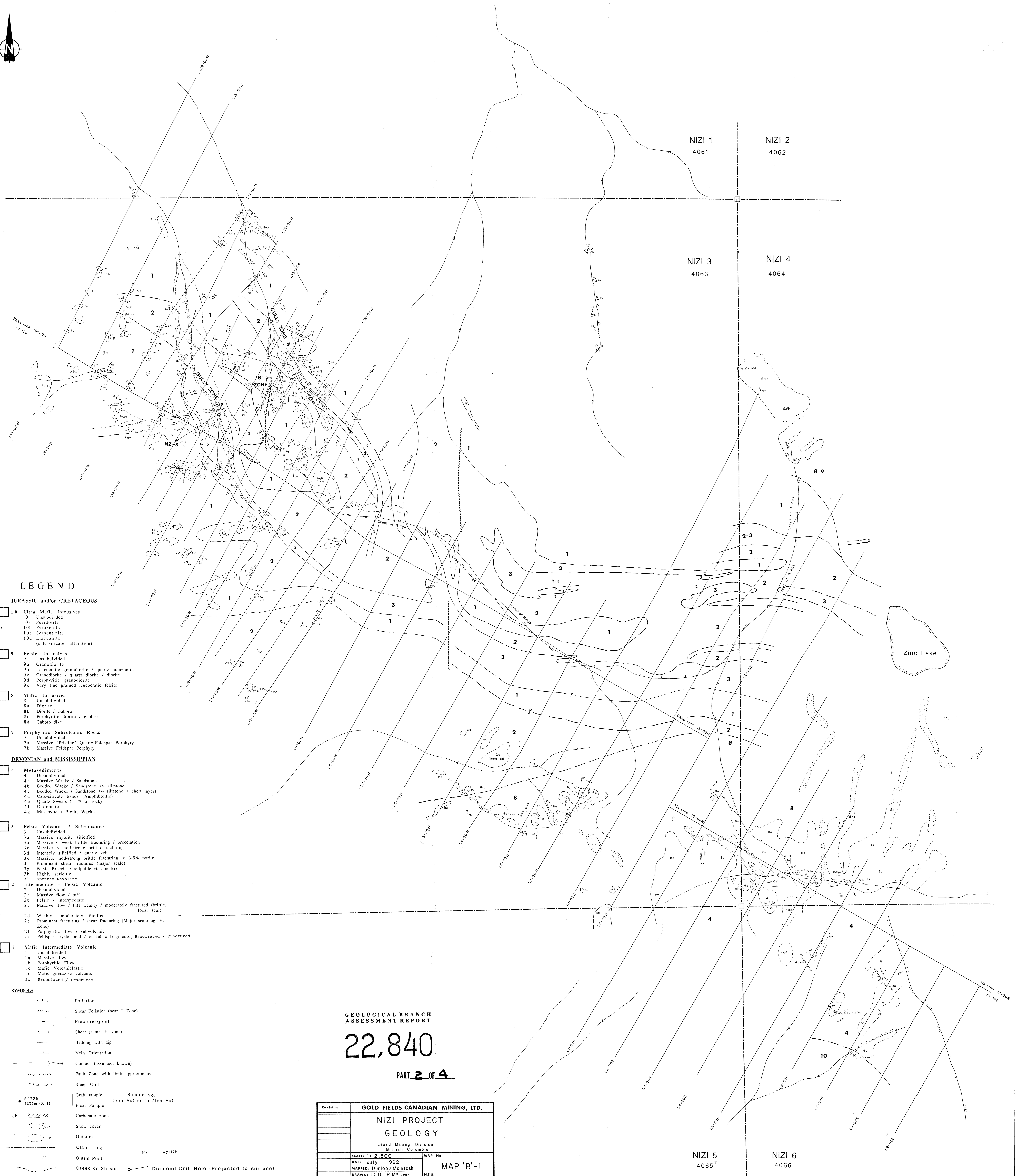
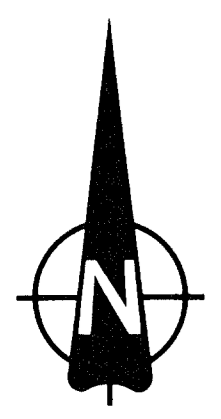

LEGEND

- JURASSIC and/or CRETACEOUS**
- 10 Ultra Mafic Intrusives
 - 10a Unsubdivided
 - 10a Peridotite
 - 10b Pyroxenite
 - 10c Serpentinized
 - 10d Listerite (calc-silicate alteration)
 - 9 Felsic Intrusives
 - 9a Unsubdivided
 - 9a Granodioritic
 - 9b Leucocratic granodiorite / quartz monzonite
 - 9c Granodiorite / quartz diorite / diorite
 - 9d Porphyritic granodiorite
 - 9e Very fine grained leucocratic felsite
 - 8 Mafic Intrusives
 - 8a Unsubdivided
 - 8a Diorite / Gabbro
 - 8c Porphyritic diorite / gabbro
 - 8d Gabbro dike
 - 7 Porphyritic Subvolcanic Rocks
 - 7a Unsubdivided
 - 7a Massive "Fristine" Quartz-Feldspar Porphyry
 - 7b Massive Feldspar Porphyry
- DEVONIAN and MISSISSIPPIAN**
- 4 Metasediments
 - 4a Unsubdivided
 - 4a Massive Wacke / Sandstone
 - 4b Bedded Wacke / Sandstone +/- siltstone
 - 4c Bedded Wacke / Sandstone +/- siltstone + chert layers
 - 4d Calc-silicate bands (Amphibolitic)
 - 4e Quartz Sweets (3-5% of rock)
 - 4f Carbonate
 - 4g Muscovite + Biotite Wacke
 - 3 Felsic Volcanics / Subvolcanics
 - 3a Unsubdivided
 - 3a Massive rhyolite silicified
 - 3b Massive < weak brittle fracturing / brecciation
 - 3c Massive < mod-strong brittle fracturing
 - 3d Intensely silicified / quartz vein
 - 3e Massive, mod-strong brittle fracturing, > 3-5% pyrite
 - 3f Prominent shear fractures (major scale)
 - 3g Felsic Breccia / sulphide rich matrix
 - 3h Highly sericitic
 - 3i Spotted Biotite
 - 2 Intermediate - Felsic Volcanic
 - 2a Unsubdivided
 - 2a Massive flow / tuff
 - 2b Felsic - intermediate
 - 2c Massive flow / tuff weakly / moderately fractured (brittle, local scale)
 - 2d Weakly - moderately silicified
 - 2e Prominent fracturing / shear fracturing (Major scale eg. H. Zone)
 - 2f Porphyritic flow / subvolcanic
 - 2x Feldspar crystal and / or felsic fragments, brecciated / Fractured
 - 1 Mafic Intermediate Volcanic
 - 1a Unsubdivided
 - 1a Massive flow
 - 1b Porphyritic Flow
 - 1c Mafic Volcaniclastic
 - 1d Mafic gneissose volcanic
 - 1x Brecciated / Fractured

- SYMBOLS**
- Foliation
 - Shear Foliation (near H Zone)
 - Fractures/Joint
 - Shear (actual H. zone)
 - Bedding with dip
 - Vein Orientation
 - Contact (assumed, known)
 - Fault Zone with limit approximated
 - Steep Cliff
 - Grab sample (Sample No. (ppb Au) or (oz/ton Au))
 - Float Sample
 - Carbonate zone
 - Snow cover
 - Outcrop
 - Claim Line
 - Claim Post
 - Creek or Stream
 - py pyrite
 - Diamond Drill Hole (Projected to surface)

GEOLOGICAL BRANCH
ASSESSMENT REPORT

22,840

PART 2 OF 4

| | | |
|----------|---|-----------|
| Revision | GOLD FIELDS CANADIAN MINING, LTD. | |
| | NIZI PROJECT | |
| | GEOLOGY | |
| | Lillard Mining Division British Columbia | |
| | SCALE: 1:2,500 | MAP No. |
| | DATE: July, 1992 | |
| | MAPPED: Dunlop / McIntosh | MAP 'B'-1 |
| | DRAWN: I.C.D., R.M.C., W.J.Z. | N.T.S. |

NIZI 1
4061

NIZI 2
4062

NIZI 3
4063

NIZI 4
4064

Zinc Lake

NIZI 5
4065

NIZI 6
4066

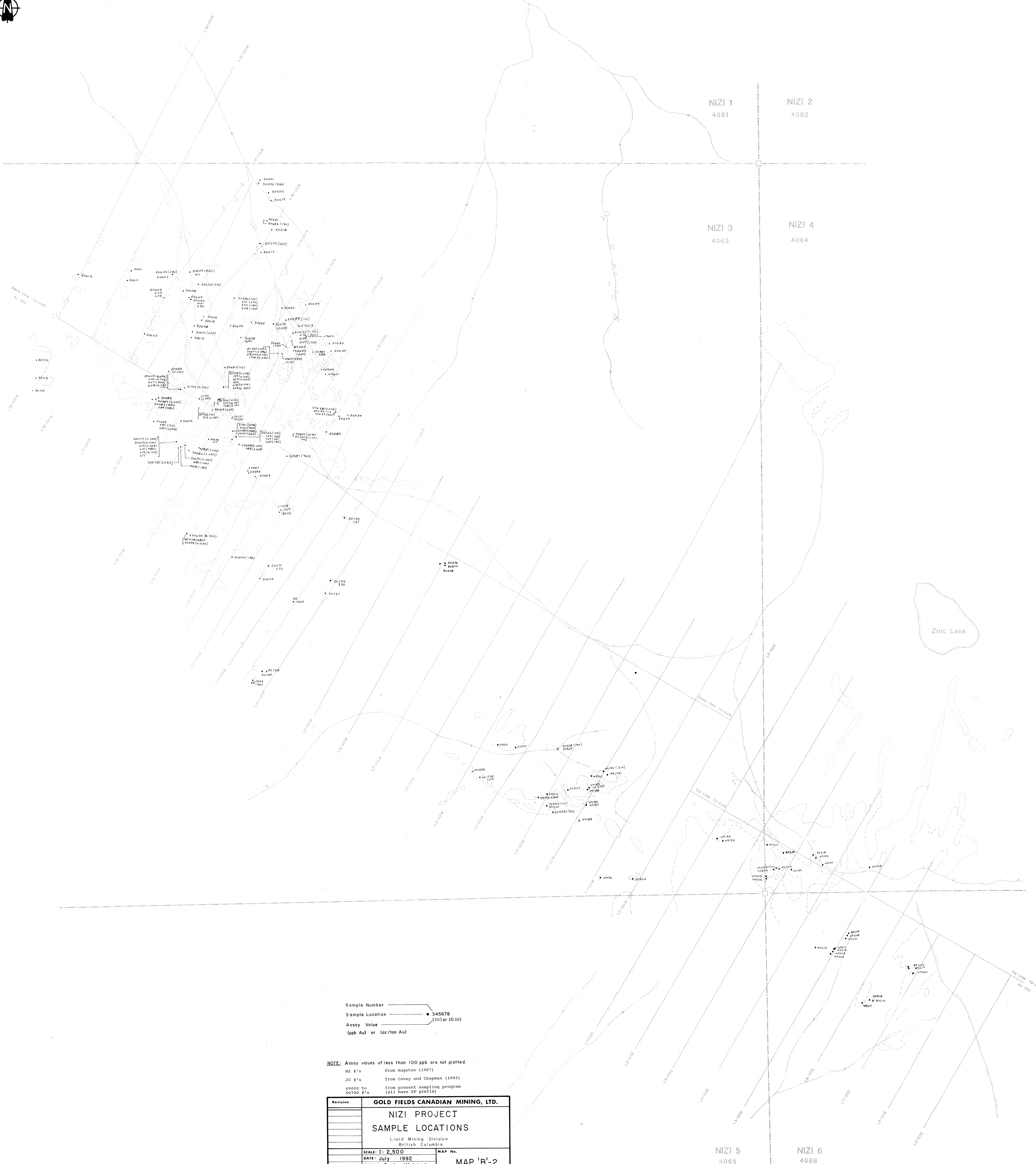
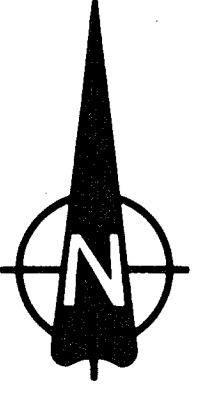

Sample Number —●— 345678
 Sample Location ——— (III) or (O.III)
 Assay Value ——— (ppb Au) or (oz/ton Au)

NOTE: Assay values of less than 100 ppb are not plotted.
 NZ #'s from Augusten (1987)
 JC #'s from Cavey and Chapman (1992)
 49000 to from present sampling program
 50700 #'s (all have GP prefix)

| | |
|-------------------------------|---|
| Revision | GOLD FIELDS CANADIAN MINING, LTD. |
| | NIZI PROJECT |
| | SAMPLE LOCATIONS |
| | Liard Mining Division British Columbia |
| SCALE: 1:2,500 | MAP No. |
| DATE: July 1992 | MAP 'B'-2 |
| MAPPED: Dunlop/McIntosh | |
| DRAWN: I.C.D., R.M.C., W.J.Z. | N.T.S. |

**GEOLOGICAL BRANCH
 ASSESSMENT REPORT**



LEGEND

- SYMBOLS**
- Foliation
 - Shear Foliation (near H Zone)
 - Fractures/joint
 - Shear (actual H. zone)
 - Bedding with dip
 - Vein Orientation
 - Contact (assumed, known)
 - Fault Zone with limit approximated
 - Steep Cliff
 - Grab sample
 - Float Sample
 - Carbonate zone
 - Snow cover
 - Outcrop
 - Claim Line
 - Claim Post
 - Creek or Stream
 - Diamond Drill Hole
- (Projected to Surface)

- JURASSIC and/or CRETACEOUS**
- 10** Ultra Mafic Intrusives
 - 10 Unsubdivided
 - 10a Peridotite
 - 10b Pyroxenite
 - 10c Serpentinite
 - 10d Lithwanite
 - 10e Calc-silicate alteration
 - 9** Felsic Intrusives
 - 9 Unsubdivided
 - 9a Granodiorite
 - 9b Leucocratic granodiorite / quartz monzonite
 - 9c Granodiorite / quartz diorite / diorite
 - 9d Porphyritic granodiorite
 - 9e Very fine grained leucocratic felsite
 - 8** Mafic Intrusives
 - 8 Unsubdivided
 - 8a Diorite
 - 8b Diorite / Gabbro
 - 8c Porphyritic diorite / gabbro
 - 8d Gabbro dike
 - 7** Porphyritic Subvolcanic Rocks
 - 7 Unsubdivided
 - 7a Massive "Porphyry" Quartz-Feldspar Porphyry
 - 7b Massive Feldspar Porphyry
- DEVONIAN and MISSISSIPPIAN**
- 4** Metasediments
 - 4 Unsubdivided
 - 4a Massive Wacke / Sandstone
 - 4b Bedded Wacke / Sandstone +/- siltstone
 - 4c Bedded Wacke / Sandstone +/- siltstone + chert layers
 - 4d Calc-silicate bands (Amphibolites)
 - 4e Quartz Swarms (3-5% of rock)
 - 4f Carbonate
 - 4g Muscovite + Biotite Wacke
 - 3** Felsic Volcanics / Subvolcanics
 - 3 Unsubdivided
 - 3a Massive rhyolite silicified
 - 3b Massive + weak brittle fracturing / brecciation
 - 3c Massive + mod-strong brittle fracturing
 - 3d Intensely silicified / quartz vein
 - 3e Massive, mod-strong brittle fracturing, > 3-5% pyrite
 - 3f Prominent shear fractures (major scale)
 - 3g Felsic Breccia / sulphide rich matrix
 - 3h Highly sericitic
 - 3i Spotted Rhyolite
 - 2** Intermediate - Felsic Volcanic
 - 2 Unsubdivided
 - 2a Massive flow / tuff
 - 2b Felsic - intermediate
 - 2c Massive flow / tuff weakly / moderately fractured (brittle, local scale)
 - 2d Weakly - moderately silicified
 - 2e Prominent fracturing / shear fracturing (Major scale eg. H. Zone)
 - 2f Porphyritic flow / subvolcanic
 - 2x Feldspar crystal and / or felsic fragments, Brecciated / Fractured
 - 1** Mafic Intermediate Volcanic
 - 1 Unsubdivided
 - 1a Massive flow
 - 1b Porphyritic Flow
 - 1c Mafic Volcaniclastic
 - 1d Mafic gneissose volcanic
 - 1x Brecciated / Fractured

**GEOLOGICAL BRANCH
ASSESSMENT REPORT**

22,840 PART 2 OF 4

GOLD FIELDS CANADIAN MINING, LTD.

**NIZI PROJECT
GEOLOGY**

Liord Mining Division
British Columbia

SCALE: 1:1,000

DATE: July 1992

MAPPED: Dunlop / McIntosh

DRAWN: I.C.D., R.M.C., W.J.Z.

MAP No. MAP 'C'-1

INTS.


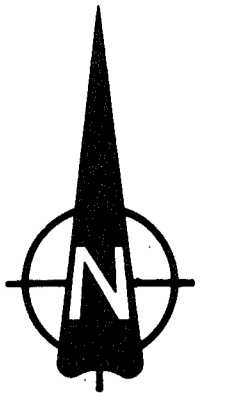

8000 f's from Babagiatti (1990) Sample Number 345678
 7500 f's from Augusten (1987) Sample Location 1111 or 0.111
 7000 f's from Cavey and Chapman (1992) Assay Value (ppb Au) or (g/ton Au)
 6000 f's from previously unreported (1991) Gold Fields sampling
 49000 to 50700 f's from present sampling program (all have SP prefix)

NOTE: Assay values of less than 100 ppb are not plotted.

| | | |
|-------------------------------|---|---------|
| Revision | GOLD FIELDS CANADIAN MINING, LTD. | |
| | NIZI PROJECT | |
| | SAMPLE LOCATIONS | |
| | Liard Mining Division British Columbia | |
| SCALE: 1:1000 | MAP No. | |
| DATE: July 1992 | | |
| MAPPED: Dunlop/McIntosh | | MAP C-2 |
| DRAWN: I.C.D., R.M.C., W.J.Z. | | |



60
58
56
54
52
50
48
46
44
42
40
38
36
34
32
30
28
26
24
22
20
18
16
14
12
10
8
6
4
2
0

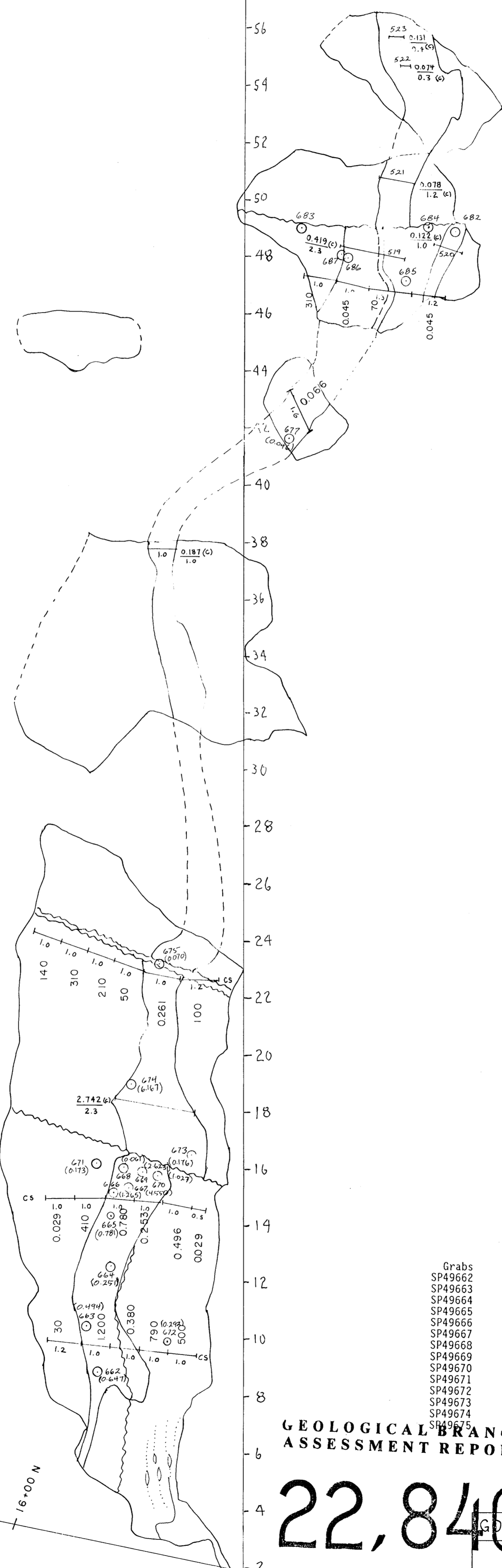

| | | |
|---------|------|-------|
| SP49519 | 2.3m | 0.419 |
| SP49520 | 1.0m | 0.122 |
| SP49521 | 1.2m | 0.078 |
| SP49522 | 0.3m | 0.074 |
| SP49523 | 0.4m | 0.131 |

| | | |
|---------|--|-------|
| SP49682 | | 0.092 |
| SP49683 | | 0.030 |
| SP49684 | | 110 |
| SP49685 | | 900 |
| SP49686 | | 0.150 |
| SP49687 | | 0.170 |

| | | |
|---------|------|-------|
| Line 4 | | |
| SP49711 | 1.0m | 310 |
| SP49712 | 1.0m | 0.045 |
| SP49713 | 1.3m | 70 |
| SP49714 | 1.2m | 0.045 |

| | | |
|---------|------|-------|
| SP49676 | 1.6m | 0.066 |
| SP49677 | | 0.046 |

| | | |
|---------|------|-------|
| Line 3 | | |
| SP49705 | 1.0m | 140 |
| SP49706 | 1.0m | 310 |
| SP49707 | 1.0m | 210 |
| SP49708 | 1.0m | 50 |
| SP49709 | 1.0m | 0.261 |
| SP49710 | 1.2m | 100 |

| | | |
|---------|------|-------|
| Line 2 | | |
| SP49699 | 1.0m | 0.029 |
| SP49700 | 1.0m | 410 |
| SP49701 | 1.0m | 0.780 |
| SP49702 | 1.0m | 0.253 |
| SP49703 | 1.0m | 0.496 |
| SP49704 | 0.5m | 0.029 |

| | | |
|---------|------|------|
| Line 1 | | |
| SP49694 | 1.2m | 30 |
| SP49695 | 1.0m | 1.2 |
| SP49696 | 1.0m | 0.38 |
| SP49697 | 1.0m | 790 |
| SP49698 | 1.0m | 500 |

- quartz vein
 - grab sample
 - chip sample
 - channel saw sample
 } 140 ppb Au or 0.012 oz/ton Au

| | |
|---------|-------|
| Grabs | |
| SP49662 | 0.647 |
| SP49663 | 0.494 |
| SP49664 | 0.251 |
| SP49665 | 0.781 |
| SP49666 | 1.265 |
| SP49667 | 4.550 |
| SP49668 | 0.061 |
| SP49669 | 2.623 |
| SP49670 | 1.027 |
| SP49671 | 0.173 |
| SP49672 | 0.292 |
| SP49673 | 0.176 |
| SP49674 | 6.167 |
| SP49675 | 0.070 |

**GEOLOGICAL BRANCH
ASSESSMENT REPORT**

22,840

PART 2 OF 4

MAP 'D'

GOLDFIELDS CANADIAN MINING LTD.

NIZI PROJECT
DISCOVERY VEIN TRENCH
SAMPLE LOCATIONS

| | | |
|---------|-------|-------|
| Aug. 92 | 1:100 | RM/WE |
|---------|-------|-------|

L 6+50 W

16+00 N

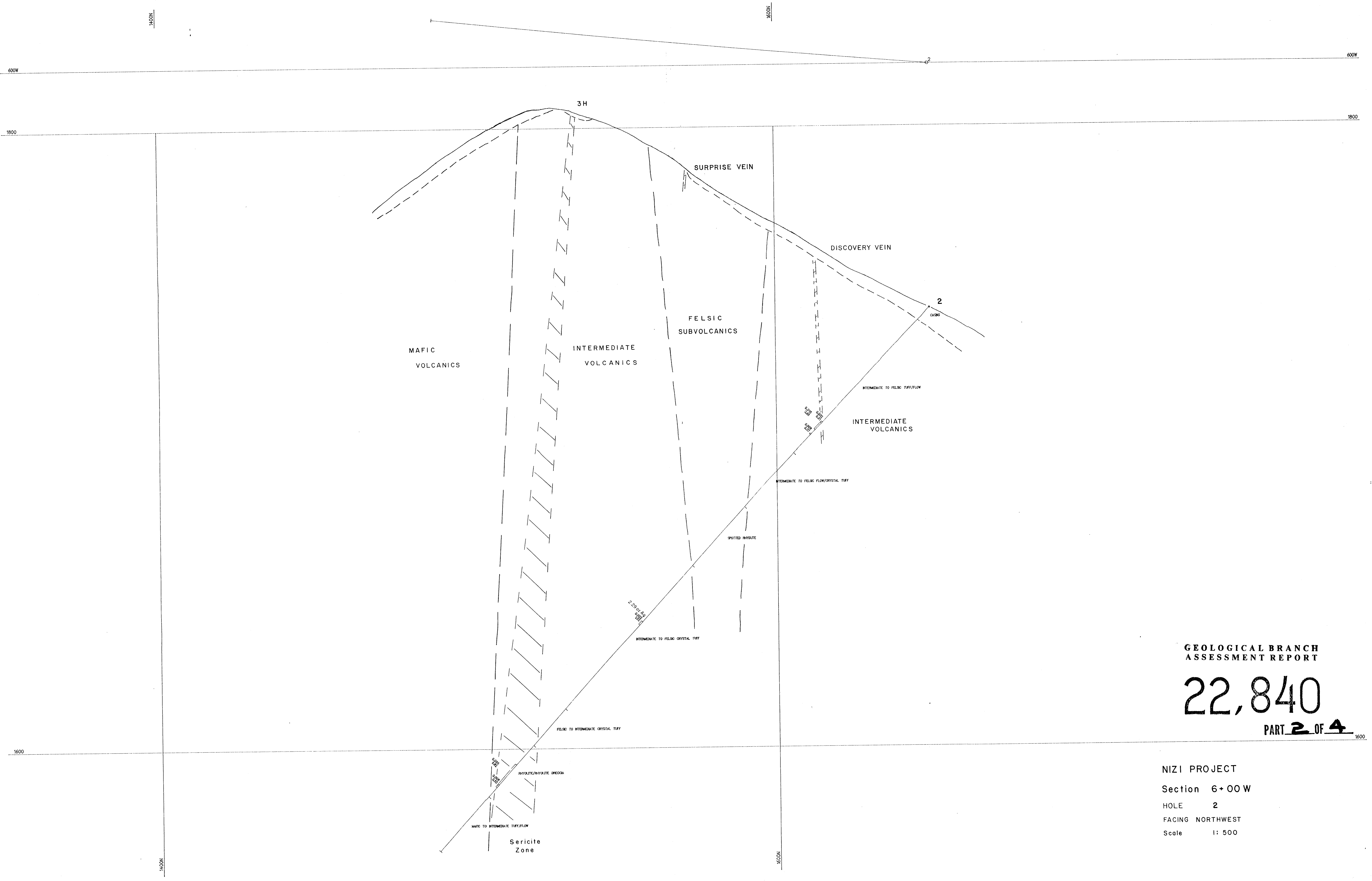

GEOLOGICAL BRANCH
ASSESSMENT REPORT

22,840

PART 2 OF 4

NIZI PROJECT
Section 6+00 W
HOLE 2
FACING NORTHWEST
Scale 1: 500

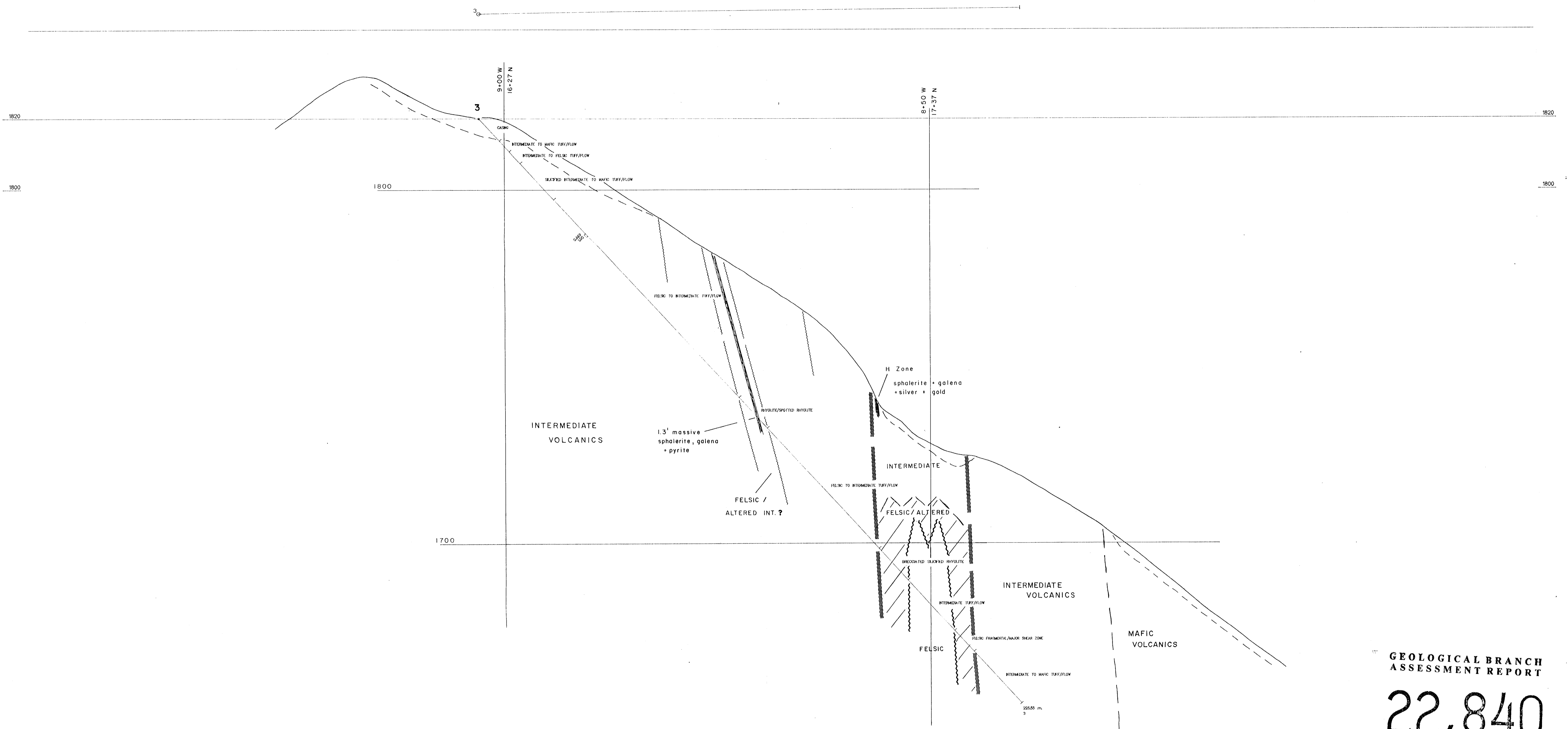

GEOLOGICAL BRANCH
ASSESSMENT REPORT

22,840

PART 2 OF 4

NIZI PROJECT
Section N 25° E
HOLE 3
FACING WEST - NORTHWEST
Scale 1: 500

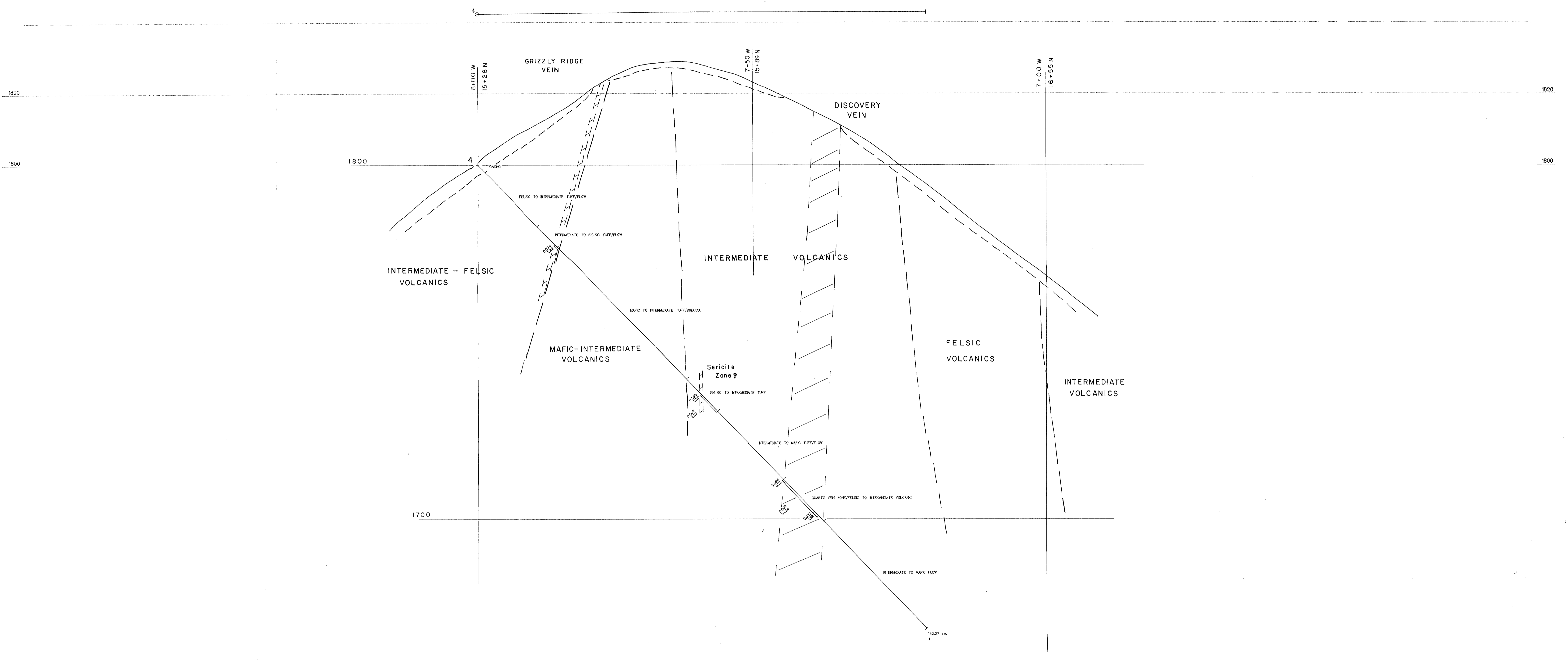

GEOLOGICAL BRANCH
ASSESSMENT REPORT

22,840

PART 2 OF 4

NIZI PROJECT
Section N 39° E
HOLE 4
FACING NORTHWEST
Scale 1: 500

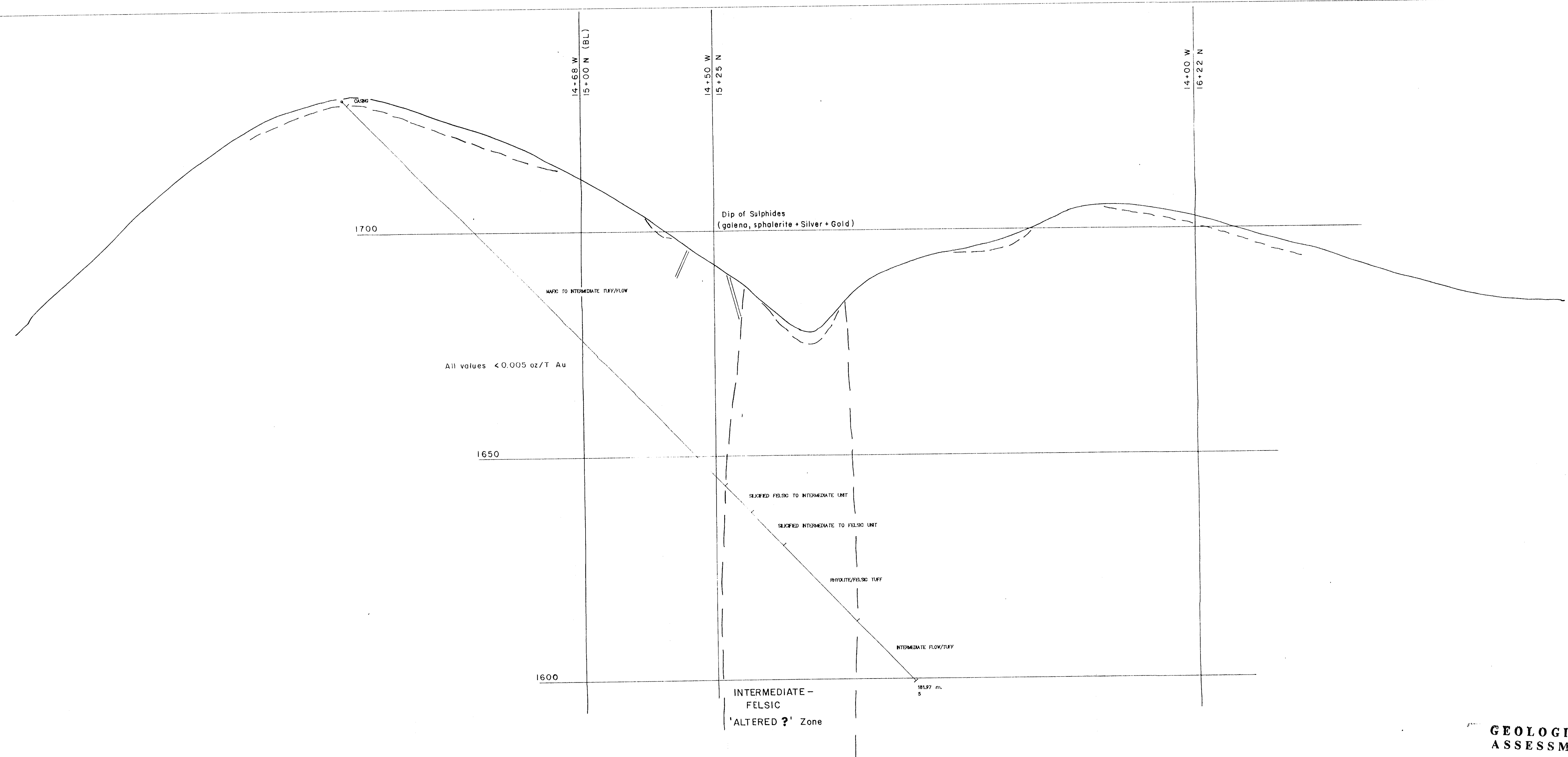

GEOLOGICAL BRANCH
ASSESSMENT REPORT

22,840

PART 2 OF 4

NIZI PROJECT
Section N58° E
HOLE 5
FACING NORTHWEST
Scale 1: 500

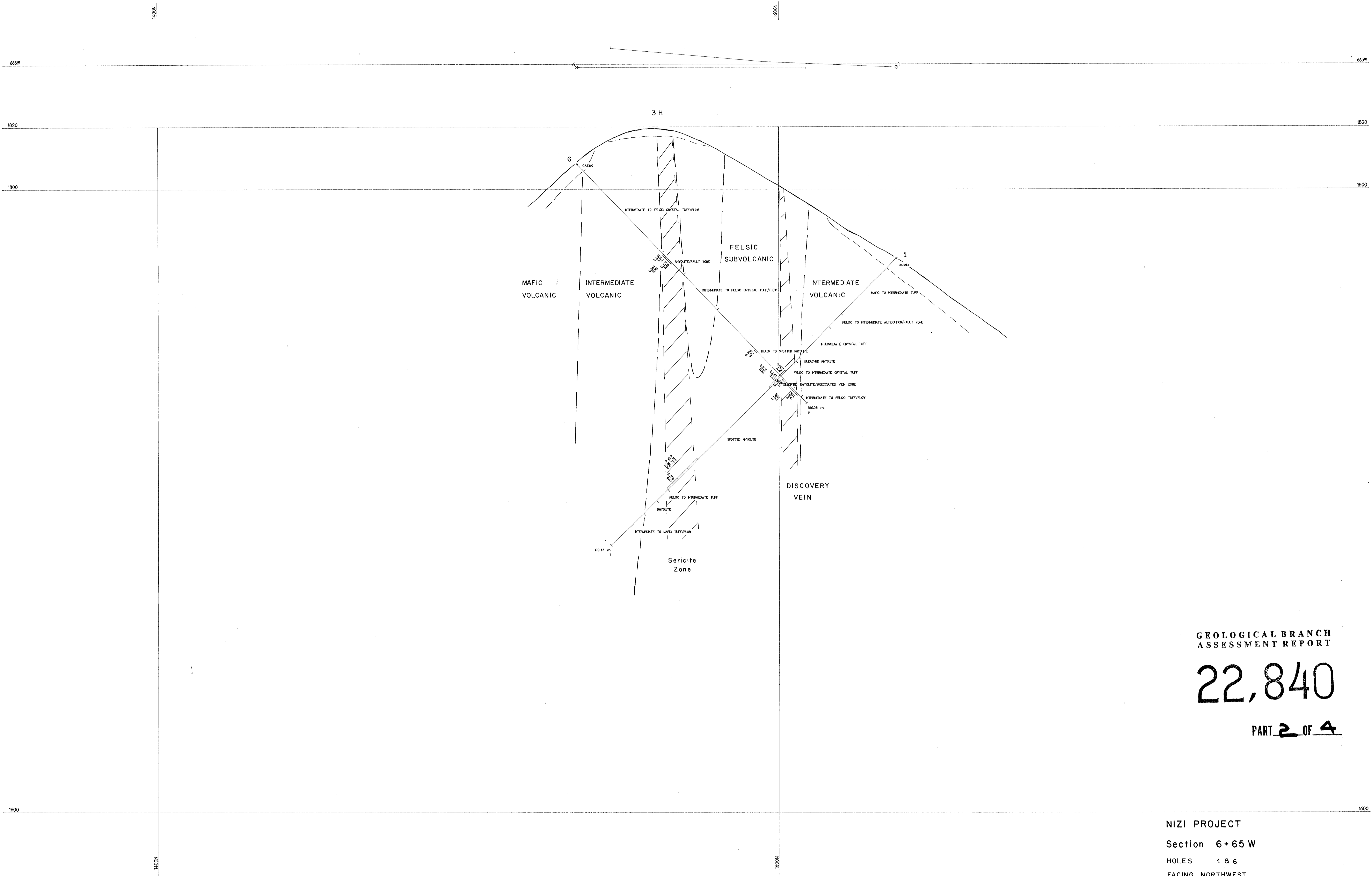

GEOLOGICAL BRANCH
ASSESSMENT REPORT

22,840

PART 2 OF 4

NIZI PROJECT
Section 6+65 W
HOLES 1 & 6
FACING NORTHWEST
Scale 1: 500