

220006

2 2

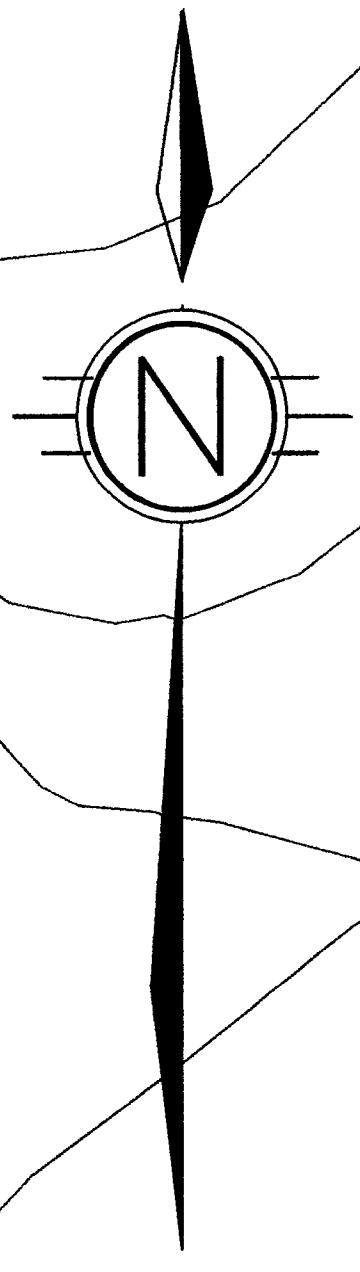

ORPIMENT ZONE

FIG. 2.9&10

EUREKA ZONE

FIG. 2.7&8

FIG. 3.2

NUNATAK FAULT

LEGEND

GEOLOGY

Stratified Rocks

- 8 Bowser Lake Group
- 7 Salmon River Formation
Well bedded argillite and tuff
- 6 Salmon River Formation volcanic rocks
6mv Mafic volcanic rocks
6rhy Rhyolite flows, breccias, tuffs
6frq Felsic, pyritic fragmental rocks
6ves Vesicular volcanic, dacite or altered andesite
6int Intermediate welded tuff and epiclastic rocks
- 5 Mt. Dilworth Formation
5ht Heterolithic lapilli tuff to tuff breccia
5epi Reworked 5ht
5rhy Flow-banded rhyolite flows, breccias
- 4 Tertiary sedimentary rocks
Calcareous sandstone, limestone. Fossiliferous
- 3 Betty Creek Formation
3v Hornblende-feldspar porphyritic volcanic rocks
3and Vesicular andesite flows, breccia
3mas Massive andesite sills
3kap Orthoclase pyritic tuffs, breccias
3fel Felsic breccia with plagioclase matrix
- 2 Unuk River Formation
Arenite with argillite, siltstone and volcanic conglomerate

Intrusions

- 9di Equigranular, medium to coarse diorite
- 9fel Massive, pale, felsic intrusion
- 9kap Orthoclase porphyry stocks, dykes
- 9int Fine-grained hb+plagioclase intrusion
- 9monz Medium-grained monzonite

ABBREVIATIONS

- arg argillite
- bx breccia
- carb carbonate
- chl chlorite
- fel feldspar
- hbl hornblende
- hntfs hornfels
- gal galeua
- py pyrite
- pxx pyroxene
- qtz quartz
- ser sericite
- sil silicification
- sph sphalerite
- sst sandstone
- thd tetrahedrite
- alu alunite
- kaol kaolinite
- pyroph pyrophyllite
- ser sericite
- hem hematite
- orp orpiment
- sb stibnite

ALTERATION ASSEMBLAGES

- A chl+hem+ep
- B chl+py+cb
- C sil'+hem+py
- D ser+py+qtz
- E kaol+py+qtz
- F pyroph+py+qtz
- G sil'n
- H pyritic sil'n
- I qz+alu+py+/-kaol+pyroph

SYMBOLS

- bedding, vertical, overturned
- bedding, tops upright
- foliation, vertical
- foliation with lineation
- joint set, vertical
- vein, vertical
- flow banding
- contact, approximate
- contact, inferred
- alteration contact
- fault
- thrust fault
- outcrop
- trench

GEOLOGICAL BRANCH ASSESSMENT REPORT

23,686

PART 2 OF 2

SCALE IN METRES

HOMESTAKE CANADA LTD.
TREATY PROPERTY GEOLOGY
EAST HALF

| | | | |
|--------------|-------------------|---------------|---------------|
| DRAWN KMP | DATE Nov. 1994 | NTS 104B/9 | FIGURE 2.4 |
|--------------|-------------------|---------------|---------------|

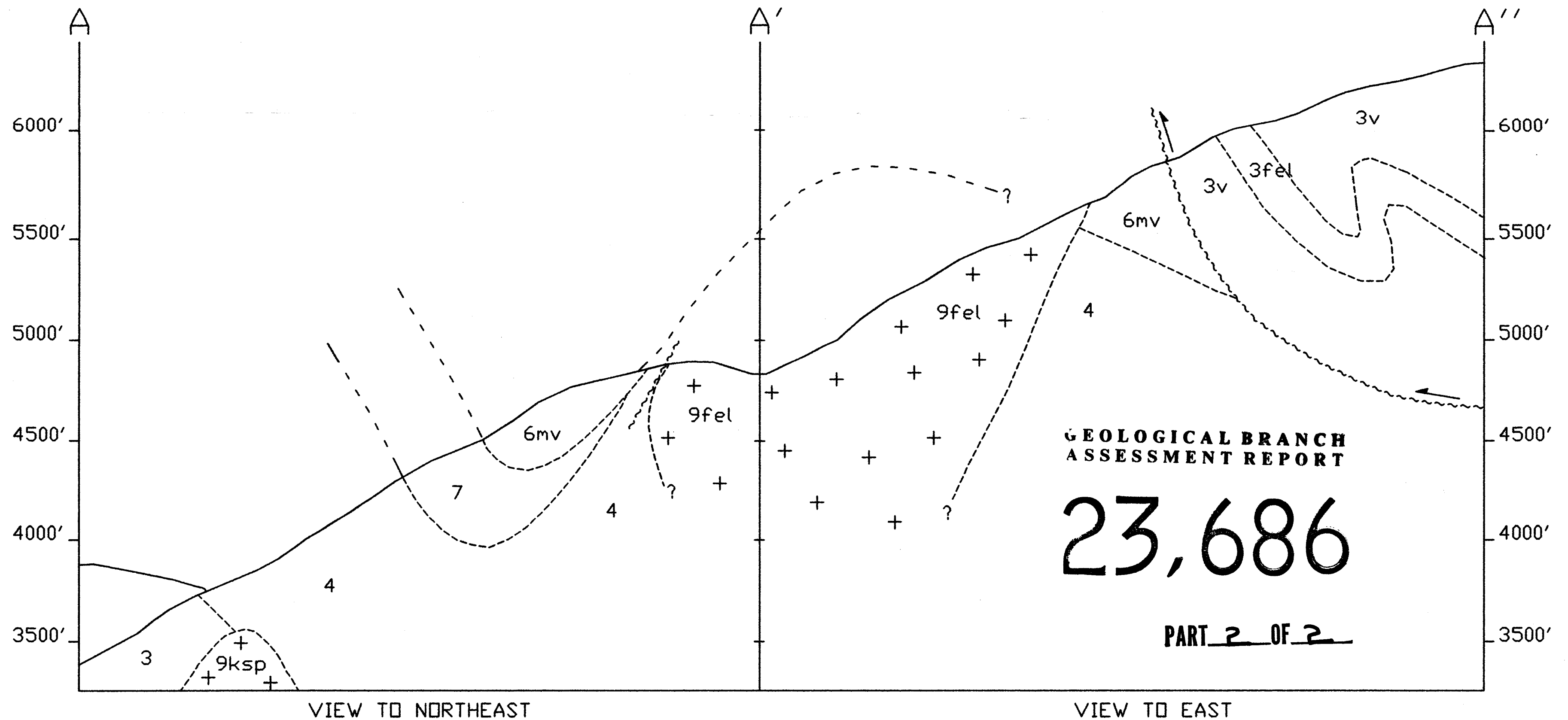

LEGEND

Stratified Rocks

- 7 Salmon River Formation
Well bedded argillite and tuff
- 6 Salmon River Formation volcanic rocks
6mv mafic volcanic rocks
- 4 Tuarician sedimentary rocks
calcareous sandstone, limestone. Fossiliferous

- 3 Betty Creek Formation
3v hornblende-feldspar porphyritic volcanic rocks
3fel felsic breccia with plag-phyrnic matrix
- Intrusions**
9fel massive, pale, siliceous rocks
9ksp orthoclase porphyry stocks, dykes

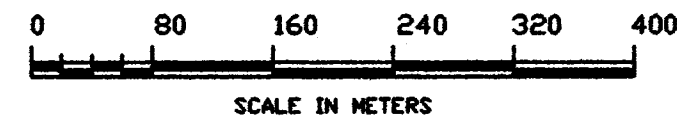

HOMESTAKE CANADA LTD.

TREATY PROPERTY

CROSS SECTION A-A'-A''

| | | | |
|--------------|-------------------|---------------|---------------|
| DRAWN KMP | DATE Nov. 1994 | NTS 104B/9 | FIGURE 2.5 |
|--------------|-------------------|---------------|---------------|

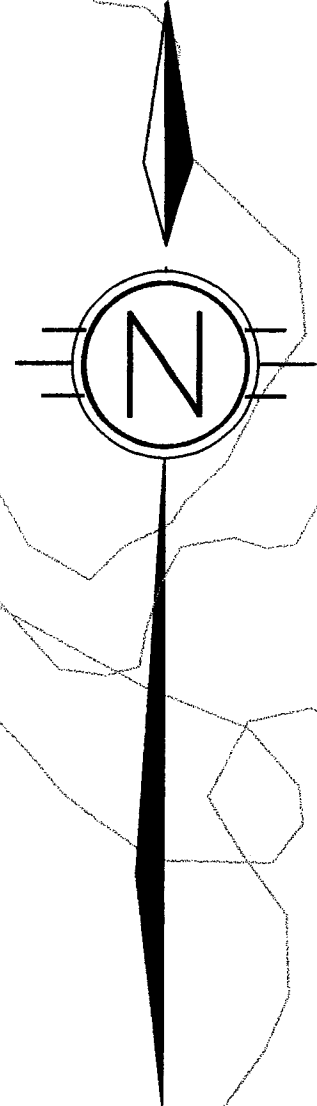

429,500e
+6,274,000n

429,000e
+6,274,000n

ATKINS

GLACIER

GLACIER

429,000e
+6,270,500n

LEGEND

GEOLOGY

Stratified Rocks

- 8 Bower Lake Group
- 7 Salmon River Formation
Well bedded argillite and tuff
- 6 Salmon River Formation volcanic rocks
6mv Mafic volcanic rocks
6rhy Rhyolite flows, breccias, tuffs
6frg Felsic, pyritic fragmental rocks
6ves Vesicular volcanic, dacite or altered andesite
6int Intermediate welded tuff and epiclastic rocks
- 5 Mt. Dilworth Formation
5ht Heterolithic lapilli tuff to tuff breccia
5doc Massive, vesicular to perlitic dacite
5rhy Flow-banded rhyolite flows, breccias
- 4 Tsonion sedimentary rocks
Colourses sandstone, limestone. Fossiliferous
- 3 Betty Creek Formation
3v Hornblende-feldspar porphyritic volcanic rocks
3and Vesicular andesite flows, breccia
3mas Massive andesite sills
3ksp Orthoclase phytic tuffs, breccias
- 2 Unuk River Formation
Arenite with argillite, siltstone and volcanic conglomerate
- 1 Shukhi Group
1v Volcanic and volcanoclastic rocks
1sed Sandstone, siltstone, and mudstone

Intrusions

- 9di Equigranular, medium to coarse diorite
- 9fel Massive, pels, felsic intrusions
- 9kap Orthoclase porphyry stocks, dykes
- 9int Fine-grained hbl+plag+phyric intrusion
- 9and Medium-grained monzonite

ABBREVIATIONS

- arg argillite
- bx breccia
- carb carbonate
- chl chlorite
- fel feldspar
- hbl hornblende
- hfta hornfels
- gal galena
- py pyrite
- pxs pyroxene
- qt quartz
- ser sericite
- sil silicification
- sph sphalerite
- sand sandstone
- tdt tetrahedrite
- olu olivine
- kaol kaolinite
- pyroph pyrophyllite
- ser sericite
- hem hematite
- orp orpiment
- sb stibnite

SYMBOLS

- bedding, tops unknown
- bedding, tops upright
- bedding, overturned
- bedding, vertical
- foliation
- foliation, vertical
- foliation with lineation
- joint set
- joint set, vertical
- flow banding
- vein
- vein, vertical
- contact, approximate
- contact, inferred
- alteration contact
- fault
- thrust fault
- outcrop

ALTERATION ASSEMBLAGES

- A chl+hem+ep
- B chl+py+cc
- C sil+hem+py
- D sil+qt+py
- E kaol+qt+py
- F pyroph+qt+py
- G sil
- H pyritic sil
- I qt+alu+py+/-kaol/pyroph
- J Fe-carb+py+/-ser



HOMESTAKE
HOMESTAKE CANADA LTD.
TREATY PROPERTY
GEOLOGY
WEST HALF

| | | | |
|--------------|-------------------|---------------|-------------------------|
| DRAWN KMP | DATE Nov. 1994 | NTS 104B/9 | FIGURE 2.6 <i>dk</i> |
|--------------|-------------------|---------------|-------------------------|

GEOLOGICAL BRANCH
ASSESSMENT REPORT

23,686

PART 2 OF 2

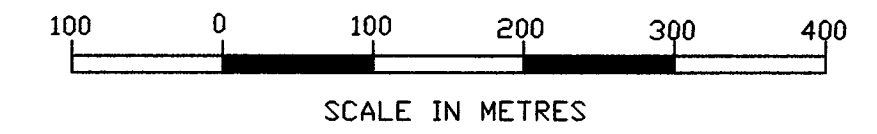

TREATY

FIG. 3.2

EUREKA ZONE

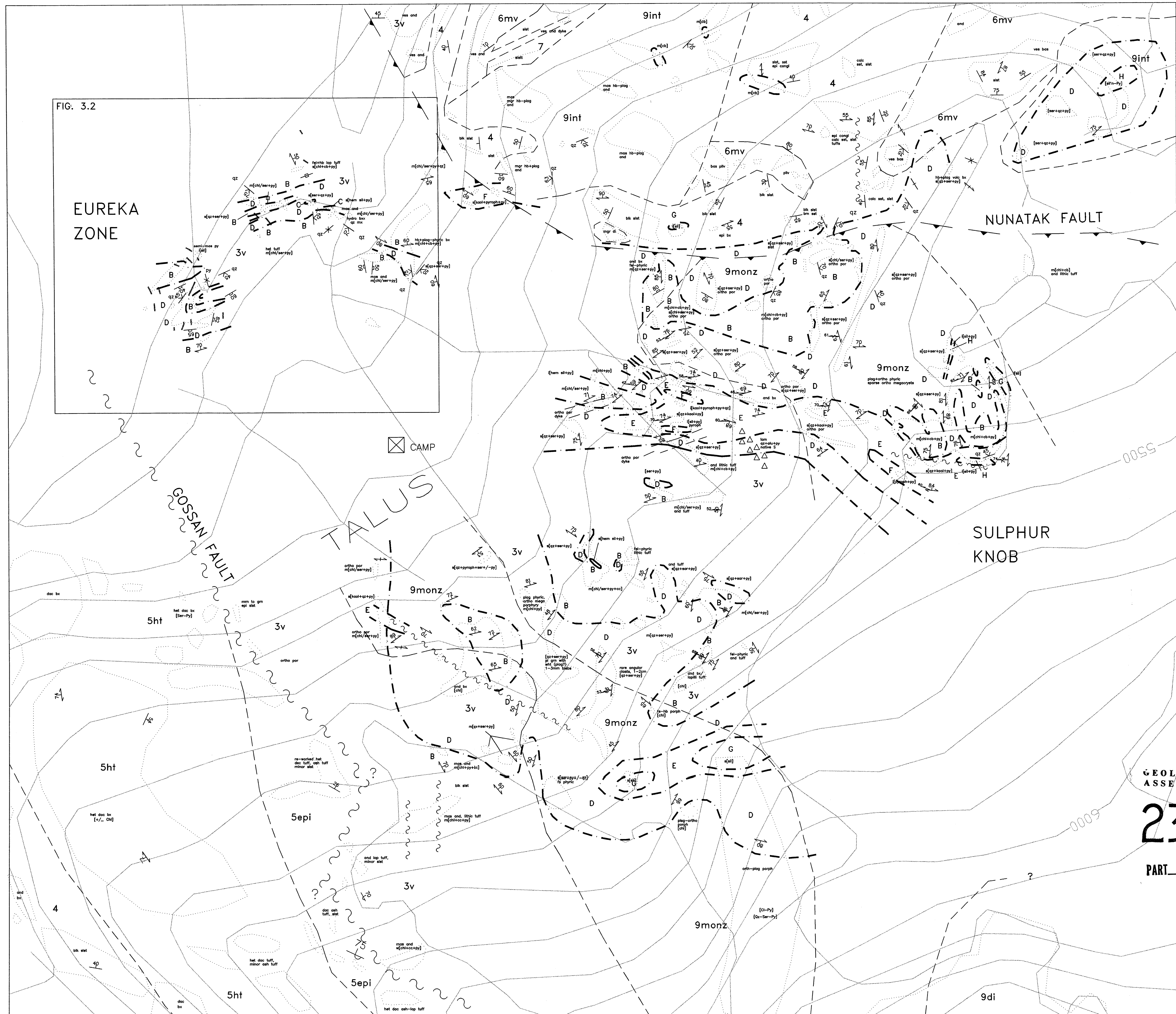

LEGEND

GEOLOGY

Stratified Rocks

- 8 Bowers Lake Group
- 7 Salmon River Formation
Well-bedded argillite and tuff
- 6 Salmon River Formation volcanic rocks
 - 6mv Mafic volcanic rocks
 - 6rhy Rhyolite flows, breccias, tuffs
 - 6frg Felsic, pyritic fragmental rocks
 - 6ves Vesicular volcanic, dacite or altered andesite
 - 6int Intermediate welded tuff and epiclastic rocks
- 5 Mt. Dilworth Formation
 - 5ht Heterolithic lapilli tuff to tuff breccia
 - 5doc Massive, vesicular to perlitic dacite
 - 5epi Reworked 5ht
- 4 Tauricon sedimentary rocks
Calcareous sandstone, limestone. Fossiliferous
- 3 Betty Creek Formation
 - 3v Hornblende-feldspar porphyritic volcanic rocks
 - 3and Vesicular andesite flows, breccia
 - 3mas Massive andesite sills
 - 3kap Orthoclase phytic tuffs, breccias
- 2 Unuk River Formation
Arenite with argillite, siltstone and volcanic conglomerate

Intrusions

- 9di Equigranular, medium to coarse diorite
- 9fel Massive, pale, felsic intrusions
- 9kap Orthoclase porphyry stocks, dykes
- 9int Fine-grained hb+plag intrusion
- 9monz Medium-grained monzonite

ABBREVIATIONS

- arg argillite
- bx breccia
- carb carbonate
- chl chlorite
- fel feldspar
- hbl hornblende
- hnfs hornfels
- gal galena
- py pyrite
- pyx pyroxene
- qz quartz
- ser sericite
- sil silicification
- sph sphalerite
- st sandstone
- thd tetrahedrite
- alu alunite
- koal kaolinite
- pyroph pyrophyllite
- ser sericite
- hem hematite
- orp orpiment
- sb stibnite

SYMBOLS

- bedding, tops unknown
- bedding, tops upright
- bedding, overturned
- bedding, vertical
- foliation
- foliation, vertical
- foliation with lineation
- joint set
- joint set, vertical
- flow banding
- vein
- vein, vertical
- contact, approximate
- contact, inferred
- alteration contact
- fault
- thrust fault
- outcrop
- trench

ALTERATION ASSEMBLAGES

- A chl+hem+ep
- B chl+py+cc
- C sil+hem+py
- D ser+qz+py
- E koal+qz+py
- F pyroph+qz+py
- G sil
- H pyritic sil

GEOLOGICAL BRANCH
ASSESSMENT REPORT

23,686

PART 2 OF 2

HOMESTAKE CANADA LTD.

TREATY PROPERTY
GEOLOGY

MAIN GOSSAN

| | | | |
|--------------|-------------------|---------------|---------------|
| DRAWN KMP | DATE Nov. 1994 | NTS 104B/9 | FIGURE 2.8 |
|--------------|-------------------|---------------|---------------|

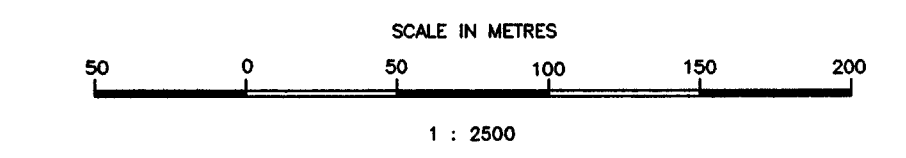

LEGEND

GEOLOGY

Stratified Rocks

- 8** Bower Lake Group
- 7** Salmon River Formation
Well-bedded argillite and tuff
- 6** Salmon River Formation volcanic rocks
 - 6mv Mafic volcanic rocks
 - 6rhy Rhyolite flows, breccias, tuffs
 - 6frg Felsic, pyritic fragmental rocks
 - 6ves Vesicular volcanic, dacite or altered andesite
 - 6int intermediate welded tuff and epiclastic rocks
- 5** Mt. Dilworth Formation
 - 5ht Heterolithic lapilli tuff to tuff breccia
 - 5dac Massive, vesicular to perlitic dacite
 - 5rhy Flow-banded rhyolite flows, breccias
- 4** Taurian sedimentary rocks
Calcareous sandstone, limestone. Fossiliferous
- 3** Betty Creek Formation
 - 3v Hornblende-feldspar porphyritic volcanic rocks
 - 3and Vesicular andesite flows, breccia
 - 3mas Massive andesite sills
 - 3ksp Orthoclase phytic tuffs, breccias
- 2** Unuk River Formation
Arenite with argillite, siltstone and volcanic conglomerate

Intrusions

- 9di Equigranular, medium to coarse diorite
- 9fel Massive, pale, siliceous rocks
- 9ksp Orthoclase porphyry stocks, dykes
- 9int Pyroxene, feldspar porphyry
- 9monz Medium-grained monzonite

ABBREVIATIONS

- arg argillite
- bx breccia
- carb carbonate
- chl chlorite
- fel feldspar
- hbl hornblende
- hnfs hornfels
- gal galena
- py pyrite
- pyx pyroxene
- qz quartz
- ser sericite
- sil silicification
- sph sphalerite
- ssat sandstone
- thd tetrahedrite
- alu alunite
- kaol kaolinite
- pyroph pyrophyllite
- ser sericite
- hem hematite
- orp orpiment
- sb stibnite

SYMBOLS

- bedding, tops unknown
- bedding, tops upright
- bedding, overturned
- bedding, vertical
- foliation
- foliation, vertical
- foliation with lineation
- joint set
- joint set, vertical
- flow banding
- vein
- vein, vertical

ALTERATION ASSEMBLAGES

- A chl+hem+ep
- B chl+py+cb
- C sil'+hem+py
- D ser+py+qz
- E kaol+py+qz
- F pyroph+py+qz
- G sil'n

- contact, approximate
- contact, inferred
- alteration contact
- fault
- thrust fault
- outcrop
- drill hole
- hell-pad

GEOLOGICAL BRANCH
ASSESSMENT REPORT

23,686

PART 2 OF 2

| | | | |
|----------------------------|-------------------|---------------|----------------|
| | | | |
| HOMESTAKE CANADA LTD. | | | |
| TREATY PROPERTY GEOLOGY | | | |
| ORPIMENT ZONE | | | |
| DRAWN KMP | DATE Nov. 1994 | NTS 104B/9 | FIGURE 2.10 |

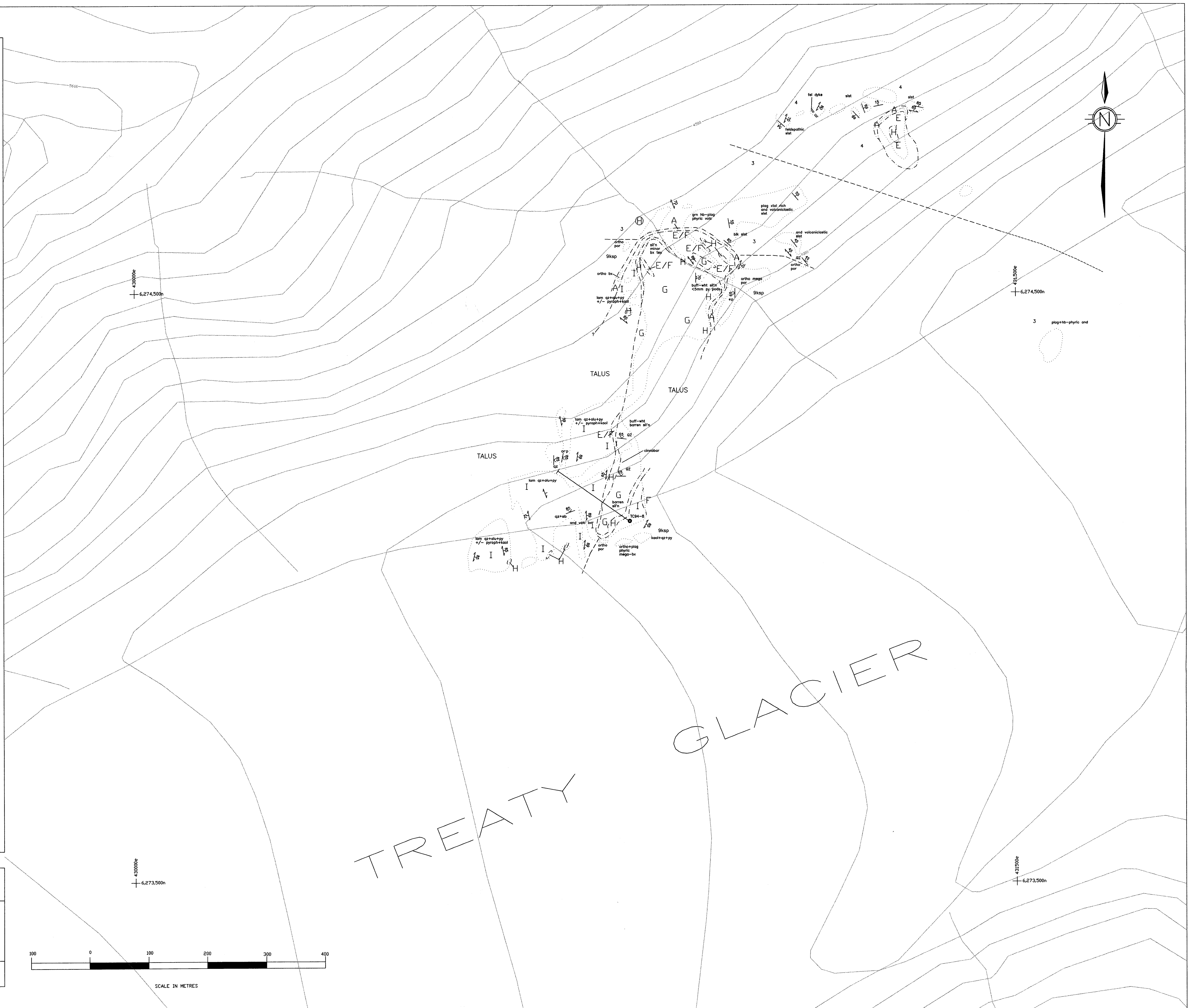
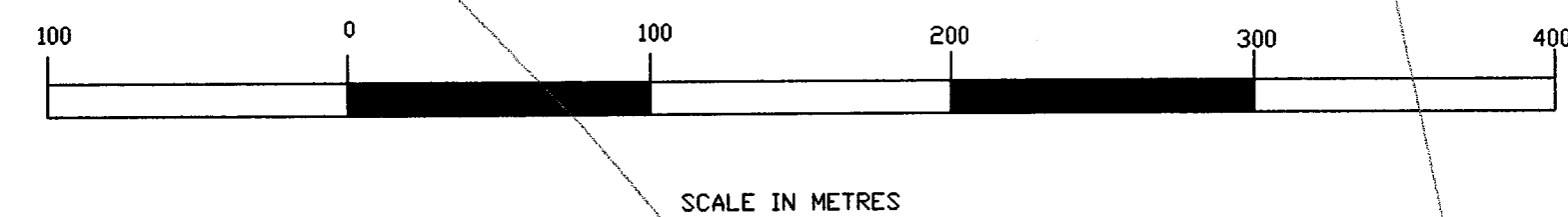

LEGEND

TRENCH GEOLOGY

- 1 - Chlorite+pyrite+/-carbonate alteration. 10% disseminated euhedral pyrite. Irregular veinlets of quartz which locally form a stockwork.
- 2 - Moderate to strong sericite+pyrite+quartz. 10% fine grained pyrite. Quartz boxwork after pyrite on weathered surfaces.
- 3 - Strong sericite+pyrite+quartz alteration with up to 15% disseminated fine grained pyrite.
- 4 - White to gray silicification with 1-2% disseminated fine grained pyrite. Rock is densely fractured with clay and limonite on fracture surfaces.
- 5 - Shear zone completely comprising quartz boxwork and abundant limonite and minor wad.
- 6 - Angular fragments of white quartz+/-barite cemented by limonite and jarosite. Clasts are angular and vary from 0.5 to 1 cm.
- 7 - Moderate to strong sericite+quartz+pyrite altered Unit 3v with 10-20 cm intervals of hydrothermal breccia (6).

ABBREVIATIONS

- arg argillite
- bx breccia
- carb carbonate
- chl chlorite
- fel feldspar
- hbl hornblende
- hnfs hornfels
- gal galena
- py pyrite
- pyx pyroxene
- ser sericite
- sil silicification
- sph sphalerite
- sst sandstone
- thd tetrahedrite
- alu alunite
- kaol kaolinite
- pyroph pyrophyllite
- ser sericite
- hem hematite
- orp orpiment
- sb stibnite

SYMBOLS

- bedding, tops unknown
- bedding, tops upright
- bedding, overturned
- bedding, vertical
- foliation
- foliation, vertical
- foliation with lineation
- joint set
- joint set, vertical
- flow banding
- vein
- vein, vertical

ALTERATION ASSEMBLAGES

- A chl+hem+ep
- B chl+py+cc
- C sil+hem+py
- D ser+py+qz
- E kaol+qz+py
- F pyroph+qz+py
- G sil
- H pyritic sil
- I qtz+olt+py+/-kaol/pyroph

- contact, approximate
- contact, inferred
- alteration contact
- fault
- thrust fault
- outcrop

TRENCH

TR94-6

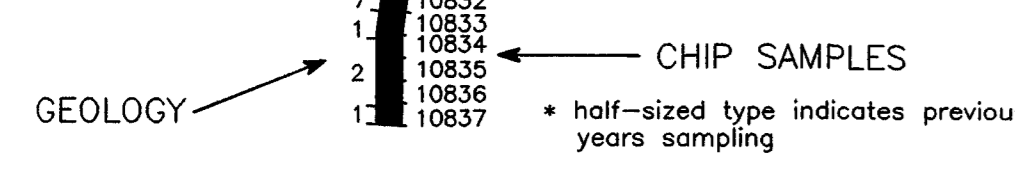

CHIP LINE

CL93-3

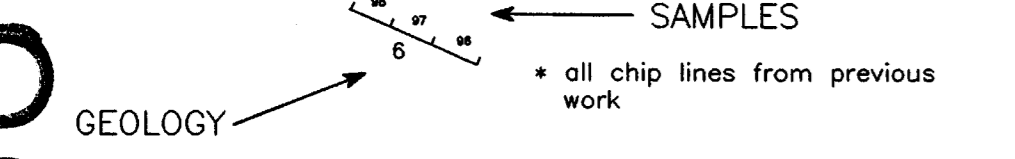

GEOLOGICAL BRANCH ASSESSMENT REPORT

23,686 PART 2 OF 2



HOMESTAKE CANADA LTD.

TREATY PROPERTY EUREKA ZONE

TRENCH MAP

| DRAWN | DATE | NTS | FIGURE |
|-------|-----------|--------|--------|
| KMP | Nov. 1994 | 104B/9 | 3.2 dk |

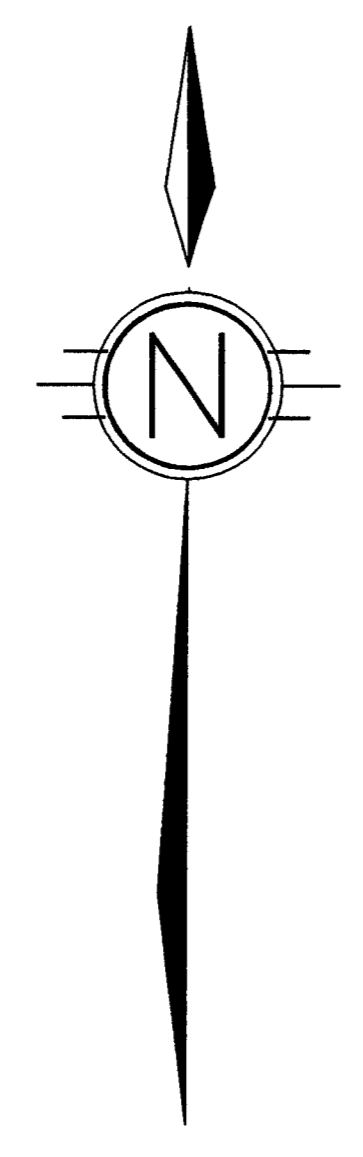
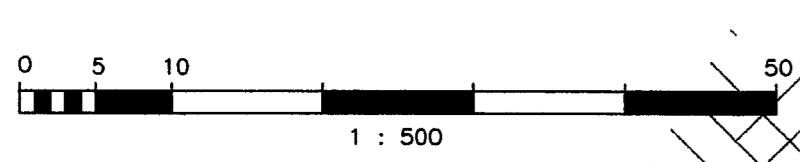

6272350n

6272350n

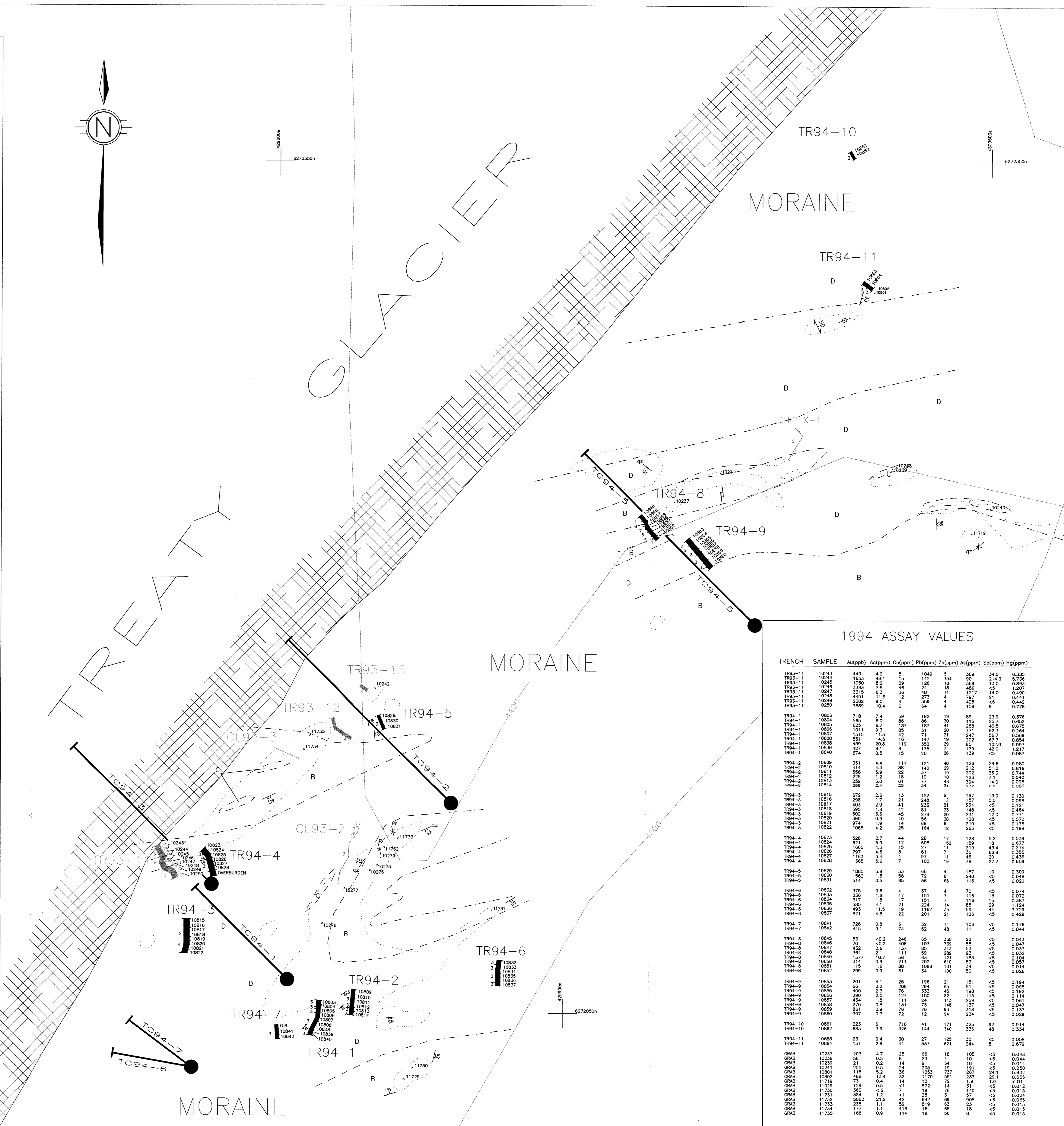

1994 ASSAY VALUES

| TRENCH | SAMPLE | Au(ppb) | Ag(ppm) | Cu(ppm) | Pb(ppm) | Zn(ppm) | As(ppm) | Sb(ppm) | Hg(ppm) |
|---------|--------|---------|---------|---------|---------|---------|---------|---------|---------|
| TR93-11 | 10243 | 443 | 4.2 | 8 | 1049 | 5 | 369 | 34.0 | 0.385 |
| TR93-11 | 10244 | 1653 | 48.1 | 15 | 142 | 154 | 90 | 214.0 | 5.736 |
| TR93-11 | 10245 | 1050 | 8.2 | 29 | 126 | 18 | 29 | 13.0 | 0.993 |
| TR93-11 | 10246 | 3395 | 7.5 | 46 | 24 | 18 | 488 | <5 | 1.207 |
| TR93-11 | 10247 | 3335 | 6.3 | 36 | 48 | 11 | 217 | 14.0 | 0.480 |
| TR93-11 | 10248 | 4491 | 11.6 | 12 | 273 | 4 | 797 | 21 | 0.441 |
| TR93-11 | 10249 | 2302 | 3.0 | 4 | 359 | 4 | 425 | <5 | 0.442 |
| TR93-11 | 10250 | 7889 | 10.4 | 6 | 64 | 4 | 159 | 9 | 0.778 |
| TR94-1 | 10803 | 718 | 7.4 | 59 | 192 | 19 | 89 | 23.9 | 0.376 |
| TR94-1 | 10804 | 565 | 6.0 | 86 | 86 | 30 | 115 | 25.7 | 0.652 |
| TR94-1 | 10805 | 625 | 6.7 | 187 | 187 | 41 | 288 | 40.5 | 0.675 |
| TR94-1 | 10806 | 1011 | 9.3 | 85 | 31 | 20 | 171 | 62.3 | 0.284 |
| TR94-1 | 10807 | 1515 | 11.5 | 42 | 71 | 21 | 247 | 58.7 | 0.569 |
| TR94-1 | 10808 | 551 | 14.5 | 16 | 147 | 19 | 202 | 67.7 | 0.854 |
| TR94-1 | 10838 | 459 | 20.8 | 119 | 352 | 29 | 85 | 162.0 | 5.997 |
| TR94-1 | 10839 | 427 | 8.1 | 1 | 135 | 7 | 179 | 42.0 | 1.217 |
| TR94-1 | 10840 | 674 | 0.5 | 15 | 20 | 26 | 139 | <5 | 0.087 |
| TR94-2 | 10809 | 351 | 4.4 | 111 | 121 | 40 | 126 | 29.6 | 0.980 |
| TR94-2 | 10810 | 414 | 4.3 | 88 | 140 | 29 | 212 | 51.2 | 0.816 |
| TR94-2 | 10811 | 556 | 5.9 | 22 | 37 | 10 | 202 | 36.0 | 0.744 |
| TR94-2 | 10812 | 225 | 1.2 | 18 | 19 | 10 | 128 | 7.1 | 0.042 |
| TR94-2 | 10813 | 259 | 3.0 | 61 | 77 | 14 | 384 | 14.0 | 0.088 |
| TR94-2 | 10814 | 258 | 2.4 | 23 | 34 | 31 | 137 | 8.2 | 0.086 |
| TR94-3 | 10815 | 672 | 2.6 | 13 | 152 | 6 | 197 | 13.0 | 0.130 |
| TR94-3 | 10816 | 398 | 1.7 | 21 | 248 | 12 | 157 | 5.0 | 0.098 |
| TR94-3 | 10817 | 403 | 2.9 | 41 | 236 | 21 | 224 | <5 | 0.121 |
| TR94-3 | 10818 | 395 | 1.8 | 45 | 91 | 23 | 148 | <5 | 0.464 |
| TR94-3 | 10819 | 602 | 3.6 | 45 | 87 | 20 | 231 | 12.0 | 0.771 |
| TR94-3 | 10820 | 390 | 0.9 | 40 | 56 | 28 | 128 | <5 | 0.072 |
| TR94-3 | 10821 | 374 | 1.9 | 14 | 69 | 6 | 110 | 5 | 0.175 |
| TR94-3 | 10822 | 1065 | 4.2 | 25 | 164 | 12 | 265 | <5 | 0.198 |
| TR94-4 | 10823 | 528 | 2.7 | 44 | 28 | 17 | 128 | 5.2 | 0.039 |
| TR94-4 | 10824 | 621 | 5.9 | 17 | 505 | 152 | 189 | 18 | 0.677 |
| TR94-4 | 10825 | 1665 | 4.3 | 15 | 27 | 11 | 219 | 15.4 | 0.274 |
| TR94-4 | 10826 | 797 | 4.6 | 3 | 61 | 7 | 35 | 66.9 | 0.355 |
| TR94-4 | 10827 | 1163 | 3.4 | 4 | 97 | 11 | 46 | 25 | 1.124 |
| TR94-4 | 10828 | 1365 | 5.6 | 7 | 100 | 19 | 78 | 27.7 | 0.659 |
| TR94-5 | 10829 | 1885 | 5.9 | 33 | 66 | 4 | 187 | 10 | 0.309 |
| TR94-5 | 10830 | 1562 | 1.5 | 58 | 79 | 6 | 240 | <5 | 0.048 |
| TR94-5 | 10831 | 514 | 0.5 | 65 | 56 | 66 | 115 | <5 | 0.020 |
| TR94-6 | 10832 | 375 | 0.6 | 4 | 37 | 4 | 70 | <5 | 0.074 |
| TR94-6 | 10833 | 236 | 1.8 | 17 | 151 | 7 | 116 | 15 | 0.072 |
| TR94-6 | 10834 | 317 | 1.8 | 17 | 151 | 7 | 116 | 15 | 0.387 |
| TR94-6 | 10835 | 585 | 4.1 | 23 | 224 | 14 | 85 | 28 | 1.124 |
| TR94-6 | 10836 | 493 | 11.5 | 19 | 1162 | 35 | 59 | 44 | 3.729 |
| TR94-6 | 10837 | 621 | 4.5 | 22 | 201 | 21 | 126 | <5 | 0.428 |
| TR94-7 | 10841 | 726 | 0.8 | 6 | 32 | 14 | 116 | <5 | 0.178 |
| TR94-7 | 10842 | 445 | 0.1 | 74 | 52 | 48 | 11 | 5 | 0.944 |
| TR94-8 | 10845 | 53 | <0.2 | 246 | 65 | 350 | 22 | <5 | 0.043 |
| TR94-8 | 10846 | 70 | <0.2 | 406 | 103 | 739 | 55 | <5 | 0.047 |
| TR94-8 | 10847 | 432 | 0.5 | 137 | 85 | 143 | 82 | <5 | 0.033 |
| TR94-8 | 10848 | 364 | 2.1 | 111 | 59 | 289 | 93 | <5 | 0.032 |
| TR94-8 | 10849 | 1377 | 10.7 | 56 | 83 | 121 | 183 | <5 | 0.104 |
| TR94-8 | 10850 | 314 | 0.9 | 211 | 202 | 610 | 29 | <5 | 0.057 |
| TR94-8 | 10851 | 115 | 1.6 | 86 | 1088 | 101 | 34 | <5 | 0.014 |
| TR94-8 | 10852 | 299 | 0.9 | 61 | 34 | 100 | 50 | <5 | 0.026 |
| TR94-9 | 10853 | 201 | 4.1 | 25 | 196 | 21 | 151 | <5 | 0.194 |
| TR94-9 | 10854 | 66 | 0.2 | 208 | 294 | 65 | 11 | <5 | 0.098 |
| TR94-9 | 10855 | 400 | 2.3 | 76 | 333 | 45 | 198 | <5 | 0.192 |
| TR94-9 | 10856 | 290 | 0.0 | 127 | 150 | 82 | 61 | <5 | 0.114 |
| TR94-9 | 10857 | 434 | 1.8 | 111 | 24 | 113 | 259 | <5 | 0.061 |
| TR94-9 | 10858 | 270 | 0.8 | 181 | 73 | 148 | 37 | <5 | 0.047 |
| TR94-9 | 10859 | 861 | 2.9 | 76 | 76 | 93 | 318 | <5 | 0.137 |
| TR94-9 | 10860 | 597 | 0.7 | 72 | 12 | 94 | 234 | <5 | 0.029 |
| TR94-10 | 10861 | 223 | 6 | 710 | 41 | 171 | 325 | 92 | 0.914 |
| TR94-10 | 10862 | 683 | 3.9 | 326 | 144 | 140 | 336 | 48 | 0.334 |
| TR94-11 | 10863 | 23 | 0.4 | 30 | 27 | 125 | 30 | <5 | 0.058 |
| TR94-11 | 10864 | 151 | 2.9 | 44 | 337 | 621 | 244 | 8 | 0.679 |
| GRAB | 10237 | 203 | 4.7 | 25 | 66 | 18 | 105 | <5 | 0.048 |
| GRAB | 10238 | 58 | 0.5 | 6 | 23 | 4 | 10 | <5 | 0.044 |
| GRAB | 10239 | 21 | 0.2 | 14 | 9 | 4 | 18 | <5 | 0.014 |
| GRAB | 10241 | 285 | 0.5 | 14 | 205 | 19 | 91 | <5 | 0.250 |
| GRAB | 10801 | 118 | 5.2 | 36 | 1053 | 737 | 267 | 24.1 | 0.932 |
| GRAB | 10802 | 488 | 1.5 | 32 | 1170 | 351 | 233 | 29.1 | 0.666 |
| GRAB | 11719 | 73 | 0.4 | 14 | 12 | 72 | 1.9 | 1.9 | <0.1 |
| GRAB | 11029 | 129 | 0.5 | <1 | 572 | 14 | 31 | <5 | 0.012 |
| GRAB | 11730 | 380 | <2 | 7 | 19 | 78 | 140 | <5 | 0.015 |
| GRAB | 11731 | 194 | 2.2 | 1 | 28 | 1 | 37 | <5 | 0.024 |
| GRAB | 11732 | 5082 | 2.2 | 42 | 642 | 69 | 905 | <5 | 0.085 |
| GRAB | 11733 | 239 | 1.1 | 69 | 819 | 63 | 28 | <5 | 0.015 |
| GRAB | 11734 | 173 | 1.1 | 416 | 16 | 68 | 18 | <5 | 0.015 |
| GRAB | 11735 | 168 | 0.9 | 114 | 18 | 56 | 6 | <5 | 0.013 |

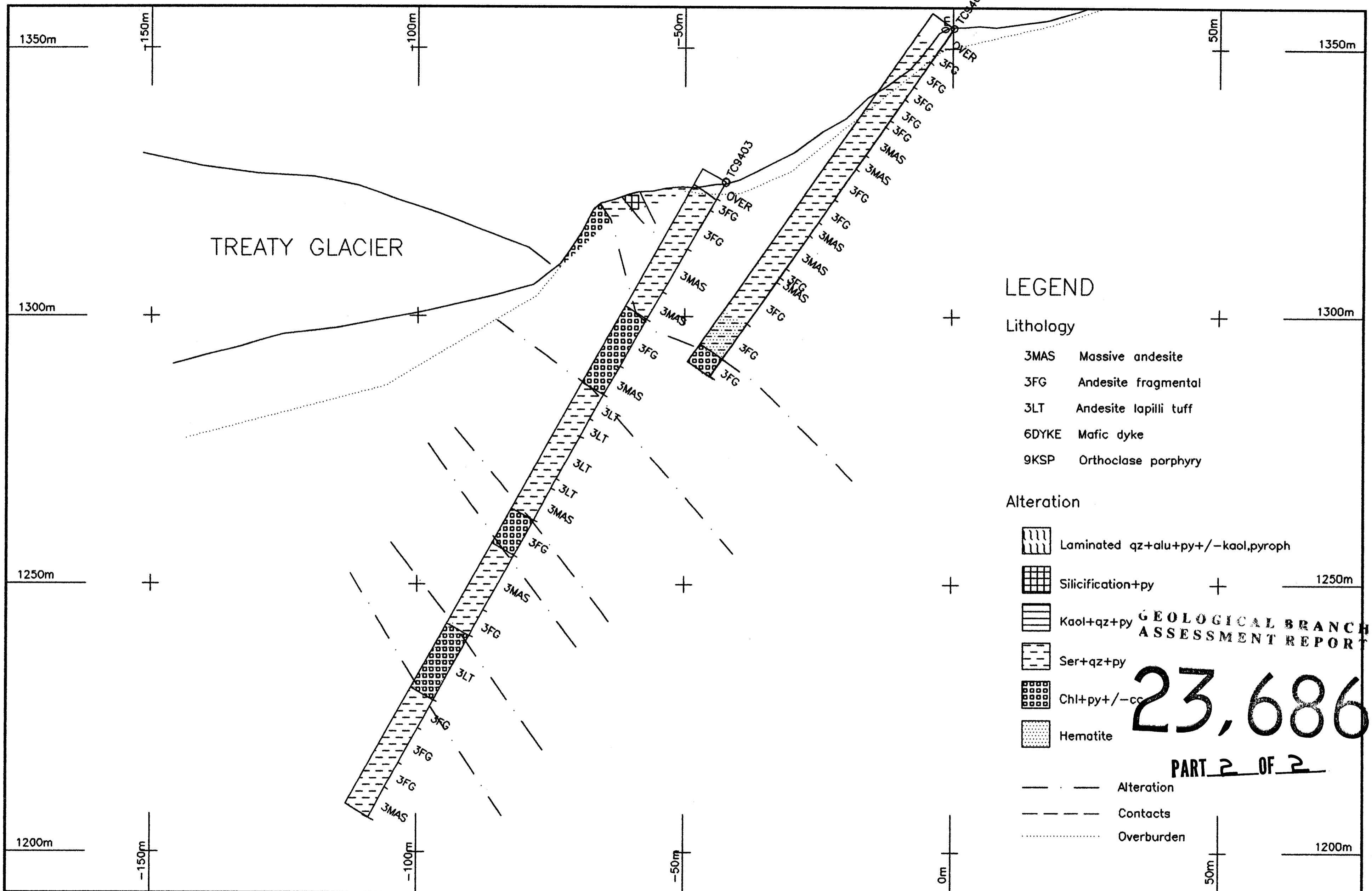

LEGEND

- Lithology**
- 3MAS Massive andesite
 - 3FG Andesite fragmental
 - 3LT Andesite lapilli tuff
 - 6DYKE Mafic dyke
 - 9KSP Orthoclase porphyry

- Alteration**
- Laminated qz+alu+py+/-kaol,pyroph
 - Silicification+py
 - Kaol+qz+py
 - Ser+qz+py
 - Chl+py+/-cc
 - Hematite

- Alteration
- Contacts
- Overburden

**GEOLOGICAL BRANCH
ASSESSMENT REPORT**

23,686

PART 2 OF 2

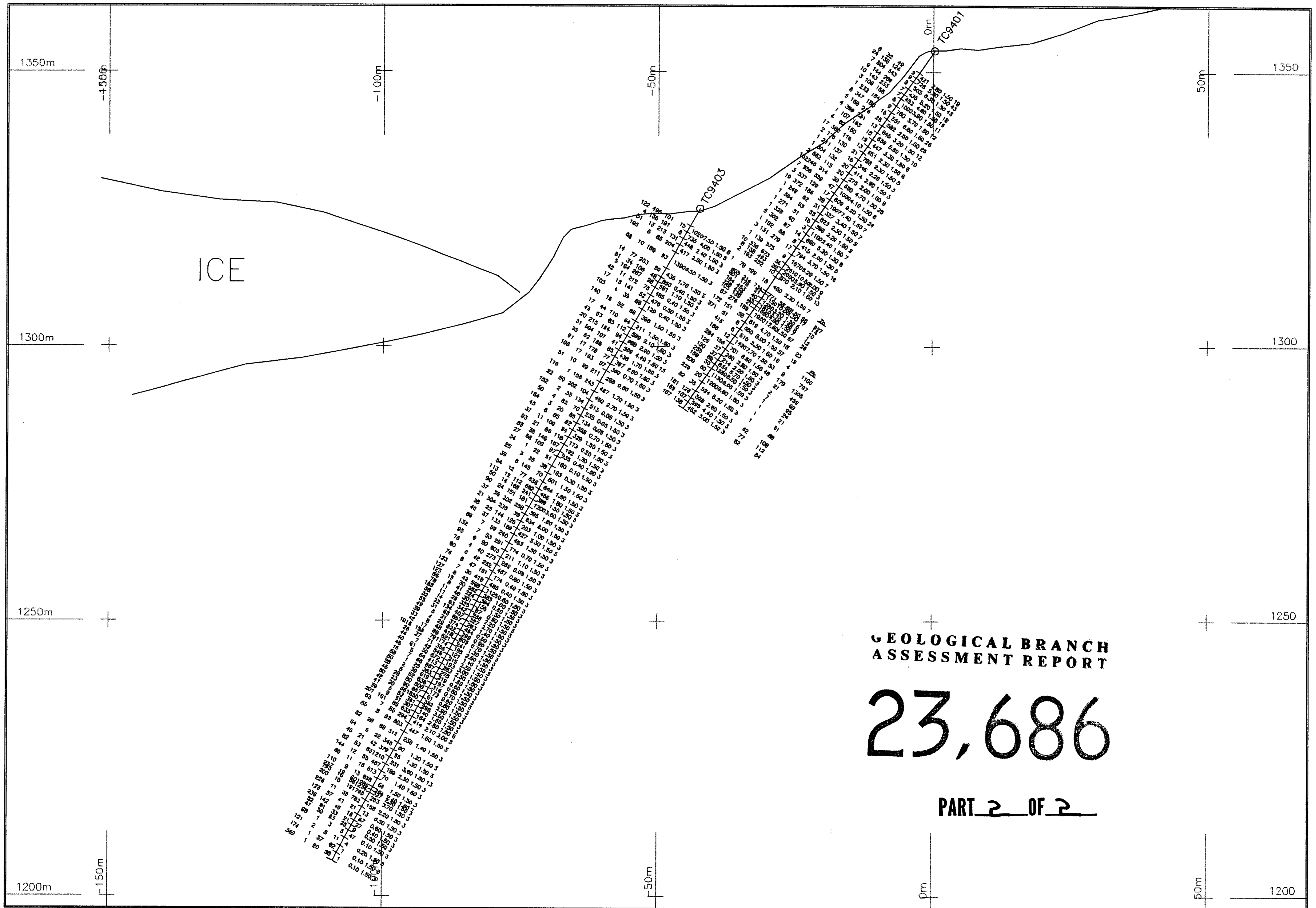

**GEOLOGICAL BRANCH
ASSESSMENT REPORT**

23,686

PART 2 OF 2

I:\104B\104BPROP\TREATY\SECTIONS\ASS1_3.DWG

NOTES :
ppmZn ppmPb ppmAs ppmCu ppmAu ppmAg ppmHg ppmSb

| | | |
|----------------|------------------|-----------------|
| SCALE 1:500 | DATE 24/11/94 | SHEET 1 of 1 |
| | REF No. | Figure 4.3 |

SECTION LOOKING AZ. 045
1994 DRILLING
TREATY CLAIMS
DDH94-01, DDH94-03

HOMESTAKE CANADA INC.
Exploration Division

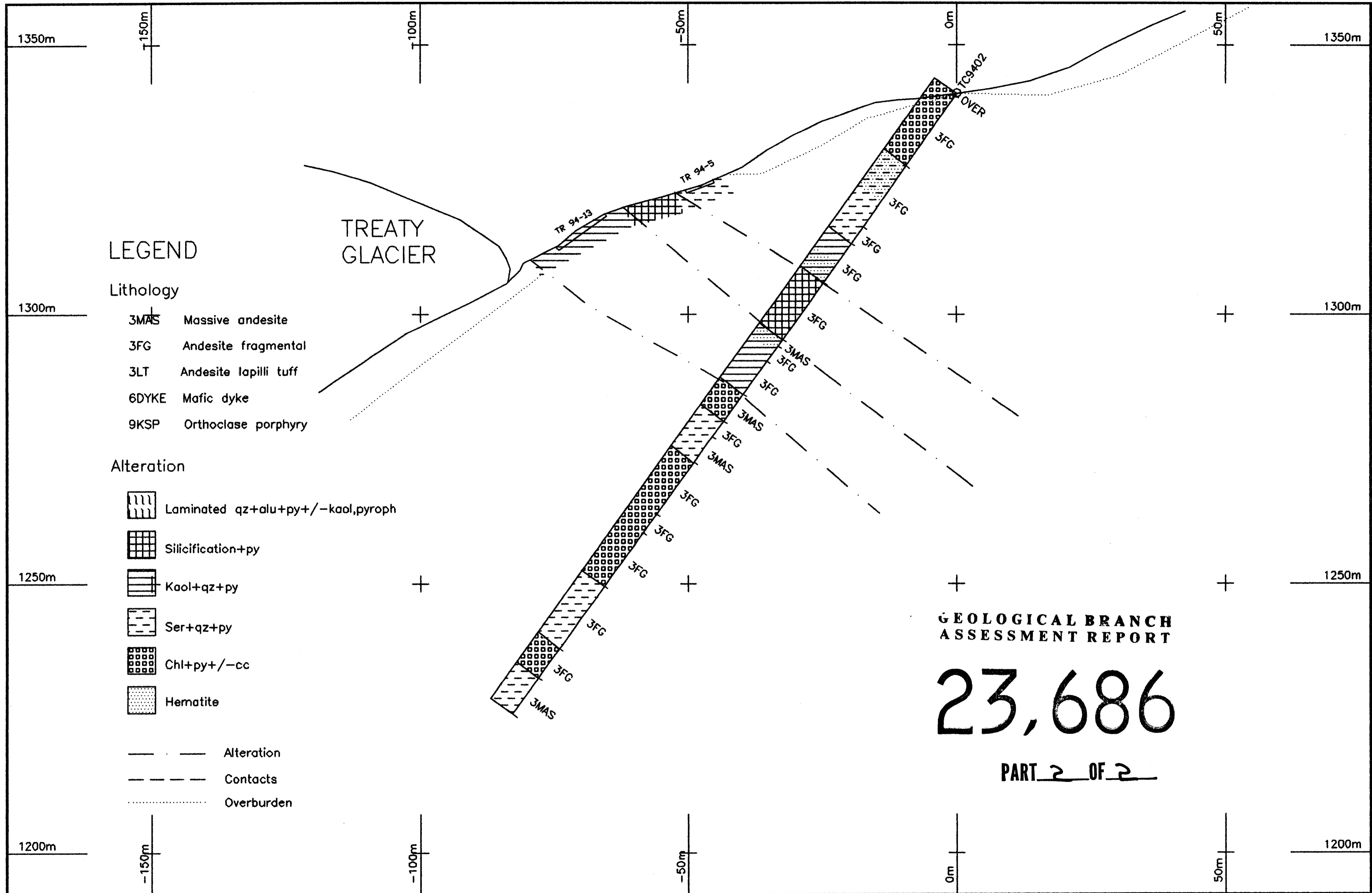

LEGEND

Lithology

- 3MAS Massive andesite
- 3FG Andesite fragmental
- 3LT Andesite lapilli tuff
- 6DYKE Mafic dyke
- 9KSP Orthoclase porphyry

Alteration

- Laminated qz+alu+py+/-kaol,pyroph
- Silicification+py
- Kaol+qz+py
- Ser+qz+py
- Chl+py+/-cc
- Hematite

- Alteration
- Contacts
- Overburden

**GEOLOGICAL BRANCH
ASSESSMENT REPORT**

23,686

PART 2 OF 2

| | | |
|----------------|------------------|-----------------|
| SCALE 1:500 | DATE 25/11/94 | SHEET 1 of 1 |
| | REF No. | Figure 4.4 |
| 0 37.50 m | | |

**SECTION LOOKING AZ. 045
1994 DRILLING
TREATY CLAIMS
DDH94-02**

HOMESTAKE CANADA INC.
Exploration Division *OK*

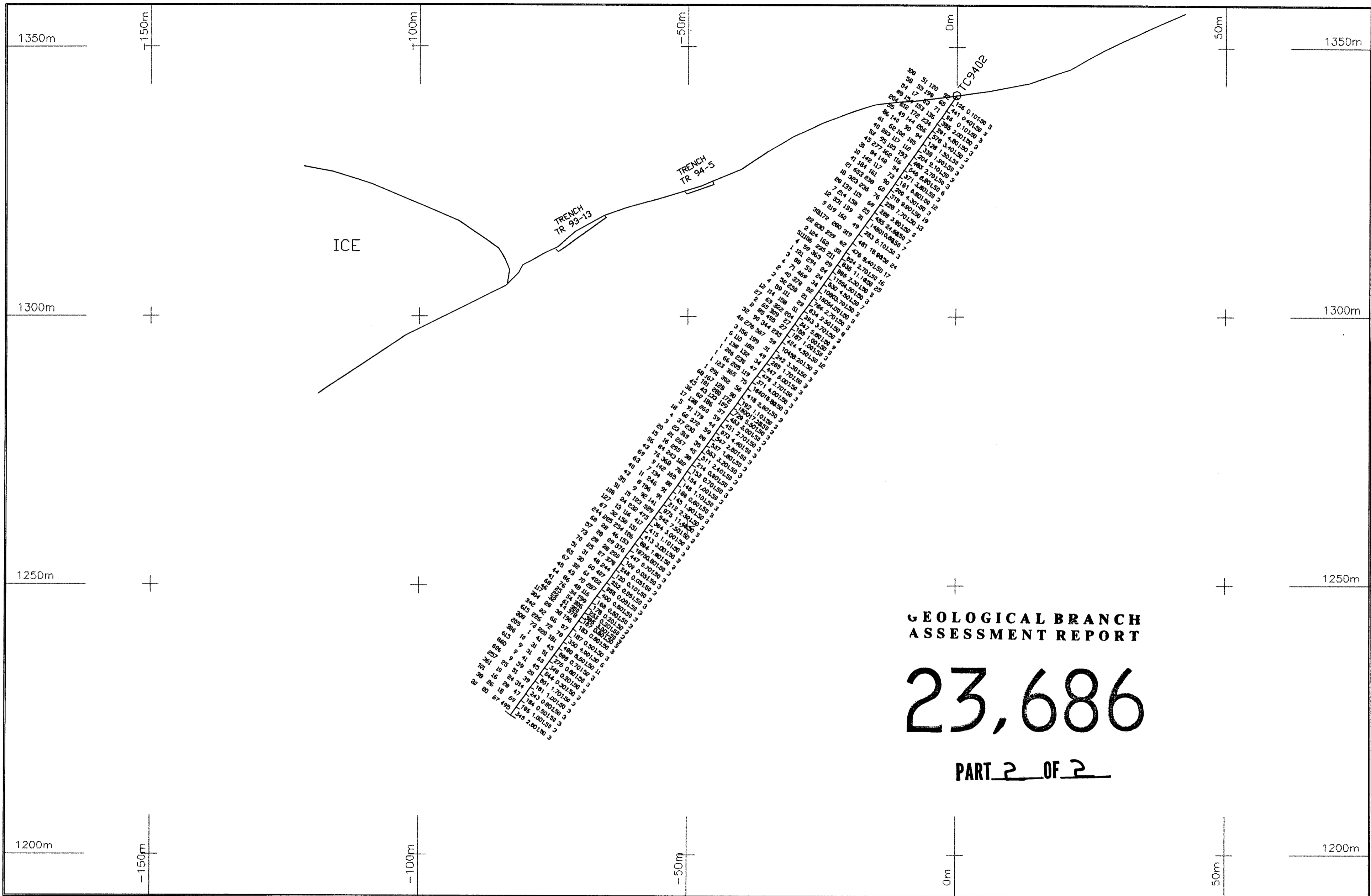

**GEOLOGICAL BRANCH
ASSESSMENT REPORT**

23,686

PART 2 OF 2

| | | | | | | |
|---|---|---------|----------|------------|---|---|
| I:\104B\104BPROP\TREATY\SECTIONS\ASS2.DWG | ppmZn ppmPb ppmAs ppmCu ppmAu ppmAg ppmHg ppmSb | SCALE | DATE | SHEET | SECTION LOOKING AZ. 045 1994 DRILLING TREATY CLAIMS DDH94-02 | HOMESTAKE CANADA INC. Exploration Division <i>OK</i> |
| | | 1:500 | 24/11/94 | 1 of 1 | | |
| | | REF No. | | Figure 4.5 | | |
| | | 0 | | 37.50 m | | |

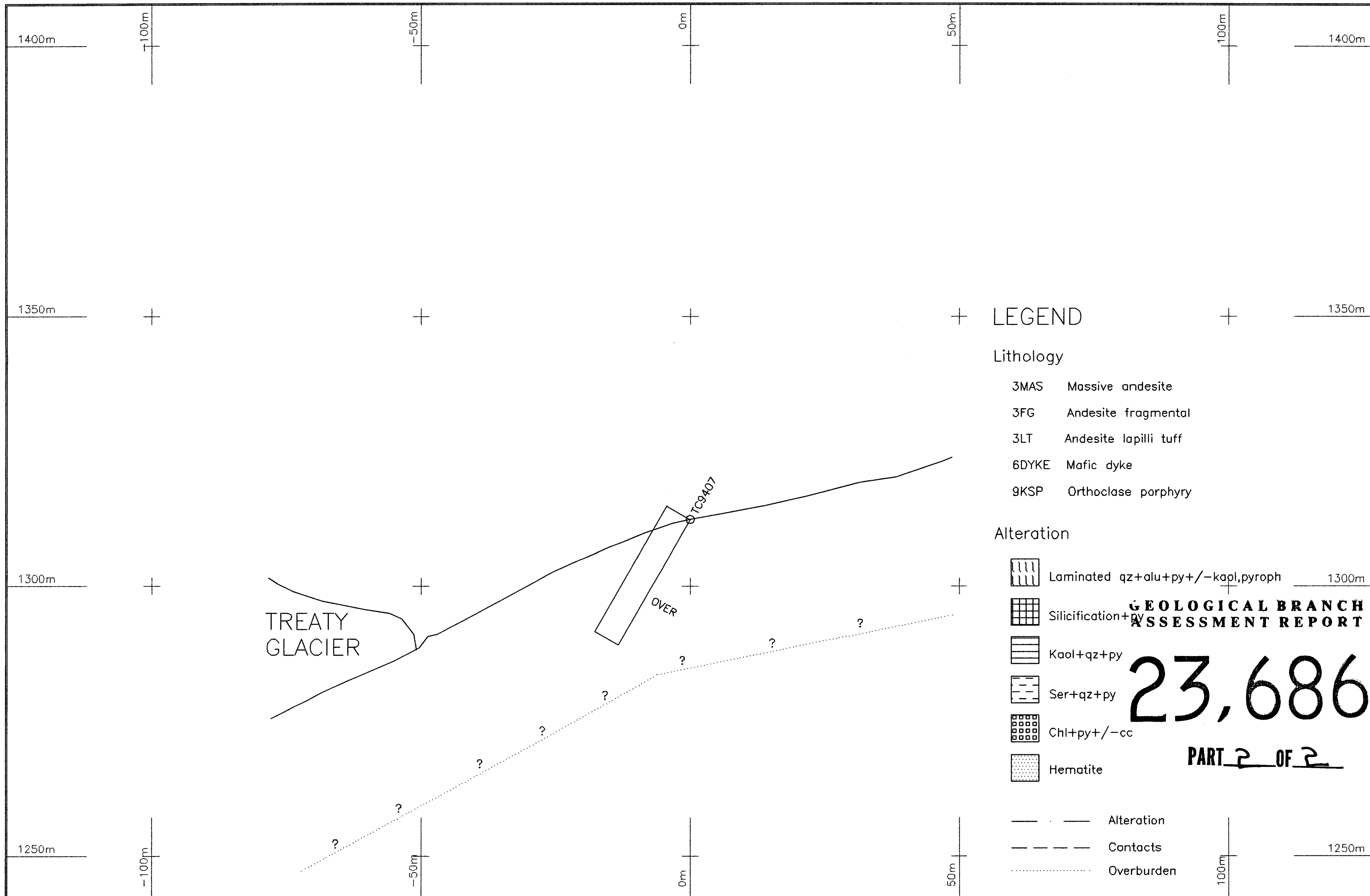

H:\104B\104BPROP\TREATY\SECTIONS\GEO4.DWG

SCALE 1:500

DATE 25/11/94

SHEET 1 of 1

FIGURE 4.6

0 37.50 m

SECTION LOOKING AZ. 045

1994 DRILLING TREATY CLAIMS DDH94-04

HOMESTAKE CANADA INC.

Exploration Division *DK*

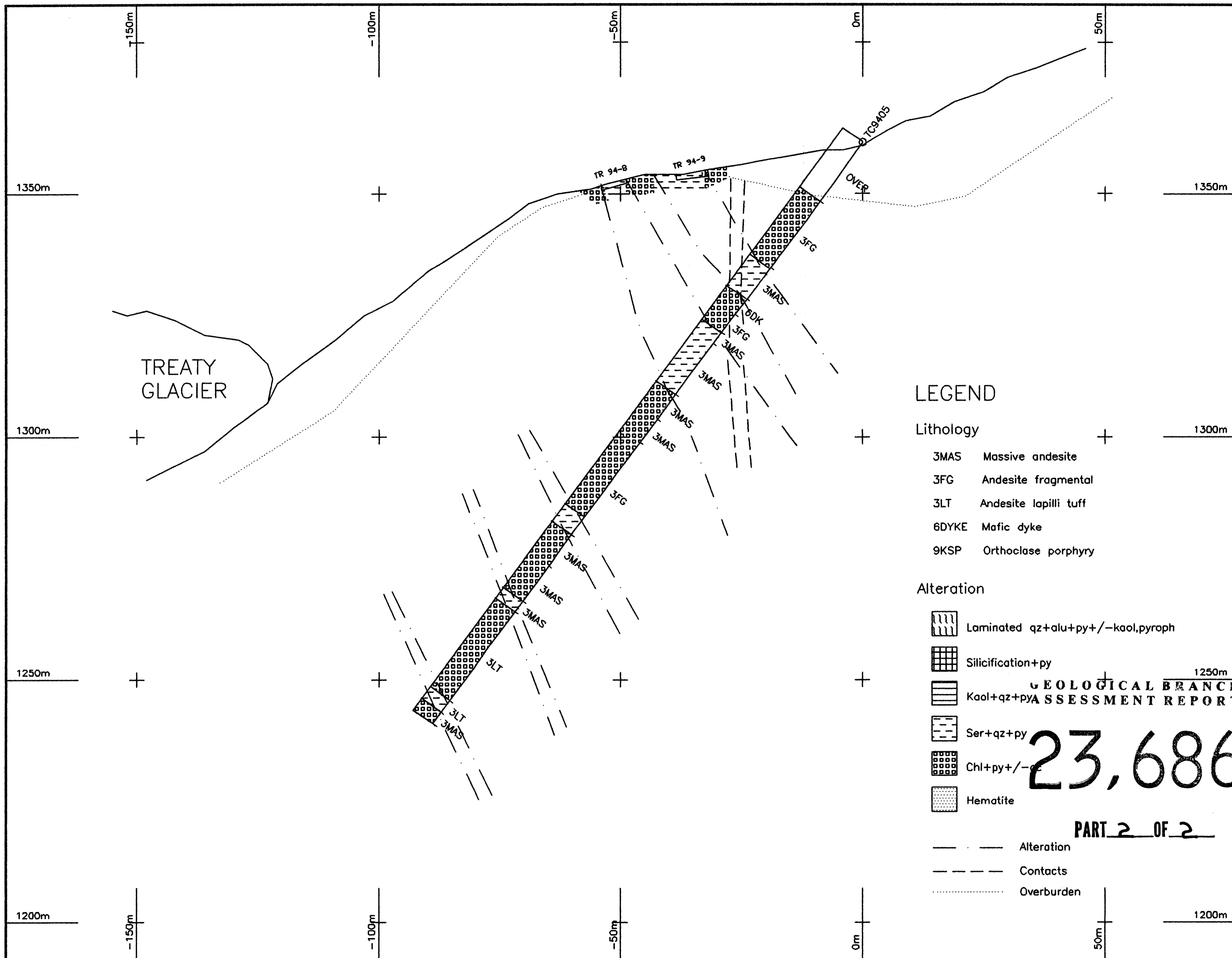

LEGEND

Lithology

- 3MAS Massive andesite
- 3FG Andesite fragmental
- 3LT Andesite lapilli tuff
- 6DYKE Mafic dyke
- 9KSP Orthoclase porphyry

Alteration

- Laminated qz+alu+py+/-kaol,pyroph
- Silicification+py
- Kaol+qz+py
- Ser+qz+py
- Chl+py+/-
- Hematite

- Alteration
- Contacts
- Overburden

23,686

PART 2 OF 2

GEOLOGICAL BRANCH
ASSESSMENT REPORT

| | | | | | | |
|--|--|------------------------|--------------------------------------|--|---|---|
| <p>I:\104B\104BPROP\TREATY\SECTIONS\GE05.DWG</p> | | <p>SCALE 1:500</p> | <p>DATE 25/11/94 REF No.</p> | <p>SHEET 1 of 1 Figure 4.7</p> | <p>SECTION LOOKING AZ. 045 1994 DRILLING TREATY CLAIMS DDH94-05</p> | <p>HOMESTAKE CANADA INC. Exploration Division</p> |
|--|--|------------------------|--------------------------------------|--|---|---|

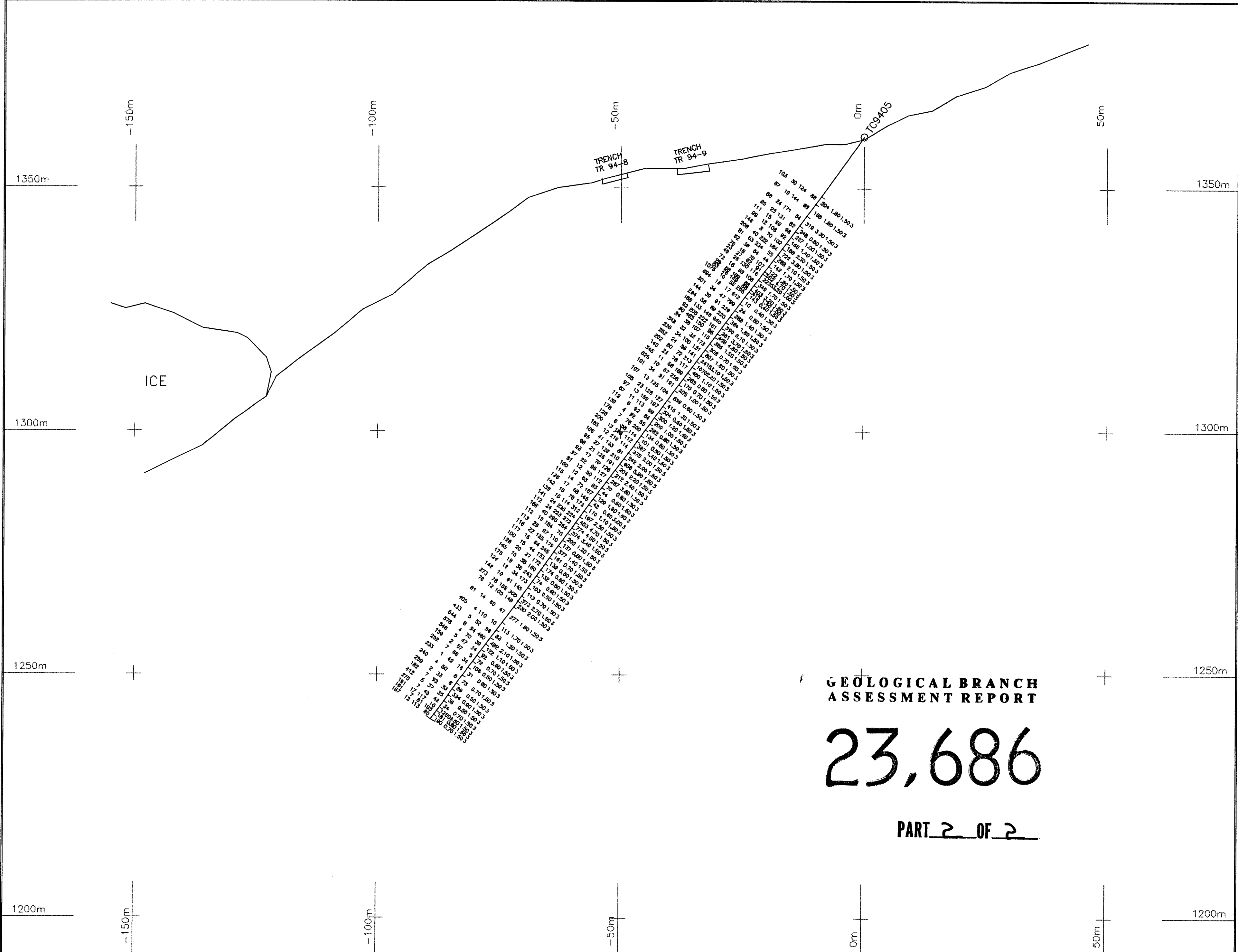

GEOLOGICAL BRANCH
ASSESSMENT REPORT

23,686

PART 2 OF 2

| | | | | | | |
|---|---|---------|----------|------------|---|---|
| I:\1048\104BPROP\TREATY\SECTIONS\ASS5.DWG | ppmZn ppmPb ppmAs ppmCu ppbAu ppmAg ppmHg ppmSb | SCALE | DATE | SHEET | SECTION LOOKING AZ. 045 1994 DRILLING TREATY CLAIMS DDH94-05 | HOMESTAKE CANADA INC. Exploration Division |
| | | 1:500 | 24/11/94 | 1 of 1 | | |
| | | REF No. | | Figure 4.8 | | |
| | | 0 | | 37.50 m | | |

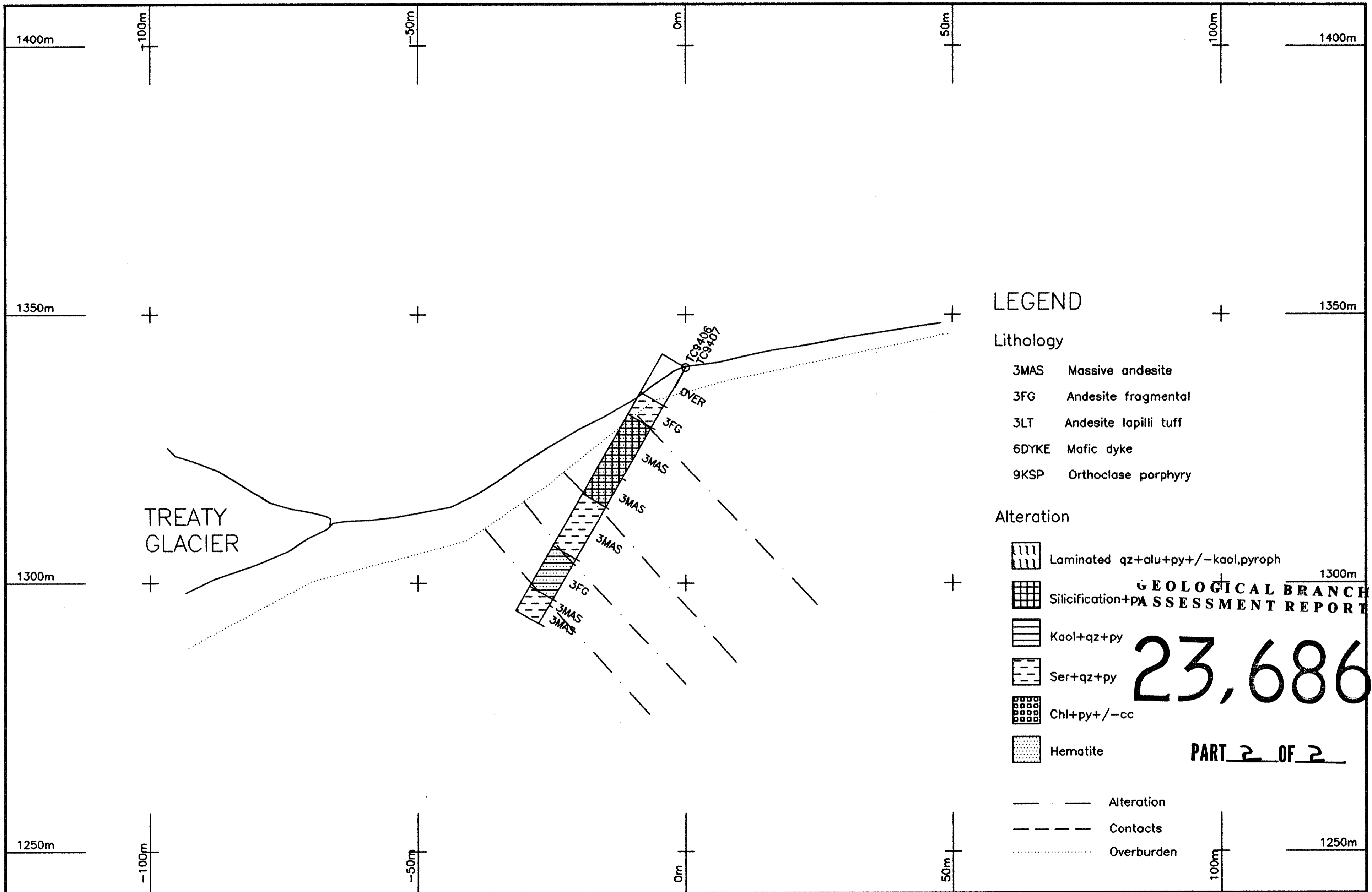

| | | | | | |
|---|-------|----------|------------|---|---|
| I:\104B\104BPROP\TREATY\SECTIONS\GED6.DWG | SCALE | DATE | SHEET | SECTION LOOKING AZ. 010 1994 DRILLING TREATY CLAIMS DDH94-06 | HOMESTAKE CANADA INC. Exploration Division <i>OK</i> |
| | 1:500 | 25/11/94 | 1 of 1 | | |
| | | REF No. | Figure 4.9 | | |
| | | | 37.50 m | | |

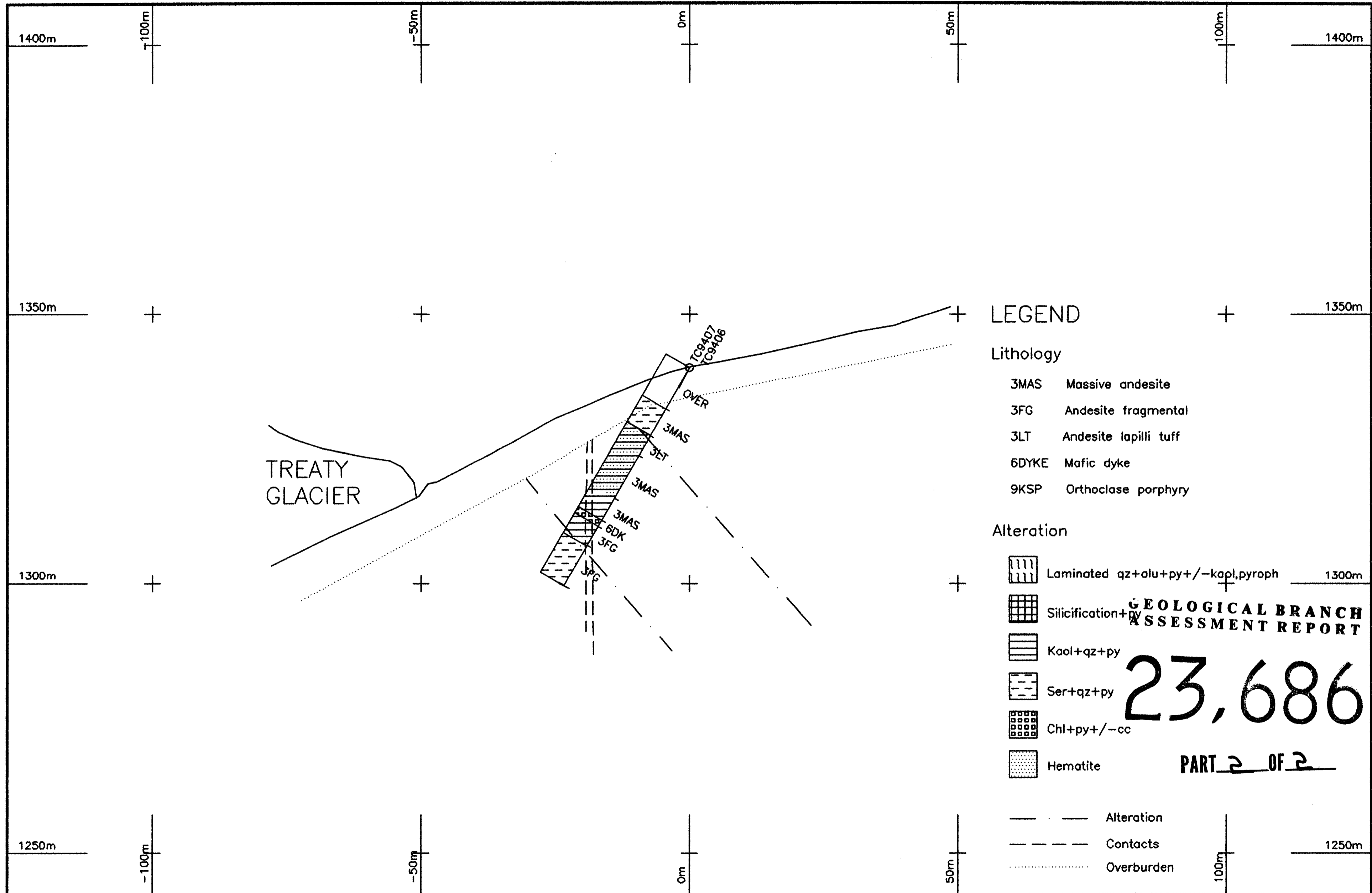

| | | | | | |
|---|----------------|------------------|-----------------|---|---|
| I:\104B\104BPROP\TREATY\SECTIONS\GEO7.DWG | SCALE 1:500 | DATE 25/11/94 | SHEET 1 of 1 | SECTION LOOKING AZ. 037 1994 DRILLING TREATY CLAIMS DDH94-07 | HOMESTAKE CANADA INC. Exploration Division <i>DK</i> |
| | | REF No. | Figure 4.11 | | |
| | | | | | |

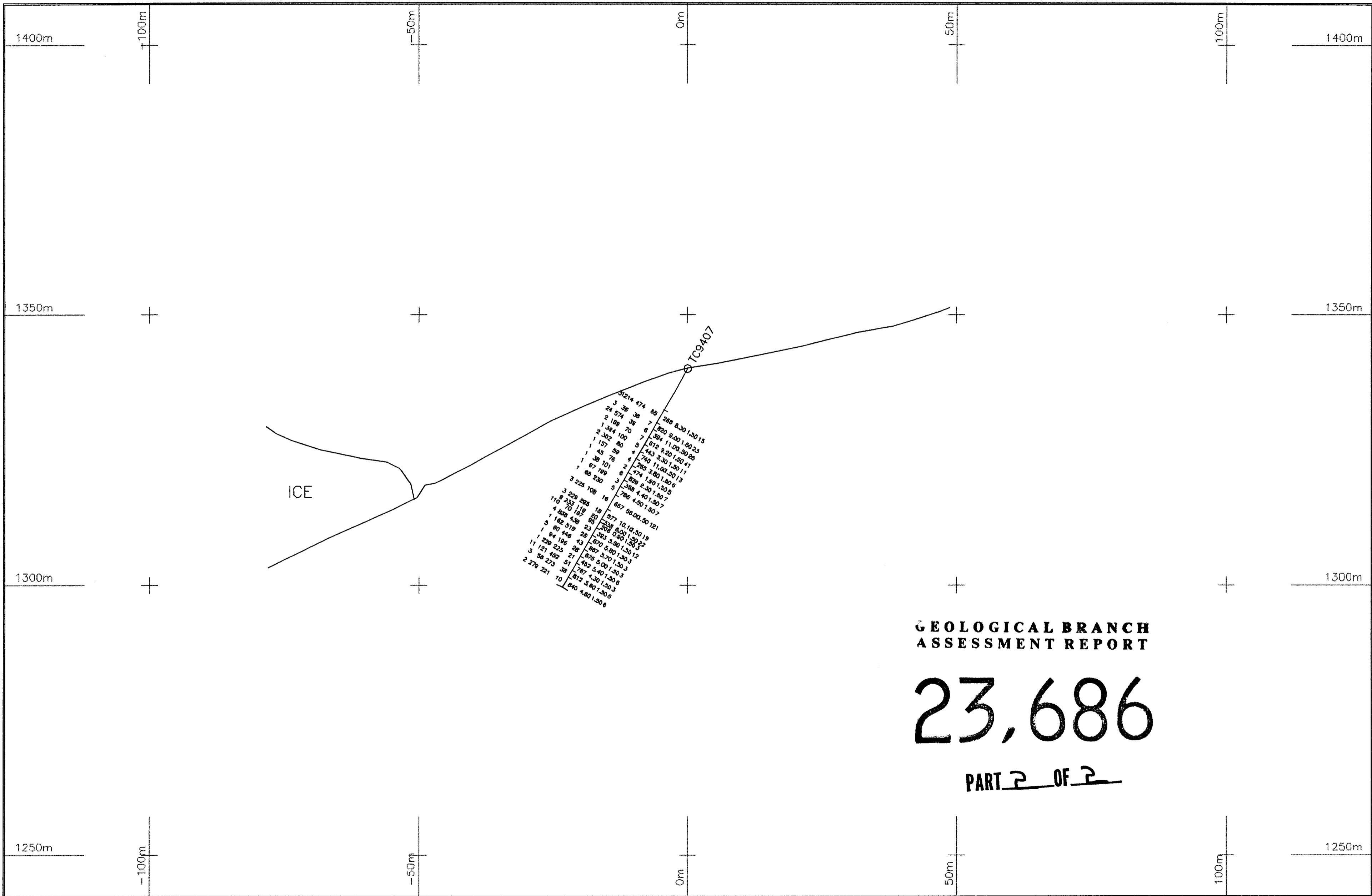

| | | | | | | | |
|----|-----|-----|----|-----|-------|------|-----|
| 3 | 214 | 474 | 69 | 268 | 8.30 | 1.50 | 15 |
| 24 | 36 | 38 | 7 | 820 | 8.00 | 1.50 | 23 |
| 2 | 188 | 38 | 6 | 384 | 11.00 | 80 | 26 |
| 1 | 344 | 100 | 7 | 512 | 9.20 | 1.50 | 41 |
| 2 | 302 | 80 | 5 | 743 | 3.30 | 1.50 | 11 |
| 1 | 151 | 58 | 4 | 740 | 11.00 | 1.50 | 11 |
| 1 | 45 | 76 | 4 | 285 | 3.80 | 1.50 | 13 |
| 1 | 36 | 101 | 2 | 474 | 1.80 | 1.50 | 9 |
| 1 | 67 | 78 | 6 | 838 | 2.30 | 1.50 | 5 |
| 1 | 65 | 230 | 3 | 388 | 4.40 | 1.50 | 7 |
| 3 | 228 | 108 | 16 | 786 | 1.50 | 1.50 | 7 |
| 3 | 228 | 288 | 18 | 657 | 58.00 | 50 | 121 |
| 8 | 330 | 119 | 50 | 577 | 10.10 | 1.50 | 18 |
| 4 | 888 | 181 | 60 | 338 | 8.00 | 1.50 | 22 |
| 1 | 162 | 438 | 60 | 201 | 0.80 | 1.50 | 52 |
| 5 | 80 | 448 | 28 | 383 | 5.90 | 1.50 | 5 |
| 1 | 94 | 198 | 43 | 870 | 5.80 | 1.50 | 12 |
| 1 | 228 | 225 | 28 | 587 | 3.70 | 1.50 | 3 |
| 1 | 121 | 452 | 21 | 485 | 5.00 | 1.50 | 3 |
| 3 | 58 | 273 | 38 | 787 | 4.30 | 1.50 | 8 |
| 2 | 278 | 221 | 10 | 812 | 3.80 | 1.50 | 5 |
| | | | | 840 | 4.80 | 1.50 | 8 |

GEOLOGICAL BRANCH
ASSESSMENT REPORT

23,686

PART 2 OF 2

| | | | | | | |
|--|--|---------|----------|-------------|---|--|
| <p>E:\1048\1048PROP\TREATY\SECTIONS\ASS7.DWG</p> | <p>ppmZn ppmPb ppmAs ppmCu ppbAu ppmAg ppmHg ppmSb</p> | SCALE | DATE | SHEET | <p>SECTION LOOKING AZ. 037 1994 DRILLING TREATY CLAIMS DDH94-07</p> | <p>HOMESTAKE CANADA INC. Exploration Division <i>D/L</i></p> |
| | | 1:500 | 24/11/94 | 1 of 1 | | |
| | | REF No. | | Figure 4.12 | | |
| | | 0 | | 37.50 m | | |

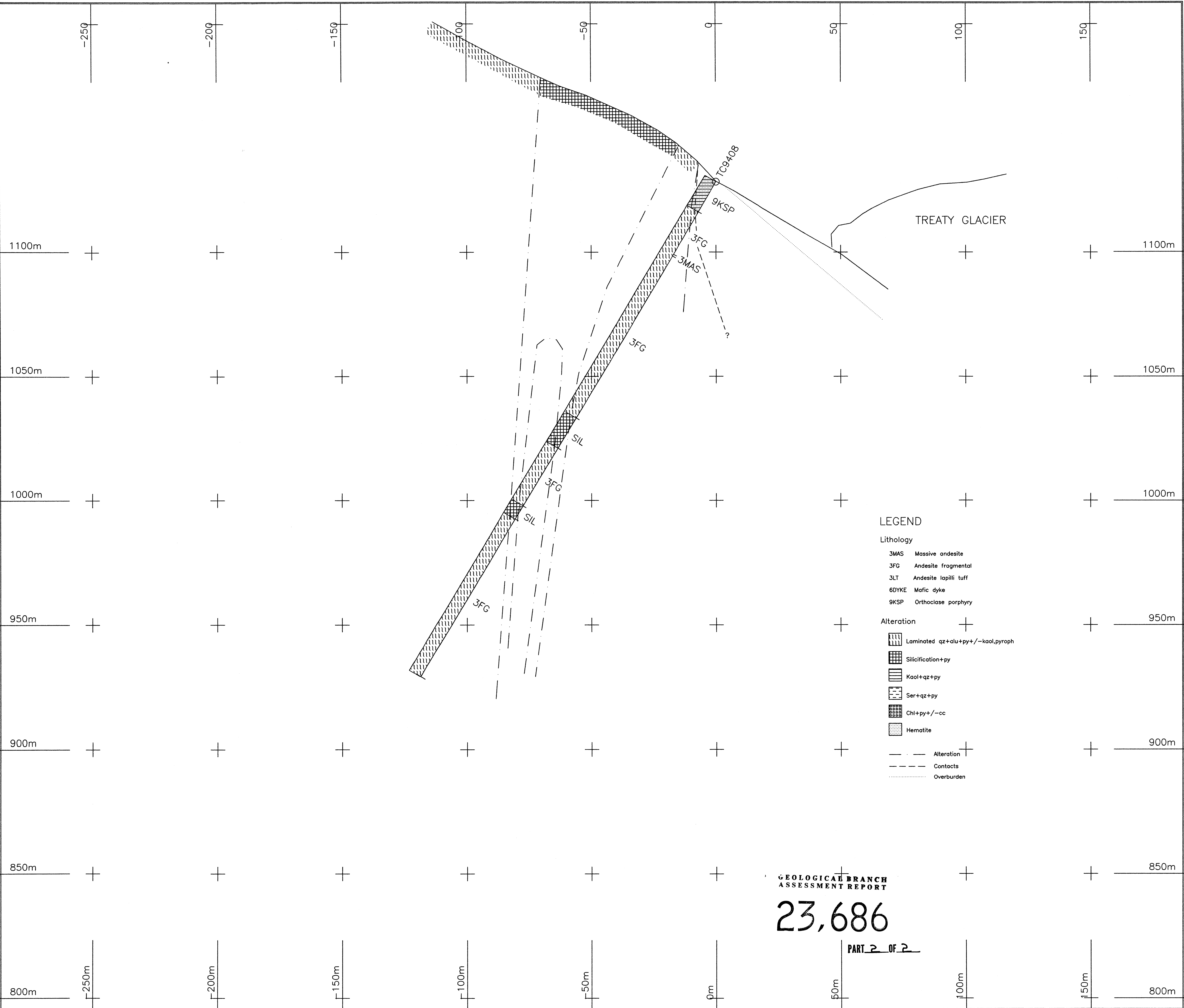

LEGEND

Lithology

- 3MAS Massive andesite
- 3FG Andesite fragmental
- 3LT Andesite lapilli tuff
- 6DYKE Mafic dyke
- 9KSP Orthoclase porphyry

Alteration

- [Symbol] Laminated qz+alu+py+/-kaol,pyroph
- [Symbol] Silicification+py
- [Symbol] Kaol+qz+py
- [Symbol] Ser+qz+py
- [Symbol] Chl+py+/-cc
- [Symbol] Hematite

--- Alteration
 - - - Contacts
 Overburden

GEOLOGICAL BRANCH
ASSESSMENT REPORT

23,686

PART 2 OF 2

| | | | | |
|----------------|------------------|-----------------|---|---|
| SCALE 1:500 | DATE 25/11/94 | SHEET 1 of 1 | SECTION LOOKING AZ. 035 1994 DRILLING TREATY CLAIMS DDH94-08 | HOMESTAKE CANADA INC. Exploration Division |
| | REF No. | Figure 4.14 | | |
| | | | | |

A:\1048\1048PROP\TREATY\SECTIONS\GEOL.DWG

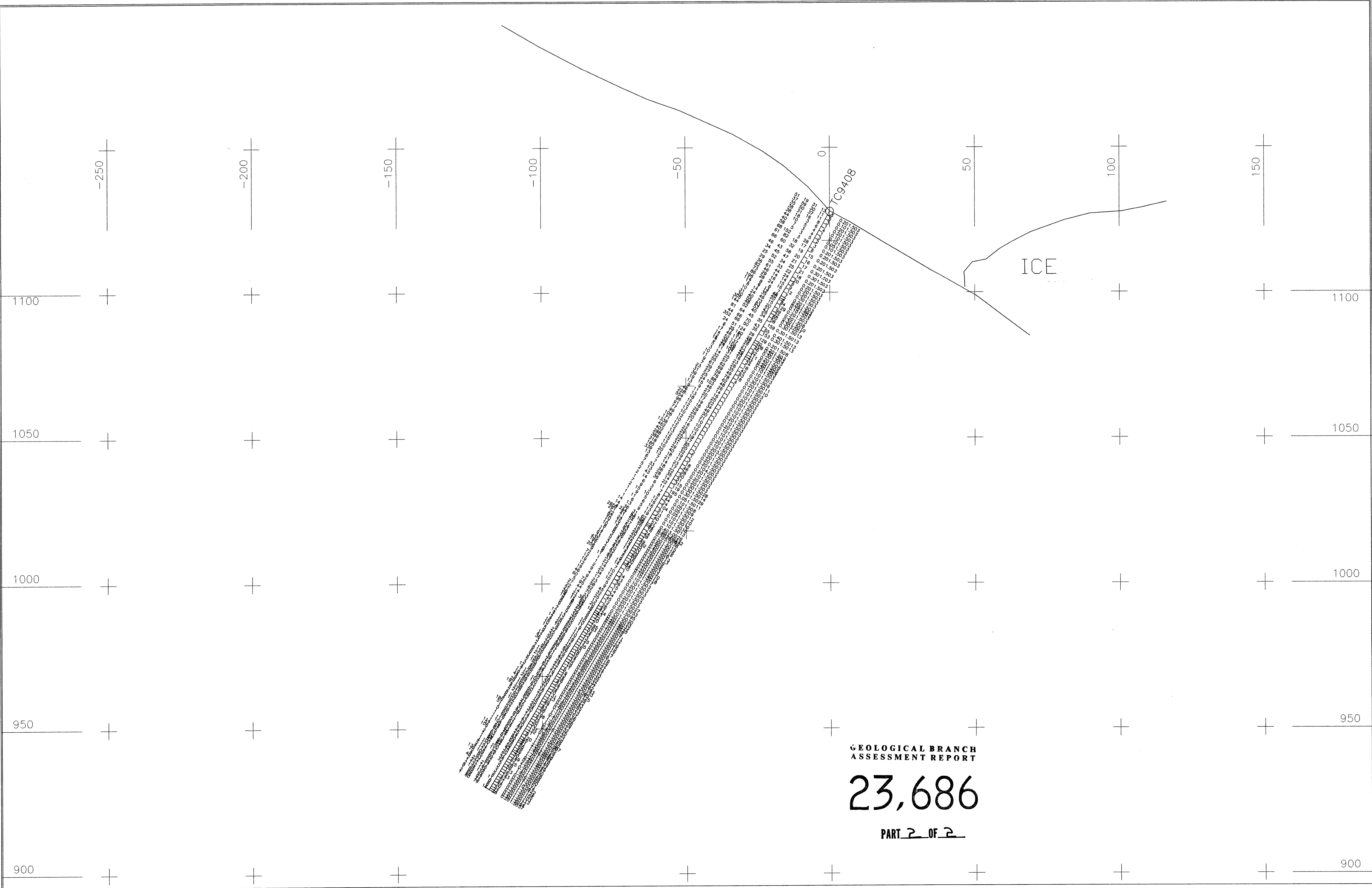

GEOLOGICAL BRANCH
ASSESSMENT REPORT

23,686

PART 2 OF 2

ppmZn ppmPb ppmAs ppmCu ppbAu ppmAg ppmHg ppmSb

| | | |
|----------------|------------------|-----------------|
| SCALE 1:500 | DATE 24/11/94 | SHEET 1 of 1 |
| | REF No. | Figure 4.15 |
| | | |

SECTION LOOKING AZ. 035
1994 DRILLING
TREATY CLAIMS
DDH94-08 *DK*

HOMESTAKE CANADA INC.
Exploration Division

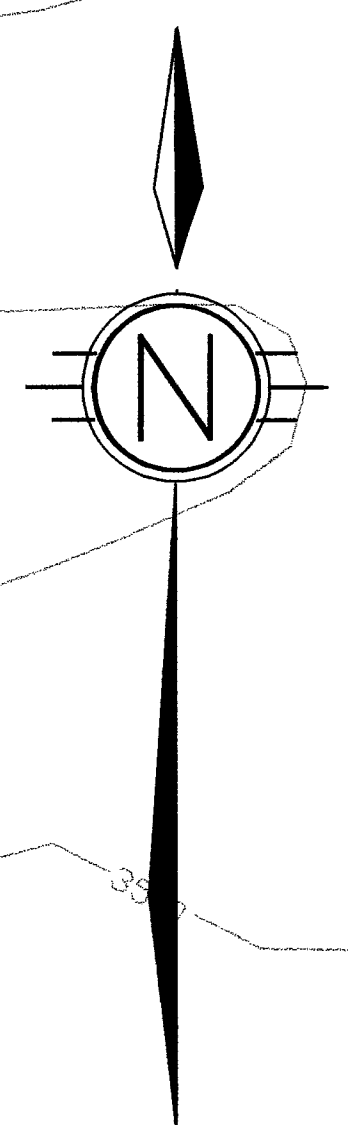
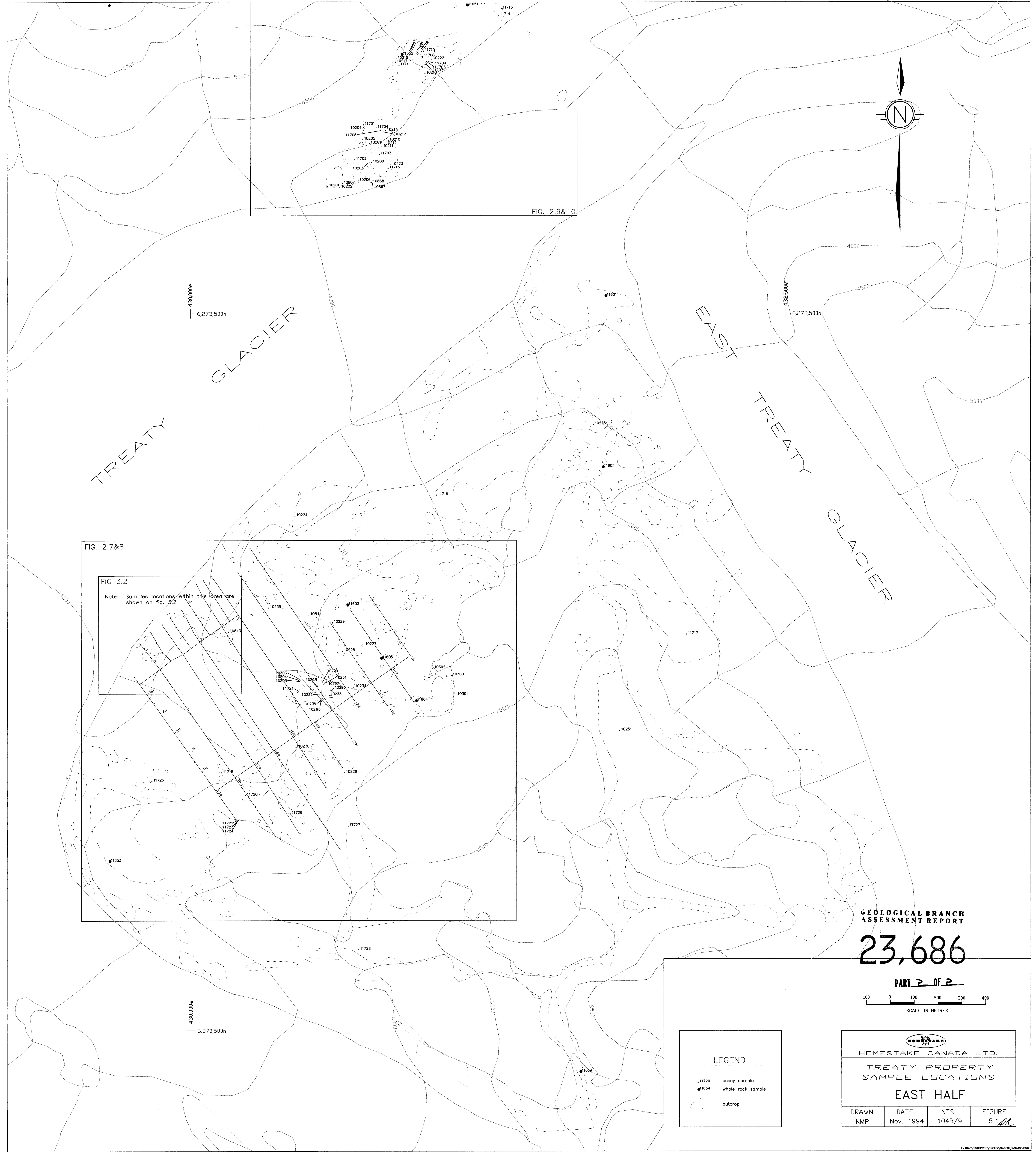

FIG. 2.9&10

430,000e
6,273,500n

430,000e
6,273,500n

FIG. 2.7&8

FIG 3.2

Note: Samples locations within this area are shown on fig. 3.2

GEOLOGICAL BRANCH
ASSESSMENT REPORT

23,686

PART 2 OF 2

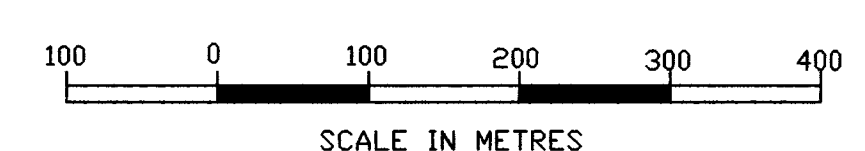

| LEGEND | |
|--------|-------------------|
| •11720 | assay sample |
| •1654 | whole rock sample |
| ○ | outcrop |

| | | | |
|---|-------------------|---------------|-------------------------|
| HOMESTAKE CANADA LTD. TREATY PROPERTY SAMPLE LOCATIONS EAST HALF | | | |
| DRAWN KMP | DATE Nov. 1994 | NTS 104B/9 | FIGURE 5.1 <i>AK</i> |



ATKINS

GR2 ZONE



GLACIER

RIDGE ZONE

GOAT TRAIL ZONE

AW ZONE

KONKIN PIT

GLACIER

TREATY

GEOLOGICAL BRANCH
ASSESSMENT REPORT

23,686

LEGEND

PART 2 OF 2

- .10309 assay sample
- outcrop



HOMESTAKE CANADA LTD.

TREATY PROPERTY
SAMPLES
WEST HALF

| DRAWN | DATE | NTS | FIGURE |
|-------|-----------|--------|---------------|
| KMP | Nov. 1994 | 104B/9 | 5.2 <i>AK</i> |

