

LOG NO: MAY 16 1995 U
 ACTION:
 FILE NO:

SUSTUT RIVER PROJECT
 ASSESSMENT REPORT - 1995 EXPLORATION PROGRAM

RECEIVED
 MAY 5 - 1995
 Gold Commissioner's Office
 VANCOUVER, B.C.

OMINECA MINING DIVISION
 BRITISH COLUMBIA
 CANADA

N.T.S. 94 D/7, 10
 Latitude 56°30'N
 Longitude 126°45'W

MINERAL CLAIMS

TENURE NUMBERS

BEAR 1 - 100
 BEAR 101 - 102

315801-315900
 316001, 316002

RED 1 - 22
 RED 29 - 50
 RED 51 - 52

315951-315972
 315979-316000
 316075, 316076

LAKE 1 - 42

316003-316044

SUSTUT 1 - 28

316047-316074

FILMED

Owner and Operator

El Condor Resources Ltd.
 1020-800 W. Pender St.
 Vancouver, B.C.
 V6C 2K6

**GEOLOGICAL BRANCH
 ASSESSMENT REPORT**

May 04, 1995

by

23,895

C.M. Rebagliati, P. Eng.
 L.K. Brommeland, B.Sc.

SUSTUT EXPLORATION 1994

TABLE OF CONTENTS

	<u>Page</u>
1.0 Summary	1
2.0 Introduction	2
3.0 Location and Access	2
4.0 Claim Data	3
5.0 Exploration History	4
6.0 Regional Geology	5
6.1 Stratigraphy	
6.2 Kastberg Intrusions	
6.3 Metamorphism	
6.4 Mineralization	
7.0 Property Geology	7
8.0 1994 Work Program	8
9.0 Recommendations	9
10.0 References	10
11.0 Statement of Costs	11
12.0 Statements of Qualifications	12

LIST OF TABLES

	<u>Following Page</u>
1. Mineral Claims - Sustut Corridor	3

LIST OF FIGURES

	<u>Following Page</u>
1.0 Site Location Map	2
2.0 Property Map	2
3.0 Claim Map - South Block	in pocket
4.0 Claim Map - North Block	in pocket
5.0 Regional Geology - Legend	7
6.0 Regional Geology - Map	7
7.0 Base Line Location Map	in pocket

APPENDICES

A. Survey Notes

1.0 SUMMARY

The Sustut Project, owned by El Condor Resources Ltd., is located approximately 250 kilometres north of Smithers in north-central British Columbia. The 5,450 hectare property is comprised of 218 two-post mineral claims and is in the Southern Toodoggone mining camp of the Omineca Mining Division.

Vehicle access to the northern claim area is via the Omineca Resource Access Road (ORAR); access to the southern claim area is via the BC Rail Dease Lake Extension. The central portion of the claim area is accessible only by helicopter.

The claims are situated in a mineral rich area with extensive overburden cover. Several regional lineaments suggest promising deposit habitat; however, due to the thick overburden layer, the claim area has received minimal exploration work. It has been suggested (Rebagliati et al., 1994) that the area has the potential to host any one of the following styles of mineralization:

- Shear hosted Au deposits.
- Sustut Copper deposit style Cu mineralization.
- Stockwork and replacement Au-Cu deposits in Sustut Group Sediments related to Eocene Kastberg felsic intrusions.
- Porphyry copper, Cu-Au-Mo plugs related to Jurassic, Cretaceous and Tertiary felsic plutons.
- Volcanogenic deposits related to subaqueous Triassic/Jurassic volcanics.

El Condor's 1994 physical exploration program on the Sustut property included the establishment and surficial geological mapping of some 43 kilometres of cut base-line and a location survey of the line, pertinent claim posts and helicopter pads. Work undertaken during the course of this program will serve as a preparatory survey for future exploration and development activity in the area.

2.0 INTRODUCTION

Located in the Omineca Mining Division in North Central British Columbia, the Sustut Project is comprised of 218 two-post mineral claims. The claims are located to the west of, and parallel to, the Sustut River. This area is a prime exploration target for both precious-metal and base-metal deposits.

El Condor's 1994 physical exploration program on the Sustut property included the establishment and surficial geological mapping of some 43 kilometres of cut base-line and a location survey of the line, pertinent claim posts and helicopter pads. Work undertaken during the course of this program will serve as a preparatory survey for future exploration and development activity in the area.

3.0 LOCATION AND ACCESS

The Sustut Project is located approximately 250 kilometres north of Smithers, British Columbia and 370 kilometres north-west of Prince George, British Columbia. The Project, which is situated at latitude 56°30' North and longitude 126°45' West, is contained within the boundaries of the Omineca Mining Division. See illustrative Figures 1.0 and 2.0.

Fixed wing access to the property is via the Sturdee Valley airfield which is located adjacent to the Omineca Resource Access Road (ORAR). This airstrip, approximately 60 km northwest of the property, is maintained by airlines using scheduled commuter-type aircraft based in Smithers, Prince George and Vancouver. The ORAR crosses the northern end of the property whereas the BC Rail Dease Lake Extension crosses the southern end of the property. The middle portion of the property is accessed by helicopter only.

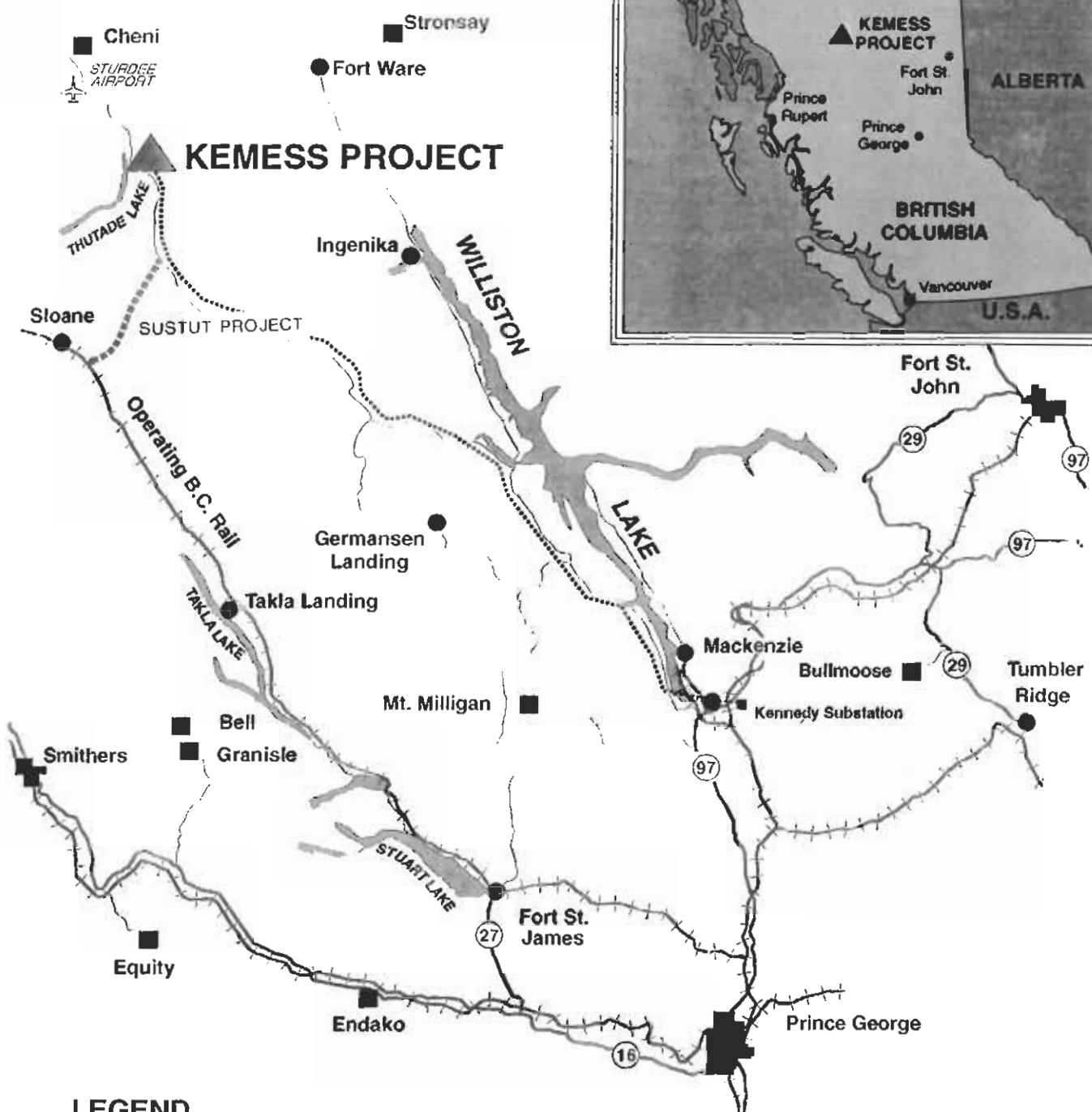
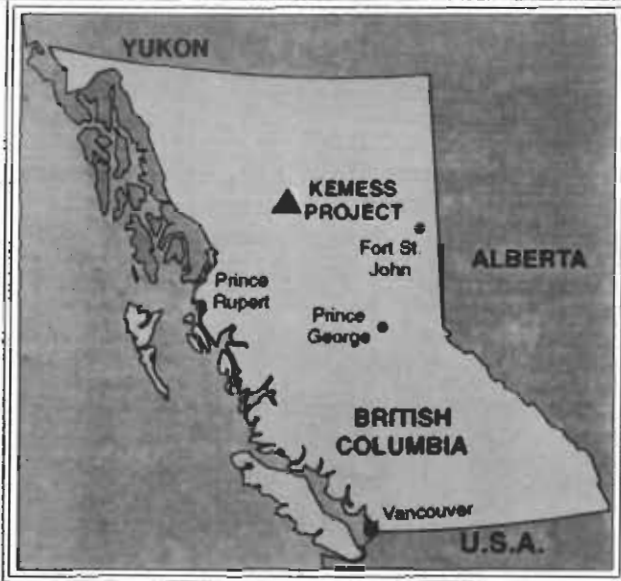

LEGEND

- Highway
- Year Round Industrial Road
- +—+ Railway
- B.C. Hydro-Proposed 230 kV Line
- Mines And Mine Development Projects



EL CONDOR RESOURCES LTD.
SUSTUT PROJECT
LOCATION MAP

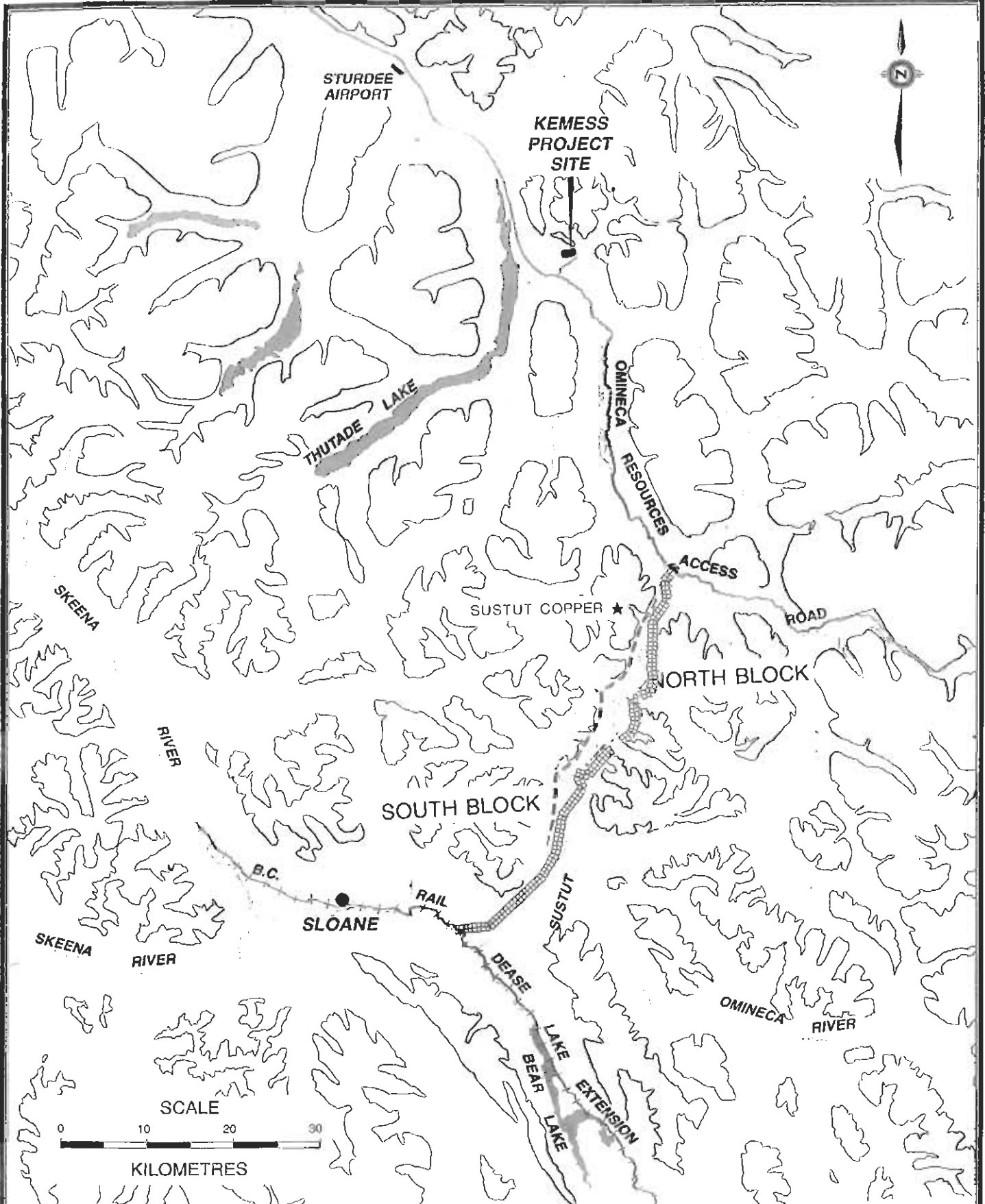

EL CONDOR RESOURCES LTD.
SUSTUT PROJECT
PROPERTY AREA

Situated in a transition zone between the gentle terrain of the Bowser Basin and Spatsizi Plateau and the western margin of the Swannell Range of the Omineca Mountains, the property parallels the western edge of the Sustut River.

The Sustut River forms a major break across the rugged northwest trending mountains. Elevations range from 1000 metres in the Sustut River Valley to 2500 metres on the surrounding peaks. Tree line occurs at 1200 metres elevation, alpine meadows extend to 1600 metres elevation and above this bare rock, scree, felsenmeer and permanent snow occur above the meadows. Past exploration activity in the area has been focused above the tree line.

Climate in the region is generally moderate although highly variable: temperatures range from +30 degrees Celsius to -35 degrees Celsius and moderate precipitation occurs more or less uniformly throughout the year.

4.0 CLAIM DATA

The Sustut Property consists of 218 two post mineral claims that are divided into two separate claim blocks: the south block and the north block. The south block, comprised of 124 claims, begins at the confluence of the Sustut and Bear Rivers and it parallels the Sustut River to a point 5 kilometres north of its confluence with Red Creek. The north block, comprised of 94 claims, begins at a point 3.5 kilometres south of Two Lake Creek and follows the Sustut River north to its confluence with Moosevale Creek. The locations of all mineral claims are illustrated by Figures 3.0 and 4.0 (in pocket).

The project claims, which are situated in the Omineca Mining Division on N.T.S. map sheets 94D/7 and 94D/10, are owned by El Condor Resources Ltd. A listing of the claims referred to in this report may be found in Table 1.0.

EL CONDOR RESOURCES LTD.
KEMESS SOUTH PROJECT
TABLE 1.0 - MINERAL CLAIMS - SUSTUT CORRIDOR

NTS 94D/7, 94D/10

Omineca Mining Division

Claim Name	Record Number	Tenure Number	Units	Record Date	Expiry Date *	Ownership
BEAR 1	315801	315801	1	05-Feb-93	05-Feb-98	El Condor (100%)
BEAR 2	315802	315802	1	05-Feb-93	05-Feb-98	El Condor (100%)
BEAR 3	315803	315803	1	05-Feb-93	05-Feb-98	El Condor (100%)
BEAR 4	315804	315804	1	05-Feb-93	05-Feb-98	El Condor (100%)
BEAR 5	315805	315805	1	05-Feb-93	05-Feb-98	El Condor (100%)
BEAR 6	315806	315806	1	05-Feb-93	05-Feb-98	El Condor (100%)
BEAR 7	315807	315807	1	05-Feb-93	05-Feb-98	El Condor (100%)
BEAR 8	315808	315808	1	05-Feb-93	05-Feb-98	El Condor (100%)
BEAR 9	315809	315809	1	05-Feb-93	05-Feb-98	El Condor (100%)
BEAR 10	315810	315810	1	05-Feb-93	05-Feb-98	El Condor (100%)
BEAR 11	315811	315811	1	05-Feb-93	05-Feb-98	El Condor (100%)
BEAR 12	315812	315812	1	05-Feb-93	05-Feb-98	El Condor (100%)
BEAR 13	315813	315813	1	05-Feb-93	05-Feb-98	El Condor (100%)
BEAR 14	315814	315814	1	05-Feb-93	05-Feb-98	El Condor (100%)
BEAR 15	315815	315815	1	05-Feb-93	05-Feb-98	El Condor (100%)
BEAR 16	315816	315816	1	05-Feb-93	05-Feb-98	El Condor (100%)
BEAR 17	315817	315817	1	05-Feb-93	05-Feb-98	El Condor (100%)
BEAR 18	315818	315818	1	05-Feb-93	05-Feb-98	El Condor (100%)
BEAR 19	315819	315819	1	05-Feb-93	05-Feb-98	El Condor (100%)
BEAR 20	315820	315820	1	05-Feb-93	05-Feb-98	El Condor (100%)
BEAR 21	315821	315821	1	05-Feb-93	05-Feb-98	El Condor (100%)
BEAR 22	315822	315822	1	05-Feb-93	05-Feb-98	El Condor (100%)
BEAR 23	315823	315823	1	05-Feb-93	05-Feb-98	El Condor (100%)
BEAR 24	315824	315824	1	05-Feb-93	05-Feb-98	El Condor (100%)
BEAR 25	315825	315825	1	05-Feb-93	05-Feb-98	El Condor (100%)
BEAR 26	315826	315826	1	05-Feb-93	05-Feb-98	El Condor (100%)
BEAR 27	315827	315827	1	05-Feb-93	05-Feb-98	El Condor (100%)
BEAR 28	315828	315828	1	05-Feb-93	05-Feb-98	El Condor (100%)
BEAR 29	315829	315829	1	05-Feb-93	05-Feb-98	El Condor (100%)
BEAR 30	315830	315830	1	05-Feb-93	05-Feb-98	El Condor (100%)
BEAR 31	315831	315831	1	05-Feb-93	05-Feb-98	El Condor (100%)
BEAR 32	315832	315832	1	05-Feb-93	05-Feb-98	El Condor (100%)
BEAR 33	315833	315833	1	06-Feb-93	06-Feb-98	El Condor (100%)
BEAR 34	315834	315834	1	06-Feb-93	06-Feb-98	El Condor (100%)
BEAR 35	315835	315835	1	06-Feb-93	06-Feb-98	El Condor (100%)
BEAR 36	315836	315836	1	06-Feb-93	06-Feb-98	El Condor (100%)
BEAR 37	315837	315837	1	06-Feb-93	06-Feb-98	El Condor (100%)
BEAR 38	315838	315838	1	06-Feb-93	06-Feb-98	El Condor (100%)
BEAR 39	315839	315839	1	06-Feb-93	06-Feb-98	El Condor (100%)
BEAR 40	315840	315840	1	06-Feb-93	06-Feb-98	El Condor (100%)
BEAR 41	315841	315841	1	06-Feb-93	06-Feb-98	El Condor (100%)
BEAR 42	315842	315842	1	06-Feb-93	06-Feb-98	El Condor (100%)
BEAR 43	315843	315843	1	06-Feb-93	06-Feb-98	El Condor (100%)
BEAR 44	315844	315844	1	06-Feb-93	06-Feb-98	El Condor (100%)
BEAR 45	315845	315845	1	06-Feb-93	06-Feb-98	El Condor (100%)
BEAR 46	315846	315846	1	06-Feb-93	06-Feb-98	El Condor (100%)
BEAR 47	315847	315847	1	06-Feb-93	06-Feb-98	El Condor (100%)
BEAR 48	315848	315848	1	06-Feb-93	06-Feb-98	El Condor (100%)
BEAR 49	315849	315849	1	06-Feb-93	06-Feb-98	El Condor (100%)

EL CONDOR RESOURCES LTD.
KEMESS SOUTH PROJECT
TABLE 1.0 - MINERAL CLAIMS - SUSTUT CORRIDOR

NTS 94D/7, 94D/10

Omineca Mining Division

Claim Name	Record Number	Tenure Number	Units	Record Date	Expiry Date *	Ownership
BEAR 50	315850	315850	1	06-Feb-93	06-Feb-98	El Condor (100%)
BEAR 51	315851	315851	1	07-Feb-93	07-Feb-98	El Condor (100%)
BEAR 52	315852	315852	1	07-Feb-93	07-Feb-98	El Condor (100%)
BEAR 53	315853	315853	1	07-Feb-93	07-Feb-98	El Condor (100%)
BEAR 54	315854	315854	1	07-Feb-93	07-Feb-98	El Condor (100%)
BEAR 55	315855	315855	1	07-Feb-93	07-Feb-98	El Condor (100%)
BEAR 56	315856	315856	1	07-Feb-93	07-Feb-98	El Condor (100%)
BEAR 57	315857	315857	1	07-Feb-93	07-Feb-98	El Condor (100%)
BEAR 58	315858	315858	1	07-Feb-93	07-Feb-98	El Condor (100%)
BEAR 59	315859	315859	1	07-Feb-93	07-Feb-98	El Condor (100%)
BEAR 60	315860	315860	1	07-Feb-93	07-Feb-98	El Condor (100%)
BEAR 61	315861	315861	1	07-Feb-93	07-Feb-98	El Condor (100%)
BEAR 62	315862	315862	1	07-Feb-93	07-Feb-98	El Condor (100%)
BEAR 63	315863	315863	1	07-Feb-93	07-Feb-98	El Condor (100%)
BEAR 64	315864	315864	1	07-Feb-93	07-Feb-98	El Condor (100%)
BEAR 65	315865	315865	1	07-Feb-93	07-Feb-98	El Condor (100%)
BEAR 66	315866	315866	1	07-Feb-93	07-Feb-98	El Condor (100%)
BEAR 67	315867	315867	1	08-Feb-93	08-Feb-98	El Condor (100%)
BEAR 68	315868	315868	1	08-Feb-93	08-Feb-98	El Condor (100%)
BEAR 69	315869	315869	1	08-Feb-93	08-Feb-98	El Condor (100%)
BEAR 70	315870	315870	1	08-Feb-93	08-Feb-98	El Condor (100%)
BEAR 71	315871	315871	1	08-Feb-93	08-Feb-98	El Condor (100%)
BEAR 72	315872	315872	1	08-Feb-93	08-Feb-98	El Condor (100%)
BEAR 73	315873	315873	1	08-Feb-93	08-Feb-98	El Condor (100%)
BEAR 74	315874	315874	1	08-Feb-93	08-Feb-98	El Condor (100%)
BEAR 75	315875	315875	1	08-Feb-93	08-Feb-98	El Condor (100%)
BEAR 76	315876	315876	1	08-Feb-93	08-Feb-98	El Condor (100%)
BEAR 77	315877	315877	1	08-Feb-93	08-Feb-98	El Condor (100%)
BEAR 78	315878	315878	1	08-Feb-93	08-Feb-98	El Condor (100%)
BEAR 79	315879	315879	1	08-Feb-93	08-Feb-98	El Condor (100%)
BEAR 80	315880	315880	1	08-Feb-93	08-Feb-98	El Condor (100%)
BEAR 81	315881	315881	1	09-Feb-93	09-Feb-98	El Condor (100%)
BEAR 82	315882	315882	1	09-Feb-93	09-Feb-98	El Condor (100%)
BEAR 83	315883	315883	1	09-Feb-93	09-Feb-98	El Condor (100%)
BEAR 84	315884	315884	1	09-Feb-93	09-Feb-98	El Condor (100%)
BEAR 85	315885	315885	1	09-Feb-93	09-Feb-98	El Condor (100%)
BEAR 86	315886	315886	1	09-Feb-93	09-Feb-98	El Condor (100%)
BEAR 87	315887	315887	1	09-Feb-93	09-Feb-98	El Condor (100%)
BEAR 88	315888	315888	1	09-Feb-93	09-Feb-98	El Condor (100%)
BEAR 89	315889	315889	1	09-Feb-93	09-Feb-98	El Condor (100%)
BEAR 90	315890	315890	1	09-Feb-93	09-Feb-98	El Condor (100%)
BEAR 91	315891	315891	1	09-Feb-93	09-Feb-98	El Condor (100%)
BEAR 92	315892	315892	1	09-Feb-93	09-Feb-98	El Condor (100%)
BEAR 93	315893	315893	1	09-Feb-93	09-Feb-98	El Condor (100%)
BEAR 94	315894	315894	1	09-Feb-93	09-Feb-98	El Condor (100%)
BEAR 95	315895	315895	1	09-Feb-93	09-Feb-98	El Condor (100%)
BEAR 96	315896	315896	1	09-Feb-93	09-Feb-98	El Condor (100%)
BEAR 97	315897	315897	1	09-Feb-93	09-Feb-98	El Condor (100%)
BEAR 98	315898	315898	1	09-Feb-93	09-Feb-98	El Condor (100%)

EL CONDOR RESOURCES LTD.
KEMESS SOUTH PROJECT
TABLE 1.0 - MINERAL CLAIMS - SUSTUT CORRIDOR

NTS 94D/7, 94D/10

Omineca Mining Division

Claim Name	Record Number	Tenure Number	Units	Record Date	Expiry Date *	Ownership
BEAR 99	315899	315899	1	09-Feb-93	09-Feb-98	El Condor (100%)
BEAR 100	315900	315900	1	09-Feb-93	09-Feb-98	El Condor (100%)
BEAR 101	316001	316001	1	09-Feb-93	09-Feb-98	El Condor (100%)
BEAR 102	316002	316002	1	09-Feb-93	09-Feb-98	El Condor (100%)
RED 1	315951	315951	1	06-Feb-93	06-Feb-98	El Condor (100%)
RED 2	315952	315952	1	06-Feb-93	06-Feb-98	El Condor (100%)
RED 3	315953	315953	1	06-Feb-93	06-Feb-98	El Condor (100%)
RED 4	315954	315954	1	06-Feb-93	06-Feb-98	El Condor (100%)
RED 5	315955	315955	1	06-Feb-93	06-Feb-98	El Condor (100%)
RED 6	315956	315956	1	06-Feb-93	06-Feb-98	El Condor (100%)
RED 7	315957	315957	1	06-Feb-93	06-Feb-98	El Condor (100%)
RED 8	315958	315958	1	06-Feb-93	06-Feb-98	El Condor (100%)
RED 9	315959	315959	1	06-Feb-93	06-Feb-98	El Condor (100%)
RED 10	315960	315960	1	06-Feb-93	06-Feb-98	El Condor (100%)
RED 11	315961	315961	1	06-Feb-93	06-Feb-98	El Condor (100%)
RED 12	315962	315962	1	06-Feb-93	06-Feb-98	El Condor (100%)
RED 13	315963	315963	1	07-Feb-93	07-Feb-98	El Condor (100%)
RED 14	315964	315964	1	07-Feb-93	07-Feb-98	El Condor (100%)
RED 15	315965	315965	1	07-Feb-93	07-Feb-98	El Condor (100%)
RED 16	315966	315966	1	07-Feb-93	07-Feb-98	El Condor (100%)
RED 17	315967	315967	1	07-Feb-93	07-Feb-98	El Condor (100%)
RED 18	315968	315968	1	07-Feb-93	07-Feb-98	El Condor (100%)
RED 19	315969	315969	1	07-Feb-93	07-Feb-98	El Condor (100%)
RED 20	315970	315970	1	07-Feb-93	07-Feb-98	El Condor (100%)
RED 21	315971	315971	1	07-Feb-93	07-Feb-98	El Condor (100%)
RED 22	315972	315972	1	07-Feb-93	07-Feb-98	El Condor (100%)
RED 29	315979	315979	1	08-Feb-93	08-Feb-97	El Condor (100%)
RED 30	315980	315980	1	08-Feb-93	08-Feb-97	El Condor (100%)
RED 31	315981	315981	1	08-Feb-93	08-Feb-97	El Condor (100%)
RED 32	315982	315982	1	08-Feb-93	08-Feb-97	El Condor (100%)
RED 33	315983	315983	1	08-Feb-93	08-Feb-97	El Condor (100%)
RED 34	315984	315984	1	08-Feb-93	08-Feb-97	El Condor (100%)
RED 35	315985	315985	1	08-Feb-93	08-Feb-97	El Condor (100%)
RED 36	315986	315986	1	08-Feb-93	08-Feb-97	El Condor (100%)
RED 37	315987	315987	1	08-Feb-93	08-Feb-97	El Condor (100%)
RED 38	315988	315988	1	08-Feb-93	08-Feb-97	El Condor (100%)
RED 39	315989	315989	1	08-Feb-93	08-Feb-97	El Condor (100%)
RED 40	315990	315990	1	08-Feb-93	08-Feb-97	El Condor (100%)
RED 41	315991	315991	1	08-Feb-93	08-Feb-97	El Condor (100%)
RED 42	315992	315992	1	08-Feb-93	08-Feb-97	El Condor (100%)
RED 43	315993	315993	1	08-Feb-93	08-Feb-97	El Condor (100%)
RED 44	315994	315994	1	08-Feb-93	08-Feb-97	El Condor (100%)
RED 45	315995	315995	1	08-Feb-93	08-Feb-97	El Condor (100%)
RED 46	315996	315996	1	08-Feb-93	08-Feb-97	El Condor (100%)
RED 47	315997	315997	1	09-Feb-93	09-Feb-97	El Condor (100%)
RED 48	315998	315998	1	09-Feb-93	09-Feb-97	El Condor (100%)
RED 49	315999	315999	1	09-Feb-93	09-Feb-97	El Condor (100%)
RED 50	316000	316000	1	09-Feb-93	09-Feb-97	El Condor (100%)
RED 51	316075	316075	1	09-Feb-93	09-Feb-97	El Condor (100%)

EL CONDOR RESOURCES LTD.
KEMESS SOUTH PROJECT
TABLE 1.0 - MINERAL CLAIMS - SUSTUT CORRIDOR

NTS 94D/7, 94D/10

Omineca Mining Division

Claim Name	Record Number	Tenure Number	Units	Record Date	Expiry Date *	Ownership
RED 52	316076	316076	1	09-Feb-93	09-Feb-97	El Condor (100%)
LAKE 1	316003	316003	1	09-Feb-93	09-Feb-97	El Condor (100%)
LAKE 2	316004	316004	1	09-Feb-93	09-Feb-97	El Condor (100%)
LAKE 3	316005	316005	1	09-Feb-93	09-Feb-97	El Condor (100%)
LAKE 4	316006	316006	1	09-Feb-93	09-Feb-97	El Condor (100%)
LAKE 5	316007	316007	1	09-Feb-93	09-Feb-97	El Condor (100%)
LAKE 6	316008	316008	1	09-Feb-93	09-Feb-97	El Condor (100%)
LAKE 7	316009	316009	1	09-Feb-93	09-Feb-97	El Condor (100%)
LAKE 8	316010	316010	1	09-Feb-93	09-Feb-97	El Condor (100%)
LAKE 9	316011	316011	1	09-Feb-93	09-Feb-97	El Condor (100%)
LAKE 10	316012	316012	1	09-Feb-93	09-Feb-97	El Condor (100%)
LAKE 11	316013	316013	1	09-Feb-93	09-Feb-97	El Condor (100%)
LAKE 12	316014	316014	1	09-Feb-93	09-Feb-97	El Condor (100%)
LAKE 13	316015	316015	1	09-Feb-93	09-Feb-97	El Condor (100%)
LAKE 14	316016	316016	1	09-Feb-93	09-Feb-97	El Condor (100%)
LAKE 15	316017	316017	1	09-Feb-93	09-Feb-97	El Condor (100%)
LAKE 16	316018	316018	1	09-Feb-93	09-Feb-97	El Condor (100%)
LAKE 17	316019	316019	1	09-Feb-93	09-Feb-97	El Condor (100%)
LAKE 18	316020	316020	1	09-Feb-93	09-Feb-97	El Condor (100%)
LAKE 19	316021	316021	1	10-Feb-93	10-Feb-97	El Condor (100%)
LAKE 20	316022	316022	1	10-Feb-93	10-Feb-97	El Condor (100%)
LAKE 21	316023	316023	1	10-Feb-93	10-Feb-97	El Condor (100%)
LAKE 22	316024	316024	1	10-Feb-93	10-Feb-97	El Condor (100%)
LAKE 23	316025	316025	1	10-Feb-93	10-Feb-97	El Condor (100%)
LAKE 24	316026	316026	1	10-Feb-93	10-Feb-97	El Condor (100%)
LAKE 25	316027	316027	1	10-Feb-93	10-Feb-97	El Condor (100%)
LAKE 26	316028	316028	1	10-Feb-93	10-Feb-97	El Condor (100%)
LAKE 27	316029	316029	1	10-Feb-93	10-Feb-97	El Condor (100%)
LAKE 28	316030	316030	1	10-Feb-93	10-Feb-97	El Condor (100%)
LAKE 29	316031	316031	1	10-Feb-93	10-Feb-97	El Condor (100%)
LAKE 30	316032	316032	1	10-Feb-93	10-Feb-97	El Condor (100%)
LAKE 31	316033	316033	1	10-Feb-93	10-Feb-97	El Condor (100%)
LAKE 32	316034	316034	1	10-Feb-93	10-Feb-97	El Condor (100%)
LAKE 33	316035	316035	1	10-Feb-93	10-Feb-97	El Condor (100%)
LAKE 34	316036	316036	1	10-Feb-93	10-Feb-97	El Condor (100%)
LAKE 35	316037	316037	1	10-Feb-93	10-Feb-97	El Condor (100%)
LAKE 36	316038	316038	1	10-Feb-93	10-Feb-97	El Condor (100%)
LAKE 37	316039	316039	1	10-Feb-93	10-Feb-97	El Condor (100%)
LAKE 38	316040	316040	1	10-Feb-93	10-Feb-97	El Condor (100%)
LAKE 39	316041	316041	1	10-Feb-93	10-Feb-97	El Condor (100%)
LAKE 40	316042	316042	1	10-Feb-93	10-Feb-97	El Condor (100%)
LAKE 41	316043	316043	1	10-Feb-93	10-Feb-97	El Condor (100%)
LAKE 42	316044	316044	1	10-Feb-93	10-Feb-97	El Condor (100%)
SUSTUT 1	316047	316047	1	10-Feb-93	10-Feb-97	El Condor (100%)
SUSTUT 2	316048	316048	1	10-Feb-93	10-Feb-97	El Condor (100%)
SUSTUT 3	316049	316049	1	10-Feb-93	10-Feb-97	El Condor (100%)
SUSTUT 4	316050	316050	1	10-Feb-93	10-Feb-97	El Condor (100%)
SUSTUT 5	316051	316051	1	10-Feb-93	10-Feb-97	El Condor (100%)
SUSTUT 6	316052	316052	1	10-Feb-93	10-Feb-97	El Condor (100%)

**EL CONDOR RESOURCES LTD.
KEMESS SOUTH PROJECT
TABLE 1.0 - MINERAL CLAIMS - SUSTUT CORRIDOR**

NTS 94D/7, 94D/10

Omineca Mining Division

Claim Name	Record Number	Tenure Number	Units	Record Date	Expiry Date *	Ownership
SUSTUT 7	316053	316053	1	10-Feb-93	10-Feb-97	El Condor (100%)
SUSTUT 8	316054	316054	1	10-Feb-93	10-Feb-97	El Condor (100%)
SUSTUT 9	316055	316055	1	10-Feb-93	10-Feb-97	El Condor (100%)
SUSTUT 10	316056	316056	1	10-Feb-93	10-Feb-97	El Condor (100%)
SUSTUT 11	316057	316057	1	10-Feb-93	10-Feb-97	El Condor (100%)
SUSTUT 12	316058	316058	1	10-Feb-93	10-Feb-97	El Condor (100%)
SUSTUT 13	316059	316059	1	10-Feb-93	10-Feb-97	El Condor (100%)
SUSTUT 14	316060	316060	1	10-Feb-93	10-Feb-97	El Condor (100%)
SUSTUT 15	316061	316061	1	10-Feb-93	10-Feb-97	El Condor (100%)
SUSTUT 16	316062	316062	1	10-Feb-93	10-Feb-97	El Condor (100%)
SUSTUT 17	316063	316063	1	10-Feb-93	10-Feb-97	El Condor (100%)
SUSTUT 18	316064	316064	1	10-Feb-93	10-Feb-97	El Condor (100%)
SUSTUT 19	316065	316065	1	10-Feb-93	10-Feb-97	El Condor (100%)
SUSTUT 20	316066	316066	1	10-Feb-93	10-Feb-97	El Condor (100%)
SUSTUT 21	316067	316067	1	10-Feb-93	10-Feb-97	El Condor (100%)
SUSTUT 22	316068	316068	1	10-Feb-93	10-Feb-97	El Condor (100%)
SUSTUT 23	316069	316069	1	10-Feb-93	10-Feb-97	El Condor (100%)
SUSTUT 24	316070	316070	1	10-Feb-93	10-Feb-97	El Condor (100%)
SUSTUT 25	316071	316071	1	10-Feb-93	10-Feb-97	El Condor (100%)
SUSTUT 26	316072	316072	1	10-Feb-93	10-Feb-97	El Condor (100%)
SUSTUT 27	316073	316073	1	10-Feb-93	10-Feb-97	El Condor (100%)
SUSTUT 28	316074	316074	1	10-Feb-93	10-Feb-97	El Condor (100%)

TOTAL NO. CLAIMS	218
TOTAL NO. UNITS	218

5.0 EXPLORATION HISTORY

5.1 District Exploration and Development

The area surrounding the property has an exploration history that dates back to the turn of the century with the discovery of placer gold, in 1889, at the mouth of McConnell Creek. The discovery at McConnell Creek, which is located approximately 30 kilometres north of Johanson Lake, led to a brief gold rush in the year 1907. Many known showings are situated in this area and are indicated on the BC Mineral Inventory Map.

Exploration activity in the late 1960's led to the discovery of the Chapelle epithermal gold-silver vein deposit. This deposit, which is located approximately 56 kilometres north of the Sustut Project, was discovered in 1968 by Kennco Explorations (Western) Limited while searching for porphyry copper-molybdenum deposits in the Toodoggone District. This discovery prompted several major mining companies to explore the region for precious-metal and base-metal occurrences. The work of these companies, over the 15 years following the Chapelle discovery, resulted in the discovery of several epithermal gold and silver prospects and porphyry gold-copper prospects.

Development of many of the epithermal gold and silver prospects has occurred in the last 15 years: Dupont of Canada Ltd. operated the Baker (Chapelle) Mine from 1980 to 1984; Cheni Gold Mines Inc. operated the epithermal-type Lawyers, Cliff and Al vein deposits from 1988 to 1992; and Sable Mines Ltd. recently mined the Shas (Shasta) epithermal gold-silver vein-stockwork deposit.

The above mentioned operators made substantial contributions to the infrastructure and development in the area. The Sturdee Valley Airfield was constructed by Dupont and the Omineca Resource Access Road was extended in 1988 by Cheni, with assistance from the provincial government, in order to facilitate mine development and operations.

Increased infrastructure has assisted other companies in the further exploration and development of the gold-copper prospects in the region. The Kemess South Au-Cu Deposit, a porphyry deposit located 30 km north of the Sustut River, is presently within the Mine Development Assessment Process. This project will result in major advances in the road, rail and power infrastructure in the area.

Further infrastructure development, such as that mentioned above, will encourage the exploration and development of existing and new prospects in the future. Projects like the Sustut Copper Deposit, which was discovered by Falconbridge Ltd. in August of 1971 during a reconnaissance helicopter flight over Savage Mountain, and properties such as those held by Golden Rule Resources Ltd. and Skeena Resources Ltd. are likely to see an increased level of exploration activity.

6.0 REGIONAL GEOLOGY

6.1 Stratigraphy

The Sustut Corridor is located in the southeast portion of the Toodoggone District of north-central British Columbia. It is located west of the approximate boundary between the terranes of Stikinia to the west and Quesnellia to the east. South of the property the boundary between the two terranes is defined by the Pinchi Fault system.

The majority of the Sustut Corridor area is underlain by mafic volcanic rocks of the Upper Triassic Takla Group and Lower Jurassic Hazelton Group as well as Upper Cretaceous to Eocene Sustut Group sediments. These supracrustal rocks have been intruded by a number of predominantly felsic intrusions of Jurassic to Eocene age.

Upper Cretaceous sedimentary members of the subaerial Sustut Group form a blanket which unconformably overlies older rocks in the southern portion of the area.

Pleistocene glaciation has intensively scoured the entire district, and has deposited variably thick mantles of till and glaciofluvial material over much of the lower benchland topography. Rugged cirque features with rock glaciers and residual morainic debris are present at higher elevations.

6.2 Kastberg Intrusions

A number of felsic plutons have been injected into the Takla Group rocks in the area. These intrusions exist as dykes, sills and small stocks, and they range in composition from diorite and quartz-diorite through quartz-monzonite with minor syenite to granodiorite components.

6.3 Metamorphism

Regional metamorphism of the Takla Group rocks in the claim area is of zeolite facies. Metamorphic grade increases northeastward from laumontitic in the Upper Formations through to prehnite-pumpellyite subfacies in the Lower Formations of the Takla Group rocks at the Sustut Copper deposit.

6.4 Mineralization

The Toodoggone District is widely known for its precious metal and copper mineralization. The Takla and Toodoggone volcanics host epithermal gold and silver mineralization.

Copper-bearing sulphide mineralization occurs dominantly within the Takla Group volcanics. It is fracture controlled and often associated with porphyry dikes and plutons. Mineralization consists of pyrite, chalcopyrite, and molybdenite with associated precious metal values.

In the Kemess Creek area, approximately 20 kilometres north of the Sustut Project, the Kemess South deposit is hosted by a flat-lying quartz monzodioritic intrusion. Only a minor portion of the gold-copper mineralization is present within the adjacent volcanic wall rocks. Conversely, the Kemess North deposit and numerous other porphyry-type showings elsewhere in the area exhibit gold-copper mineralization hosted in Takla Group volcanic rocks.

At the Sustut Copper deposit, mineralization occurs in a sulphide rich sheet-like zone in a volcanoclastic unit within the Takla Group. Mineralization consists of disseminations and veinlets of chalcocite, bornite, chalcopyrite, pyrite and minor native copper.

7.0 PROPERTY GEOLOGY

The Sustut Project claims are situated in a mineral rich area with extensive overburden cover. Several regional lineaments suggest promising deposit habitat potential; however, the claim area has received minimal exploration work due to the presence of the thick overburden layer.

The property claims overly the northeast trending Sustut River Fault structure and subsidiary parallel structures (Figures 5.0 and 6.0). This structural trend is intersected by several major northwest trending structures, that commonly parallel major creeks including: Red Creek, Two Lake Creek, Asitka and Saiya Faults as well as numerous minor northwest trending fault structures.

It has been suggested (Rebagliati et al., 1994) that the claim area has the potential to host any one of the following styles of mineralization:

- Shear hosted Au deposits at the junction of intersecting structures.
- Sustut Copper deposit style Cu mineralization.

STRATIFIED ROCKS

UPPER TERTIARY and/or QUATERNARY

TQ.6 basalt, flow, breccia, plugs and dikes

UPPER CRETACEOUS to EOCENE
SUSTUT GROUP

BROTHERS PEAK FORMATION: conglomerate, sandstone, siltstone and acid tuff; minor coal

TANGU CREEK FORMATION: conglomerate, sandstone and siltstone; minor coal

JURASSIC

Middle and Upper Jurassic
BOWSER LAKE GROUP
Upper Oxfordian

VJ.1 Volcanics: basalt and andesite flow, breccia, tuff and lahar

VJ.2 sediments: sandstone, siltstone, argillite, and conglomerate; minor coal

Collon to Lower Oxfordian

VJA ASHMAN FORMATION: argillite and siltstone; minor sandstone and tuff

LOWER and MIDDLE JURASSIC
HAZELTON GROUP
Middle Toarcian to Middle Bajocian

LJ.5 SHITIER FORMATION: graywacke, siltstone, sandstone, and tuff

Lower Phensbachian to Middle Toarcian

LJ.6 MILKITAMA FORMATION: argillite, siltstone, graywacke and tuff; minor sandstone and limestone

LJ.7 CAMPBELL HILLS: basalt and andesite flow, breccia, pillow breccia and tuff

Sinemurian to Lower Phensbachian

LJ.8 TELYMA FORMATION: calcalkaline basalt, andesite, dacite and rhyolite flow, breccia, tuff and lahar, intravolcanic conglomerate, conglomerate, sandstone and siltstone; polygenic conglomerate with Arkka, Tekla, and granitic clasts

UPPER TRIASSIC

TAKIA GROUP

Upper Noronian to Middle Noronian
East west of the Inyemka - Pinchi Fault Zone

UT.4 WOODHALL FORMATION: andesitic and basaltic to basaltic conglomerate, breccia, sandstone, tuff and argillite

UT.5 FORTUNE MOUNTAIN FORMATION: basic andesite porphyry basalt flow, breccia, pillow breccia, tuff and interbedded tilted felsic upper porphyry

UT.6 DENOR FORMATION: tuff, sandstone and argillite; minor limestone and breccia

East east of the Inyemka - Pinchi fault zone

UT.7 volcanics: basic to intermediate flow, breccia and tuff; probably includes intrusive members (UJ.8); green phyllite and phyllitic schist, minor sediments

UT.8 sediments: argillite, tuff, sandstone, phyllite and phyllitic schist; limestone and skarn

PERMIAN, TRIASSIC and JURASSIC

PT.1 LAY RANGE ASSEMBLAGE and TAKIA GROUP

PT.2 SIFUKA ASSEMBLAGE: sericite, chlorite, siliceous schist and phyllite, minor mafics; includes the Asitka, Takla and Hazelton Groups and possibly parts of the Bowser Lake Group

PERMIAN

PA ASITKA GROUP: basalt, rhyolite, tuff, chert, argillite and calcisate

PENNSYLVANIAN and PERMIAN

PP.1 LAY RANGE ASSEMBLAGE: basic volcanics, calcareous phyllite, quartzite and limestone

PP.2 CACHE CREEK GROUP: (a) siliceous phyllite, metabert, metabas, (b) greenstone and amphibolite

UPPER PROTEROZOIC

PR.1 LESFEL FORMATION: limestone, locally calcitic and psilocitic; minor dolomite

PR.2 TSHAYIZ FORMATION: sericite phyllite

PR.3 SWANWELL FORMATION: quartz-feldspathic, gritty sandstone, siltstone, shale and conglomerate, metamorphic equivalents from chlorite to kyanite grade

INTRUSIVES

EOCENE

EJ.1 EASTERS INTRUSIONS: quartz monzonite, quartz-eye porphyry and felsite

LATE CRETACEOUS

EJ.2 AXILOGED LAYERED GABBRO INTRUSION; and minor plugs of gabbro and diabase

EARLY CRETACEOUS and ? LATER

EJ.3 JENSEN PEAK BATHOLITH: (EJ.3d) quartz monzodiorite
JOHANSON CREEK STOCK: (EJ.3e) quartz diorite
KLYVIL CREEK body: (EJ.3f) leuco-granodiorite, minor granite stock west of Fleet Peak: (EJ.3g) quartz diorite and granodiorite
stock west of Hoqem Batholith: (EJ.3h) granodiorite

EARLY JURASSIC

EJ.4 MOGEM BATHOLITH: (EJ.4d) foliated quartz monzodiorite (Meslininka Pluton)
FLEET PEAK PLUTON: foliated (EJ.4e) monzodiorite and diorite
JOHANSON LAKE STOCK: (EJ.4f) quartz monzodiorite
DARR LAKE STOCK: (EJ.4g) quartz diorite
ASITKA PEAK STOCK: (EJ.4h) quartz diorite
McConnell Range and Fredrickson Peak stocks: (EJ.4i) quartz monzodiorite, and quartz diorite
plugs adjacent to the Sustut River: (EJ.4j) leucocratic porphyry plugs

LATE TRIASSIC

ET.1 gabbro, diabase, hypabyssal augite porphyry intrusions

ET.2 Alaskan-type ultramafics: gabbro, hornblende, pyroxenite and dunite

LATE PALEOZOIC and ? TRIASSIC

ET.3 Alpine ultramafics: serpentinite, serpenitised peridotite, gneissites

MAP SYMBOLS

- geologic boundary: known, approximate, inferred
- limit of mapping and exposure
- fault: known, approximate, inferred
- high angle reverse fault: known, approximate, inferred
- thrust fault: known, approximate, inferred
- bedding: upright, vertical, overturned
- foliation or schistosity: inclined, vertical
- fold: anticline, syncline
- metamorphic isograd
- K/Ar Age determinations

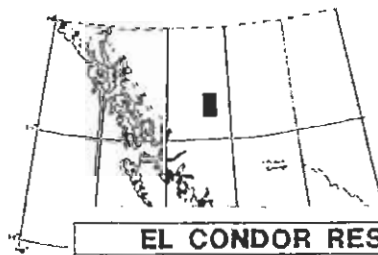

EL CONDOR RESOURCES LTD.
SUSTUT PROJECT

REGIONAL GEOLOGY
LEGEND

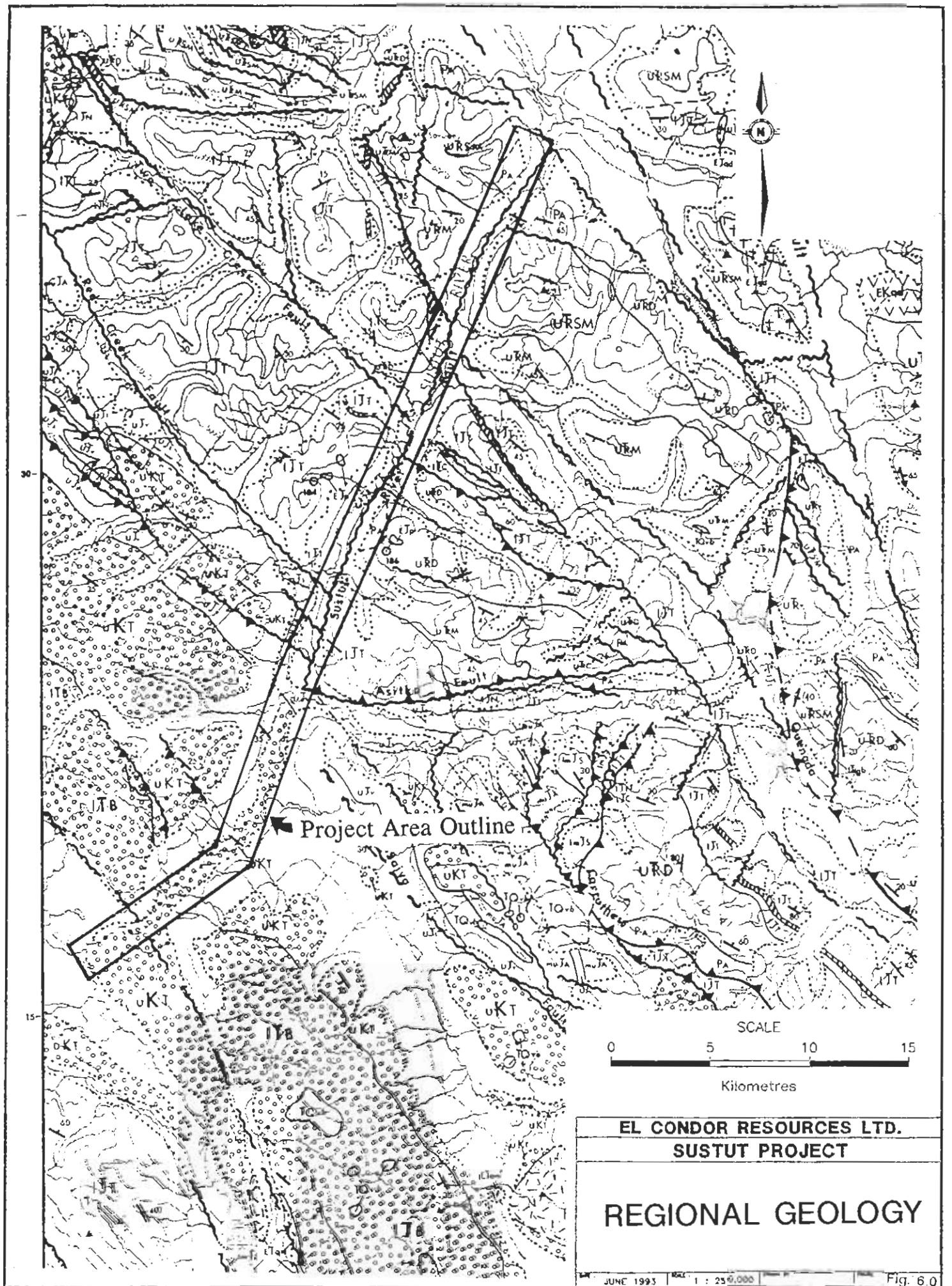

- Stockwork and replacement Au-Cu deposits in Sustut Group Sediments related to Eocene Kastberg felsic intrusions.
- Porphyry copper, Cu-Au-Mo plugs related to Jurassic, Cretaceous and Tertiary felsic plutons.
- Volcanogenic deposits related to subaqueous Triassic/Jurassic volcanics.

8.0 1994 EXPLORATION PROGRAM

During August and September 1994, El Condor Resources Ltd. completed a physical exploration program on the Sustut Property. The program included: establishment of a 43 kilometre cut baseline, preparatory surficial geology/geotechnical mapping and surveying of the cut base line and pertinent claim posts and helicopter pads.

8.1 Baseline Preparation

During August and September 1994, Courier de Bois Ltd. line cutting crews were contracted to establish a 43 kilometre baseline. This baseline followed the claim line of the southern claim block from the confluence of the Bear and Sustut Rivers to the confluence of the Sustut River and Two Lake Creek as illustrated in Figure 7.0.

8.2 Baseline Survey

During August and September 1994, McElhanney Consulting Services Ltd., in conjunction with Thurber Engineering Ltd., carried out a center-line survey on the southern claim block. This effort not only established survey control for the claim block, but also allowed for rudimentary surficial geological/geotechnical mapping and the establishment of the precise locations of several claim posts and helicopter pads.

9.0 RECOMMENDATIONS

The 1994 exploration program was primarily preparatory in nature. Expanded geochemical, geophysical and geological programs may now be undertaken along the cut center-line with the added benefit of proximal survey control. Rudimentary knowledge of the surficial geology will be valuable for determining extent of outcrop for future programs and for developing road access to a specific area of the property should it become necessary.

10.0 REFERENCES

GSC Map 7778G, McConnell Creek, Geophysical Series (Aeromagnetic), 1972.

Harper, G., Geology of the Sustut Copper Deposit in British Columbia, CIM Bulletin, v. 70. n. 783, pp.123-32.

Lord, J.S., McConnell Creek, GSC Map 962A, 1948.

Monger, J.W.H., The Triassic Takla Group in McConnell Creek Map-Area, North Central BC, GSC Paper 76-29.

Richards, T., McConnell Creek Map-Area (94D/E) Geology, GSC O.F. 342, 1975.

Wilton, D.H., Sinclair, A.J., Genetic Model for Sustut Copper Deposit in Triassic Volcaniclastic Rocks, Central British Columbia, IAGOD Symposium, published in Nevada Bureau of Mines and Geology, Report 33, pp. 185-187.

Rebagliati, C.M., and Klassen, R.W., Sustut River Project, Assessment Report - 1993 Exploration Program, April, 1994.

11.0 STATEMENT OF COSTS

Sustut Project 1994 Expenditures

Line Cutting - 43 km (August 19 to September 25, 1994)

Courier de Bois Ltd.		
102 man days at \$250.00 per man day	\$25,500.00	
Room and Board		
102 man days at \$110.00 per man day	\$11,220.00	
Sub-total		\$ 36,720.00

Survey Crew (August 17 to September 26, 1994)

McElhanney Consulting Services		
106 man days at \$350.00 per man day	\$37,100.00	
Room and Board		
106 man days at \$110.00 per man day	\$11,660.00	
Sub-total		\$ 48,760.00

Helicopter Support

Canadian Helicopters and Pacific Western Helicopters		
20 hours at \$700.00 per hour	\$14,000.00	
Sub-total		\$ 14,000.00

Report Preparation

El Condor Technical Staff		
2 days at \$300.00 per day	\$ 600.00	
Sub-total		\$ 600.00

1994 Exploration Expenditures **\$ 100,080.00**

11.0 STATEMENT OF QUALIFICATIONS

I, Clarence Mark Rebagliati, of the City of Vancouver, Province of British Columbia, DO HEREBY CERTIFY THAT:

1. I am a consulting Geological Engineer with a business office at Suite 1020 - 800 West Pender Street, Vancouver, British Columbia.
2. I am a graduate of the Provincial Institute of Mining, Haileybury, Ontario (Mining Technology, 1966).
3. I am a graduate of the Michigan Technological University, Houghton, Michigan, U.S.A. (B.Sc., Geological Engineering, 1969).
4. I am a registered member, in good standing, of the Association of Professional Engineers and Geoscientists of British Columbia.
5. I have practiced my profession continuously since graduation.
6. I directed the 1994 exploration program on the Sustut property.

C.M. Rebagliati, P.Eng.

Dated at Vancouver, British Columbia, this 04th day of May, 1995.

11.0 STATEMENT OF QUALIFICATIONS

I, Lena Kathryn Brommeland, of the City of Vancouver, Province of British Columbia, DO HEREBY CERTIFY THAT:

1. I am a Geologist employed by El Condor Resources Ltd. at Suite 1020 - 800 West Pender Street, Vancouver, British Columbia.
2. I am a graduate of the University of British Columbia, with a Bachelor of Science in Geology, 1989.
3. I have practiced my profession continuously since graduation.
4. I reviewed the data from the 1994 exploration program on the subject property.

Lena K. Brommeland, B.Sc.

Dated at Vancouver, British Columbia, this 04th day of May, 1995.

APPENDIX A
SURVEY NOTES

CLAIM POST DATA - FIELD BOOK #2



LEVEL NOTES OF:

STA	BS	HI	IFS	FS	ELEV.
		END AUG 21	TH		
		322.5	29.7	+1.0	30 cm PINE
		10.3	29.5	+2.9	"
2+512.9					
		66.2	29.6	+1.1	
2+403.3					
		59.4	30.6	+0.4	
2+452.7					
		54.3	14.4	+0.8	
		113.2	15.2	+2.0	
		110.9	76.1	+0.6	
2+438.3					
		53.7	16.5	-1.5	
2+421.0					

10
McElhanney

JOB NO.: _____ DATE: _____ PAGE: _____
 CREW: _____
 WEATHER: _____

		#635360 M	Bear 11	
		FINAL POST #2	J SM105	
		DIST FROM IP	500	
		DATE COMPLETED	Feb 5/93	
		TIME	1330 hrs	
		#635361		
		FINAL POST #2	Bear 12	
		DATE COMPLETED	Feb 5/93	
		TIME	1330 hrs	
		#635362	INITIAL POST No 1	
		CLAIM NAME:	Bear 13	
		Locator:	J SM105	
		AGENT FOR:	El Condor	
		DATE COMPLETED	Feb 5/93	
		TIME	1330 AMPS	
		DIR TO FP	265°	
		M/R	0	
		M/L	500	
		CLAIM POST #	635363 M SAME	BEAR 14
			Feb 5/93	13:35 hrs
			265°	J SM105
			M/R	500
			M/L	0

SEE NEXT PAGE (11)

FS-7815

NOTES OF:

III

IFS

FS

ELEV.

⑪

McElhanney

NO.: _____ DATE: _____ PAGE: _____

NEW: _____

WEATHER: _____

#635360 M Final Post #2

Claim Name: Bear 11

Locator Name: J. SMIDS

Agent For: El Condor

Date Completed: Feb 5/93

Time " : 1330 hrs

Dist from IP 500 m

#635361 M Final Post #2

Claim Name: Bear 12

Locator Name: J. SMIDS

Agent For: El Condor

Date Completed: Feb 5/93

Time " : 1330 hrs

Dist from IP 500 m

#635362 INITIAL POST #1

Claim Name: Bear 13

Locator Name: J. SMIDS

Agent For: El Condor

Date Commenced: Feb 5/93

Time " : 1330 hrs

Dir to FP 265°

M/R

M/L

500

FS-7015

LEVEL NOTES OF:

STA	BS	HI	IFS	FS	ELEV.
#635363		INITIAL POST			
Claim Name:		Bea-14			
Locator Name:		J. SMITH			
Agent For:		El Condor			
Date Commenced		Feb 5/93			
Time		13:35			
Dir to FP		265°			
M/R :		500			
M/L :					

McElhanney

JOB NO.: _____ DATE: _____ PAGE: _____

CREW: _____

WEATHER: _____

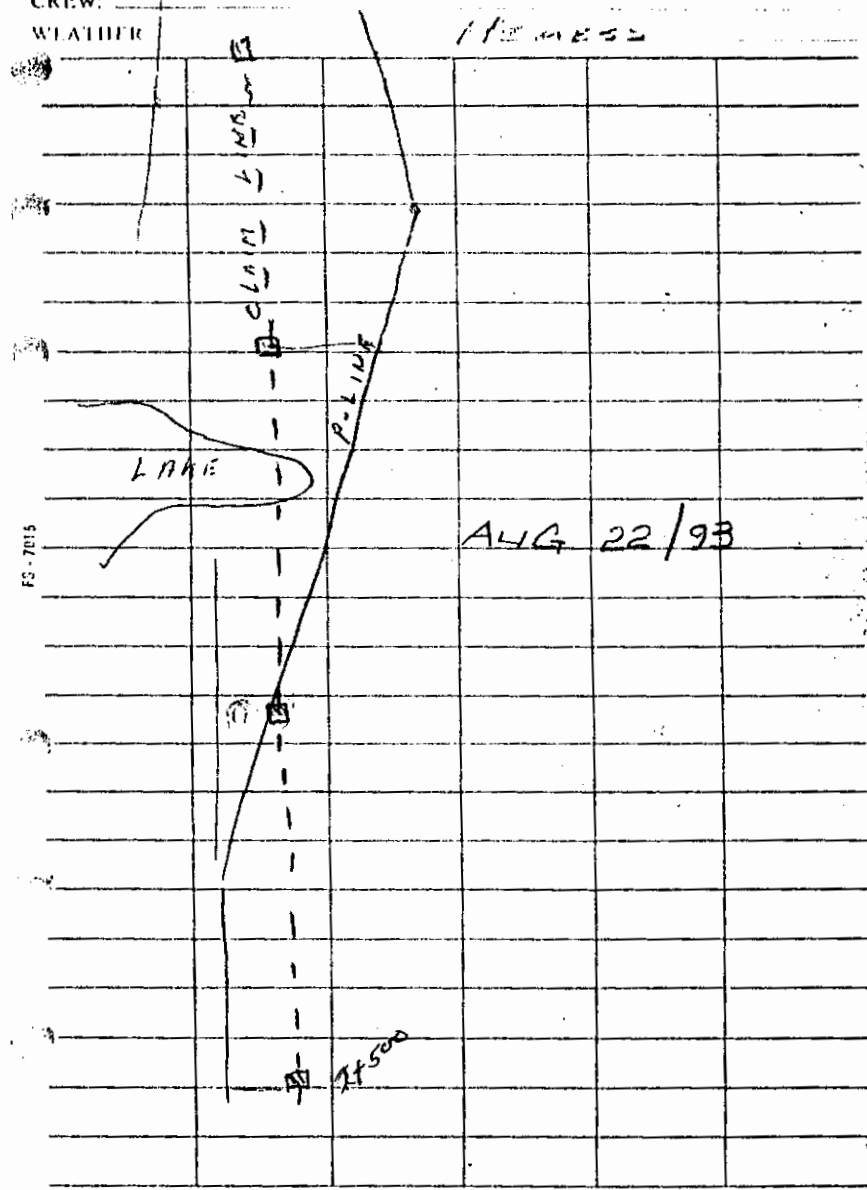

LEVEL NOTES OF:

McElhanney

JOB NO.: _____ DATE: _____ PAGE: (3)

CREW: _____

WEATHER: _____ KEMESS

STA	BS	HI	IFS	FS	ELEV.
No	635	359 M			
		FINAL POST N° 2			
		Claim Name: Bear 10			
		Locator: J SMIDS			
		Agent For: El Condor			
		Dist FROM IP 500M			
		Date Completed: Feb 5/93			
		Time Completed: 1300 hrs			
No	635	360 M			
		INITIAL POST N° 1			
		Claim Name: Bear 11			
		Locator: J SMIDS			
		Agent For: El Condor			
		Date Commenced: Feb 5/93			
		Time " : 1300 hrs			
		DIR TO FP: 265°			
		M/R 500			
		M/L 500			

FS-7015

No	635	361 M			
		INITIAL POST N° 1			
		Claim Name: Bear 12			
		Locator: J SMIDS			
		Agent For: El Condor			
		Date Commenced: Feb 5/93			
		Time " : 1300 hrs			
		DIR TO FP 265°			
		M/R : 500			
		M/L : 500			

LEVEL NOTES OF:

STA	BS	HI	IFS	FS	ELEV.
No 635 358 INITIAL POST No 1					
CLAIM NAME : BEAR 9					
LOCATOR : 1 SMIDS					
AGENT FOR: EL CONDOR.					
DATE COMP: FEB 5/93					
TIME: 12:25 hrs.					
DIR TO F.P. 265°					
M/R 0					
M/L 500					
No 635 359 INITIAL POST No 1					
CLAIM NAME : BEAR 10					
LOCATOR : 1 SMIDS.					
AGENT FOR: EL CONDOR.					
DATE COMP: FEB 5/93					
TIME: 12:20 hrs					
DIR TO FP 265°					
M/R 500					
M/L 0					
CLAIM POST					
	336.7	35.1	+2.1		
	324.5	13.6	+11.8		
	337.2	22.5	-3.3		
	316.1	35.1	+2.4		
31489.5	BT'S (5) (6.0)				
	251.0 BS	11.0			
	12.7	25.2	-0.1		
3444.3	(5.8) (6.5)				

McElhanney

JOB NO.: _____ DATE: KANESS PAGE: (6)

CREW: _____

WEATHER: _____

No 635 356 FINAL POST No 2			
CLAIM NAME BEAR 7			
LOCATOR 1 SMIDS			
AGENT FOR: EL CONDOR.			
DATE COMP FEB 5/93			
TIME 12:25 hrs			
DIST FROM IP 500			
No 635 357 FINAL POST No 2			
CLAIM NAME BEAR 8			
LOCATOR 1 SMIDS			
AGENT FOR: EL CONDOR.			
DATE COMP FEB 5/93			
TIME 12:25 hrs			
DIST FROM IP 500			
CLAIM POST			
TRaverse Pt	(19.3)		
Traverse Pt	(3) 36.1	35.1	35cm +2.4
Traverse Pt	BT'S		
	(14) 15.2	24.7	+1.9
	(15.4)		

FS-7015

LEVEL NOTES OF:

STA	BS	HI	IIS	FS	ELFV.
12+471.4	22.1	41.6	+5.4		
12+449.5	22.1	20	+3.9		
12+429.8	21.9	30.4	+0.3		
12+399.1	22.7	33.2	17.3		
12+366.2	22.2	14.0	+2.4		
12+352.2	22.2	37.0	-0.4		
12+315.2	22.2	31.0	+1.9		
12+284.2	22.2	14.6	+9.4		
12+269.6	22.2	30.8	+3.7		
12+238.8	22.0	33.0	+6.0		
12+205.8					

McElhanney

JOB NO.: _____ DATE: _____ PAGE: 84

CREW: _____

WEATHER: _____

(221)	(227)	(227)			
+8	-9	-21			
(222)	(222)	9/2			
+10	-8				
(221)	(227)				
+12.8	-9.3				
46	53				
(221)	(222)				
+7	-9				
(221)	(221)				
+11	-9				
(221)	(227)				
+12	-11				
(221)	(227)				
+18	-3.5				
(221)	(221)				
+17	-10				
(221)	(227)				
+13	+10				
(221)	(227)				
+13	-12				

111
 Geotech?
 bedrock?
 some exposed shale
 Clay Part
 T.C.
 See Page #
 15-29 cm
 SP-100
 ballston
 ↓

LEVEL NOITS OF:

STA	BS	HI	IFS	FS	ELEV.
12+943.3					
	38.5	22.3	+0.1		
12+921.0					
	38.4	28.9	-0.9		
12+892.1					
	38.8	17.8	-2.0		
12+874.3					
	38.7	44.8	12.4		
12+829.5					
	38.7	26.1	-2.4		
12+803.4					
	37.1	20.0	+7.6		
12+783.4					
	38.7	24.5	+1.3		
12+758.9					
	38.8	22.4	-0.8		
12+736.5					
	38.8	23.2	-6.5		
12+713.3					
	38.7	24.9	-3.7		
12+688.4					

McElhanney

JOB NO: _____ DATE: _____ PAGE: 86
 CREW: _____
 WEATHER: _____

(23.0)	(23.7)		
+4	-13.5		
(23.0)	(23.7)		
+13	-12.5		
(23.0)	(23.7)		
+14.5	-8.5	CLAIM POST #2	
		SEE PAGE	
(23.0)	(23.7)		
+4.5	-10		
(23.0)	(23.7)		
+9	-11	500' CAMP	
(23.0)	(23.7)		
+8.5	-12		
(23.0)	(23.7)		
+12.5	-10		
(23.0)	(23.7)		
+17.0	-8.5	Assorted size	
		TAKES	
		Lobble	
(23.0)	(23.7)		
+10	-11.5	500' CAMP	
(23.0)	(23.7)		
+7.5	-14		

LEVEL NOTES OF:

STA	BS	HI	IFS	FS	ELEV.
13+467.8					
	38.6	23.3	-1.5		
13+446.5					
	38.4	37.4	-2.7		
13+409.1					
	39.0	22.4	+4.7		
13+386.7					
	38.7	1.98	+8.0		
13+367.9					
	38.4	29.0	+5.3		
13+338.9					
	39.3	22.0	-8.2		
13+216.1					
	38.9	34.6	-17.6		
13+300.0					
	39.1	18.5	-26.3		
13+281.5					
	38.7	23.3	-4.6		
13+259.2					
	39.1	24.9	+0.1		
13+233.3					

McElhanney

JOB NO: _____ DATE: _____ PAGE: 88
 CREW: _____
 WEATHER: _____

(242)	(242)		
+8.5	-11.5		
(243)	(243)		
+8	-14		
(244)	(244)		
+10	-12.5		
(245)	(245)		
+9.5	-10.5		
(246)	(246)		
+16	-6.5		
(247)	(247)		
+14	-14		
(248)	(248)		
+14.5	-13.5		
(249)	(249)		
+20	-12		
(250)	(250)		
+12.5	-12.5		
(251)	(251)		
+6	-18		

66411 POST #3
 SEE P 4
 CUBBLE 0-35 CT
 occasional
 1 1/3 CT
 builder
 0.5-10
 500 Ø CAP

JOB NO.: _____

DATE: _____

LEVEL NOTES OF:

STA	BS	HI	IFS	FS	ELEV.
13+980.4	BS 24.2	26.5	-4.7		
13+952.9	23.7	21.5	-1.8		
13+932.4	23.7	30.1	+3.9		
13+902.3	24.1	22.1	-1.3		
13+882.1	25.1	17.8	-15.8		
13+862.4	24.0	18.3	-2.1		
13+844.1	23.8	28.6	+0.2		
(P) 13+815.2	39.2	20.2	-0.8		
13+794.3	39.2	24.5	-1.6		
13+769.8					

JOB NO.: _____

DATE: _____

PAGE: 20

CREW: _____

WEATHER: _____

	(257)	(15)	97 253.2°	24.1	+11.2	30 cm Pulson
	+8	-3.2				
		(53)	296.6°	27.1	+6.6	30 cm Pulson
	(258)					
	+2	$\frac{-4}{7}$	$\frac{+40}{4}$	$\frac{-3}{30}$		
	(259)	(257)	(258)	(259)		
	+2	-7				
	(259)	(259)				
	+4	-4				500 ft comp
	(259)	(259)				
	+7	-3				
	(259)	(259)				
	+4	-6				CLAIM + 4
	(259)	(259)				
	+5	-8				
	(259)	(259)				
	+5	-8				Pulson Sprinkler
	(259)	(259)				
	+6	-8				

LEVEL NOTES OF:

STA	BS	HI	IFS	FS	ELEV.
			(Rec. 1058)		
15+092.0	(575)				
	25.3	19.1	-2.0		
15+072.9	(574)				
	24.9	15.4	+6.8		
15+057.9	(573)				
	24.8	33.9	+1.0		
15+023.6	BT'S (572)				
	24.1	33.9	+0.6		
14+989.7	(571)				
	24.7	35.2	-2.5		
14+954.5	(570)				
	24.4	27.2	-1.4		
14+927.3	(569)				
	24.1	20.0	+1.6		
14+907.3	(568)				
	23.9	38.3	-0.8		
14+869.0	(567)				
	22.6	34.8	-0.6		
14+834.2	(566)				
	24.0	35.7	+0.1		
14+790.5	(565)				

McElhanney

JOB NO.: _____ DATE: _____ PAGE: 95

CREW: _____

WEATHER: _____

	(575)	(275)			
	+9	-13			
	(574)	(574)			
	+8	-19			
	(574)	(574)			
	+4	-14	(275)		
	(573)	(573)	(1) 206.5' 22.8" 30 cm		
	+9	-13	(2) 320.4' 16.8" 30 cm		
FS-7015	(573)	(573)	(3) 16		
	+8	-11			
	(572)	(572)			
	+0	-12			
	(571)	(571)			
	+9	-13			Balsam Spruce.
	(570)	(570)			
	+6	-13			
	(570)	(570)			
	+11	-11			
	(570)	(570)			
	+9	-12			CLIM POST # 6

LEVEL NOTES OF:

STA	BS	HI	IFS	FS	ELEV.
15+363.9	(2781)				
	12.1	30.8	+1.1		
15+333.1	(2781)				
	25.8	21.7	+0.1		
15+311.4	(2781)				
	25.7	28.7	+1.2		
15+291.7	(2781)				
	25.3	31.3	-0.5		
15+250.4	(2781)				
	25.0	21.7	-10.1		
15+228.7	(2781)				
	25.2	31.5	-3.0		
15+196.2	(2770)				
	25.4	29.0	-2.2		
15+167.2	(2781)				
	24.1	21.0	-0.8		
15+146.2	(2781)				
	25.3	23.3	+6.4		
15+122.9	(2781)				
	23.7	30.9	-3.0		
15+092.0	(2781)				

McElhanney

JOB NO.: _____ DATE: _____ PAGE: 96
 CREW: _____
 WEATHER: _____

(2801)	(2802)		
+10	-13		
(2781)	(2787)		
+8	-14	CLAIM	POST #7
50			
(2781)	(2782)		
+9	-15		
(2786)	(2787)		
+11	-10		
(2781)	(2782)		
+10	-11		
(2786)	(2787)		Balsam Spruce
+8	-12		
(2771)	(2772)		
+9	-13		
(2765)	(2767)		
+9	-14		
(2760)	(2762)		
+9	-8		
(2756)	(2757)		
+11	-13		

LEVEL NOTES OF:

McElhanney

JOB NO.: _____ DATE: _____ PAGE: 28
 CREW: _____
 WEATHER: _____

STA	BS	HI	IFS	FS	ELEV.
15+970.6					
	356.1	35.3	-4.2		
15+934.3					
	356.4	21.3	+1.0		
15+913.0					
	13.1	24.8	+1.1		
15+888.2					
	12.5	36.8	-5.0		
15+854.4					
	12.9	24.1	-4.3		
15+827.5					
	12.5	25.4	-5.2		
15+801.9					
	12.3	18.3	+0.9		
15+783.6					
	12.4	17.4	-3.2		
15+746.2					
	12.5	21.7	-2.7		
15+724.5					
	12.6	34.2	+1.2		
15+690.5					

	(58.0)	(61.0)			
	+6	-6			500' 6" CURB
	(58.0)	(58.0)			
	+6	-6			
	(58.0)	(58.0)			
	+4	-2			
	(58.0)	(58.0)			
	+6	-4			
FS-7015	(58.0)	(58.0)			
	+3	0			CLAIM POST # 8
	(58.0)	(58.0)			
	+3	-12			
	(58.0)	(58.0)			
	+9	-12			Beam Spruce
	(58.0)	(58.0)			
	+9	-12			
	(58.0)	(58.0)			
	+12	-11			20' 50' on ORG
	(58.0)	(58.0)			
	+6	-12			

LEVEL NOTES OF:

STA	BS	HI	IFS	FS	ELEV.
16+537.2					
	5.0	25.0	-4.4		
16+512.2					
	357.8	33.7	-6.1		
16+470.5	BT'S				
	357.9	19.2	+14.7		
16+459.3					
	357.5	15.3	+12.1		
16+426.7					
	357.2	29.4	+7.9		
16+397.1					
	359.2	24.4	+8.2		
16+372.7					
	357.6	32.2	+7.1		
16+340.7					
	357.7	24.5	+5.2		
16+316.0					
	357.6	34.5	+6.0		
16+281.5					
	357.4	38.5	+5.7		
16+243.0					

McElhanney

JOB NO: _____ DATE: _____ PAGE: 100

CREW: _____

WEATHER: _____

(2.5)	(2.5)				
+25	-24				
(2.5)	(2.5)				
+15	-20 6	-32 off			
(1.5)	(1.5)	(11)	253.5°	25.5	+12.4 35cm sprink
+14.5	-21	BT'S			
(1.5)	(1.5)	(6.8)	294.5	39.6	+13.8 35cm sprink
+15.5	-18				
(1.5)	(1.5)				
+17	-18				
(1.5)	(1.5)				
+9	-12				7 MIXED cable 500 φ CMP →
(1.5)	(1.5)				
+6	-9				500 φ CMP →
(1.5)	(1.5)				
+7	-10.5				300 φ CMP →
(1.5)	(1.5)				
+9	-11				
(1.5)	(1.5)				
+6	-11				CLAMP 1 φ

LEVEL NOTES OF:

STA	BS	HI	IFS	FS	ELEV.
17+329.2					
	33.1	33.4	-1.6		
P ¹ 17+295.8	6.1	32.7	-2.5		
17+299.9	6.5	32.4	-2.7		
17+227.5	6.7	25.5	-2.3		
17+202.0	6.5	35.0	+1.8		
17+167.0	7.1	36.0	+2.5		
17+136.0	6.7	36.6	+1.6		
17+099.4	7.1	29.1	+6.5		
17+074.3	6.9	29.5	+1.2		
17+044.8	6.7	37.3	-2.7		
17+007.5					

McElhanney

JOB NO: _____ DATE: _____ PAGE: 103

CREW: _____

WEATHER: _____

		(31.2)			
	+12	-12			
		(2.1)			
	+13	-15			
	+15	-12	Chain Post = (11)		
	31.1	(31.1)			
	+9	-11			
	(31.2)	(31.2)			
	+9	-12			
	(31.2)	(31.2)			
	+9	-8.9			
	(31.2)	(31.2)			
	+10	-10			
	(31.2)	(31.2)			
	+8	-11			
	(31.2)	(31.2)			
	+10	-12			
	(31.2)	(31.2)			
	+13	-8			

LEVEL NOTES OF:

STA	BS	HI	IFS	FS	ELEV.
17+823.0					
	354.3	41.0	+13.3		
17+782.0					
	353.5	26.0	+9.6		
17+761.0		9			
	353.8	25.2	+9.7		
17+735.0					
	354.6	21.4	+13.6		
17+714.0					
	353.7	20.9	+6.4		
17+685.5					
	353.8	22.5	+8.0		
17+663.0					
	354.0	34.6	+5.7		
17+628.0					
	353.5	17.0	-4.5		
17+611.4					
	353.3	26.8	+0.3		
17+584.6					
	354.3	14.5	11.1		
17+570.1					

McElhanney

JOB NO: _____ DATE: _____ PAGE: 105

CREW: _____

WEATHER: _____

	324.6	320.0			
	+8	-9			
	324.0	320.0			PINE
	+10	-10			
	323.8	320.0			SPRUCE BALSAM
	+9	-12			CLAIM POST # 12
	322.0	320.0			
	+9	-12			
	321.0	320.0			
	+12	-6			
	320.0	320.0			
	+6	-11			
	320.0	320.0			
	+8	-9			Cobble 5-350'
	320.0	320.0			
	+13	-11			
	320.0	320.0			Balsam Spruce
	+11	-11			
	320.0	320.0			
	+9	-13			

FS-2015

LEVEL NOTES OF:

McElhanney

JOB NO.: _____ DATE: _____ PAGE: 107
 CREW: _____
 WEATHER: _____

STA	BS	HI	IFS	FS	ELEV.
121315.8					
121303.3	333.8	32.5	-2.2		
121270.0	332.6	33.3	+2.6		
121250.1	333.7	19.9	-0.9		
121219.4	333.6	30.7	-2.5		
121196.8	334.1	24.6	-0.9		
121163.4	354.3	31.4	-5.9		
121138.6	354.7	24.9	-5.9		
121111.7	354.3	26.9	-18.7		
121072.9	354.3	33.9	-5.6		
121047.1	354.6	25.8	-16.4		

	(311)	(322)			
+12	-12				
	(311)	(310)			
+24	-12	+16			
	(311)	(311)			
+24	-22	+29			CLAIM POST # 13
	(311)	(311)			
+20	-24	(311)			
	(311)	(311)			
+20	-24				
	(311)	(311)			
	(20)	24.89	AZ	(311)	
	(311)	30.5		-24	
	(311)	(311)			
+15	-23				
	(311)	(311)			
+24	-16				PINE
	(311)	(311)			SPRUC
+20	-24				Balsam
	(311)	(311)			
	(311)	(311)			
	115	17			

18 x 33

FS-7015

LEVEL NOTES OF:

STA	BS	HI	IFS	FS	ELEV.
18+829.1					
	334.8	23.8	+7.6		
18+852.3					
	334.8	30.1	+4.4		
18+775.2					
	334.6	34.5	+4.2		
18+740.7					
	334.8	30.9	+7.5		
18+707.8					
	334.3	20.4	-5.4		
18+689.1					
	335.6	12.9	+9.0		
18+676.5					
	334.5	24.5	-0.3		
18+652.0					
	334.9	20.7	+1.1		
18+631.3					
	335.1	29.5	+1.3		
18+601.8					
	334.8	14.0	+12.4		
18+587.9					

McElhanney

JOB No: _____ DATE: _____ PAGE: 109

CREW: _____

WEATHER: _____

(344)	(347)	
+21	-25	
(344)	(347)	
+24	-24	
30		
(347)	(347)	
-23	-10	(26)
(347)	5	4/5
+27	-24	
(347)	(347)	
+28	-19	500 ft CMP
(347)	(347)	
+21	-26	CLAIM TIE # (14)
(347)	(347)	
+28	-23	500 ft CMP
(347)	(347)	
+33	-22	
(347)	(347)	
+30	-29	
(347)	(347)	
(14)	(14)	
(14)	(14)	
+11	-33	
17	-13	-6
		data

LEVEL NOTES OF:

#15

STA	BS	HI	IFS	FS	ELEV.
No. 635372M FINAL BEAR 65 No. 635375M FINAL BEAR 60					
No. 648158M INITIAL BEAR 65 No. 648159M INITIAL BEAR 60					
011					

TRANSIT NOTES OF:

STA	SD	VA	HD	HA/BRG.
19+368.5	358.2	37.3	-1.3	
19+331.2	358.2	35.2	+0.8	
19+296.9	358.1	19.7	-1.5	
19+276.2	358.4	26.1	+4.3	
19+250.8	358.1	25.5	-0.1	
19+225.7	358.3	31.7	-1.7	
19+191.2	357.9	18.7	+1.3	
19+175.2	358.4	38.6	-3.3	
19+136.7	358.1	30.3	-6.1	
19+106.4	344.5	34.5	+2.0	
19+071.9				

FS-7026

McElhanney

JOB No. _____ DATE _____ PAGE 112
 CREW _____
 WEATHER _____

(3510)	(3517)	
+10	-14	
(3511)	(3517)	
+8	-14	
(3518)	(3527)	
+9	-12	Clear to 15
(3519)	(3528)	
+11	-10	
(3520)	(3527)	
+12	-11	
(3521)	(3527)	
+14	-11	
(3510)	(3517)	
+14	-14	
(3511)	(3512)	(3533)
+14	0	1/8
(3506)	(3507)	2/4
+15	-10	
(3506)	(3506)	
+16	-14	Bolt

TRANSIT NOTES OF:

Manney

PAGE 119

SEA	SD	VA	HD	HA BRG
191868.3				
	352.7	37.2	-6.1	
19183.1				
	351.0	26.1	-11.5	
191810.1				
	328.0	34.7	+3.3	
191770.2				
	336.1	11.9	+10.5	
191758.4				
	327.2	16.1	+3.8	
191742.3				
	326.5	7.7	-9.5	
191732.6				
	328.5	10.1	+21.4	
191722.5				
	327.9	19.5	-5.7	
191703.0				
	328.0	26.5	+6.3	
191676.5				
	328.3	29.3	-0.2	
191647.2				

FS-7026

FOR No. _____ DATE _____

CREW _____

WEATHER _____

B

(360)	(14)	
+19	-13.5	
(360)	(360)	
+4	-15	
(360)	(360)	
+13	13	
(360)	(360)	
+13	-10	
(360)	(360)	
+15	-10	
(360)	(360)	
+13	-15	
(360)	(360)	
+13	-28	
(360)	16.5	
+13	-12	
(360)	(360)	
+4	-58	
(360)	8.5	
+14	-12	

Balloon Sprung

3 Sim. Sprung

500 ft. CMH

Clear # 10

500 ft. CMH

500 ft. CMH

CLAIM POST DATA - FIELD BOOK #3

LEVEL NOTES OF: *2 PM*

CLAIM POST INFORMATION *around 5200T*

SLOANE Connector

STA	BS	HI	IFS	FS	ELEV.
No			No		
FINAL POST #2			FINAL POST #2		
CLAIM NAME			CLAIM NAME		
LOCATOR			LOCATOR		
AGENT FOR			AGENT FOR		
DIST FROM IP			DIST FROM IP		
DATE COMPLETED			DATE COMPLETED		
TIME COMPLETED			TIME COMPLETED		
No			No		
INITIAL POST #1			INITIAL POST #1		
CLAIM NAME			CLAIM NAME		
LOCATOR			LOCATOR		
AGENT FOR			AGENT FOR		
DATE COMMENCED			DATE COMMENCED		
TIME COMMENCED			TIME COMMENCED		
DIR TO FP			DIR TO FP		
METERS RIGHT			METERS RIGHT		
METERS LEFT			METERS LEFT		

LEVEL NOTES OF:

CLAIM POST INFORMATION

SLOANE CONNECTER

STA	BS	HI	IFS	FS	ELEV.
No	650975		No	650976	
FINAL POST #2			FINAL POST #2		
CLAIM NAME	BEAR 75		CLAIM NAME	BEAR 76	
LOCATOR	J SM 105		LOCATOR	J SM 105	
AGENT FOR	EC CONDO OR RES LTD		AGENT FOR	EC CONDO OR RES LTD	
DIST FROM IP	500		DIST FROM IP	500	
DATE COMPLETED	FEB 08 99		DATE COMPLETED	FEB 08 94	
TIME COMPLETED	1256		TIME COMPLETED	1258	
No:	650 977		No:	650978	
INITIAL POST #1			INITIAL POST #1		
CLAIM NAME:	BEAR 77		CLAIM NAME:	BEAR 78	
LOCATOR:	J SM 105		LOCATOR:	J SM 105	
AGENT FOR:	EC CONDO OR RES LTD		AGENT FOR:	EC CONDO OR RES LTD	
DATE COMMENCED	FEB 93		DATE COMMENCED	FEB 93	
TIME COMMENCED	1259		TIME COMMENCED	1300	
DIST TO FP	360		DIST TO FP	360	
METERS RIGHT	0		METERS RIGHT	500	
METERS LEFT	500		METERS LEFT	0	

CLAIM POST INFORMATION

SLOANE CONNECTER

McElhanney

JOB NO.: _____ DATE: _____ PAGE: 128

CREW: _____

WEATHER: _____

No	650979		No	650980	
FINAL POST #2			FINAL POST #2		
CLAIM NAME	BEAR 79		CLAIM NAME	BEAR 80	
LOCATOR	J SM 105		LOCATOR	J SM 105	
AGENT FOR	EC CONDO OR RES LTD		AGENT FOR	EC CONDO OR RES LTD	
DIST FROM IP	500		DIST FROM IP	500	
DATE COMPLETED	FEB 93		DATE COMPLETED	FEB 93	
TIME COMPLETED	1442		TIME COMPLETED	1443	
No	650981		No	650982	
INITIAL POST #1			INITIAL POST #1		
CLAIM NAME	BEAR 81		CLAIM NAME	BEAR 82	
LOCATOR	J SM 105		LOCATOR	J SM 105	
AGENT FOR	EC CONDO OR RES LTD		AGENT FOR	EC CONDO OR RES LTD	
DATE COMMENCED	FEB 93		DATE COMMENCED	FEB 93	
TIME COMMENCED	1444		TIME COMMENCED	1445	
DIST TO FP	280		DIST TO FP	280	
METERS RIGHT	0		METERS RIGHT	500	
METERS LEFT	500		METERS LEFT	0	

FS-7015

McElhanney

JOB NO: 711 DATE: PAGE: 196

CREW:

WEATHER:

63829	FINAL	BEAR 73
63829	FINAL	BEAR 74
650915	INITIAL	BEAR 75
650920	INITIAL	BEAR 76

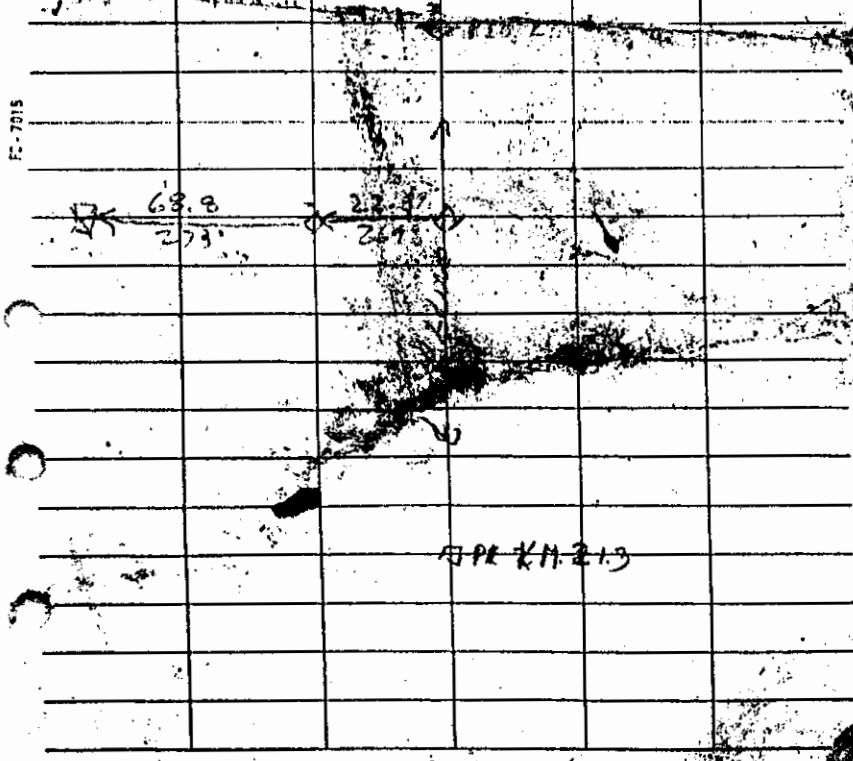

195

CLAIM POST LOCATED AND RECORDED

650979	FINAL	BEAR 79
650980	FINAL	BEAR 80
650981	INITIAL	BEAR 81
650982	INITIAL	BEAR 82

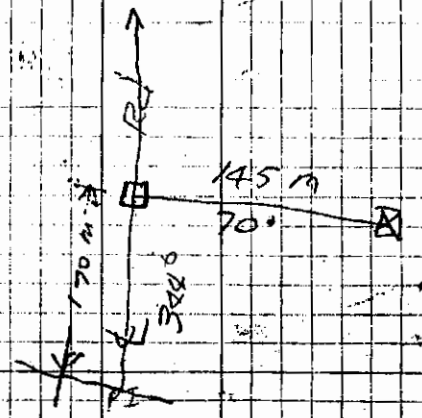

SEPT 04/94

LEVEL NOTES OF:

CLAIM POST INFORMATION

SLOANE CONNECTOR

STA	BS	HI	IFS	FS	ELEV.
No 635373			No	635375	
FINAL POST #2			FINAL POST #2		
CLAIM NAME	BEAR 63		CLAIM NAME	BEAR 64	
BEATON	JSM105		LOCATOR	JSM105	
AGENT FOR	EL CONDOR RES LTD		AGENT FOR	EL CONDOR RES LTD	
DIST FROM IP	500		DIST FROM IP	500	
Date completed	FEB 07 93		Date completed	FEB 07 93	
Time completed	1440 hrs		Time completed	1440 hrs	
No 648158			No 648159		
INITIAL POST			INITIAL POST		
CLAIM NAME	BEAR 65		CLAIM NAME	BEAR 66	
LOCATOR	JSM105		LOCATOR	JSM105	
AGENT FOR	EL CONDOR RES LTD		AGENT FOR	EL CONDOR RES LTD	
Date commenced	FEB 07 93		Date commenced	FEB 07 93	
Time commenced	1444		Time commenced	1445	
Dir To FP	360°		Dir To FP	360°	
Meters Right	∅		Meters Right	500	
Meters Left	500		Meters Left	∅	

Sept 04 94

McElhanney

JOB NO.: _____ DATE: _____ PAGE: 188

CREW: PC AS AR M. Dale SALLER

WEATHER: CLAIM POST INFORMATION Q

SLOANE CONNECTOR		#16	
No 648158 m		No 648159 m	
FINAL POST #2		FINAL POST #2	
CLAIM NAME	BEAR 65	CLAIM NAME	BEAR 66
LOCATOR	JSM105	LOCATOR	JSM105
AGENT FOR	EL CONDOR RES LTD	AGENT FOR	EL CONDOR RES LTD
DIST FROM IP	500	DISTANCE FROM IP	500
Date completed	FEB 07 93	Date completed	FEB 07 93
Time completed	1538	Time completed	1540
No 648161		No 648160	
INITIAL POST #1		INITIAL POST #1	
CLAIM NAME	BEAR 67	CLAIM NAME	BEAR 68
LOCATOR	JSM105	LOCATOR	JSM105
AGENT FOR	EL CONDOR RES LTD	AGENT FOR	EL CONDOR RES LTD
Date commenced	FEB 07 93	Date commenced	FEB 07 93
Time commenced	1541	Time commenced	1542
Dir To FP	360	Dir To FP	360
Meters Right	∅	Meters Right	500
Meters Left	500	Meters Left	∅

Sept 03/93

LEVEL NOTES OF:

CLAIM POST INFORMATION

SLOANE CONNECTOR

#3 N^o

STA	BS	HI	IFS	FS	ELEV.
No 635302 M			No 635383		
FINAL POST #2			FINAL POST #2		
CLAIM NAME BEAR 54			CLAIM NAME BEAR 60		
LOCATOR J SMIDS			LOCATOR J. SMIDS		
AGENT FOR EL CONDOR RESULT			AGENT FOR EL CONDOR RESULT		
DIST FROM IP 500			DIST FROM IP 500		
Date completed FEB 07 93			Date completed FEB 07 93		
Time completed 13:15 hrs			Time completed 13:12 hrs		
No 635384 M			No 635374 M		
INITIAL POST #1			INITIAL POST #1		
CLAIM NAME BEAR 61			CLAIM NAME BEAR 62		
LOCATOR J. SMIDS			LOCATOR J SMIDS		
AGENT FOR EL CONDOR RESULT			AGENT FOR EL CONDOR RESULT		
Date commenced			Date commenced		
TIME COMMENCED 13:20 hr			TIME COMMENCED 13:25 hr		
DIST TO FP 020			DIST TO FP 020		
meters Right 2			meters Right 500		
meters Left 500			meters Left 0		

McElhanney

JOB NO:

DATE:

PAGE:

CREW: EF AR

M de la Salle

#14

WEATHER: MORNING FOG

00

No 635384	No 635374
FINAL POST #2	FINAL POST #2
CLAIM NAME BEAR 61	CLAIM NAME BEAR 62
LOCATOR J SMIDS	LOCATOR J SMIDS
AGENT FOR EL CONDOR RESULT	AGENT FOR EL CONDOR RESULT
DIST FROM IP 500	DIST FROM IP 500
Date completed FEB 07 1993	Date completed FEB 07 93
Time completed 1400	Time completed 1402
No 635373	No 635375
INITIAL POST #1	INITIAL POST #1
CLAIM NAME BEAR 63	CLAIM NAME BEAR 64
LOCATOR J SMIDS	LOCATOR J SMIDS
AGENT FOR EL CONDOR RESULT	AGENT FOR EL CONDOR RESULT
Date commenced FEB 07 93	Date commenced FEB 93
Time commenced 1404	Time commenced 1405
DIST TO FP 360	DIST TO FP 360
meters Right 0	meters Right 500
meters Left 500	meters Left 0

SEPT/02/94 LEVEL NOTES OF:

#11

CLAIM POST INFORMATION
SLOANE CONNECTOR

STA	BS	HI	IFS	FS	ELEV.
No 648131			No 648132		
FINAL POST #2			FINAL POST #2		
CLAIM NAME BEAR55			CLAIM NAME BEAR56		
LOCATOR BEAR55			LOCATOR J SMIOS		
AGENT FOR EL CONDOR RES LTD			AGENT FOR EL CONDOR RES LTD		
DIST FROM IP 500M			DIST FROM IP 500M		
DATE COMPLETED FEB 07 93			DATE COMPLETED FEB 07 93		
TIME COMPLETED 1149 hrs			TIME COMPLETED 1149 hrs		
No 648133			No 635381		
INITIAL POST #1			INITIAL POST #1		
CLAIM NAME BEAR57			CLAIM NAME BEAR58		
LOCATOR J SMIOS			LOCATOR J SMIOS		
AGENT FOR EL CONDOR RES LTD			AGENT FOR EL CONDOR RES LTD		
DATE COMMENCED FEB 07 93			DATE COMMENCED FEB 07 93		
TIME COMMENCED 1150 hrs			TIME COMMENCED 1155 hrs		
DIT TO FP 0200			DIT TO FP 0200		
METERS TO Right 0			METERS TO Right 0		
METERS TO Left 500M			METERS TO Left 500M		

Sept 07/93

McElhanney

JOB NO. SLOANE CONNECTOR DATE: PAGE: ①

CREW: R.F. AR. M. DeLaSalle.

WEATHER: CLAIM POST INFORMATION (M)

SLOANE CONNECTOR

No 648133 M	No 635381 M
FINAL POST #2	FINAL POST #2
CLAIM NAME BEAR57	CLAIM NAME BEAR58
LOCATOR J SMIOS	LOCATOR J SMIOS
AGENT FOR EL CONDOR RES LTD	AGENT FOR EL CONDOR RES LTD
DIST FROM IP 500	DIST FROM IP 500
DATE COMPLETED FEB 07 93	DATE COMPLETED FEB 07 93
TIME COMPLETED 1226 hrs	TIME COMPLETED 1227 hrs
No 635382	No: 635383
INITIAL POST #1	INITIAL POST #1
CLAIM NAME BEAR59	CLAIM NAME BEAR60
LOCATOR J SMIOS	LOCATOR J SMIOS
AGENT FOR EL CONDOR RES LTD	AGENT FOR EL CONDOR RES LTD
DATE COMMENCED FEB 07 93	DATE COMMENCED FEB 07 93
TIME COMMENCED 1230 hr	TIME COMMENCED 1235 hr
DIT TO FP 0200	DIT TO FP 0200
METERS Right 0	METERS Right 500M
METERS Left 500M	METERS Left 0

SEPT/02/94 LEVEL NOTES OF:

#10

CLAIMPOST INFORMATION

J.

SLOANE CONNECTION

STA	BS	HI	IFS	FS	ELEV.
No: 648129M			No: 648130		
FINAL POST #2			FINAL POST #2		
CLAIM NAME:			CLAIM NAME		
BEAR 53			BEAR 54		
LOCATOR:			LOCATOR		
J. SMIDS			J. SMIDS		
AGENT FOR			AGENT FOR		
EL CONDOR RES LTD			EL CONDOR RES LTD		
DISTANCE FROM IP			DIST FROM IP		
500 M			500 M		
DATE COMPLETED			DATE COMPLETED		
07 FEB 93			07 FEB 93		
TIME COMPLETED			TIME COMPLETED		
1100 HRS			1101 HRS		
No: 648131 M			No: 648132		
INITIAL POST #1			INITIAL POST #1		
CLAIM NAME			CLAIM NAME		
BEAR 55			BEAR 56		
LOCATOR			LOCATOR		
J. SMIDS			J. SMIDS		
AGENT FOR			AGENT FOR		
EL CONDOR RES LTD			EL CONDOR RES LTD		
DATE COMMENCED			DATE COMMENCED		
FEB 07 93			FEB 07 93		
TIME COMMENCED			TIME COMMENCED		
11 03 HRS			11 05		
DIP TO FP			DIP TO FP		
020°			020°		
METERS TO RIGHT			METERS TO RIGHT		
5			500		
METERS TO LEFT			METERS TO LEFT		
500			0		

McElhanney

JOB NO: SLOANE CONNECTION DATE: Sept 02 94 PAGE: 186

CREW: RE M. de la SALLE A. P.

WEATHER: Cloudy

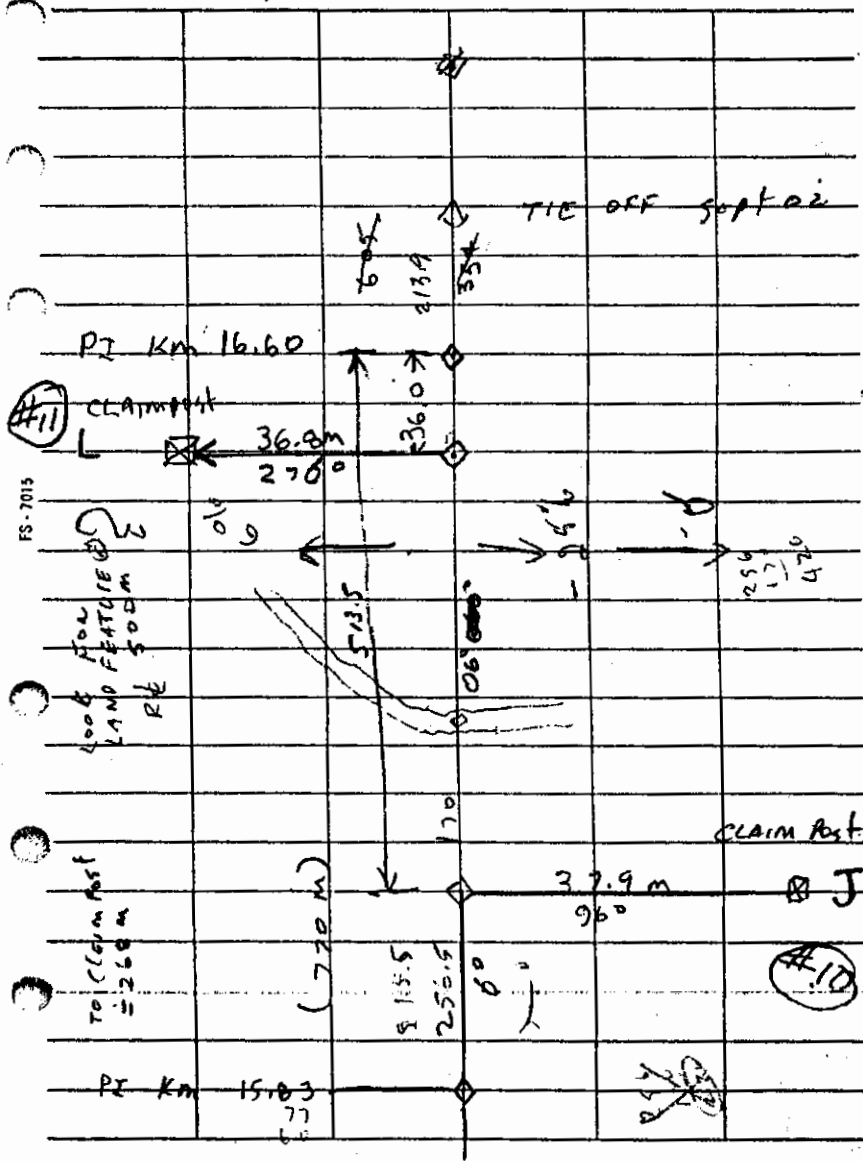

LEVEL NOTES OF:

8

CLAIM POST INFORMATION

SLOANE			CONNECTOR		
STA	BS	HI	IFS	FS	ELEV.
No 648156 M			No 648157 M		
FINAL POST #2			FINAL POST #2		
CLAIM NAME BEAR 49			CLAIM NAME BEAR 50		
LOCATOR JSMIDS			LOCATOR J SMIDS		
AGENT FOR EL CONDOR RES LTD			AGENT FOR EL CONDOR RES LTD		
Dist From IP 500 M			Dist From IA 500 M		
Date Completed 06 FEB 93			Date Completed 06 FEB 93		
Time completed 1522			Time completed 1522		
No 648127 M			No 648128 M		
INITIAL POST #1			INITIAL POST #1		
CLAIM NAME BEAR 51			CLAIM NAME BEAR 52		
LOCATOR J SMIDS			LOCATOR J SMIDS		
AGENT FOR EL CONDOR RES LTD			AGENT FOR EL CONDOR RES LTD		
DATE COMMENCED 07 FEB 93			DATE COMMENCED FEB 07 93		
TIME COMMENCED 0920H			TIME COMMENCED 0920 HRS		
Direction to FP 30° meters to Right \varnothing			Direction to FP 20° meters to Right 500		
meters to Left 500			METERS TO LEFT \varnothing		

McElhanney

JOB NO: _____ DATE: _____ PAGE: 9/185
 CREW: SLOANE CONNECTOR
 WEATHER: CLAIM POST INFORMATION

No 648126 M	No 648127 M
FINAL POST #2	FINAL POST #2
CLAIM NAME BEAR 52	CLAIM NAME BEAR 51
LOCATOR J SMIDS	LOCATOR J SMIDS
AGENT FOR EL CONDOR RES LTD	AGENT FOR EL CONDOR RES LTD
Dist from IP 500 M	Dist from IP 500 M
Date completed 07 FEB 93	Date completed 07 FEB 93
Time completed 1012 hrs	Time completed 1012 HRS
No 648129 M	No 648130 M
INITIAL POST #1	INITIAL POST #1
CLAIM NAME BEAR 53	CLAIM NAME BEAR 54
LOCATOR J SMIDS	LOCATOR J SMIDS
AGENT FOR EL CONDOR RES LTD	AGENT FOR EL CONDOR RES LTD
DATE COMMENCED 07 FEB 93	DATE COMMENCED 07 FEB 93
TIME COMMENCED 1013 HRS	TIME COMMENCED 1015 HRS
Direction to FP 20° meters to Right \varnothing	Direction to FP 20° meters to Right 500
meters to Left 500	meters to Left \varnothing

LEVEL NOTES OF:

#7

CLAIM POST INFORMATION

STA	BS	HI	IFS	FS	ELEV.
No 648148 M			No 648155 M		
FINAL POST #2			FINAL POST #2		
CLAIM NAME			CLAIM NAME BEAR 48		
BEAR 47			LOCATION		
LOCATION J SMIDS			J SMIDS		
AGENT FOR			AGENT FOR		
EL CONDOR RES LTD			EL CONDOR RES LTD		
Dist From IP 500 M			Dist From IP 500 M		
Date completed			Date completed		
06 FEB 93			06 FEB 93		
Time completed			Time completed		
14:35			14:35		
No 648156 M			No 648157 M		
INITIAL POST #1			INITIAL POST #1		
CLAIM NAME BEAR 49			CLAIM NAME BEAR 50		
LOCATION			LOCATION		
J SMIDS			J SMIDS		
AGENT FOR			AGENT FOR		
EL CONDOR RES LTD			EL CONDOR RES LTD		
Date commenced			Date commenced		
06 FEB 93			06 FEB 93		
Time commenced			Time commenced		
14:35			14:35		
Dist To FP 0490			Dist To FP 0490		
meters To Right —			meters To Right 500		
meters To Left 500			meters To Left —		

McElhanney

JOB NO.: _____ DATE Aug 31 / Sept 94 PAGE: 184

CREW: _____

WEATHER: _____

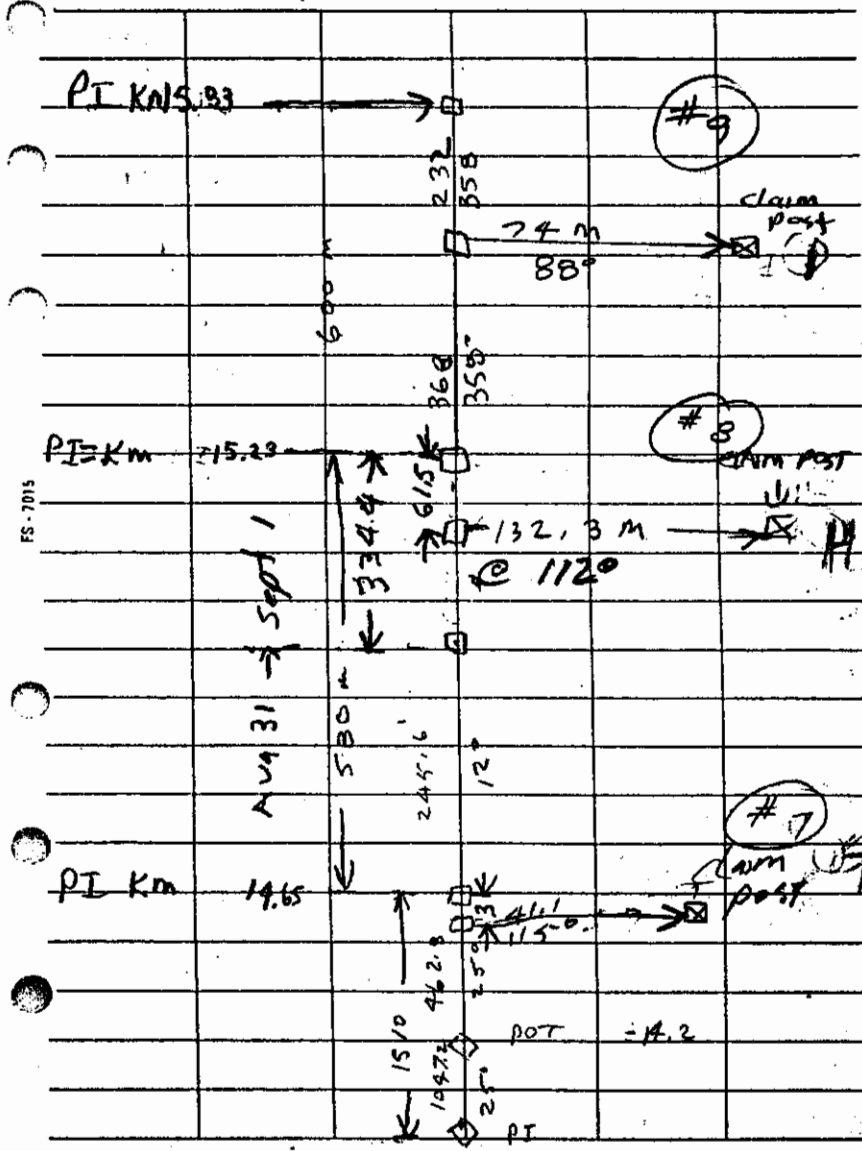

LEVEL NOTES OF:

#5

STA	BS	HI	IFS	FS	ELEV.
No 648144 M			No 648145 M		
FINAL POST #2			FINAL POST		
CLAIM NAME BEAR 43			CLAIM NAME BEAR 44		
LOCATOR J SMIDS			LOCATOR J SMIDS		
AGENT FOR ELCONDOR RES LTD			AGENT FOR ELCONDOR RES LTD		
Distance from IP 500m			Distance From IP 500m		
Date completed 06 FEB 93			Date completed 06 FEB 93		
Time Completed 1312			Time completed 1312		
No 648146 M			No 648147 M		
INITIAL POST #1			INITIAL POST #1		
CLAIM NAME BEAR 45			CLAIM NAME BEAR 46		
LOCATOR J. SMIDS			LOCATOR J. SMIDS		
AGENT FOR ELCONDOR RES LTD			AGENT FOR ELCONDOR RES LTD		
Date commenced 06 FEB 93			Date commenced 06 FEB 93		
Time commenced 1315 hrs			Time commenced 1315 hrs		
Dir to FP 049°			Dir to FP 049°		
Meters To Right —			Meters To Right 500		
Meters To Left 500			Meters To Left —		

#6

McElhanney

JOB NO.: _____ DATE: _____ PAGE: 182

CREW: _____
WEATHER: _____

No 648146 M	No 648147 M
FINAL POST #2	FINAL POST #2
CLAIM NAME BEAR 45	CLAIM NAME BEAR 44
LOCATOR J SMIDS	LOCATOR J SMIDS
AGENT FOR ELCONDOR RES LTD	AGENT FOR ELCONDOR RES LTD
DIST FROM IP 500m	DIST FROM IP 500m
DATE COMPLETED 06 FEB 93	DATE COMPLETED 06 FEB 93
TIME COMPLETED 1349 hrs	TIME COMPLETED 1350 hrs
No 648148 M	No 648149 M
INITIAL POST #1	INITIAL POST #1
CLAIM NAME BEAR 47	CLAIM NAME BEAR 48
LOCATOR J SMIDS	LOCATOR J. SMIDS
AGENT FOR ELCONDOR RES LTD	AGENT FOR ELCONDOR RES LTD
DATE COMMENCED 06 FEB 93	DATE COMMENCED 06 FEB 93
TIME COMMENCED 1349 hrs	TIME COMMENCED 1350 hrs
Dir to FP 049°	Dir to FP 049°
METERS TO RIGHT —	METERS TO RIGHT 500
METERS TO LEFT 500	METERS TO LEFT —

McElhanney

JOB NO.: _____ DATE: Aug 30 74 PAGE: _____
CREW: RE AL. MALL 181
WEATHER: OVERCAST

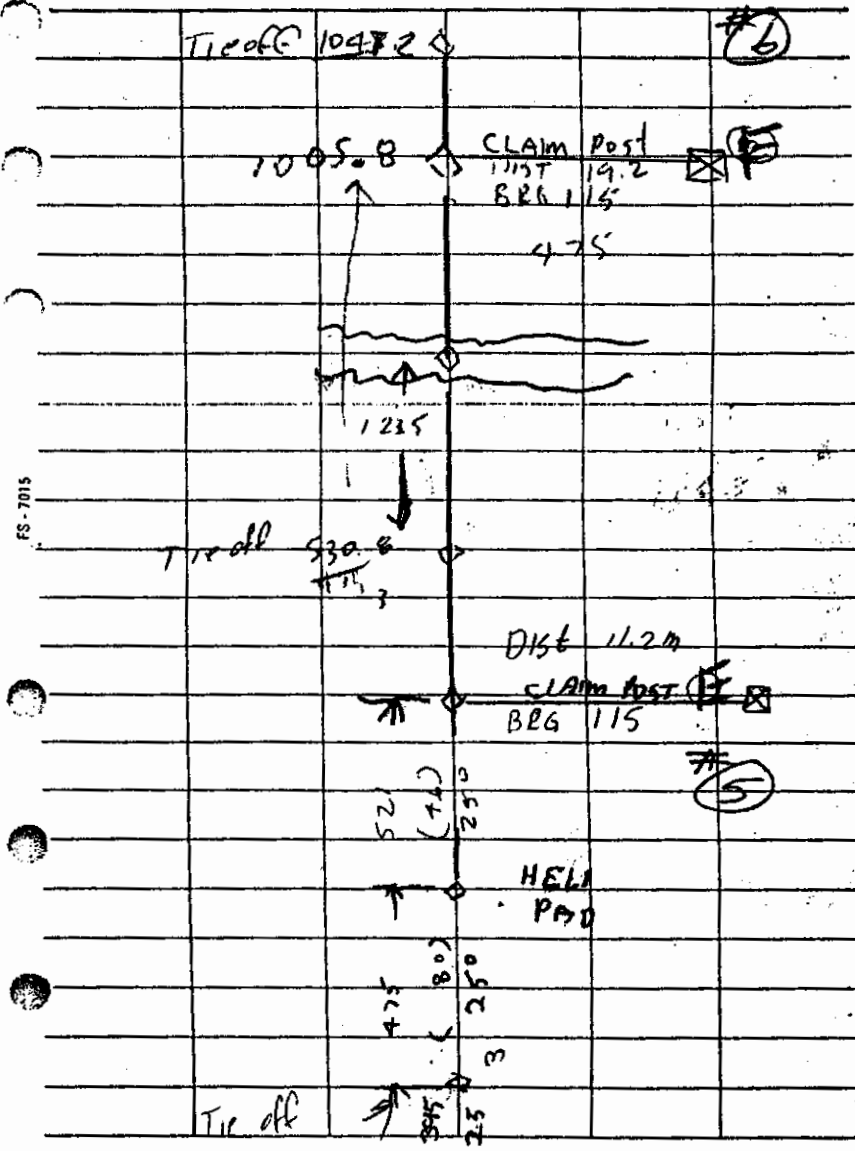

1047.2
395
65 2.2
GSE M

530.8
395
35 B
3A0

#4

LOCATION of CLAIM POST

No 648142 FINAL BEAR 41
 No 648143 FINAL BEAR 42
 No 648144 INITIAL BEAR 43
 No 648145 INITIAL BEAR 44

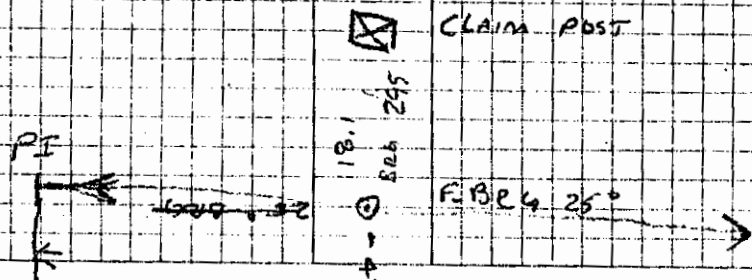

Kit on the Rain WEATHERPROOF

No. 382

J. J. DARRING CORP. TAUCOMA, WA 98171

No 648142 M
FINAL POST #2

(1)

#4

180

CLAIM NAME BEAR 41
 LOCATION J SMIDS
 AGENT FOR EL CONDOR RES LTD
 DIST FROM IP 500 M
 DATE COMPLETED 06 FEB 93
 TIME COMPLETED 12 29 hr

No 648143 M

FINAL POST #2

CLAIM NAME BEAR 42
 AGENT LOCATION J SMIDS
 AGENT FOR EL CONDOR RES LTD
 DIST FROM IP 500 M
 DATE COMPLETED 06 FEB 93
 TIME COMPLETED 12 29 hrs

No 648144

INITIAL POST #1

CLAIM NAME BEAR 43
 LOCATION J SMIDS
 AGENT FOR EL CONDOR RES LTD
 DATE COMMENCED 06 FEB 93
 TIME COMMENCED 12 30 hrs
 DIR TO FP 049°
 DISTANCE TO RIGHT —
 DISTANCE TO LEFT 500 M

No 648145

INITIAL POST #1

CLAIM NAME BEAR 44
 LOCATION J SMIDS
 AGENT FOR EL CONDOR RES LTD
 DATE COMMENCED 06 FEB 93
 TIME COMMENCED 12 30 hrs
 DIR TO FP 49°
 DIST TO RIGHT 500 M
 DISTANCE TO LEFT —

#3

LOCATION of Claims post
 FINAL No 648140, 141,
 BEAR 39 BEAR 40
 INITIAL No 648142, 143
 BEAR 41 BEAR 42

98.6A
 - BRG 309
 ⊗ d of L line
 ⊗ clamp post

No 648140 M
 FINAL POST #2



#3

179

CLAIM NAME BEAR 39
 LOCATOR J SMIDS
 AGENT FOR EL CONDOOR RES LTD
 Distance from IP 500 M
 Date Completed 06 FEB 93
 Time Completed 1140

No 648141 M
 FINAL POST #2
 CLAIM NAME BEAR 40
 LOCATOR J SMIDS
 AGENT FOR EL CONDOOR RES LTD
 Distance from IP 500 M
 Date Completed 06 FEB 93
 Time Completed 1140

No 648142 M
 INITIAL POST #1
 CLAIM NAME BEAR 41
 AGENT FOR EL CONDOOR RES LTD
 DATE COMMENCED 06 FEB 93
 DATE TIME COMMENCED 1145
 DIR to IP 29°
 meters to Right —
 meters to LEFT 500

No 648143 M
 INITIAL POST #1
 CLAIM NAME BEAR 42
 LOCATOR J SMIDS
 AGENT FOR EL CONDOOR RES LTD
 DATE COMMENCED 06 FEB 93
 TIME COMMENCED 1145
 DIR to IP 299
 meters to Right 500
 meters to Left —

TRAVEL TO LOCAL C
 CLAIM POST TO "L-Line" #2
 (# 648136 + 648137 F) 648138 & 648139 I

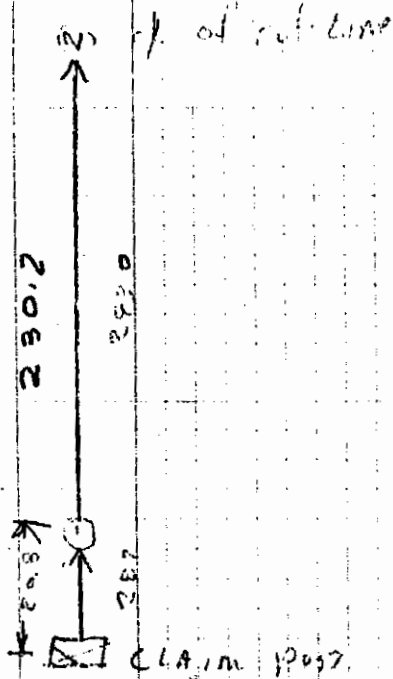

No 648136 M L #2 178
 FINAL POST #2
 CLAIM NAME BEAR 35
 LOCATOR 5 SMIDG
 AGENT FOR EL CONDON RES LTD
 DIST FROM IP 500 M
 DATE COMPLETED 06 FEB 93
 TIME COMPLETED 1020

No 64837 M
 FINAL POST #2
 CLAIM NAME BEAR 36
 LOCATOR 5 SMIDG
 AGENT FOR EL CONDON RES LTD
 DIST FROM IP 500 M
 DATE COMPLETED 06 FEB 93
 TIME COMPLETED 1020

No 648138 M
 INITIAL POST #1
 CLAIM NAME BEAR 37
 LOCATOR 5 SMIDG
 AGENT FOR EL CONDON RES LTD
 DATE COMMENCED 06 FEB 93
 TIME COMMENCED 1020
 DIR TO FP 049°
 DISTANCE RIGHT —
 DISTANCE LEFT 500 M

No 648139
 INITIAL POST #1
 CLAIM NAME BEAR 38
 LOCATOR 5 SMIDG
 AGENT FOR EL CONDON RES LTD
 DATE COMMENCED 06 FEB 93
 TIME COMMENCED 1020
 DIRECTION TO FP 049°
 DISTANCE RIGHT 500 M
 DISTANCE LEFT —

TRANSIT NOTES OF:

STA	SD	VA	HD	HA/BRG.
TAG No	648140	M		
INITIAL POST #1				
CLAIM NAME	BEAR 39			
LOCATED	J SMIDS			
AGENT FOR	ELCONDOR RES LTD			
DATE COMMENCED	06 FEB 93			
TIME COMMENCED	1105 HRS			
Dir To FP	049°			
M. R.	—			
M. Left	500			
TAG No	648140	M		
INITIAL POST #2				
CLAIM NAME	BEAR 40			
LOCATED	J SMIDS			
AGENT FOR	ELCONDOR RES LTD			
DATE COMMENCED	06 FEB 93			
TIME COMMENCED	1105 HRS			
Dir To FP	049°			
M R	500			
M L	—			

NO - 7831-MGL WATERPROOF

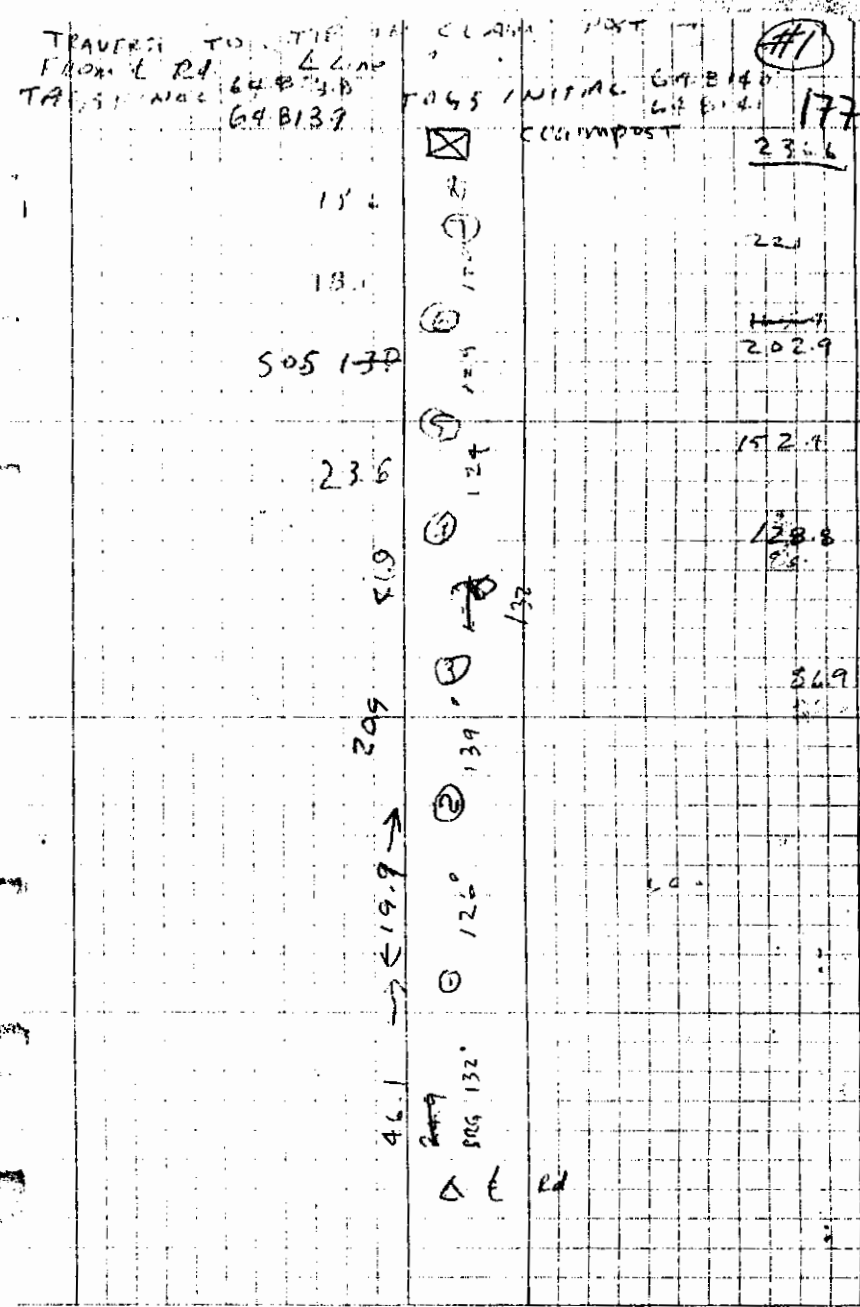

LEVEL NOTES OF:

STA	BS	HI	IFS	FS	ELEV.
24+563.7	777			996.15	
	343.8	4.2	+4.9		
24+570.3	777				
	343.6	20.8	+4.8		
24+579.5	777			993.98	
	343.1	18.4	-14.0		
24+501.1	875			996.56	
	343.4	134.1	-2.7		
24+467.0	775			997.48	
	343.2	12.2	+4.3		
24+54.8	775			998.28	
	342.7	34.7	+2.8		
24+420.1	765			995.99	
	342.7	34.6	+1.6		
24+385.5	765			995.44	
	342.9	38.5	+5.0		
24+347.0	775			993.51	
	342.7	26.1	+6.6		
24+320.9	775			991.79	
	342.7	23.4	+2.5		
24+297.5	775			991.20	

McElhanney

JOB NO.: _____ DATE: _____ PAGE: 163

CREW: _____

WEATHER: _____

776	+5	-6	(775)		
777	+5	-3	(772)		
778	+10	+6	(787)	500 @ 500	30 cm Blagan
779	+6.5	-14.5	(732)	(99) 256.0	38.1 7.7
779	+4	-26	(777)	(100) 281.1	22.6 +4.6
779	+4	-11	(772)	110 im tie	±22
779	+6	-10	(767)		
775	+4	-14	(762)		
775	-1.5	-12.5	(771)		
775	+4	-2	(752)		
	45				

LEVEL NOTES OF:

STA	BS	HI	IFS	FS	ELEV.
22+910.7	(475)			990.34	
	244.3	13.8	-4.1		
(22+896.9)	(475)			990.91	
	299.3	37.0	+1.6		
22+859.9	(475)			990.32	
	298.9	18.4	+13.7		
22+841.5	(475)			987.81	
	299.1	21.8	-1.3		
22+819.7	(475)			988.09	
	299.0	22.0	+2.5		
22+797.7	(475)			987.54	
	299.0	22.0	+2.9		
22+775.7	(475)			986.90	
	299.2	17.2	7.3		
22+758.5	(475)			985.64	
	299.4	35.5	+7.6		
22+723.0	(475)			982.94	
	299.4	36.7	+8.8		
22+686.3	(475)			979.71	
	299.1	21.6	+11.5		
22+664.7	(445)			977.23	

McElhanney

JOB NO.: _____ DATE: _____ PAGE: 57

CREW: _____

WEATHER: _____

(477)	(470)				
(475)	+6/10	-3	(475)		
				Claim tie # 21	
(471)	-2		(477)		
(460)	0		(437)	Claim line King	
(481)	+4		(452)		
(478)	+2		(477)		
(471)	-2		(472)		
(466)	0		(467)	Helipad	
(461)	-1		(462)		
(451)	+3		(457)		
(451)	-2		(452)		

JOB NO.: _____ DATE: 11/1

CREW: _____

WEATHER: _____

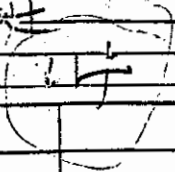

CC Camp and Found
 DOCKED
 FINAC BEAR 61
 FINAC BEAR 62
 FINAC BEAR 63
 FINAC BEAR 60

FS-7015

Part # 635304
 635304
 635373
 635373
 635373

210

JOB NO.: _____ DATE: _____ PAGE: _____
CREW: _____
WEATHER: _____

①

Claim post LOCATED

&

RECORDED

Post # 648161 FINAL BEAR 67
648160 FINAL BEAR 68

Post # 648162 INITIAL BEAR 69
Post # 635329 INITIAL BEAR 70

Rick

FS-7015

JOB NO.: _____ DATE: _____ PAGE: _____
CREW: _____
WEATHER: _____

①
16

Claim post LOCATED
and
RECORDED

Post # 648158^M FINAL BEAR 65
Post # 648159^M FINAL BEAR 66

Post # 648161 INITIAL BEAR 67
Post # 648162 INITIAL BEAR 68

Rick

FS-7015

CLAIM POST DATA - FIELD BOOK #4

LEVEL NOTES OF:

STA	BS	HI	IFS	FS	ELEV.
		2310			
		35+658			
		Brg 297°	117°		
		HD 13			
		% +40			
		Brg 297°	117°		
		HD 23			
		% +38			
		Bra's From claim post		2211	
				Rec 9 25	

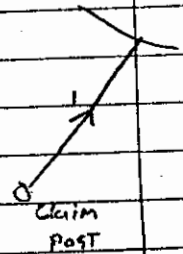

claim of 102, 132, 162, 192, 222

36 + 650

McElhanney

JOB NO.: _____ DATE: Sept 17/94 PAGE: 37

CREW: _____

WEATHER: _____

				% +1	
				N9E	(232)
				30	Rec 100
	+38/10	+40/14	+28/14	(232) 35+859	-32/14 -33/15 -30/10
				% +6 1/2	(231)
				N9E	
				30	
				(231)	
		Andrew		35+829	230
				% +4	
				N9E	
				30	
	+45/10	+51/15	+47/15	(231) 35+799	-37/20 -10/15
				% +9	229
				N9E	
				30	
				(229)	
		Andrew		35+769	

FS-7015

56, 66, 80, 92, 102
 LEVEL NOTES OF:
 35+769
 % + 37

STA	BS	HI	IFS	FS	ELEV.
		N9E	(228)		
		10			
Brg 273	Brg 277		Brg 99°	Brg 129°	
+33/23	+25/17	35+759	19/8	-33/25	
		E culvert	600 mm		
		% - 10	(221)		
Tree's Balsam		N9E			
ONE OR TWO SPRUCE UP TO 0.5		12			
		(217)			
Andrew		35+747			
Ground 0.4 strip					
Till with rock UP TO 0.5		% + 1	(226)		
		N9E			
		14			
+40/15	+44/20	(224)	-47/10	-42/25	
		35+733			
		% + 27	(225)		
		N9E			
		10			
		(225)			
		35+723			

351648 McElhanney

JOB NO.: _____ DATE: Sept 16/94 PAGE: 36
 CREW: EN, AF
 WEATHER: _____

NO	650923	M	NO	650924
	Final Post (No. 2)			
Claim Name	Red 23		Red 24	
Locator	B Hobson		B Hobson	
Agent For	El condor Res LTD		El condor Res LTD	
DIST From I.P.	500		500	
Date Completed	Feb 7 1993		Feb 7 1993	
Time Completed	13 50 HRS		13 51 HRS	
NO	650925		NO	650926
	INITIAL Post (No. 1)			
Claim Name	Red 25		Red 26	
Locator	B Hobson		B Hobson	
Agent For	El condor Res LTD		El condor Res LTD	
Date Commenced	Feb 7 1993		Feb 7 1993	
Time commenced	13 54 HRS		13 56 HRS	
DIR TO FP	40°		40°	
metres To Right	—		Right 500	
metres To Left	500		Left —	

FS-7015

200, 230

LEVEL NOTES OF:

245E
39E
2600

(222)

357667

STA	BS	PT M.	IFS	FS	ELEV.
		% +9			
		N 13W	(221)		
		2219			
Andrew		35+658			
		% +18			
		N 13W	(220)		
		30			
		(220)			
Andrew		35+628			
		% +13	(219)		
		N 13W			
		30			
		+40/ 35	(219)	-35/ 12	-32/ 20
		35+598			-25/ 10
		% +11			
		N 13W	(218)		
		30			
		(218)			
Andrew		35+568			

Look on page 36
Tied in
claim
post

30) 46) 56

McElhanney

JOB NO: _____ DATE: Sept 16/94 PAGE: 35

CREW: EN, AF

WEATHER: _____

		(225)			
	Andrew	35+723			
		E culvert MIN			
		% -17			
		N 9 E	(224)		
		10			
		+40/ 20	(225)	-46/ 15	-34/ 20
		35+713			
		% -3			
		N 9 E	(223)		
		35cm Balsum			
		16			
		Ref # 147	(222)		
		HD 19.9			
	Andrew	35+697			
		N 43 W			
		% +42			
		% +5			
		N 9 E			
		30	(222)		
		40 cm Balsum			
		Ref # 146	(222)		
		HD 18.3			
		566 W			
		35+667			
		% +38			
		P.I			

FS-7015

From STA 34+20.4

LEVEL NOTES OF:

Crew EN AF

STA	BS	HI	IFS	FS	ELEV.
No 650917			No 650918		
FINAL POST #2 NAME Red 17			FINAL POST #2 NAME Red 18		
LOCATOR B Hobson			LOCATOR B Hobson		
AGENT FOR EL Condor Res LTD			AGENT FOR EL Condor Res LTD		
Dist from IP 500			Dist from IP 500		
Date completed Feb 1993			Date completed Feb 1993		
TIME completed 1116 HRS			TIME completed 1118 HRS		
No 650919			No 650920		
INITIAL POST #1			INITIAL POST #1		
CLAIM NAME Red 19			CLAIM NAME Red 20		
LOCATOR B Hobson			LOCATOR B Hobson		
AGENT FOR EL Condor Res LTD			AGENT FOR EL Condor Res LTD		
DATE COMMENCED Feb 1993			DATE COMMENCED Feb 1993		
TIME COMMENCED 1120 HRS			TIME COMMENCED 1122 HRS		
DIP TO CP 029°			DIP TO CP 029°		
METERS RIGHT —			METERS RIGHT 500		
METERS LEFT 500			METERS LEFT —		

From 34+20.7 To PC 35+39.8
511 more
McElhanney

JOB NO.: _____ DATE: SEPT 15/94 PAGE: 31
CREW: EN AF
WEATHER: 34+94.7

			%+4		
			N 7 1/2 E	(194)	
			30		
	+27/+38	+28/	(194)	-30/	-35/
	/20/8	/15	34+917	/15	/20
			%+6		
			N 7 1/2 E	(193)	
			30		
			(193)		
	Andrew		34+887		
			%+10	(192)	
			N 7 1/2 E		
			30		
	+24/	+26/	(192)	-24/	-23/
	/15	/25	34+857	/15	/25
			Eng 276° & min culvert Eng 98°		
			%+13		
			N 7 1/2 E	(191)	
			30		
			(191)		
	Andrew		34+827		

FS-7015

FROM

STA 33 219
LEVEL NOTES OF:

CLAIM POST INFORMATION

GLDANE CONNECTOR

STA	BS	HI	IFS	FS	ELEV.
No 650913			No 650914		
FINAL POST #2			FINAL POST #2		
CLAIM NAME Red 13			CLAIM NAME Red 14		
LOCATOR B Hobson			LOCATOR B Hobson		
AGENT FOR El Condor Res LTD			AGENT FOR El Condor Res LTD		
DIST FROM IP 500			DIST FROM IP 500		
DATE COMPLETED Feb 7 1993			DATE COMPLETED Feb 7 1993		
TIME COMPLETED 1000 HRS			TIME COMPLETED 1001 HRS		

No 650915			No 650916		
INITIAL POST #1			INITIAL POST #1		
CLAIM NAME Red 15			CLAIM NAME Red 16		
LOCATOR B Hobson			LOCATOR B Hobson		
AGENT FOR El Condor Res LTD			AGENT FOR El Condor Res LTD		
DATE COMMENCED Feb 7 1993			DATE COMMENCED Feb 7 1993		
TIME COMMENCED 1002 HRS			TIME COMMENCED 1003 HRS		
DIR TO FP 029°			DIR TO FP 029°		
METERS RIGHT —			METERS RIGHT 500		
METERS LEFT 500			METERS LEFT —		

33+702

McElhanney

JOB NO: _____ DATE: _____ PAGE: _____

CREW: EN, AF

WEATHER: _____

No 650915		No 650916	
FINAL POST #2		FINAL POST #2	
CLAIM NAME Red 15		CLAIM NAME Red 16	
LOCATOR B Hobson		LOCATOR B Hobson	
AGENT FOR El Condor Res LTD		AGENT FOR El Condor Res LTD	
DIST TO IP 500		DIST TO IP 500	
DATE COMPLETED Feb 7 1993		DATE COMPLETED Feb 7 1993	
TIME COMPLETED 1039 HRS		TIME COMPLETED 1040 HRS	
BOTH TAGS DISTROYED chewed up By animals ↓ ripped off post can't read more			
No 650917		No 650918	
INITIAL POST #1		INITIAL POST #1	
CLAIM NAME Red 17		CLAIM NAME Red 18	
LOCATOR		LOCATOR	
AGENT FOR		AGENT FOR	
DATE COMMENCED		DATE COMMENCED	
TIME COMMENCED		TIME COMMENCED	
DIR TO FP		DIR TO FP	
METERS RIGHT		METERS RIGHT	
METERS LEFT		METERS LEFT	

LEVEL NOTES OF:

34+827

0/0-3

STA	BS	HI	IFS	FS	ELEV.
		N 7 1/2 E	(190)		
		24			
+30/10	+43/20	+17/14	(190)	-23/30	-20/10
		34+803			
		0/0-8	(189)		
		N 7 1/2 E			
		30			
Andrew		34+773			
		0/0+16	(188)		
		N 7 1/2 E			
		13			
		Brg 265°			
		+36/35	(185)	Brg 113°	
		34+760		-23/35	
Tree's		& culvert min			
Balsam 0 to 0.6		0/0-12			
one two spruce 0 to 0.6		N 7 1/2 E	(187)		
ground 0.4 strip		17			
Till with stones			(187)		
up to 0.5					
Andrew		34+743			

Travers from 34+650 claim post
 JOB NO: _____ DATE: _____ PAGE: 32
 CREW: EN, AF
 WEATHER: _____

	claim post				
	Brg 327°				
	30				
	Brg 274°				
	25				
	Brg 348°				
	16				
	Brg 305°				
	17				
	Brg 270°				
	26				
	Brg 275°				
	30				
	Brg 279°				
	30				
	34+650				

FS-7015

LEVEL NOTES OF:

McElhanney

JOB NO.: _____ DATE: Sept 14/94 PAGE: 24

CREW: _____

WEATHER: _____

STA	BS	HI	IFS	FS	ELEV.
		142			
		33+642			
		% +19 1/2			
		N 7 1/2 E	(141)		
		16			
		(141)	-22/15	-26/25	
		33+626			
		Brig 290° E culvert Min		Brig 87°	
		% -15 1/2			
		N 7 1/2 E	(140)		
		17			
		(14)			
	Andrew	33+609			
		% -6 1/2	(139)		
		N 7 1/2 E			
		29			
		(134)	-21/14	-28/25	
		33+580			

		33+755	(145)		
		% +1	Edge of opening		
		N 7 1/2 E			
		30			
		+31/40	145		
		Brig 275°	33+725		
		% -6 1/2	← Creek		
		N 7 1/2 E	(144)		
		23			
		(144)	Brig 285°		
		33+702			
		% -5			
		N 7 1/2 E	(143)		
		30			
		+28/20	+43/18	143	
		33+672			
		% +5	(142)		
		N 7 1/2 E			
		30			
		(142)			
		33+642			

Some
Belemnite
Remains

+31/20 +60/14 +30/10

Brig 290° E culvert Min

claim post

FS-7015

Brig 285°

24 m 1/2

Ground
of a stripping
fill
with stones
up to 0.5

open
area
slide
← 70m →

	(110)		
	32+799		
	%+6	(109)	
	N 5 1/2 E		
	30		
+14/40	(109)	-9/15	-14/25
	32+769		
	HP 30	(108)	
	%+4		
	N 5 1/2 E		
	(108)		
Andrew	32+739		
B=260°	⊥ culvert	Brg 96	
	%-4	1.2 m	
	N 5 1/2 E	(107)	
	14		
+17/30	(107)	-15/40	
+23/8	32+725		
	%-10 1/2		
	N 5 1/2 E	(106)	
	30		
	(106)		
Andrew	32+695		

30m
14m
claim Post
Brg 97°

	(113)		
	32+883		
	%+6	(112)	
	N 5 1/2 E		
	30		
	(112)		
	Brg 260°	32+853	Brg 80°
	⊥ culvert		600mm
	%+1	(111)	
	N 5 1/2 E		
	24		
+16/25	(111)	-12/15	+10/20
+12/15			
Trces Belson at 0.5	32+829		
	%+2	(110)	
	N 5 1/2 E		
	30		
	(110)		
Andrew	32+799		

Ground
0.4 stripping
silted with
stones up to 0.5

	32+312			
	% 0			
	N 11W	(90)		
	30			
+12/10 +7/20 +29/10	32+282	(90)	-17/12	-18/10 -25/15
Trees Balsam 0 to 0.5	% +1 1/2			
ground 0.4 strip clay gravel with stone upto 0.3	N 11W	(89)		
	30			
Andrew	32+252	(89)		
	% +5	(88)		
	N 11W			
	30			
claim post 0 - 8m 15% dist 29m	32+222	(88)	-8/15	-16/25
+12/18 +15/25				
	% -2 3/4			
	N 11W	(87)		
	15			
Andrew	32+207	(87)		

3971, 427, 441, 171

FORM 6910

Job No. _____ Date SEPT 12/94 Page 13

Surveyor EN, AF

	32+416	(95)		
	% +2			
	N 11W	(94)		
	30			
+13/25 +14/15	32+386	(94)	-13/30	
Brq 263°	& culvert		min Brq 80°	
	% +2			
	N 11W	(93)		
	12 14			
		(93)		
Andrew	32+372			
		(92)		
	% -3			
	N 11W			
	30			
+12/35	32+342	(92)	-18/25	-10/5 -29/10
	% +1			
	N 11W	(91)		
	30			
Andrew	32+312	(91)		

NCI 983

225, 225, 232 262

(87)
32+207

4

90+3 1/2

N 11W

30

(86)

Brg 268°

32+177

Brg 75°

-15/

11/25

E color

r / 25.

90-1

min 600 mm

N 11W

(85)

7

12/35

(85)

-10/12

-17/25

32+170

90-3

(84)

N 11W

30

(84)

Andrew

32+140

Tree's Balsam
2 T.D.O.S

Ground 0.4 strip

90 0

(83)

clay gravel

N 11W

with stones up
to 2-3

30

7/15

+20/25

(83)

-30/12

-12/20

-36/15

32+110

FORM 891C



Job No.

Date SEPT 12/94

Page

12

Surveyor

EN, AF

Claim Post

Tic

From STA 32+222

claim Name Red 9

Locator

B Hobson

AMT for

El condor

Dist from I.P. 500

DATE COMPLETED Feb 6 93

Time Completed 1400 hrs

Red 10

B Hobson

El condor

500

Feb 6 93

1402 hrs

Red 11

B Hobson

El condor

Feb 6 1993

1406 hrs

DUE TO EA 0 29°

RIGHT

LEFT

500

Red 12

B Hobson

El condor

Feb 6 1993

1410 hrs

0 29°

500

NCI 983

76

claim tags from 31+139

Red 7
B Hobson
EL Condor Res LTD
Feb 6 1993
12:15 Hrs
Dir to Fr. 0290
meter to Right
meter to Left Sop

Red 8
B Hobson
EL Condor Res LTD
Feb 6 1993
12:20 Hrs
0290
Right Sop
Left —

31+231

% +33

N 7 W

40 22

Andrew 31+209

% 0

N 7 W

24

P.I. 125

+1/20 +10/10

+43/15

31+185

-16/35

-30/10

% -38

N 7 W

16

Andrew

31+169

17 - 40

31.231
109
122

109



FORM 8910

Job No.

Date

SEPT 11 / 99

Page

7

Surveyor

EN AP

31+298 (51)

% +8 1/2

N 61 E

33

+3/40

31+265

-4/8

-42/27

-20/15

% +35

N 61 E

8

+28/10 ←

Arg = 240° 31+257

E cuiver min

% 0 - 16

N 61 E

6

31+251

% +2

N 61 E

20

-1/20

+12/10

-7/12

+20/6

31+231

-54/13

-34/20

-27/10

P.I.

150 180 210 240



FORM 6910

Job No. _____ Date Sept 11/94 Page 6

Surveyor EM, AF 31+189

Claim name <u>RED 5</u>	claim post	% + 5 1/2	
Locator <u>B. Hobson</u>		N 7° W	(43)
Agent for <u>Ed Cantor</u>	Brg 330°	30	
DIST from I.P. <u>500</u>	8.2 m	(43)	-11/10 -55/20 -30/15
Date completed <u>Feb 6 1993</u>		31+139	
Time completed <u>12:10 hrs</u>			
<u>RED 6</u>			
<u>B. Hobson</u>			
<u>Ed Cantor RES LTD</u>		% - 2 1/2	(42)
<u>500</u>		N 8° W	REF# 129
<u>Feb 6 1993</u>		30	N 54 E
<u>12:12 hrs</u>			% - 11
			HD 22.8 m
<u>Andrew</u>		(42)	
		31+109	
<u>+2/25</u>	<u>-10/3</u>	<u>+9/12</u>	
		P.I	30 cm spruce
		% + 2	REF# 128
		N 15 E	545 E
		6	% - 8 1/2
			HD 22 m
		(41)	
		31+103	
		% + 8 1/2	-50/30
		N 15 E	
		30	(40)
		(40)	
<u>Andrew</u>		31+073	

NCI 983

	(40)			
	31+073			
	% + 4	(39)		
	N 15 E			
	30			
<u>-5/17</u>	<u>+12/6</u>	<u>-5/12</u>	<u>+13/10</u>	
	(39)	<u>-5/30</u>	<u>-10/4</u>	<u>-38/20</u>
	31+043			
	% 87 1/2			
	N 15 E	(39)		
	30			
	(38)			
<u>Andrew</u>	31+013			
<u>Ground</u>	<u>2.4 striping</u>	(37)		
<u>clay soil</u>	<u>500</u>	% + 2		
<u>Tree's Balsam</u>	<u>0.70 0.5</u>	N 15 E		
	30			
<u>0/30</u>	<u>-5/13</u>	(37)	<u>-14/10</u>	<u>-40/9</u>
	301983		<u>-24/16</u>	<u>-35/10</u>
	% + 9			
	N 15 E			
	30			
	(36)			
<u>Andrew</u>	30+953			

CLAIM POST DATA - FIELD BOOK #5

330, 360, 390, 400, 430

(316)
37+959

0/0-2

N16E

30

3154

3151

(315)

3153

3154

+8/

+10/

37+929

-6/

-15/

20

8

& culvert

min

14

15

Br 371° 0/0-15

Br 371°

N16E

10

(314)

Andrew

37+919

Tree's

Batsum to 0.5

0/0-6

(313)

Ground 0.4 strip

N16E

30

3133

3134

3135

3136

Till with stones

3171

(313)

-3/

-18/

-28/

-20/

312+13

0/

37+889

17

10

8

10

25

14

0/0+1

N16E

30

(312)

Andrew

37+859

NO. 25 CLAIM
38 + 270

McElhanney

Job No.

Date Sept 19/94 Page 50

Surveyor

EN, AF

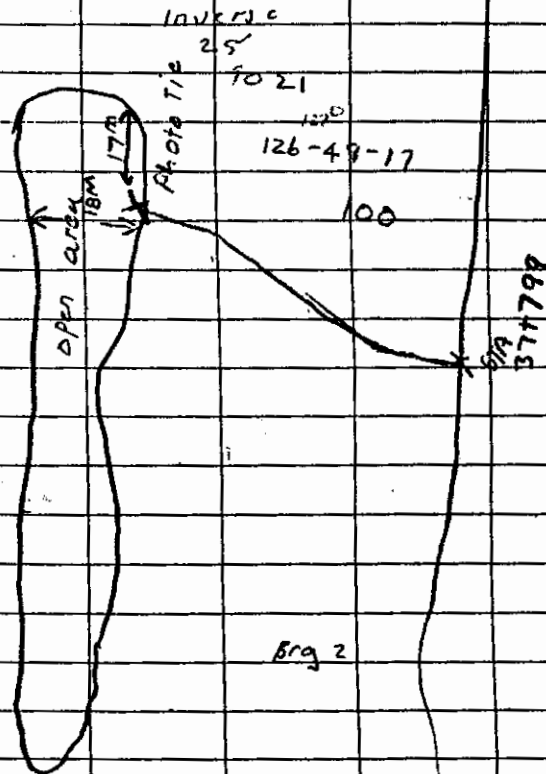

FS-7010

LEVEL NOTES OF:

39+658

0/0-3

STA	BS	HI	IFS	FS	ELEV.
		NoE	(379)		
		30			
		(379)			
		39+638			
		0/0-5	(378)		
		NoE			
3782	3781	30	3783	3784	3785
+8/25	0/13	(378)	0/-28/6	-19/7	-9/18
		39+608			
Tree's		0/0			
Balsam	0 To 0.5	NoE	(377)		
one two	spruce				
To 0.5		29			
		(377)			
Andrew		39+579			
Ground					
0.4	strip	0/0+2	(376)		
Till with		NoE			
stones up to		30			
0.5		(376)			
		39+549			

McElhanney

JOB NO.: _____ DATE: SEPT 21/94 PAGE: 61

CREW: EN, AP

WEATHER: _____ 39+752

			E creek		
			0/0-2		
			NoE		383
			13		
			(382)		
			39+739		
			0/0+1		(382)
			NoE		
			3821	3822	3821
			30		3824
			+8/13	+12/7	+5/15
			(382)		-3/20
			39+709		
			0/0-2		
			NoE		(381)
			14		
Andrew			(381)		
			+8/25	+12/10	+5/15
			39+695		
			0/0+1		
			NoE		(380)
			3802	3801	
			Ground 0.5	strip	
			27		3803 3804 3805
			+8/25	+6/10	(380)
			39+668		
			-7/13	+5/12	-3/15

Photo Tie Rod

claim post

FS-7015

SURVEY DATA - HELICOPTER PADS

HELICOPTER PAD - LOCATIONS

Coordinate System: NAD83 UTM129W

Datum Name: NAD83

Ellipsoid: GRS80 A= 6378137.00, B= 6356752.31

Generic Tfm: dx= 0.000, dy= 0.000, dz= 0.000

rx= 0.000, ry= 0.000, rz= 0.000

scale= 0.0000 ppm

Specific Tfm: Use grid file "grid.dac"

Coordinate Type: UTM Mapping Plane

False North = 0.0, False East = 500000.0

Central Meridian = -129.00, Scale Factor = 0.99960

Zone Width = 6.00

Name	Northing	Easting	H	N	HI
heli pad 01	6242966.9125	629124.8401	0.0000	0.0000	0.0000
heli pad 02	6244123.9810	630544.0784	0.0000	0.0000	0.0000
heli pad 03	6245732.4418	632732.1921	0.0000	0.0000	0.0000
heli pad 04	6247369.3518	634021.0456	0.0000	0.0000	0.0000
heli pad 05	6251058.3368	635027.2607	0.0000	0.0000	0.0000
heli pad 06	6251710.2994	634512.2704	0.0000	0.0000	0.0000
heli pad 07	6252545.9043	635103.4885	0.0000	0.0000	0.0000
heli pad 08	6254527.9855	634968.3473	0.0000	0.0000	0.0000
heli pad 09	6263775.6794	635628.7955	0.0000	0.0000	0.0000
heli pad 10	6258132.4465	636796.8404	0.0000	0.0000	0.0000
heli pad 11	6259079.2683	636221.4467	0.0000	0.0000	0.0000
heli pad 12	6259866.2463	637593.8885	0.0000	0.0000	0.0000
heli pad 13	6262320.7963	638284.4879	0.0000	0.0000	0.0000
heli pad 14	6264279.1966	639688.6856	0.0000	0.0000	0.0000
heli pad 15	6266307.7672	639837.1519	0.0000	0.0000	0.0000
heli pad 16	6269041.9398	640546.5929	0.0000	0.0000	0.0000

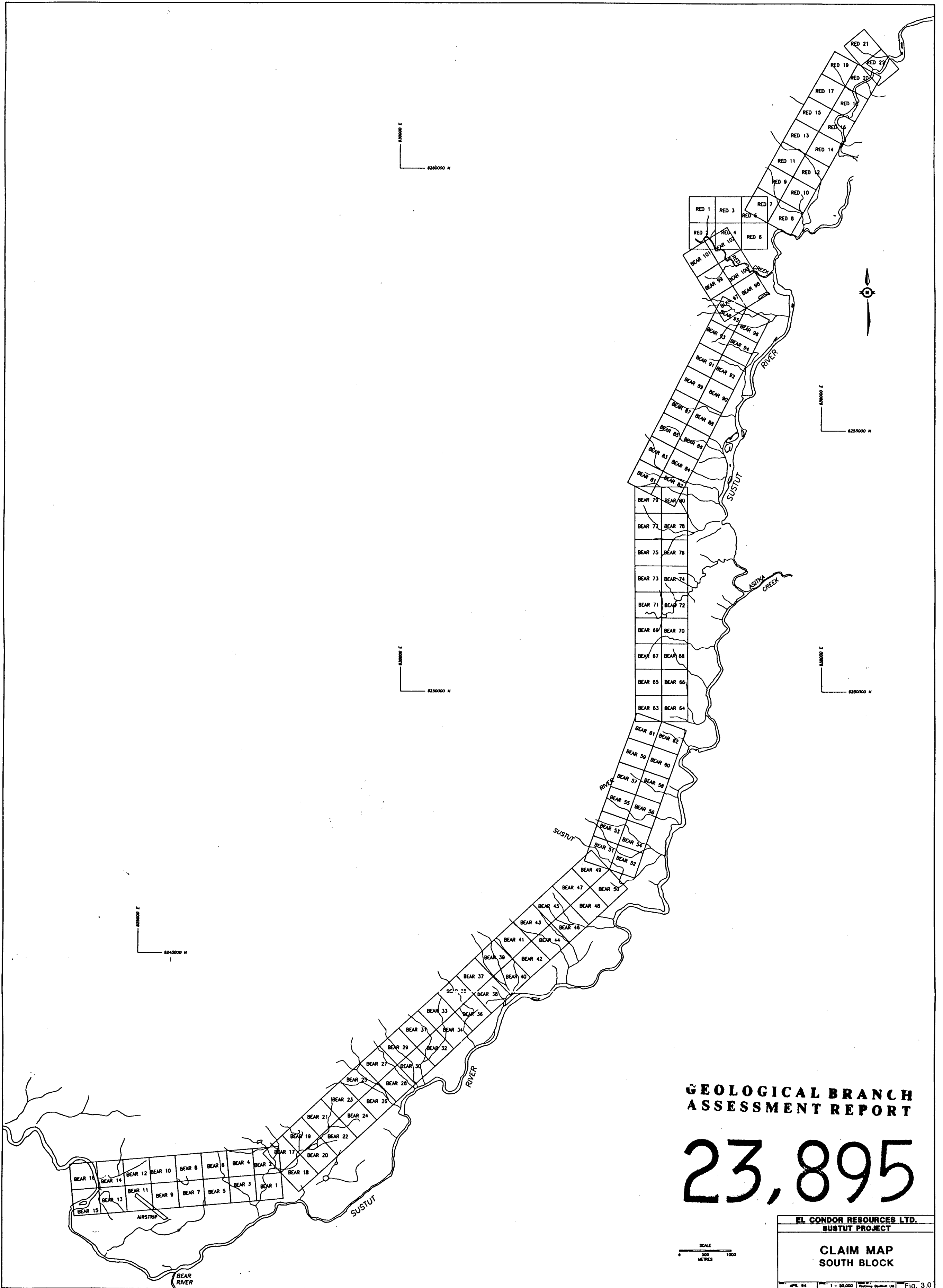

**GEOLOGICAL BRANCH
ASSESSMENT REPORT**

23,895

EL CONDOR RESOURCES LTD.	
SUSTUT PROJECT	
CLAIM MAP SOUTH BLOCK	
APR. 84	1:50,000

SCALE
0 500 1000
METRES

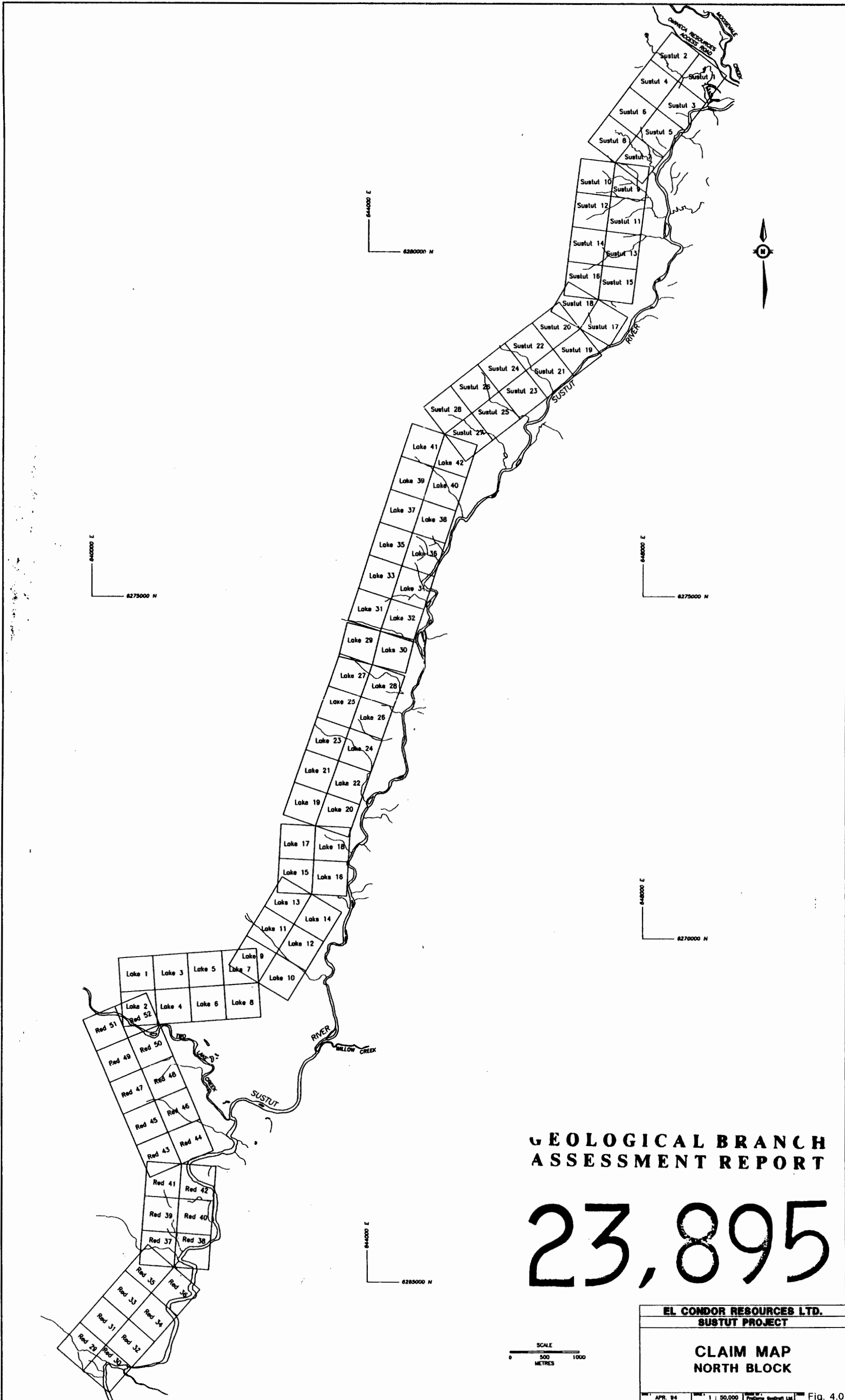

**GEOLOGICAL BRANCH
ASSESSMENT REPORT**

23,895

EL CONDOR RESOURCES LTD.	
SUSTUT PROJECT	
CLAIM MAP NORTH BLOCK	
APR. 94	1 : 50,000

Fig. 4.0

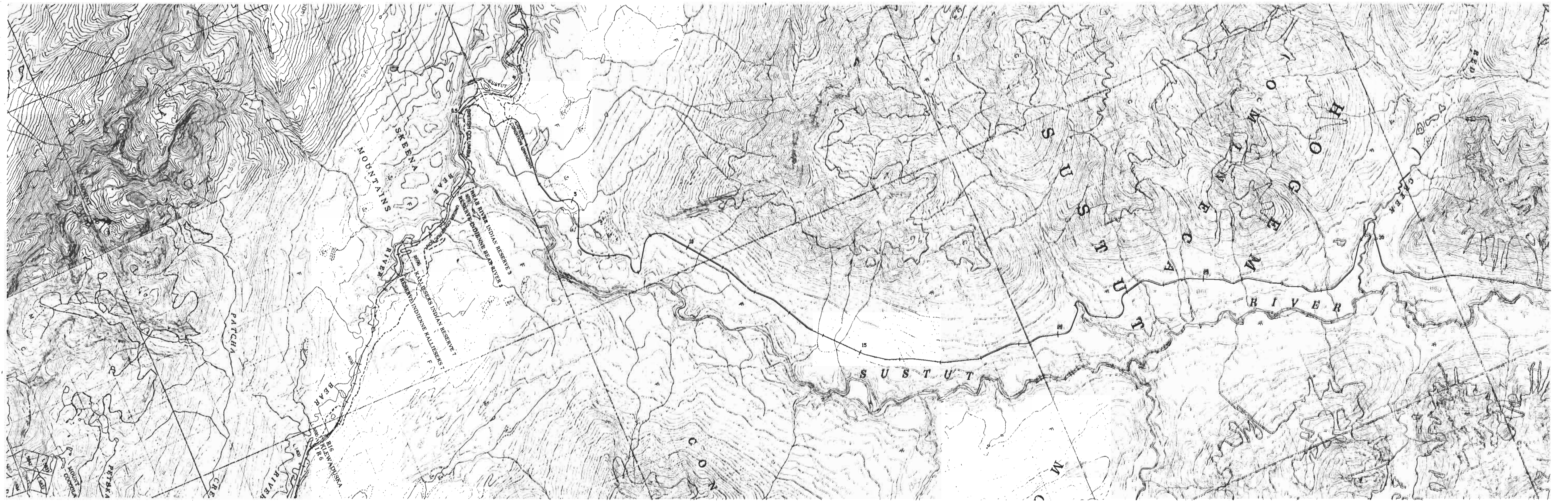

LEGEND:
 15 Kilometre 0.5 to 43, cut & surveyed in 1994
 30 Kilometre 43 to 63, cut & surveyed in 1993

No.	Date	Revision	Dr.	Cl.

McELHANNEY CONSULTING SERVICES LTD.
 100-780 BEATTY ST., VANCOUVER, B.C., V6B 2M1. TEL: (604) 683-8521 FAX: (604) 683-4350



KEMESS SOUTH JOINT VENTURE
SUSTUT PROJECT
 Cut and Surveyed Center-line

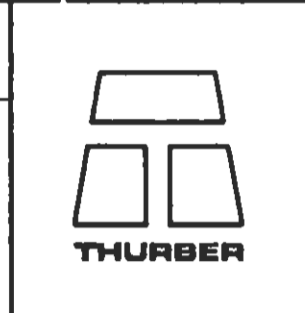

Located	RRS	Job No.	2113-00442-0	Drawing No.	
Designed	DC/ED	Scale	Hor. 1 : 50000	FIGURE 7.0	
Checked	RJF	Date	DEC 1994		
Approved	JDC	Revision			

This drawing and design is the property of McElhanney Consulting Services Ltd. and cannot be used, reused, or reprinted without the written consent of said company.

Destroy all prints bearing previous number

23,895
 GEOLOGICAL BRANCH
 ASSESSMENT REPORT