

GEOLOGICAL SURVEY BRANCH
ASSESSMENT REPORTS

DATE RECEIVED
JAN 25 1996

PROSPECTING REPORT FOR ANNIE BELL CLAIM

Vernon Mining Division, B.C.

82L/5E

50°19'N, 119°38'W

Owners: Glen Grywacheski

Operator: G. Grywacheski

Author: A. Higgins

Date: January 10, 1996

**GEOLOGICAL SURVEY BRANCH
ASSESSMENT REPORT**

24,262

TABLE OF CONTENTS

1.	Introduction	(i)	location, access	Pg. 1
		(ii)	property definition	Pg. 1
		(iii)	work summary	Pg. 1
2.	Technical Data and Interpretation			
		(i)	purpose	Pg. 1
		(ii)	results	Pg. 1
		(iii)	interpretation	Pg. 2
		(iv)	conclusions	Pg. 2
3.	Prospector's description of observations			Pg. 3
4.	Cost Statement			Pg. 4
5.	Statement of Qualifications			Pg. 5

Figure 1 Index map, Annie Bell Claim

Figure 2 Plan map of prospecting, Flash claims

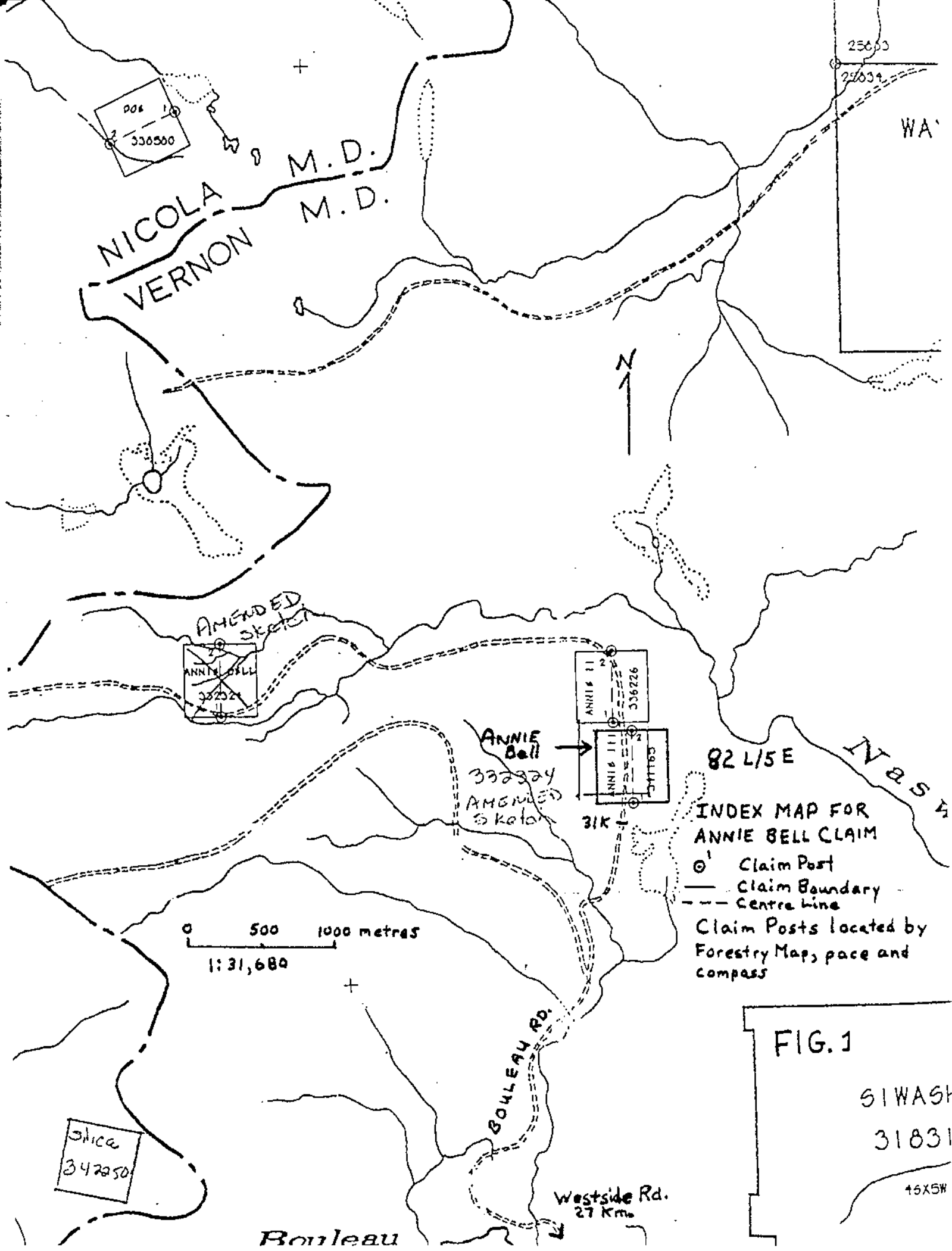

FIG. 1

SIWASH
31831

45X5W

1. Introduction:

(i) Location and Access:

The Annie Bell claim (Figure 1) is located in Vernon Mining Division about 20 km west of Okanagan Lake, approximately 60 km by road west from Vernon, B.C. The initial post of the 2-post claim is located just north of 31 km on Bouleau Forest Rd., which leaves Westside Rd. at Whiteman Creek.

(ii) Property Definition:

The claim was staked in 1994 by owner Glen Grywacheski to cover showings of lapidary rock exposed in old workings (pre-1972). Operator is G. Grywacheski.

Chalcedony and agate of good lapidary quality are found in several locations along Bouleau Forest Road on the claim.

(iii) Work Summary:

Work from May to October consisted of collection of about 200 kg. of loose surface material over an area of 100m² and 30 kg. of samples obtained by one day of jackhammer work on two in situ vertical seams of material.

Figure 2 is a plan of the claim showing the location of surface sample collection and jackhammer work.

2. Technical Data and Interpretation:

(i) Purpose:

Seven days of prospecting and sample collection (using hand methods) were conducted from May to August to find and collect material for investigation of lapidary qualities. One day was spent in October using a jackhammer to extract material at depth from a vertical seam exposed in the road ditch and another vertical seam exposed in old cat workings nearby.

(ii) Results:

At least six vertical seams of chalcedony and agate outcrop on the property, and are best exposed along Bouleau Forest Rd. in the central area of the claim. The author of

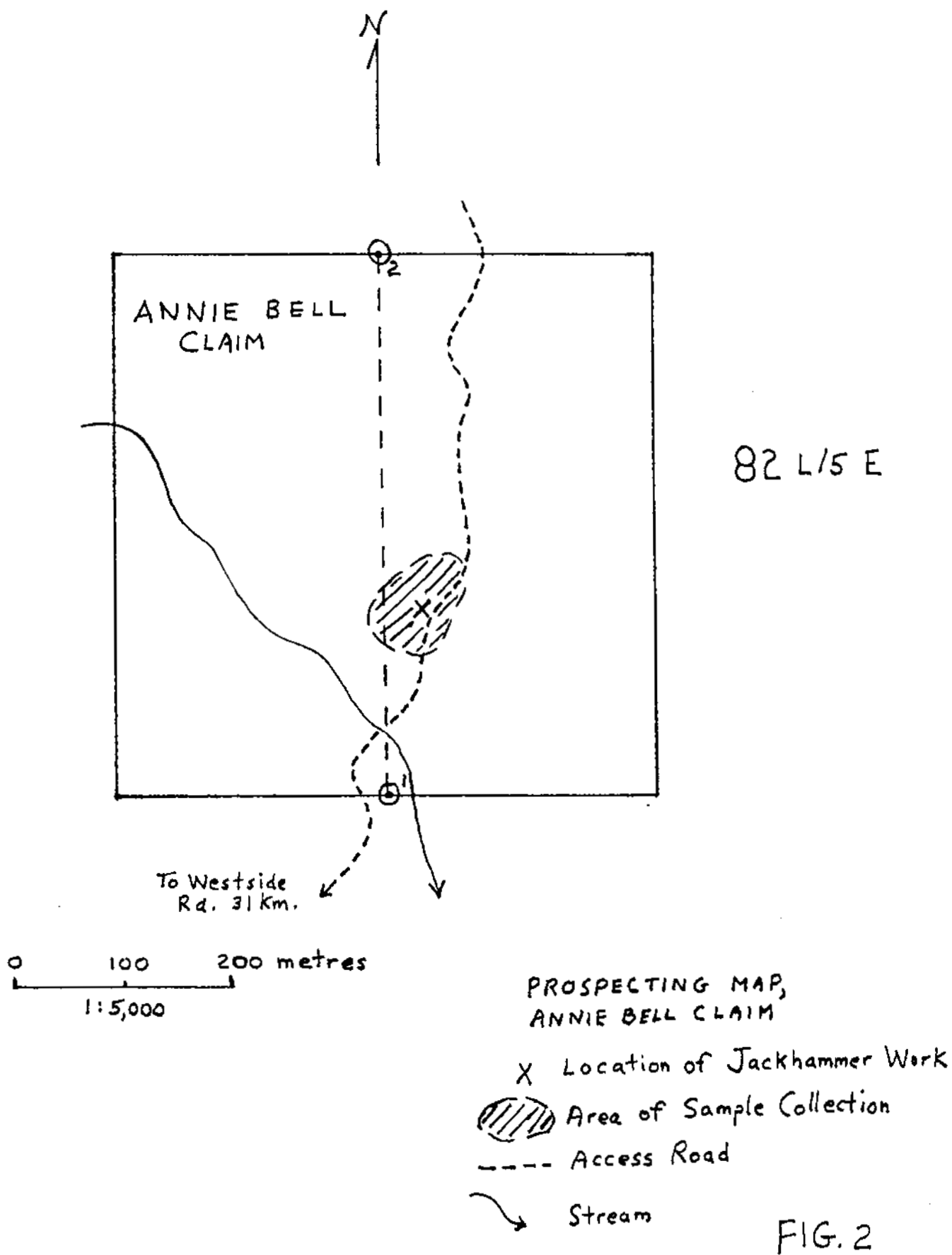

FIG. 2

this report has not visited the showings but is familiar with the geology in the vicinity of the claim and has examined the samples collected by the owner.

The samples examined by the author consist of opaque black and dark brown chalcedony, and translucent agate varying from medium red-brown to light yellow-brown (tan) in colour. Both types of material exhibit little fracture and take a good polish. Milky agate was also reported by the owner.

(iii) Interpretation:

Chalcedony and agate appear to result from siliceous solutions infilling vertical fractures in hard shale or basalt country rock. The material is generally a milky agate at depth, grading upwards to translucent and opaque chalcedony in various shades of brown, with opaque black chalcedony on top.

(iv) Conclusions:

Good lapidary quality chalcedony and agate occur on the property. Further trenching work is indicated in order to search for different types and colours of lapidary material, and to prospect for precious opal which has been found in similar rocks in this area.

3. **Prospector's Description of Observations:**

The claim owner has described the following observations to the writer of this report.

Agate and Chalcedony occur as surface float and in vertical seams on the property. The vertical seams occur in a dark country rock of hard shale or possibly basalt, which dips gently to the west.

Six vertical seams were examined in the central part of the claim. Three of these occur in the ditch of the forestry access road and three more about 5 metres west in the back of a borrow pit.

The first three seams are about .5 m high, vary in width from 5 to 20 cm. and are about .5 m apart over a zone about 2 m. wide. The seams are capped by soil overburden. Material in these seams consists of opaque black chalcedony approximately 15 cm thick, overlying about 25 cm of opaque dark brown chalcedony, which in turn overlies a few cm of yellow-brown translucent agate which grades to a milky agate where the seam tapers out in the bottom of the ditch.

The three seams further west vary from 5 cm to 25 cm in width and .6 m to 2 m high. They are about .5 to .75 m apart. The widest and highest seam was exposed by jackhammer and consists of fractured red/brown chalcedony on top, overlying about 1.6 m of opaque black chalcedony grading at depth to a chocolate brown and tan translucent chalcedony, which in turn grades to a milky agate of unknown depth at the bottom of the exposed seam.

Glen Grywacheski, claim owner

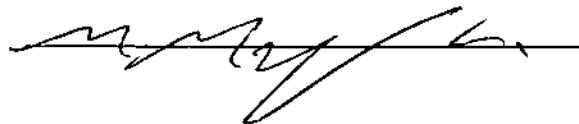
A handwritten signature in black ink, appearing to read 'Glen Grywacheski', written over a horizontal line.

COST STATEMENT

May 19, May 26, June 7, June 31, July 12, August 19 and August 23, 1995; 7 days prospecting and sample collection on Annie Bell Claim, Tony Grywacheski.

7 days x \$50/day	=	\$ 1,050
7 days truck rental		
x \$40/day	=	<u> 280</u>
Total		<u>\$ 1,330</u>

October 8, 1995; 1 day physical work with jackhammer on Annie Bell Claim, Glen Grywacheski, Mary Grywacheski, Tony Grywacheski, Michael Grywacheski, Daryle Grywacheski.

5 x 1 x \$150/day	=	\$ 750
Truck Rental		
2 x 1 x \$40/day	=	<u> 80</u>
Total		<u>\$ 830</u>

Total Work = \$ 2,160

STATEMENT OF QUALIFICATIONS

1. Andrew G. Higgins, B.A., F.G.A.C., has 27 years experience mining and prospecting.

Andrew G. Higgins

2. Glen Grywacheski has 30 years experience collecting lapidary rock.

Glen Grywacheski