



GEOLOGICAL SURVEY BRANCH ASSESSMENT REPORTS
DATE RECEIVED OCT 6 1996

DIAMOND DRILLING REPORT

on the

RUBY MINERAL CLAIMS

Vancouver Mining Division
British Columbia

N.T.S. 092G/12W, 092G/13W, 092F/09E

Latitude 49° 47' 00" N

Longitude 123° 57' 00" W

for

Mr. Charles Boitard
2245 West 13th Avenue
Vancouver, B.C.
V6K 2S4

FILMED

by

P. REYNOLDS, B.Sc., P.Geo.
September 21, 1996

GEOLOGICAL SURVEY BRANCH
ASSESSMENT REPORT

24,557

TABLE OF CONTENTS

1.	SUMMARY	2
2.	INTRODUCTION	2
3.	LOCATION, ACCESS AND PHYSIOGRAPHY	2
4.	CLAIM STATUS	3
5.	HISTORY	4
6.	REGIONAL GEOLOGY	4
7.	PROPERTY GEOLOGY	4
8.	DIAMOND DRILLING	5
9.	CONCLUSION AND RECOMMENDATIONS	6
10.	REFERENCES	7
11.	CERTIFICATE	8

LIST OF FIGURES

FIGURE 1	LOCATION MAP	APPENDIX II
FIGURE 2	CLAIM MAP	APPENDIX II
FIGURE 3	REGIONAL GEOLOGY	APPENDIX II
FIGURE 4	DRILL PLAN	APPENDIX II

APPENDICES

APPENDIX I	STATEMENT OF COSTS
APPENDIX II	FIGURES 1-4
APPENDIX III	DRILL LOGS

1. SUMMARY

- 1.1 The Ruby property consists of six contiguous mineral claims totaling 55 units. The claims are located approximately 80 kilometres northwest of Vancouver, B.C. The claims are accessible by good paved and gravel roads from Earls Cove or Egmont.
- 1.2 The property is underlain for the most part by hornblende biotite quartz porphyry of the Cretaceous coast batholith.
- 1.3 Four diamond drill holes were completed in 1996 to test for gold and silver mineralization. No economic amounts of gold or silver mineralization were encountered.
- 1.4 A modest amount of data on the local geology and mineral showings exists. It is recommended that this data be reviewed and plotted on a common database. Further exploration should be directed at the known mineralized systems. Systematic outcrop mapping should be useful in determining the strike extent of the various mineral showings.

2. INTRODUCTION

- 2.1 This report has been prepared at the request of Mr. Charles Boitard, claim owner, to satisfy assessment requirements.
- 2.2 The information for the following report was obtained from sources cited under references and from the authors drill logs of diamond drill holes 96-1 through 96-4. The drilling program was carried out by Mr. Charles Boitard between June 12 and June 27, 1996. The author logged the drill holes on September 20, 1996. The diamond drill core is stored at the drill sites on the property.
- 2.3 The registered owner of the Wood claims is Mr. Charles Boitard. The claims lie at the north end of the Sechelt peninsula approximately 80 kilometres northwest of Vancouver, B.C. Access to the claims is by paved highway and a network of logging roads.

3. LOCATION, ACCESS AND PHYSIOGRAPHY

- 3.1 The Ruby claims are located at the north end of the Sechelt peninsula approximately 80 kilometres northwest of Vancouver, B.C. The claims are centered at 49° 47' north latitude and 123° 57' west longitude on NTS map sheet 092G/12W. The claims are in the Vancouver Mining Division.
- 3.2 Access is provided by Provincial Highway 101 from the Langdale ferry terminal near Gibsons to Earls Cove. A paved road from Earls Cove to Egmont cuts through the southern portion of the claims. Good dirt roads provide access to most of the claim area.

3.3 The claims occupy an area of sharply undulating coastal lowlands leading inland to steeply rising mountainous terrain. The property lies between elevations zero to 180 metres above sea level. Vegetation consists of salal, alder, fir Hemlock and cedar trees. Water for all stages of exploration is available from nearby lakes. The climate is temperate, typical of the southern coast.

4. CLAIM STATUS

4.1 The Ruby property comprises 6 mineral claims totaling 55 units. Complete claim information is as follows:

<u>NAME</u>	<u>UNITS</u>	<u>RECORD NO.</u>	<u>EXPIRY DATE *</u>
Ruby #1	15	327142	29 June 98
Ruby #2	6	327143	30 June 98
Ruby #3	20	343173	20 January 99
Ruby #4	12	343174	21 January 99
Taj 1	1	316566	12 March 99
Taj 3	1	316568	12 March 99

* Includes assessment currently being applied.

4.3 All claims are recorded in the name of Mr. Charles Boitard. Any legal aspect of claim ownership is beyond the scope of this report.

5. HISTORY

- 5.1 The earliest recorded work in the area was in 1913 when Mr. R. Durnsford Jr. drove a tunnel near Earls Cove (Stein adit). In 1937, work was first recorded on the Cambrian Chieftan property, located approximately seven kilometres southeast of Earls Cove.
- 5.2 In 1952, gold and silver bearing massive sulphide veins were located along the beach on what is now the Ruby #3 claim. The showings reportedly assayed up to 6.21 ounces per ton gold and 6.4 ounces per ton silver. In 1965, Abacon Minerals Exploration Ltd. shipped 106 tons of this material to the Tacoma smelter. This shipment returned 34 ounces of gold, 45 ounces of silver and 170 pounds of copper. The claims subsequently lapsed.
- 5.3 In 1982, Chalice Mining Inc. acquired the ground by staking and carried out exploration programs consisting of prospecting, geochemical and geophysical surveys, geological mapping, trenching and 572 metres of diamond drilling in 21 holes.
- 5.4 Blue Chip Resources Inc. optioned the ground from Chalice and carried out more geochemical and IP surveys in 1987 and 1988.
- 5.5 Mr. Boitard acquired the claims in 1995. Since that time, he has re-established the grid and carried out VLF surveys over portions of the property. This year he drilled four diamond core holes on the Ruby #3 claim.

6. REGIONAL GEOLOGY

- 6.1 The Ruby claims are situated on the western margin of the Coast Plutonic Complex. The area is underlain primarily by Cretaceous age batholithic rocks of mainly quartz diorite composition with lesser diorite and granodiorite.
- 6.2 Northwesterly trending bodies of intermediate volcanics and sediments form roof pendants within the intrusives. The roof pendants have been correlated with the Upper Triassic Karmutsen Formation.
- 6.3 The above sequence of rocks has been intruded by numerous feldspar porphyry, diorite and andesite dykes.

7. PROPERTY GEOLOGY

- 7.1 The Ruby claims appear to be underlain by a hornblende biotite quartz diorite which locally grades into a hornblende quartz diorite, diorite or monzodiorite. The quartz diorite weathers to greyish white and iron staining occurs in patches around fracture zones.

7.2 The quartz diorite is intruded by feldspar porphyry, diorite and dark green to grey andesitic dykes. Dyke widths vary from a few centimetre to several tens of metres and have variable orientations.

7.3 Alteration, as seen in the drill core, consists of variable though generally weak propylitic and potassic alteration.

8. DIAMOND DRILLING

8.1 During the period June 12 to June 27, 1996, four diamond drill holes were completed on the Ruby #3 claim. The drill hole locations are plotted on Figure 4.

8.2 Drilling was supervised by Mr. Charles Boitard. The core was logged by the author on June 20, 1996. Core size is NQ. The core is stored at the drill sites. Drill logs are included in appendix III.

8.3 The following table sets out the particulars of the drill holes.

DDH #	NORTHING	EASTING	AZIMUTH	DIP	DEPTH
96-1	340 N	250 E	120°	-55°	140.55 m
96-2	350 N	400 E	075°	-55°	200.30 m
96-3	25 S	349 E	335°	-45°	146.34 m
96-4	25 S	349 E	335°	-65°	238.41 m

8.4 All drill holes intersected alternating zones of quartz diorite and crosscutting andesite and feldspar porphyry dykes. The quartz diorite grades locally into diorite. No mineralized zones were encountered.

9. CONCLUSION AND RECOMMENDATIONS

- 9.1 The 1996 diamond drilling failed to intersect any mineralized zones.
- 9.2 Past work has shown that gold and silver mineralization occurs in quartz pyrite veins and pyritic breccias. Highly variable gold grades up to 300 grams per tonne have been reported. Veins are typically narrow but appear to thicken adjacent to cross cutting andesitic dykes and small shear zones.
- 9.3 A modest amount of data on the local geology and mineral showings exists. This data should be reviewed and plotted on a common database. Further exploration should be directed at the known mineralized systems. Systematic outcrop mapping should be useful in determining the strike extent of the various mineral showings.

10. REFERENCES

Grove, Edward W.

Geological Report and Work Proposal on the Chalice Mining Inc. Egmont Property. July 15, 1985. BCEMPR AR 14,736.

Howell, William A.

Geological, Geochemical and Geophysical Report on Egmont Property for Blue Chip Resources Inc. February 29, 1988. BCEMPR AR 17,941.

11. CERTIFICATE

I, Paul Reynolds, of the city of Vancouver in the province of British Columbia do hereby certify that:

- 1) I am a Professional Geoscientist registered with the Association of Professional Engineers and Geoscientists of British Columbia.
- 2) I am a graduate of the University of British Columbia with a B.Sc. degree in geology.
- 3) I have practiced my profession as exploration geologist since graduation in 1987.
- 4) This report is based on a review of previous reports and the Author's diamond drill logs DDH 96-1, 96-2, 96-3 and 96-4.
- 5) I have no interest, directly or indirectly, in the Ruby property nor do I expect to receive any interest in the future.
- 6) Permission is hereby granted to Mr. Charles Boitard to use this report in support of any filing to be submitted to the Ministry of Energy, Mines and Petroleum Resources of the Province of British Columbia for the purpose of filing assessment on the Ruby mineral claims.

Dated this 21st day of September, 1996.

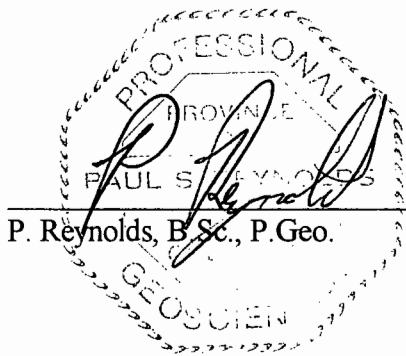

APPENDIX I
STATEMENT OF COSTS

STATEMENT OF COSTS

Diamond Drilling	725 metres @ \$60/metre	43,500
GST		3,045

TOTAL		\$46,545
-------	--	----------

APPENDIX II

FIGURES 1-4

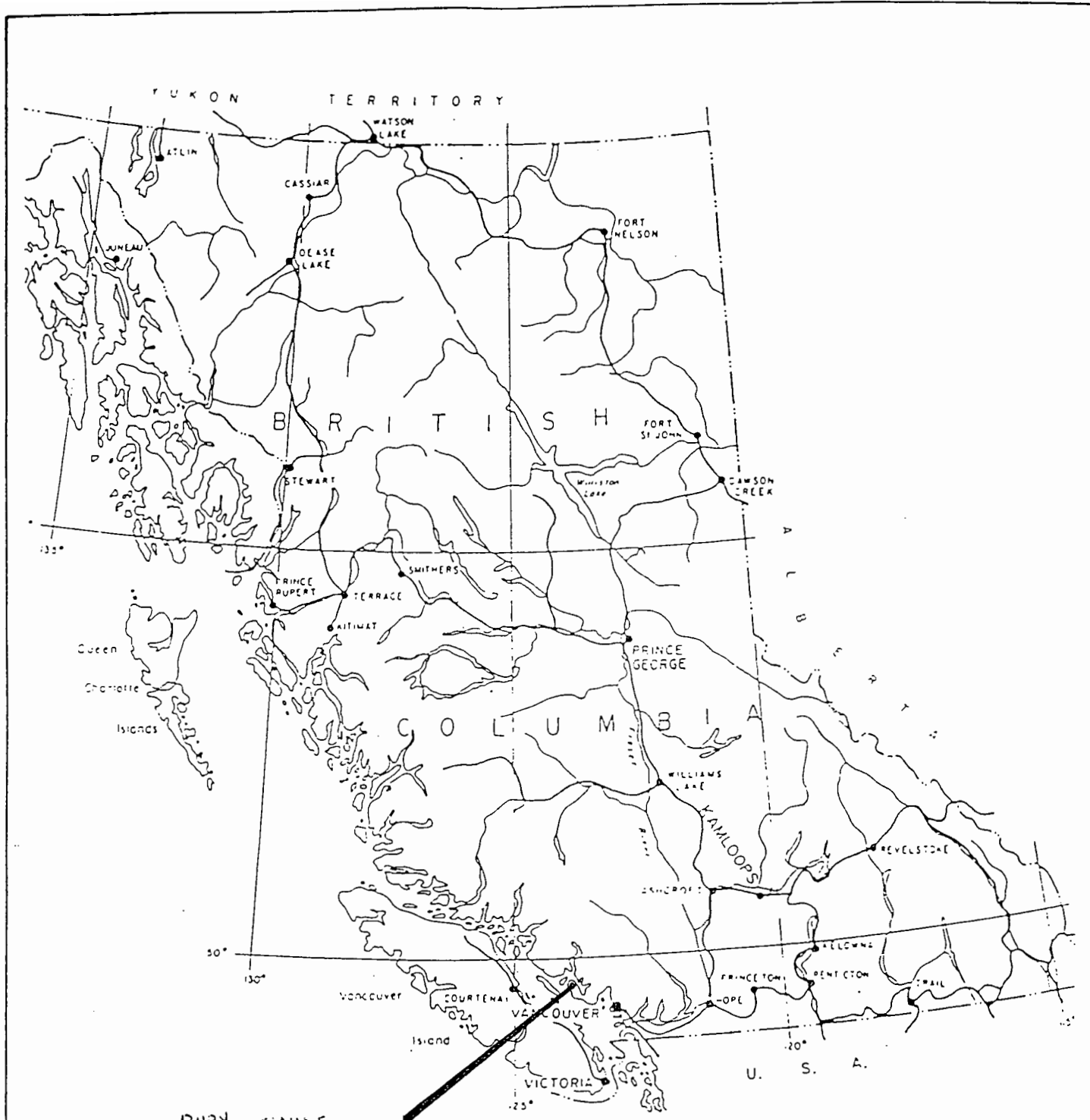

RUBY CLAIMS

REYNOLDS GEOLOGICAL		
LOCATION MAP		
RUBY CLAIMS		
DRAWN: P.R.	FIG. NO. 1	

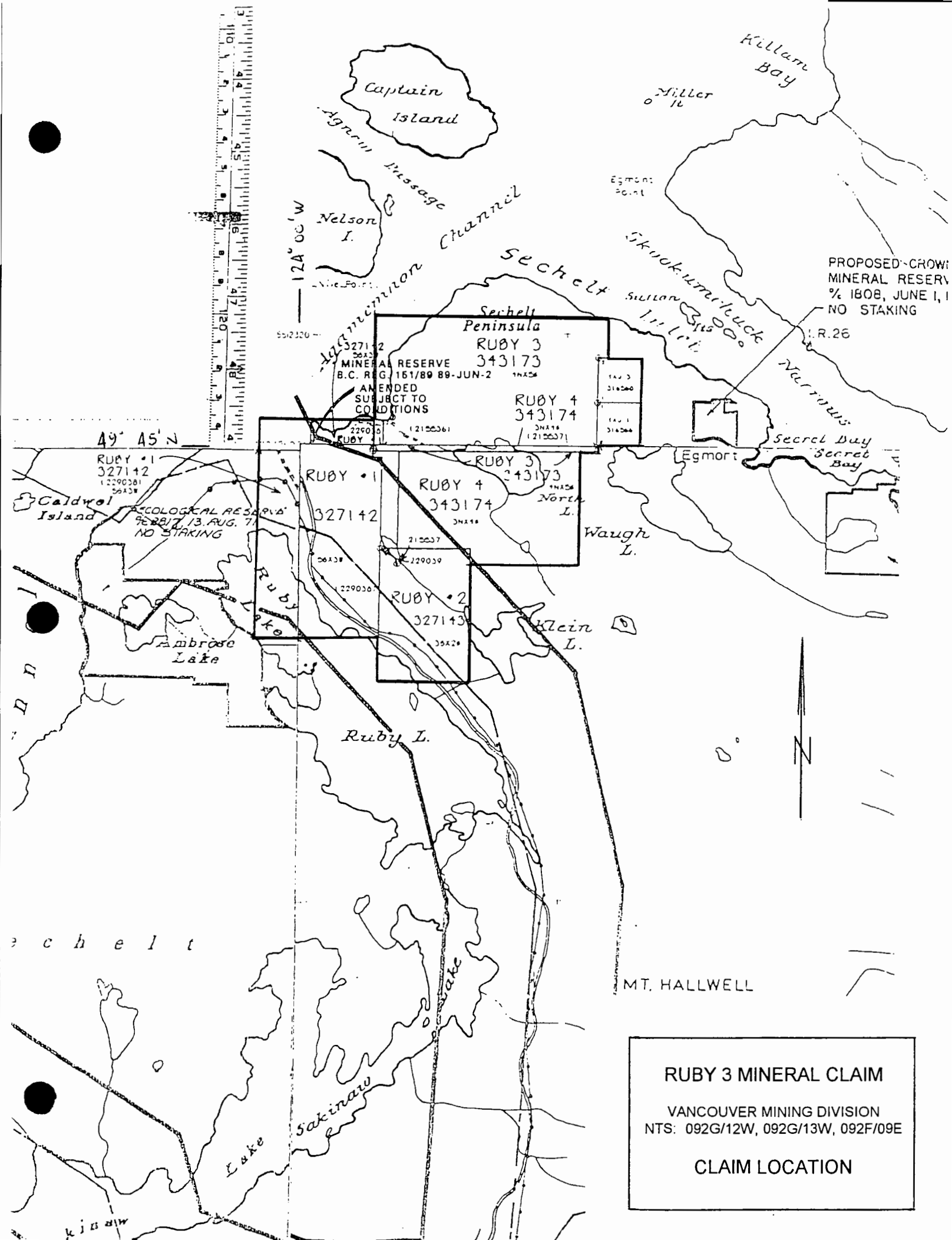

PROPOSED-CROWN
MINERAL RESERVE
% 1808, JUNE 1, 1
NO STAKING

I.R. 26

327142
MINERAL RESERVE
B.C. REG. 151/89 89-JUN-2
AMENDED
SUBJECT TO
CONDITIONS

RUBY 4
343174
JN418
(215037)

RUBY 1
327142
JN418
(229038)

RUBY 4
343174
JN418
(215037)

RUBY 2
327143
JN418
(229036)

RUBY 3 MINERAL CLAIM

VANCOUVER MINING DIVISION
NTS: 092G/12W, 092G/13W, 092F/09E

CLAIM LOCATION

APPENDIX III
DIAMOND DRILL LOGS

DIAMOND DRILL RECORD

HOLE NO:

96-2

PAGE NO:

4

DEPTH		RECOVERY	DESCRIPTION	SAMPLE No.	FROM	TO	WIDTH OF SAMPLE				
FROM	TO										
122.50	133.84		HBQD. MEDIUM TO DARK GREY. FINER GRAINED THAN PREVIOUS. 130.49 - 130.79 MINOR SHEARING @ 35° TO C.A.								
133.84	146.04		HBQD. LIGHT GREY.								
146.04	146.3A		FINE GRAINED, DARK GREEN ANDESITE. BOTTOM CONTACT @ 45° TO C.A.								
146.3A	166.46		HBQD. LIGHT GREY								
166.46	169.21		FINE GRAINED, DK GREEN ANDESITE. TOP CONTACT @ 30° TO C.A. BOTTOM CONTACT @ 60° TO C.A.								
169.21	200.30		HBQD. LIGHT GREY.								
200.30			E.O. It.								

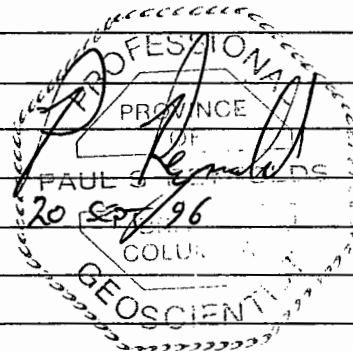

DIAMOND DRILL RECORD

HOLE NO:

96-3

PAGE NO:

3

DEPTH		RECOVERY	DESCRIPTION	SAMPLE No.	FROM	TO	WIDTH OF SAMPLE				
FROM	TO										
89.94	93.60		FINE GRAINED, DK GREEN ANDESITE.								
93.60	96.04		HBQD. LIGHT GREY								
96.04	100.61		FELDSPAR PORPHYRY. TRACE Py. Py INCREASING TO 1% ON FRAC'S. MINOR EP ON FRAC'S.								
100.61	101.22		FELSITE DYKE. LIGHT GREEN. FINE GRAINED.								
101.22	138.41		MEDIUM GRAINED MONZONITE TO MONZO-DIORITE. UP TO 20% K-SPAR IN DK GREEN, FINE GRAINED GROUNDMASS. TRACE Py.								
138.41	146.34		HBQD. CHLORITE & EPIDOTE ALTERED. MINOR ORANGE STAIN.								
146.34			E. O. H.								

GEOLOGICAL SURVEY OF CANADA
 OTTAWA
 PAUL S. [Signature]
 20 Sept 96
 GEOSCIENCE

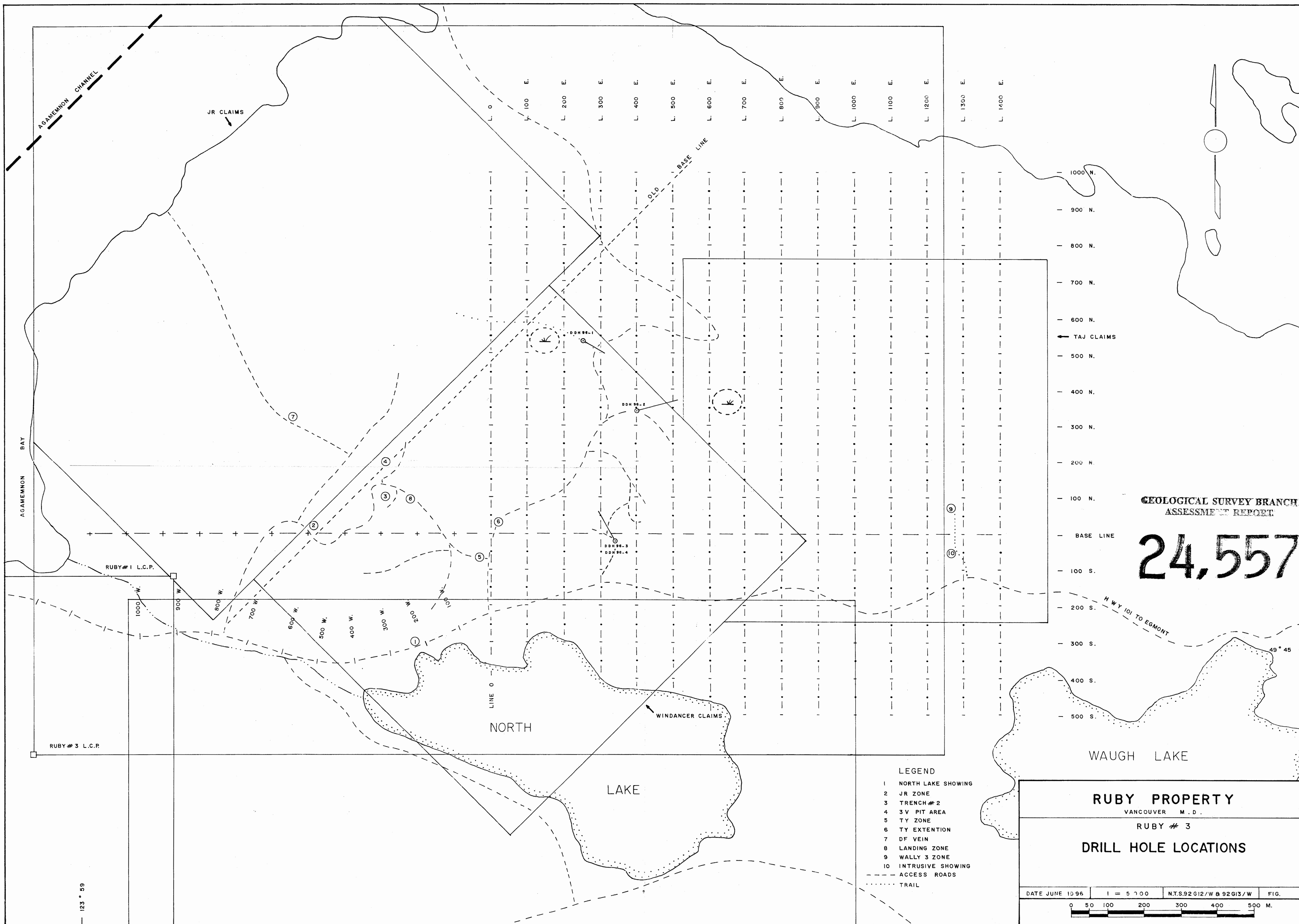

GEOLOGICAL SURVEY BRANCH
ASSESSMENT REPORT

24,557

- LEGEND**
- 1 NORTH LAKE SHOWING
 - 2 JR ZONE
 - 3 TRENCH # 2
 - 4 3V PIT AREA
 - 5 TY ZONE
 - 6 TY EXTENTION
 - 7 DF VEIN
 - 8 LANDING ZONE
 - 9 WALLY 3 ZONE
 - 10 INTRUSIVE SHOWING
 - - - ACCESS ROADS
 - TRAIL

RUBY PROPERTY
VANCOUVER M.D.

RUBY # 3

DRILL HOLE LOCATIONS

DATE JUNE 13 96 1 = 5 700 N.T.S. 92 612/W & 92 613/W FIG.

0 50 100 200 300 400 500 M.

123 * 59