

**ALLANA GROUP**  
**(Also known as the Big G, Gilke Mine and The Dome Group)**

**OWNER: ALBERT DOIRON - prospector.**

951 Aspen Road  
R.R.#1, Site 38, C-32  
Comox, BC V9N 5N1

Phone/Fax: (250) 339-2173

## **ASSESSMENT REPORT**

**Map: 92F 13E, 92K 4E**

Latitude: 50 North Longitude: 125 37 30 West

Area: Greenstone Creek, Campbell River, British Columbia.

**Mining Division: Naniamo**

**Original Property:**

Mineral Lease M-14 Lots: 1215 and 1216 the Thundercloud and Rainbow Claims. Area covered by the Thundercloud and Rainbow consists of: 85.75 Acres.

**Recently Staked Claims (Oct. 1995):** 16 units (four post) Allana. Tag No. 116598. These units partially overlap the Mineral Leases of the Thundercloud and Rainbow.

**Date:** December 1995.

**Report by:** Will Thompson

857 Fern Rd. East  
Qualicum Beach B.C.  
V9K 1M3

Phone: (604) 752-9373

116598

**ALLANA GROUP**  
**(Also known as the Big G, Gilke Mine and The Dome Group)**

**OWNER: ALBERT DOIRON - prospector.**

951 Aspen Road  
R.R.#1, Site 38, C-32  
Comox, BC V9N 5N1

Phone/Fax: (250) 339-2173

## **ASSESSMENT REPORT**

**Map: 92F 13E, 92K 4E**

Latitude: 50 North Longitude: 125 37 30 West

Area: Greenstone Creek, Campbell River, British Columbia.

**Mining Division: Naniamo**

**Original Property:**

Mineral Lease M-14 Lots: 1215 and 1216 the Thundercloud and Rainbow Claims. Area covered by the Thundercloud and Rainbow consists of: 85.75 Acres.

**Recently Staked Claims (Oct. 1995):** 16 units (four post) Allana. Tag No. 116598.  
These units partially overlap the Mineral Leases of the Thundercloud and Rainbow.

Date: December 1995.

Report by: Will Thompson

857 Fern Rd. East  
Qualicum Beach B.C.  
V9K 1M3

Phone: (604) 752-9373

**Allana Group**

Owner: Albert Doiron  
Address: 951 Aspen Road  
RR - 1 Site 38 C-32  
Comox, BC  
V9N 5N1

Phone/Fax: (250) 339 - 2173

Map: 92F 13E, 92K 4E  
Latitude: 50 North Longitude: 125 37 30 West  
Area: Greenstone Creek, Campbell River, BC

Mining Division: Nanaimo  
Mineral Leases: M-14, Lots 1215 and 1216. The  
Thundercloud and Rainbow Claims.  
Allana Claims: Staked October 1995, 16 Units (four  
post)

## Table of Contents

### Page

1	Title Page
2	Introduction
3	Summary of work done in 1996 prospecting and sampling program
4	Prospecting report & Assay Values
5	Geochemistry
6	Breakdown of expenditures

Introduction:

*This report is written as an apendment to the report prepared by W. Thompson in December, 1995. The 1995 report was prepared for the application of a prospectors grant with available documentation at that time. No research was done by W. Thompson, other than examining reports provided by Mr. Doiron. A summary and proposed expenditures were included in that report.*

The Allana Group has also been called other names by different owners. These names include the Big G, Gilke Mine, and the Dome Group.

The property has been worked since 1917 when 83 tons were mined that contained 131 ounces of silver, 1 ounce of gold, and 30,904 pounds of copper. Various other people and companies have prospected sampled, mapped and drilled the property, but not ever again actually worked the deposit. The property was acquired by Mr. Darrein, to see if he could develop it to a point where a larger company would be interested in doing an extensive development program.

The Doiron work consisted mainly of prospecting, and soil sampling. The soil sampling initially was concentrated on roads. Trying to repeat old work to confirm high values found by others on a road sampling program. The second phase included flagging lines on which soil samples were collected. All the results of these samples are appended and a map showing the grid and roads sampled is enclosed. The location of each sample is the number assigned beside the assay.

Summary of work done in 1996 prospecting and sampling program.

The property has not been worked since about 1969 so a significant amount of time was spent re-locating roads, trails and excavations.

Previous work done in 1969 by Weymark Engineering Ltd. included an aerial magnetometer survey. This was conducted by Geo-X Surveys Ltd. There were some magnetic highs and low that were not followed up on the ground. Previous soil sampling on old roads indicated that there were some high copper values that should be followed up as well.

The 1996 program was designed to follow up the 1969 work. Soil Sampling was conducted along some roads to re-expose any potential ground anomalies that were indicated by previous work.

Some soil samples indicated fairly high Vanadium, Gold and Copper in the North West part of the property. A small grid was put in along flagged lines. Soil samples were taken at 25 meter intervals on lines 25 meters apart. The samples were analyzed by Chemex Labs for 32 elements by I.C.P. The main elements included: Au, Ag, Cu, As, Pb, Zn, and V. Sampling outlined significant high values in Gold, Copper, and Vanadium.

Between the period from November 1, 1996 to September 15, 1996 a total of \$22,718.79 was spent. This included \$4,641 in the cost of assaying.

### Prospecting Report:

Initial prospecting consisted of locating and sampling the old adits on the Thundercloud and Rainbow Mineral Leases (M-14, Lots 1215 and 1216).

Four Adits were located and grab samples from the veins were taken. The results of the samples indicated significant copper, zinc, silver, gold, arsenic, cobalt, and cadmium. The high values are as follows over a vein width of about 2 feet. The vein is up to about 8 feet in width, but seems to thin to a few inches in the main adit. Are as follows: 25,300 ppm Cu, >50,000 ppm Zn, 4 ppm Ag, 160 ppb Au, 410 ppm As, 460 ppm Co, and 465 ppm Cd. The veins occur in andesite tuffs and flows. The veins are gently dipping at 15 to 20 degrees to the north. Mineralization in the veins consists of chalcopyrite, pyrite, pyrrohtite, sphalerite, with minor silver and gold.

Prospecting on the rest of the property revealed little outcrop in a generally flat lying area. Some small outcrops of limestone, andesite and argillacious shales were encountered. The argillacious shales found in the north western part of the property had numerous poorly preserved clam shells. All of the old roads were walked and some cross-country traverses were made with little finds between the roads.

### Geochemistry:

#### Soil sampling:

##### Procedure:

Soil Samples were taken on roads at 50 meter and 25 meter intervals. Samples on the grid were taken at 25 meter intervals on lines 25 meters apart. The samples were taken from the "C" or oxidized horizon of the soil which was usually less than a foot from the surface. The samples were collected and stored in 3" x 8" craft paper bags that were then dried and shipped to the assayer.

Assaying was done by Chemex Labs Ltd. of North Vancouver using standard ICP. Some elements required nitric-aqua regia digestion. Dry Sieve to -80 mesh.

Gold Values Range from 10 ppb to 160 ppb.  
Vanadium Values Range from 4 ppm to 586 ppm.  
If 215 samples, 180 showed above background.  
A good correlation appears to exist with Vanadium.

Zn Values Range from 2 ppm to 405 ppm.  
Cu Values Range from 3 ppm to 227 ppm.



Breakdown of expenditures:  
November 1, 1995 through and including September 15,  
1996.

Assays	\$4641.66 ✓
Shipping	\$ 103.11
Transportation & Fuel	\$2283.25 ✓
Labor	\$3000.00 ✓
Meals	\$1049.60 ✓
Geologist Fees	\$1646.00
Tools & Repair Materials	\$1798.86
Prospecting & Soil Sampling	\$8000.00 ✓
Drafting	\$ 966.81
-----	
TOTAL	\$23489.29

Transportation & Fuel - consisted of a 4 hour drive to and from the property. Fuel cost per day 40 days @ \$57.08 = \$2283.25. Mileage consists of 28 miles of highway roads and 38 miles of old logging roads.

Labor - Ed Gwinner (casual labor) 30 days @ \$100.00 = \$3000.00.

Prospecting & Soil Sampling - 40 days @ \$200.00 = \$8000.00.



# Chemex Labs Ltd.

Analytical Chemists \* Geochemists \* Registered Assayers  
212 Brooksbank Ave., North Vancouver  
British Columbia, Canada V7J 2C1  
PHONE: 604-984-0221

To: DOIRON, ALBERT

BOX 759  
UCLUELET, BC  
VOR 3A0

\*\*

INVOICE NUMBER

I 9 6 2 2 8 0 5

## BILLING INFORMATION

Date: 12-JUL-96  
Project:  
P.O. No.:  
Account: LOL

Comments:

Billing: For analysis performed on  
Certificate A9622805

Terms: Payment due on receipt of invoice  
1.25% per month (15% per annum)  
charged on overdue accounts

Please Remit Payments to:

**CHEMEX LABS LTD.**  
212 Brooksbank Ave.,  
North Vancouver, B.C.  
Canada V7J 2C1

# OF SAMPLES	ANALYSED FOR CODE - DESCRIPTION	UNIT PRICE	SAMPLE PRICE	AMOUNT
31	201 - Dry, sieve to -80 mesh	1.25		
	202 - save reject	0.85		
	ICP-32	7.00		
	983 - Au ppb FA+AA	9.75	18.85	584.35
1	201 - Dry, sieve to -80 mesh	1.25		
	202 - save reject	0.85		
	983 - Au ppb FA+AA	9.75	11.85	11.85
				Total Cost \$ 596.20
				(Reg# R100938885 ) GST \$ 41.73
				<b>TOTAL PAYABLE (CDN) \$ 637.93</b>



# Chemex Labs Ltd.

Analytical Chemists \* Geochemists \* Registered Assayers  
212 Brooksbank Ave., North Vancouver  
British Columbia, Canada V7J 2C1  
PHONE: 604-984-0221 FAX: 604-984-0218

To: DOIRON, ALBERT

BOX 759  
UCLUELET, BC  
V0R 3A0

A9622805

Comments: ATTN:AL DOIRON

CERTIFICATE

A9622805

(LOL) - DOIRON, ALBERT

Project:  
P.O. #:

Samples submitted to our lab in Vancouver, BC.  
This report was printed on 12-JUL-96.

## SAMPLE PREPARATION

CHEMEX CODE	NUMBER SAMPLES	DESCRIPTION
201	32	Dry, sieve to -80 mesh
202	32	save reject
229	32	ICP - AQ Digestion charge

\* NOTE 1:

The 32 element ICP package is suitable for trace metals in soil and rock samples. Elements for which the nitric-aqua regia digestion is possibly incomplete are: Al, Ba, Be, Ca, Cr, Ga, K, La, Mg, Na, Sr, Tl, W.

## ANALYTICAL PROCEDURES

CHEMEX CODE	NUMBER SAMPLES	DESCRIPTION	METHOD	DETECTION LIMIT	UPPER LIMIT
983	32	Au ppb: Fuse 30 g sample	FA-AAS	5	10000
2118	31	Ag ppm: 32 element, soil & rock	ICP-AES	0.2	200
2119	31	Al %: 32 element, soil & rock	ICP-AES	0.01	15.00
2120	31	As ppm: 32 element, soil & rock	ICP-AES	2	10000
2121	31	Ba ppm: 32 element, soil & rock	ICP-AES	10	10000
2122	31	Be ppm: 32 element, soil & rock	ICP-AES	0.5	100.0
2123	31	Bi ppm: 32 element, soil & rock	ICP-AES	2	10000
2124	31	Ca %: 32 element, soil & rock	ICP-AES	0.01	15.00
2125	31	Cd ppm: 32 element, soil & rock	ICP-AES	0.5	100.0
2126	31	Co ppm: 32 element, soil & rock	ICP-AES	1	10000
2127	31	Cr ppm: 32 element, soil & rock	ICP-AES	1	10000
2128	31	Cu ppm: 32 element, soil & rock	ICP-AES	1	10000
2150	31	Fe %: 32 element, soil & rock	ICP-AES	0.01	15.00
2130	31	Ga ppm: 32 element, soil & rock	ICP-AES	10	10000
2131	31	Hg ppm: 32 element, soil & rock	ICP-AES	1	10000
2132	31	K %: 32 element, soil & rock	ICP-AES	0.01	10.00
2151	31	La ppm: 32 element, soil & rock	ICP-AES	10	10000
2134	31	Mg %: 32 element, soil & rock	ICP-AES	0.01	15.00
2135	31	Mn ppm: 32 element, soil & rock	ICP-AES	5	10000
2136	31	Mo ppm: 32 element, soil & rock	ICP-AES	1	10000
2137	31	Na %: 32 element, soil & rock	ICP-AES	0.01	5.00
2138	31	Ni ppm: 32 element, soil & rock	ICP-AES	1	10000
2139	31	P ppm: 32 element, soil & rock	ICP-AES	10	10000
2140	31	Pb ppm: 32 element, soil & rock	ICP-AES	2	10000
2141	31	Sb ppm: 32 element, soil & rock	ICP-AES	2	10000
2142	31	Sc ppm: 32 elements, soil & rock	ICP-AES	1	10000
2143	31	Sr ppm: 32 element, soil & rock	ICP-AES	1	10000
2144	31	Ti %: 32 element, soil & rock	ICP-AES	0.01	5.00
2145	31	Tl ppm: 32 element, soil & rock	ICP-AES	10	10000
2146	31	U ppm: 32 element, soil & rock	ICP-AES	10	10000
2147	31	V ppm: 32 element, soil & rock	ICP-AES	1	10000
2148	31	W ppm: 32 element, soil & rock	ICP-AES	10	10000
2149	31	Zn ppm: 32 element, soil & rock	ICP-AES	2	10000

McDougal I.

SCALE  
0 500 1000 2000  
METERS

Q2 K4 E.

NORTH

MINERAL  
O/C 582  
SUBJECT

M.D. DISTRICT

COMOX

LAND

DISTRICT

Greenstone

Q2 F 13 E

RESERVE  
90-JUN-29

BK 1009

MINERAL RESERVE  
O/C 583 88-04-08  
SUBJECT TO CONDITIONS

CONA PARK  
CHANGE LANDS  
1990-APR-19

BK 1064

BK 562

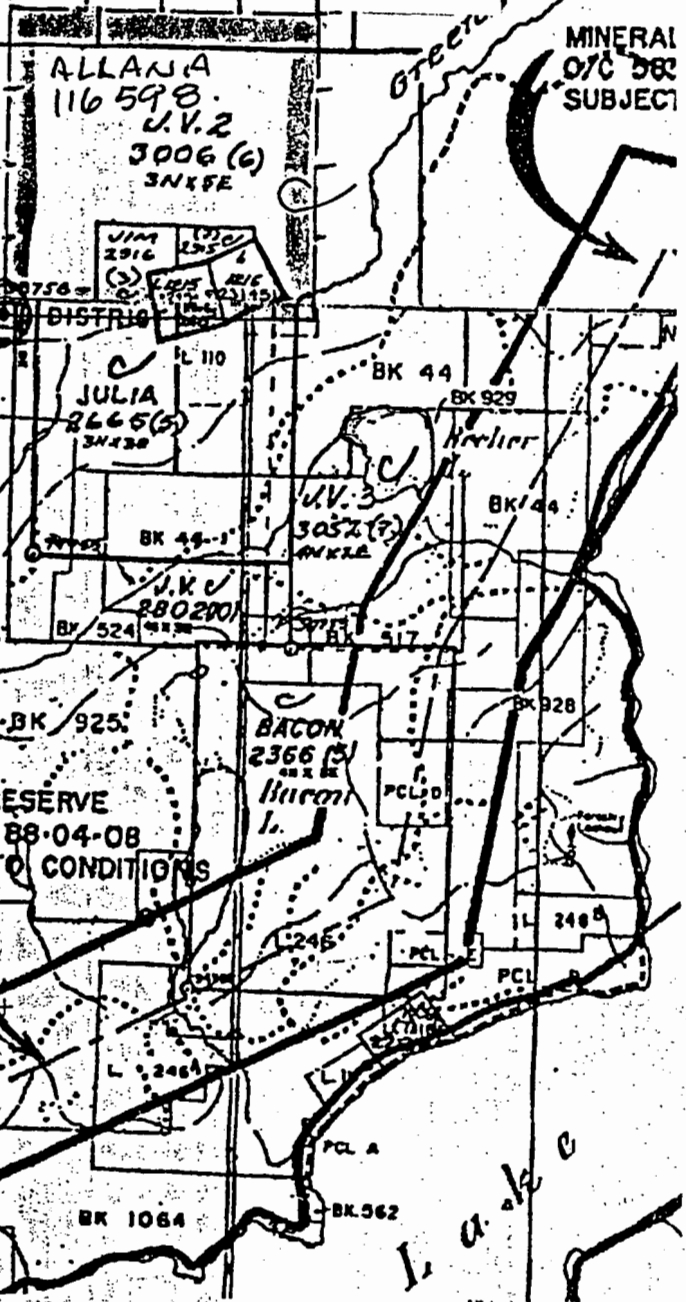

Scale 1:50,000 Echelle

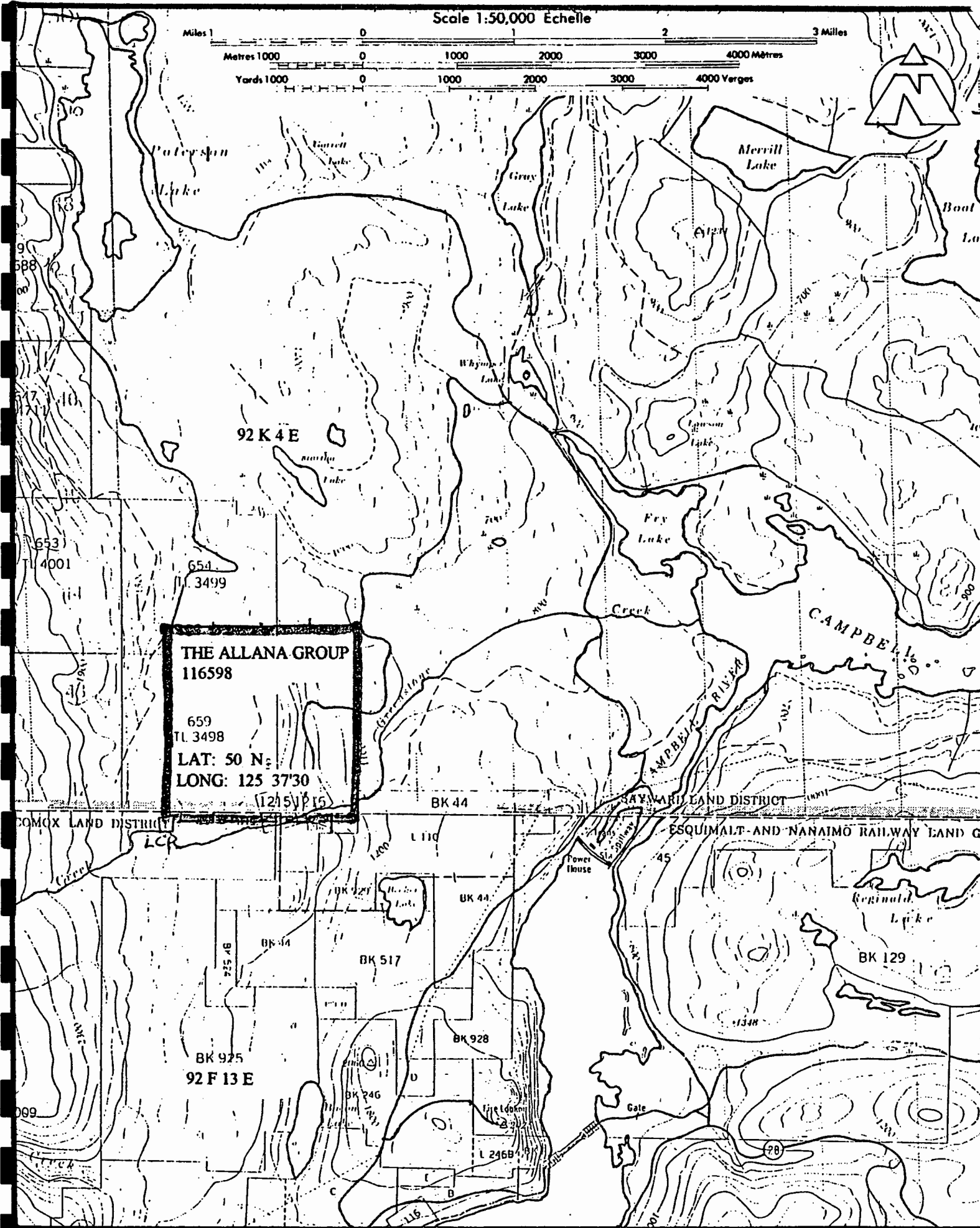
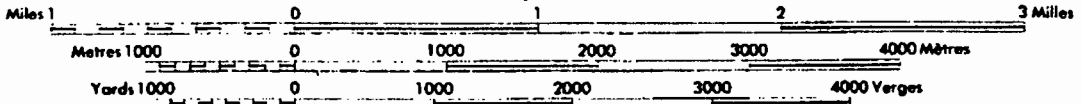

**THE ALLANA GROUP**  
 116598  
 659  
 TL 3498  
 LAT: 50 N  
 LONG: 125 37'30  
 (125 37 15)

PROPERTY LOCATION MAP OF THE ALLANA GROUP

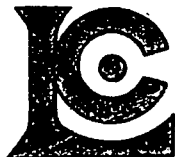

# Chemex Labs Ltd.

Analytical Chemists \* Geochemists \* Registered Assayers

212 Brooksbank Ave., North Vancouver  
British Columbia, Canada V7J 2C1  
PHONE: 604-984-0221 FAX: 604-984-0218

To: DOIRON, ALBERT

BOX 759  
UCLUELET, BC  
V0R 3A0

Project:  
Comments: ATTN: A. DOIRON

Page Number :1-A  
Total Pages :1  
Certificate Date: 07-MAY-96  
Invoice No. :19617350  
P.O. Number :  
Account :LOL

## CERTIFICATE OF ANALYSIS A9617350

SAMPLE	PREP CODE	Au ppb FA+AA	Ag ppm	Al %	As ppm	Ba ppm	Be ppm	Bi ppm	Ca %	Cd ppm	Co ppm	Cr ppm	Cu ppm	Fe %	Ga ppm	Hg ppm	K %	La ppm	Mg %	Mn ppm
A-LINE NORTH 1	201 229	< 5	0.2	3.71	2	10	< 0.5	< 2	1.19	0.5	12	83	48	7.72	10	< 1	< 0.01	< 10	0.41	1505
A-LINE NORTH 2	201 229	< 5	0.2	3.25	2	20	< 0.5	< 2	1.96	< 0.5	9	86	34	6.26	10	< 1	< 0.01	< 10	0.21	555
A-LINE 025M	201 229	< 5	< 0.2	4.70	< 2	10	< 0.5	< 2	1.16	< 0.5	11	80	57	6.63	10	1	< 0.01	< 10	0.44	645
A-LINE 050M	201 229	< 5	< 0.2	3.61	< 2	10	< 0.5	< 2	0.89	< 0.5	15	113	45	9.91	10	< 1	< 0.01	< 10	0.24	940
A-LINE 075M	201 229	5	0.2	4.81	< 2	30	< 0.5	< 2	1.64	0.5	20	66	98	6.40	10	< 1	< 0.01	< 10	0.76	1670
A-LINE 100M	201 229	< 5	0.2	2.57	8	10	< 0.5	< 2	1.50	< 0.5	10	76	31	8.34	10	< 1	< 0.01	< 10	0.27	485
A-LINE 125M	201 229	< 5	0.2	4.27	< 2	10	< 0.5	< 2	1.10	1.0	15	91	54	7.43	10	< 1	< 0.01	< 10	0.39	600
A-LINE 150M	201 229	< 5	0.4	5.94	6	20	< 0.5	< 2	1.36	1.5	17	93	69	6.95	10	< 1	< 0.01	< 10	0.59	435
A-LINE 175M	201 229	< 5	0.2	5.67	6	60	< 0.5	< 2	1.74	1.0	19	80	227	5.98	10	< 1	< 0.01	< 10	0.97	440
B-LINE 000	201 229	< 5	< 0.2	6.66	8	30	< 0.5	< 2	1.41	0.5	17	72	99	5.03	< 10	< 1	< 0.01	< 10	0.63	565
B-LINE 025	201 229	5	< 0.2	4.69	< 2	30	< 0.5	< 2	1.45	1.0	17	76	72	5.97	10	< 1	< 0.01	< 10	0.61	830
B-LINE 050	201 229	5	0.2	5.25	12	20	< 0.5	< 2	1.72	0.5	20	68	100	5.87	10	< 1	< 0.01	< 10	0.73	635
B-LINE 075	201 229	< 5	< 0.2	5.07	< 2	30	< 0.5	< 2	2.00	0.5	22	68	172	5.89	10	< 1	0.01	< 10	0.94	595
B-LINE 100	201 229	< 5	0.2	6.32	8	30	< 0.5	< 2	1.27	3.5	27	94	72	7.47	10	< 1	< 0.01	< 10	0.51	1165
B-LINE 125	201 229	5	0.2	5.53	6	30	< 0.5	< 2	1.72	3.5	20	80	83	6.45	10	< 1	0.01	< 10	0.66	555
B-LINE 150	201 229	< 5	0.2	6.42	< 2	30	< 0.5	< 2	1.59	1.5	25	84	95	6.24	10	< 1	< 0.01	< 10	0.62	605
B-LINE 175	201 229	< 5	0.2	5.11	< 2	60	< 0.5	< 2	1.02	1.5	18	85	51	6.72	10	< 1	< 0.01	< 10	0.43	765
B-LINE 200	201 229	5	< 0.2	4.63	2	60	< 0.5	< 2	2.33	1.0	19	51	120	5.04	< 10	< 1	< 0.01	< 10	0.93	660
B-LINE 225	201 229	< 5	< 0.2	3.53	14	40	< 0.5	< 2	4.62	1.5	16	33	76	4.33	< 10	< 1	0.01	10	0.50	1325
B-LINE 250	201 229	< 5	< 0.2	3.46	18	40	< 0.5	< 2	4.59	0.5	20	38	113	4.13	< 10	< 1	0.03	< 10	0.76	910
B-LINE 275	201 229	< 5	< 0.2	0.78	6	< 10	< 0.5	< 2	1.00	0.5	6	13	29	0.93	< 10	< 1	< 0.01	< 10	0.16	280
B-LINE 300	201 229	< 5	< 0.2	2.97	36	30	< 0.5	< 2	2.78	2.5	14	58	99	3.96	< 10	< 1	0.01	< 10	0.63	1585
B-LINE 325	201 229	< 5	< 0.2	0.96	12	20	< 0.5	< 2	4.34	7.0	5	21	87	1.14	< 10	< 1	0.03	< 10	0.22	1640
B-LINE 350	201 229	< 5	< 0.2	3.10	14	40	< 0.5	< 2	4.18	0.5	14	30	48	4.48	< 10	< 1	0.02	< 10	0.65	1110
B-LINE 375	201 229	< 5	< 0.2	4.38	< 2	20	< 0.5	< 2	1.51	0.5	18	71	77	6.22	10	< 1	< 0.01	< 10	0.62	765
B-LINE 400	201 229	< 5	< 0.2	4.27	2	30	< 0.5	< 2	2.04	< 0.5	18	54	101	5.12	< 10	< 1	< 0.01	< 10	0.81	735
B-LINE 425	201 229	< 5	< 0.2	4.40	6	30	< 0.5	< 2	2.35	0.5	19	65	82	5.83	10	< 1	< 0.01	< 10	0.71	1270
B-LINE 450	201 229	< 5	< 0.2	5.37	10	40	< 0.5	< 2	2.00	0.5	21	64	144	5.31	10	< 1	< 0.01	< 10	1.01	585
B-LINE 475	201 229	5	< 0.2	5.12	< 2	40	< 0.5	< 2	2.02	< 0.5	22	73	151	5.76	10	< 1	0.01	< 10	1.09	505
B-LINE 500	201 229	< 5	0.2	4.80	2	30	< 0.5	< 2	1.77	0.5	20	84	82	6.70	10	< 1	0.01	< 10	0.74	765

CERTIFICATION:

*Hart Buchler*



# Chemex Labs Ltd.

Analytical Chemists \* Geochemists \* Registered Assayers

212 Brooksbank Ave., North Vancouver  
British Columbia, Canada V7J 2C1  
PHONE: 604-984-0221 FAX: 604-984-0218

To: DOIRON, ALBERT

BOX 759  
UCLUELET, BC  
V0R 3A0

Project:  
Comments: ATTN: A. DOIRON

Page Number : 1-B  
Total Pages : 1  
Certificate Date: 07-MAY-96  
Invoice No. : 19617350  
P.O. Number :  
Account : LOL

## CERTIFICATE OF ANALYSIS

### A9617350

SAMPLE	PREP		Mo	Na	Ni	P	Pb	Sb	Sc	Sr	Ti	Tl	U	V	W	Zn
	CODE		ppm	%	ppm	ppm	ppm	ppm	ppm	ppm	%	ppm	ppm	ppm	ppm	ppm
A-LINE NORTH 1	201	229	< 1	< 0.01	19	780	2	< 2	7	23	0.70	< 10	< 10	337	< 10	64
A-LINE NORTH 2	201	229	4	< 0.01	34	680	8	< 2	6	21	0.52	< 10	< 10	419	< 10	64
A-LINE 025M	201	229	< 1	< 0.01	20	610	2	< 2	10	21	0.58	< 10	< 10	292	< 10	42
A-LINE 050M	201	229	< 1	< 0.01	17	630	2	< 2	10	15	0.73	< 10	< 10	420	< 10	58
A-LINE 075M	201	229	< 1	< 0.01	34	670	10	< 2	13	23	0.61	< 10	< 10	293	< 10	70
A-LINE 100M	201	229	< 1	< 0.01	24	690	4	< 2	5	14	0.64	< 10	< 10	362	< 10	56
A-LINE 125M	201	229	< 1	< 0.01	24	870	6	< 2	10	19	0.72	< 10	< 10	345	< 10	68
A-LINE 150M	201	229	< 1	< 0.01	34	770	4	< 2	12	21	0.58	< 10	< 10	272	< 10	130
A-LINE 175M	201	229	< 1	< 0.01	51	280	< 2	< 2	21	36	0.51	< 10	< 10	243	< 10	64
B-LINE 000	201	229	1	< 0.01	29	990	< 2	< 2	14	22	0.46	< 10	< 10	217	< 10	62
B-LINE 025	201	229	< 1	< 0.01	30	720	6	< 2	14	28	0.53	< 10	< 10	280	< 10	76
B-LINE 050	201	229	< 1	< 0.01	32	690	< 2	< 2	14	27	0.53	< 10	< 10	264	< 10	70
B-LINE 075	201	229	< 1	< 0.01	41	450	2	< 2	18	50	0.45	< 10	< 10	261	< 10	86
B-LINE 100	201	229	1	< 0.01	33	1200	4	< 2	17	22	0.53	< 10	< 10	410	< 10	162
B-LINE 125	201	229	1	< 0.01	48	520	2	2	15	30	0.41	< 10	< 10	366	< 10	174
B-LINE 150	201	229	< 1	< 0.01	47	780	2	< 2	15	27	0.41	< 10	< 10	294	< 10	166
B-LINE 175	201	229	< 1	< 0.01	31	950	4	< 2	9	42	0.45	< 10	< 10	344	< 10	120
B-LINE 200	201	229	< 1	< 0.01	47	700	2	< 2	13	39	0.46	< 10	< 10	252	< 10	88
B-LINE 225	201	229	< 1	< 0.01	34	2340	8	< 2	10	93	0.24	< 10	< 10	133	< 10	100
B-LINE 250	201	229	< 1	0.01	35	1820	6	< 2	10	125	0.26	< 10	< 10	142	< 10	84
B-LINE 275	201	229	< 1	< 0.01	58	360	2	< 2	2	7	0.05	< 10	< 10	95	< 10	106
B-LINE 300	201	229	3	< 0.01	32	620	10	< 2	11	76	0.40	< 10	< 10	191	< 10	204
B-LINE 325	201	229	3	0.02	19	1040	20	< 2	3	128	0.11	< 10	< 10	83	< 10	232
B-LINE 350	201	229	< 1	< 0.01	20	1200	24	< 2	6	112	0.27	< 10	< 10	130	< 10	140
B-LINE 375	201	229	< 1	< 0.01	29	1010	6	< 2	11	28	0.58	< 10	< 10	286	< 10	76
B-LINE 400	201	229	< 1	< 0.01	31	890	4	< 2	13	46	0.48	< 10	< 10	228	< 10	70
B-LINE 425	201	229	< 1	< 0.01	30	1710	10	< 2	13	78	0.50	< 10	< 10	243	< 10	94
B-LINE 450	201	229	< 1	< 0.01	40	630	< 2	< 2	14	37	0.46	< 10	< 10	227	< 10	78
B-LINE 475	201	229	< 1	< 0.01	45	430	< 2	< 2	20	40	0.35	< 10	< 10	215	< 10	72
B-LINE 500	201	229	< 1	< 0.01	39	580	4	< 2	13	38	0.42	< 10	< 10	251	< 10	96

CERTIFICATION:

*Hart Buchler*

MAY 13 '96 14:44



# Chemex Labs Ltd.

Analytical Chemists \* Geochemists \* Registered Assayers  
 212 Brooksbank Ave., North Vancouver  
 British Columbia, Canada V7J 2C1  
 PHONE: 604-984-0221 FAX: 604-984-0218

To: DOIRON, ALBERT

BOX 759  
 UCLUELET, BC  
 V0R 3A0

Project:  
 Comments: ATTN: ALBERT DOIRON

Page Number 1-A  
 Total Pages 1  
 Certificate Date 12-MAY-96  
 Invoice No. I-9617614  
 P.O. Number :  
 Account :

## CERTIFICATE OF ANALYSIS A9617614

SAMPLE DESCRIPTION	PREP CODE	An ppb FA+AA	Ag ppm	Al %	As ppm	Ba ppm	Be ppm	Bi ppm	Ca %	Cd ppm	Co ppm	Cr ppm	Cu ppm	Fe %	Ga ppm	Hg ppm	K %	La ppm	Mg %	Mn ppm
C-L1800M 0000M	202 201	10 < 0.2	5.28	6	30	0.5	< 2	1.47	0.5	24	86	87	6.97	10	< 1	0.01	< 10	0.73	425	
C-L1800M 0050M	202 201	< 5 < 0.2	4.47	4	20	< 0.5	< 2	1.81	< 0.5	21	88	78	6.46	10	3	< 0.01	< 10	0.61	490	
C-L1800M 0100M	202 201	< 5 < 0.2	0.46	< 2	10	< 0.5	< 2	1.01	< 0.5	2	9	14	0.68	< 10	< 1	0.01	< 10	0.09	120	
C-L1800M 0150M	202 201	10 < 0.2	5.10	8	30	< 0.5	2	1.57	< 0.5	18	70	101	5.30	10	1	< 0.01	< 10	0.65	740	
C-L1800M 0200M	202 201	10 < 0.2	3.68	2	20	< 0.5	< 2	1.42	< 0.5	16	73	49	6.84	10	2	< 0.01	< 10	0.47	585	
C-L1800M 0250M	202 201	< 5 < 0.2	4.02	8	10	< 0.5	< 2	1.19	0.5	15	79	49	6.45	10	< 1	< 0.01	< 10	0.46	510	
C-L1800M 0300M	202 201	< 5 < 0.2	4.19	10	20	< 0.5	< 2	1.38	< 0.5	17	80	56	6.09	10	2	< 0.01	< 10	0.53	500	
C-L1800M 0350M	202 201	10 < 0.2	3.07	< 2	20	< 0.5	2	1.24	< 0.5	14	66	43	6.23	10	1	< 0.01	< 10	0.39	420	
C-L1800M 0400M	202 201	< 5 < 0.2	4.94	8	10	< 0.5	2	1.39	0.5	14	73	58	5.75	10	< 1	< 0.01	< 10	0.54	485	
C-L1800M 0450M	202 201	10 < 0.2	3.09	8	20	< 0.5	2	1.51	< 0.5	13	57	53	4.89	10	1	< 0.01	< 10	0.51	345	
C-L1800M 0500M	202 201	< 5 < 0.2	4.52	10	20	0.5	2	1.68	0.5	23	84	79	6.44	10	2	< 0.01	< 10	0.76	320	
C-L1800M 0550M	202 201	< 5 < 0.2	4.00	6	20	0.5	2	1.63	0.5	22	70	58	6.10	10	3	< 0.01	< 10	0.52	415	
C-L1800M 0600M	202 201	< 5 < 0.2	4.36	14	10	< 0.5	< 2	1.49	0.5	16	64	66	5.75	10	3	< 0.01	< 10	0.69	410	
C-L1800M 0650M	202 201	< 5 < 0.2	4.92	6	20	< 0.5	2	1.47	2.0	16	78	57	6.74	10	1	< 0.01	< 10	0.53	360	
C-L1800M 0700M	202 201	< 5 < 0.2	6.23	10	20	0.5	4	1.06	< 0.5	18	69	75	5.28	10	2	0.01	< 10	0.64	425	
C-L1800M 0750M	202 201	< 5 < 0.2	5.37	16	20	< 0.5	< 2	1.17	0.5	16	82	74	7.00	10	3	< 0.01	< 10	0.61	415	
C-L1800M 0800M	202 201	< 5 < 0.2	3.66	10	30	< 0.5	< 2	1.17	0.5	14	80	44	7.51	10	1	< 0.01	< 10	0.46	305	
C-L1800M 0850M	202 201	< 5 < 0.2	4.67	6	30	0.5	4	1.62	1.0	21	63	126	5.64	10	1	< 0.01	< 10	0.92	515	
C-L1800M 0900M	202 201	< 5 < 0.2	3.36	8	30	0.5	< 2	1.42	1.0	22	70	67	6.10	10	< 1	< 0.01	< 10	0.46	1305	
C-L1800M 0950M	202 201	< 5 < 0.2	3.46	2	10	< 0.5	< 2	1.31	1.5	12	57	58	5.21	< 10	< 1	< 0.01	< 10	0.53	450	
C-L1800M 1000M	202 201	10 < 0.2	3.62	2	20	< 0.5	< 2	1.23	1.0	12	68	56	6.17	10	< 1	< 0.01	< 10	0.47	320	
C-L1800M 1050M	202 201	< 5 < 0.2	4.03	< 2	20	< 0.5	< 2	1.34	1.5	12	76	64	6.57	10	< 1	< 0.01	< 10	0.49	305	
C-L1800M 1100M	202 201	15 < 0.2	5.17	< 2	20	< 0.5	< 2	0.97	1.5	11	71	69	6.44	10	< 1	< 0.01	< 10	0.52	325	
C-L1800M 1150M	202 201	5 < 0.2	4.27	2	20	< 0.5	< 2	0.77	1.0	10	80	80	6.92	10	< 1	< 0.01	< 10	0.33	180	

✓

CERTIFICATION: \_\_\_\_\_

CHEMEX URX FAX1

PAGE: 002

05/13/96

3:49PM

CHEMEX LABS VAX-FAX2

PAGE 002



MAY 13 '96 14:46



# Chemex Labs Ltd.

Analytical Chemists \* Geochemists \* Registered Assayers  
 212 Brooksbank Ave., North Vancouver  
 British Columbia, Canada V7J 2C1  
 PHONE: 604-984-0221 FAX: 604-984-0218

To: DOIRON, ALBERT

BOX 750  
 UCLUELET, BC  
 V0R 3A0

Project :  
 Comments: ATTN: ALBERT DOIRON

Page Number 1-B  
 Total Pages 1  
 Certificate Date 12-MAY-96  
 Invoice No. I-9617614  
 P.O. Number :  
 Account :

## CERTIFICATE OF ANALYSIS A9617614

SAMPLE DESCRIPTION	PREP CODE	Mo ppm	Na %	Ni ppm	P ppm	Pb ppm	Sb ppm	Sc ppm	Sr ppm	Ti %	Tl ppm	U ppm	V ppm	W ppm	Zn ppm
C-L1800M 0000M	202 201	< 1	< 0.01	41	540	4	< 2	13	30	0.46	< 10	< 10	278	< 10	130
C-L1800M 0050M	202 201	< 1	< 0.01	34	420	2	2	12	37	0.54	< 10	< 10	334	< 10	74
C-L1800M 0100M	202 201	< 1	0.01	5	370	2	< 2	1	30	0.07	< 10	< 10	30	< 10	14
C-L1800M 0150M	202 201	1	< 0.01	38	620	6	< 2	15	30	0.47	< 10	< 10	240	< 10	62
C-L1800M 0200M	202 201	1	< 0.01	25	850	4	< 2	9	22	0.61	< 10	< 10	321	< 10	66
C-L1800M 0250M	202 201	1	< 0.01	25	580	2	2	10	22	0.56	< 10	< 10	307	< 10	64
C-L1800M 0300M	202 201	< 1	< 0.01	28	550	4	< 2	11	25	0.54	< 10	< 10	285	< 10	60
C-L1800M 0350M	202 201	< 1	< 0.01	23	390	2	2	7	26	0.57	< 10	< 10	315	< 10	48
C-L1800M 0400M	202 201	1	< 0.01	27	520	6	< 2	10	25	0.54	< 10	< 10	271	< 10	60
C-L1800M 0450M	202 201	< 1	< 0.01	22	430	8	< 2	9	29	0.51	< 10	< 10	257	< 10	54
C-L1800M 0500M	202 201	< 1	< 0.01	36	360	< 2	< 2	14	34	0.51	< 10	< 10	288	< 10	100
C-L1800M 0550M	202 201	1	< 0.01	29	480	2	< 2	10	32	0.59	< 10	< 10	324	< 10	88
C-L1800M 0600M	202 201	2	< 0.01	31	440	< 2	2	11	26	0.51	< 10	< 10	278	< 10	86
C-L1800M 0650M	202 201	2	< 0.01	34	350	< 2	< 2	12	26	0.42	< 10	< 10	374	< 10	222
C-L1800M 0700M	202 201	< 1	< 0.01	29	690	2	< 2	14	23	0.39	< 10	< 10	237	< 10	60
C-L1800M 0750M	202 201	< 1	< 0.01	32	480	2	< 2	10	25	0.48	< 10	< 10	301	< 10	78
C-L1800M 0800M	202 201	< 1	< 0.01	26	560	2	< 2	8	25	0.49	< 10	< 10	323	< 10	106
C-L1800M 0850M	202 201	< 1	< 0.01	43	700	< 2	< 2	16	28	0.52	< 10	< 10	286	< 10	98
C-L1800M 0900M	202 201	2	< 0.01	29	510	2	2	11	27	0.57	< 10	< 10	340	< 10	92
C-L1800M 0950M	202 201	< 1	< 0.01	23	580	6	< 2	9	26	0.49	< 10	< 10	257	< 10	74
C-L1800M 1000M	202 201	< 1	< 0.01	24	480	8	< 2	10	24	0.56	< 10	< 10	311	< 10	92
C-L1800M 1050M	202 201	3	< 0.01	26	440	6	< 2	9	31	0.60	< 10	< 10	366	< 10	106
C-L1800M 1100M	202 201	2	< 0.01	25	720	6	< 2	11	23	0.52	< 10	< 10	327	< 10	72
C-L1800M 1150M	202 201	5	< 0.01	27	440	6	< 2	9	22	0.58	< 10	< 10	337	< 10	66

CERTIFICATION: \_\_\_\_\_

CHEMEX VAX FAX1

PAGE 003

05/13/96 3:50PM CHEMEX LABS VAX-FAX2

PAGE 003

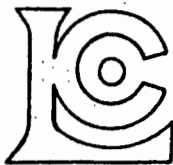

# Chemex Labs Ltd.

Analytical Chemists \* Geochemists \* Registered Assayers  
 212 Brooksbank Ave., North Vancouver  
 British Columbia, Canada V7J 2C1  
 PHONE: 604-984-0221 FAX: 604-984-0218

To: DOIRON, ALBERT

BOX 759  
 UCLUELET, BC  
 V0R 3A0

Project :  
 Comments: ATTN: AL DOIRON

Page Number : 1-A  
 Total Pages : 3  
 Certificate Date: 07-JUN-96  
 Invoice No. : 19619445  
 P.O. Number :  
 Account : LOL

## CERTIFICATE OF ANALYSIS A9619445

SAMPLE	PREP CODE	Au ppb FA+AA	Ag ppm	Al %	As ppm	Ba ppm	Be ppm	Bi ppm	Ca %	Cd ppm	Co ppm	Cr ppm	Cu ppm	Fe %	Ga ppm	Hg ppm	K %	La ppm	Mg %	Mn ppm
D-LINE 050S	201 229	< 5	0.2	2.37	2	20	< 0.5	< 2	1.13	0.5	10	72	32	6.89	10	< 1	< 0.01	< 10	0.43	720
D-LINE 150A	201 229	< 5	< 0.2	5.12	< 2	20	< 0.5	< 2	1.64	< 0.5	23	83	71	6.33	10	< 1	< 0.01	< 10	0.64	710
D-LINE 150B	201 229	< 5	0.2	5.15	2	20	< 0.5	< 2	1.41	< 0.5	21	74	60	5.79	10	< 1	< 0.01	< 10	0.58	600
D-LINE 200	201 229	< 5	< 0.2	6.11	< 2	40	0.5	< 2	1.49	0.5	22	92	106	6.58	10	< 1	< 0.01	< 10	0.65	425
D-LINE 250	201 229	< 5	< 0.2	4.38	< 2	10	< 0.5	< 2	1.65	0.5	16	79	61	6.65	10	< 1	< 0.01	< 10	0.63	310
D-LINE 300A	201 229	< 5	< 0.2	5.70	< 2	30	0.5	< 2	1.64	< 0.5	20	68	78	4.96	10	< 1	< 0.01	< 10	0.70	540
D-LINE 300B	201 229	< 5	0.2	4.62	< 2	10	< 0.5	< 2	1.54	< 0.5	17	75	73	6.76	10	< 1	< 0.01	< 10	0.61	415
D-LINE 350	201 229	< 5	0.2	7.52	< 2	10	< 0.5	< 2	1.12	0.5	14	80	71	6.02	10	< 1	< 0.01	< 10	0.73	305
D-LINE 400	201 229	< 5	0.2	7.47	< 2	20	< 0.5	< 2	0.94	0.5	13	76	71	6.34	10	< 1	0.01	< 10	0.53	380
D-LINE 450CR	201 229	< 5	< 0.2	4.90	< 2	30	< 0.5	< 2	2.09	0.5	16	65	95	5.78	10	< 1	< 0.01	< 10	0.84	465
D-LINE 500	201 229	< 5	< 0.2	4.30	< 2	30	< 0.5	< 2	2.02	0.5	15	52	106	5.03	< 10	< 1	< 0.01	< 10	0.83	480
D-LINE 600	201 229	< 5	< 0.2	4.85	< 2	20	< 0.5	< 2	1.52	0.5	17	78	79	6.18	10	< 1	< 0.01	< 10	0.63	970
D-LINE 650CR	201 229	< 5	< 0.2	4.11	8	10	< 0.5	< 2	1.40	2.0	13	112	55	10.15	20	< 1	< 0.01	< 10	0.54	290
D-LINE 700CR	201 229	< 5	< 0.2	4.76	< 2	10	< 0.5	< 2	2.28	0.5	15	87	61	6.48	10	< 1	< 0.01	< 10	0.54	425
D-LINE 750	201 229	< 5	0.2	5.29	8	20	< 0.5	< 2	1.85	1.5	17	87	56	6.03	< 10	< 1	< 0.01	< 10	0.50	815
D-LINE 800	201 229	< 5	0.2	5.11	< 2	20	< 0.5	< 2	1.55	1.5	17	82	72	6.97	10	< 1	< 0.01	< 10	0.58	460
D-LINE 850	201 229	< 5	0.2	6.02	< 2	30	0.5	< 2	1.66	1.0	17	90	74	7.54	10	< 1	< 0.01	< 10	0.79	515
D-LINE 900	201 229	< 5	0.2	5.15	< 2	20	< 0.5	< 2	1.52	2.0	13	100	51	8.29	10	< 1	0.03	< 10	0.63	350
D-LINE 950	201 229	< 5	0.2	4.65	< 2	30	< 0.5	< 2	1.23	1.5	13	75	42	7.72	10	< 1	< 0.01	< 10	0.41	290
D-LINE 1000	201 229	< 5	< 0.2	4.76	8	40	< 0.5	< 2	1.71	2.0	17	80	77	6.14	10	< 1	< 0.01	< 10	0.63	395
D-LINE 1050	201 229	< 5	< 0.2	6.32	< 2	30	< 0.5	< 2	1.26	1.0	19	90	85	7.01	10	< 1	< 0.01	< 10	0.63	400
D-LINE 1100	201 229	< 5	< 0.2	5.17	< 2	30	< 0.5	< 2	1.43	1.0	18	82	54	7.42	10	< 1	0.01	< 10	0.50	695
D-LINE 1150	201 229	< 5	< 0.2	5.09	< 2	30	< 0.5	< 2	1.88	0.5	16	71	80	6.53	10	< 1	< 0.01	< 10	0.78	895
D-LINE 1200	201 229	20	0.2	5.29	2	20	< 0.5	< 2	1.42	1.5	20	87	59	6.91	10	< 1	< 0.01	< 10	0.64	810
D-LINE 1250	201 229	50	< 0.2	3.56	< 2	10	< 0.5	< 2	1.52	1.5	11	100	36	10.40	20	< 1	< 0.01	< 10	0.53	600
D-LINE 1300	201 229	< 5	< 0.2	4.45	< 2	20	< 0.5	< 2	1.29	0.5	16	88	46	6.87	10	< 1	< 0.01	< 10	0.51	635
LINE 1N 000	201 229	10	0.2	4.48	< 2	20	< 0.5	< 2	1.32	1.5	13	89	39	6.62	10	< 1	< 0.01	< 10	0.43	640
LINE 1N 025E	201 229	20	< 0.2	4.56	< 2	20	< 0.5	< 2	1.46	1.5	15	92	39	5.85	10	< 1	< 0.01	< 10	0.39	790
LINE 1N 050E	201 229	20	< 0.2	3.67	6	40	< 0.5	< 2	2.22	1.0	15	59	56	5.06	< 10	< 1	< 0.01	< 10	0.51	1880
LINE 1N 075E	201 229	< 5	< 0.2	4.82	< 2	30	< 0.5	< 2	1.51	1.0	21	86	45	6.43	10	< 1	< 0.01	< 10	0.55	850
LINE 1N 100E	201 229	15	< 0.2	4.36	18	30	< 0.5	< 2	2.09	2.5	18	76	73	6.63	10	< 1	< 0.01	< 10	0.65	2210
LINE 1N 125E	201 229	< 5	0.2	4.87	< 2	20	< 0.5	< 2	1.59	1.0	22	82	86	6.48	10	< 1	< 0.01	< 10	0.70	520
LINE 1N 150E	201 229	< 5	< 0.2	3.14	< 2	50	< 0.5	< 2	1.42	< 0.5	14	50	33	5.55	10	< 1	0.03	< 10	0.61	1280
LINE 1N 175E	201 229	< 5	0.2	4.75	8	50	< 0.5	< 2	1.60	0.5	16	82	66	6.65	10	< 1	0.03	< 10	0.60	1265
LINE 1N 200EH-R	201 229	10	0.2	4.80	< 2	60	0.5	< 2	1.89	0.5	17	75	52	6.76	10	< 1	< 0.01	< 10	0.55	1345
LINE 1N 225E	201 229	20	0.6	8.36	2	120	1.0	< 2	3.13	1.5	17	25	65	4.94	10	< 1	0.03	10	0.43	8230
LINE 1N 250E	201 229	10	< 0.2	2.45	< 2	10	< 0.5	< 2	1.34	< 0.5	9	89	43	9.93	30	< 1	< 0.01	< 10	0.55	425
LINE 1N 275E	201 229	< 5	< 0.2	4.99	< 2	20	< 0.5	< 2	1.32	0.5	20	94	50	7.67	10	< 1	< 0.01	< 10	0.63	1010
LINE 1N 300E	201 229	< 5	< 0.2	4.53	2	40	< 0.5	< 2	1.12	< 0.5	17	58	58	6.86	10	< 1	< 0.01	< 10	0.30	1810
LINE 1N 325E	201 229	< 5	0.2	6.61	< 2	30	0.5	< 2	1.34	0.5	23	98	59	6.23	10	< 1	< 0.01	< 10	0.68	2250

CERTIFICATION: *[Signature]*

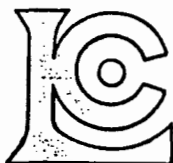

# Chemex Labs Ltd.

Analytical Chemists \* Geochemists \* Registered Assayers

212 Brooksbank Ave., North Vancouver  
British Columbia, Canada V7J 2C1  
PHONE: 604-984-0221 FAX: 604-984-0218

To: DOIRON, ALBERT

BOX 759  
UCLUELET, BC  
V0R 3A0

Project:  
Comments: ATTN: AL DOIRON

Page Number : 1-B  
Total Pages : 3  
Certificate Date: 07-JUN-96  
Invoice No. : 19619445  
P.O. Number :  
Account : LOL

## CERTIFICATE OF ANALYSIS A9619445

SAMPLE	PREP CODE	Mo ppm	Na %	Ni ppm	P ppm	Pb ppm	Sb ppm	Sc ppm	Sr ppm	Ti %	Tl ppm	U ppm	V ppm	W ppm	Zn ppm
D-LINE 050S	201 229	3 < 0.01		23	1000	2 < 2		6	17	0.68	< 10	< 10	367	< 10	62
D-LINE 150A	201 229	2 < 0.01		33	690	< 2 < 2		11	27	0.47	< 10	< 10	299	< 10	86
D-LINE 150B	201 229	3 < 0.01		26	1090	< 2 < 2		9	21	0.55	< 10	< 10	268	< 10	54
D-LINE 200	201 229	< 1 < 0.01		45	460	< 2	2	13	22	0.38	< 10	< 10	240	< 10	88
D-LINE 250	201 229	2 < 0.01		32	520	< 2 < 2		9	24	0.47	< 10	< 10	289	< 10	96
D-LINE 300A	201 229	1 < 0.01		34	750	< 2 < 2		12	28	0.45	< 10	< 10	238	< 10	74
D-LINE 300B	201 229	1 < 0.01		31	440	< 2 < 2		11	27	0.57	< 10	< 10	332	< 10	64
D-LINE 350	201 229	4 < 0.01		32	770	< 2 < 2		14	25	0.46	< 10	< 10	248	< 10	70
D-LINE 400	201 229	3 < 0.01		29	650	< 2 < 2		10	25	0.35	< 10	< 10	204	< 10	90
D-LINE 450CR	201 229	1 < 0.01		34	470	< 2 < 2		13	36	0.45	< 10	< 10	273	< 10	88
D-LINE 500	201 229	1 < 0.01		29	540	< 2	2	13	39	0.45	< 10	< 10	254	< 10	66
D-LINE 600	201 229	3 < 0.01		30	460	< 2	< 2	15	29	0.44	< 10	< 10	281	< 10	60
D-LINE 650CR	201 229	1 < 0.01		24	380	< 2	< 2	8	29	0.53	< 10	< 10	462	< 10	90
D-LINE 700CR	201 229	4 < 0.01		27	410	< 2	2	11	47	0.52	< 10	< 10	397	< 10	108
D-LINE 750	201 229	3 < 0.01		29	370	< 2	2	9	46	0.42	< 10	< 10	239	< 10	128
D-LINE 800	201 229	1 < 0.01		34	370	< 2 < 2		10	30	0.45	< 10	< 10	300	< 10	78
D-LINE 850	201 229	3 < 0.01		38	740	2	< 2	13	30	0.48	< 10	< 10	313	< 10	112
D-LINE 900	201 229	3 < 0.01		30	560	< 2 < 2		11	30	0.48	< 10	< 10	320	< 10	126
D-LINE 950	201 229	3 < 0.01		27	380	< 2	2	9	25	0.56	< 10	< 10	352	< 10	154
D-LINE 1000	201 229	2 < 0.01		41	280	< 2	6	8	40	0.38	< 10	< 10	238	< 10	162
D-LINE 1050	201 229	2 < 0.01		43	680	< 2 < 2		14	25	0.46	10	< 10	329	< 10	102
D-LINE 1100	201 229	4 < 0.01		32	550	< 2	2	10	33	0.49	< 10	< 10	328	< 10	84
D-LINE 1150	201 229	2 < 0.01		36	550	< 2 < 2		13	33	0.44	< 10	< 10	294	< 10	84
D-LINE 1200	201 229	3 < 0.01		33	1180	< 2 < 2		12	27	0.52	< 10	< 10	317	< 10	108
D-LINE 1250	201 229	< 1 < 0.01		21	660	< 2 < 2		8	27	0.55	< 10	< 10	445	< 10	58
D-LINE 1300	201 229	1 < 0.01		25	690	< 2	2	10	27	0.56	< 10	< 10	316	< 10	88
LINE 1N 000	201 229	3 < 0.01		27	930	< 2	< 2	8	27	0.50	< 10	< 10	357	< 10	110
LINE 1N 025E	201 229	2 < 0.01		27	1590	< 2	< 2	8	28	0.46	< 10	< 10	331	< 10	108
LINE 1N 050E	201 229	< 1 < 0.01		27	1130	2	< 2	10	64	0.47	< 10	< 10	234	< 10	80
LINE 1N 075E	201 229	2 < 0.01		33	1300	< 2 < 2		8	41	0.51	< 10	< 10	282	< 10	106
LINE 1N 100E	201 229	3 < 0.01		31	950	2	< 2	11	50	0.62	< 10	< 10	306	< 10	150
LINE 1N 125E	201 229	6 < 0.01		38	660	< 2	< 2	14	28	0.60	< 10	< 10	323	< 10	122
LINE 1N 150E	201 229	2 < 0.01		22	790	18	< 2	6	59	0.48	< 10	< 10	260	< 10	50
LINE 1N 175E	201 229	1 < 0.01		31	1210	2	< 2	10	50	0.55	< 10	< 10	288	< 10	90
LINE 1N 200EH-R	201 229	1 < 0.01		34	1390	< 2	< 2	10	72	0.59	< 10	< 10	280	< 10	110
LINE 1N 225E	201 229	2	0.02	36	7450	8	< 2	7	145	0.12	< 10	< 10	57	< 10	330
LINE 1N 250E	201 229	1 < 0.01		22	550	< 2	< 2	6	33	0.66	< 10	< 10	489	< 10	48
LINE 1N 275E	201 229	1 < 0.01		32	700	< 2	< 2	10	29	0.58	< 10	< 10	323	< 10	68
LINE 1N 300E	201 229	3 < 0.01		22	910	4	6	9	56	0.51	< 10	< 10	260	< 10	48
LINE 1N 325E	201 229	2 < 0.01		37	1270	2	< 2	10	28	0.51	< 10	< 10	247	< 10	92

CERTIFICATION:

*Hart Buchler*



# Chemex Labs Ltd.

Analytical Chemists \* Geochemists \* Registered Assayers  
 212 Brooksbank Ave., North Vancouver  
 British Columbia, Canada V7J 2C1  
 PHONE: 604-984-0221 FAX: 604-984-0218

To: DOIRON, ALBERT

BOX 759  
 UCLUELET, BC  
 VOR 3A0

Project:  
 Comments: ATTN: AL DOIRON

Page Number :1-A  
 Total Pages :2  
 Certificate Date: 18-JUN-96  
 Invoice No. : I9620606  
 P.O. Number :  
 Account : LOL

## CERTIFICATE OF ANALYSIS A9620606

SAMPLE	PREP CODE		Au ppb fusion		Ag	Al	As	Ba	Be	Bi	Ca	Cd	Co	Cr	Cu	Fe	Ga	Hg	K	La	Mg
			FA+AA	wt. gm	ppm	%	ppm	ppm	ppm	ppm	%	ppm	ppm	ppm	ppm	%	ppm	ppm	%	ppm	%
E-LINE 000N	201	202	< 5	30.00	0.2	4.52	2	20	< 0.5	< 2	1.69	1.5	19	113	60	7.00	10	< 1	0.02	< 10	0.69
E-LINE 050N	201	202	< 5	15.00	0.2	4.42	6	20	< 0.5	< 2	1.40	0.5	16	83	52	6.75	10	< 1	0.01	< 10	0.87
E-LINE 100N	201	202	< 5	30.00	0.2	2.87	< 2	10	< 0.5	< 2	1.59	1.0	13	102	38	8.68	20	< 1	< 0.01	< 10	0.43
E-LINE 150N	201	202	< 5	15.00	0.2	4.14	12	10	< 0.5	< 2	1.97	2.0	18	78	65	5.74	10	< 1	0.01	< 10	0.83
E-LINE 200N	201	202	< 5	15.00	0.2	4.00	2	10	< 0.5	< 2	1.67	0.5	14	64	46	5.33	10	< 1	0.01	< 10	0.51
E-LINE 250N	201	202	< 5	15.00	0.2	5.61	2	20	< 0.5	< 2	1.61	0.5	17	88	78	6.21	10	< 1	0.01	< 10	0.72
E-LINE 300N	201	202	not/ss	not/ss	0.2	3.16	2	10	< 0.5	< 2	1.61	< 0.5	11	55	50	4.66	< 10	< 1	0.01	< 10	0.69
E-LINE 350N	201	202	< 5	30.00	0.2	3.29	2	10	< 0.5	< 2	1.99	0.5	15	69	49	5.97	10	< 1	0.01	< 10	0.76
E-LINE 050S	201	202	< 5	10.00	0.4	4.66	38	10	< 0.5	< 2	2.46	1.5	16	143	105	6.22	10	< 1	0.01	< 10	0.54
E-LINE 175S	201	202	< 5	10.00	0.2	3.49	< 2	10	< 0.5	< 2	1.91	< 0.5	8	125	52	11.05	30	< 1	< 0.01	< 10	0.41
E-LINE 225S	201	202	< 5	10.00	0.8	5.57	8	30	< 0.5	< 2	2.72	1.5	26	103	247	5.38	10	< 1	0.01	10	0.83
E-LINE 275S	201	202	< 5	15.00	< 0.2	5.21	2	50	< 0.5	< 2	3.33	< 0.5	22	141	163	5.33	10	< 1	0.01	10	1.01
E-LINE 325S	201	202	not/ss	not/ss	0.4	1.22	< 2	10	< 0.5	not/ss	3.81	0.5	6	50	129	0.89	< 10	< 1	< 0.01	10	0.13
E-LINE 375S	201	202	< 5	15.00	< 0.2	5.63	2	10	< 0.5	< 2	2.25	0.5	16	90	93	6.69	10	< 1	0.01	< 10	0.68
E-LINE 425S	201	202	< 5	30.00	0.6	4.68	6	20	< 0.5	2	2.91	1.5	18	72	98	5.69	10	< 1	0.01	< 10	0.78
E-LINE 475S	201	202	< 5	30.00	0.2	4.67	6	10	< 0.5	< 2	2.09	0.5	15	64	72	5.76	10	< 1	0.01	< 10	0.66
E-LINE 525S	201	202	< 5	15.00	0.2	6.26	< 2	20	< 0.5	< 2	1.65	< 0.5	17	75	58	6.31	10	< 1	0.01	< 10	0.68
E-LINE 575S	201	202	< 5	15.00	0.2	5.54	< 2	30	< 0.5	< 2	1.74	0.5	30	68	76	6.51	10	< 1	0.01	< 10	0.63
E-LINE 625S	201	202	< 5	15.00	0.2	4.96	< 2	10	< 0.5	< 2	1.44	< 0.5	14	85	61	7.53	10	< 1	< 0.01	< 10	0.58
E-LINE 675S	201	202	< 5	15.00	0.2	4.04	2	10	< 0.5	< 2	1.25	< 0.5	10	85	44	7.75	10	< 1	< 0.01	< 10	0.42
F-LINE R77	201	202	< 5	15.00	0.2	6.41	6	10	< 0.5	< 2	1.43	0.5	22	102	59	7.13	10	< 1	0.01	< 10	0.60
F-LINE R211	201	202	< 5	30.00	0.2	4.70	< 2	10	< 0.5	< 2	1.11	< 0.5	9	117	51	10.60	30	< 1	0.01	< 10	0.52
F-LINE 000N	201	202	< 5	30.00	0.2	4.06	2	20	< 0.5	< 2	1.17	< 0.5	11	117	42	9.93	30	< 1	0.01	< 10	0.50
F-LINE 025N	201	202	< 5	30.00	0.2	4.71	2	10	< 0.5	< 2	1.22	< 0.5	12	138	59	10.40	30	< 1	0.01	< 10	0.58
F-LINE 050N	201	202	< 5	30.00	0.2	2.46	2	10	< 0.5	< 2	1.06	< 0.5	7	97	35	9.10	30	< 1	< 0.01	< 10	0.33
F-LINE 075N	201	202	< 5	15.00	0.4	3.83	4	10	< 0.5	< 2	2.94	< 0.5	14	65	59	5.49	10	< 1	0.01	< 10	0.68
F-LINE 100N	201	202	< 5	15.00	< 0.2	4.13	44	10	< 0.5	< 2	2.54	0.5	11	76	63	5.82	< 10	< 1	0.01	< 10	0.64
F-LINE 125N	201	202	< 5	15.00	0.2	4.33	2	10	< 0.5	< 2	2.38	1.5	18	96	92	6.70	10	< 1	< 0.01	10	0.58
F-LINE 150N	201	202	< 5	15.00	0.2	3.86	2	20	< 0.5	< 2	2.21	0.5	21	74	87	8.15	20	< 1	0.01	< 10	1.03
F-LINE 175N	201	202	< 5	15.00	< 0.2	5.38	14	30	< 0.5	< 2	1.77	7.5	22	121	92	7.82	20	< 1	0.01	10	0.64
F-LINE 200N	201	202	< 5	30.00	0.2	4.35	2	30	< 0.5	< 2	1.80	2.0	15	87	71	7.46	10	< 1	0.01	< 10	0.75
F-LINE 225N	201	202	< 5	15.00	0.2	3.68	6	20	< 0.5	< 2	1.53	0.5	16	92	41	8.89	20	< 1	0.01	< 10	0.62
F-LINE 250N	201	202	< 5	15.00	0.2	5.45	4	20	< 0.5	< 2	1.43	0.5	22	78	67	6.64	10	< 1	0.01	< 10	0.62
F-LINE 275N	201	202	< 5	30.00	0.2	6.13	4	20	< 0.5	< 2	1.38	< 0.5	17	108	64	7.66	10	< 1	0.01	< 10	0.61
F-LINE 300N	201	202	< 5	15.00	0.2	4.26	< 2	20	< 0.5	< 2	1.24	0.5	14	95	39	8.16	10	< 1	0.01	< 10	0.45
F-LINE 325N	201	202	< 5	15.00	0.2	1.76	2	10	< 0.5	< 2	1.03	0.5	5	76	28	8.00	20	< 1	0.01	< 10	0.27
F-LINE 350N	201	202	< 5	15.00	0.2	2.54	4	20	< 0.5	< 2	1.65	0.5	11	86	40	8.54	20	< 1	0.01	< 10	0.55
F-LINE 375N	201	202	< 5	15.00	0.2	3.59	4	30	< 0.5	< 2	1.55	4.0	17	88	60	8.08	10	< 1	0.01	< 10	0.57
F-LINE 400N	201	202	< 5	15.00	0.2	4.77	2	10	< 0.5	< 2	1.20	0.5	8	106	43	8.84	10	< 1	0.02	< 10	0.42
F-LINE 425N	201	202	< 5	15.00	0.2	7.33	8	30	< 0.5	< 2	1.64	1.5	21	99	154	6.94	10	< 1	0.01	< 10	0.71

CERTIFICATION:

*Hart Buchler*



# Chemex Labs Ltd.

Analytical Chemists \* Geochemists \* Registered Assayers

212 Brooksbank Ave., North Vancouver  
British Columbia, Canada V7J 2C1  
PHONE: 604-984-0221 FAX: 604-984-0218

To: DOIRON, ALBERT

BOX 759  
UCLUELET, BC  
V0R 3A0

2

Page Number :1-B  
Total Pages :2  
Certificate Date: 17-JUN-96  
Invoice No. : I9620606  
P.O. Number :  
Account : LOL

Project :  
Comments: ATTN: AL DOIRON

## CERTIFICATE OF ANALYSIS

## A9620606

SAMPLE	PREP CODE		Mn	Mo	Na	Ni	P	Pb	Sb	Sc	Sr	Ti	Tl	U	V	W	Zn
			ppm	ppm	%	ppm	ppm	ppm	ppm	ppm	ppm	%	ppm	ppm	ppm	ppm	ppm
E-LINE 000N	201	202	555	2	0.01	39	250	2	< 2	9	41	0.46	< 10	< 10	335	< 10	108
E-LINE 050N	201	202	385	2	< 0.01	34	540	2	< 2	8	31	0.56	< 10	< 10	305	< 10	82
E-LINE 100N	201	202	565	11	< 0.01	22	440	4	< 2	6	36	0.74	< 10	< 10	586	< 10	96
E-LINE 150N	201	202	990	4	< 0.01	35	420	4	< 2	9	41	0.50	< 10	< 10	355	< 10	116
E-LINE 200N	201	202	480	12	< 0.01	26	470	< 2	< 2	8	40	0.55	< 10	< 10	379	< 10	90
E-LINE 250N	201	202	415	2	< 0.01	36	410	2	< 2	14	30	0.51	< 10	< 10	279	< 10	66
E-LINE 300N	201	202	420	4	< 0.01	25	440	< 2	< 2	7	31	0.46	< 10	< 10	257	< 10	52
E-LINE 350N	201	202	435	6	< 0.01	30	350	2	< 2	7	42	0.60	< 10	< 10	387	< 10	94
E-LINE 050S	201	202	800	8	< 0.01	27	520	6	< 2	22	59	0.55	< 10	20	361	< 10	66
E-LINE 175S	201	202	235	4	< 0.01	19	260	2	< 2	8	49	0.67	< 10	< 10	523	< 10	54
E-LINE 225S	201	202	2010	6	< 0.01	38	950	2	2	39	63	0.44	< 10	< 10	299	< 10	94
E-LINE 275S	201	202	545	< 1	< 0.01	47	330	< 2	< 2	37	103	0.26	< 10	< 10	220	< 10	42
E-LINE 325S	201	202	1635	7	< 0.01	10	810	6	< 2	10	101	0.04	< 10	< 10	60	< 10	10
E-LINE 375S	201	202	355	1	< 0.01	34	370	< 2	< 2	15	56	0.35	< 10	< 10	234	< 10	60
E-LINE 425S	201	202	860	< 1	0.03	36	210	2	< 2	17	63	0.44	< 10	< 10	224	< 10	98
E-LINE 475S	201	202	505	< 1	< 0.01	26	370	< 2	< 2	12	46	0.47	< 10	< 10	253	< 10	56
E-LINE 525S	201	202	1045	< 1	< 0.01	33	900	< 2	< 2	11	29	0.58	< 10	< 10	286	< 10	64
E-LINE 575S	201	202	2570	2	< 0.01	36	530	2	< 2	14	37	0.62	< 10	< 10	303	< 10	70
E-LINE 625S	201	202	370	1	< 0.01	27	610	2	< 2	11	28	0.70	< 10	< 10	334	< 10	58
E-LINE 675S	201	202	295	< 1	< 0.01	23	370	2	< 2	8	28	0.64	< 10	< 10	328	< 10	62
F-LINE R77	201	202	760	1	< 0.01	28	660	< 2	< 2	13	25	0.48	< 10	< 10	261	< 10	60
F-LINE R211	201	202	275	< 1	< 0.01	21	590	2	< 2	10	20	0.59	< 10	< 10	440	< 10	58
F-LINE 000N	201	202	365	< 1	< 0.01	23	520	2	< 2	10	21	0.66	< 10	< 10	414	< 10	52
F-LINE 025N	201	202	470	< 1	< 0.01	25	520	2	< 2	9	21	0.74	< 10	< 10	425	< 10	46
F-LINE 050N	201	202	185	< 1	< 0.01	19	180	2	< 2	5	17	0.62	< 10	< 10	451	< 10	46
F-LINE 075N	201	202	850	< 1	< 0.01	24	490	< 2	< 2	14	59	0.58	< 10	< 10	244	< 10	72
F-LINE 100N	201	202	360	1	< 0.01	23	400	2	< 2	10	64	0.54	< 10	< 10	218	< 10	110
F-LINE 125N	201	202	480	4	< 0.01	27	350	< 2	2	21	58	0.54	< 10	< 10	329	< 10	52
F-LINE 150N	201	202	565	1	< 0.01	35	390	2	< 2	10	42	0.46	< 10	< 10	312	< 10	80
F-LINE 175N	201	202	520	5	< 0.01	40	330	2	< 2	19	39	0.49	< 10	< 10	374	< 10	250
F-LINE 200N	201	202	495	1	< 0.01	35	460	6	< 2	11	35	0.57	< 10	< 10	348	< 10	92
F-LINE 225N	201	202	1015	< 1	< 0.01	28	400	2	< 2	7	28	0.62	< 10	< 10	384	< 10	80
F-LINE 250N	201	202	815	< 1	< 0.01	28	1010	2	< 2	12	22	0.61	< 10	< 10	288	< 10	60
F-LINE 275N	201	202	840	< 1	< 0.01	30	1230	2	< 2	13	22	0.67	< 10	< 10	333	< 10	70
F-LINE 300N	201	202	910	1	< 0.01	20	1360	6	< 2	9	24	0.67	< 10	< 10	357	< 10	66
F-LINE 325N	201	202	280	< 1	< 0.01	16	560	6	< 2	5	33	0.91	< 10	< 10	503	< 10	44
F-LINE 350N	201	202	490	< 1	< 0.01	21	580	4	< 2	8	35	0.82	< 10	< 10	459	< 10	50
F-LINE 375N	201	202	2160	2	< 0.01	28	380	2	< 2	10	32	0.64	< 10	< 10	389	< 10	140
F-LINE 400N	201	202	370	1	< 0.01	20	550	4	2	8	23	0.67	< 10	< 10	399	< 10	54
F-LINE 425N	201	202	755	1	< 0.01	43	680	< 2	< 2	27	33	0.55	< 10	< 10	279	< 10	82

CERTIFICATE INCOMPLETE

CERTIFICATION: \_\_\_\_\_



# Chemex Labs Ltd.

Analytical Chemists \* Geochemists \* Registered Assayers  
 212 Brooksbank Ave., North Vancouver  
 British Columbia, Canada V7J 2C1  
 PHONE: 604-984-0221 FAX: 604-984-0218

To: DOIRON, ALBERT

BOX 759  
 UCLUELET, BC  
 V0R 3A0

Project :  
 Comments: ATTN: AL DOIRON

Page Number : 1-B  
 Total Pages : 2  
 Certificate Date: 18-JUN-96  
 Invoice No. : 19620606  
 P.O. Number :  
 Account : LOL

## CERTIFICATE OF ANALYSIS

### A9620606

SAMPLE	PREP		Mn	Mo	Na	Ni	P	Pb	Sb	Sc	Sr	Ti	Tl	U	V	W	Zn
	CODE		ppm	ppm	%	ppm	ppm	ppm	ppm	ppm	ppm	%	ppm	ppm	ppm	ppm	ppm
B-LINE 000M	201	202	555	2	0.01	39	250	2	< 2	9	41	0.46	< 10	< 10	335	< 10	108
B-LINE 050N	201	202	385	2	< 0.01	34	540	2	< 2	8	31	0.56	< 10	< 10	305	< 10	82
B-LINE 100M	201	202	565	11	< 0.01	22	440	4	< 2	6	36	0.74	< 10	< 10	586	< 10	96
B-LINE 150M	201	202	990	4	< 0.01	35	420	4	< 2	9	41	0.50	< 10	< 10	355	< 10	116
B-LINE 200M	201	202	480	12	< 0.01	26	470	< 2	< 2	8	40	0.55	< 10	< 10	379	< 10	90
B-LINE 250M	201	202	415	2	< 0.01	36	410	2	< 2	14	30	0.51	< 10	< 10	279	< 10	66
B-LINE 300M	201	202	470	4	< 0.01	25	440	< 2	< 2	7	31	0.46	< 10	< 10	257	< 10	52
B-LINE 350M	201	202	435	6	< 0.01	30	350	2	< 2	7	42	0.60	< 10	< 10	387	< 10	94
B-LINE 050B	201	202	800	8	< 0.01	27	520	6	< 2	22	59	0.55	< 10	< 10	361	< 10	66
B-LINE 175M	201	202	235	4	< 0.01	19	260	2	< 2	8	49	0.67	< 10	< 10	523	< 10	54
B-LINE 225M	201	202	2010	6	< 0.01	38	950	2	2	39	63	0.44	< 10	< 10	299	< 10	94
B-LINE 275M	201	202	545	< 1	< 0.01	47	330	< 2	< 2	37	103	0.26	< 10	< 10	220	< 10	42
B-LINE 325M	201	202	1635	7	< 0.01	10	810	6	< 2	10	101	0.04	< 10	< 10	60	< 10	10
B-LINE 375M	201	202	355	1	< 0.01	34	370	< 2	< 2	15	56	0.35	< 10	< 10	234	< 10	60
B-LINE 425M	201	202	860	< 1	< 0.03	36	210	2	< 2	17	63	0.44	< 10	< 10	224	< 10	98
B-LINE 475M	201	202	505	< 1	< 0.01	26	370	< 2	< 2	12	46	0.47	< 10	< 10	253	< 10	56
B-LINE 525M	201	202	1045	< 1	< 0.01	33	900	< 2	< 2	11	29	0.58	< 10	< 10	286	< 10	64
B-LINE 575M	201	202	2570	2	< 0.01	36	530	2	< 2	14	37	0.62	< 10	< 10	303	< 10	70
B-LINE 625M	201	202	370	1	< 0.01	27	610	2	< 2	11	28	0.70	< 10	< 10	334	< 10	58
B-LINE 675M	201	202	295	< 1	< 0.01	23	370	2	< 2	8	28	0.64	< 10	< 10	328	< 10	62
F-LINE R77	201	202	760	1	< 0.01	28	660	< 2	< 2	13	25	0.48	< 10	< 10	261	< 10	60
F-LINE R211	201	202	275	< 1	< 0.01	21	550	2	< 2	10	20	0.59	< 10	< 10	440	< 10	58
F-LINE 000N	201	202	365	< 1	< 0.01	23	520	2	< 2	10	21	0.66	< 10	< 10	414	< 10	52
F-LINE 025N	201	202	470	< 1	< 0.01	25	520	2	< 2	9	21	0.74	< 10	< 10	425	< 10	46
F-LINE 050N	201	202	185	< 1	< 0.01	19	180	2	< 2	5	17	0.62	< 10	< 10	451	< 10	46
F-LINE 075M	201	202	850	< 1	< 0.01	24	490	< 2	< 2	14	59	0.58	< 10	< 10	244	< 10	72
F-LINE 100M	201	202	360	1	< 0.01	23	400	2	< 2	10	64	0.54	< 10	< 10	218	< 10	110
F-LINE 125M	201	202	480	4	< 0.01	27	350	< 2	2	21	58	0.54	< 10	< 10	329	< 10	52
F-LINE 150M	201	202	565	1	< 0.01	35	390	2	< 2	10	42	0.46	< 10	< 10	312	< 10	80
F-LINE 175M	201	202	520	5	< 0.01	40	330	2	< 2	19	39	0.49	< 10	< 10	374	< 10	250
F-LINE 200M	201	202	495	1	< 0.01	35	460	6	< 2	11	35	0.57	< 10	< 10	348	< 10	92
F-LINE 225N	201	202	1015	< 1	< 0.01	28	400	2	< 2	7	28	0.62	< 10	< 10	384	< 10	80
F-LINE 250M	201	202	815	< 1	< 0.01	28	1010	2	< 2	12	22	0.61	< 10	< 10	288	< 10	60
F-LINE 275M	201	202	840	< 1	< 0.01	30	1230	2	< 2	13	22	0.67	< 10	< 10	333	< 10	70
F-LINE 300M	201	202	910	1	< 0.01	20	1360	6	< 2	9	24	0.67	< 10	< 10	357	< 10	66
F-LINE 325M	201	202	380	< 1	< 0.01	16	560	6	< 2	5	33	0.91	< 10	< 10	503	< 10	44
F-LINE 350M	201	202	490	< 1	< 0.01	21	580	4	< 2	8	35	0.82	< 10	< 10	459	< 10	50
F-LINE 375M	201	202	2160	2	< 0.01	28	380	2	< 2	10	32	0.64	< 10	< 10	389	< 10	140
F-LINE 400M	201	202	370	1	< 0.01	20	550	4	2	8	23	0.67	< 10	< 10	399	< 10	54
F-LINE 425M	201	202	755	1	< 0.01	43	680	< 2	< 2	27	33	0.55	< 10	< 10	279	< 10	82

CERTIFICATION:



# Chemex Labs Ltd.

Analytical Chemists \* Geochemists \* Registered Assayers  
212 Brooksbank Ave., North Vancouver  
British Columbia, Canada V7J 2C1  
PHONE: 604-984-0221 FAX: 604-984-0218

To: DOIRON, ALBERT

BOX 759  
UCLUELET, BC  
V0R 3A0

Project:  
Comments: ATTN: AL DOIRON

Page Number :2-A  
Total Pages :2  
Certificate Date: 18-JUN-96  
Invoice No. :19620606  
P.O. Number :  
Account :LOL

## CERTIFICATE OF ANALYSIS A9620606

SAMPLE	PREP CODE	Au ppb fusion FA+AA wt. gm	Ag ppm	Al %	As ppm	Ba ppm	Be ppm	Bi ppm	Ca %	Cd ppm	Co ppm	Cr ppm	Cu ppm	Fe %	Ga ppm	Hg ppm	K %	La ppm	Mg %
F-LINE 450N	201 202	< 5 15.00	0.2	4.12	8	20	< 0.5	< 2	2.06	0.5	16	66	78	6.43	10	< 1	0.01	< 10	0.72
F-LINE 475N	201 202	< 5 30.00	0.4	6.41	48	50	< 0.5	< 2	3.04	0.5	20	63	65	7.51	10	< 1	0.01	< 10	0.39
F-LINE 500N	201 202	10 30.00	0.2	5.65	10	20	< 0.5	< 2	1.21	0.5	18	69	90	5.24	< 10	< 1	0.03	< 10	0.67
F-LINE 525N	201 202	< 5 15.00	0.2	6.67	6	40	< 0.5	< 2	1.72	1.5	26	86	65	6.59	10	< 1	< 0.01	< 10	0.75
F-LINE 550N	201 202	< 5 30.00	0.2	4.11	10	100	< 0.5	< 2	1.48	0.5	20	103	38	5.71	10	< 1	0.01	< 10	0.21
F-LINE 575N	201 202	55 30.00	0.6	4.17	10	40	< 0.5	< 2	2.53	1.5	18	60	26	5.14	10	< 1	0.01	< 10	0.24
F-LINE 600N	201 202	< 5 30.00	0.4	6.11	6	30	< 0.5	< 2	1.59	1.5	19	103	56	7.39	10	< 1	0.01	< 10	0.71
FREE LINE 489E	201 202	< 5 15.00	0.2	5.24	2	30	< 0.5	< 2	1.38	< 0.5	14	92	56	6.51	10	< 1	0.01	< 10	0.56

CERTIFICATION: [Signature]

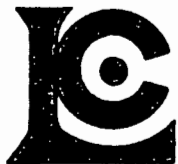

# Chemex Labs Ltd.

Analytical Chemists \* Geochemists \* Registered Assayers

212 Brooksbank Ave., North Vancouver  
British Columbia, Canada V7J 2C1  
PHONE: 604-984-0221 FAX: 604-984-0218

To: DOIRON, ALBERT

BOX 759  
UCLUELET, BC  
V0R 3A0

Project :  
Comments: ATTN: AL DOIRON

Page Number :2-B  
Total Pages :2  
Certificate Date: 18-JUN-96  
Invoice No. : I9620606  
P.O. Number :  
Account : LOL

## CERTIFICATE OF ANALYSIS

A9620606

SAMPLE	PREP CODE	Mn ppm	Mo ppm	Na %	Ni ppm	P ppm	Pb ppm	Sb ppm	Sc ppm	Sr ppm	Ti %	Tl ppm	U ppm	V ppm	W ppm	Zn ppm
F-LINE 450N	201 202	630	1 < 0.01		30	660	< 2	< 2	10	38	0.55	< 10	< 10	298	< 10	50
F-LINE 475N	201 202	570	2 < 0.01		35	3240	18	< 2	14	43	0.31	< 10	< 10	193	< 10	92
F-LINE 500N	201 202	330	1 < 0.01		53	1420	2	< 2	21	18	0.36	< 10	< 10	190	< 10	52
F-LINE 525N	201 202	1400	1 < 0.01		58	840	< 2	< 2	11	28	0.55	< 10	< 10	249	< 10	104
F-LINE 550N	201 202	605	5 < 0.01		111	2310	12	< 2	5	42	0.25	< 10	< 10	515	< 10	134
F-LINE 575N	201 202	2790	5 < 0.01		72	1320	18	2	5	38	0.28	< 10	< 10	336	< 10	216
F-LINE 600N	201 202	1170	5 < 0.01		43	810	2	< 2	10	31	0.62	< 10	< 10	405	< 10	90
TREE LINE 489E	201 202	450	< 1 < 0.01		28	680	< 2	< 2	12	30	0.63	< 10	< 10	294	< 10	62

CERTIFICATION: \_\_\_\_\_



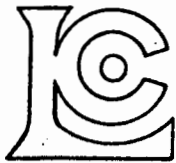

# Chemex Labs Ltd.

Analytical Chemists \* Geochemists \* Registered Assayers  
 212 Brooksbank Ave., North Vancouver  
 British Columbia, Canada V7J 2C1  
 PHONE: 604-984-0221 FAX: 604-984-0218

To: DOIRON, ALBERT

BOX 759  
 UCLUELET, BC  
 V0R 3A0

Project:  
 Comments: ATTN: AL DOIRON

Page Number :2-A  
 Total Pages :3  
 Certificate Date: 07-JUN-96  
 Invoice No. :19619445  
 P.O. Number :  
 Account :LOL

## CERTIFICATE OF ANALYSIS A9619445

SAMPLE	PREP CODE	Au ppb FA+AA	Ag ppm	Al %	As ppm	Ba ppm	Be ppm	Bi ppm	Ca %	Cd ppm	Co ppm	Cr ppm	Cu ppm	Fe %	Ga ppm	Hg ppm	K %	La ppm	Mg %	Mn ppm
LINE 1N 350E	201 229	< 5	0.2	4.02	6	30	< 0.5	< 2	1.25	0.5	13	75	46	6.49	10	1	< 0.01	< 10	0.42	1165
LINE 1N 375E	201 229	< 5	< 0.2	3.36	8	30	< 0.5	< 2	1.29	< 0.5	15	92	34	9.16	10	< 1	< 0.01	< 10	0.40	1255
LINE 1N 400E	201 229	< 5	< 0.2	5.09	6	40	< 0.5	< 2	2.14	0.5	17	59	128	5.64	10	< 1	< 0.01	< 10	0.86	755
LINE 1N 425E	201 229	< 5	< 0.2	6.24	6	30	< 0.5	< 2	1.75	1.0	18	71	86	5.45	10	< 1	< 0.01	< 10	0.74	835
LINE 1N 450E	201 229	< 5	0.2	4.29	< 2	30	< 0.5	< 2	1.40	0.5	18	84	72	6.99	10	< 1	< 0.01	< 10	0.52	1220
LINE 1N 475E	201 229	< 5	0.2	4.84	< 2	20	< 0.5	< 2	1.20	0.5	15	87	45	7.92	10	< 1	< 0.01	< 10	0.47	540
LINE 1N 500E	201 229	< 5	< 0.2	5.49	6	20	< 0.5	< 2	1.62	0.5	17	82	67	6.09	10	< 1	< 0.01	< 10	0.68	560
LINE 1S 000	201 229	< 5	< 0.2	4.72	14	30	< 0.5	< 2	1.71	2.0	15	68	35	6.24	10	1	< 0.01	< 10	0.52	640
LINE 1S 025E	201 229	< 5	< 0.2	3.57	< 2	30	< 0.5	< 2	1.60	1.0	16	86	51	7.04	10	< 1	< 0.01	< 10	0.55	1435
LINE 1S 050E	201 229	< 5	0.2	5.56	10	110	< 0.5	< 2	2.40	0.5	21	63	187	5.09	10	< 1	0.03	< 10	1.03	680
LINE 1S 075E	201 229	45	0.2	3.66	14	30	< 0.5	< 2	4.29	1.0	16	28	104	4.08	< 10	< 1	0.04	10	0.72	735
LINE 1S 125E	201 229	15	0.4	4.71	50	60	< 0.5	< 2	2.89	10.0	20	75	136	5.35	10	< 1	< 0.01	< 10	0.76	5120
LINE 1S 150E	201 229	< 5	< 0.2	4.75	8	30	< 0.5	< 2	1.55	< 0.5	16	71	55	6.71	10	< 1	< 0.01	< 10	0.56	500
LINE 1S 175E	201 229	< 5	< 0.2	3.86	2	30	< 0.5	< 2	1.44	0.5	16	110	37	8.66	10	< 1	< 0.01	< 10	0.48	915
LINE 1S 200E	201 229	20	< 0.2	4.08	6	30	< 0.5	< 2	1.48	0.5	16	91	58	6.61	10	< 1	< 0.01	< 10	0.59	640
LINE 1S 225E	201 229	< 5	< 0.2	4.39	< 2	30	< 0.5	< 2	1.34	< 0.5	17	89	44	6.70	10	1	< 0.01	< 10	0.43	1035
LINE 1S 250E	201 229	< 5	0.2	4.61	2	30	< 0.5	< 2	1.35	0.5	19	84	80	5.89	10	< 1	< 0.01	< 10	0.61	820
LINE 1S 275E	201 229	< 5	< 0.2	3.09	2	30	< 0.5	< 2	1.74	< 0.5	25	81	44	8.00	10	1	< 0.01	< 10	0.67	2090
LINE 1S 300E	201 229	< 5	< 0.2	5.09	2	30	< 0.5	< 2	1.86	0.5	17	80	102	6.16	10	1	< 0.01	< 10	0.90	705
LINE 1S 325E	201 229	< 5	< 0.2	3.46	6	50	< 0.5	< 2	1.15	0.5	15	80	38	7.06	10	< 1	< 0.01	< 10	0.39	2730
LINE 1S 350E	201 229	< 5	< 0.2	5.43	10	40	< 0.5	< 2	1.91	0.5	22	86	99	6.01	10	< 1	< 0.01	< 10	0.75	615
LINE 1S 400E	201 229	not/ps	0.2	4.03	2	40	< 0.5	< 2	1.23	0.5	16	75	46	6.68	10	< 1	< 0.01	< 10	0.42	1015
LINE 1S 425E	201 229	< 5	< 0.2	5.13	6	30	< 0.5	< 2	1.67	0.5	19	89	55	6.62	10	< 1	< 0.01	< 10	0.61	1040
LINE 1S 450E	201 229	< 5	< 0.2	5.34	8	40	< 0.5	< 2	1.53	1.0	20	83	66	6.63	10	1	< 0.01	< 10	0.66	1390
LINE 1S 475E	201 229	< 5	< 0.2	2.91	4	10	< 0.5	< 2	1.38	0.5	12	94	30	9.45	20	< 1	< 0.01	< 10	0.43	740
LINE 1S 500E	201 229	< 5	< 0.2	4.34	2	30	< 0.5	< 2	1.81	0.5	16	71	63	6.51	10	1	< 0.01	< 10	0.65	1020
LINE 2N 0+50N	201 229	< 5	< 0.2	4.75	8	40	< 0.5	< 2	1.53	1.5	16	79	91	5.17	10	1	< 0.01	< 10	0.70	505
LINE 2N 025E	201 229	20	< 0.2	3.27	4	20	< 0.5	< 2	0.98	1.0	10	95	38	8.30	10	< 1	< 0.01	< 10	0.38	415
LINE 2N 050E	201 229	< 5	< 0.2	3.08	6	30	< 0.5	< 2	1.56	0.5	12	58	62	5.23	10	< 1	< 0.01	< 10	0.51	875
LINE 2N 075E	201 229	< 5	< 0.2	3.65	14	30	< 0.5	< 2	1.73	1.5	14	59	62	5.52	10	< 1	< 0.01	< 10	0.61	1210
LINE 2N 100E	201 229	10	< 0.2	3.03	< 2	10	< 0.5	< 2	1.16	0.5	9	68	40	5.95	10	< 1	< 0.01	< 10	0.37	680
LINE 2N 125E	201 229	< 5	< 0.2	5.61	6	50	< 0.5	< 2	1.81	0.5	21	68	150	5.68	10	1	< 0.01	< 10	0.96	820
LINE 2N 150E	201 229	< 5	< 0.2	4.07	2	30	< 0.5	< 2	1.06	0.5	11	91	32	8.01	10	< 1	< 0.01	< 10	0.33	655
LINE 2N 175E	201 229	< 5	< 0.2	1.72	2	10	< 0.5	< 2	0.89	< 0.5	6	96	27	10.00	30	< 1	< 0.01	< 10	0.27	425
LINE 2N 200E	201 229	< 5	0.2	4.88	10	30	< 0.5	< 2	1.14	0.5	13	97	49	7.29	10	< 1	< 0.01	< 10	0.45	900
LINE 2N 225E	201 229	< 5	< 0.2	4.13	< 2	30	< 0.5	< 2	1.46	< 0.5	14	99	59	7.72	10	< 1	< 0.01	< 10	0.51	675
LINE 2N 250E	201 229	< 5	< 0.2	3.64	< 2	40	< 0.5	< 2	1.41	< 0.5	15	60	59	6.25	10	< 1	< 0.01	< 10	0.48	1180
LINE 2N 275E	201 229	160	< 0.2	5.42	10	40	< 0.5	< 2	1.24	< 0.5	16	71	54	6.36	10	< 1	< 0.01	< 10	0.40	1025
LINE 2N 300EA	201 229	< 5	< 0.2	5.59	2	40	< 0.5	< 2	1.24	0.5	18	93	69	7.72	10	< 1	< 0.01	< 10	0.55	520
LINE 2N 300EB	201 229	< 5	< 0.2	4.59	10	30	< 0.5	< 2	1.34	< 0.5	15	79	48	7.63	10	< 1	< 0.01	< 10	0.50	735

CERTIFICATION:

*Handwritten signature*

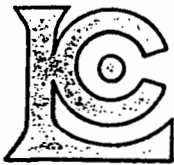

# Chemex Labs Ltd.

Analytical Chemists \* Geochemists \* Registered Assayers

212 Brooksbank Ave., North Vancouver  
British Columbia, Canada V7J 2C1  
PHONE: 604-984-0221 FAX: 604-984-0218

To: DOIRON, ALBERT

BOX 759  
UCLUELET, BC  
V0R 3A0

Project:  
Comments: ATTN: AL DOIRON

Page Number :2-B  
Total Pages :3  
Certificate Date: 07-JUN-96  
Invoice No. :19619445  
P.O. Number :  
Account :LOL

## CERTIFICATE OF ANALYSIS

A9619445

SAMPLE	PREP CODE	Mo ppm	Na %	Ni ppm	P ppm	Pb ppm	Sb ppm	Sc ppm	Sr ppm	Ti %	Tl ppm	U ppm	V ppm	W ppm	Zn ppm
LINE 1N 350E	201 229	1 < 0.01		23	1260	8	< 2	8	28	0.60	< 10	< 10	307	< 10	108
LINE 1N 375E	201 229	< 1 < 0.01		18	1120	8	< 2	7	29	0.72	< 10	< 10	408	< 10	68
LINE 1N 400E	201 229	1 < 0.01		31	640	2	< 2	15	37	0.53	< 10	< 10	282	< 10	68
LINE 1N 425E	201 229	< 1 < 0.01		36	620	< 2	< 2	14	29	0.40	< 10	< 10	247	< 10	84
LINE 1N 450E	201 229	< 1 < 0.01		26	580	8	< 2	10	27	0.41	< 10	< 10	290	< 10	82
LINE 1N 475E	201 229	< 1 < 0.01		21	590	2	< 2	10	25	0.40	< 10	< 10	311	< 10	60
LINE 1N 500E	201 229	< 1 < 0.01		29	630	2	< 2	11	30	0.40	< 10	< 10	248	< 10	64
LINE 1S 000	201 229	1 < 0.01		27	1260	6	< 2	10	35	0.50	< 10	< 10	254	< 10	118
LINE 1S 025E	201 229	< 1 < 0.01		25	580	2	< 2	13	32	0.55	< 10	< 10	320	< 10	60
LINE 1S 050E	201 229	< 1 < 0.01		47	1090	2	< 2	18	78	0.48	< 10	< 10	256	< 10	80
LINE 1S 075E	201 229	1 < 0.01		30	1670	12	< 2	9	53	0.24	< 10	< 10	170	< 10	104
LINE 1S 125E	201 229	8 < 0.01		41	1030	4	< 2	27	86	0.49	< 10	< 10	261	< 10	380
LINE 1S 150E	201 229	< 1 < 0.01		26	1250	6	< 2	10	35	0.54	< 10	< 10	288	< 10	88
LINE 1S 175E	201 229	< 1 < 0.01		21	1890	6	< 2	7	24	0.64	< 10	< 10	391	< 10	82
LINE 1S 200E	201 229	< 1 < 0.01		27	1170	2	< 2	10	29	0.63	< 10	< 10	311	< 10	94
LINE 1S 225E	201 229	< 1 < 0.01		23	1030	4	< 2	9	27	0.62	< 10	< 10	319	< 10	76
LINE 1S 250E	201 229	1 < 0.01		32	940	2	< 2	14	29	0.54	< 10	< 10	274	< 10	88
LINE 1S 275E	201 229	< 1 < 0.01		23	1170	4	< 2	8	27	0.69	< 10	< 10	385	< 10	64
LINE 1S 300E	201 229	< 1 < 0.01		36	530	2	< 2	13	33	0.44	< 10	< 10	256	< 10	70
LINE 1S 325E	201 229	< 1 < 0.01		21	680	6	< 2	6	23	0.56	< 10	< 10	325	< 10	108
LINE 1S 350E	201 229	< 1 < 0.01		40	590	2	< 2	15	34	0.42	< 10	< 10	250	< 10	96
LINE 1S 400E	201 229	< 1 < 0.01		19	640	6	< 2	8	28	0.50	< 10	< 10	309	< 10	64
LINE 1S 425E	201 229	< 1 < 0.01		30	730	2	< 2	10	34	0.44	< 10	< 10	278	< 10	94
LINE 1S 450E	201 229	1 < 0.01		33	950	8	< 2	10	30	0.49	< 10	< 10	275	< 10	122
LINE 1S 475E	201 229	1 < 0.01		18	510	8	< 2	6	29	0.56	< 10	< 10	396	< 10	54
LINE 1S 500E	201 229	2 < 0.01		25	490	6	< 2	10	38	0.45	< 10	< 10	291	< 10	64
LINE 2N 0+50N	201 229	3 < 0.01		38	760	6	< 2	14	30	0.46	< 10	< 10	365	< 10	140
LINE 2N 025E	201 229	1 < 0.01		20	880	8	< 2	6	19	0.61	< 10	< 10	414	< 10	68
LINE 2N 050E	201 229	1 < 0.01		21	1490	2	< 2	9	27	0.50	< 10	< 10	236	< 10	52
LINE 2N 075E	201 229	< 1 < 0.01		23	1040	8	< 2	9	33	0.47	< 10	< 10	264	< 10	68
LINE 2N 100E	201 229	1 < 0.01		14	930	4	< 2	6	27	0.60	< 10	< 10	306	< 10	48
LINE 2N 125E	201 229	< 1 < 0.01		38	800	8	< 2	14	40	0.47	< 10	< 10	252	< 10	74
LINE 2N 150E	201 229	< 1 < 0.01		23	760	6	< 2	7	25	0.61	< 10	< 10	376	< 10	76
LINE 2N 175E	201 229	< 1 < 0.01		17	790	18	< 2	4	19	0.76	< 10	< 10	583	< 10	50
LINE 2N 200E	201 229	< 1 < 0.01		26	810	8	< 2	9	25	0.51	< 10	< 10	313	< 10	74
LINE 2N 225E	201 229	< 1 < 0.01		28	570	6	< 2	13	27	0.51	< 10	< 10	325	< 10	62
LINE 2N 250E	201 229	< 1 < 0.01		20	670	4	< 2	8	35	0.50	< 10	< 10	263	< 10	54
LINE 2N 275E	201 229	< 1 < 0.01		22	1300	4	< 2	9	26	0.49	< 10	< 10	256	< 10	92
LINE 2N 300EA	201 229	< 1 < 0.01		29	1200	2	< 2	14	38	0.52	< 10	< 10	336	< 10	100
LINE 2N 300EB	201 229	< 1 < 0.01		23	810	4	< 2	9	29	0.52	< 10	< 10	318	< 10	66

CERTIFICATION:

*Albert Doiron*

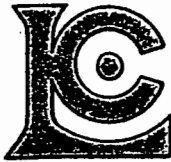

# Chemex Labs Ltd.

Analytical Chemists \* Geochemists \* Registered Assayers  
 212 Brooksbank Ave., North Vancouver  
 British Columbia, Canada V7J 2C1  
 PHONE: 604-984-0221 FAX: 604-984-0218

To: DOIRON, ALBERT

BOX 759  
 UCLUELET, BC  
 V0R 3A0

Project :  
 Comments: ATTN:AL DOIRON

Page Number :1-A  
 Total Pages :1  
 Certificate Date: 12-JUL-96  
 Invoice No. :I9622805  
 P.O. Number :  
 Account :LOL

## CERTIFICATE OF ANALYSIS

A9622805

SAMPLE	PREP CODE	Au ppb FA+AA	Ag ppm	Al %	As ppm	Ba ppm	Be ppm	Bi ppm	Ca %	Cd ppm	Co ppm	Cr ppm	Cu ppm	Fe %	Ga ppm	Hg ppm	K %	La ppm	Mg %	Mn ppm
LINE-3N00	201 202	< 5	0.8	3.77	< 2	20	0.5	< 2	1.35	1.0	17	84	43	7.37	10	< 1	0.01	< 10	0.50	1085
LINE-3N 025E	201 202	25	0.6	3.42	2	20	< 0.5	2	1.32	1.5	13	77	45	7.30	10	< 1	0.01	< 10	0.52	445
LINE-3N 050E	201 202	< 5	0.6	3.61	2	30	< 0.5	< 2	1.31	1.0	18	79	48	6.81	10	< 1	0.01	< 10	0.45	965
LINE-3N 075E	201 202	< 5	0.8	4.92	< 2	30	0.5	< 2	1.83	1.0	20	62	103	5.97	10	< 1	0.01	< 10	0.73	805
LINE-3N 100E	201 202	< 5	0.8	5.01	6	40	0.5	< 2	1.51	0.5	23	78	98	6.40	10	< 1	0.02	< 10	0.80	785
LINE-3N 125E	201 202	< 5	0.4	2.85	< 2	30	< 0.5	< 2	0.79	< 0.5	13	90	30	8.92	10	< 1	0.01	< 10	0.31	395
LINE-3N 175E	201 202	< 5	not/ss	not/ss	not/ss	not/ss	not/ss	not/ss	not/ss	not/ss	not/ss	not/ss	not/ss	not/ss	not/ss	not/ss	not/ss	not/ss	not/ss	not/ss
LINE-3N 200E	201 202	< 5	0.8	4.71	2	40	0.5	< 2	1.56	0.5	25	79	70	6.22	10	< 1	0.01	< 10	0.65	1770
LINE-3N 225E	201 202	< 5	0.6	3.90	6	40	0.5	< 2	0.98	0.5	15	54	26	6.11	10	< 1	0.02	< 10	0.26	1590
LINE-3N 250E	201 202	10	0.6	4.74	6	40	0.5	< 2	1.33	1.0	19	58	69	5.55	< 10	< 1	0.02	< 10	0.45	1500
LINE-3N 275E	201 202	< 5	0.8	6.26	10	50	0.5	< 2	1.28	< 0.5	19	57	57	5.82	10	< 1	0.02	< 10	0.51	455
LINE-3N 300E	201 202	< 5	1.0	6.04	20	30	0.5	2	1.88	1.0	23	74	124	4.94	< 10	< 1	0.01	< 10	0.63	620
LINE-3N 325E	201 202	< 5	0.8	4.52	8	30	0.5	< 2	1.39	1.0	17	72	73	6.67	10	< 1	0.01	< 10	0.46	730
LINE-3N 350E	201 202	< 5	0.8	4.19	2	30	0.5	< 2	1.71	0.5	25	70	70	6.74	10	< 1	0.01	< 10	0.67	990
LINE-4N 00	201 202	< 5	0.6	5.26	6	10	< 0.5	< 2	1.17	1.5	11	100	43	6.95	10	< 1	0.01	< 10	0.38	340
LINE-4N 025E	201 202	< 5	0.2	1.94	< 2	30	< 0.5	< 2	0.81	0.5	9	42	26	3.27	< 10	< 1	0.03	< 10	0.27	300
LINE-4N 050E(A)	201 202	< 5	0.6	5.59	18	20	0.5	< 2	1.19	1.5	21	78	56	6.33	10	< 1	0.01	< 10	0.45	585
LINE-4N 050E(B)	201 202	< 5	0.6	6.44	14	20	0.5	2	0.92	1.5	32	113	48	8.14	10	< 1	0.01	< 10	0.35	600
LINE-4N 075	201 202	< 5	0.4	2.58	< 2	20	0.5	< 2	0.94	0.5	12	89	23	8.59	10	< 1	0.01	< 10	0.26	550
LINE-4N 100E	201 202	< 5	0.8	3.27	2	10	0.5	< 2	1.59	1.5	19	87	31	8.31	10	< 1	0.01	< 10	0.39	915
LINE-4N 125E	201 202	< 5	0.8	3.77	12	40	0.5	< 2	1.38	1.0	21	80	41	7.36	10	< 1	0.01	< 10	0.40	2530
LINE-4N 150E(A)	201 202	< 5	0.6	3.13	< 2	30	0.5	< 2	1.04	0.5	24	95	36	9.32	20	< 1	0.01	< 10	0.33	1215
LINE-4N 150E(B)	201 202	< 5	0.6	3.18	2	20	0.5	2	1.26	0.5	14	80	44	7.34	10	< 1	0.01	< 10	0.40	965
LINE-4N 175E	201 202	< 5	< 0.2	4.00	14	110	< 0.5	< 2	2.34	1.0	17	59	38	6.14	10	< 1	0.01	< 10	0.53	3700
LINE-4N 200E	201 202	5	0.6	5.19	10	30	< 0.5	< 2	1.18	1.5	36	63	67	6.27	< 10	< 1	0.02	< 10	0.50	2650
LINE-4N 225E	201 202	< 5	0.8	3.77	8	170	< 0.5	2	1.77	0.5	17	58	50	5.07	< 10	< 1	0.03	< 10	0.45	1170
LINE-4N 250E(A)	201 202	< 5	0.8	5.27	4	50	0.5	< 2	1.42	0.5	19	71	41	6.27	10	< 1	0.02	< 10	0.51	1190
LINE-4N 250E(B)	201 202	< 5	0.6	5.44	< 2	40	0.5	< 2	1.50	0.5	26	71	76	5.90	10	< 1	0.03	< 10	0.83	2670
LINE-4N 275E	201 202	< 5	0.8	4.83	< 2	40	0.5	< 2	1.66	< 0.5	22	69	69	6.62	10	< 1	0.01	< 10	0.61	1195
LINE-4N 300E	201 202	< 5	0.2	5.98	10	40	0.5	< 2	1.31	0.5	26	74	75	6.67	10	< 1	0.02	< 10	0.61	1420
LINE-4N 325E	201 202	< 5	0.2	3.22	8	50	0.5	4	2.12	< 0.5	25	75	39	7.21	10	< 1	0.02	< 10	0.44	2810
LINE-4N 350E	201 202	< 5	< 0.2	5.85	4	10	0.5	< 2	1.26	1.0	24	93	61	7.31	10	< 1	0.02	< 10	0.45	800

CERTIFICATION:

*[Handwritten signature]*



# Chemex Labs Ltd.

Analytical Chemists \* Geochemists \* Registered Assayers  
 212 Brooksbank Ave., North Vancouver  
 British Columbia, Canada V7J 2C1  
 PHONE: 604-984-0221 FAX: 604-984-0218

To: DOIRON, ALBERT

BOX 759  
 UCLUELET, BC  
 V0R 3A0

Project:  
 Comments: ATTN:AL DOIRON

Page Number :1-B  
 Total Pages :1  
 Certificate Date: 12-JUL-96  
 Invoice No. :19622805  
 P.O. Number :  
 Account :LOL

<b>CERTIFICATE OF ANALYSIS</b>	<b>A9622805</b>
--------------------------------	-----------------

SAMPLE	PREP CODE		Mo	Na	Ni	P	Pb	Sb	Sc	Sr	Ti	Tl	U	V	W	Zn
			ppm	%	ppm	ppm	ppm	ppm	ppm	ppm	ppm	%	ppm	ppm	ppm	ppm
LINE-3N00	201	202	< 1	< 0.01	26	770	4	< 2	8	23	0.64	< 10	< 10	372	< 10	76
LINE-3N 025E	201	202	1	< 0.01	23	910	8	< 2	7	27	0.64	< 10	< 10	392	< 10	72
LINE-3N 050E	201	202	< 1	< 0.01	26	1670	14	< 2	8	26	0.63	< 10	< 10	340	< 10	74
LINE-3N 075E	201	202	< 1	< 0.01	27	850	2	< 2	12	31	0.55	< 10	< 10	280	< 10	72
LINE-3N 100E	201	202	< 1	< 0.01	33	680	2	< 2	12	30	0.54	< 10	< 10	273	< 10	66
LINE-3N 125E	201	202	< 1	< 0.01	19	660	8	< 2	6	19	0.73	< 10	< 10	458	< 10	60
LINE-3N 175E	201	202	not/ss	not/ss	not/ss	not/ss	not/ss	not/ss	not/ss	not/ss	not/ss	not/ss	not/ss	not/ss	not/ss	not/ss
LINE-3N 200E	201	202	< 1	< 0.01	30	1150	8	< 2	9	26	0.61	< 10	< 10	282	< 10	82
LINE-3N 225E	201	202	< 1	< 0.01	18	1100	10	< 2	5	28	0.47	< 10	< 10	229	< 10	80
LINE-3N 250E	201	202	< 1	< 0.01	27	2550	6	< 2	9	41	0.42	< 10	< 10	218	< 10	72
LINE-3N 275E	201	202	< 1	< 0.01	31	1500	14	< 2	11	47	0.41	< 10	< 10	189	< 10	84
LINE-3N 300E	201	202	1	< 0.01	54	900	10	< 2	31	32	0.44	< 10	< 10	221	< 10	60
LINE-3N 325E	201	202	< 1	< 0.01	22	1660	6	< 2	9	32	0.60	< 10	< 10	286	< 10	64
LINE-3N 350E	201	202	< 1	< 0.01	29	800	4	< 2	9	32	0.61	< 10	< 10	320	< 10	80
LINE-4N 00	201	202	1	< 0.01	20	720	8	< 2	9	23	0.52	< 10	< 10	334	< 10	74
LINE-4N 025E	201	202	1	< 0.01	20	920	12	< 2	4	23	0.39	< 10	< 10	188	< 10	46
LINE-4N 050E(A)	201	202	< 1	< 0.01	28	1200	6	< 2	8	22	0.52	< 10	< 10	272	< 10	86
LINE-4N 050E(B)	201	202	1	< 0.01	24	1070	6	< 2	9	16	0.47	< 10	< 10	273	< 10	86
LINE-4N 075	201	202	< 1	< 0.01	16	870	10	< 2	5	17	0.70	< 10	< 10	417	< 10	58
LINE-4N 100E	201	202	< 1	< 0.01	21	1470	10	< 2	7	21	0.73	< 10	< 10	435	< 10	74
LINE-4N 125E	201	202	1	< 0.01	21	1980	12	< 2	7	29	0.64	< 10	< 10	330	< 10	92
LINE-4N 150E(A)	201	202	< 1	< 0.01	20	1180	12	< 2	6	21	0.74	< 10	< 10	438	< 10	92
LINE-4N 150E(B)	201	202	< 1	< 0.01	19	800	4	< 2	7	25	0.70	< 10	< 10	362	< 10	54
LINE-4N 175E	201	202	1	< 0.01	26	2090	14	< 2	8	69	0.54	< 10	< 10	226	< 10	140
LINE-4N 200E	201	202	< 1	< 0.01	20	2700	2	< 2	7	22	0.46	< 10	< 10	218	< 10	52
LINE-4N 225E	201	202	1	< 0.01	25	1500	10	< 2	8	82	0.43	< 10	< 10	218	< 10	76
LINE-4N 250E(A)	201	202	< 1	< 0.01	27	2620	6	< 2	8	29	0.47	< 10	< 10	257	< 10	100
LINE-4N 250E(B)	201	202	< 1	< 0.01	35	1510	6	< 2	10	33	0.51	< 10	< 10	251	< 10	82
LINE-4N 275E	201	202	< 1	< 0.01	28	2660	8	< 2	9	31	0.52	< 10	< 10	279	< 10	76
LINE-4N 300E	201	202	< 1	< 0.01	31	1230	< 2	< 2	13	32	0.45	< 10	< 10	264	< 10	98
LINE-4N 325E	201	202	< 1	< 0.01	24	1240	4	< 2	7	51	0.61	< 10	< 10	297	< 10	84
LINE-4N 350E	201	202	< 1	< 0.01	33	1270	2	< 2	11	25	0.58	< 10	< 10	307	< 10	94

CERTIFICATION: \_\_\_\_\_

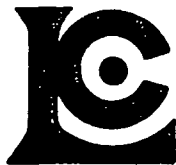

# Chemex Labs Ltd.

Analytical Chemists \* Geochemists \* Registered Assayers

212 Brooksbank Ave., North Vancouver  
British Columbia, Canada V7J 2C1  
PHONE: 604-984-0221 FAX: 604-984-0218

To: DOIRON, ALBERT

BOX 759  
UCLUELET, BC  
V0R 3A0

Project :  
Comments: ATTN: AL DOIRON

Page Number :3-A  
Total Pages :3  
Certificate Date: 07-JUN-96  
Invoice No. : I9619445  
P.O. Number :  
Account : LOL

## CERTIFICATE OF ANALYSIS

### A9619445

SAMPLE	PREP CODE	Au ppb FA+AA	Ag ppm	Al %	As ppm	Ba ppm	Be ppm	Bi ppm	Ca %	Cd ppm	Co ppm	Cr ppm	Cu ppm	Fe %	Ga ppm	Hg ppm	K %	La ppm	Mg %	Mn ppm
LINE 2N 350E	201 229	< 5	0.2	6.48	14	40	< 0.5	< 2	1.25	0.5	18	92	83	6.62	10	1	0.01	< 10	0.57	415
LINE 2N 375E	201 229	< 5	< 0.2	5.03	14	20	< 0.5	< 2	1.40	0.5	17	81	47	7.25	20	2	0.01	< 10	0.51	825
LINE 2N 400E	201 229	< 5	< 0.2	4.36	8	30	< 0.5	< 2	1.17	0.5	17	83	48	7.82	20	< 1	0.01	< 10	0.40	865
LINE 2N 425E	201 229	< 5	< 0.2	5.36	8	30	< 0.5	< 2	1.38	1.0	20	76	88	6.47	10	3	0.01	< 10	0.62	800
LINE 2N 450E	201 229	< 5	< 0.2	5.75	< 2	30	< 0.5	< 2	1.65	1.0	20	86	102	6.31	10	< 1	0.01	< 10	0.68	795
LINE 2N 475E	201 229	< 5	< 0.2	1.90	10	260	0.5	< 2	0.38	< 0.5	10	19	25	2.09	< 10	< 1	0.40	10	0.54	575
LINE 2N 500E	201 229	20	< 0.2	2.54	4	370	0.5	< 2	0.50	< 0.5	7	19	29	2.26	< 10	< 1	0.53	10	0.66	450
LINE 2S 000	201 229	< 5	< 0.2	2.56	10	350	0.5	< 2	0.51	< 0.5	8	20	28	2.30	< 10	< 1	0.53	10	0.61	420
LINE 2S 025E	201 229	< 5	< 0.2	2.77	10	320	0.5	< 2	0.50	< 0.5	7	20	25	2.33	< 10	< 1	0.47	10	0.63	465
LINE 2S 050E	201 229	< 5	< 0.2	3.21	10	330	0.5	< 2	0.57	< 0.5	6	23	26	2.48	< 10	< 1	0.44	10	0.63	360
LINE 2S 075E	201 229	< 5	< 0.2	2.08	36	400	1.5	< 2	1.49	0.5	11	17	38	2.33	< 10	< 1	0.51	10	0.59	355
LINE 2S 100E	201 229	15	< 0.2	1.84	10	310	0.5	< 2	0.43	< 0.5	7	19	25	2.23	< 10	< 1	0.49	10	0.67	490
LINE 2S 150E	201 229	5	< 0.2	2.26	16	370	0.5	< 2	0.49	0.5	10	22	46	2.55	< 10	< 1	0.61	10	0.76	640
LINE 2S 175E	201 229	< 5	< 0.2	1.53	14	240	0.5	< 2	0.35	< 0.5	8	19	27	1.92	< 10	< 1	0.31	10	0.41	475
LINE 2S 200E	201 229	< 5	< 0.2	2.46	10	320	0.5	< 2	0.44	< 0.5	9	21	27	2.32	< 10	< 1	0.47	10	0.61	575
LINE 2S 225E	201 229	< 5	< 0.2	2.65	8	310	0.5	< 2	0.50	< 0.5	7	19	28	2.33	< 10	< 1	0.53	10	0.60	485
LINE 2S 250E	201 229	< 5	< 0.2	2.89	12	320	0.5	< 2	0.51	< 0.5	6	20	26	2.36	< 10	< 1	0.47	10	0.62	400
LINE 2S 275E	201 229	< 5	< 0.2	3.00	16	540	0.5	< 2	0.58	< 0.5	8	23	34	2.74	< 10	< 1	0.73	10	0.92	470
LINE 2S 300E	201 229	< 5	< 0.2	2.73	12	550	0.5	< 2	0.57	0.5	9	22	34	2.69	< 10	< 1	0.74	10	0.99	730
LINE 3S 075E	201 229	< 5	< 0.2	2.16	34	610	0.5	< 2	0.50	0.5	11	21	41	2.48	< 10	< 1	0.56	10	0.69	770
LINE 3S 100E	201 229	< 5	< 0.2	2.81	82	940	0.5	< 2	0.56	0.5	10	23	60	3.00	< 10	< 1	0.74	10	0.71	750
LINE 3S 125E	201 229	< 5	< 0.2	3.02	14	360	0.5	< 2	0.59	< 0.5	8	21	32	2.51	< 10	< 1	0.55	10	0.71	500
LINE 3S 150E	201 229	< 5	< 0.2	2.82	6	330	0.5	< 2	0.51	< 0.5	7	19	27	2.31	< 10	< 1	0.51	10	0.64	490
LINE 3S 175E	201 229	< 5	< 0.2	3.14	26	750	0.5	< 2	0.68	0.5	9	23	47	2.83	< 10	< 1	0.73	10	0.86	520
LINE 3S 200E	201 229	< 5	< 0.2	3.02	12	980	0.5	< 2	0.57	< 0.5	9	23	40	2.81	< 10	< 1	0.87	10	1.01	560
LINE 3S 225E	201 229	< 5	< 0.2	2.59	16	570	0.5	< 2	0.57	< 0.5	9	21	34	2.58	< 10	< 1	0.80	10	0.96	675
LINE 3S 275E	201 229	< 5	< 0.2	2.60	26	810	0.5	< 2	0.63	< 0.5	8	21	49	2.59	< 10	< 1	0.66	10	0.85	525
LINE 3S 300E	201 229	< 5	< 0.2	3.05	36	1230	1.0	< 2	0.66	< 0.5	9	23	52	2.90	< 10	< 1	0.72	10	0.86	555
LINE 4S 225E	201 229	< 5	< 0.2	2.48	46	1020	0.5	< 2	0.62	0.5	9	19	43	2.52	< 10	< 1	0.62	10	0.76	550
LINE 4S 075E	201 229	< 5	< 0.2	2.78	50	1130	0.5	< 2	0.61	< 0.5	9	23	61	2.83	< 10	< 1	0.72	10	0.88	640
LINE 4S 100E	201 229	< 5	< 0.2	3.07	48	1220	1.0	< 2	0.67	< 0.5	8	22	44	2.76	< 10	< 1	0.74	10	0.88	460
LINE 4S 125E	201 229	< 5	0.2	2.66	< 2	20	< 0.5	< 2	4.30	0.5	13	23	23	5.15	10	< 1	0.01	< 10	0.31	660
LINE 4S 150E	201 229	< 5	0.4	3.15	< 2	30	< 0.5	2	1.88	< 0.5	13	75	42	7.00	10	< 1	< 0.01	< 10	0.41	435
LINE 4S 175E	201 229	< 5	0.2	4.44	< 2	20	< 0.5	2	1.79	1.0	18	69	66	6.66	10	< 1	< 0.01	< 10	0.64	1050
LINE 4S 200E	201 229	< 5	< 0.2	4.71	6	20	< 0.5	< 2	1.31	< 0.5	13	90	54	6.86	10	< 1	< 0.01	< 10	0.50	630
LINE 4S 250E	201 229	< 5	< 0.2	2.64	< 2	30	< 0.5	< 2	1.59	0.5	12	79	33	7.36	10	< 1	< 0.01	< 10	0.49	1015
LINE 4S 275E	201 229	< 5	< 0.2	2.53	6	10	< 0.5	< 2	1.45	0.5	11	77	38	6.56	10	< 1	< 0.01	< 10	0.55	320
LINE 4S 300E	201 229	< 5	< 0.2	4.10	< 2	40	< 0.5	< 2	1.59	1.0	15	80	37	5.85	10	< 1	< 0.01	< 10	0.55	760

CERTIFICATION:

*Hart Bisher*



# Chemex Labs Ltd.

Analytical Chemists \* Geochemists \* Registered Assayers  
 212 Brooksbank Ave., North Vancouver  
 British Columbia, Canada V7J 2C1  
 PHONE: 604-984-0221 FAX: 604-984-0218

To: DOIRON, ALBERT

BOX 759  
 UCLUELET, BC  
 V0R 3A0

Project:  
 Comments: ATTN: AL DOIRON

Page Number : 3-B  
 Total Pages : 3  
 Certificate Date: 07-JUN-96  
 Invoice No. : I9619445  
 P.O. Number :  
 Account : LOL

## CERTIFICATE OF ANALYSIS

### A9619445

SAMPLE	PREP CODE	Mo ppm	Na %	Ni ppm	P ppm	Pb ppm	Sb ppm	Sc ppm	Sr ppm	Ti %	Tl ppm	U ppm	V ppm	W ppm	Zn ppm
LINE 2N 350E	201 229	2	0.01	34	840	10	< 2	12	56	0.56	< 10	< 10	277	< 10	86
LINE 2N 375E	201 229	< 1	0.01	24	610	6	< 2	8	28	0.61	< 10	< 10	324	< 10	60
LINE 2N 400E	201 229	< 1	0.01	22	850	6	< 2	7	25	0.64	< 10	< 10	360	< 10	78
LINE 2N 425E	201 229	1	0.01	33	790	2	< 2	11	28	0.54	< 10	< 10	282	< 10	108
LINE 2N 450E	201 229	3	0.01	39	620	2	< 2	13	31	0.59	< 10	< 10	301	< 10	90
LINE 2N 475E	201 229	1	0.05	13	400	12	< 2	4	68	0.08	< 10	< 10	47	< 10	56
LINE 2N 500E	201 229	< 1	0.03	13	520	12	< 2	5	73	0.06	< 10	< 10	45	< 10	66
LINE 2S 000	201 229	< 1	0.03	14	530	10	< 2	5	77	0.07	< 10	< 10	46	< 10	64
LINE 2S 025E	201 229	< 1	0.04	13	540	12	< 2	5	80	0.10	< 10	< 10	48	< 10	64
LINE 2S 050E	201 229	< 1	0.05	13	610	10	< 2	6	81	0.09	< 10	< 10	48	< 10	68
LINE 2S 075E	201 229	1	0.04	57	940	12	< 2	5	106	0.02	< 10	< 10	38	< 10	260
LINE 2S 100E	201 229	< 1	0.09	13	440	10	< 2	4	75	0.10	< 10	< 10	48	< 10	66
LINE 2S 150E	201 229	1	0.07	21	580	12	< 2	5	88	0.08	< 10	< 10	52	< 10	94
LINE 2S 175E	201 229	1	0.06	12	380	12	< 2	3	65	0.09	< 10	< 10	48	< 10	52
LINE 2S 200E	201 229	< 1	0.04	13	500	12	< 2	5	74	0.09	< 10	< 10	48	< 10	64
LINE 2S 225E	201 229	< 1	0.03	13	660	10	< 2	5	73	0.09	< 10	< 10	47	< 10	70
LINE 2S 250E	201 229	1	0.04	12	580	10	< 2	5	76	0.09	< 10	< 10	46	< 10	68
LINE 2S 275E	201 229	< 1	0.04	17	480	10	< 2	6	86	0.10	< 10	< 10	50	< 10	82
LINE 2S 300E	201 229	< 1	0.14	17	670	12	< 2	6	87	0.11	< 10	< 10	56	< 10	88
LINE 3S 075E	201 229	1	0.04	20	630	14	< 2	5	81	0.09	< 10	< 10	51	< 10	88
LINE 3S 100E	201 229	2	0.01	30	960	10	< 2	7	96	0.04	< 10	< 10	56	< 10	122
LINE 3S 125E	201 229	1	0.04	14	610	10	< 2	5	90	0.09	< 10	< 10	51	< 10	70
LINE 3S 150E	201 229	< 1	0.04	12	560	10	< 2	5	78	0.10	< 10	< 10	48	< 10	64
LINE 3S 175E	201 229	1	0.03	21	640	12	< 2	6	92	0.09	< 10	< 10	54	< 10	94
LINE 3S 200E	201 229	1	0.12	19	530	12	2	6	98	0.11	< 10	< 10	55	< 10	92
LINE 3S 225E	201 229	< 1	0.09	17	640	12	< 2	5	85	0.10	< 10	< 10	51	< 10	86
LINE 3S 275E	201 229	1	0.03	20	720	12	< 2	5	95	0.08	< 10	< 10	50	< 10	94
LINE 3S 300E	201 229	1	0.03	23	620	14	2	6	94	0.06	< 10	< 10	50	< 10	102
LINE 4E 225E	201 229	1	0.02	19	680	12	6	5	92	0.06	< 10	< 10	47	< 10	96
LINE 4S 075E	201 229	< 1	0.03	24	590	12	6	6	93	0.07	< 10	< 10	52	< 10	108
LINE 4S 100E	201 229	1	0.03	24	640	14	2	7	95	0.05	< 10	< 10	51	< 10	108
LINE 4S 125E	201 229	< 1	< 0.01	13	330	2	< 2	5	29	0.29	< 10	< 10	168	< 10	54
LINE 4S 150E	201 229	1	< 0.01	26	440	2	< 2	7	24	0.64	< 10	< 10	362	< 10	70
LINE 4S 175E	201 229	1	< 0.01	27	1010	< 2	< 2	10	27	0.62	< 10	< 10	312	< 10	72
LINE 4S 200E	201 229	1	< 0.01	22	1040	< 2	< 2	9	20	0.59	< 10	< 10	306	< 10	78
LINE 4S 250E	201 229	2	< 0.01	21	1180	< 2	< 2	6	23	0.61	< 10	< 10	405	< 10	62
LINE 4S 275E	201 229	1	< 0.01	26	880	< 2	< 2	6	19	0.70	< 10	< 10	385	< 10	46
LINE 4S 300E	201 229	3	< 0.01	39	990	2	< 2	7	27	0.50	< 10	< 10	339	< 10	252

78

CERTIFICATION:

*Hart B. Schler*



# Chemex Labs Ltd.

Analytical Chemists \* Geochemists \* Registered Assayers

212 Brooksbank Ave., North Vancouver  
British Columbia, Canada V7J 2C1  
PHONE: 604-984-0221 FAX: 604-984-0218

To: DOIRON, ALBERT

BOX 759  
UCLUELET, BC  
V0R 3A0

Project :  
Comments: ATTN:AL DOIRON

Page Number : 1-A  
Total Pages : 1  
Certificate Date: 12-JUL-96  
Invoice No. : I9622808  
P.O. Number :  
Account : LOL

## CERTIFICATE OF ANALYSIS

### A9622808

SAMPLE	PREP CODE	Au g/t FA+AA	Ag ppm	Al %	As ppm	Ba ppm	Be ppm	Bi ppm	Ca %	Cd ppm	Co ppm	Cr ppm	Cu ppm	Fe %	Ga ppm	Hg ppm	K %	La ppm	Mg %	Mn ppm
LINE 2N 275E	205 226	0.010	< 0.2	0.16	2	< 10	< 0.5	< 2	>15.00	< 0.5	< 1	5	71	0.17	< 10	2	0.03	< 10	0.12	105
SMI 7/10K	205 226	0.015	< 0.2	1.51	6	80	< 0.5	< 2	1.42	< 0.5	23	21	116	4.77	< 10	1	0.08	< 10	1.10	190
SOUTHEAST 1/10K	205 226	0.010	< 0.2	2.45	44	< 10	< 0.5	< 2	1.22	< 0.5	20	27	35	6.88	< 10	< 1	0.04	< 10	2.16	975
D-LINE 1250	205 226	< 0.005	< 0.2	0.03	< 2	< 10	< 0.5	< 2	>15.00	< 0.5	< 1	< 1	< 1	0.07	< 10	< 1	< 0.01	< 10	0.07	85
D-LINE:1250LEACHED	205 226	< 0.005	< 0.2	0.14	< 2	< 10	< 0.5	< 2	>15.00	< 0.5	< 1	3	3	0.15	< 10	1	< 0.01	< 10	0.10	435

Handwritten calculations and notes:

$$\begin{array}{r} 25 \\ 11 \\ \hline 25 \\ 25 \\ \hline 25 \end{array}$$

$$\begin{array}{r} 21 \\ 25 \\ \hline 50 \\ 105 \\ \hline 155 \\ 275 \\ \hline 430 \end{array}$$

$$\begin{array}{r} 32 \\ 25 \\ \hline 160 \\ 740 \\ \hline 900 \\ 30 \end{array}$$

$$\begin{array}{r} 900 \\ 275 \\ \hline 1175 \\ 55-6 \\ 9-35 \end{array}$$

$$\begin{array}{r} 25 \\ 11 \\ \hline 25 \\ 25 \\ \hline 25 \end{array}$$

CERTIFICATION:

*Hart Buchler*



# Chemex Labs Ltd.

Analytical Chemists \* Geochemists \* Registered Assayers  
212 Brooksbank Ave., North Vancouver  
British Columbia, Canada V7J 2C1  
PHONE: 604-984-0221 FAX: 604-984-0218

To: DOIRON, ALBERT

BOX 759  
UCLUELET, BC  
V0R 3A0

Project:  
Comments: ATTN:AL DOIRON

Page Number :1-B  
Total Pages :1  
Certificate Date: 12-JUL-96  
Invoice No. :19622808  
P.O. Number :  
Account :LOL

## CERTIFICATE OF ANALYSIS

### A9622808

SAMPLE	PREP CODE	Mo ppm	Na %	Ni ppm	P ppm	Pb ppm	Sb ppm	Sc ppm	Sr ppm	Ti %	Tl ppm	U ppm	V ppm	W ppm	Zn ppm
LINE 2N 275E	205 226	< 1	< 0.01	< 1	660	4	4	< 1	670	< 0.01	< 10	< 10	4	< 10	16
SMI 7/10K	205 226	1	0.19	2	600	< 2	< 2	6	66	0.16	< 10	< 10	88	< 10	18
SOUTHMAIN 1/10K	205 226	< 1	0.03	1	580	8	2	14	17	0.30	< 10	< 10	190	< 10	44
D-LINE 1250	205 226	< 1	< 0.01	< 1	100	2	2	< 1	719	< 0.01	< 10	< 10	4	< 10	< 2
DLIN1250LEACHED	205 226	< 1	< 0.01	< 1	130	2	6	< 1	863	< 0.01	< 10	< 10	5	< 10	2

CERTIFICATION:

*Heinrich Bechler*





# Chemex Labs Ltd.

Analytical Chemists \* Geochemists \* Registered Assayers  
 212 Brooksbank Ave., North Vancouver  
 British Columbia, Canada V7J 2C1  
 PHONE: 604-984-0221 FAX: 604-984-0218

To: DOIRON, ALBERT

BOX 759  
 UCLUELET, BC  
 V0R 3A0

Project:  
 Comments: ATTN: ALBERT DOIRON

Page Number :1-A  
 Total Pages :1  
 Certificate Date: 13-MAY-96  
 Invoice No. :I9617615  
 P.O. Number :  
 Account :LOL

<b>CERTIFICATE OF ANALYSIS</b>	<b>A9617615</b>
--------------------------------	-----------------

SAMPLE	PREP CODE		Au	Ag	Al	As	Ba	Be	Bi	Ca	Cd	Co	Cr	Cu	Fe	Ga	Hg	K	La	Mg	Mn
	FA+AA		ppb	ppm	%	ppm	ppm	ppm	ppm	%	ppm	ppm	ppm	ppm	%	ppm	ppm	%	ppm	%	ppm
ROCK SAMPLE #1	205	226	< 5	< 0.2	1.86	2	60	< 0.5	< 2	1.35	< 0.5	6	71	29	3.31	< 10	< 1	0.13	< 10	0.36	150
ROCK SAMPLE #2	205	226	< 5	< 0.2	0.08	< 2	40	< 0.5	2	>15.00	3.5	< 1	18	9	0.15	< 10	< 1	0.01	< 10	0.33	145
S-MAIN PIT	205	226	15	< 0.2	6.43	6	10	< 0.5	< 2	5.12	3.5	19	80	40	5.54	10	< 1	< 0.01	< 10	0.95	475

CERTIFICATION:

*Hart Buchler*



# Chemex Labs Ltd.

Analytical Chemists \* Geochemists \* Registered Assayers  
212 Brooksbank Ave., North Vancouver  
British Columbia, Canada V7J 2C1  
PHONE: 604-984-0221 FAX: 604-984-0218

To: DOIRON, ALBERT

BOX 759  
UCLUELET, BC  
V0R 3A0

Project :

Comments: ATTN: ALBERT DOIRON

## CERTIFICATE OF ANALY

SAMPLE	PREP		Mo	Na	Ni	P	Pb	Sb	Sc	Sr	Ti	Tl	U	V	W
	CODE		ppm	%	ppm	ppm	ppm	ppm	ppm	ppm	%	ppm	ppm	ppm	ppm
ROCK SAMPLE #1	205	226	14	0.22	1	930	4	< 2	1	101	0.11	< 10	< 10	61	< 10
ROCK SAMPLE #2	205	226	8	0.01	11	140	< 2	< 2	< 1	955	< 0.01	< 10	< 10	117	< 10
S-MAIN PIT	205	226	< 1	< 0.01	38	580	2	< 2	13	21	0.42	< 10	< 10	210	< 10

CERTIFIC



# Chemex Labs Ltd.

Analytical Chemists \* Geochemists \* Registered Assayers

212 Brooksbank Ave., North Vancouver  
British Columbia, Canada V7J 2C1  
PHONE: 604-984-0221 FAX: 604-984-0218

To: DOIRON, ALBERT

BOX 759  
UCLUELET, BC  
V0R 3A0

Project :  
Comments: ATTN: AL DOIRON

Page Number : 1-B  
Total Pages : 1  
Certificate Date: 03-JUN-96  
Invoice No. : I9619444  
P.O. Number :  
Account : LOL

## CERTIFICATE OF ANALYSIS

### A9619444

SAMPLE	PREP CODE		Ni	P	Pb	Sb	Sc	Sr	Ti	Tl	U	V	W	Zn
			ppm	ppm	ppm	ppm	ppm	ppm	%	ppm	ppm	ppm	ppm	ppm
S-MAIN-#1	205	226	< 5	700	15	< 10	20	15	0.50	< 20	< 20	240	< 20	65

CERTIFICATION:

*H. J. Biebler*

TUE 4 '96 16:59



# Chemex Labs Ltd.

Analytical Chemists \* Geochemists \* Registered Assayers  
 212 Brooksbank Ave., North Vancouver  
 British Columbia, Canada V7J 2C1  
 PHONE: 604-984-0221 FAX: 604-984-0218

To: DOIRON, ALBERT

BOX 759  
 UCLUELET, BC  
 V0R 3A0

Project :  
 Comments: ATTN: AL DOIRON

Page Number 1-A  
 Total Pages 1  
 Certificate Date 03-JUN-96  
 Invoice No. I-9619444  
 P.O. Number :  
 Account :

## CERTIFICATE OF ANALYSIS A9619444

SAMPLE DESCRIPTION	PREP CODE	Au ppb FA+AA	Ag ppm	Al %	As ppm	Ba ppm	Be ppm	Bi ppm	Ca %	Cd ppm	Co ppm	Cr ppm	Cu ppm	Fe %	Hg ppm	K %	Mg %	Mn ppm	Mo ppm	Na %
S-MAIN-#1	205 226	< 5	< 1	3.20	60	< 20	< 5	< 10	1.08	< 5	25	30	40	9.22	< 10	0.06	2.86	1300	< 5	0.04

CERTIFICATION: \_\_\_\_\_

CHEMEX URX FAX

PRIN: 002

06/04/96 6:01PM CHEMEX LABS VAX-FAX

PAGE 002



# Chemex Labs Ltd.

Analytical Chemists \* Geochemists \* Registered Assayers  
 212 Brooksbank Ave., North Vancouver  
 British Columbia, Canada V7J 2G1  
 PHONE: 604-984-0221 FAX: 604-984-0218

To: DOIRON, ALBERT

BOX 759  
 UCLUELET, BC  
 V0R 3A0

Project :  
 Comments: Attn: Albert Doiron

Page Number 1-A  
 Total Pages 1  
 Certificate Date 08-JUN-96  
 Invoice No. I-9620155  
 P.O. Number :  
 Account :

## CERTIFICATE OF ANALYSIS A9620155

SAMPLE DESCRIPTION	PREP CODE	Au ppb RUSH	Ag ppm	Al %	As ppm	Ba ppm	Be ppm	Bi ppm	Ca %	Cd ppm	Co ppm	Cr ppm	Cu ppm	Fe %	Ga ppm	Hg ppm	K %	La ppm	Mg %	Mn ppm
S.M. 1/10K	255 295	< 5	0.6	3.17	12	180	< 0.5	2	2.75	1.5	12	29	84	4.34	10	< 1	0.10	4.10	1.64	845

PRELIMINARY DATA ONLY

CERTIFICATION: \_\_\_\_\_

JUN 10 '96 07:02



# Chemex Labs Ltd.

Analytical Chemists \* Geochemists \* Registered Assayers  
 212 Brooksbank Ave., North Vancouver  
 British Columbia, Canada V7J 2C1  
 PHONE: 604-984-0221 FAX: 604-984-0218

To: DOIRON, ALBERT

BOX 759  
 UCLUELET, BC  
 V0R 3A0

Project :  
 Comments: Attn: Albert Dolron

Page Number 1-B  
 Total Pages 1  
 Certificate Date 08-JUN-96  
 Invoice No. I-9620155  
 P.O. Number :  
 Account :

## CERTIFICATE OF ANALYSIS

A9620155

SAMPLE DESCRIPTION	PREP CODE	Mo ppm	Na %	Ni ppm	P ppm	Pb ppm	Sb ppm	Sc ppm	Sr ppm	Tl %	Tl ppm	U ppm	V ppm	W ppm	Zn ppm
S.M. 1/10K	255 295	3	0.15	3	890	30	< 2	12	259	0.11	< 10	< 10	106	< 10	104

PRELIMINARY DATA ONLY

CERTIFICATION: \_\_\_\_\_

CHEMEX VAX FAX1

PAGE.003

06/10/96 8:04AM CHEMEX LABS VAX-FAX2

PAGE 003



# Chemex Labs Ltd.

Analytical Chemists \* Geochemists \* Registered Assayers

212 Brooksbank Ave., North Vancouver  
British Columbia, Canada V7J 2C1  
PHONE: 604-984-0221 FAX: 604-984-0218

To: DOIRON, ALBERT

BOX 759  
UCLUELET, BC  
V0R 3A0

Project :  
Comments: ATTN: AL DOIRON

Page Number : 1-A  
Total Pages : 1  
Certificate Date: 02-JUN-96  
Invoice No. : I9619443  
P.O. Number :  
Account : LOL

## CERTIFICATE OF ANALYSIS A9619443

SAMPLE	PREP CODE	Au ppb FA+AA	Ag ppm	Al %	As ppm	Ba ppm	Be ppm	Bi ppm	Ca %	Cd ppm	Co ppm	Cr ppm	Cu ppm	Fe %	Ga ppm	Hg ppm	K %	La ppm	Mg %	Mn ppm
SOUTH MAIN 1/10R	201 202	65	1.0	4.97	52	30	0.5	< 2	0.09	2.5	35	37	57	14.65	< 10	1	0.04	< 10	0.33	2750
SOUTH MAIN 268	201 202	< 5	< 0.2	5.96	4	20	0.5	< 2	0.81	0.5	12	88	72	6.76	10	< 1	< 0.01	< 10	0.52	255
SOUTH MAIN 1726	201 202	10	0.2	6.21	4	20	0.5	< 2	1.23	0.5	17	121	94	8.44	10	< 1	< 0.01	< 10	0.64	295

CERTIFICATION:

*Hart Buchler*



# Chemex Labs Ltd.

Analytical Chemists \* Geochemists \* Registered Assayers  
212 Brooksbank Ave., North Vancouver  
British Columbia, Canada V7J 2C1  
PHONE: 604-984-0221 FAX: 604-984-0218

To: DOIRON, ALBERT

BOX 759  
UCLUELET, BC  
V0R 3A0

Project :  
Comments: ATTN: AL DOIRON

Page Number :1-B  
Total Pages :1  
Certificate Date: 02-JUN-96  
Invoice No. :19619443  
P.O. Number :  
Account :LOL

## CERTIFICATE OF ANALYSIS

A9619443

SAMPLE	PREP		Mo	Na	Ni	P	Pb	Sb	Sc	Sr	Ti	Tl	U	V	W	Zn
	CODE		ppm	%	ppm	ppm	ppm	ppm	ppm	ppm	%	ppm	ppm	ppm	ppm	ppm
SOUTH MAIN 1/10K	201	202	5	< 0.01	6	1530	38	6	18	8	0.20	< 10	< 10	131	< 10	142
SOUTH MAIN 268	201	202	< 1	< 0.01	23	750	6	2	12	14	0.52	< 10	< 10	239	< 10	54
SOUTH MAIN 1726	201	202	< 1	< 0.01	37	450	4	2	19	24	0.45	< 10	< 10	284	< 10	64

CERTIFICATION:

*Hart Becher*



JUN 4 '96 17:00



# Chemex Labs Ltd.

Analytical Chemists \* Geochemists \* Registered Assayers  
 212 Brooksbank Ave., North Vancouver  
 British Columbia, Canada V7J 2C1  
 PHONE: 604-984-0221 FAX: 604-984-0218

To: DOIRON, ALBERT

BOX 750  
 UCLUELET, BC  
 V0R 3A0

Project :  
 Comments: ATTN: AL DOIRON

Page Number 1-B  
 Total Pages 1  
 Certificate Date 03-JUN-96  
 Invoice No. I-9619444  
 P.O. Number :  
 Account :

## CERTIFICATE OF ANALYSIS

A9619444

SAMPLE DESCRIPTION	PREP CODE	Ni	P	Pb	Sb	Sc	Sr	Ti	Tl	U	V	W	Zn
		ppm	ppm	ppm	ppm	ppm	ppm	ppm	ppm	ppm	ppm	ppm	ppm
S-MAIN-#1	205 226	< 5	700	15	< 10	20	15	0.50	< 20	< 20	240	< 20	65

CERTIFICATION: \_\_\_\_\_

CHEMEX VAX FAX

PAGE.003

00/04/90 0:04:11 CHEMEX LABS VAX-TRM 1 NOV 96



# Chemex Labs Ltd.

Analytical Chemists \* Geochemists \* Registered Assayers  
212 Brooksbank Ave., North Vancouver  
British Columbia, Canada V7J 2C1  
PHONE: 604-984-0221 FAX: 604-984-0218

To: DOIRON, ALBERT

BOX 759  
UCLUELET, BC  
V0R 3A0

Project :  
Comments: ATTN: AL DOIRON

Page Number : 1-A  
Total Pages : 1  
Certificate Date: 03-JUN-96  
Invoice No. : I9619444  
P.O. Number :  
Account : LOL

## CERTIFICATE OF ANALYSIS

A9619444

SAMPLE	PREP CODE		Au ppb	Ag	Al	As	Ba	Be	Bi	Ca	Cd	Co	Cr	Cu	Fe	Hg	K	Mg	Mn	Mo	Na
			FA+AA	ppm	%	ppm	ppm	ppm	ppm	%	ppm	ppm	ppm	ppm	%	ppm	%	%	ppm	ppm	%
S-MAIN-#1	205	226	< 5	< 1	3.20	60	< 20	< 5	< 10	1.08	< 5	25	30	40	9.22	< 10	0.06	2.86	1300	< 5	0.04

CERTIFICATION:

*Hart Bichler*

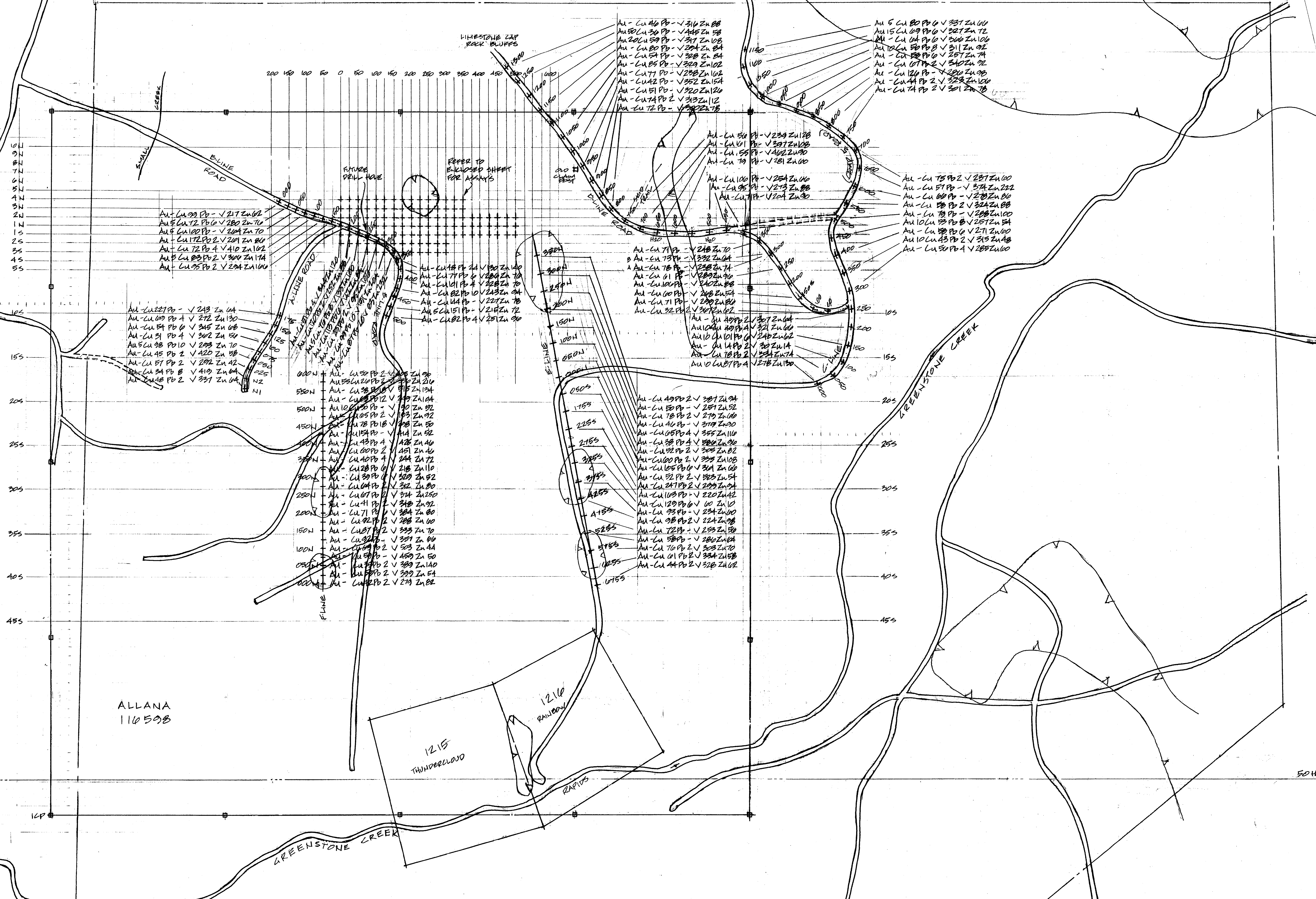

ALLANA  
11059B

1215  
THUNDERCLOUD

1210  
RAILROAD

BECHER  
LAKE

- LEGEND
- ▣ CLAIM BOUNDARY
  - ROAD/TRAIL
  - DRILL HOLE LOCATION
  - GRID LINES
  - ⊕ OLD MAGNETOMETER READINGS
  - CREEK
- Au - GOLD (PPM) Cu - COPPER (PPM)  
Pb - LEAD (PPM) V - VANADIUM (PPM)  
Zn - ZINC (PPM)

24571

THE ALLANA GROUP	
NTS:	3213E 3214E
SOIL SAMPLING MAP DRILL HOLE LOCATION MAP (FUTURE) GOLD/VANADIUM ASSAY PLOT	
DATE:	SEPT 09 / JAN 07
DRAWN:	RME
<p>0 50 100 200 300 400 METERS (1:5000)</p>	



	0	25E	50E	75E	100E	125E	150E	175E	200E	225E	250E	275E	300E	325E	350E	375E	400E	425E	450E	475E	500E	
4N	Au - Cu 49 Pb 8 V 334 Zn 24	Au - Cu 26 Pb 12 V 334 Zn 46	Au - Cu 56 Pb 6 V 272 Zn 86	Au - Cu 23 Pb 10 V 417 Zn 58	Au - Cu 31 Pb 10 V 435 Zn 74	Au - Cu 41 Pb 12 V 330 Zn 92	Au - Cu 30 Pb 12 V 438 Zn 92	Au - Cu 38 Pb 14 V 224 Zn 140	Au 5 Cu 67 Pb 2 V 218 Zn 52	Au - Cu 50 Pb 10 V 218 Zn 76	Au - Cu 41 Pb 6 V 257 Zn 100	Au - Cu 69 Pb 8 V 279 Zn 76	Au - Cu 75 Pb - V 264 Zn 98	Au - Cu 39 Pb 4 V 297 Zn 84	Au - Cu 61 Pb 2 V 307 Zn 94							
3N	Au - Cu 43 Pb 4 V 372 Zn 76	Au - Cu 45 Pb 8 V 392 Zn 72	Au - Cu 48 Pb 14 V 340 Zn 74	Au - Cu 103 Pb 2 V 280 Zn 72	Au - Cu 98 Pb 2 V 278 Zn 66	Au - Cu 30 Pb 8 V 458 Zn 60			Au - Cu 70 Pb 8 V 282 Zn 82	Au - Cu 26 Pb 10 V 229 Zn 80	Au - Cu 69 Pb 6 V 218 Zn 72	Au - Cu 57 Pb 14 V 189 Zn 84	Au - Cu 124 Pb 10 V 221 Zn 60	Au - Cu 73 Pb 6 V 286 Zn 64	Au - Cu 70 Pb 4 V 320 Zn 80							
2N	Au - Cu 91 Pb 6 V 368 Zn 140	Au - Cu 38 Pb 8 V 414 Zn 68	Au - Cu 62 Pb 2 V 234 Zn 52	Au - Cu 62 Pb 8 V 264 Zn 68	Au - Cu 40 Pb 4 V 304 Zn 48	Au - Cu 50 Pb 8 V 252 Zn 74	Au - Cu 32 Pb 6 V 376 Zn 76	Au - Cu 27 Pb 18 V 383 Zn 50	Au - Cu 49 Pb 8 V 313 Zn 74	Au - Cu 59 Pb 6 V 325 Zn 62	Au - Cu 59 Pb 4 V 263 Zn 54	Au - Cu 54 Pb 4 V 256 Zn 92	Au - Cu 69 Pb 2 V 334 Zn 100	Au - Cu 48 Pb 4 V 318 Zn 66	Au - Cu 83 Pb 10 V 277 Zn 86	Au - Cu 47 Pb 6 V 324 Zn 60	Au - Cu 48 Pb 6 V 340 Zn 78	Au - Cu 88 Pb 2 V 282 Zn 108	Au - Cu 102 Pb 2 V 301 Zn 90	Au - Cu 25 Pb 12 V 47 Zn 56	Au - Cu 29 Pb 12 V 45 Zn 66	
1N	Au 10 Cu 39 Pb - V 357 Zn 110	Au 20 Cu 39 Pb - V 331 Zn 108	Au 20 Cu 56 Pb 2 V 234 Zn 80	Au - Cu 45 Pb - V 282 Zn 106	Au - Cu 73 Pb - V 306 Zn 150	Au - Cu 80 Pb - V 323 Zn 122	Au - Cu 33 Pb 18 V 260 Zn 50	Au - Cu 66 Pb 2 V 288 Zn 90	Au - Cu 52 Pb - V 280 Zn 110	Au 20 Cu 65 Pb 8 V 57 Zn 330	Au 10 Cu 43 Pb - V 489 Zn 48	Au - Cu 50 Pb - V 323 Zn 68	Au - Cu 58 Pb 4 V 260 Zn 48	Au - Cu 59 Pb 2 V 247 Zn 92	Au - Cu 46 Pb 8 V 307 Zn 108	Au - Cu 34 Pb 8 V 408 Zn 68	Au - Cu 128 Pb 2 V 282 Zn 68	Au - Cu 80 Pb - V 247 Zn 84	Au - Cu 72 Pb 8 V 290 Zn 82	Au - Cu 45 Pb 2 V 31 Zn 60	Au - Cu 67 Pb 2 V 248 Zn 64	
1S	Au - Cu 35 Pb 6 V 254 Zn 118	Au - Cu 51 Pb 2 V 320 Zn 60	Au - Cu 67 Pb 2 V 256 Zn 80	Au 45 Cu 104 Pb 12 V 170 Zn 104		Au 15 Cu 136 Pb 4 V 261 Zn 380	Au - Cu 55 Pb 6 V 288 Zn 88	Au - Cu 37 Pb 6 V 391 Zn 82	Au 20 Cu 58 Pb 2 V 311 Zn 94	Au - Cu 44 Pb 4 V 319 Zn 76	Au - Cu 80 Pb 2 V 274 Zn 88	Au - Cu 44 Pb 4 V 385 Zn 64	Au - Cu 102 Pb 2 V 256 Zn 70	Au - Cu 38 Pb 6 V 325 Zn 108	Au - Cu 99 Pb 2 V 250 Zn 96							
2S	Au - Cu 28 Pb 10 V 46 Zn 64	Au - Cu 25 Pb 12 V 48 Zn 64	Au - Cu 26 Pb 14 V 48 Zn 68	Au - Cu 38 Pb 12 V 38 Zn 260	Au 15 Cu 25 Pb 10 V 48 Zn 66		Au 5 Cu 46 Pb 12 V 52 Zn 94	Au - Cu 27 Pb 12 V 48 Zn 52	Au - Cu 27 Pb 12 V 48 Zn 64	Au - Cu 28 Pb 10 V 47 Zn 70	Au - Cu 26 Pb 10 V 46 Zn 68	Au - Cu 34 Pb 10 V 50 Zn 82	Au - Cu 34 Pb 12 V 56 Zn 88									
3S				Au - Cu 41 Pb 14 V 51 Zn 88	Au - Cu 60 Pb 10 V 56 Zn 122	Au - Cu 32 Pb 10 V 51 Zn 70	Au - Cu 27 Pb 10 V 48 Zn 64	Au - Cu 47 Pb 12 V 54 Zn 94	Au - Cu 40 Pb 12 V 55 Zn 92	Au - Cu 34 Pb 12 V 51 Zn 86		Au - Cu 49 Pb 12 V 50 Zn 94	Au - Cu 52 Pb 14 V 50 Zn 102									
4S				Au - Cu 61 Pb 12 V 52 Zn 108	Au - Cu 44 Pb 14 V 51 Zn 108	Au - Cu 23 Pb 2 V 168 Zn 54	Au - Cu 42 Pb 2 V 362 Zn 70	Au - Cu 66 Pb - V 312 Zn 72	Au - Cu 54 Pb - V 306 Zn 78	Au - Cu 43 Pb 12 V 47 Zn 96	Au - Cu 33 Pb - V 405 Zn 62	Au - Cu 38 Pb - V 385 Zn 46	Au - Cu 37 Pb 2 V 339 Zn 252									

AU-PPB-CU-PB-V-ZN-PPM

GRID ASSAY RESULTS