

TECHNICAL ASSESSMENT REPORT

FOR

FORERUNNER RESOURCES INC.

ON THE

MINERAL CLAIMS

DAM 1 AND DAM 2

TENURE NUMBERS 326450 AND 326451

LOCATED NEAR LIKELY, B. C.

N T S 093 A 11W

52 DEGREES 35' NORTH, 121 DEGREES 27' WEST

BY TERRY GARROW, P. GEO.

FILMED

SEPTEMBER 17, 1996

GEOLOGICAL SURVEY BRANCH
ASSESSMENT REPORT

24,582

GEOLOGICAL SURVEY BRANCH ASSESSMENT REPORTS
DATE RECEIVED OCT 10 1996

CONTENTS

	PAGE
1.0 INTRODUCTION	
1.1 PROPERTY LOCATION	1
1.2 ACCESS	1
1.3 HISTORY AND ECONOMIC ASSESSMENT	2
2.0 OBJECTIVE AND SCOPE OF THIS TECHNICAL STUDY	2
3.0 SEISMIC REFRACTION SURVEY METHOD	
3.1 EQUIPMENT UTILIZED	3
3.2 SURVEY PROCEDURES	3
4.0 SEISMIC REFRACTION ANALYSIS	
4.1 INTERPRETATION	4
4.2 INTERPRETIVE METHOD	5
4.3 LIMITATIONS	
5.0 GEOPHYSICAL RESULTS RELATIVE TO GEOLOGY	6
6.0 CONCLUSIONS	7
7.0 RECOMMENDATIONS	7
8.0 QUALIFICATIONS	8
9.0 STATEMENT OF COSTS	9

ILLUSTRATIONS

FIGURE		PAGE
1	INDEX MAP - PROVINCIAL LOCATION 1:8,000,000	1A
2	DISTRICT LOCATION MAP 1:50,000	1B
3	PLACER CLAIM MAP 1:31,680	1C
4	DETAILED SITE PLAN 1:1,000 - DAM 1 CLAIM - LINE A	2A
	- DAM 2 CLAIM - LINE B	2B
5	SEISMIC REFRACTION SECTION - DAM 1 CLAIM - LINE A	4A
	- DAM 2 CLAIM - LINE B	4B

1.0 INTRODUCTION

1.1 PROPERTY LOCATION

THE DAM 1 AND DAM 2 PLACER PROJECT AND PLACER CLAIMS 326450 AND 326451 ARE LOCATED ON THE NORTH SIDE OF SPANISH MOUNTAIN, 0.5 KILOMETERS WEST OF SPANISH LAKE AND ON BOTH SIDES OF SPANISH CREEK. THESE CLAIMS ARE APPROXIMATELY 7 KILOMETERS EAST OF LIKELY, B. C. ON THE 1300 LOGGING ROAD. LIKELY IS A SMALL TOWN 70 KILOMETERS NORTH EAST OF WILLIAMS LAKE, WHICH IS APPROXIMATELY 700 KILOMETERS NORTH OF VANCOUVER.

GEOGRAPHICALLY, THE PROPERTY IS LOCATED ON THE SPANISH LAKE MAP SHEET, 93 A /11, SCALE 1:50,000, IN THE CARIBOO LAND DISTRICT. THE LATITUDE AND LONGITUDE COORDINATES ARE 52 DEGREES 35 MINUTES NORTH AND 121 DEGREES 27 MINUTES WEST. THE AVERAGE PROPERTY ELEVATION IS 945 METERS ABOVE SEA LEVEL.

1.2 ACCESS

ACCESS TO THIS PROPERTY IS BY PAVED ROAD TO LIKELY FROM WILLIAMS LAKE, THEN ALL WEATHER GRAVEL LOGGING ROAD TO THE EDGE OF THE SITE AND 4 X 4 DIRT ROADS AROUND THE SITE. A 400 METER LONG GRAVEL AIRSTRIP, MAINTAINED BY THE MINISTRY OF TRANSPORT IS LOCATED 3 KILOMETERS WEST OF THE PROPERTY.

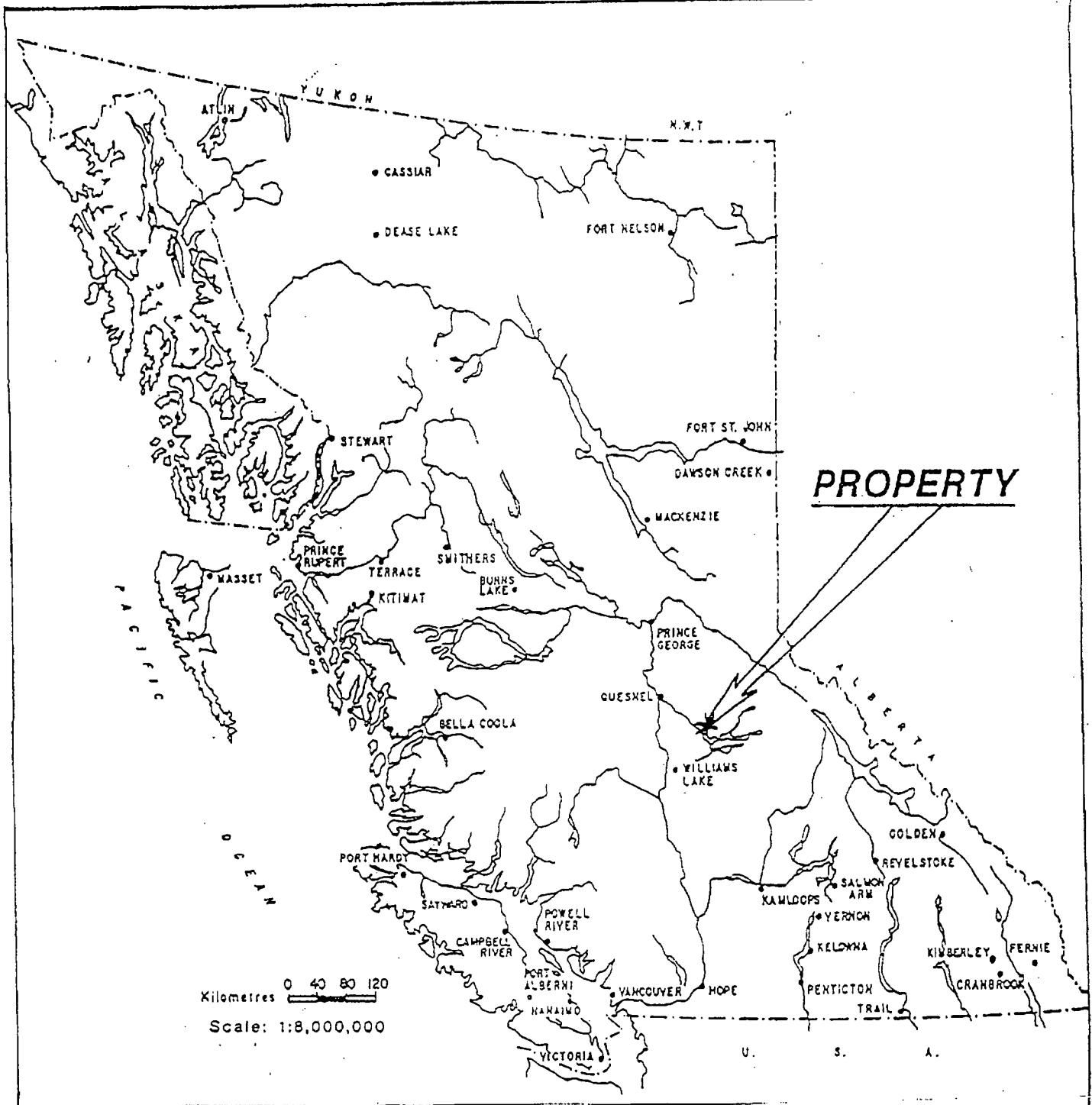

FORERUNNER RESOURCES INC

DAM 1 AND DAM 2 PLACER PROJECT

INDEX MAP PROVINCIAL LOCATION

T. D. G. SEPTEMBER 96 FIGURE 1

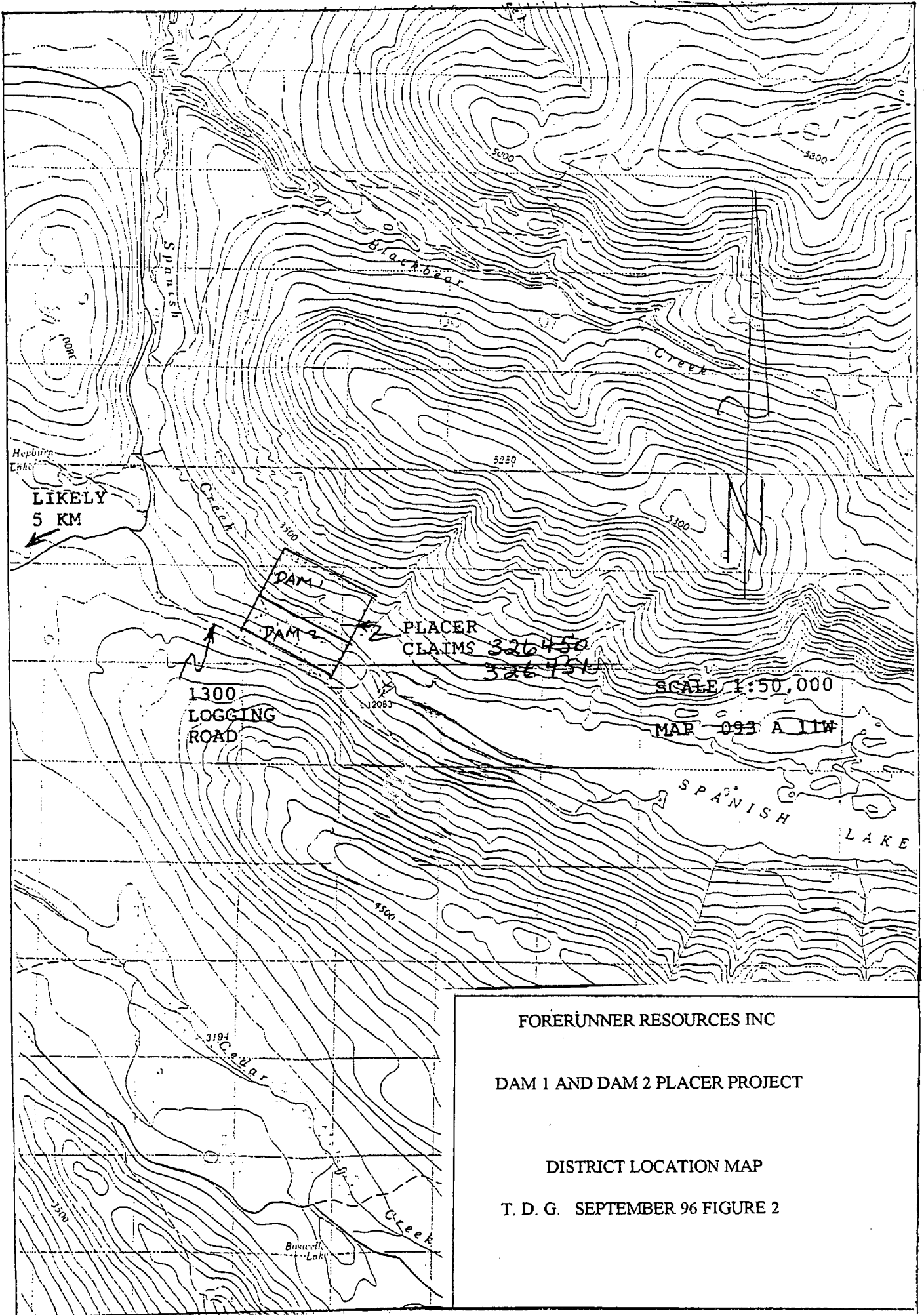

FORERUNNER RESOURCES INC

DAM 1 AND DAM 2 PLACER PROJECT

DISTRICT LOCATION MAP

T. D. G. SEPTEMBER 96 FIGURE 2

RELEASE REQUIRED

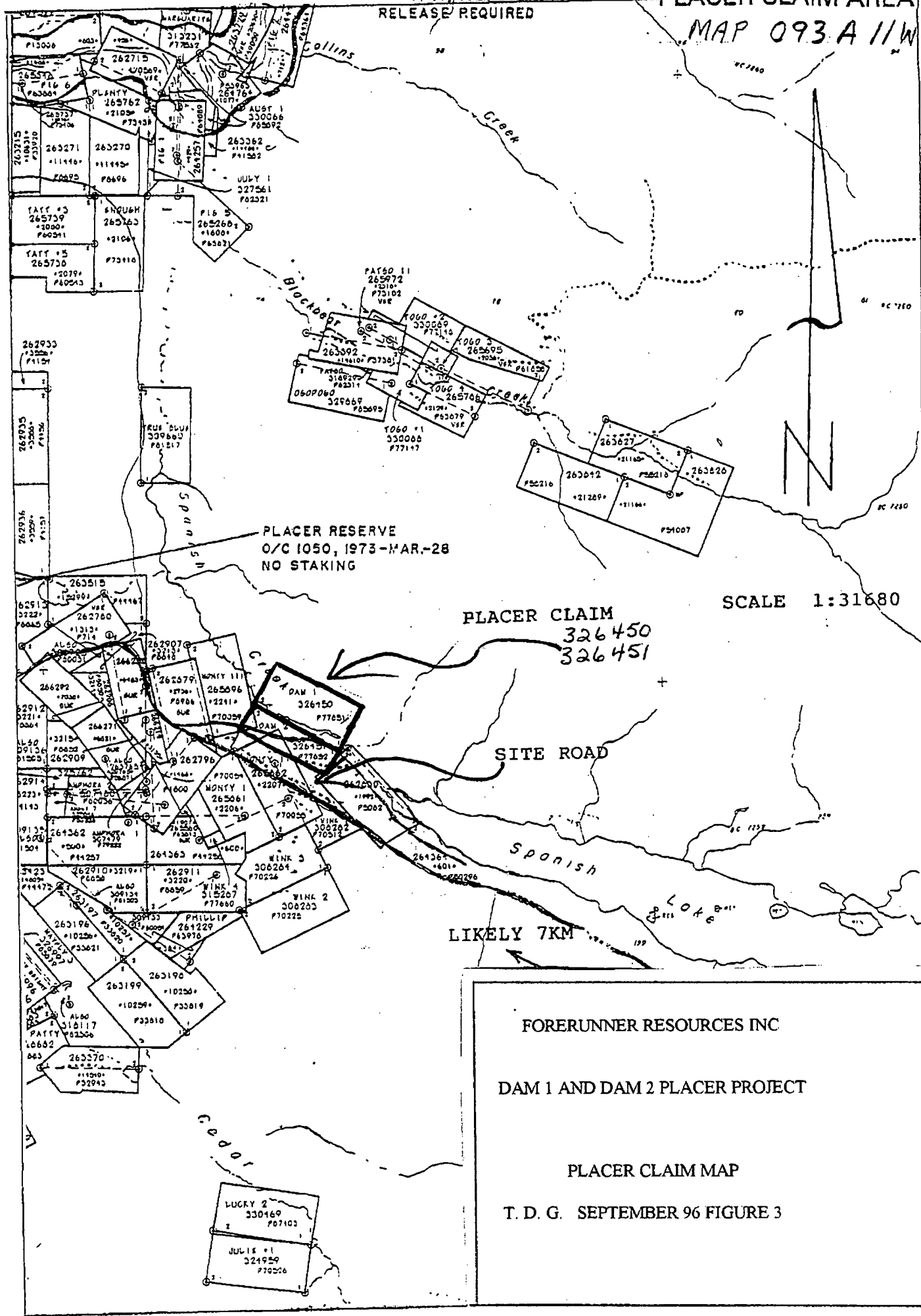

PLACER RESERVE
O/C 1050, 1973-MAR.-28
NO STAKING

PLACER CLAIM
326 450
326 451

SCALE 1:31680

SITE ROAD

Spanish

LIKELY 7KM

FORERUNNER RESOURCES INC

DAM 1 AND DAM 2 PLACER PROJECT

PLACER CLAIM MAP

T. D. G. SEPTEMBER 96 FIGURE 3

LUCKY 2
330169
P07103

JULIE #1
324929
P70226

1.3 HISTORY AND ECONOMIC ASSESSMENT

PLACER CLAIMS 326450 AND 326451 HAVE HAD NO RECORDED HISTORY OF SUCCESSFUL PLACER GOLD MINING; HOWEVER, THERE ARE A FEW SMALL BULK TESTING PITS LOCATED ON THE WEST END OF THE PROPERTY. THE SPANISH MOUNTAIN AREA HAS BEEN A FOCAL POINT OF GOLD PRODUCTION AND PROSPECTING FOR MANY YEARS AND THESE CLAIMS ON THE NORTH SIDE OF THE MOUNTAIN APPEARS TO HAVE SUITABLE GEOLOGY AND SHALLOW BENCH GRAVELS TO CONTAIN SMALL HIGH GRADE ALLUVIAL GOLD DEPOSITS IN AREAS NOT SCOURED TO BEDROCK BY THE PLEISTOCENE GLACIERS.

2.0 OBJECTIVE AND SCOPE OF THIS TECHNICAL STUDY

PAST ECONOMIC EVALUATIONS BY THE AUTHOR ON SEVERAL LARGE PLACER GOLD PRODUCERS IN THE IMMEDIATE AREA HAVE SHOWN THAT THE MOST SIGNIFICANT HIGHER GRADE PLACER CHANNELS ARE CONTROLLED IN DIRECTION AND DEPTH BY FLUVIAL EROSION ALONG FAULTS AND SHEAR ZONES IN THE BEDROCK. A BRIEF RECONNAISSANCE GEOLOGICAL TRAVERSE ACROSS THE BEDROCK EXPOSED ON THE DAM 1 AND DAM 2 CLAIMS INDICATES APPROPRIATE FAULTING AND SHEARING DIRECTIONS TRANSVERSE TO LOCAL GLACIAL SCOURING. SECONDLY, THERE ARE ABUNDANT BOULDERS SCATTERED IN THE OLD PLACER WORKINGS WITH QUARTZ VEINS CONTAINING SULPHIDES AND VERY FINE PLACER GOLD CAN BE PANNED ALONG SEVERAL OF THE SMALL CREEKS WHERE THESE SEISMIC SURVEYS ARE BEING DONE.

THIS TECHNICAL REPORT OUTLINES A VERY PRELIMINARY STUDY OF BEDROCK FAULT ZONES WITH CORRESPONDING BEDROCK RIVER CHANNELS FILLED WITH POTENTIAL GOLD BEARING GRAVELS. THE TWO SEISMIC LINES WERE LOCATED TO INVESTIGATE FIRSTLY A LOW GRAVEL BENCH PARALLEL TO SPANISH CREEK AND SECONDLY A HIGHER GRAVEL BENCH PARALLEL AND DUE SOUTH OF THE FIRST LINE. THE FIRST LINE IS ON DAM 1 CLAIM, WHILE THE SECOND LINE IS ON DAM 2 CLAIM. IF THESE TWO SEISMIC LINES LOCATE BEDROCK CHANNELS CONTAINING POTENTIAL GOLD BEARING GRAVELS, THEN ADDITIONAL SEISMIC LINES WILL BE PLANNED, FOLLOWED BY EXCAVATOR TEST PITTING TO TEST THE GRADE OF GOLD IN THE GRAVELS.

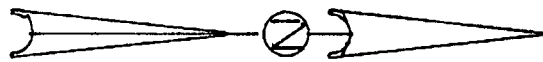

SCALE 1:1000

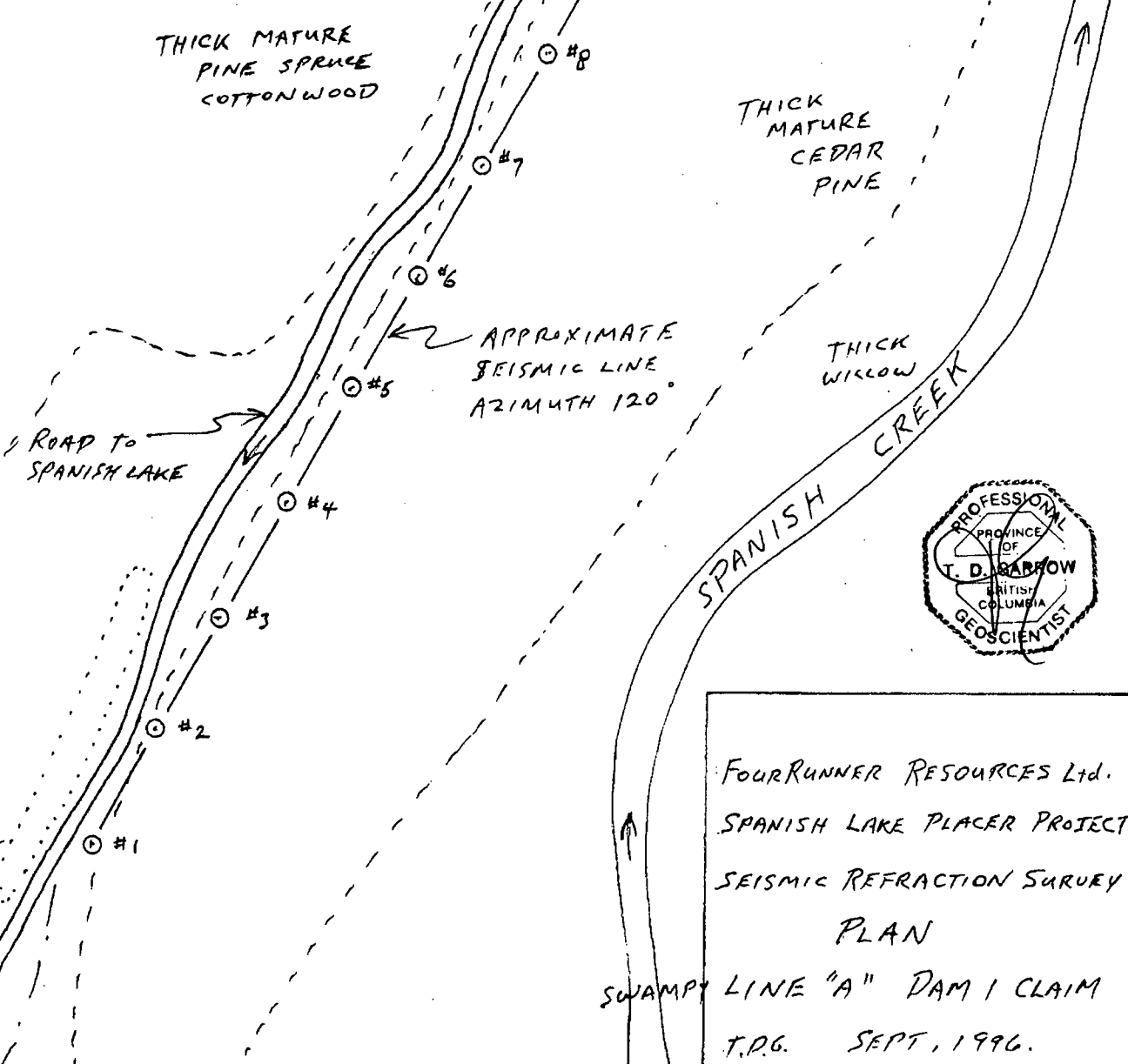
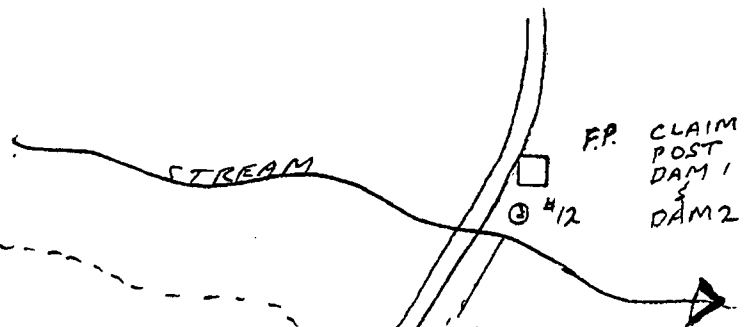
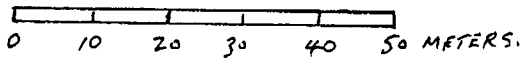

FourRunner Resources Ltd.
SPANISH LAKE PLACER PROJECT
SEISMIC REFRACTION SURVEY
PLAN
SWAMPY LINE "A" DAM 1 CLAIM
T.P.G. SEPT. 1996.

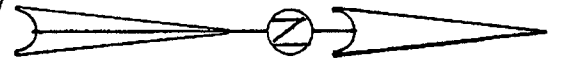

SCALE 1:1000

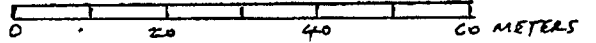

TREES

MATURE
CEDAR
COTTONWOOD
PINE

#1

#2

#3

#4

#5

#6

#7

#8

#9

#10

#11

#12

GEOPHONES

SEISMIC BASELINE
AZIM 100°-105°

CREEK

TREES

MATURE
PINE
COTTONWOOD

OLD
PLACER
PITS

ROAD TO
SPANISH
LAKE

CREEK

TO I.P. FOR
DAM 1 & 2
325 METERS
@ AZIM 090



FORERUNNER RESOURCES LTD.
SPANISH LAKE PLACER PROJECT
SEISMIC REFRACTION SURVEY
PLAN
LINE "B", DAM 2 CLAIM
T.D.G. SEPT, 1996.

3.0 SEISMIC REFRACTION SURVEY METHOD

3.1 SEISMIC EQUIPMENT UTILIZED

THIS GEOPHYSICAL SURVEY WAS COMPLETED ON PLACER CLAIM 326450 AND 326451 UTILIZING A GEOMETRICS NIMBUS ES-1210 MULTICHANNEL SIGNAL ENHANCEMENT SEISMOGRAPH. A 240 METER MULTICORD CABLE WITH 12 GEOPHONE TAKEOUTS SPACED AT 20 METERS EACH, WAS USED FOR SEISMIC LINE COVERAGE. A 5 KILO SLEDGE HAMMER EQUIPPED WITH AN ELECTRONIC HAMMER SWITCH CONNECTED BY CABLE TO THE SEISMOGRAPH, WAS POUNDED UPON A STEEL STRIKER PLATE TO INITIATE THE ACOUSTIC ENERGY SIGNAL THAT WAS SENSED BY EACH GEOPHONE AND RECORDED BY THE SEISMOGRAPH.

3.2 SURVEY PROCEDURES

FOR THIS SURVEY, THE 250 METER MULTICORD CABLE WAS STRETCHED OUT IN A STRAIT LINE WITH AN AZIMUTH OF 120 DEGREES ON LINE A AND AN AZIMUTH OF 100 TO 105 DEGREES ON LINE B, THAT APPROXIMATELY FOLLOWED ACCESS ROADS ON EACH CLAIM. THE 12 PIN TYPE GEOPHONES WERE IMPLANTED IN SOLID SUBSOIL AT 20 METER INTERVALS AND CONNECTED TO THE MULTICORD CABLE. THE STRIKER PLATE WAS PLACED SECURELY ON SOLID SOIL BELOW ANY LOOSE DETRITUS AND WAS STRUCK WITH THE SLEDGE HAMMER AT FOUR EQUALLY SPACED LOCATIONS BETWEEN EACH GEOPHONE AND THE RESULTANT FIRST ARRIVAL OF ENERGY AT EACH GEOPHONE WAS RECORDED. A TIME DISTANCE GRAPH WAS DRAWN IN THE FIELD, USING THE FIRST ENERGY ARRIVAL DATA FOR EACH GEOPHONE. LATER IN THE OFFICE, THE VELOCITIES OF THE ENERGY PROPAGATED IN EACH LAYER AND THE DEPTH OF EACH LAYER TO BEDROCK WERE CALCULATED FROM THE TIME DISTANCE GRAPH. A CLINOMETER SURVEY RECORDED THE CHANGE OF SURFACE ELEVATION FOR EACH GEOPHONE.

4.0 SEISMIC REFRACTION ANALYSIS

4.1 INTERPRETATION

THIS SEISMIC REFRACTION SURVEY COMPLETED ON PLACER CLAIM 326450 AND 326451 IS THE FIRST SURVEY OF ITS TYPE TO BE DONE ON THIS PROPERTY. THIS TYPE OF EQUIPMENT HAS BEEN VERY SUCCESSFUL IN OUTLINING RIVER LIKE DEPRESSIONS ERODED INTO THE BEDROCK OF THESE CLAIMS. THESE DEPRESSIONS CONTAIN DENSELY PACKED SANDY GRAVELS WHICH EXPERIENCE HAS SHOWN ARE THE HOST FOR PLACER GOLD OF ECONOMIC VALUE IN THIS AREA.

INTERPRETATION OF THE VERTICAL SEISMIC SECTION INDICATES THAT TWO DISTINCT UNCONSOLIDATED SEDIMENT LAYERS HAVE BEEN DEPOSITED OVER A STRONGLY ERODED AND UNEVEN BEDROCK. THE TOP LAYER (FROM 0.0 TO 6.23 METERS THICK) CONSISTS OF A WEATHERED SANDY TOPSOIL WITH ROOTS AND ORGANIC DEBRIS WITH AN AVERAGE VELOCITY OF 630 - 650 MPS. THE SECOND LAYER REACHING DEPTHS FROM 4.8 TO 11.0 METERS) CONSISTS OF SATURATED OR UNSATURATED DENSELY PACKED SANDY GRAVELS WITH BOULDERS RESTING DIRECTLY ON BEDROCK. THIS SANDY GRAVEL HAS AN AVERAGE VELOCITY OF 1070 - 1090 MPS WITH A LOW READING OF 620 MPS AND A HIGH READING OF 1530 MPS. THE BEDROCK VELOCITIES ARE TYPICAL FOR FRACTURED ARGILLITES AND ANDESITES IN THE LIKELY AREA, WITH AVERAGE VELOCITIES OF 3380 - 3390 MPS., HIGH READINGS OF 5080 MPS. AND LOW READINGS OF 2050 MPS (METERS PER SECOND).

IT IS INTERESTING TO NOTE THAT NO OBVIOUS LAYERS OF GLACIAL BOULDER CLAY WERE OUTLINED ON THIS SECTION WHICH REDUCES PROJECTED MINING COSTS.

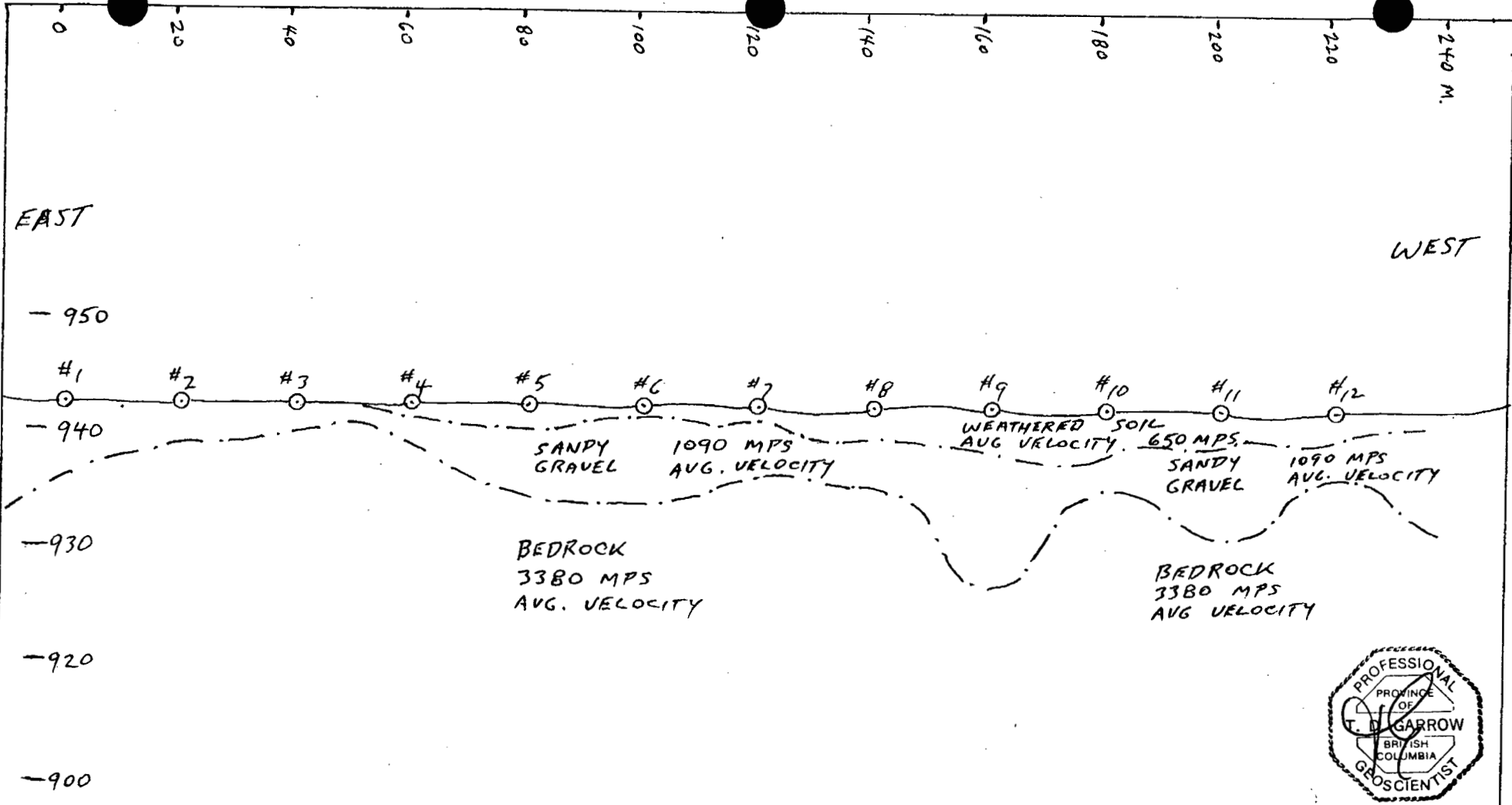

EAST WEST

- 950
 #1 #2 #3 #4 #5 #6 #7 #8 #9 #10 #11 #12
 - 940
 SANDY GRAVEL 1090 MPS AVG. VELOCITY
 WEATHERED SOIL 650 MPS AVG. VELOCITY
 SANDY GRAVEL 1090 MPS AVG. VELOCITY
 - 930
 BEDROCK 3380 MPS AVG. VELOCITY
 BEDROCK 3380 MPS AVG. VELOCITY
 - 920
 - 900
 - 890
 - 880 METERS ABOVE SEA LEVEL



SECTION LOOKING SW
 AZIMUTH OF SEISMIC LINE 120°
 HORIZONTAL SCALE 1:1000
 VERTICAL SCALE 1:500

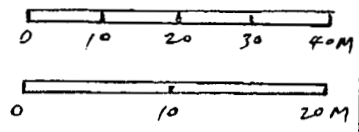

FORERUNNER RESOURCES Ltd.
 SPANISH LAKE PLACER PROJECT
 SEISMIC REFRACTION SURVEY
 VERTICAL SECTION - LOOKING SW
 LINE "A", DAM 1 CLAIM
 T.D.G. SEPT, 1996

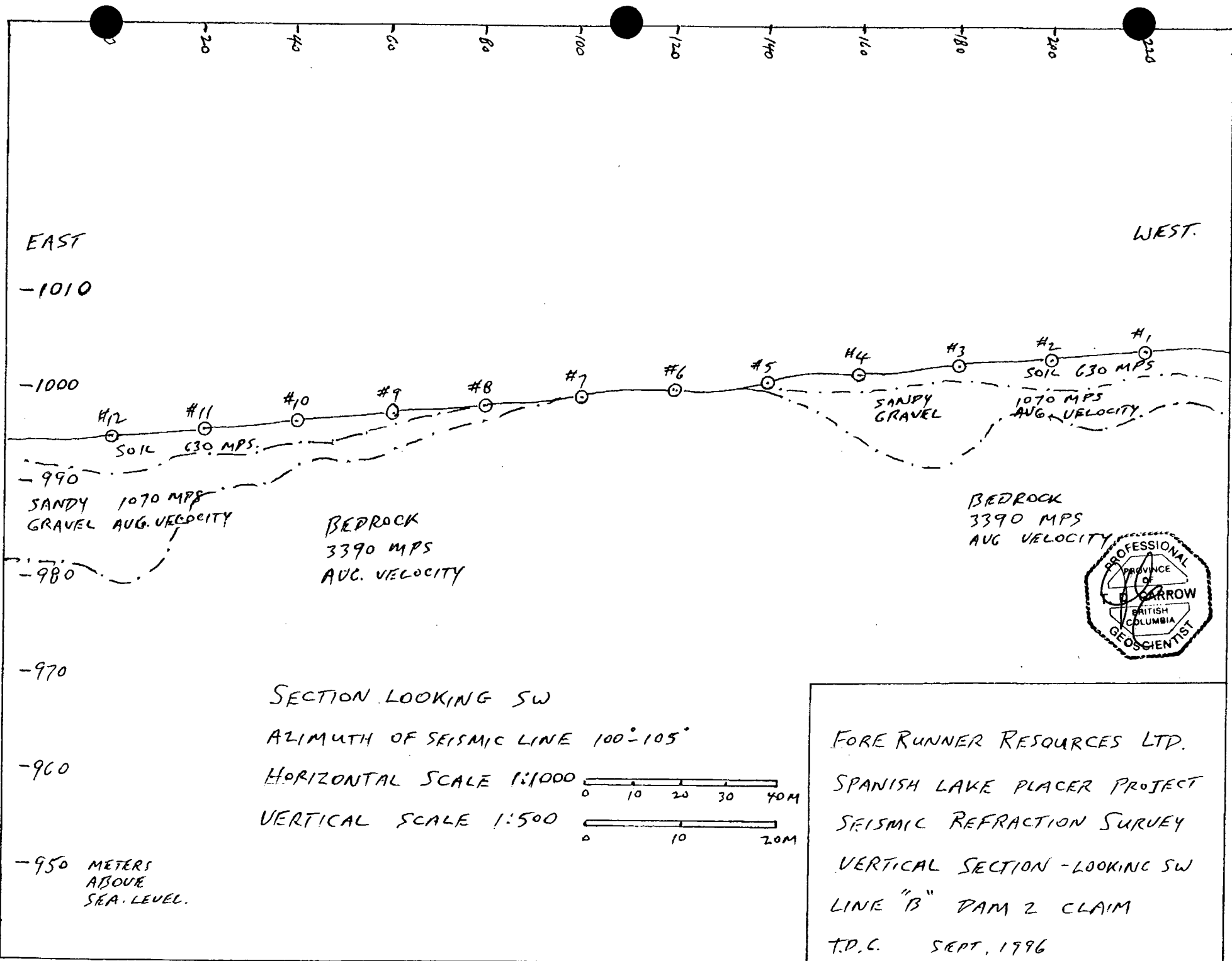

EAST
-1010

WEST

-1000

-990

-980

-970

-960

-950

METERS
ABOVE
SEA LEVEL.

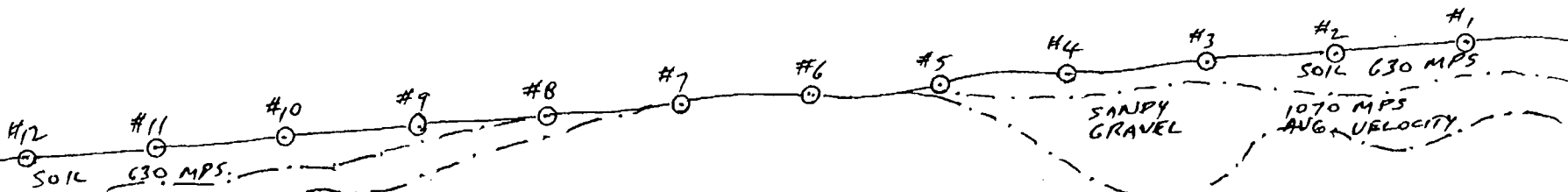

SECTION LOOKING SW
AZIMUTH OF SEISMIC LINE 100°-105°
HORIZONTAL SCALE 1:1000
VERTICAL SCALE 1:500

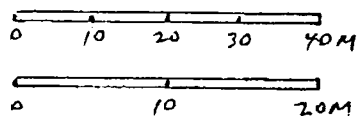

FORE RUNNER RESOURCES LTD.
SPANISH LAKE PLACER PROJECT
SEISMIC REFRACTION SURVEY
VERTICAL SECTION - LOOKING SW
LINE "B" DAM 2 CLAIM
T.D.C. SEPT, 1996

4.2 INTERPRETIVE METHOD

WHEN A SEISMIC REFRACTION SURVEY IS DONE, THE SEISMOGRAPH RECORDS THE TIME BETWEEN THE INITIATION OF THE SHOCK WAVE BY THE HAMMER BLOW ON THE STRIKER PLATE AND ITS FIRST ARRIVAL (SHORTEST TIME PATH) AT EACH GEOPHONE LOCATED AT MEASURED DISTANCES FROM THE HAMMER BLOW. A TIME DISTANCE GRAPH CAN BE CONSTRUCTED TO OUTLINE THE CHANGES OF VELOCITY OF THE SHOCK WAVES AS THEY TRAVERSE LAYERS OF DIFFERENT DENSITY.

THE FIELD DATA CONSISTING OF TIMES RECORDED IN MILLISECONDS AND DISTANCES MEASURED FROM THE HAMMER POINT TO EACH GEOPHONE ARE PLOTTED ON A GRAPH, VELOCITIES ARE CALCULATED BY; $VELOCITY = DISTANCE / TIME$.
THE THICKNESS OF THE LAYER IS CALCULATED BY;

$THICKNESS = 1/2 \text{ THE DISTANCE BETWEEN VELOCITY CHANGES } \times$
 $SQUARE \text{ ROOT OF } [(VELOCITY 2 - VELOCITY 1) / (VELOCITY 2 + VELOCITY 1)]$

SHOCK WAVES TRAVEL THROUGH EARTH MATERIALS WITH SPECIFIC AND KNOWN VELOCITIES.

IN GENERAL, THE VELOCITY CONTRAST BETWEEN REFRACTIVE LAYERS WAS MORE THAN ADEQUATE FOR A GOOD INTERPRETATION FROM THE DATA OF THIS SURVEY.

4.3 LIMITATIONS

THE DEPTHS TO SUBSURFACE BOUNDARIES DERIVED FROM SEISMIC REFRACTION SURVEYS ARE GENERALLY ACCEPTED AS ACCURATE TO WITHIN TEN PERCENT OF THE TRUE DEPTHS TO THE BOUNDARIES. IN SOME CASES, UNUSUAL GEOLOGICAL CONDITIONS MAY PRODUCE FALSE OR MISLEADING SEISMIC ARRIVALS. BECAUSE THIS IS THE FIRST SEISMIC REFRACTION SURVEY DONE ON CLAIMS 326450 AND 326451, THERE IS NOTHING TO COMPARE THE RESULTS TO. AN ON SITE INVESTIGATION CONFIRMED THAT BEDROCK APPEARS TO BE VERY CLOSE TO SURFACE BETWEEN GEOPHONES 3 AND 4 ON LINE A, AND GEOPHONES 5 AND 7 ON LINE B AS INDICATED BY THE SEISMIC.

5.0 GEOPHYSICAL RESULTS RELATIVE TO PROPERTY GEOLOGY

THE RESULTS OF THE SEISMIC REFRACTION SURVEY ARE PRESENTED ON THE BASELINE VERTICAL SECTION AT THE HORIZONTAL SCALE OF 1:1000 AND THE VERTICAL SCALE OF 1:500. THE GEOPHYSICAL INTERPRETATION APPEARS TO AGREE WITH BRIEF SURFACE INSPECTION; HOWEVER, NO DRILLING OR EXCAVATION HAS BEEN DONE TO CONFIRM ANY SUBSURFACE INTERPRETATION. INSPECTION OF LOCAL BEDROCK OUTCROPS CONFIRM THAT THERE ARE HIGHLY SHEARED SULFIDE RICH ANDESITES ON THIS PROPERTY AS THE SEISMIC OUTLINES. GEOLOGICAL SURVEY MAPPING OF THIS AREA SUGGESTS THAT THERE IS A REGIONAL FAULT STRIKING AT APPROX. 110 DEGREES PASSING THROUGH SPANISH LAKE, WITH LESS SIGNIFICANT FAULT DIRECTIONS AT 50 AND 170 DEGREES. THE BEDROCK DEPRESSIONS OUTLINED ON THE BASELINE SECTION WOULD APPEAR TO RELATE TO THE 50 DEGREE FAULTING DIRECTION.

6.0 CONCLUSIONS

THIS PRELIMINARY SEISMIC SURVEY HAS BEEN AN INEXPENSIVE AND SUCCESSFUL METHOD OF PREDICTING THE SUBSURFACE GEOLOGY OF THE TEST AREA, AND TO ULTIMATELY LOCATE POTENTIALLY ECONOMIC GOLD BEARING GRAVELS. JUST THIS PRELIMINARY TWO LINE SURVEY OUTLINES MULTIPLE BEDROCK DEPRESSIONS FILLED TO A DEPTH OF 11 METERS WITH POTENTIAL GOLD BEARING GRAVEL.

THE INFORMATION FROM THIS SURVEY SHOULD BE TESTED BY EXCAVATION TO CONFIRM THE RESULTS, AND ADDITIONAL SEISMIC LINES SHOULD BE COMPLETED PARALLEL AND PERPENDICULAR TO THE PRELIMINARY BASELINE SURVEYS TO DEVELOP A THREE DIMENSIONAL PATTERN OF POTENTIAL GOLD GRAVELS TO BE EVALUATED ON THE PROPERTY.

7.0 RECOMMENDATIONS

PRELIMINARY TESTING UTILIZING SEISMIC SURVEYS HAS BEEN SUCCESSFUL; THEREFORE, I RECOMMEND ADDITIONAL SEISMIC SURVEYS AND BULK TESTING OF GRAVELS TO FURTHER EVALUATE THE PLACER GOLD POTENTIAL.

-EXTEND BOTH LINES A & B TO 1000 METERS IN LENGTH TO COVER THE LENGTH OF THE PLACER CLAIMS.

-COMPLETE THREE SEISMIC LINES, EACH 500 METERS LONG EQUALLY SPACED AND AT 90 DEGREES TO LINES A & B.

EXCAVATE SEVERAL BULK TESTS OF SEVERAL HUNDRED CUBIC METERS EACH IN THE AREAS OF BEST POTENTIAL FOR PLACER GOLD.

STATEMENT OF QUALIFICATIONS

I, TERRY DAVID GARROW, OF LIKELY IN THE PROVINCE OF BRITISH COLUMBIA, DO HEREBY CERTIFY;

1. THAT I AM A CONSULTING MINING GEOLOGIST WITH OFFICES AT SPANISH CREEK ROAD, BOX 197, LIKELY, BRITISH COLUMBIA.
2. THAT I AM A GRADUATE OF SIR WILFRED LAURIER UNIVERSITY-1966, AND THE UNIVERSITY OF SASKATCHEWAN-1969, WITH AN ADVANCED DEGREE IN GEOLOGY.
3. THAT I AM REGISTERED AS A PROFESSIONAL GEOSCIENTIST IN THE ASSOCIATION OF PROFESSIONAL ENGINEERS AND GEOSCIENTISTS OF BRITISH COLUMBIA.
4. THAT MY 25 YEARS OF CONTINUOUS GEOLOGICAL EXPERIENCE HAVE EXPOSED ME TO A WIDE RANGE OF SUPERVISORY, ENVIRONMENTAL AND GEOLOGICAL SITUATIONS, AND HAVE ALLOWED CONSIDERABLE FAMILIARIATION WITH THE EXPLORATION AND PRODUCTION OF BOTH LODE AND PLACER DEPOSITS.
5. THAT THIS REPORT IS WRITTEN WITH THE KNOWLEDGE GAINED FROM MY ASSOCIATION WITH GALLERY RESOURCES OVER THE LAST 4 YEARS AND MY CURRENT EMPLOYMENT AS A TECHNICAL CONSULTANT ON SITE.
6. THAT I HAVE NO INTEREST, DIRECT OR INDIRECT, IN THE PROPERTIES OR SECURITIES OF GALLERY RESOURCES LTD.

DATED AT VANCOUVER, B.C., THIS 27th DAY OF September, 1996

TERRY DAVID GARROW, P. GEO

Terry D Garrow

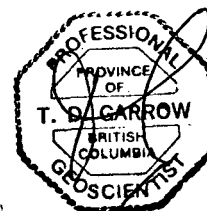

9.0 STATEMENT OF COSTS

1.5 DAYS SEISMIC REFRACTION SURVEY ON PLACER CLAIMS 326450 & 326451

MOBILIZATION - DEMOBILIZATION VANCOUVER TO LIKELY	\$200
FIELD EQUIPMENT & OPERATOR CHARGE	\$950
FIELD ASSISTANT	\$300
FOOD & ACCOMMODATION	\$300
<u>OFFICE REPORT & DRAFTING</u>	<u>\$600</u>
TOTAL COSTS OF SEISMIC SURVEY	\$2350