

**SILVER APEX**  
**ASSESSMENT REPORT**  
**1996**

24770

## Table of Contents

Title Page and Summary	1,2
Location, Access, History	2.1
Location Map Fig. 1	3
Regional Map Fig. 2	4
Unit Locational Map Fig. 3	5
Topographical Map	6
Project Maps / Assays Plotted ( Ag Pb Zn )	12
Sample Summary	7.- 1,2,3,4
Assay Report Certificates	8.- 1,2,3,4,5,6,7
Analysis (INTERPRETATION & CONCLUSION)	9.-
Statement of Costs	10
The Author	11

# **SILVER APEX**

## **ASSESSMENT REPORT**

### **1996**



TITLE OF REPORT [type of survey(s)] SILVER APEX TOTAL COST  
FEBRUARY 6, 1997 PRELIMINARY GEOCHEMICAL

AUTHOR(S) DAVID J. CURRIE SIGNATURE(S)

NOTICE OF WORK PERMIT NUMBER(S)/DATE(S) CBK-95-05-00488-001-M137 YEAR OF WORK 1996

STATEMENT OF WORK - CASH PAYMENT EVENT NUMBER(S)/DATE(S)

PROPERTY NAME SILVER APEX

CLAIM NAME(S) (on which work was done) SILVER APEX I II III

COMMODITIES SOUGHT SILVER LEAD ZINC

MINERAL INVENTORY MINFILE NUMBER(S), IF KNOWN

MINING DIVISION SLOCAN NTS 82F14E

LATITUDE 50° N LONGITUDE 117° 14' W \* (at centre of work)

OWNER(S)  
1) DAVID J. CURRIE 2)

MAILING ADDRESS  
4462 S.E. MARINE DRIVE  
BURNABY, B.C. V5J 3G2

OPERATOR(S) [who paid for the work]  
1) DAVID J. CURRIE 2)

MAILING ADDRESS  
4462 S.E. MARINE DRIVE  
BURNABY, B.C. V5J 3G2

PROPERTY GEOLOGY KEYWORDS (lithology, age, stratigraphy, structure, alteration, mineralization, size and attitude):  
SLOCAN TYPE - SILVER-LEAD-ZINC, HOST ROCK-SLOCAN  
SEDIMENTARY SERIES, TRIASSIC; INTRUSIVES, NELSON PORPHYRY  
GRANITE, HOST ROCK CONTACT METAMORPHISM, MINERALIZATION  
QUARTZ, QUARTZ SEDIMENT BRECCIA, ORE AgPbZn, STRIKE NE-SW, DIF.  
S.E., APPARENT EXTENSION TO S.W. OF UTICA MINE LOAD

REFERENCES TO PREVIOUS ASSESSMENT WORK AND ASSESSMENT REPORT NUMBERS  
V. CUKOR P. ENG. RW PHENDLER P ENG. J. SNELL P. ENG.  
D. CURRIE 14675-20

TYPE OF WORK IN THIS REPORT <b>GEOCHEM</b>	EXTENT OF WORK (IN METRIC UNITS)	ON WHICH CLAIMS <b>SILVER APEX</b>	PROJECT COSTS APPORTIONED (incl. support)
GEOLOGICAL (scale, area)			
Ground, mapping	<b>YES / COMPASS - HIP CHAIN REPORT PREP.</b>		
Photo interpretation			
GEOPHYSICAL (line-kilometres)			
Ground			
Magnetic			
Electromagnetic			
Induced Polarization			
Radiometric			
Seismic			
Other			
Airborne			
GEOCHEMICAL (number of samples analysed for ...)			
Soil	<b>73</b>		
Silt			
Rock	<b>X</b>		
Other			
DRILLING (total metres; number of holes, size)			
Core			
Non-core			
RELATED TECHNICAL			
Sampling/assaying			
Petrographic			
Mineralographic			
Metallurgic			
PROSPECTING (scale, area)			
PREPARATORY/PHYSICAL			
Line/grid (kilometres)			
Topographic/Photogrammetric (scale, area)			
Legal surveys (scale, area)			
Road, local access (kilometres)/trail			
Trench (metres)			
Underground dev. (metres)			
Other			
TOTAL COST			<b>\$ 2600.</b>

Location and Access

The centre of the claims is at approximately west longitude 117°09' and north latitude 69°58'.

The Silver Apex property is located at an elevation of 5000' to 8000' ( 1515 to 2425 meters ) about 100 kilometers north of Nelson in southeast British Columbia. It lies four kilometers east of Sandon and can be reached by four wheel vehicle from Sandon by following a good logging road up Carpenter Creek past Cody to the property. The logging road traverses the claims from north to southeast.

Sandon is accessible by road from Nelson or Castlegar north on Highway 6 along Slecan Lake in New Denver and thence east on the New Denver-Kasle road for 16 kilometers to the town.

No buildings exist on the claims and ample water is available locally for exploration and mining purposes. The property is well timbered, except for the southwest corner which is close to the peak of Mount Cody.

History

The claims were located by Mr. David J. Currie in October 1984.

Records of earlier activity on the property are obscure, but there is believed to have been some lead production on the easterly side of the property; where is not clear.

There are also accounts of an adit on Carpenter Creek which produced high grade silver somewhere in the general area on the south side of the creek, which the author believes could be on the property. It has not been located.

There are some old workings indicated on maps near Cody Peak but no records were kept or are available. These workings for the most part have not been found either.

The property is traversed by what appears to be the Utica Lode System and which is the purpose of the current exploration program. The Utica Mine on the northeast side of the property was a profitable mine of high grade silver lead ore for many years until the late 1950's. It is hoped that similar ore will be located on the Silver Apex on the extension of the same lode system.

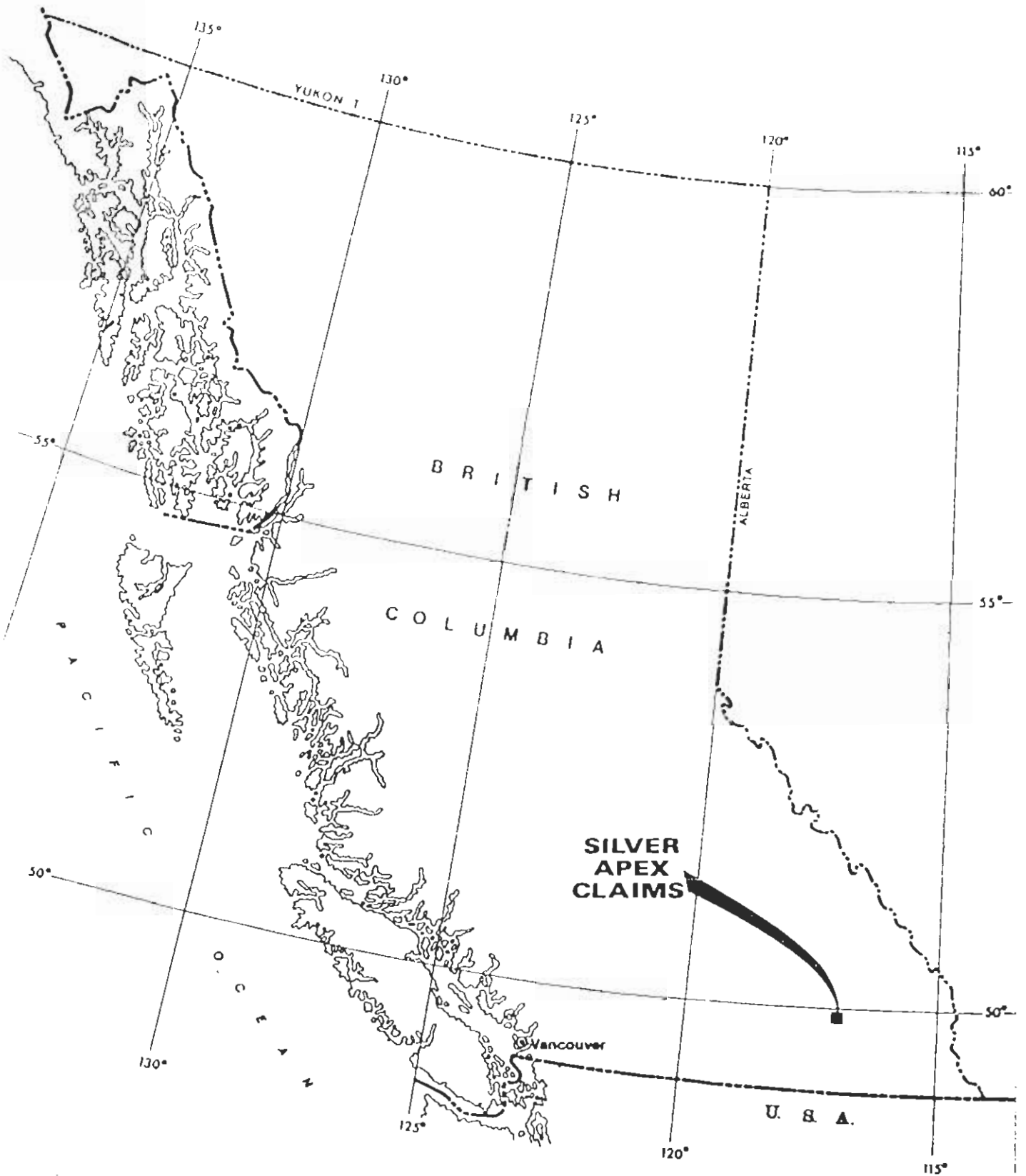

Location Map  
SILVER APEX PROJECT  
Slocan Mining Division  
British Columbia

Fig. 1

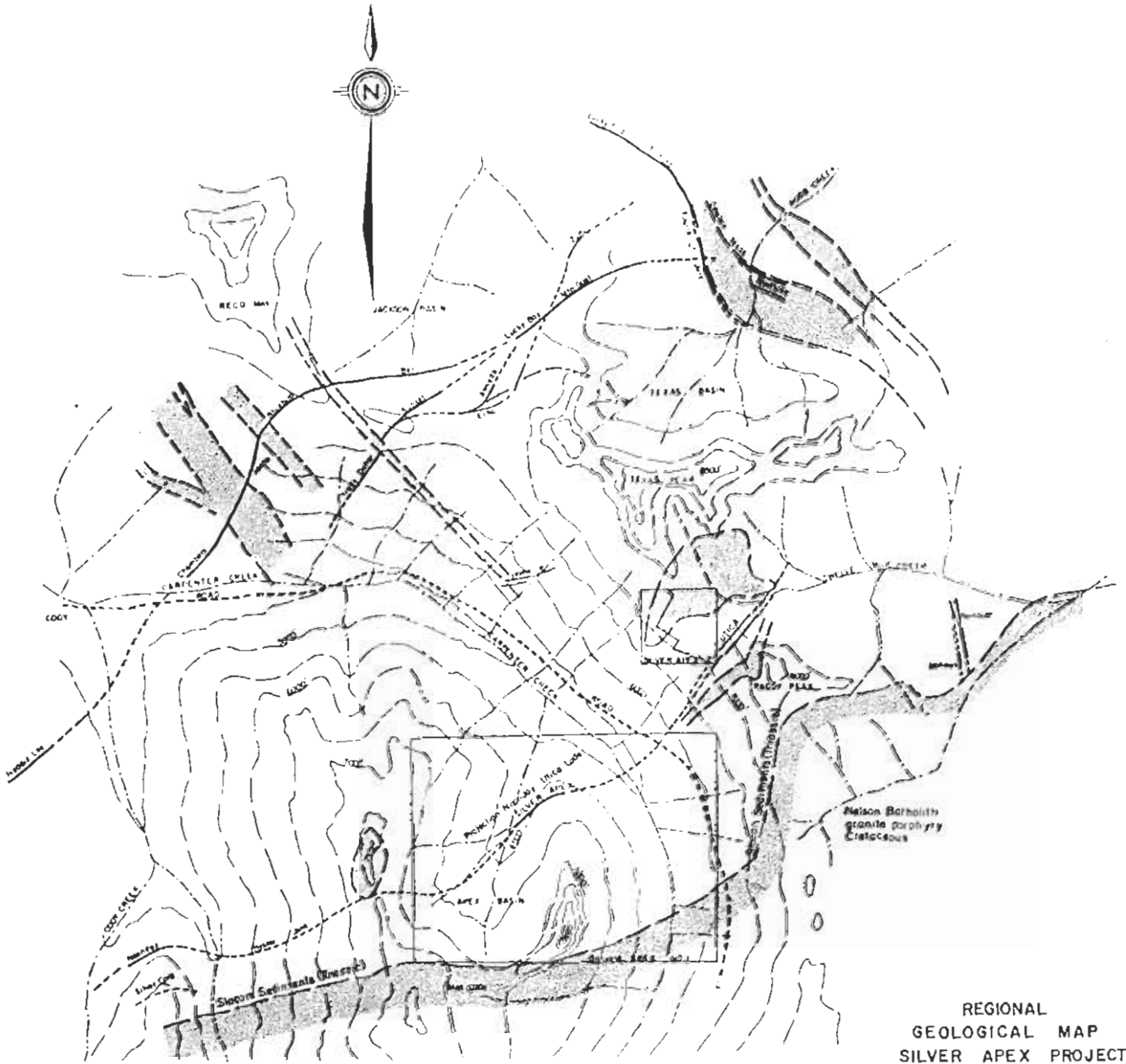

REGIONAL  
 GEOLOGICAL MAP  
 SILVER APEX PROJECT  
 SLOAN MINING DIVISION

0 1 2 3 4 5 6 7 8 9 10

GEOLOGISTICS ENGINEERING LIMITED  
 Vancouver, Canada

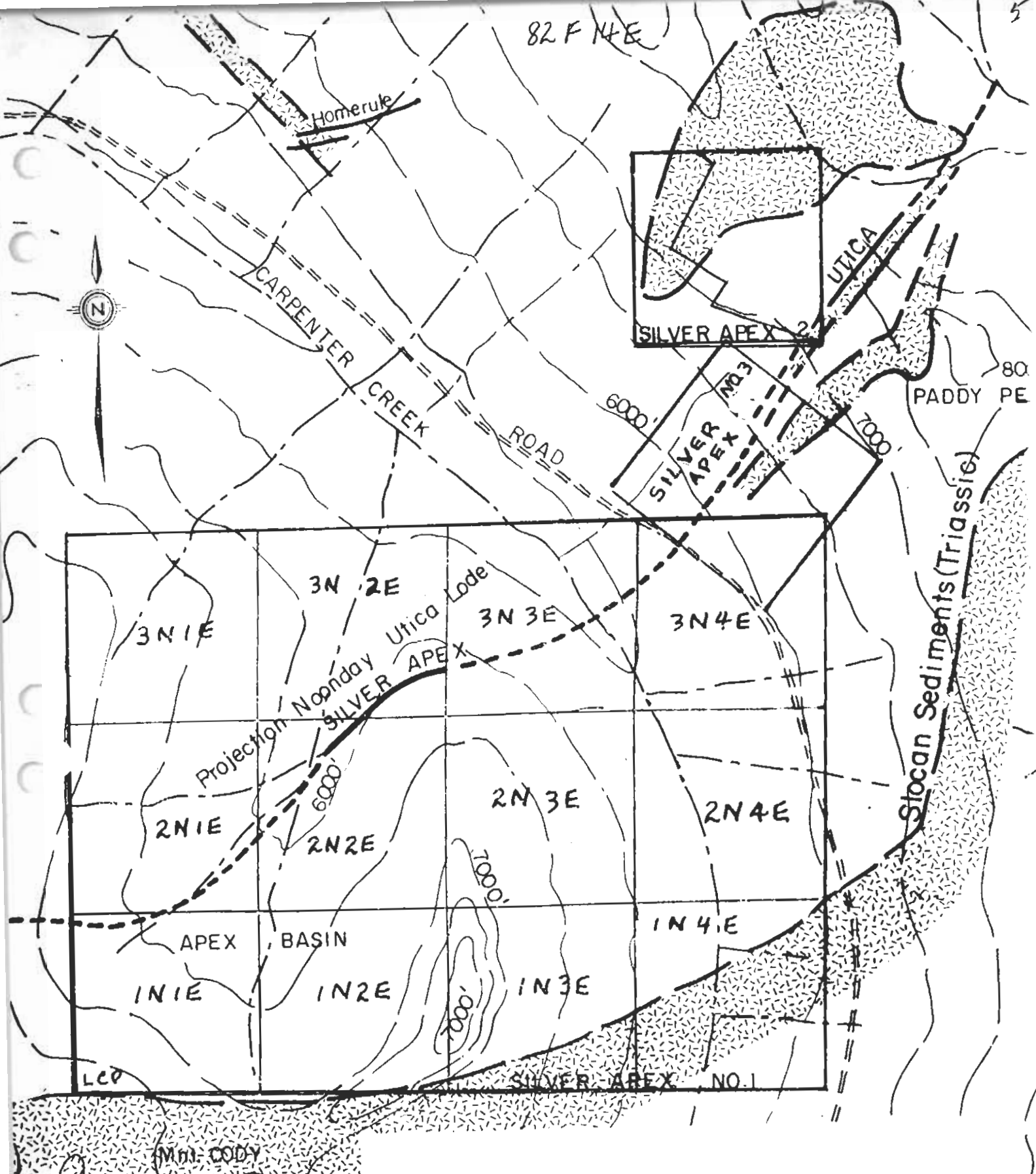

# SILVER APEX PROJECT



FIG 3



NTS MAP 82 F/W  
SECOND STATUS EDITION - September 1973

To Rosebery - 1 miles To Kaslo - 28 miles

To New Denver - 9 miles

117° 00'

50° 00'

To Kaslo - 8 miles

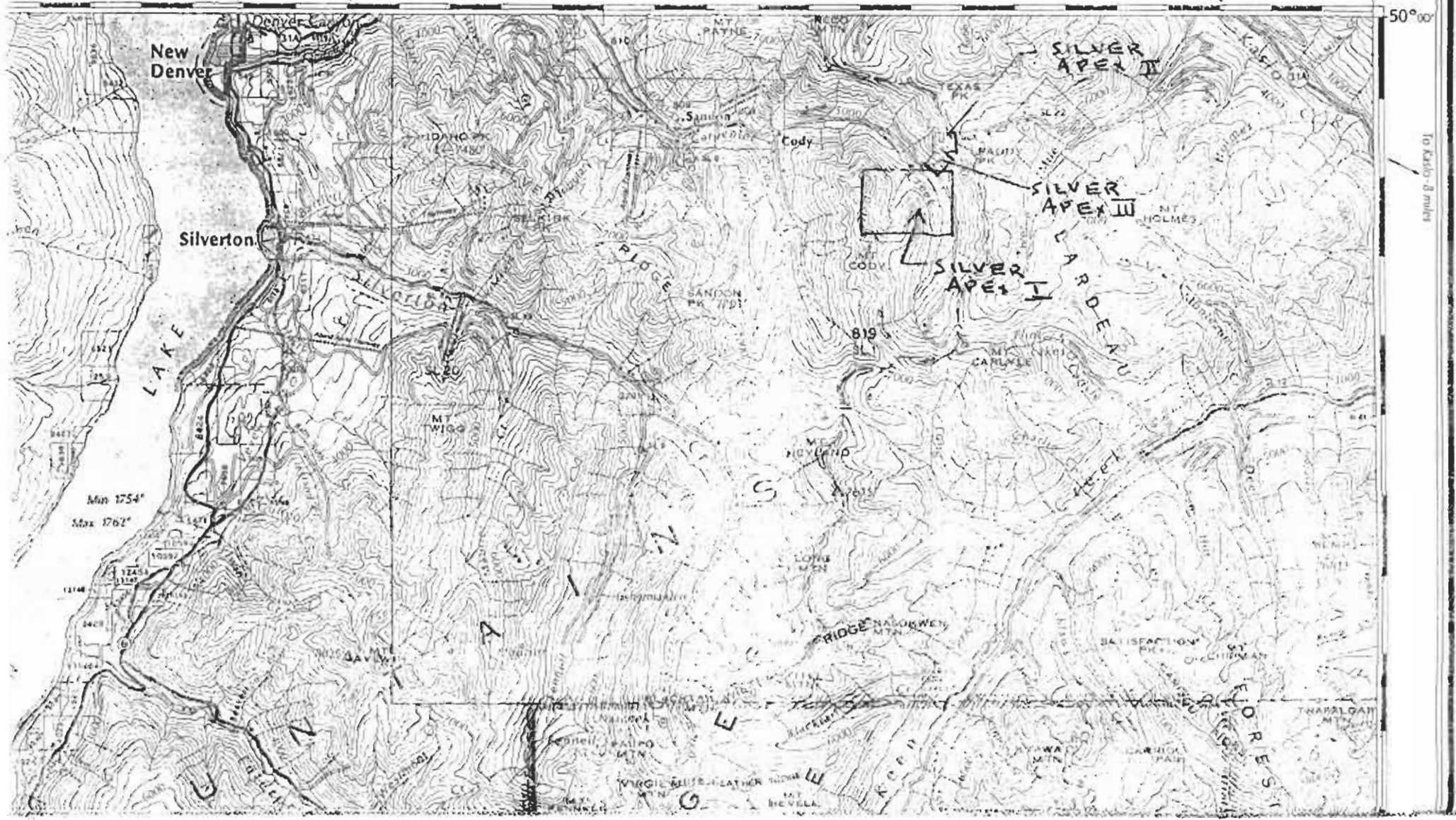

199

# SAMPLES FOR GEOCHEMICAL ANALYSIS - SILVER APEX- TETRAHEDRAL PROJECT.

SAMPLE NUMBER	SOIL (✓) SAMPLE (SOME ROCK)	OTHER TYPE OF SAMPLE	MOISTURE CONTENT		WEIGHT COLLECTED (GRAMS)	HORIZON			TERRAIN SLOPE °	DEPTH OF SAMPLE	TEXTURE			TETRAHEDRAL CRYSTALS	ASH LAYERS (✓)	OTHER
			WET	MOIST A		A	B	C			FINE	MED	COARSE			
5.6	✓			✓	300			✓	See MAP	1.0m		✓				
5.7	✓			✓	300			✓		1.0		✓				
5.8	✓			✓	300			✓		1.0		✓				
5.9	✓			✓	300			✓		1.0		✓				
6.0	✓			✓	300			✓		1.0		✓				
6.1	✓			✓	300			✓		1.0		✓				
6.2	✓			✓	300			✓		1.0		✓				
6.3	✓			✓	300			✓		1.0		✓				
6.4	✓			✓	300			✓		1.0		✓				
6.5	✓			✓	300			✓		1.0		✓				
6.6	✓			✓	300			✓		1.0		✓				
6.7	✓			✓	300			✓		1.0		✓				
6.8	✓			✓	300			✓		1.0		✓				
6.9	✓			✓	300			✓		1.0		✓				
7.0	✓			✓	300			✓		1.0		✓				
7.1	✓			✓	300			✓		1.0		✓				
7.2	✓			✓	300			✓		1.0		✓				
7.3	✓			✓	300			✓		1.0		✓				
7.4	✓			✓	300			✓		1.0		✓				
7.5	✓			✓	300			✓		1.0		✓				
7.6	✓			✓	300			✓		1.0		✓				
7.7	✓			✓	300			✓		1.0		✓				
7.8	✓			✓	300			✓		1.0		✓				
7.9	✓			✓	300			✓		1.0		✓				
8.0	✓			✓	300			✓		1.0		✓				

# SAMPLES FOR GEOCHEMICAL ANALYSIS - SILVER APEX - PROJECT.

SAMPLE NUMBER	SOIL (✓) SAMPLE (SOME ROCK)	OTHER TYPE OF SAMPLE	MOISTURE CONTENT		WEIGHT COLLECTED (GRAMS)	HORIZON			TERRAIN SLOPE °	DEPTH OF SAMPLE (FT)	TEXTURE			TETRAHEDRAL CRYSTALS	ASH LAYERS ( )	OTHER
			WET	MOIST		A	B	C			FINE	MED	COURSE			
8.1	✓		✓		300		✓		SEE MAP	1.0		✓				
8.2	✓		✓		300		✓		MAP	1.0		✓				
8.3	✓		✓		300		✓			1.0		✓				
8.4	✓		✓		300		✓			1.0		✓				
8.5	✓		✓		200		✓			1.0		✓				
8.6	✓		✓		200		✓			1.0		✓				
8.7	✓		✓		300		✓			1.0		✓				
8.8	✓		✓		300		✓			1.0		✓				
8.9	✓		✓		300		✓			1.0		✓				
9.0	✓		✓		300		✓			1.0		✓				
9.1	✓		✓		300		✓			1.0		✓				
9.2	✓		✓		300		✓			1.0		✓				
9.3	✓		✓		300		✓			1.0		✓				
9.4	✓		✓		200		✓			1.0		✓				
9.5	✓		✓		200		✓			1.0		✓				
9.6	✓		✓		200		✓			1.0		✓				
9.7	✓		✓		300		✓			1.0		✓				
9.8	✓		✓		300		✓			1.0		✓				
9.9	✓		✓		300		✓			1.0		✓				
10.0	✓		✓		300		✓			1.0		✓				
10.1	✓		✓		300		✓			1.0		✓				
10.2	✓		✓		300		✓			1.0		✓				
10.3	✓		✓		300		✓			1.0		✓				
10.4	✓		✓		300		✓			1.0		✓				
10.5	✓		✓		300		✓			1.0		✓				

199

# SAMPLES FOR GEOCHEMICAL ANALYSIS - SILVER APEX -

TETRAHEDRAL PROJECT.

SAMPLE NUMBER	SOIL (✓) SAMPLE  (SOME ROCK)	OTHER TYPE OF SAMPLE	MOISTURE CONTENT		WEIGHT COLLECTED (GRAMS)	HORIZON			TERRAIN SLOPE °	DEPTH OF SAMPLE (IN)	TEXTURE			TETRAHEDRAL CRYSTALS	ASH LAYERS ( )	OTHER
			WET	MOIST %		A	B	C			FINE	MED	COURSE			
10.6	✓			✓	300			✓	See Map	1.0		✓				
10.7	✓			✓	300			✓		1.0		✓				
10.8	✓			✓	300			✓		1.0		✓				
10.9	✓			✓	300			✓		1.0		✓				
11.0	✓			✓	300			✓		1.0		✓				
11.1	✓			✓	300			✓		1.0		✓				
11.2	✓			✓	300			✓		1.0		✓				
11.3	✓			✓	300			✓		1.0		✓				
11.4	✓			✓	300			✓		1.0		✓				
11.5	✓			✓	300			✓		1.0		✓				
11.6	✓			✓	300			✓		1.0		✓				
11.7	✓			✓	300			✓		1.0		✓				
11.8	✓			✓	300			✓		1.0		✓				
11.9	✓			✓	300			✓		1.0		✓				
12.0	✓			✓	300			✓		1.0		✓				
12.1	✓			✓	300			✓		1.0		✓				
12.2	✓			✓	300			✓		1.0		✓				
12.3	✓			✓	300			✓		1.0		✓				
12.4	✓			✓	300			✓		1.0		✓				
12.5	✓			✓	300			✓		1.0		✓				
12.6	✓			✓	300			✓		1.0		✓				
12.7	✓			✓	300			✓		1.0		✓				
12.8	✓			✓	300			✓		1.0		✓				
12.9	✓			✓	300			✓		1.0		✓				

199

# SAMPLES FOR GEOCHEMICAL ANALYSIS - SILVER APEX -

TETRAHEDRAL PROJECT.

SAMPLE NUMBER	SOIL SAMPLE (✓) (SOME ROCK)	OTHER TYPE OF SAMPLE	MOISTURE CONTENT		WEIGHT COLLECTED (GRAMS)	HORIZON			TERRAIN SLOPE °	DEPTH OF SAMPLE (m)		TEXTURE			TETRAHEDRAL CRYSTALS	ASH LAYERS (✓)	OTHER	
			WET	MOIST		A	B	C		FINE	MED	COARSE						
13.0	✓			✓	300			✓	See MISS	1.0 m		✓						
13.1	✓			✓	300			✓		1.0		✓						
13.2	✓			✓	300			✓		1.0		✓						
13.3	✓			✓	300			✓		1.0		✓						
3.4	✓			✓	300			✓		1.0		✓						
13.5	✓			✓	300			✓		1.0		✓						
13.6	✓			✓	300			✓		1.0		✓						
13.7	✓			✓	300			✓		1.0		✓						
13.8	✓			✓	300			✓		1.0		✓						
13.9	✓			✓	300			✓		1.0		✓						
14.0	✓			✓	300			✓		1.0		✓						
14.1	✓			✓	300			✓		1.0		✓						
14.2	✓			✓	300			✓		1.0		✓						
14.3	✓			✓	300			✓		1.0		✓						
14.4	✓			✓	300			✓		1.0		✓						
14.5	✓			✓	300			✓		1.0		✓						
14.6	✓			✓	300			✓		1.0		✓						
14.7	✓			✓	300			✓		1.0		✓						
14.8	✓			✓	300			✓		1.0		✓						
14.9	✓			✓	300			✓		1.0		✓						
15.0	✓			✓	300			✓		1.0		✓						
15.1	✓			✓	300			✓		1.0		✓						
15.2	✓			✓	300			✓		1.0		✓						
15.3	✓			✓	300			✓		1.0		✓						
15.4	✓			✓	300			✓		1.0		✓						
15.5	✓			✓	200			✓		1.0		✓						

199

# SAMPLES FOR GEOCHEMICAL ANALYSIS - SILVER APEX -

TETRAHEDRAL PROJECT.

SAMPLE NUMBER	SOIL SAMPLE (✓) (SOME ROCK)	OTHER TYPE OF SAMPLE	MOISTURE CONTENT		WEIGHT COLLECTED (GRAMS)	HORIZON			TERRAIN SLOPE °	DEPTH OF SAMPLE (m)	TEXTURE			TETRAHEDRAL CRYSTALS	ASH LAYERS ( )	OTHER
			WET	MOIST A		A	B	C			FINE	MED	COURSE			
15.6	✓			✓	300		✓		See Map.	1.0		✓				
15.7	✓			✓	300		✓			1.0		✓				
15.8	✓			✓	300		✓			1.0		✓				
15.9	✓			✓	300		✓			1.0		✓				
16.0	✓			✓	300		✓			1.0		✓				
16.1	✓			✓	300		✓			1.0		✓				
16.2	✓			✓	300		✓			1.0		✓				
16.3	✓			✓	300		✓			1.0		✓				
16.4	✓			✓	300		✓			1.0		✓				
16.5	✓			✓	300		✓		1.0		✓					



# Chemex Labs Ltd.

Analytical Chemists \* Geochemists \* Registered Assayers  
212 Brooksbank Ave., North Vancouver  
British Columbia, Canada V7J 2C1  
PHONE: 604-984-0221

To: CURRIE, DAVID

4462 S.E. MARINE DR.  
BURNABY, BC  
V5J 3G2

**INVOICE NUMBER**

**I 9 7 1 3 0 8 2**

BILLING INFORMATION	
Date:	12-FEB-97
Project:	
P.O. No.:	
Account:	MLI
Comments:	
Billing:	For analysis performed on Certificate A9713082
Terms:	Payment due on receipt of invoice 1.25% per month (15% per annum) charged on overdue accounts
Please Remit Payments to:	
	<b>CHEMEX LABS LTD.</b> 212 Brooksbank Ave., North Vancouver, B.C. Canada V7J 2C1

# OF SAMPLES	ANALYSED FOR CODE - DESCRIPTION	UNIT PRICE	SAMPLE PRICE	AMOUNT
45	201 - Dry, sieve to -80 mesh	1.25		
	202 - save reject	0.85		
	ICF-9g	7.00	9.10	409.50
Total Cost \$				409.50
Client Discount ( 10%) \$				-40.95
Net Cost \$				368.55
(Reg# R100938885 ) GST \$				25.80
<b>TOTAL PAYABLE (CDN) \$</b>				<b>394.35</b>

2

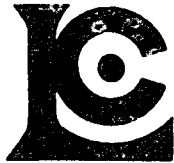

# Chemex Labs Ltd.

Analytical Chemists \* Geochemists \* Registered Assayers  
212 Brooksbank Ave., North Vancouver  
British Columbia, Canada V7J 2C1  
PHONE: 604-984-0221 FAX: 604-984-0218

To: CURRIE, DAVID

4462 S.E. MARINE DR.  
BURNABY, BC  
V5J 3G2

A9713082

Comments: ATTN:DAVID CURRIE

**CERTIFICATE** **A9713082**

(MLI) - CURRIE, DAVID

Project:  
P.O. #:

Samples submitted to our lab in Vancouver, BC.  
This report was printed on 8-APR-97.

SAMPLE PREPARATION		
CHEMEX CODE	NUMBER SAMPLES	DESCRIPTION
201	45	Dry, sieve to -80 mesh
202	45	save reject
229	45	ICP - AQ Digestion charge

ANALYTICAL PROCEDURES					
CHEMEX CODE	NUMBER SAMPLES	DESCRIPTION	METHOD	DETECTION LIMIT	UPPER LIMIT
2118	45	Ag ppm: 32 element, soil & rock	ICP-AES	0.2	100.0
2120	45	As ppm: 32 element, soil & rock	ICP-AES	2	10000
2123	45	Bi ppm: 32 element, soil & rock	ICP-AES	2	10000
2128	45	Cu ppm: 32 element, soil & rock	ICP-AES	1	10000
2131	45	Hg ppm: 32 element, soil & rock	ICP-AES	1	10000
2136	45	Mo ppm: 32 element, soil & rock	ICP-AES	1	10000
2140	45	Pb ppm: 32 element, soil & rock	ICP-AES	2	10000
2141	45	Sb ppm: 32 element, soil & rock	ICP-AES	2	10000
2149	45	Zn ppm: 32 element, soil & rock	ICP-AES	2	10000

*David*





# Chemex Labs Ltd.

Analytical Chemists \* Geochemists \* Registered Assayers

212 Brooksbank Ave., North Vancouver  
British Columbia, Canada V7J 2C1  
PHONE: 604-984-0221 FAX: 604-984-0218

To: CURRIE, DAVID

4462 S.E. MARINE DR.  
BURNABY, BC  
V5J 3G2

Project :

Comments: ATTN:DAVID CURRIE

Page Number : 1  
Total Pages : 2  
Certificate Date: 12-FEB-97  
Invoice No. : I9713082  
P.O. Number :  
Account : MLI

## CERTIFICATE OF ANALYSIS

### A9713082

SAMPLE	PREP CODE	Ag ppm	As ppm	Bi ppm	Cu ppm	Hg ppm	Mo ppm	Pb ppm	Sb ppm	Zn ppm
8.8	201 202	1.0	2	< 2	57	< 1	3	22	2	204
8.9	201 202	0.4	2	< 2	31	< 1	3	20	< 2	286
9.0	201 202	< 0.2	4	< 2	68	< 1	5	38	< 2	442
9.1	201 202	1.0	< 2	< 2	49	< 1	2	20	< 2	346
9.2	201 202	0.6	< 2	< 2	31	< 1	3	24	< 2	140
9.3	201 202	0.6	2	< 2	42	< 1	4	34	< 2	162
9.4	201 202	< 0.2	2	< 2	54	< 1	4	24	< 2	388
9.5	201 202	0.8	< 2	< 2	51	< 1	3	24	< 2	200
9.6	201 202	0.4	2	< 2	30	< 1	5	36	< 2	164
9.7	201 202	1.2	8	< 2	44	< 1	6	20	< 2	320
9.8	201 202	0.6	< 2	< 2	36	< 1	2	22	< 2	84
9.9	201 202	0.8	2	< 2	60	< 1	4	32	< 2	396
10.0	201 202	< 0.2	2	< 2	54	< 1	3	26	< 2	214
10.1	201 202	< 0.2	< 2	< 2	41	< 1	1	18	< 2	216
10.2	201 202	0.4	4	< 2	52	< 1	3	34	< 2	274
10.3	201 202	0.8	2	< 2	32	< 1	3	24	< 2	126
10.4	201 202	0.2	< 2	< 2	50	< 1	7	24	< 2	110
10.5	201 202	0.2	< 2	< 2	58	< 1	1	24	< 2	126
10.6	201 202	0.6	2	< 2	28	< 1	2	24	< 2	86
10.7	201 202	0.6	2	< 2	22	< 1	3	22	< 2	46
10.8	201 202	0.4	< 2	< 2	38	< 1	5	26	< 2	92
10.9	201 202	< 0.2	< 2	< 2	46	< 1	1	16	< 2	124
11.0	201 202	0.2	< 2	< 2	29	< 1	1	20	< 2	42
11.1	201 202	0.2	< 2	< 2	28	< 1	2	22	< 2	60
11.2	201 202	0.4	< 2	< 2	24	< 1	1	22	< 2	78
11.3	201 202	0.6	< 2	< 2	24	< 1	1	20	< 2	86
11.4	201 202	0.4	< 2	< 2	33	< 1	1	18	< 2	30
14.7	201 202	0.6	< 2	< 2	21	< 1	1	10	< 2	54
14.8	201 202	< 0.2	< 2	< 2	43	< 1	2	14	< 2	126
14.9	201 202	0.2	2	< 2	39	< 1	2	14	< 2	102
15.0	201 202	0.6	< 2	< 2	40	< 1	1	12	< 2	122
15.1	201 202	< 0.2	< 2	< 2	40	< 1	1	12	< 2	114
15.2	201 202	0.2	< 2	< 2	42	< 1	1	12	< 2	92
15.3	201 202	0.2	< 2	< 2	34	< 1	2	16	< 2	88
15.4	201 202	< 0.2	< 2	< 2	31	< 1	1	10	< 2	92
15.5	201 202	0.2	< 2	< 2	43	< 1	1	12	< 2	112
15.6	201 202	< 0.2	< 2	< 2	18	< 1	1	12	< 2	48
15.7	201 202	< 0.2	< 2	< 2	37	< 1	2	14	< 2	76
15.8	201 202	< 0.2	< 2	< 2	32	< 1	3	14	< 2	66
15.9	201 202	< 0.2	< 2	< 2	36	< 1	3	12	< 2	122

CERTIFICATION

*David Currie*

1/2



# Chemex Labs Ltd.

Analytical Chemists \* Geochemists \* Registered Assayers

212 Brooksbank Ave., North Vancouver  
British Columbia, Canada V7J 2C1  
PHONE: 604-984-0221 FAX: 604-984-0218

To: CURRIE, DAVID

4462 S.E. MARINE DR.  
BURNABY, BC  
V5J 3G2

Project :

Comments: ATTN:DAVID CURRIE

Page ber :2  
Total Pages :2  
Certificate Date: 12-FEB-97  
Invoice No. : I9713082  
P.O. Number :  
Account : MLI

## CERTIFICATE OF ANALYSIS

### A9713082

SAMPLE	PREP CODE		Ag ppm	As ppm	Bi ppm	Cu ppm	Hg ppm	Mo ppm	Pb ppm	Sb ppm	Zn ppm	
16.1	201	202	0.2	< 2	< 2	38	< 1	2	12	< 2	108	
16.2	201	202	0.8	< 2	< 2	25	< 1	3	16	< 2	84	
16.3	201	202	0.6	< 2	< 2	30	< 1	3	16	< 2	122	
16.4	201	202	0.2	< 2	< 2	30	< 1	1	16	< 2	60	
16.5	201	202	0.3	< 2	< 2	36	< 1	2	18	< 2	94	

CERTIFICATION:

*David Currie*

8.3



# Chemex Labs Ltd.

Analytical Chemists \* Geochemists \* Registered Assayers  
212 Brooksbank Ave., North Vancouver  
British Columbia, Canada V7J 2C1  
PHONE: 604-984-0221

To: CURRIE, DAVID

4462 S.E. MARINE DR.  
BURNABY, BC  
V5J 3G2

**INVOICE NUMBER**

**I 9 7 1 9 9 0 8**

## BILLING INFORMATION

Date: 17-APR-97  
Project:  
P.O. No.:  
Account: MLI

Comments:

Billing: For analysis performed on  
Certificate A9719908

Terms: Payment due on receipt of invoice  
1.25% per month (15% per annum)  
charged on overdue accounts

Please Remit Payments to:

**CHEMEX LABS LTD.**  
212 Brooksbank Ave.,  
North Vancouver, B.C.  
Canada V7J 2C1

COPY

# OF SAMPLES	ANALYSED FOR CODE - DESCRIPTION	UNIT PRICE	SAMPLE PRICE	AMOUNT
53	201 - Dry, sieve to -80 mesh	1.25		
	202 - save reject	0.85		
	ICP-9g	7.00	9.10	482.30
Total Cost \$				482.30
Client Discount ( 10%) \$				-48.23
Net Cost \$				434.07
(Reg# R100938885 ) GST \$				30.38
<b>TOTAL PAYABLE (CDN) \$</b>				<b>464.45</b>

8.4



# Chemex Labs Ltd.

Analytical Chemists \* Geochemists \* Registered Assayers  
212 Brooksbank Ave., North Vancouver  
British Columbia, Canada V7J 2C1  
PHONE: 604-984-0221 FAX: 604-984-0218

To: CURRIE, DAVID

4462 S.E. MARINE DR.  
BURNABY, BC  
V5J 3G2

A9719908

Comments: ATTN: DAVID CURRIE

**CERTIFICATE**                      **A9719908**

(MLI) - CURRIE, DAVID

Project:  
P.O. #:

Samples submitted to our lab in Vancouver, BC.  
This report was printed on 17-APR-97.

SAMPLE PREPARATION		
CHEMEX CODE	NUMBER SAMPLES	DESCRIPTION
201	53	Dry, sieve to -80 mesh
202	53	save reject
298	53	ICP - AQ Digestion charge

ANALYTICAL PROCEDURES					
CHEMEX CODE	NUMBER SAMPLES	DESCRIPTION	METHOD	DETECTION LIMIT	UPPER LIMIT
2118	53	Ag ppm: 32 element, soil & rock	ICP-AES	0.2	100.0
2120	53	As ppm: 32 element, soil & rock	ICP-AES	2	10000
2123	53	Bi ppm: 32 element, soil & rock	ICP-AES	2	10000
2128	53	Cu ppm: 32 element, soil & rock	ICP-AES	1	10000
2131	53	Hg ppm: 32 element, soil & rock	ICP-AES	1	10000
2136	53	Mo ppm: 32 element, soil & rock	ICP-AES	1	10000
2140	53	Pb ppm: 32 element, soil & rock	ICP-AES	2	10000
2141	53	Sb ppm: 32 element, soil & rock	ICP-AES	2	10000
2149	53	Zn ppm: 32 element, soil & rock	ICP-AES	2	10000

5.8



# Chemex Labs Ltd.

Analytical Chemists \* Geochemists \* Registered Assayers:  
 212 Brooksbank Ave., North Vancouver  
 British Columbia, Canada V7J 2C1  
 PHONE: 604-984-0221 FAX: 604-984-0218

To: CURRIE, DAVID

4462 S.E. MARINE DR.  
 BURNABY, BC  
 V5J 3G2

Project:  
 Comments: ATTN: DAVID CURRIE

Page per : 1  
 Total Pages : 2  
 Certificate Date: 15-APR-97  
 Invoice No. : 19719908  
 P.O. Number :  
 Account : MLI

## CERTIFICATE OF ANALYSIS A9719908

SAMPLE	PREP CODE	Ag ppm	As ppm	Bi ppm	Cu ppm	Hg ppm	Mo ppm	Pb ppm	Sb ppm	Zn ppm
5.6	201 202	0.4	6	< 2	55	< 1	3	24	< 2	164
5.7	201 202	0.6	6	< 2	51	1	4	34	< 2	156
5.8	201 202	0.8	2	< 2	31	< 1	3	18	2	118
5.9	201 202	0.4	4	< 2	31	< 1	3	22	2	72
6.0	201 202	0.8	4	< 2	47	< 1	4	22	2	154
6.1	201 202	0.2	< 2	< 2	38	< 1	4	18	< 2	202
6.2	201 202	0.6	4	< 2	87	1	8	28	< 2	712
6.3	201 202	1.6	< 2	< 2	19	< 1	3	18	< 2	94
6.4	201 202	1.8	8	< 2	122	< 1	26	32	< 2	1625
6.5	201 202	1.4	8	< 2	116	< 1	10	26	2	1940
6.6	201 202	1.6	12	< 2	68	< 1	10	20	4	1780
6.7	201 202	2.0	2	< 2	67	< 1	11	16	< 2	638
6.8	201 202	2.0	2	< 2	52	< 1	7	18	< 2	600
6.9	201 202	0.4	9	< 2	77	< 1	8	26	< 2	676
7.0	201 202	0.8	6	< 2	53	< 1	8	24	2	384
7.1	201 202	0.8	6	< 2	52	< 1	4	24	< 2	410
7.2	201 202	0.2	< 2	< 2	24	1	6	26	< 2	102
7.3	201 202	1.6	< 2	< 2	54	< 1	5	24	2	348
7.4	201 202	0.8	2	< 2	34	< 1	5	22	< 2	122
7.5	201 202	1.2	4	< 2	52	< 1	6	30	< 2	538
7.6	201 202	0.8	2	< 2	38	< 1	6	26	< 2	142
7.7	201 202	1.0	8	< 2	55	< 1	8	28	< 2	712
7.8	201 202	2.0	6	< 2	42	< 1	4	26	< 2	174
7.9	201 202	1.4	< 2	< 2	27	< 1	4	36	2	96
8.0	201 202	1.0	2	< 2	34	< 1	4	22	< 2	122
8.1	201 202	0.8	< 2	< 2	22	< 1	3	20	< 2	98
8.2	201 202	0.6	< 2	< 2	18	< 1	2	26	< 2	58
8.3	201 202	0.2	< 2	< 2	58	< 1	3	20	< 2	148
8.4	201 202	1.0	2	< 2	91	< 1	3	20	< 2	230
8.5	201 202	0.2	< 2	< 2	37	< 1	2	24	< 2	138
8.6	-- --	not/ss	not/ss	not/ss	not/ss	not/ss	not/ss	not/ss	not/ss	not/ss
8.7	201 202	0.4	< 2	< 2	44	< 1	3	22	< 2	142
11.5	201 202	45.0	2770	< 2	123	< 1	7	7160	24	1030
A 11.6	201 202	33.0	2320	< 2	83	< 1	8	5690	18	762
A 12.6	201 202	1.0	22	< 2	36	< 1	4	66	2	98
A 12.7	201 202	1.0	8	< 2	45	< 1	4	24	< 2	94
A 12.8	201 202	0.2	< 2	< 2	18	< 1	3	18	< 2	58
A 12.9	201 202	0.8	6	< 2	24	< 1	3	16	< 2	90
A 13.0	201 202	1.0	4	< 2	29	< 1	4	12	< 2	140
A 13.1	201 202	1.2	8	< 2	64	< 1	5	24	< 2	510

CERTIFICATION: *Hart Buchler*



# Chemex Labs Ltd.

Analytical Chemists \* Geochemists \* Registered Assayers  
 212 Brooksbank Ave., North Vancouver  
 British Columbia, Canada V7J 2C1  
 PHONE: 604-984-0221 FAX: 604-984-0218

To: CURRIE, DAVID

4462 S.E. MARINE DR.  
 BURNABY, BC  
 V5J 3G2

Project :  
 Comments: ATTN: DAVID CURRIE

Page Number : 2  
 Total Pages : 2  
 Certificate Date: 15-APR-97  
 Invoice No. : 19719908  
 P.O. Number :  
 Account : MLI

<b>CERTIFICATE OF ANALYSIS</b>	<b>A9719908</b>
--------------------------------	-----------------

SAMPLE	PREP CODE	Ag ppm	As ppm	Bi ppm	Cu ppm	Hg ppm	Mo ppm	Pb ppm	Sb ppm	Zn ppm
A 13.2	201 202	0.2	8	< 2	81	< 1	4	32	< 2	530
A 13.3	201 202	0.6	2	< 2	101	< 1	9	26	< 2	870
A 13.4	201 202	0.8	8	< 2	129	< 1	15	22	< 2	1815
A 13.5	201 202	0.8	12	< 2	73	< 1	12	20	< 2	836
A 13.6	201 202	1.0	10	< 2	65	< 1	11	26	< 2	680
A 13.7	201 202	1.0	6	< 2	81	< 1	9	20	< 2	726
A 13.8	201 202	1.0	< 2	< 2	31	< 1	3	12	< 2	176
A 13.9	201 202	0.4	6	< 2	35	< 1	6	20	< 2	338
A 14.0	201 202	0.2	2	< 2	27	< 1	7	22	< 2	148
A 14.1	201 202	0.8	4	< 2	40	< 1	6	18	< 2	236
A 14.2	201 202	1.6	2	< 2	54	< 1	3	10	< 2	630
A 14.3	201 202	0.2	2	< 2	29	< 1	2	6	< 2	516
A 14.5	201 202	0.4	8	< 2	35	< 1	4	18	< 2	108
A 14.6	201 202	0.6	10	< 2	85	< 1	10	24	< 2	1115

CERTIFICATION: David Currie

4-1

### INTERPRETATION

All samples were taken consistently, from the same horizon. Their locations were chained and plotted on the map drawn by David J. Currie, with the aid of field time and topographical maps.

Number of samples analyzed: 182

It is intended to be a preliminary examination of the Silver Apex Property: topography, mineralization, occurrence and location of the Noonday Utica Lode, and to determine the best location and method of future exploration on the property.

The Silver Apex is a large project and only preliminary data has been achieved to date.

### CONCLUSIONS

There is sufficient data on part of the property to suggest further geochem is desireable.

Background or average values on that part of the property have been determined to be:

Ag 0.5 Pb 22 Zn 129 Cu 43.5

The area located between lines XW and ZY show generally higher than background values for Ag,Pb,Zn,Cu. The lode system is exposed in this section as shown on the map. More data needs to be collected to determine if the lode is the reason for these higher values.

Area shown as **A** in section 3N3E has some unusual Ag,Pb,As,Zn,Cu values; especially the heavier metals. More samples should be taken to support these values and to determine if further examination is warranted. The reason for these anomalic values should be determined.

More background samples should be collected.

The indicated strike should be further explored.

The effect of the road and other major surface disturbances should be examined in relation to geochem values.

A grid pattern of sample locations should be emphasized.

STATEMENT OF COSTS

NOVEMBER 9, 1996

SILVER APEX PROJECT

1 MAN @ \$175 / DAY - 5 DAYS		\$ 875. -
ASSAY / GEOCHEM	394.35	858.80
	464.45	
PAC ACCOUNT		780. -
MAPS, PHOTOCOPIES, MATERIALS, etc.		90. -
		<u><u>\$ 2,603.80</u></u>



### Qualifications of the Author

The Author, David J. Currie, is a resident of British Columbia, and:

- 1) Attended the University of British Columbia and has four years science education, including a one year course in applied geology.
- 2) Has worked and supervised exploration and development in the Slocan Mining Camp for 10 years.
- 3) Properties the author worked on include predominantly the Payne Mine and Silver Apex Project.
- 4) Is the holder of a B.C. Free Miners Certificate since 1984.

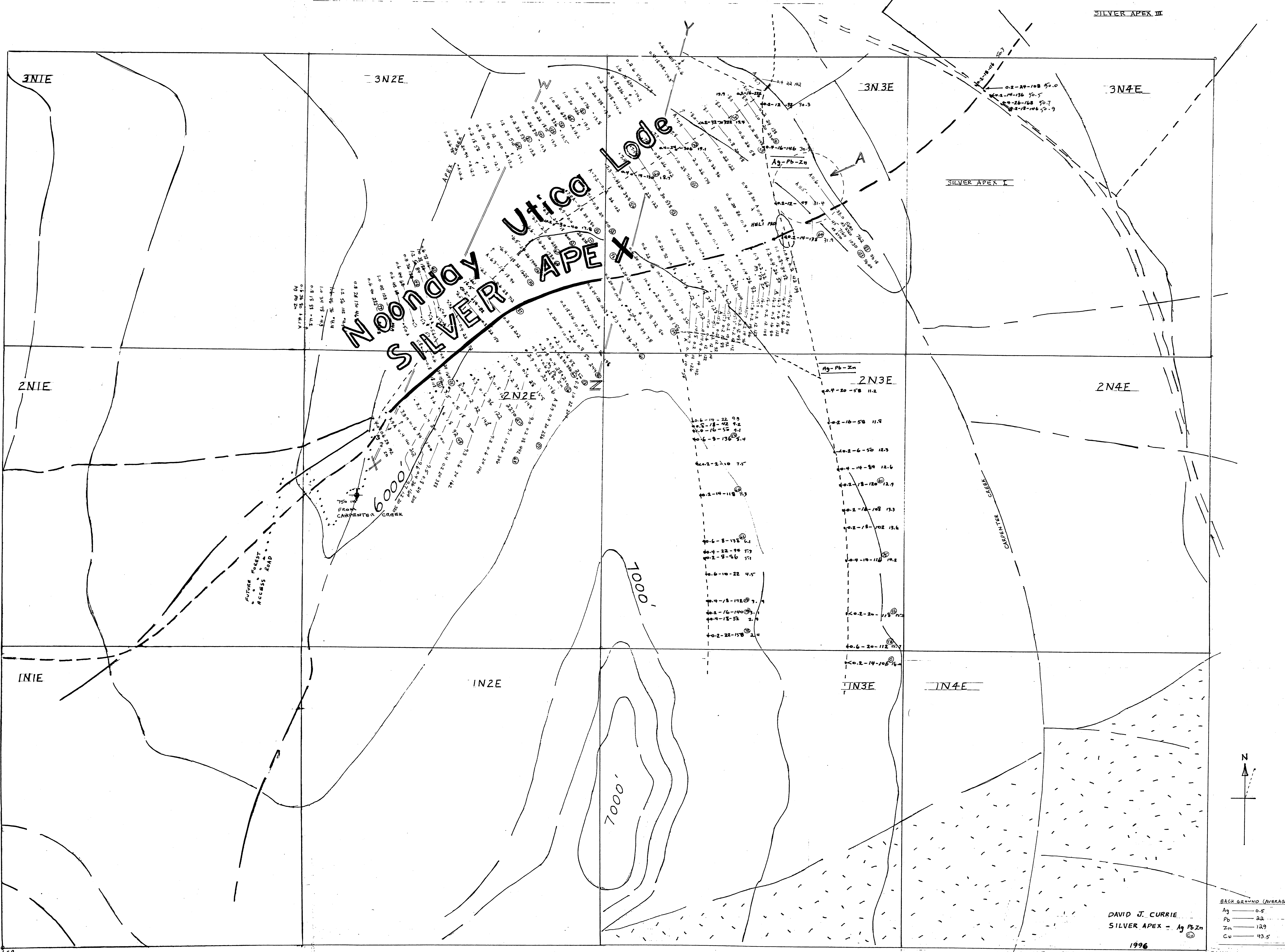

SILVER APEX III

3N1E

3N2E

3N3E

3N4E

2N1E

2N2E

2N3E

2N4E

1N1E

1N2E

1N3E

1N4E

FUTURE FOREST ACCESS ROAD

750' FROM CARPENTER CREEK

6000'

7000'

CARPENTER CREEK

Ag-Pb-Zn

Ag-Pb-Zn

DAVID J. CURRIE  
SILVER APEX - Ag Pb Zn

1996

BACK GROUND (AVERAGE)

Ag	0.5
Pb	22
Zn	129
Cu	43.5

SCALE 1:20