

INTERNATIONAL SKYLINE GOLD CORPORATION

**SUMMARY OF 1995 EXPLORATION WORK ON THE
JOHNNY MOUNTIAN PROJECT**

**FOR
EXPLORE B.C.**

**BY
SANDY MARTIN, B.A.Sc.**

February 22, 1996

**GEOLOGICAL SURVEY BRANCH
ASSESSMENT REPORT**

25,372

RECEIVED
E. *Abb*
MAR 1 1 1996
**EXPLORE B.C. PROGRAM
MEMPR**

TABLE OF CONTENTS

TABLE OF CONTENTS	1
1.0 INTRODUCTION	1
2.0 HISTORY	1
3.0 THE 1995 EXPLORATION PROGRAM	3
4.0 CONCLUSIONS.....	3

1.0 INTRODUCTION

During September and October of 1995, International Skyline Gold Corporation conducted exploration on the on its Johnny Mountain Gold property. The Johnny Mountain property is located in northwestern British Columbia in the Iskut River Region, 6 km south of Cominco's Snip mine (figure 1).

2.0 HISTORY

In the periods of the Cassiar and Klondike gold rush (1873-75 and 1896-1900 respectively), the Stikine River served as a major access route to the gold fields. During this time, the Iskut River, which joins the Stikine 40 km downstream, was surveyed by International Boundary survey crews. Several prominent, regional topographic structures were identified by these surveys, including Johnny Mountain .

The first claims in the area were staked by the Iskut Mining Company of Wrangell Alaska in 1907. The 9 original claims (known as the Iskoot claims), covered the west side of Bronson Creek on Johnny Ridge, three kilometers southeast of the present Snip Mine. The Red Bluff claim group, 5 kilometers northeast of the Johnny Mountain property, was staked in 1909. Between 1908 and 1911, a number of short adits were developed and some trenching was carried out on both claim groups. One ton of material extracted from the Iskoot group was assayed and yielded approximately 1.9 grams Au, 44.2 ounces Ag, and 12.4% Cu.

Cominco staked 42 claims in 1929 around the Iskoot and Red Bluff groups but found nothing of interest and abandoned the claims. In 1949 a brief prospecting program was carried out by the Kennco Exploration Company on Bronson Creek and the Lower Crown Grants.

The Stonehouse deposit (Johnny Mountain Mine), on Johnny Mountain, was discovered in 1954 by the Hudsons Bay Mining and Smelting Company. Between August 1988 and September of 1990 the Johnny Mountain mine was operated by the Skyline Gold Corporation and mined 207, 058 tonnes of ore yielding 2.91 tonnes of gold, 4.56 tonnes of silver, and 973 tonnes of copper.

The mine reopened for three months in the fall of 1993 (from September to November) and mined 24,027 tons of ore at a grade of 0.33 oz/ton gold, 0.77 oz/ton silver, and 0.24% copper.

Extensive exploration has been carried out throughout the area of the Johnny Mountain mine by several companies. Numerous showings that were trenched and drilled by Skyline Gold Corporation include: SMC, Bonanza, CE, C-1, C-2, C-3, Road and Mike showings. Other significant exploration projects include Inel (Gulf International Minerals Ltd.) 11 km southwest of Snip, and the



FIGURE 1

INTERNATIONAL SKYLINE GOLD CORPORATION

JOHNNY MOUNTAIN PROPERTY

LOCATION MAP

Scale 1:2 000 000	Date
Ref.	

Rock and Roll (Black Dog deposit, owned by Eurus Resource Corp. and Thios Resources Inc.), 10 km to the northwest. Keewatin Engineering Inc. carried out exploration on the Handel and Chopin claim groups to the east of Snip on behalf of Solomon Resources between 1988 and 1991.

International Skyline Gold Corporation has conducted exploration, and applied for a permit to develop the Bronson Slope Deposit (previously the Red Bluff) 4.5 km north of Johnny Mountain. The proposed Bronson project will be an open cast, low grade, gold, copper, silver, molybdenum mine.

3.0 THE 1995 EXPLORATION PROGRAM

In September of 1995, International Skyline conducted a surface sampling program on its Johnny Mountain Property. The study was completed by Lou Straith, a geologist employed by International Skyline. Past exploration has discovered mineralised boulders in till on Johnny Mountain, containing vein material similar to the veins found in the Stonehouse Deposit. This has become known as McFadden Zone till and indicates the presence of veins, with metal contents similar to those found in the Johnny Mountain Mine, lying south of Stonehouse under the glacier. Glacial retreat over the summer months of 1995 revealed a previously unsampled area containing mineralized till (see figure 2, Appendix 1). Samples were taken from the toe of the glacier and assayed at Cominco's Snip operation. The results of these samples can be seen in Appendix 1.

A re-examination of drill core from the 1988 drilling program revealed a high grade intersection near the collar of hole 954S (see figure 3, Appendix 2). Between the hole lengths of 2.1 and 6.5 meters, gold grades averaged 44.34 ppm. A trenching program was proposed to investigate this discovery and was conducted by Lou Straith, a geologist employed by International Skyline. Thirty-five channel samples were taken and assayed at Cominco's Snip facility. The results and sketches of trench diagrams are shown in Appendix 2.

4.0 CONCLUSIONS

International Skyline is encouraged by the findings from surface samples on Johnny Mountain and will continue to sample from freshly exposed glacial till. The results from the trenching program failed to identify a near surface high grade zone.

The Company intends to continue exploration on Johnny Mountain. A diamond drilling program is anticipated for the summer of 1996 involving surface and underground diamond drilling.

Respectfully Submitted,

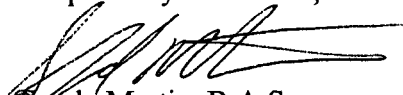

Sandy Martin, B.A.Sc.

APPENDIX 1

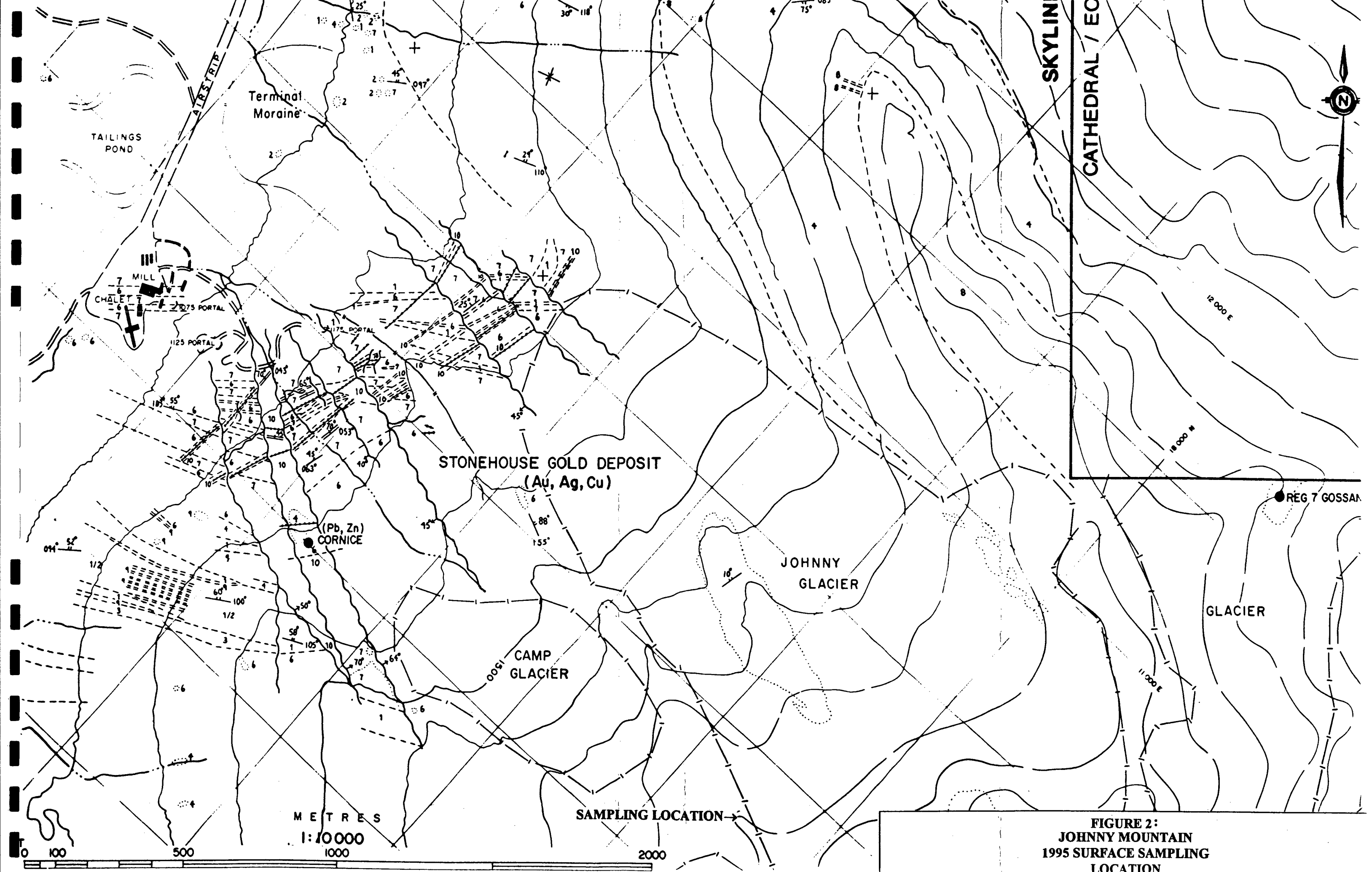

**FIGURE 2:
JOHNNY MOUNTAIN
1995 SURFACE SAMPLING
LOCATION**

COMINCO METALS

SNIP OPERATIONS

ASSAY LABORATORY REPORT

DATE 30-Sep-85

SKYLINE

JOB #: _____

SAMPLE #	Au g/t				
4308	0.05				
4309	0.47				
4310	0.09				
4311	0.04				
4312	0.12				
4313	0.37				
4314	0.41				
4315	8.73				
4316	0.19				
4317	0.11				
4318	0.13				
4319	0.06				
4320	0.16				
4321	0.04				
4322	0.07				
4323	0.12				



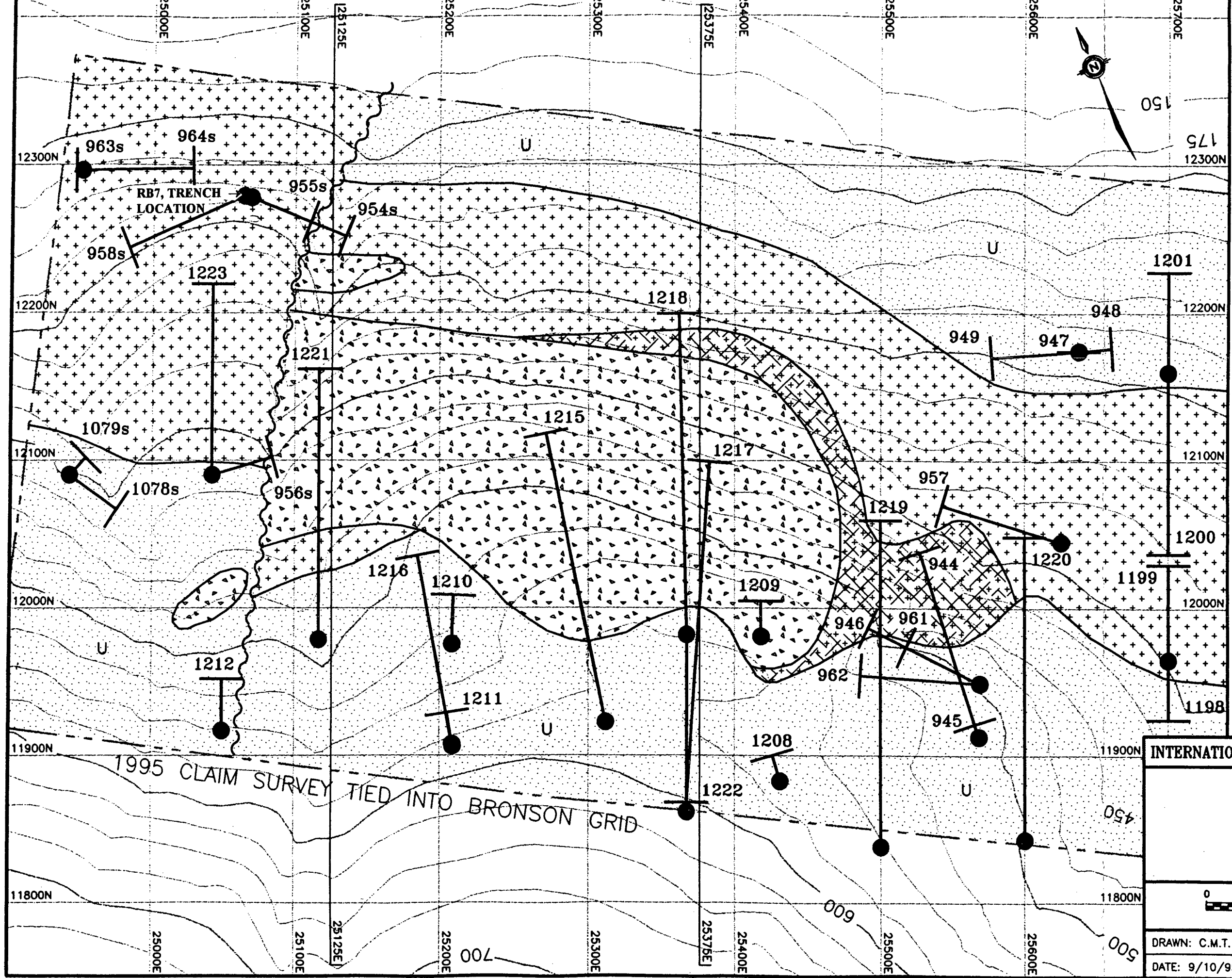

DEREK A. BLUNDELL
CERTIFIED ASSAYER: Derek A Blundell
PROVINCE OF BRITISH COLUMBIA

APPENDIX 2





LEGEND

LITHOLOGY

-  Quartz Magnetite Replacement &/or Breccia
-  Quartz Magnetite Stockwork after Previous Rock Types
-  Red Bluff Porphyry intrusive
-  Sedimentary Rocks
 - U - undifferentiated
 - A - Biotite carbonate alteration
 - B - Biotite chlorite hornfels
 - C - Potassium feldspar alteration.

SYMBOLS

-  Drill Hole Trace
-  Fault
-  Claim Boundary

INTERNATIONAL SKYLINE GOLD CORPORATION

1995 RB7
TRENCHING
LOCATION

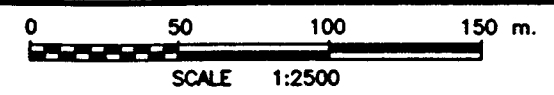

DRAWN: C.M.T. / D.Y.	Filename: Fig2-1.dwg	Figure
DATE: 9/10/95	NTS: 104B/11	3

PANEL NO.	SAMPLE NO.	Au (g/t)
1	4264	0.36
2	4265	0.15
3	4266	0.16
4	4267	0.22
5	4268	0.14
6	4269	0.16
7	4270	0.17
8	4271	0.17
9	4272	0.18
10	4273	0.16
11	4275	0.40
12	4274	0.17
13	4276	0.18
14	4277	0.12
15	4278	0.08
16	4279	0.09
17	4280	0.06
18	4281	0.13
19	4282	0.08
20	4283	0.09
21	4284	0.18
22	4285	0.10
23	4286	0.16
24	4287	0.15
25	4288	0.15
26	4289	0.13
27	4290	0.20
28	4291	0.12
29	4292	0.11
30	4293	0.16
31	4259	0.17
32	4260	0.19
33	4261	0.15
34	4262	0.42
35	4263	0.15

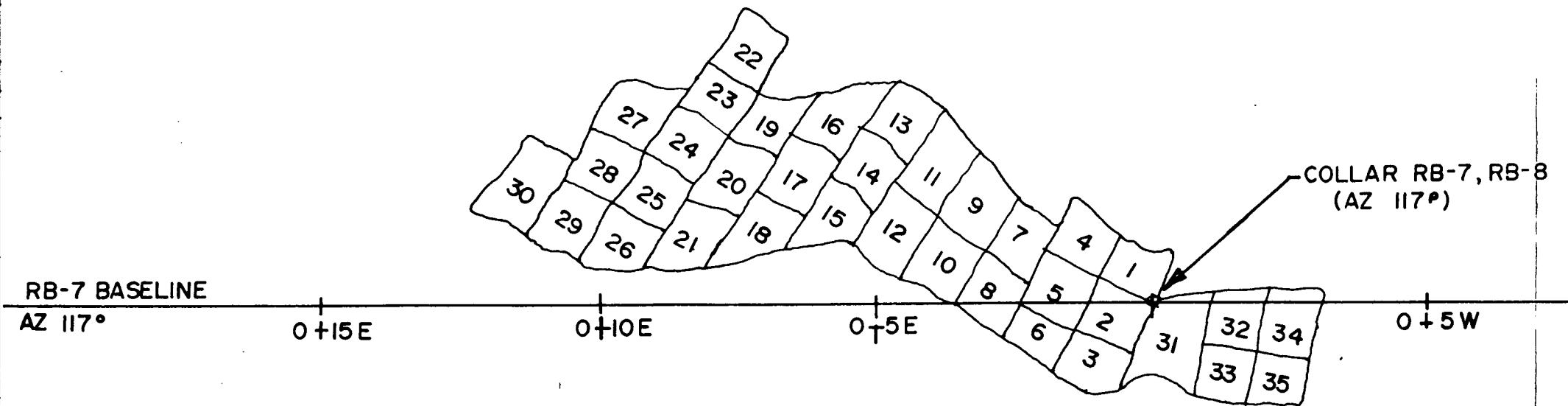

SKYLINE GOLD CORPORATION
Johnny Mountain Project

Compiled By: L.D.S.
Drawn By: L.D.S.

Date Compiled: 25/08/95
Date Drawn: 11/01/96

Title: BRONSON SLOPE - RB-7 SHOWING (LOOKING SOUTH)

Scale:
1:100

RB-7 BASELINE

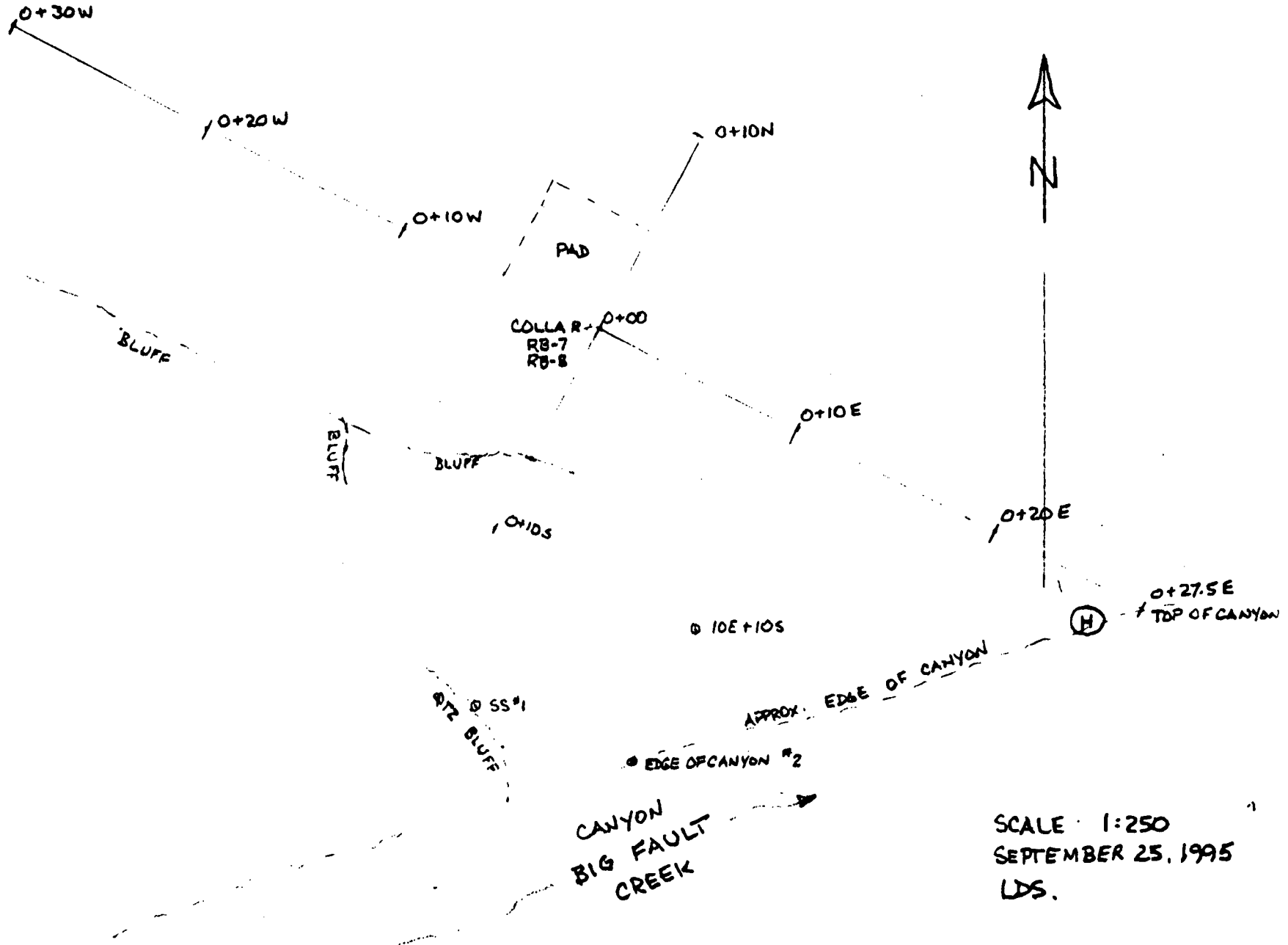

SCALE: 1:250
SEPTEMBER 25, 1995
LDS.

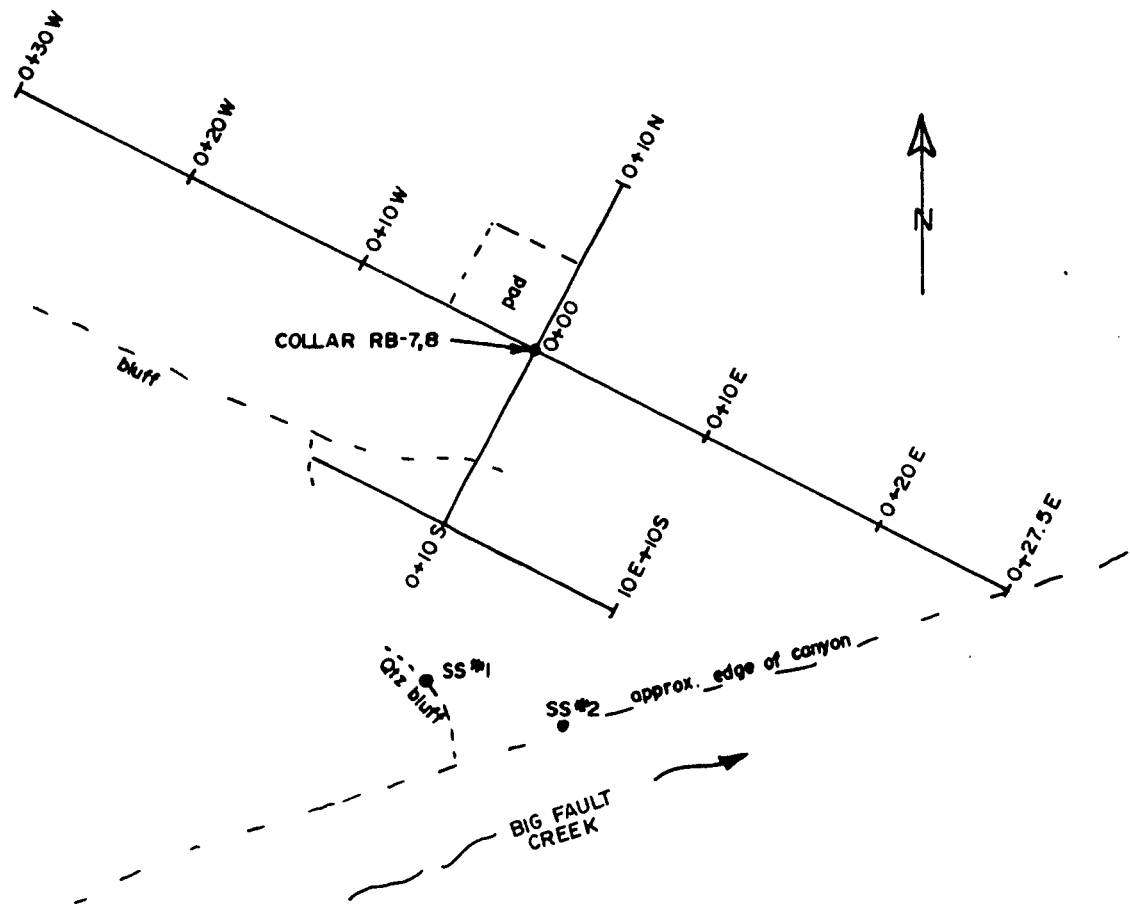

 SKYLINE GOLD CORPORATION Johnny Mountain Project	Compiled By: L.D.S.	Date Compiled: 25/08/95	Title: BRONSON SLOPE RB-7 BASELINE	Scale: 1:250
	Drawn By: L.D.S.	Date Drawn: 11/01/96		

COMINCO METALS

SNIP OPERATIONS

ASSAY LABORATORY REPORT

DATE 26-Sep-85

SKYLINE

JOB #: _____

SAMPLE #	Au g/t					
4251	0.61					
4252	0.44					
4253	0.35					
4254	0.63					
4255	1.01					
4256	0.54					
4257	0.39					
4258	0.60					
4259	0.17					
4260	0.19					
4261	0.15					
4262	0.42					
4263	0.15					
4264	0.36					
4265	0.15					
4266	0.16					
4267	0.22					
4268	0.14					
4269	0.16					
4270	0.17					
4271	0.17					
4272	0.18					
4273	0.16					
4274	0.17					

DEREK A. BLUNDELL
CERTIFIED ASSAYER: *Derek A Blundell*
PROVINCE OF BRITISH COLUMBIA

SNIP OPERATIONS

ASSAY LABORATORY REPORT

DATE 29-Sep-95

SKYLINE

JOB #: _____

SAMPLE #	Au g/t				
4275	0.40				
4276	0.18				
4277	0.12				
4278	0.08				
4279	0.09				
4280	0.06				
4281	0.13				
4282	0.08				
4283	0.09				
4284	0.18				
4285	0.10				
4286	0.16				
4287	0.15				
4288	0.15				
4289	0.13				
4290	0.20				
4291	0.12				
4292	0.11				
4293	0.16				
4301	0.13				
4302	0.09				
4303	0.11				
4304	0.13				
4305	0.11				
4306	0.11				
4307	0.13				

DEREK A. BLUNDELL
 CERTIFIED ASSAYER: *Derek A. Blundell*
 PROVINCE OF BRITISH COLUMBIA