

RECEIVED

AUG 14 1998

Gold Commissioner's Office
VANCOUVER, B.C.

DIAMOND DRILLING REPORT

on the

BEATON MINERAL CLAIMS

Kamloops Mining Division
British Columbia

N.T.S. 092I/10E
Latitude 50° 41' N
Longitude 120° 37' W

for

operator:
GREEN VALLEY MINES INC.
2245 West 13th Avenue
Vancouver, B.C.
V6K 2S4

owner:
Mr. Charles Boitard
2245 West 13th Avenue
Vancouver, B.C.
V6K 2S4

by

P. REYNOLDS, B.Sc., P.Geo.
07 August 98

GEOLOGICAL SURVEY BRANCH
ASSESSMENT REPORT

25,615

TABLE OF CONTENTS

1.	SUMMARY	3
2.	INTRODUCTION	3
3.	LOCATION, ACCESS AND PHYSIOGRAPHY	3
4.	CLAIM STATUS	4
5.	HISTORY	4
6.	GEOLOGY	5
7.	DIAMOND DRILLING	5
8.	CONCLUSION AND RECOMMENDATIONS	6
9.	REFERENCES	7
10.	CERTIFICATE	8

LIST OF FIGURES

FIGURE 1	LOCATION MAP	FOLLOWS PAGE 3
FIGURE 2	CLAIM MAP	FOLLOWS PAGE 4
FIGURE 3	REGIONAL GEOLOGY	FOLLOWS PAGE 5
FIGURE 4	DRILL PLAN	BACK POCKET
FIGURE 5	SECTION THROUGH DDH 97-1	FOLLOWS PAGE 6

APPENDICES

APPENDIX I	STATEMENT OF COSTS
APPENDIX II	DRILL LOGS

1. SUMMARY

- 1.1 The Beaton property consists of 18 contiguous mineral claims totalling 134 units. The claims are located approximately five kilometres west of the former producing Afton Mine and 18 kilometres west of the town of Kamloops, B.C. The claims are accessible by good gravel roads from Kamloops.
- 1.2 The property is underlain for the most part by andesites of the Nicola Volcanics.
- 1.3 One diamond drill hole was completed in 1997 to test for copper mineralization. No economic amounts of copper mineralization were encountered.
- 1.4 Three to four lines of soil geochemistry with analysis by enzyme leach or mobile metal ion (MMI) should be conducted as an orientation. In test cases these geochemical techniques have been able to detect mineral deposits buried by up to several hundred metres of overburden and/or barren cap rock.

2. INTRODUCTION

- 2.1 This report has been prepared at the request of Mr. Charles Boitard, President of Green Valley Mines Inc., to satisfy assessment requirements.
- 2.2 The information for the following report was obtained from sources cited under references and from the drill logs of one diamond drill hole. The drilling program was carried out by Mr. Charles Boitard between 17 October and 19 October, 1997. The Author logged the diamond drill core on the property.
- 2.3 The registered owner of the Beaton claims is Mr. Charles Boitard. The claims are being operated by Green Valley Mines Inc. The claims lie approximately 18 kilometres west of Kamloops, B.C. This area is known for its porphyry copper and molybdenum production from both volcanic and intrusive host rocks. Significant gold and silver has been recovered from these deposits.

3. LOCATION, ACCESS AND PHYSIOGRAPHY

- 3.1 The Beaton property is located on the Thompson Plateau approximately 18 kilometres west of Kamloops, B.C. The claims are centered at 50° 41' north latitude and 120° 37' west longitude on NTS map sheet 092I/10E. The claims are in the Kamloops Mining Division.
- 3.2 Access is provided by the Trans-Canada Highway and then south along the Cherry Creek Road which branches off the highway approximately two kilometres west of the Afton Mine. Good dirt roads provide access to most of the claim area.
- 3.3 The property lies between elevations 700 to 885 metres above sea level. Vegetation consists of pockets of Pine within grasslands. Water for all stages of exploration is available from Beaton Cr  ek, the main drainage on the Beaton claims. The climate is semi-arid with an average

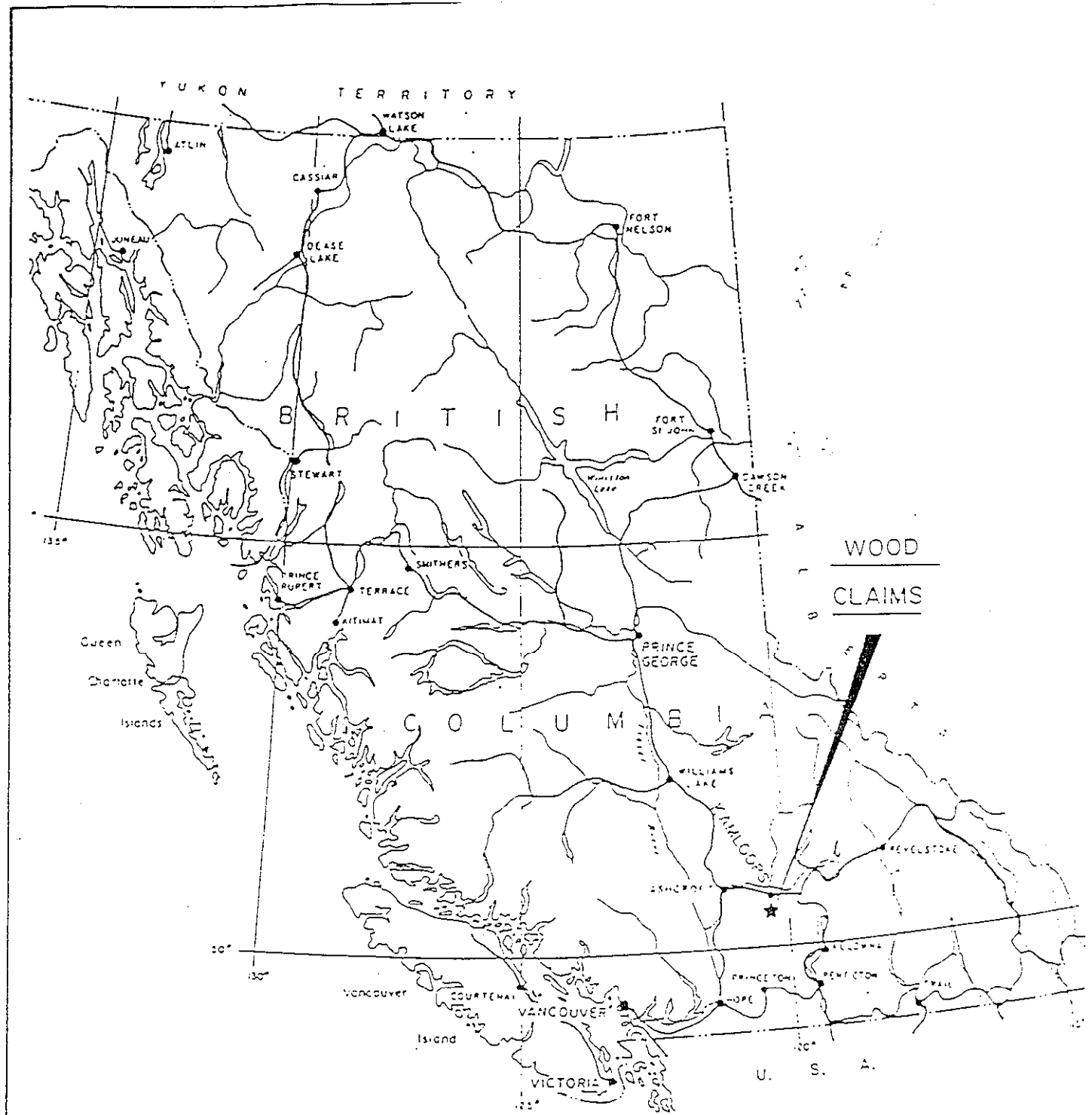

REYNOLDS GEOLOGICAL		
GREEN VALLEY MINES INC.		
LOCATION MAP		
KAMLOOPS M.D.		NTS: 0921/10E
DRAWN: P.R.	AUGUST '95	FIG. NO. 1

annual precipitation of 250 to 280 millimetres.

4. CLAIM STATUS

4.1 The Beaton property comprises 18 mineral claims totalling 134 units. Complete claim information is as follows:

Tenure No.	Name	Owner FMC	Percent ownership	Map No.	Good to Date	Mining Division	No. of Units
217821	BEATON #2	102688	100	092110E	June 15, 2002	Kamloops	20
217974	BEATON #5	102688	100	092110E	March 8, 1999	Kamloops	5
316736	ROSE #1	102688	100	092110E	March 23, 1999	Kamloops	12
316737	ROSE #2	102688	100	092110E	March 20, 1999	Kamloops	1
316738	ROSE #3	102688	100	092110E	March 20, 1999	Kamloops	1
316739	ROSE #4	102688	100	092110E	March 22, 1999	Kamloops	1
316740	ROSE #5	102688	100	092110E	March 23, 1999	Kamloops	1
316741	ROSE #6	102688	100	092110E	March 22, 1999	Kamloops	1
316742	ROSE #7	102688	100	092110E	March 23, 1999	Kamloops	1
316743	ROSE #8	102688	100	092110E	March 23, 1999	Kamloops	1
316745	ROSE #10	102688	100	092110E	March 19, 1999	Kamloops	1
316746	ROSE #11	102688	100	092110E	March 19, 1999	Kamloops	1
355486	DUFFY	102688	100	092110E	May 1, 1999	Kamloops	20
217820	BEATON #1	102688	100	092110E	June 15, 2002	Kamloops	20
217971	BEATON #6	102688	100	092110E	March 8, 1999	Kamloops	4
217972	BEATON #7	102688	100	092110E	March 8, 1999	Kamloops	4
217973	BEATON #4	102688	100	092110E	March 8, 1999	Kamloops	20
217970	MASKAM	102688	100	092110E	March 8, 1999	Kamloops	20

* Includes assessment currently being applied.

4.2 All claims are recorded in the name of Mr. Charles Boitard. Any legal aspect of claim ownership is beyond the scope of this report.

5. HISTORY

5.1 The Afton orebody, located five kilometres east of the Beaton claims, began production in 1977 and continued through 1991 when it was shut down for economic reasons. At start-up, Afton had drill proven ore reserves of 30.84 million tonnes grading 1.0% copper, 0.58 ppm gold and 4.19 ppm silver at a cut off grade of 0.25% copper (Carr & Reed, 1976).

5.2 In 1972, the TT claims were explored by Bow River Resources Ltd. A magnetic survey on the TT claims reportedly revealed Coast Intrusives, and Tertiary volcanics as well as Nicola Volcanics within portions of the present day Beaton claims (Sookochoff, 1992).

5.3 In 1980, Asarco completed a magnetometer survey on the Red 1-4 claims, two of which occupied a portion of the northeast corner of the present Beaton claims. The resultant magnetic highs were determined to be the result of outcroppings of Nicola volcanics. Percussion drilling in 1981 revealed chalcopyrite but no economic concentrations of copper were discovered.

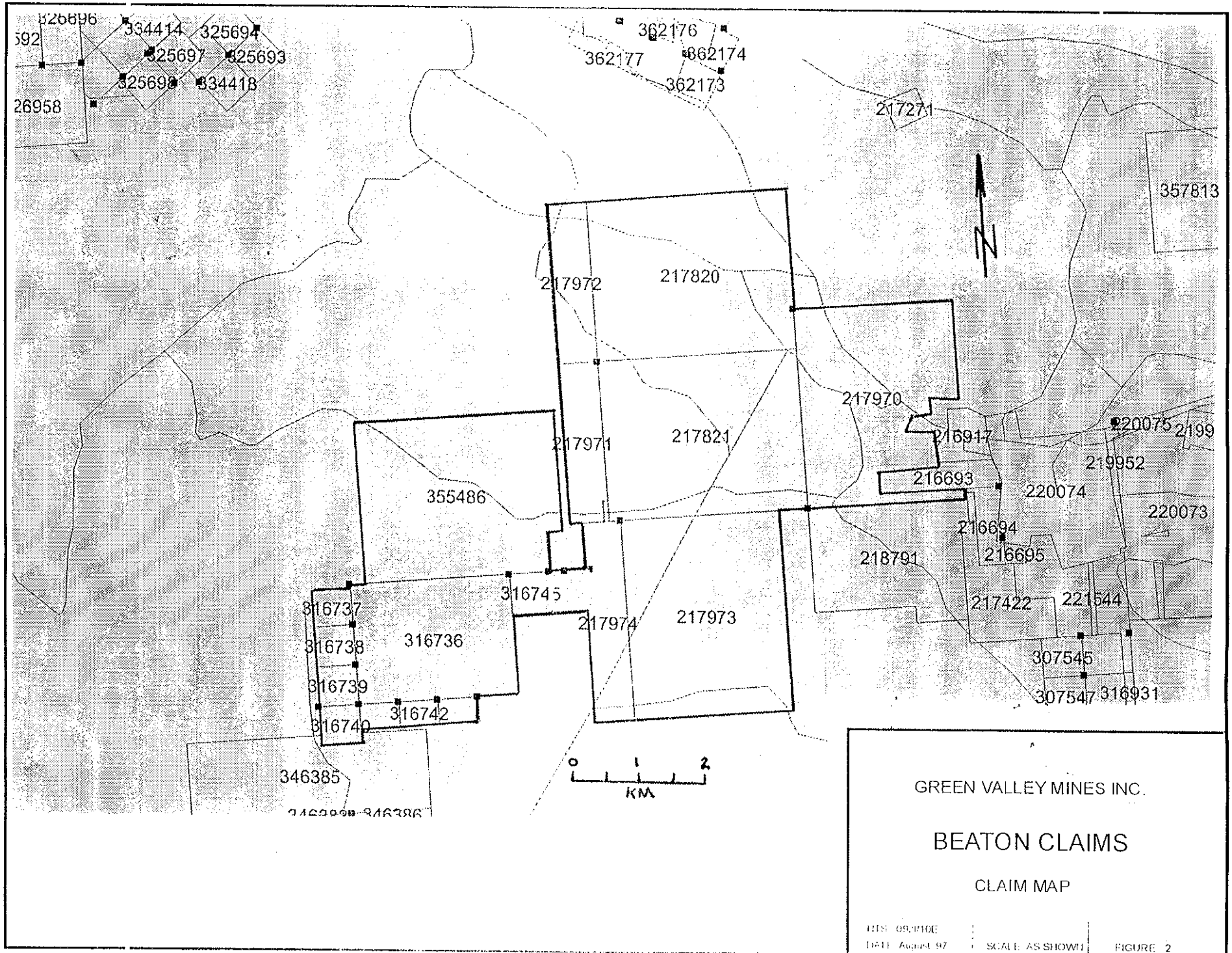

GREEN VALLEY MINES INC.
BEATON CLAIMS
 CLAIM MAP

THIS DRAWING
 DATE August 97 SCALE AS SHOWN FIGURE 2

- 5.4 In 1983, De Baca Resources explored the Akila claim which included the southwest corner of the present day Beaton claims. One diamond drill hole was completed to test a silicified shear zone that strikes 070°. This hole reportedly returned assays of nominal copper and silver.
- 5.5 Since 1987 exploration on the Beaton claims has consisted of IP surveys, localized soil geochemical surveys and the drilling of nine percussion drill holes in 1992, three percussion holes and one diamond drill hole in 1993. Further diamond drilling and percussion drilling was completed in 1994 and 1995.

6. GEOLOGY

- 6.1 The Beaton claims lie within the Quesnel Trough, a 30 to 60 kilometre wide belt of Lower Mesozoic volcanic and related sedimentary rocks bounded by older sedimentary rocks of the Cache Creek Group to the east and younger Coast Intrusions to the west. In the area of the Beaton claims the Quesnel Trough is dominated by Upper Triassic Nicola Group andesites, basalts, tuffs and argillites. The Nicola Group is intruded by Upper Triassic - Lower Jurassic diorite, syenite and monzonite of the Iron Mask Batholith. This batholith represents a major northwest trending structure that crosscuts the north-northwesterly trending Nicola volcanics. Portions of this area are obscured by later plateau lavas.
- 6.2 Bedrock exposure in this area amounts to only about ten percent, the rest being covered by glacial drift deposited from Pleistocene ice sheets that moved from northwest to southeast.
- 6.3 No systematic, property scale geological mapping has been carried out on the property. The Beaton #2 claim is underlain by andesite of the Nicola Group and quartz monzonite of the Iron Mask pluton. A rhyolite flow was observed, by the author, near percussion drill hole 93-3.

7. DIAMOND DRILLING

- 7.1 During the period 17 October to 19 October, 1997, one diamond drill hole was completed on the Beaton #2 claim. The drill hole was drilled at azimuth 185° and dips 65° from the horizontal. The hole was drilled to a total depth of 246.04 metres. The drill hole location is plotted on Figure 4.
- 7.2 Drilling was supervised by Mr. Charles Boitard, President of Green Valley Mines Inc. The hole was logged by the author on 28 October, 1997. Core size is NQ. The core is stored at the drill site. Drill logs are included in appendix II.

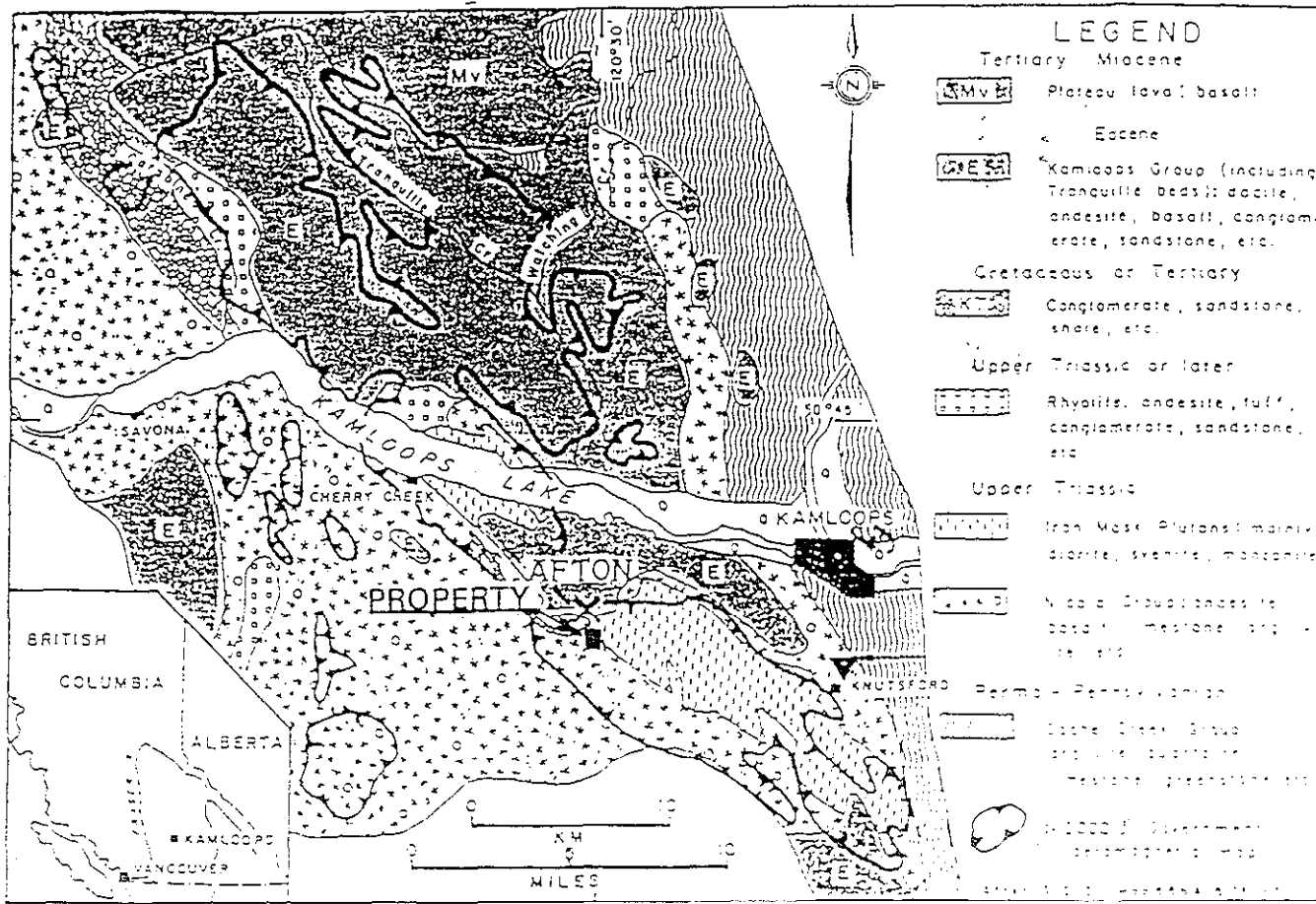

REYNOLDS GEOLOGICAL			
GREEN VALLEY MINES INC.			
REGIONAL GEOLOGY			
KAMLOOPS M.O.		NTS: 0921/10E	
SCALE AS SHOWN	DRAWN: P.R.	AUGUST '95	FIG. NO. 3

AFTER CARR & REED, 1976

7.3 Diamond drill hole 97-1 intersected unaltered dark green and purple andesites for most of its length. Locally, minor hematite and quartz were noted on the fractures. No core was assayed. A section through DDH 97-1 is plotted on Figure 5.

8. CONCLUSION AND RECOMMENDATIONS

8.1 The 1997 drilling program failed to delineate any significant copper mineralization however, previous percussion drilling results (PDH 92-8) contained elevated levels of gold, barite and arsenic indicating potential epithermal mineralization (Reynolds, September 8, 1993).

8.2 Three to four lines of soil geochemistry with analysis by enzyme leach or mobile metal ion (MMI) should be conducted as an orientation. In test cases these geochemical techniques have been able to detect mineral deposits buried by up to several hundred metres of overburden and/or barren cap rock.

DDH 97-1

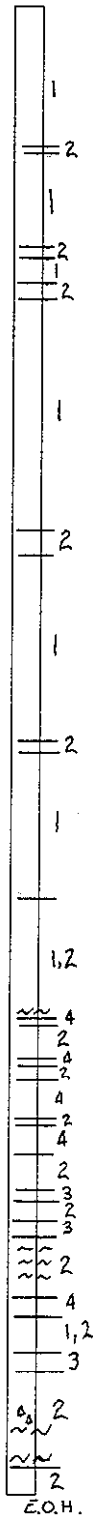

LEGEND

- 4 Andesite Dyke
- 3 Crystal Tuff
- 2 Maroon Andesite
- 1 Green Andesite

REYNOLDS GEOLOGICAL LTD.

GREEN VALLEY MINES INC.

BEATON PROPERTY
SECTION THROUGH DDH 97-1

DATE: August '97

SCALE: 1:1,250

NTS: 092/10E

FIGURE 5

10. CERTIFICATE

I, Paul Reynolds, of the city of Vancouver in the province of British Columbia do hereby certify that:

- 1) I am a Professional Geoscientist registered with the Association of Professional Engineers and Geoscientists of British Columbia.
- 2) I am a graduate of the University of British Columbia with a B.Sc. degree in geology.
- 3) I have practiced my profession as exploration geologist since graduation in 1987.
- 4) This report is based on a review of previous reports and by the Authors diamond drill log 97-1.
- 5) I have no interest, directly or indirectly, in the Beaton property or in the securities of Green Valley Mines Inc., nor do I expect to receive any interest in the future.
- 6) Permission is hereby granted to Mr. Charles Boitard and Green Valley Mines Inc. to use this report in support of any filing to be submitted to the Ministry of Energy, Mines and Petroleum Resources of the Province of British Columbia for the purpose of filing assessment on the Beaton mineral claims.

Dated this 7th day of August, 1997.

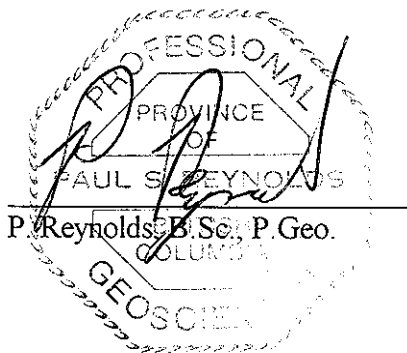

APPENDIX I

STATEMENT OF COSTS

STATEMENT OF COSTS

Diamond Drilling	246.04 metres @ \$65/m	15,993
Mob/De-mob		1,308
Truck Rental		430
Geological, Drill logging & Report		5,000
Supervision, Re-seeding and Reclamation		375
Room and Board		300

TOTAL

\$23,406

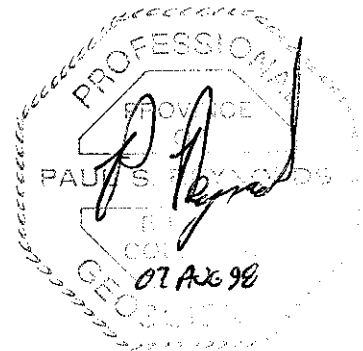

APPENDIX II

DRILL LOGS

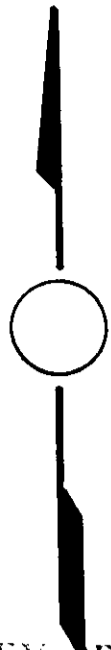

MINERAL SURVEY BRANCH
ANNUAL REPORT

25,616

50° 40'

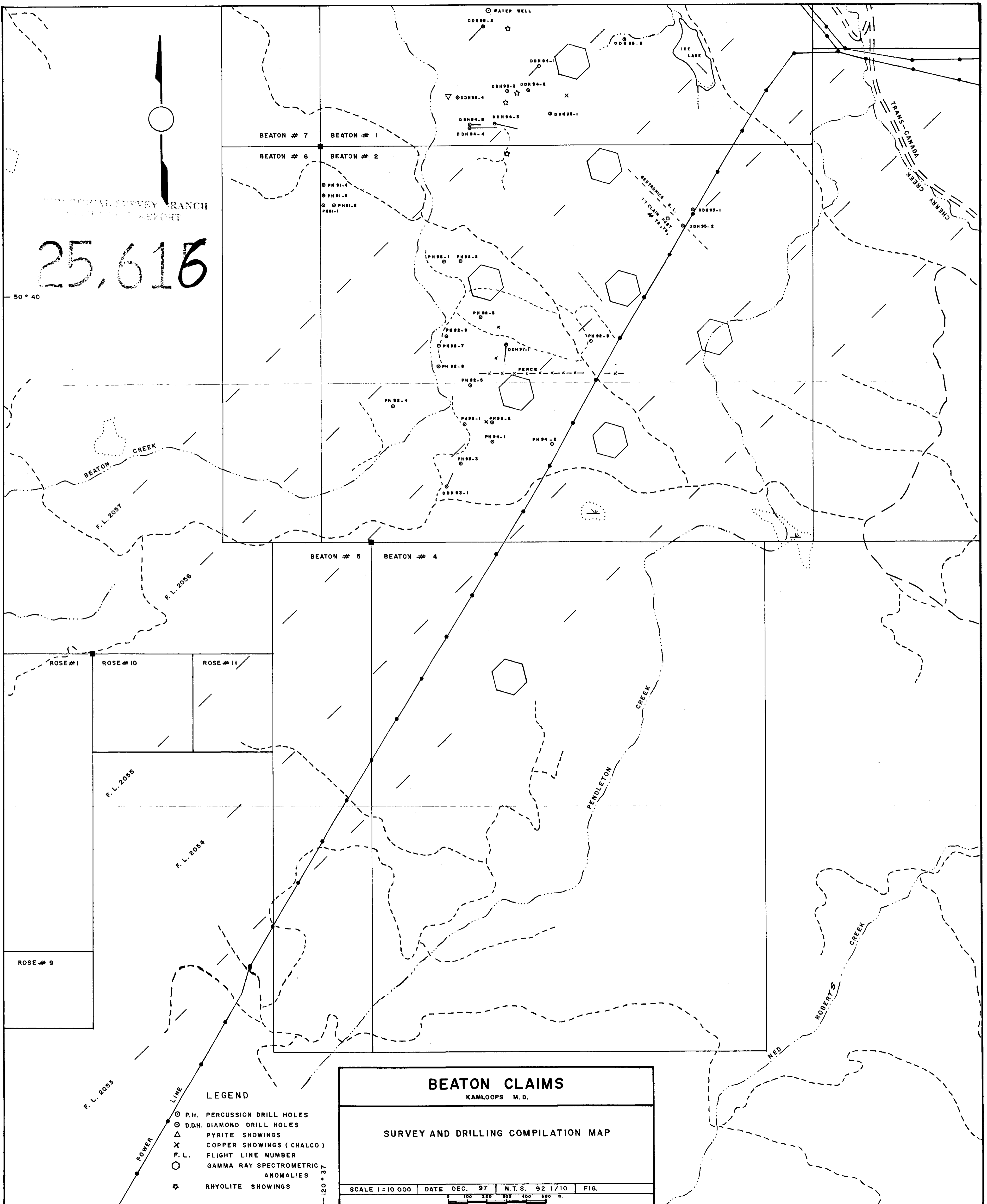

- LEGEND**
- P.H. PERCUSSION DRILL HOLES
 - ⊗ D.D.H. DIAMOND DRILL HOLES
 - △ PYRITE SHOWINGS
 - X COPPER SHOWINGS (CHALCO)
 - - - F.L. FLIGHT LINE NUMBER
 - ⬡ GAMMA RAY SPECTROMETRIC ANOMALIES
 - ★ RHYOLITE SHOWINGS

BEATON CLAIMS
KAMLOOPS M.D.

SURVEY AND DRILLING COMPILATION MAP

SCALE 1=10 000	DATE DEC. 97	N.T.S. 92 1/10	FIG.
----------------	--------------	----------------	------

0 100 200 300 400 500 m