

[ARIS11A]

ARIS Summary Report

Regional Geologist, Cranbrook	Date Approved: 1998.10.20	Off Confidential: 1999.06.30
-------------------------------	---------------------------	------------------------------

ASSESSMENT REPORT: 25647	Mining Division(s): Fort Steele
---------------------------------	---------------------------------

Property Name: Dek B

Location:

NAD 27	Latitude: 49 14 30	Longitude: 115 44 00	UTM: 11	5454874	592200
NAD 83	Latitude: 49 14 30	Longitude: 115 44 04	UTM: 11	5455092	592116
NTS:	082G04E				

Camp:

Claim(s): Dek 13-21

Operator(s): Stephenson, L.G.
Author(s): Stephenson, L.G.

Report Year: 1998

No. of Pages: 11 Pages

Commodities Searched For: Silver, Copper, Zinc, Lead

General Work Categories: PROS

Work Done: ~~Prospecting~~
PROS Prospecting (425.0 ha.)

Keywords: Creston Formation, Helikian, Quartzites, Siltstones

Statement Nos.: 3120895

MINFILE Nos.:

Related Reports:

Report on a
Geological Prospecting Program

DEK B PROPERTY

DEK CLAIMS 13 - 21
FORT STEELE MINING DIVISION
CRANBROOK AREA
N.T.S. 82G4W

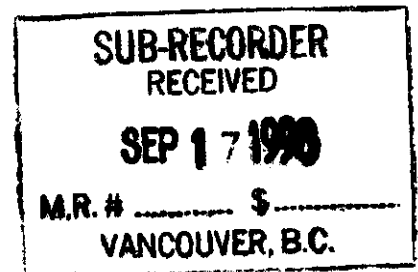

LAT: 49°15'N

LONG: 115°45'W

Work Permit # MX-5-410-0600424

OWNER

L.G. STEPHENSON

1419 133A St.
Surrey, British Columbia
V4A 6A2

Work Performed from August 1, 1997 through June 29, 1998

Report By: L. Stephenson
Submitted: September, 1998

GEOLOGICAL SURVEY BRANCH
ASSESSMENT REPORT

25,647

TABLE OF CONTENTS

	Page
1.00 Introduction	1
2.00 Location and Access	1
3.00 Geological Prospecting	2
4.00 Conclusions	2
Exhibit "A" - Statement of Expenditure	5
Affidavit	6
Author's Qualifications	7
MAPS	
Map 1 - Location Map	3
Map 2 - Location of Traverses and Showing on Claims	4
Map 3 - Prospecting Sampling Traverse Map (Attached)	

Report on a
Geological Prospecting Program

DEK 13-21 CLAIMS

FORT STEELE MINING DIVISION

L. Stephenson

August 1998

1.00 Introduction

Mr. L. Stephenson staked the DEK 13 -21 Claims in July of 1997 and under took to evaluate and locate the Southeast-northwest striking "Jake Showing" reported on the claims. This showing is projected to be on the St. Eugene Mine trend as projected from the Society Girl deposit through the "Pipeline Showing" located 1 km to northwest of the property.

A geological prospecting survey was completed to establish the actual position of the early 1990's exploration work. Rock samples were taken that are representative of the Creston rocks and the reported mineralized structure.

2.00 Location and Access

The DEK 13-21 Claims are located east southeast of the town of Moyie, British Columbia. Access is provided to the claims via the Teepee Creek logging road.

3.00 Geological Prospecting and Mapping

Geological prospecting traverses were conducted across the claims and along the pipeline to confirm the geology. The Index map (Map 2) shows the traverses and the Prospecting Traverse Sampling map (Map 3) shows the showings and outcrop areas located to date on the Claims.

Rock types identified as Lower and Upper Creston Formation underlay most of the DEK 13 - 21 Claims, but increasing float samples of Kitchener formation to the east suggests that part of the claims are underlain by that formation. No previous assessment reports have been "published" although work done in the early 1990's that discovered the initial showing outlined the Creston Formation intruded by gabbro (Moyie?) to be intimately related to the showings. Although float boulders of gabbro were identified in the area no outcrops were encountered in the prospecting traverses. Most of the gabbro float was associated with the old filled in trench areas. The Creston rocks are mainly argillite-argillaceous quartzites with a few thick quartzite units. Most of the observed outcrops consisted of thin 3 - 5 cm thick beds

The units were striking north-south with a gentle easterly dip (15-20 degrees). The best exposures of these rocks were found along the Teepee Creek road and along the uppermost logging roads in the western part of the claims (topographic high).

No structural features were noted in the traverses. More detailed geological investigation will be necessary to reveal this

The old trenches were located in obviously disturbed areas. Float material of gabbro vein material was located on DEK 17 near its eastern boundary. Along the logging roads through DEK 17 and DEK 19 mineralized outcrops were identified.

4.00 Mineralization

Mineralization has been located on the DEK 13 - 21 Claims along the topographically highest logging road and below it. Some of the old trenches were identified as areas of disturbance and definitive trench outlines were observed. The float samples located adjacent to the trenches had oxidized sulphides(?), in veins of quartz within the quartzite and siltstone of the Creston Formation. Cerussite was identified in the samples.

In the gabbro vein material, rusty oxide (after sulphide) staining was found indicating that the mineralization association is not unlike that found in the St. Eugene Mine to the west.

5.00 Conclusions

The DEK 13-21 Claims have the "Jake Showing" located in its boundaries. This showing is part of the projected trend associated with the St. Eugene Mine where it cuts the Creston rocks. The Creston rocks stratigraphically overlay the Aldridge rocks which host the main St. Eugene deposit. The mineralogy and setting is not unlike that of the St Eugene mine area, where ore shoots are associated with the mafic (Gabbro) dikes.

Further exploration is required to further evaluate these claims.



LAURENCE STEPHENSON, B.Sc., M.B.A.
P.Eng.

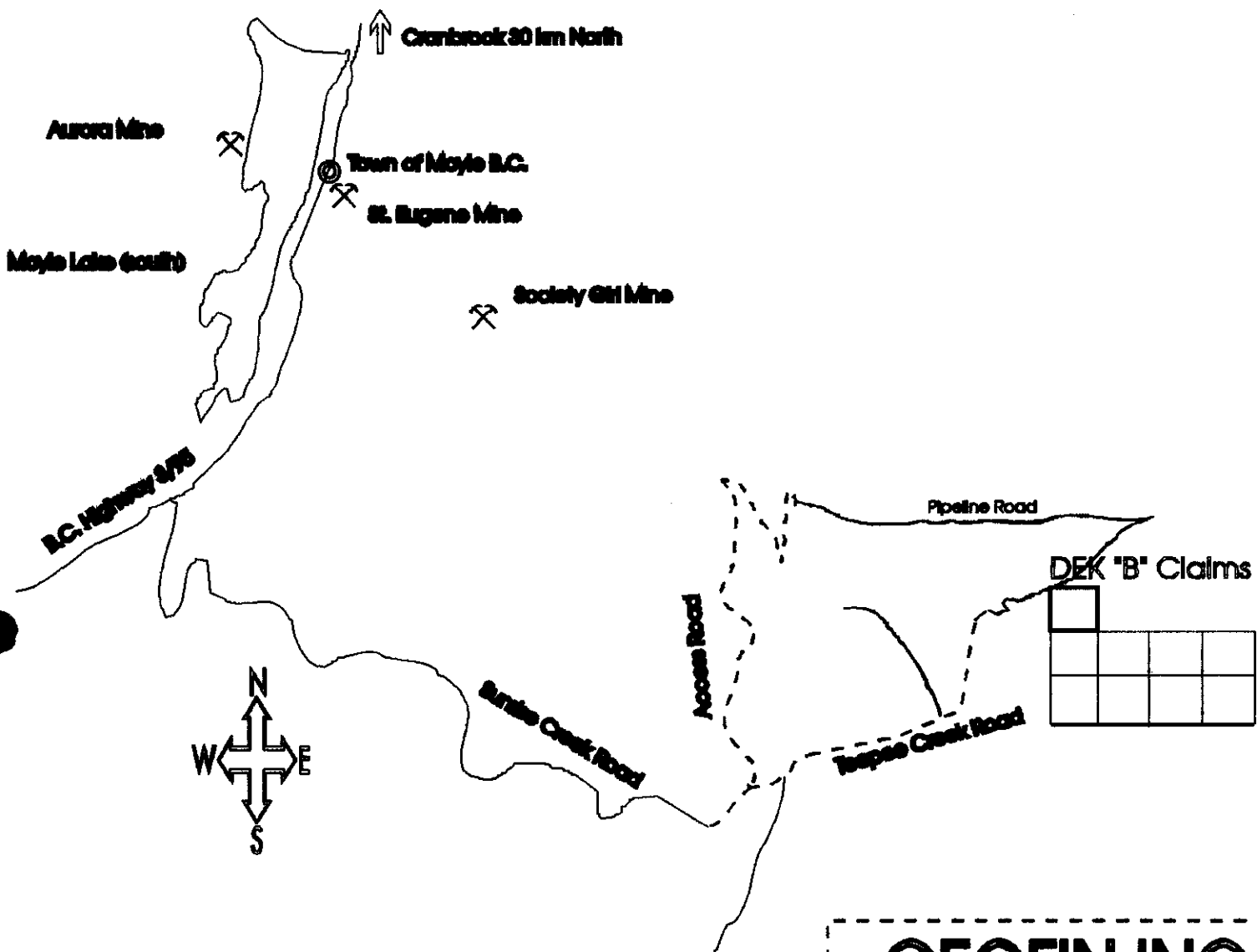

GEOFIN INC.

**MAP 1 - LOCATION OF
DEK CLAIMS
1998**

ASSESSMENT WORK

Drawn By: L. Stephenson Date: April 1998

Scale: metres

Location of Traverses and Showing on Claims **N**

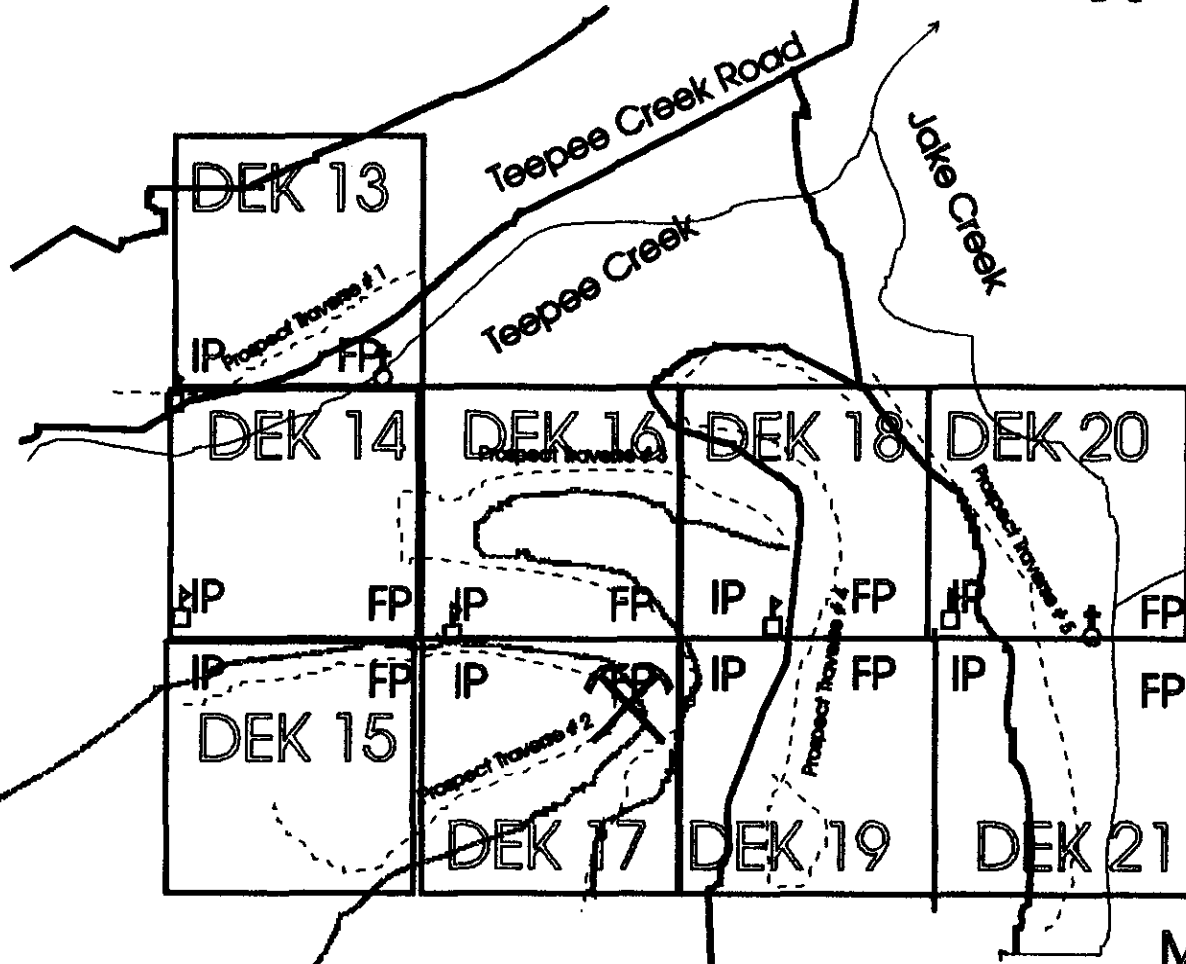

MAP 2

Prospecting Sampling Traverses
Assessment Work 1998
DEK Claim Group "B"
DEK Claims 13 - 21

Date: Aug '98

Drawn by : L. Stephenson

0 100 200 300 400 500

Metres

EXHIBIT "A"

STATEMENT OF EXPENDITURES

GEOLOGICAL PROSPECTING

**ON THE DEK 13 - 21 CLAIMS
FORT STEELE M.D.**

Covering the period of August 1st 1997 to June 28th, 1998

SALARIES:

L. Stephenson - Geologist, P. Eng. Geological Prospecting 3 days
Report writing &
Interpretation 1 Days
Map Preparation 1 Days
Travelling - 2 days
7 days @ \$400/ day \$2,800

TRANSPORTATION:

1 - 4x4 Pickup; 7 days @ \$65/day \$ 450

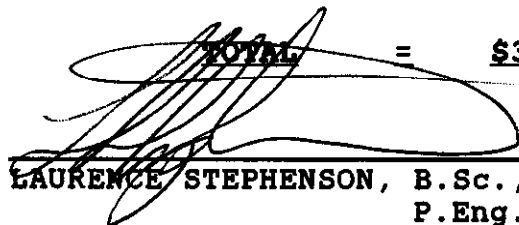
TOTAL = \$3,250
LAURENCE STEPHENSON, B.Sc., M.B.A.
P.Eng.

IN THE MATTER OF THE
B.C. MINERAL ACT
AND
IN THE MATTER OF A
GEOLOGICAL PROSPECTING PROGRAM

CARRIED OUT ON THE DEK 13-21 CLAIMS PROPERTY
MOYIE AREA
in the Fort Steele Mining Division
of the province of British Columbia
More Particularly N.T.S. 82G4W

A F F I D A V I T

I, L. Stephenson, of the City of Surrey, in the Province of British Columbia, make an oath and say:

1. That I am employed as a geologist by GeoFin Inc. and as such have a personal knowledge of the facts to which I hereinafter depose:
2. That annexed hereto and marked as Exhibit "A" to this my Affidavit is a true copy of expenditures incurred on a geological prospecting program, on the DEK 13 - 21 mineral claims;
3. That the said expenditures were incurred between the 1st day of August, 1997 and the 28th day of June, 1998 for the purpose of mineral exploration.

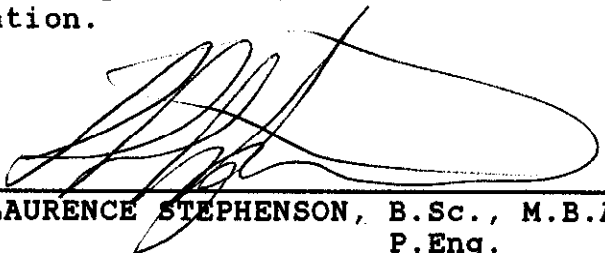
LAURENCE STEPHENSON, B.Sc., M.B.A.
P.Eng.

AUTHOR'S QUALIFICATIONS

I, Laurence Stephenson, of the City of Surrey, in the Province of British Columbia, do hereby certify that:

1. I graduated from Carleton University in 1975 with a Bachelor of Science degree in Geology then, in 1985, graduated from York University with a Masters of Business Administration;
2. I am registered as a Professional Engineer for the Province of Ontario (1981) and currently a member in good standing;
3. I have had over 30 years experience in the field of mining exploration.



LAURENCE STEPHENSON, B.Sc., M.B.A.
P.Eng.

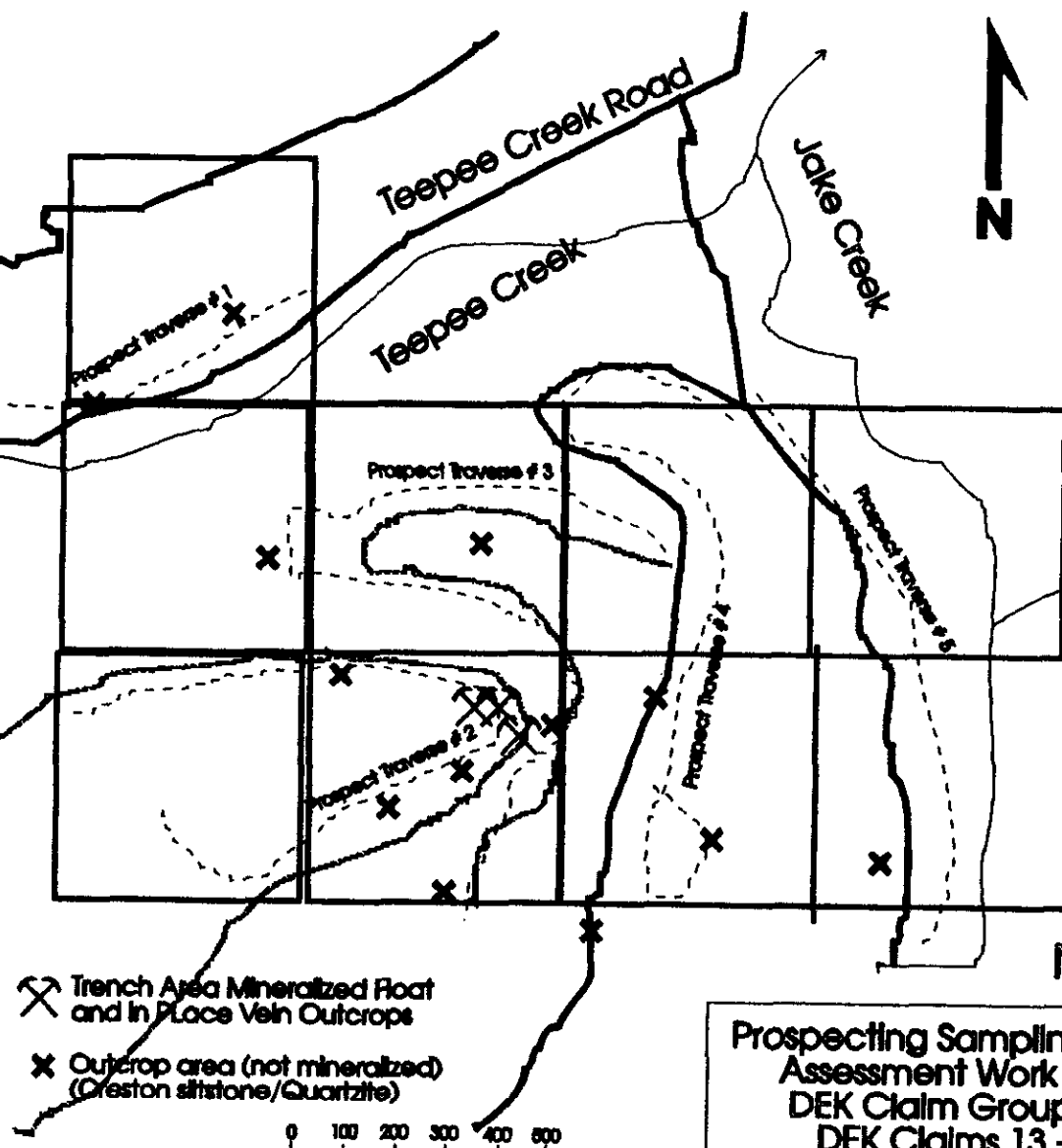

MAP 3

Prospecting Sampling Traverses Assessment Work 1998 DEK Claim Group 'B' DEK Claims 13 - 21	
Date: Aug '98	Drawn by: L. Stephenson

12
13
14
15
16
17
18
19

115°45'00"
49°15'00"

5455296

595584

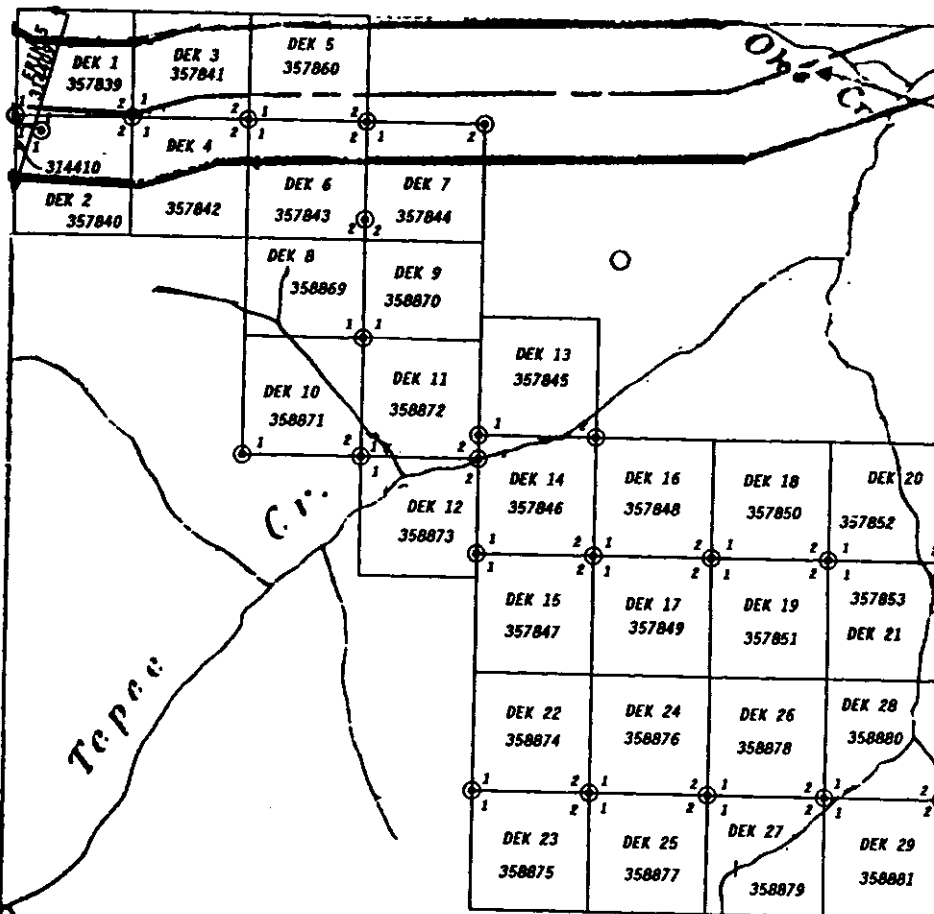

MINERAL & PLACER RESERV
% 660, 20-2-75
SUBJECT TO CONDITIONS