

GEOLOGICAL REPORT

on the

LONG BEACH CLAIMS

TEXADA ISLAND, BRITISH COLUMBIA

Longitude 124°18'10"/Latitude 49°38'14"

NTS: 92F/9W (92F.069)

Nanaimo Mining Division

Prepared for

HOMEGOLD RESOURCES LTD.

Unit 5 - 2330 Tyner St.,

Port Coquitlam, B.C.,

V3C 2Z1

Phone: 604-970-6402 / Fax: 604-944-6102

website: www.HomegoldResources.com

Prepared by

J. T. SHEARER, M.Sc., P.Geo.

Unit 5 - 2330 Tyner St.,

Port Coquitlam, B.C.,

V3C 2Z1

Phone: 604-970-6402 / Fax: 604-944-6102

E-mail: jo@HomegoldResources.com

May 15, 2001

26582

RECEIVED
JUL 15 2001
Gold Commissioner's Office
VANCOUVER, B.C.

TABLE OF CONTENTS

	<u>Page</u>
LIST OF ILLUSTRATIONS and TABLES.....	ii
SUMMARY	iii
INTRODUCTION.....	1
LOCATION and ACCESS.....	2
CLAIM STATUS.....	3
HISTORY.....	4
REGIONAL GEOLOGY.....	5
LOCAL GEOLOGY.....	7
CONCLUSIONS and RECOMMENDATIONS	9
REFERENCES.....	10
APPENDICES	
Appendix I Statement of Qualifications	12
Appendix II Statement of Costs	13

**GEOLOGICAL SURVEY BRANCH
ASSESSMENT REPORT**

26,582

LIST of ILLUSTRATIONS and TABLES
ILLUSTRATIONS and TABLES

	<u>Following</u> <u>Page</u>
FIGURE 1	Location Map, iii
FIGURE 2	Access Map,..... 1
FIGURE 3	Trim Map, 1:20,000 2
FIGURE 4	Claim Map 3
FIGURE 5	Regional Geology 6
FIGURE 6	Local Geology in pocket

TABLES

	<u>Page</u>
TABLE 1	List of Claims 8

SUMMARY

1. The Longbeach 1-10 and 17-20 two-post mineral claims were located in 1998 to cover previously discovered copper-gold showings.
2. The area is accessed by the well maintained BC Hydro road to the east side of the major high voltage transmission line and then by old logging roads in various states of disrepair.
3. The claims are underlain of chloritic Karmutsen Formation amygdaloidal volcanics, which have been intruded by a Cretaceous granodiorite stock.
4. Previous work includes old trenches and pits on irregular chalcopyrite bearing silicified zones and quartz veins. Previous surveys conducted in the past include SP, and limited soil sampling. Several small pits were blasted out for assessment purposes in 1985.
5. Previous rock samples across short widths (less than 30 cm) have previously assayed up to 0.59 oz./ton gold in copper-rich sections. Gold values attain 0.362 oz/ton in chip sampling over 30 to 60 cm.
6. Soil sampling on the Long Beach Claims was conducted in 1985 by J. T. Shearer. A total of 115 soil samples and 5 rock geochem samples were collected. Results indicate anomalous gold in soils in the southeast areas and along the Upper Creek showings. Soil profiles in the southeast zone show highly anomalous conditions increasing with depth to definite cut-offs. The southern contact between the intrusive and volcanics is characterized by a high gold in soil content.
7. The present geological mapping program consisted of traversing along the new access afforded by the recent logging of the second growth timber.
8. A program of systematic geological traverses is required to more accurately define the geological setting of the property.

Respectfully submitted,

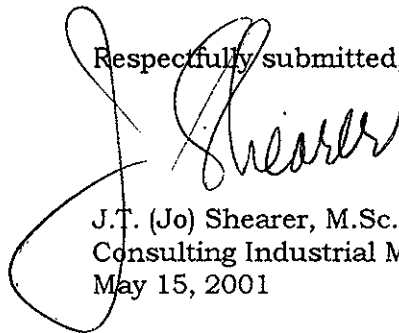

J.T. (Jo) Shearer, M.Sc., P.Geo.
Consulting Industrial Mineral Geologist
May 15, 2001

INTRODUCTION

The claims are underlain by a granodiorite to quartz diorite stock in contact with altered Karmutsen Formation mafic-rich volcanics. Chlorite and epidote alteration is common near the intrusive contact. The area is within a weak porphyry copper system and some of the precious metal values could be related to peripheral zoning of this extensive mineralizing event.

Previous work encountered anomalous gold values in soil samples, which, together with SP, magnetics and VLF EM suggest a relatively narrow linear zone trending 288°, marked by silicified and pyritized rocks in the southeast area. Discontinuous exposure of siliceous zones in the Upper Creek area indicates a narrow mineralized trend nearly perpendicular to the southeast linear. The higher gold-in-soils near the south intrusive volcanic contact found in 1981 by the writer, were checked by detail follow-up sampling in 1985 (Shearer, 1981 and 1985). Highly anomalous areas should be exposed by hand trenching and may warrant backhoe trenching.

Limited backhoe trenching was conducted in 1998 along the lower road north of the Hydro Line to determine depth and type of overburden. Subsequent to 1998 the "Dude" claims have been located to the west of the Long Beach Claims by R. Duker and associates, who are planning a bulk sample of the road quarry intrusive material at Mr. Duker's test milling facility at Priest Lake.

Access in 2001 was greatly facilitated by logging activity south of the hydro line. Old roads have been upgraded and brushed out.

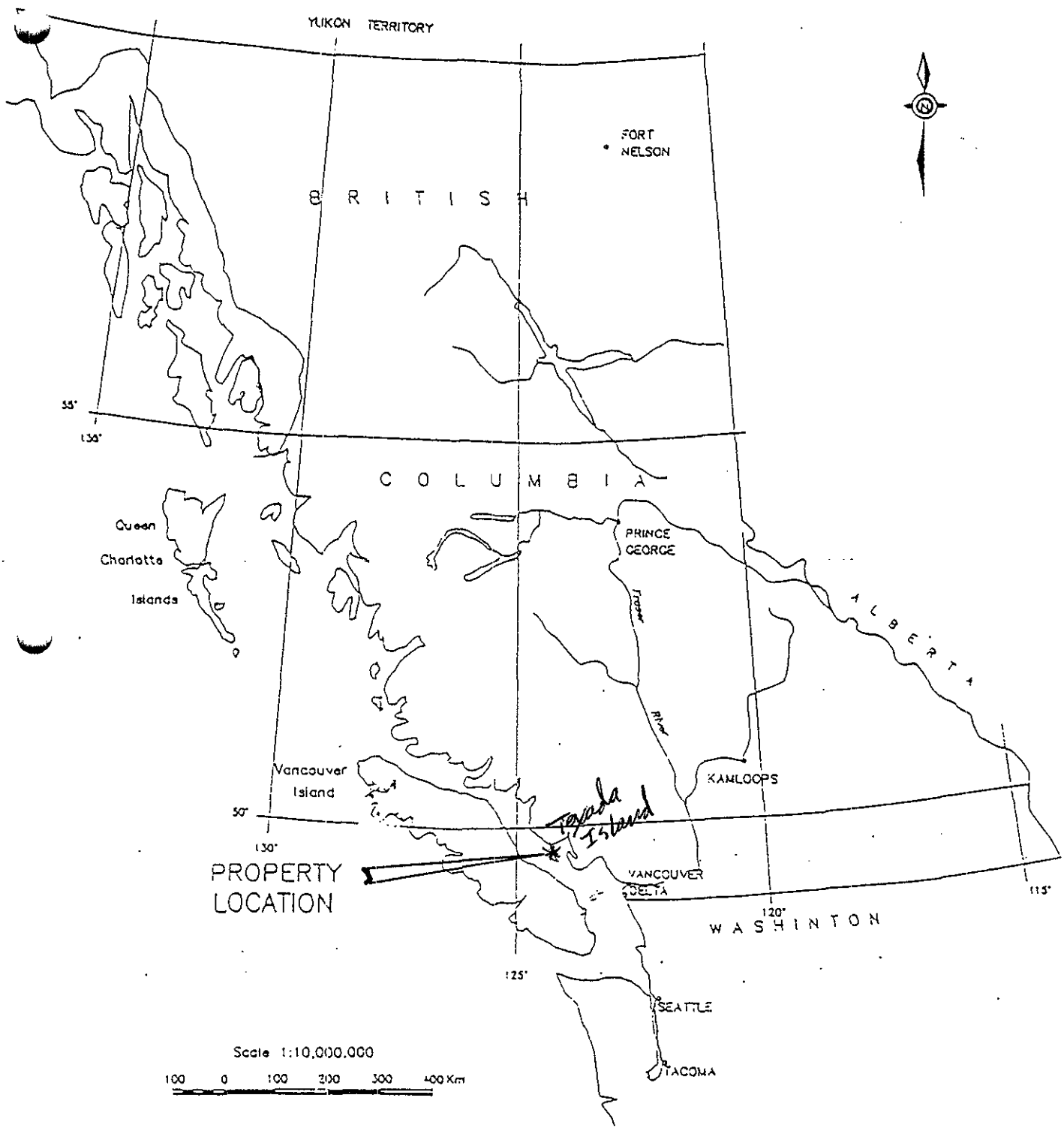

PROPERTY LOCATION

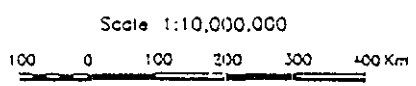

HOMEGOLD RESOURCES LTD.				
LONG BEACH CLAIMS				
LOCATION MAP				
SCALE as shown	DATE May 15, 2001	N.T.S. 92F/9W	WORK BY J. T. Shearer	FIGURE 1

LOCATION and ACCESS

Access to the south end of the Island is provided by a paved highway linking Vananda with Gillies Bay. Access to various mining properties is established from the paved highway or main logging roads, which run the length of the Island, Figure 2.

Access to the Long Beach area is by improved hydro road to the transmission line area and then by upgraded old logging roads into the property as shown in Figures 2. The main showings are 19 km southeast of the Gillies Bay Airstrip. The old roads are passable with difficulty by two-wheel drive vehicle but a 4x4 is advisable. Parts of the claim group have undergone juvenile forest spacing, however, harvesting of the second growth has started south of the powerline.

The relief on the northern part of Texada Island is characterized by relatively low hills mainly underlain by carbonate rocks. The southern part of the Island is higher and more rugged from a central high series of mountains. A regular scheduled Government Ferry links Westview Terminal at Powell River with the dock at Blubber Bay on the north end of Texada.

Southern British Columbia Colombie-Britannique du Sud

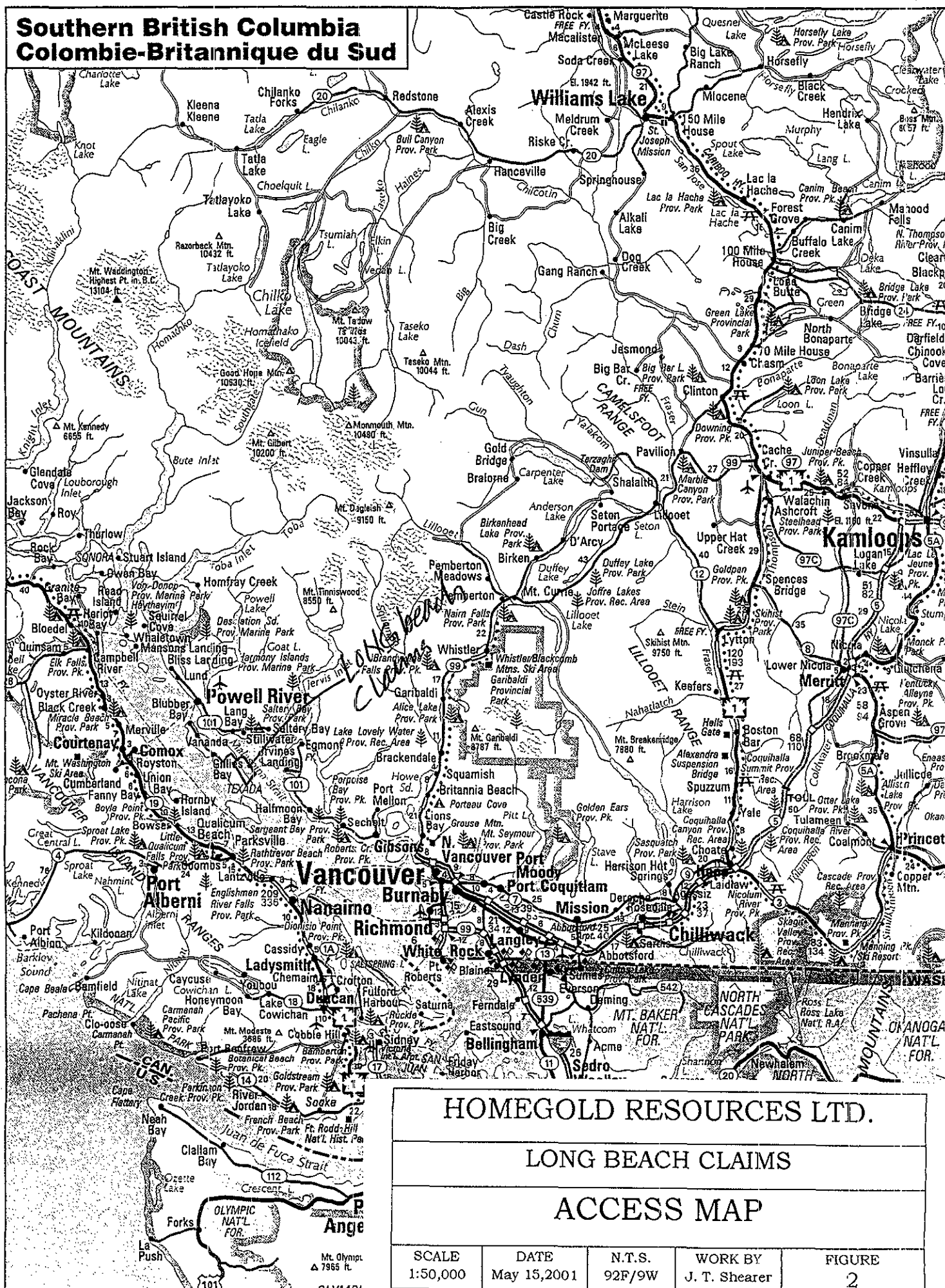

HOMEGOLD RESOURCES LTD.

LONG BEACH CLAIMS

ACCESS MAP

SCALE	DATE	N.T.S.	WORK BY	FIGURE
1:50,000	May 15, 2001	92F/9W	J. T. Shearer	2

CLAIM STATUS

The Long Beach Property is covered by 14 two-post claims as shown on Figure 3. The Long Beach Claims were located in 1998. The claims are situated north and south around the Cheekye-Dunsmuir high voltage transmission line that is under Mineral Reserve o/c 574 79:03:01 subject to conditions.

TABLE I
List of Claims

Claim Name	Tenure Number	Size	Units	*Current Anniversary Date	Current Owner
Long Beach 1	362396	2 post	1	May 2, 2003	J.T. Shearer
Long Beach 2	362397	2 post	1	May 2, 2003	J.T. Shearer
Long Beach 3	362398	2 post	1	May 2, 2003	J.T. Shearer
Long Beach 4	362399	2 post	1	May 2, 2003	J.T. Shearer
Long Beach 5	362400	2 post	1	May 3, 2003	J.T. Shearer
Long Beach 6	362401	2 post	1	May 2, 2003	J.T. Shearer
Long Beach 7	362402	2 post	1	May 2, 2003	J.T. Shearer
Long Beach 8	362403	2 post	1	May 2, 2003	J.T. Shearer
Long Beach 9	362404	2 post	1	May 2, 2003	J.T. Shearer
Long Beach 10	362405	2 post	1	May 2, 2003	J.T. Shearer
Long Beach 17	364067	2 post	1	July 9, 2003	J.T. Shearer
Long Beach 18	364068	2 post	1	July 9, 2003	J.T. Shearer
Long Beach 19	364069	2 post	1	July 9, 2003	J.T. Shearer
Long Beach 20	364070	2 post	1	July 9, 2003	J.T. Shearer

14 claims

* with application of assessment work documented in this report.

Under the present status of mineral claims in British Columbia, the consideration of industrial minerals requires careful designation of the product end use. An industrial mineral is a rock or naturally occurring substance that can be mined and processed for its unique qualities and used for industrial purposes (as defined in the *Mineral Tenure Act*). It does not include "Quarry Resources". Quarry Resources includes earth, soil, marl, peat, sand and gravel, and rock, rip-rap and stone products that are used for construction purposes (as defined in the *Land Act*). Construction means the use of rock or other natural substances for roads, buildings, berms, breakwaters, runways, rip-rap and fills and includes crushed rock. Dimension stone means any rock or stone product that is cut or split on two or more sides, but does not include crushed rock.

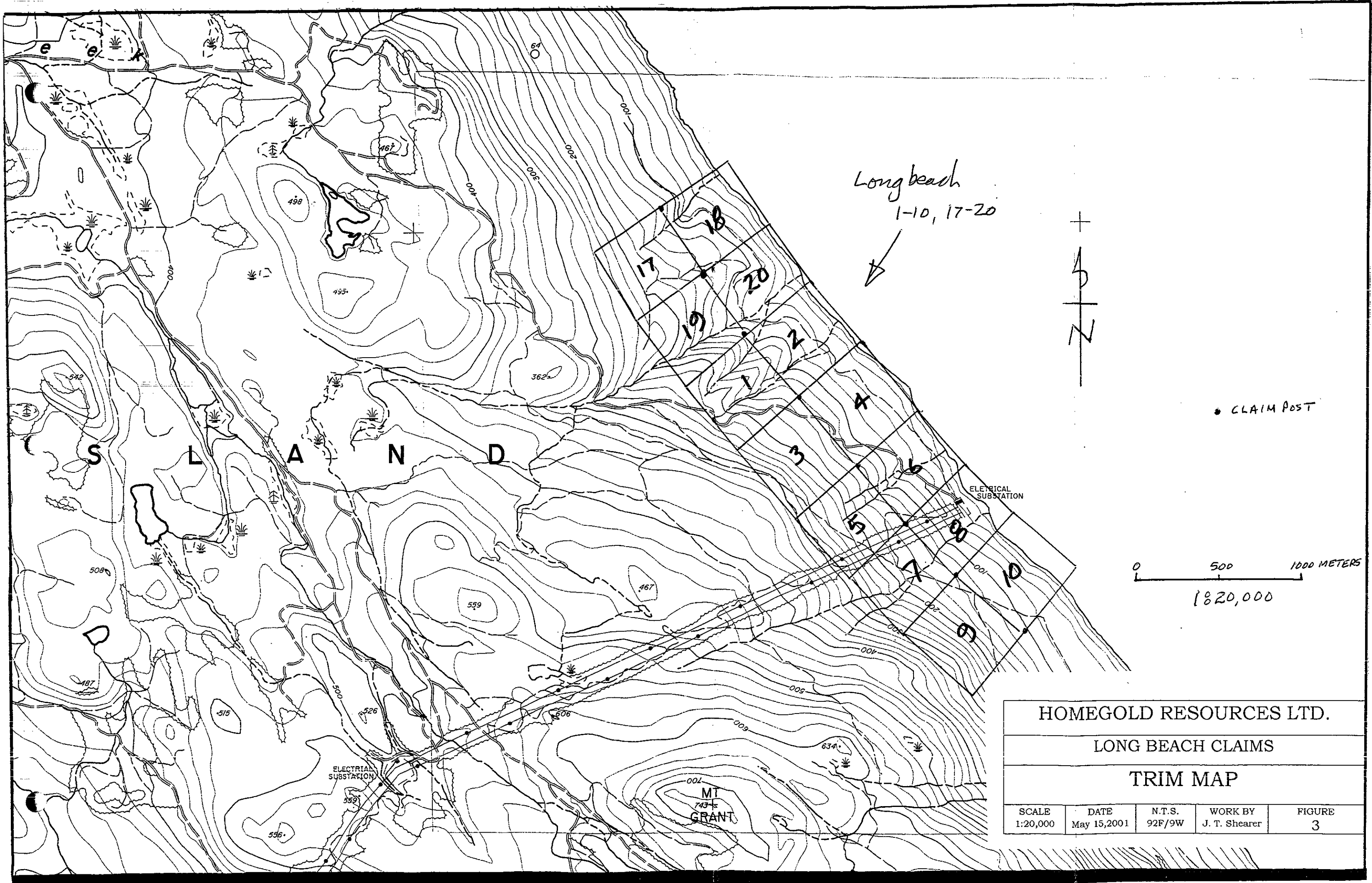

HOMEGOLD RESOURCES LTD.

LONG BEACH CLAIMS

TRIM MAP

SCALE 1:20,000	DATE May 15, 2001	N.T.S. 92F/9W	WORK BY J. T. Shearer	FIGURE 3
-------------------	----------------------	------------------	--------------------------	-------------

HISTORY

Named in 1791 by Spanish explorers, Texada Island was soon used by the whaling industry. In 1876 a whaler named Harry Trim discovered iron ore, which precipitated boom of exploration on Texada. In 1886 the first iron mine was opened, in 1890 copper was found and in 1898 copper and gold were mined at Marble Bay. Captain Sturt purchased the first lot in Van Anda in 1878 and by 1898 Van Anda had become a boomtown. From these old producers, approximately 75,000 ounces of gold, 500,000 ounces of silver and 19,000,000 pounds of copper were recovered. The larger of these mines being the Marble Bay Mine, the Little Billie Mine, the Cornell Mine and the Copper Queen Mine. Several kilometres to the south, near the town of Gilles Bay, Texada Mines Ltd. operated a large underground and open pit mine at Welcome Bay between 1952 and 1976. Over 20 million tones of ore was mined yielding iron and copper concentrates and approximately 35,000 ounces of gold. At present there are three major open pit limestone quarries in operation at the north end of the Island.

Recent metallic mineral exploration can be viewed as culminating in a series of large budget modern programs by such companies as BP Resources, Echo Bay and Billiton.

The first recorded work in the Long Beach Area is in 1950 by D. W. Cochrane, who excavated the Upper Creek trenches (Minister of Mines 1950, pages 178-180). A large claim block was located by R. Samuelson and R. Mickle in late 1969 and optioned to Falconbridge Nickel Mines Ltd. (Wares 1971). Part of this old property encompasses the present Long Beach Claims and was referred to as the Airstrip Grid. Work by past owners included limited SP, magnetometer and soil sampling. Small hand pits have been blasted into areas of anomalous SP values (Shearer, 1981 and 1985).

In late 1984, spectacular specimens of coarse gold from a narrow quartz vein on the Holly Crown Grant near Kirk Lake were discovered in place. This claim was optioned to Northair Mines Ltd. in January 1985 and a diamond drill program was completed in early May 1985, however, results were disappointing at depth.

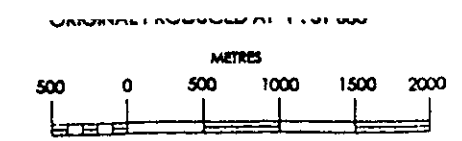
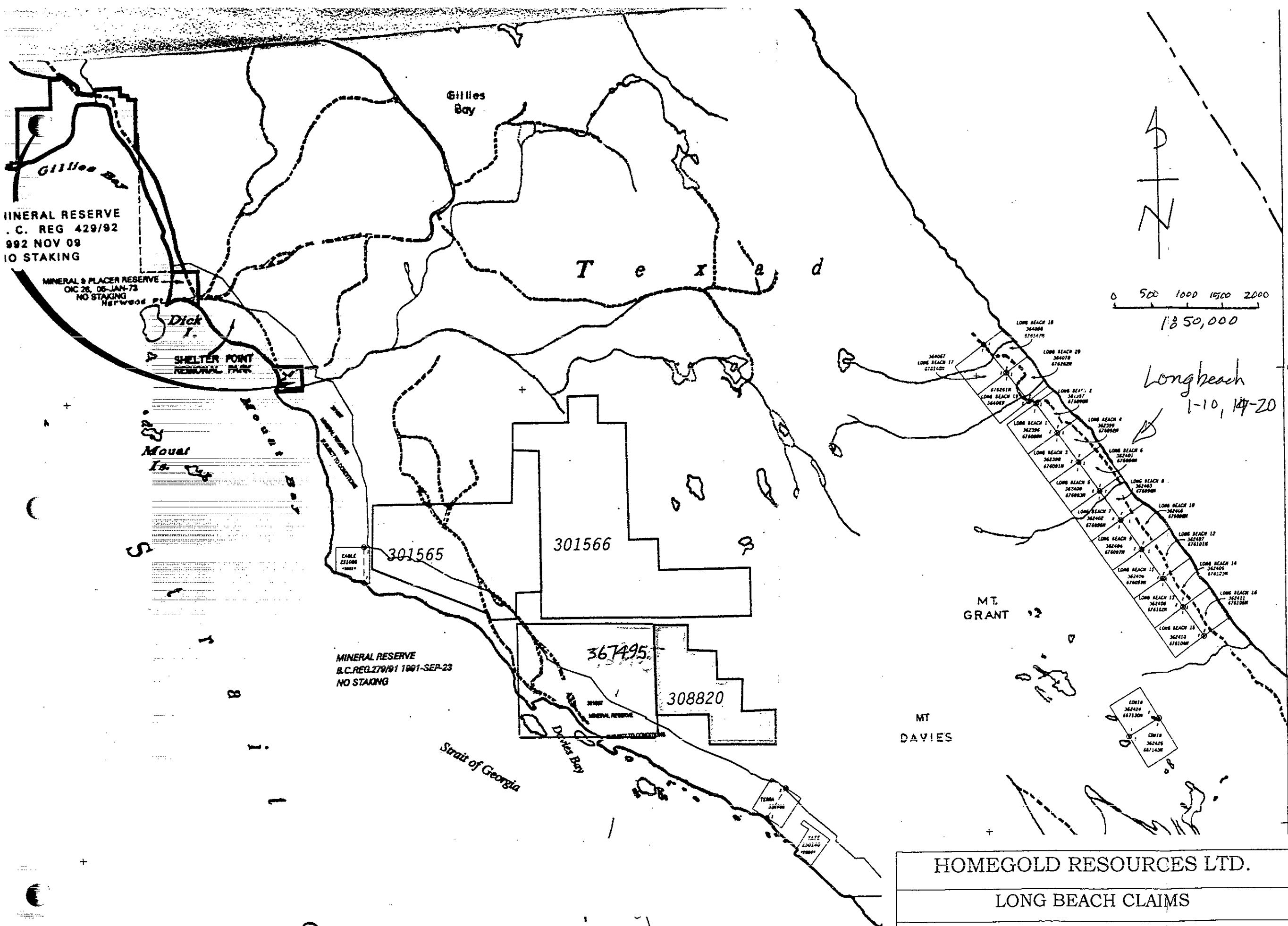

ADMINISTRATIVE AREAS
 MINING DIVISIONS: NANAIMO,
 VANCOUVER

LAND DISTRICTS:

ALIENATIONS

- NO STAKING AREAS
- NO STAKING RESERVES
- PARKS
- ECOLOGICAL RESERVES
- RECREATION AREAS
- INDIAN RESERVES

CONDITIONAL AREAS

- SUBJECT TO CONDITIONS RESERVES
- SECTION 19 RECREATION AREAS
- 1 POST CLAIM AREAS
- AREAS SUBJECT TO URANIUM / THORIUM REGULATIONS

MINERAL TENURE

- MINERAL CLAIM
- MINERAL LEASE
- INDUSTRIAL MINERAL CLAIM
- CLAIM NAME EXAMPLE
- TITLE NUMBER 345679
- OLD TITLE NUMBER 3489
- TAG NUMBER 100000
- LEGAL POST (
- WITNESS POST) (
- FORFEITED TENURE C
- VERIFIED YE

HOMEGOLD RESOURCES LTD.				
LONG BEACH CLAIMS				
CLAIM MAP				
SCALE	DATE	N.T.S.	WORK BY	FIGURE
1:50,000	May 15, 2001	92F/9W	J. T. Shearer	4

REGIONAL GEOLOGY

The regional geology of Texada Island is relatively simple as shown on Figure 5. Upper Paleozoic Sicker Formation volcanics, volcanoclastics sediments and limestone are exposed on the extreme south tip. Most of the Island is underlain by Upper Triassic Karmutsen Formation amygdaloidal, pillowed to massive basalt, breccia and aquagene tuff. This is overlain by a massive Upper Triassic limestone (Quatsino Formation), which occurs mainly in a belt extending across the north end of the Island. Five stocks of quartz diorite to diorite are exposed on the coastline. One of these stocks along Long Beach partially hosts the copper-gold showings on the Long Beach Claims. Near Gillies Bay a fault block of Upper Cretaceous Nanaimo Group coarse clastics has been preserved.

The Quatsino Formation contains the most significant limestone resources situated on or near tidewater along the British Columbia coast. The formation was named for the extensive outcrops of limestone of Late Triassic age occurring on Quatsino Sound on northern Vancouver Island. Similar limestone on Texada Island, previously referred to as Marble Bay Formation, is included with the Quatsino Formation. On southern Vancouver Island most Upper Triassic limestones were initially mapped as the Sutton Limestone. These have also been incorporated into the Quatsino Formation. The Sutton Limestone is now restricted to the latest Triassic limestone member of the Parsons Bay Formation.

The Quatsino Formation is conformably underlain by basalts and andesites of the Karmutsen Formation. In places these volcanic rocks are intercalated with the limestone, such as in the Cowichan Lake area on southern Vancouver Island. The Quatsino Limestone grades upward into thinly bedded black limestone and black calcareous argillite of the Parsons Bay Formation.

Two large masses of Quatsino Limestone, referred to as the northern and southern belts, outcrop on Texada Island. The northern belt, with a strike length of 13 kilometres and up to 3 kilometres wide, extends from the north end of the Island south towards Gilles Bay. It is preserved along the axis of a broad northwesterly plunging syncline that is complicated by subsidiary folds. The southern belt (Davies Bay deposit) trends northward along the west coast of the Island for 6 kilometres within a tilted fault block.

The Quatsino Formation is composed largely of massive to thickly bedded, fine-grained (microtic), black to light grey, bluish grey weathering limestone. The rock is predominantly calcium to high calcium in composition. Silica contamination, in the form of chert nodules and beds, is fairly common. The limestone in the northern belt can be separated into three members, each at least 100 metres thick, based on composition (Mathews, 1947; Mathews and McCammon, 1957). The lower member is composed exclusively of high calcium limestone is overlain by a middle member of generally calcium limestone, which is in turn overlain by an upper member of magnesian limestone.

Stratification has not been found in the Davies Bay Limestone belt. Direct evidence of its relationship to the surrounding volcanic rocks of the Karmutsen Formation cannot be determined. In view of similarity of this limestone in appearance and composition to the limestone on the northern part of Texada Island, it may be referred to the Quatsino Formation overlying the Karmutsen Group. The volcanic rocks exposed along the shore to the southeast of the limestone belt strike easterly at a marked angle to the concealed

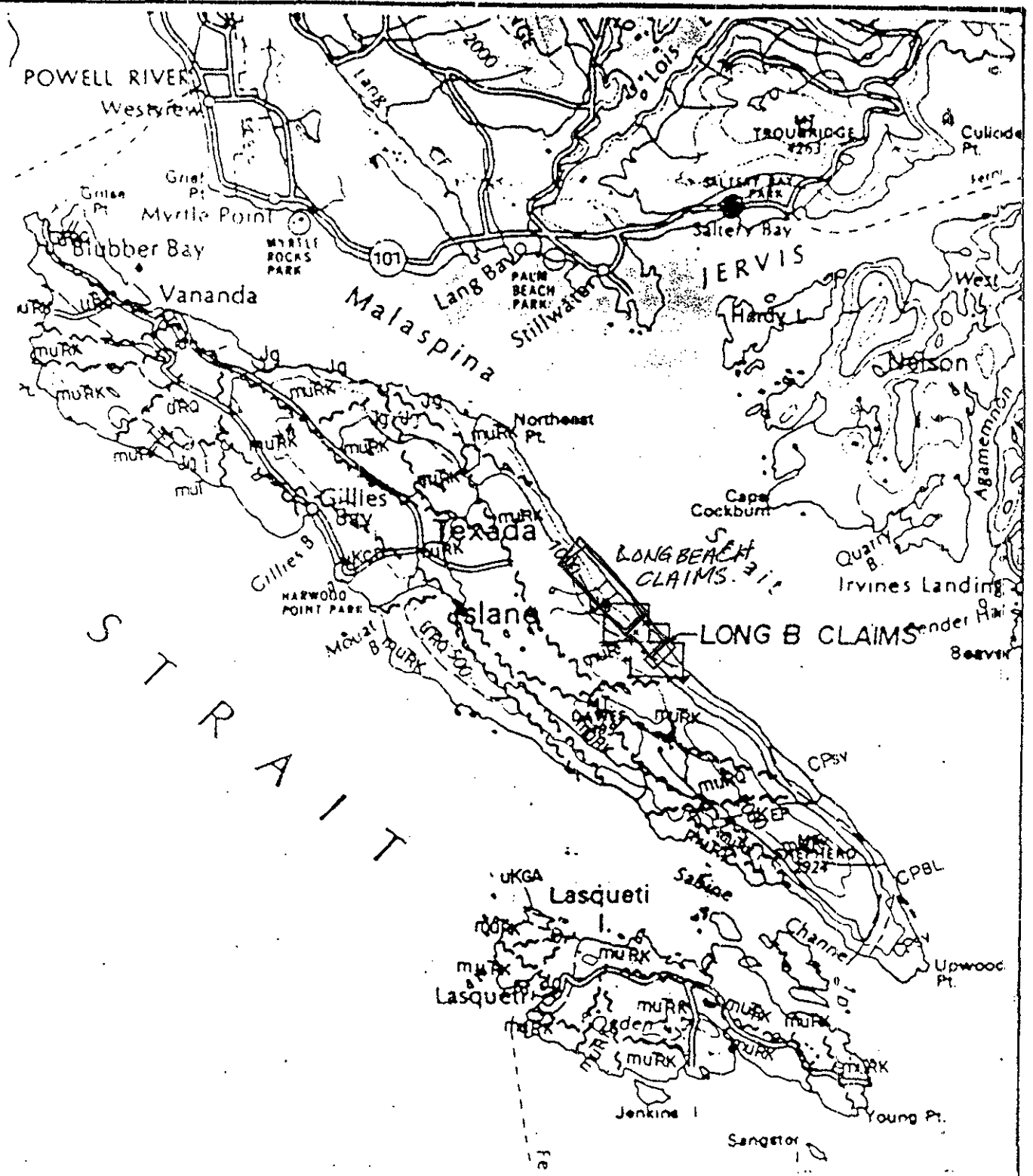

LEGEND

- UKEP Nanaimo sandstone
- UKCD Nanaimo conglomerate
- JQ INTRUSIVES granodiorite
- muRK KARMUTSEN VOLCANICS
- u5G quatsino Limestone
- CP BL SICKER sediment
- CP SV SICKER

HOMEGOLD RESOURCES LTD.

LONG BEACH CLAIMS

REGIONAL GEOLOGY

SCALE 1:250,000	DATE May 15, 2001	N.T.S. 92F/9W	WORK BY J. T. Shearer	FIGURE 5
--------------------	----------------------	------------------	--------------------------	-------------

LOCAL GEOLOGY

Wares (1971) describes the quartz diorite stock north of the Long Beach area as a "composite granodiorite intrusion". However, most of the intrusive exposures mapped by Wares are identified as quartz diorite. The few granodiorite outcrops could possibly be the result of potassic feldspar alteration as observed on the Long Beach claims. Alteration appears to vary considerably over short distances. In one locality an intensely chloritized and potassium-rich rock is adjacent to relatively fresh biotite-hornblende diorite (Shearer, 1985).

Karmutsen Formation volcanics were seen in the Upper Creek area and near the final post for Longbeach 9 + 10. These are dark green, very fine grained chloritized and epidotized greenstones. Occasionally 2 to 9mm feldspar phenocrysts were seen on weathered surfaces.

Geological observations are plotted on Figure 6 (in pocket). A very pyritic, volcanic agglomerate-breccia was noted 65 metres southwest of Long Beach #9 Claim. Dark, polymictic, subangular, fine grained fragments averaging 1 to 2 cm in diameter predominate. Occasionally clasts range up to 25 cm in diameter. This rock contains about 5% pyrite but assayed 5ppb gold.

To the southwest of Longbeach #9 Claim the volcanic-intrusive contact is well exposed in the Main Creek striking 343° and dipping steeply to the west. This contact is sharp with some suggestion of a narrow banded, chilled margin. A large quartz vein has been uncovered by trenching adjacent to the contact hosted by diorite. The vein structure passes westward into volcanics and becomes progressively less well defined. To the west and south a prominent topographic feature is a line of 30 to 40 metre high cliffs. These cliffs do not mark the volcanic-intrusive contact but rather start about 100m within the volcanic terrain.

All intrusive specimens are moderately to strongly magnetic, whereas the volcanics are non-magnetic. Pyrite occurs in the Southeast Area in small lenses up to 15%, as 3-5mm stingers and thin fracture fillings.

Several old showing of various dimensions are known on the claims mainly within the intrusive but also in the Upper Creek zone passing into the volcanics. King (1950) describes three showings that were sampled with the following results:

<u>Quartz Vein</u>	<u>Thickness</u>	<u>Gold Content</u>
Number 3 vein	width 12 inches	0.56 oz/ton gold
Southeast showing	width 8 inches	0.39 oz/ton gold
Main or Upper Creek Area	width 14 inches	0.22 oz/ton gold

Chip samples by D. A. Harron in 1980 show gold values over narrow widths up to 0.476 oz/ton gold in the chalcopyrite-rich Upper Creek showing.

The old Southeast Vein mentioned by King (1950) has not been positively identified. However, the zone now referred to as the Southeast Area is somewhat farther along "strike" from the apparent location of the 1950 work. The Upper Creek Zone is reported by King as follows:

"The main vein, on which most of the work has been done, is in a creek near the centre of the group and has been traced nearly 210 feet by rock trenches and

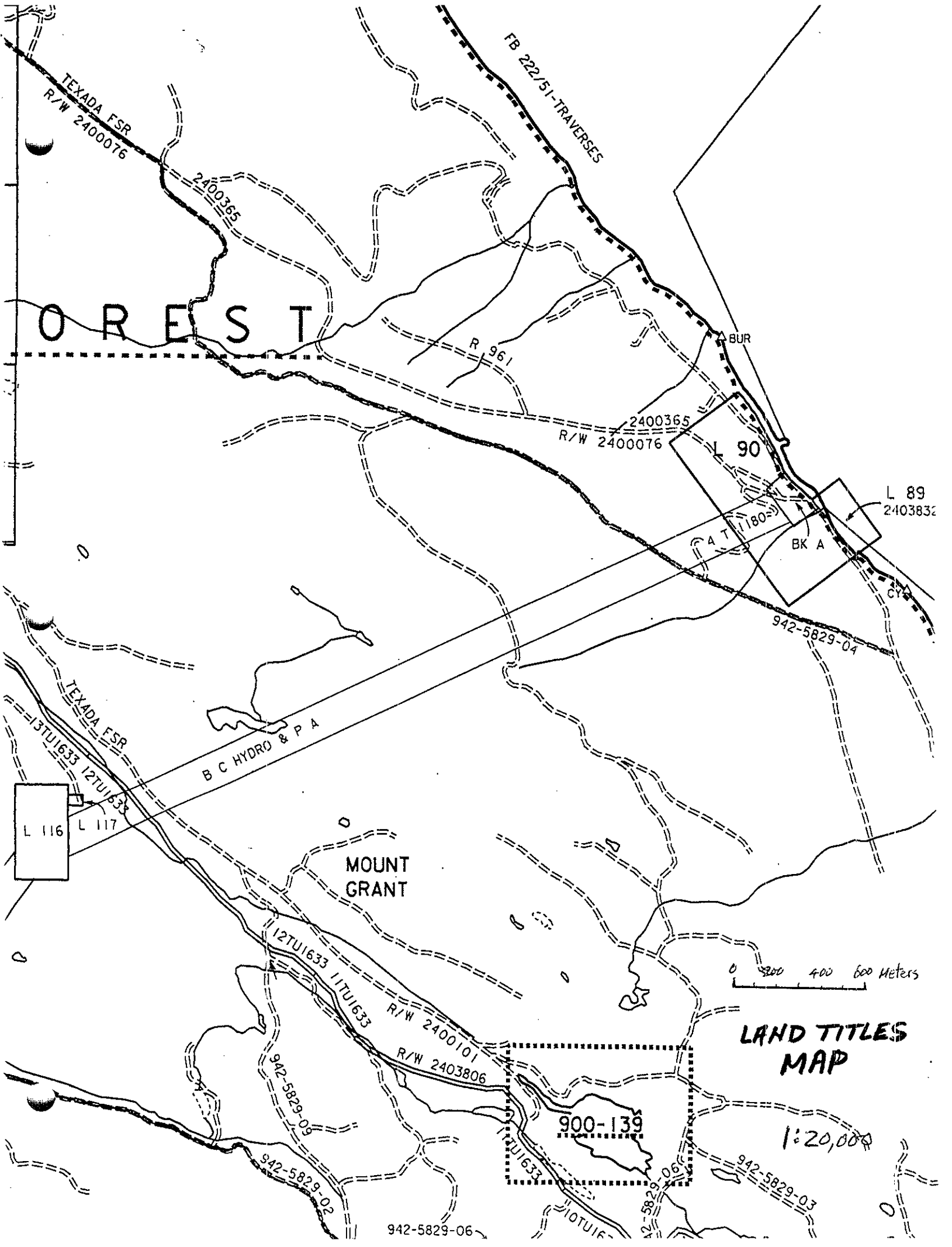

FB 222/51-TRAVERSES

TEXADA FSR
R/W 2400076

FOREST

BUR

R 961

2400365
R/W 2400076

L 90

L 89
2403832

BK A

942-5829-04

B C HYDRO & P A

L 116

L 117

MOUNT GRANT

0 200 400 600 Meters

LAND TITLES
MAP

1:20,000

900-139

12TU1633 11TU1633
R/W 2400101
R/W 2403806

942-5829-09

942-5829-02

942-5829-06

942-5829-03

stripping. The vein is in a straight definite fracture that strikes north 22° east and dips 66° northwest between walls of andesite slightly mineralized with pyrite. The vein filling is of quartz mineralized with pyrite, chalcopyrite and secondary bornite."

Previous rock chips confirm the concept of gold values in two main, narrow, linear zones. This type of mineralization is to be expected on the periphery of a largely porphyry copper-molybdenum system as outlined by Falconbridge (Wares, 1971). The tonnage potential of the narrow linear zones outlined to date appear to be limited.

However, more significant would be the location of the bedrock source for the high gold in soil values that have been found in the Southeast Area and at the south contact between the volcanics and intrusive. It is also possible that these high gold in soils are related to the porphyry copper system gold enrichment and inherent high mobility of metals in the presence of abundant pyrite decomposition (low pH).

On the west edge of Long Beach #1 Claim is a large exposure of rusty weathering, highly fractured and faulted crudely foliated granodiorite. Abundant chlorite coats fractures. The hornblende is elongated defining the foliation and is distinctly poikiloblastic. Rounded "inclusions" up to 3-4 cm long are common throughout. The prominent faulting observed at this locality appears to trend.

At km 11 on the "Upper Road" on the Long Beach #5 Claim, are well exposed outcrops of blocky weathering fine to medium crystalline equigranular quartz diorite containing approximately 25% stubby poikiloblastic hornblende. The exposure along the road is accentuated by excavations for the ditchline and culverts (Figure 6, in pocket).

There is a gradual trend to more mafic rich dioritic intrusive phases toward the southeast along the "Upper Road" down to the final post of Long Beach 9 and 10.

Numerous outcrops of buff brown weathering dark green Karmutsen Formation crystal tuff were observed along the creek gully in central Long Beach 17 and 18 Claims.

CONCLUSIONS and RECOMMENDATIONS

Attention in the past, around the Long Beach Claim Area, has focussed on the definition of narrow gold bearing silicified zones and quartz veins. Several small gold-bearing zones have been outlined in the Upper Creek and Southeast Areas to the south of the present Long Beach 9 and 10 Claims.

The western portion of the claims is characterized by an altered intrusive contact between a composite granitic pluton and Karmutsen Formation chloritic basalt. Local areas of intense chlorite, kaolin and potassic alteration are common within the intrusion. Silicification appears to be accompanied by abundant pyrite in lenses and heavy disseminations.

Previous SP and VLF EM surveys indicate zones of anomalous response that correlate with sulphide-rich areas on surface. High gold-in-soil values are found in the Southeast Area, however, these results are thought to have migrated downslope and the bedrock source should be traced up hill. The area is covered by stable wooded talus sheets. Dr. R. B. Band in Wares (1971) comments that:

“Steep slopes and generally sparse vegetation cover resulting from a recent (1967?) forest fire favours mechanical downslope dispersion of the soil.

The extent of downslope migration of gold values was evaluated by additional soil sampling in 1985. This area is not spatially associated with the narrow structure in the southeast Area and should be considered as a separate zone. The 1985 work has indicated several sub-areas that warrant follow up hand trenching. If had trenching is successful in locating covered precious metal sources then mechanized trenching with a bulldozer will be required.

Future work should concentrate on differentiating between scattered, small gold veins associated with normal porphyry copper deposit zoning and a potentially large, new gold zone associated with the volcanic-intrusive contact.

An exploration program to further investigate the copper-gold showings and soil anomalies on the Long Beach Claims is recommended.

Future exploration should consist of:

Geological mapping and prospecting of the entire claims block,
(a) more detailed mapping near showings, 1:2,500

These data will serve as a basis for a property inventory to assign priorities for mineralized areas. Information from previous Falconbridge work will be useful. Particular attention should be paid to faults and airphoto linears.

Respectfully submitted

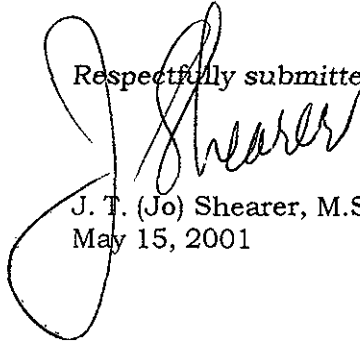
J. T. (Jo) Shearer, M.Sc., P.Geo.
May 15, 2001

REFERENCES

- King, R. B., 1950:
B.C. Minister of Mines Annual Report 1950 R. B. King reporting on Gordon and William Claims, Pages A178-180.
- Brennan, F., 1979:
Diamond Drilling Report on the Hernando Claim. B.C. Ministry of Energy & Mines, Assessment Report 7559.
- 1981:
Diamond Drilling and Prospecting on the Hernando Claims, B.C. Ministry of Energy & Mines, Assessment Report 10065.
- Fischl, P., 1992:
Limestone and Dolomite Resources in British Columbia, B.C. Ministry of Energy, Mines & Petroleum Resources, Open File 1992-18, 150pp.
- Forester, C., 1989:
Diamond Drilling, Geological and Geochemical Report on the Vananda-Cornell for Freeport-McMoran Gold, B.C. Ministry of Energy & Mines, Assessment Report 19315, 238 pp.
- Harron, D. A., 1980:
Chemex Lab Certificates 684-9264 Dupont of Canada Exploration.
- Hora, Z. D. and Sharman, K. J., 1980:
Texada Island Limestone; in Geological Fieldwork 1979, B.C. Department of Mines Paper, 1980-1, pages 109-111.
- Johanson, E., 1979/1980:
Sketch of SP Readings, Geochemistry, Magnetometer, Location Map 1 inch = 500 feet.
- Kowalchuk, J. M., 1988:
Geological Report on the Angel 1-4 and Long B 25, B.C. Ministry of Energy & Mines, Assessment Report 17685.
- Lavaque, J., 1986:
Geological and Geophysical Report on the Paul 1045 Claims; Assessment Report 14817.
- Mathews, W. H., 1947:
Calcareous Deposits of the Georgia Strait Area; B.C. Department of Mines Bulletin 23, pages 87-88.
- Mathews, W. H. and McCammon, J. W., 1957:
Calcareous Deposits of Southwestern British Columbia; B.C. Department of Mines Bulletin 40, pages 80-82.
- McConnell, R. G., 1914:
Geology of Texada Island, Geological Survey of Canada Memoir 58, 112p.

- Muller, J., 1977:
Vancouver Island, Open File, Geological Survey of Canada, 3 sheets 1:250,000.
- Sadlier-Brown, T. L., 1999:
An Evaluation of the Mineral Resources of the Sliammon Traditional Territory
Phase I, February 25, 1999, 10 pages.
- Sarjeant, P. T., 1989:
Geological and Trenching Report on the Angel 105, Fox 1-20 and Arl 1 Claims
for Echo Bay Mines, B.C. Ministry of Energy & Mines, Assessment Report 18671,
115 pp.
- Savelieff, R., 1974:
Drilling Report on the Paul Claims; Assessment Report 5273.
- Shearer, J. T., 1981a:
Geochemical and Geological Report on the Long B Property, B.C. Ministry of
Energy & Mines, Assessment Report 9264.
- 1981b:
Geochemical Report on the Long B Claims Texada Island, Private Report for
Carolin Mines Ltd. 18pp plus maps, May 18, 1981. Filed as Assessment.
- 1985:
Diamond Drilling Report on the Angel Property, B.C. Ministry of Energy &
Mines, Assessment Report 13747.
- 1998:
Mining Permit Application Summary on the South Slesse Limestone Quarry,
Mx7-114, for I.G. Machine & Fibers Ltd., Dated January 10, 1998, 23 pages.
- 1999:
Diamond Drilling Report on the Davies Bay Limestone Deposit filed for
Assessment Credit.
- 2000:
Diamond Drilling Report on the Ravens Bay-Will Claims Tex Mineral Claim
Group, Texada Island, filed for Assessment Credit.
- Stevenson, J. S., 1947:
Lode Gold Deposits - Southwest British Columbia, B.C. Department of Mines,
Bulletin 20 - Part IV, 41 pp.
- Ware, R., 1971:
Mickle - Samuelson Option, PM 158 Falconbridge Nickel mine Ltd., Private
Report 12 pp plus 5 appendices and maps (map 158-70-GP-1 missing).
- Webster, I. C. I. and Ray, G. E., 1990:
Geology and Mineral Occurrences of Northern Texada Island. B.C. Ministry of
Energy, Mines and Petroleum Resources, Open File 1990-3.

APPENDIX I

STATEMENT OF QUALIFICATIONS

J. T. SHEARER, M.Sc., F.G.A.C., P.Geo.

May 15, 2001

Appendix I

STATEMENT OF QUALIFICATIONS

I, Johan T. Shearer of 1817 Greenmount Avenue, in the City of Port Coquitlam, in the Province of British Columbia, do hereby certify:

1. I graduated in Honours Geology (B.Sc., 1973) from the University of British Columbia and the University of London, Imperial College, (M.Sc. 1977).
2. I have practiced my profession as an Exploration Geologist continuously since graduation and have been employed by such mining companies as McIntyre Mines Ltd., J.C. Stephen Explorations Ltd., Carolin Mines Ltd. and TRM Engineering Ltd. I am presently employed by Homegold Resources Ltd.
3. I am a fellow of the Geological Association of Canada (Fellow No. F439). I am also a member of the Canadian Institute of Mining and Metallurgy, and the Geological Society of London. I am a member in good standing of the Association of Professional Engineers and Geoscientists of British Columbia (P.Ge., Member Number 19,279).
4. I am an independent consulting geologist employed since December 1986 by Homegold Resources Ltd. at Unit #5 2330 Tyner Street, Port Coquitlam, British Columbia.
5. I am the author of the report entitled "Geological Report on the Long Beach Claims, Texada Island" dated May 15, 2001.
6. I have visited the property recently in April 2001 (April 1-3 & 13, 2001) and supervised several drilling programs since 1985 on Texada. I have toured and studied the operating Limestone Quarries on Texada since 1980. I am familiar with the regional geology and geology of most properties. I have become familiar with the previous work conducted on the Longbeach property by examining in detail the available reports, plans and sections, and have discussed previous work with persons knowledgeable of the area.

Dated at Port Coquitlam, British Columbia, this 15th day of May 2001.

Respectfully Submitted

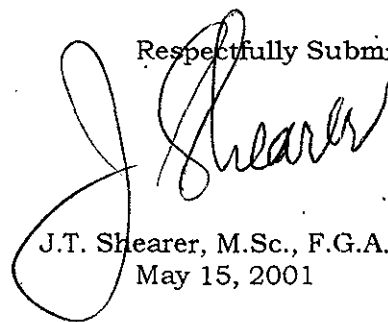

J.T. Shearer, M.Sc., F.G.A.C., P.Ge.
May 15, 2001

APPENDIX II

STATEMENT OF COSTS

May 15, 2001

Appendix II
STATEMENT of COSTS
LONG BEACH 1-20 CLAIMS
GEOLOGICAL MAPPING 2001

Wages and Benefits

J.T. Shearer, M.Sc., P.Geo.	
4 days @ \$350/day, April 1, 2, 3 & 13, 2001	\$ 1,400.00
S. L. Shearer, Assistant	
4 days @ \$200, April 1, 2, 3 & 13, 2001	<u>800.00</u>
	\$ 2,200.00
GST	<u>154.00</u>
Subtotal Wages	\$ 2,354.00

Transportation

Truck Rental, Fully equipped 4x4	
5 days @ 53.50	267.00
Gas	145.10
Hotel and Meals	582.50
Ferries, Vancouver - Texada & Return	87.50
Field Supplies	72.13
Base Map, 1:5,000	65.35
Drafting	450.00
Word Processing, 12 hrs @ \$25/hr	300.00
Reproduction and Report Preparation	<u>700.00</u>

Total \$ 5,024.08

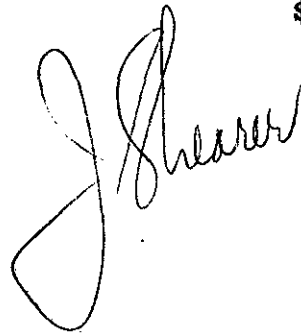

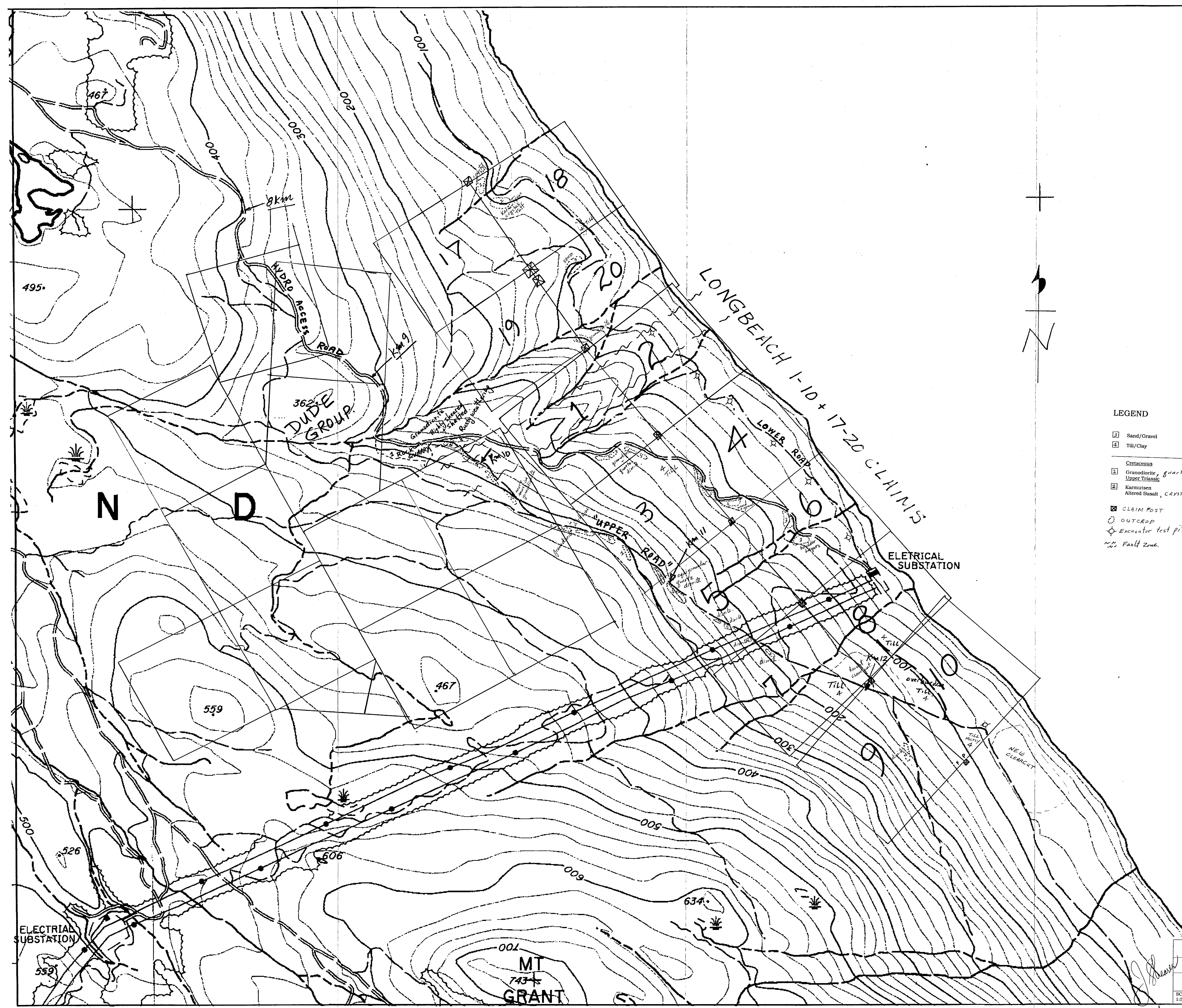

LEGEND

- ① Sand/Gravel
 - ② Till/Clay
-
- Cretaceous
- ① Granodiorite, quartz diorite, Upper Triassic
 - ② Karmutsen Altered Basalt, CRYSTAL TUFF
- ⊠ CLAIM POST
 - OUTCROP
 - ⊕ Excavator test pits 1998
 - Fault Zone

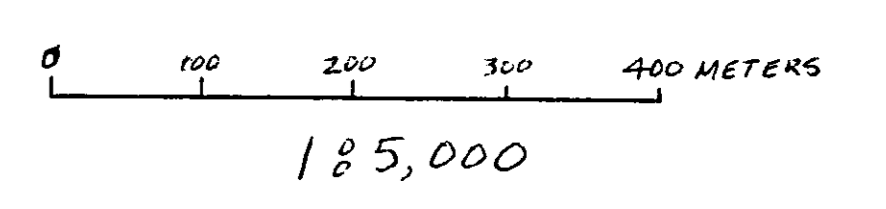

HOMEGOLD RESOURCES LTD.
 LONG BEACH CLAIMS
 LOCAL GEOLOGY

SCALE: 1:25,000	DATE May 18, 2001	N.T.S. 92F/9W	WORK BY J. T. SHEARER	FIGURE 6
--------------------	----------------------	------------------	--------------------------	-------------

GEOLOGICAL SURVEY BRANCH
ASSESSMENT DIVISION

26,582