

**RECEIVED**  
JAN 21 2004  
Gold Commissioner's Office  
VANCOUVER, B.C.

SPARKLE PROPERTY

Prospecting Report

Prepared by: James Dixon

January 7, 2004

**GEOLOGICAL SURVEY BRANCH**  
ASSESSMENT REPORT

27,313

## TABLE OF CONTENTS

	<u>Page</u>
Location and Access.....	1
Purpose.....	1
Procedure.....	2
Conclusion.....	2
Statement of Expenditure.....	3
Author's Qualifications.....	3

### Figures

Figure No. 1 – Location .....	4
Figure No. 2 – Claim Map .....	5
Figure No. 3 – Map of Prospecting Traverses.....	6
Figure No. 4 – Map of Prospecting Traverses.....	7

### **Location and Access**

The Sparkle claims are located 25 km. southwest of Houston, British Columbia. The claim area is centred at 54 ° 22 ' N latitude and 126 ° 44' W longitude. See Figure No. 1

Access is obtained by travelling along a logging road that connects with a cat trail which leads to the claims.

### **Purpose**

The objective of prospecting the area is to locate commercial quantities of precious metal minerals.

### **Procedure**

The Sparkle claims are located on fairly level ground, with minimal overburden. See Figure No. 2. The elevation at the claim site is well above timberline. Prospecting work for this report has involved examining the rock revealed during previous trenching for the presence of possible precious metal mineralization. See Figure No. 3 and Figure No. 4.

### **Conclusion**

High temperature contact metamorphism of an andesitic tuff unit (possibly in part of basaltic composition) of the Telkwa Formation is evident. Hazelton Group is indicated by the presence of epidote and specular hematite. The porous, vugular surface exposure at several locales is the result of calcite, hematite and rhodochrosite weathering and has been filled by a heavy crust of malachite in several samples. Bornite and chalcopyrite mineralization is evident, while late mineralization is represented by well-crystallized calcite and brown-pink rhodochrosite. This area needs to be investigated to determine occurrence, size and grade; and thus the presence of commercial quantities of ore.

**Statement of Expenditures**

Five days prospecting (10 hrs./day @ \$25.00/hr.)	\$ 1,250.00
Transportation/Accommodation Costs	<u>150.00</u>
	\$ 1,400.00

**Author's Qualifications**

I, James Dixon, do hereby certify that I:

- am a prospector and reside at 4055 – 2<sup>nd</sup> Avenue, Smithers BC
- have 2 year's prospecting experience
- am an Engineering Technologist
- am familiar with rock sampling techniques
- prepared this report

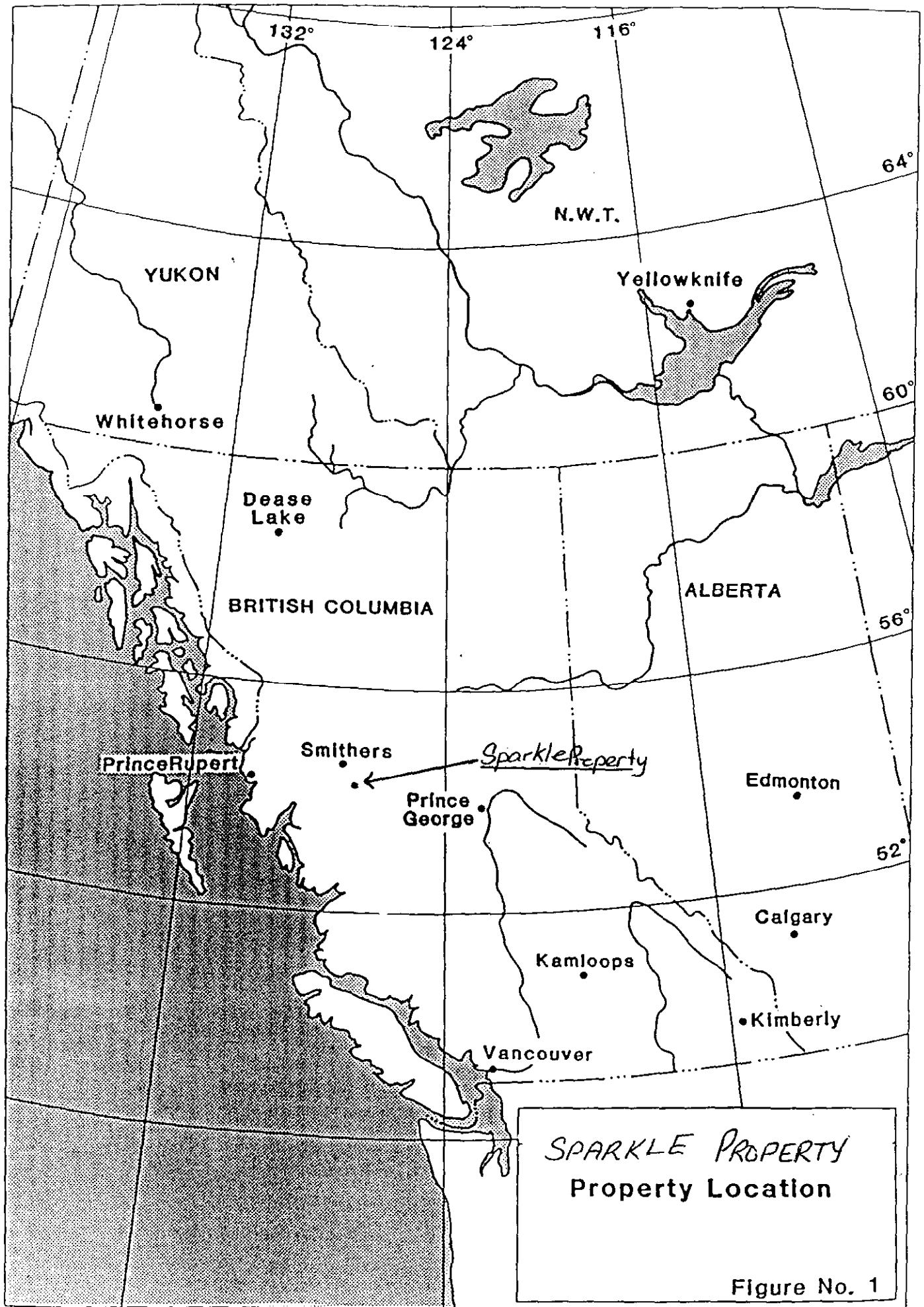

Claim Location Map

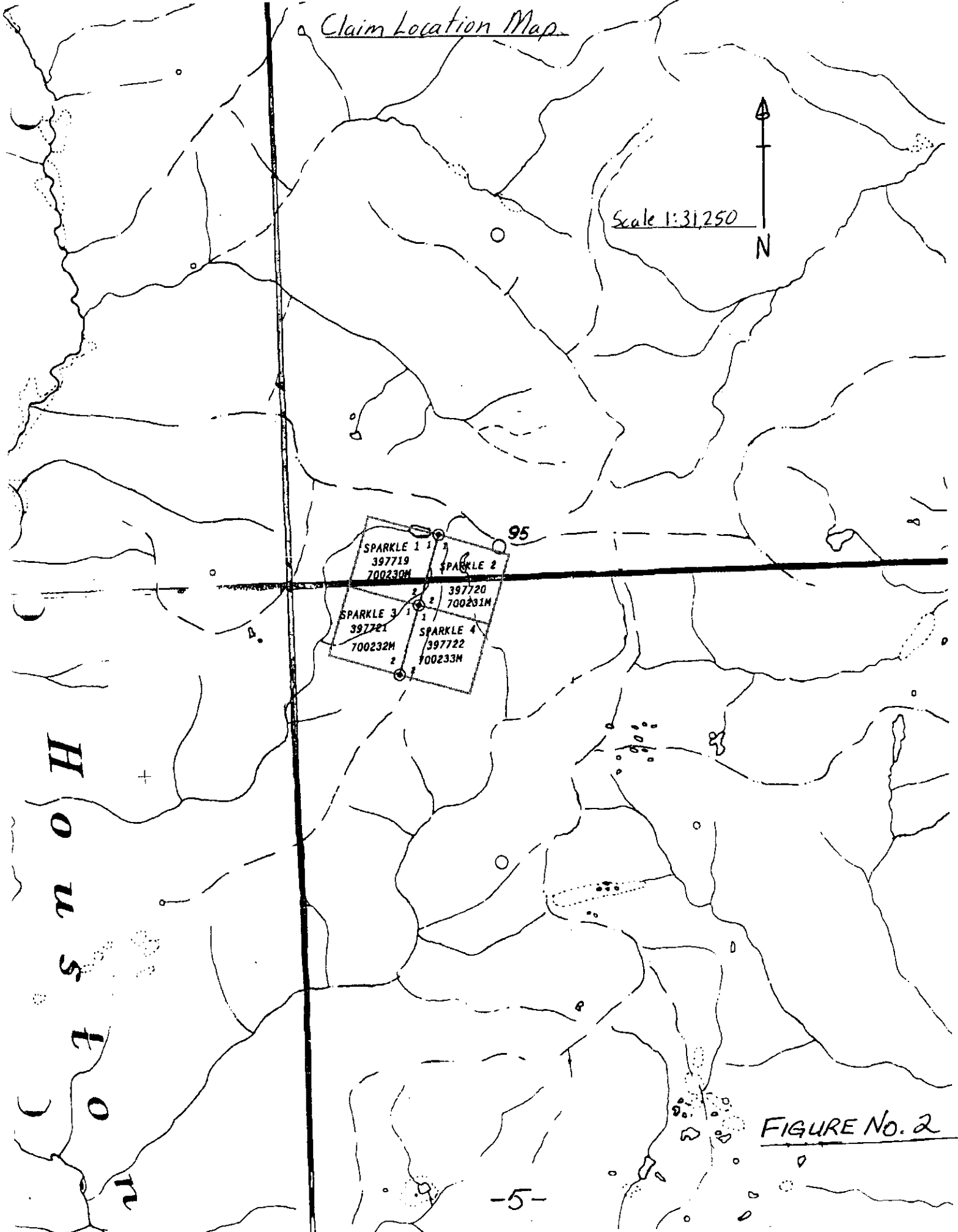

Scale 1:31,250



95

Howson

FIGURE NO. 2

MAP OF PROSPECTING TRAVERSES

Figure No. 4

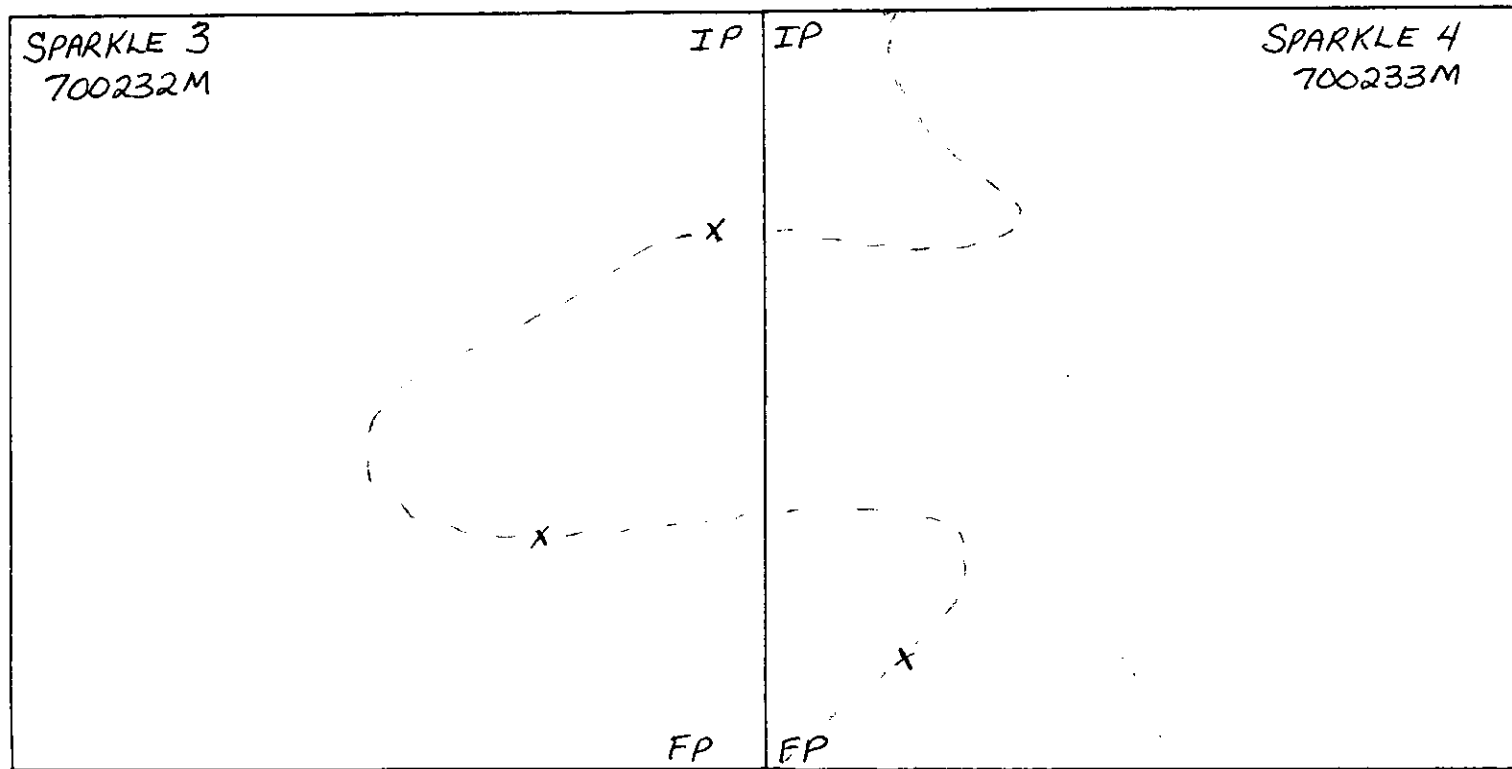

----- Traverse  
X Sample Location  
Scale 1:5000



# MAP OF PROSPECTING TRAVERSES

Figure No. 3

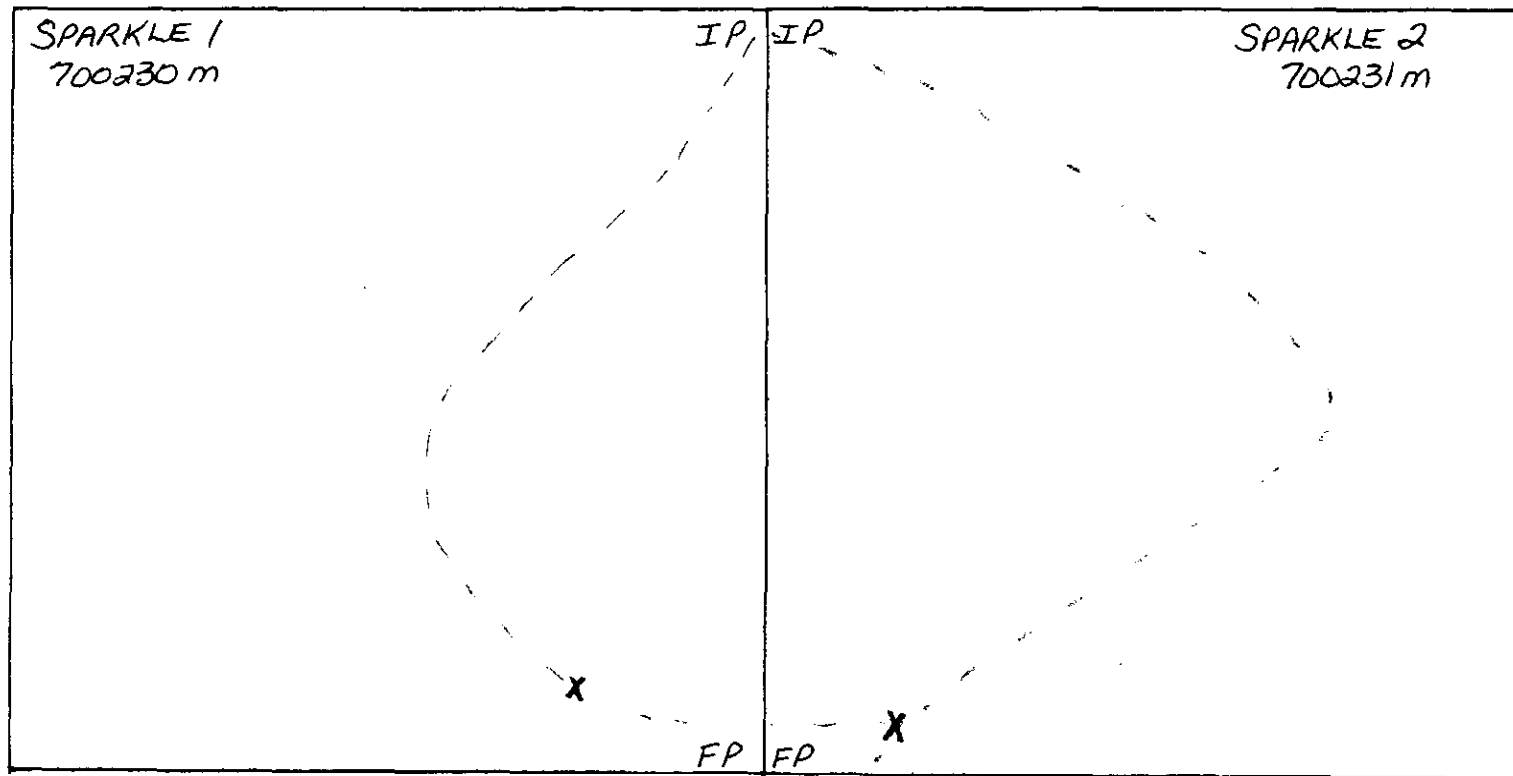

----- Traverse  
X Sample Location  
Scale 1:5000