

Assessment Report

on the

FRANKLIN PROPERTY

Geology, Geochemistry, Trenching, Diamond Drilling

PART 2 - Maps

NTS 82E/9

Lat: 49° 33' N

Long: 118° 22' W

(at centre of property)

Greenwood Mining Division
British Columbia, Canada

Operator:
Tuxedo Resources Ltd.
817 - 938 Howe St.
Vancouver, B.C.
V6Z 1N9

By:
Linda Caron, M.Sc., P. Eng.
717 75th Ave, Box 2493
Grand Forks, B.C.
V0H 1H0

January 15, 2004

TUXEDO RESOURCES LTD.
FRANKLIN PROPERTY

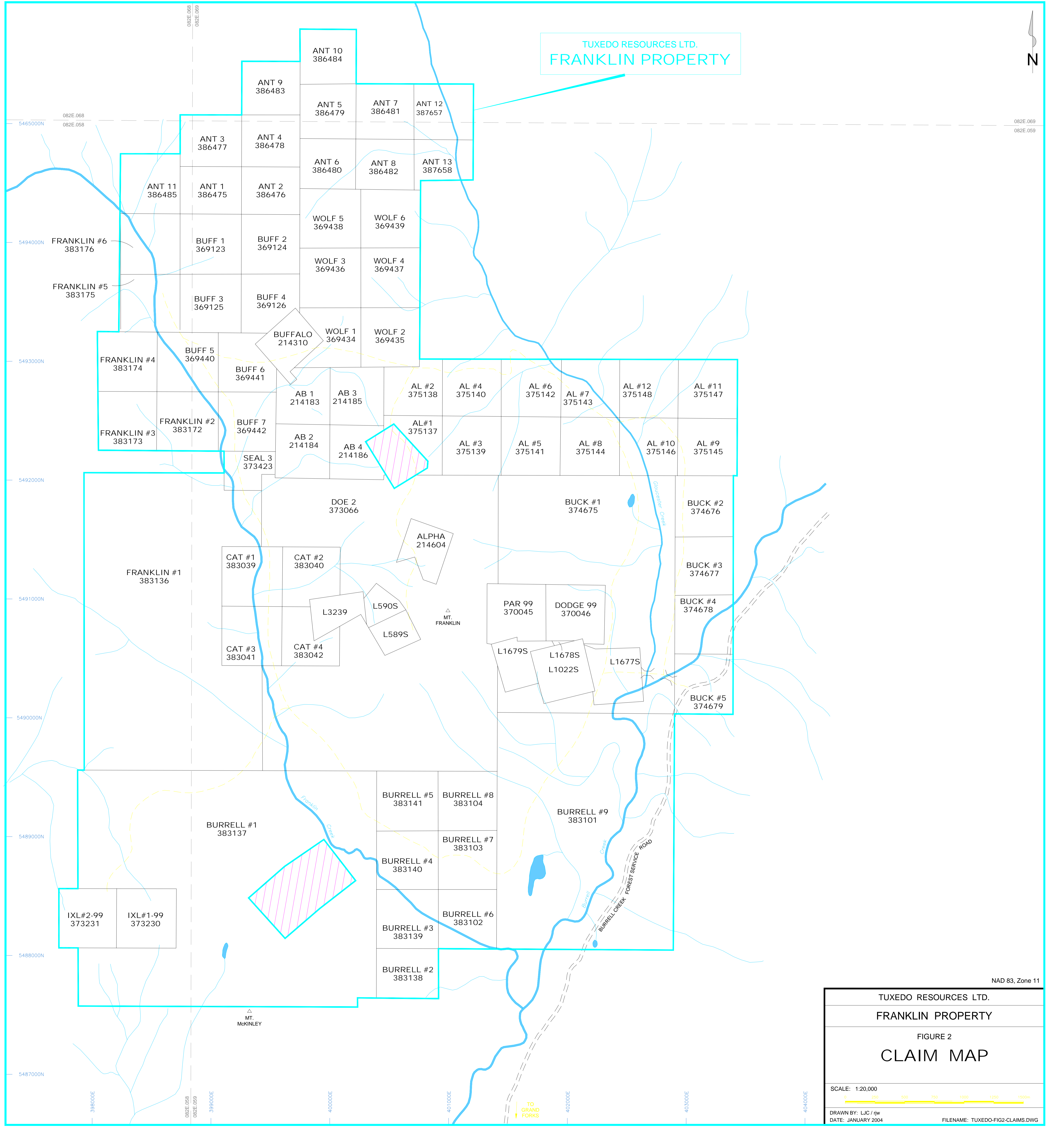
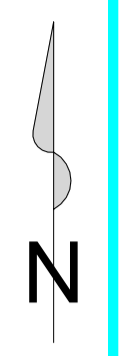

NAD 83, Zone 11

TUXEDO RESOURCES LTD.	
FRANKLIN PROPERTY	
FIGURE 2	
CLAIM MAP	
SCALE: 1:20,000	
DRAWN BY: LIC / rjw	
DATE: JANUARY 2004	
FILENAME: TUXEDO-FIG2-CLAIMS.DWG	

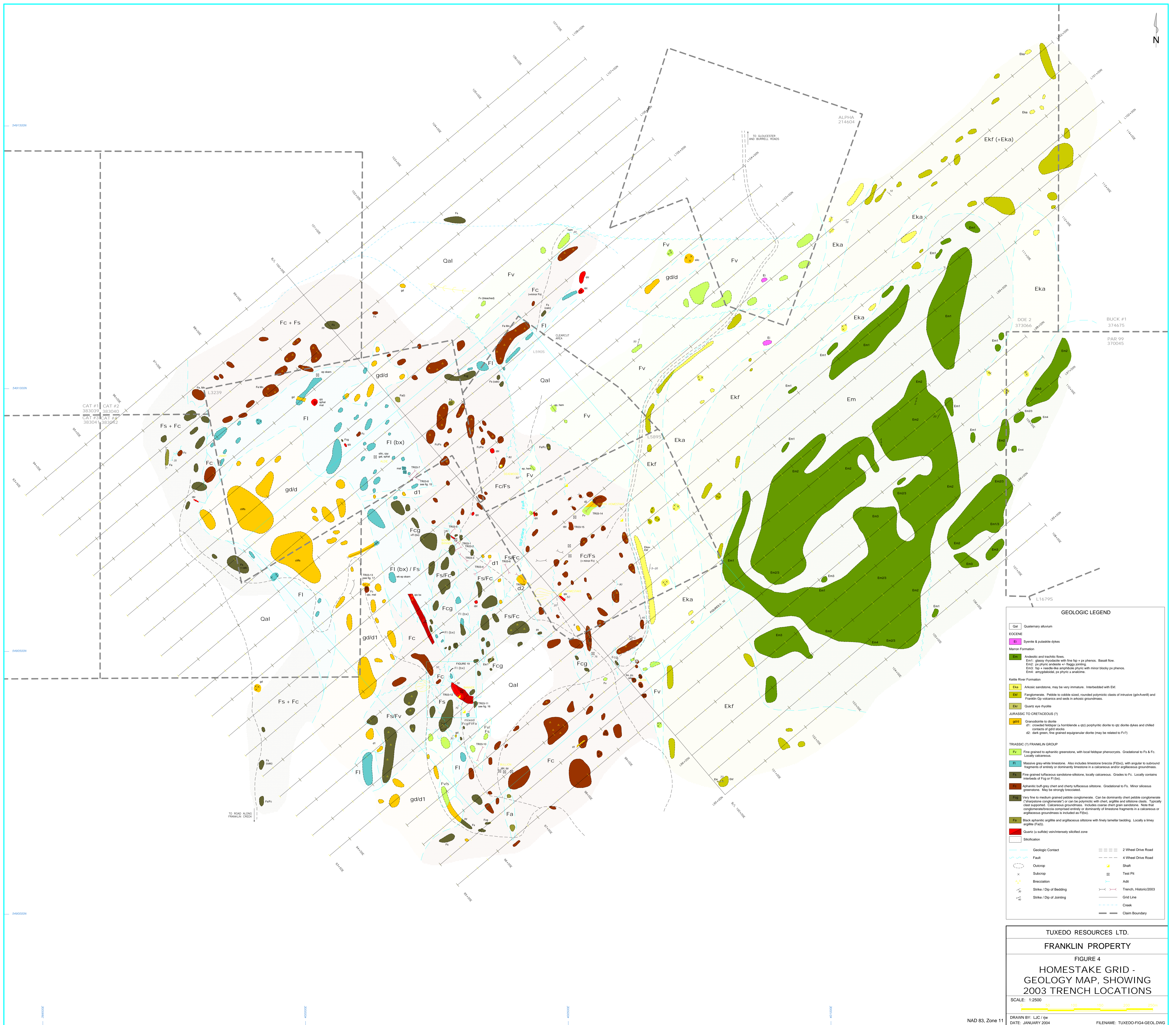

GEOLOGIC LEGEND	
Qal	Quaternary alluvium
EOCENE	
Em	Syenite & pulsate dykes
Mazon Formation	
Em1	Andesite and trachite flows. Em1: glass rhyolite with fine lap + px phenos. Basalt flow. Em2: px phytic andesite +/- raggy jointing. Em3: lap + needles-like amphibole phytic with minor blocky px phenos. Em4: amygdaloidal, px phytic + anatexis.
Kettle River Formation	
Eka	Arkasic sandstone, may be very immature. Interbedded with Ekl.
Em	Fanglomerate. Pebble to cobble sized, rounded polymictic clasts of intrusive (gla+Ar) and Franciscan Op. volcanics and seds in arkasic groundmass.
Eks	Quartz eye rhyolite
JURASSIC TO CRETACEOUS (?)	
Grd	Granodiorite to diorite
d1	crowded ledgipar (is hornblende + Qtz) porphyritic diorite to Qtz diorite dikes and chilled contacts of gld stocks
d2	dark green, fine grained equigranular diorite (may be related to Fv7)
TRIASSIC (?) FRANKLIN GROUP	
Fv	Fine grained to aphantic gneiss, with local ledgipar phenocrysts. Gradational to Fx & Fc. Locally calcareous.
Fb	Massive grey-white limestone. Also includes limestone breccia (FBbx), with angular to subround fragments of arctic or dominantly limestone in a calcareous and/or argillaceous groundmass.
Fg	Fine grained tuffaceous sandstone-siltstone, locally calcareous. Grades to Fc. Locally contains interbeds of Fcg or FI (bx).
Fh	Aphantic buff-grey chert and cherty tuffaceous siltstone. Gradational to Fx. Minor siliceous gneissosity. May be strongly brecciated.
Fj	Very fine to medium grained pebbly conglomerate. Can be dominantly chert pebble conglomerate ("sandstone conglomerate") or can be polymictic with chert, argillite and siltstone clasts. Typically chert supported. Calcareous groundmass. Includes coarse chert grain sandstone. Rare red conglomerate/breccia composed entirely or dominantly of limestone fragments in a calcareous or argillaceous groundmass is included as Fj(bx).
Fk	Black schmatic argillite and argillaceous siltstone with finely lamellar bedding. Locally a limy argillite (Fak).
Fs	Quartz (suffk) vein/veinously silicified zone
	Silicification
Geologic Contact	
Fault	
Outcrop	
Subcrop	
Brecciation	
Strike / Dip of Bedding	
Strike / Dip of Jointing	
2 Wheel Drive Road	
4 Wheel Drive Road	
Shaft	
Test Pit	
Aft	
Trench, Historic/2003	
Grid Line	
Creek	
Claim Boundary	

TUXEDO RESOURCES LTD.
 FRANKLIN PROPERTY
 FIGURE 4
 HOMESTAKE GRID -
 GEOLOGY MAP, SHOWING
 2003 TRENCH LOCATIONS
 SCALE: 1:2500
 DRAWN BY: LIC / jw
 DATE: JANUARY 2004
 NAD 83, Zone 11
 FILENAME: TUXEDO-FIG4-GEOL.DWG

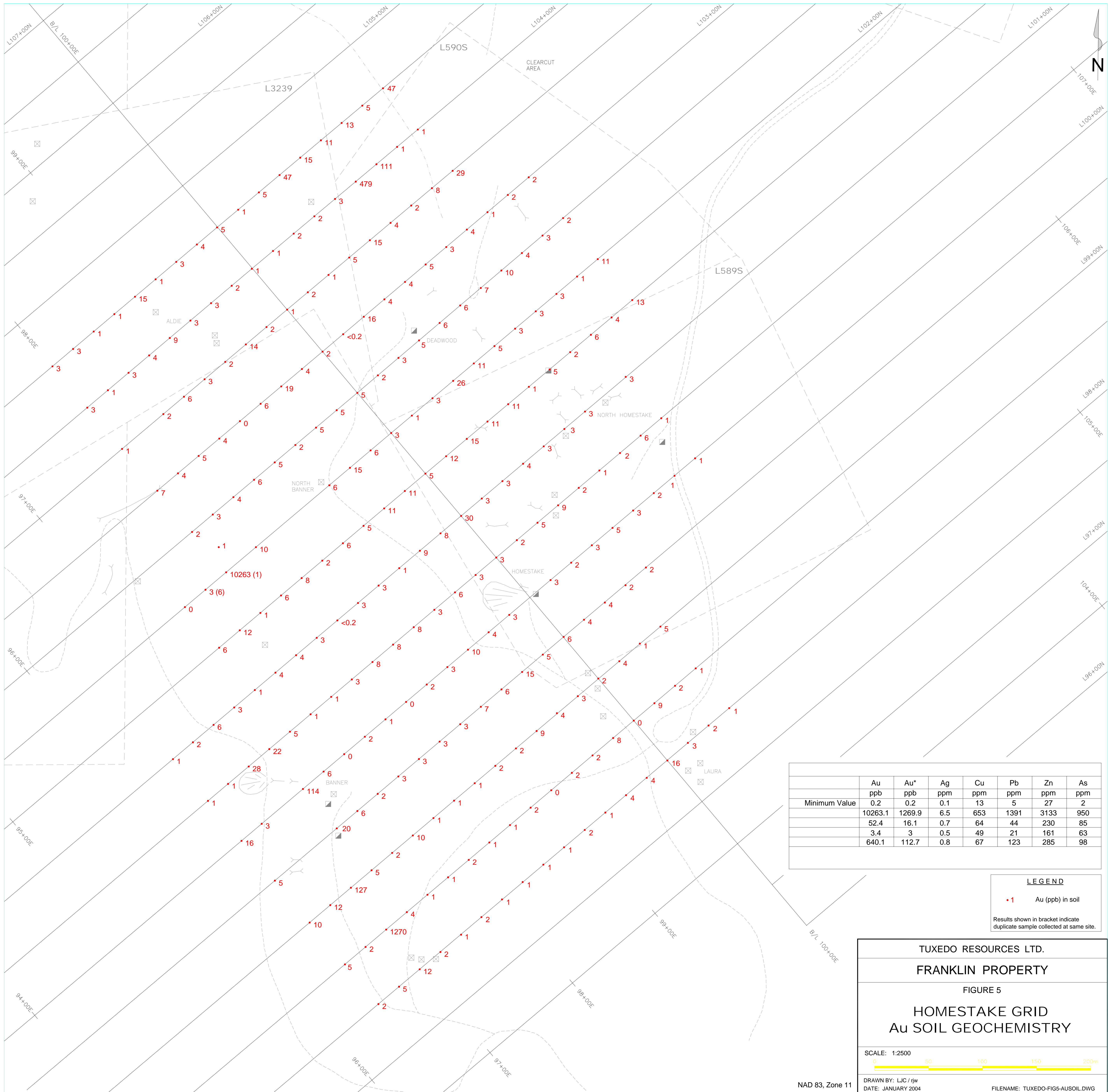

	Au	Au*	Ag	Cu	Pb	Zn	As
	ppb	ppb	ppm	ppm	ppm	ppm	ppm
Minimum Value	0.2	0.2	0.1	13	5	27	2
	10263.1	1269.9	6.5	653	1391	3133	950
	52.4	16.1	0.7	64	44	230	85
	3.4	3	0.5	49	21	161	63
	640.1	112.7	0.8	67	123	285	98

LEGEND

• 1 Au (ppb) in soil

Results shown in bracket indicate duplicate sample collected at same site.

TUXEDO RESOURCES LTD.
 FRANKLIN PROPERTY
 FIGURE 5
 HOMESTAKE GRID
 Au SOIL GEOCHEMISTRY

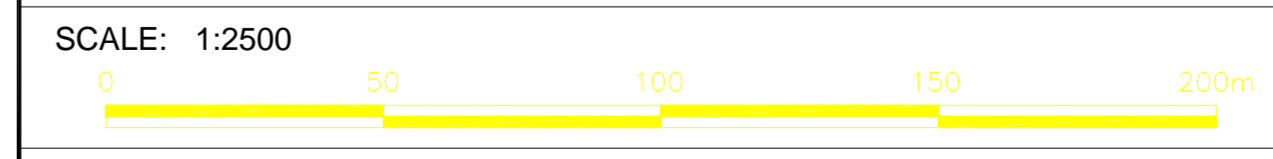

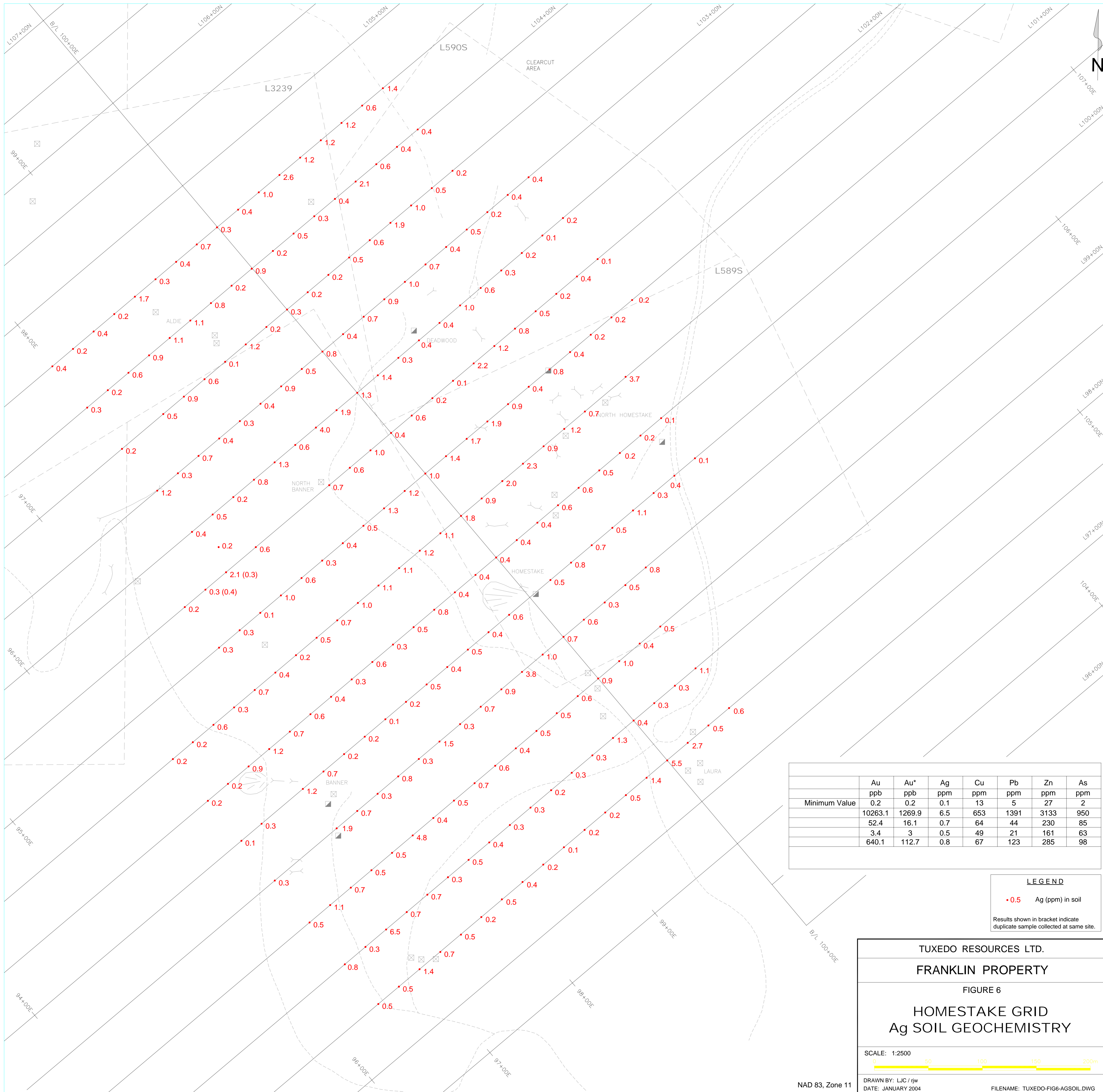

	Au	Au*	Ag	Cu	Pb	Zn	As
	ppb	ppb	ppm	ppm	ppm	ppm	ppm
Minimum Value	0.2	0.2	0.1	13	5	27	2
	10263.1	1269.9	6.5	653	1391	3133	950
	52.4	16.1	0.7	64	44	230	85
	3.4	3	0.5	49	21	161	63
	640.1	112.7	0.8	67	123	285	98

LEGEND
 •0.5 Ag (ppm) in soil
 Results shown in bracket indicate duplicate sample collected at same site.

TUXEDO RESOURCES LTD.
 FRANKLIN PROPERTY
 FIGURE 6
 HOMESTAKE GRID
 Ag SOIL GEOCHEMISTRY

SCALE: 1:2500

DRAWN BY: LJC / rjw
 DATE: JANUARY 2004
 FILENAME: TUXEDO-FIG6-AGSOIL.DWG

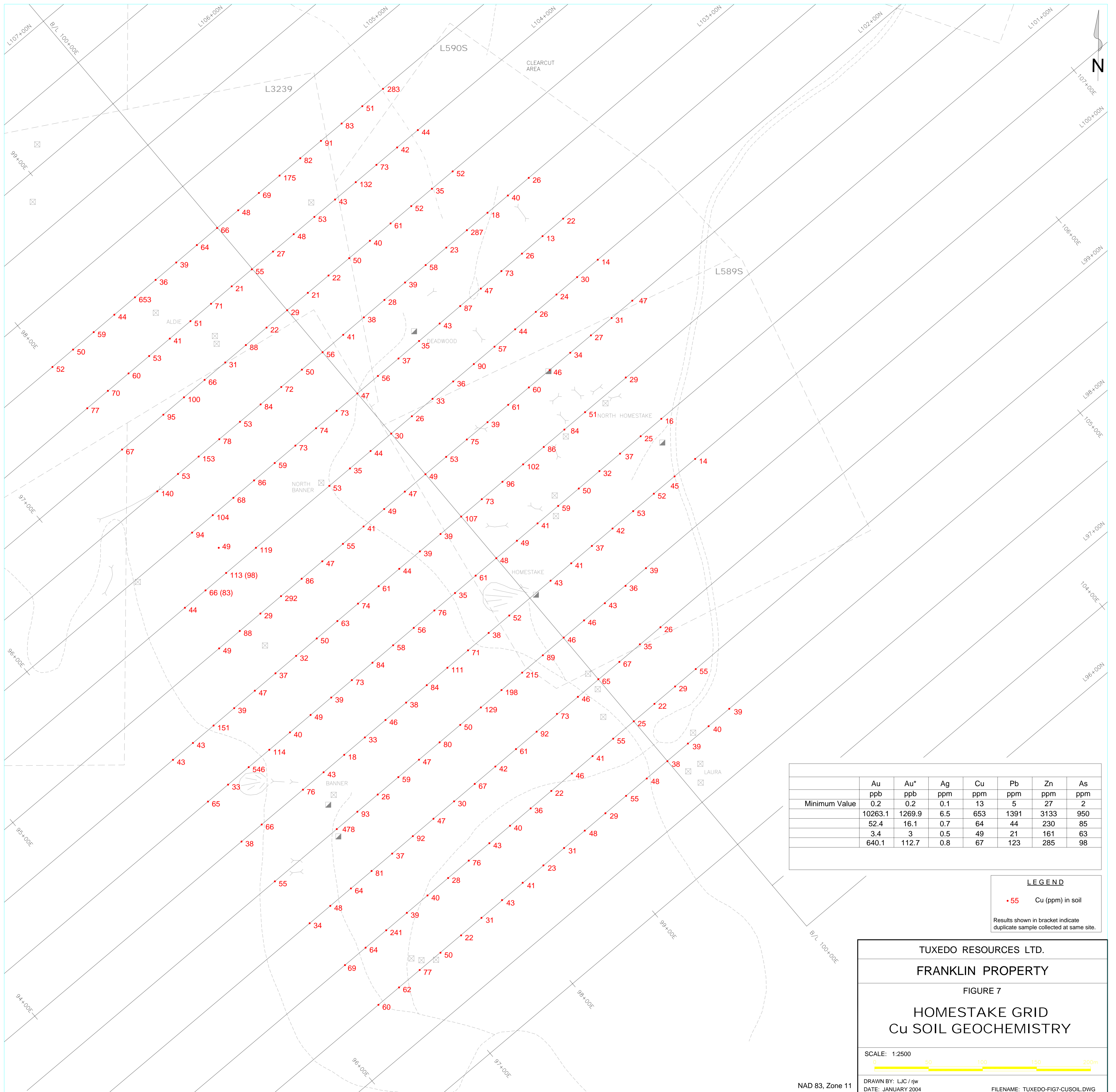

	Au	Au*	Ag	Cu	Pb	Zn	As
	ppb	ppb	ppm	ppm	ppm	ppm	ppm
Minimum Value	0.2	0.2	0.1	13	5	27	2
	10263.1	1269.9	6.5	653	1391	3133	950
	52.4	16.1	0.7	64	44	230	85
	3.4	3	0.5	49	21	161	63
	640.1	112.7	0.8	67	123	285	98

LEGEND

• 55 Cu (ppm) in soil

Results shown in bracket indicate duplicate sample collected at same site.

TUXEDO RESOURCES LTD.

FRANKLIN PROPERTY

FIGURE 7

HOMESTAKE GRID
Cu SOIL GEOCHEMISTRY

SCALE: 1:2500

0 50 100 150 200m

DRAWN BY: LJC / fjw
DATE: JANUARY 2004

FILENAME: TUXEDO-FIG7-CUSOIL.DWG

NAD 83, Zone 11

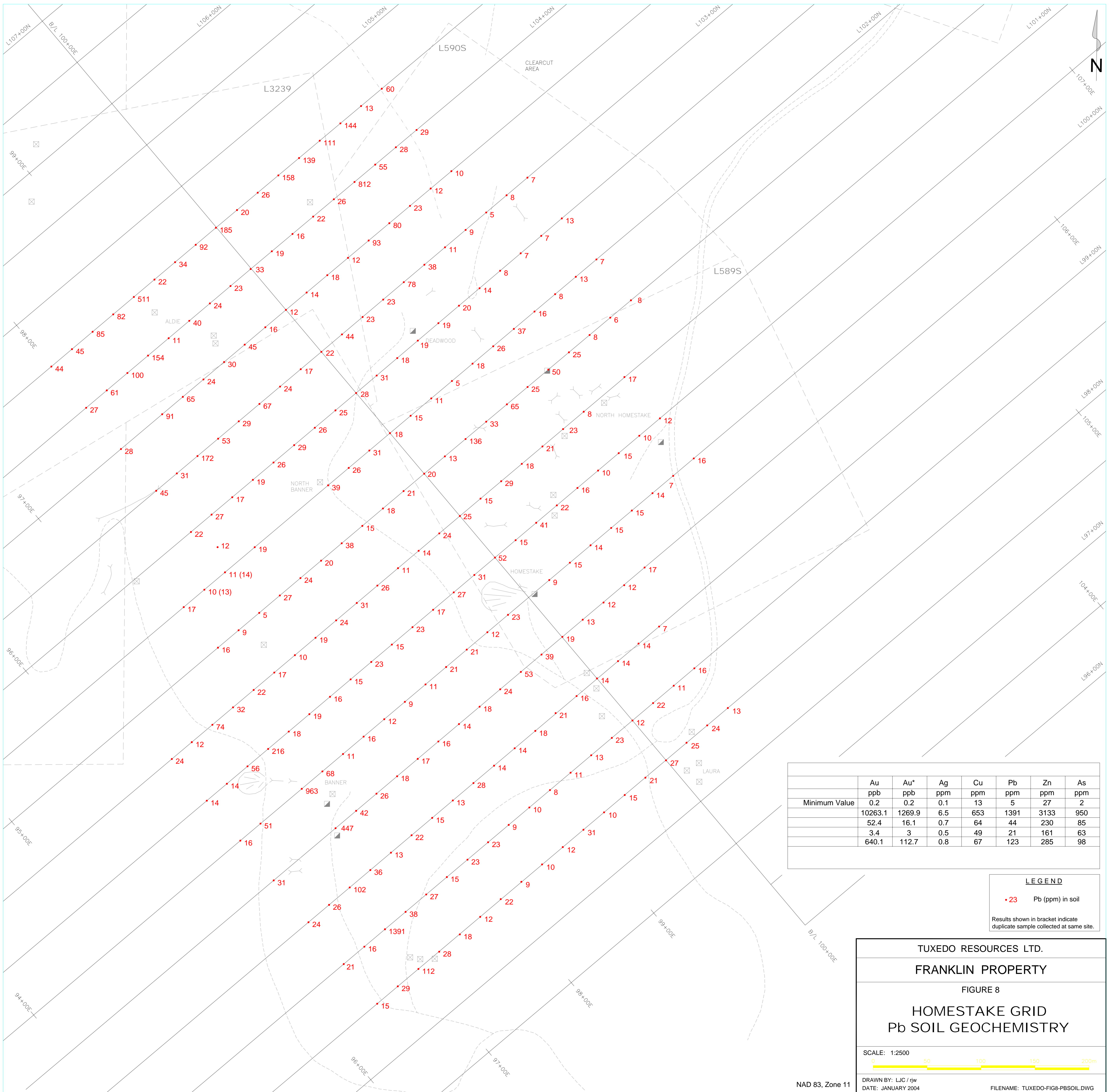

	Au	Au*	Ag	Cu	Pb	Zn	As
	ppb	ppb	ppm	ppm	ppm	ppm	ppm
Minimum Value	0.2	0.2	0.1	13	5	27	2
	10263.1	1269.9	6.5	653	1391	3133	950
	52.4	16.1	0.7	64	44	230	85
	3.4	3	0.5	49	21	161	63
	640.1	112.7	0.8	67	123	285	98

LEGEND

• 23 Pb (ppm) in soil

Results shown in bracket indicate duplicate sample collected at same site.

TUXEDO RESOURCES LTD.

FRANKLIN PROPERTY

FIGURE 8

HOMESTAKE GRID

Pb SOIL GEOCHEMISTRY

SCALE: 1:2500

DRAWN BY: LJC / rjw
DATE: JANUARY 2004

FILENAME: TUXEDO-FIG8-PBSOIL.DWG

NAD 83, Zone 11

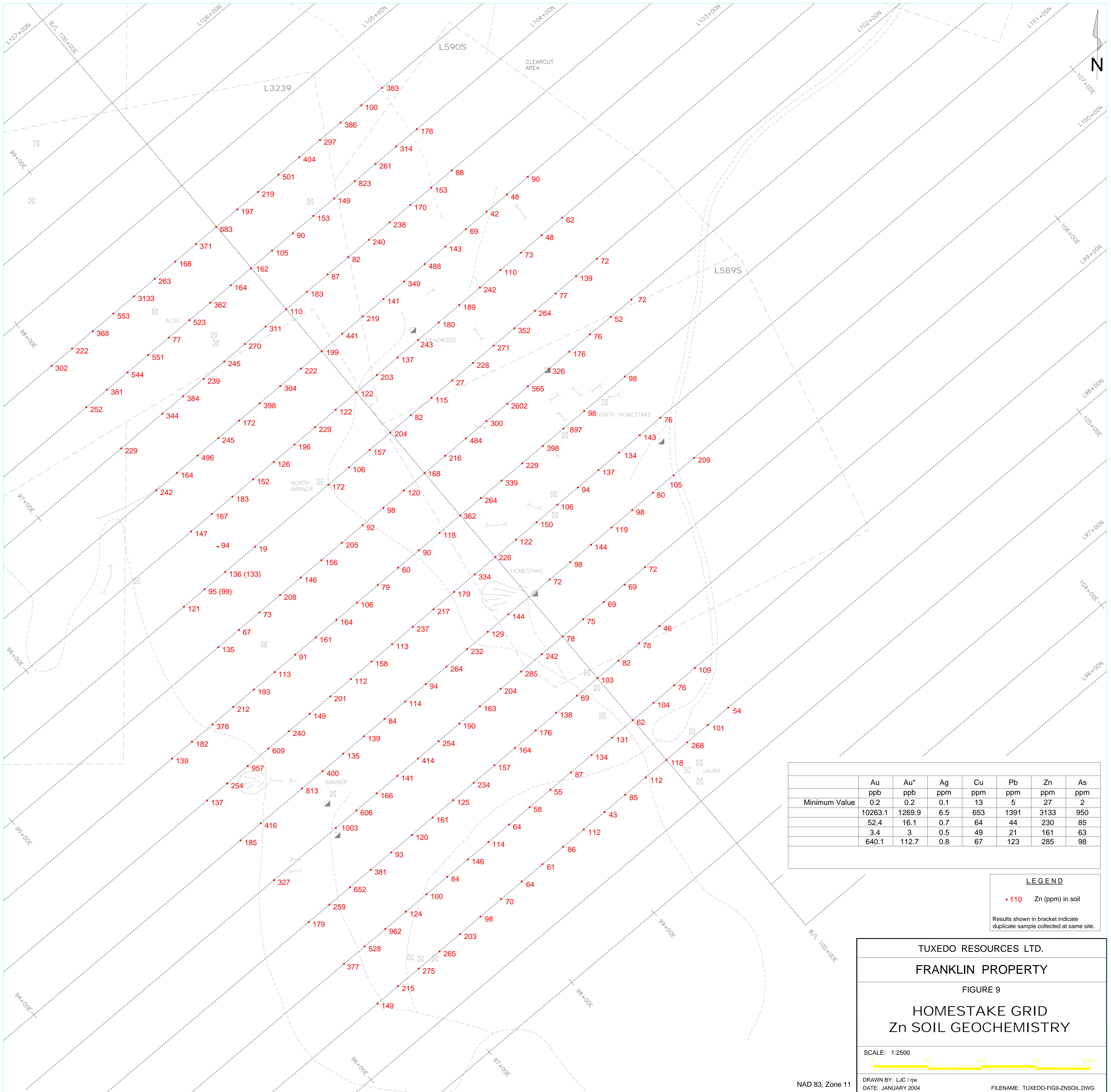

	Au	Au*	Ag	Cu	Pb	Zn	As
	ppb	ppb	ppm	ppm	ppm	ppm	ppm
Minimum Value	0.2	0.2	0.1	13	5	27	2
	10263.1	1269.9	6.5	653	1391	3133	950
	52.4	16.1	0.7	64	44	230	85
	3.4	3	0.5	49	21	161	63
	640.1	112.7	0.8	67	123	285	98

LEGEND

• 110 Zn (ppm) in soil

Results shown in bracket indicate duplicate sample collected at same site.

TUXEDO RESOURCES LTD.

FRANKLIN PROPERTY

FIGURE 9

HOMESTAKE GRID

Zn SOIL GEOCHEMISTRY

SCALE: 1:2500

DRAWN BY: LJC / rjw
DATE: JANUARY 2004

FILENAME: TUXEDO-FIG9-ZNSOIL.DWG

NAD 83, Zone 11

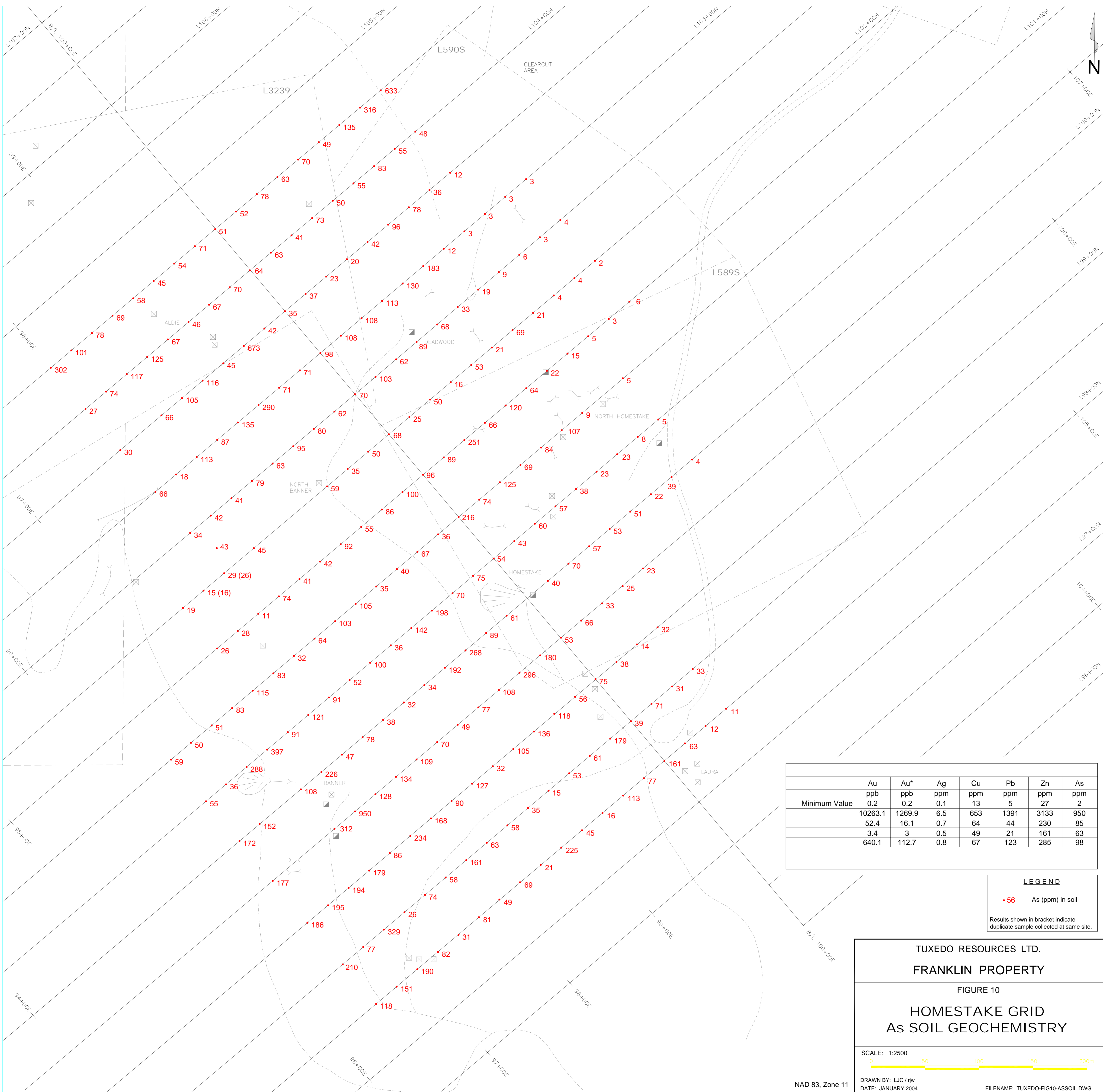

	Au	Au*	Ag	Cu	Pb	Zn	As
	ppb	ppb	ppm	ppm	ppm	ppm	ppm
Minimum Value	0.2	0.2	0.1	13	5	27	2
	10263.1	1269.9	6.5	653	1391	3133	950
	52.4	16.1	0.7	64	44	230	85
	3.4	3	0.5	49	21	161	63
	640.1	112.7	0.8	67	123	285	98

LEGEND

• 56 As (ppm) in soil

Results shown in bracket indicate duplicate sample collected at same site.

TUXEDO RESOURCES LTD.

FRANKLIN PROPERTY

FIGURE 10

HOMESTAKE GRID
As SOIL GEOCHEMISTRY

SCALE: 1:2500

DRAWN BY: LJC / rjw
DATE: JANUARY 2004

FILENAME: TUXEDO-FIG10-ASSOIL.DWG

NAD 83, Zone 11

TUXEDO RESOURCES LTD.
FRANKLIN PROPERTY

CONTOUR SOIL SAMPLE RESULTS

Sample ID	0.7	0.2	12	7	49	3.9
MR 5+50N	0.7	0.2	12	7	49	3.9
MR 5+25N	0.6	0.3	19	14	102	6.7
MR 5+00N	0.3	0.1	23	6	50	2.8
MR 4+75N	2.2	0.1	60	5	22	1.9
MR 4+50N	0.4	0.1	7	8	47	2.5
MR 4+25N	0.7	0.1	10	8	88	2.5
MR 4+00N	<.2	0.2	10	8	49	3.1
MR 3+75N	1.0	0.3	30	18	187	9.6
MR 3+50N	0.5	0.3	11	15	172	6.9
MR 3+25N	<.2	0.3	11	11	126	6.7
MR 3+00N	2.1	0.2	16	10	87	3.3
MR 2+75N	0.4	0.4	41	14	136	4.6
MR 2+50N	0.2	0.1	10	9	64	2.8
MR 2+25N	0.6	0.1	16	8	60	2
MR 2+00N	0.4	0.1	18	10	62	2.5
MR 1+75N	0.7	0.3	17	7	59	1.5
MR 1+50N	1.4	0.2	82	11	106	3.4
MR 1+25N	1.1	0.2	32	9	56	2.8
MR 1+00N	1.7	0.1	18	7	71	1.9
MR 0+75N	8.1	0.3	92	10	58	3.6
MR 0+50N	4.3	0.1	29	9	55	2.8
MR 0+25N	1.5	0.2	62	9	60	2.9
MR 0+00	1.5	0.2	35	8	64	2.5

ROCK SAMPLE RESULTS

Sample ID	64	3.0	124	206	129	162	29
JB001	64	3.0	124	206	129	162	29
JB002	89	8.1	560	221	160	25	
JB003	187	11.1	49	109	280	33	
JB004	304	2.2	116	23	35	107	<.5
JB005	58	2.2	116	23	35	107	<.5
JB006	170		46	694	122	50	
JB007	176		21	141	188	42	
JB008	784						
JB009	126					64	
JB010	104	9.1	105	444	124	47	
JB011	172	6.2	132	198	758	67	30
JB012	99					5	
JB013	90					1	
JB014	365		182	197	33	55	
JB015	237		150	104	11	50	
JB016			42	144	0	24	
JB017	13	0.3	304	48	30	8	36
JB018		1.2	350	7	15	42	72
JB019	44	0.7	328	2	34	7	16
JB020	22	1.3		5	82	54	70
JB021	4	0.3	101	17	63	30	12
JB022	2	0.3	168	7	45	62	7
JB023	5	0.2	117	2	44	4	5
JB024	12	0.1	55	2	59	15	8
JB025	4	0.1	111	3	67	13	<.5
JB026	3	0.1	136	2	25	9	<.5
JB027	11	0.1	46	1	42	5	8
JB028	3	0.2	56	13	85	22	3
JB029	<.2	0.1	68	3	30	12	5
JB030	1	0.1	9	3	6	6	<.5
JB031	0	0.0	22	1	52	5	5
JB032	6	0.3	478	2	97	12	5
JB033	10	0.2	94	5	42	37	<.5
JB034	42	0.4	100	6	61	37	8
JB035	0	0.0	19	6	23	2	<.5
JB036	<.2	0.0	14	7	18	1	<.5
JB037	1	0.0	6	5	17	1	<.5
JB038	5	0.4	146	3	24	5	<.5
JB039	0.8		39	3	9	3	5
JB040	1.2	26	14	13	31	<.5	
JB041	0.1	15	2	2	0	<.5	
JB042	112	1.2	783	8	23	142	<.5
JB043	22	0.6	284	16	19	53	<.5
JB044	342		45	77	169	129	
JB045	17	0.6	74	13	76	59	12
JB046	4	0.2	173	2	30	26	6
JB047	4	0.1	122	2	54	11	<.5
JB048	5	0.2	153	1	23	3	<.5
JB049	2	0.1	107	3	70	3	<.5
JB050	3	0.1	28	3	46	19	<.5
JB051	2	1.3	44	10	48	7	<.5
JB052	32	0.8	32	9	3	3	<.5
JB053	3	0.0	5	3	9	1	<.5
JB054	15	0.2	48	6	6	9	<.5
JB055	9	0.0	24	6	48	1	<.5
JB056	15	0.4	692	2	30	1	<.5
JB057	50	2.3	333	16	15	2	<.5
JB058	7	0.1	96	7	93	2	<.5
JB059	18	0.6	346	4	14	2	<.5
JB060	126	1.4	639	5	14	18	8
JB061	7	0.1	17	15	38	7	<.5
JB062	3	0.1	91	19	17	3	3
JB063	5	0.8	207	50	12	1	<.5
JB064	2	0.1	47	11	6	1	<.5
JB065	2	0.1	22	4	21	1	<.5
JB066	2	0.2	158	3	34	1	<.5
JB067	9	0.1	71	5	40	2	<.5
JB068	24	0.7	701	5	52	19	<.5
JB069	25	0.2	47	3	21	4	<.5
JB070	12	0.2	61	6	37	14	<.5
JB071	15	0.2	110	5	28	25	<.5
JB072	13	0.1	105	5	22	3	44
JB073	11	0.1	16	5	9	1	23
JB074	4	0.1	56	4	38	7	19
JB075	5	0.1	45	6	30	7	13
JB076	5	0.1	50	10	27	9	9
JB077	2	0.1	76	3	34	12	5
JB078	7	0.6	23	4	22	7	11
JB079	4	0.0	20	3	9	3	21
JB080	17.3	10	26	3	16	16	16
JB081	317		5	62	2	<.5	
JB082		8.8	385	155	800	33	26
JB083	124	1.2	89	17	20	50	5
JB084	21	0.3	13	16	115	20	7
JB085	17	0.1	112	3	106	2	<.5
JB086	8	8.9		106	249	49	28
JB087	8	6.3		800	524	23	36
JB088	8	3.6	414	69	169	10	
JB089	31	0.8	312	42	46	10	14
JB090	22	0.5	112	17	19	16	13
JB091	23	0.8	479	10	57	1	20
JB092	143	1.6	486	23	42	98	5
JB093	32	1.4	23	33	8	53	198
JB094	10	0.3	25	35	140	21	13
JB095	2	0.1	332	17	68	2	3
JB096	4	0.1	70	10	14	1	7
JB097	1	0.1	15	19	13	2	<.5
JB098	49	1.7	208	192	670	31	34
JB099		6.9		18	68	12	15
JB100	4	0.4	73	61	164	19	8
JB101	3	0.1	34	11	44	6	8
AE001	17	0.5	733	3	41	24	<.5
AE002	151	5.7		1	135	4	<.5
AE003	13	0.5	83	7	23	22	<.5
AE004	57					3	
AE005	77	10.4		18	45	3	9
AE006	37	1.5	62	26	18	38	10
AE007	84		362			52	81
AE008	<.4	3.9	24			29	

Note: - in the above table indicates analysis not done for that element.

LEGEND

- x JB006 2003 ROCK SAMPLE LOCATION
- MR0+51 2003 CONTOUR SOIL SAMPLE LOCATION

NAD 83, Zone 11

TUXEDO RESOURCES LTD.
FRANKLIN PROPERTY

FIGURE 11
ROCK & CONTOUR SOIL SAMPLE LOCATIONS & RESULTS

SCALE: 1:20,000

0 250 500 750 1000 1250 1500m

DRAWN BY: LJC / r/w
DATE: JANUARY 2004
FILENAME: TUXEDO-FIG11-ROCK-CNTSOIL.DWG

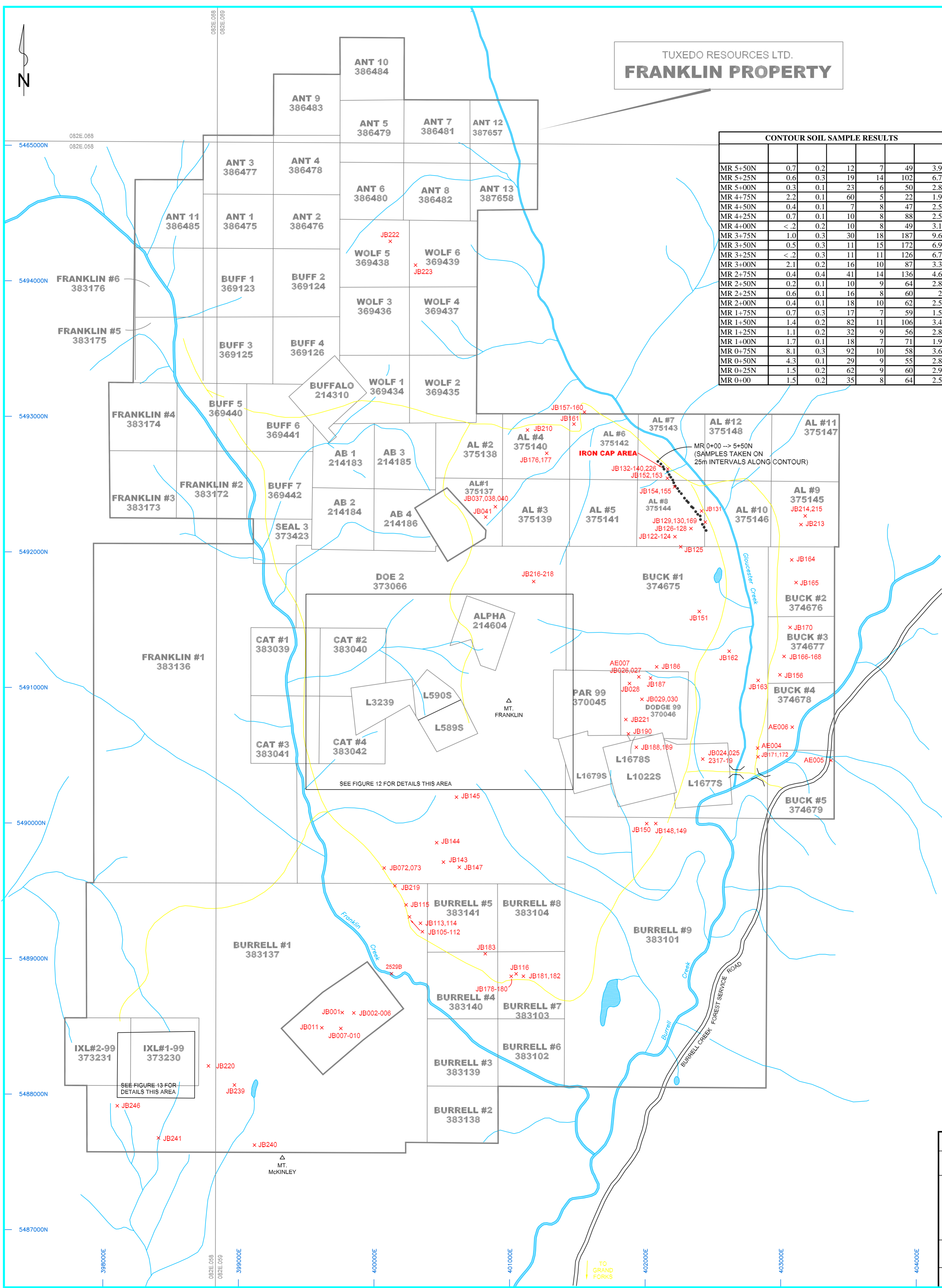

ROCK SAMPLE RESULTS				
JB 017				
JB 018	896	746	305	
JB 019	302			27
JB 020	817	47.6	1053	8660
JB 021	1439	> 100	13661	30464
JB 022	16.4			> 99999
JB 023				61
JB 029	17	0.3	56	14
JB 042	9	0.2	89	5
JB 043	10	0.5	49	15
JB 044	6	0.3	40	7
JB 045	4	0.1	16	3
JB 046	4	0.1	16	3
JB 047	6	0.8	176	27
JB 048	10	0.5	46	11
JB 049	24	5.4	290	36
JB 050	13	0.1	28	6
JB 051	150	13.9	515	19
JB 052	43	1.0	368	39
JB 053	42	13.8	172	9210
JB 054	20	2.7	93	697
JB 055	9	0.1	16	61
JB 056	4	0.1	7	14
JB 057	4	0.5	747	8
JB 058	1810			39
JB 059	1074	11.2	1511	3699
JB 061	1991	12.0	753	10979
JB 062	536	7.7	668	817
JB 063	19	1.1	46	10
JB 064	4	0.2	9	4
JB 065	8	0.2	9	4
JB 066	13	0.1	5	2
JB 067	9	0.2	25	13
JB 068	310	55.8	1821	14425
JB 069	20	4.3	699	54
JB 071	6	0.7	37	184
JB 074	4	0.3	37	18
JB 075	4	0.3	37	18
JB 076	151	1.9	813	3
JB 077	43	1.1	525	7
JB 078	16	0.5	279	4
JB 079	15	1.5	94	371
JB 080	11	0.9	49	114
JB 081	24	0.5	61	114
JB 082	673			27
JB 083	21	0.9	78	281
JB 084	45	0.3	23	40
JB 085	17	1.8	202	297
JB 086	72	5.9	221	17
JB 087	71	0.1	17	3
JB 088	5	0.2	74	8
JB 089	338	7.7	569	12
JB 090	5	0.1	74	10
JB 091	62	0.2	14	761
JB 092	4	0.0	1	3
JB 093	12	1.2	451	376
JB 094	3	0.7	100	10
JB 095	36	13.0	100	93
JB 096	16	0.8	97	136
JB 097	28	7.3	191	141
JB 098	11	2.8	191	9
JB 099	4	0.2	4	41
JB 100	11	10.4	3157	14897
JB 101	10	8.0	302	40
JB 102	3	0.4	154	133
JB 103	8	0.2	69	3
JB 104	103	5.8	7	16
JB 117	65	3.8	66	52
JB 118	26	2.6	69	24

JB 119	1	0.8	51	11
JB 120	3	0.3	24	7
JB 121	12	4.3	2507	3
JB 141	5	0.1	5	3
JB 142	49	24.9	5571	24
JB 146	17	0.0	24	13
JB 173	173	8.8	157	3029
JB 174	26	0.2	14	26
JB 175	32	0.2	79	28
JB 185	7	0.1	27	23
JB 191	79	6.6	1515	2210
JB 192	85	18.4	2214	1860
JB 224	3	0.1	7	21
JB 225	4	0.1	38	28
2301	234	56.1	162	129
2302	100	6.5	244	61
2303	4	0.4	35	26
2304	1982	4.0	193	138
2305	38	1.2	59	51
2306	30	1.8	36	40
2307	104	5.8	37	33
2308	2714	18.0	189	1562
2309	2695	19.1	272	3676
2310	703	2.1	52	189
2311	172	1.3	112	38
2312	4650	18.2	291	1632
2313	6612	17.9	355	1602
2314	9.38	46.8	1811	23454
2315	118	3.0	368	471
2316	57	2.0	28	114
2320	1	0.0	7	16
2321	260	77.9	23	120
2322	210	10.9	247	875
2323	66	1.1	14	17
2324	126	36.0	4352	1342
2325	1691	97.4	4091	8704
2326	826	49.6	4638	6633
2327	28	0.8	434	79
2328	13	0.7	301	45
2329	196	5.6	148	171
2330	322	4.5	331	721
2331	55	9.0	2015	1842
2332	6	0.3	91	29

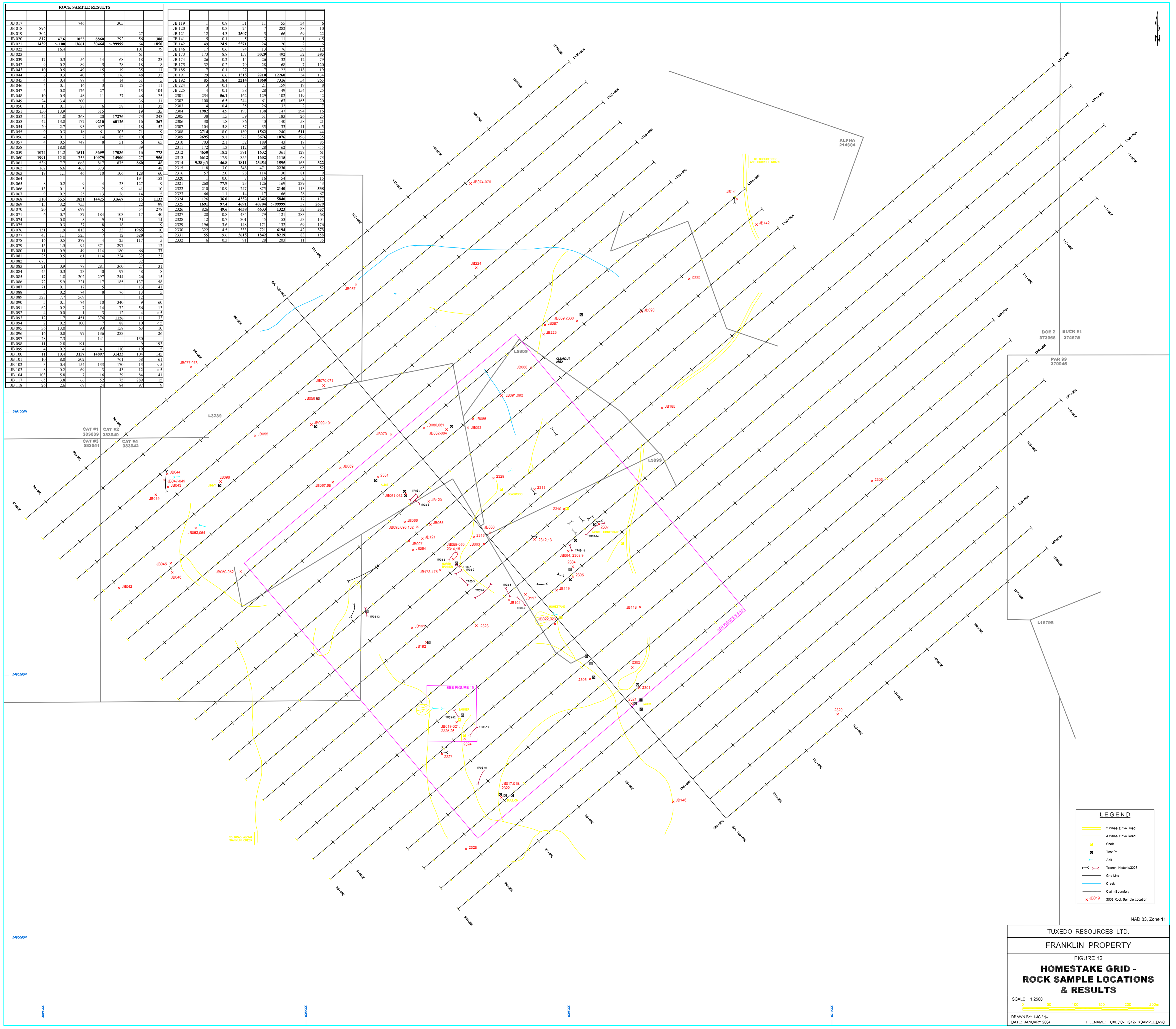

NAD 83, Zone 11

TUXEDO RESOURCES LTD.
FRANKLIN PROPERTY

FIGURE 12
**HOMESTAKE GRID -
ROCK SAMPLE LOCATIONS
& RESULTS**

SCALE: 1:2500
0 50 100 150 200 250m

DRAWN BY: LJC / jw
DATE: JANUARY 2004
FILENAME: TUXEDO-FIG12-TXSAMPLE.DWG

IXL AREA ROCK SAMPLE RESULTS							
JB 012		14.2		45	146	77	47
JB 013	366						
JB 014	104	1.4	632	27	20	5	15
JB 015	134	2.7	936	18	29	11	18
JB 016		7.1		45	35	9	8
JB 031	49	0.7	220	43	31	10	27
JB 032	149	2.0	310	10	22	13	60
JB 033	787	1.2		7	21	3	51
JB 034		7.3		27	76	275	142
JB 035	184	0.6	271	6	15	15	20
JB 036	49	0.2	80	6	46	3	10
JB 184	28	0.2	259	4	37	11	16
JB 193	18	0.3	33	28	159	18	7
JB 194	65	0.4	67	21	65	6	7
JB 195	37	0.4	135	7	58	<.1	12
JB 196	35	0.3	56	8	75	74	10
JB 197	120	4.6	20	972	124	288	93
JB 198	27	0.5	6	9	33	9	7
JB 199	32	0.5	110	10	32	4	5
JB 200	128	0.6	153	4	35	1	12
JB 201	92	2.0		5	58	6	<.5
JB 202	40	0.2	31	3	22	2	12
JB 203	74	2.3		4	25	10	11
JB 204	102	1.4	744	3	21	9	14
JB 205		3.0		15	75	86	24
JB 206	81	0.6	92	3	29	3	8
JB 207		1.3		2	105	9	7
JB 208		1.2		2	94	4	<.5
JB 209	637	2.1		3	87	18	8
JB 211	200						
JB 212	313						
JB 227	960	2.8	529	18	127	7	243
JB 228	267	1.4		10	68	5	72
JB 229	666	1.3	570	5	167	6	30
JB 230		9.3	886	27	11	47	51
JB 231	9	0.3	39	2	30	6	17
JB 232	67	0.5	692	3	19	3	46
JB 233		3.2		3	25	10	25
JB 234		1.4		3	38	3	18
JB 235	37	0.5	797	4	25	3	12
JB 236	18	3.0				95	
JB 237	25	6.0		201		10	
JB 238	352						
JB 242	3	1.2	162	447	802	4	48
JB 243		7.8		7	48	15	16
JB 244	212	0.6		6	28	15	9
JB 245	208	0.8	380	5	125	4	7

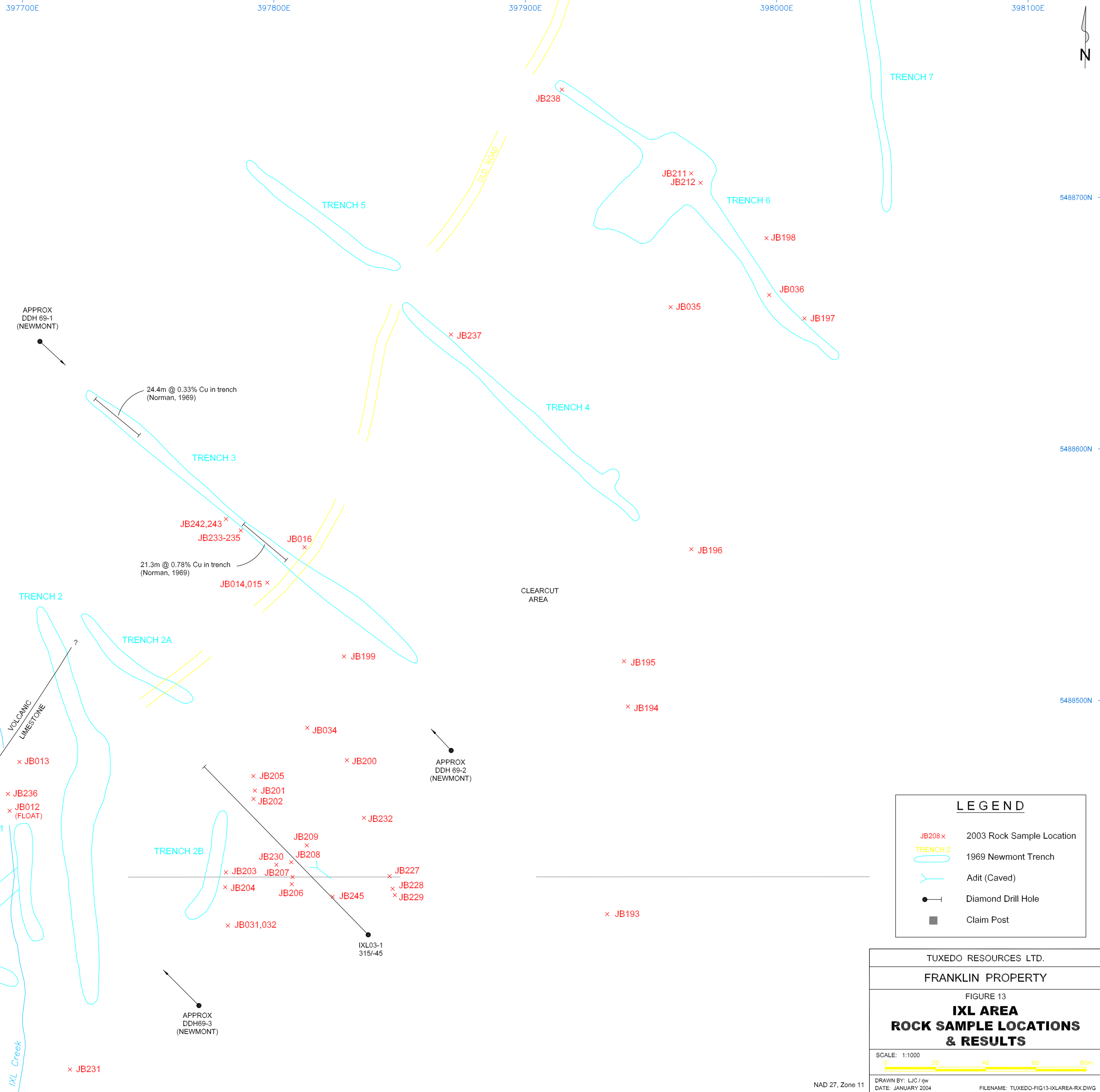

LEGEND

- JB208 x 2003 Rock Sample Location
- TRENCH 2 1969 Newmont Trench
- Adit (Caved)
- Diamond Drill Hole
- Claim Post

TUXEDO RESOURCES LTD.
 FRANKLIN PROPERTY
 FIGURE 13
**IXL AREA
 ROCK SAMPLE LOCATIONS
 & RESULTS**

SCALE: 1:1000
 0 20 40 60 80m

DRAWN BY: LJC / rjw
 DATE: JANUARY 2004
 FILENAME: TUXEDO-FIG13-IXLAREA-RX.DWG