

RECEIVED

SEP 14 2004

Gold Commissioner's Office
VANCOUVER, B.C.

ASSESSMENT REPORT
PROSPECTING PROGRAM

CP 1 - 26
TRAIL CREEK MINING DIVISION

N.T.S. MAPSHEETS 082E040 – 082F031

UTM COORDINATES 5466000N – 426000E

Work Performed: Summer 2003

OWNER
Tom Kennedy
404-22nd Ave N
Cranbrook BC V1C 5B9

REPORT BY
Craig Kennedy
Prospector
2290 Dewolfe Ave
Kimberley BC V1A 1P5

27195
GEOLOGICAL SURVEY OF CANADA
ASSESSMENT REPORT

Table of Contents

	<u>Page</u>
1.00 INTRODUCTION	3
1.10 Location & Access	3
1.20 History	3
1.30 The Property	3
2.00 PROSPECTING	6
3.00 CONCLUSION	7
4.00 STATEMENT OF EXPENDITURES	8
5.00 AUTHOR'S QUALIFICATIONS	9

List of Illustrations

Figure 1-Property Location Map	4
Figure 2-Claim Location Map	5
Figure 3-Prospecting Map	Pocket

CP 1 - 26

PROSPECTING ASSESSMENT REPORT

Craig Kennedy

September 2004

1.00 INTRODUCTION

1.10 LOCATION & ACCESS:

The CP 1 – 26 claims are located in the Trail Creek mining district of South East British Columbia (NTS: 1:20,000 – scale maps 082E040 & 082F031). The Upper Sheep Creek logging road provides truck access. The property is rolling moderate terrain with wet thickly vegetated low lands, semi open hillsides and ridge tops. Forty percent of the property was industrial logged 10 to 25 years ago. Logging access trails provide good foot access to most areas of the property.

1.20 HISTORY:

The CP Property has been held under tenure by majors, juniors and individuals through the past 100 years. Previous work in the area has targeted the potential for economic vein and or porphyry stle molybdenite mineralization. The majority of this work including some drilling was done in the late 1970's and early 1980's. (Assessment report #5197)

1.30 THE PROPERTY:

The CP property is 26 contiguous two post units owned by Tom Kennedy of 404-22nd Ave N, Cranbrook BC V1C 5B9.

Figure 1: Regional location map



DAVENPORT MAPS LTD

CP Claims

Figure 2: Claim Location Maps

Maps # 082E040 & 082F031

Scale 1:20,000

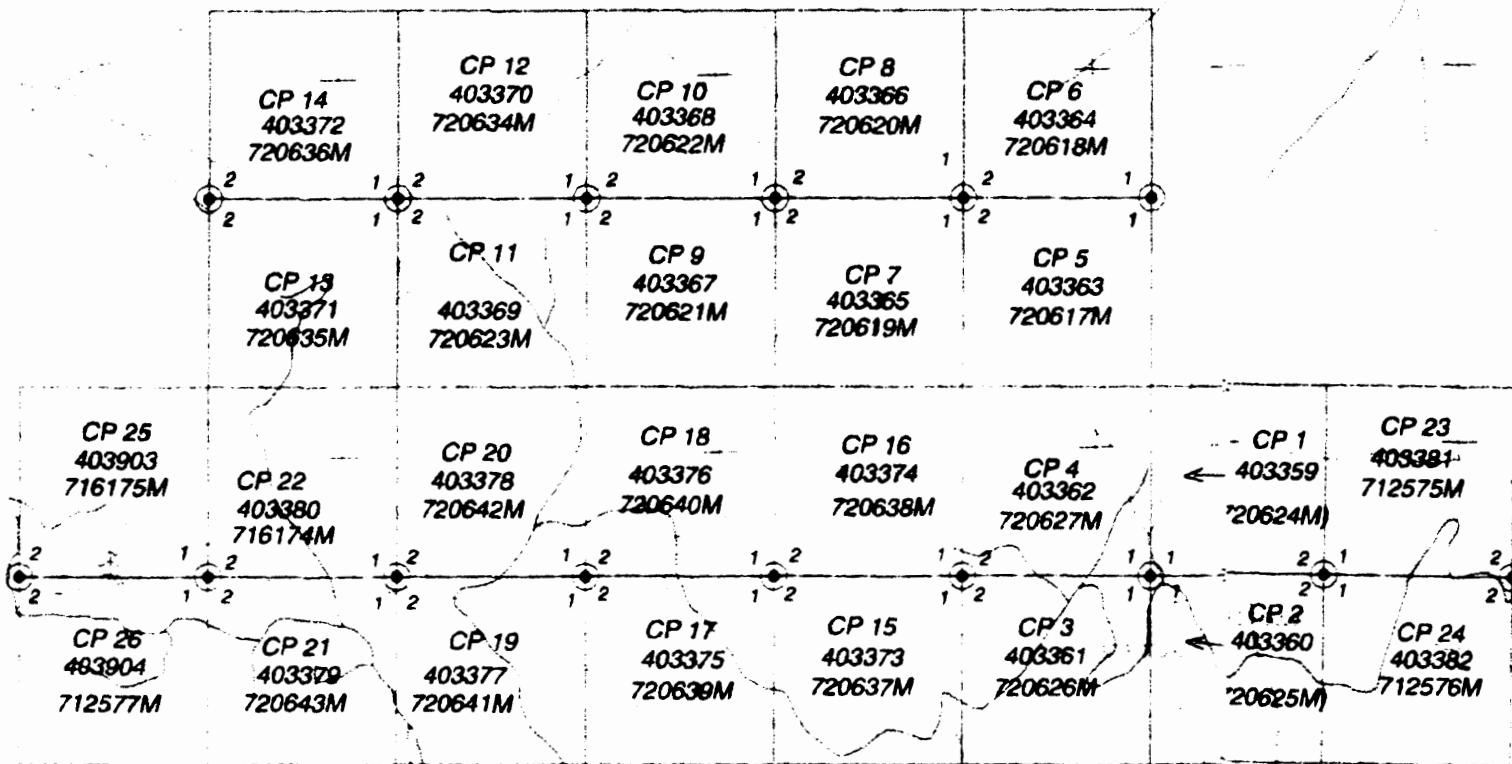

2.00 PROSPECTING REPORT – CP 1 – 26 Claims

The CP claims were established to cover the historic Mount Shields molybdenite occurrences. As mentioned previously the area had seen extensive exploration activity during the 1970's and 80's. This work targeted porphyry alteration associated with the Upper Sheep Creek structural zone.

South of Mount Shields the Upper Sheep Creek structural zone develops envelopes of intensive argillic, manganese alteration. This alteration also has shearing and quartz veining; some quartz veining has a very distinctive epithermal character.

The following are features of interest encountered during prospecting the CP claim group.

1) Iron Oxide Mineralization

The CP claims and adjacent area host a very extensive fracture and quartz vein network of magnetite-hematite mineralization. Most of this mineralization is associated with limonite staining. Chalcopyrite, molybdenite, galena and sphalerite were also noted with veins and along fractures. There does not seem to be preferred orientation for the iron oxide veining.

2) Pyrite Mineralization

Pyrite mineralization is wide spread, occurring mostly as disseminations and as patches, some areas host pods of massive pyrite, these zones are associated with areas of increased silicification. Other minerals noted with increased levels of pyrite were molybdenite on fractures and rare chalcopyrite.

3) Fluorite Alteration

In areas where there is more silicification, pyrite, carbonate and manganese, quite impressive amounts of fluorite are often seen. Cubic crystals to 1cm in width have been noted, the

fluorite is multi colored with green and purple the most common. The more massive pyrite zones often contain the heaviest amounts of fluorite, all carbonate alteration especially along fractures with manganese also contain abundant fluorite. The fluorite alteration is of primary interest in light of the fact the epithermal quartz noted in the Upper Sheep Creek structure is associated with it.

4) Polyolithic Breccia Zone

Exposures of this east west structure can be traced in excess of 1km and the zone reaches widths close to 60 meters. Both fragments and matrix contain disseminations of pyrite, hematite and magnetite, occasional grains and crystals of molybdenite and fluorite were noted. Micro quartz veining is also another common feature of this silicified breccia zone.

3.00 CONCLUSION

The CP claims are located where the Upper Sheep Creek (NS) structure intersects the polyolithic (EW) structure. This is the obvious focus for the previous explored porphyry mineralization. Of importance now is the occurrence of epithermal quartz veining in the Upper sheep Creek structure to the south.

To the south the epithermal quartz veins are associated with very intensely altered argillic envelopes. These types of alteration zones would not be exposed in the lowland areas of the CP claims, the porphyry alteration is associated with silicified zones so it forms more resistant flank and ridge outcrops.

Rock samples should be collected from as many quartz veins as possible. Along with this, soil sampling should be done in the area of the projected Upper Sheep Creek structure. If gold anomalies are created geophysics might help to find buried argillic alteration zones.

4.00

STATEMENT OF EXPENDITURES

Prospecting Program
CP 1 - 26 Property

Work performed Summer 2003

PROSPECTING CONTRACTORS:

Tom Kennedy, Cranbrook BC 5days @ \$450.00/day (includes 4X4 vehicle)	\$2250.00
Craig Kennedy Kimberley BC 3days @ \$450.00/day (includes 4X4 vehicle)	\$1350.00
Craig Kennedy - report preparation and writing 1 day @ \$350.00/day (includes typing, drafting & supplies)	<u>350.00</u>
Total:	<u>\$3950.00</u>

Craig Kennedy

Craig Kennedy
Prospector

5.00 Statement of Qualifications

As the author of this report I, Craig Kennedy, certify that:

1. I am an independent prospector residing at 2290 Dewolfe Avenue, Kimberley BC.
2. I have been actively prospecting in the East and West Kootenays district of BC for the past 27 years and have made my living prospecting for the past 15 years.
3. I have been employed as a professional prospector by major and junior mineral exploration companies.
4. I own and maintain mineral claims in BC and have optioned numerous claims to various exploration companies.

Craig Kennedy

Craig Kennedy
Prospector

