

**LEGEND**

- Topographic Contours (20m Contour Interval)
- Drainage
- Roads / Trails

**Eocene - Ootsa Lake Group**

- Edw Basalt, rhyolite
- Ti Feldspar porphyry

**LATE CRETACEOUS-Eocene**

- KTqfp quartz-feldspar porphyry
- Bx Breccia: angular clasts with spy cement

**LATE CRETACEOUS - BULKLEY INTRUSIVE SUITE**

- LKBPqfns Porphyritic Granodiorite, Quartz-feldspar porphyry,
- pqm,qd,qd Granodiorite, Quartz diorite to diorite

**LOWER TO MIDDLE JURASSIC - HAZELTON GROUP**

- mJS Smilfers formation
- ImJW rhyolitic pyroclastics
- ImJS Nihilwa formation?
- IJT siltstone, mudstone
- IJT Telawa formation
- IJT orogenic pyroclastics

Geological Contact and/or Fault

Vein

Geology from: MacIntyre (2004)

Pre-2004 Drill Hole

S05-09 2004-2005 Drill Hole with ID

Trench

IP chargeability high (2004)  
(3D inversion, -100m level)  
(120,70,60,50 unit contours)

Projection & Datum: NAD 83, UTM, Zone 9

0 500 m

**Grayd Resource Corp.**

**SEEL PROPERTY**

BRITISH COLUMBIA

**PROPERTY COMPILATION**

Scale: 1:5000 BCGS: 093E065  
Date: June 2005 NTS: 93E/11E **Fig. 5**

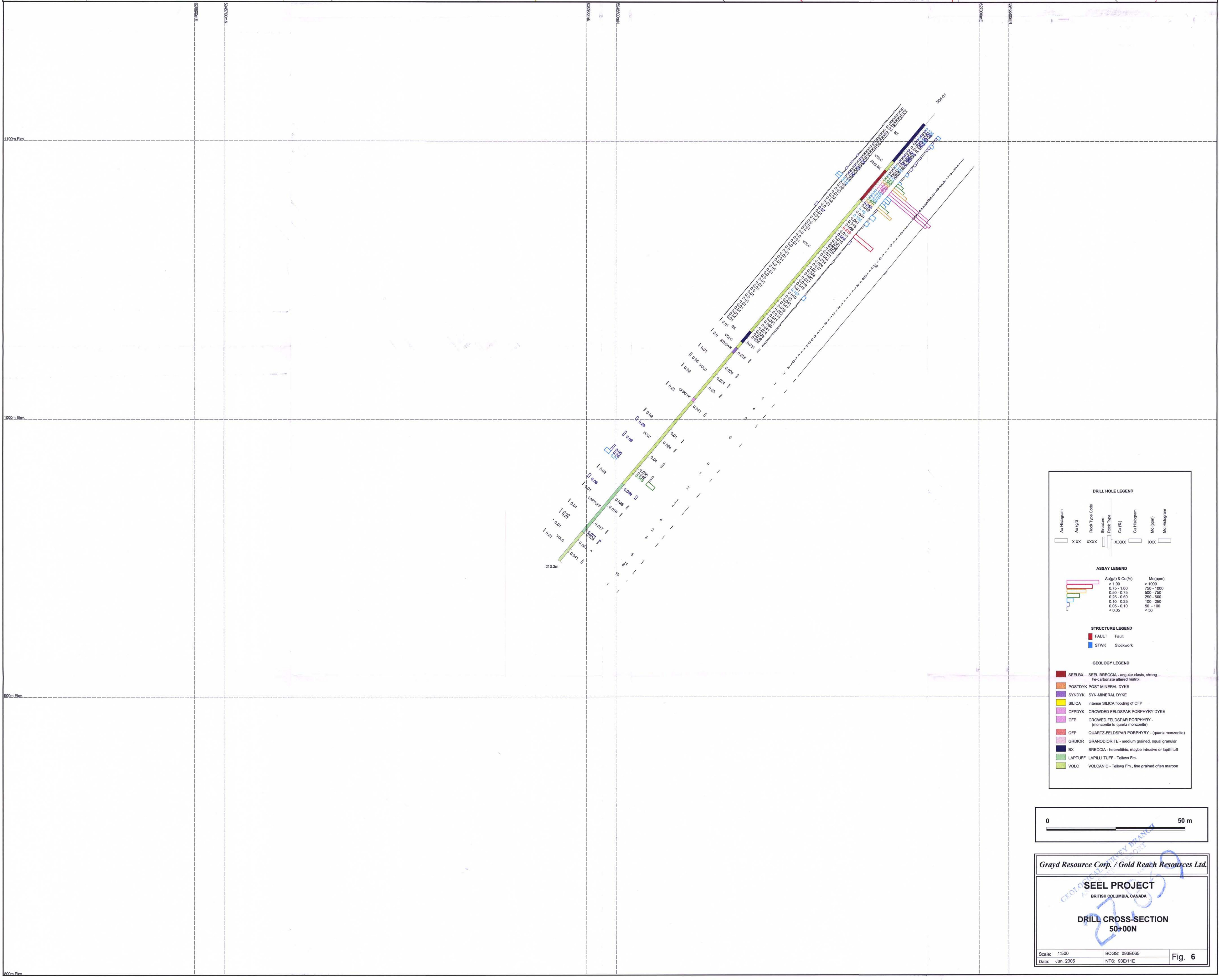
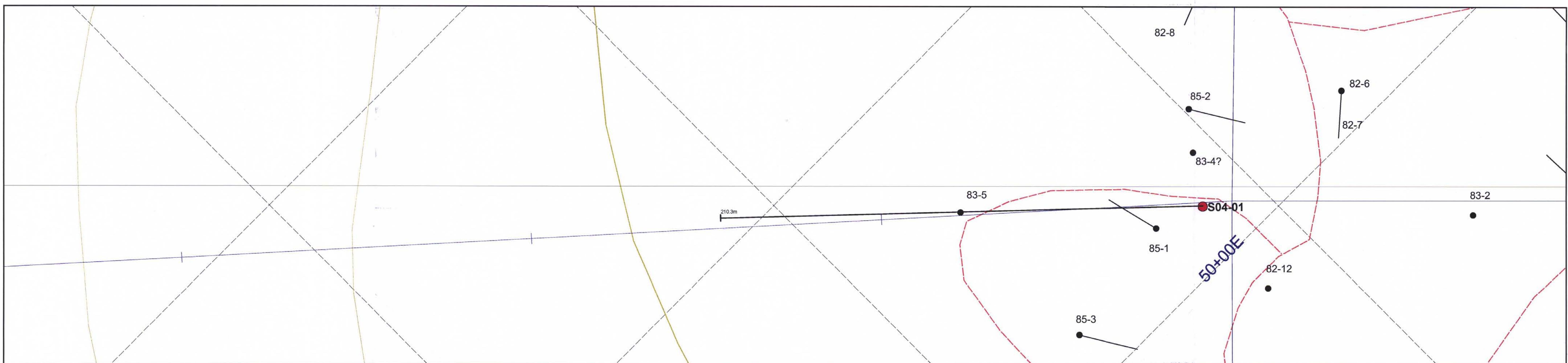

**DRILL HOLE LEGEND**

Au Histogram: X.XX  
 Au (g/t): XXXX  
 Rock Type Code: X.XXX  
 Structure: XXX  
 Cu (g/t): X.XXX  
 Cu Histogram: XXX  
 Mo (g/t): XXX  
 No Histogram: XXX

**ASSAY LEGEND**

Au(g/t) & Cu(%)	Mg(ppm)
> 1.00	> 1000
0.75 - 1.00	750 - 1000
0.50 - 0.75	500 - 750
0.25 - 0.50	250 - 500
0.10 - 0.25	100 - 250
0.05 - 0.10	50 - 100
< 0.05	< 50

**STRUCTURE LEGEND**

■ FAULT Fault  
 ■ STWK Stockwork

**GEOLOGY LEGEND**

■ SEELBX SEEL BRECCIA - angular clasts, strong Fe-carbonate altered matrix  
 ■ POSTDYK POST MINERAL DYKE  
 ■ SYNDYK SYNMINERAL DYKE  
 ■ SILICA Intense SILICA flooding of CFP  
 ■ CFPDYK CROWDED FELDSPAR PORPHYRY DYKE  
 ■ CFP CROWDED FELDSPAR PORPHYRY - (monzonite to quartz monzonite)  
 ■ QFP QUARTZ-FELDSPAR PORPHYRY - (quartz monzonite)  
 ■ GRDIOR GRANODIORITE - medium grained, equal granular  
 ■ BX BRECCIA - heterolithic, maybe intrusive or lapilli tuff  
 ■ LAPLUFF LAPILLI TUFF - Telkwa Fm.  
 ■ VOLC VOLCANIC - Telkwa Fm., fine grained often maroon

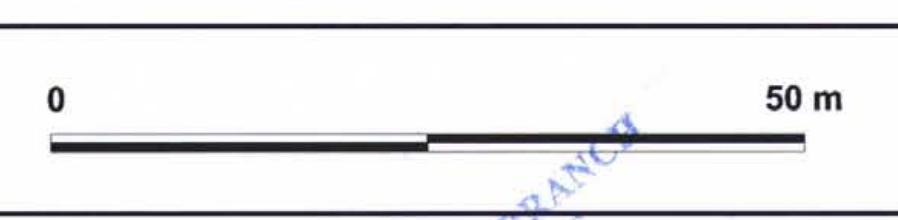

Grayd Resource Corp. / Gold Reach Resources Ltd.

**SEEL PROJECT**  
BRITISH COLUMBIA, CANADA

**DRILL CROSS-SECTION**  
50+00N

Scale: 1:500  
Date: Jun 2005  
BCGS: 093E065  
NTS: 90E/11E

Fig. 6

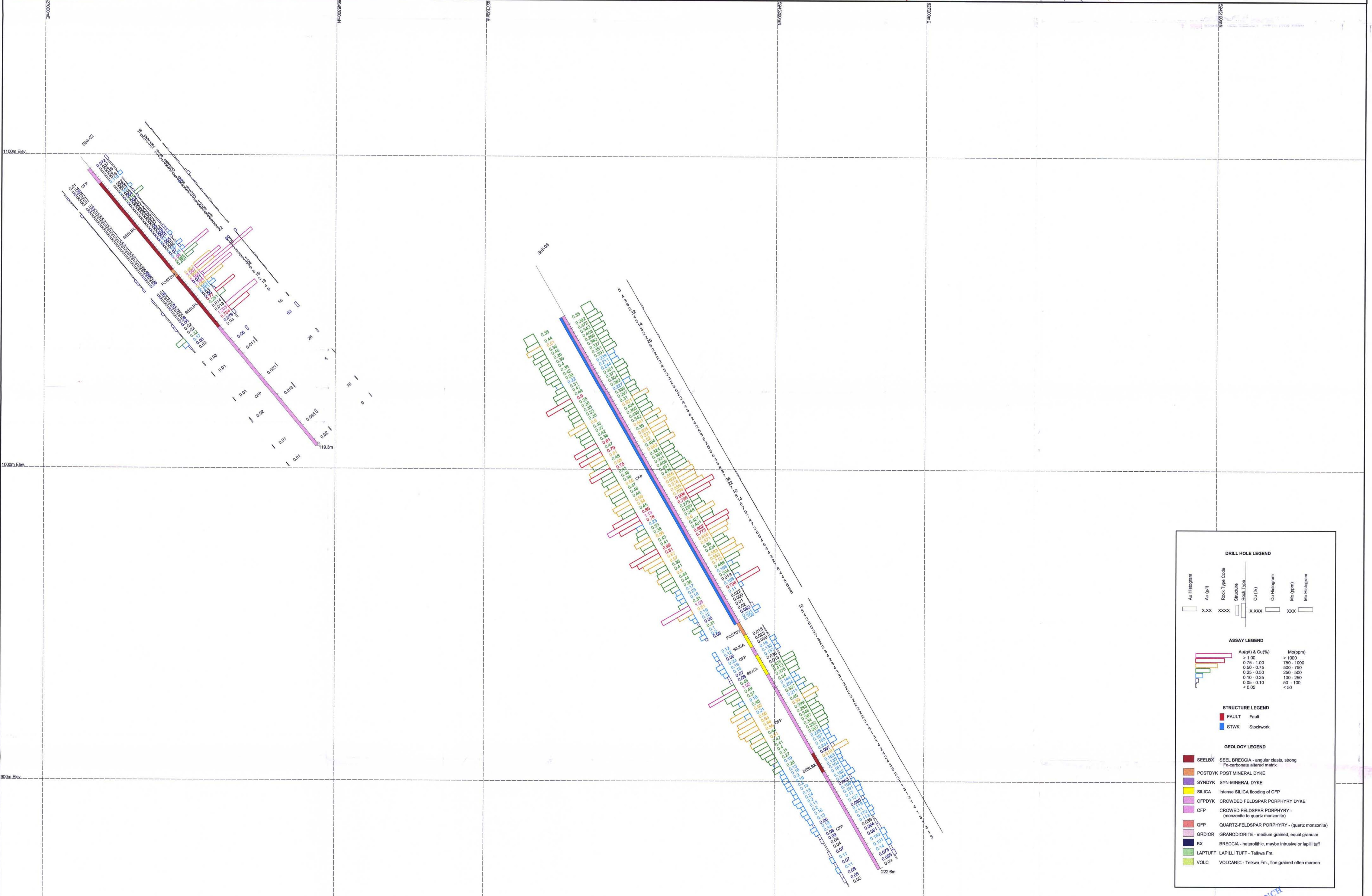
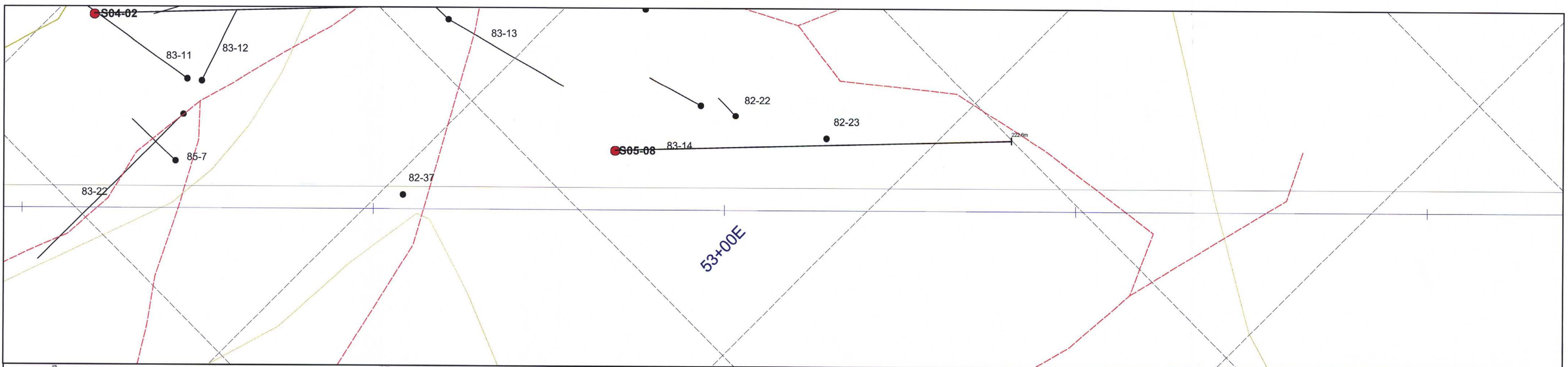

**DRILL HOLE LEGEND**

Au Histogram: XXX XXXX  
 Au (g/t): XXXX  
 Rock Type Code: XXXX  
 Structure: XXXX  
 Cu (%): XXXX  
 No (gpm): XXXX  
 No Histogram: XXXX

**ASSAY LEGEND**

Au(g/t) & Cu(%)	M(gpm)
> 1.00	> 1000
0.75 - 1.00	750 - 1000
0.50 - 0.75	500 - 750
0.25 - 0.50	250 - 500
0.10 - 0.25	100 - 250
0.05 - 0.10	50 - 100
< 0.05	< 50

**STRUCTURE LEGEND**

FAULT: Fault  
 STWK: Stockwork

**GEOLOGY LEGEND**

- SEELBX: SEEL BRECCIA - angular clasts, strong Fe-carbonate altered matrix
- POSTDYK: POST MINERAL DYKE
- SYNDYK: SYN-MINERAL DYKE
- SILICA: Intense SILICA flooding of CFP
- CFPDYK: CROWDED FELDSPAR PORPHYRY DYKE
- CFP: CROWDED FELDSPAR PORPHYRY - (monzonite to quartz monzonite)
- QFP: QUARTZ-FELDSPAR PORPHYRY - (quartz monzonite)
- GRDOR: GRANODIORITE - medium grained, equal granular
- BX: BRECCIA - heterolithic, maybe intrusive or lapilli tuff
- LAPLUFF: LAPILLI TUFF - Telkwa Fm.
- VOLC: VOLCANIC - Telkwa Fm., fine grained often micaceous



Geological Survey Branch

Grayd Resource Corp. / Gold Reach Resources Ltd.

**SEEL PROJECT**  
BRITISH COLUMBIA, CANADA

**DRILL CROSS-SECTION**  
49+00N

Scale: 1:500  
Date: Jun. 2005  
BCGS: 093E005  
NTS: 93E/11E

Fig. 7

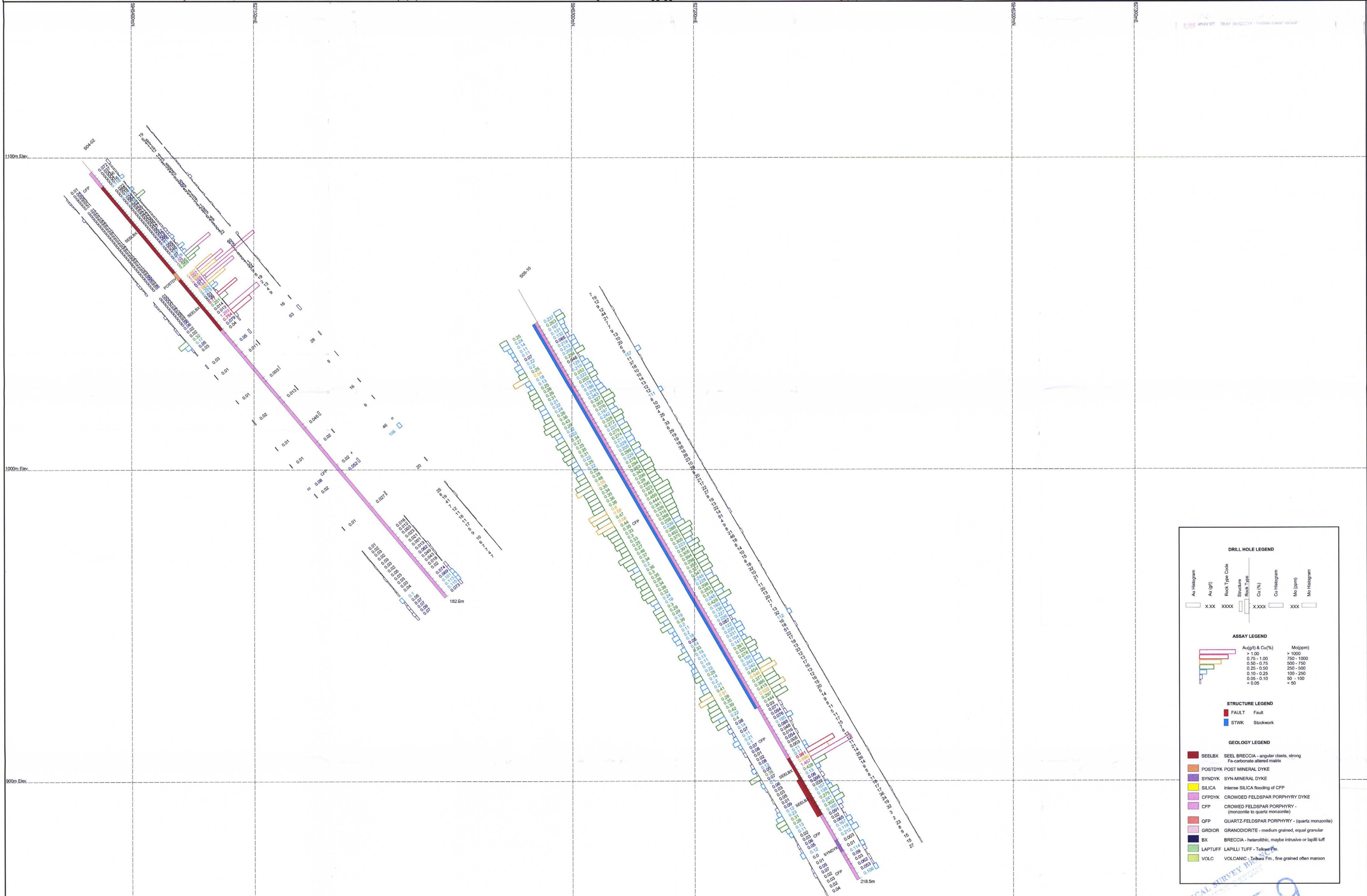
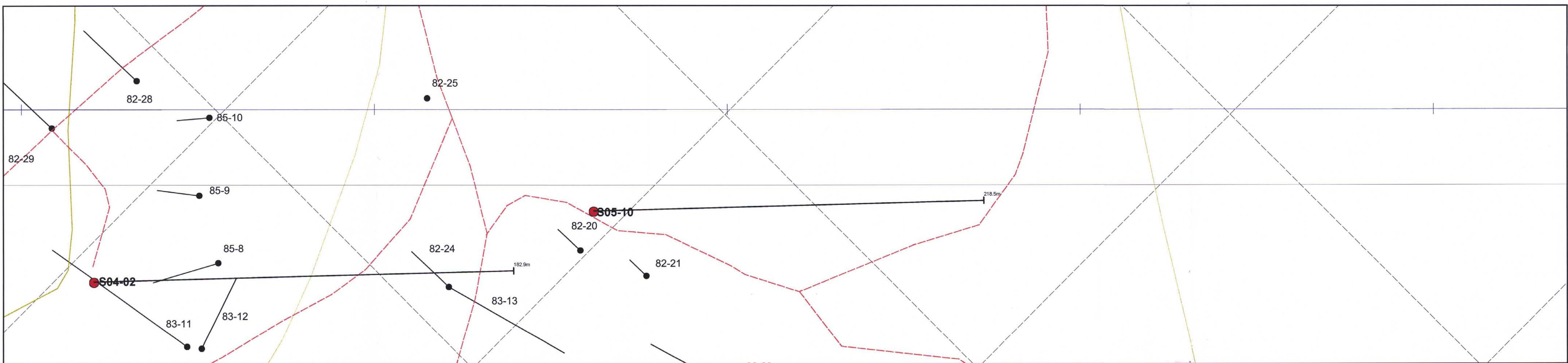

**DRILL HOLE LEGEND**

Au Histogram: [Symbol] Au (g/t) X.XX XXXX  
 Rock Type Code: [Symbol] [Symbol]  
 Cu Histogram: [Symbol] Cu (%) X.XXX XXXX  
 Mo Histogram: [Symbol] Mo (ppm) XXXX

**ASSAY LEGEND**

Au(g/t) & Cu(%)  
 > 1.00  
 0.75 - 1.00  
 0.50 - 0.75  
 0.25 - 0.50  
 0.10 - 0.25  
 0.05 - 0.10  
 0.05

Mo(ppm)  
 > 1000  
 750 - 1000  
 500 - 750  
 250 - 500  
 100 - 250  
 50 - 100  
 < 50

**STRUCTURE LEGEND**

FAULT Fault  
 STWK Stockwork

**GEOLOGY LEGEND**

SEELBX SEEL BRECCIA - angular clasts, strong  
 Fucationalis altered matrix  
 POSTDYK POST MINERAL DYKE  
 SYNDYK SYN-MINERAL DYKE  
 SILICA Intense SILICA flooding of CFP  
 CFPDYK CROWDED FELDSPAR PORPHYRY DYKE  
 CFP CROWDED FELDSPAR PORPHYRY -  
 (monzonite to quartz monzonite)  
 QFP QUARTZ-FELDSPAR PORPHYRY - (quartz monzonite)  
 GRDIOR GRANODIORITE - medium grained, equal granular  
 BX BRECCIA - heterolithic, maybe intrusive or lapilli tuff  
 LAPLUFF LAPILLI TUFF - Tolmie Fm.  
 VOLC VOLCANIC - Tolmie Fm., fine grained often maroon



Grayd Resource Corp. / Gold Reach Resources Ltd.

**SEEL PROJECT**  
BRITISH COLUMBIA, CANADA

**DRILL CROSS-SECTION**  
49+75N

Scale: 1:500 BCGS: 093E065  
Date: Jun. 2005 NTS: 03E/11E Fig. 8

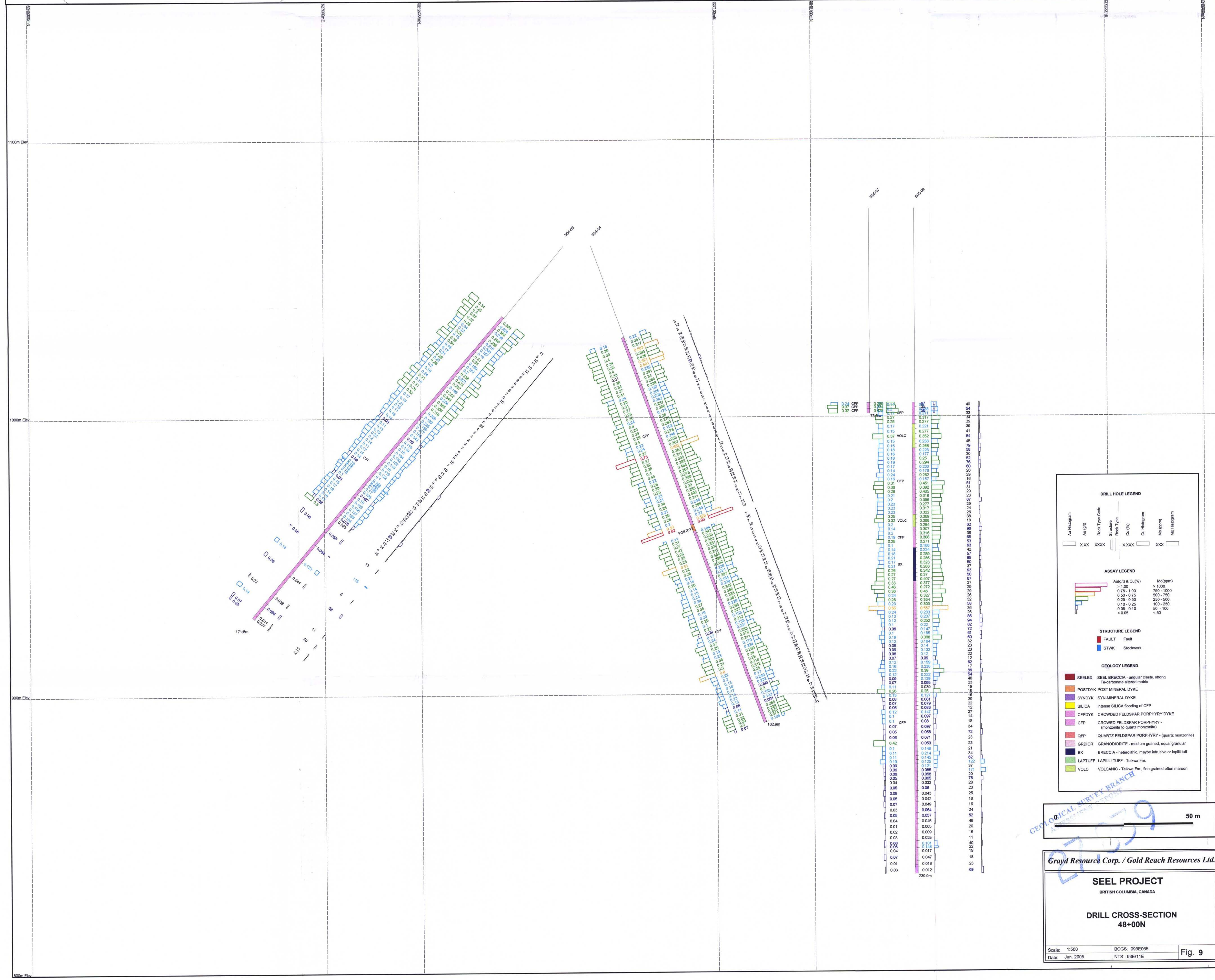
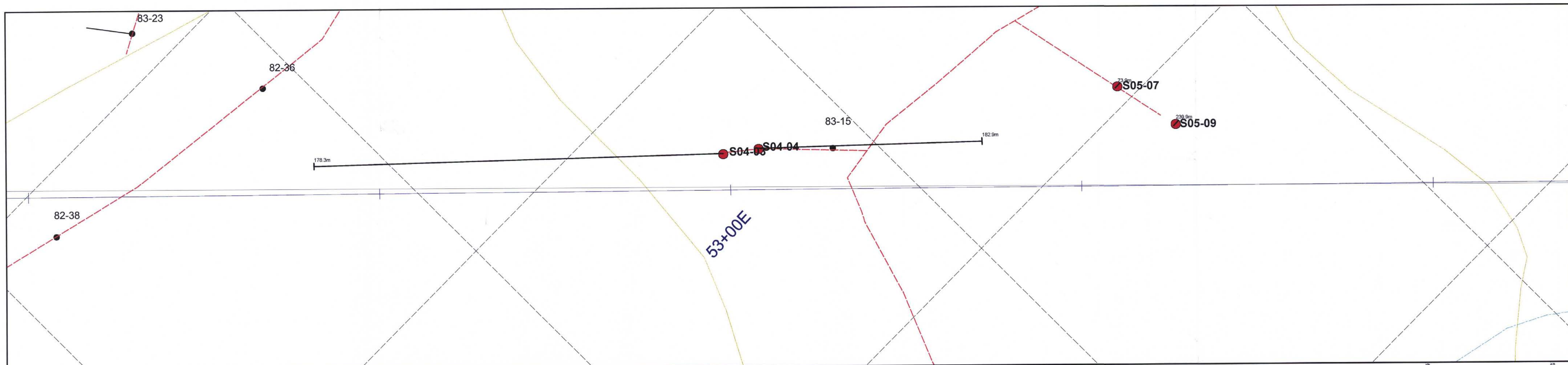

**DRILL HOLE LEGEND**

Au Histogram	Au (g/t)	Rock Type Code	Structure	Cu Histogram	Mo Histogram
X.XX	XXXX	X.XXX	XXX	XXX	XXX

**ASSAY LEGEND**

Au (g/t) & Cu (%)	Mo (ppm)
> 1.00	> 1000
0.75 - 1.00	700 - 1000
0.50 - 0.75	500 - 750
0.25 - 0.50	250 - 500
0.10 - 0.25	100 - 250
0.05 - 0.10	50 - 100
< 0.05	< 50

**STRUCTURE LEGEND**

FAULT	Fault
STWK	Stockwork

**GEOLOGY LEGEND**

SEELBX	SEEL BRECCIA - angular clasts, strong Fe-carbonate altered matrix
POSTDYK	POST MINERAL DYKE
SYNDYK	SYN-MINERAL DYKE
SILICA	Intense SILICA flooding of CFP
CFPDYK	CROWDED FELDSPAR PORPHYRY DYKE
CFP	CROWDED FELDSPAR PORPHYRY - (monzonite to quartz monzonite)
QFP	QUARTZ-FELDSPAR PORPHYRY - (quartz monzonite)
GRDIOR	GRANODIORITE - medium grained, equal granular
BX	BRECCIA - heterolithic, maybe intrusive or lapilli tuff
LAPTUFF	LAPILLI TUFF - Telkwa Fm.
VOLC	VOLCANIC - Telkwa Fm., fine grained often maroon

Scale: 1:500  
Date: Jun. 2005

BCGS: 093E065  
NTS: 03E/11E

Fig. 9

**SEEL PROJECT**  
BRITISH COLUMBIA, CANADA

**DRILL CROSS-SECTION**  
48+00N

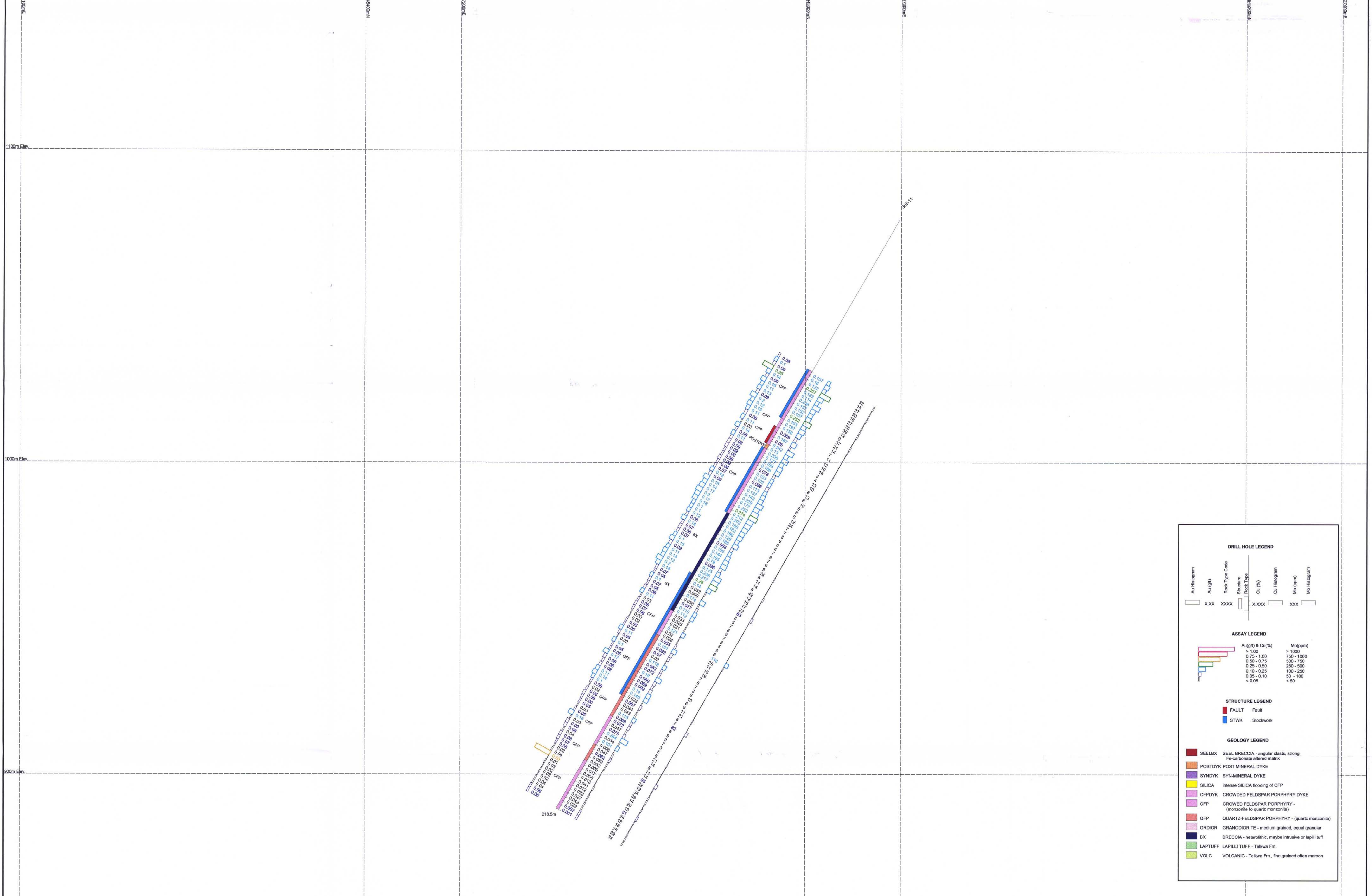
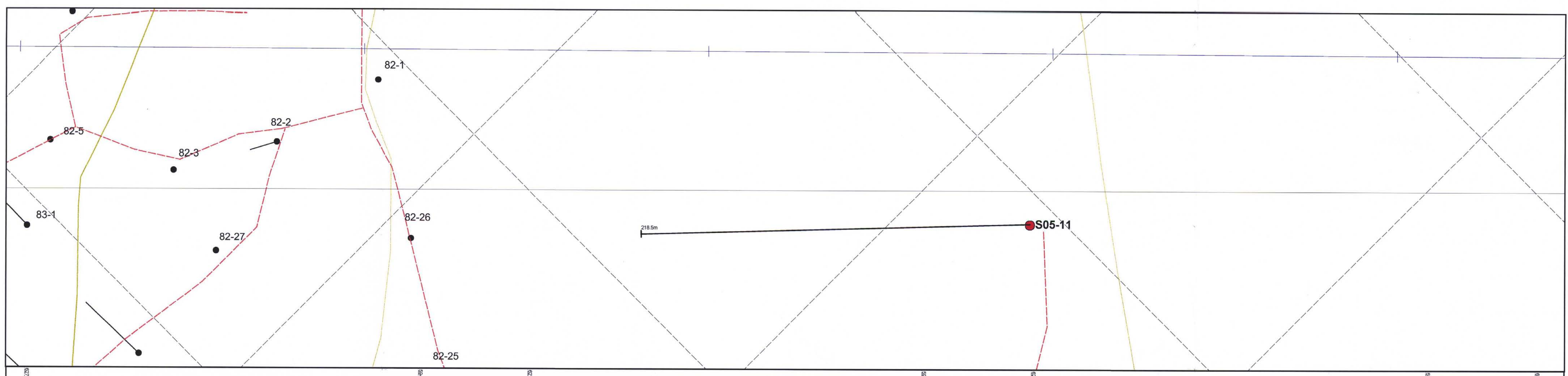

**DRILL HOLE LEGEND**

Au Histogram: X.XX XXXX  
 Au (g/t): XXXX  
 Rock Type Code: Structure  
 Rock Type: CXXXX  
 Cu (%): XXXX  
 Cu Histogram: XXXX  
 Mo (gpm): XXXX  
 Mo Histogram: XXXX

**ASSAY LEGEND**

Au(g/t) & Cu(%)	Mo(ppm)
> 1.00	> 1000
0.75 - 1.00	750 - 1000
0.50 - 0.75	500 - 750
0.25 - 0.50	250 - 500
0.10 - 0.25	100 - 250
0.05 - 0.10	50 - 100
< 0.05	< 50

**STRUCTURE LEGEND**

FAULT: Fault  
 STWK: Stockwork

**GEOLOGY LEGEND**

SEELBX: SEEL BRECCIA - angular clasts, strong Fe-carbonate altered matrix  
 POSTDYK: POST MINERAL DYKE  
 SYNDYK: SYN MINERAL DYKE  
 SILICA: Intense SILICA flooding of CFP  
 CFPDYK: CROWDED FELDSPAR PORPHYRY DYKE  
 CFP: CROWDED FELDSPAR PORPHYRY - (monzonite to quartz monzonite)  
 QFP: QUARTZ-FELDSPAR PORPHYRY - (quartz monzonite)  
 GRDOR: GRANODIORITE - medium grained, equal granular  
 BX: BRECCIA - heterolithic, maybe intrusive or lapilli tuff  
 LAPLUFF: LAPILLI TUFF - Tolka Fm.  
 VOLC: VOLCANIC - Tolka Fm., fine grained often macon

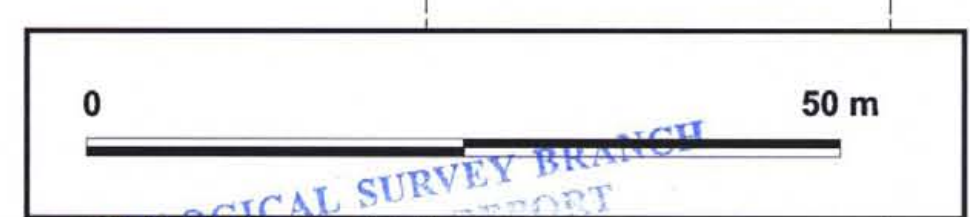

Geological Survey Branch  
 Geological Survey Department

Grayd Resource Corp. / Gold Reach Resources Ltd.  
 27-119  
**SEEL PROJECT**  
 BRITISH COLUMBIA, CANADA

**DRILL CROSS-SECTION 50+50N**

Scale: 1:500  
 Date: Jun 2006  
 BCGS: 093E065  
 NTS: 93E/11E  
 Fig. 10



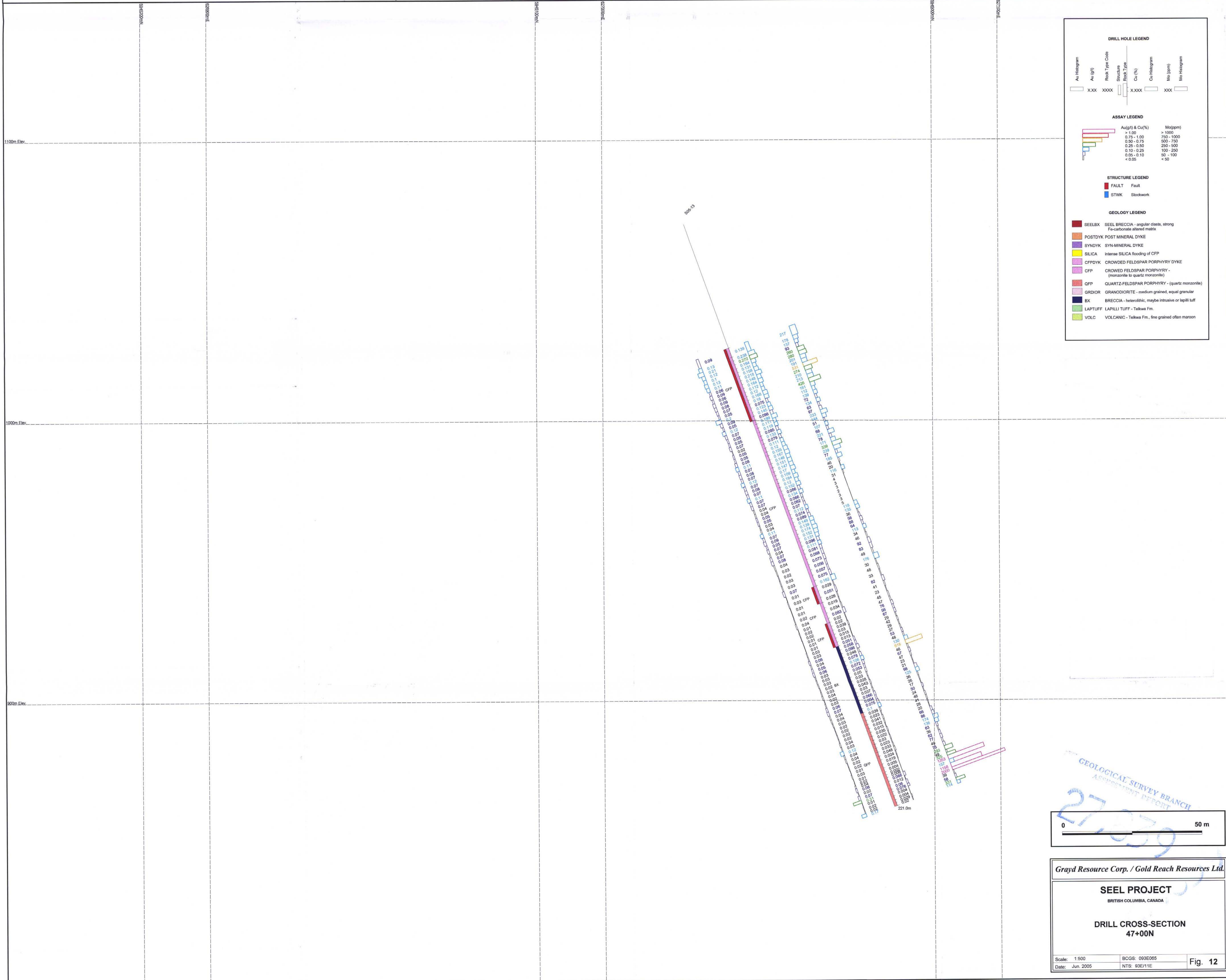
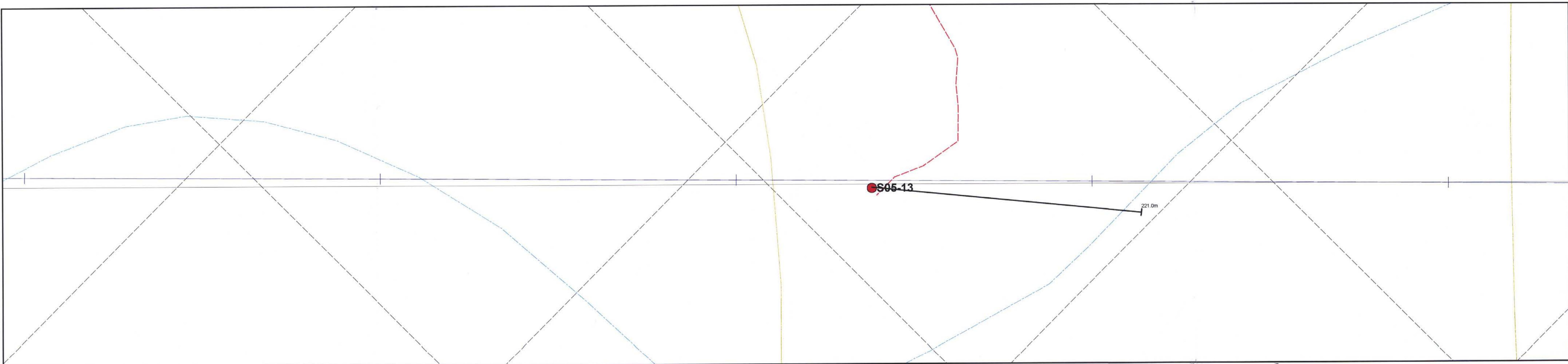

**DRILL HOLE LEGEND**

Au Histogram: X.XX  
 Rock Type Codes: XXXX  
 Blotum: X.XXX  
 Cu (N): XXX  
 No Histogram: XXX

**ASSAY LEGEND**

Au(g/t) & Cu(%) Mo(ppm)

> 1.00	> 1000
0.75 - 1.00	750 - 1000
0.50 - 0.75	500 - 750
0.25 - 0.50	250 - 500
0.10 - 0.25	100 - 250
0.05 - 0.10	50 - 100
< 0.05	< 50

**STRUCTURE LEGEND**

FAULT: Fault  
 STWK: Stockwork

**GEOLOGY LEGEND**

SEELBX: SEEL BRECCIA - angular clasts, strong Fe-carbonate altered matrix  
 POSTDYK: POST MINERAL DYKE  
 SYN DYK: SYN-MINERAL DYKE  
 SILICA: Intense SILICA flooding of CFP  
 CFPDYK: CROWDED FELDSPAR PORPHYRY DYKE  
 CFP: CROWDED FELDSPAR PORPHYRY - (monzonite to quartz monzonite)  
 QFP: QUARTZ-FELDSPAR PORPHYRY - (quartz monzonite)  
 GRDOR: GRANODIORITE - medium grained, equal granular  
 BX: BRECCIA - heterolithic, maybe intrusive or lapilli tuff  
 LAPLUFF: LAPILLI TUFF - Talkeena Fm.  
 VOLC: VOLCANIC - Talkeena Fm., fine grained often maroon

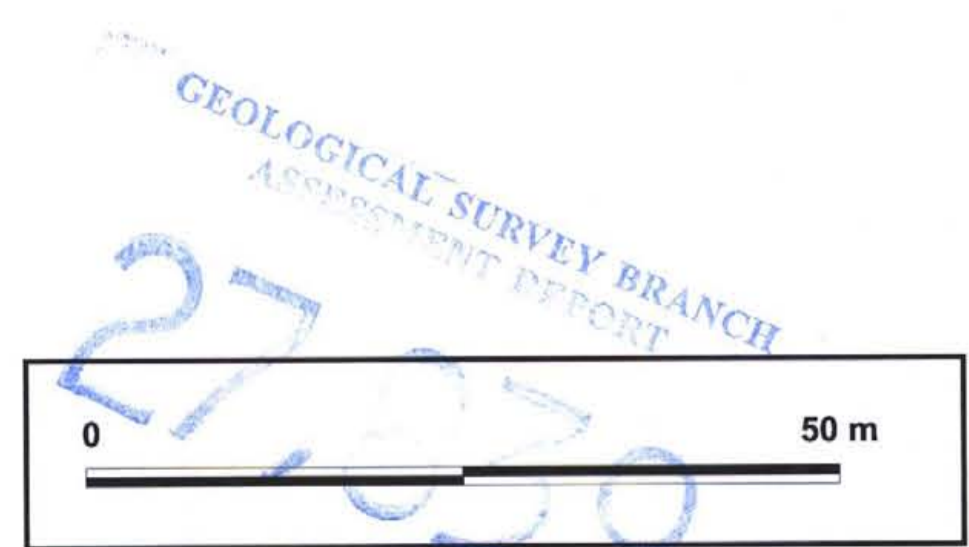

Grayd Resource Corp. / Gold Reach Resources Ltd.

**SEEL PROJECT**  
BRITISH COLUMBIA, CANADA

**DRILL CROSS-SECTION**  
47+00N

Scale: 1:500 BCGS: 093E065  
Date: Jun. 2005 NTS: 93E/11E Fig. 12



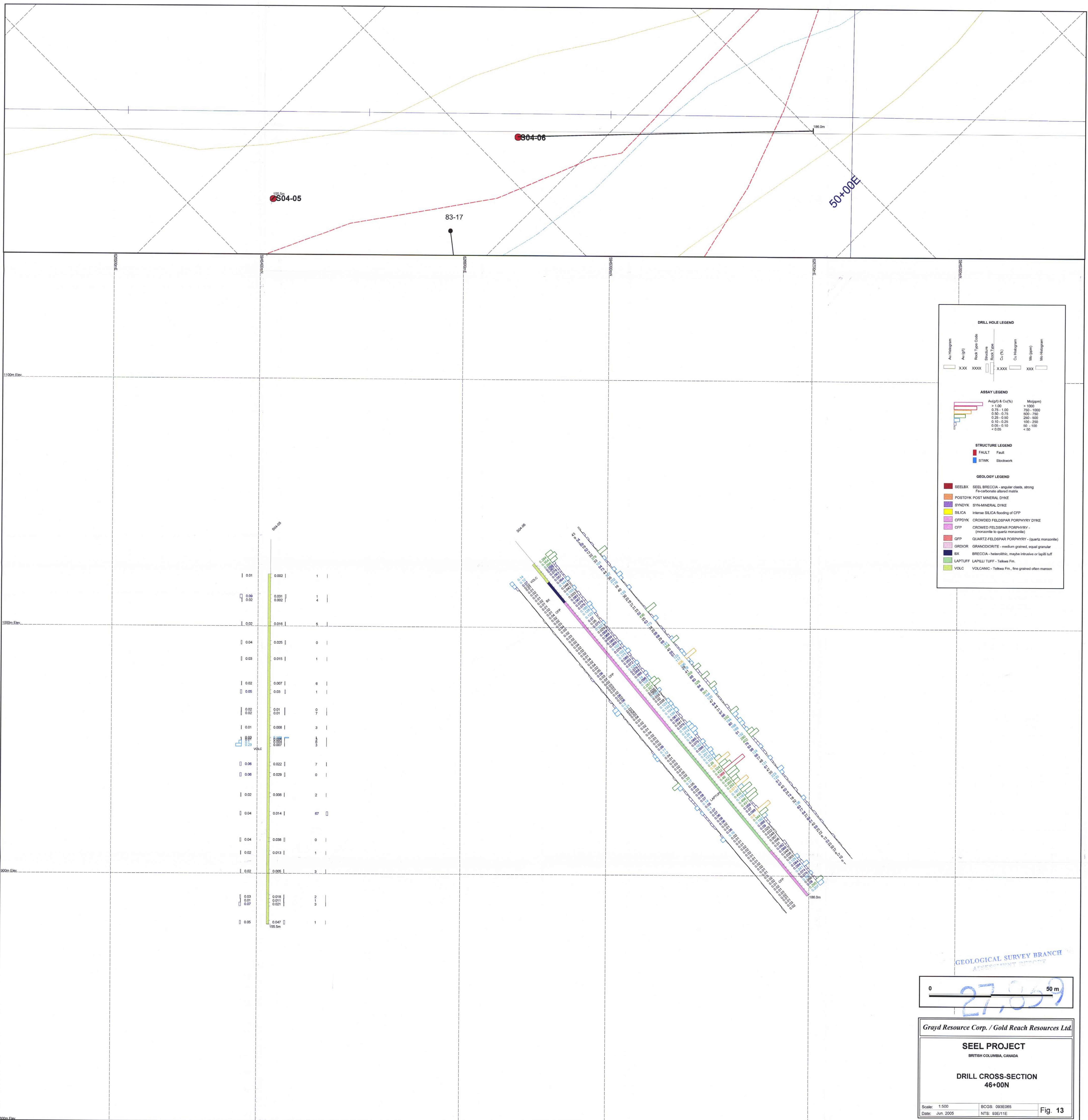

GEOLOGICAL SURVEY BRANCH  
 APPROVED REPORT

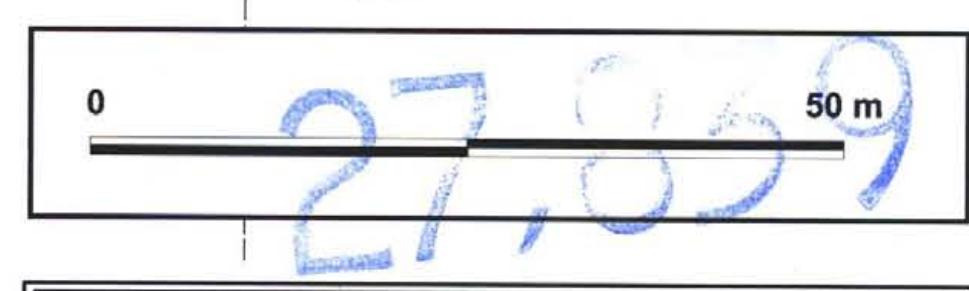

Grayd Resource Corp. / Gold Reach Resources Ltd.

**SEEL PROJECT**  
 BRITISH COLUMBIA, CANADA

**DRILL CROSS-SECTION**  
 46+00N

Scale: 1:500  
 Date: Jun. 2005  
 BCGS: 093E065  
 NTS: 93E/11E  
 Fig. 13

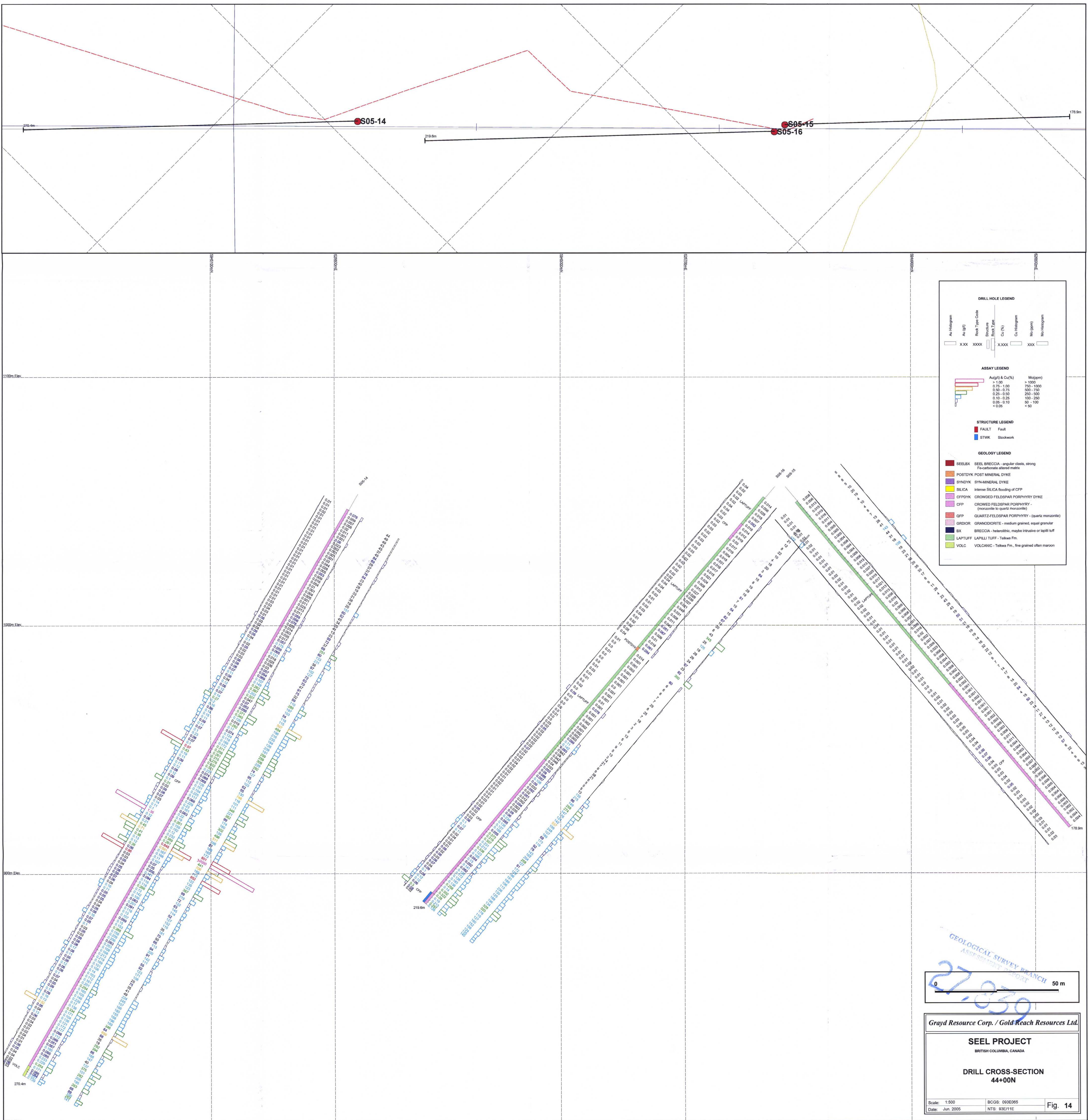

**DRILL HOLE LEGEND**

Assay Histogram: X.XX XXXX

Rock Type Code: XXXX

Structure: X.XXX

Cu (%) Histogram: XXXX

Mo (ppm) Histogram: XXXX

**ASSAY LEGEND**

Au(g/t) & Cu(%)	Mo(ppm)
> 1.00	> 1000
0.75 - 1.00	750 - 1000
0.50 - 0.75	500 - 750
0.25 - 0.50	250 - 500
0.10 - 0.25	100 - 250
0.05 - 0.10	50 - 100
< 0.05	< 50

**STRUCTURE LEGEND**

- FAULT: Fault
- STWK: Stockwork

**GEOLOGY LEGEND**

- SEELBX: SEEL BRECCIA - angular clasts, strong Fe-carbonate altered matrix
- POSTDYK: POST-MINERAL DYKE
- SYNDYK: SYN-MINERAL DYKE
- SILICA: Intense SILICA flooding of CFP
- CFPDYK: CROWDED FELDSPAR PORPHYRY DYKE
- CFP: CROWDED FELDSPAR PORPHYRY - (porphyritic to quartz monzonite)
- QFP: QUARTZ-FELDSPAR PORPHYRY - (quartz monzonite)
- GRDOR: GRANODIORITE - medium grained, equal granular
- BK: BRECCIA - heterolithic, maybe intrusive or lapilli tuff
- LAPLUFF: LAPILLI TUFF - Talawa Fin.
- VOLC: VOLCANIC - Talawa Fin., fine grained often maroon

0 50 m

27039

GEOLOGICAL SURVEY BRANCH  
ASSESSMENT REPORT

Grayd Resource Corp. / Gold Reach Resources Ltd.

**SEEL PROJECT**  
BRITISH COLUMBIA, CANADA

**DRILL CROSS-SECTION  
44+00N**

Scale: 1:500      BCOS: 033E065      Fig. 14  
Date: Jun. 2005      NTS: 93E/11E

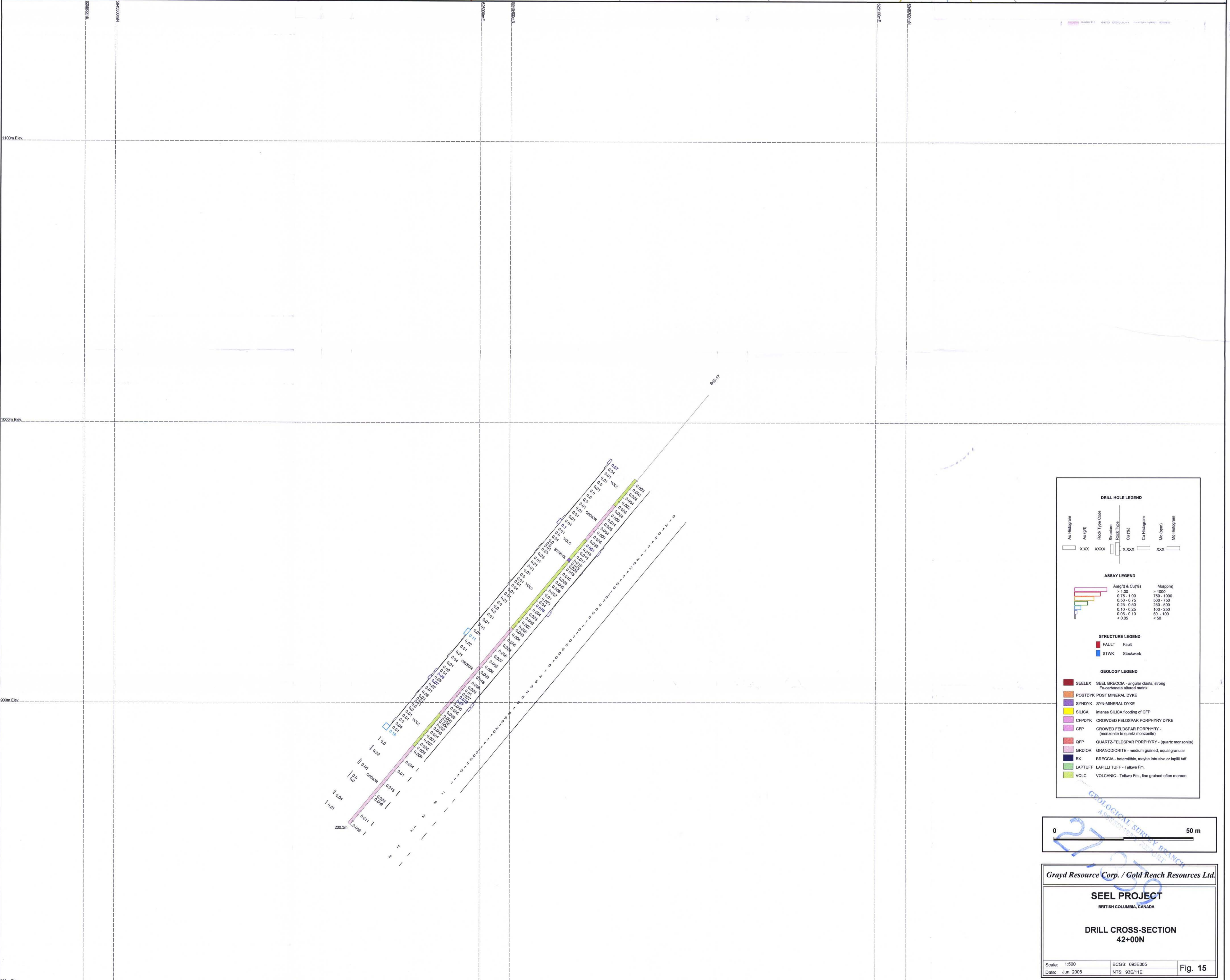
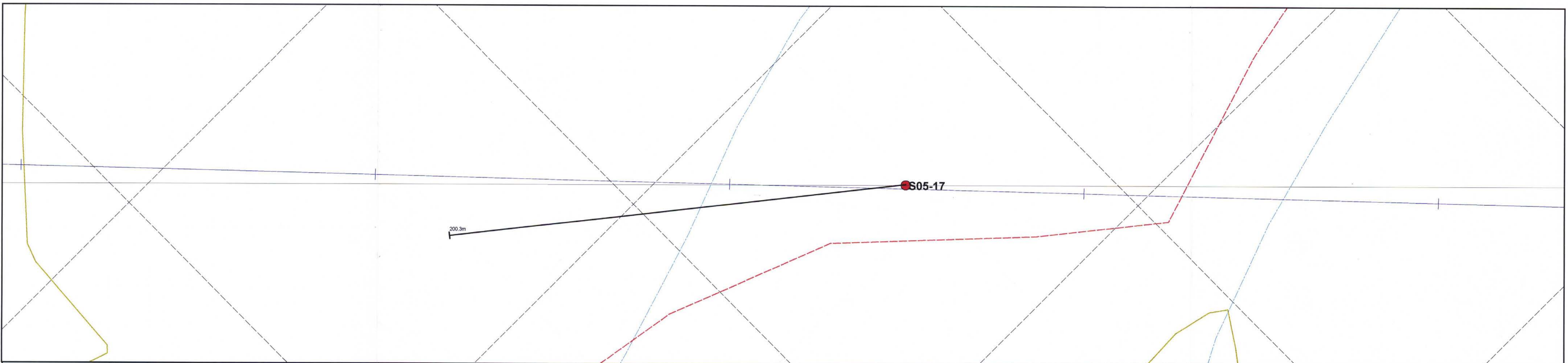

**DRILL HOLE LEGEND**

Au Histogram: XXXX  
 Au (g/t): XXXX  
 Rock Type Code: XXXX  
 Structure: XXXX  
 Cu (%): XXXX  
 Cu Histogram: XXXX  
 No (ppm): XXXX  
 No Histogram: XXXX

**ASSAY LEGEND**

Au(g/t) & Cu(%)  
 > 1.00  
 0.75 - 1.00  
 0.50 - 0.75  
 0.25 - 0.50  
 0.10 - 0.25  
 0.05 - 0.10  
 < 0.05

Mol(ppm)  
 > 1000  
 750 - 1000  
 500 - 750  
 250 - 500  
 100 - 250  
 50 - 100  
 < 50

**STRUCTURE LEGEND**

FAULT Fault  
 STWK Stockwork

**GEOLOGY LEGEND**

SEELEX SEEL BRECCIA - angular clasts, strong Fe-carbonate altered matrix  
 POSTDYK POST MINERAL DYKE  
 SYNDYK SYN-MINERAL DYKE  
 SILICA Intense SILICA flooding of CFP  
 CFPDYK CROWNED FELDSPAR PORPHYRY DYKE  
 CFP CROWNED FELDSPAR PORPHYRY - (intermediate to quartz monzonite)  
 QFP QUARTZ-FELDSPAR PORPHYRY - (quartz monzonite)  
 GRDOR GRANODIORITE - medium grained, equal granular  
 BK BRECCIA - heterolithic, maybe intrusive or lapilli tuff  
 LAPUFF LAPILLI TUFF - Telwa Fm.  
 VOLC VOLCANIC - Telwa Fm., fine grained often maroon



Grayd Resource Corp. / Gold Reach Resources Ltd.

**SEEL PROJECT**  
 BRITISH COLUMBIA, CANADA

**DRILL CROSS-SECTION**  
 42+00N

Scale: 1:500  
 Date: Jun 2005  
 BCGS: 093E065  
 NTS: 93E/11E  
 Fig. 15