

RECEIVED
AUG 18 2005
Gold Commissioner's Office
VANCOUVER, B.C.

Brian Kostiuk
514 13th Ave. S.
Cranbrook, B.C.
V1C 2W4

AIR ROTARY CHIP SAMPLING ON THE KAYLA
PLACE CLAIM IN THE BREWERY CRK/
WILD HORSE RIVER AREA,
FORT STEELE MINING DIVISION
SOUTHEASTERN BRITISH COLUMBIA

NTS 082G 49° 39' N; 116° 37' W
GEOLOGICAL SURVEY BRANCH
ASSESSMENT REPORT
KAYLA CLAIM

27,844
OWNER: Brian Kostiuk

By: Brian Kostiuk
514 - 13th Ave. S.
Cranbrook, B.C.
V1C 2W4

July 2005

AIR ROTARY CHIP SAMPLING ON THE KAYLA CLAIM
IN FREWERY CRK - WILDHORSE RIVER AREA
FORT STEELE MINING DIVISION

NTS 082G 49° 39' N: 116° 37' W

TABLE OF CONTENTS

SUMMARY OF WORK AND CONCLUSION	1
LOCATION & ACCESS	1
CLAIM MAP	2
HISTORY	3
GEOLOGY	3
DRILL RESULTS	4
REFERENCES	8

LIST OF FIGURES:

1. KAYLA CLAIM MAP	2
2. DRILL LOCATION	2A
3. DRILL CROSS SECTION	2B
4. GEOLOGY MAP	

APPENDICES:

A. STATEMENT OF EXPENDITURES	5
B. STATEMENT OF WORK	6
C. STATEMENT OF QUALIFICATIONS	7

SUMMARY OF WORK & CONCLUSIONS

The December 2004 drilling by Owens Drilling LTD. Of Cranbrook, B.C. consisted of concentrating overburden and bedrock samples.

The sample washing was done by Brian Kostiuk and Kyle Purdy at the J. D. Ranch, Fort Steele. Method used was a vibrating Jig and Spray Bar with a line bottom sluice manufactured by Dave Vanember. The concentrates were hand panned by Brian Kostiuk. No visible gold observed.

Location and Access

The Kayla claim is located along the eastern edge of the Rocky Mtn. Trench just west of the western slopes of the Hoghe Range - approx. 20 km N/E of Cranbrook. Travel N/E from Fort Steele on the west side Wildhorse Road to 8 K. at Brewery Creek. Then 3 KM N to Drill site. Located in the Brewery Creek Drainage.

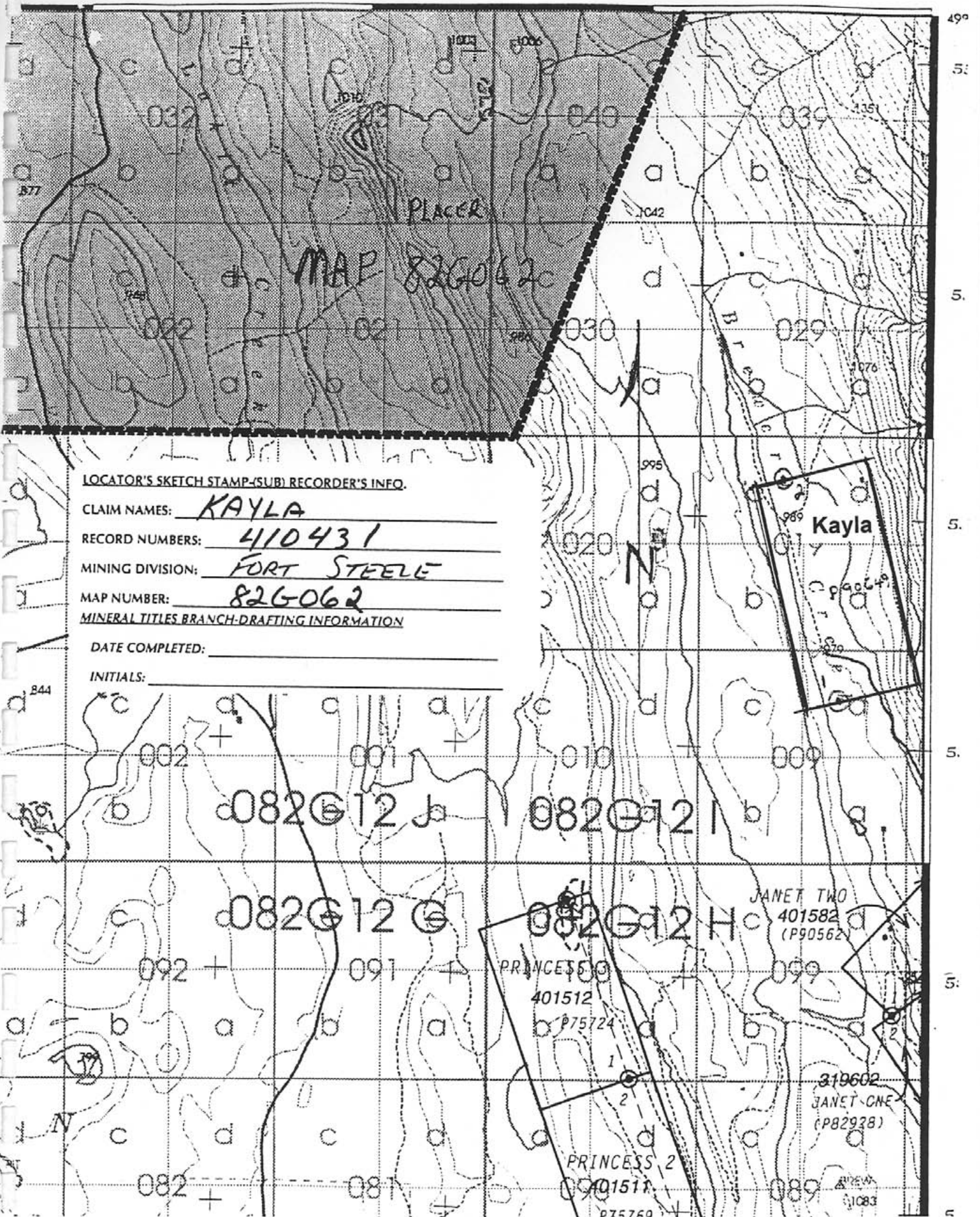

LOCATOR'S SKETCH STAMP-(SUB) RECORDER'S INFO.

CLAIM NAMES: KAYLA

RECORD NUMBERS: 410431

MINING DIVISION: FORT STEELE

MAP NUMBER: 82G062

MINERAL TITLES BRANCH-DRAFTING INFORMATION

DATE COMPLETED: _____

INITIALS: _____

Kayla

082G12 J

082G12 I

082G12 G

082G12 H

PRINCESS 1
401512
P75724

JANET TWO
401582
(P90562)

319602
JANET ONE
(P82928)

PRINCESS 2
401511
P75760

1083

Drill Location
 UTM East 600583 Utm North 5503400

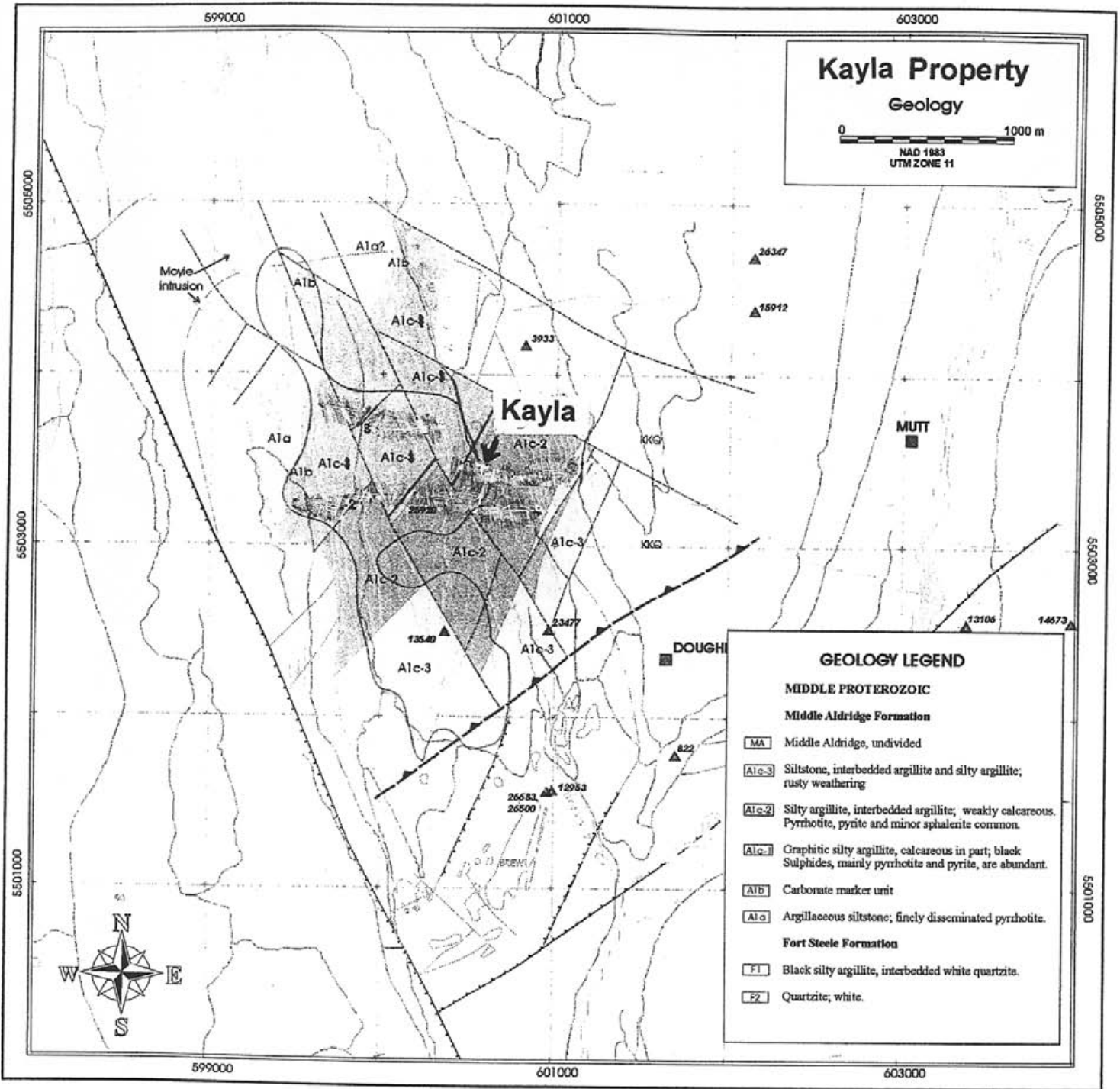

Fig. 2A
 Figures: Detailed drill location map of the Kayla claim area.

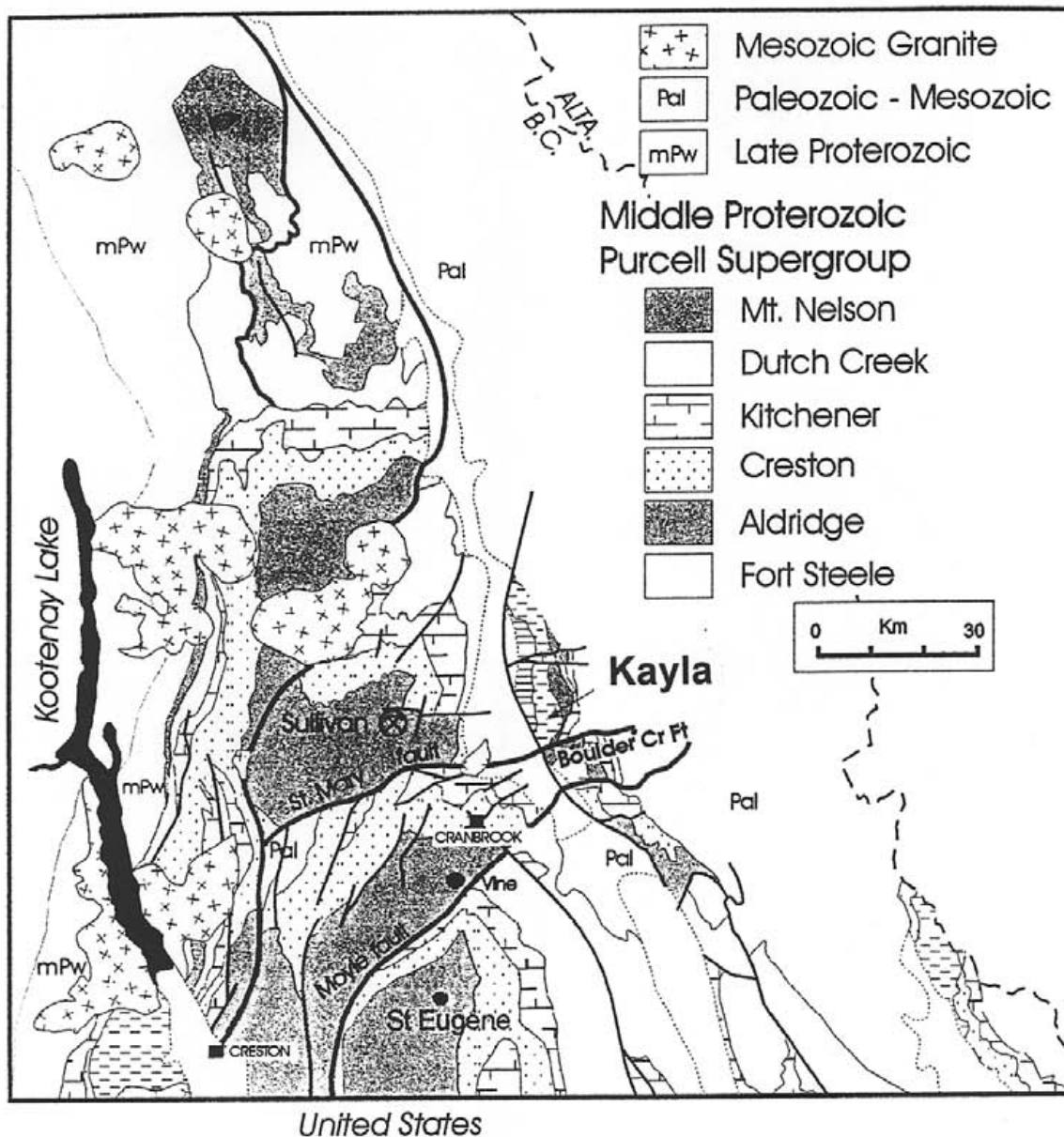
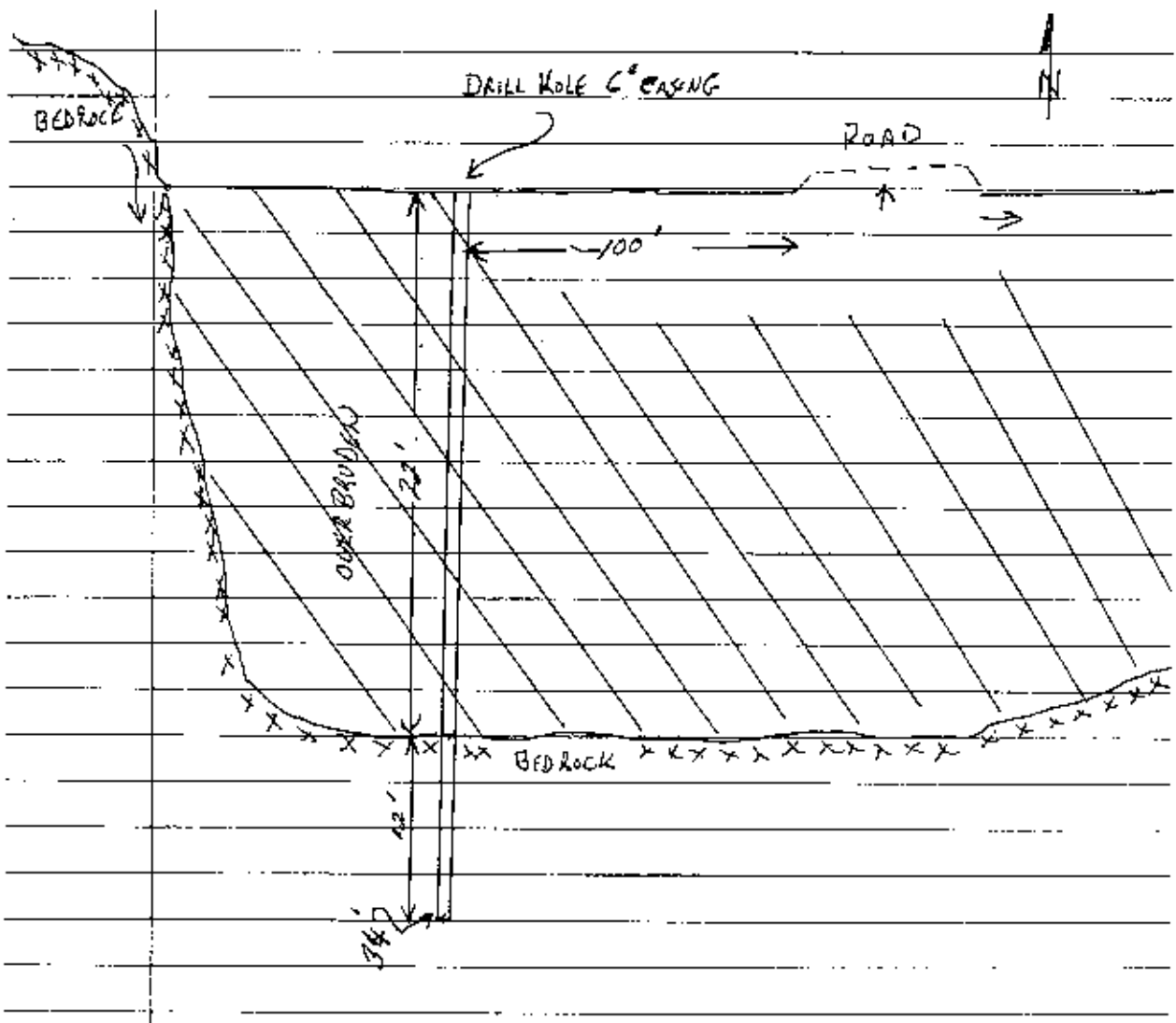

Figure 2: General location map showing regional geology and location of the Kayla Claim.

Fig. 2B

Drill Cross Section

Kayla Claim - NTS - 082G12 49° 39' N: 116° 37' W



HISTORY

Little is known of early work on the property with no placer reports on record.

The property was staked by Brian Kostiuk on the potential for placer gold as the Brewer Creek Drainage has evidence of early river run material.

A hole in December 2004 was drilled to test the overburden and bedrock depth as confirmed by diamond drilling by Klondike gold corp.

GEOLOGY

A north - trending succession of metasedimentary rocks and intrusive sills of the middle proterozoic Purcell Supergroup underlies the Kayla property. This succession includes the Fort Steele formation dominated by cross - bedded quartz - Rich arenites and overlying Aldridge formation (figure 4) rocks are generally steeply dipping, complex folded and have a well developed axial planar cleavage. In general tops are to the east, and therefore west dipping stratigraphy is overturned. A complex array of faults cups the area.

Drill Results

Kayla Placer Claim

Dec. 21/04

Samples	Material	Concentrates
0 - 2 Ft.	Gravel / Sand	Not Washed
2 - 4	Gabro / quartz	"
4 - 6	Boulders	"
6 - 8	"	"
8 - 10	"	"
10 - 12	"	"
12 - 14	"	"
14 - 16	"	"
16 - 18	"	Black Sand / Pyrite
18 - 20	"	" "
20 - 22	"	" "
22 - 24	Bedrock	"Pyrite oxidized"
24 - 26	"	Pyrite/Pyrrhotite Lots
26 - 28	"	" " "
28 - 30	"	" " "
30 - 32	"	" " "
32 - 34	"	" " "
		<u>"No Gold Visible"</u>

STATEMENT OF WORK

Air Rotary Drill Rig	\$1000.00
Supervision and Sample	\$300.00
	<hr/>
	\$1300.00

References

1. Boulder Creek Road exploration Project; Michael P. Henrick; Nov. 1991.
2. Boulder Creek Road exploration Project; Michael P. Henrick; Nov. 1990.
3. Geological report on place Leased #922,926, and 930: C.B. Newmarch.
R. L. Hughes; 1962. (BC MPR Assessment Report #479)
4. Bri-Lin Mineral Claim Group Report, Michael Bapty, P. Eng. Bapty Research
Limited, March 31, 1994.
5. Lone I Steel V Report, By Brian Kostiuik, Jun, 1995.
6. Sully property, April, 2005.
Trygue Hoy, P. Eng. Phd. Consultant
Dave Pighin, P. Geo, Consultant

Brian Kostiuk
514 - 13th Ave. S.
Cranbrook, B.C.
V1C 2W4
Phone: (604) 489-8035

Brian Kostiuk is a business consultant living in Cranbrook, B.C. He has management experience in a broad range of construction and mining activities.

Career Highlights

- Owner / manager of Tri-Kon Precast Concrete Products, manufacturing items for construction and landscaping applications - helping to diversify Cranbrook's industrial base.
- Owner / manager of Kostiuk Construction, engaged in excavating, underground utilities, subdivisions and municipal works. Projects included Cranbrook's sewer spray irrigation and the Columbia River crossing of the water transmission line at Radium.
- Owner / manager of Bri-Lin Developments, involved in property development and transportation. Built and operated Cranbrook's first mini warehouses and hauled petroleum for 39 Thrifty gas stations in the Kootenays and the Okanagan.
- Owner / manager of Tri-Core Drilling and Lone Peak Placer, specializing in mining exploration. Located the extension of the original Wildhorse Creek.

Professional Affiliations

- President - Kootenay Placer Association
- Member - Kootenay Chamber of Mines

Vocational Education

- Supervisors' Training Program - Columbia Training Services
- W.H.M.I.S. Safety Certificate
- Transportation of Dangerous Goods Certificate
- B.C. Gas fitter Ticket
- Supervisor Mines Act. #96-2385
- Occupational First Aid Level 3. #000520419