

Assessment Report
On the
Kettle Property:
Geochemistry, Geophysics, Geology and Trenching

Mineral Mining Division
British Columbia, Canada

Part 2 of 2 (Large Drawings)

Report by
William J. Wilkinson, B.Sc., P. Geo.

126 Nagle Place
Penticton, British Columbia
V2A7B5

December 20, 2005

CD Inside

28121

Vol. 2

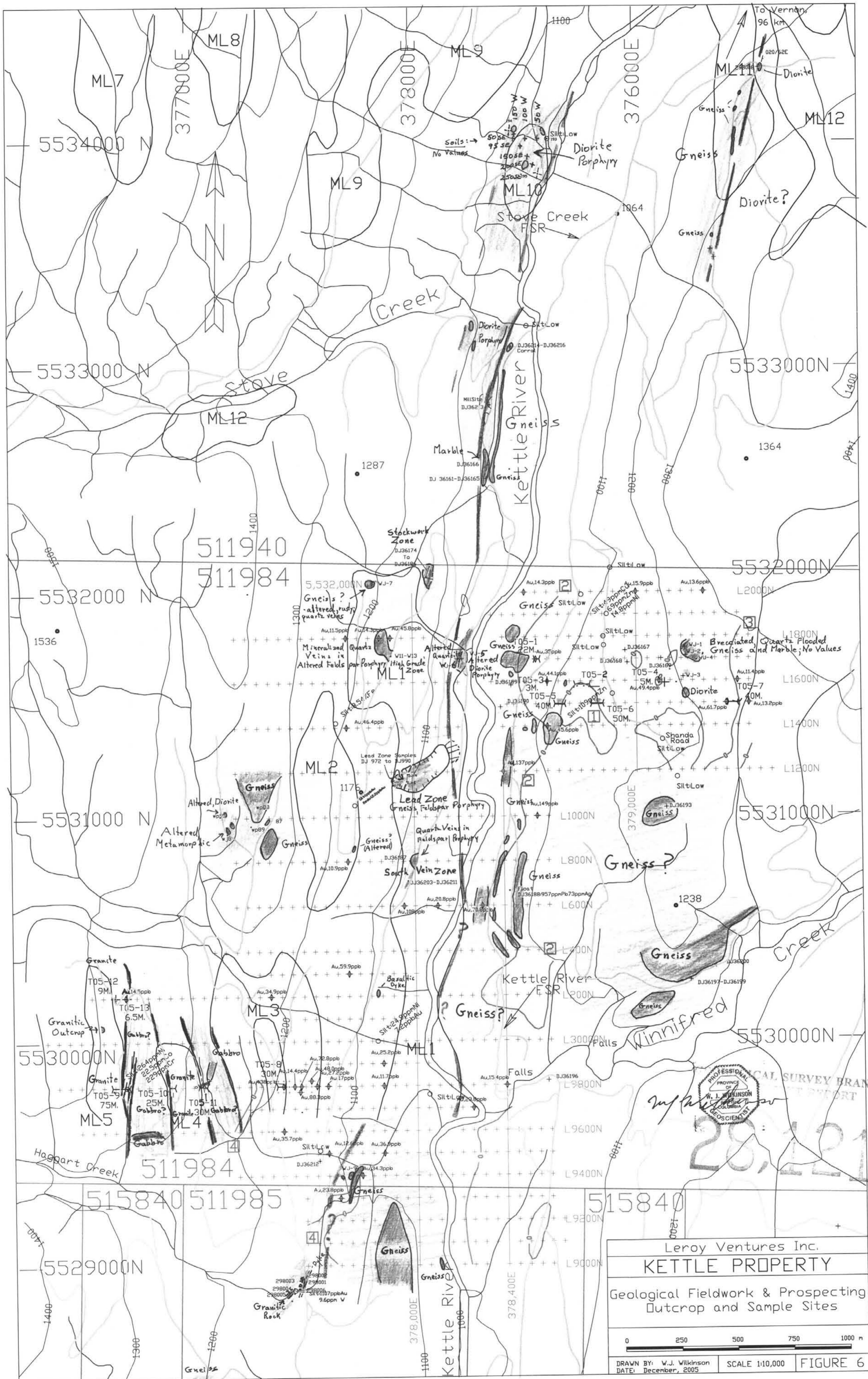

Leroy Ventures Inc.
KETTLE PROPERTY
 Geological Fieldwork & Prospecting
 Outcrop and Sample Sites

0 250 500 750 1000 m

DRAWN BY: W.J. Wilkinson
 DATE: December, 2005 SCALE 1:10,000 FIGURE 6

PROFESSIONAL SURVEY BRANCH
 W.J. WILKINSON
 GEOSCIENTIST
 28,121

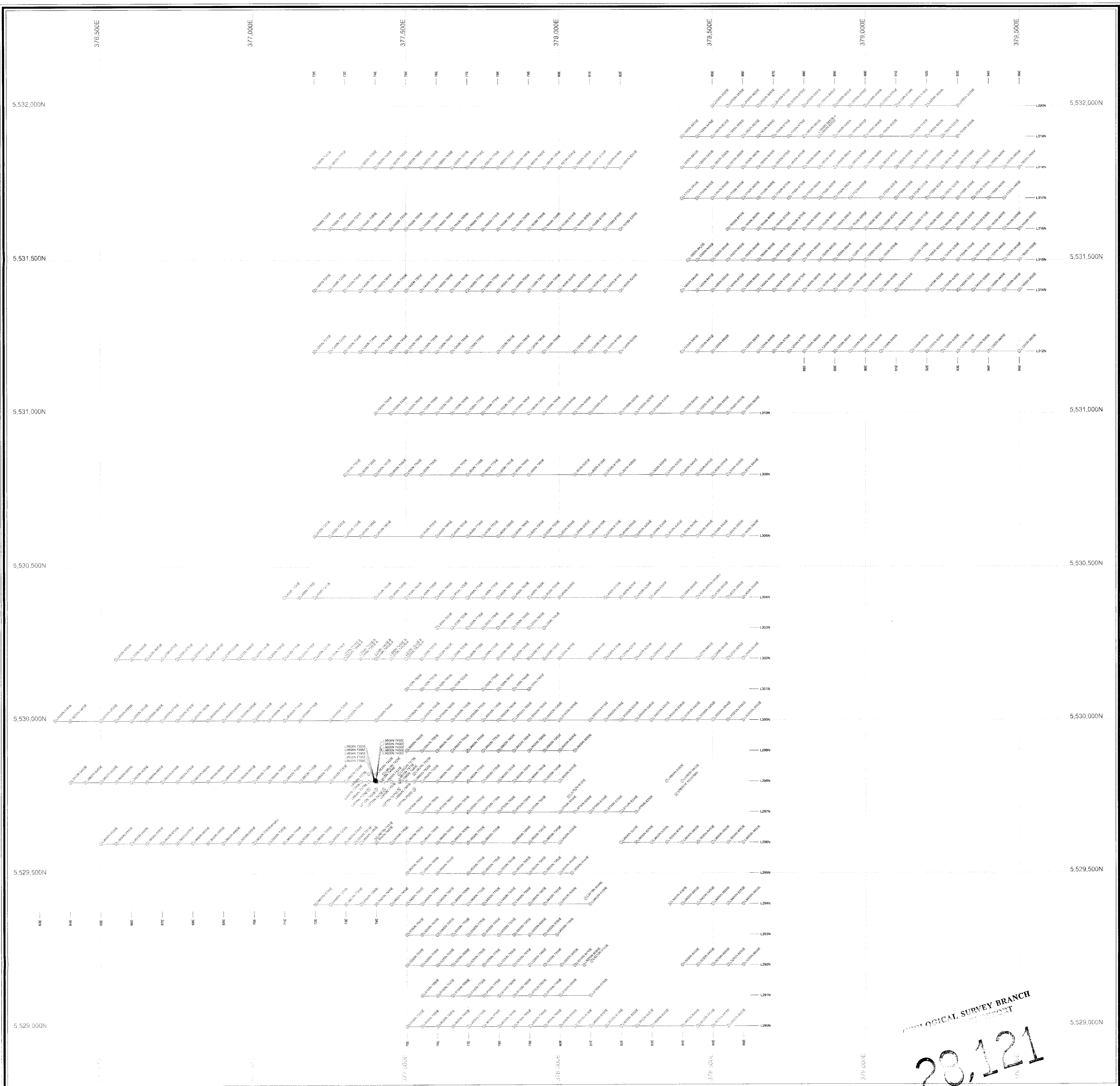

UTM Grid North

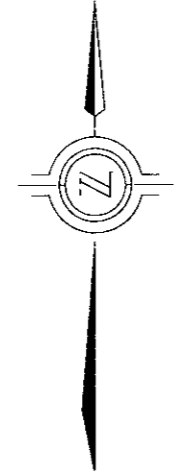

LERoy VENTURES
KETTLE PROPERTY
SOIL SAMPLE LOCATIONS

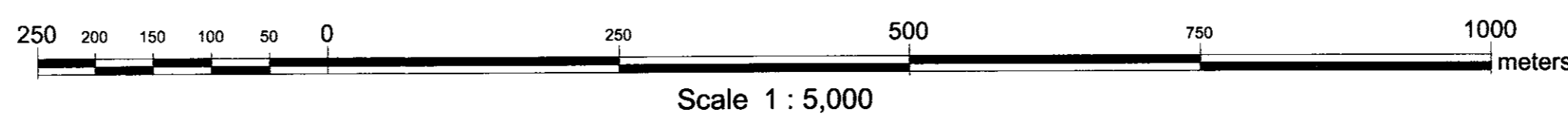

28,121
MAY 15 2005

LERoy VENTURES
KETTLE PROPERTY

**SOIL
LOCATIONS**

Data by: Bal Wilkinson
 Drawn By: J. David Williams, P.Eng.
 Scale: 1:5,000
 N.T.S.: 082E15
 Date: 15 October 2005
 File: Kettle_SoilSurvey.dwg [Soil_5K]

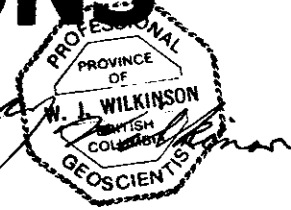

MAP 01

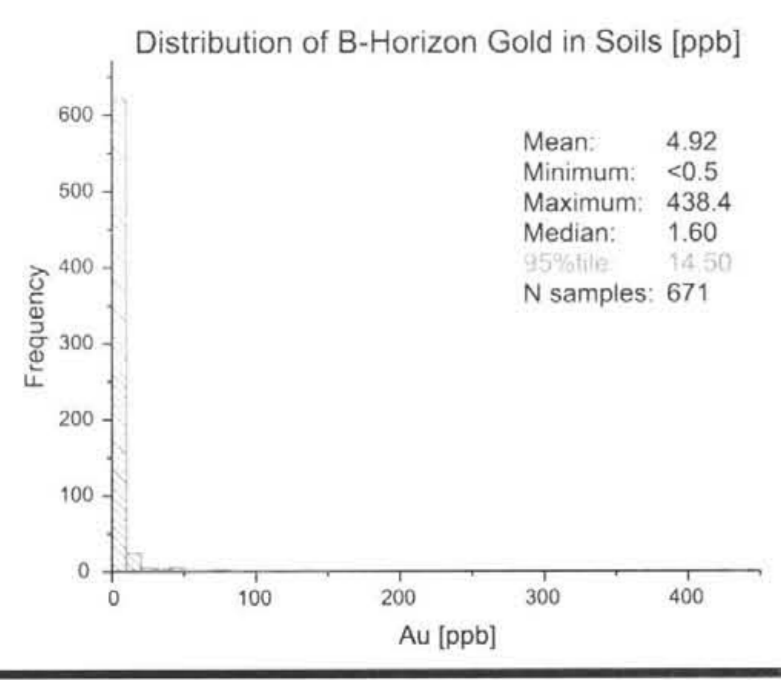
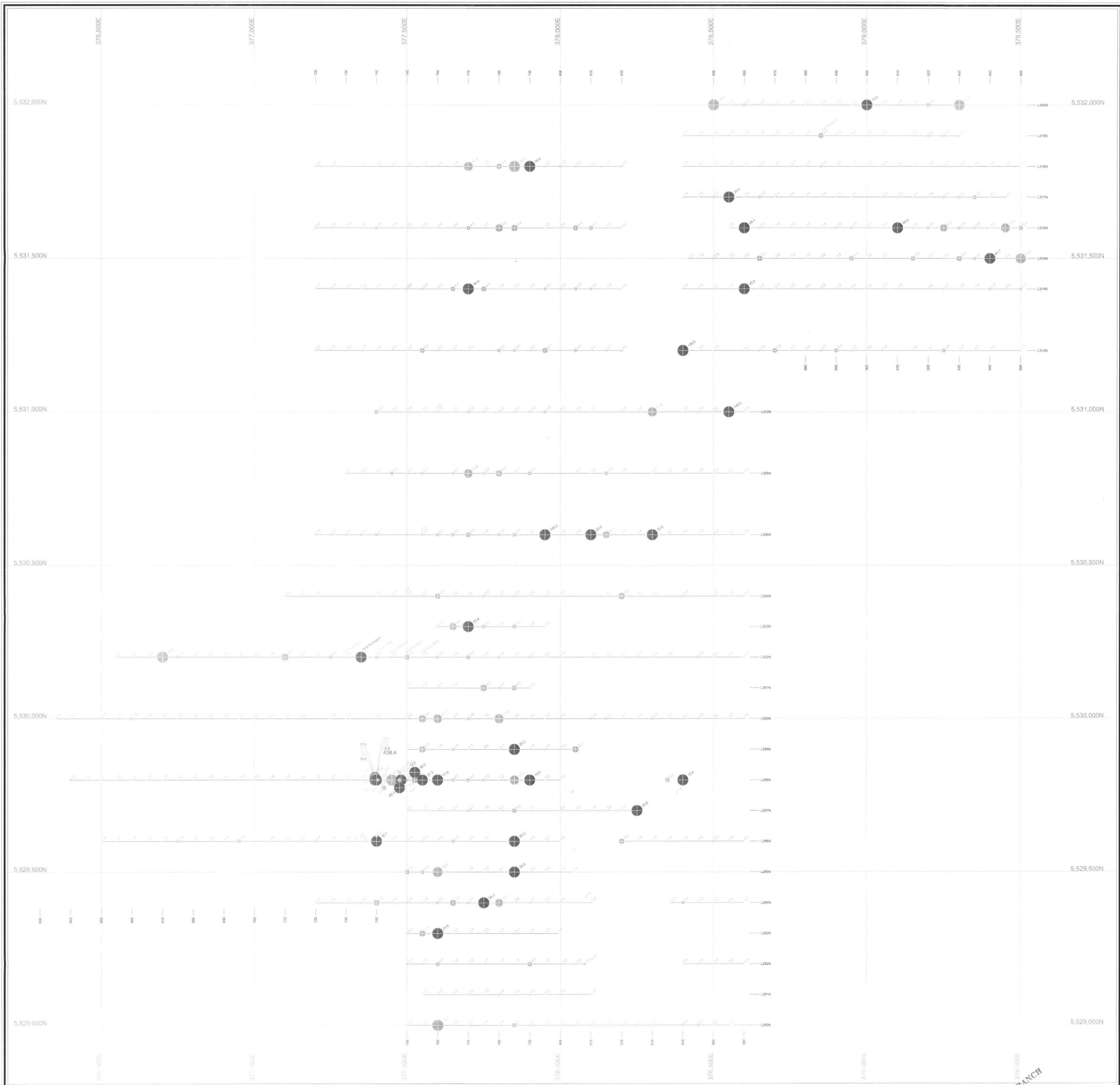

Symbol Key

- Assay > 95%tile
- Sample scaled proportional to assay
- Assay below detection limit

All samples from B-horizon unless specifically labelled A-horizon.

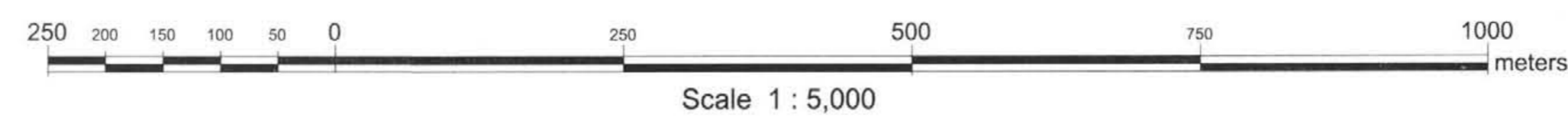

LEROY VENTURES
KETTLE PROPERTY
GOLD in SOILS [ppb]



MAP 02

LEROY VENTURES
KETTLE PROPERTY

Au
20121

Geological Survey Branch
Professional Geoscientist
David Wilkinson
15 October 2005

Date: 15 October 2005
File: Kettle_SoilSurvey.dwg [Au_5k]

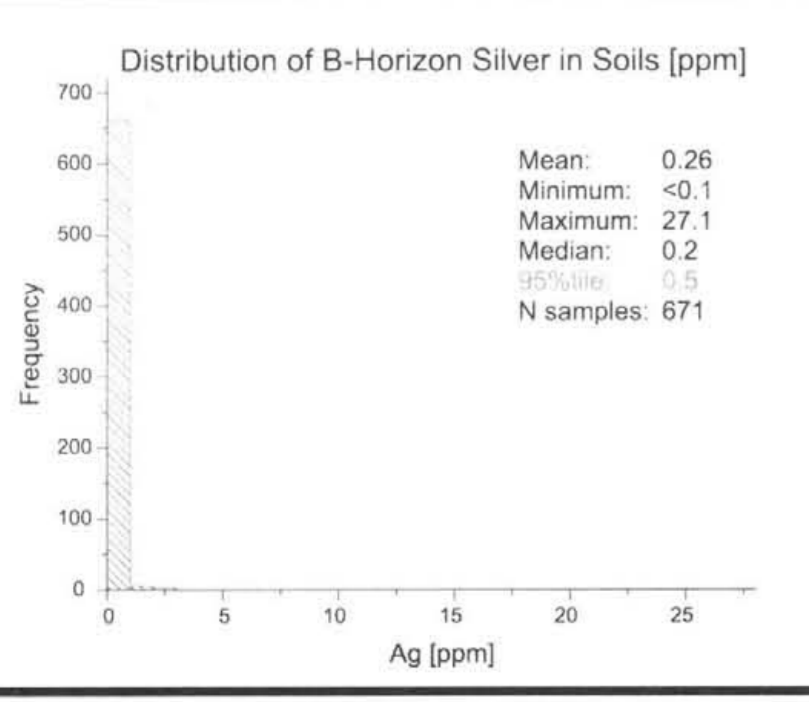
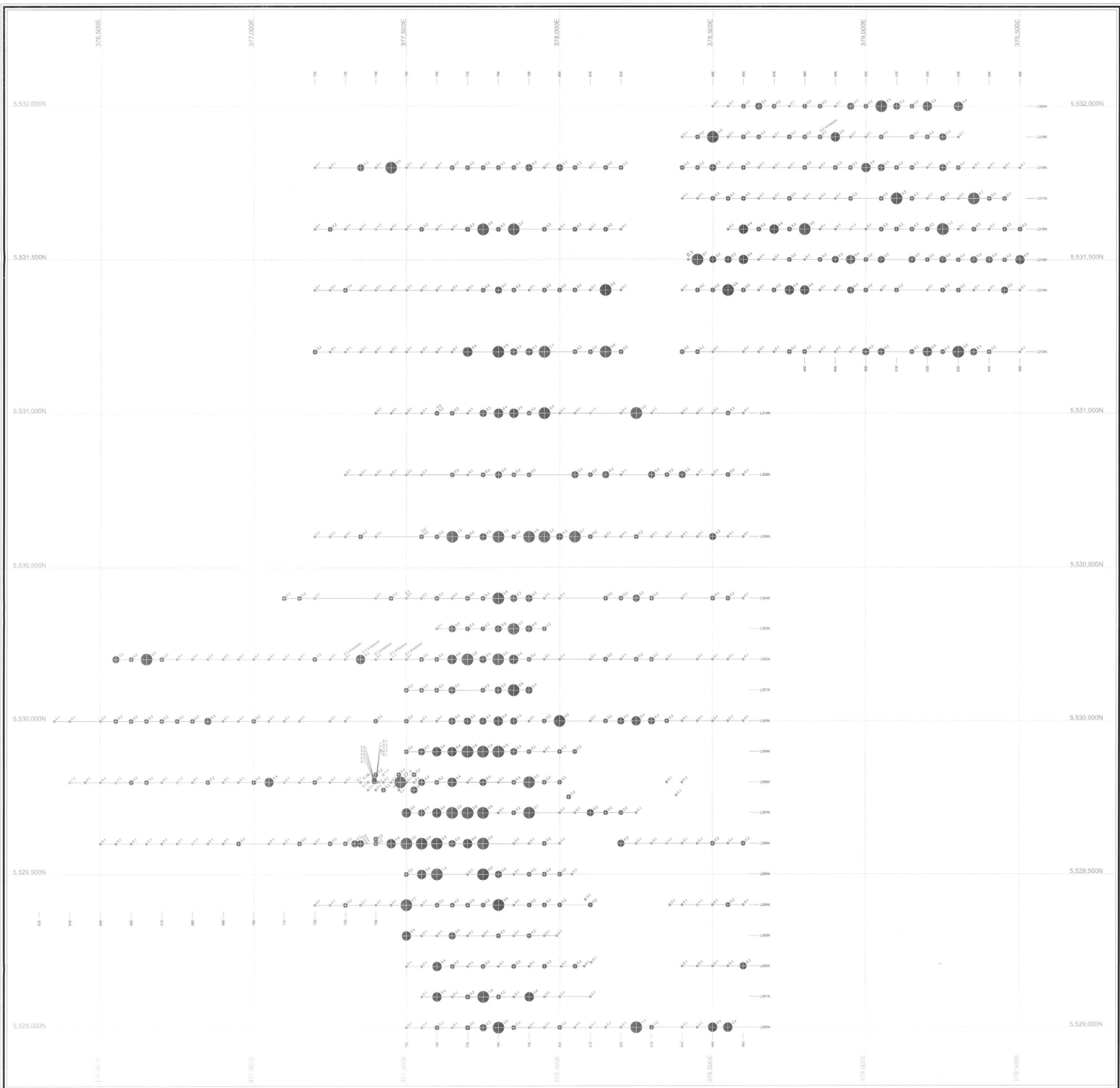

Symbol Key

- Assay > 95%tile
- Sample scaled proportional to assay
- Assay below detection limit

All samples from B-horizon unless specifically labelled A-horizon.

LERoy VENTURES
KETTLE PROPERTY
SILVER in SOILS [ppm]

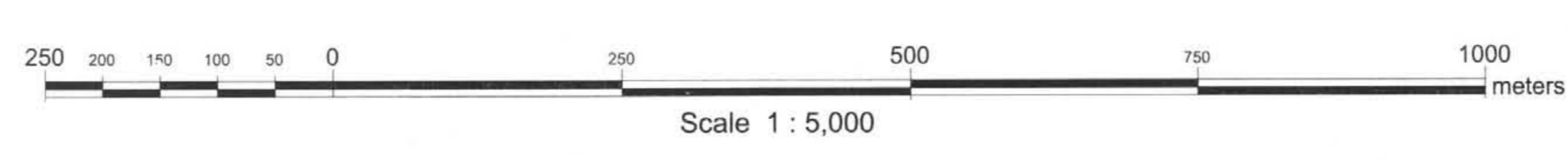

MAP 03

LERoy VENTURES
KETTLE PROPERTY

Ag [ppm]

PROFESSIONAL
GEOLOGICAL SURVEY BRANCH
J. DAVID WILLIAMS
N.T.S. 08/28/15
Date: revised 19 October 2005
File: Kettle_SoilSurvey.dwg [Ag_5K]

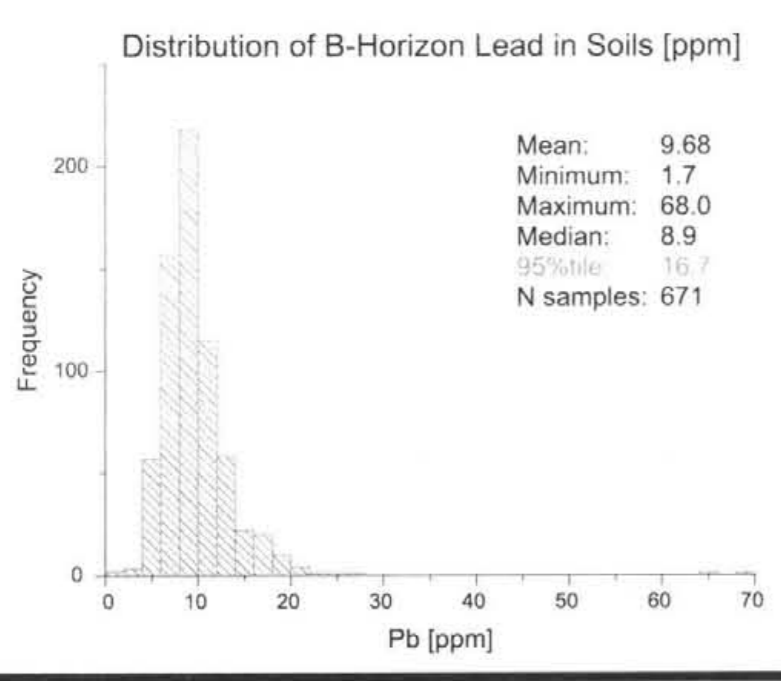
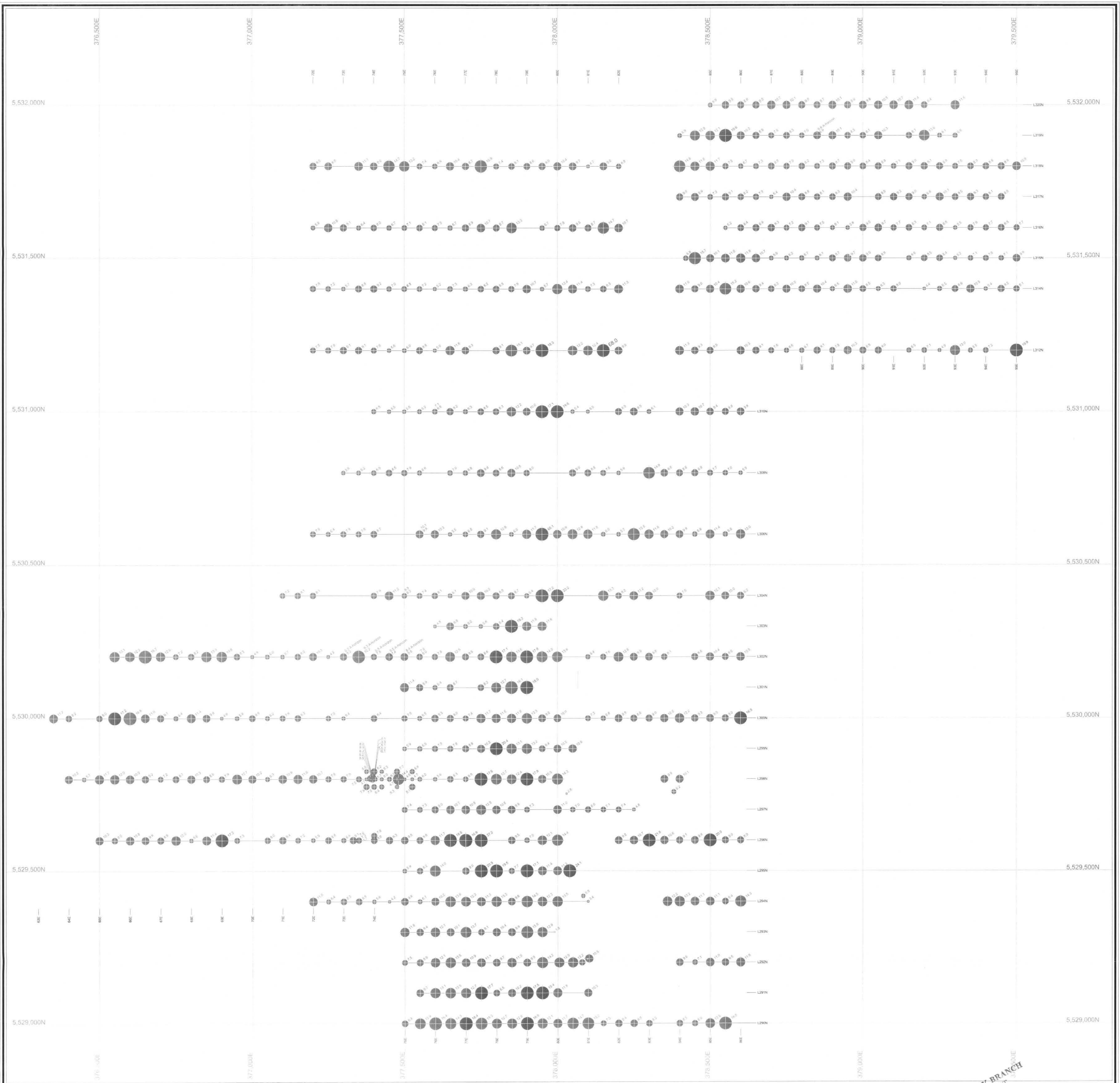

Symbol Key

- Assay > 95%ile
- Sample scaled proportional to assay
- Assay below detection limit

All samples from B-horizon unless specifically labelled A-horizon.

LERoy VENTURES
KETTLE PROPERTY
LEAD in SOILS [ppm]

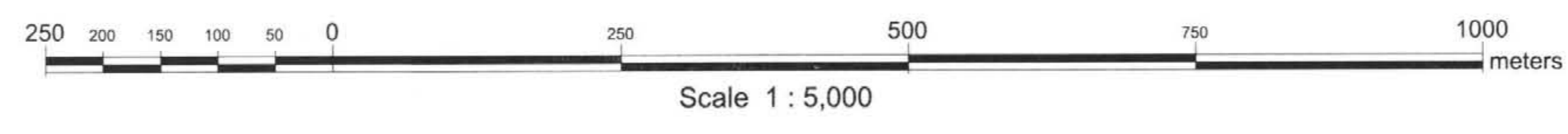

MAP 04

2021

LERoy VENTURES
KETTLE PROPERTY

Bill Wilkinson
Geotechnical Engineer

Date by: Bill Wilkinson
Drawn By: J. David Williams, P.Eng
Scale: 1:5,000
N.T.S.: 082E/15
Date: revised 18 October 2005
File: Kettle_SoilSurvey.dwg [Pb_5K]

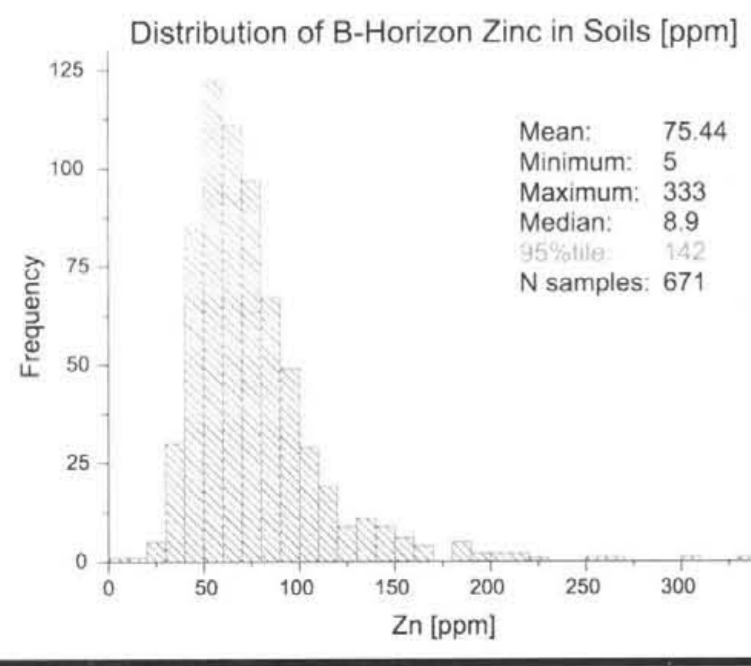
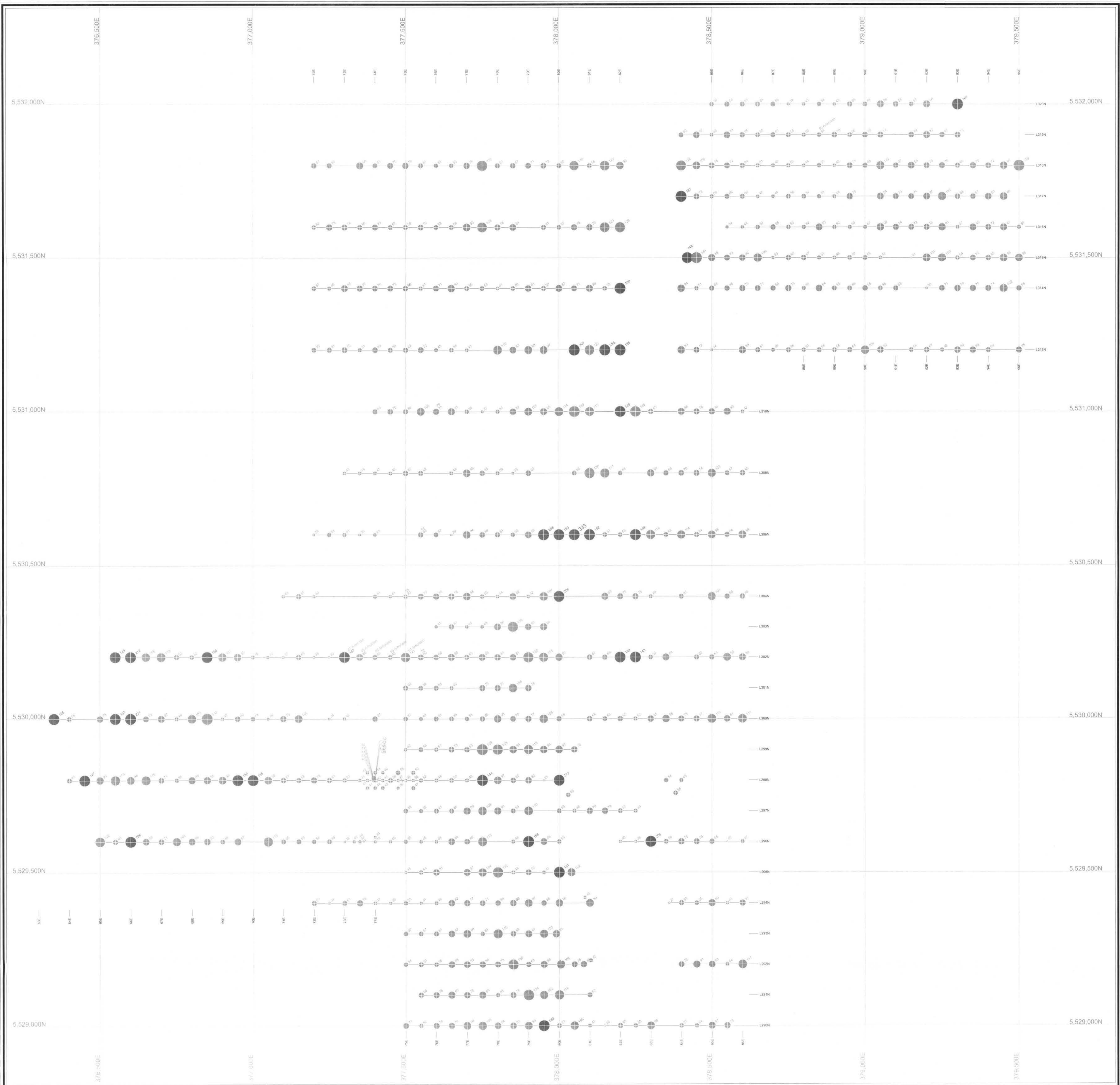

Symbol Key

- Assay > 95%tile
- Sample scaled proportional to assay
- Assay below detection limit

All samples from B-horizon unless specifically labelled A-horizon.

LERoy VENTURES
KETTLE PROPERTY
ZINC in SOILS [ppm]

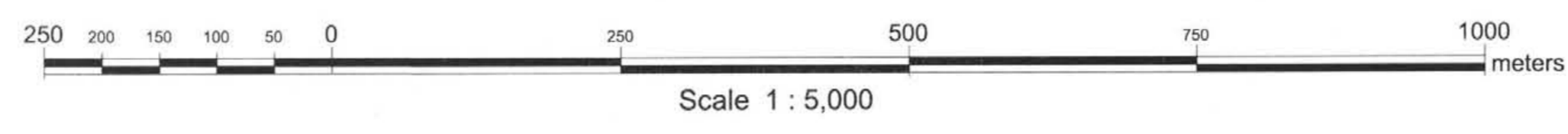

MAP 05

LERoy VENTURES
KETTLE PROPERTY

Zn [ppm]

Geological Survey
Professional Engineer
J. David Williams
N.T.S.: 082E/15
Date: revised 18 October 2005
File: Kettle_SoilSurvey.dwg (2.5K)

28, 11

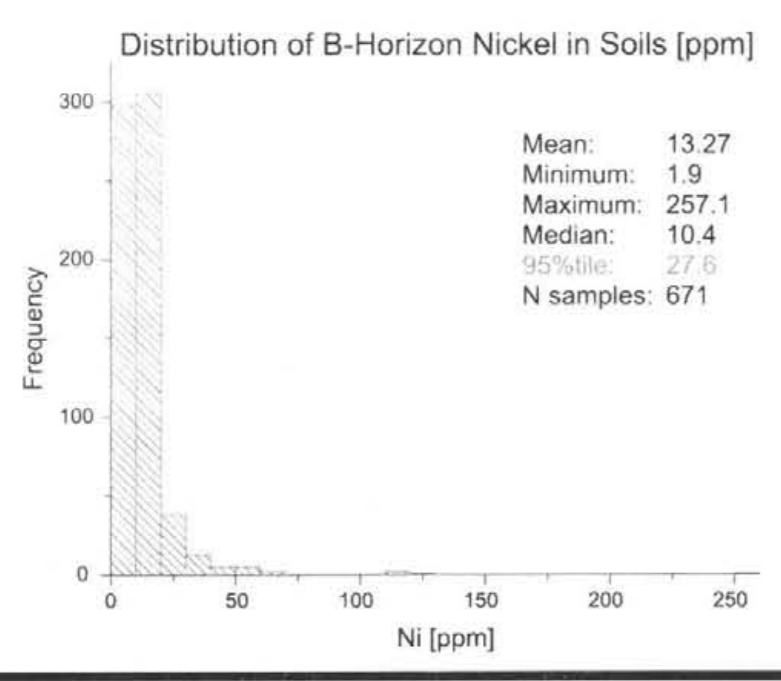
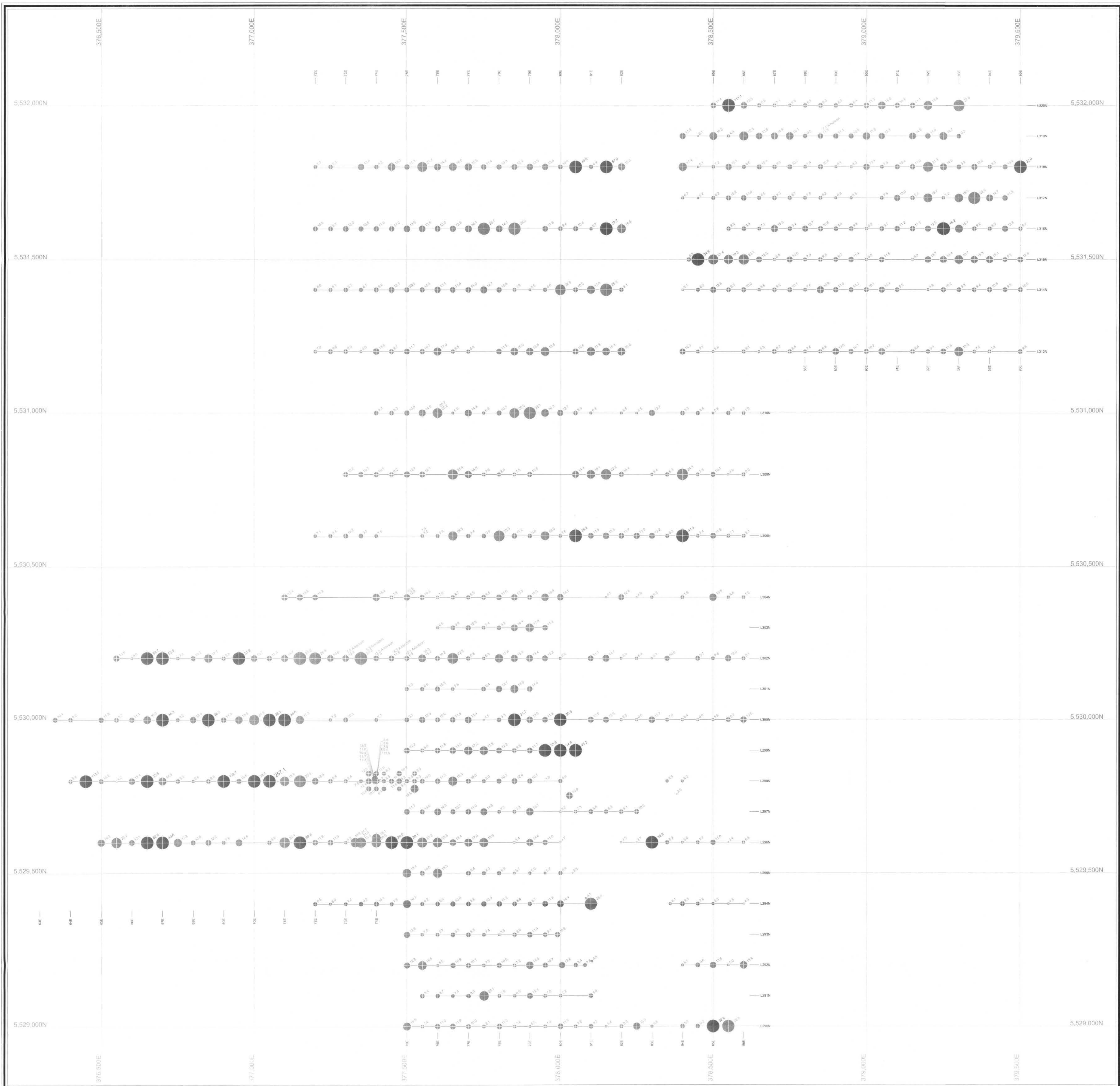

Symbol Key

- Assay > 95%tile
- Sample scaled proportional to assay
- Assay below detection limit

All samples from B-horizon unless specifically labelled A-horizon.

LEROY VENTURES
KETTLE PROPERTY
NICKEL in SOILS [ppm]

Scale 1 : 5,000



MAP 06

Ni [ppm]

PROFESSIONAL ENGINEER
J. DAVID WILLIAMS, P. ENG.
COLUMBIA UNIVERSITY
SCHOOL OF CIVIL AND ENVIRONMENTAL ENGINEERING

Date: 08/25/15
N.T.S.: 08/25/15
File: Kettle_SoilSurvey.dwg (NLSK)

28.1.15

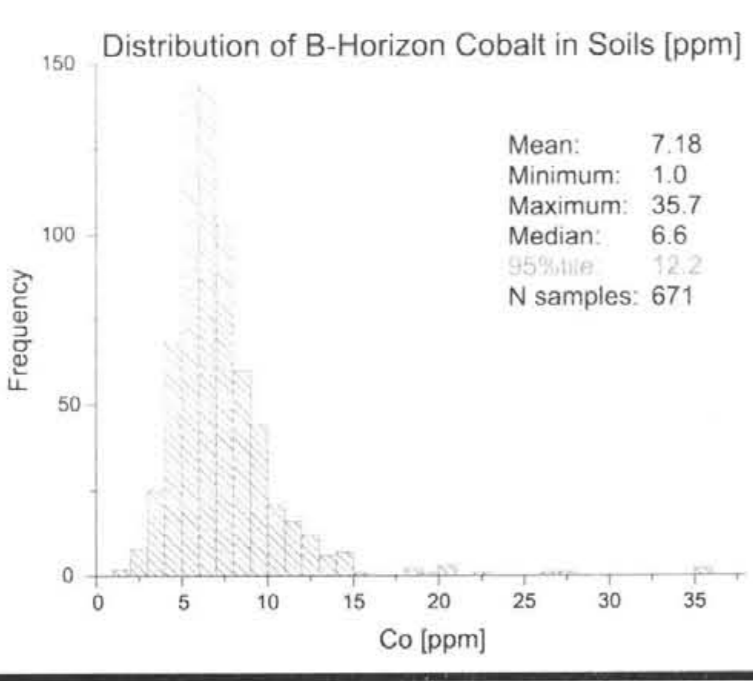
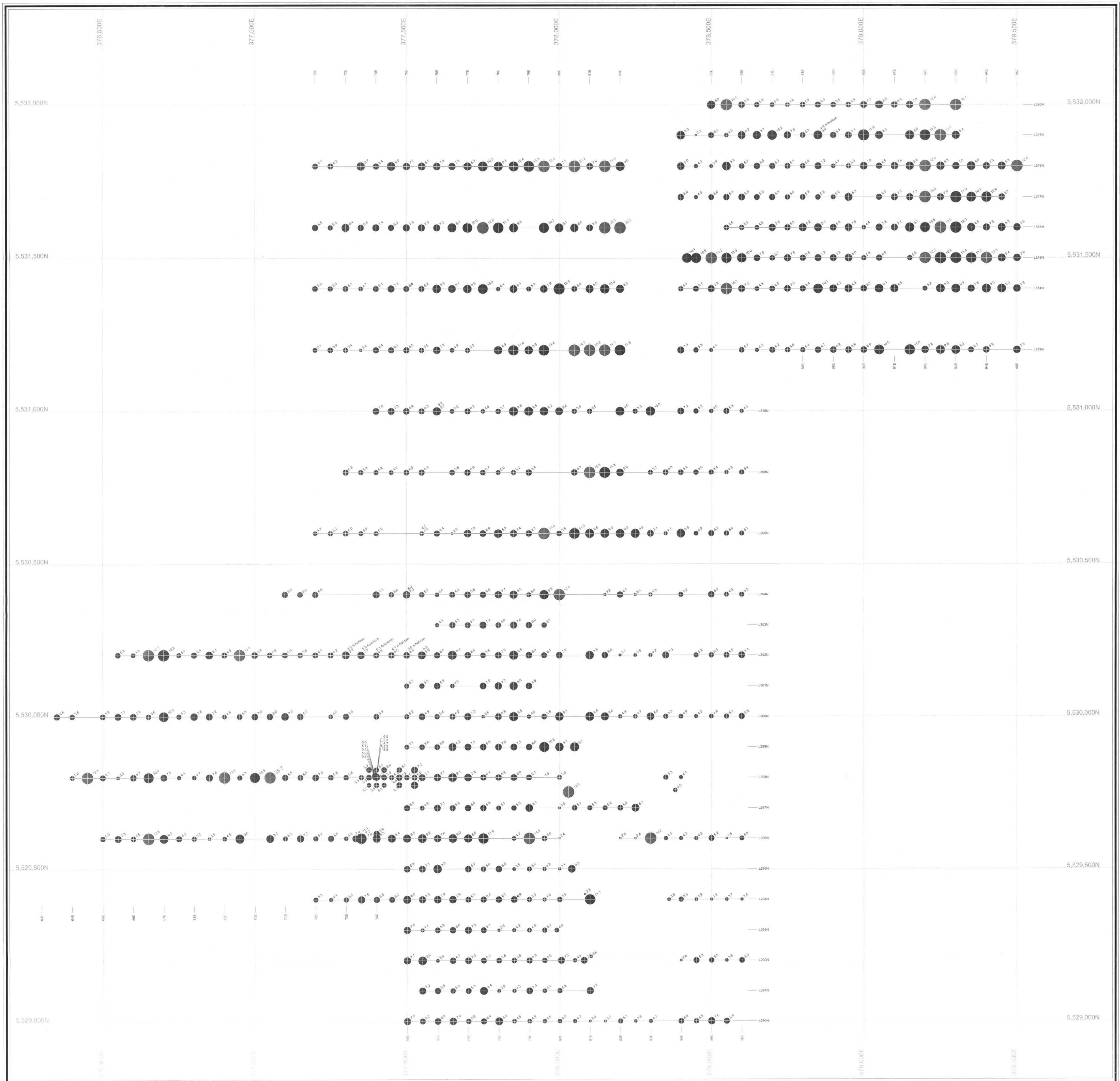

Symbol Key

- Assay > 95%ile
- Sample scaled proportional to assay
- Assay below detection limit

All samples from B-horizon unless specifically labelled A-horizon.

LEROY VENTURES
KETTLE PROPERTY
COBALT in SOILS [ppm]

Scale 1 : 5,000



MAP 07

Co [ppm]

PROFESSIONAL SURVEY BRANCH
REPORT

Data by: Bill Wilkinson
 Drawn By: J. David Williams, P. Eng.
 Scale: 1:5,000
 N.T.S.: 08/21/15
 Date: revised 18 October 2005
 File: Kettle_SoilSurvey.dwg [Co_5K]

2017-21

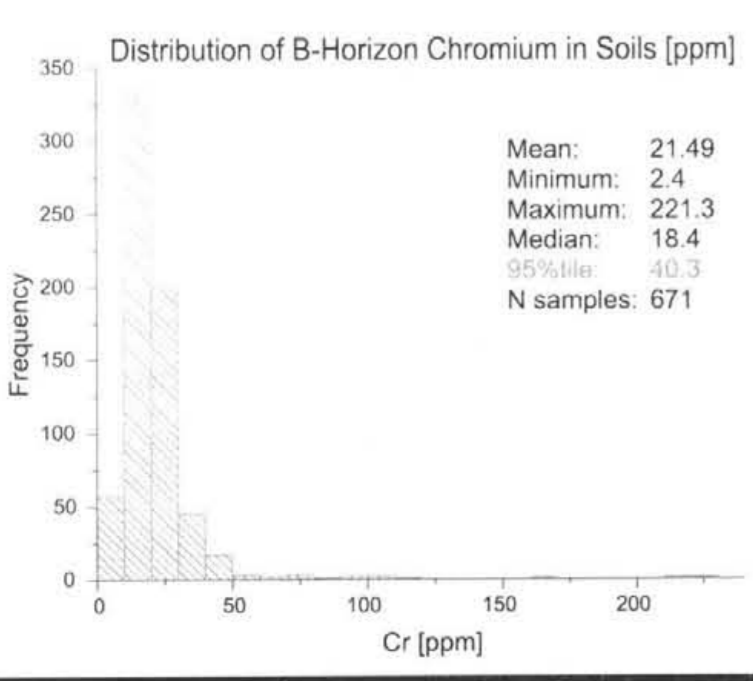
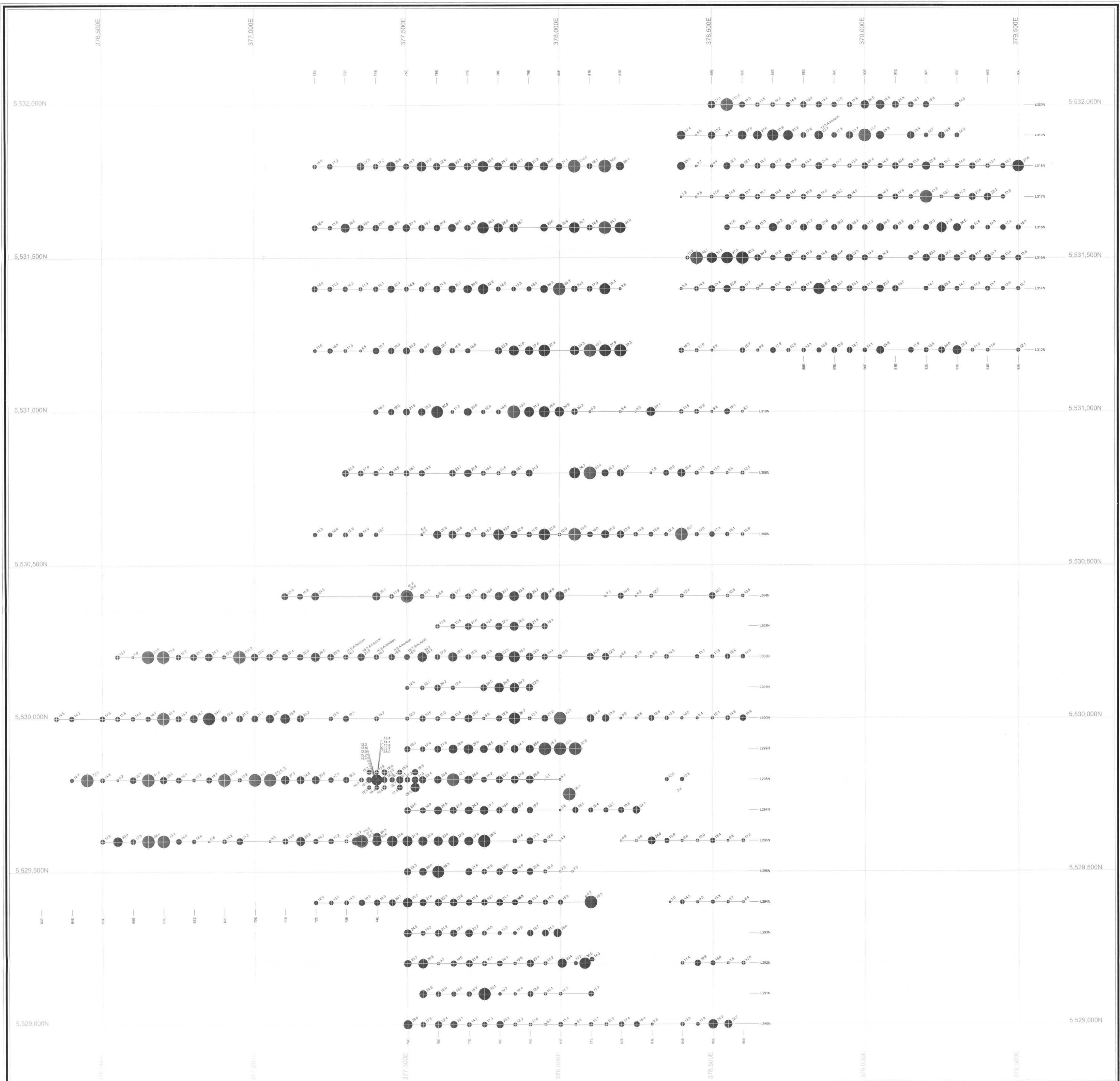

Symbol Key

- Assay > 95%tile
- Sample scaled proportional to assay
- Assay below detection limit

All samples from B-horizon unless specifically labelled A-horizon.

LEROY VENTURES
KETTLE PROPERTY
CHROMIUM in SOILS [ppm]

Scale 1 : 5,000



MAP 08

**LEROY VENTURES
KETTLE PROPERTY**

Cr [ppm]

Date: 08/22/15
 Drawn By: J. David Williams, P.Eng.
 Scale: 1:5,000
 N.T.S.: 08/22/15
 Date: revised 18 October 2005
 File: Kettle_SoilSurvey.dwg [Cr_5K]

28,141

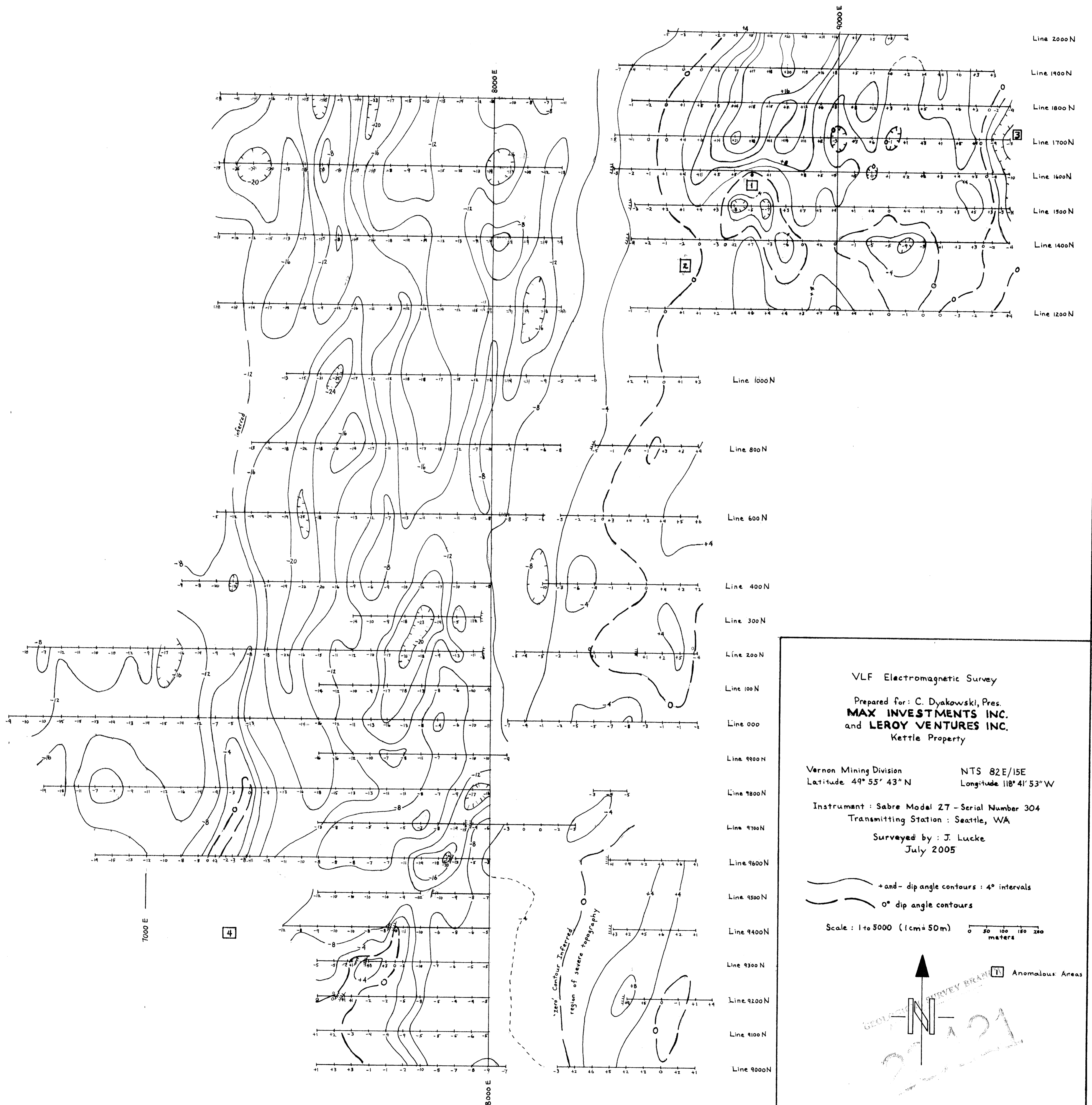

VLF Electromagnetic Survey

Prepared for: C. Dyakowski, Pres.
MAX INVESTMENTS INC.
 and **LEROY VENTURES INC.**
 Kettle Property

Vernon Mining Division NTS 82E/15E
 Latitude 49° 55' 43" N Longitude 118° 41' 53" W

Instrument: Sabre Model 27 - Serial Number 304
 Transmitting Station: Seattle, WA

Surveyed by: J. Lucke
 July 2005

— + and - dip angle contours: 4° intervals
 - - - 0° dip angle contours

Scale: 1 to 5000 (1cm = 50m)

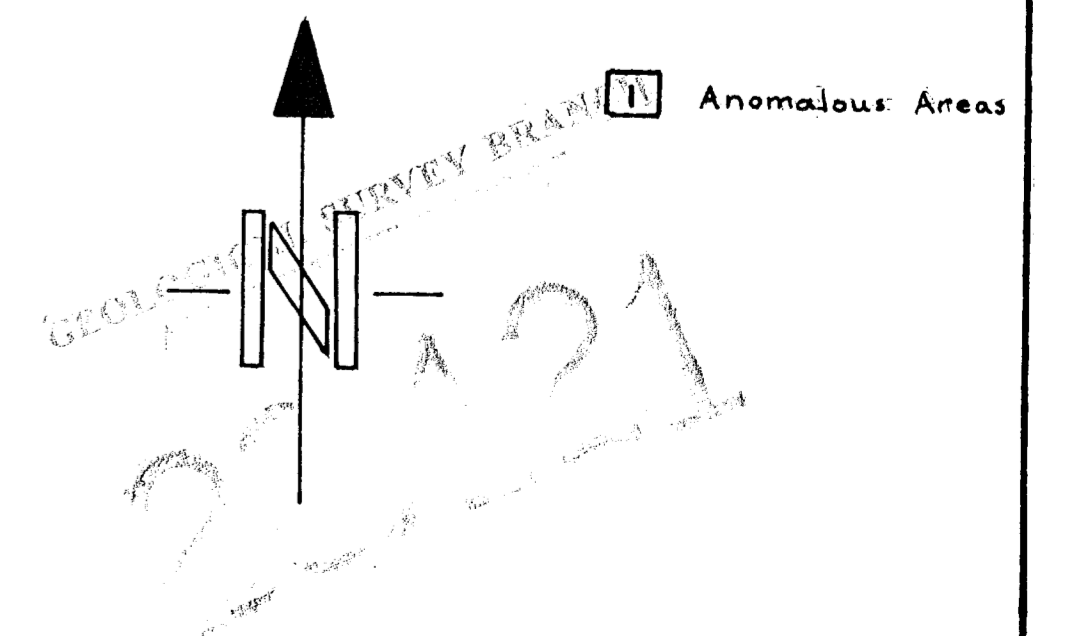

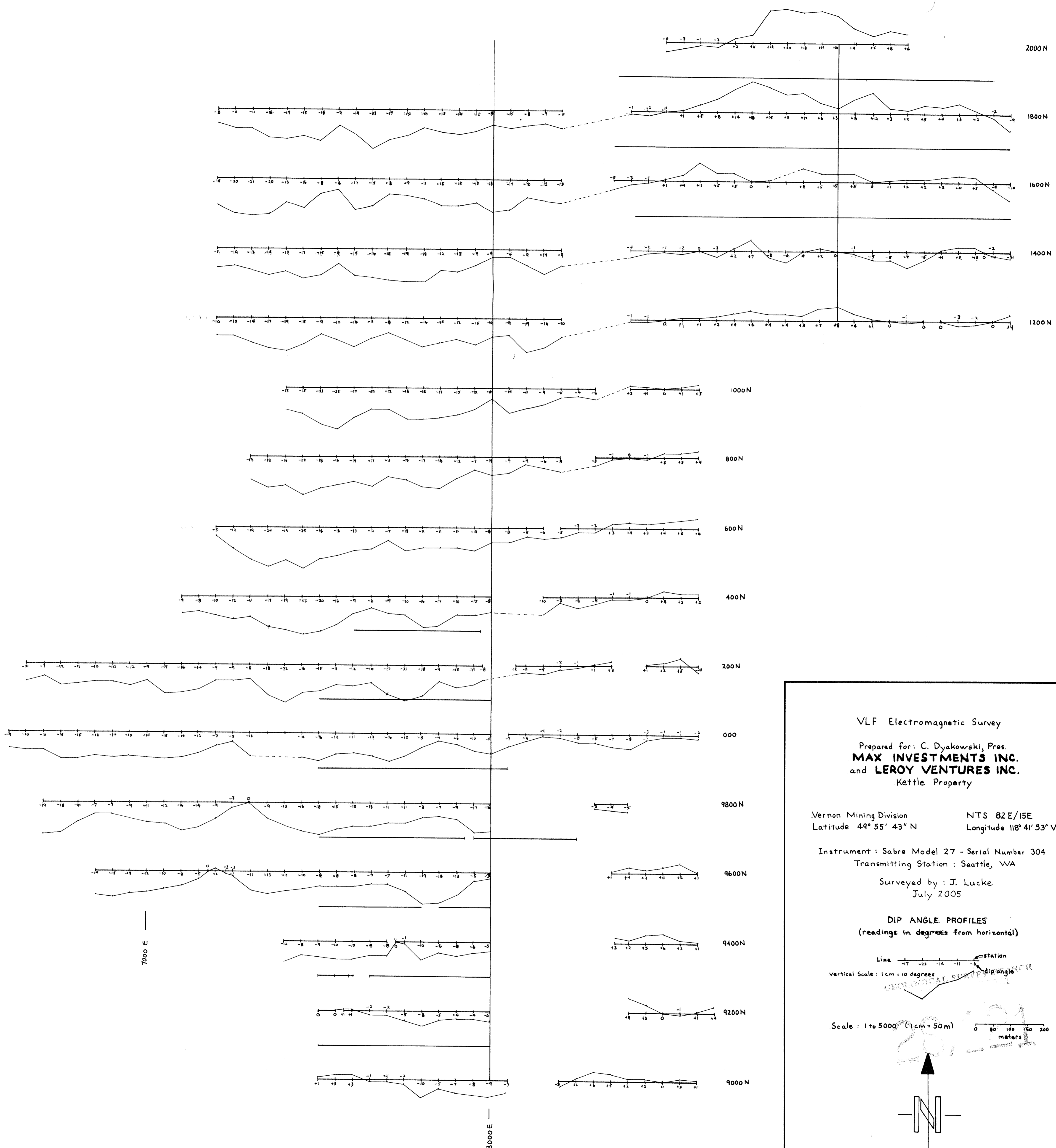

VLF Electromagnetic Survey

Prepared for: C. Dyakowski, Pres.
MAX INVESTMENTS INC.
 and **LEROY VENTURES INC.**
 Kettle Property

Vernon Mining Division NTS 82 E/15 E
 Latitude 49° 55' 43" N Longitude 118° 41' 53" W

Instrument: Sabre Model 27 - Serial Number 304
 Transmitting Station: Seattle, WA

Surveyed by: J. Lucke
 July 2005

DIP ANGLE PROFILES
 (readings in degrees from horizontal)

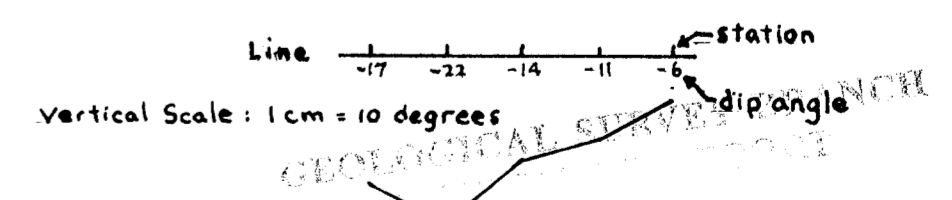

Scale: 1 to 5000' (1 cm = 50 m)

