

**Report # 4-
On-going exploration on the
Deerhorn (rand) project,
Diamond Drilling and
Related work**

**First half of D. Drilling program
July, 2005**

Event # 4042920

**Cariboo Mining Division
NTS 93A-3W, 93A-6W
Lat. 52° 16' 3" Long. 121° 21'**

Owned by:

Herb Wahl

Jack Brown-John

Rudy C. Riepe

Operated by Performance Minerals Canada Ltd.

Prepared by:

**Rudy C. Riepe, Prospector
P.O box 69 Sechelt B.C.
February, 2006**

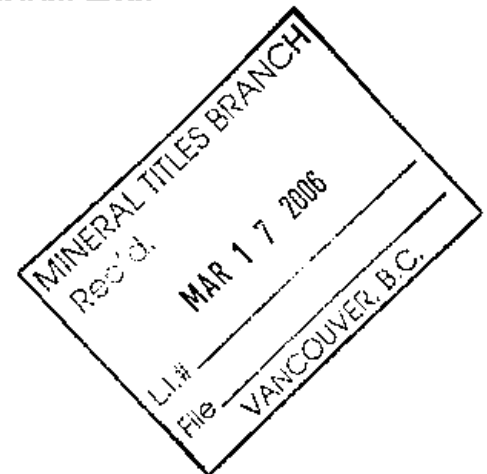

List of Figures

- 1 General location**
- 2 Claim Map 1:20,000**
- 3 Claim Map and detail**
- 4 Detail Work Map 1:5,000**
- 5 Forestry Tenure and Access**

Drill Records

- Hole #1 2 pages**
- Hole #2 4 pages**
- Hole #3 2 pages**
- Hole #4 2 pages**
- Hole #5 4 pages**

LOCATION AND ACCESS (Figs. 1, & A)

The property lies 7 Km southeast of Horsefly, just south of the Horsefly River. Access is south from Horsefly on the 108 Road to Woodjam Road, then east to the bridge spanning Deerhorn Creek. A network of secondary logging trails provides access to most interior areas of the claims.

PROPERTY (Fig. 1A)

The property is constituted as follows:

<u>Claim</u>	<u>Record No.</u>	<u>Units</u>	<u>Record Date</u>
Rand-1	362837	20	13 May 1998
Rand-2	367381	20	27 Nov 1998
Rand-3	368561	18	14 April 1999
Rand-4	406281	1	18 Oct 2003
Rand-5	406282	1	18 Oct 2003
Goldbuck	412900	20	21 Jul 2004

The claims are all situated in the Cariboo Mining Division. Annual assessment expenditure per claim unit is \$100 in the first three years of tenure, increasing to \$200/unit thereafter. The above are all in good standing until the next anniversary date.

TERRAIN/TOPOGRAPHY

The rand mineral claims lie within the Quesnel Highland division of the Central B.C. Fraser Plateau. Elevations in the claimed area range from 2,800 feet ASL in the Horsefly River Valley, to some 330 feet ASL in the southern claim area. Terrain is generally flattish to rolling, principal stream drainage is northerly into the Horsefly River. About 40% of the area is regenerating cut blocks, with the usual spruce-pine-fir-aspen timber present in un-logged areas. Glacial overburden is extensive and thick, with glacial outwash more abundant towards the Horsefly River. The only outcrop observed was syenitic intrusive, present as a substantial stock west of Deerhorn Creek.

February, 2006

Re: 2005 Rand Group Ongoing Exploration Program

Purpose of the work program

To determine the extent and boundaries of the alteration halo proximal to the domineering. Takomkane Stock to the south and it's Lithology to depth.

Work performed

- Relocated proposed Drill-sites, re-established reference points.
- Mobilized crew and equipment to clear Drill-sites, and started drilling June 25/05.
- Supervised drilling, core recovery and records. Footage from 4 locations and 5 DDHoles total *3899 ft. = 1185 meter*
- Casing in DDH # 2, 4, & 5 remained to allow Down Hole Geophysics.
- Drill-sites were cleaned and reconditioned after completion of drilling July 10/05
- Core boxes transferred to safe-site for storage and logging.
- Recorded the Work Program with Mineral Titles for credit, 2 years to July 21/07 plus opened PAC Account Wind River Resources Credit.

Results

To follow after 2006 half of program

Work Ahead

- Split core as indicated by spotassays.
- Measure conductivity and proximity through Downhole Geophysics, particularly in DDH #2 & 4
- To drill fence of 4 holes app. 1.5 Km south of present line of holes.

to fault movement has occurred.

GOLD MINERALIZATION AND ASSOCIATED DEPOSIT

Lode gold mineralization was reported from the area as early as 1902, when placer miners drove tunnels on pyrite bearing

Figure 1. Location map showing major tectonic features and gold occurrences

Fig. 1
Performance Minerals Canada Ltd.
Deerhorn (Rand) Gold-Copper Project
General Location Map

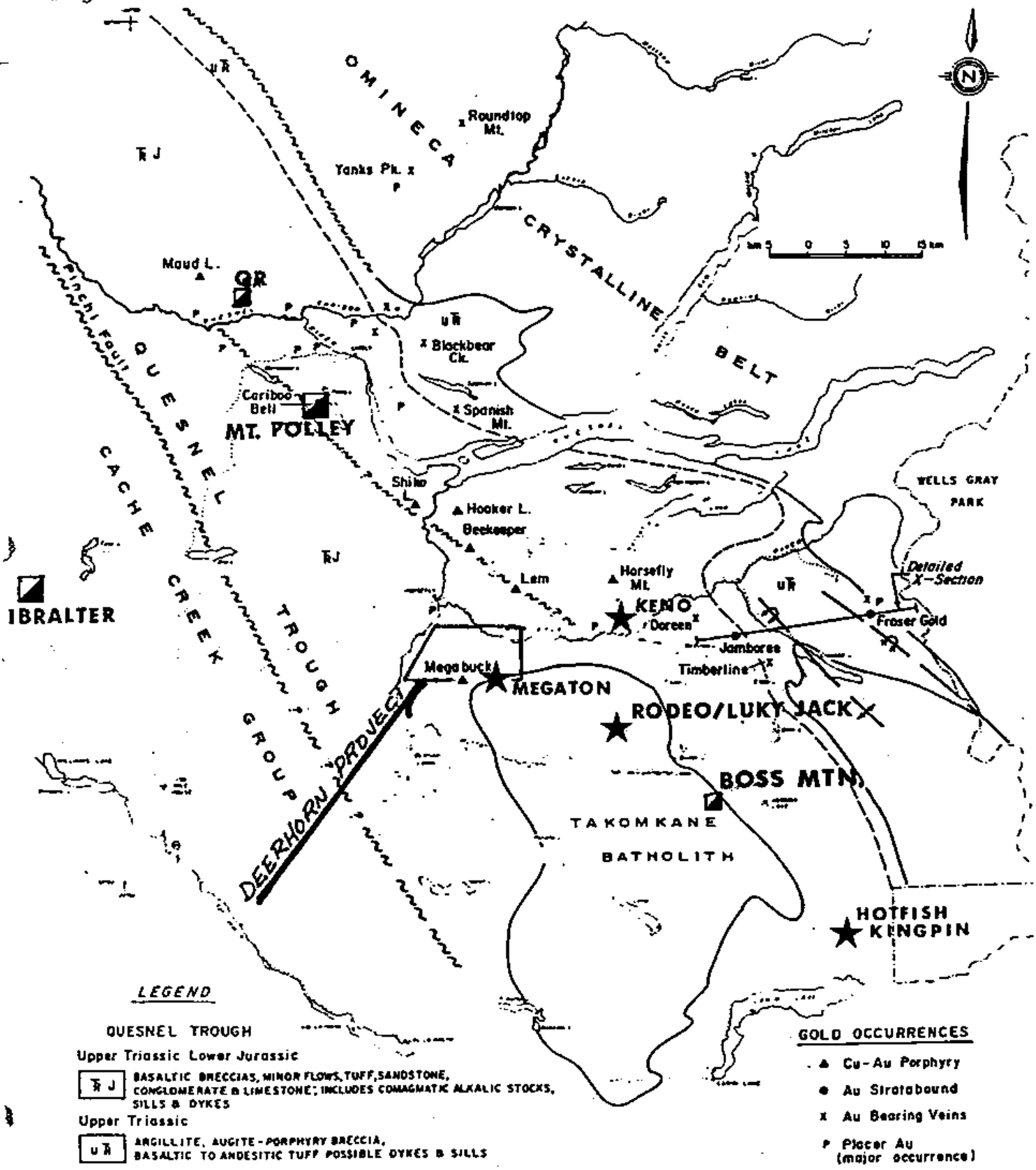
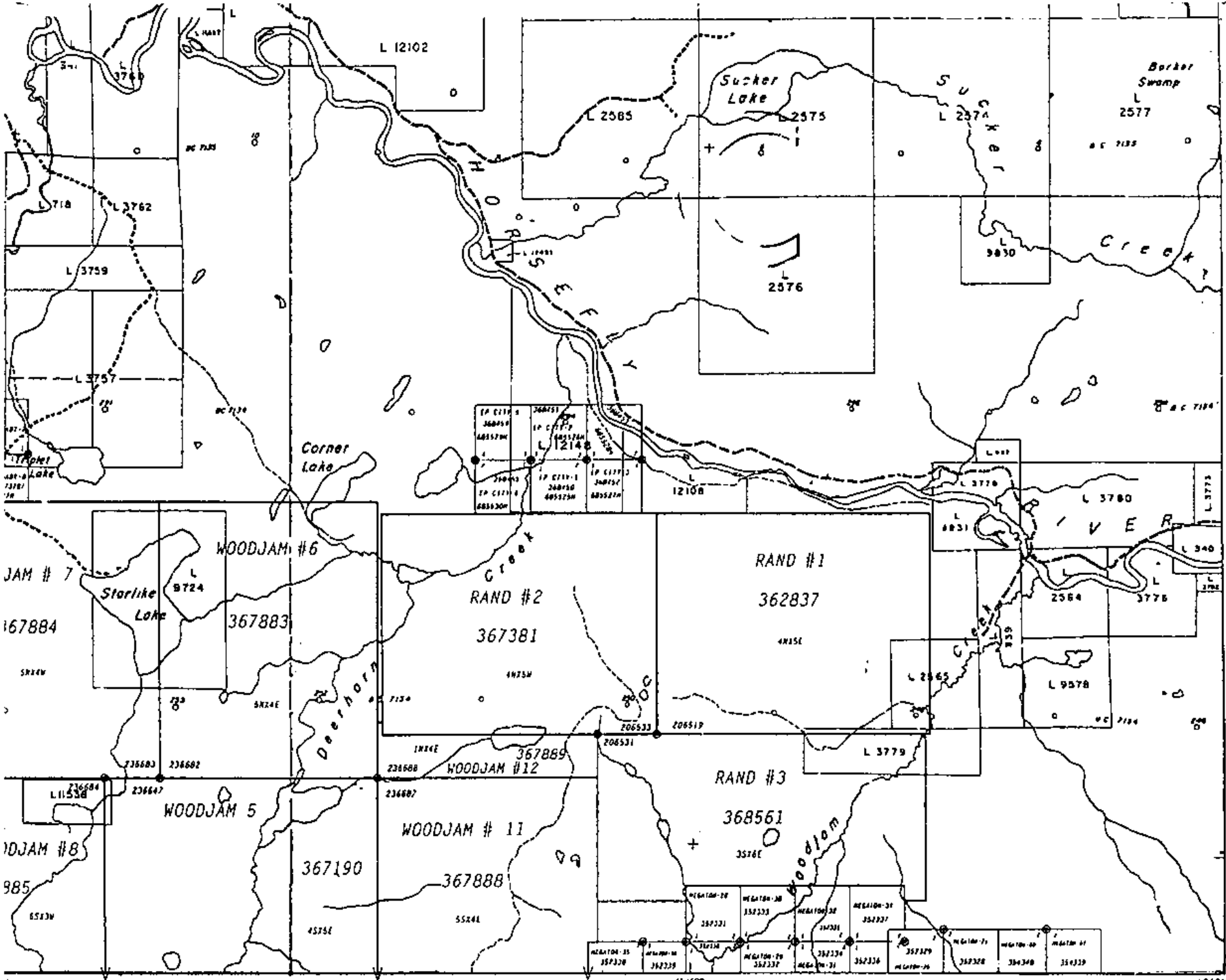

Fig 4



414592

52°15'00"
121°15'00"

PERFORMANCE MINERALS
OF CANADA LTD.

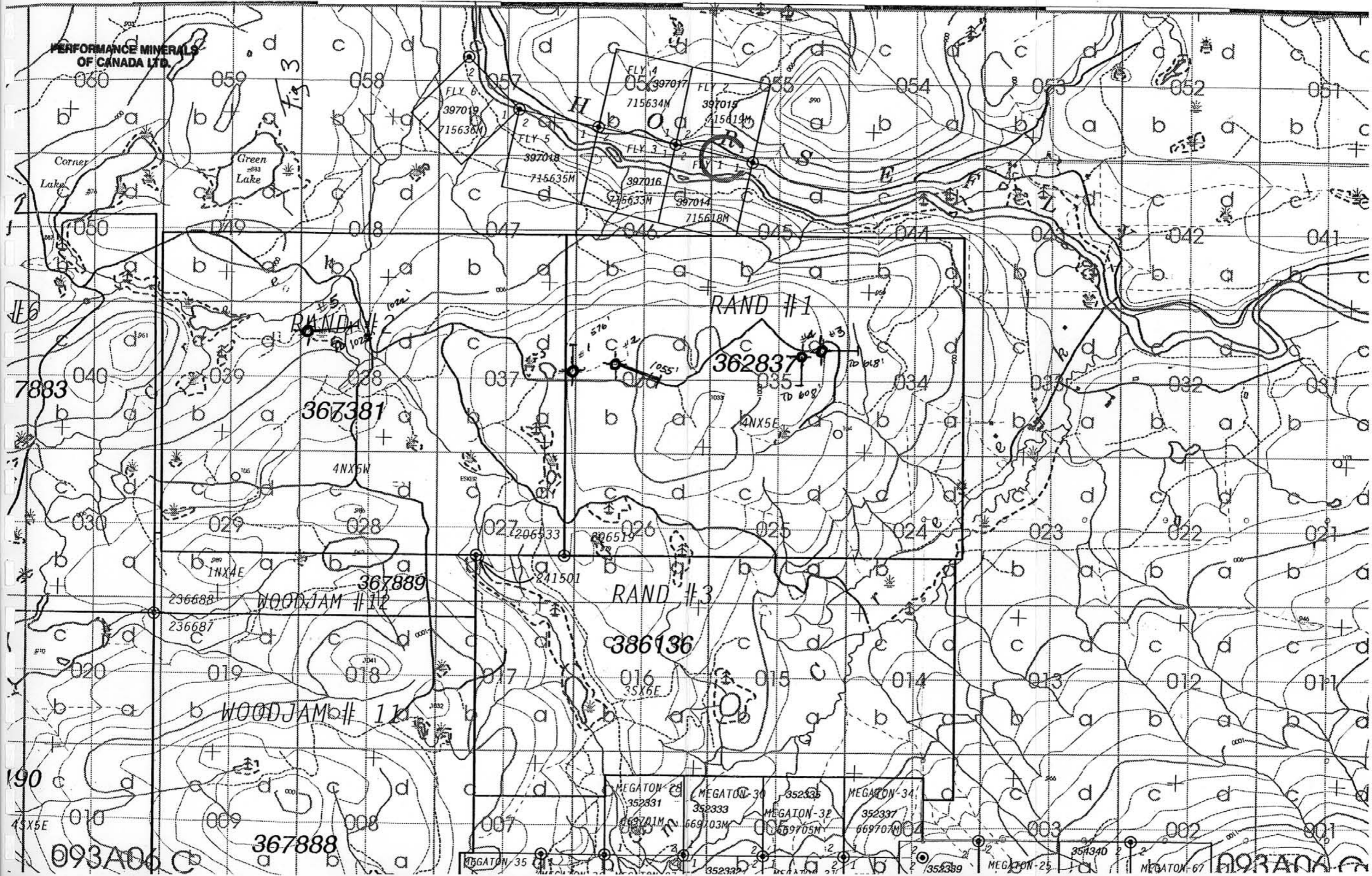

DIAMOND DRILL RECORD

 PROPERTY Cariboo Rand

 HOLE No. 05-19

DIP TEST		
Footage	Angle	
	Reading	Corrected

 Hole No. 19 Sheet No. 1 Lat. 0614020
 Section -60° Dep. 5790419
 Date Begun June 26 -05 Bearing North 0 Az
 Date Finished June 28 -05 Elev. Collar 976 m.

 Total Depth 576' - 176 m.
 Logged By Rudi Riepe
 Claim Rand 1
 Core Size NO

DEPTH	DESCRIPTION	SAMPLE No.	WIDTH OF SAMPLE	Colour	Grain	Sb.	Box
1 - 37	OB Volcanic residue + clay (rubble)			mixed brown			1
37 - 47	EC Sediments, siltstone			brown	fine	heavy	2
47 - 71	" " layered			br-white	"	medium	3
71 - 76	" " " carbon to lignites			brown	"	"	3
76 - 86	" Sandstone coated black organic & lign.			br-grey	"	"	3-4
86 - 90	" inclusions iron oxides sericite clays			gr-black	"	"	4
90 - 115.5	" Sandstone softer iron oxides			gr-mar	medium		5-6
115.5 - 134	" " organic inclusions			grey	"		6+7
134 - 152	" Siltstone layered, light colored banding			dark br.	fine		7
152 - 160	" " " wide banding			brown	"	light	8
160 - 166	" lignite to coal massive			dark br	"	"	9
166 - 178	" Siltstone mixed coal in clay			"	"	"	9
178 - 181	" " massive coal bands			grey	medium	med.	10
181 - 185	" Sandstone minor organics			grey	"	"	10
185 - 188	" Siltstone more coal bands			grey	fine	"	10
188 - 196.5	" Sandstone massive minor bands (1/4")			"	med	"	11
196.5 - 202	" Siltstone bands (1/4") in massive coal			gr-black	fine	"	11
202 - 242	" Sandstone minor bands (blk)			grey	fine	"	12+13
242 - 288	" Siltstone massive " "			"	"	"	14
288 - 275	" " core fractured			dk grey	"	"	15
275 - 285	" Sandstone clay banding to 1" wide			gr.	med	"	15

DIAMOND DRILL RECORD

 PROPERTY Cariboo Road

 HOLE No. 05-1a

DIP TEST		
Footage	Angle	
	Reading	Corrected

Hole No. <u>1a</u>	Sheet No. <u>2</u>	Lat.	Total Depth. <u>176 m</u>
Section	Dep.	Logged By	Claim
Date Begun	Bearing	Core Size	
Date Finished	Elev. Collar		

DEPTH	DESCRIPTION	SAMPLE No.	WIDTH OF SAMPLE	Color	Grain	S.B.	Box
285 - 312	Sediments Siltstone + coarse sand banding (1/4 to 3/8")			grey-white	mixed	light	16
312 - 314	" Sandstone			grey	medium	"	16
314 - 330	" Siltstone minor coal bands @ 318			gr-blk	fine	"	17
330 - 342	" " grading to fine sandstone @ 333			grey	"	"	18
342 - 349	" " mixed to sandst white bands				"	"	18
349 - 378	" " increasingly tuffaceous "			dk bl	medium	"	19+20
378 - 383	" " mixing to volcanic sediment character			white	"	"	20
383 - 389	" " " sandy sections			white	"	"	20
389 - 462	Volcanic " in character Sandstone section			light grey	coarse	"	20-23
462 - 478	Volcanic Sediments some conglomerate sections cemented			"	medium	very low	23
478 - 531	" → Fly ash character			"	"	Specific	24-26
531 - 538	" Tuffa cemented Breccia			"	"	Gravity	27
538 - 548	" " more massive bands (Breccia)			"	"	"	27
548 - 565	" Tuffa rock massive			gr-white	"	"	28
565 - 569	" Conglomerate darker inclusions			dk grey	"	"	29
569 - 576	" Tuffa rock massive to EOH			white	"	"	29
Pipes stuck in hole - data break through unconformity 2 recovered some tools by blasting							

DIAMOND DRILL RECORD

 PROPERTY Caribou Rand

 HOLE No. 05 - 02

DIP TEST		
Footage	Angle	
	Reading	Corrected

 Hole No. 02 Sheet No. 1
 Section -60° W
 Date Begun June 29 -05
 Date Finished July 2 -05

 Lat. 0614228
 Dep. 5793668
 Bearing Azy 64°
 Elev. Collar 985 m

 Total Depth 10.55' = 322 m
 Logged By Rudi Riepe
 Claim Rand 1
 Core Size NQ

DEPTH	DESCRIPTION	SAMPLE No.	WIDTH OF SAMPLE	Colour	Grain	SG.	Box
0 - 17	OB Volcanics mix clay (rubble)			dk green	fine	heavy	1
17 - 28	6" solid core followed conglomerates volcanics			"	coarse	"	1
28 - 38	Andesitic Volcs fractured Fe oxides on slips some opal in Oxi			green-blk	fine	"	2
38 - 45	" minor sulfides in layer core pos. (Cu stain)			black grey	"	"	2
45 - 58	2 Bottom of Miocene Flow vesicles appearing minor Sulfides			"	"	"	3
58 - 68	Contact material, sediments sandy oxides vesicles basaltic looking			brown	coarse	light	3
68 - 76	tuffaceous flow rock minor sulfides Mangan stains			grey	"	"	3
76 - 81	loose sand stone with oxides Fe			br. grey	"	"	4
81 - 90	Sediments Volcs solution cavities remnant with coal			"	medium	"	4
90 - 106	Tuff in sandstone + brecciated minor metallic oxides			dk grey	coarse	medium	5
106 - 115	banded siltstone minor Volcs.			grey	very fine	light	6
115 - 119	Dacite Volcs. oxides on fractures minor metallics			dk grey	fine	heavy	6
119 - 135	" massive core few fracture vesicles + Zeolite filled			"	"	"	7
135 - 153	" " " more metallics			"	"	"	8
153 - 171	" " some Cu stain			black	"	"	9
171 - 188	" solid "			"	"	"	10
188 - 207	" " " Cu stain on fractures very hard rock			"	"	very "	11
207 - 223	" fracture increase more metallics			"	"	on contact	12
223 - 226	Volcanic sediments + tuff			light grey	"	lighter med	12
226 - 241	" " some pronounced layering some coal shades of grey			"	"	light	13
241 - 259	" " coal bands up to 6" wide minor metallics to coal			"	"	light	14

DIAMOND DRILL RECORD

PROPERTY Cariboo - Rand

HOLE No. 05-02

DIP TEST		
Footage	Angle	
	Reading	Corrected

Hole No. 02 Sheet No. 2 Lat. Total Depth 322 m
 Section Dep. Logged By
 Date Begun Bearing Claim
 Date Finished Elev. Collar Core Size

DEPTH	DESCRIPTION	SAMPLE No.	WIDTH OF SAMPLE	Color	Grain	SG.	Box
259 - 272	Volcanic Sediments narrow coal bands 2-3" some metallics			grey-black	fine	light	15
272 - 296	" " into silty @ 288 with minor banding			dk grey	medium	"	16
296 - 315	" " siltstone (ash) massive core to shade			"	fine	med.	17
315 - 333	" " " " solid increase sericite			"	fine	"	18
333 - 337	" " sandstone layered some organic streaks			grey	med.	"	19
337 - 352	" " " silty sulphides in fracture bands @ 345			"	fine	"	19
352 - 371	" " " clay nature " much sericite			grey	med	"	20
371 - 388	" " " " " "			"	"	"	21
388 - 405	" " frequent banding fracturing			"	fine	"	22
405 - 414	" " sandstone inc. metallics			light grey	med	light	23
414 - 422	" " " fractured + layering			"	fine	lighter	23
422 - 438	" " Tuff banded metallics in dark bands			grey	fine	light	24
438 - 455	" " " sandy banded @ 443			"	med	"	25
455 - 459	" " banded silts			"	fine	"	26
458 - 476	" " sandstone less sericite			dk grey	Coarse	"	26
476 - 494	Tuff " type " inc. biotite flakes			light grey	med.	very light	27
494 - 513	" " " v. Ash like "			"	fine	"	28
513 - 519	" " " inc. Fracture			"	medium	light	29
519 - 523	" " " " coarsens			"	fine	"	29
523 - 530	" " " banded layering inc. organics			"	"	"	29
530 - 550	" " " sand to clay bands minor metallics			"	"	"	30

DIAMOND DRILL RECORD

PROPERTY Cariboo - Rand

HOLE No. 05 - 02

DIP TEST		
Footage	Angle	
	Reading	Corrected

Hole No. 02 Sheet No. 3 Lot..... Total Depth..... 322m.
 Section..... Dep..... Logged By.....
 Date Begun..... Bearing..... Claim.....
 Date Finished..... Elev. Collar..... Core Size.....

DEPTH	DESCRIPTION	SAMPLE No.	WIDTH OF SAMPLE	Colour	grain	SG.	Box
550 - 556	Volcanic Sediments (Tuff)			light grey	wood	light	31
556 - 568	" " Breccia in broken sections some metal			"	"	"	31
568 - 575	" " Clay bands @ 575			dk grey	fine	med	32
575 - 587	" " (Ash)			light grey	med.	"	32
587 - 605	" " "			"	"	"	33
605 - 629	" " some breccia cemented @ 622 some metal			dk grey	"	"	34
629 - 643	" " "			light grey	"	light	35
643 - 661	" " white tuff inclusions @ 652 up			grey	"	"	36
661 - 679	" " structure to up to 60° leaning			"	fine	"	37
679 - 697	" " increase silica + moisture retention			"	"	"	38
697 - 716	" " white tuff inclusions			"	med	media	39
716 - 735	" " solid core @ 718 bleeding darker			"	"	"	40
735 - 753	some " alteration ind. increase banding @ 742 sulphides			"	fine	"	41
753 - 772	" " very light, with org. remains			grey	med	v light	42
772 - 791	" " "			"	"	"	43
791 - 808	" " some layering			dk grey	fine	"	44
808 - 812	" " alteration evid. increase in metallics			grey	med	"	45
812 - 820	" " some compacted green clay @ 815 "			"	fine	"	45
820 - 826	" " banded altered sediments			"	"	light	45
826 - 843	" " " " " " some metallics			"	"	media	46
843 - 861	" " clay heavy compacted + mineralized			"	"	heavy	47

DIAMOND DRILL RECORD

 PROPERTY Cariboo Rand

 HOLE No. 05-03

DIP TEST		
Footage	Angle	
	Reading	Corrected

 Hole No. 03 Sheet No. 1
 Section -60°
 Date Begun July 2-05
 Date Finished July 3-05

 Lat. 0615694
 Dep. 5793654
 Bearing 60° Az
 Elev. Collar 967 m

 Total Depth 618' = 189 m.
 Logged By Rudi Riepe
 Claim Rand 1
 Core Size N.R.

DEPTH	DESCRIPTION	SAMPLE No.	WIDTH OF SAMPLE	Colour	Grain	SG.	Box
1 - 10	Casing (left in hole)						1
10 - 12	Surface effed mostly volcanic sedimentary			grey	medium	med	1
12 - 14	" " limonite oxides minor metallics			gr-rusty	"	"	1
14 - 28	Volcanic Flow contact @ 14' Andesite with oxides			"	"	"	1
28 - 46	Dense andesite	"	on fracture	grey	fine	heavy	2
46 - 62	" "	"	"	"	"	"	3
62 - 78	" "	"	"	dk grey	"	"	4
78 - 96	" "	"	"	"	"	"	5
96 - 113	" Dacite + silica alteration Cu stain	"	"	"	"	"	6
113 - 129	" " " + banding			light grey	"	"	7
129 - 147	" " "			grey	"	"	8
147 - 165	" " "			"	"	"	9
165 - 182	" more andesitic			dk grey	"	"	10
182 - 202	" "			"	"	"	11
202 - 220	Solid core " some carbonate veinlets			"	"	"	12
220 - 237	Dense dacite metallics			"	"	"	13
237 - 254	" some sulphides			"	"	"	14
254 - 271	Contact @ 269 with banded volcanic sediment			"	"	medium	15
271 - 278	Banded layered coal some sulphides			black	"	light	16
278 - 290	" " clay to silt to sandstone increase Biotite gl blades			"	"	medium	17
290 - 308	Volcanic Sediments " " sulphides			grey	"	"	17

DIAMOND DRILL RECORD

PROPERTY Cariboo Rand

HOLE No. 05-04

DIP TEST		
Footage	Angle	
	Reading	Corrected

Hole No. 04 Sheet No. 1
 Section -60°
 Date Begun July 4 - 05
 Date Finished July 5 - 05

Lat. 06155.10
 Dep. 57936.33
 Bearing Azy 158°
 Elev. Collar

Total Depth 608' = 186 m
 Logged By Rud. Riepe
 Claim Rand 1
 Core Size N.O.

DEPTH	DESCRIPTION	SAMPLE No.	WIDTH OF SAMPLE	Colour	Grain	Sp. G.	Box
1 - 20	Casing in volcanic surface rubble						1
20 - 39	Andesite to dacite increased silica oxides		onslips	dk gray	fine	medium	1
39 - 56	Dacite oxides on fractures			"	"	"	2
56 - 73	" " "			"	"	"	3
73 - 91	" " " solid core			"	"	heavy	4
91 - 110	" " " "			"	"	"	5
110 - 127	" 126' rusty fractures minor carbonates			"	"	"	6
127 - 145	" " " "			"	"	"	7
145 - 163	" solid core			"	"	"	8
163 - 182	" " "			gray green	"	"	9
182 - 201	" " " "			"	"	"	10
201 - 218	" " " "			gray	"	"	11
218 - 236	" solid core			dk gray	"	"	12
236 - 255	" " " "			"	"	"	13
255 - 273	" some carbonate on fractures			"	"	"	14
273 - 291	" " " minor sulphides			dk green	"	"	15
291 - 293	" Andesitic contact with layered sediments @ 293'			"	"	medium	15
293 - 308	Volcanic sediments coal band + other organics		quiet sooty dk	"	"	"	16
308 - 328	" " layered dk bands			gray	"	"	17
328 - 346	" " compact clay			light gray	"	heavy	18
346 - 364	" " small conglomerate inclusion clay type		Agglom.	"	"	"	19

DIAMOND DRILL RECORD

PROPERTY Cariboo RandHOLE No. 05-05

DIP TEST		
Footage	Angle	
	Reading	Corrected

Hole No. 05 Sheet No. 1 Lat. 0617429
 Section -55 Dep. 5793492
 Date Begun July 5-05 Bearing Azy W
 Date Finished July 9-05 Elev. Collar 939 m

Total Depth 1022' = 312 m.
 Logged By Rudi Riepe
 Claim Rand 2
 Core Size NQ

DEPTH	DESCRIPTION	SAMPLE No.	WIDTH OF SAMPLE	Colour	Grain	SpG.	Box
1 - 10	Casing						
10 - 30	Volcanics dense Basalt intense fracture			Black	fine medium		1
30 - 38	Silty banded sandstone mix + conglomerate			dk grey	fine to coarse		2
38 - 56	Mixed sandstone breccia + dark organic inclusions			grey	" very "		3
56 - 86	Siltstone minor layering			dk grey	" "		3+4
86 - 91	sandstone buffaceous			grey	coarse light		4
91 - 100	Siltstone tuft inclusions trace pyrite throughout (1m)			dk brown	fine v. light		4
100 - 139	" fractured bluish staining minor sulphides			grey	fine light		5-6
139 - 160	stained blue (light) siltstone				fine		7-8
160 - 166	sandstone conglomerate inclusions			grey	coarse med		9
166 - 176	Siltstone massive with banding sulphides on fracture			Bl tabular	fine		9
176 - 187	sandstone minor alterations			lt grey	med		10
187 - 192	Layered sandstone + volcanic inclusions			dk grey	" to fine		10+11
192 - 208	Andesitic flow (bluestaining) sulphide small fract. dense			grey	med heavy		11
208 - 214	" " solid "			dk grey	fine		12
214 - 220	" " layered inclusions of conglomerates bluestain			"	"		12+13
220 - 228	" " Breccia in dark matrix			"	"		13
228 - 236	Andesite fractured Blue stain			"	"		14
236 - 242.5	" " " bleaching effect			beige grey	"		14
242.5 - 252	Volcanic sediments sandy Breccia inclusions			grey	coarse medium		14
252 - 270	" " " coarse " minor calstain			"	med.		15

DIAMOND DRILL RECORD

PROPERTY Cariboo Rand

HOLE No. 05-05

DIP TEST		
Footage	Angle	
	Reading	Corrected

Hole No. 05 Sheet No. 2 Lat. _____ Total Depth 312 m
 Section _____ Dep. _____ Logged By _____
 Date Begun _____ Bearing _____ Claim _____
 Date Finished _____ Elev. Collar _____ Core Size _____

DEPTH	DESCRIPTION	SAMPLE No.	WIDTH OF SAMPLE	Colour	Grain	SpG.	Box
270 - 288	Tuffaceous sandstone conglomerates throughout			grey from	Coarse	med.	16
288 - 305	" " " reds prev.			red bl. grey	"	"	17
305 - 315	" Conglomerate contents increasing	Sulphide	fine	throughout	"	"	18
315 - 324	Contact with Andesitic porphyro fractured + stained			grey	med.	"	18
324 - 338	Andesite (Porph) fine red phen's throughout			"	"	"	19
338 - 357	" " " increased brecciation			"	"	"	20
357 - 375	" " copper stain on fractures			"	"	"	21
375 - 393	" " "			"	"	"	22
393 - 406	" " "			"	"	"	23
406 - 421	" " @ 412 prominent	Pearl Sulphides		"	"	"	24
421 - 436	" " @ 42 "	"		"	"	"	25
436 - 451	" " @ 444 Contact with Volc Sedim.			light grey	fine	"	26
451 - 458	Volcanic Sediments minor sulphide some metallics			"	"	"	27
458 - 469	" matrix + conglomerates			"	med	"	28
469 - 483	" " "			grey	med. to coarse	"	28
483 - 499	" " "			"	"	"	29
499 - 508	Contact with fine silt grading into conglomerate			Sandy	"	"	30
508 - 517	Layered conglomerates + sandy			matrix	"	"	30
517 - 535	conglomerate in silty matrix			"	lenticular	"	31
535 - 545	Contact with Volcanic Sediments			grey	fine	"	32
545 - 588	Volcanic Sediment solid core to 588			large rock inclus. light grey	"	"	

DIAMOND DRILL RECORD

PROPERTY Cariboo Rand

HOLE No. 05-05

DIP TEST		
Footage	Angle	
	Reading	Corrected

Hole No. 05 Sheet No. 3 Lat. _____ Total Depth 312 m
 Section _____ Dep. _____ Logged By. _____
 Date Begun _____ Bearing _____ Claim _____
 Date Finished _____ Elev. Collar _____ Core Size _____

DEPTH	DESCRIPTION	SAMPLE No.	WIDTH OF SAMPLE	Colour	grain	SpG	Box
588 - 598	Volcanic Sediments Solid core			light grey	fine	med	34+35
598 - 608	" " " Some metal in core			"	medium	"	36
608 - 645	" " " "			"	"	"	37
645 - 663	" " " decreases ash content			"	"	"	38
663 - 682	Sandstone increas. opaquous (biotite dark)			"	"	heavy	39
682 - 700	" ash contents decreasing less sulphides			"	fine	med	40
700 - 710	Back to Volc. Sediments lesser opaquous "			very light	"	"	41
710 - 718	" " " "			darker	coarser	"	41
718 - 737	" " " "			dk grey	med	"	42
737 - 756	Sandstone Tuff bec. very coarse @ 751			grey	"	"	43
756 - 775	" Solid core			grey	fine	"	44
775 - 779	" "			"	"	"	45
779 - 786	" lesser Volcanic contents			light grey	"	"	45
786 - 795	Silt stone (clay compacted) conglomerate sections			dk grey	U. fine	"	45
795 - 813	" " "			grey	"	"	46
813 - 830	" " " false slips			"	"	"	47
830 - 849	" (expanded)			light	"	"	48
849 - 853	" (clay comp.)			dk grey	"	"	49
853 - 858	" coarse sections - in bands			grey	"	"	49
858 - 866	Sandstone with compact clay section @ 863			"	medium	"	49
866 - 869	" " " fine metallics			"	"	"	50

Statement of Costs

Rand # 1

Drilling costs as recorded per statement of July 18/05	\$128,732.21
Work on Rand # 1 mineral claim was performed by: Rudy C. Riepe, experienced prospector	
19 Field days at \$350 a day	\$6650.00
3 Office days at \$200 a day	\$600.00
	<hr/>
	\$135,982.21
Truck 4 by 4, 2005 GMC Crew Cab at \$60 a day	\$1140.00
Expenses and Travel	\$1750.00
Copies and Supplies	\$140.00
	<hr/>
Grand Total	\$146,862.21

Certified true and correct,



Signed:
Rudy C. Riepe