

OCT. 29 06

STAN STREIBCHUK

site 2 Comp. 48, RR # 1

NEW DENVER B.C. V06150

250 358 7201

ATTN: ROSIE.

MINERAL TITLES BRANCH

Ministry of ENERGY + mines

VANCOUVER B.C.

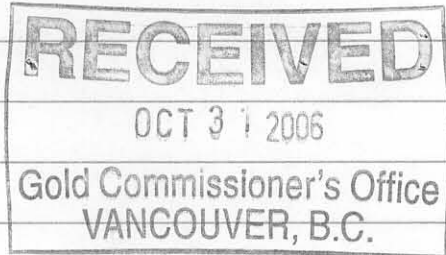

Physical + Technical assessment information, regarding
 Strube property / Tenure # 518270 / SLOAN Mining
 Division B.C. NTS 82F/13, For The July - NOV 2006
 season.

henson - GALENA Contractors h.t.d. Nakusp B.C. 250 265 ⁴¹⁰⁰~~7221~~
 (Ralph Allen).

MINDAS - GENEX Mining Company h.t.d. Silvertown B.C. ^{250 358} 2890
 (Bob Mills).

Map showing location + physical work / Road Rehab,
 Map showing Mine Plan approx 150 mtrs. under ground.
 Approx Cost For 2006 season. \$ 250,000

Work is ongoing.

28,588

Stan St.

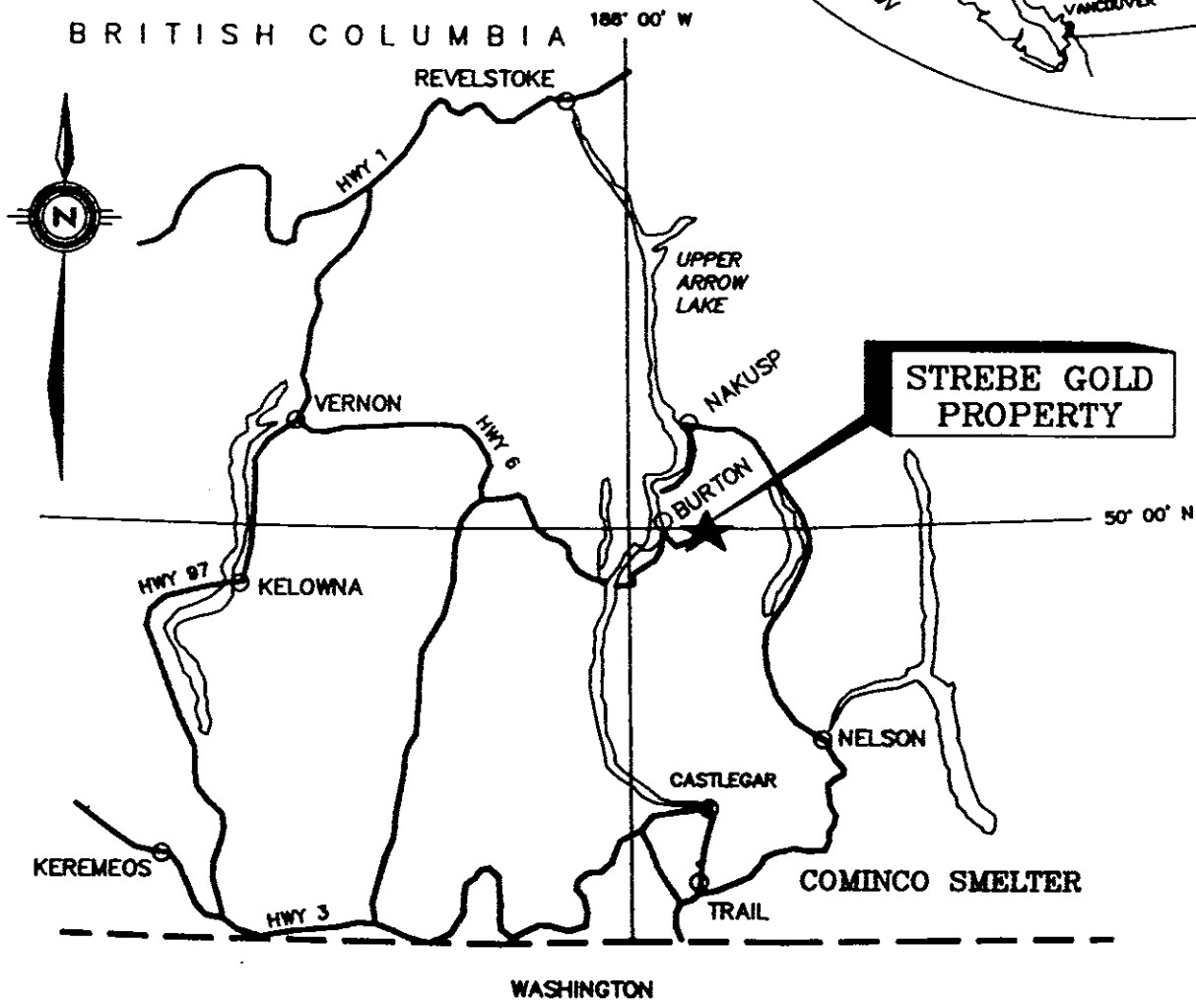
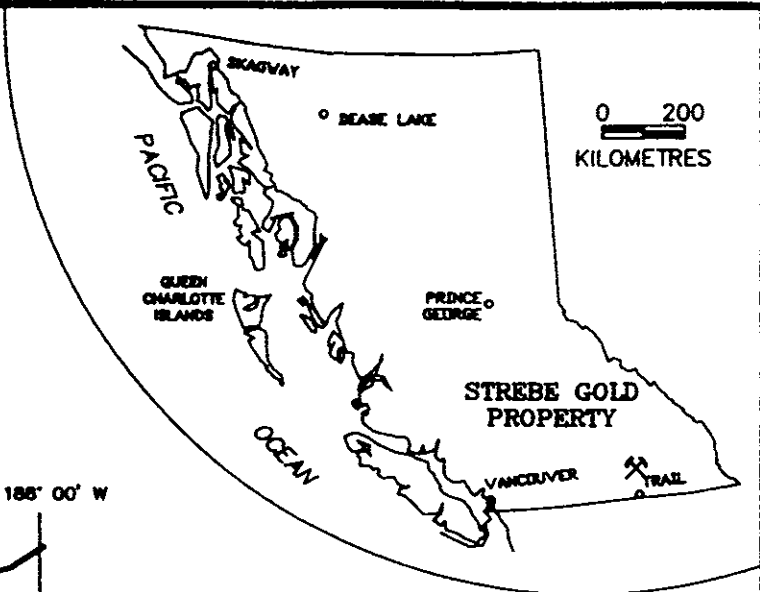

EXPLORATIONS LTD.	
STREBE GOLD PROPERTY	
SLOCAN MINING DIVISION, B.C. NTS: 82F/13	
LOCATION MAP	
DATE: 1982	FIGURE: 1

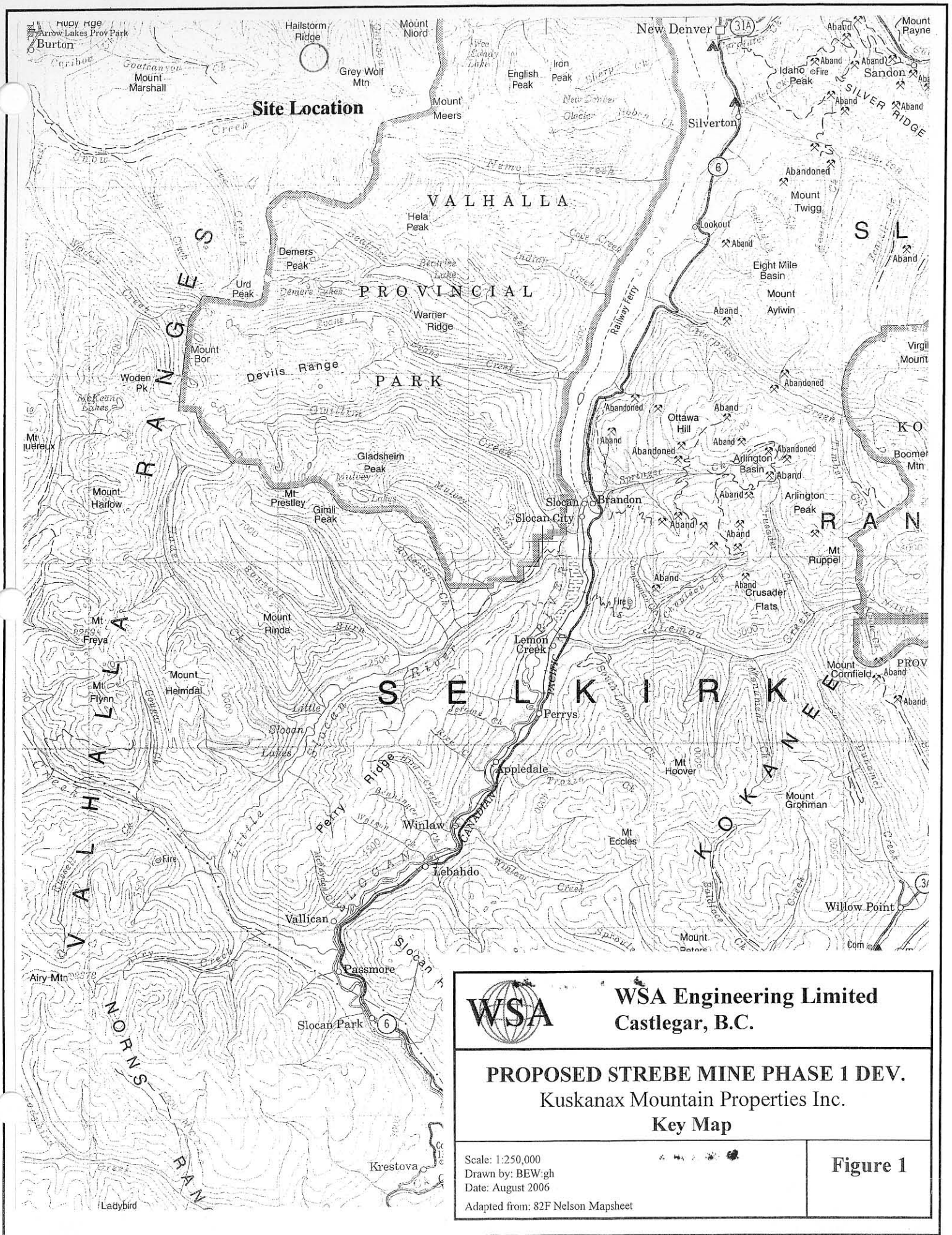

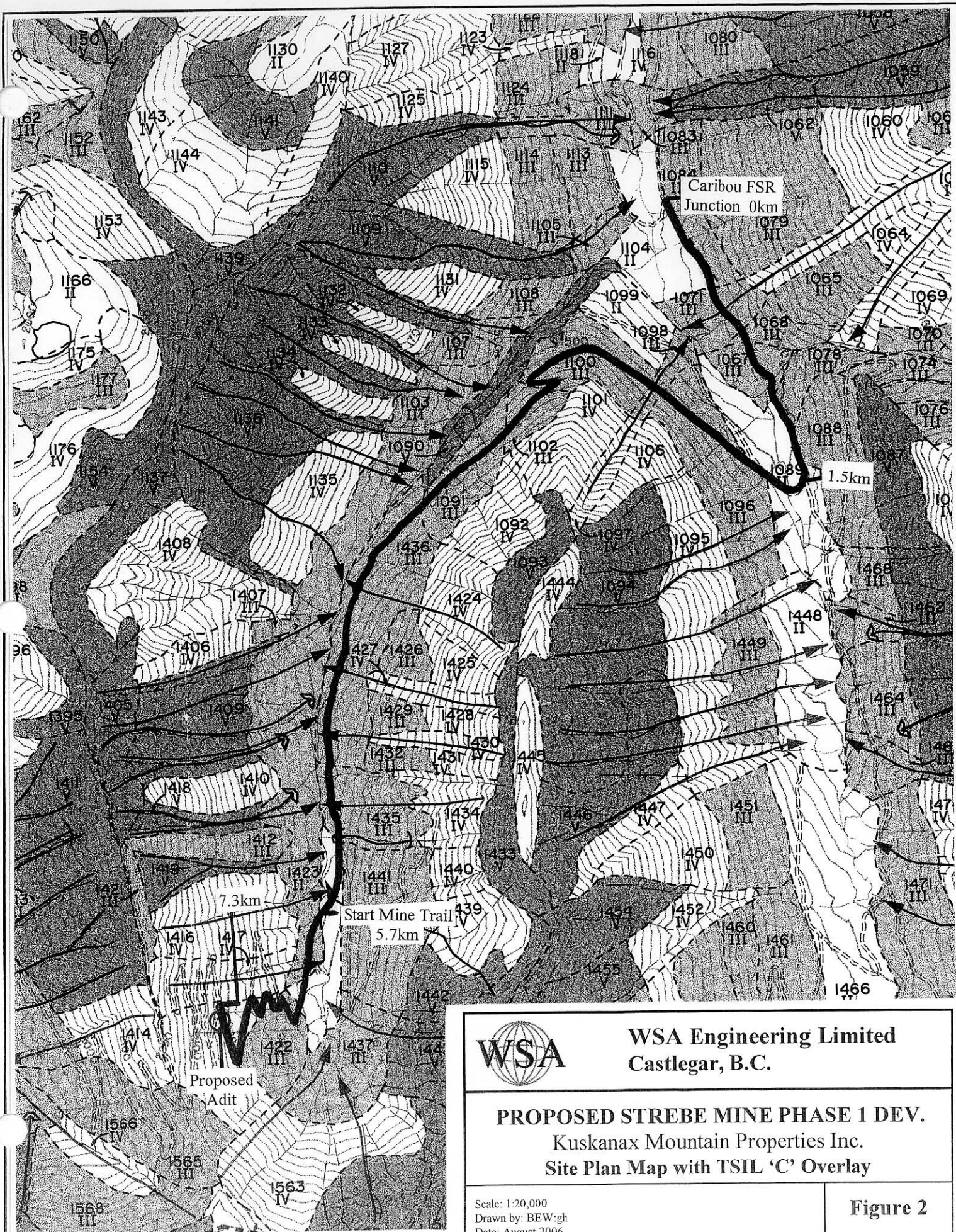

WSA Engineering Limited
Castlegar, B.C.

PROPOSED STREBE MINE PHASE 1 DEV.
 Kuskanax Mountain Properties Inc.
 Site Plan Map with TSIL 'C' Overlay

Scale: 1:20,000
 Drawn by: BEW:gh
 Date: August 2006

Figure 2

Map created Fri Feb 03 14:58:41 PST 2006

Legend

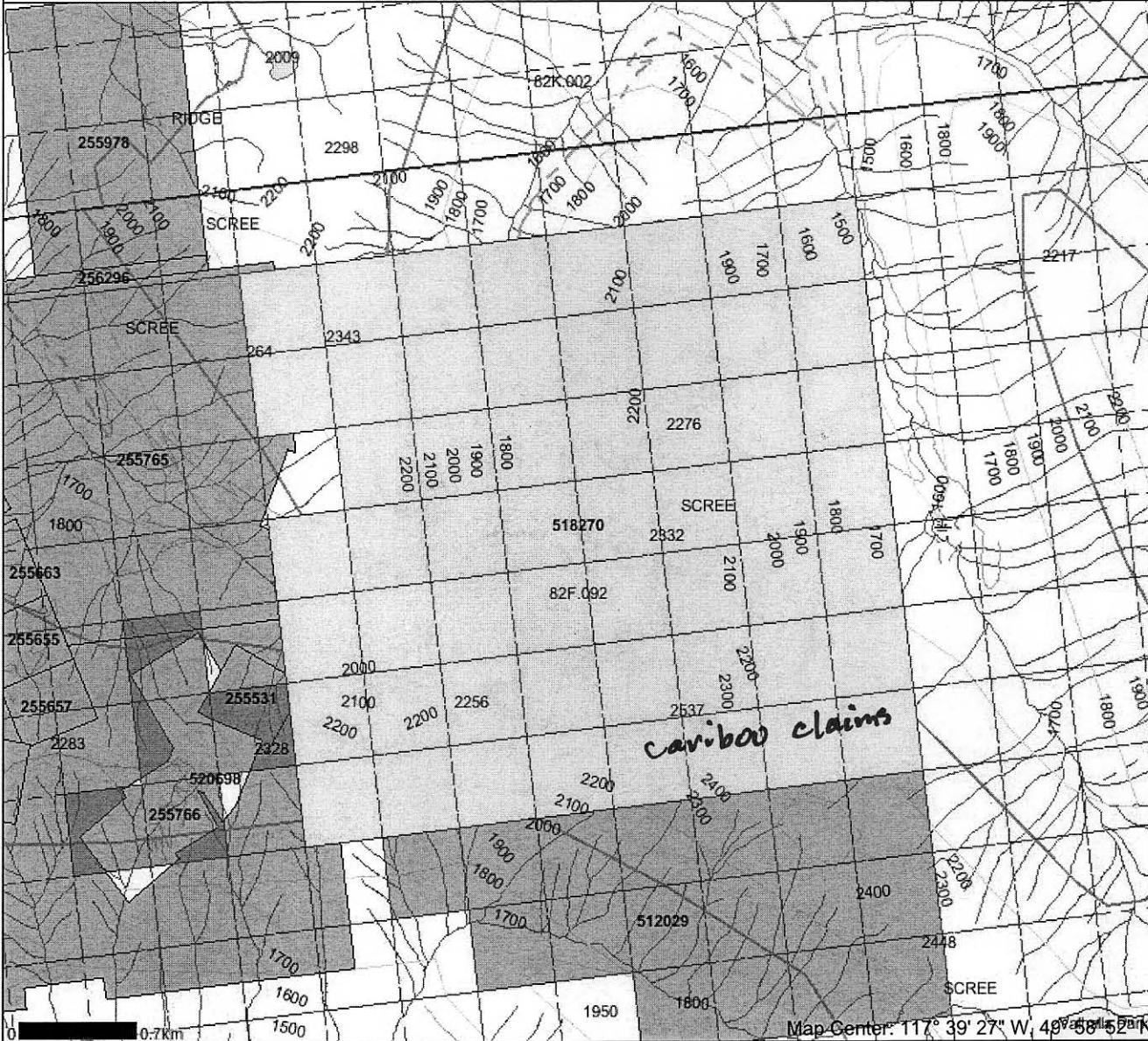

- Indian Reserves
- National Parks
- Parks
- Mineral Titles Grid
- Mineral Tenures
- Reserves (Sites)
- Placer Claim Designation
- Placer Lease Designation
- No Staking Reserve
- Conditional Reserve
- Release Required Reserve
- Surface Restriction
- Recreation Area
- Others
- Mining Divisions
- BCGS Grid
- Contours (1:250K)
- Contour - Index
- Contour - Intermediate
- Areaof Exclusion
- Areaof Indefinite Contours
- Transportation - Points (TRIM)
- Helipad
- Transportation - Lines (TRIM)
- Airfield
- Airport
- Airstrip
- AirportAbandoned
- Ferry Route
- Road (Gravel Undivided) - 1 Lane
- Road (Gravel Undivided) - 2 Lanes
- Road (Gravel Undivided) - U/C - 1 Lane
- Road (Gravel Undivided) - U/C - 2 Lanes
- Road (Paved Divided) - Not Elevated - 1 Lane Each Way
- Road (Paved Divided) - Not Elevated - 2 Lanes Each Way
- Road (Paved Divided) - U/C - Not Elevated - 2 Lanes Each Way
- Road (Paved Undivided) - Not Elevated - 1 Lane
- Road (Paved Undivided) - Not Elevated - 2 Lanes
- Road (Paved Undivided) - Not Elevated - 4 Lanes
- Road (Paved Undivided) - U/C - Not Elevated - 4 Lanes
- Road (Unimproved)
- Cut (Roadway)
- Embankment/Fill (Roadway)
- Trail
- Bridge - Foot
- Bridge - Trestle
- Tunnel
- Bridge
- Rail Line (Double Track)
- Rail Line (Multiple Track)
- Rail Line (Single Track)

Scale: 1:35,427

DO NOT USE FOR NAVIGATION

Payment Receipt

Service Provided: Mineral Tenure Operation

Date:	Aug 15, 2006	Transaction Type:	Purchase
Card Type:	Visa	Amount:	\$ 457.09
Card Number:	xxxxxxxxxxxx0556	Invoice Number:	110053333

Note 1: *The above card number is hidden for privacy.*

Approval Code:	097532	Response Message:	0APPROVED 097532
Host Date/Time:	Aug 15, 2006 / 12:16:41pm	Sequence Number:	009001001065
ISO Response Code:	00	Terminal ID:	BCGOVEMMTO
Response Code:	001		

Note 2: *"Mineral Tenure Operation" will appear on your credit card statement.*

Click [here](#) to print this receipt.

REPORT OF PHYSICAL EXPLORATION AND DEVELOPMENT
Section 15 - Mineral Tenure Act Regulation

1. Event number: <i>4097929</i>	2. Tenure number(s): <i>518270</i>	3. Type of Tenure: <input checked="" type="checkbox"/> Mineral, or <input type="checkbox"/> Placer
4. Recorded holder:	Address:	Phone:
5. Operator: <i>GALENA CONTRACTORS LTD.</i>	Address: <i>P.O. Box 70 NAKUSP B.C. V0G 1R0</i>	Phone: <i>250 265-4100</i>
6. Report author:	Address:	Phone:
7. Qualifications of operator:	<i>35 YEAR ROAD BUILDING, EXCAVATION AND SITE PREP EXPERIENCE</i>	

8. Brief summary of work activity on claim(s) in recent years:	<i>INSTALL BRIDGE, BRUSHING, PITCHING + CULVERT INSTALLATION TO EXORATION ADIT SITE.</i>
--	--

NEW WORK (Attach additional sheets if more space is required)

9. Start date: <i>July 16 06</i> Stop date: <i>NOV. 1 06</i>	10. Tenure number(s) of claim(s) that work was performed on: <i>518270</i>
11. Detailed written description of the work activity and results obtained: (If ground control or survey work is being claimed please attach plan(s) as required by Section 15 of the Regulations)	<i>Access Adit Approx 150 mtrs. in length completed. Test sample will be postponed till spring Assay results still pending.</i>
12. Metric dimensions of workings: (Open cuts, adits, pits, shafts, trenches)	<i>• Approx 3 mtr x 3 mtr. x 150 mtr. underground drift. purpose Test sample.</i>
13. Amount of material excavated and tested or processed: (metric units)	<i>Approx. 1200 Ton. development rock</i>
14. Geographic location of work sites: (access description, map numbers, map coordinates) Attach 1:10,000 scale MTO map	<i>Test sample not yet accomplished.</i>

Continue on following page

15. Was GPS used to map work sites? If yes, specify make and model: <i>TOPCOM, HUPER +</i>	16. Work site(s) marking (flagging, cut lines, other):
17. Are photographs of work sites attached? <i>YES</i>	18. Was Notice of work filed? Permit number: <i>MX-5-588</i>

These costs are yet unknown, in completion.

19. Expense(s):	Total Hours	Hourly Rate	Daily Rate	Total(s) (\$)
Labour cost: (specify type)				
Equipment & Machinery cost: (specify type)				

20. Transportation: (specify type)	Rate(s)	Days / Distance	Total(s) (\$)
Lodging / Food:			
Other: (specify)			
Total costs:			
Amount claimed for assessment:			

Alan D.W.

 (Signature of Recorded Holder / Agent)

Oct 29 06

 (Date)

**Please ensure you attach the map.
 This report must be submitted within 30 days of the date
 you registered the exploration and development work in MTO.**

Submit the report to any Government Agent, Mineral Titles Office, or you can mail to:
 Mineral Titles Branch
 Ministry of Energy, Mines and Petroleum Resources
 300 - 865 Hornby Street
 Vancouver, BC V6Z 2G3



Contact Us ► Help ?

B.C. HOME

Mineral Titles

Mineral Titles Online

Mineral Claim Exploration and Development Work/Expiry Date Change

- Select Input Method
- Select/Input Tenures
- Input Lots
- Data Input Form
- Review Form Data
- Process Payment
- Confirmation

- [Main Menu](#)
- [Search Tenures](#)
- [View Mineral Tenures](#)
- [View Placer Tenures](#)

→ [MTO Help Tips](#)

Exit this e-service ►

Mineral Claim Exploration and Development Work/Expiry Date Change

Confirmation

Recorder: STANLEY ALEXANDER STREBCHUK (125976)

Submitter: STANLEY ALEXANDER STREBCHUK (125976)

Recorded: 2006/AUG/15

Effective: 2006/AUG/15

D/E Date: 2006/AUG/15

Your report is due in 90 days. Please attach a copy of this confirmation page to the front of your report.

Event Number: 4097929

Work Start Date: 2006/JUL/01

Total Value of Work: \$ 41329.74

Work Stop Date: 2006/AUG/14

Mine Permit No:

Work Type: Technical and Physical Work

Physical Items: Labour, Machinery and equipment

Technical Items: Geological, Geophysical, Road and trail work

Summary of the work value:

Tenure #	Claim Name/Property	Issue Date	Good To Date	New Good To Date	# of Days Forward	Area in Ha	Work Value Due	Sub-mission Fee
518270		2005/JUL/26	2006/AUG/23	2007/AUG/23	365	1142.73	\$ 4570.92	\$ 457.09

Total required work value: \$ 4570.92

PAC name: strebe

Debited PAC amount: \$ 0.00

Credited PAC amount: \$ 36758.82

Total Submission Fees: \$ 457.09

Total Paid: \$ 457.09

The event was successfully saved.

Please use **Back** button to go back to event confirmation index.

Back

Logs Unlimited
P.O. Box 447
Nakusp, B. C.
VOG 1R0

10-Aug-06

Kuskanax Mountain Properties Inc.
P.O. Box 404
Nakusp, B. C.
VOG 1R0

RE: Bridge, Installation and Related Costs to Completion

Bridge	12,500.00	
Lowbed Grader (In/Out)	\$400.00	
Haul Blocks	\$700.00	
Haul Bridge	\$750.00	
Install Blocks	\$800.00	
Install Bridge	\$400.00	
Grade road to accommodate lowbed	\$1,600.00	
Extra's: Bolts, Drill Rental	\$65.00	
	<u>Sub-total</u>	<u>\$17,215.00</u>
		\$17,215.00
4 hrs. extra road grade (Bridge to 1st switchback)	\$400.00	
	<u>Sub-total</u>	<u>\$400.00</u>
		\$17,615.00
Lowbed D6 to Hicks	\$625.00	
Lowbed 325 to Nakusp	\$500.00	
	<u>Sub-total</u>	<u>\$1,125.00</u>
		\$18,740.00
	6% GST	\$1,124.40
	TOTAL	\$19,864.40

GALENA CONTRACTORS LTD.



Phone: (250) 265-4100 Fax: (250) 265-3831
 Box 70, Nakusp, BC V0G 1R0
 email: galenacontractors@telus.net



July 29, 2006

Kuskanax Mountain Properties
 Nakusp, BC V0G 1R0

Invoice #: 7599

Job # 06100 - FRLD

- EX102 - 1997 Caterpillar 325B Excavator
- CA304 - 1990 Caterpillar D6H Dozer

Machine	EX102 (Machine Only)	CA304	CA304 (Machine Only)
Rate	\$ 109.15	\$ 120.56	\$ 85.90
16-Jul-06	8		
18-Jul-06	8		
20-Jul-06	8	9.5	
21-Jul-06	7	9	
23-Jul-06	0		
24-Jul-06	9		
25-Jul-06	4		8
26-Jul-06	8		8
27-Jul-06	8		8
28-Jul-06	8		
29-Jul-06	8	8	
30-Jul-06	9	9	
Total Hours	85	35.5	24

Strebchuk's Wages	July 2 - 8	\$ 769.60
	July 9 - 15	\$ 291.20
	July 16 - 22	\$ 1,289.60

Culverts	9 meters of 450s	\$ 349.74
	4.5 meters of 600s	\$ 233.60
	16 meters of 300s	\$ 441.12

POSTED

Culverts \$ 1,024.46 (PST)
 Strebchuk's Wages \$ 2,350.40
 Payroll Overhead - 20% \$ 470.08
 EX102 - 85 hours at \$109.15 per hour \$ 9,277.75
 CA304 - 35.5 hours at \$120.56 per hour \$ 4,279.88
 CA304 - 24 hours at \$85.90 per hour \$ 2,061.60
 Lowbed Charges (see attached) \$ 718.50

Total Amount \$ 20,182.67
 6% GST on \$20,182.67 1,210.96
 7% PST on \$1024.46 71.71
\$ 21,465.34

Terms: Payment due within 30 days, interest charged at 2% per month on overdue accounts.

**ENGINEERING LIMITED**

2248 Columbia Avenue Castlegar, BC V1N 2X1

e-mail mail@wsaeng.ca

Tel: (250) 365-3696

Fax: (250) 365-3607

August 18, 2006

Kuskanax Mountain Properties Inc.
Box 70
Nakusp, BC
V0G 1R0

Attn. Ralph Allen

**RE: GEOTECHNICAL ASSESSMENT
PROPOSED STREBE MINE PHASE I DEVELOPMENT**

INTRODUCTION

At the request of Mr. Ralph Allen of Kuskanax Mountain Properties Inc., WSA Engineering Ltd., (WSA) conducted a field review of the proposed access road construction and mine adit portal site within the Caribou Creek drainage near New Denver, BC. The purpose of the assessment was to assess the stability of the access roads and portal site, and provide an estimation of the scope of reclamation works that would be required once the Phase I development is completed and an estimate of the reclamation cost.

PROJECT DESCRIPTION

The Strebe Mine property is located on the lower slopes of the upper reaches of Caribou Creek drainage, approximately 20 km west of New Denver, BC (see Figures 1 and 2). The property is centered at Latitude 49°58'08" and Longitude 117°39'13". The Strebe Mine site is accessed by traveling approximately 0.8 km along Bonanza Road from Highway 6 near the community of Hills, to access the Shannon Creek Forest Service Road (FSR), then approximately 27 km along the FSR to a non-status forestry access road which accesses the upper portions of the Caribou Creek drainage. Approximately 1.5 km along this road the mine access branches west across the east fork of Caribou Creek and traverses west then south into the west fork drainage. At approximately 5.7 m from the FSR junction, the old logging road access ends and the mine access trail begins. The trail crosses the west fork then switchbacks seven times up to the existing portal access trail location at 7.3 km from the FSR junction.

The Phase I development plan includes the construction of an approximate 1.5 m x 2.1 m exploration tunnel (adit) extending approximately 65 m horizontal into the mountain slope to intercept an ore vein. A bulk sample of ore will be removed from the mine to evaluate the feasibility of future development phases. Approximately 300 m³ of waste rock will be generated by the adit excavation and ore removal works. The waste material is to be wasted by filling onto the existing access trail grade directly downslope from the adit portal.

BACKGROUND INFORMATION

Predecessor companies of WSA Engineering Ltd., including the Nelson, BC branch office of R.T. Banting Engineering Ltd., McIntyre Woods Geotechnical Engineers, and Woods Associates Engineering, completed numerous Terrain Stability Field Assessment and Mapping projects in the Caribou Creek drainage. The projects that were most specific to the Strebe Mine development site include a Detailed Terrain Stability Mapping project (TSIL 'C') and a Geotechnical Review of road deactivation prescriptions by R.T. Banting Engineering Ltd., for Slocan Group in 1996. These project reports were reviewed by WSA in completing the current assessment of the Strebe Mine site.

An excerpt from the TSIL 'C' Terrain Stability Map is included in Figure 2. The logging roads that are being used to access the mine site are situated within Terrain Stability Class (TSC) III and II terrain, which has been rated as having a Low and Very Low (respectively) hazard of landslide initiation following conventional sidecast road construction. The mine access trail above the first switchback crosses terrain that is rated as TSC IV, which represents a Moderate hazard of landslide initiation based primarily on the slope steepness and the presence of gullies.

FIELD REVIEW

A field assessment was completed by Mr. Bryan Woods, P. Eng., of WSA on July 25, 2006 with Mr. Allen. A vehicle traverse was conducted of the existing access road and trail, and foot reconnaissance was conducted of the adit portal site. At the time of the review the mine access from the FSR junction had been upgraded as needed by filling cross-ditches, brushing, cleaning ditches, and installing culverts that had been removed during previous road deactivation works. The mine access trail had also been upgraded by widening the existing trail, and at the time of the review the switchbacks were being widened to facilitate the mobilization of a large compressor that would be required to complete the adit excavation work.

OBSERVATIONS

The Caribou FSR is generally in good drive-able condition from the Bonanza Road junction to the non-status road junction at approximately 27 km. The road is maintained on a seasonal basis to a 2WD standard by the Ministry of Forests. From the non-status road junction to 1.5 km, the existing road is in generally good condition and required little or no upgrading works.

From 1.5 km the access road is narrower and had been semi-permanently deactivated with installation of frequent cross-ditches, and an old log culvert located on the east fork of Caribou Creek had been removed and replaced with a 4WD accessible ford. It is understood that a bridge or large culvert is intended to be installed at the crossing. At the time of the review the cross-ditches had been filled, the road surface and ditchline brushed, and the ditch and culvert inlets cleaned.

From the end of the old logging access, the mine trail crosses the west fork of Caribou Creek and traverses up the west slope of the valley. The slopes gradually increase up to 50% at the first switchback location, then increase to 65% at the portal location with localized areas of relief. The entire trail had been widened approximately 1 m by additional excavation into the cut bank and side-cast filling along the outside shoulder. The first switchback had been substantially expanded by similarly cutting into the bank around the top of the curve and placing material in lifts below the switchback, working upward from the fill toe. It is understood that similar works have been conducted on the upper six switchbacks subsequent to the field review.

Soils exposed in the access trail cut banks consisted of silt and sand with some gravel (colluvium) and isolated deposits of silty sand and gravel glaciofluvial soils, overlying bedrock within 2 m depth. Bedrock depth was observed to decrease up the slope and was inferred to be within 0.5 m of the ground surface at the proposed portal location. The slopes crossed by the mine access trail were observed to be generally well drained and dry, aside from a small ephemeral stream draw that passes a short distance north of the 3rd and 5th switchbacks. Also, a relatively small amount of groundwater seepage had been encountered emanating from the bedrock exposed in the first and third switchback cut banks.

Below the portal location where the waste rock is proposed to be spoiled, the trail crosses a 50% slope that is dry and stable. The trail grade dips approximately 2 m through the proposed spoil location. Approximately 5 m below the trail the slope increases to 60%. The plan for placing the spoil is understood to consist of excavating a key (trail) below the existing trail above the steeper slope break, then placing rock from the key upwards and onto the existing trail surface to create a level road grade.

The mine portal site is located on an approximate 65% slope that is dry and stable, and underlain by bedrock at a shallow depth. The bedrock in the area is variable, but generally consists of Meta sediments of the Milford Group. The bedrock was observed to be reasonably competent with favorable structure. No evidence of bedrock failure was observed in the area during the field review nor identified by the TSIL 'C' mapping.

RECOMMENDATIONS

The field assessment found that the mine access roads and mine portal are located on stable terrain. Based on the proposed development plan, the hazard of landslide initiation is rated as Low, provided the road upgrading works are conducted in accordance with BC Forest Industry standards. Specifically, this would include stripping beneath and keying in the switchback fills and construction of the fills from the toe upward, and controlling surface water and intercepted subsurface water with the installation of culverts at natural drainage features (streams, gullies, and draws) wherever possible. The area where the mine waste rock is to be spoiled should also be stripped of organics and the fill keyed in and constructed from the toe upward.

The area of the adit portal is considered to be stable and not subject to any significant natural hazards. However, the slopes around the portal location are relatively steep and precautions are required to avoid destabilizing the slopes from placement of excessive fill or discharge of mine drainage. Soil cuts excavated above and adjacent to the portal location to expose the bedrock surface should be sloped no steeper than 1H:1V.

Provided the waste site and switchbacks are constructed in a stable manner, reclamation works required for the site following the Phase I development will be limited to deactivation of the mine trail and logging access road (not including the FSR), and broadcast seeding of exposed soils in the waste site and around the portal location. Deactivation requirements for the roads will include primarily installation of cross-ditches at all drainage features and backup cross-ditches at all cross-drain culverts, and possibly some minor fill slope pullback. Deactivation costs for this level of work would typically run no more than \$400/km. Based on the 7.3 km length of mine trail and logging access road to be deactivated, the total reclamation cost is expected to be less the \$5,000 including mobilization of crews and equipment.

CLOSURE

This report has been prepared for the exclusive use of Kuskanax Mountain Properties Inc., and is in accordance with generally accepted geotechnical engineering principles and practice. No other warranty, expressed or implied, is made. Any use which a third party makes of this report, or any reliance on or decisions to be made based on it, are the responsibility of such third parties. WSA Engineering Ltd. accepts no responsibility for damages, if any, suffered by any third party as a result of decisions made or actions based on this report.

If there are any questions or concerns regarding the foregoing information, please contact the undersigned at your convenience.

Respectfully submitted,
WSA ENGINEERING LTD.

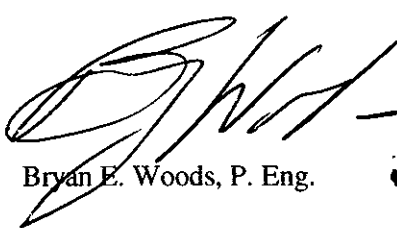
Bryan E. Woods, P. Eng.

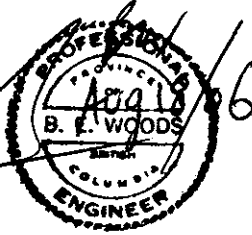

BEW:gh

Attachments: Figure 1 – Key Map (1:250,000 scale)
Figure 2 – Site Plan Map with TSIL ‘C’ Overlay (1:20,000 scale)



WSA ENGINEERING LIMITED
 2248 Columbia Avenue Castlegar, BC V1N 2X1

ph 250-365-3696
 fx 250-365-3607

Date: August 31, 2006
Invoice # 5797

Invoice submitted to:

Kuskanax Mountain Properties Inc.
 c/o Galena Contractors Ltd.
 Box 70
 Nakusp BC V0G 1R0
 Attn: Ralph Alen

In Reference To: 06001-083 Strebe Mine Geo Assess

FINAL INVOICE

For Services Rendered as Follows:

Professional Services

	<u>Hrs/Rate</u>	<u>Amount</u>
7/24/2006 - BEW Senior Geotechnical Engineer - Field	6.50	650.00
	100.00/hr	
8/17/2006 - GH Administration	1.00	50.00
	50.00/hr	
8/18/2006 - ER Administration	0.50	25.00
	50.00/hr	
8/16/2006 - BEW Senior Geotechnical Engineer - Office GES	3.00	300.00
	100.00/hr	
8/17/2006 - BEW Senior Geotechnical Engineer - Office GES	4.00	400.00
	100.00/hr	
8/18/2006 - BEW Senior Geotechnical Engineer - Office GES	3.00	300.00
	100.00/hr	
Total Professional Services Rendered	18.00	\$1,725.00

Project Costs

	<u>Qty/Price</u>	
7/24/2006 - BEW Vehicle - day rate	1	57.00
	57.00	
- BEW Kilometers	340	170.00
	0.50	
Total Costs		\$227.00
GST-891850588RT0002		\$117.12

APPROVED
BY: _____

Kuskanax Mountain Properties Inc.

Page 2

Amount

Total Amount Due This Invoice

\$2,069.12

BALANCE DUE

\$2,069.12

TERMS: 30 DAYS FROM INVOICE DATE
INTEREST AT 2% PER MONTH ON OUTSTANDING BALANCE

Side View B-B

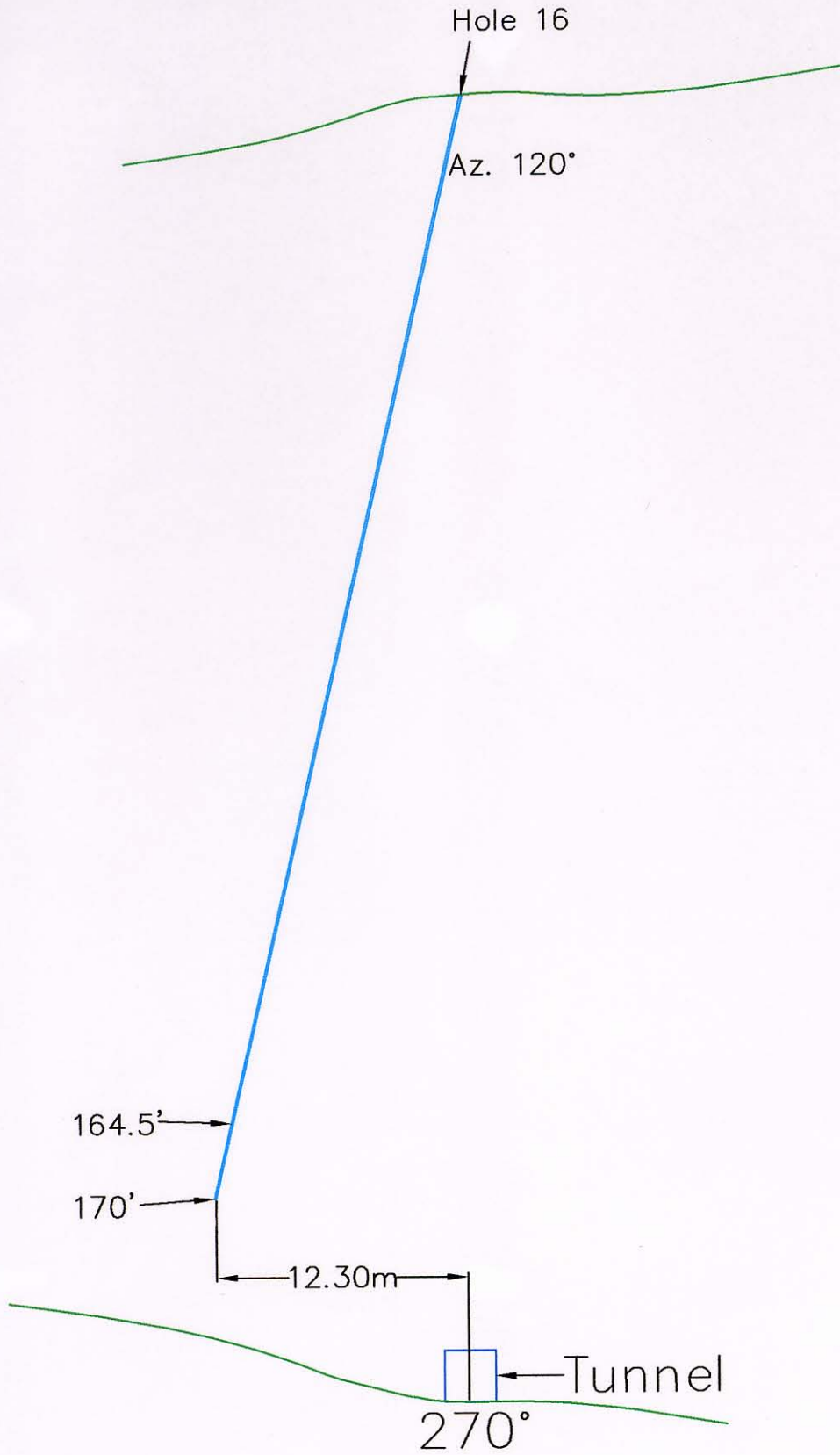

Side View A-A

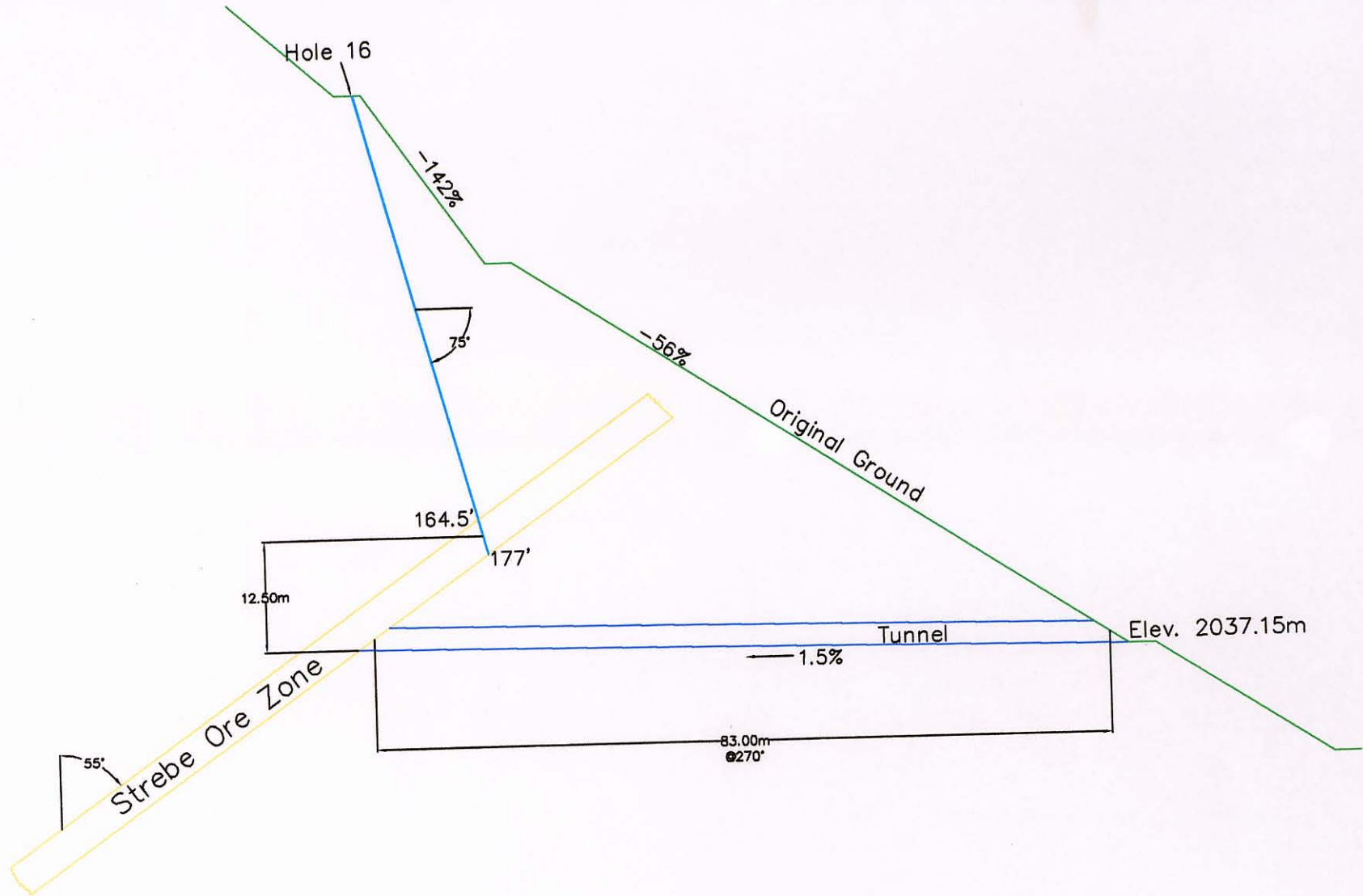

Plan View

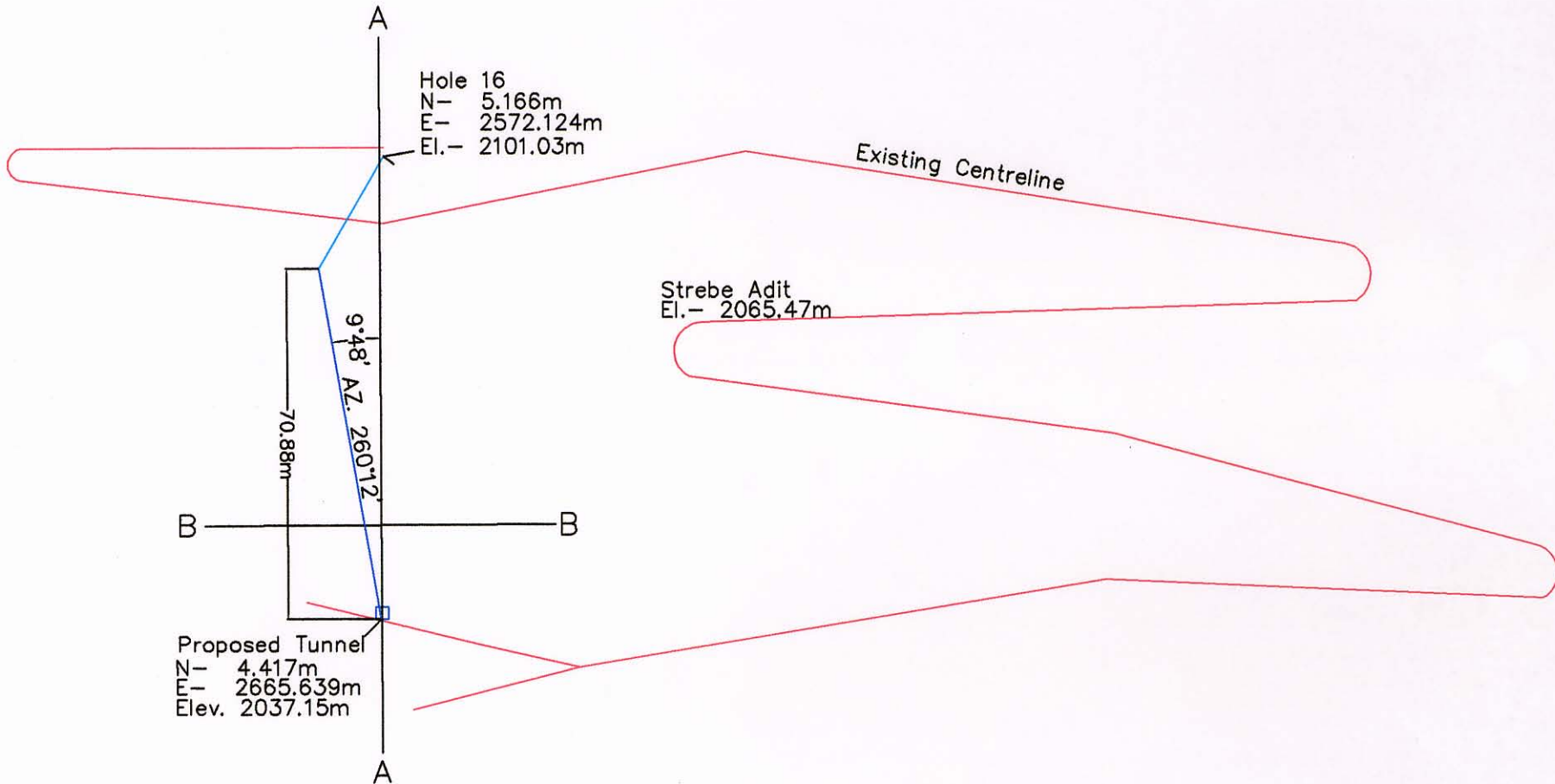

NOTE: All Coordinates are based on Table II (list of 1988 Drill Holes)







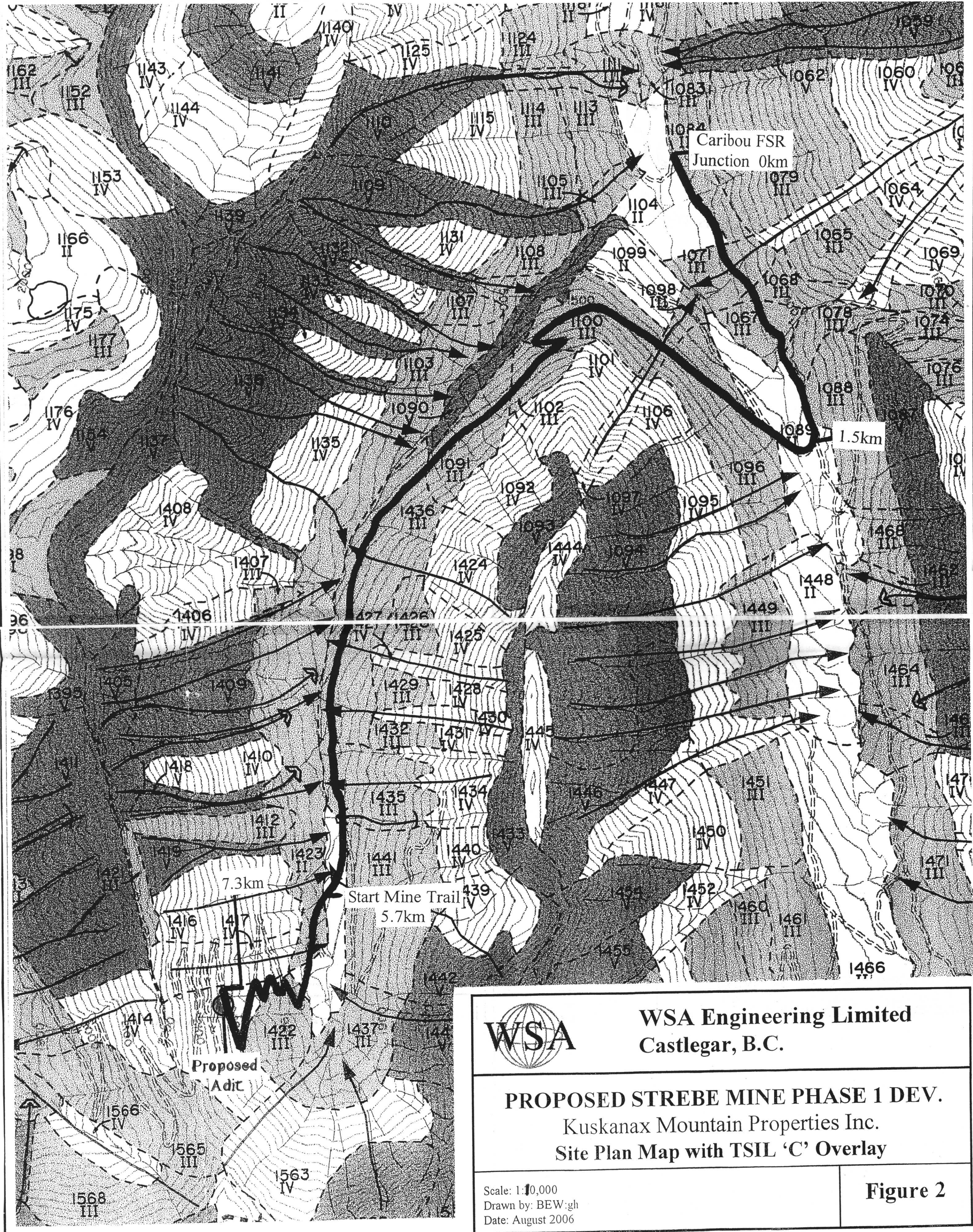

WSA Engineering Limited
Castlegar, B.C.

PROPOSED STREBE MINE PHASE 1 DEV.
 Kuskanax Mountain Properties Inc.
 Site Plan Map with TSIL 'C' Overlay

Scale: 1:10,000
 Drawn by: BEW:gh
 Date: August 2006

Figure 2

